

ASSESSMENT BOOK

FOR THE YEAR

1942

Town of Shingobee

CASS COUNTY, MINN.

MILLER-DAVIS COMPANY

PRINTERS, BLANK BOOK MAKERS, STATIONERS, LEGAL BLANKS,
BANK AND COUNTY SUPPLIES
219-221 SO. FOURTH ST., MINNEAPOLIS, MINN.

1 Assessment of Taxable Unplatted Real Property in the Town of Shingabe, County of Cass, Minn., for the Year 1942.

HOMESTEADS, up to True and Full Value of \$4,000.00, Assessable at 20 per cent, Class 3B, Remainder at 33 1/3 per cent, Class 3.

| NAME OF OWNER | School District | DESCRIPTION OF PROPERTY | | | | Indicate Homestead | ASSESSOR'S VALUATIONS | | | | | EQUALIZED VALUATIONS | | | | | |
|--------------------------------------------------|-----------------|------------------------------------------|-------------|---------------|--------------|--------------------|-------------------------|-----------------------------------------------------------------------|-------------------------------------------------------|----------------------------------------------------------------------|------------------------------------------------------------------------------------------|--------------------------------------------------------------------|--------------------------------------------------------|------------------------------------------------------------------------------------|------------------------------------------------------|-------------------------------------------------------|-----------------------------------------------------------------|
| | | SUBDIVISION | Sec. or Lot | Twp. or Block | Rng. or Rng. | | Number of Acres of Land | True and Full Value of Lands Exclusive of Structures and Improvements | STRUCTURES AND IMPROVEMENTS | | Total True and Full Value of Lands, Including all Structures, Improvements and Machinery | Assessed Value of Homesteads up to \$4,000 at 20 per cent Class 3B | Assessed Value of Remainder at 33 1/3 per cent Class 3 | Total Assessed Value of Lands Including all Structures, Improvements and Machinery | Total Assessed Value as Equalized by Board of Review | Total Assessed Value as Equalized by the County Board | Total Assessed Value as Equalized by the Department of Taxation |
| | | | | | | | | | True and Full Value of Buildings and other Structures | True and Full Value of Machinery Permanently Attached to Real Estate | | | | | | | |
| | 5 | NE 1/4 of NE 1/4 | | 1 | 141 | 31 | | | | | | | | | | | |
| | | NW 1/4 of NE 1/4 | | | | | | | | | | | | | | | |
| | | SW 1/4 of NE 1/4 | | | | | | | | | | | | | | | |
| | | SE 1/4 of NE 1/4 | | | | | | | | | | | | | | | |
| M. C. Cole | | all of lot 7 except 1/290' x less 2 acc. | | | | 740 | ✓ | 180 | 266 | 294 | 444 | 460 | 89 | 92 | 89 | | |
| Ernest & Florence Richardson | | NE 1/4 of NW 1/4 297' x 336' of lot 7 | | | | 2 | ✓ | 40 | 228 | 240 | 28 | 280 | 56 | 56 | 54 | | |
| | | NW 1/4 of NW 1/4 | | | | | | | | | | | | | | | |
| | | SW 1/4 of NW 1/4 | | | | | | | | | | | | | | | |
| Hazel Elliott | | SE 1/4 of NW 1/4 Lot 6 | | | | 2650 | | 520 | 477 | 4145 | 300 | 4757 | 1586 | 1655 | 1586 | | |
| Ali Girardier | | 1/2 of NE 1/4 of SW 1/4 | | | | 21 | | 188 | | 168 | | 56 | 56 | 56 | 56 | | |
| | | NE 1/4 of SW 1/4 | | | | | | | | | | | | | | | |
| | | NW 1/4 of SW 1/4 | | | | | | | | | | | | | | | |
| Thomas E. & Tomogene Seever | | NE 1/4 of SE 1/4 of SW 1/4 | | | | 10 | | 120 | | 120 | | 40 | 40 | 40 | 40 | | |
| Ernest Miller | | SE 1/4 of SW 1/4 | | | | 2914 | ✓ | 240 | | 240 | 48 | 48 | 48 | 48 | 48 | | |
| J. E. & Merle M. Meyer & Mabel L. Mitchell | | Lot 8 | | | | 2115 | ✓ | 500 | 227 | 2365 | 277 | 2865 | 573 | 573 | 549 | | |
| W. J. Becker | | NE 1/4 of SE 1/4 1/290' of lot 7 | | | | 1003 | | 261 | 314 | 330 | 575 | 591 | 192 | 197 | 197 | | |
| John L. Ruffin | | 1/2 of NW 1/4 of SE 1/4 | | | | 20 | | 153 | | 153 | | 51 | 51 | 51 | 51 | | |
| Ali Girardier | | 1/2 of NW 1/4 of SE 1/4 | | | | 20 | | 153 | | 153 | | 51 | 51 | 51 | 51 | | |
| Lewis Lieske | | SE 1/4 of SE 1/4 less 1.44 acc. | | | | 3856 | | 312 | | 312 | | 104 | 104 | 104 | 104 | | |
| Francis Bloom | | 1/2 of SW 1/4 86 1/2 | | | | 20 | | 180 | 228 | 240 | 408 | 420 | 136 | 140 | 136 | | |
| Ruth F. Miller | | 1/2 of SW 1/4 1/2 1/4 of lot 371 | | | | 350 | | 45 | | 45 | | 15 | 15 | 15 | 15 | | |
| Ruth F. Miller (Cont. for deed to A. C. Forrest) | | 1/2 of SW 1/4 1/2 1/4 of lot 371 | | | | 180 | | 180 | 428 | 450 | 60 | 688 | 138 | 138 | 134 | | |
| | | | | | | 22428 | | 3052 | 2488 | 8050 | 360 | 11462 | 874 | 907 | 2309 | 3216 | |

2 Assessment of Taxable Unplatted Real Property in the Town of Shingabe, County of Cass, Minn., for the Year 1942.

HOMESTEADS, up to True and Full Value of \$4,000.00, Assessable at 20 per cent, Class 3B, Remainder at 33 1/3 per cent, Class 3.

| NAME OF OWNER | School District | DESCRIPTION OF PROPERTY | | | | Indicate Homestead | ASSESSOR'S VALUATIONS | | | | | EQUALIZED VALUATIONS | | | | | |
|--------------------------------------------|-----------------|-------------------------------------------------|-------------|---------------|--------------|--------------------|-------------------------|-----------------------------------------------------------------------|-------------------------------------------------------|----------------------------------------------------------------------|------------------------------------------------------------------------------------------|--------------------------------------------------------------------|--------------------------------------------------------|------------------------------------------------------------------------------------|------------------------------------------------------|-------------------------------------------------------|-----------------------------------------------------------------|
| | | SUBDIVISION | Sec. or Lot | Twp. or Block | Rng. or Rng. | | Number of Acres of Land | True and Full Value of Lands Exclusive of Structures and Improvements | STRUCTURES AND IMPROVEMENTS | | Total True and Full Value of Lands, Including all Structures, Improvements and Machinery | Assessed Value of Homesteads up to \$4,000 at 20 per cent Class 3B | Assessed Value of Remainder at 33 1/3 per cent Class 3 | Total Assessed Value of Lands Including all Structures, Improvements and Machinery | Total Assessed Value as Equalized by Board of Review | Total Assessed Value as Equalized by the County Board | Total Assessed Value as Equalized by the Department of Taxation |
| | | | | | | | | | True and Full Value of Buildings and other Structures | True and Full Value of Machinery Permanently Attached to Real Estate | | | | | | | |
| State of Minnesota | 5 | NE 1/4 of NE 1/4 2 acc. of lot 3 | | | | 2 | 141 | 31 | | | | | | | | | |
| J. E. & Merle M. Meyer & Mabel L. Mitchell | | NW 1/4 of NE 1/4 lot 4 less 1 acc. | | | | 1450 | ✓ | 360 | 371 | 390 | 731 | 770 | 146 | 154 | 150 | 150 | |
| | | SW 1/4 of NE 1/4 | | | | | | | | | | | | | | | |
| | | SE 1/4 of NE 1/4 | | | | | | | | | | | | | | | |
| Ernest Miller | | 6 acc. of lot 2 - 1/2 of M. & J. Rep. | | | | 6 | ✓ | 120 | 171 | 180 | 291 | 309 | 58 | 60 | 60 | 58 | |
| Dagney G. Douglass | | NE 1/4 of NW 1/4 1 acc. of lot 4 | | | | 1 | | 90 | 150 | 143 | 233 | 248 | 80 | 80 | 80 | 78 | |
| Ernest Miller | | NW 1/4 of NW 1/4 1/2 acc. of lot 2 | | | | 4 | ✓ | 60 | | | | 240 | 80 | 80 | 80 | 78 | |
| | | SW 1/4 of NW 1/4 | | | | | | | | | | 60 | 12 | 12 | 12 | 12 | |
| | | SE 1/4 of NW 1/4 | | | | | | | | | | | | | | | |
| Frank L. Belbrock | | 60 acc. of lot 3 | | | | 60 | | 15 | | | | 15 | 5 | 5 | 5 | 5 | |
| J. E. & Merle M. Meyer & Mabel L. Mitchell | | NE 1/4 of SW 1/4 lot 3 less 1 acc. less 60 acc. | | | | 1440 | ✓ | 100 | | | | 100 | 20 | 20 | 20 | 20 | |
| Ida A. Knudson | | NW 1/4 of SW 1/4 1/2 acc. less 1/4 acc. | | | | 3175 | | 246 | | | | 246 | 82 | 82 | 82 | 82 | |
| Wm. B. Nilson | | SW 1/4 of SW 1/4 lot 7 | | | | 29 | | 291 | | | | 291 | 97 | 97 | 97 | 97 | |
| | | SE 1/4 of SW 1/4 1/2 | | | | 5450 | | 540 | | | | 540 | 180 | 180 | 180 | 180 | |
| Gust Peters | | lot 9 less 300' x 250' in NE corner | | | | 3728 | ✓ | 350 | 114 | 114 | 444 | 470 | 93 | 94 | 94 | 93 | |
| Wm. Belford | | NE 1/4 of SE 1/4 1 acc. of lot 5 less road | | | | 1 | ✓ | 200 | 114 | 114 | 1040 | 1060 | 268 | 280 | 280 | 268 | |
| E. A. & Viola E. Ryberg | | NW 1/4 of SE 1/4 3/4 acc. of lot 5 | | | | 75 | | 15 | | | | 15 | 5 | 5 | 5 | 5 | |
| Edwin & Josephine Golberg | | 300' x 250' in NE cor. of lot 9 | | | | 172 | ✓ | 100 | 47 | 47 | 275 | 425 | 115 | 120 | 120 | 115 | |
| | | SE 1/4 of SE 1/4 | | | | | | | | | | | | | | | |
| Ernest Miller | | lots 1 & 10 | | | | 19 | ✓ | 200 | | | | 200 | 40 | 40 | 40 | 40 | |
| | | | | | | 21550 | | 2687 | 2540 | | | 5227 | 776 | 449 | 1225 | 1199 | |
| | | | | | | | | | | | | 2414 | 5101 | 752 | 447 | | |

Assessment of Taxable Unplatted Real Property in the Town of Shingabe, County of Cass, Minn., for the Year 1942.

HOMESTEADS, up to True and Full Value of \$4,000.00, Assessable at 20 per cent, Class 3B, Remainder at 33 1/3 per cent, Class 3.

Table with columns: NAME OF OWNER, SCHOOL DISTRICT, DESCRIPTION OF PROPERTY, ASSESSOR'S VALUATIONS, EQUALIZED VALUATIONS. Includes entries for John Andrus, Jr., Mrs. B. Wilson, Hazel F. Connelly, etc.

Assessment of Taxable Unplatted Real Property in the Town of Shingabe, County of Cass, Minn., for the Year 1942.

HOMESTEADS, up to True and Full Value of \$4,000.00, Assessable at 20 per cent, Class 3B, Remainder at 33 1/3 per cent, Class 3.

Table with columns: NAME OF OWNER, SCHOOL DISTRICT, DESCRIPTION OF PROPERTY, ASSESSOR'S VALUATIONS, EQUALIZED VALUATIONS. Includes entries for Hazel F. Connelly, Stanley B. Kuzniak & Gertrude Berazyk, Danworthy Camps Corp., etc.

Assessment of Taxable Unplatted Real Property in the Town of Shingobe, County of Cass, Minn., for the Year 1942.

HOMESTEADS, up to True and Full Value of \$4,000.00, Assessable at 20 per cent, Class 3B, Remainder at 33 1/3 per cent, Class 3.

Table with columns: NAME OF OWNER, SCHOOL DISTRICT, DESCRIPTION OF PROPERTY, ASSESSOR'S VALUATIONS, and EQUALIZED VALUATIONS. Includes entries for U.S. of America, Stanley B. Kuzniak & Gertrude Barczyk, and E. Geraldine Batson.

Assessment of Taxable Unplatted Real Property in the Town of Shingobe, County of Cass, Minn., for the Year 1942.

HOMESTEADS, up to True and Full Value of \$4,000.00, Assessable at 20 per cent, Class 3B, Remainder at 33 1/3 per cent, Class 3.

Table with columns: NAME OF OWNER, SCHOOL DISTRICT, DESCRIPTION OF PROPERTY, ASSESSOR'S VALUATIONS, and EQUALIZED VALUATIONS. Includes entries for Leslie R. Flint, State of Minnesota (Cont. to J. L. Posebuhr), and Dee & Florence A. Ward.

Assessment of Taxable Unplatted Real Property in the Town of Shingabe, County of Cass, Minn., for the Year 1942.

HOMESTEADS, up to True and Full Value of \$4,000.00, Assessable at 20 per cent, Class 3B, Remainder at 33 1/3 per cent, Class 3.

Table with columns: NAME OF OWNER, SCHOOL DISTRICT, DESCRIPTION OF PROPERTY, ASSESSOR'S VALUATIONS (True and Full Value, Structures and Improvements, Total True and Full Value), and EQUALIZED VALUATIONS (Total Assessed Value as Equalized by Board of Review, Total Assessed Value as Equalized by County Board, Total Assessed Value as Equalized by Department of Taxation).

Assessment of Taxable Unplatted Real Property in the Town of Shingabe, County of Cass, Minn., for the Year 1942.

HOMESTEADS, up to True and Full Value of \$4,000.00, Assessable at 20 per cent, Class 3B, Remainder at 33 1/3 per cent, Class 3.

Table with columns: NAME OF OWNER, SCHOOL DISTRICT, DESCRIPTION OF PROPERTY, ASSESSOR'S VALUATIONS (True and Full Value, Structures and Improvements, Total True and Full Value), and EQUALIZED VALUATIONS (Total Assessed Value as Equalized by Board of Review, Total Assessed Value as Equalized by County Board, Total Assessed Value as Equalized by Department of Taxation).

Assessment of Taxable Unplatted Real Property in the Town of Shingabe, County of Cass, Minn., for the Year 1942.

HOMESTEADS, up to True and Full Value of \$4,000.00, Assessable at 20 per cent, Class 3B, Remainder at 33 1/2 per cent, Class 3.

Table with columns: NAME OF OWNER, SCHOOL DISTRICT, DESCRIPTION OF PROPERTY, ASSESSOR'S VALUATIONS, EQUALIZED VALUATIONS. Includes entries for Florence Lewis, Blmer + Stella H. Walker, James R. & Gertrude Cory, John Littlejohn, etc.

Summary totals for page 9: 114 43, 1102, 90, 1192, 116, 204, 320, 320.

Assessment of Taxable Unplatted Real Property in the Town of Shingabe, County of Cass, Minn., for the Year 1942.

HOMESTEADS, up to True and Full Value of \$4,000.00, Assessable at 20 per cent, Class 3B, Remainder at 33 1/2 per cent, Class 3.

Table with columns: NAME OF OWNER, SCHOOL DISTRICT, DESCRIPTION OF PROPERTY, ASSESSOR'S VALUATIONS, EQUALIZED VALUATIONS. Includes entries for Gust Peters, Alma Dolva, Hilda Lenora Bisell, etc.

Summary totals for page 10: 255, 1452, 531, 1452, 531, 484, 484.

Assessment of Taxable Unplatted Real Property in the Town of Shingobe, County of Cass, Minn., for the Year 1942.

HOMESTEADS, up to True and Full Value of \$4,000.00, Assessable at 20 per cent, Class 3B, Remainder at 33 1/2 per cent, Class 3.

Table with columns: NAME OF OWNER, SCHOOL DISTRICT, DESCRIPTION OF PROPERTY, ASSESSOR'S VALUATIONS (True and Full Value, Structures and Improvements, Total True and Full Value), EQUALIZED VALUATIONS (Total Assessed Value as Equalized by Board of Review).

Assessment of Taxable Unplatted Real Property in the Town of Shingobe, County of Cass, Minn., for the Year 1942.

HOMESTEADS, up to True and Full Value of \$4,000.00, Assessable at 20 per cent, Class 3B, Remainder at 33 1/2 per cent, Class 3.

Table with columns: NAME OF OWNER, SCHOOL DISTRICT, DESCRIPTION OF PROPERTY, ASSESSOR'S VALUATIONS (True and Full Value, Structures and Improvements, Total True and Full Value), EQUALIZED VALUATIONS (Total Assessed Value as Equalized by Board of Review).

Vertical handwritten note on the right margin: Note diff. position in 1st list

Assessment of Taxable Unplatted Real Property in the Town of Shingabe, County of Cass, Minn., for the Year 1942.

HOMESTEADS, up to True and Full Value of \$4,000.00, Assessable at 20 per cent, Class 3B, Remainder at 33 1/3 per cent, Class 3.

Table with columns: NAME OF OWNER, SCHOOL DISTRICT, DESCRIPTION OF PROPERTY, ASSESSOR'S VALUATIONS, and EQUALIZED VALUATIONS. Includes entries for Mrs. Bernard & Ekman, Bernard & Ekman, Wm. Opitz, Mrs. Mollie Wright, Sam Seegmiller, and Bessie J. Andrew.

Assessment of Taxable Unplatted Real Property in the Town of Shingabe, County of Cass, Minn., for the Year 1942.

HOMESTEADS, up to True and Full Value of \$4,000.00, Assessable at 20 per cent, Class 3B, Remainder at 33 1/3 per cent, Class 3.

Table with columns: NAME OF OWNER, SCHOOL DISTRICT, DESCRIPTION OF PROPERTY, ASSESSOR'S VALUATIONS, and EQUALIZED VALUATIONS. Includes entries for U. S. of America, State of Minnesota, and Hugh V. Norton.

Assessment of Taxable Unplatted Real Property in the Town of Shingabe, County of Cass, Minn., for the Year 1942.

HOMESTEADS, up to True and Full Value of \$4,000.00, Assessable at 20 per cent, Class 3B, Remainder at 33 1/3 per cent, Class 3.

Table with columns: NAME OF OWNER, SCHOOL DISTRICT, DESCRIPTION OF PROPERTY, ASSESSOR'S VALUATIONS, and EQUALIZED VALUATIONS. Includes entries for NE 1/4 of NE 1/4 lot 2, NW 1/4 of NE 1/4, SW 1/4 of NE 1/4, SE 1/4 of NE 1/4, NE 1/4 of NW 1/4, NW 1/4 of NW 1/4, SW 1/4 of NW 1/4, SE 1/4 of NW 1/4, NE 1/4 of SW 1/4, NW 1/4 of SW 1/4, SW 1/4 of SW 1/4, SE 1/4 of SW 1/4, NE 1/4 of SE 1/4, NW 1/4 of SE 1/4, SW 1/4 of SE 1/4, SE 1/4 of SE 1/4.

Assessment of Taxable Unplatted Real Property in the Town of Shingabe, County of Cass, Minn., for the Year 1942.

HOMESTEADS, up to True and Full Value of \$4,000.00, Assessable at 20 per cent, Class 3B, Remainder at 33 1/3 per cent, Class 3.

Table with columns: NAME OF OWNER, SCHOOL DISTRICT, DESCRIPTION OF PROPERTY, ASSESSOR'S VALUATIONS, and EQUALIZED VALUATIONS. Includes entries for U. S. of America, Anton C. Nielsen, A. C. Sho, NE 1/4 of NE 1/4, NW 1/4 of NE 1/4, SW 1/4 of NE 1/4, SE 1/4 of NE 1/4, NE 1/4 of NW 1/4, NW 1/4 of NW 1/4, SW 1/4 of NW 1/4, SE 1/4 of NW 1/4, NE 1/4 of SW 1/4, NW 1/4 of SW 1/4, SW 1/4 of SW 1/4, SE 1/4 of SW 1/4, NE 1/4 of SE 1/4, NW 1/4 of SE 1/4, SW 1/4 of SE 1/4, SE 1/4 of SE 1/4.

Assessment of Taxable Unplatted Real Property in the Town of Shingabe, County of Cass, Minn., for the Year 1942.

HOMESTEADS, up to True and Full Value of \$4,000.00, Assessable at 20 per cent, Class 3B, Remainder at 33 1/3 per cent, Class 3.

Table with columns: NAME OF OWNER, SCHOOL DISTRICT, DESCRIPTION OF PROPERTY, ASSESSOR'S VALUATIONS, and EQUALIZED VALUATIONS. Includes entries for State of Minnesota and Herman Scholberg + The Keystone Land Co. + Louis F. Lambert.

Assessment of Taxable Unplatted Real Property in the Town of Shingabe, County of Cass, Minn., for the Year 1942.

HOMESTEADS, up to True and Full Value of \$4,000.00, Assessable at 20 per cent, Class 3B, Remainder at 33 1/3 per cent, Class 3.

Table with columns: NAME OF OWNER, SCHOOL DISTRICT, DESCRIPTION OF PROPERTY, ASSESSOR'S VALUATIONS, and EQUALIZED VALUATIONS. Includes entries for U. S. of America and State of Minnesota.

Assessment of Taxable Unplatted Real Property in the Town of Shingabe, County of Cass, Minn., for the Year 1942.

Table with columns: NAME OF OWNER, SCHOOL DISTRICT, DESCRIPTION OF PROPERTY, ASSESSOR'S VALUATIONS, EQUALIZED VALUATIONS. Includes handwritten entries for 'Noble Hawey' and 'First Natl Bk., Walker'.

131 75 131 75 1217 290 276 1507 1493 158 155 239 239 397 394

Assessment of Taxable Unplatted Real Property in the Town of Shingabe, County of Cass, Minn., for the Year 1942.

Table with columns: NAME OF OWNER, SCHOOL DISTRICT, DESCRIPTION OF PROPERTY, ASSESSOR'S VALUATIONS, EQUALIZED VALUATIONS. Includes handwritten entries for 'Henry M. & Arvilla Lueck' and 'Frederick A. & Harold H. Jorgenson'.

144 48 144 48 1191 820 779 2011 1970 338 330 107 107 445 437

Assessment of Taxable Unplatted Real Property in the Town of Shingabe, County of Cass, Minn., for the Year 1942.

FORM 4

HOMESTEADS, up to True and Full Value of \$4,000.00, Assessable at 70 per cent, Class 3B, Remainder at 33 1/3 per cent, Class 3.

Table with columns: NAME OF OWNER, SCHOOL DISTRICT, DESCRIPTION OF PROPERTY (SUBDIVISION, Sec., Twp., Lot, Block, Acres, 100ths), ASSESSOR'S VALUATIONS (True and Full Value of Lands, Structures and Improvements, Total True and Full Value of Lands), and EQUALIZED VALUATIONS (Total Assessed Value as Equalized by Board of Review, Total Assessed Value as Equalized by the County Board, Total Assessed Value as Equalized by the Department of Taxation).

Assessment of Taxable Unplatted Real Property in the Town of Shingabe, County of Cass, Minn., for the Year 1942.

HOMESTEADS, up to True and Full Value of \$4,000.00, Assessable at 20 per cent, Class 3B, Remainder at 33 1/3 per cent, Class 3.

Table with columns: NAME OF OWNER, SCHOOL DISTRICT, DESCRIPTION OF PROPERTY (SUBDIVISION, Sec., Twp., Lot, Block, Acres, 100ths), ASSESSOR'S VALUATIONS (True and Full Value of Lands, Structures and Improvements, Total True and Full Value of Lands), and EQUALIZED VALUATIONS (Total Assessed Value as Equalized by Board of Review, Total Assessed Value as Equalized by the County Board, Total Assessed Value as Equalized by the Department of Taxation).

Assessment of Taxable Unplatted Real Property in the Town of Shingabe, County of Cass, Minn., for the Year 1942.

HOMESTEADS, up to True and Full Value of \$4,000.00, Assessable at 20 per cent, Class 3B, Remainder at 33 1/3 per cent, Class 3.

Table with columns: NAME OF OWNER, SCHOOL DISTRICT, DESCRIPTION OF PROPERTY, ASSESSOR'S VALUATIONS, and EQUALIZED VALUATIONS. Includes entries for U.S. of America and Daniel J. Walsh.

Assessment of Taxable Unplatted Real Property in the Town of Shingabe, County of Cass, Minn., for the Year 1942.

HOMESTEADS, up to True and Full Value of \$4,000.00, Assessable at 20 per cent, Class 3B, Remainder at 33 1/3 per cent, Class 3.

Table with columns: NAME OF OWNER, SCHOOL DISTRICT, DESCRIPTION OF PROPERTY, ASSESSOR'S VALUATIONS, and EQUALIZED VALUATIONS. Includes entries for U.S. of America, Mattie Krueger, and Annie Marie Johnson & Caroline C. Lindstrom.

Assessment of Taxable Unplatted Real Property in the Town of Shingabe, County of Cass, Minn., for the Year 1942.

HOMESTEADS, up to True and Full Value of \$4,000.00, Assessable at 20 per cent, Class 3B, Remainder at 33 1/3 per cent, Class 3.

Table with columns: NAME OF OWNER, SCHOOL DISTRICT, DESCRIPTION OF PROPERTY, ASSESSOR'S VALUATIONS, EQUALIZED VALUATIONS. Includes entries for U.S. of America, F.D. Norenberg, Hugh V. Norton, and others.

Assessment of Taxable Unplatted Real Property in the Town of Shingabe, County of Cass, Minn., for the Year 1942.

HOMESTEADS, up to True and Full Value of \$4,000.00, Assessable at 20 per cent, Class 3B, Remainder at 33 1/3 per cent, Class 3.

Table with columns: NAME OF OWNER, SCHOOL DISTRICT, DESCRIPTION OF PROPERTY, ASSESSOR'S VALUATIONS, EQUALIZED VALUATIONS. Includes entries for U.S. of America, Stephen A. & Helen Grace Barry, Rudolf Miller et al, and others.

Assessment of Taxable Unplatted Real Property in the Town of Shingobee, County of Cass, Minn., for the Year 1942.

HOMESTEADS, up to True and Full Value of \$4,000.00, Assessable at 20 per cent, Class 3B, Remainder at 33 1/3 per cent, Class 3.

Table with columns: NAME OF OWNER, SCHOOL DISTRICT, DESCRIPTION OF PROPERTY, ASSESSOR'S VALUATIONS (True and Full Value of Land, Structures and Improvements, etc.), EQUALIZED VALUATIONS (Total Assessed Value as Equalized by Board of Review, etc.).

Assessment of Taxable Unplatted Real Property in the Town of Shingobee, County of Cass, Minn., for the Year 1942.

HOMESTEADS, up to True and Full Value of \$4,000.00, Assessable at 20 per cent, Class 3B, Remainder at 33 1/3 per cent, Class 3.

Table with columns: NAME OF OWNER, SCHOOL DISTRICT, DESCRIPTION OF PROPERTY, ASSESSOR'S VALUATIONS (True and Full Value of Land, Structures and Improvements, etc.), EQUALIZED VALUATIONS (Total Assessed Value as Equalized by Board of Review, etc.).

Assessment of Taxable Unplatted Real Property in the Town of Shingobe, County of Cass, Minn., for the Year 1942.

HOMESTEADS, up to True and Full Value of \$4,000.00, Assessable at 20 per cent, Class 3B, Remainder at 33 1/3 per cent, Class 3.

| NAME OF OWNER | School District | DESCRIPTION OF PROPERTY | | | | ASSESSOR'S VALUATIONS | | | | | | EQUALIZED VALUATIONS | | | | |
|-------------------|-----------------|-------------------------|-------------|---------------|-----------------|-----------------------|-----------------------------------------------------------------------|-------------------------------------------------------|----------------------------------------------------------------------|------------------------------------------------------------------------------------------|--------------------------------------------------------------------|--------------------------------------------------------|------------------------------------------------------------------------------------|------------------------------------------------------|-------------------------------------------------------|-----------------------------------------------------------------|
| | | SUBDIVISION | Sec. or Lot | Twp. or Block | Rtg. or Acreage | Indicate Homestead | STRUCTURES AND IMPROVEMENTS | | | Total True and Full Value of Lands, Including all Structures, Improvements and Machinery | Assessed Value of Homesteads up to \$1,000 at 20 per cent Class 3B | Assessed Value of Remainder at 33 1/3 per cent Class 3 | Total Assessed Value of Lands Including all Structures, Improvements and Machinery | Total Assessed Value as Equalized by Board of Review | Total Assessed Value as Equalized by the County Board | Total Assessed Value as Equalized by the Department of Taxation |
| | | | | | | | True and Full Value of Lands Exclusive of Structures and Improvements | True and Full Value of Buildings and other Structures | True and Full Value of Machinery Permanently Attached to Real Estate | | | | | | | |
| U. S. of America | 5 | NE 1/4 of NE 1/4 | 27 | 141 | 31 | | | | | | | | | | | |
| U. S. of America | | NW 1/4 of NE 1/4 | | | | | | | | | | | | | | |
| U. S. of America | | SW 1/4 of NE 1/4 | | | | | | | | | | | | | | |
| U. S. of America | | SE 1/4 of NE 1/4 | | | | | | | | | | | | | | |
| U. S. of America | | NE 1/4 of NW 1/4 Lot 1 | | | | | | | | | | | | | | |
| U. S. of America | | NW 1/4 of NW 1/4 " 2 | | | | | | | | | | | | | | |
| Olaf Lunde | | SW 1/4 of NW 1/4 | 40 | | | ✓ | 240 | 43 45 | 283 285 | 57 | | 57 | | 57 | | |
| U. S. of America | | SE 1/4 of NW 1/4 | | | | | | | | | | | | | | |
| U. S. of America | | NE 1/4 of SW 1/4 | | | | | | | | | | | | | | |
| Mrs. Hattie Floro | | NW 1/4 of SW 1/4 | 40 | | | ✓ | 240 | 43 45 | 283 285 | 57 | | 57 | | 57 | | |
| U. S. of America | | SW 1/4 of SW 1/4 | | | | | | | | | | | | | | |
| U. S. of America | | SE 1/4 of SW 1/4 | | | | | | | | | | | | | | |
| U. S. of America | | NE 1/4 of SE 1/4 | | | | | | | | | | | | | | |
| Geo. Ewen | | NW 1/4 of SE 1/4 | 40 | | | | 240 | | 240 | 80 | | 80 | | 80 | | |
| " | | SW 1/4 of SE 1/4 | 40 | | | | 240 | | 240 | 80 | | 80 | | 80 | | |
| " | | SE 1/4 of SE 1/4 | 40 | | | | 240 | | 240 | 80 | | 80 | | 80 | | |
| | | | 200 | | | | 1200 | 90 | 1290 | 114 | 240 | 354 | | 354 | | |
| | | | 200 | | | | | 86 | 1286 | 114 | 240 | | | | | |

Assessment of Taxable Unplatted Real Property in the Town of Shingobe, County of Cass, Minn., for the Year 1942.

HOMESTEADS, up to True and Full Value of \$4,000.00, Assessable at 20 per cent, Class 3B, Remainder at 33 1/3 per cent, Class 3.

| NAME OF OWNER | School District | DESCRIPTION OF PROPERTY | | | | ASSESSOR'S VALUATIONS | | | | | | EQUALIZED VALUATIONS | | | | |
|---------------------------------------------------------|-----------------|-------------------------|-------------|---------------|-----------------|-----------------------|-----------------------------------------------------------------------|-------------------------------------------------------|----------------------------------------------------------------------|------------------------------------------------------------------------------------------|--------------------------------------------------------------------|--------------------------------------------------------|------------------------------------------------------------------------------------|------------------------------------------------------|-------------------------------------------------------|-----------------------------------------------------------------|
| | | SUBDIVISION | Sec. or Lot | Twp. or Block | Rtg. or Acreage | Indicate Homestead | STRUCTURES AND IMPROVEMENTS | | | Total True and Full Value of Lands, Including all Structures, Improvements and Machinery | Assessed Value of Homesteads up to \$4,000 at 20 per cent Class 3B | Assessed Value of Remainder at 33 1/3 per cent Class 3 | Total Assessed Value of Lands Including all Structures, Improvements and Machinery | Total Assessed Value as Equalized by Board of Review | Total Assessed Value as Equalized by the County Board | Total Assessed Value as Equalized by the Department of Taxation |
| | | | | | | | True and Full Value of Lands Exclusive of Structures and Improvements | True and Full Value of Buildings and other Structures | True and Full Value of Machinery Permanently Attached to Real Estate | | | | | | | |
| Genevieve P. Michelle, Loretta M. Nells & Harvey Plymat | ✓ | NE 1/4 of NE 1/4 Lot 1 | 28 | 141 | 31 | 2475 | ✓ | 200 | 43 45 | 243 245 | 49 | | 49 | | 49 | |
| U. S. of America | | NW 1/4 of NE 1/4 " 2 | | | | | | | | | | | | | | |
| U. S. of America | | SW 1/4 of NE 1/4 " 11 | | | | | | | | | | | | | | |
| U. S. of America | | SE 1/4 of NE 1/4 | | | | | | | | | | | | | | |
| G.P. Michelle, L.M. Nells & H.L. Plymat | | NE 1/4 of NW 1/4 " 3 | | | | 3750 | | 261 | | 261 | | 87 | 87 | | 87 | |
| " " " " | | NW 1/4 of NW 1/4 " 4 | | | | 2950 | | 261 | | 261 | | 87 | 87 | | 87 | |
| U. S. of America | | SW 1/4 of NW 1/4 " 5 | | | | | | | | | | | | | | |
| U. S. of America | | SE 1/4 of NW 1/4 | | | | | | | | | | | | | | |
| U. S. of America | | NE 1/4 of SW 1/4 | | | | | | | | | | | | | | |
| U. S. of America | | NW 1/4 of SW 1/4 " 6 | | | | | | | | | | | | | | |
| U. S. of America | | SW 1/4 of SW 1/4 " 7 | | | | | | | | | | | | | | |
| State of Minnesota | | SE 1/4 of SW 1/4 " 8 | | | | | | | | | | | | | | |
| U. S. of America | | NE 1/4 of SE 1/4 " 10 | | | | | | | | | | | | | | |
| U. S. of America | | NW 1/4 of SE 1/4 | | | | | | | | | | | | | | |
| David J. Collins | | SW 1/4 of SE 1/4 " 9 | | | | 2850 | ✓ | 170 | | 170 | 34 | 34 | | 34 | | 34 |
| " | | SE 1/4 of SE 1/4 | 40 | | | ✓ | 240 | | 240 | 48 | 48 | | 48 | | 48 | |
| | | | 16525 | | | | 1132 | 45 | 1177 | 131 | 174 | 305 | | 305 | | 305 |
| | | | 16525 | | | | | 43 | 1175 | 131 | 174 | | | | | |

Assessment of Taxable Unplatted Real Property in the Town of Shingobe, County of Cass, Minn., for the Year 1942.

HOMESTEADS, up to True and Full Value of \$4,000.00, Assessable at 20 per cent, Class 3B, Remainder at 33 1/3 per cent, Class 3.

Table with columns: NAME OF OWNER, SCHOOL DISTRICT, DESCRIPTION OF PROPERTY, ASSESSOR'S VALUATIONS, and EQUALIZED VALUATIONS. Includes entries for U.S. of America and S.P. Michelke.

Assessment of Taxable Unplatted Real Property in the Town of Shingobe, County of Cass, Minn., for the Year 1942.

HOMESTEADS, up to True and Full Value of \$4,000.00, Assessable at 20 per cent, Class 3B, Remainder at 33 1/3 per cent, Class 3.

Table with columns: NAME OF OWNER, SCHOOL DISTRICT, DESCRIPTION OF PROPERTY, ASSESSOR'S VALUATIONS, and EQUALIZED VALUATIONS. Includes entries for U.S. of America, Myrtle Laflam, Leo Klein, Otto Zeller, W.F. Weiss, and John H. Hougen.

Assessment of Taxable Unplatted Real Property in the Town of Shingobee, County of Cass, Minn., for the Year 1942.

HOMESTEADS, up to True and Full Value of \$4,000.00, Assessable at 20 per cent, Class 3B, Remainder at 33 1/3 per cent, Class 3.

Table with columns: NAME OF OWNER, SCHOOL DISTRICT, DESCRIPTION OF PROPERTY, ASSESSOR'S VALUATIONS, and EQUALIZED VALUATIONS. Includes entries for John N. & Anna M. Swanson, Merlin R. Nyatt, Arnold Nelson, Joe M. Jung, and Howard D. & Eda Stall.

Assessment of Taxable Unplatted Real Property in the Town of Shingobee, County of Cass, Minn., for the Year 1942.

HOMESTEADS, up to True and Full Value of \$4,000.00, Assessable at 20 per cent, Class 3B, Remainder at 33 1/3 per cent, Class 3.

Table with columns: NAME OF OWNER, SCHOOL DISTRICT, DESCRIPTION OF PROPERTY, ASSESSOR'S VALUATIONS, and EQUALIZED VALUATIONS. Includes entries for G. P. Michelle, John L. Blomquist, and State of Minnesota.

Assessment of Taxable Unplatted Real Property in the Town of Shingabe, County of Cass, Minn., for the Year 1942.

HOMESTEADS, up to True and Full Value of \$4,000.00, Assessable at 20 per cent, Class 3B, Remainder at 33 1/3 per cent, Class 3.

Table with columns: NAME OF OWNER, SCHOOL DISTRICT, DESCRIPTION OF PROPERTY, ASSESSOR'S VALUATIONS, and EQUALIZED VALUATIONS. Includes entries for David J. Collins, Genevieve Michelke, U.S. of America, and others.

Assessment of Taxable Unplatted Real Property in the Town of Shingabe, County of Cass, Minn., for the Year 1942.

HOMESTEADS, up to True and Full Value of \$4,000.00, Assessable at 20 per cent, Class 3B, Remainder at 33 1/3 per cent, Class 3.

Table with columns: NAME OF OWNER, SCHOOL DISTRICT, DESCRIPTION OF PROPERTY, ASSESSOR'S VALUATIONS, and EQUALIZED VALUATIONS. Includes entries for Henry Rose, Ole A. Larson, Everett Batcheller, U.S. of America, and others.

Assessment of Taxable Unplatted Real Property in the Town of Shingabe, County of Cass, Minn., for the Year 1942.

HOMESTEADS, up to True and Full Value of \$4,000.00, Assessable at 20 per cent, Class 3B, Remainder at 33 1/3 per cent, Class 3.

FORM 4

| NAME OF OWNER | School District | DESCRIPTION OF PROPERTY | | | | ASSESSOR'S VALUATIONS | | | | | | EQUALIZED VALUATIONS | | | |
|-----------------------------------------|-----------------|-------------------------|-----------------------------|------------------|-------------------------|-----------------------|-------------------------------------------------------|----------------------------------------------------------------------|-----------------------------------------------------------------------------------------|--------------------------------------------------------------------|--------------------------------------------------------|------------------------------------------------------------------------------------|------------------------------------------------------|-------------------------------------------------------|-------------------------------------------------------------|
| | | SUBDIVISION | Sec. or Lot | Twp. or Blk. | Number of Acres of Land | Indicate Homestead | STRUCTURES AND IMPROVEMENTS | | Total True and Full Value of Land, Including all Structures, Improvements and Machinery | Assessed Value of Homesteads up to \$4,000 at 20 per cent Class 3B | Assessed Value of Remainder at 33 1/3 per cent Class 3 | Total Assessed Value of Lands Including all Structures, Improvements and Machinery | Total Assessed Value as Equalized by Board of Review | Total Assessed Value as Equalized by the County Board | Total Assessed Value as Equalized by Department of Taxation |
| | | | | | | | True and Full Value of Buildings and other Structures | True and Full Value of Machinery Permanently Attached to Real Estate | | | | | | | |
| <u>Harry G. Taylor</u> | <u>5</u> | <u>NE 1/4 of NE 1/4</u> | <u>Ad 250' of lot 2</u> | <u>34 1/4 31</u> | <u>11 44</u> | | <u>1900</u> | <u>2120</u> | <u>707</u> | <u>707</u> | <u>740</u> | <u>707</u> | | | |
| <u>Theodore & Helen G. Kolderie</u> | | <u>NW 1/4 of NE 1/4</u> | <u>100' x 250' of lot 1</u> | | <u>57</u> | | <u>900</u> | <u>960</u> | <u>320</u> | <u>320</u> | <u>320</u> | <u>305</u> | | | |
| | | <u>SW 1/4 of NE 1/4</u> | | | | | | | | | | | | | |
| | | <u>SE 1/4 of NE 1/4</u> | | | | | | | | | | | | | |
| | | <u>NE 1/4 of NW 1/4</u> | | | | | | | | | | | | | |
| | | <u>NW 1/4 of NW 1/4</u> | | | | | | | | | | | | | |
| | | <u>SW 1/4 of NW 1/4</u> | | | | | | | | | | | | | |
| | | <u>SE 1/4 of NW 1/4</u> | | | | | | | | | | | | | |
| | | <u>NE 1/4 of SW 1/4</u> | | | | | | | | | | | | | |
| | | <u>NW 1/4 of SW 1/4</u> | | | | | | | | | | | | | |
| | | <u>SW 1/4 of SW 1/4</u> | | | | | | | | | | | | | |
| | | <u>SE 1/4 of SW 1/4</u> | | | | | | | | | | | | | |
| | | <u>NE 1/4 of SE 1/4</u> | | | | | | | | | | | | | |
| | | <u>NW 1/4 of SE 1/4</u> | | | | | | | | | | | | | |
| | | <u>SW 1/4 of SE 1/4</u> | | | | | | | | | | | | | |
| | | <u>SE 1/4 of SE 1/4</u> | | | | | | | | | | | | | |
| | | | | | | <u>1201</u> | <u>280</u> | <u>2900</u> | <u>3180</u> | <u>1060</u> | <u>1060</u> | <u>1012</u> | | | |
| | | | | | | <u>1201</u> | | <u>2755</u> | <u>3035</u> | <u>1012</u> | | | | | |

Assessment of Taxable Unplatted Real Property in the Town of Shingabe, County of Cass, Minn., for the Year 1942.

HOMESTEADS, up to True and Full Value of \$4,000.00, Assessable at 20 per cent, Class 3B, Remainder at 33 1/3 per cent, Class 3.

| NAME OF OWNER | School District | DESCRIPTION OF PROPERTY | | | | ASSESSOR'S VALUATIONS | | | | | | EQUALIZED VALUATIONS | | | |
|----------------------------------------------|-----------------|-------------------------|-------------------------------------|------------------------------------------|-------------------------|-----------------------|-------------------------------------------------------|----------------------------------------------------------------------|-----------------------------------------------------------------------------------------|--------------------------------------------------------------------|--------------------------------------------------------|------------------------------------------------------------------------------------|------------------------------------------------------|-------------------------------------------------------|-------------------------------------------------------------|
| | | SUBDIVISION | Sec. or Lot | Twp. or Blk. | Number of Acres of Land | Indicate Homestead | STRUCTURES AND IMPROVEMENTS | | Total True and Full Value of Land, Including all Structures, Improvements and Machinery | Assessed Value of Homesteads up to \$4,000 at 20 per cent Class 3B | Assessed Value of Remainder at 33 1/3 per cent Class 3 | Total Assessed Value of Lands Including all Structures, Improvements and Machinery | Total Assessed Value as Equalized by Board of Review | Total Assessed Value as Equalized by the County Board | Total Assessed Value as Equalized by Department of Taxation |
| | | | | | | | True and Full Value of Buildings and other Structures | True and Full Value of Machinery Permanently Attached to Real Estate | | | | | | | |
| | <u>5</u> | <u>NE 1/4 of NE 1/4</u> | <u>35 1/4 31</u> | | | | | | | | | | | | |
| | | <u>NW 1/4 of NE 1/4</u> | | | | | | | | | | | | | |
| <u>P. C. De Lury & Adolph Kniezger</u> | | <u>SW 1/4 of NE 1/4</u> | <u>lot 1</u> | | <u>3760</u> | | <u>222</u> | <u>222</u> | <u>74</u> | <u>74</u> | <u>74</u> | <u>74</u> | | | |
| | | <u>SE 1/4 of NE 1/4</u> | | | | | | | | | | | | | |
| <u>Theodore & Helen G. Kolderie</u> | | <u>50' x 250' of "</u> | <u>4</u> | | <u>35</u> | | <u>60</u> | <u>60</u> | <u>20</u> | <u>20</u> | <u>20</u> | <u>20</u> | | | |
| <u>Park Region Lumber Co.</u> | | <u>NE 1/4 of NW 1/4</u> | <u>" 2</u> | | <u>240</u> | | <u>45</u> | <u>45</u> | <u>15</u> | <u>15</u> | <u>15</u> | <u>15</u> | | | |
| <u>Geo. Lowen</u> | | <u>NW 1/4 of NW 1/4</u> | <u>" 3</u> | | <u>30</u> | | <u>180</u> | <u>180</u> | <u>60</u> | <u>60</u> | <u>60</u> | <u>60</u> | | | |
| <u>Ewrett S. Batcheller & Henry Rose</u> | | <u>SW 1/4 of NW 1/4</u> | <u>" 4</u> | <u>400' x 250' } " 150' x 250' }</u> | <u>28 31</u> | | <u>180</u> | <u>180</u> | <u>60</u> | <u>60</u> | <u>60</u> | <u>60</u> | | | |
| <u>Ada L. Macklin</u> | | <u>SE 1/4 of NW 1/4</u> | <u>200' x 250' of lot 4</u> | | <u>117</u> | | <u>60</u> | <u>900</u> | <u>320</u> | <u>320</u> | <u>320</u> | <u>320</u> | | | |
| <u>Theodore & Helen G. Kolderie</u> | | <u>NE 1/4 of SW 1/4</u> | <u>250' x 250' " 4</u> | | <u>117 Out</u> | | <u>60</u> | <u>60</u> | <u>20</u> | <u>20</u> | <u>20</u> | <u>20</u> | | | <u>20 out</u> |
| <u>Lloyd & Mildred Sundin</u> | | <u>NE 1/4 of SW 1/4</u> | <u>350' on Lake x 250' of lot 4</u> | | <u>1</u> | | <u>82</u> | <u>1040</u> | <u>357</u> | <u>374</u> | <u>374</u> | <u>374</u> | | | <u>357</u> |
| | | <u>NW 1/4 of SW 1/4</u> | | | | | | | | | | | | | |
| | | <u>SW 1/4 of SW 1/4</u> | | | | | | | | | | | | | |
| | | <u>SE 1/4 of SW 1/4</u> | | | | | | | | | | | | | |
| | | <u>NE 1/4 of SE 1/4</u> | | | | | | | | | | | | | |
| | | <u>NW 1/4 of SE 1/4</u> | | | | | | | | | | | | | |
| | | <u>SW 1/4 of SE 1/4</u> | | | | | | | | | | | | | |
| | | <u>SE 1/4 of SE 1/4</u> | | | | | | | | | | | | | |
| | | | | | | <u>1201</u> | <u>889</u> | <u>1940</u> | <u>2829</u> | <u>943</u> | <u>943</u> | <u>911</u> | <u>911</u> | | |
| | | | | | | <u>1202</u> | | <u>1843</u> | <u>2732</u> | | | | | | |

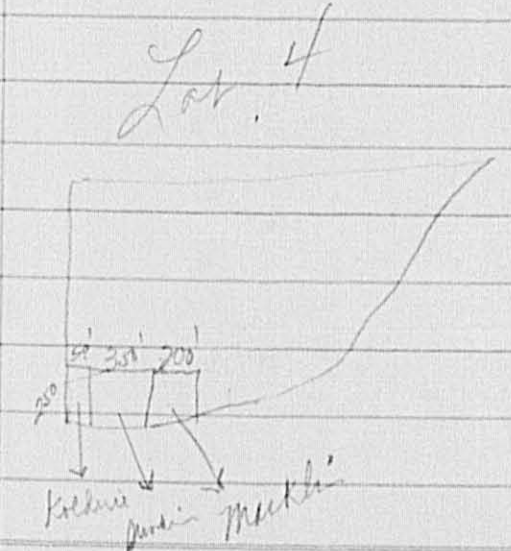

Assessment of Taxable Unplatted Real Property in the Town of Shingobe, County of Cass, Minn., for the Year 1942.

HOMESTEADS, up to True and Full Value of \$4,000.00, Assessable at 20 per cent, Class 3B, Remainder at 33 1/3 per cent, Class 3.

Table with columns: NAME OF OWNER, SCHOOL DISTRICT, DESCRIPTION OF PROPERTY, SUBDIVISION, ASSESSOR'S VALUATIONS (True and Full Value of Land, Structures and Improvements, Total True and Full Value of Land), EQUALIZED VALUATIONS (Total Assessed Value as Equalized by Board of Review, Total Assessed Value as Equalized by the County Board, Total Assessed Value as Equalized by the Department of Taxation).

Assessment of Taxable Unplatted Real Property in the Town of Shingobe, County of Cass, Minn., for the Year 1942.

HOMESTEADS, up to True and Full Value of \$4,000.00, Assessable at 20 per cent, Class 3B, Remainder at 33 1/3 per cent, Class 3.

Table with columns: NAME OF OWNER, SCHOOL DISTRICT, DESCRIPTION OF PROPERTY, SUBDIVISION, ASSESSOR'S VALUATIONS (True and Full Value of Land, Structures and Improvements, Total True and Full Value of Land), EQUALIZED VALUATIONS (Total Assessed Value as Equalized by Board of Review, Total Assessed Value as Equalized by the County Board, Total Assessed Value as Equalized by the Department of Taxation).

Assessment of Taxable Unplatted Real Property in the Town of Shingobe, County of Cass, Minn., for the Year 1942.

Table with columns: NAME OF OWNER, SCHOOL DISTRICT, DESCRIPTION OF PROPERTY, ASSESSOR'S VALUATIONS, EQUALIZED VALUATIONS. Includes entries for Raymond E. & Carl M. Stanley and L. H. & R. E. Stanley.

Assessment of Taxable Unplatted Real Property in the Town of Shingobe, County of Cass, Minn., for the Year 1942.

Table with columns: NAME OF OWNER, SCHOOL DISTRICT, DESCRIPTION OF PROPERTY, ASSESSOR'S VALUATIONS, EQUALIZED VALUATIONS. Includes entries for Leroy & Leila H. Matson, Christian Ojerke, Alvin Clarine, B. F. Nelson Mfg. Co., P. L. Kuehnichel, Irene Olson, and Caroline Clarine.

Assessment of Taxable Unplatted Real Property in the Town of Shingobee, County of Cass, Minn., for the Year 1942.

HOMESTEADS, up to True and Full Value of \$4,000.00, Assessable at 20 per cent, Class 3B, Remainder at 33 1/3 per cent, Class 3.

Table with columns: NAME OF OWNER, SCHOOL DISTRICT, DESCRIPTION OF PROPERTY, ASSESSOR'S VALUATIONS, EQUALIZED VALUATIONS. Includes entries for Alvin Clarine (or Nels Strand), State of Minnesota, U.S. of America, Axel Strand, and various land parcels.

Assessment of Taxable Unplatted Real Property in the Town of Shingobee, County of Cass, Minn., for the Year 1942.

HOMESTEADS, up to True and Full Value of \$4,000.00, Assessable at 20 per cent, Class 3B, Remainder at 33 1/3 per cent, Class 3.

Table with columns: NAME OF OWNER, SCHOOL DISTRICT, DESCRIPTION OF PROPERTY, ASSESSOR'S VALUATIONS, EQUALIZED VALUATIONS. Includes entries for Fred W. & Jessie M. Reising, W. F. Weiss, Red River Lbr. Co., Bert R. Gardner, Ole Berg & May Thompson, Agnes Jakschi, Frank Hohman, Alois Jakschi, Walter S. & Magdalene H. Leslie.

Assessment of Taxable Unplatted Real Property in the Town of Shingobee, County of Cass, Minn., for the Year 1942.

HOMESTEADS, up to True and Full Value of \$4,000.00, Assessable at 20 per cent, Class 3B, Remainder at 33 1/2 per cent, Class 3.

Table with columns: NAME OF OWNER, SCHOOL DISTRICT, DESCRIPTION OF PROPERTY, ASSESSOR'S VALUATIONS, EQUALIZED VALUATIONS. Includes entries for Fred M. & Jessie M. Seising and various land parcels.

Assessment of Taxable Unplatted Real Property in the Town of Shingobee, County of Cass, Minn., for the Year 1942.

HOMESTEADS, up to True and Full Value of \$4,000.00, Assessable at 20 per cent, Class 3B, Remainder at 33 1/2 per cent, Class 3.

Table with columns: NAME OF OWNER, SCHOOL DISTRICT, DESCRIPTION OF PROPERTY, ASSESSOR'S VALUATIONS, EQUALIZED VALUATIONS. Includes entries for Bert Jamison, Una D. & C. J. Woolley, R.O. & S.H. Simonson, Minnie De Florin, John Hohman, John Westlund, Walter S. & Magdaline H. Seale, A. J. Thompson, and John B. De Florin.

Assessment of Taxable Unplatted Real Property in the Town of Shingobee, County of Cass, Minn., for the Year 1942.

HOMESTEADS, up to True and Full Value of \$4,000.00, Assessable at 20 per cent, Class 3B, Remainder at 33 1/3 per cent, Class 3.

Table with columns: NAME OF OWNER, SCHOOL DISTRICT, DESCRIPTION OF PROPERTY, ASSESSOR'S VALUATIONS, EQUALIZED VALUATIONS. Includes entries for Andrew Magnuson, A.G. Thompson, Minnie De Florin, John B. De Florin, P.O. & H. Simonson.

Assessment of Taxable Unplatted Real Property in the Town of Shingobee, County of Cass, Minn., for the Year 1942.

HOMESTEADS, up to True and Full Value of \$4,000.00, Assessable at 20 per cent, Class 3B, Remainder at 33 1/3 per cent, Class 3.

Table with columns: NAME OF OWNER, SCHOOL DISTRICT, DESCRIPTION OF PROPERTY, ASSESSOR'S VALUATIONS, EQUALIZED VALUATIONS. Includes entries for Ferdinand Zink, Aron & Hanna Hawkinson, Elsie Rapp & D.M. Murphy, Aron & Hanna Hawkinson, Ethel L. Peterson.

Assessment of Taxable Unplatted Real Property in the Town of Shingabe, County of Cass, Minn., for the Year 1942. HOMESTEADS, up to True and Full Value of \$4,000.00, Assessable at 20 per cent, Class 3B, Remainder at 33 1/3 per cent, Class 3.

Table with columns: NAME OF OWNER, SCHOOL DISTRICT, DESCRIPTION OF PROPERTY, ASSESSOR'S VALUATIONS, and EQUALIZED VALUATIONS. Includes entries for Nathaniel C. & Bertha Bennett, Ethel L. Peterson, Farmers St. Bk. Walker, Charles Mankenberg, Lucy Shanandore, and Edward Johnson.

Assessment of Taxable Unplatted Real Property in the Town of Shingabe, County of Cass, Minn., for the Year 1942. HOMESTEADS, up to True and Full Value of \$4,000.00, Assessable at 20 per cent, Class 3B, Remainder at 33 1/3 per cent, Class 3.

Table with columns: NAME OF OWNER, SCHOOL DISTRICT, DESCRIPTION OF PROPERTY, ASSESSOR'S VALUATIONS, and EQUALIZED VALUATIONS. Includes entries for U. S. of America - In Trust for Minn. Chippewa Tribe and Faye C. Andrus.

Assessment of Taxable Unplatted Real Property in the Town of Shingobee, County of Cass, Minn., for the Year 1942.

HOMESTEADS, up to True and Full Value of \$4,000.00, Assessable at 20 per cent, Class 3B, Remainder at 33 1/3 per cent, Class 3.

Table with columns: NAME OF OWNER, SCHOOL DISTRICT, DESCRIPTION OF PROPERTY, ASSESSOR'S VALUATIONS, EQUALIZED VALUATIONS. Includes entries for Thomas A. Barker, A. H. Morris, S. E. + Genevieve Fischer, A. W. Morris, John Hanson, H. A. Hanson, + Sofia Hanson, A. N. Mc Pherson, John Hanson, H. A. Hanson, + Sofia Hanson.

21370
20947 2300 900 41 3241 260 647 907 893

Assessment of Taxable Unplatted Real Property in the Town of Shingobee, County of Cass, Minn., for the Year 1942.

HOMESTEADS, up to True and Full Value of \$4,000.00, Assessable at 20 per cent, Class 3B, Remainder at 33 1/3 per cent, Class 3.

Table with columns: NAME OF OWNER, SCHOOL DISTRICT, DESCRIPTION OF PROPERTY, ASSESSOR'S VALUATIONS, EQUALIZED VALUATIONS. Includes entries for Lawrence Thompson, U. S. of America, A. G. & Lydia Thompson, U. S. of America, State of Minnesota, U. S. of America.

100 520 500 1020 204 204 199

Assessment of Taxable Unplatted Real Property in the Town of Shengobee, County of Cass, Minn., for the Year 1942.

HOMESTEADS, up to True and Full Value of \$4,000.00, Assessable at 20 per cent, Class 3B, Remainder at 33 1/3 per cent, Class 3.

Table with columns: NAME OF OWNER, SCHOOL DISTRICT, DESCRIPTION OF PROPERTY, ASSESSOR'S VALUATIONS, and EQUALIZED VALUATIONS. Includes entries for U.S. of America with subdivisions like NE 1/4 of NE 1/4.

Assessment of Taxable Unplatted Real Property in the Town of Shengobee, County of Cass, Minn., for the Year 1942.

HOMESTEADS, up to True and Full Value of \$4,000.00, Assessable at 20 per cent, Class 3B, Remainder at 33 1/3 per cent, Class 3.

Table with columns: NAME OF OWNER, SCHOOL DISTRICT, DESCRIPTION OF PROPERTY, ASSESSOR'S VALUATIONS, and EQUALIZED VALUATIONS. Includes entries for Mrs. Loretta Hudson Prehn and U.S. of America with subdivisions like NE 1/4 of NE 1/4.

Assessment of Taxable Unplatted Real Property in the Town of Shingobee, County of Cass, Minn., for the Year 1942.

Table with columns: NAME OF OWNER, SCHOOL DISTRICT, DESCRIPTION OF PROPERTY, ASSESSOR'S VALUATIONS, and EQUALIZED VALUATIONS. Includes entries for U.S. of America, Edwards & Clara E. Kistner, Fritz & Olga Carlson, Mitchell Ellis, Ferdinand Zink, Claude B. & Lillian Starr.

Assessment of Taxable Unplatted Real Property in the Town of Shingobee, County of Cass, Minn., for the Year 1942.

Table with columns: NAME OF OWNER, SCHOOL DISTRICT, DESCRIPTION OF PROPERTY, ASSESSOR'S VALUATIONS, and EQUALIZED VALUATIONS. Includes entries for Daniel A. Wallace, Albert Carlson, Fred Sembke & Raymond Sembke, John Hanson, H. A. Hanson & Sofia Hanson, Albert Bratrud, John Hanson, H. R. Hanson & Sofia Hanson, Ed. L. P. Staede, Alfred W. & Edna M. Oberly, Edna C. Mc Garry Pick, Bertie Southwick, L. A. & Julia Truxell.

Assessment of Taxable Unplatted Real Property in the Town of Shingobee, County of Cass, Minn., for the Year 1942.

HOMESTEADS, up to True and Full Value of \$4,000.00, Assessable at 20 per cent, Class 3B, Remainder at 33 1/2 per cent, Class 3.

Table with columns: NAME OF OWNER, SCHOOL DISTRICT, DESCRIPTION OF PROPERTY, ASSESSOR'S VALUATIONS (True and Full Value, Structures and Improvements, Total True and Full Value), EQUALIZED VALUATIONS (Total Assessed Value as Equalized by Board of Review, Total Assessed Value as Equalized by County Board, Total Assessed Value as Equalized by Department of Taxation).

Assessment of Taxable Unplatted Real Property in the Town of Shingobee, County of Cass, Minn., for the Year 1942.

HOMESTEADS, up to True and Full Value of \$4,000.00, Assessable at 20 per cent, Class 3B, Remainder at 33 1/2 per cent, Class 3.

Table with columns: NAME OF OWNER, SCHOOL DISTRICT, DESCRIPTION OF PROPERTY, ASSESSOR'S VALUATIONS (True and Full Value, Structures and Improvements, Total True and Full Value), EQUALIZED VALUATIONS (Total Assessed Value as Equalized by Board of Review, Total Assessed Value as Equalized by County Board, Total Assessed Value as Equalized by Department of Taxation).

Assessment of Taxable Unplatted Real Property in the Town of Shingabe, County of Cass, Minn., for the Year 1942.

HOMESTEADS, up to True and Full Value of \$4,000.00, Assessable at 20 per cent, Class 3B, Remainder at 33 1/3 per cent, Class 3.

Table with columns: NAME OF OWNER, SCHOOL DISTRICT, DESCRIPTION OF PROPERTY, ASSESSOR'S VALUATIONS (True and Full Value, Structures and Improvements, Total True and Full Value), and EQUALIZED VALUATIONS (Total Assessed Value as Equalized by Board of Review).

58 43 1640 3700 173 5513 427 1026 1553 1499

Assessment of Taxable Unplatted Real Property in the Town of Shingabe, County of Cass, Minn., for the Year 1942.

HOMESTEADS, up to True and Full Value of \$4,000.00, Assessable at 20 per cent, Class 3B, Remainder at 33 1/3 per cent, Class 3.

Table with columns: NAME OF OWNER, SCHOOL DISTRICT, DESCRIPTION OF PROPERTY, ASSESSOR'S VALUATIONS (True and Full Value, Structures and Improvements, Total True and Full Value), and EQUALIZED VALUATIONS (Total Assessed Value as Equalized by Board of Review).

29 83 624 860 150 1634 310 28 338 330

Assessment of Taxable Unplatted Real Property in the Town of Shingobee, County of Cass, Minn., for the Year 1942.

HOMESTEADS, up to True and Full Value of \$4,000.00, Assessable at 20 per cent, Class 3B, Remainder at 33 1/3 per cent, Class 3.

Table with columns: NAME OF OWNER, SCHOOL DISTRICT, DESCRIPTION OF PROPERTY, ASSESSOR'S VALUATIONS, EQUALIZED VALUATIONS. Includes entries for Letha L. Peterson and U. S. of America in trust for Minn. Chippewa Tribe.

Assessment of Taxable Unplatted Real Property in the Town of Shingobee, County of Cass, Minn., for the Year 1942.

HOMESTEADS, up to True and Full Value of \$4,000.00, Assessable at 20 per cent, Class 3B, Remainder at 33 1/3 per cent, Class 3.

Table with columns: NAME OF OWNER, SCHOOL DISTRICT, DESCRIPTION OF PROPERTY, ASSESSOR'S VALUATIONS, EQUALIZED VALUATIONS. Includes entries for R.A. Naustrold, Letha L. Peterson, Pearl Hinde, Fred Hawkins, and Chris F. Hanser.

Assessment of Taxable Unplatted Real Property in the Town of Shingobee, County of Cass, Minn., for the Year 1942.

Table with columns: NAME OF OWNER, SCHOOL DISTRICT, DESCRIPTION OF PROPERTY, ASSESSOR'S VALUATIONS, EQUALIZED VALUATIONS. Includes entries for Russell & Ruby Angel, William Erickson, Clara Wipond, Herman Fisher, George & Sylvia A. Jensen, Arthur O. & Anna C. Dallaire, H. M. & Daisy Lemberling, George A. & Sylvia A. Jensen, Norman Fisher, Arthur O. & Anna C. Dallaire, Norman Fisher, Loni Berg, Fred Fisher, and a final summary row.

Assessment of Taxable Unplatted Real Property in the Town of Shingobee, County of Cass, Minn., for the Year 1942.

Table with columns: NAME OF OWNER, SCHOOL DISTRICT, DESCRIPTION OF PROPERTY, ASSESSOR'S VALUATIONS, EQUALIZED VALUATIONS. Includes entries for U. S. of America, M. G. Stokessberg, C. D. Bacon, Oral & Ethyle Dickinson, Dorothy Fluke, J. Virginia Rastear, J. C. Jewell, Quentin M. & Henrietta J. Menger, J. Virginia Rastear, H. P. Fluke, Mimi Power & Light Co., Carl E. & Nina Steadland, and Dorothy Fluke. Includes a 'Balance of Sec. 27 on next page' note.

Assessment of Taxable Unplatted Real Property in the Town of Shingabe, County of Cass, Minn., for the Year 1942.

HOMESTEADS, up to True and Full Value of \$4,000.00, Assessable at 20 per cent, Class 3B, Remainder at 33 1/3 per cent, Class 3.

Table with columns: NAME OF OWNER, SCHOOL DISTRICT, DESCRIPTION OF PROPERTY, ASSESSOR'S VALUATIONS, EQUALIZED VALUATIONS. Includes entries for Orel Dickenson, J.C. Andrus Jr. & Faye C. Andrus, Dorothy Fluke, John C. Andrus, Jr., and various land subdivisions.

Summary row for page 65: 171 78, 2401, 230, 2631, 246, 467, 713, 711

Assessment of Taxable Unplatted Real Property in the Town of Shingabe, County of Cass, Minn., for the Year 1942.

HOMESTEADS, up to True and Full Value of \$4,000.00, Assessable at 20 per cent, Class 3B, Remainder at 33 1/3 per cent, Class 3.

Table with columns: NAME OF OWNER, SCHOOL DISTRICT, DESCRIPTION OF PROPERTY, ASSESSOR'S VALUATIONS, EQUALIZED VALUATIONS. Includes entries for Harry Paddock, J.C. Jewell, Daniel & Cecelia Wallace, Louis Nordtune, John Nordtunson, J.C. Jewell, U.S. of America, Lee L. Champlin, Stephen Greber (Curtis Voshel), Lee L. Champlin, U.S. of America, A. Ben Oliver & Elvie Hazel Oliver, August & Louise Olson, U.S. of America, and various land subdivisions.

Summary row for page 66: Balance of Sec. 29 on next page, 204 17, 2095, 3272, 115, 5482, 461, 1059, 1520, 1473

Assessment of Taxable Unplatted Real Property in the Town of Shingabe, County of Cass, Minn., for the Year 1942.

HOMESTEADS, up to True and Full Value of \$4,000.00, Assessable at 20 per cent, Class 3B, Remainder at 33 1/3 per cent, Class 3.

Table with columns: NAME OF OWNER, SCHOOL DISTRICT, DESCRIPTION OF PROPERTY, ASSESSOR'S VALUATIONS, EQUALIZED VALUATIONS. Includes entries for Paul D. Jewell, Hattie + Alfred Oberly, Stephen Gruber, A. E. Farnum, and Garold W. Dickinson.

Assessment of Taxable Unplatted Real Property in the Town of Shingabe, County of Cass, Minn., for the Year 1942.

HOMESTEADS, up to True and Full Value of \$4,000.00, Assessable at 20 per cent, Class 3B, Remainder at 33 1/3 per cent, Class 3.

Table with columns: NAME OF OWNER, SCHOOL DISTRICT, DESCRIPTION OF PROPERTY, ASSESSOR'S VALUATIONS, EQUALIZED VALUATIONS. Includes entries for U. S. of America, Stephen Gruber, Lee L. Champlin, Harry Paddock, and Andrew J. Oberly.

Assessment of Taxable Unplatted Real Property in the Town of Shingabe, County of Cass, Minn., for the Year 1942.

HOMESTEADS, up to True and Full Value of \$4,000.00, Assessable at 20 per cent, Class 3B, Remainder at 33 1/3 per cent, Class 3.

Table with columns: NAME OF OWNER, SCHOOL DISTRICT, DESCRIPTION OF PROPERTY, ASSESSOR'S VALUATIONS, EQUALIZED VALUATIONS. Includes entries for U.S. of America, State of Minnesota, and Jacob Distel.

Assessment of Taxable Unplatted Real Property in the Town of Shingabe, County of Cass, Minn., for the Year 1942.

HOMESTEADS, up to True and Full Value of \$4,000.00, Assessable at 20 per cent, Class 3B, Remainder at 33 1/3 per cent, Class 3.

Table with columns: NAME OF OWNER, SCHOOL DISTRICT, DESCRIPTION OF PROPERTY, ASSESSOR'S VALUATIONS, EQUALIZED VALUATIONS. Includes entries for Henry L. Perry and Chas. Sloan.

Assessment of Taxable Unplatted Real Property in the Town of Shingabe, County of Cass, Minn., for the Year 1942.

HOMESTEADS, up to True and Full Value of \$4,000.00, Assessable at 20 per cent, Class 3B, Remainder at 33 1/3 per cent, Class 3.

Table with columns: NAME OF OWNER, SCHOOL DISTRICT, DESCRIPTION OF PROPERTY, ASSESSOR'S VALUATIONS, EQUALIZED VALUATIONS. Includes entries for Leonard A. Gruber, N.E. 1/4 of N.E. 1/4, and others.

Assessment of Taxable Unplatted Real Property in the Town of Shingabe, County of Cass, Minn., for the Year 1942.

HOMESTEADS, up to True and Full Value of \$4,000.00, Assessable at 20 per cent, Class 3B, Remainder at 33 1/3 per cent, Class 3.

Table with columns: NAME OF OWNER, SCHOOL DISTRICT, DESCRIPTION OF PROPERTY, ASSESSOR'S VALUATIONS, EQUALIZED VALUATIONS. Includes entries for Bert L. John L. & Andrew L. Johnson, N.E. 1/4 of N.E. 1/4 Lot 1, and others.

Assessment of Taxable Unplatted Real Property in the Town of Shingabe, County of Cass, Minn., for the Year 1942.

HOMESTEADS, up to True and Full Value of \$4,000.00, Assessable at 2 1/2 per cent, Class 3B, Remainder at 3 3/4 per cent, Class 3.

Table with columns: NAME OF OWNER, SCHOOL DISTRICT, DESCRIPTION OF PROPERTY, ASSESSOR'S VALUATIONS (True and Full Value, Structures and Improvements, Total True and Full Value), EQUALIZED VALUATIONS (Total Assessed Value as Equalized by Board of Review).

Mr. Voshel: Waver, Minn., 19... DEAR SIR:

Mc Pherson has sold quite a few tracts which are not on tax lists on account of deeds not being recorded. If you find any buildings on these please enter on assessment book if you can find the name of owner.

Handwritten notes and signatures: M. Mc, A. N. M., M. Mc, L. C. PETERSON, County Auditor, Cass County, Minn., John Resch, Vivian Haas & Leta Beach, Mrs. Daisy H. Currow, Margaret Patricia & Charles H. Currow, Alfred E. Pool & Winnifred E. Pool, R. B. Todd, Clarence & Marian Kirwan, Wayne Cunningham, P. M. Hall & Ed. V. P. Staede, M. G. & Hope Stokesberry.

the Town of Shingabe, County of Cass, Minn., for the Year 1942. True and Full Value of \$4,000.00, Assessable at 2 1/2 per cent, Class 3B, Remainder at 3 3/4 per cent, Class 3.

Table with columns: PROPERTY, ASSESSOR'S VALUATIONS (True and Full Value, Structures and Improvements, Total True and Full Value), EQUALIZED VALUATIONS (Total Assessed Value as Equalized by Board of Review).

Assessment of Taxable Unplatted Real Property in the Town of Shingabe, County of Cass, Minn., for the Year 1942.

HOMESTEADS, up to True and Full Value of \$4,000.00, Assessable at 20 per cent, Class 3B, Remainder at 33 1/3 per cent, Class 3.

Table with columns: NAME OF OWNER, SCHOOL DISTRICT, DESCRIPTION OF PROPERTY, ASSESSOR'S VALUATIONS (True and Full Value of Lands, Structures and Improvements, etc.), and EQUALIZED VALUATIONS.

Assessment of Taxable Unplatted Real Property in the Town of Shingabe, County of Cass, Minn., for the Year 1942.

HOMESTEADS, up to True and Full Value of \$4,000.00, Assessable at 20 per cent, Class 3B, Remainder at 33 1/3 per cent, Class 3.

Table with columns: NAME OF OWNER, SCHOOL DISTRICT, DESCRIPTION OF PROPERTY, ASSESSOR'S VALUATIONS (True and Full Value of Lands, Structures and Improvements, etc.), and EQUALIZED VALUATIONS.

Assessment of Taxable Unplatted Real Property in the Town of Shingabe, County of Cass, Minn., for the Year 1942.

HOMESTEADS, up to True and Full Value of \$4,000.00, Assessable at 20 per cent, Class 3B, Remainder at 33 1/3 per cent, Class 3.

Table with columns: NAME OF OWNER, SCHOOL DISTRICT, DESCRIPTION OF PROPERTY, ASSESSOR'S VALUATIONS, EQUALIZED VALUATIONS. Includes entries for Chris F. Hansier, Jennie M. Buchanan, George & Lempi Alto, and Jefferson C. McRill.

Assessment of Taxable Unplatted Real Property in the Town of Shingabe, County of Cass, Minn., for the Year 1942.

HOMESTEADS, up to True and Full Value of \$4,000.00, Assessable at 20 per cent, Class 3B, Remainder at 33 1/3 per cent, Class 3.

Table with columns: NAME OF OWNER, SCHOOL DISTRICT, DESCRIPTION OF PROPERTY, ASSESSOR'S VALUATIONS, EQUALIZED VALUATIONS. Continuation of the assessment data from page 75.

Assessment of Taxable Platted Real Property in the Town of Shingobe, County of Cass, Minn., for the Year 1942.

Table with columns: NAME OF OWNER, SCHOOL DISTRICT, SUBDIVISION, Lot, Block, Indicate Homestead, ASSESSOR'S VALUATIONS (True and Full Value of Lands, Structures and Improvements, etc.), EQUALIZED VALUATIONS (Total Assessed Value as Equalized by Board of Review, etc.).

Assessment of Taxable Platted Real Property in the Town of Shingobe, County of Cass, Minn., for the Year 1942.

Table with columns: NAME OF OWNER, SCHOOL DISTRICT, SUBDIVISION, Lot, Block, Indicate Homestead, ASSESSOR'S VALUATIONS (True and Full Value of Lands, Structures and Improvements, etc.), EQUALIZED VALUATIONS (Total Assessed Value as Equalized by Board of Review, etc.).

Assessment of Taxable Platted Real Property in the Town of Shingabe, County of Cass, Minn., for the Year 1942.

HOMESTEADS, up to True and Full Value of \$4,000.00, Assessable at 25 per cent, Class 3C, Remainder at 40 per cent, Class 4.

Table with columns: NAME OF OWNER, SCHOOL DISTRICT, DESCRIPTION OF PROPERTY, ASSESSOR'S VALUATIONS, EQUALIZED VALUATIONS. Includes entries for Nels Broughton, Argelia Thompson, Con Nansen, Mary Erickson, John Olson, Bernad C. Anderson, Gertrude Scholte, Harry Padlock, F. C. Bragg, George Huffman, John Olson, Harry Padlock.

Assessment of Taxable Platted Real Property in the Town of Shingabe, County of Cass, Minn., for the Year 1942.

HOMESTEADS, up to True and Full Value of \$4,000.00, Assessable at 25 per cent, Class 3C, Remainder at 40 per cent, Class 4.

Table with columns: NAME OF OWNER, SCHOOL DISTRICT, DESCRIPTION OF PROPERTY, ASSESSOR'S VALUATIONS, EQUALIZED VALUATIONS. Includes entries for J. J. Lillian & Martin Reid, Walter Mc Carthy, Betty Malquist, Alfred Malquist, Minnie Simon, Paul & Molly Mueger, James S. & Helen Taylor, Caroline Larson, Lucile Smith, Wm. A. & Olga Robarge, Fred J. Eaton & Evelyn Eaton, A. N. Mc Pherson, Edwin Hansen, First Natl Bk., Anna Staede, Mike Steadland, L. L. Mayes, Goldie Oliver, Carl Berg, Bessie Berg.

Assessment of Taxable Platted Real Property in the Town of Shingabe, County of Cass, Minn., for the Year 1942.

HOMESTEADS, up to True and Full Value of \$4,000.00, Assessable at 25 per cent, Class 3C, Remainder at 40 per cent, Class 4.

| NAME OF OWNER | School District | DESCRIPTION OF PROPERTY | | Indicate Homestead | ASSESSOR'S VALUATIONS | | | | | | | EQUALIZED VALUATIONS | | | | | |
|--------------------------------|-----------------|----------------------------|-----------------------------------------|-------------------------------------|-------------------------------------------------------------------------------|---------------------------------------------------------------|------------------------------------------------------------------------------|--------------------------------------------------------------------------------------------------|----------------------------------------------------------------------------|------------------------------------------------------------|--------------------------------------------------------------------------------------------|--------------------------------------------------------------|---------------------------------------------------------------|-------------------------------------------------------------------------|--|--|--|
| | | | | | True and Full Value of Lands Exclusive of Structures and Improvements Dollars | STRUCTURES AND IMPROVEMENTS | | Total True and Full Value of Lands, Including all Structures, Improvements and Machinery Dollars | Assessed Value of Homesteads up to \$4,000 at 25 per cent Class 3C Dollars | Assessed Value of Remainder at 40 per cent Class 4 Dollars | Total Assessed Value of Lands Including all Structures, Improvements and Machinery Dollars | Total Assessed Value as Equalized by Board of Review Dollars | Total Assessed Value as Equalized by the County Board Dollars | Total Assessed Value as Equalized by the Department of Taxation Dollars | | | |
| | | | | | | True and Full Value of Buildings and other Structures Dollars | True and Full Value of Machinery Permanently Attached to Real Estate Dollars | | | | | | | | | | |
| <u>Kiddie Oliver</u> | <u>5</u> | <u>Auditor's Plat</u> | <u>16 t. of creek</u> | <input checked="" type="checkbox"/> | <u>40</u> | | <u>40</u> | <u>10</u> | | <u>10</u> | | | | | | | |
| <u>Joe D. Jenks</u> | | <u>2 3/4 of</u> | <u>17</u> | <input checked="" type="checkbox"/> | <u>100</u> | <u>100</u> | <u>200</u> | <u>50</u> | | <u>50</u> | | | | | | | |
| <u>Norma Bowman</u> | | <u>Bal. of 17 + all of</u> | <u>18</u> | <input checked="" type="checkbox"/> | <u>80</u> | <u>100</u> | <u>40</u> | <u>220</u> | <u>55</u> | <u>55</u> | | | | | | | |
| <u>Edward Lucia</u> | | | <u>19</u> | <input checked="" type="checkbox"/> | <u>100</u> | <u>140</u> | <u>240</u> | <u>60</u> | | <u>60</u> | | | | | | | |
| <u>Harold + Eleanor Beddoe</u> | | | <u>20</u> | <input checked="" type="checkbox"/> | <u>300</u> | <u>340</u> | <u>40</u> | <u>680</u> | <u>170</u> | <u>170</u> | | | | | | | |
| <u>Faye C. Andrus</u> | | | <u>21</u> | | <u>100</u> | | <u>100</u> | | <u>40</u> | <u>40</u> | | | | | | | |
| <u>Gerald W. Dickinson</u> | | | <u>22</u> | <input checked="" type="checkbox"/> | <u>200</u> | <u>630</u> | <u>50</u> | <u>880</u> | <u>220</u> | <u>220</u> | | | | | | | |
| <u>H. W. + Cora Dickinson</u> | | | <u>23</u> | <input checked="" type="checkbox"/> | <u>100</u> | <u>400</u> | | <u>500</u> | <u>125</u> | <u>125</u> | | | | | | | |
| <u>Faye C. Andrus</u> | | | <u>24</u> | | <u>100</u> | <u>250</u> | | <u>350</u> | | <u>140</u> | <u>140</u> | | | | | | |
| <u>Harry E. Simon</u> | | | <u>25</u> | | <u>150</u> | | <u>150</u> | | <u>60</u> | <u>60</u> | | | | | | | |
| | | | <u>26 transferred to Walker Village</u> | | | | | | | | | | | | | | |
| | | | | | <u>1270</u> | <u>1960</u> | <u>130</u> | <u>3360</u> | <u>690</u> | <u>240</u> | <u>930</u> | | | | | | |

Assessment of Taxable Platted Real Property in the Town of Shingabe, County of Cass, Minn., for the Year 1942.

HOMESTEADS, up to True and Full Value of \$4,000.00, Assessable at 25 per cent, Class 3C, Remainder at 40 per cent, Class 4.

| NAME OF OWNER | School District | DESCRIPTION OF PROPERTY | | Indicate Homestead | ASSESSOR'S VALUATIONS | | | | | | | EQUALIZED VALUATIONS | | | | | |
|----------------------------------------|-----------------|-------------------------|-----------|-------------------------------------|-------------------------------------------------------------------------------|---------------------------------------------------------------|------------------------------------------------------------------------------|--------------------------------------------------------------------------------------------------|----------------------------------------------------------------------------|------------------------------------------------------------|--------------------------------------------------------------------------------------------|--------------------------------------------------------------|---------------------------------------------------------------|-------------------------------------------------------------------------|--|--|--|
| | | | | | True and Full Value of Lands Exclusive of Structures and Improvements Dollars | STRUCTURES AND IMPROVEMENTS | | Total True and Full Value of Lands, Including all Structures, Improvements and Machinery Dollars | Assessed Value of Homesteads up to \$4,000 at 25 per cent Class 3C Dollars | Assessed Value of Remainder at 40 per cent Class 4 Dollars | Total Assessed Value of Lands Including all Structures, Improvements and Machinery Dollars | Total Assessed Value as Equalized by Board of Review Dollars | Total Assessed Value as Equalized by the County Board Dollars | Total Assessed Value as Equalized by the Department of Taxation Dollars | | | |
| | | | | | | True and Full Value of Buildings and other Structures Dollars | True and Full Value of Machinery Permanently Attached to Real Estate Dollars | | | | | | | | | | |
| <u>Thomas A. Barker</u> | <u>5</u> | <u>Chippewa Point</u> | <u>1</u> | | <u>30</u> | | <u>30</u> | <u>12</u> | | <u>12</u> | | | | | | | |
| <u>A. H. Morris</u> | | | <u>2</u> | | <u>30</u> | | <u>30</u> | <u>12</u> | | <u>12</u> | | | | | | | |
| | | | <u>3</u> | | <u>30</u> | | <u>30</u> | <u>12</u> | | <u>12</u> | | | | | | | |
| <u>Joseph + Elizabeth M. Bridgeman</u> | | | <u>4</u> | <input checked="" type="checkbox"/> | <u>40</u> | <u>508</u> | | <u>548</u> | <u>137</u> | | <u>137</u> | | | | | | |
| <u>"</u> | <u>"</u> | | <u>5</u> | <input checked="" type="checkbox"/> | <u>32</u> | <u>200</u> | | <u>232</u> | <u>58</u> | | <u>58</u> | | | | | | |
| <u>"</u> | <u>"</u> | | <u>6</u> | <input checked="" type="checkbox"/> | <u>32</u> | <u>200</u> | | <u>232</u> | <u>58</u> | | <u>58</u> | | | | | | |
| <u>"</u> | <u>"</u> | | <u>7</u> | <input checked="" type="checkbox"/> | <u>32</u> | <u>100</u> | | <u>132</u> | <u>33</u> | | <u>33</u> | | | | | | |
| <u>"</u> | <u>"</u> | | <u>8</u> | <input checked="" type="checkbox"/> | <u>16</u> | | | <u>16</u> | <u>4</u> | | <u>4</u> | | | | | | |
| <u>A. H. Morris</u> | | | <u>9</u> | | <u>20</u> | | | <u>20</u> | | <u>8</u> | <u>8</u> | | | | | | |
| <u>"</u> | | | <u>10</u> | | <u>20</u> | | | <u>20</u> | | <u>8</u> | <u>8</u> | | | | | | |
| <u>"</u> | | | <u>11</u> | | <u>20</u> | | | <u>20</u> | | <u>8</u> | <u>8</u> | | | | | | |
| <u>"</u> | | | <u>12</u> | | <u>20</u> | | | <u>20</u> | | <u>8</u> | <u>8</u> | | | | | | |
| | | | | | <u>322</u> | <u>1008</u> | | <u>1330</u> | <u>290</u> | <u>68</u> | <u>358</u> | | | | | | |

Assessment of Taxable Platted Real Property in the Town of Shengabe, County of Cass, Minn., for the Year 1942.
HOMESTEADS, up to True and Full Value of \$4,000.00, Assessable at 25 per cent, Class 3C, Remainder at 40 per cent, Class 4.

| NAME OF OWNER | School District | SUBDIVISION | Lot | Block | Indicate Homestead | ASSESSOR'S VALUATIONS | | | | | | EQUALIZED VALUATIONS | | | |
|-----------------------------------------|-----------------|-------------------------------------------------|-----|-------|--------------------|----------------------------------------------------------------------------------|------------------------------------------------------------------|---------------------------------------------------------------------------------|-----------------------------------------------------------------------------------------------------|-------------------------------------------------------------------------------|---------------------------------------------------------------|-----------------------------------------------------------------------------------------------|-----------------------------------------------------------------|------------------------------------------------------------------|----------------------------------------------------------------------------|
| | | | | | | True and Full Value of Lands Exclusive of Structures and Improvements Dollars | STRUCTURES AND IMPROVEMENTS | | Total True and Full Value of Lands, Including all Structures, Improvements and Machinery Dollars | Assessed Value of Homesteads up to \$4,000 at 25 per cent Class 3C Dollars | Assessed Value of Remainder at 40 per cent Class 4 Dollars | Total Assessed Value of Lands Including all Structures, Improvements and Machinery Dollars | Total Assessed Value as Equalized by Board of Review Dollars | Total Assessed Value as Equalized by the County Board Dollars | Total Assessed Value as Equalized by the Department of Taxation Dollars |
| | | | | | | | True and Full Value of Buildings and other Structures Dollars | True and Full Value of Machinery Permanently Attached to Real Estate Dollars | | | | | | | |
| Nathaniel C. Bennett | 5 | <u>Opibway</u> | 1 | 3 | | 40 | 300 | 340 | 136 | 136 | 136 | | | | |
| N. C. Bennett | | | 2 | | | 10 | | 10 | 4 | 4 | 4 | | | | |
| Nathaniel Cobb Bennett & Bertha Bennett | | | 3 | | | 30 | | 30 | 12 | 12 | 12 | | | | |
| N. C. Bennett | | | 4 | | | 10 | | 10 | 4 | 4 | 4 | | | | |
| " | | | 5 | | | 10 | | 10 | 4 | 4 | 4 | | | | |
| " | | | 6 | | | 10 | | 10 | 4 | 4 | 4 | | | | |
| " | | <u>Lake frontage lying N. of lots 3 & 4</u> | | 2 | | 40 | | 40 | 16 | 16 | 16 | | | | |
| | | | | | | 150 | 300 | 450 | 180 | 180 | 180 | | | | |

Assessment of Taxable Platted Real Property in the Town of Shengabe, County of Cass, Minn., for the Year 1942.
HOMESTEADS, up to True and Full Value of \$4,000.00, Assessable at 25 per cent, Class 3C, Remainder at 40 per cent, Class 4.

| NAME OF OWNER | School District | DESCRIPTION OF PROPERTY | Indicate Homestead | ASSESSOR'S VALUATIONS | | | | | | EQUALIZED VALUATIONS | | | | |
|--------------------------------|-----------------|---------------------------------------------------------------------------------------------------|--------------------|----------------------------------------------------------------------------------|------------------------------------------------------------------|---------------------------------------------------------------------------------|-----------------------------------------------------------------------------------------------------|-------------------------------------------------------------------------------|---------------------------------------------------------------|-----------------------------------------------------------------------------------------------|-----------------------------------------------------------------|------------------------------------------------------------------|----------------------------------------------------------------------------|--|
| | | | | True and Full Value of Lands Exclusive of Structures and Improvements Dollars | STRUCTURES AND IMPROVEMENTS | | Total True and Full Value of Lands, Including all Structures, Improvements and Machinery Dollars | Assessed Value of Homesteads up to \$4,000 at 25 per cent Class 3C Dollars | Assessed Value of Remainder at 40 per cent Class 4 Dollars | Total Assessed Value of Lands Including all Structures, Improvements and Machinery Dollars | Total Assessed Value as Equalized by Board of Review Dollars | Total Assessed Value as Equalized by the County Board Dollars | Total Assessed Value as Equalized by the Department of Taxation Dollars | |
| | | | | | True and Full Value of Buildings and other Structures Dollars | True and Full Value of Machinery Permanently Attached to Real Estate Dollars | | | | | | | | |
| Chas. A. Ball | | <u>Ball's 1st Addition to Little Gummy Beach</u> <u>11.48 ac of Lot 7 - Sec. 26 - 141 - 31</u> | | 1 | 1 | 50 | | 50 | 20 | 20 | 20 | | | |
| " | | | | 2 | | 50 | | 50 | 20 | 20 | 20 | | | |
| " | | | | 3 | | 50 | | 50 | 20 | 20 | 20 | | | |
| " | | | | 4 | | 50 | | 50 | 20 | 20 | 20 | | | |
| " | | | | 5 | | 50 | | 50 | 20 | 20 | 20 | | | |
| " | | | | 6 | | 50 | | 50 | 20 | 20 | 20 | | | |
| " | | | | 7 | | 50 | | 50 | 20 | 20 | 20 | | | |
| " | | | | 8 | | 50 | | 50 | 20 | 20 | 20 | | | |
| " | | | | 9 | | 50 | | 50 | 20 | 20 | 20 | | | |
| " | | | | 10 | | 50 | | 50 | 20 | 20 | 20 | | | |
| " | | | | 1 | 2 | 50 | | 50 | 20 | 20 | 20 | | | |
| " | | | | 2 | | 50 | | 50 | 20 | 20 | 20 | | | |
| " | | | | 3 | | 50 | | 50 | 20 | 20 | 20 | | | |
| Warren A. & Gertrude B. Hanson | | | | 4 | | 50 | 120 | 170 | 68 | 68 | 68 | | | |
| Chas. Ball | | | | 5 | | 50 | 150 | 200 | 80 | 80 | 80 | | | |
| " | | | | 6 | | 50 | | 50 | 20 | 20 | 20 | | | |
| | | | | | | 800 | 270 | 1070 | 428 | 428 | 428 | | | |

Assessment of Taxable Platted Real Property in the _____ of _____, County of _____, Minn., for the Year 1942.

HOMESTEADS, up to True and Full Value of \$4,000.00, Assessable at 25 per cent, Class 3C, Remainder at 40 per cent, Class 4.

Table with columns: NAME OF OWNER, SCHOOL DISTRICT, SUBDIVISION, Lot, Block, ASSESSOR'S VALUATIONS (True and Full Value of Lands, Structures and Improvements, Total True and Full Value of Lands), EQUALIZED VALUATIONS (Total Assessed Value as Equalized by Board of Review).

Assessment of Taxable Platted Real Property in the _____ of _____, County of _____, Minn., for the Year 1942.

HOMESTEADS, up to True and Full Value of \$4,000.00, Assessable at 25 per cent, Class 3C, Remainder at 40 per cent, Class 4.

Table with columns: NAME OF OWNER, SCHOOL DISTRICT, SUBDIVISION, Lot, Block, ASSESSOR'S VALUATIONS (True and Full Value of Lands, Structures and Improvements, Total True and Full Value of Lands), EQUALIZED VALUATIONS (Total Assessed Value as Equalized by Board of Review).

Assessment of Taxable Platted Real Property in the _____ of _____, County of _____, Minn., for the Year 1942.

Table with columns: NAME OF OWNER, SCHOOL DISTRICT, DESCRIPTION OF PROPERTY, SUBDIVISION, Lot, Block, Indicate Homestead, ASSESSOR'S VALUATIONS (True and Full Value of Land, Structures and Improvements, Total True and Full Value of Land, etc.), EQUALIZED VALUATIONS (Total Assessed Value as Equalized by Board of Review, etc.).

Assessment of Taxable Platted Real Property in the _____ of _____, County of _____, Minn., for the Year 1942.

Table with columns: NAME OF OWNER, SCHOOL DISTRICT, DESCRIPTION OF PROPERTY, SUBDIVISION, Lot, Block, Indicate Homestead, ASSESSOR'S VALUATIONS (True and Full Value of Land, Structures and Improvements, Total True and Full Value of Land, etc.), EQUALIZED VALUATIONS (Total Assessed Value as Equalized by Board of Review, etc.).

Assessment of Taxable Platted Real Property in the _____ of _____, County of _____, Minn., for the Year 1942.

Table with columns: NAME OF OWNER, School District, DESCRIPTION OF PROPERTY (SUBDIVISION, Lot, Block), ASSESSOR'S VALUATIONS (True and Full Value of Land, Structures and Improvements, etc.), and EQUALIZED VALUATIONS (Total Assessed Value as Equalized by Board of Review, etc.).

Assessment of Taxable Platted Real Property in the _____ of _____, County of _____, Minn., for the Year 1942.

Table with columns: NAME OF OWNER, School District, DESCRIPTION OF PROPERTY (SUBDIVISION, Lot, Block), ASSESSOR'S VALUATIONS (True and Full Value of Land, Structures and Improvements, etc.), and EQUALIZED VALUATIONS (Total Assessed Value as Equalized by Board of Review, etc.).

Assessment of Taxable Platted Real Property in the _____ of _____, County of _____, Minn., for the Year 1942.

HOMESTEADS, up to True and Full Value of \$4,000.00, Assessable at 25 per cent, Class 3C, Remainder at 40 per cent, Class 4.

| NAME OF OWNER | School District | DESCRIPTION OF PROPERTY | Indicate Homestead | ASSESSOR'S VALUATIONS | | | | | EQUALIZED VALUATIONS | | | | |
|---------------------|-----------------|---------------------------------------------------|--------------------|---------------------------------------------------------------------|---------------------------------------------------------------|------------------------------------------------------------------------------|-------------------------------------------------------------------------------------------------|----------------------------------------------------------------------------|------------------------------------------------------------|-----------------------------------------------------------------------------------|--------------------------------------------------------------|---------------------------------------------------------------|-------------------------------------------------------------------------|
| | | | | True and Full Value of Land and Structures and Improvements Dollars | True and Full Value of Buildings and other Structures Dollars | True and Full Value of Machinery Permanently Attached to Real Estate Dollars | Total True and Full Value of Land, including all Structures, Improvements and Machinery Dollars | Assessed Value of Homesteads up to \$4,000 at 25 per cent Class 3C Dollars | Assessed Value of Remainder at 40 per cent Class 4 Dollars | Total Assessed Value including all Structures, Improvements and Machinery Dollars | Total Assessed Value as Equalized by Board of Review Dollars | Total Assessed Value as Equalized by the County Board Dollars | Total Assessed Value as Equalized by the Department of Taxation Dollars |
| William Leikenterry | | SUBDIVISION CHARITON BEACH Lot 3-334-141-31 | | That part of Lot 13 lying North of South line of Twp. 141, R31 | 10 | | | 10 | 4 | 4 | | | |
| | | | | That part of Lot 14 lying North of South line of Twp. 141 R31 | 15 | | | 15 | 6 | 6 | | | |
| | | | | That part of Lot 15 lying North of South line of Twp. 141 Rge 31 | 20 | | | 20 | 8 | 8 | | | |
| | | | | That part of Lot 16 lying North of South line of Twp. 141 Rge 31 | 25 | | | 25 | 10 | 10 | | | |
| | | | | 17 | 50 | | | 50 | 20 | 20 | | | |
| | | | | 18 | 50 | | | 50 | 20 | 20 | | | |
| | | | | 19 | 50 | | | 50 | 20 | 20 | | | |
| | | | | 20 | 50 | | | 50 | 20 | 20 | | | |
| | | | | 21 | 50 | | | 50 | 20 | 20 | | | |
| | | | | 22 | 50 | | | 50 | 20 | 20 | | | |
| | | | | 23 | 50 | | | 50 | 20 | 20 | | | |
| | | | | 24 | 50 | | | 50 | 20 | 20 | | | |
| 25 | 50 | | | 50 | 20 | 20 | | | | | | | |
| | Outlet A | | | 20 | | | 20 | 8 | 8 | | | | |
| | " B | | | 20 | | | 20 | 8 | 8 | | | | |
| | | | | 560 | | | 560 | 224 | 224 | | | | |

Assessment of Taxable Platted Real Property in the _____ of _____, County of _____, Minn., for the Year 1942.

Remainder at 40 per cent, Class 4.

| NAME OF OWNER | School District | DESCRIPTION OF PROPERTY | Indicate Homestead | ASSESSOR'S VALUATIONS | | | | | EQUALIZED VALUATIONS | | | |
|---------------|-----------------|-------------------------|--------------------|---------------------------------------------------------------------|---------------------------------------------------------------|------------------------------------------------------------------------------|-------------------------------------------------------------------------------------------------|----------------------------------------------------------------------------|------------------------------------------------------------|-----------------------------------------------------------------------------------|--------------------------------------------------------------|---------------------------------------------------------------|
| | | | | True and Full Value of Land and Structures and Improvements Dollars | True and Full Value of Buildings and other Structures Dollars | True and Full Value of Machinery Permanently Attached to Real Estate Dollars | Total True and Full Value of Land, including all Structures, Improvements and Machinery Dollars | Assessed Value of Homesteads up to \$4,000 at 25 per cent Class 3C Dollars | Assessed Value of Remainder at 40 per cent Class 4 Dollars | Total Assessed Value including all Structures, Improvements and Machinery Dollars | Total Assessed Value as Equalized by Board of Review Dollars | Total Assessed Value as Equalized by the County Board Dollars |
| | | | | | | | | | | | | |

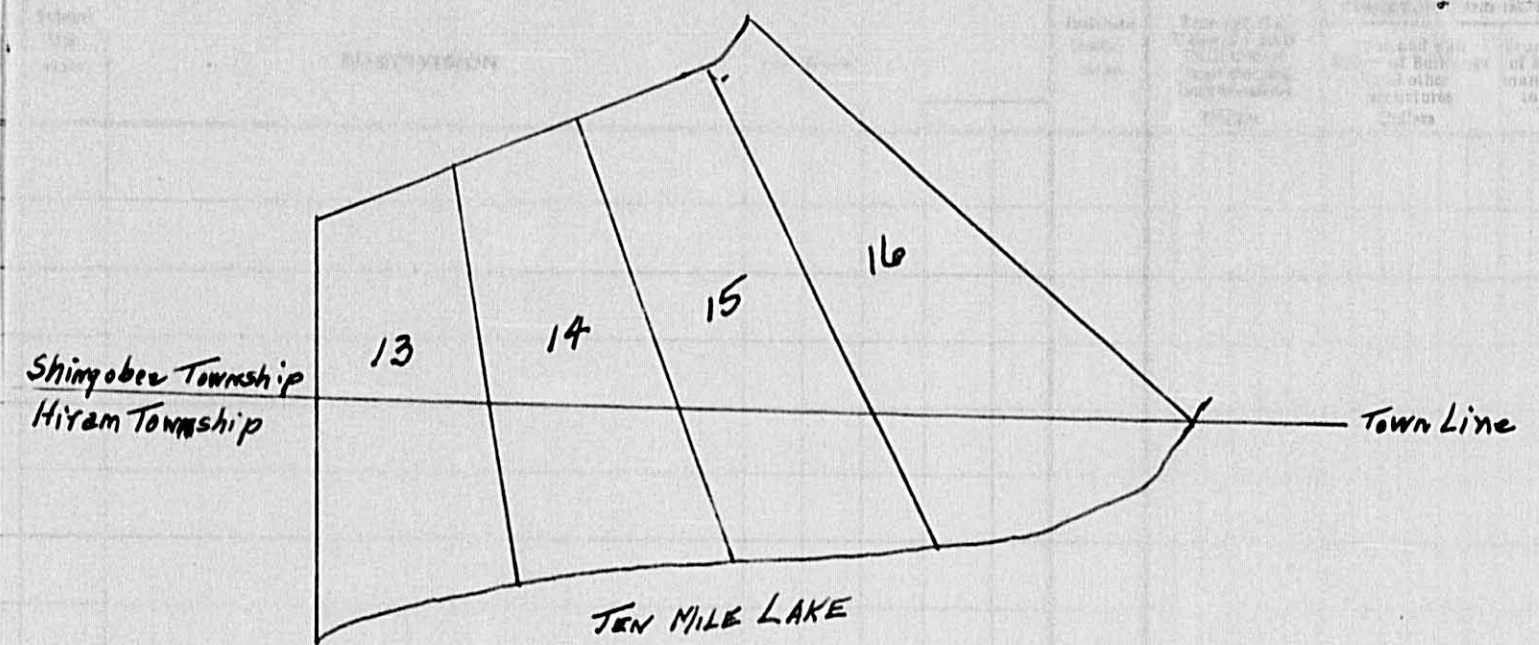

Lots 13-14-15-16 CHARITON BEACH

UNPLATTED

Tabular Statement of Taxable Unplatted Real Property Assessment of the _____ of _____, County of _____, Minnesota, 19_____

FORM 6 MILLER-DAY COMPANY, MINNEAPOLIS

Table with columns: Number of Acres of Land Assessed, ASSESSOR'S VALUATIONS (STRUCTURES AND IMPROVEMENTS, Total True and Full Value of Lands Including All Structures, Improvements and Machinery, Assessed Value of Homesteads up to \$4,000 at 20 per cent Class 3B, Assessed Value of Remainder at 33 1/2 per cent Class 3, Total Assessed Value of All Structures, Improvements and Machinery), EQUALIZED VALUATIONS (Total Assessed Value as Equalized by the Board of Review, Total Assessed Value as Equalized by the County Board, Total Assessed Value as Equalized by the Minnesota Tax Commission), and REMARKS.

UNPLATTED

Tabular Statement of Taxable Unplatted Real Property Assessment of the _____ of _____, County of _____, Minnesota, 19_____

FORM 6 MILLER-DAY COMPANY, MINNEAPOLIS

Table with columns: Number of Acres of Land Assessed, ASSESSOR'S VALUATIONS (STRUCTURES AND IMPROVEMENTS, Total True and Full Value of Lands Including All Structures, Improvements and Machinery, Assessed Value of Homesteads up to \$4,000 at 20 per cent Class 3B, Assessed Value of Remainder at 33 1/2 per cent Class 3, Total Assessed Value of All Structures, Improvements and Machinery), EQUALIZED VALUATIONS (Total Assessed Value as Equalized by the Board of Review, Total Assessed Value as Equalized by the County Board, Total Assessed Value as Equalized by the Minnesota Tax Commission), and REMARKS.

UNPLATTED

Tabular Statement of Taxable Unplatted Real Property Assessment of the _____ of _____, County of _____, Minnesota, 19_____

FORM 6 - MILLER-DAVIS COMPANY, MINNEAPOLIS

Table with columns: Number of Acres of Land Assessed, ASSESSOR'S VALUATIONS (STRUCTURES AND IMPROVEMENTS, True and Full Value of Lands Including All Structures, etc.), EQUALIZED VALUATIONS (Total Assessed Value as Equalized by the Board of Review, etc.), and REMARKS. Includes handwritten entries and a summary row at the bottom.

UNPLATTED

Tabular Statement of Taxable Unplatted Real Property Assessment of the _____ of _____, County of _____, Minnesota, 19_____

FORM 6 - MILLER-DAVIS COMPANY, MINNEAPOLIS

Table with columns: Number of Acres of Land Assessed, ASSESSOR'S VALUATIONS (STRUCTURES AND IMPROVEMENTS, True and Full Value of Lands Including All Structures, etc.), EQUALIZED VALUATIONS (Total Assessed Value as Equalized by the Board of Review, etc.), and REMARKS. Includes handwritten entries and a summary row at the bottom.

UNPLATTED

Tabular Statement of Taxable Unplatted Real Property Assessment of the _____ of _____, County of _____, Minnesota, 19_____

FORM 6 MILLER-DAY COMPANY, MINNEAPOLIS

| Number of Acres of Land Assessed | ASSESSOR'S VALUATIONS | | | | | EQUALIZED VALUATIONS | | | REMARKS |
|----------------------------------|-------------------------------------------------------------------------------|-------------------------------------------------------------------------------------------|------------------------------------------------------------------------------|-------------------------------------------------------------------------------------------------|----------------------------------------------------------------------------|----------------------------------------------------------------|------------------------------------------------------------------|---------------------------------------------------------------|---------|
| | True and Full Value of Lands Exclusive of Structures and Improvements Dollars | STRUCTURES AND IMPROVEMENTS True and Full Value of Buildings and other Structures Dollars | True and Full Value of Machinery Permanently Attached to Real Estate Dollars | Total True And Full Value of Lands Including All Structures, Improvements and Machinery Dollars | Assessed Value of Homesteads up to \$4,000 at 20 per cent Class 3B Dollars | Assessed Value of Remainder at 33 1/2 per cent Class 3 Dollars | Total Assessed Value as Equalized by the Board of Review Dollars | Total Assessed Value as Equalized by the County Board Dollars | |

Footings Brought Forward from Page

" " " " "

" " " " "

" " " " "

" " " " "

" " " " "

" " " " "

" " " " "

" " " " "

" " " " "

" " " " "

" " " " "

" " " " "

" " " " "

" " " " "

" " " " "

" " " " "

" " " " "

" " " " "

" " " " "

" " " " "

" " " " "

PLATTED

Tabular Statement of Taxable Platted Real Property Assessment of the _____ of _____, County of _____, Minnesota, 19_____

FORM 63 1/2 MILLER-DAY COMPANY, MINNEAPOLIS

| Number of Acres of Land Assessed | ASSESSOR'S VALUATIONS | | | | | EQUALIZED VALUATIONS | | | REMARKS |
|----------------------------------|-------------------------------------------------------------------------------|-------------------------------------------------------------------------------------------|------------------------------------------------------------------------------|-------------------------------------------------------------------------------------------------|----------------------------------------------------------------------------|------------------------------------------------------------|--------------------------------------------------------------------------------------------|------------------------------------------------------------------|---------|
| | True and Full Value of Lands Exclusive of Structures and Improvements Dollars | STRUCTURES AND IMPROVEMENTS True and Full Value of Buildings and other Structures Dollars | True and Full Value of Machinery Permanently Attached to Real Estate Dollars | Total True and Full Value of Lands Including All Structures, Improvements and Machinery Dollars | Assessed Value of Homesteads up to \$4,000 at 25 per cent Class 3C Dollars | Assessed Value of Remainder at 40 per cent Class 4 Dollars | Total Assessed Value of Lands Including All Structures, Improvements and Machinery Dollars | Total Assessed Value as Equalized by the Board of Review Dollars | |

Footings Brought Forward from Page

1

2

3

4

5

6

7

8

9

10

11

12

13

14

15

16

17

18

20

15148 30324 1222 46694 6246 8684 14930

