

Assessment & The Field - 1985
Stingobee

COLLECTIONS OF TAXES OF 1956 *Town* OF *Shingabe*, CASS COUNTY, MINNESOTA

FUNDS	MARCH SETTLEMENT 1956	JUNE SETTLEMENT 1956	NOV. SETTLEMENT 1956	Amount Collected from Nov. 19... to First Monday in Jan. 1957	REDUCTIONS	Total Reductions and Collected	BALANCE UNCOLLECTED	ADDITIONS	Total Uncollected to First Monday in January, 1957
State-Non-Homestead,	12594	24863	11410	49					
State-Homestead,	18894	27783	13416	450					
County Revenue,	76672	195527	94417	3167					
County Road and Bridge,	38350	97798	47224	1584					
County Welfare,	13640	34784	16776	5635					
County Bond and Interest,	21291	69547	33606	1127					
<i>Court House</i>	5475	13961	6741	227					
Town Revenue,	8211	20942	10112	339					
Town Road and Bridge,	32848	83767	40449	1336					
Town Drag,	2757	6781	3371	113					
State Loan,	13687	34903	16854	565					
<i>Phone</i>	2737	6781	3371	114					
<i>Cemetery</i>									
School Local 1 Mill,	2736	6980	3371	113					
School Special,	118857	242801	127962	3092					
School State Loan,									
Deficiency	54746	139612	67415	2261					
Tuition									
Transportation	2956	7539	3640	124					
C. O.	54746	139612	67415	2261					
<i>B. & Int.</i>	13687	34903	16854	565					
	615623	1502394	735593	23512					

	SCHOOL DISTRICT NO.	LOCAL 1 MILL	SPECIAL	STATE LOAN	Deficiency	Transport.	C. O.	B. & Int.	TOTALS
June MARCH SETTLEMENT	School District No. <i>G#5</i>	4249	100232		84985	6589	84985	21246	306286
	<i>Na#5</i>	2731	136569		5427	2958	5427	13657	265761
	Totals	6980	242801		139612	7539	139612	34903	571447
March JUNE SETTLEMENT	School District No. <i>G#5</i>	720	18011		14409	778	14409	3602	51929
	<i>Na#5</i>	2016	100846		40337	2118	40337	10089	195799
	Totals	2736	118857		54746	2956	54746	13686	247727
NOVEMBER SETTLEMENT	School District No. <i>G#5</i>	1623	40576		32461	1753	32461	8115	116987
	<i>Na#5</i>	1748	87386		34954	1887	34954	8739	168668
	Totals	3371	127962		67415	3640	67415	16854	285657
NOVEMBER to JANUARY	School District No. <i>G#5</i>	102	2562		2049	112	2049	512	7386
	<i>Na#5</i>	11	530		212	12	212	53	1030
	Totals	113	3092		2261	124	2261	565	8416
ADDITIONS	School District No.								
	Totals								
REDUCTIONS	School District No.								
	Totals								

or Ceased to be Homesteads

HOMESTEADS

Sec. or Lot	Town or Block	Range	Number of Acres of Land
			Acres 100ths

State of Minnesota
 Cass County
 Shingabe
 Real Estate
 Island
 Dulipore Point
 Kabeona
 Springs
 Highway
 Pulling 1st Add'n
 to Office Guise

Assessment Roll and Tax List of Real Property in the Town of Wing Lake, Cass County, Minnesota, for Taxes for the Year 1955.

Cass County, Minnesota, for Taxes for the Year 1955.

Table with columns: IN WHOSE NAME ASSESSED, TO WHOM TRANSFERRED, DESCRIPTION OF PROPERTY, TRUE AND FULL VALUATIONS, ASSESSED VALUATIONS, VALUATIONS BY SCHOOL DISTRICTS AS EQUALIZED BY DEPARTMENT OF TAXATION, TAXES, PAID, WHEN PAID, Number of Receipt, March Settlement 1956, June Settlement 1956, Penalty, November Settlement 1956, Collections to First Monday in January 1957, Delinquent on First Monday in January 1957, Total Delinquent Tax and Penalty, REMARKS.

Real 14-51

Survey Beach

St. 14-21

Island

Chippewa Point

Wabekona

Springs

Quincy

1st Add'n

to Cottage Grove

Assessment Roll and Tax List of Real Property in the Town of Winnipeg, Cass County, Minnesota, for Taxes for the Year 1955. *Indicate Type of Property: R - Residential, C - Commercial, I - Industrial, U - Utility, F - Farm

Cass County, Minnesota, for Taxes for the Year 1955.

Table with columns: IN WHOSE NAME ASSESSED, TO WHOM TRANSFERRED, DESCRIPTION OF PROPERTY, TRUE AND FULL VALUATIONS, ASSESSED VALUATIONS, VALUATIONS BY SCHOOL DISTRICTS AS EQUALIZED BY DEPARTMENT OF TAXATION, SOLD FOR TAXES, PAID, WHEN PAID, Number of Receipt, March Settlement, June Settlement, November Settlement, Collections to First Monday in January in 1957, Delinquent on First Monday in January in 1957, Total Delinquent Tax and Penalty, REMARKS.

Real 141-31

State Beach

Sh 142-31

Island

Chippewa Point

of Kabeleona

to Springs

01 way

to 1st Adm

to 2nd Adm

to 3rd Adm

to 4th Adm

Assessment Roll and Tax List of Real Property in the Town of Memphis, Cass County, Minnesota

*Indicate Type of Property: R-Residential, C-Commercial, I-Industrial, U-Utility, F-Farm

Table with columns: IN WHOSE NAME ASSESSED, TO WHOM TRANSFERRED, DESCRIPTION OF PROPERTY, TRUE AND FULL VALUATIONS (LAND, BUILDINGS, MACHINERY, TOTAL), ASSESSED VALUATIONS (RURAL, ALL OTHER, MACHINERY, TOTAL), Total Assessed Value as Equalized by the Board of Review, FINAL EQUALIZED VALUE.

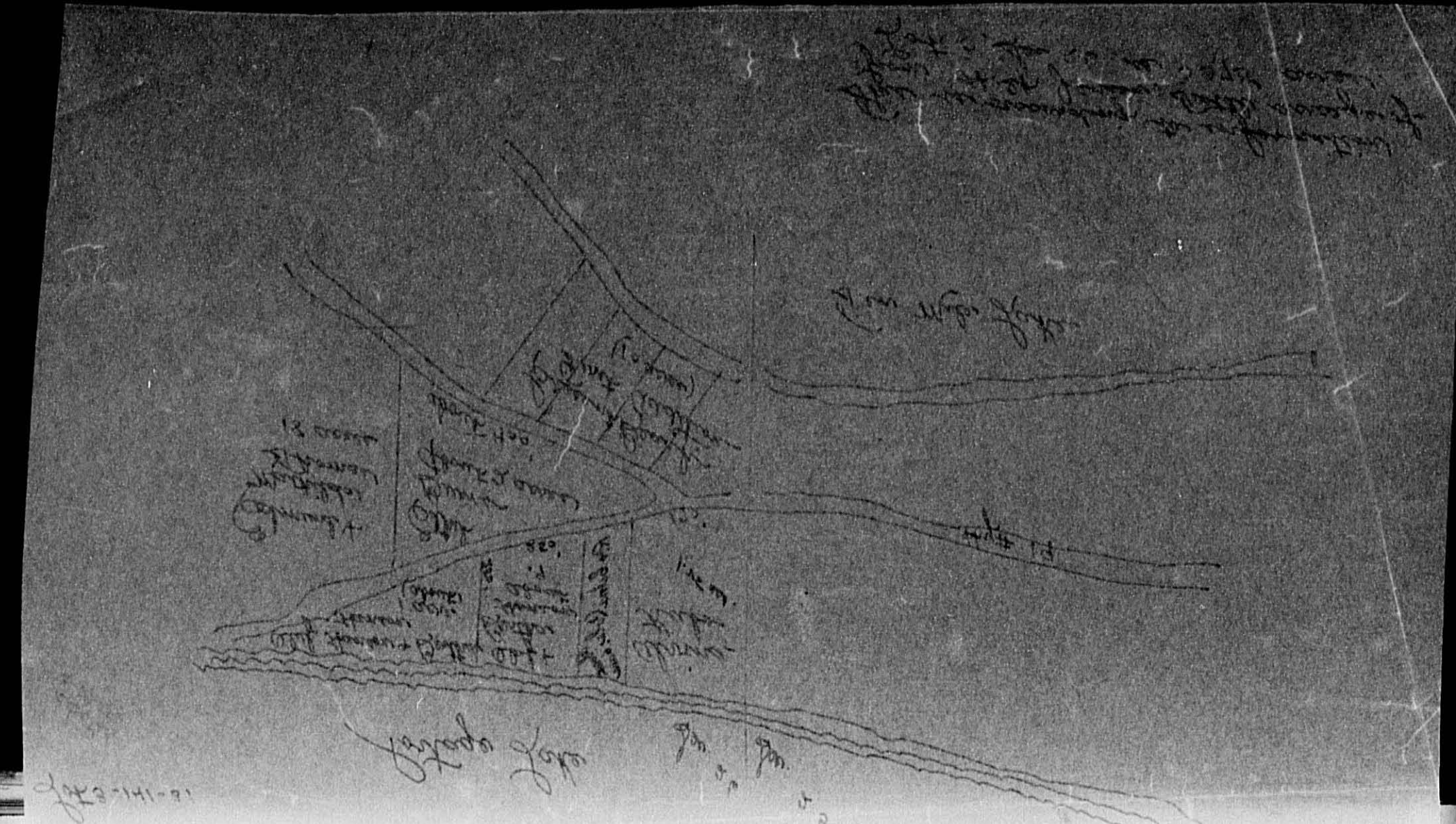

Cass County, Minnesota, for Taxes for the Year 1955.

Table with columns: VALUATIONS BY SCHOOL DISTRICTS AS EQUALIZED BY DEPARTMENT OF TAXATION, TAX INCLUDING STATE HOMESTEAD, SPECIAL TAXES, TOTAL TAXES, PAID, WHEN PAID, Number of Receipt, March Settlement 1956, June Settlement 1956, November Settlement 1956, Collections to First Monday in January 1957, Delinquent on First Monday in January 1957, Total Delinquent Tax and Penalty, REMARKS.

Vertical text on the right edge of the page: Shiloh Island, Dulapena Point, etc.

Assessment Roll and Tax List of Real Property in the Town of Shingobee,
*Indicate Type of Property: R-Residential, C-Commercial, I-Industrial, U-Utility, F-Farm

IN WHOSE NAME ASSESSED	TO WHOM TRANSFERRED	DESCRIPTION OF PROPERTY	No. School District	Indicate Homestead Yes or No	Indicate Agricultural Yes or No	Indicate Type of Property	TRUE AND FULL VALUATIONS				ASSESSED VALUATIONS					Total Assessed Value as Equalized by the Board of Review	FINAL EQUALIZED VALUE	
							LAND Exclusive of Structures and Improvements	BUILDINGS and Other Structures	MACHINERY Permanently Attached to Real Estate	TOTAL True and Full Value	RURAL		ALL OTHER		MACHINERY Permanently Attached to Real Estate			TOTAL ASSESSED VALUE
											Homestead Up to \$1,000 20%	Over \$4,000 and Non-Homestead 33 1/3%	Homestead Up to \$1,000 25%	Over \$4,000 and Non-Homestead 40%				
Robert & Bessie Cluth		NE 1/4 of NE 1/4																
		NW 1/4 of NE 1/4																
		SW 1/4 of NE 1/4																
		SE 1/4 of NE 1/4																
"	"	1/2 of Lot 3 less Rpt.																
St. F. Heiss		1/2 of Lot 3																
Telford H & Laura Hanson		Lot 4 less 4.5 acres Rpt less 7 ac																
U.S. of America		7 ac of Lot 4																
U.S. of America		SE 1/4 of NW 1/4 Lot 5																
Richard S. Sindeland		Lot 2 less 7.1 ac of Lot 1. one that part of Rpt. of Rpt. except for the following: from lot 1. where N. boundary of Rpt. intersects E. line of Lot 1. thence N. on S. line of Lot 1. to shore of Lakeona Bay; thence N.W. along shore a distance of 550; thence S. parallel to E. line of Lot 1 to N. boundary of Rpt. thence S. by along Rpt. to begin.																
Olaf & Inez Berg		SE 1/4 of SW 1/4 - 7 1/2 1/4 of SW 1/4 less 4.8 ac.																
U.S. of America		Lot 6																
U.S. of America		SE 1/4 of SE 1/4 Lot 7																
Olaf Berg & Inez Berg		SE 1/4 of SW 1/4																
Agnes Jakubick		342' x 225' of NW 1/4 of SE 1/4 + 1.2 ac. of Lot 7																
E. J. & Cecile F. Neches		Lot 1 less Rpt. + less sold less to Ranchman																
Mary Hohman		NE 1/4 of SE 1/4 less 12.6 ac + less 4.6 ac																
Rancho Brands, Inc.		part of Lot 1																

Cass County, Minnesota, for Taxes for the Year 1955.

SOLD FOR TAXES	VALUATIONS BY SCHOOL DISTRICTS AS EQUALIZED BY DEPARTMENT OF TAXATION						Tax including State Homestead	State Tax on Non-Homestead	SPECIAL TAXES	TOTAL TAXES	PAID	WHEN PAID	Number of Receipt	March Settlement 1956	June Settlement 1956	Penalty	November Settlement 1956	Penalty	Collections to First Monday in January 1957	Penalty	Delinquent on First Monday in January 1957	Total Delinquent Tax and Penalty	REMARKS	
	District No.	District No.	District No.	District No.	District No.	District No.																		
	Rate	Rate	Rate	Rate	Rate	Rate																		
1																								
2																								
3																								
4																								
5																								
6																								
7																								
8																								
9																								
10																								
11																								
12																								
13																								
14																								
15																								
16																								
17																								
18																								
19																								
20																								

Shingobee Island
Chippewa Point
Lakebena Springs
Ojibway
Bell's 1st Add'n to Cottage Grove

Assessment Roll and Tax List of Real Property in the Town of Down, of Stearns County, Minnesota

*Indicate Type of Property: R-Residential, C-Commercial, I-Industrial, U-Utility, F-Farm

Table with columns: IN WHOSE NAME ASSESSED, TO WHOM TRANSFERRED, DESCRIPTION OF PROPERTY, TRUE AND FULL VALUATIONS, ASSESSED VALUATIONS, FINAL EQUALIZED VALUE.

Cass County, Minnesota, for Taxes for the Year 1955.

Table with columns: VALUATIONS BY SCHOOL DISTRICTS AS EQUALIZED BY DEPARTMENT OF TAXATION, TAXES, PAID, WHEN PAID, Number of Receipt, March Settlement, June Settlement, November Settlement, Collections to First Monday in January 1957, Delinquent on First Monday in January 1957, Total Delinquent Tax and Penalty, REMARKS.

Stearns Beach, Shingobee Island, Dulipawa Point, Kahkroka, Ojibway, Bell's 1st Addn to Cass County

Assessment Roll and Tax List of Real Property in the Town of Shingabe, Cass County, Minnesota, for Taxes for the Year 1955.

*Indicate Type of Property: R-Residential, C-Commercial, I-Industrial, U-Utility, F-Farm

Table with columns: IN WHOSE NAME ASSESSED, TO WHOM TRANSFERRED, DESCRIPTION OF PROPERTY, TRUE AND FULL VALUATIONS, ASSESSED VALUATIONS, FINAL EQUALIZED VALUE. Includes handwritten entries for Edward Howard Musch, Arthur A. & Alpha J. Larson, Roscoe Groff, Eugene & Louisa Harrington, Darrell L. & Lois Hillberg, Alfed N. & Edna N. Oberly, Anna M. Richard Bennett, Claude B. & Lillian Starr, George S. Riegle, Eric & Beulah Hagen, Victor O. & Ruth N. Mattson, John L. & Alvina J. Hartman, Clarence Heeter, Walter R. & Viola E. Worcester, Ind. School Dist. #5, Village of Walker, Raymond M. & Mary Louise Bright, Edmund L. & Helen Walters, E. L. Rogers, Roy & Dorothy Anderson.

Cass County, Minnesota, for Taxes for the Year 1955.

Table with columns: VALUATIONS BY SCHOOL DISTRICTS AS EQUALIZED BY DEPARTMENT OF TAXATION, TAX INCLUDING STATE HOMESTEAD, STATE TAX ON NON-HOMESTEAD, SPECIAL TAXES, TOTAL TAXES, PAID, WHEN PAID, Number of Receipt, March Settlement 1956, June Settlement 1956, Penalty, November Settlement 1956, Penalty, Collections to First Monday in January 1957, Penalty, Delinquent on First Monday in January 1957, Total Delinquent Tax and Penalty, REMARKS. Includes handwritten entries for Edward Howard Musch, Arthur A. & Alpha J. Larson, Roscoe Groff, Eugene & Louisa Harrington, Darrell L. & Lois Hillberg, Alfed N. & Edna N. Oberly, Anna M. Richard Bennett, Claude B. & Lillian Starr, George S. Riegle, Eric & Beulah Hagen, Victor O. & Ruth N. Mattson, John L. & Alvina J. Hartman, Clarence Heeter, Walter R. & Viola E. Worcester, Ind. School Dist. #5, Village of Walker, Raymond M. & Mary Louise Bright, Edmund L. & Helen Walters, E. L. Rogers, Roy & Dorothy Anderson.

Assessment Roll and Tax List of Real Property in the Town of *Shingobee* of *Shingobee* County, Minnesota

*Indicate Type of Property: R-Residential, C-Commercial, I-Industrial, U-Utility, F-Farm

Table with columns: IN WHOSE NAME ASSESSED, TO WHOM TRANSFERRED, SUBDIVISION, TRUE AND FULL VALUATIONS (LAND, BUILDINGS, MACHINERY, TOTAL), ASSESSED VALUATIONS (RURAL, ALL OTHER, MACHINERY, TOTAL), Total Assessed Value, FINAL EQUALIZED VALUE.

Cass County, Minnesota, for Taxes for the Year 1955.

Table with columns: SOLD FOR TAXES, VALUATIONS BY SCHOOL DISTRICTS AS EQUALIZED BY DEPARTMENT OF TAXATION, Tax including State Homestead, State Tax on Non-Homestead, SPECIAL TAXES, TOTAL TAXES, PAID, WHEN PAID, Number of Receipt, March Settlement, June Settlement, November Settlement, Collections to First Monday in January 1957, Delinquent on First Monday in January 1957, Total Delinquent Tax and Penalty, REMARKS.

Sumner Beach, Shingobee Island, Onipewa Point, Kabeokra Springs, Otterway, Roll 1st Addn to Cass Co. Assessor

Assessment Roll and Tax List of Real Property in the Town of *Shimsho*, Cass County, Minnesota

Form 5CD (55) 1-15-55

Table with columns: IN WHOSE NAME ASSESSED, TO WHOM TRANSFERRED, DESCRIPTION OF PROPERTY, TRUE AND FULL VALUATIONS, ASSESSED VALUATIONS, FINAL EQUALIZED VALUE. Includes handwritten entries for Harry Laddock, J. C. Jewell, etc.

Cass County, Minnesota, for Taxes for the Year 1956.

Table with columns: SOLD FOR TAXES, VALUATIONS BY SCHOOL DISTRICTS AS EQUALIZED BY DEPARTMENT OF TAXATION, TAX INCLUDING STATE HOMESTEAD, SPECIAL TAXES, TOTAL TAXES, PAID, WHEN PAID, Number of Receipt, March Settlement, June Settlement, Penalty, November Settlement, Collections to First Monday in January 1957, Delinquent on First Monday in January 1957, Total Delinquent Tax and Penalty, REMARKS. Includes handwritten entries for Harry Laddock, J. C. Jewell, etc.

Assessment Roll and Tax List of Real Property in the Town of Hinckley of Shingee County, Minnesota. *Indicate Type of Property: R-Residential, C-Commercial, I-Industrial, U-Utility, F-Farm

Form 50D (55) WILBUR-DAY COMPANY, MINNEAPOLIS

Table with columns: IN WHOSE NAME ASSESSED, TO WHOM TRANSFERRED, SUBDIVISION, TRUE AND FULL VALUATIONS (LAND, BUILDINGS, MACHINERY, TOTAL), ASSESSED VALUATIONS (RURAL, ALL OTHER, MACHINERY, TOTAL), FINAL EQUALIZED VALUE, and REMARKS. Includes handwritten entries for various property owners like 'John McFarley' and 'Alice Ruth'.

(continued on next page)

10718

Cass County, Minnesota, for Taxes for the Year 1955.

Table with columns: VALUATIONS BY SCHOOL DISTRICTS AS EQUALIZED BY DEPARTMENT OF TAXATION, TAX INCLUDING STATE HOMESTEAD, SPECIAL TAXES, TOTAL TAXES, PAID WHEN PAID, Number of Receipt, March Settlement, June Settlement, November Settlement, Collections to First Monday in January, Delinquent on First Monday in January, Total Delinquent Tax and Penalty, and REMARKS. Includes handwritten entries for various property owners and tax amounts.

Handwritten summary of tax totals: H 756, 429, 1185; H 334=1090, 687=1116, 1021.2206; 23924, 23164, 47088; 574, 47662.

29633 10583

3146 43.00

Shingee Beach, Shingee Island, Chippewa Point, Kasekwa, Strykers, Otterway, Pulling 1st Add'n to Chippewa James

Assessment Roll and Tax List of Real Property in the

Town of *Shingee*
 *Indicate Type of Property: R-Residential, C-Commercial, I-Industrial, U-Utility, F-Farm

Form 50 (55) JULY 1954 COMPACT, MINNESOTA

IN WHOSE NAME ASSESSED	TO WHOM TRANSFERRED	DESCRIPTION OF PROPERTY			TRUE AND FULL VALUATIONS										FINAL EQUALIZED VALUE Dollars	
		Subdivision	Sec. or Lot Town or Block Rng.	Number of Acres of Land Acres 100ths	LAND Exclusion of Structures and Improvements Dollars	BUILDINGS and Other Structures Dollars	MACHINERY Permanently Attached to Real Estate Dollars	TOTAL True and Full Value Dollars	RURAL		ALL OTHER			TOTAL ASSESSED VALUE Dollars		Total Assessed Value as Equalized by the Board of Review Dollars
									Homestead Up to \$1,000 20%	Over \$1,000 and Non-Homestead 33 1/3%	Homestead Up to \$1,000 25%	Over \$1,000 and Non-Homestead 40%	MACHINERY Permanently Attached to Real Estate 33 1/3%			
		Part of 712 & 1/2 - Dec 30-1941-31														
Henry Heathman			1													
Henry + Shirley J. Heathman			2													
"			3													
Henry Heathman + Wm S. Lathrop			4													
Howard L. + Florence Helmbricht			5													
"			6													
"			7													
"			8													
"			9													
"			10													
Howard + Florence Helmbricht			11													
"			12													
			13													
			14													
			15													
			16													
			17													
			18													
			19													
			20													
		<i>Total Area</i>													11,398.76	

See incl on line 2 page 24

Total Area 11,398.76

Cass County, Minnesota, for Taxes for the Year 1955.

SOLD FOR TAXES	VALUATIONS BY SCHOOL DISTRICTS AS EQUALIZED BY DEPARTMENT OF TAXATION							Tax including State Homestead Dollars	State Tax on Non-Homestead 5.17 Mills	SPECIAL TAXES Dollars	TOTAL TAXES Dollars	PAID Dollars	WHEN PAID Month Day Year	Number of Receipt	March Settlement 1956 Dollars	June Settlement 1956 Dollars	November Settlement 1956 Dollars	Penalty Dollars	Collections to First Monday in January 1957 Dollars	Penalty Dollars	Delinquent on First Monday in January 1957 Dollars	Total Delinquent Tax and Penalty Dollars	REMARKS		
	District No. No. 5 Rate Mills	District No. No. 7 Rate Mills	District No. No. 10 Rate Mills	District No. No. 15 Rate Mills	District No. No. 17 Rate Mills	District No. No. 20 Rate Mills	District No. No. 25 Rate Mills																		
	Dollars	Dollars	Dollars	Dollars	Dollars	Dollars	Dollars																		

Grand Totals
 H 24545 11783 = 36328 145170 a⁵
 7H 45552 32882 = 78234 1088267 a⁵
 70097 4465 = 114562 24239.96 40420 24644 16

Personal