

**ASSESSMENT BOOK**

FOR THE YEAR

**1942**

*Town of Shingobee*

CASS COUNTY, MINN.

MILLER-DAVIS COMPANY

PRINTERS, BLANK BOOK MAKERS, STATIONERS, LEGAL BLANKS,  
BANK AND COUNTY SUPPLIES  
219-221 SO. FOURTH ST., MINNEAPOLIS, MINN.









1 Assessment of Taxable Unplatted Real Property in the Town of Shingabe, County of Cass, Minn., for the Year 1942.

HOMESTEADS, up to True and Full Value of \$4,000.00, Assessable at 20 per cent. Class 3B, Remainder at 33 1/2 per cent, Class 3.

NAME OF OWNER	School District	DESCRIPTION OF PROPERTY	Indicate Homestead	ASSESSOR'S VALUATIONS					EQUALIZED VALUATIONS						
				True and Full Value of Land	True and Full Value of Buildings and other Structures	True and Full Value of Machinery Permanently Attached to Real Estate	Total True and Full Value of Land, Including all Structures, Improvements and Machinery	Assessed Value of Homesteads up to \$4,000 at 20 per cent Class 3B	Assessed Value of Remainder at 33 1/2 per cent Class 3	Total Assessed Value as Equalized by Board of Review	Total Assessed Value as Equalized by the County Board	Total Assessed Value as Equalized by the Department of Taxation			
	5	NE 1/4 of NE 1/4													
		NW 1/4 of NE 1/4													
		SW 1/4 of NE 1/4													
		SE 1/4 of NE 1/4													
M. C. Cole		All of Lot 7 except 11 x 90' & less 2 acs.		740	180	266	444	89	92	89					
Ernest & Florence Richardson		NE 1/4 of NW 1/4 297 x 336' of Lot 7		2	40	228	28	56	56	54					
		NW 1/4 of NW 1/4													
		SW 1/4 of NW 1/4													
Hazel Elliott		SE 1/4 of NW 1/4 Lot 6		2650	520	435	300	1586	1655	1586					
Ali Girardier		1/2 of NE 1/4 of SW 1/4		21	188			56	56	56					
		NE 1/4 of SW 1/4													
		NW 1/4 of SW 1/4													
Thomas E. & Corogene Severe		NE 1/4 of SE 1/4		10	120			40	40	40					
Ernest Miller		SE 1/4 of SE 1/4		2914	240			48	48	48					
J. & Merle M. Meyer & Mabel L. Mitchell		Lot 8		2115	500	2365	277	573	573	549					
W. J. Becker		NE 1/4 of SE 1/4 1290' of Lot 7		1003	261	330	575	197	197	192					
John L. Ruffin		1/2 of NW 1/4 of SE 1/4		20	153			51	51	51					
Ali Girardier		1/2 of NW 1/4 of SE 1/4		20	153			51	51	51					
Lewis Lieske		SE 1/4 of SE 1/4 less 1.44 acs.		3856	312			104	104	104					
Jessie Bloom		1/2 of NW 1/4 86' x 140'		20	180	240	408	140	140	136					
Ruth F. Miller		NW 1/4 of SW 1/4 1/2 of NW 1/4 of NE 1/4 371		350	45	475	60	134	15	15					
Ruth F. Miller (Cont. for deed to A. C. Forrest)		1/2 of NW 1/4 1/2 of NW 1/4 of NE 1/4 371		180	180	450	60	138	138	134					
				2052	3052	8050	360	874	907	2309					

2 Assessment of Taxable Unplatted Real Property in the Town of Shingabe, County of Cass, Minn., for the Year 1942.

HOMESTEADS, up to True and Full Value of \$4,000.00, Assessable at 20 per cent, Class 3B, Remainder at 33 1/2 per cent, Class 3.

NAME OF OWNER	School District	DESCRIPTION OF PROPERTY	Indicate Homestead	ASSESSOR'S VALUATIONS					EQUALIZED VALUATIONS						
				True and Full Value of Land	True and Full Value of Buildings and other Structures	True and Full Value of Machinery Permanently Attached to Real Estate	Total True and Full Value of Land, Including all Structures, Improvements and Machinery	Assessed Value of Homesteads up to \$4,000 at 20 per cent Class 3B	Assessed Value of Remainder at 33 1/2 per cent Class 3	Total Assessed Value as Equalized by Board of Review	Total Assessed Value as Equalized by the County Board	Total Assessed Value as Equalized by the Department of Taxation			
State of Minnesota	5	NE 1/4 of NE 1/4 2 acs of Lot 2		214131											
J. & Merle M. Meyer & Mabel L. Mitchell		NW 1/4 of NE 1/4 Lot 4 less 1 ac.		1450	360	371	731	146	150	146					
		SW 1/4 of NE 1/4													
		SE 1/4 of NE 1/4													
Ernest Miller		6 acs. of Lot 2 - N. of M. & J. Rg.		6	120	171	291	58	60	58					
Dagney E. Douglass		NE 1/4 of NW 1/4 1 ac. of Lot 4		1	90	180	233	60	80	60					
Ernest Miller		NW 1/4 of NW 1/4 1/2 of Lot 2 less 3.15 ac. of Rg.		4	60	150	240	12	80	80					
		SW 1/4 of NW 1/4													
		SE 1/4 of NW 1/4													
Frank L. Belbrock		60 acs. of Lot 3		60	15		15	5	5	5					
J. & Merle M. Meyer & Mabel L. Mitchell		NE 1/4 of SW 1/4 Lot 3 less 1/2 ac. 60 acs.		1440	900		100	20	20	20					
Ida A. Knudson		Lot 5 less 1/2 of Shingabe Island		3175	246		246	82	82	82					
Wm. B. Wilson		SW 1/4 of SW 1/4 Lot 7		29	291		291	97	97	97					
		SE 1/4 of SW 1/4 Lot 8		5450	540		540	180	180	180					
Gust Peters		Lot 9 less 300' x 250' in NE corner		3728	350	114	464	93	94	94					
Wm. Belford		NE 1/4 of SE 1/4 1 ac. of Lot 5 less road		1	200	120	1300	280	280	268					
E. A. & Viola E. Ryberg		NW 1/4 of SE 1/4 3/4 ac. of Lot 5		75	15		15	5	5	5					
Edin & Josephine Golberg		300' x 250' in NE cor. of Lot 9		172	100	475	575	115	120	115					
		SE 1/4 of SE 1/4													
Ernest Miller		lots 1 & 10		19	200		200	40	40	40					
				21550	2687	2540	5227	776	449	1225					
						2414	5101	752	447	1199					



Assessment of Taxable Unplatted Real Property in the Town of Shingabe, County of Cass, Minn., for the Year 1942.

HOMESTEADS, up to True and Full Value of \$4,000.00, Assessable at 20 per cent, Class 3B, Remainder at 33 1/3 per cent, Class 3.

Table with columns: NAME OF OWNER, SCHOOL DISTRICT, DESCRIPTION OF PROPERTY, ASSESSOR'S VALUATIONS (True and Full Value of Land, Structures and Improvements, etc.), EQUALIZED VALUATIONS (Total Assessed Value as Equalized by Board of Review, etc.).

Assessment of Taxable Unplatted Real Property in the Town of Shingabe, County of Cass, Minn., for the Year 1942.

HOMESTEADS, up to True and Full Value of \$4,000.00, Assessable at 20 per cent, Class 3B, Remainder at 33 1/3 per cent, Class 3.

Table with columns: NAME OF OWNER, SCHOOL DISTRICT, DESCRIPTION OF PROPERTY, ASSESSOR'S VALUATIONS (True and Full Value of Land, Structures and Improvements, etc.), EQUALIZED VALUATIONS (Total Assessed Value as Equalized by Board of Review, etc.).



Assessment of Taxable Unplatted Real Property in the Town of Shingobe, County of Cass, Minn., for the Year 1942.

HOMESTEADS, up to True and Full Value of \$4,000.00, Assessable at 20 per cent, Class 3B, Remainder at 33 1/3 per cent, Class 3.

DESCRIPTION OF PROPERTY

ASSESSOR'S VALUATIONS

EQUALIZED VALUATIONS

Table with columns: NAME OF OWNER, School District, SUBDIVISION, Sec. Twp. or Range, Number of Acres of Land, Indicate Homestead, True and Full Value of Lands, Structures and Improvements, Total True and Full Value of Lands, Assessed Value of Homesteads, Assessed Value of Remainder, Total Assessed Value of Lands, Total Assessed Value as Equalized by Board of Review, Total Assessed Value as Equalized by the County Board, Total Assessed Value as Equalized by the Department of Taxation.

Assessment of Taxable Unplatted Real Property in the Town of Shingobe, County of Cass, Minn., for the Year 1942.

HOMESTEADS, up to True and Full Value of \$4,000.00, Assessable at 20 per cent, Class 3B, Remainder at 33 1/3 per cent, Class 3.

DESCRIPTION OF PROPERTY

ASSESSOR'S VALUATIONS

EQUALIZED VALUATIONS

Table with columns: NAME OF OWNER, School District, SUBDIVISION, Sec. Twp. or Range, Number of Acres of Land, Indicate Homestead, True and Full Value of Lands, Structures and Improvements, Total True and Full Value of Lands, Assessed Value of Homesteads, Assessed Value of Remainder, Total Assessed Value of Lands, Total Assessed Value as Equalized by Board of Review, Total Assessed Value as Equalized by the County Board, Total Assessed Value as Equalized by the Department of Taxation.



Assessment of Taxable Unplatted Real Property in the Town of Shingobe, County of Cass, Minn., for the Year 1942.

HOMESTEADS, up to True and Full Value of \$4,000.00, Assessable at 20 per cent, Class 3B, Remainder at 33 1/3 per cent, Class 3.

Table with columns: NAME OF OWNER, SCHOOL DISTRICT, DESCRIPTION OF PROPERTY, ASSESSOR'S VALUATIONS, and EQUALIZED VALUATIONS. Rows include owners like U.S. of America, Ethel Mann, and Viola L. Cooke.

Assessment of Taxable Unplatted Real Property in the Town of Shingobe, County of Cass, Minn., for the Year 1942.

HOMESTEADS, up to True and Full Value of \$4,000.00, Assessable at 20 per cent, Class 3B, Remainder at 33 1/3 per cent, Class 3.

Table with columns: NAME OF OWNER, SCHOOL DISTRICT, DESCRIPTION OF PROPERTY, ASSESSOR'S VALUATIONS, and EQUALIZED VALUATIONS. Rows include owners like U.S. of America, Allen H. Cummings, and Mary Adams.



Assessment of Taxable Unplatted Real Property in the Town of Shingabe, County of Cass, Minn., for the Year 1942.

HOMESTEADS, up to True and Full Value of \$4,000.00, Assessable at 20 per cent, Class 3B, Remainder at 33 1/2 per cent, Class 3.

Table with columns: NAME OF OWNER, SCHOOL DISTRICT, DESCRIPTION OF PROPERTY, ASSESSOR'S VALUATIONS, EQUALIZED VALUATIONS. Includes entries for Florence Lewis, Elmer + Stella H. Walker, James R. & Gertrude Cory, John Littlejohn, etc.

114 43 1102 90 1192 116 204 320 1188 146 204

Assessment of Taxable Unplatted Real Property in the Town of Shingabe, County of Cass, Minn., for the Year 1942.

HOMESTEADS, up to True and Full Value of \$4,000.00, Assessable at 20 per cent, Class 3B, Remainder at 33 1/2 per cent, Class 3.

Table with columns: NAME OF OWNER, SCHOOL DISTRICT, DESCRIPTION OF PROPERTY, ASSESSOR'S VALUATIONS, EQUALIZED VALUATIONS. Includes entries for Gust Peters, Alma Dolva, Hilda Lenora Bisell, etc.

255 1452 1452 1404 484 177 177 484



Assessment of Taxable Unplatted Real Property in the Town of Shingobee, County of Cass, Minn., for the Year 1942.

HOMESTEADS, up to True and Full Value of \$4,000.00, Assessable at 20 per cent, Class 3B, Remainder at 33 1/3 per cent, Class 3.

Table with columns: NAME OF OWNER, SCHOOL DISTRICT, DESCRIPTION OF PROPERTY, ASSESSOR'S VALUATIONS (True and Full Value of Land, Structures and Improvements, Total True and Full Value of Land), EQUALIZED VALUATIONS (Total Assessed Value as Equalized by Board of Review).

Assessment of Taxable Unplatted Real Property in the Town of Shingobee, County of Cass, Minn., for the Year 1942.

HOMESTEADS, up to True and Full Value of \$4,000.00, Assessable at 20 per cent, Class 3B, Remainder at 33 1/3 per cent, Class 3.

Table with columns: NAME OF OWNER, SCHOOL DISTRICT, DESCRIPTION OF PROPERTY, ASSESSOR'S VALUATIONS (True and Full Value of Land, Structures and Improvements, Total True and Full Value of Land), EQUALIZED VALUATIONS (Total Assessed Value as Equalized by Board of Review).



Assessment of Taxable Unplatted Real Property in the Town of Shingabe, County of Cass, Minn., for the Year 1942.

HOMESTEADS, up to True and Full Value of \$4,000.00, Assessable at 20 per cent, Class 3B, Remainder at 33 1/3 per cent, Class 3.

Table with columns: NAME OF OWNER, SCHOOL DISTRICT, DESCRIPTION OF PROPERTY, ASSESSOR'S VALUATIONS, and EQUALIZED VALUATIONS. Includes entries for Mrs. Bernard Eckman, Bernard Eckman, Wm. Opitz, Mrs. Mollie Wright, Sam Seegmiller, and Bessie J. Andrew.

Assessment of Taxable Unplatted Real Property in the Town of Shingabe, County of Cass, Minn., for the Year 1942.

HOMESTEADS, up to True and Full Value of \$4,000.00, Assessable at 20 per cent, Class 3B, Remainder at 33 1/3 per cent, Class 3.

Table with columns: NAME OF OWNER, SCHOOL DISTRICT, DESCRIPTION OF PROPERTY, ASSESSOR'S VALUATIONS, and EQUALIZED VALUATIONS. Includes entries for U. S. of America, State of Minnesota, and Hugh V. Norton.



Assessment of Taxable Unplatted Real Property in the Town of Shingabe, County of Cass, Minn., for the Year 1942.

HOMESTEADS, up to True and Full Value of \$4,000.00, Assessable at 20 per cent, Class 3B, Remainder at 33 1/3 per cent, Class 3.

Table with columns: NAME OF OWNER, SCHOOL DISTRICT, DESCRIPTION OF PROPERTY, ASSESSOR'S VALUATIONS, and EQUALIZED VALUATIONS. Includes entries for State of Minnesota, U.S. of America, and various land subdivisions.

Assessment of Taxable Unplatted Real Property in the Town of Shingabe, County of Cass, Minn., for the Year 1942.

HOMESTEADS, up to True and Full Value of \$4,000.00, Assessable at 20 per cent, Class 3B, Remainder at 33 1/3 per cent, Class 3.

Table with columns: NAME OF OWNER, SCHOOL DISTRICT, DESCRIPTION OF PROPERTY, ASSESSOR'S VALUATIONS, and EQUALIZED VALUATIONS. Includes entries for U.S. of America, Anton C. Nielsen, and A.C. Shoe, with handwritten acreage and valuation data.







Assessment of Taxable Unplatted Real Property in the Town of Shingabe, County of Cass, Minn., for the Year 1942. HOMESTEADS, up to True and Full Value of \$4,000.00, Assessable at 20 per cent, Class 3B, Remainder at 33 1/3 per cent, Class 3.

Table with columns: NAME OF OWNER, SCHOOL DISTRICT, DESCRIPTION OF PROPERTY, ASSESSOR'S VALUATIONS, and EQUALIZED VALUATIONS. Includes handwritten entries for 'Noble Harvey' and 'First Natl Bk, Walker'.

Assessment of Taxable Unplatted Real Property in the Town of Shingabe, County of Cass, Minn., for the Year 1942. HOMESTEADS, up to True and Full Value of \$4,000.00, Assessable at 20 per cent, Class 3B, Remainder at 33 1/3 per cent, Class 3.

Table with columns: NAME OF OWNER, SCHOOL DISTRICT, DESCRIPTION OF PROPERTY, ASSESSOR'S VALUATIONS, and EQUALIZED VALUATIONS. Includes handwritten entries for 'Henry M. & Arvilla Lueck' and 'Frederick A. & Harold H. Jorgenson'.



Assessment of Taxable Unplatted Real Property in the Town of Shingabe, County of Cass, Minn., for the Year 1942.

Table with columns: NAME OF OWNER, SCHOOL DISTRICT, DESCRIPTION OF PROPERTY, ASSESSOR'S VALUATIONS, and EQUALIZED VALUATIONS. Includes entries for State of Minnesota, U.S. of America, and various subdivisions like NE 1/4 of NE 1/4.

Assessment of Taxable Unplatted Real Property in the Town of Shingabe, County of Cass, Minn., for the Year 1942.

Table with columns: NAME OF OWNER, SCHOOL DISTRICT, DESCRIPTION OF PROPERTY, ASSESSOR'S VALUATIONS, and EQUALIZED VALUATIONS. Includes entries for Nels D. Olson and Charlie John Mayers, with various subdivisions and valuation details.



Assessment of Taxable Unplatted Real Property in the Town of Shingabe, County of Cass, Minn., for the Year 1942.

HOMESTEADS, up to True and Full Value of \$4,000.00, Assessable at 70 per cent, Class 3B, Remainder at 33 1/3 per cent, Class 3.

Table with columns: NAME OF OWNER, SCHOOL DISTRICT, SUBDIVISION, ASSESSOR'S VALUATIONS (STRUCTURES AND IMPROVEMENTS, Total True and Full Value of Lands, Assessed Value of Homesteads, Assessed Value of Remainder), EQUALIZED VALUATIONS (Total Assessed Value as Equalized by Board of Review, Total Assessed Value as Equalized by the County Board, Total Assessed Value as Equalized by the Department of Taxation).

Assessment of Taxable Unplatted Real Property in the Town of Shingabe, County of Cass, Minn., for the Year 1942.

HOMESTEADS, up to True and Full Value of \$4,000.00, Assessable at 20 per cent, Class 3B, Remainder at 33 1/3 per cent, Class 3.

Table with columns: NAME OF OWNER, SCHOOL DISTRICT, SUBDIVISION, ASSESSOR'S VALUATIONS (STRUCTURES AND IMPROVEMENTS, Total True and Full Value of Lands, Assessed Value of Homesteads, Assessed Value of Remainder), EQUALIZED VALUATIONS (Total Assessed Value as Equalized by Board of Review, Total Assessed Value as Equalized by the County Board, Total Assessed Value as Equalized by the Department of Taxation).



Assessment of Taxable Unplatted Real Property in the Town of Shingabe, County of Cass, Minn., for the Year 1942.

HOMESTEADS, up to True and Full Value of \$4,000.00, Assessable at 20 per cent, Class 3B, Remainder at 33 1/3 per cent, Class 3.

Table with columns: NAME OF OWNER, SCHOOL DISTRICT, DESCRIPTION OF PROPERTY, ASSESSOR'S VALUATIONS, and EQUALIZED VALUATIONS. Includes entries for U.S. of America, F.D. Norenberg, Hugh V. Norton, and others.

Assessment of Taxable Unplatted Real Property in the Town of Shingabe, County of Cass, Minn., for the Year 1942.

HOMESTEADS, up to True and Full Value of \$4,000.00, Assessable at 20 per cent, Class 3B, Remainder at 33 1/3 per cent, Class 3.

Table with columns: NAME OF OWNER, SCHOOL DISTRICT, DESCRIPTION OF PROPERTY, ASSESSOR'S VALUATIONS, and EQUALIZED VALUATIONS. Includes entries for U.S. of America, Stephen A. & Helen Grace Barry, Rudolf Miller et al, and others.



Assessment of Taxable Unplatted Real Property in the Town of Shingobee, County of Cass, Minn., for the Year 1942.

HOMESTEADS, up to True and Full Value of \$4,000.00, Assessable at 20 per cent, Class 3B, Remainder at 33 1/3 per cent, Class 3.

Table with columns: NAME OF OWNER, SCHOOL DISTRICT, DESCRIPTION OF PROPERTY, ASSESSOR'S VALUATIONS (True and Full Value of Land, Structures and Improvements, etc.), EQUALIZED VALUATIONS (Total Assessed Value as Equalized by Board of Review, etc.).

Assessment of Taxable Unplatted Real Property in the Town of Shingobee, County of Cass, Minn., for the Year 1942.

HOMESTEADS, up to True and Full Value of \$4,000.00, Assessable at 20 per cent, Class 3B, Remainder at 33 1/3 per cent, Class 3.

Table with columns: NAME OF OWNER, SCHOOL DISTRICT, DESCRIPTION OF PROPERTY, ASSESSOR'S VALUATIONS (True and Full Value of Land, Structures and Improvements, etc.), EQUALIZED VALUATIONS (Total Assessed Value as Equalized by Board of Review, etc.).



Assessment of Taxable Unplatted Real Property in the Town of Shingobe, County of Cass, Minn., for the Year 1942.

HOMESTEADS, up to True and Full Value of \$4,000.00, Assessable at 20 per cent, Class 3B, Remainder or 33 1/3 per cent, Class 3.

NAME OF OWNER	School District	DESCRIPTION OF PROPERTY				ASSESSOR'S VALUATIONS						EQUALIZED VALUATIONS				
		SUBDIVISION	Sec. or Lot	Twp. or Block	Number of Acres of Land	Infinite Homestead	True and Full Value of Land Exclusive of Structures and Improvements	STRUCTURES AND IMPROVEMENTS		Total True and Full Value of Land, Including all Structures, Improvements and Machinery	Assessed Value of Homesteads up to \$4,000 at 20 per cent Class 3B	Assessed Value of Remainder at 33 1/3 per cent Class 3	Total Assessed Value of Land, Including all Structures, Improvements and Machinery	Total Assessed Value as Equalized by Board of Review	Total Assessed Value as Equalized by the County Board	Total Assessed Value as Equalized by the Department of Taxation
								True and Full Value of Buildings and other Structures	True and Full Value of Machinery Permanently Attached to Real Estate							
U. S. of America	5	NE 1/4 of NE 1/4			27 1/4 31											
U. S. of America		NW 1/4 of NE 1/4														
U. S. of America		SW 1/4 of NE 1/4														
U. S. of America		SE 1/4 of NE 1/4														
U. S. of America		NE 1/4 of NW 1/4 Lot 1														
U. S. of America		NW 1/4 of NW 1/4 " 2														
Olaf Lunde		SW 1/4 of NW 1/4	40			240	43 45		283 285	57 57		57		57		
U. S. of America		SE 1/4 of NW 1/4														
U. S. of America		NE 1/4 of SW 1/4														
Mrs. Hattie Floro		NW 1/4 of SW 1/4	40			240	43 45		283 285	57 57		57		57		
U. S. of America		SW 1/4 of SW 1/4														
U. S. of America		SE 1/4 of SW 1/4														
U. S. of America		NE 1/4 of SE 1/4														
Geo. Lewin		NW 1/4 of SE 1/4	40			240			240	80		80		80		
"		SW 1/4 of SE 1/4	40			240			240	80		80		80		
"		SE 1/4 of SE 1/4	40			240			240	80		80		80		
			200			1200	90 86		1290 1286	114 114	240 240	354		354		

Assessment of Taxable Unplatted Real Property in the Town of Shingobe, County of Cass, Minn., for the Year 1942.

HOMESTEADS, up to True and Full Value of \$4,000.00, Assessable at 20 per cent, Class 3B, Remainder at 33 1/3 per cent, Class 3.

NAME OF OWNER	School District	DESCRIPTION OF PROPERTY				ASSESSOR'S VALUATIONS						EQUALIZED VALUATIONS				
		SUBDIVISION	Sec. or Lot	Twp. or Block	Number of Acres of Land	Infinite Homestead	True and Full Value of Land Exclusive of Structures and Improvements	STRUCTURES AND IMPROVEMENTS		Total True and Full Value of Land, Including all Structures, Improvements and Machinery	Assessed Value of Homesteads up to \$4,000 at 20 per cent Class 3B	Assessed Value of Remainder at 33 1/3 per cent Class 3	Total Assessed Value of Land, Including all Structures, Improvements and Machinery	Total Assessed Value as Equalized by Board of Review	Total Assessed Value as Equalized by the County Board	Total Assessed Value as Equalized by the Department of Taxation
								True and Full Value of Buildings and other Structures	True and Full Value of Machinery Permanently Attached to Real Estate							
Genevieve P. Michelle, Louisa M. Wells & Harvey Plymat		NE 1/4 of NE 1/4 Lot 1	29 1/4 31	24 75		200	43 45		243 245	49 49		49		49		
U. S. of America		NW 1/4 of NE 1/4 " 2														
U. S. of America		SW 1/4 of NE 1/4 " 11														
U. S. of America		SE 1/4 of NE 1/4														
G.P. Michelle, L.M. Wells & H.L. Plymat		NE 1/4 of NW 1/4 " 3		37 50		261			261			87		87		87
"		NW 1/4 of NW 1/4 " 4		29 50		261			261			87		87		87
U. S. of America		SW 1/4 of NW 1/4 " 5														
U. S. of America		SE 1/4 of NW 1/4														
U. S. of America		NE 1/4 of SW 1/4														
U. S. of America		NW 1/4 of SW 1/4 " 6														
U. S. of America		SW 1/4 of SW 1/4 " 7														
State of Minnesota		SE 1/4 of SW 1/4 " 8														
U. S. of America		NE 1/4 of SE 1/4 " 10														
U. S. of America		NW 1/4 of SE 1/4														
David J. Collins		SW 1/4 of SE 1/4 " 9		28 50		170			170	34		34		34		
"		SE 1/4 of SE 1/4		40		240			240	48		48		48		
						165 25			1132	45 43		1177 1175	136 131	174 174	305	305



Assessment of Taxable Unplatted Real Property in the Town of Shingabe, County of Cass, Minn., for the Year 1942.

HOMESTEADS, up to True and Full Value of \$4,000.00, Assessable at 20 per cent, Class 3B, Remainder at 33 1/3 per cent, Class 3.

Table with columns: NAME OF OWNER, SCHOOL DISTRICT, DESCRIPTION OF PROPERTY, ASSESSOR'S VALUATIONS (True and Full Value of Lands, Structures and Improvements, etc.), EQUALIZED VALUATIONS (Total Assessed Value as Equalized by Board of Review, etc.).

Assessment of Taxable Unplatted Real Property in the Town of Shingabe, County of Cass, Minn., for the Year 1942.

HOMESTEADS, up to True and Full Value of \$4,000.00, Assessable at 20 per cent, Class 3B, Remainder at 33 1/3 per cent, Class 3.

Table with columns: NAME OF OWNER, SCHOOL DISTRICT, DESCRIPTION OF PROPERTY, ASSESSOR'S VALUATIONS (True and Full Value of Lands, Structures and Improvements, etc.), EQUALIZED VALUATIONS (Total Assessed Value as Equalized by Board of Review, etc.).



Assessment of Taxable Unplatted Real Property in the Town of Shingobee, County of Cass, Minn., for the Year 1942.

HOMESTEADS, up to True and Full Value of \$4,000.00, Assessable at 20 per cent, Class 3B, Remainder at 33 1/2 per cent, Class 3.

NAME OF OWNER	School District	DESCRIPTION OF PROPERTY				ASSESSOR'S VALUATIONS					EQUALIZED VALUATIONS				
		SUBDIVISION	Sec. or Lot	Twp. or Block	Number of Acres of Land	Indicate Homestead	True and Full Value of Land Exclusive of Structures and Improvements	True and Full Value of Buildings and other Structures	True and Full Value of Machinery Permanently Attached to Real Estate	Total True and Full Value of Land, Including all Structures, Improvements and Machinery	Assessed Value of Homesteads up to \$4,000 at 20 per cent Class 3B	Assessed Value of Remainder at 33 1/2 per cent Class 3	Total Assessed Value as Equalized by Board of Review	Total Assessed Value as Equalized by the County Board	Total Assessed Value as Equalized by the Department of Taxation
U. S. of America	5	NE 1/4 of NE 1/4			31 141 31										
John N. & Anna M. Swanson		NW 1/4 of NE 1/4			29	✓	600	1824	2424	485		504	485		
"		SW 1/4 of NE 1/4			39 81	✓	320		320	64		64	64		
U. S. of America		SE 1/4 of NE 1/4													
Merlin R. Hyatt		NE 1/4 of NW 1/4			12 08		120		120	40		40	40		
U. S. of America		NW 1/4 of NW 1/4 Lot 1													
Arnold Nelson		SW 1/4 of NW 1/4 Lot 2			48 82	✓	335	29 30	364	73		73	73		
U. S. of America		SE 1/4 of NW 1/4													
Joe N. Jung		NE 1/4 of SW 1/4			18 11		180		180	60		60	60		
U. S. of America		NW 1/4 of SW 1/4 Lot 3													
Howard R. & Eda Stall		SW 1/4 of SW 1/4 Lot 4			48 51		480	299 420	879	293		300	293		
U. S. of America		SE 1/4 of SW 1/4													
U. S. of America		NE 1/4 of SE 1/4													
U. S. of America		NW 1/4 of SE 1/4													
U. S. of America		SW 1/4 of SE 1/4													
U. S. of America		SE 1/4 of SE 1/4													
					196 33		2035	2870	4405	641		400	1041		
					196 33			2252	4287	622		393			

Assessment of Taxable Unplatted Real Property in the Town of Shingobee, County of Cass, Minn., for the Year 1942.

HOMESTEADS, up to True and Full Value of \$4,000.00, Assessable at 20 per cent, Class 3B, Remainder at 33 1/2 per cent, Class 3.

NAME OF OWNER	School District	DESCRIPTION OF PROPERTY				ASSESSOR'S VALUATIONS					EQUALIZED VALUATIONS				
		SUBDIVISION	Sec. or Lot	Twp. or Block	Number of Acres of Land	Indicate Homestead	True and Full Value of Land Exclusive of Structures and Improvements	True and Full Value of Buildings and other Structures	True and Full Value of Machinery Permanently Attached to Real Estate	Total True and Full Value of Land, Including all Structures, Improvements and Machinery	Assessed Value of Homesteads up to \$4,000 at 20 per cent Class 3B	Assessed Value of Remainder at 33 1/2 per cent Class 3	Total Assessed Value as Equalized by Board of Review	Total Assessed Value as Equalized by the County Board	Total Assessed Value as Equalized by the Department of Taxation
U. S. of America	5	NE 1/4 of NE 1/4			32 141 31										
G. P. Michelle		NW 1/4 of NE 1/4			40		240		240	80		80	80		
U. S. of America		SW 1/4 of NE 1/4													
U. S. of America		SE 1/4 of NE 1/4													
State of Minnesota		NE 1/4 of NW 1/4													
State of Minnesota		NW 1/4 of NW 1/4													
State of Minnesota		SW 1/4 of NW 1/4													
U. S. of America		SE 1/4 of NW 1/4													
U. S. of America		NE 1/4 of SW 1/4													
U. S. of America		NW 1/4 of SW 1/4													
U. S. of America		SW 1/4 of SW 1/4													
U. S. of America		SE 1/4 of SW 1/4													
State of Minnesota		1/2 of NW 1/4 SW 1/4													
U. S. of America		NE 1/4 of SE 1/4													
G. P. Michelle		NW 1/4 of SE 1/4			20		120		120	40		40	40		
John L. Blomquist		SW 1/4 of SE 1/4			40	✓	240	38 40	278	56		56	56		
"		SE 1/4 of SE 1/4 Lot 1			33 75	✓	200		200	40		40	40		
					133 75		800	40 58	840	96		120	216		
					133 75				838	96					



Assessment of Taxable Unplatted Real Property in the Town of Shingabe, County of Cass, Minn., for the Year 1942.

HOMESTEADS, up to True and Full Value of \$4,000.00, Assessable at 20 per cent, Class 3B, Remainder at 33 1/3 per cent, Class 3.

Table with columns: NAME OF OWNER, SCHOOL DISTRICT, DESCRIPTION OF PROPERTY, ASSESSOR'S VALUATIONS, and EQUALIZED VALUATIONS. Includes entries for David J. Collins, Genevieve Michels, U.S. of America, and others.

Assessment of Taxable Unplatted Real Property in the Town of Shingabe, County of Cass, Minn., for the Year 1942.

HOMESTEADS, up to True and Full Value of \$4,000.00, Assessable at 20 per cent, Class 3B, Remainder at 33 1/3 per cent, Class 3.

Table with columns: NAME OF OWNER, SCHOOL DISTRICT, DESCRIPTION OF PROPERTY, ASSESSOR'S VALUATIONS, and EQUALIZED VALUATIONS. Includes entries for Henry Rose, Ole A. Larson, Everett Batcheller, U.S. of America, and others.



Assessment of Taxable Unplatted Real Property in the Town of Shogabe, County of Cass, Minn., for the Year 1942.

HOMESTEADS, up to True and Full Value of \$4,000.00, Assessable at 20 per cent, Class 3B, Remainder at 33 1/2 per cent, Class 3.

NAME OF OWNER	School District	DESCRIPTION OF PROPERTY				ASSESSOR'S VALUATIONS					EQUALIZED VALUATIONS					
		SUBDIVISION	Sec. or Lot	Twp. or Block	Number of Acres of Land	Indicate Homestead	True and Full Value of Land Exclusive of Structures and Improvements	STRUCTURES AND IMPROVEMENTS		Total True and Full Value of Land, Including all Structures, Improvements and Machinery	Assessed Value of Homestead up to \$4,000 at 20 per cent Class 3B	Assessed Value of Remainder at 33 1/2 per cent Class 3	Total Assessed Value of Land Including all Structures, Improvements and Machinery	Total Assessed Value as Equalized by Board of Review	Total Assessed Value as Equalized by the County Board	Total Assessed Value as Equalized by the Department of Taxation
								True and Full Value of Buildings and other Structures	True and Full Value of Machinery Permanently Attached to Real Estate							
Harry G Taylor	5	NE 1/4 of NE 1/4	34	14	31	11	44	220	1900	2120	707	740	707			
Theodore Helen G. Kolderie		NW 1/4 of NE 1/4	100	X	250	of Lot 1	57	60	855	915	320	320	305			
		SW 1/4 of NE 1/4														
		SE 1/4 of NE 1/4														
		NE 1/4 of NW 1/4														
		NW 1/4 of NW 1/4														
		SW 1/4 of NW 1/4														
		SE 1/4 of NW 1/4														
		NE 1/4 of SW 1/4														
		NW 1/4 of SW 1/4														
		SW 1/4 of SW 1/4														
		SE 1/4 of SW 1/4														
		NE 1/4 of SE 1/4														
		NW 1/4 of SE 1/4														
		SW 1/4 of SE 1/4														
		SE 1/4 of SE 1/4														
							1201	280	2900	3180	1060	1060	1012			
								2755	3035	1012						

Assessment of Taxable Unplatted Real Property in the Town of Shogabe, County of Cass, Minn., for the Year 1942.

HOMESTEADS, up to True and Full Value of \$4,000.00, Assessable at 20 per cent, Class 3B, Remainder at 33 1/2 per cent, Class 3.

NAME OF OWNER	School District	DESCRIPTION OF PROPERTY				ASSESSOR'S VALUATIONS					EQUALIZED VALUATIONS					
		SUBDIVISION	Sec. or Lot	Twp. or Block	Number of Acres of Land	Indicate Homestead	True and Full Value of Land Exclusive of Structures and Improvements	STRUCTURES AND IMPROVEMENTS		Total True and Full Value of Land, Including all Structures, Improvements and Machinery	Assessed Value of Homestead up to \$4,000 at 20 per cent Class 3B	Assessed Value of Remainder at 33 1/2 per cent Class 3	Total Assessed Value of Land Including all Structures, Improvements and Machinery	Total Assessed Value as Equalized by Board of Review	Total Assessed Value as Equalized by the County Board	Total Assessed Value as Equalized by the Department of Taxation
								True and Full Value of Buildings and other Structures	True and Full Value of Machinery Permanently Attached to Real Estate							
	5	NE 1/4 of NE 1/4	35	14	31											
		NW 1/4 of NE 1/4														
P. C. De Lury & Adolph Kainegger		SW 1/4 of NE 1/4	Lot 1			2760	222		222		74	74		74		
		SE 1/4 of NE 1/4														
Theodore & Helen G. Kolderie		50' x 250' of "	4			35	60		60		20	20		20		
Park Region Lumber Co.		NE 1/4 of NW 1/4	"	2		240	45		45		15	15		15		
Mrs. Lowen		NW 1/4 of NW 1/4	"	3		30	180		180		60	60		60		
Everett L. Batcheller & Henry Rose		SW 1/4 of NW 1/4	"	4		2831	180		180		60	60		60		
Ada L. Macklin		SE 1/4 of NW 1/4	200' x 250' of Lot 4			117	60	855	915		305	320		320		305
Theodore & Helen G. Kolderie		Supplisted	250' x 250' "	4		117	60		60		20	20		20		20 out
Lloyd & Mildred Sundin		350' on Lake x 250' of	NE 1/4 of SW 1/4 of Lot 4			1	82	988	1070		357	374		374		357
		NW 1/4 of SW 1/4														
		SW 1/4 of SW 1/4														
		SE 1/4 of SW 1/4														
		NE 1/4 of SE 1/4														
		NW 1/4 of SE 1/4														
		SW 1/4 of SE 1/4														
		SE 1/4 of SE 1/4														
							889	1940	2829		943	943		911		911
								1843	2732							

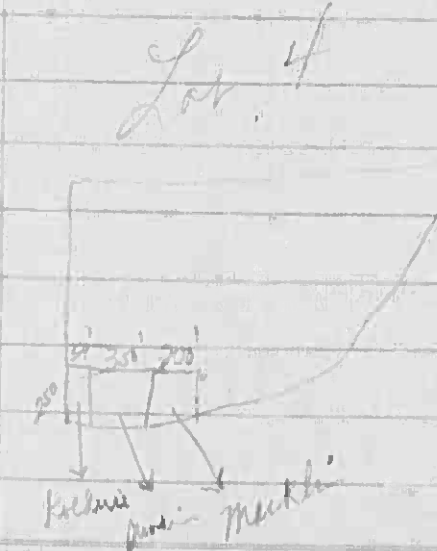



Assessment of Taxable Unplatted Real Property in the Town of Shingobe, County of Cass, Minn., for the Year 1942.

HOMESTEADS, up to True and Full Value of \$4,000.00, Assessable at 20 per cent, Class 3B, Remainder at 33 1/2 per cent, Class 3.

Table with columns: NAME OF OWNER, DESCRIPTION OF PROPERTY, ASSESSOR'S VALUATIONS, EQUALIZED VALUATIONS. Includes entries for L. A. Bassett, Emily Johnson & Henry Roworth, Clarence S. Searse, Walter E. Zimbrick, Geo. B. Leonard, Herman Scholberg.

Assessment of Taxable Unplatted Real Property in the Town of Shingobe, County of Cass, Minn., for the Year 1942.

HOMESTEADS, up to True and Full Value of \$4,000.00, Assessable at 20 per cent, Class 3B, Remainder at 33 1/2 per cent, Class 3.

Table with columns: NAME OF OWNER, DESCRIPTION OF PROPERTY, ASSESSOR'S VALUATIONS, EQUALIZED VALUATIONS. Includes entries for Mrs. Maggie Gould, Mrs. Joe Smith & Pete Reas, Kothel L. Peterson.



Assessment of Taxable Unplatted Real Property in the Town of Shingobee, County of Cass, Minn., for the Year 1942.

Table with columns: NAME OF OWNER, SCHOOL DISTRICT, DESCRIPTION OF PROPERTY, ASSESSOR'S VALUATIONS, and EQUALIZED VALUATIONS. Includes entries for Raymond & Carl H. Stanley and Co. H. & R. Stanley.

Assessment of Taxable Unplatted Real Property in the Town of Shingobee, County of Cass, Minn., for the Year 1942.

Table with columns: NAME OF OWNER, SCHOOL DISTRICT, DESCRIPTION OF PROPERTY, ASSESSOR'S VALUATIONS, and EQUALIZED VALUATIONS. Includes entries for Leroy & Lela H. Matson, Christian Bjork, Alvin Clarine, B. F. Nelson Mfg. Co., P. L. Kuehnel, Irene Olson, and Caroline Clarine.



Assessment of Taxable Unplatted Real Property in the Town of Shingabe, County of Cass, Minn., for the Year 1942.

HOMESTEADS, up to True and Full Value of \$4,000.00, Assessable at 20 per cent, Class 3B, Remainder at 33 1/3 per cent, Class 3.

Table with columns: NAME OF OWNER, SCHOOL DISTRICT, DESCRIPTION OF PROPERTY, ASSESSOR'S VALUATIONS, EQUALIZED VALUATIONS. Includes entries for Alvin Clarine (or Nels Strand), State of Minnesota, U.S. of America, and Axel Strand.

Assessment of Taxable Unplatted Real Property in the Town of Shingabe, County of Cass, Minn., for the Year 1942.

HOMESTEADS, up to True and Full Value of \$4,000.00, Assessable at 20 per cent, Class 3B, Remainder at 33 1/3 per cent, Class 3.

Table with columns: NAME OF OWNER, SCHOOL DISTRICT, DESCRIPTION OF PROPERTY, ASSESSOR'S VALUATIONS, EQUALIZED VALUATIONS. Includes entries for Fred W. & Jessie M. Deising, W.F. Weiss, Red River Lbr. Co., Bert R. Gardner, Ole Berg & May Thompson, Agnes Jakschi, Frank Hohman, Alvin Jakschi, and Walter D. & Magdalene H. Leslie.



Assessment of Taxable Unplatted Real Property in the Town of Shingabe, County of Cass, Minn., for the Year 1942. HOMESTEADS, up to True and Full Value of \$4,000.00, Assessable at 20 per cent, Class 3B, Remainder at 33 1/3 per cent, Class 3.

Table with columns: NAME OF OWNER, SCHOOL DISTRICT, DESCRIPTION OF PROPERTY, ASSESSOR'S VALUATIONS (STRUCTURES AND IMPROVEMENTS, True and Full Value of Land, etc.), EQUALIZED VALUATIONS (Total Assessed Value as Equalized by Board of Review, etc.).

Assessment of Taxable Unplatted Real Property in the Town of Shingabe, County of Cass, Minn., for the Year 1942. HOMESTEADS, up to True and Full Value of \$4,000.00, Assessable at 20 per cent, Class 3B, Remainder at 33 1/3 per cent, Class 3.

Table with columns: NAME OF OWNER, SCHOOL DISTRICT, DESCRIPTION OF PROPERTY, ASSESSOR'S VALUATIONS (STRUCTURES AND IMPROVEMENTS, True and Full Value of Land, etc.), EQUALIZED VALUATIONS (Total Assessed Value as Equalized by Board of Review, etc.).

Balance of Sec. 8 on next page



Assessment of Taxable Unplatted Real Property in the Town of Shingobee County of Cass, Minn., for the Year 1942.

HOMESTEADS, up to True and Full Value of \$4,000.00, Assessable at 20 per cent, Class 3B, Remainder at 33 1/2 per cent, Class 3.

Table with columns: NAME OF OWNER, SCHOOL DISTRICT, DESCRIPTION OF PROPERTY, ASSESSOR'S VALUATIONS, EQUALIZED VALUATIONS. Includes entries for Andrew Magnuson, A.G. Thompson, Minnie De Floren, John B. De Floren, and P.O. & H. Simonson.

Assessment of Taxable Unplatted Real Property in the Town of Shingobee, County of Cass, Minn., for the Year 1942.

HOMESTEADS, up to True and Full Value of \$4,000.00, Assessable at 20 per cent, Class 3B, Remainder at 33 1/2 per cent, Class 3.

Table with columns: NAME OF OWNER, SCHOOL DISTRICT, DESCRIPTION OF PROPERTY, ASSESSOR'S VALUATIONS, EQUALIZED VALUATIONS. Includes entries for Ferdinand Zink, Aron & Hanna Hawkinson, Elsie Rapp & D.M. Murphy, and Lohel L. Peterson.



Assessment of Taxable Unplatted Real Property in the Town of Shingabe, County of Cass, Minn., for the Year 1942.

HOMESTEADS, up to True and Full Value of \$4,000.00, Assessable at 20 per cent, Class 3B, Remainder at 33 1/2 per cent, Class 3.

Table with columns: NAME OF OWNER, SCHOOL DISTRICT, DESCRIPTION OF PROPERTY, ASSESSOR'S VALUATIONS, EQUALIZED VALUATIONS. Includes entries for Nathanial C. & Bertha Bennett, M.C. Bennett, Ethel L. Peterson, Farmers St. Bk. Walker, Charles Mankenberg, Lucy Shanandore, Edward Johnson.

Assessment of Taxable Unplatted Real Property in the Town of Shingabe, County of Cass, Minn., for the Year 1942.

HOMESTEADS, up to True and Full Value of \$4,000.00, Assessable at 20 per cent, Class 3B, Remainder at 33 1/2 per cent, Class 3.

Table with columns: NAME OF OWNER, SCHOOL DISTRICT, DESCRIPTION OF PROPERTY, ASSESSOR'S VALUATIONS, EQUALIZED VALUATIONS. Includes entries for U. S. of America - In Trust for Minn. Chippewa Tribe, Faye C. Andrus.



Assessment of Taxable Unplatted Real Property in the Town of Shingobee, County of Cass, Minn., for the Year 1942.

HOMESTEADS, up to True and Full Value of \$4,000.00, Assessable at 20 per cent, Class 3B, Remainder at 33 1/2 per cent, Class 3.

Table with columns: NAME OF OWNER, SCHOOL DISTRICT, DESCRIPTION OF PROPERTY, ASSESSOR'S VALUATIONS, EQUALIZED VALUATIONS. Includes entries for Thomas A. Barker, A. H. Morris, S. E. + Genevieve Fischer, A. W. Morris, John Hanson, H. A. Hanson, + Sofia Hanson, A. N. Mc Pherson, John Hanson, H. A. Hanson, + Sofia Hanson.

21370  
20977 2300 900 41 3241 260 647 807 893

Assessment of Taxable Unplatted Real Property in the Town of Shingobee, County of Cass, Minn., for the Year 1942.

HOMESTEADS, up to True and Full Value of \$4,000.00, Assessable at 20 per cent, Class 3B, Remainder at 33 1/2 per cent, Class 3.

Table with columns: NAME OF OWNER, SCHOOL DISTRICT, DESCRIPTION OF PROPERTY, ASSESSOR'S VALUATIONS, EQUALIZED VALUATIONS. Includes entries for Lawrence Thompson, U. S. of America, A. G. + Lydia Thompson, U. S. of America, State of Minnesota, U. S. of America.

100 520 500 7020 204 204 199



Assessment of Taxable Unplatted Real Property in the Town of Shengobee, County of Cass, Minn., for the Year 1942.

HOMESTEADS, up to True and Full Value of \$4,000.00, Assessable at 20 per cent, Class 3B, Remainder at 33 1/3 per cent, Class 3.

Table with columns: NAME OF OWNER, SCHOOL DISTRICT, DESCRIPTION OF PROPERTY, ASSESSOR'S VALUATIONS, EQUALIZED VALUATIONS. Includes rows for U.S. of America with various subdivisions like NE 1/4 of NE 1/4.

Assessment of Taxable Unplatted Real Property in the Town of Shengobee, County of Cass, Minn., for the Year 1942.

HOMESTEADS, up to True and Full Value of \$4,000.00, Assessable at 20 per cent, Class 3B, Remainder at 33 1/3 per cent, Class 3.

Table with columns: NAME OF OWNER, SCHOOL DISTRICT, DESCRIPTION OF PROPERTY, ASSESSOR'S VALUATIONS, EQUALIZED VALUATIONS. Includes rows for Mrs. Loretta Anderson Pelton and U.S. of America with subdivisions like NE 1/4 of NE 1/4.



Assessment of Taxable Unplatted Real Property in the Town of Shingobee, County of Cass, Minn., for the Year 1942. HOMESTEADS, up to True and Full Value of \$4,000.00, Assessable at 20 per cent, Class 3B, Remainder at 33 1/2 per cent, Class 3.

Table with columns: NAME OF OWNER, SCHOOL DISTRICT, DESCRIPTION OF PROPERTY, ASSESSOR'S VALUATIONS, and EQUALIZED VALUATIONS. Includes entries for U.S. of America, Edward & Clara E. Kistner, Fritz & Olga Carlson, Mitchell Ellis, Ferdinand Zink, Claude B. & Lillian Starr.

Assessment of Taxable Unplatted Real Property in the Town of Shingobee, County of Cass, Minn., for the Year 1942. HOMESTEADS, up to True and Full Value of \$4,000.00, Assessable at 20 per cent, Class 3B, Remainder at 33 1/2 per cent, Class 3.

Table with columns: NAME OF OWNER, SCHOOL DISTRICT, DESCRIPTION OF PROPERTY, ASSESSOR'S VALUATIONS, and EQUALIZED VALUATIONS. Includes entries for Daniel A. Wallace, Albert Carlson, Fred Sembke & Raymond Sembke, John Hanson, Albert Bratrud, John Hanson, H. B. Hanson & Sofia Hanson, Ed. L. P. Staede, Alfred W. & Edna M. Oberly, Edna C. Mc Garry Pick, Bertie Southwick, L. A. & Julia Truxell.



Assessment of Taxable Unplatted Real Property in the Town of Shingobee, County of Cass, Minn., for the Year 1942.

HOMESTEADS, up to True and Full Value of \$4,000.00, Assessable at 20 per cent, Class 3B, Remainder at 33 1/3 per cent, Class 3.

Table with columns: NAME OF OWNER, SCHOOL DISTRICT, DESCRIPTION OF PROPERTY, ASSESSOR'S VALUATIONS (True and Full Value, Structures and Improvements, Total True and Full Value), EQUALIZED VALUATIONS (Total Assessed Value as Equalized by Board of Review, Total Assessed Value as Equalized by the County Board, Total Assessed Value as Equalized by the Department of Taxation).

Assessment of Taxable Unplatted Real Property in the Town of Shingobee, County of Cass, Minn., for the Year 1942.

HOMESTEADS, up to True and Full Value of \$4,000.00, Assessable at 20 per cent, Class 3B, Remainder at 33 1/3 per cent, Class 3.

Table with columns: NAME OF OWNER, SCHOOL DISTRICT, DESCRIPTION OF PROPERTY, ASSESSOR'S VALUATIONS (True and Full Value, Structures and Improvements, Total True and Full Value), EQUALIZED VALUATIONS (Total Assessed Value as Equalized by Board of Review, Total Assessed Value as Equalized by the County Board, Total Assessed Value as Equalized by the Department of Taxation).



Assessment of Taxable Unplatted Real Property in the Town of Shingobee, County of Cass, Minn., for the Year 1942.

HOMESTEADS, up to True and Full Value of \$4,000.00, Assessable at 20 per cent, Class 3B, Remainder at 33 1/2 per cent, Class 3.

Table with columns: NAME OF OWNER, SCHOOL DISTRICT, DESCRIPTION OF PROPERTY, ASSESSOR'S VALUATIONS (True and Full Value, Structures and Improvements, Total True and Full Value), EQUALIZED VALUATIONS (Total Assessed Value as Equalized by Board of Review, Total Assessed Value as Equalized by the County Board, Total Assessed Value as Equalized by the Department of Taxation).

Assessment of Taxable Unplatted Real Property in the Town of Shingobee, County of Cass, Minn., for the Year 1942.

HOMESTEADS, up to True and Full Value of \$4,000.00, Assessable at 20 per cent, Class 3B, Remainder at 33 1/2 per cent, Class 3.

Table with columns: NAME OF OWNER, SCHOOL DISTRICT, DESCRIPTION OF PROPERTY, ASSESSOR'S VALUATIONS (True and Full Value, Structures and Improvements, Total True and Full Value), EQUALIZED VALUATIONS (Total Assessed Value as Equalized by Board of Review, Total Assessed Value as Equalized by the County Board, Total Assessed Value as Equalized by the Department of Taxation).



Assessment of Taxable Unplatted Real Property in the Town of Shingobee, County of Cass, Minn., for the Year 1942.

HOMESTEADS, up to True and Full Value of \$4,000.00, Assessable at 20 per cent, Class 3B, Remainder at 33 1/3 per cent, Class 3.

Table with columns: NAME OF OWNER, SCHOOL DISTRICT, DESCRIPTION OF PROPERTY, ASSESSOR'S VALUATIONS, EQUALIZED VALUATIONS. Includes entries for Letha L. Peterson and U. S. of America in trust for Miss Chippewa Lake.

Assessment of Taxable Unplatted Real Property in the Town of Shingobee, County of Cass, Minn., for the Year 1942.

HOMESTEADS, up to True and Full Value of \$4,000.00, Assessable at 20 per cent, Class 3B, Remainder at 33 1/3 per cent, Class 3.

Table with columns: NAME OF OWNER, SCHOOL DISTRICT, DESCRIPTION OF PROPERTY, ASSESSOR'S VALUATIONS, EQUALIZED VALUATIONS. Includes entries for R.A. Naustrold, Letha L. Peterson, Pearl Hinde, Fred Hawkins, and Chris F. Hanser.



Assessment of Taxable Unplatted Real Property in the Town of Shingobee, County of Cass, Minn., for the Year 1942.

Table with columns: NAME OF OWNER, SCHOOL DISTRICT, DESCRIPTION OF PROPERTY, ASSESSOR'S VALUATIONS, EQUALIZED VALUATIONS. Includes entries for Russell & Ruby Angel, William Erickson, Clara Upend, Herman Fisher, George & Sylvia A. Jensen, Arthur O. & Anne C. Dallaire, H. M. & Daisy Lemberling, George A. & Sylvia A. Jensen, Herman Fisher, Arthur O. & Anne C. Dallaire, Herman Fisher, Loni Berg, Fred Fisher.

Assessment of Taxable Unplatted Real Property in the Town of Shingobee, County of Cass, Minn., for the Year 1942.

Table with columns: NAME OF OWNER, SCHOOL DISTRICT, DESCRIPTION OF PROPERTY, ASSESSOR'S VALUATIONS, EQUALIZED VALUATIONS. Includes entries for U. S. of America, M. G. Johanson, C. D. Bacon, Oral & Edyle Dickinson, Dorothy Fluke, J. Virginia Rastear, J. C. Jewell, Quentin M. & Henrietta J. Neuger, J. Virginia Rastear, H. P. Fluke, Mavis Powers & Light Co., Carl E. & Nina Steadland, Dorothy Fluke.



Assessment of Taxable Unplatted Real Property in the Town of Shingabe, County of Case, Minn., for the Year 1942. HOMESTEADS, up to True and Full Value of \$4,000.00, Assessable at 20 per cent, Class 3B, Remainder at 3 1/2 per cent, Class 3.

Table with columns: NAME OF OWNER, SCHOOL DISTRICT, SUBDIVISION, ASSESSOR'S VALUATIONS (True and Full Value of Land, Structures and Improvements, etc.), EQUALIZED VALUATIONS (Total Assessed Value as Equalized by Board of Review, etc.).

171 78 2401 230 2631 246 467 713 711

Assessment of Taxable Unplatted Real Property in the Town of Shingabe, County of Case, Minn., for the Year 1942. HOMESTEADS, up to True and Full Value of \$4,000.00, Assessable at 20 per cent, Class 3B, Remainder at 3 1/2 per cent, Class 3.

Table with columns: NAME OF OWNER, SCHOOL DISTRICT, SUBDIVISION, ASSESSOR'S VALUATIONS (True and Full Value of Land, Structures and Improvements, etc.), EQUALIZED VALUATIONS (Total Assessed Value as Equalized by Board of Review, etc.).

Balance of Sec. 29 on next page 204 17 2095 3272 115 5482 461 1059 1520 1473



Assessment of Taxable Unplatted Real Property in the Town of Shingabe, County of Cass, Minn., for the Year 1942.

HOMESTEADS, up to True and Full Value of \$4,000.00, Assessable at 20 per cent, Class 3B, Remainder at 33 1/3 per cent, Class 3.

Table with columns: NAME OF OWNER, SCHOOL DISTRICT, DESCRIPTION OF PROPERTY, ASSESSOR'S VALUATIONS (True and Full Value, Structures and Improvements, Total True and Full Value, Assessed Value), EQUALIZED VALUATIONS (Total Assessed Value as Equalized by Board of Review, Total Assessed Value as Equalized by the County Board, Total Assessed Value as Equalized by the Department of Taxation).

Assessment of Taxable Unplatted Real Property in the Town of Shingabe, County of Cass, Minn., for the Year 1942.

HOMESTEADS, up to True and Full Value of \$4,000.00, Assessable at 20 per cent, Class 3B, Remainder at 33 1/3 per cent, Class 3.

Table with columns: NAME OF OWNER, SCHOOL DISTRICT, DESCRIPTION OF PROPERTY, ASSESSOR'S VALUATIONS (True and Full Value, Structures and Improvements, Total True and Full Value, Assessed Value), EQUALIZED VALUATIONS (Total Assessed Value as Equalized by Board of Review, Total Assessed Value as Equalized by the County Board, Total Assessed Value as Equalized by the Department of Taxation).



Assessment of Taxable Unplatted Real Property in the Town of Shingabe, County of Cass, Minn., for the Year 1942. HOMESTEADS, up to True and Full Value of \$4,000.00, Assessable at 20 per cent, Class 3B, Remainder at 33 1/3 per cent, Class 3.

Table with columns: NAME OF OWNER, SCHOOL DISTRICT, DESCRIPTION OF PROPERTY, ASSESSOR'S VALUATIONS, EQUALIZED VALUATIONS. Includes entries for U.S. of America, State of Minnesota, and Jacob Distel.

Assessment of Taxable Unplatted Real Property in the Town of Shingabe, County of Cass, Minn., for the Year 1942. HOMESTEADS, up to True and Full Value of \$4,000.00, Assessable at 20 per cent, Class 3B, Remainder at 33 1/3 per cent, Class 3.

Table with columns: NAME OF OWNER, SCHOOL DISTRICT, DESCRIPTION OF PROPERTY, ASSESSOR'S VALUATIONS, EQUALIZED VALUATIONS. Includes entries for Henry L. Perry and Chas. Sloan.



Assessment of Taxable Unplatted Real Property in the Town of Shingabe, County of Cass, Minn., for the Year 1942. HOMESTEADS, up to True and Full Value of \$4,000.00, Assessable at 20 per cent, Class 3B, Remainder at 33 1/3 per cent, Class 3.

Table with columns: NAME OF OWNER, SCHOOL DISTRICT, DESCRIPTION OF PROPERTY, ASSESSOR'S VALUATIONS, EQUALIZED VALUATIONS. Includes entries for Leonard A. Gruber, N.E. 1/4 of N.E. 1/4, and others.

Assessment of Taxable Unplatted Real Property in the Town of Shingabe, County of Cass, Minn., for the Year 1942. HOMESTEADS, up to True and Full Value of \$4,000.00, Assessable at 20 per cent, Class 3B, Remainder at 33 1/3 per cent, Class 3.

Table with columns: NAME OF OWNER, SCHOOL DISTRICT, DESCRIPTION OF PROPERTY, ASSESSOR'S VALUATIONS, EQUALIZED VALUATIONS. Includes entries for Bert L. Johnson, N.E. 1/4 of N.E. 1/4 Lot 1, and others.



Assessment of Taxable Unplatted Real Property in the Town of Shingabe, County of Cass, Minn., for the Year 1942.

HOMESTEADS, up to True and Full Value of \$4,000.00, Assessable at 20 per cent, Class 3B, Remainder at 33 1/2 per cent, Class 3.

Table with columns: NAME OF OWNER, SCHOOL DISTRICT, DESCRIPTION OF PROPERTY, ASSESSOR'S VALUATIONS (True and Full Value, Structures and Improvements, Total True and Full Value), EQUALIZED VALUATIONS (Total Assessed Value as Equalized by Board of Review, Total Assessed Value as Equalized by County Board, Total Assessed Value as Equalized by Department of Taxation).

Mr. Voshel: Waverly, Minn., 19... DEAR SIR:

Mc Pherson has sold quite a few tracts which are not on tax lists on account of deeds not being recorded. If you find any buildings on these please enter on assessment book if you can find the name of owner.

the Town of Shingabe, County of Cass, Minn., for the Year 1942.

True and Full Value of \$4,000.00, Assessable at 20 per cent, Class 3B, Remainder at 33 1/2 per cent, Class 3.

Table with columns: PROPERTY (Sec. Twp. or or Rng., Acres of Land, Indicate Homestead), ASSESSOR'S VALUATIONS (True and Full Value of Land, Structures and Improvements, Total True and Full Value), EQUALIZED VALUATIONS (Total Assessed Value as Equalized by Board of Review, Total Assessed Value as Equalized by County Board, Total Assessed Value as Equalized by Department of Taxation).



Assessment of Taxable Unplatted Real Property in the Town of Shingabe, County of Cass, Minn., for the Year 1942.

HOMESTEADS, up to True and Full Value of \$4,000.00, Assessable at 20 per cent, Class 3B, Remainder at 33 1/3 per cent, Class 3.

Table with columns: NAME OF OWNER, SCHOOL DISTRICT, DESCRIPTION OF PROPERTY, ASSESSOR'S VALUATIONS (True and Full Value, Structures and Improvements, Total True and Full Value), EQUALIZED VALUATIONS (Total Assessed Value as Equalized by Board of Review, Total Assessed Value as Equalized by County Board, Total Assessed Value as Equalized by Department of Taxation).

Assessment of Taxable Unplatted Real Property in the Town of Shingabe, County of Cass, Minn., for the Year 1942.

HOMESTEADS, up to True and Full Value of \$4,000.00, Assessable at 20 per cent, Class 3B, Remainder at 33 1/3 per cent, Class 3.

Table with columns: NAME OF OWNER, SCHOOL DISTRICT, DESCRIPTION OF PROPERTY, ASSESSOR'S VALUATIONS (True and Full Value, Structures and Improvements, Total True and Full Value), EQUALIZED VALUATIONS (Total Assessed Value as Equalized by Board of Review, Total Assessed Value as Equalized by County Board, Total Assessed Value as Equalized by Department of Taxation).



Assessment of Taxable Unplatted Real Property in the Town of Shingabe, County of Cass, Minn., for the Year 1942.

HOMESTEADS, up to True and Full Value of \$4,000.00, Assessable at 20 per cent, Class 3B, Remainder at 33 1/3 per cent, Class 3.

Table with columns: NAME OF OWNER, SCHOOL DISTRICT, SUBDIVISION, ASSESSOR'S VALUATIONS (True and Full Value of Land, Structures and Improvements, Total True and Full Value of Land), EQUALIZED VALUATIONS (Total Assessed Value as Equalized by Board of Review, Total Assessed Value as Equalized by County Board, Total Assessed Value as Equalized by Department of Taxation).

Assessment of Taxable Unplatted Real Property in the Town of Shingabe, County of Cass, Minn., for the Year 1942.

HOMESTEADS, up to True and Full Value of \$4,000.00, Assessable at 20 per cent, Class 3B, Remainder at 33 1/3 per cent, Class 3.

Table with columns: NAME OF OWNER, SCHOOL DISTRICT, SUBDIVISION, ASSESSOR'S VALUATIONS (True and Full Value of Land, Structures and Improvements, Total True and Full Value of Land), EQUALIZED VALUATIONS (Total Assessed Value as Equalized by Board of Review, Total Assessed Value as Equalized by County Board, Total Assessed Value as Equalized by Department of Taxation).



Assessment of Taxable Platted Real Property in the Town of Shingabe, County of Cass, Minn., for the Year 1942.

HOMESTEADS, up to True and Full Value of \$4,000.00, Assessable at 25 per cent, Class 3C, Remainder at 40 per cent, Class 4.

Table with columns: NAME OF OWNER, SCHOOL DISTRICT, SUBDIVISION, Lot, Block, Indicate Homestead, ASSESSOR'S VALUATIONS (True and Full Value of Lands, Structures and Improvements, Total True and Full Value of Lands), EQUALIZED VALUATIONS (Total Assessed Value as Equalized by Board of Review, Total Assessed Value as Equalized by County Board, Total Assessed Value as Equalized by Department of Taxation).

Assessment of Taxable Platted Real Property in the Town of Shingabe, County of Cass, Minn., for the Year 1942.

HOMESTEADS, up to True and Full Value of \$4,000.00, Assessable at 25 per cent, Class 3C, Remainder at 40 per cent, Class 4.

Table with columns: NAME OF OWNER, SCHOOL DISTRICT, SUBDIVISION, Lot, Block, Indicate Homestead, ASSESSOR'S VALUATIONS (True and Full Value of Lands, Structures and Improvements, Total True and Full Value of Lands), EQUALIZED VALUATIONS (Total Assessed Value as Equalized by Board of Review, Total Assessed Value as Equalized by County Board, Total Assessed Value as Equalized by Department of Taxation).







Assessment of Taxable Platted Real Property in the Town of Shingabe, County of Cass, Minn., for the Year 1942.

HOMESTEADS, up to True and Full Value of \$4,000.00, Assessable at 25 per cent, Class 3C, Remainder at 40 per cent, Class 4.

Table with columns: NAME OF OWNER, SCHOOL DISTRICT, DESCRIPTION OF PROPERTY, ASSESSOR'S VALUATIONS, EQUALIZED VALUATIONS. Includes entries for Nels Broughton, Argelia Thompson, Con Nansen, Mary Erickson, John Olson, etc.

952 2052 136 3140 460 520 980

Assessment of Taxable Platted Real Property in the Town of Shingabe, County of Cass, Minn., for the Year 1942.

HOMESTEADS, up to True and Full Value of \$4,000.00, Assessable at 25 per cent, Class 3C, Remainder at 40 per cent, Class 4.

Table with columns: NAME OF OWNER, SCHOOL DISTRICT, DESCRIPTION OF PROPERTY, ASSESSOR'S VALUATIONS, EQUALIZED VALUATIONS. Includes entries for J.F. Hillians & Martin Reid, Walter Mc Carthy, Betty Malquist, etc.

1684 4930 280 6894 996 1164 2160











Assessment of Taxable Platted Real Property in the Town of Shingabe, County of Cass, Minn., for the Year 1942.  
HOMESTEADS, up to True and Full Value of \$4,000.00, Assessable at 25 per cent, Class 3C, Remainder at 40 per cent, Class 4.

NAME OF OWNER	School District	DESCRIPTION OF PROPERTY	Indicate Homestead	ASSESSOR'S VALUATIONS						EQUALIZED VALUATIONS			
				True and Full Value of Land Exclusive of Structures and Improvements Dollars	STRUCTURES AND IMPROVEMENTS		Total True and Full Value of Land, Including all Structures, Improvements and Machinery Dollars	Assessed Value of Homesteads up to \$4,000 at 25 per cent Class 3C Dollars	Assessed Value of Remainder at 40 per cent Class 4 Dollars	Total Assessed Value of Land Including all Structures, Improvements and Machinery Dollars	Total Assessed Value as Equalized by Board of Review Dollars	Total Assessed Value as Equalized by the County Board Dollars	Total Assessed Value as Equalized by the Department of Taxation Dollars
					True and Full Value of Buildings and other Structures Dollars	True and Full Value of Machinery Permanently Attached to Real Estate Dollars							
Nathaniel C. Bennett	5	Gibway		40	300	340	136	136					
N. C. Bennett				10		10	4	4					
Nathaniel C. Bennett & Bertha Bennett				30		30	12	12					
N. C. Bennett				10		10	4	4					
"				10		10	4	4					
"				10		10	4	4					
"		Lake frontage lying N. of lots 3 & 4		40		40	16	16					
				150	300	450	180	180					

Assessment of Taxable Platted Real Property in the Town of Shingabe, County of Cass, Minn., for the Year 1942.  
HOMESTEADS, up to True and Full Value of \$4,000.00, Assessable at 25 per cent, Class 3C, Remainder at 40 per cent, Class 4.

NAME OF OWNER	School District	DESCRIPTION OF PROPERTY	Indicate Homestead	ASSESSOR'S VALUATIONS						EQUALIZED VALUATIONS			
				True and Full Value of Land Exclusive of Structures and Improvements Dollars	STRUCTURES AND IMPROVEMENTS		Total True and Full Value of Land, Including all Structures, Improvements and Machinery Dollars	Assessed Value of Homesteads up to \$4,000 at 25 per cent Class 3C Dollars	Assessed Value of Remainder at 40 per cent Class 4 Dollars	Total Assessed Value of Land Including all Structures, Improvements and Machinery Dollars	Total Assessed Value as Equalized by Board of Review Dollars	Total Assessed Value as Equalized by the County Board Dollars	Total Assessed Value as Equalized by the Department of Taxation Dollars
					True and Full Value of Buildings and other Structures Dollars	True and Full Value of Machinery Permanently Attached to Real Estate Dollars							
Chas. A. Ball		Ball's 1st Subdivision 1648 ac of Lot 7 - Sec. 26 - 141 - 31		50		50	20	20					
"				50		50	20	20					
"				50		50	20	20					
"				50		50	20	20					
"				50		50	20	20					
"				50		50	20	20					
"				50		50	20	20					
"				50		50	20	20					
"				50		50	20	20					
"				50		50	20	20					
Warren A. & Gertrude B. Hanson				50	120	170	68	68					
Chas. Ball				50	150	200	80	80					
"				50		50	20	20					
				800	270	1070	428	428					











Assessment of Taxable Platted Real Property in the \_\_\_\_\_ of \_\_\_\_\_, County of \_\_\_\_\_, Minn., for the Year 1942. HOMESTEADS, up to True and Full Value of \$4,000.00, Assessable at 25 per cent, Class 3C, Remainder at 40 per cent, Class 4.

Table with columns: NAME OF OWNER, School District, DESCRIPTION OF PROPERTY (SUBDIVISION, Lot, Block), ASSESSOR'S VALUATIONS (True and Full Value of Lands, Structures and Improvements, Total True and Full Value of Lands), and EQUALIZED VALUATIONS (Total Assessed Value as Equalized by Board of Review, Total Assessed Value as Equalized by the County Board, Total Assessed Value as Equalized by the Department of Taxation).

Assessment of Taxable Platted Real Property in the \_\_\_\_\_ of \_\_\_\_\_, County of \_\_\_\_\_, Minn., for the Year 1942. HOMESTEADS, up to True and Full Value of \$4,000.00, Assessable at 25 per cent, Class 3C, Remainder at 40 per cent, Class 4.

Table with columns: NAME OF OWNER, School District, DESCRIPTION OF PROPERTY (SUBDIVISION, Lot, Block), ASSESSOR'S VALUATIONS (True and Full Value of Lands, Structures and Improvements, Total True and Full Value of Lands), and EQUALIZED VALUATIONS (Total Assessed Value as Equalized by Board of Review, Total Assessed Value as Equalized by the County Board, Total Assessed Value as Equalized by the Department of Taxation).



Assessment of Taxable Platted Real Property in the \_\_\_\_\_ of \_\_\_\_\_, County of \_\_\_\_\_, Minn., for the Year 1942.  
 HOMESTEADS, up to True and Full Value of \$4,000.00, Assessable at 25 per cent, Class 3C, Remainder at 40 per cent, Class 4.

NAME OF OWNER	School District	SUBDIVISION	Lot	Block	Indicate Homestead	ASSESSOR'S VALUATIONS						EQUALIZED VALUATIONS						
						True and Full Value of Land Exclusive of Structures and Improvements Dollars	True and Full Value of Buildings and other Structures Dollars	True and Full Value of Machinery Permanently Attached to Real Estate Dollars	Total True and Full Value of Land, Including all Structures, Improvements and Machinery Dollars	Assessed Value of Homesteads up to \$4,000 at 25 per cent Class 3C Dollars	Assessed Value of Remainder at 40 per cent Class 4 Dollars	Total Assessed Value of Land Including all Structures, Improvements and Machinery Dollars	Total Assessed Value as Equalized by Board of Review Dollars	Total Assessed Value as Equalized by the County Board Dollars	Total Assessed Value as Equalized by the Department of Taxation Dollars			
U. S. of America	5	Wa-ha-ra-re-Bay	24															
U. S. of America			27															
U. S. of America			23															
U. S. of America			26															
U. S. of America			25															
U. S. of America			26															

Assessment of Taxable Platted Real Property in the \_\_\_\_\_ of \_\_\_\_\_, County of \_\_\_\_\_, Minn., for the Year 1942.  
 HOMESTEADS, up to True and Full Value of \$4,000.00, Assessable at 25 per cent, Class 3C, Remainder at 40 per cent, Class 4.

NAME OF OWNER	School District	SUBDIVISION	Lot	Block	Indicate Homestead	ASSESSOR'S VALUATIONS						EQUALIZED VALUATIONS						
						True and Full Value of Land Exclusive of Structures and Improvements Dollars	True and Full Value of Buildings and other Structures Dollars	True and Full Value of Machinery Permanently Attached to Real Estate Dollars	Total True and Full Value of Land, Including all Structures, Improvements and Machinery Dollars	Assessed Value of Homesteads up to \$4,000 at 25 per cent Class 3C Dollars	Assessed Value of Remainder at 40 per cent Class 4 Dollars	Total Assessed Value of Land Including all Structures, Improvements and Machinery Dollars	Total Assessed Value as Equalized by Board of Review Dollars	Total Assessed Value as Equalized by the County Board Dollars	Total Assessed Value as Equalized by the Department of Taxation Dollars			
Lathé Burns	5	Sunrise Heights	1			50			50			20	20					
"			2			50			50			20	20					
"			3			50			50			20	20					
"			4			50			50			20	20					
"			5			50			50			20	20					
"			6			50			50			20	20					
Fred Fisher			7			50			50			20	20					
"			8			50			50			20	20					
"			9			50			50			20	20					
"			10			50			50			20	20					
"			11			50			50			20	20					
"			12			50			50			20	20					
Victor Muller			13			50			50			20	20					
Fred Fisher			14			50			50			20	20					
"			15			50			50			20	20					
"			16			50			50			20	20					
Hilding Johnson			17		✓	50			48	12		12	12					
"			18		✓	50			52	13		13	13					
Hilding A. & Jeanette Johnson			19		✓	52	300		352	88		88	88					
"			20		✓	48			48	12	20	12	12					
						1000	300		1300	125	320	445	445					



Assessment of Taxable Platted Real Property in the \_\_\_\_\_ of \_\_\_\_\_ County of \_\_\_\_\_ Minn., for the Year 1942.  
 HOMESTEADS, up to True and Full Value of \$4,000.00, Assessable at 25 per cent, Class 3C, Remainder at 40 per cent, Class 4.

NAME OF OWNER	School District	DESCRIPTION OF PROPERTY	Indicate Homestead	ASSESSOR'S VALUATIONS					EQUALIZED VALUATIONS			
				True and Full Value of Land, Structures and Improvements Dollars	True and Full Value of Structures and Improvements Dollars	True and Full Value of Machinery Permanently Attached to Real Estate Dollars	Total True and Full Value of Land, Structures, Improvements and Machinery Dollars	Assessed Value of Homestead up to \$4,000 at 25 per cent Class 3C Dollars	Assessed Value of Remainder at 40 per cent Class 4 Dollars	Total Assessed Value including all Structures, Improvements and Machinery Dollars	Total Assessed Value as Equalized by Board of Review Dollars	Total Assessed Value as Equalized by the Department of Taxation Dollars
William Leikentery		CHARITON BEACH Lot 3-334-141-31										
		That part of Lot 13 lying North of South line of Twp. 141, R. 31			10		10	4	4			
		That part of Lot 14 lying North of South line of Twp. 141 R. 31			15		15	6	6			
		That part of Lot 15 lying North of South line of Twp. 141 R. 31			20		20	18	8			
		That part of Lot 16 lying North of South line of Twp. 141 R. 31			25		25	10	10			
		17			50		50	20	20			
		18			50		50	20	20			
		21			50		50	20	20			
		20			50		50	20	20			
		24			50		50	20	20			
		22			50		50	20	20			
		23			50		50	20	20			
		24			50		50	20	20			
	25			50		50	20	20				
	Outlet A			20		20	8	8				
	" B			20		20	8	8				
				560		560	224	224				

Assessment of Taxable Platted Real Property in the \_\_\_\_\_ of \_\_\_\_\_ County of \_\_\_\_\_ Minn., for the Year 1942.  
 up to True and Full Value of \$4,000.00, Assessable at 25 per cent, Class 3C, Remainder at 40 per cent, Class 4.

NAME OF OWNER	School District	DESCRIPTION OF PROPERTY	Indicate Homestead	ASSESSOR'S VALUATIONS					EQUALIZED VALUATIONS			
				True and Full Value of Land, Structures and Improvements Dollars	True and Full Value of Structures and Improvements Dollars	True and Full Value of Machinery Permanently Attached to Real Estate Dollars	Total True and Full Value of Land, Structures, Improvements and Machinery Dollars	Assessed Value of Homestead up to \$4,000 at 25 per cent Class 3C Dollars	Assessed Value of Remainder at 40 per cent Class 4 Dollars	Total Assessed Value including all Structures, Improvements and Machinery Dollars	Total Assessed Value as Equalized by Board of Review Dollars	Total Assessed Value as Equalized by the Department of Taxation Dollars
		Shingobee Township Hiram Township										
		LOT 13-14-15-16 CHARITON BEACH										

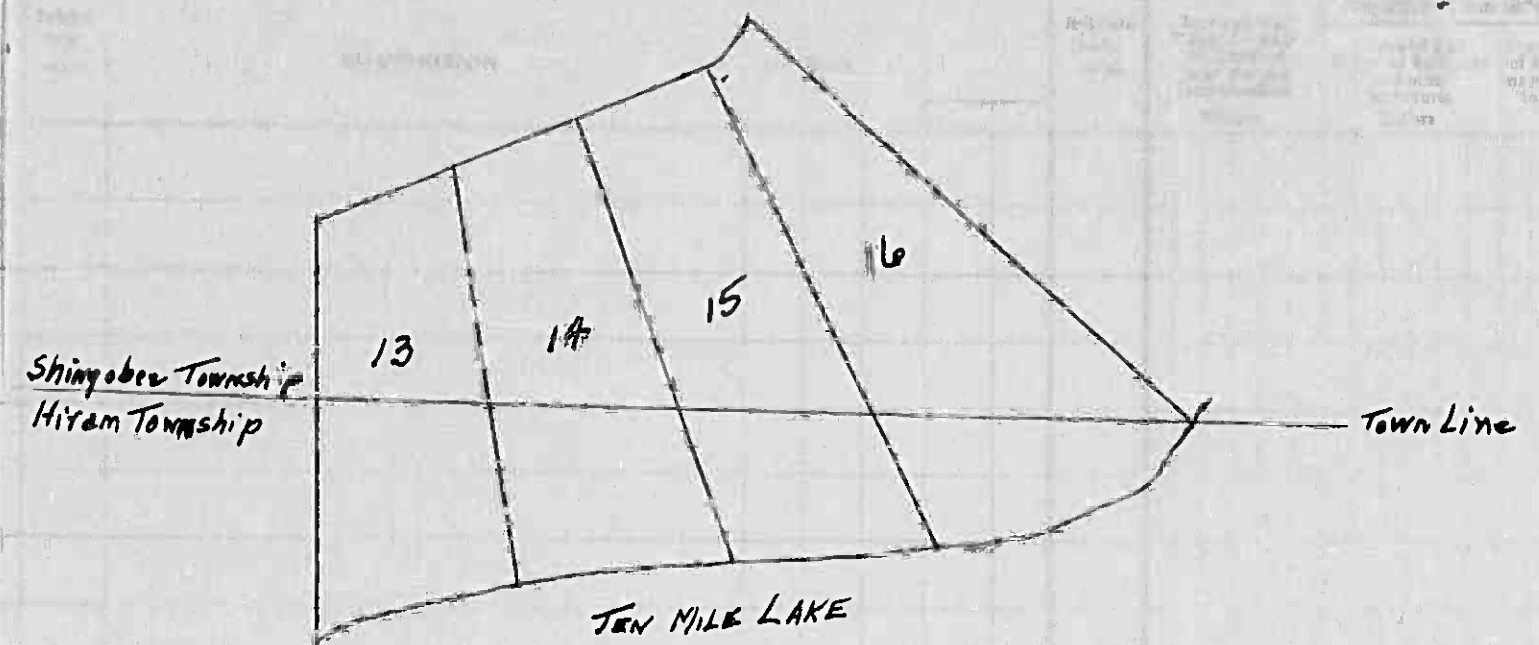



















Number of Acres of Land Assessed	ASSESSOR'S VALUATIONS							EQUALIZED VALUATIONS			REMARKS
	True and Full Value of Lands Exclusive of Structures and Improvements Dollars	STRUCTURES AND IMPROVEMENTS True and Full Value of Buildings and other Structures Dollars	True and Full Value of Machinery Permanently Attached to Real Estate Dollars	Total True and Full Value of Lands Including All Structures, Improvements and Machinery Dollars	Assessed Value of Homesteads up to \$4,000 at 25 per cent Class 3C Dollars	Assessed Value of Remainder at 40 per cent Class 4 Dollars	Total Assessed Value of Lands Including All Structures, Improvements and Machinery Dollars	Total Assessed Value as Equalized by the Board of Review Dollars	Total Assessed Value as Equalized by the County Board Dollars	Total Assessed Value as Equalized by the Department of Taxation Dollars	

Footings Brought Forward from Page

21  
 1.5148 30324 1222 46694 6246 8684 14930  
 560 560 224 224

15708 30324 1222 47254 6246 8908 15154

✓  
 15708  
 15708

Number of Acres of Land Assessed	ASSESSOR'S VALUATIONS							EQUALIZED VALUATIONS			REMARKS
	True and Full Value of Lands Exclusive of Structures and Improvements Dollars	STRUCTURES AND IMPROVEMENTS True and Full Value of Buildings and other Structures Dollars	True and Full Value of Machinery Permanently Attached to Real Estate Dollars	Total True and Full Value of Lands Including All Structures, Improvements and Machinery Dollars	Assessed Value of Homesteads up to \$4,000 at 25 per cent Class 3C Dollars	Assessed Value of Remainder at 40 per cent Class 4 Dollars	Total Assessed Value of Lands Including All Structures, Improvements and Machinery Dollars	Total Assessed Value as Equalized by the Board of Review Dollars	Total Assessed Value as Equalized by the County Board Dollars	Total Assessed Value as Equalized by the Department of Taxation Dollars	

Footings Brought Forward from Page

21  
 1.5148 30324 1222 46694 6246 8684 14930  
 560 560 224 224