

Assessment & Tax List - 1963
Salem

DIRECTIONS TO ASSESSOR

OFFICE OF COUNTY AUDITOR, 1963.

To Assessor of the County, Minn.

According to the requirements of law, I herewith deliver to you the Assessment Books for the year 1963, for the year 1963, as the same has come to my knowledge from any source, and I hereby direct you to assess such Real Estate and all Personal Property, and make such changes in Real Estate as are required in the odd-numbered year, and make return thereof as required by the laws of Minnesota prescribing the duties of the assessor.

A form of the return to be signed by you is appended in this book.

County Auditor.

Extracts from Laws Relating to the Listing of Personal Property

Section Numbers refer to Minnesota Statutes

Sec. 272.01. PROPERTY SUBJECT TO TAXATION. All real and personal property in this state, and all personal property of persons residing therein, . . . is taxable, except such as is by law exempt from taxation.

WHEN LISTED AND ASSESSED

Sec. 272.01. . . . Personal Property shall be listed and assessed annually on its value on May 1, and if acquired on that day, shall be listed by or for the persons acquiring it.

Sec. 273.22. By whom listed. Personal Property shall be listed in the manner following: 1. The property of a full age and sound mind, being a resident of this state, shall be listed by the owner.

Sec. 273.26. Where listed. Except as otherwise in this chapter provided, the assessment shall be made in the county, town, or district where the owner, agent or trustee resides.

Sec. 273.27. Certain personal property; where listed. All household machinery, excepting upward of one piece of household machinery, owned by the owner for personal and domestic purposes, or for the farming business, shall be listed and assessed in the district where the same is usually kept.

Sec. 273.29. Merchants and manufacturers. The personal property of a merchant or manufacturer shall be listed in the town or district where his business is carried on.

Sec. 273.30. Farm property of non-resident. When the owner of a farm is a non-resident, the assessment shall be made in the county, town, or district where the farm is situated.

Sec. 273.32. Gas and Water Companies. The personal property of a gas or water company shall be listed in the county, town, or district where the same is usually kept.

Sec. 273.33. Electric, Light and Power Companies. The personal property of an electric, light and power company shall be listed in the county, town, or district where the same is usually kept.

Sec. 273.34. Electric, Light and Power Companies. The personal property of an electric, light and power company shall be listed in the county, town, or district where the same is usually kept.

Sec. 273.35. Gas and Water Companies. The personal property of a gas or water company shall be listed in the county, town, or district where the same is usually kept.

Sec. 273.36. Electric, Light and Power Companies. The personal property of an electric, light and power company shall be listed in the county, town, or district where the same is usually kept.

Sec. 273.37. Electric, Light and Power Companies. The personal property of an electric, light and power company shall be listed in the county, town, or district where the same is usually kept.

Sec. 273.38. Merchants and Manufacturers. The personal property of a merchant or manufacturer shall be listed in the county, town, or district where the same is usually kept.

Sec. 273.39. Gas and Water Companies. The personal property of a gas or water company shall be listed in the county, town, or district where the same is usually kept.

Sec. 273.40. Electric, Light and Power Companies. The personal property of an electric, light and power company shall be listed in the county, town, or district where the same is usually kept.

Sec. 273.41. Electric, Light and Power Companies. The personal property of an electric, light and power company shall be listed in the county, town, or district where the same is usually kept.

Sec. 273.42. Property removed from one county, town, or district to another. The assessor shall be notified of any such removal, and he shall assess the property in the county, town, or district to which it is removed.

Sec. 273.43. Property removed from one county, town, or district to another. The assessor shall be notified of any such removal, and he shall assess the property in the county, town, or district to which it is removed.

Sec. 273.44. Estates of decedents. The personal property of a decedent shall be listed and assessed in the county, town, or district where the decedent resided at the time of his death.

Sec. 273.45. Persons under Guardianship. The personal property of a minor under guardianship shall be listed and assessed in the county, town, or district where the guardian resides.

Sec. 273.46. Assignees and receivers. Personal property in the hands of an assignee or receiver shall be listed and assessed in the county, town, or district where the assignor or grantor resided.

Sec. 273.47. Property removed from one county, town, or district to another. The assessor shall be notified of any such removal, and he shall assess the property in the county, town, or district to which it is removed.

Sec. 273.48. Property removed from one county, town, or district to another. The assessor shall be notified of any such removal, and he shall assess the property in the county, town, or district to which it is removed.

Sec. 273.49. Property removed from one county, town, or district to another. The assessor shall be notified of any such removal, and he shall assess the property in the county, town, or district to which it is removed.

Sec. 273.50. Property removed from one county, town, or district to another. The assessor shall be notified of any such removal, and he shall assess the property in the county, town, or district to which it is removed.

Sec. 273.51. Property removed from one county, town, or district to another. The assessor shall be notified of any such removal, and he shall assess the property in the county, town, or district to which it is removed.

Sec. 273.52. Property removed from one county, town, or district to another. The assessor shall be notified of any such removal, and he shall assess the property in the county, town, or district to which it is removed.

Sec. 273.53. Property removed from one county, town, or district to another. The assessor shall be notified of any such removal, and he shall assess the property in the county, town, or district to which it is removed.

Sec. 273.54. Property removed from one county, town, or district to another. The assessor shall be notified of any such removal, and he shall assess the property in the county, town, or district to which it is removed.

Sec. 273.55. Property removed from one county, town, or district to another. The assessor shall be notified of any such removal, and he shall assess the property in the county, town, or district to which it is removed.

Sec. 273.56. Property removed from one county, town, or district to another. The assessor shall be notified of any such removal, and he shall assess the property in the county, town, or district to which it is removed.

Sec. 273.57. Property removed from one county, town, or district to another. The assessor shall be notified of any such removal, and he shall assess the property in the county, town, or district to which it is removed.

Sec. 273.58. Property removed from one county, town, or district to another. The assessor shall be notified of any such removal, and he shall assess the property in the county, town, or district to which it is removed.

Sec. 273.59. Property removed from one county, town, or district to another. The assessor shall be notified of any such removal, and he shall assess the property in the county, town, or district to which it is removed.

Sec. 273.60. Property removed from one county, town, or district to another. The assessor shall be notified of any such removal, and he shall assess the property in the county, town, or district to which it is removed.

The forms in this book are prescribed for the 1963 assessment by The Commissioner of Taxation

Minnesota Statutes, Section 270.07. The commissioner of taxation shall prescribe the form of all blanks and books required under this chapter . . .

Minnesota Statutes, Section 273.03. The county auditor shall annually provide the necessary assessment books and blanks at the expense of the county, for and to correspond with each taxation district. He shall make out, in the real property assessment book, complete lists of all lands or lots subject to assessment, showing the names of the owners, if to him known; and, if unknown, so stated opposite each tract or lot, the number of acres, and the lots or parts of lots or blocks included in each description of property. . . .

Minnesota Statutes, Section 273.04. The assessors and at least one member of each local board of review shall meet at the office of the county auditor on a day to be fixed by the commissioner of taxation for the purpose of receiving instructions as to their duties under the laws of the state. Each assessor attending such meetings shall receive as compensation for such service the sum of \$7.50 per day for each day necessarily consumed in attending such meeting, and mileage at the rate of seven cents per mile, and each board of review member the sum of \$6.00 per day and mileage at the rate of five cents per mile for each mile necessarily traveled in going from his home to and returning from the county seat, to be computed by the usually traveled route, and paid out of the county treasury upon the warrant of the county auditor.

Assessment of

COLLECTIONS OF TAXES OF 196

OF

CASS COUNTY, MINNESOTA

Form 34

NAME OF OWNER

1

2

3

4

5

6

7

8

FUNDS	MARCH SETTLEMENT 1964	JUNE SETTLEMENT 1964	NOV. SETTLEMENT 1964	Amount Collected from Nov. 1964 to First Monday in Jan. 1965	REDUCTIONS	Total Reductions and Collected	BALANCE UNCOLLECTED	ADDITIONS	Total Uncollected to First Monday in January, 1965
State—Non-Homestead,	17 92	9 90	10 94	62					
State—Homestead,	16 62	24 74	20 33	84					
County Revenue,	63 92	95 65	77 95	3 24					
County Road and Bridge,	40 57	60 71	49 48	2 05					
County Welfare,	120 72	180 65	147 22	6 11					
County Bond and Interest,	3 89	5 83	4 75	2 0					
<i>ex muree</i>	1 79	2 67	2 18	0 9					
<i>R.E.R.A.</i>	10 49	15 69	12 79	5 3					
<i>ccv Ref.</i>	3 7	5 5	4 5	0 2					
Town Revenue,	20 29	30 36	24 74	1 03					
Town Road and Bridge,	10 56	15 77	12 86	5 3					
Town State Loan,									
School Local 1 Mill,									
School Special,	80 32	67 44	68 66	2 06					
School State Loan,									
Deficiency	146 13	218 68	178 20	7 40					
Tuition									
Transportation									
<i>E W Berg</i>	4 06	6 07	4 95	2 1					
<i>Ague Ass</i>	97	1 46	1 17	0 5					
<i>Transp</i>	2 39	3 58	2 92	1 2					
	540 91	739 75	619 61	25 10					

	SCHOOL DISTRICT NO.	LOCAL 1 MILL	SPECIAL	STATE LOAN	Deficiency	TOTALS
MARCH SETTLEMENT	School District No.					
	<i>Un a</i>		85		303	388
	<i>Un na</i>		79 47		143 10	222 57
	Totals		80 32		146 13	226 45
JUNE SETTLEMENT	School District No.					
	<i>Un a</i>		54 00		194 48	248 48
	<i>Un na</i>		13 44		24 20	37 64
	Totals		67 44		218 68	286 12
NOVEMBER SETTLEMENT	School District No.					
	<i>Un a</i>		30 30		109 12	139 42
	<i>Un na</i>		38 36		69 08	107 44
	Totals		68 66		178 20	246 86
NOVEMBER to JANUARY	School District No.					
	<i>Un a</i>		2 06		7 40	9 46
	<i>Un na</i>					
	Totals					9 46
ADDITIONS	School District No.					
	Totals					
REDUCTIONS	School District No.					
	Totals					

Real Estate

Personal

Assessment Roll and Tax List of Real Property in the Town of Salem

Cass County, Minnesota, for Taxes for the Year 1963.

Form SCD MILLER-DAVIS CO., MINNEAPOLIS * Indicate Type of Property: R-Residential, C-Commercial, I-Industrial, U-Utility, F-Farm, L-Lakeshore, T-Timber, M-Mineral

Table with columns: IN WHOSE NAME ASSESSED, DESCRIPTION OF PROPERTY, TRUE AND FULL VALUATIONS, ASSESSED VALUATIONS, and FINAL EQUALIZED VALUE. Includes entries for U.S. of America and E.E. Menton.

Table with columns: VALUATIONS BY SCHOOL DISTRICTS AS EQUALIZED BY DEPARTMENT OF TAXATION, Tax including State Homestead, State Tax on Non-Homestead, SPECIAL TAXES, TOTAL TAXES, PAID, WHEN PAID, Number of Receipt, March Settlement, June Settlement, November Settlement, Collections to First Monday in January 1965, Delinquent on First Monday in January 1965, Total Delinquent Tax and Penalty, and REMARKS. Includes handwritten notes and dates.

143 348-28

Personal

Assessment Roll and Tax List of Real Property in the

Form 500 MILLER-DAVIS CO., MINNEAPOLIS

* Inc

DESCRIPTION OF PROPERTY

IN WHOSE NAME ASSESSED	SUBDIVISION	Sec. or Lot	Town or Block	Rng.	Number of Acres of Land	No. School District	Indicate Homestead Yes or No	Agri. Rec. Yes or No	Indicate Type of Property	No. of Acres	
										100ths	100ths
John J., Marguerite J., Thomas E. & Robert V. Phipps	N E 1/4 of N E 1/4	15	143	26	40	Un	yes	yes	T		
" " " " " "	N W 1/4 of N E 1/4				40	"	"	"	F		
W. M. + P. Ry. Co.	S W 1/4 of N E 1/4				40	"	"	"	"		
U. S. of America	S E 1/4 of N E 1/4										
Myron Jacobson	N E 1/4 of N W 1/4				40	no	yes		F		
State of Minnesota	N W 1/4 of N W 1/4										
State of Minnesota	S W 1/4 of N W 1/4										
State of Minnesota	S E 1/4 of N W 1/4										
Victor + Doris Erickson	N E 1/4 of S W 1/4				40	yes	yes		F		
" " " " " "	N W 1/4 of S W 1/4				40	"	"	"	T		
" " " " " "	S W 1/4 of S W 1/4				40	"	"	"	F		
Lloyd Woodhouse	S E 1/4 of S W 1/4 less 30d				39	no	"	"	"		
John J., Marguerite J., Thomas E. & Robert V. Phipps	N 44' of S. 132' of W. 440' of E. 473' of S E 1/4 of S W 1/4				1	yes	no		C		
U. S. of America	N E 1/4 of S E 1/4										
E. E. Menton	N W 1/4 of S E 1/4				40	yes	yes		T		
Ebenezer E. Menton	S W 1/4 of S E 1/4				40	"	"	"	"		
E. E. Menton	S E 1/4 of S E 1/4				40	"	"	"	F		

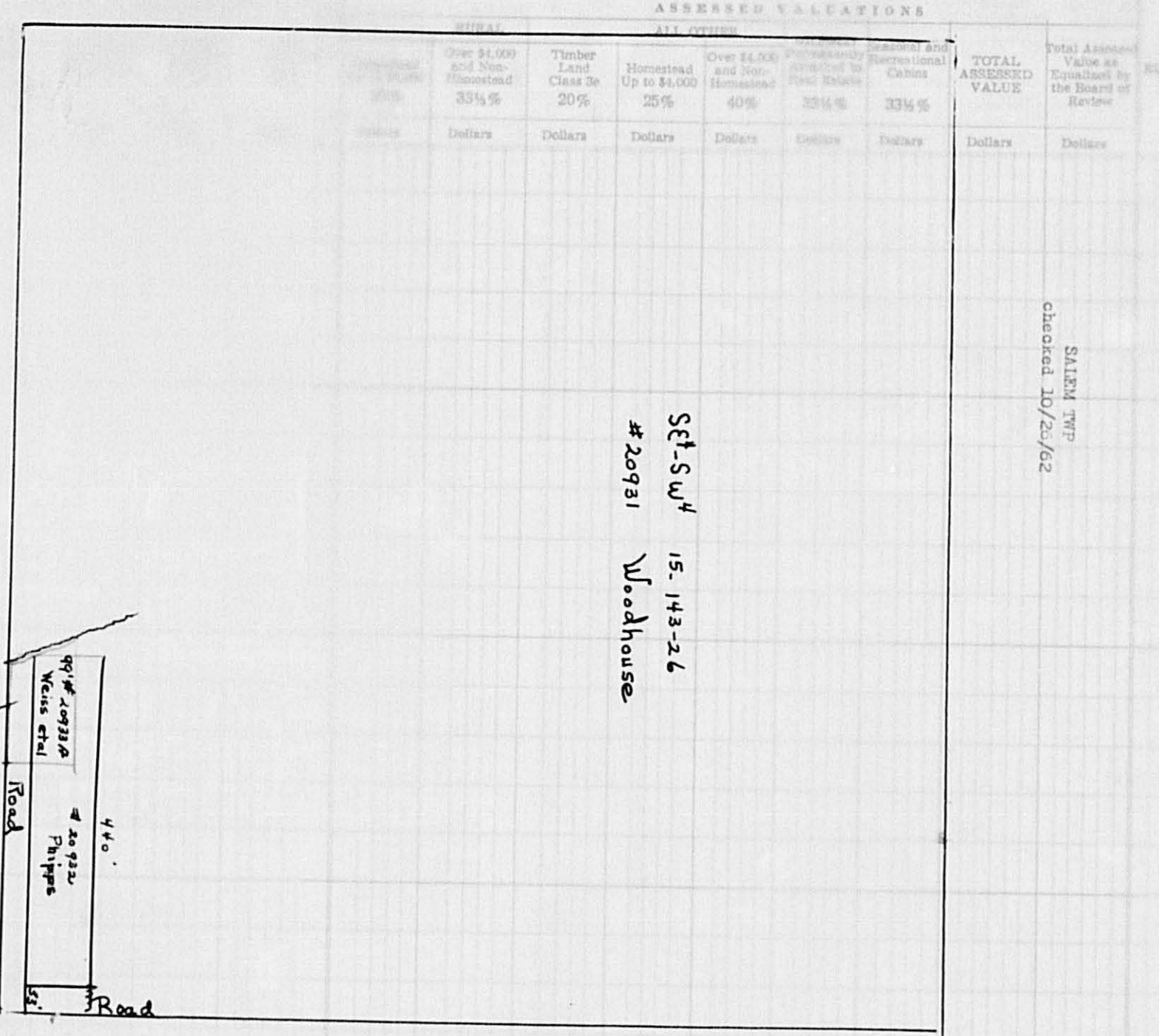

S E 1/4 SW 1/4 15-143-26 #20931 Woodhouse

SALEM TWP checked 10/20/62

Cass County, Minnesota, for Taxes for the Year 1963.

ASSESSED VALUATIONS

Over \$1,000 and Non-Homestead	Timber Land Class 2e	Homestead Up to \$4,000	Over \$4,000 and Non-Homestead	Personal Property	Recreational Cabins
33%	20%	25%	40%	33%	33%

TOTAL ASSESSED VALUE	Total Value as Equalized by the Board of Review
Dollars	Dollars

VALUATIONS BY SCHOOL DISTRICTS AS EQUALIZED BY DEPARTMENT OF TAXATION

SOLD FOR TAXES	VALUATIONS BY SCHOOL DISTRICTS AS EQUALIZED BY DEPARTMENT OF TAXATION						Tax Including State Homestead	State Tax on Non-Homestead	SPECIAL TAXES	SPECIAL TAXES	TOTAL TAXES	PAID	WHEN PAID	Number of Receipt	March Settlement 1964	June Settlement 1964	Penalty	November Settlement 1964	Penalty	Collections to First Monday in January 1965	Penalty	Delinquent on First Monday in January 1965	Total Delinquent Tax and Penalty	REMARKS	
	District No.	District No.	District No.	District No.	District No.	District No.																			
1	42						1000				1000	1	PAID IN FULL JUN 1 7 1964											pen. abated abate # 9422 8991	
2	36						858				858	2	PAID IN FULL JUN 1 7 1964											pen. abated abate # 9422 8991	
3	34						810				810	3	PAID IN FULL JUN 1 7 1964											pen. abated abate # 9422 8991	
4																									
5																									
6	55						1310	50			1360	6	2nd HALF PAID JUL 5 1964 10407 1st HALF PAID MAY 25 1964 10407		680		680							8970	
7																									
8																									
9																									
10																									
11	25						596				596	11												596 } 656 8966	
12	44						1048				1048	12	2nd HALF PAID OCT 1 6 1964 1st HALF PAID MAY 1 9 1964	18276	524		524							19107 8989	
13	61						1454				1454	13	2nd HALF PAID OCT 1 6 1964 1st HALF PAID MAY 1 9 1964	11369	727		727							" " 8971	
14	90						2144	80			2224	14	PAID IN FULL MAY 8 1964 8104		2224									8971	
15																									2376 8972
16																									
17	42						1000				1000	17	PAID IN FULL JUN 1 7 1964											pen. abated abate # 9422 8991	
18	36						858				858	18	PAID IN FULL JUN 1 7 1964											pen. abated abate # 9422 8991	
19	128						3050				3050	19	PAID IN FULL JUN 1 7 1964											pen. abated abate # 9422 8991	
20	448						1428				1428	20												8966	
	145						2376	130			16634					6531		9507						596	
	593						16504																		

440

Assessment Roll and Tax List of Real Property in the Town of Salem, Cass County, Minnesota, for Taxes for the Year 1963.

Table with columns: IN WHOSE NAME ASSESSED, DESCRIPTION OF PROPERTY, TRUE AND FULL VALEATIONS, ASSESSED VALUATIONS, and FINAL EQUALIZED VALUE. Includes handwritten entries for John J. Marguerite, W. M. + P. Ry. Co., Myron Jacobson, Victor + Doris Erickson, Lloyd Woodhouse, and E. E. Menton.

Cass County, Minnesota, for Taxes for the Year 1963.

Table with columns: VALUATIONS BY SCHOOL DISTRICTS AS EQUALIZED BY DEPARTMENT OF TAXATION, TAX INCLUDING STATE HOMESTEAD, SPECIAL TAXES, TOTAL TAXES, PAID, WHEN PAID, and REMARKS. Includes handwritten entries for tax payments and remarks such as 'pen. abated' and 'date # 9422'.

Assessment Roll and Tax List of Real Property in the Town of Salem

Cass County, Minnesota, for Taxes for the Year 1963.

Form SCD - MILLER-DAVIS CO., MINNEAPOLIS

* Indicate Type of Property: R-Residential, C-Commercial, I-Industrial, U-Utility, F-Farm, L-Lakeshore, T-Timber, M-Mineral

Main table with columns: IN WHOSE NAME ASSESSED, DESCRIPTION OF PROPERTY, TRUE AND FULL VALUATIONS, ASSESSED VALUATIONS, VALUATIONS BY SCHOOL DISTRICTS AS EQUALIZED BY DEPARTMENT OF TAXATION, TAXES, PAID, WHEN PAID, etc.

IN WHOSE NAME ASSESSED

DESCRIPTION OF PROPERTY

TRUE AND FULL VALUATIONS

ASSESSED VALUATIONS

VALUATIONS BY SCHOOL DISTRICTS AS EQUALIZED BY DEPARTMENT OF TAXATION

State of Minnesota

GOVT LOT 1

16 143 26

Un

State of Minnesota

N W 1/4 of N E 1/4

GOVT LOT 2

State of Minnesota

S W 1/4 of N E 1/4

State of Minnesota

N E 1/4 of N W 1/4

GOVT LOT 3

State of Minnesota

N W 1/4 of N W 1/4

Dept. of Conservation

S W 1/4 of N W 1/4

State of Minnesota

S E 1/4 of N W 1/4

State of Minnesota

N E 1/4 of S W 1/4

State of Minnesota

N W 1/4 of S W 1/4

Albert Hare

S W 1/4 of S W 1/4

40

yes yes F

State of Minnesota

S E 1/4 of S W 1/4

Victor + Doie Erickson

N E 1/4 of S E 1/4

40

yes yes T

State of Minnesota

N W 1/4 of S E 1/4

A. L. Coleman

S W 1/4 of S E 1/4

40

yes yes F

Victor + Doie Erickson

S E 1/4 of S E 1/4

40

" " T

160

SOLD FOR TAXES

District No. Rate

District No. Rate

District No. Rate

District No. Rate

District No. Rate

District No. Rate

District No. Rate

District No. Rate

District No. Rate

District No. Rate

District No. Rate

District No. Rate

District No. Rate

District No. Rate

District No. Rate

District No. Rate

District No. Rate

District No. Rate

District No. Rate

District No. Rate

District No. Rate

District No. Rate

District No. Rate

District No. Rate

District No. Rate

District No. Rate

District No. Rate

District No. Rate

District No. Rate

District No. Rate

District No. Rate

District No. Rate

District No. Rate

District No. Rate

District No. Rate

District No. Rate

District No. Rate

District No. Rate

District No. Rate

District No. Rate

District No. Rate

District No. Rate

District No. Rate

Tax including State Homestead

State Tax on Non-Homestead

SPECIAL TAXES

SPECIAL TAXES

TOTAL TAXES

PAID

WHEN PAID

Number of Receipt

March Settlement 1964

June Settlement 1964

Penalty

November Settlement 1964

Penalty

Collections to First Monday in January 1965

Penalty

Delinquent on First Monday in January 1965

Total Delinquent Tax and Penalty

REMARKS

Month Day Year

\$ cts.

\$ cts.

\$ cts.

\$ cts.

\$ cts.

\$ cts.

\$ cts.

\$ cts.

\$ cts.

\$ cts.

\$ cts.

\$ cts.

\$ cts.

\$ cts.

\$ cts.

\$ cts.

\$ cts.

\$ cts.

\$ cts.

\$ cts.

\$ cts.

\$ cts.

\$ cts.

\$ cts.

Personal

Assessment Roll and Tax List of Real Property in the Town of Salem

Form 300 - MILLER-DAVIS CO., MINNEAPOLIS

* Indicate Type of Property: R-Residential, C-Commercial, I-Industrial, U-Utility, F-Farm, L-Lakeshore, T-Timber, M-Mineral

Cass County, Minnesota, for Taxes for the Year 1963.

Table with columns: IN WHOSE NAME ASSESSED, SUBDIVISION, Description of Property, TRUE AND FULL VALUATIONS, ASSESSED VALUATIONS (RURAL, ALL OTHER, MACHINERY, etc.), FINAL EQUALIZED VALUE.

Table with columns: VALUATIONS BY SCHOOL DISTRICTS AS EQUALIZED BY DEPARTMENT OF TAXATION, Tax including State Homestead, State Tax on Non-Homestead, SPECIAL TAXES, TOTAL TAXES, PAID, WHEN PAID, Number of Receipt, March Settlement, June Settlement, November Settlement, Collections to First Monday in January, Delinquent on First Monday in January, Total Delinquent Tax and Penalty, REMARKS.

Assessment Roll and Tax List of Real Property in the Town of Salem

* Indicate Type of Property: R-Residential, C-Commercial, I-Industrial, U-Utility, F-Farm, L-Lakeshore, T-Timber, M-Mineral

Form SCD - MILLER-DAVIS CO., MINNEAPOLIS

Table with columns: IN WHOSE NAME ASSESSED, SUBDIVISION, Sec. or Lot, Town or Block, Ring, Number of Acres of Land, No. School District, Indicate Homestead, Indicate Sea, Indicate Recreational, Indicate Type of Property, TRUE AND FULL VALUATIONS, ASSESSED VALUATIONS, FINAL EQUALIZED VALUE.

Cass County, Minnesota, for Taxes for the Year 1963.

Table with columns: SOLD FOR TAXES, VALUATIONS BY SCHOOL DISTRICTS AS EQUALIZED BY DEPARTMENT OF TAXATION, Tax including State Homestead, State Tax on Non-Homestead, SPECIAL TAXES, TOTAL TAXES, PAID, WHEN PAID, Number of Receipt, March Settlement, June Settlement, November Settlement, Collections to First Monday in January, Delinquent on First Monday in January, Total Delinquent Tax and Penalty, REMARKS.

Assessment Roll and Tax List of Real Property in the Town of Salem

* Indicate Type of Property: R-Residential, C-Commercial, I-Industrial, U-Utility, F-Farm, L-Lakeshore, T-Timber, M-Mineral

Form 500 MILLER-DAVIS CO., MINNEAPOLIS

Table with columns: IN WHOSE NAME ASSESSED, DESCRIPTION OF PROPERTY, TRUE AND FULL VALUATIONS, ASSESSED VALUATIONS, and FINAL EQUALIZED VALUE. Includes entries for E.E. Menton, Hazel Menton, Everett L. + Marie Estelle Mann, Elizabeth + Eva Helland, Victor + Doris Erickson, and U.S. of America.

239

Cass County, Minnesota, for Taxes for the Year 1963.

Table with columns: VALUATIONS BY SCHOOL DISTRICTS AS EQUALIZED BY DEPARTMENT OF TAXATION, TAXES, PAID, WHEN PAID, and REMARKS. Includes entries for SOLD FOR TAXES and various payment dates like JUN 17 1964 and JAN 20 1964.

H 192
42
234

5574 38

5612

1038 1513 3061

Assessment Roll and Tax List of Real Property in the Town of Salem

Form SCD MILLER-DAVIS CO., MINNEAPOLIS

* Indicate Type of Property: R-Residential, C-Commercial, I-Industrial, U-Utility, F-Farm, L-Lakeshore, T-Timber, M-Mineral

Table with columns: IN WHOSE NAME ASSESSED, SUBDIVISION, Sec. or Lot, Town or Block, No. of Acres, TRUE AND FULL VALUATIONS, ASSESSED VALUATIONS, and FINAL EQUALIZED VALUE.

80

Cass County, Minnesota, for Taxes for the Year 1963.

Table with columns: VALUATIONS BY SCHOOL DISTRICTS AS EQUALIZED BY DEPARTMENT OF TAXATION, TAX INCLUDING STATE HOMESTEAD, SPECIAL TAXES, TOTAL TAXES, PAID, WHEN PAID, Number of Receipt, March Settlement, June Settlement, November Settlement, Collections to First Monday in January 1965, Delinquent on First Monday in January 1965, Total Delinquent Tax and Penalty, REMARKS.

H 130

3096

3096

1548

1548

Personal

Assessment Roll and Tax List of Real Property in the Town of Salem, Minnesota

Form SCD MILLER-DAVIS CO., MINNEAPOLIS

* Indicate Type of Property: R-Residential, C-Commercial, I-Industrial, U-Utility, F-Farm, L-Lakeshore, T-Timber, M-Mineral

Cass County, Minnesota, for Taxes for the Year 1963.

Table with columns for IN WHOSE NAME ASSESSED, DESCRIPTION OF PROPERTY, TRUE AND FULL VALUATIONS, ASSESSED VALUATIONS, VALUATIONS BY SCHOOL DISTRICTS AS EQUALIZED BY DEPARTMENT OF TAXATION, and REMARKS. Includes rows for U.S. of America and various subdivisions.

Assessment Roll and Tax List of Real Property in the Town of Salem, Cass County, Minnesota, for Taxes for the Year 1963.

Form 500 - MILLER-DAVIS CO., MINNEAPOLIS

* Indicate Type of Property: R-Residential, C-Commercial, I-Industrial, U-Utility, F-Farm, L-Lakeshore, T-Timber, M-Mineral

Cass County, Minnesota, for Taxes for the Year 1963.

Table with columns: IN WHOSE NAME ASSESSED, DESCRIPTION OF PROPERTY, TRUE AND FULL VALUATIONS, ASSESSED VALUATIONS, VALUATIONS BY SCHOOL DISTRICTS AS EQUALIZED BY DEPARTMENT OF TAXATION, SOLD FOR TAXES, PAID, WHEN PAID, Number of Receipt, March Settlement 1964, June Settlement 1964, Penalty, November Settlement 1964, Penalty, Collections to First Monday in January 1965, Penalty, Delinquent on First Monday in January 1965, Total Delinquent Tax and Penalty, REMARKS.

Assessment Roll and Tax List of Real Property in the Town of Salem

Form SCD MILLER-DAVIS CO., MINNEAPOLIS

* Indicate Type of Property: R-Residential, C-Commercial, I-Industrial, U-Utility, F-Farm, L-Lakeshore, T-Timber, M-Mineral

Cass County, Minnesota, for Taxes for the Year 1963.

Table with columns for Property Description, Valuations (True and Full, Assessed), School Districts, and Taxes. Includes entries for U.S. of America, State of Minnesota, and various individuals like Wm. E. Houchins and Lena Daniels.

Assessment Roll and Tax List of Real Property in the Town of Salem

Form 5CD MILLER-DAVIS CO., MINNEAPOLIS

* Indicate Type of Property: R-Residential, C-Commercial, I-Industrial, U-Utility, F-Farm, L-Lakeshore, T-Timber, M-Mineral

Cass County, Minnesota, for Taxes for the Year 1963.

Table with columns: IN WHOSE NAME ASSESSED, DESCRIPTION OF PROPERTY, TRUE AND FULL VALUATIONS, ASSESSED VALUATIONS, VALUATIONS BY SCHOOL DISTRICTS AS EQUALIZED BY DEPARTMENT OF TAXATION, TAX, PAID, WHEN PAID, Number of Receipt, March Settlement 1964, June Settlement 1964, November Settlement 1964, Penalty, Collections to First Monday in January 1965, Delinquent on First Monday in January 1965, Total Delinquent Tax and Penalty, REMARKS.

Albert P. & Grace M. Daniels

U. S. of America

U. S. of America

Albert Paul Daniels

Paul Daniels

U. S. of America

U. S. of America

U. S. of America

U. S. of America

State of Minnesota

U. S. of America

Eugene & Alda Godfrey

State of Minnesota (cont. to Howard Dick)

U. S. of America

U. S. of America

U. S. of America

U. S. of America

U. S. of America

U. S. of America

Personal

Assessment Roll and Tax List of Real Property in the Town of Salem

Form 500 - MILLER-DAVIS CO., MINNEAPOLIS

* Indicate Type of Property: R-Residential, C-Commercial, I-Industrial, U-Utility, F-Farm, L-Lakeshore, T-Timber, M-Mineral

Cass County, Minnesota, for Taxes for the Year 1963.

Table with columns for Description of Property, True and Full Valuations, Assessed Valuations, Valuations by School Districts, and Tax Information. Includes handwritten entries for property owners like Edith A. + Geo. Eugene Brown and Cassie Johnston, and tax payment dates like PAID IN FULL OCT 29 1964.

9000
8986

Assessment Roll and Tax List of Real Property in the Town of Salem

Form 500 MILLER-DAVIS CO., MINNEAPOLIS

* Indicate Type of Property: R-Residential, C-Commercial, I-Industrial, U-Utility, F-Farm, L-Lakeshore, T-Timber, M-Mineral

Table with columns: IN WHOSE NAME ASSESSED, DESCRIPTION OF PROPERTY, TRUE AND FULL VALUATIONS, ASSESSED VALUATIONS (RURAL, ALL OTHER, MACHINERY, Seasonal and Recreational Cabins, TOTAL ASSESSED VALUE), Total Assessed Value as Equalized by the Board of Review, FINAL EQUALIZED VALUE.

U. S. of America
Leroy + Gladys Brown
U. S. of America
U. S. of America
Mary Brown Sterns
Rose + Eleanor Rose Wind
U. S. of America
Myron Jacobson
U. S. of America
U. S. of America
U. S. of America
Myron Jacobson
U. S. of America
U. S. of America
U. S. of America
U. S. of America
U. S. of America
U. S. of America
U. S. of America

140 00

Cass County, Minnesota, for Taxes for the Year 1963.

Table with columns: SOLD FOR TAXES, VALUATIONS BY SCHOOL DISTRICTS AS EQUALIZED BY DEPARTMENT OF TAXATION, Tax Including State Homestead, State Tax on Non-Homestead, SPECIAL TAXES, TOTAL TAXES, PAID, WHEN PAID, Number of Receipt, March Settlement 1964, June Settlement 1964, Penalty, November Settlement 1964, Penalty, Collections to First Monday in January 1965, Penalty, Delinquent on First Monday in January 1965, Total Delinquent Tax and Penalty, REMARKS.

1
2
3
4
5 SOLD FOR TAXES
6 SOLD FOR TAXES
7
8
9
10
11
12
13
14
15
16
17
18
19
20
H 303
11
314
7482 10
7492
3991 2633
868

Assessment Roll and Tax List of Real Property in the Town of Salem

Form SCD MILLER-DAVIS CO., MINNEAPOLIS

* Indicate Type of Property: R-Residential, C-Commercial, I-Industrial, U-Utility, F-Farm, L-Lakeshore, T-Timber, M-Mineral

Table with columns: IN WHOSE NAME ASSESSED, DESCRIPTION OF PROPERTY, TRUE AND FULL VALUATIONS, ASSESSED VALUATIONS, FINAL EQUALIZED VALUE. Includes entries for U.S. of America, Robert W. + Helen B. Magnuson, Frank Ylinen, Donald M. + Dorothy A. Jacobson, J. H. Nygren, State of Minnesota, and Donald M. + Dorothy A. Jacobson.

Cass County, Minnesota, for Taxes for the Year 1963.

Table with columns: SOLD FOR TAXES, VALUATIONS BY SCHOOL DISTRICTS AS EQUALIZED BY DEPARTMENT OF TAXATION, Tax Including State Homestead, SPECIAL TAXES, TOTAL TAXES, PAID, WHEN PAID, Number of Receipt, March Settlement, June Settlement, November Settlement, Penalty, Collections to First Monday in January 1965, Delinquent on First Monday in January 1965, Total Delinquent Tax and Penalty, REMARKS. Includes entries for 1 through 20 with handwritten tax amounts and payment dates.

