

Assessment & Tax List - 1961

Rogers

Assessment Roll and Tax List of Real Property in the town of Pogon, Minnesota
* Indicate Type of Property: R-Residential, C-Commercial, I-Industrial, U-Utility, F-Farm, L-Lakeshore, T-Timber, M-Mineral

Form SCD MILLER-PAXIS CO., MINNAPOLIS

IN WHOSE NAME ASSESSED	DESCRIPTION OF PROPERTY				No. School District	Indicate Homestead Yes or No	Agri. or Hort. Yes or No	Indicate Type of Property	TRUE AND FULL VALUATIONS				ASSESSED VALUATIONS							FINAL EQUALIZED VALUE				
	SUBDIVISION	Sec. of Lot	Town of Block	Prop. No.					Number of Acres of Land	LAND Exclusive of Structures and Improvements	BUILDINGS and Other Structures	MACHINERY Permanently Attached to Real Estate	TOTAL True and Full Value	RURAL			ALL OTHER				MACHINERY Permanently Attached to Real Estate	Seasonal and Recreational Cabins	TOTAL ASSESSED VALUE	Total Assessed Value as Equalized by the Board of Review
														Acres	100ths	Homestead Up to \$4,000 20%	Over \$4,000 and Non-Homestead 33 1/3%	Timber Land Class 3c 20%	Homestead Up to \$4,000 25%					
Norothy Mullett	GOVT LOT 1	19	14227	60	Wk	NO	NO	L																
	NW 1/4 of NW 1/4																							
	SW 1/4 of NW 1/4																							
	SE 1/4 of NW 1/4																							
	NE 1/4 of NW 1/4																							
	NW 1/4 of NW 1/4																							
Paul R. + Leola E. Smith	GOVT LOT 2			14 75		NO	NO	L																
	SE 1/4 of NW 1/4																							
	NE 1/4 of SW 1/4																							
	NW 1/4 of SW 1/4																							
Harvey Carmex Buntzman	GOVT LOT 3																							
	GOVT LOT 4																							
	GOVT LOT 5 (SEE NEXT PAGE)																							
	GOVT LOT 6			3525		NO	YES	L																
				5060																				

(CONT NEXT PAGE)

Cass County, Minnesota, for Taxes for the Year 1961.

SOLD FOR TAXES	VALUATIONS BY SCHOOL DISTRICTS AS EQUALIZED BY DEPARTMENT OF TAXATION						Tax Including State Homestead	State Tax on Non-Homestead	SPECIAL TAXES	SPECIAL TAXES	TOTAL TAXES	PAID	WHEN PAID	Number of Receipts	March Settlement 1961	June Settlement 1961	Penalty	November Settlement 1961	Penalty	Collections to First Monday in January 1962	Penalty	Delinquent on First Monday in January 1961	Total Delinquent Tax and Penalty	REMARKS	
	District No.	District No.	District No.	District No.	District No.	District No.																			
	Rate	Rate	Rate	Rate	Rate	Rate																			
1							572	16			588	1	PAID IN FULL MAY 1 0 1962 9879		588									10572	
2																									
3																									
4																									
5																									
6																									
7																									
8																									10570
9																									
10																									
11																									
12																									
13																									
14																									
15																									
16																									
17																									
18																									
19																									2246
20																									10579

2nd HALF PAID OCT 18 1962 2315
1st HALF PAID MAY 3 1962 13052

Part of Paul Park Bog Bay

Assessment Roll and Tax List of Real Property in the

1584'

er, M-Mineral

Cass County, Minnesota, for Taxes for the Year 1961.

PLATTEN, MILLER-DAVIS CO., MINNEAPOLIS

IN WHOSE NAME ASSESSED	DESCRIPTION
	(GOVT LOT 5 - ITS DIVISI)
Lester H. + Rose E. Lippert	1 E. 100' OF GOVT LOT 5
Henry E. + Mabel A. Meyer	2 W. 100' OF E. 200' OF GO
Fred J. Meyer	3 W. 100' OF E. 300' OF GO
District #4 + Edna K. Meyer	4 W. 100' OF E. 500' OF GO
Joseph J. Gruba Jr. + John M. Gruba	5 W. 100' OF E. 400' OF GOV
Joseph J. Gruba	6 W. 100' OF E. 200' OF GOV
Peter J. Lubash	7 W. 100' OF E. 200' OF GOV
Paul O. + Elizabeth A. Vorwerk	8 W. 200' OF E. 700' OF GOV
Roger + Ina Severson	9 W. 100' OF E. 500' OF GOV
Henry E. + Jeanne E. Samways	10 W. 100' OF E. 1000' OF GOV
Best C. + Alvy H. Andergren	11 W. 100' OF E. 1200' OF GOV
Paul R. + Ayola E. Smith	12 W. 170' OF GOVT LOT 5
	13 S W 1/4 of S W 1/4
	14 S E 1/4 of S W 1/4
	15 N E 1/4 of S E 1/4
	16 N W 1/4 of S E 1/4
Oren C. + Violet E. Himble	18 W. 100' OF E. 1100' OF GOVT
	19 S E 1/4 of S E 1/4
	20

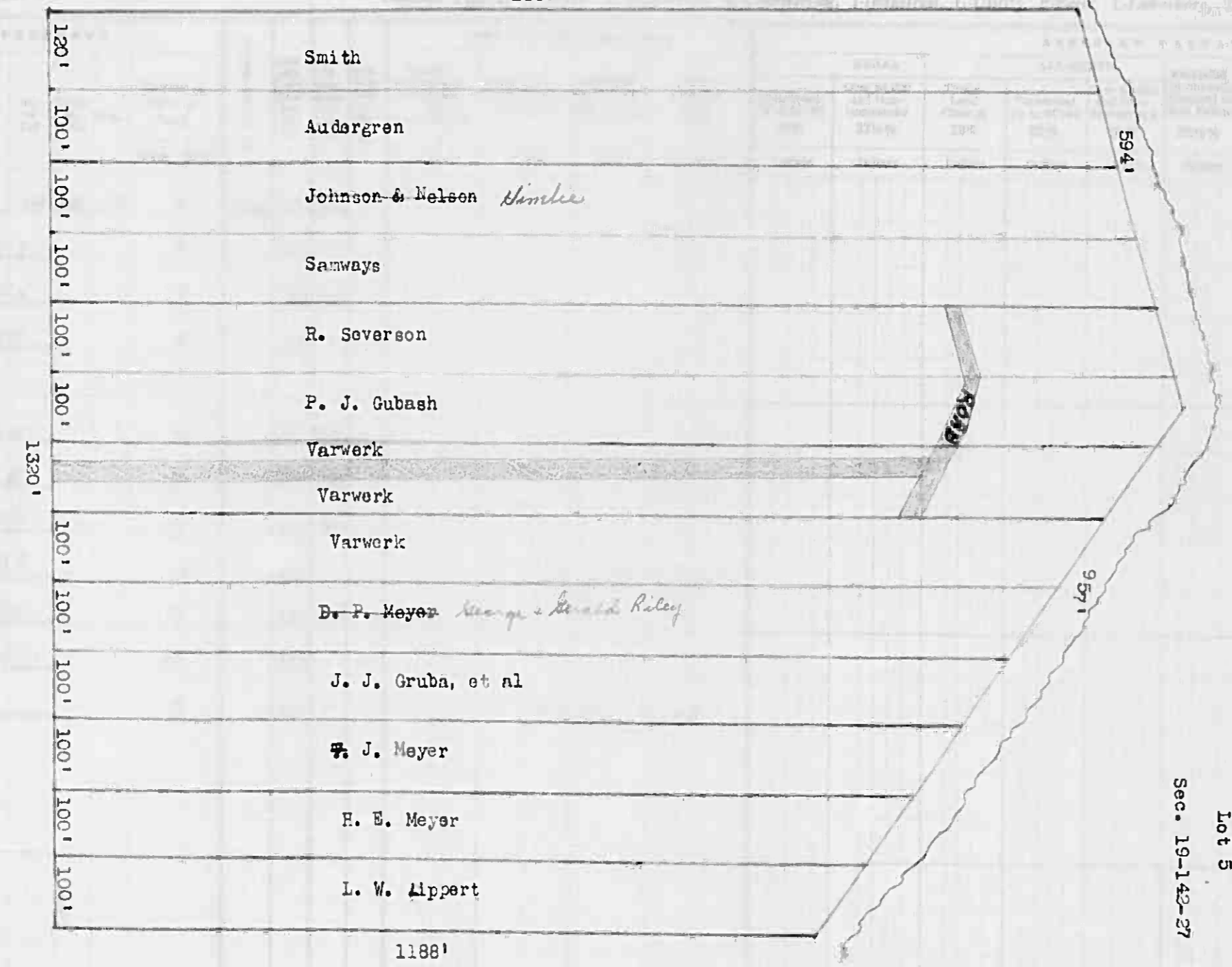

Land	TOTAL ASSESSED VALUE	Total Assessed Value as Equalized by the Board of Review	FINAL EQUALIZED VALUE
Dollars	Dollars	Dollars	Dollars

SOLD FOR TAXES	District No.	District Rate	District No.	District Rate	District No.	District Rate	Tax Including State Homestead	State Tax on Non-Homestead	SPECIAL TAXES	SPECIAL TAXES	TOTAL TAXES	PAID	WHEN PAID	Number of Receipt	March Settlement 1962	June Settlement 1962	Penalty	November Settlement 1962	Penalty	Collections to First Monday in January 1963	Penalty	Delinquent on First Monday in January 1963	Total Delinquent Tax and Penalty	REMARKS		
1		41					1298	38			1336	PAID IN FULL	MAY 29 1962	9292		1336										
2		177					5602	162			5764	PAID IN FULL	APR 23 1962	9630		5764									10628	
3							4374				4374	PAID IN FULL	MAY 10 1962	9870		4374									10627	
4							572	16			588														10569	
5																									10551	
6		137					4336	124			4460	PAID IN FULL	OCT 31 1962	19603											10631	
7							572	16			588	PAID IN FULL	MAY 29 1962	9280		588		4460							10574	
8		44					1392	40			1432	PAID IN FULL	MAY 31 1962	16807		1432									10624	
9		59					1868	54			1922	PAID IN FULL	MAY 26 1962	9877		1922									10626	
10							572	16			588	PAID IN FULL	MAY 1 1962	9871		588									10573	
11							572	16			588	PAID IN FULL	NOV 27 1962	20740											10572	
12		50					1682	46			1728	PAID IN FULL	MAY 2 1962	13230		1728									10575	
13																										
14																										
15																										
16																										
17																										
18							572	16			588	PAID IN FULL	APR 23 1962	9629		588									10571	
19																										
20							14496	544			23956															

130 = 130	14496
135 = 593	8916
265 = 723	23412

Part of Robert Beach Part of Boy Bay

Assessment Roll and Tax List of Real Property in the Town of Rogers

* Indicate Type of Property: R-Residential, C-Commercial, A-Industrial, U-Utility, F-Farm, L-Lakeshore, T-Timber, M-Mineral

Form SCD MILLER-DAVIS CO., MINNEAPOLIS

Table with columns: IN WHOSE NAME ASSESSED, DESCRIPTION OF PROPERTY, TRUE AND FULL VALUATIONS, ASSESSED VALUATIONS, and FINAL EQUALIZED VALUE. Includes handwritten entries for Harvey & Carmen Countryman, Olaf Johnson, Joe O. Bodin, Maurice & Cleora Johnson, J.C. Huffman, etc.

Cass County, Minnesota, for Taxes for the Year 1961.

Table with columns: SOLD FOR TAXES, VALUATIONS BY SCHOOL DISTRICTS AS EQUALIZED BY DEPARTMENT OF TAXATION, Tax including State Homestead, SPECIAL TAXES, TOTAL TAXES, PAID, WHEN PAID, Number of Receipt, March Settlement 1962, June Settlement 1962, November Settlement 1962, Collections to First Monday in January 1963, Delinquent on First Monday in January 1963, Total Delinquent Tax and Penalty, REMARKS. Includes handwritten entries for Harvey & Carmen Countryman, Olaf Johnson, etc.

