

ASSESSMENT & TAX LIST - 1960

Ponto Lake



# DIRECTIONS TO ASSESSOR

OFFICE OF COUNTY AUDITOR,  
1960.

To \_\_\_\_\_ County, Minn., Assessor of the \_\_\_\_\_ of \_\_\_\_\_  
for the year 1960, are hereby delivered to you. The list of real estate contains all descriptions subject to taxation, so far as the same have come to my knowledge from any source, and you are directed to assess all property and make a return thereof as required by the laws of the State of Minnesota prescribing the duties of the assessor. A form of the return to be signed by you is appended in this book.

County Auditor

## Extracts from Laws Relating to the Listing of Personal Property Section Numbers refer to Minnesota Statutes

**Sec. 273.01. PROPERTY SUBJECT TO TAXATION.** All real and personal property in this state, and all personal property of persons residing therein, . . . is taxable, except such as is by law exempt from taxation.

**WHEN LISTED AND ASSESSED.** . . . Personal Property shall be listed and assessed annually by assessor to its value on May 1, and if acquired on that day, shall be listed by the assessor on that day.

**Sec. 273.22. By whom listed.** Personal Property shall be listed in this state, shall list all of his age, and sound mind, being a resident of all . . . He shall also list separately, and in the name of his principal, . . . controlled by him as agent or attorney . . . invested, loaned, or otherwise by his guardian of a minor, child, or insane person shall be listed by the assessor on that day.

**Sec. 273.27. Certain personal property.** All household machines, including clocks, musical instruments, . . . the assessor on that day.

**Sec. 273.29. Merchants and manufacturers.** The assessor shall be listed in the town or district where . . . of a manufacturer shall be listed in the town or district where . . .

**Sec. 273.30. Farm property of non-resident.** When a farm does not reside thereon, the same shall be listed . . . towns or districts. If the farm is situated in several . . . tract in which the principal place of business of such farm is located . . . houses, with their contents, . . . elevators and warehouses, . . . any railroad company which are not in good faith . . . operated as personal property in the town or district where . . .

**Sec. 273.33. Pipeline Companies.** Subdivision 1. Personal property of natural pipeline companies engaged in the business . . . shall be listed and assessed in the county, town, or district where the same is . . .

**Sec. 273.35. Gas and Water Companies.** The personal property of electric, gas, and water companies shall be listed and assessed in the town or district where located, without regard to the principal or other . . .

**Sec. 273.37. Electric Light and Power Companies and others.** Property with power, place of listing, and assessment . . .

**Sec. 273.40. False statement regarding taxes.** Every person who, in making a return for taxation, or in any other manner, . . .

**Sec. 273.42. Property exempt from taxation.** No . . .

**Sec. 273.43. Qualification of property.** Subdivision 1. How classified for purpose of taxation, earnings or other . . .

**Sec. 273.44. Estates of decedents.** The personal property of the estate of a decedent shall be listed and assessed at the place . . .

**Sec. 273.45. Person under Guardianship.** The personal property of a person under guardianship shall be listed and assessed at the . . .

**Sec. 273.46. Assessor and receiver.** This assessor shall be . . .

**Sec. 273.47. Property of decedent.** No . . .

**Sec. 273.48. Assessor's duty.** The assessor shall . . .

**Sec. 273.49. Why of doubt in case of doubt.** In case of doubt as to the proper place of listing, . . .

**Sec. 273.50. Assessor may enter dwellings.** . . .

**Sec. 273.51. Assessor's duty.** . . .

**Sec. 273.52. Assessor's duty.** . . .

**Sec. 273.53. Assessor's duty.** . . .

**Sec. 273.54. Assessor's duty.** . . .

**Sec. 273.55. Assessor's duty.** . . .

**Sec. 273.01. PROPERTY SUBJECT TO TAXATION.** All real and personal property in this state, and all personal property of persons residing therein, . . . is taxable, except such as is by law exempt from taxation.

**WHEN LISTED AND ASSESSED.** . . . Personal Property shall be listed and assessed annually by assessor to its value on May 1, and if acquired on that day, shall be listed by the assessor on that day.

**Sec. 273.22. By whom listed.** Personal Property shall be listed in this state, shall list all of his age, and sound mind, being a resident of all . . . He shall also list separately, and in the name of his principal, . . . controlled by him as agent or attorney . . . invested, loaned, or otherwise by his guardian of a minor, child, or insane person shall be listed by the assessor on that day.

**Sec. 273.27. Certain personal property.** All household machines, including clocks, musical instruments, . . . the assessor on that day.

**Sec. 273.29. Merchants and manufacturers.** The assessor shall be listed in the town or district where . . . of a manufacturer shall be listed in the town or district where . . .

**Sec. 273.30. Farm property of non-resident.** When a farm does not reside thereon, the same shall be listed . . . towns or districts. If the farm is situated in several . . . tract in which the principal place of business of such farm is located . . . houses, with their contents, . . . elevators and warehouses, . . . any railroad company which are not in good faith . . . operated as personal property in the town or district where . . .

**Sec. 273.33. Pipeline Companies.** Subdivision 1. Personal property of natural pipeline companies engaged in the business . . . shall be listed and assessed in the county, town, or district where the same is . . .

**Sec. 273.35. Gas and Water Companies.** The personal property of electric, gas, and water companies shall be listed and assessed in the town or district where located, without regard to the principal or other . . .

**Sec. 273.37. Electric Light and Power Companies and others.** Property with power, place of listing, and assessment . . .

**Sec. 273.40. False statement regarding taxes.** Every person who, in making a return for taxation, or in any other manner, . . .

**Sec. 273.42. Property exempt from taxation.** No . . .

**Sec. 273.43. Qualification of property.** Subdivision 1. How classified for purpose of taxation, earnings or other . . .

**Sec. 273.44. Estates of decedents.** The personal property of the estate of a decedent shall be listed and assessed at the place . . .

**Sec. 273.45. Person under Guardianship.** The personal property of a person under guardianship shall be listed and assessed at the . . .

**Sec. 273.46. Assessor and receiver.** This assessor shall be . . .

**Sec. 273.47. Property of decedent.** No . . .

**Sec. 273.48. Assessor's duty.** The assessor shall . . .

**Sec. 273.49. Why of doubt in case of doubt.** In case of doubt as to the proper place of listing, . . .

**Sec. 273.50. Assessor may enter dwellings.** . . .

**Sec. 273.51. Assessor's duty.** . . .

**Sec. 273.52. Assessor's duty.** . . .

**Sec. 273.53. Assessor's duty.** . . .

**Sec. 273.54. Assessor's duty.** . . .

**Sec. 273.55. Assessor's duty.** . . .

Minnesota Statutes, Section 270.07. The commissioner of taxation shall prescribe the form of all blanks and books required under this chapter . . .

Minnesota Statutes, Section 273.03. The county auditor shall annually provide the necessary assessment books and blanks at the expense of the county, for and to correspond with each assessment district. He shall make out, in the real him known; and, if unknown, so stated opposite each tract or lot, the number of acres, and the lots or parts of lots or blocks included in each description of property. . . .

Minnesota Statutes, Section 273.04. The assessors and at least one member of each local board of review shall meet at the office of the county auditor on a day to be fixed by the commissioner of taxation for the purpose of receiving instructions as to their duties under the laws of the state. Each assessor attending such meetings shall receive as compensation for such service the sum of \$7.50 per day for each day necessarily consumed in attending such meeting, and mileage at the rate of seven cents per mile, and each board of review member the sum of \$6.00 per day and mileage at the rate of five cents per mile for each mile necessarily traveled in going from his home to and returning from the county seat to be computed by the usually traveled route, and paid out of the county treasury upon the warrant of the county auditor.

The forms in this book are prescribed for the 1960 assessment by JOSEPH M. ROBERTSON, Commissioner of Taxation







**SUMMARY OF TAX COLLECTION**

Original Levy	- - - - -	\$ 17,529.12	
Additions	- - - - -	\$ 53.74	
			\$ 17,582.86
Abatements	- - - - -	\$ 298.80	
			\$ 17,284.06

**COLLECTIONS**

March Settlement	- - - - -	\$ 2,861.82	
June Settlement	- - - - -	\$ 10,804.98	
November Settlement	- - - - -	\$ 3,090.73	
January Settlement	- - - - -	\$ 2.96	\$ 16,760.50
			\$ .....
Over Collected	- - - - -	\$ 72.71	
Under Collected	- - - - -	\$ .....	
Delinquent	- - - - -	\$ 596.27	\$ 523.56
Total	- - - - -		\$ 17,284.06

Red Estate

Camp Point  
 Point Point  
 Hepburn  
 Beach  
 East Shore  
 Ada Pine  
 Beach  
 North Shore  
 degress Ist. Add'l



TABULAR SCHEDULE OF VALUATIONS, RATES AND TAXES

LEVIED IN THE Town OF Ponto Lake

COUNTY OF CASS, STATE OF MINNESOTA

School District No.	VALUATION BY SCHOOL DISTRICTS				RATE OF STATE TAXES	RATE OF COUNTY TAXES											RATE OF TOWN TAXES											RATE OF SCHOOL TAXES			TAXES LEVIED												
	Agri-cultural Lands	Non-Agri-cultural Lands	Personal Property	Total Value of all Property except Money and Credits		Rev.	R. & B.	Welfare	Bonds and Int.	PERA	Civil Def.	Total Rate of County Tax	Rev.	R. & B.	Drag Tax	State Loan	Fire	Total Rate of Town Tax	Local	Special	State Loan	Deficiency	Tuition	Transportation	C.O. P.L.	Total Rate of Sch'l Tax	Total Rate of all Taxes	LOCAL 1 MILL AND SPECIAL SCHOOL TAXES BY DISTRICTS					ALL OTHER TAXES										
Dollars	Dollars	Dollars	Dollars	Mills	Mills	Mills	Mills	Mills	Mills	Mills	Mills	Mills	Mills	Mills	Mills	Mills	Mills	Mills	Mills	Mills	Mills	Mills	Mills	Mills	Mills	Mills	Mills	Local 1 Mill	Special	State Loan	Def.	C.O.	PERA	Total School Taxes	FUNDS	Rate	Amounts						
114	39,700	16,538	9,504	69,239	11.684	33.3	20.58	0.04	5.63	0.23	121.7	5.06	9.		5.		19.06	25.	39.88			24.38	3.95			93.21	240.81						11,185.7	17,843.5	10,908.3	176.73	4,170.48	State - Non-Homestead,	295.08				
			79,581																							118.21	245.81					12,248.0	9,769.0	5,972.1	96.76	4,218.7	State - Homestead,	421.87					
																																	23,433.7	2,761.25	16,880.4	273.49	7,066.15	County Revenue,	2305.66				
																																						County Road and Bridge,	1384.78				
																																						County Welfare,	4018.60				
																																						Bonds and Interest	3898.0				
																																						PERA	1592				
																																							Civil Defense	35035			
																																							Town Revenue,	62315			
																																								Town Road and Bridge,	34620		
																																								Town Drag,	131970		
																																								Town State Loan.			
																																								Fire			
																																								School Local 1 Mill,			
																																								School Special,	234337		
																																								School State Loan,	276125		
																																								Deficiency			
																																									Tuition		
																																									Transportation	168804	
																																									C.O.	27349	
																																									PERA	706615	

Assessed Value	Rural	All Other	Personal Property	Total
Homestead	17,058	2478		19,536
Non-Homestead	33,044	3658	13,001	49,703
Total	50,102	6136	13,001	69,239

C.2 7572  
Other 5429

P.P. excluding State Rate

C. Nurse 13847  
R+B Bldg 13847  
Agricult. Assn. 3462  
842632

Total Levy, \$ 17,529.12  
Total Number of Acres 12,351.93  
I, L. C. Peterson, Auditor of said County and State aforesaid, do hereby certify that the foregoing is a true and correct Schedule, showing the valuation of all the taxable property, in the Town of Ponto Lake, in said County, the several rates of Taxation and Totals of the several Tax Funds levied thereon for the year 1960.  
Witness my hand and official seal, this 13<sup>th</sup> day of January, A. D. 1960.  
By L. C. Peterson, County Auditor  
By Helen Bilbrey, Deputy

SEAL

Total Taxes Real Estate 14,212.96  
Pers. Prop. 3,316.16  
Total 17,529.12

Real Estate

Camp Blanche, Camp Ponto Lake, Hagansee Plat of Beach, Kat Shore, Ada Pine North Shore Hagansee 1st. Add.



COLLECTIONS OF TAXES OF 1961 OF *Town of Ponto Lac*, CASS COUNTY, MINNESOTA

FUNDS	MARCH SETTLEMENT 1961	JUNE SETTLEMENT 1961	NOV. SETTLEMENT 1961	Amount Collected from Nov. 19 to First Monday in Jan. 1962	REDUCTIONS	Total Reductions and Collected	BALANCE UNCOLLECTED	ADDITIONS	Total Uncollected to First Monday in January, 1962
State-Non-Homestead,	32.39	204.04	48.18		08				
State-Homestead,	35.82	286.29	80.00		08				
County Revenue,	371.62	1423.12	408.57		40				
County Road and Bridge,	223.19	854.73	245.39		24				
County Welfare,	647.71	2480.42	712.12		69				
County Bond and Interest, <i>PERA</i>	62.83	240.61	69.08		07				
<i>Civil Defense</i>	2.57	9.83	2.82		01				
<i>Co. Nurse</i>	22.32	85.47	24.54		02				
<i>P. &amp; B. Bldg.</i>	22.32	85.47	24.54		02				
Town Revenue,	56.47	216.25	62.08		06				
Town Road and Bridge,	100.44	384.63	110.42		11				
Town Drag,									
Town State Loan,									
<i>Fires</i>	55.81	213.68	61.35		06				
School Local 1 Mill,									
School Special,	461.51	1384.02	398.59		30				
School State Loan,									
Deficiency	445.07	1704.32	489.31		48				
Tuition									
Transportation									
<i>C. B.</i>	272.09	1041.92	299.13		29				
<i>PERA</i>	44.09	168.81	48.47		05				
<i>Agric. Ass'n.</i>	5.58	21.37	6.14						
	2861.82	10804.98	3090.73		296				

	LOCAL 1 MILL	SPECIAL	STATE LOAN	<i>Deficiency</i>	<i>C.B.</i>	<i>PERA</i>	TOTALS
MARCH SETTLEMENT		96.51 365.00		153.94 291.12	94.11 177.98	15.25 22.84	359.81 862.95
Totals		461.51		445.07	272.09	44.09	1235.50
JUNE SETTLEMENT		752.81 631.21		1200.87 503.45	734.14 307.78	118.94 49.87	2816.76 1492.31
Totals		1384.02		1704.32	1041.92	168.81	4299.07
NOVEMBER SETTLEMENT		214.88 183.71		342.78 146.53	209.55 89.58	33.95 14.52	801.16 434.34
Totals		398.59		489.31	299.13	48.47	1235.50
NOVEMBER to JANUARY		30		48	29	05	112
Totals		30		48	29	05	112
ADDITIONS							
Totals							
REDUCTIONS							
Totals							

Real Estate

Map Dishes  
Ponto Point  
Beach  
East Shore  
Ada Pine  
North Shore  
Gress 1st. Add.











Assessment Roll and Tax List of Real Property in the Town of Pont Lake, Cass County, Minnesota, for Taxes for the Year 1960.

FORM 500 - MILLER-DAVIS CO., MINNEAPOLIS

\* Indicate Type of Property: R-Residential, C-Commercial, I-Industrial, U-Utility, F-Farm, L-Lakeshore, T-Timber, M-Mineral

Cass County, Minnesota, for Taxes for the Year 1960.

Table with columns: IN WHOSE NAME ASSESSED, DESCRIPTION OF PROPERTY, TRUE AND FULL VALUATIONS, VALUATIONS BY SCHOOL DISTRICTS AS EQUALIZED BY DEPARTMENT OF TAXATION, TAXES, PAID, WHEN PAID, Number of Receipt, March Settlement 1961, June Settlement 1961, November Settlement 1961, Collections to First Monday in January 1962, Delinquent on First Monday in January 1962, Total Delinquent Tax and Penalty, REMARKS.

Continued on next page

Frank N. & Helen Gardner Part of Lot 11

Camp Blanche, Pine Camp, Pont Lake, Narrows, Plat of, Ada, Pine, North Shore, Degrass 1st, Add'l



















Assessment Roll and Tax List of Real Property in the Town of Ponto Lake

Cass County, Minnesota, for Taxes for the Year 1960.

Form SCD - MILLER-DAVIS CO., MINNEAPOLIS

\* Indicate Type of Property: R-Residential, C-Commercial, I-Industrial, U-Utility, F-Farm, L-Lakeshore, T-Timber, M-Mineral

Main table with columns: IN WHOSE NAME ASSESSED, DESCRIPTION OF PROPERTY, TRUE AND FULL VALUATIONS, ASSESSED VALUATIONS, VALUATIONS BY SCHOOL DISTRICTS AS EQUALIZED BY DEPARTMENT OF TAXATION, TAXES, PAID, WHEN PAID, etc.

Camp Blanche, Ponto Point, Ada Pine, North Shore, Depress Ist., Add'l



















Assessment Roll and Tax List of Real Property in the Town of Pont Lake

\* Indicate Type of Property: R-Residential, C-Commercial, I-Industrial, U-Utility, F-Farm, L-Lakeshore, T-Timber, M-Mineral

Cass County, Minnesota, for Taxes for the Year 1960.

Form SCD MILLER-DAVIS CO., MINNEAPOLIS

Table with columns: IN WHOSE NAME ASSESSED, DESCRIPTION OF PROPERTY, TRUE AND FULL VALUATIONS, ASSESSED VALUATIONS, VALUATIONS BY SCHOOL DISTRICTS AS EQUALIZED BY DEPARTMENT OF TAXATION, TAXES, PAID, WHEN PAID, Number of Receipt, March Settlement 1961, June Settlement 1961, November Settlement 1961, Collections to First Monday in January 1962, Delinquent on First Monday in January 1962, Total Delinquent Tax and Penalty, REMARKS.

Continued on next Page  
F. W. Lang

Camp Blanche  
Kane Camp  
Pontic Point  
Japanese Plat of  
Beach East Shore  
Ada Pine  
North Shore  
Dress 1st. Add.



















Assessment Roll and Tax List of Real Property in the Town of Ponts Lake

Cass County, Minnesota, for Taxes for the Year 1960.

Form SCD - MILLER-DAVIS CO., MINNEAPOLIS

Table with columns: IN WHOSE NAME ASSESSED, DESCRIPTION OF PROPERTY, TRUE AND FULL VALUATIONS, ASSESSED VALUATIONS, VALUATIONS BY SCHOOL DISTRICTS AS EQUALIZED BY DEPARTMENT OF TAXATION, TAXES, PAID, WHEN PAID, Number of Receipt, March Settlement, June Settlement, November Settlement, Penalty, Collections to First Monday in January 1962, Delinquent on First Monday in January 1962, Total Delinquent Tax and Penalty, REMARKS.

(Continued on next page)

Camp Blanche, Kinnear Camp, Ponts Point, Japanese Flat of Beach, Ada Fine Beach, North Shore, Dress 1st. Add'l.











Assessment Roll and Tax List of Real Property in the Town of Ponto Lake of Ponto Lake

Form SCD, MILLER-DAVIS CO., MINNEAPOLIS

\* Indicate Type of Property: R-Residential, C-Commercial, I-Industrial, U-Utility, F-Farm, L-Lakeshore, T-Timber, M-Mineral

Table with columns: IN WHOSE NAME ASSESSED, DESCRIPTION OF PROPERTY, TRUE AND FULL VALUATIONS, ASSESSED VALUATIONS, and FINAL EQUALIZED VALUE. Includes handwritten entries for various property owners like Warren N. Kack, Kathryn W. Greene, etc.

Cass County, Minnesota, for Taxes for the Year 1960.

Table with columns: VALUATIONS BY SCHOOL DISTRICTS AS EQUALIZED BY DEPARTMENT OF TAXATION, TAX INCLUDING STATE HOMESTEAD, SPECIAL TAXES, TOTAL TAXES, PAID, WHEN PAID, and REMARKS. Includes handwritten entries for various tax payments and dates.























Assessment Roll and Tax List of Real Property in the Town of...

Cass County, Minnesota, for Taxes for the Year 1960.

Main table with columns: IN WHOSE NAME ASSESSED, DESCRIPTION OF PROPERTY, TRUE AND FULL VALUATION, VALUATIONS BY SCHOOL DISTRICTS AS EQUALIZED BY DEPARTMENT OF TAXATION, TAX INCLUDING STATE HOMESTEAD, SPECIAL TAXES, TOTAL TAXES, PAID, WHEN PAID, etc.

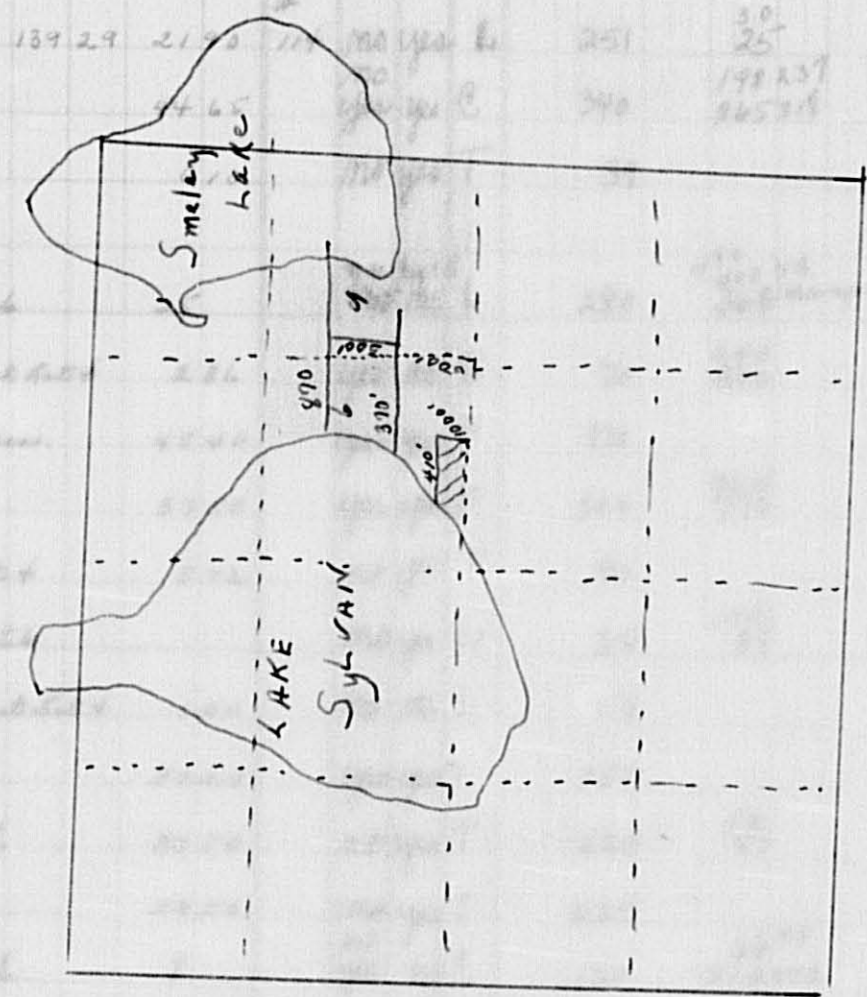

870' x 550' of Lot 6 + 9  
1000' of S. 1000' of Lots 6 + 9  
MICK J LABB  
S. 1000' of Lots 6 + 9, less  
1000' + less S. 1000' of W. 410'  
C. P. R. C. K. L. & T. O. N  
Lots 6 + 9 less S. 1000' (or)  
N. E. MINNETTE

5100' x W 410' in SW  
CORNER of LOT 6  
BARTLINE PERSONS

(Continued on next pages)

Camp Blanche  
Kinnear Camp  
Ponto Point  
Beach  
Ada Pine  
North Shore  
Depress Ist. Add'l



















Assessment Roll and Tax List of Real Property in the Town of Porto Lake

\* Indicate Type of Property: R-Residential, C-Commercial, I-Industrial, U-Utility, F-Farm, L-Lakeshore, T-Timber, M-Mineral

Table with columns: IN WHOSE NAME ASSESSED, DESCRIPTION OF PROPERTY, TRUE AND FULL VALUATIONS, ASSESSED VALUATIONS, and FINAL EQUALIZED VALUE. Includes entries for Otto B. Griffin, Kerbie + Isabelle Siltman, Oscar E. Johnson + Malet Johnson, Frank E. Rohrer, and State of Minnesota.

Cass County, Minnesota, for Taxes for the Year 1960.

Table with columns: VALUATIONS BY SCHOOL DISTRICTS AS EQUALIZED BY DEPARTMENT OF TAXATION, Tax including State Homestead, State Tax on Non-Homestead, SPECIAL TAXES, TOTAL TAXES, PAID, WHEN PAID, Number of Receipt, March Settlement 1961, June Settlement 1961, November Settlement 1961, Collections to First Monday in January 1962, Delinquent Tax and Penalty, and REMARKS. Includes handwritten notes and dates like '2nd Half Paid OCT 23 1961'.

Vertical text on the right edge of the page: Camp Blanche, Kline Camp, Porto Point, Napanee Beach, East Shore, Ada Pine Beach, North Shore, Grass Ist. Add'l.



Assessment Roll and Tax List of Real Property in the Town of Ponto Lake

\* Indicate Type of Property: R-Residential, C-Commercial, I-Industrial, U-Utility, F-Farm, L-Lakeshore, T-Timber, M-Mineral

Form 5CD MILLER-DAVIS CO., MINNEAPOLIS

Table with columns: IN WHOSE NAME ASSESSED, DESCRIPTION OF PROPERTY, TRUE AND FULL VALUATIONS, ASSESSED VALUATIONS, and FINAL EQUALIZED VALUE. Includes rows for Albert P. & Katherine M. Heberlee, Erwin Holz, and Ora C. Siltman.

Cass County, Minnesota, for Taxes for the Year 1960.

Table with columns: VALUATIONS BY SCHOOL DISTRICTS AS EQUALIZED BY DEPARTMENT OF TAXATION, TAX INCLUDING STATE HOMESTEAD, SPECIAL TAXES, TOTAL TAXES, PAID, WHEN PAID, Number of Receipt, March Settlement, June Settlement, November Settlement, Collections to First Monday in January, Delinquent on First Monday in January, Total Delinquent Tax and Penalty, and REMARKS. Includes handwritten entries for tax payments and dates.

Camp Blanche, Kinnear Camp, Ponto Point, Naparose Beach, Plat of East Shore, Ada Pine Beach, North Shore, Agass Ist. Add'l



















Assessment Roll and Tax List of Real Property in the Town of Ponto Lake

\* Indicate Type of Property: R-Residential, C-Commercial, I-Industrial, U-Utility, F-Farm, L-Lakeshore, T-Timber, M-Mineral

Form 500 MILLER-DAVIS CO., MINNEAPOLIS

Table with columns: IN WHOSE NAME ASSESSED, DESCRIPTION OF PROPERTY, TRUE AND FULL VALUATIONS, ASSESSED VALUATIONS, and FINAL EQUALIZED VALUE.

Cass County, Minnesota, for Taxes for the Year 1960.

Table with columns: VALUATIONS BY SCHOOL DISTRICTS AS EQUALIZED BY DEPARTMENT OF TAXATION, Tax Including State Homestead, State Tax on Non-Homestead, SPECIAL TAXES, TOTAL TAXES, PAID, WHEN PAID, Number of Receipt, March Settlement, June Settlement, November Settlement, Collections to First Monday in January, Delinquent on First Monday in January, Total Delinquent Tax and Penalty, REMARKS.

Camp Blanche, Kame Camp, Ponto Point Beach, Reservoir Plat of East Shore, Ada Pine North Shore, Grass 1st. Add'l



Assessment Roll and Tax List of Real Property in the Town of Ponton Lake of Ponton Lake

Form SCD MILLER-DAVIS CO., MINNEAPOLIS

\* Indicate Type of Property: R-Residential, C-Commercial, I-Industrial, U-Utility, F-Farm, L-Lakeshore, T-Timber, M-Mineral

Cass County, Minnesota, for Taxes for the Year 1960.

Main table with columns: IN WHOSE NAME ASSESSED, DESCRIPTION OF PROPERTY, TRUE AND FULL VALUATIONS, ASSESSED VALUATIONS, VALUATIONS BY SCHOOL DISTRICTS AS EQUALIZED BY DEPARTMENT OF TAXATION, Tax including State Homestead, State Tax on Non-Homestead, SPECIAL TAXES, TOTAL TAXES, PAID, WHEN PAID, Number of Receipt, March Settlement 1961, June Settlement 1961, November Settlement 1961, Collections to First Monday in January 1962, Delinquent on First Monday in January 1962, Total Delinquent Tax and Penalty, REMARKS.

(Continued on Next Page)

Camp Blanche, Kinne Camp, Ponton Point Beach, Napanee Flat of East Shore, Ada Pine North Shore, Grass 1st. Add'n











Assessment Roll and Tax List of Real Property in the Town of Ponto Lake, Cass County, Minnesota, for Taxes for the Year 1960.

Form SCD MILLER-DAVIS CO., MINNEAPOLIS

Table with columns: IN WHOSE NAME ASSESSED, SUBDIVISION, No. School District, Indicate Homestead, Indicate Acreage, Indicate Property, TRUE AND FULL VALUATIONS (LAND, BUILDINGS, MACHINERY, TOTAL), ASSESSED VALUATIONS (RURAL, ALL OTHER, MACHINERY, Seasonal and Recreational Cabins, TOTAL ASSESSED VALUE, Total Assessed Value as Equalized by the Board of Review), FINAL EQUALIZED VALUE.

Cass County, Minnesota, for Taxes for the Year 1960.

Table with columns: VALUATIONS BY SCHOOL DISTRICTS AS EQUALIZED BY DEPARTMENT OF TAXATION (District No., Rate, Mills), Tax including State Homestead, State Tax on Non-Homestead, SPECIAL TAXES, TOTAL TAXES, PAID, WHEN PAID, Number of Receipt, March Settlement, June Settlement, November Settlement, Collections to First Monday in January, Delinquent on First Monday in January, Total Delinquent Tax and Penalty, REMARKS.

Camp Blanche, Kline Camp, Ponto Point, Nepanse Beach, Plat of Beach, Ada Pine Beach, North Shore, Grass 1st. Add'n



Assessment Roll and Tax List of Real Property in the Town of Ponto Lake of Ponto Lake

\* Indicate Type of Property: R-Residential, C-Commercial, I-Industrial, U-Utility, F-Farm, L-Lakeshore, T-Timber, M-Mineral

Form 5CD MILLER-DAVIS CO., MINNEAPOLIS

Table with columns: IN WHOSE NAME ASSESSED, DESCRIPTION OF PROPERTY, TRUE AND FULL VALUATIONS, ASSESSED VALUATIONS, and FINAL EQUALIZED VALUE. Includes entries for Farret W. Metzgroth, Joyce C. Haugen, et al, Donald F. Lindquist, et al, A. L. Bachorn, Ernest & Pauline Siltman, H. Lauritz Hansen, State of Minnesota, Hebra R. Rasmussen, Beatrice E. Wedge, Leslie & Esther Shepard, Manfred & Alvilda B. Reitan, Leslie & Esther Shepard.

(Continued on next page)

Cass County, Minnesota, for Taxes for the Year 1960.

Table with columns: VALUATIONS BY SCHOOL DISTRICTS AS EQUALIZED BY DEPARTMENT OF TAXATION, Tax Including State Homestead, State Tax on Non-Homestead, SPECIAL TAXES, TOTAL TAXES, PAID, WHEN PAID, Number of Receipt, March Settlement 1961, June Settlement 1961, November Settlement 1961, Collections to First Monday in January 1962, Delinquent on First Monday in January 1962, Total Delinquent Tax and Penalty, REMARKS. Includes entries for Farret W. Metzgroth, Joyce C. Haugen, et al, Donald F. Lindquist, et al, A. L. Bachorn, Ernest & Pauline Siltman, H. Lauritz Hansen, State of Minnesota, Hebra R. Rasmussen, Beatrice E. Wedge, Leslie & Esther Shepard, Manfred & Alvilda B. Reitan, Leslie & Esther Shepard.

Camp Blanche, Kinne Camp, Ponto Point, Japanese Beach, Plat of Beach, Ada, Pine North Shore, Dress 1st, Add'n



Assessment Roll and Tax List of Real Property in the Town of Ponton Lake

\* Indicate Type of Property: R-Residential, C-Commercial, I-Industrial, U-Utility, F-Farm, L-Lakeshore, T-Timber, M-Mineral

Form 5CD MILLER-DAVIS CO., MINNEAPOLIS

Table with columns: IN WHOSE NAME ASSESSED, DESCRIPTION OF PROPERTY, TRUE AND FULL VALUATIONS, ASSESSED VALUATIONS, and FINAL EQUALIZED VALUE. Includes handwritten entries for property owners like Nicholas & Evelyn Mully and Arthur J. & Sarah Harris.

9.50

488 1194 1433

1682 55 469 1921 64 534

524 598

Cass County, Minnesota, for Taxes for the Year 1960.

Table with columns: VALUATIONS BY SCHOOL DISTRICTS AS EQUALIZED BY DEPARTMENT OF TAXATION, TAXES, PAID, WHEN PAID, and REMARKS. Includes handwritten tax amounts and payment dates.

H 64 534 598

14398 314

14772

12446

1326

Camp Blanche, Kinne Camp, Ponton Lake, Hapness Plat of Beach, Ada Pine North Shore Hapness 1st. Add'n



Assessment Roll and Tax List of Real Property in the Town of Ponto Lake

\* Indicate Type of Property: R-Residential, C-Commercial, I-Industrial, U-Utility, F-Farm, L-Lakeshore, T-Timber, M-Mineral

Form SCD MILLER-DAVIS CO., MINNEAPOLIS

Table with columns: IN WHOSE NAME ASSESSED, DESCRIPTION OF PROPERTY, TRUE AND FULL VALUATIONS, ASSESSED VALUATIONS, and FINAL EQUALIZED VALUE. Includes entries for James H. & Sophia B. Fullerton, Clayton E. & Ada O. Petersons, Daniel M. & Angeline M. Boalittle, Matt L. & Lucille Novatney, Van & Olive Alexander, Williams E. & Elva B. Anderson, and Red River Lumber Co.

Cass County, Minnesota, for Taxes for the Year 1960.

Table with columns: VALUATIONS BY SCHOOL DISTRICTS AS EQUALIZED BY DEPARTMENT OF TAXATION, Tax including State Homestead, State Tax on Non-Homestead, SPECIAL TAXES, TOTAL TAXES, PAID, WHEN PAID, Number of Receipt, March Settlement 1961, June Settlement 1961, November Settlement 1961, Collections to First Monday in January 1962, Delinquent on First Monday in January 1962, Total Delinquent Tax and Penalty, and REMARKS. Includes tax payment details for various districts.

Camp Blanche, Klumpe Camp, Ponto Point, Napawa Beach, East Shore, Ada Pine North Shore, Agass 1st, Add'n











































Assessment Roll and Tax List of Real Property in the Town of Ponto Lake, Cass County, Minnesota, for Taxes for the Year 1960.

\* Indicate Type of Property: R-Residential, C-Commercial, I-Industrial, U-Utility, F-Farm, L-Lakeshore, T-Timber, M-Mineral

Table with columns: IN WHOSE NAME ASSESSED, SUBDIVISION, DESCRIPTION OF PROPERTY, TRUE AND FULL VALUATIONS (LAND, BUILDINGS, MACHINERY, TOTAL), ASSESSED VALUATIONS (RURAL, ALL OTHER, MACHINERY, Seasonal and Recreational Cabins, TOTAL ASSESSED VALUE), Total Assessed Value as Equalized by the Board of Review, FINAL EQUALIZED VALUE.

Nipanas Beach

Arthur C. & Luella R. Anderson
John J. & Marie Urmann
Claire E. & Evelyn J. Anderson
Arthur C. & Luella R. Anderson

Summary totals for assessed and equalized values.

Cass County, Minnesota, for Taxes for the Year 1960.

Table with columns: SOLD FOR TAXES, VALUATIONS BY SCHOOL DISTRICTS AS EQUALIZED BY DEPARTMENT OF TAXATION, Tax including State Homestead, State Tax on Non-Homestead, SPECIAL TAXES, TOTAL TAXES, PAID, WHEN PAID, Number of Receipt, March Settlement 1961, June Settlement 1961, November Settlement 1961, Collections to First Monday in January 1962, Delinquent on First Monday in January 1962, Total Delinquent Tax and Penalty, REMARKS.

Mapano Beach, Ponto Point, Kinne Camp, Camp Blauor, Sandgrass 2nd Add'n, Lashor's Lake Ada Park, Plat of East Shore, Ada Pine North Shore, Sandgrass 1st. Add'n







Assessment Roll and Tax List of Real Property in the Town of Ponto Lake

\* Indicate Type of Property: R-Residential, C-Commercial, I-Industrial, U-Utility, F-Farm, L-Lakeshore, T-Timber, M-Mineral

FORM 50 MILLER-DAVIS CO., MINNEAPOLIS

DESCRIPTION OF PROPERTY

TRUE AND FULL VALUATIONS

ASSESSED VALUATIONS

VALUATIONS BY SCHOOL DISTRICTS AS EQUALIZED BY DEPARTMENT OF TAXATION

Table with columns for property description, valuations, taxes, and payments. Includes names like Denver S. & Dorothy C. Baldwin, Charles H. & Lillie S. Brown, and Bernhardt J. & Joy J. Hansen. Includes handwritten notes and calculations.

Cass County, Minnesota, for Taxes for the Year 1960.

Map Blanch, Kinne Camp, Ponto Point, Napanee Beach, East Shore

Stacy, Snodgrass 2nd Add'n, Leashor's Lake Ada Park, Snady Wood, Ada Pine, North Shore, Degrass 1st. Add'n















Assessment Roll and Tax List of Real Property in the Town of Ponto Lake of Ponto Lake

\* Indicate Type of Property: R-Residential, C-Commercial, I-Industrial, U-Utility, F-Farm, L-Lakeshore, T-Timber, M-Mineral

Cass County, Minnesota, for Taxes for the Year 1960.

Mapase Beach, Ponto Point, Kinne Camp, Pamp Blant, Ada Pine Beach, East Shore, Flat of

Table with columns: IN WHOSE NAME ASSESSED, SUBDIVISION, DESCRIPTION OF PROPERTY, TRUE AND FULL VALUATIONS, ASSESSED VALUATIONS, and FINAL EQUALIZED VALUE.

Table with columns: VALUATIONS BY SCHOOL DISTRICTS AS EQUALIZED BY DEPARTMENT OF TAXATION, TAXES, PAID, WHEN PAID, and REMARKS.

Sum, Woodgrass 2nd Add'n, Leasher's Lake Ada Park, Slaggy Wood Shore, Ponto North Shore, Hahm's South











Assessment Roll and Tax List of Real Property in the Town of Ponto Lake of Ponto Lake

Cass County, Minnesota, for Taxes for the Year 1960.

Snodgrass 2nd Add'n, Ponto Point, Ponto Point Beach, East Shore, East Shore, Snodgrass 1st. Adn. to North Shore

Main table with columns: IN WHOSE NAME ASSESSED, SUBDIVISION, DESCRIPTION OF PROPERTY, TRUE AND FULL VALUATIONS, ASSESSED VALUATIONS, VALUATIONS BY SCHOOL DISTRICTS AS EQUALIZED BY DEPARTMENT OF TAXATION, TAXES, PAID, WHEN PAID, Number of Receipt, March Settlement, June Settlement, November Settlement, Collections to First Monday in January 1962, Delinquent on First Monday in January 1962, Total Delinquent Tax and Penalty, REMARKS.

Summary totals for columns: 694, 2375, 3069, 744, 2850, 3594, 46, 26, 940, 1012, 55, 31, 1098, 1184

Summary totals for columns: 55, 31, 86, 1098, 1129, 1184, 26442, 2286, 28728, 190, 29518

Snodgrass 1st. Adn. to North Shore, Ponto Point, Ponto Point Beach, East Shore, East Shore, Snodgrass 1st. Adn. to North Shore



















Assessment Roll and Tax List of Real Property in the Town of Porto Lake

\* Indicate Type of Property: R-Residential, C-Commercial, I-Industrial, U-Utility, F-Farm, L-Lakeshore, T-Timber, M-Mineral

Cass County, Minnesota, for Taxes for the Year 1960.

Snodgrass 2nd Add'n  
Leher's Lake Ada Park  
Shady Wood Shores  
Snodgrass 1st. Add'n. to North Sho

IN WHOSE NAME ASSESSED	SUBDIVISION	Sec. or Lot	Town or Block	No. of Acres of Land	No. School District	TRUE AND FULL VALUATIONS										FINAL EQUALIZED VALUE
						LAND EXCLUSIVE OF STRUCTURES AND IMPROVEMENTS				ASSESSED VALUATIONS						
						BUILDINGS and Other Structures	MACHINERY Permanently Attached to Real Estate	TOTAL True and Full Value	Homestead Up to \$4,000 20%	Over \$4,000 and Non-Homestead 33 1/3%	Timber Land Class 3c 20%	ALL OTHER	MACHINERY Permanently Attached to Real Estate 33 1/3%	Seasonal and Recreational Cabins 33 1/3%	TOTAL ASSESSED VALUE	
Otto B. Griffin	Plat of Shadywood Shores	61		1	114	24	173	197	49	49	49	49	49	49	49	49
"	"	62		2		20	144	164	41	41	41	41	41	41	41	41
"	"	63		3		19		19	5	5	5	5	5	5	5	5
"	"	64		4		16		16	4	4	4	4	4	4	4	4
"	"	65		5		24		24	6	6	6	6	6	6	6	6
"	"	66		6		38		38	10	10	10	10	10	10	10	10
"	"	67		7		48		48	12	12	12	12	12	12	12	12
Hiram J. + Jekie H. Gruba	"	68		8		40		40	16	16	16	16	16	16	16	16
"	"	69		9		36		36	14	14	14	14	14	14	14	14
"	"	70		10		30	660	690	12	12	12	12	12	12	12	12
Otto B. Griffin	"	71		11		25	550	575	236	236	236	236	236	236	236	236
"	"	72		12		29		29	8	8	8	8	8	8	8	8
"	"	73		13		24		24	6	6	6	6	6	6	6	6
"	"	74		14		20	240	269	5	5	5	5	5	5	5	5
"	"	75		15		24	99	129	32	32	32	32	32	32	32	32
"	"	76		16		25	83	108	27	27	27	27	27	27	27	27
"	"	77		17		29		29	7	7	7	7	7	7	7	7
"	"	78		18		24		24	6	6	6	6	6	6	6	6
Floyd R. + Phyllis J. Campbell	8 1/2 x 25'	79		19		24		24	6	6	6	6	6	6	6	6
"	"	80		20		20		20	5	5	5	5	5	5	5	5
Otto B. Griffin	Howard W. Paulson	81		21		24		24	6	6	6	6	6	6	6	6
"	"	82		22		20		20	5	5	5	5	5	5	5	5
						464	977	1441	194	266	460	460	460	460	460	460
						557	1172	1729	239	309	548	548	548	548	548	548

SOLD FOR TAXES	VALUATIONS BY SCHOOL DISTRICTS AS EQUALIZED BY DEPARTMENT OF TAXATION						Tax Including State Homestead	State Tax on Non-Homestead	SPECIAL TAXES	SPECIAL TAXES	TOTAL TAXES	PAID	WHEN PAID	Number of Receipt	March Settlement 1961	June Settlement 1961	November Settlement 1961	Collections to First Monday in January 1962	Delinquent on First Monday in January 1962	Total Delinquent Tax and Penalty	REMARKS	
	District No.	District No.	District No.	District No.	District No.	District No.																
	Rate	Rate	Rate	Rate	Rate	Rate																
	114																					
	49						1302															
	5						132															
	5						132															
	6						160															
	10						266															
	12						318															
	19						506	14														
	14						392	10														
	276						7336	194														
	8						212															
	6						160															
	67						1780															
	32						850															
	7						186															
	7						186															
	6						160															
	6						160															
	239						14564	218														

Snodgrass Point  
Halley's Haven  
Hearin's South Shore Acres







Assessment Roll and Tax List of Real Property in the Town of Pont Lake

\* Indicate Type of Property: R-Residential, C-Commercial, I-Industrial, U-Utility, F-Farm, L-Lakeshore, T-Timber, M-Mineral

Cass County, Minnesota, for Taxes for the Year 1960.

Snodgrass 2nd Add'n, Snodgrass 1st. A.C., Shady Wood Shores, Leisher's Lake Ada Park, Ha-ranae

Snodgrass 2nd Add'n, Snodgrass 1st. A.C., Shady Wood Shores, Leisher's Lake Ada Park, Ha-ranae

Table with columns: IN WHOSE NAME ASSESSED, SUBDIVISION, DESCRIPTION OF PROPERTY, TRUE AND FULL VALUATIONS, ASSESSED VALUATIONS, VALUATIONS BY SCHOOL DISTRICTS AS EQUALIZED BY DEPARTMENT OF TAXATION, TAX INCLUDING STATE HOMESTEAD, SPECIAL TAXES, TOTAL TAXES, PAID, WHEN PAID, Number of Receipt, March Settlement 1961, June Settlement 1961, November Settlement 1961, Collections to First Monday in January 1962, Delinquent on First Monday in January 1962, Total Delinquent Tax and Penalty, REMARKS.

420 590 1010 80 270 350 460 708 1168 95 310 405

95 310 = 405 7464 2526 284 10274 7108 8402 764











