

Assessment & Tax List - 1954

Ponto Lake

SUMMARY OF TAX COLLECTION

Original Levy	- - - - -	\$ 11,775.72	
Additions	- - - - -	\$	
			\$ 11,775.72
Abatement	- - - - -	\$ 158.34	
			\$ 11,617.38
COLLECTIONS			
March Settlement	- - - - -	\$ 2406.05	
June Settlement	- - - - -	\$ 6209.43	
November Settlement	- - - - -	\$ 2353.21	
January Settlement	- - - - -	\$ 73.34	\$ 11,042.03
			\$
Over Collected	- - - - -	\$ 9.00	
Under Collected	- - - - -	\$.10	
Delinquent	- - - - -	\$ 584.25	\$ 575.35
Total	- - - - -	\$ 11,617.38	

COLLECTIONS OF TAXES OF 1954

Town

OF *Park Lake*

CASS COUNTY, MINNESOTA

FUNDS	MARCH SETTLEMENT 1953	JUNE SETTLEMENT 1954	NOV. SETTLEMENT 1954	Amount Collected from Nov. 1953 to First Monday in Jan. 1954	REDUCTIONS	Total Reductions and Collected	BALANCE UNCOLLECTED	ADDITIONS	Total Uncollected to First Monday in January, 1954
State-Non-Homestead, State-Homestead,	4776 3786	8672 10814	2983 3811	61 123					
County Revenue, County Road and Bridge, County Welfare, County Bond and Interest, <i>A. & C. sinking</i>	27081 14364 48352 11850 1927	71629 37993 127893 29228 5096	27259 14458 48670 11123 1939	879 466 1569 359 63					
Town Revenue, Town Road and Bridge, Town Drag, Town State Loan, <i>Town Home</i>	6069 5780 463 4817 4817	16054 15277 2548 12741 12741	6109 5818 970 4849 4849	197 188 31 156 156					
School Local 1 Mil., School Special, School State Loan, Deficiency, Tuition, Transportation, C.O.	764 35801 60154 1445 8457	2549 83192 159109 3822 22373	970 30997 60548 1454 8514	31 781 1952 47 275					
	240605	620943	235321	7334					

	LOCAL 1 MILL	SPECIAL	STATE LOAN	Deficiency	Transport.	C. O.	TOTALS
MARCH SETTLEMENT							
School District No. <i>G#30</i> <i>A#30</i>	495 469	12369 23432		30892 29262	742 703	4344 4115	48892 57981
Totals	964	35801		60154	1445	8459	106823
JUNE SETTLEMENT							
School District No. <i>G#30</i> <i>A#30</i>	1769 780	44216 38976		110434 48675	2653 1169	15529 6844	174601 96444
Totals	2549	83192		159109	3822	22373	271045
NOVEMBER SETTLEMENT							
School District No. <i>G#30</i> <i>A#30</i>	700 270	17489 13508		43680 16868	1049 405	6142 2372	69060 33423
Totals	970	30997		60548	1454	8514	102493
NOVEMBER to JANUARY							
School District No. <i>G#30</i>	31	781		1952	47	275	3086
Totals	31	781		1952	47	275	3086
ADDITIONS							
School District No.							
Totals							
REDUCTIONS							
School District No.							
Totals							

Assessment Roll and Tax List of Real Property in the Town of Ponts Lake

Cass County, Minnesota, for Taxes for the Year 1954.

*Indicate Type of Property: R-Residential, C-Commercial, I-Industrial, U-Utility, F-Farm

IN WHOSE NAME ASSESSED	TO WHOM TRANSFERRED	DESCRIPTION OF PROPERTY					TRUE AND FULL VALUATIONS					ASSESSED VALUATIONS					FINAL EQUALIZED VALUE	SOLD FOR TAXES	VALUATIONS BY SCHOOL DISTRICTS AS EQUALIZED BY DEPARTMENT OF TAXATION						Tax Including State Homestead	State Tax on Non-Homestead	SPECIAL TAXES	TOTAL TAXES	PAID	WHEN PAID	Number of Receipt	March Settlement 1955	June Settlement 1955	Penalty	November Settlement 1955	Penalty	Collections to First Monday in January 1956	Penalty	Delinquent on First Monday in January 1956	Total Delinquent Tax and Penalty	REMARKS					
		SUBDIVISION	Sec. or Lot	Town or Block	Rng	Number of Acres of Land	LAND Exclusive of Structures and Improvements	BUILDINGS and Other Structures	MACHINERY Permanently Attached to Real Estate	TOTAL True and Full Value	RURAL		ALL OTHER		MACHINERY Permanently Attached to Real Estate	TOTAL ASSESSED VALUE			Total Assessed Value as Equalized by the Board of Review	District No. 30	District No. 20	District No. 10	District No. 5	District No. 1																		District No. 0				
											Homestead Up to \$4,000 20%	Over \$4,000 and Non-Homestead 33 1/3%	Homestead Up to \$4,000 25%	Over \$4,000 and Non-Homestead 40%																													Dollars	Dollars	Dollars	Dollars
											Acres	10ths	Dollars	Dollars																													Dollars	Dollars	Dollars	Dollars
Mary P. Udine	Theodore O. & Alice C. Sommer	NE 1/4 of NE 1/4	2	139.29	35.75	30 yrs	T	160					32		1	# 32							744			744	1	PAID IN FULL OCT 20 1955																		
R. L. Udine	"	NW 1/4 of NE 1/4	"	"	35.25	"	T	160					32		2	# 32							744			744	2	PAID IN FULL OCT 25 1955																		
"	"	SW 1/4 of NE 1/4	"	"	40	"	T	130					26		3	# 26							604			604	3	PAID IN FULL OCT 29 1955																		
Mary P. Udine	"	SE 1/4 of NE 1/4	"	"	40	"	T	160					32		4	# 32							744			744	4	PAID IN FULL OCT 20 1955																		
A. J. Udine	"	NE 1/4 of NW 1/4	"	"	34.75	"	T	225					55		6	# 55							1280			1280	6	PAID IN FULL OCT 29 1955																		
"	"	NW 1/4 of NW 1/4	"	"	34.25	"	T	255					51		7	# 51							1186			1186	7	PAID IN FULL OCT 29 1955																		
"	"	SW 1/4 of NW 1/4	"	"	40	"	F	400					80		8	# 80							1862			1862	8	PAID IN FULL OCT 29 1955																		
"	"	SE 1/4 of NW 1/4	"	"	40	"	F	310	325				127		9	# 127							2954			2954	9	PAID IN FULL OCT 29 1955																		
Chester W. & Lucille M. Siltman	"	NE 1/4 of SW 1/4	"	"	40	"	T	105					21		11	# 21							488			488	11	PAID IN FULL MAY 27 1955	5979																	
Theo. Oscar & Alice E. Sommer	"	NW 1/4 of SW 1/4	"	"	40	"	F	185	380				113		12	# 113							2628			2628	12	PAID IN FULL OCT 29 1955	15106																	
Chester W. & Lucille M. Siltman	"	SW 1/4 of SW 1/4 of 316 links	"	"	39	"	F	165	220				77		13	# 77							1792			1792	13	PAID IN FULL MAY 27 1955	5979																	
"	"	SE 1/4 of SW 1/4	"	"	40	"	F	200					40		14	# 40							930			930	14	PAID IN FULL MAY 27 1955	5979																	
Clara C. Wierick	"	SE 1/4 of SW 1/4 of 316 links of W. 316 links of SW 1/4	"	"	1	"	R	15	125				28		15	# 28							722			722	15	PAID IN FULL FEB 2 1955	344	722																
Carl Anderson	Theodore O. & Alice C. Sommer	NE 1/4 of SE 1/4 Lot 3	"	"	44.15	70 yrs	T	351					117		16	# 117							2722	62		2784	16	PAID IN FULL OCT 29 1955	15106																	
R. L. Udine	"	NW 1/4 of SE 1/4 Lot 4	"	"	38.40	70 yrs	T	280					56		17	# 56							1302			1302	17	PAID IN FULL OCT 29 1955																		
Chester W. & Lucille M. Siltman	"	SW 1/4 of SE 1/4 Lot 5	"	"	41.05	"	T	180					36		18	# 36							838			838	18	PAID IN FULL MAY 27 1955	5979																	
		SE 1/4 of SE 1/4													19																															
															20																															
					583.60			3931	1050				4981	806	117		# 78 = 806	# 28 = 117					2081.8	62		21622	722	4048	16832																	
																# 28 = 806	# 28 = 117						722																							
																28	923						21540																							

Camp Blariche
Pine Camp
of Ponts Lake
Sprague Beach
of East Shore
La Pine

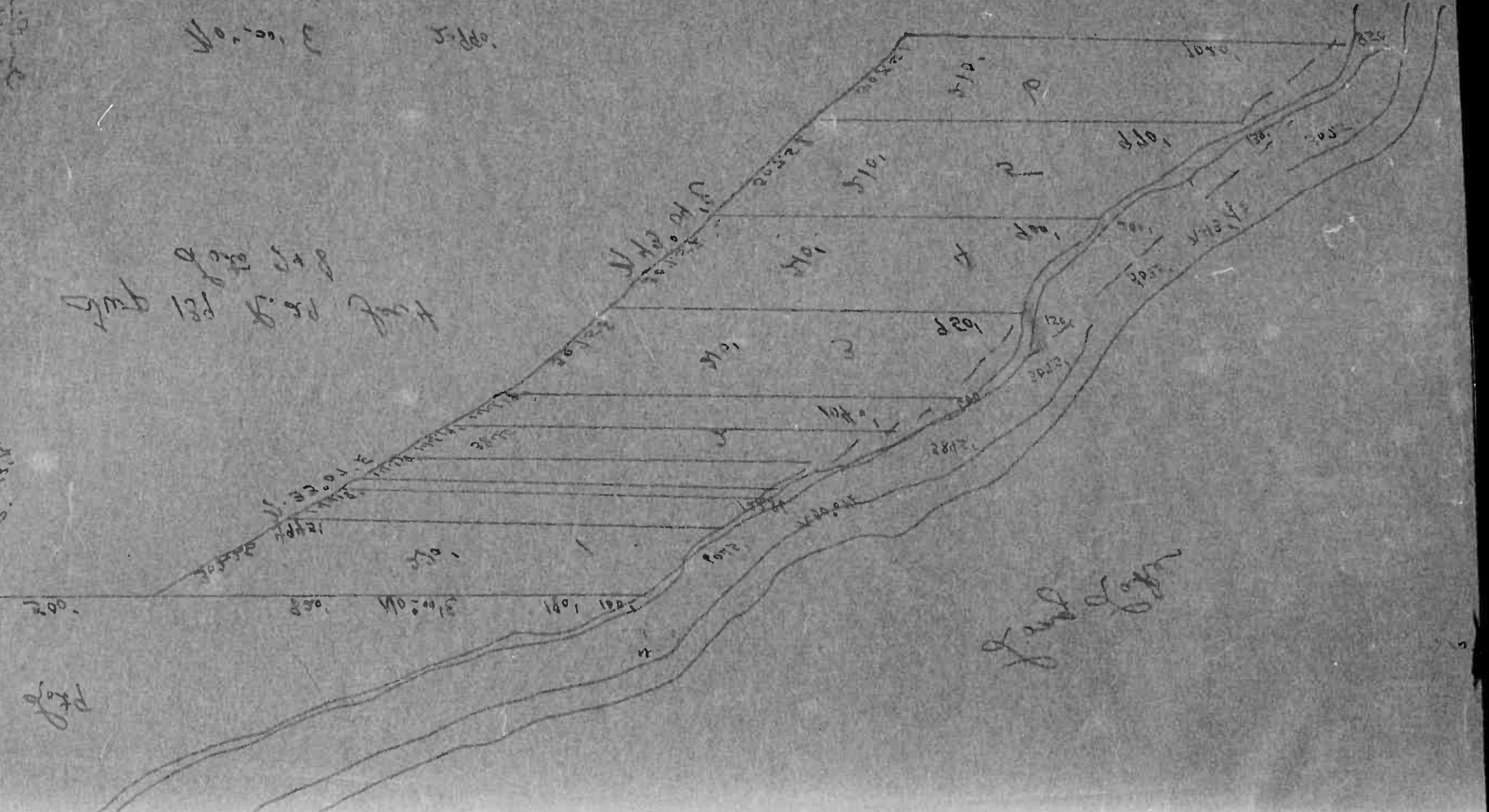

Assessment Roll and Tax List of Real Property in the County of Woods Lake, State of Minnesota

Cass County, Minnesota, for Taxes for the Year 1954.

IN WHOSE NAME ASSESSED	TO WHOM TRANSFERRED	DESCRIPTION OF PROPERTY				TRUE AND FULL VALUATIONS										FINAL EQUALIZED VALUE	SOLD FOR TAXES	VALUATIONS BY SCHOOL DISTRICTS AS EQUALIZED BY DEPARTMENT OF TAXATION						State Tax on Non-Homestead	SPECIAL TAXES	TOTAL TAXES	PAID	WHEN PAID	Number of Receipt	March Settlement 1955	June Settlement 1955	November Settlement 1955	Collections to First Monday in January 1956	Delinquent on First Monday in January 1956	Total Delinquent Tax and Penalty	REMARKS
		Subdivision	Sec. or Lot	Town or Block	Reg.	Number of Acres of Land	LAND Exclusive of Structures and Improvements	BUILDINGS and Other Structures	MACHINERY Permanently Attached to Real Estate	TOTAL True and Full Value	RURAL Homestead 20%	Over \$1,000 and Non-Homestead 33 1/3%	ALL OTHER Homestead 25%	Over \$1,000 and Non-Homestead 40%	MACHINERY Permanently Attached to Real Estate 33 1/3%			TOTAL ASSESSED VALUE	District No.	Rate	District No.	Rate	District No.													
Roy W. Kathryn M. & David Snodgrass		NE 1/4 of NE 1/4	Lot 1	4	139.29	27.45	30	70	C	2.00	345.44	1.50	6.95	7.0	11.5	1.85	1	115	115	47.06	60	47.66	1	2nd Half Paid MAY 31 1955	10237	24.13		24.13								
State of Minnesota		NE 1/4 of NE 1/4	Lot 2													2						2														
Ralph & Helen Cipriani		12 ac. of Lot 6			12		70		T	60			60		2.0	2.0	3	20		4.66	10	4.76	3	PAID IN FULL MAY 31 1955	10595		4.76									
Roy W. Kathryn M. & David Snodgrass		SE 1/4 of NE 1/4			40		70		T	160			160		3.2	3.2	4	32		7.44		7.44	4	2nd Half Paid AUG 2 1955	10595		3.72		3.72							
"		Lot 6 less 12 ac.							T	55			55		1.1	1.1	5	11		2.56		2.56	5	1st Half Paid MAY 31 1955	10237		1.28		1.28							
Melvin H. Johnson & Leta M. McAllister		W. 306' of Lot 9 (about 4 ac.)			5.50		70		R	1.04	35.2		45.6		1.52	1.52	6	15.2		35.36	80	36.16	6	PAID IN FULL MAY 31 1955	10597		36.16									
State of Minnesota		SW 1/4 of NE 1/4	Lot 3													7							7													
E. G. & Agnes B. Walkerson		SW 1/4 of NE 1/4	Lot 4		50.25				T	246			246		8.2	8.2	8	82		19.08	42	19.50	8	2nd Half Paid OCT 31 1955	10597		9.75		9.75							
State of Minnesota		302.25' x 1100' of lots 5 & 6														9							9													
William V. & M. S. Gray		302.25' x 1100' of lots 7 & 8			4				R	60	1.02		162		5.4	5.4	10	54		12.56	28	12.84	10	PAID IN FULL MAY 31 1955	10593		12.84									
Oliver T. & Vivian L. Price		507.5' x 950' of lot 7 (part of plat)			5				L	75	1.26		201		6.7	6.7	11	67		15.54	34	15.92	11											15.92		
Frank J. & Caroline Harris		307.5' x 970' of lot 7 (part of plat)			5				L	75	1.50		225		7.5	7.5	11	75		17.44	40	17.84	12	PAID IN FULL FEB 5 1955	609		17.84									
Edith Margaret & Carl Edward Sandberg		307.5' x 1010' of lot 7 (part of plat)			5				R	75	1.14		186		6.2	6.2	13	62		14.42	32	14.74	13	PAID IN FULL FEB 1 1955	1298		14.74									
State of Minnesota		SW 1/4 of SW 1/4														14							14													
William V. & M. S. Gray		744' x 970' of lots 7 & 8 (part of plat)			1.87				T	42			42		1.4	1.4	15	14		3.26	08	3.34	15	PAID IN FULL MAY 31 1955	10593		3.34									
Marland D. & Monica J. Hart		NE 1/4 of SE 1/4			40		70		T	130			130	2.6	2.6	16	26		6.04		6.04	16	PAID IN FULL MAY 2 1955			6.04										
"		SW 1/4 of SE 1/4			40				T	40			40	8	8	17	8		1.86		1.86	17	PAID IN FULL MAY 24 1955	1322		1.86										
"		SW 1/4 of SE 1/4			40				T	150			150	3.0	3.0	18	30		6.98		6.98	18	PAID IN FULL MAY 2 1955			6.98										
"		SE 1/4 of SE 1/4			40		70		T	132			132	4.4	4.4	19	44		10.24	22	10.46	19	2nd Half Paid OCT 1 1955	1430		5.23		5.23								
Ethel Clodfelder					40				T	132			132	4.4	4.4	19	44		10.24	22	10.46	19	1st Half Paid MAY 31 1955	1034		5.23										
					296.09					1604	123.6		2940	177	68.5	86.2				47.06	356	208.70				116.07		44.11					15.92			

Assessment Roll and Tax List of Real Property in the Town of Pont Lake

*Indicate Type of Property: R-Residential, C-Commercial, I-Industrial, U-Utility, F-Farm

Table with columns: IN WHOSE NAME ASSESSED, TO WHOM TRANSFERRED, SUBDIVISION, TRUE AND FULL VALUATIONS, ASSESSED VALUATIONS, and FINAL EQUALIZED VALUE. Includes entries for Dorsey, Wm. H. Dorsey, Mary E. Dorsey, Elmer & Ada Doty, Vern & Elva Keep, Lela & Lee Reynolds, and State of Minnesota.

Cass County, Minnesota, for Taxes for the Year 1954.

Table with columns: SOLD FOR TAXES, VALUATIONS BY SCHOOL DISTRICTS AS EQUALIZED BY DEPARTMENT OF TAXATION, Tax Including State Homestead, State Tax on Non-Homestead, SPECIAL TAXES, TOTAL TAXES, PAID, WHEN PAID, Number of Receipt, March Settlement 1955, June Settlement 1955, Penalty, November Settlement 1955, Collections to First Monday in January 1956, Delinquent on First Monday in January 1956, Total Delinquent Tax and Penalty, and REMARKS. Includes entries for various property owners and their tax payment details.

Assessment Roll and Tax List of Real Property in the Town of Pointe Lake,
*Indicate Type of Property: R-Residential, C-Commercial, I-Industrial, U-Utility, F-Farm

Table with columns: IN WHOSE NAME ASSESSED, TO WHOM TRANSFERRED, DESCRIPTION OF PROPERTY, TRUE AND FULL VALUATIONS, ASSESSED VALUATIONS, FINAL EQUALIZED VALUE. Includes entries for C.R. Peterson, Erwin Holz, C.B. Peterson, Elwyn & Dorothy Siltman, State of Minnesota, and Carl & Minnie Holz.

Cass County, Minnesota, for Taxes for the Year 1954.

Table with columns: SOLD FOR TAXES, VALUATIONS BY SCHOOL DISTRICTS AS EQUALIZED BY DEPARTMENT OF TAXATION, Tax including State Homestead, State Tax on Non-Homestead, SPECIAL TAXES, TOTAL TAXES, PAID, WHEN PAID, Number of Receipt, March Settlement 1955, June Settlement 1955, November Settlement 1955, Penalty, Collections to First Monday in January 1956, Delinquent on First Monday in January 1956, Total Delinquent Tax and Penalty, REMARKS. Includes handwritten entries for payments and cancellations.

*Indicate Type of Property: R-Residential, C-Commercial, I-Industrial, U-Utility, F-Farm

Table with columns: IN WHOSE NAME ASSESSED, TO WHOM TRANSFERRED, DESCRIPTION OF PROPERTY, TRUE AND FULL VALUATIONS, ASSESSED VALUATIONS, VALUATIONS BY SCHOOL DISTRICTS AS EQUALIZED BY DEPARTMENT OF TAXATION, TAX INCLUDING STATE HOMESTEAD, SPECIAL TAXES, TOTAL TAXES, PAID, WHEN PAID, Number of Receipt, March Settlement 1955, June Settlement 1955, Penalty, November Settlement 1955, Penalty, Collections to First Monday in January 1956, Penalty, Delinquent on First Monday in January 1956, Total Delinquent Tax and Penalty, REMARKS.

(Continued on next page)

Camp Blatchford, Pine Camp, Pointe Pointe, Pease Beach, East Shore, La Pine

Assessment Roll and Tax List of Real Property in the Town of Pointe Lake

*Indicate Type of Property: R-Residential, C-Commercial, I-Industrial, U-Utility, F-Farm

Table with columns: IN WHOSE NAME ASSESSED, TO WHOM TRANSFERRED, DESCRIPTION OF PROPERTY, TRUE AND FULL VALUATIONS, ASSESSED VALUATIONS, FINAL EQUALIZED VALUE. Includes handwritten entries for Metzger Clothing, Joyce C. Hangan, Donald J. Lindquist, etc.

Continued on next page

Cass County, Minnesota, for Taxes for the Year 1954.

Table with columns: SOLD FOR TAXES, VALIDATIONS BY SCHOOL DISTRICTS AS EQUALIZED BY DEPARTMENT OF TAXATION, Tax including State Homestead, State Tax on Non-Homestead, SPECIAL TAXES, TOTAL TAXES, PAID, WHEN PAID, Number of Receipt, March Settlement 1955, June Settlement 1955, November Settlement 1955, Collections to First Monday in January 1956, Delinquent on First Monday in January 1956, Total Delinquent Tax and Penalty, REMARKS. Includes handwritten entries for various tax payments and dates.

Camp Blanche, Pine Camp, Pointe Lake, Spanish Beach, East Shore, La Pine Beach

Assessment Roll and Tax List of Real Property in the Town of Ponto Lake

*Indicate Type of Property: R-Residential, C-Commercial, I-Industrial, U-Utility, F-Farm

Cass County, Minnesota, for Taxes for the Year 1954.

Table with columns: IN WHOSE NAME ASSESSED, TO WHOM TRANSFERRED, DESCRIPTION OF PROPERTY, TRUE AND FULL VALUATIONS, ASSESSED VALUATIONS, VALUATIONS BY SCHOOL DISTRICTS AS EQUALIZED BY DEPARTMENT OF TAXATION, TAX INCLUDING STATE HOMESTEAD, SPECIAL TAXES, TOTAL TAXES, PAID, WHEN PAID, Number of Receipt, March Settlement 1955, June Settlement 1955, Penalty, November Settlement 1955, Penalty, Collections to First Monday in January 1956, Penalty, Delinquent on First Monday in January 1956, Total Delinquent Tax and Penalty, REMARKS.

Camp Blanche
Ponto Lake
of East Shore
La Pine Beach

Assessment Roll and Tax List of Real Property in the Town of Pointe Lake

*Indicate Type of Property: R-Residential, C-Commercial, I-Industrial, U-Utility, F-Farm

Cass County, Minnesota, for Taxes for the Year 1954.

Camp Blanche

IN WHOSE NAME ASSESSED	TO WHOM TRANSFERRED	DESCRIPTION OF PROPERTY					TRUE AND FULL VALUATIONS				ASSESSED VALUATIONS					FINAL EQUALIZED VALUE		
		Subdivision	Sec. or Lot	Town or Block	Reg.	Number of Acres of Land	LAND Exclusive of Structures and Improvements	BUILDINGS and Other Structures	MACHINERY Permanently Attached to Real Estate	TOTAL True and Full Value	RURAL		ALL OTHER		MACHINERY Permanently Attached to Real Estate		TOTAL ASSESSED VALUE	Total Assessed Value as Equalized by the Board of Review
											Acres	1000s	Homestead Up to \$1,000 20%	Over \$4,000 and Non-Homestead 33 1/3%				
Chas. F. & Blanche Almendinger		Camp Blanche (all of lot 5 Sec 3 R 139-24)	1	1					20					8	8			
"	"	"	2	2					30					12	12			
"	"	"	3	2					30					12	12			
"	"	"	4	3					30					12	12			
"	"	"	5	4					30					12	12			
"	"	"	6	5			1909		36				94	94				
"	"	"	7	6					30				12	12				
"	"	"	8	7					30				12	12				
Otto W. & Kate Abel			9	8			10000		40	4364		119	40	169	169			
"	"	S. 393' of blk	10	1					30				12	12				
Harry G. & Myrtle R. Stultz		1/2 of lot 11 St. lying between H. & Dora C. Babb's	11	9	2				80	455		214		214	214			
"	"	"	12	1	2				60			24		24	24			
Harry G. & Myrtle R. Stultz		1/2 of lot 11 St. lying adjacent to lot 9	15						5			2		2	2			
Otto W. & Kate Abel		16.48 1/2 of lot 11 St. lying adjacent to lot 11	16						16		4		4	4	4			
Charles F. & Blanche M. Almendinger		1/2 of 1st St. all 1st ave.	17						40		16		16	16	16			
Laurence Wiener		S. 143' of block 1	18						8	68		19		19	19			
			19															
			20															
									515	1358		1773		142	4824	624		

SOLD FOR TAXES	VALUATIONS BY SCHOOL DISTRICTS AS EQUALIZED BY DEPARTMENT OF TAXATION						Tax including State Homestead	State Tax on Non-Homestead	SPECIAL TAXES	TOTAL TAXES	PAID	WHEN PAID	Number of Receipt	March Settlement 1955	June Settlement 1955	Penalty	November Settlement 1955	Penalty	Collections to First Monday in January 1956	Penalty	Delinquent on First Monday in January 1956	Total Delinquent Tax and Penalty	REMARKS
	District No.	District No.	District No.	District No.	District No.	District No.																	
	Rate	Rate	Rate	Rate	Rate	Rate																	
1							206	04		210	1	PAID IN FULL MAY 31 1955	10695		210								
2							310	06		316	2	1st Half Paid OCT 11 1955		158		158							
3							310	06		316	3	1st Half Paid MAY 31 1955		158		158							
4							310	06		316	4	2nd Half Paid OCT 11 1955	10694		158		158						
5							310	06		316	5	1st Half Paid MAY 31 1955	14006		158		158						
6							2422	50		2472	6	2nd Half Paid OCT 11 1955	14006		1236		1236						
7							310	06		316	7	1st Half Paid MAY 31 1955	10694		158		158						
8							310	06		316	8	2nd Half Paid OCT 11 1955	14006		158		158						
9							4096	20		4116	9	1st Half Paid MAY 12 1955	5620		2058		2058						
10							310	06		316	10	2nd Half Paid OCT 5 1955	13941				316						
11							5514	112		5626	11	1st Half Paid MAY 31 1955	1123		2813		2813						
12							618	120		630	12	2nd Half Paid AUG 2 1955	10696		315		315						
13											13												
14											14												
15							52	-		52	15	1st Half Paid MAY 31 1955	10696		26		26						
16							104			104	16	2nd Half Paid OCT 5 1955	13940		52		52						
17							412	08		420	17	PAID IN FULL MAY 31 1955	10695		420		420						
18							490			490	18	PAID IN FULL MAY 12 1955	5619		490		490						
19											19												
20											20												
							16084	248		16332					8568		7764						

Pointe North Shore Kline Camp Pointe Point Repanes Beach of East Shore Ma Pine Beach

Assessment Roll and Tax List of Real Property in the Town of Ponto Lake

Indicate Type of Property: R-Residential, C-Commercial, I-Industrial, U-Utility, F-Farm

Table with columns: IN WHOSE NAME ASSESSED, TO WHOM TRANSFERRED, SUBDIVISION, DESCRIPTION OF PROPERTY, TRUE AND FULL VALUATIONS, ASSESSED VALUATIONS, FINAL EQUALIZED VALUE.

Cass County, Minnesota, for Taxes for the Year 1954.

Table with columns: VALUATIONS BY SCHOOL DISTRICTS AS EQUALIZED BY DEPARTMENT OF TAXATION, Tax including State Homestead, State Tax on Non-Homestead, SPECIAL TAXES, TOTAL TAXES, PAID, WHEN PAID, Number of Receipt, March Settlement 1955, June Settlement 1955, November Settlement 1955, Collections to First Monday in January 1955, Delinquent on First Monday in January 1955, Total Delinquent Tax and Penalty, REMARKS.

Camp Blanche, Kinne Camp, Ponto Point

Ponto North Shore, Shady Wood Shore, Snodgrass, Narpane Beach, East Shore, 2nd Addn, Ka Pine Beach

Assessment Roll and Tax List of Real Property in the Town of Ponto Lake

*Indicate Type of Property: R-Residential, C-Commercial, I-Industrial, U-Utility, F-Farm

Cass County, Minnesota, for Taxes for the Year 1954.

Table with columns: IN WHOSE NAME ASSESSED, TO WHOM TRANSFERRED, SUBDIVISION, TRUE AND FULL VALUATIONS, ASSESSED VALUATIONS, VALUATIONS BY SCHOOL DISTRICTS AS EQUALIZED BY DEPARTMENT OF TAXATION, TAX INCLUDING STATE HOMESTEAD, STATE TAX ON NON-HOMESTEAD, SPECIAL TAXES, TOTAL TAXES, PAID, WHEN PAID, Number of Receipt, March Settlement 1955, June Settlement 1955, Penalty, November Settlement 1955, Penalty, Collections to First Monday in January 1956, Delinquent on First Monday in January 1956, Total Delinquent Tax and Penalty, REMARKS.

Camp Blanche

Kinne Camp

Ponto Point

Napance Beach

Ponto North Shore

Shady Wood Shore Snodgrass 1st Adm. to East Shore

Plat of East Shore Via Pine Beach

