

TOWN OF PINE RIVER

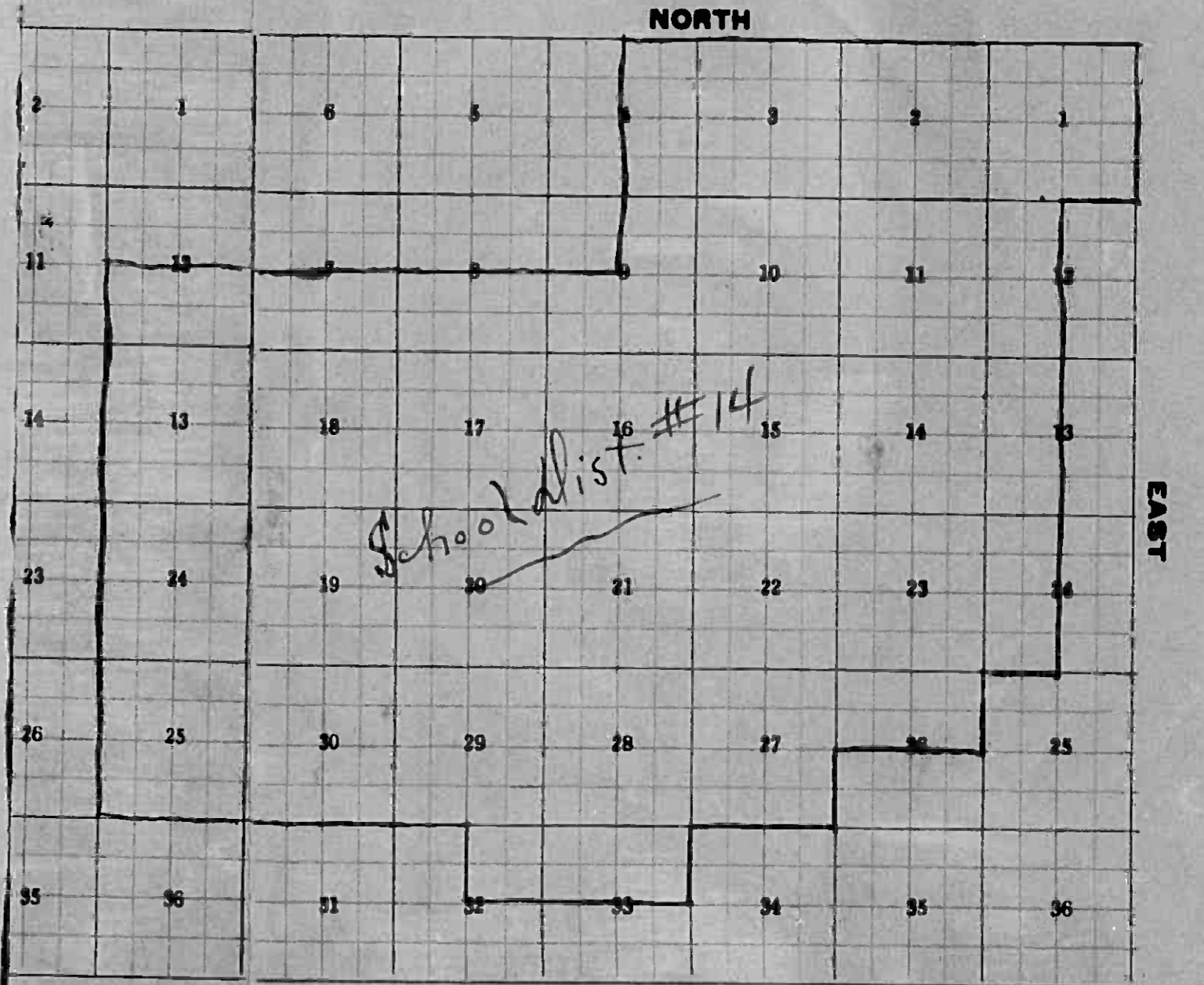

Range 31 of \_\_\_\_\_ Township 138 Range 30

Lands shaded belong to \_\_\_\_\_



Railroads \_\_\_\_\_ 
 Mills\* 
 Marshes 
 Railroads



Auditor's Office, Cass County, Minnesota.

I, C. D. Bacon Auditor of Cass County, and  
State of Minnesota, do hereby certify that the following is a correct list of the Taxes levied on the Real and Personal  
Property in the Town of Pine River for the year 1915 (L. S.)

WITNESS my hand and official seal this 3 day of January 1916  
C. D. Bacon County Auditor.

Treasurer's Office, Cass County, State of Minnesota.

RECEIVED this, the first Monday (being the 3 day) of January, A. D. 1916, of C. D. Bacon  
Auditor of Cass County, Minnesota, the Tax List of all taxable Real and Personal Property in the Town  
of Pine River in said County of Cass for the year A. D. 1915, as specified above, and  
amounting to ninety seven hundred fifty four  $\frac{65}{100}$  Dollars.

W. J. McKeown  
Treasurer of Cass County.







State of Minnesota,

County of CASS CO.

OFFICE OF COUNTY TREASURER

Walker, Minn. Jan. 1 1917

To C. D. Bacon County Auditor:

SIR:—I herewith return to you the Tax List for the Towns of Pine River & Barclay in said CASS CO. County, for the year 1915 heretofore received from you. I certify that I have compared the same with the duplicate receipts in your office, and have written opposite the amount of each tax so received the words "One-Half Paid" or "Paid in Full" as the case may be, and the number of my receipt given in discharge of said Tax, and each tract or lot of Real Property against which the Taxes remain unpaid is delinquent for said year.

Yours respectfully,

W. J. McKeown  
County Treasurer.

Walker, Minn. Jan. 2 1917

Auditor's Office, Cass County, Minn.

RECEIVED OF W. J. McKeown County Treasurer, the Tax List for the Towns of Pine River & Barclay in said County of Cass for the year 1915.

C. D. Bacon  
County Auditor.  
E. O.



Tax List of Real Property in the Town of Pine River

Cass County, Minnesota, for Taxes of the Year 1915

IN WHOSE NAME ASSESSED	TO WHOM TRANSFERRED	Sold for Taxes	SUBDIVISION	Sec. or Lot	Town or Block	No. of Acres	VALUATION	GENERAL TAXES			Ditch No.	SCHOOL DISTRICT			TOTAL TAXES	PAID	WHEN PAID	No. of Receipt	March Settlement	June Settlement	Penalty	November Settlement	Penalty	Collections to First Monday in January	Penalty	Delinquent on First Monday in January	REMARKS		
								State	County	Local		District No.	District No.	Rate														Rate	Rate
								\$	cts.	\$		cts.	\$	cts.														\$	cts.
Footings Brought Forward,																													
James E. Foley Winifred T. Rothchild			NE 1/4 of NE 1/4	4	138	29	40	168							918	Paid in Full	MAR 13 1916	2175		918									
"			NW 1/4 of NE 1/4	40			40	336							1836	Paid in Full	APR 28 1916	2972		1836									
M. D. O'Brien & Jas. King			SW 1/4 of NE 1/4	40			40																						
"			SE 1/4 of NE 1/4	40			40	168							918	Paid in Full	MAY 31 1916	6956		918									
J. E. Andrews Chas. Westfall	John J. Marsh		NE 1/4 of NW 1/4	40			40	168							918	Paid in Full	MAY 19 1916	3793		918									
"	"		NW 1/4 of NW 1/4	40			40																						
"	"		SW 1/4 of NW 1/4	40			40	529							2891	Paid in Full	MAY 31 1916	5870		2891									
"	"		SE 1/4 of NW 1/4	40			40																						
Frances S. Moulster Wm E. White			3 acres of lot 6	3			3	39							213	Paid in Full	MAY 31 1916	5475		213									
"			NE 1/4 of SW 1/4	40			40																						
"			NW 1/4 of SW 1/4	40			40	751							4104	✓		5706									4720 Paid subsequent to Cert. No. 3774		
"			SE 1/4 of SW 1/4	40			40																						
Geo. Moulster J. J. Buckman & Co. Wm E. White			Lot 5	36			36	60																					
"			4 acres of Lot 6	4			4	65							355	✓	10744												
"			NE 1/4 of SE 1/4	26			26	12	110						602	Paid in Full	APR 5- 1916	2468		602									
"			NW 1/4 of SE 1/4	56			56	75	266						1454	✓		5707									1672 Paid subsequent to Cert. No. 3775		
"			SW 1/4 of SE 1/4																										
"			SE 1/4 of SE 1/4																										
Latherine Kline			4 acres of Lot 6	4			4	39							213	Paid in Full	APR 7- 1916	2505		213									
Footings Carried Forward,																													
57047 2639 14422																													



# Tax List of Real Property in the Town of Pine River

# Cass County, Minnesota, for Taxes of the Year 1915

IN WHOSE NAME ASSESSED	TO WHOM TRANSFERRED	Sold for Taxes	SUBDIVISION	Sec. or Lot	Town or Block	No. of Acres	VALUATION	GENERAL TAXES				SCHOOL DISTRICT				TOTAL TAXES	PAID	WHEN PAID	No. of Receipt	March Settlement	June Settlement	Penalty	November Settlement	Penalty	Collections to First Monday in January	Penalty	Delinquent on First Monday in January	REMARKS
								State	Mills	State	Ditch	District No.	District No.	Rate	Rate													
			Footings Brought Forward,																									
James Westfall			NE 1/4 of NE 1/4	5	13829	40	872																					
"			NW 1/4 of NE 1/4			40																						
"			SW 1/4 of NE 1/4			40																						
"			SE 1/4 of NE 1/4			40																						
J. J. Edwards			NE 1/4 of NW 1/4			40	168																					
"			NW 1/4 of NW 1/4			40																						
"			SW 1/4 of NW 1/4			40	570																					
"			SE 1/4 of NW 1/4			40																						
Conservation Co.			NE 1/4 of SW 1/4			40	336																					
"			NW 1/4 of SW 1/4			40																						
Geo. W. Ruscoe			SW 1/4 of SW 1/4			40	168																					
Conservation Co.			SE 1/4 of SW 1/4			40	168																					
J. Goodman			NE 1/4 of SE 1/4			40																						
"			NW 1/4 of SE 1/4			40	504																					
"			SW 1/4 of SE 1/4			40																						
Jessie Munroe Westfall			SE 1/4 of SE 1/4			40	168																					
			Footings Carried Forward,			640	29544																					

1st Half Paid OCT 21 1916 8277  
 476 57s Half Paid MAY 31 1916 6155

2nd Half Paid OCT 21 1916 8277  
 918 1s Half Paid MAY 31 1916 6155

3116 Paid in Full MAY 31 1916 5708

2nd Half Paid OCT 28 1916 8764  
 1836 1s Half Paid MAY 31 1916 5620

2nd Half Paid OCT 28 1916 8764  
 918 1s Half Paid MAY 31 1916 5620  
 2nd Half Paid OCT 28 1916 8764  
 918 1s Half Paid MAY 31 1916 5620

Bal Paid May 30 1917 6596  
 2754 1st Half Paid MAY 30 1916 4938

1st Half Paid OCT 21 1916 8277  
 918 1s Half Paid MAY 31 1916 6155

2382

2383

459

459

3116

918

918

459

459

459

459

1377

1377

459

459

16143



Tax List of Real Property in the Town of Pine River

Cass County, Minnesota, for Taxes of the Year 1915

IN WHOSE NAME ASSESSED	TO WHOM TRANSFERRED	Sold for Taxes	SUBDIVISION	Sec. or Lot	Town or Block	No. of Acres	VALUATION	GENERAL TAXES			Ditch No.	SCHOOL DISTRICT		TOTAL TAXES	PAID	WHEN PAID	No. of Receipt	March Settlement	June Settlement	Penalty	November Settlement	Penalty	Collections to First Monday in January	Penalty	Delinquent on First Monday in January	REMARKS		
								State	County	Local		District No.	Rate														District No.	Rate
Footings Brought Forward,																												
H.A. Peterson	E.D. Hooley & Hill		NE 1/4 of NE 1/4	Lot 1	6 138 39	38 11	320																					
	"		NW 1/4 of NE 1/4	" 2		38 56																						
W.C. Yawkey			SW 1/4 of NE 1/4			40	168																					
J.C. Mays			SE 1/4 of NE 1/4			40	168																					
H.A. Peterson	E.D. Hooley & Hill		NE 1/4 of NW 1/4	" 3		26 85	114																					
W.S. Reid & W.A. Spurrier			NW 1/4 of NW 1/4	" 4		35	147																					
W.C. Yawkey			SW 1/4 of NW 1/4			40	336																					
			SE 1/4 of NW 1/4			40																						
J.H. Kimball	H.S. Gilbert		NE 1/4 of SW 1/4			40	168																					
	"		NW 1/4 of SW 1/4	" 6		44 16	353																					
Fred Chamberlain			SW 1/4 of SW 1/4			40																						
			SE 1/4 of SW 1/4			40	168																					
Conservation Co.			NE 1/4 of SE 1/4			40	168																					
W.C. Yawkey			NW 1/4 of SE 1/4			40	168																					
Fred Chamberlain			SW 1/4 of SE 1/4			40	168																					
J.C. Mays			SE 1/4 of SE 1/4			40	280																					
Footings Carried Forward,																												
						622 68	2726																					

14895



Tax List of Real Property in the Town of Pine River

Cass County, Minnesota, for Taxes of the Year 1915

IN WHOSE NAME ASSESSED	TO WHOM TRANSFERRED	Sold for Taxes	SUBDIVISION	Sec. or Lot	Town or Block	No. of Acres	VALUATION	GENERAL TAXES				Ditch No.	SCHOOL DISTRICT		TOTAL TAXES	PAID	WHEN PAID	No. of Receipt	March Settlement	June Settlement	Penalty	November Settlement	Penalty	Collections to First Monday in January	Penalty	Delinquent on First Monday in January	REMARKS
								State	County	Town	Local		District No.	District Rate													
Footings Brought Forward,																											
Jesse J. + Warren L. Hirst			NE 1/4 of NE 1/4	7	138	29	140	Error in Book for 1914																			
			NW 1/4 of NE 1/4																								
			SW 1/4 of NE 1/4																								
			SE 1/4 of NE 1/4																								
Leonard Sutton H. C. Campbell	Lulu Bugick		NE 1/4 of NW 1/4	40			168																				
			NW 1/4 of NW 1/4																								
			SW 1/4 of NW 1/4																								
			SE 1/4 of NW 1/4																								
Jesse J. + Warren L. Hirst H. C. Campbell Katherine Neubauer	Lulu Bugick		NE 1/4 of SW 1/4	40			168																				
			NW 1/4 of SW 1/4																								
			SW 1/4 of SW 1/4																								
			SE 1/4 of SW 1/4																								
Jesse J. + Warren L. Hirst " " N. O. Ry Co.			NE 1/4 of SE 1/4	40			336																				
			NW 1/4 of SE 1/4																								
			SW 1/4 of SE 1/4																								
			SE 1/4 of SE 1/4																								
Footings Carried Forward,																											

Abatement # 38857

10.55 Paid subsequent to Cert. No. 3779  
10.55 Paid subsequent to Cert. No. 3780



Tax List of Real Property in the Town of Pine River

Cass County, Minnesota, for Taxes of the Year 1915

IN WHOSE NAME ASSESSED	TO WHOM TRANSFERRED	Sold for Taxes	SUBDIVISION	Sec. or Lot	Town or Block	No. of Acres	VALUATION	GENERAL TAXES				SCHOOL DISTRICT		TOTAL TAXES	PAID	WHEN PAID	No. of Receipt	March Settlement	June Settlement	Penalty	November Settlement	Penalty	Collections to First Monday in January	Penalty	Delinquent on First Monday in January	REMARKS
								State	County	Town	Local	District No.	District Rate													
Footings Brought Forward,																										
James Westfall			NE 1/4 of NE 1/4			29.40	145																			
F. B. Dean			NW 1/4 of NE 1/4			40	145																			
E. Erickson			SW 1/4 of NE 1/4			40	140																			
Chas. Westfall			SE 1/4 of NE 1/4			40	140																			
J. C. Mayo			NE 1/4 of NW 1/4			40	150																			
Maudie Dyke			NW 1/4 of NW 1/4			40	300																			
H. O. Hills			SW 1/4 of NW 1/4			40																				
			SE 1/4 of NW 1/4			40	145																			
L. M. Mann Land Co.			NE 1/4 of SW 1/4			40	268																			
Maudie Dyke			NW 1/4 of SW 1/4			40																				
			SW 1/4 of SW 1/4			40	336																			
L. M. Mann Land Co.			SE 1/4 of SW 1/4			40	168																			
E. Erickson			NE 1/4 of SE 1/4			40	168																			
H. A. Peterson			NW 1/4 of SE 1/4			40	336																			
			SW 1/4 of SE 1/4			40																				
			SE 1/4 of SE 1/4			40																				
Footings Carried Forward,																										
						100	2841																			

James Westfall  
F. B. Dean  
E. Erickson  
Chas. Westfall

J. C. Mayo  
Maudie Dyke  
H. O. Hills

L. M. Mann Land Co.  
Maudie Dyke  
L. M. Mann Land Co.

E. Erickson  
H. A. Peterson  
Garey & Hilley

2nd Half Paid OCT 2 1 1916 8277  
 792 1st Half Paid MAY 31 1916 6155  
 792 Paid in Full MAY 17 1916 3617  
 766 Paid in Full MAY 31 1916 5826  
 766 Paid in Full MAY 31 1916 5870  
 820 Paid in Full MAY 27 1916 4486  
 1640 2nd Half Paid OCT 2 6 1916 8559  
 1st Half Paid MAY 27 1916 4513  
 792 ✓ 5710  
 918 2nd Half Paid OCT 31 1916 9419  
 1st Half Paid MAY 29 1916 4598  
 1836 2nd Half Paid OCT 2 6 1916 8559  
 4th Half Paid MAY 27 1916 4513  
 2nd Half Paid OCT 31 1916 9419  
 918 1st Half Paid MAY 29 1916 4598  
 918 Paid in Full MAY 31 1916 406  
 2nd Half Paid OCT 7 1916 7834  
 1836 Paid in Full 5 31 '16 6061

911 Paid subsequent to Cert. No. 3781

12794



Tax List of Real Property in the Town of Pine River

Cass County, Minnesota, for Taxes of the Year 1915

IN WHOSE NAME ASSESSED	TO WHOM TRANSFERRED	Sold for Taxes	SUBDIVISION	Sec. or Lot	Town or Block	Rag.	No. of Acres		VALUATION	GENERAL TAXES			Ditch No.	SCHOOL DISTRICT		TOTAL TAXES	PAID	WHEN PAID	No. of Receipt	March Settlement	June Settlement	Penalty	November Settlement	Penalty	Collections to First Monday in January	Penalty	Delinquent on First Monday in January	REMARKS												
							Acres	100ths		State	Mills	State		District No.	District No.														District Rate	District Rate										
									Dollars	\$	cts.	\$	cts.	\$	cts.	\$	cts.	Month	Day	Year	\$	cts.	\$	cts.	\$	cts.	\$	cts.	\$	cts.	\$	cts.								
Footings Brought Forward,																																								
Ham J. Hygatt	Henry A. McMillan		NE 1/4 of NE 1/4 Lot				9	138	29	25	55																													
"	"		NW 1/4 of NE 1/4					40			609																													
"	"		SW 1/4 of NE 1/4					40																																
"	"		SE 1/4 of NE 1/4			2		39	40																															
Morrison Bros.			NE 1/4 of NW 1/4					40			672																													
"			NW 1/4 of NW 1/4					40																																
"			SW 1/4 of NW 1/4					40																																
"			SE 1/4 of NW 1/4					40																																
C. A. Smith			NE 1/4 of SW 1/4					40			336																													
Harriet E. Jennings			NW 1/4 of SW 1/4					40																																
"			SW 1/4 of SW 1/4					40			336																													
"			SE 1/4 of SW 1/4					40																																
Ed Donahue	J. P. Brewer		NE 1/4 of SE 1/4					40			672																													
"	"		NW 1/4 of SE 1/4					40																																
"	"		SW 1/4 of SE 1/4					40																																
"	"		SE 1/4 of SE 1/4					40																																
Footings Carried Forward,																																								
							624	95	2625																															
															14344																									



Tax List of Real Property in the Town of Pine River

Cass County, Minnesota, for Taxes of the Year 1915

IN WHOSE NAME ASSESSED	TO WHOM TRANSFERRED	Sold for Taxes	SUBDIVISION	Sec. or Lot	Town or Block	No. of Acres	VALUATION	GENERAL TAXES				SCHOOL DISTRICT		TOTAL TAXES	PAID	WHEN PAID	No. of Receipt	March Settlement	June Settlement	Penalty	November Settlement	Penalty	Collections to First Monday in January	Penalty	Delinquent on First Monday in January	REMARKS		
								State Mills	County Mills	Town Mills	Ditch No.	District No.	District Rate															
			Footings Brought Forward,																									
First St. Park Pine River	Chas. E. Glover		NE 1/4 of NE 1/4			16 1/2	336																					
Chas. John Johnson	S. Frederick		NW 1/4 of NE 1/4			40	168																					
Thos. S. Aving			SW 1/4 of NE 1/4			40	168																					
John Warner Grover Jr.			SE 1/4 of NE 1/4			40	185																					
Mary L. Johnson			NE 1/4 of NW 1/4			40	361																					
John Warner Grover Jr.			NW 1/4 of NW 1/4			40	140																					
John Warner Grover Jr.			SW 1/4 of NW 1/4			40	545																					
Chas. John Johnson	S. Frederick		SE 1/4 of NW 1/4			40	140																					
Willard Rice			NE 1/4 of SW 1/4			40	545																					
"			NW 1/4 of SW 1/4			40	545																					
"			SW 1/4 of SW 1/4			40	545																					
Chas. John Johnson	S. Frederick		SE 1/4 of SW 1/4		Lot 1	37 45	545																					
Sylvester Proffit	Chris A. Emerson		NE 1/4 of SE 1/4			40	168																					
Chas. John Johnson	S. Frederick		NW 1/4 of SE 1/4			40	168																					
Tom Rivece			SW 1/4 of SE 1/4			32 75	328																					
H. Bangston			SE 1/4 of SE 1/4			40	328																					
			Footings Carried Forward,			132 20	2707																					

1896 Paid in Full APR 20 1916 2800  
 2nd Half Paid OCT 31 1916  
 1st Half Paid MAY 31 1916 1800

918 1st Half Paid MAY 31 1916 9538  
 2nd Half Paid OCT 31 1916 6494  
 1st Half Paid MAY 31 1916 918

1011 2nd Half Paid OCT 7 - 1916 7837  
 1st Half Paid MAY 31 1916 3760 506 505

1973 Paid in Full MAR 9 1916 2126  
 2nd Half Paid OCT 7 - 1916 7837  
 1st Half Paid MAY 31 1916 3760 1973 382 383

765 2nd Half Paid OCT 31 1916 9538  
 1st Half Paid MAY 31 1916 6494 383 385

2979 2nd Half Paid OCT 3 - 1916 7772  
 1st Half Paid MAY 31 1916 6496 1490 1489

918 Paid in Full OCT 31 1916 9242  
 2nd Half Paid OCT 31 1916 7538  
 1st Half Paid MAY 31 1916 6494 459 459

1792 2nd Half Paid OCT 31 1916 8464  
 1st Half Paid MAY 30 1916 4699 896 896

14793











Tax List of Real Property in the Town of Pine River

Cass County, Minnesota, for Taxes of the Year 1915

March 20th 1916

IN WHOSE NAME ASSESSED	TO WHOM TRANSFERRED	Sold for Taxes	SUBDIVISION	Sec. or Lot	Town or Block	No. of Acres	VALUATION	GENERAL TAXES			Ditch No.	SCHOOL DISTRICT		TOTAL TAXES	PAID	WHEN PAID	No. of Receipt	March Settlement	June Settlement	Penalty	November Settlement	Penalty	Collections to First Monday in January	Penalty	Delinquent on First Monday in January	REMARKS	
								State	County	Town		State	School														District No.
Footings Brought Forward,																											
Wm Franklin Guinnessett	Farmers State Bank Pine River		NE 1/4 of NE 1/4	19	138	29	40	185																			
Benjamin Shipper			NW 1/4 of NE 1/4			40		168																			
Robert H. Shipper			SW 1/4 of NE 1/4			40		168																			
Robert W. Shipper			SE 1/4 of NE 1/4			40		168																			
John O. Thompson	J. Brewer		NE 1/4 of NW 1/4			40		168																			
Edward B. Harmon			NW 1/4 of NW 1/4			40		168																			
"			SW 1/4 of NW 1/4			40		168																			
Clarence Riley			SE 1/4 of NW 1/4			40		176																			
Frank J. Beckford			NE 1/4 of SW 1/4			40		672																			
"			NW 1/4 of SW 1/4			40																					
"			SW 1/4 of SW 1/4			40																					
"			SE 1/4 of SW 1/4			40																					
Frank J. Hill			NE 1/4 of SE 1/4			40		672																			
W. A. Spurrier			NW 1/4 of SE 1/4			40																					
"			SW 1/4 of SE 1/4			40																					
Frank J. Hill			SE 1/4 of SE 1/4			40																					
Footings Carried Forward,																											
				6	40		271.9																				

10.11 Paid in Full DEC 1 1915 10194  
 918 Paid in Full Oct. 31 '16 9588  
 918 Paid in Full MAY 31 1916 9887  
 918 Paid in Full Oct. 31 '16 9589  
 918 Paid in Full FEB 29 1916 1676  
 918 Paid in Full DEC 20 1916 10476  
 918 Paid in Full DEC 20 1916 8213  
 96 Paid in Full MAY 31 1916 6731  
 3672 Paid in Full DEC 20 1916 10832  
 5123  
 5123  
 3672 Paid in Full OCT 24 1916 8473  
 1/2 SE 1/4 MAY 31 1916 6161  
 with DE  
 X 5322

11055 Paid subsequent to Cert. No. 2050  
 10.55 Paid subsequent to Cert. No. 2051

1836 11286

14824







Tax List of Real Property in the Town of Pine River

Cass County, Minnesota, for Taxes of the Year 1915

IN WHOSE NAME ASSESSED	TO WHOM TRANSFERRED	Sold for Taxes	SUBDIVISION	Sec. or Lot	Town or Block	No. of Acres	VALUATION	GENERAL TAXES			SCHOOL DISTRICT		TOTAL TAXES	PAID	WHEN PAID	No. of Receipt	March Settlement	June Settlement	Penalty	November Settlement	Penalty	Collections to First Monday in January	Penalty	Delinquent on First Monday in January	REMARKS
								State	Mills	State	Ditch No.	District No.													
Footings Brought Forward,																									
Lewis J. Hayden			NE 1/4 of NE 1/4	21	29	40	168																		
J. Greenwaldt			NW 1/4 of NE 1/4 Lot 8			40	386						918	Paid in Full	MAY 17 1916	368.3		918							
"			SW 1/4 of NE 1/4		7	14							2109	1st Half Paid	MAY 31 1916	306.5		1033		1054					
"			SE 1/4 of NE 1/4		6	29																			
"			NE 1/4 of NW 1/4		1	17																			
"			NW 1/4 of NW 1/4 Less 1 acre for school			39	464						2536	1st Half Paid	MAY 31 1916	306.5		1567		1268					
"			SW 1/4 of NW 1/4			40																			
"			SE 1/4 of NW 1/4		2	19																			
<del>Chleworth &amp; Jones</del>	W. A. Spurrer		NE 1/4 of SW 1/4		3	32	145						792	1st Half Paid	MAY 31 1916	306.5		396		396					
John Greenwaldt	"		NW 1/4 of SW 1/4			40	168						918	Paid in Full	APR 5 - 1916										
Al. Mastard	ella M. Moustier		SW 1/4 of SW 1/4			40	168						918	Paid in Full	APR 5 - 1916	246.2		1836							
John Greenwaldt			SE 1/4 of SW 1/4			40	168						918	1st Half Paid	OCT 26 1916	864.2		489		459					
"			NE 1/4 of SE 1/4		5	39	168						918	Paid in Full	MAY 3 1916	309.9		918							
"			NW 1/4 of SE 1/4		4	16	135						738	1st Half Paid	OCT 26 1916	306.5									
"			SW 1/4 of SE 1/4			40	135						738	1st Half Paid	MAY 31 1916	864.2		1107		1107					
"			SE 1/4 of SE 1/4			40	135						738	1st Half Paid	MAY 31 1916	306.5									
Footings Carried Forward,																									
5,973.5 1,240																									
12,240																									







Tax List of Real Property in the Town of Pine River

Cass County, Minnesota, for Taxes of the Year 1915

IN WHOSE NAME ASSESSED	TO WHOM TRANSFERRED	Sold for Taxes	SUBDIVISION	Sec. or Lot	Town or Block	No. of Acres	GENERAL TAXES				S.R.V. Dist. No.	SCHOOL DISTRICT		TOTAL TAXES	PAID	WHEN PAID	No. of Receipt	March Settlement	June Settlement	Penalty	November Settlement	Penalty	Collections to First Monday in January	Penalty	Delinquent on First Monday in January	REMARKS		
							State	County	Town	Local		District No.	Rate														District No.	Rate
Footings Brought Forward,																												
Jacob L. Lewis	Anna Dalton		NE 1/4 of NE 1/4	29	138	29	40	168	918						2nd Half Paid OCT 31 1916	9329												
Wm C. Courray		NW 1/4 of NE 1/4		40	168	918								918 1st Half Paid MAY 31 1916	5504			543		375						See Rec.		
Jacob L. Lewis		SW 1/4 of NE 1/4		40	168	918								918 Paid in Full JAN 17 1916														
H.A. Spurrer		SE 1/4 of NE 1/4		40	168	918								918 Paid in Full JAN 17 1916	103			1836										
	Anna Dalton		NE 1/4 of NW 1/4			40	210	1148							1148 Paid in Full OCT 14 1916													
		NW 1/4 of NW 1/4		40	210	1148								1148 Paid in Full OCT 14 1916														
		SW 1/4 of NW 1/4		40	210	1148								1148 Paid in Full OCT 14 1916														
		SE 1/4 of NW 1/4		40	210	1148								1148 Paid in Full OCT 14 1916														
			NE 1/4 of SW 1/4			40	168	918			233				2nd Half Paid OCT 31 1916	9287												
W.C. Courray	B.F. Christian		NW 1/4 of SW 1/4 Lot 3			36	162	885			209			1151 1st Half Paid MAY 31 1916	5569			576		576								
Albert Rues		SW 1/4 of SW 1/4 Lot 2		40	193	1055					233			1094 Paid Apr. 5 1917	6384											1094		
W.C. Courray		SE 1/4 of SW 1/4		40	193	1055					233			1288 2nd Half Paid OCT 31 1916	9287													
		Part of Lot 3		4	24	131					233			1288 1st Half Paid MAY 31 1916	5569													
	W. Walton		NE 1/4 of SE 1/4			40	185	1011			175			154 Paid in Full APR 1 - 1916	2411													
		NW 1/4 of SE 1/4		40	185	1011					175			1186 Paid in Full MAY 18 1916	3740													
		SW 1/4 of SE 1/4		40	193	1055					175			1186 Paid in Full MAY 18 1916														
		SE 1/4 of SE 1/4		40	193	1055					175			1230 2nd Half Paid OCT 31 1916	9547													
			Footings Carried Forward,			640	3001	16440			1631			1230 1st Half Paid MAY 31 1916	5569													
															18071													



Tax List of Real Property in the Town of Pine River

Cass County, Minnesota, for Taxes of the Year 1915

IN WHOSE NAME ASSESSED	TO WHOM TRANSFERRED	Sold for Taxes	SUBDIVISION	Sec. or Lot	Town or Block	No. of Acres	VALUATION	GENERAL TAXES			S. R. 21 No. 80	SCHOOL DISTRICT		TOTAL TAXES	PAID	WHEN PAID	No. of Receipt	March Settlement	June Settlement	Penalty	November Settlement	Penalty	Collections to First Monday in January	Penalty	Delinquent on First Monday in January	REMARKS			
								State	Mills	State		District No.	District No.														Rate	Rate	
Footings Brought Forward,																													
H. A. Spurrer L. Hill	Anna Dalton W. A. Spurrer		NE 1/4 of NE 1/4 Lot 4	30	138	29	2060	84	459		87			546															
			NW 1/4 of NE 1/4 " 3				1230	55	301		59			360															
			SW 1/4 of NE 1/4																										
			SE 1/4 of NE 1/4																										
H. H. Davis James R. Blackburn J. J. Peterson			NE 1/4 of NW 1/4 " 2				4335	182	994		288			1242	Paid in Full	DEC 29 1916	10033												
			NW 1/4 of NW 1/4 " 1				4945	206	1126		287			141	31x5323														
			SW 1/4 of NW 1/4 " 1				1934	91	497		113			610	Paid in Full	DEC 29 1916	10336												
			SE 1/4 of NW 1/4																										
			All east of Norway Brook lot 1				830	93	508					508	2nd Half Paid	OCT 21 1916	8274												
			NE 1/4 of SW 1/4												1st Half Paid	MAY 31 1916	6156												
			NW 1/4 of SW 1/4																										
			SW 1/4 of SW 1/4																										
			SE 1/4 of SW 1/4																										
			NE 1/4 of SE 1/4																										
			NW 1/4 of SE 1/4																										
			SW 1/4 of SE 1/4																										
			SE 1/4 of SE 1/4																										
			NE 1/4 of SE 1/4																										
			SW 1/4 of SE 1/4																										
			SE 1/4 of SE 1/4																										
			NE 1/4 of SE 1/4																										
			SW 1/4 of SE 1/4																										
			SE 1/4 of SE 1/4																										
			NE 1/4 of SE 1/4																										
			SW 1/4 of SE 1/4																										
			SE 1/4 of SE 1/4																										
			NE 1/4 of SE 1/4																										
			SW 1/4 of SE 1/4																										
			SE 1/4 of SE 1/4																										
			NE 1/4 of SE 1/4																										
			SW 1/4 of SE 1/4																										
			SE 1/4 of SE 1/4																										
			NE 1/4 of SE 1/4																										
			SW 1/4 of SE 1/4																										
			SE 1/4 of SE 1/4																										
			NE 1/4 of SE 1/4																										
			SW 1/4 of SE 1/4																										
			SE 1/4 of SE 1/4																										
			NE 1/4 of SE 1/4																										
			SW 1/4 of SE 1/4																										
			SE 1/4 of SE 1/4																										
			NE 1/4 of SE 1/4																										
			SW 1/4 of SE 1/4																										
			SE 1/4 of SE 1/4																										
			NE 1/4 of SE 1/4																										
			SW 1/4 of SE 1/4																										
			SE 1/4 of SE 1/4																										
			NE 1/4 of SE 1/4																										
			SW 1/4 of SE 1/4																										
			SE 1/4 of SE 1/4																										
			NE 1/4 of SE 1/4																										
			SW 1/4 of SE 1/4																										
			SE 1/4 of SE 1/4																										
			NE 1/4 of SE 1/4																										
			SW 1/4 of SE 1/4																										
			SE 1/4 of SE 1/4																										
			NE 1/4 of SE 1/4																										
			SW 1/4 of SE 1/4																										
			SE 1/4 of SE 1/4																										
			NE 1/4 of SE 1/4																										
			SW 1/4 of SE 1/4																										
			SE 1/4 of SE 1/4																										
			NE 1/4 of SE 1/4																										
			SW 1/4 of SE 1/4																										
			SE 1/4 of SE 1/4																										
			NE 1/4 of SE 1/4																										
			SW 1/4 of SE 1/4																										
			SE 1/4 of SE 1/4																										
			NE 1/4 of SE 1/4																										



Tax List of Real Property in the Town of Pine River

Cass County, Minnesota, for Taxes of the Year 1915

IN WHOSE NAME ASSESSED	TO WHOM TRANSFERRED	Sold for Taxes	SUBDIVISION	Sec. or Lot	Town or Block	No. of Acres	VALUATION			GENERAL TAXES			S.P. No.	SCHOOL DISTRICT		TOTAL TAXES	PAID	WHEN PAID	No. of Receipt	March Settlement	June Settlement	Penalty	November Settlement	Penalty	Collections to First Monday in January	Penalty	Delinquent on First Monday in January	REMARKS										
							Dollars	Cts.	Mills	State	School	Bonds		District No.	District Rate														District Mills									
Footings Brought Forward,																																						
J.E. Geary + Hill	H. B. Chandler		NE 1/4 of NE 1/4	Lot 1	31	58	29	29	38	280	15	30	341																									
Madge S. Forbes			NW 1/4 of NE 1/4	" 2					28	196	10	71	245																									
<del>Ed L. Forbes</del>				209 SW 1/4 of NE 1/4					20	182	9	94	175																									
J. W. Ward				SE 1/4 of NE 1/4					40	168	9	18	349																									
Madge S. Forbes				NE 1/4 of NW 1/4	West of Norway Brook Lot 3	10				47	2	56	87																									
Jens Sorenson			NW 1/4 of NW 1/4	Lot 4 less 5a	18	94			737	4	027	166																										
"			SW 1/4 of NW 1/4	" 5	45	28						395																										
Ben Ackerman			SE 1/4 of NW 1/4		15				321	1	754	130																										
"			6 ac of NE 1/4 of SW 1/4					600				53																										
"	Duplicate of H. Klein		NW 1/4 of SW 1/4	6 acres of lot 6				600				53																										
Edna McAllister			SW 1/4 of SW 1/4	" " NE SW				200				47																										
Eraemus Lewis			SE 1/4 of SW 1/4	1 acre of " 6				100	80	4	37	09																										
"			5 acres of lot 4					500																														
Diantha Plank			NE 1/4 of SE 1/4																																			
"			NW 1/4 of SE 1/4					40				349																										
"			SW 1/4 of SE 1/4					40				349																										
Guy Stanley	Duplicate See P 21		SE 1/4 of SE 1/4	1 acre of				39				336																										
William Lewis			1 acre of SE 1/4						14			46																										
Footings Carried Forward,																																						
							32560	2725	14889	2056																												

1871 Paid in Full FEB 12 1916 581  
 1316 2nd Half Paid OCT 2 1916 8274  
 1169 1st Half Paid MAY 31 1916 6156  
 1169 2nd Half Paid AUG 7 - 1916 6156  
 1267 Paid in Full APR 19 1916 2765

343 2nd Half Paid OCT 2 1916 8274  
 4588 1st Half Paid MAY 31 1916 6156  
 4588 2nd Half Paid SEP 28 1916 7658  
 4588 1st Half Paid MAY 31 1916 6139

Pd. under Protest  
 1990 not adv.

446 Paid in Full MAY 20 1916 3860

4862 X 5086

17946



Tax List of Real Property in the Town of Pine River

Cass County, Minnesota, for Taxes of the Year 1915

IN WHOSE NAME ASSESSED	TO WHOM TRANSFERRED	Sold for Taxes	SUBDIVISION	Sec. or Lot	Town or Block	Rng.	No. of Acres	VALUATION	GENERAL TAXES			SCHOOL DISTRICT		TOTAL TAXES	PAID	WHEN PAID	No. of Receipt	March Settlement	June Settlement	Penalty	November Settlement	Penalty	Collections to First Monday in January	Penalty	Delinquent on First Monday in January	REMARKS									
									State	County	Town	District No.	District No.														Rate	Rate							
									Dollars	¢	cts.	¢	cts.	¢	cts.	¢	cts.	¢	cts.	¢	cts.	¢	cts.	¢	cts.	¢	cts.								
Footings Brought Forward,																																			
Annie Anyon	H. C. John		NE 1/4 of NE 1/4 3 acres of SW 1/4 NE 31				138.29	35																											
			NW 1/4 of NE 1/4 1/2 " " "				150	140																											
			SW 1/4 of NE 1/4 1/2 " " "				1150	84																											
			SE 1/4 of NE 1/4																																
Erasmus Lewis			NE 1/4 of NW 1/4 5 acres of NW 1/4 NW 1/4				5	93																											
B. E. Wideman			SW 1/4 of NW 1/4 all West of Norway Brook Lot 3				19.87	210																											
Alcie Hoffman	Lewis P. Solberg		1 acre of NW 1/4 SW 1/4				1	21																											
Herbert Kline			NE 1/4 of SW 1/4																																
Winona Hill			NW 1/4 of SW 1/4 3 acres of NE 1/4 SW 1/4				3	146																											
Rena May Hill			SW 1/4 of SW 1/4 2 " " " "				12	42																											
John Jacob Hoffman	Lewis P. Solberg		SE 1/4 of SW 1/4 2 " " " "				2	322																											
			1 " " " "				1	105																											
Alfred B. Christenson			NE 1/4 of SE 1/4																																
Edwin Parker			NW 1/4 of SE 1/4 3.60 " " Lot 6				3.60	112																											
A. E. Snell			SW 1/4 of SE 1/4 4 " " " 6				4	105																											
Thos. A. Thorpe			SE 1/4 of SE 1/4 6 " " " 6				6	105																											
			" " " " NW 1/4 SW 1/4				1	105																											
Footings Carried Forward,																																			
							14.47	1520																											

2nd Half Paid OCT 31 1916 9633  
 19 1/2 Half Paid MAY 31 1916 6386  
 76 5/8 Paid in full MAY 31 1916  
 45 5/8 Paid in full MAY 31 1916 } 6141

Hal. Paid 6 30 1916 7096  
 50 8/8 Part Paid MAY 31 1916 5706  
 2nd Half Paid OCT 31 1916 10001  
 114 8/8 Half Paid MAY 31 1916 3498

114 Paid in Full FEB 21 1916 891  
 2nd Half Paid OCT 2- 1916 7697  
 79 7/8 1st Half Paid MAY 25 1916 4349  
 22 9/8 1st Half Paid OCT 30 1916 8763  
 22 9/8 1st Half Paid MAY 31 1916 6382  
 2nd Half Paid OCT 31 1916 9550  
 175 9/8 Half Paid MAY 31 1916 6532

574 Paid in Full FEB 21 1916 891  
 2nd Half Paid OCT 17 1916 8032  
 612 1st Half Paid MAY 31 1916 3069

574 Paid in Full DEC 16 1916 10544  
 8303

574 Not Ass.

574 57







Tax List of Real Property in the Town of Pine River

Cass County, Minnesota, for Taxes of the Year 1915

IN WHOSE NAME ASSESSED	TO WHOM TRANSFERRED	Sold for Taxes	SUBDIVISION	Sec. or Lot	Town or Block	No. of Acres	GENERAL TAXES			S.P.H. Dist. No.	SCHOOL DISTRICT		TOTAL TAXES	PAID	WHEN PAID	No. of Receipt	March Settlement	June Settlement	Penalty	November Settlement	Penalty	Collections to First Monday in January	Penalty	Delinquent on First Monday in January	REMARKS						
							State	County	Town		State	School														District No.	Rate	Rate			
							VALUATION	State	County	Town	State	School	District No.	Rate	Rate																
							Dollars	cts.	cts.	cts.	cts.	cts.	cts.	cts.	cts.	Month	Day	Year	cts.	cts.	cts.	cts.	cts.	cts.	cts.	cts.					
Footings Brought Forward,																															
H. J. Davis	Jay P. Brewer		NE 1/4 of NE 1/4	32	128	19	40	191	1043		175			1218	Paid in Full	MAY 3	1916	3067													
Alva Newland			NW 1/4 of NE 1/4		40		40	179	978		175			1153	Paid in Full	APR 3	1916	2421													
J. H. Grover	Fred Kieseberg		SW 1/4 of NE 1/4		40		40	191	1043		175			1218	Paid in Full	JAN 28	1916														
"	"		SE 1/4 of NE 1/4		40		40	186	1016		175			1191	Paid in Full	JAN 28	1916	296													
Emily S. Bowman	F. L. Hill & J. E. Geary		NE 1/4 of NW 1/4		40		40	359	1961		233			2427	Paid in Full	FEB 12	1916														
Emma C. Davis	"		NW 1/4 of NW 1/4		40		40				233			2493	Paid in Full	FEB 12	1916	581	4920												
"	"		SW 1/4 of NW 1/4		40		40	371	2027		233																				
"	"		SE 1/4 of NW 1/4		40		40				233																				
Hill & Geary	"		NE 1/4 of SW 1/4		40		40	353	1929		233			2395	x 5087											2395					
Peter Hanson	"		NW 1/4 of SW 1/4		40		40				233			2504	1st Half Paid	MAY 26	1916	4357	1252												
"	"		SW 1/4 of SW 1/4		40		40	373	2038		233									2nd Half Paid	OCT 27	1916	8738	1252							
"	"		SE 1/4 of SW 1/4		40		40				233																				
Chas. E. Hebbert & H. H. Hill	"		NE 1/4 of SE 1/4		40		40	168	918		175			1093	1st Half Paid	MAY 23	1916	8966													
Hetter & Hill	Christine Hanson		NW 1/4 of SE 1/4		40		40	168	918		175			1093	2nd Half Paid	OCT 30	1916														
"	"		SW 1/4 of SE 1/4		40		40	336	1836		175			2186	Paid	Feb 17	1917	6244								2186					
"	"		SE 1/4 of SE 1/4		40		40				175																				
Footings Carried Forward,																															
							640	2875	15707		3264			18971																	







Tax List of Real Property in the Town of Pine River

Cass County, Minnesota, for Taxes of the Year 1915

IN WHOSE NAME ASSESSED

TO WHOM TRANSFERRED

Sold for Taxes

SUBDIVISION

Sec. or Lot  
Town or Block

No. of Acres

Area 100ths

VALUATION

GENERAL TAXES

Mills

State

County

Town

Local

Total

State

School

Bonds

Ditch

No.

.....

.....

.....

.....

.....

.....

.....

.....

.....

.....

.....

.....

.....

.....

.....

.....

.....

.....

.....

.....

.....

.....

.....

.....

.....

.....

.....

.....

.....

.....

.....

.....

.....

.....

.....

.....

.....

.....

.....

.....

.....

.....

.....

.....

.....

.....

.....

.....

.....

.....

.....

.....

.....

.....

.....

SCHOOL DISTRICT

District

No.

Rate

Mills

.....

.....

.....

.....

.....

.....

.....

.....

.....

.....

.....

.....

.....

.....

.....

.....

.....

.....

.....

.....

.....

.....

.....

.....

.....

.....

.....

.....

.....

.....

.....

.....

.....

.....

.....

.....

.....

.....

.....

.....

.....

.....

.....

.....

.....

.....

.....

.....

.....

.....

.....

.....

.....

.....

TOTAL TAXES

PAID

WHEN PAID

No. of Receipt

March Settlement

June Settlement

Penalty

November Settlement

Penalty

Collections to First Monday in January

Penalty

Delinquent on First Monday in January

REMARKS

Footings Brought Forward,

H. G. + Giles H. Anderson

NE 1/4 of NE 1/4 Lot 1 138 30 40 02 672  
 NW 1/4 of NE 1/4 " 2 40 06  
 SW 1/4 of NE 1/4 " 40  
 SE 1/4 of NE 1/4 " 40

2nd Half Paid OCT 31 1916 9259  
 3672 1st Half Paid MAY 31 1916 6682

1836 1836

J. H. Kimball

NE 1/4 of NW 1/4 " 3 40 16 168  
 NW 1/4 of NW 1/4 " 4 40 14 407  
 SW 1/4 of NW 1/4 " 5 57 50  
 SE 1/4 of NW 1/4 " 40 168

2nd Half Paid OCT 31 1916 9259  
 918 1st Half Paid MAY 31 1916 6682  
 2224 1st Half Paid MAY 31 1916 5470

459 459  
 1112 1112

H. G. + Giles H. Anderson

N. L. Bowman

NE 1/4 of SW 1/4 " 7 43 50 183  
 NW 1/4 of SW 1/4 " 9 28 45 120  
 SW 1/4 of SW 1/4 " 8 40 168

2nd Half Paid OCT 31 1916 9259  
 918 1st Half Paid MAY 31 1916 6682

459 459

St. Paul + Chicago  
 N. L. Bowman

Fred H. Smith

NE 1/4 of SE 1/4 " 40  
 NW 1/4 of SE 1/4 " 40 672  
 SW 1/4 of SE 1/4 " 40  
 SE 1/4 of SE 1/4 " 40

2nd Half Paid OCT 30 1916 8903  
 3672 1st Half Paid MAY 31 1916 4969

1836 1836

Footings Carried Forward,

60983 2558

13978



Tax List of Real Property in the Town of Pine River

Cass County, Minnesota, for Taxes of the Year 1915

Pinell Street Co., Minneapolis, Minn. 55404

IN WHOSE NAME ASSESSED

TO WHOM TRANSFERRED

Sold for Taxes

SUBDIVISION

Sec. or Lot, Town or Block, Rag.

No. of Acres

Acres 100ths

VALUATION

Dollars

GENERAL TAXES

Mile

State

County

Town

Local

Total

State

School

Bonds

Ditch

No.

Rate

Rate

Rate

Rate

Rate

Rate

Rate

Rate

Rate

Rate

Rate

Rate

Rate

Rate

Rate

Rate

Rate

Rate

Rate

Rate

Rate

Rate

Rate

Rate

Rate

Rate

Rate

Rate

Rate

Rate

Rate

Rate

Rate

Rate

Rate

Rate

Rate

Rate

Rate

Rate

Rate

Rate

Rate

Rate

Rate

Rate

Rate

Rate

Rate

Rate

Rate

Rate

Rate

Rate

Rate

Rate

Rate

Rate

Rate

Rate

Rate

Rate

SCHOOL DISTRICT

District

No.

Rate

Rate

Rate

Rate

Rate

Rate

Rate

Rate

Rate

Rate

Rate

Rate

Rate

Rate

Rate

Rate

Rate

Rate

Rate

Rate

Rate

Rate

Rate

Rate

Rate

Rate

Rate

Rate

Rate

Rate

Rate

Rate

Rate

Rate

Rate

Rate

Rate

Rate

Rate

Rate

Rate

Rate

Rate

Rate

Rate

Rate

Rate

Rate

Rate

Rate

Rate

Rate

Rate

Rate

Rate

Rate

Rate

Rate

Rate

Rate

Rate

Rate

Rate

Rate

Rate

TOTAL TAXES

PAID

WHEN PAID

No. of Receipt

March Settlement

June Settlement

Penalty

November Settlement

Penalty

Collections to First Monday in January

Penalty

Delinquent on First Monday in January

REMARKS

Footings Brought Forward,

NE 1/4 of NE 1/4

2 138 20 40

168

NW 1/4 of NE 1/4

40

168

SW 1/4 of NE 1/4

40

168

SE 1/4 of NE 1/4

40

168

NE 1/4 of NW 1/4

40

672

NW 1/4 of NW 1/4

40

SW 1/4 of NW 1/4

40

SE 1/4 of NW 1/4

40

NE 1/4 of SW 1/4

40

672

NW 1/4 of SW 1/4

40

SW 1/4 of SW 1/4

40

SE 1/4 of SW 1/4

40

NE 1/4 of SE 1/4

40

672

NW 1/4 of SE 1/4

40

SW 1/4 of SE 1/4

40

SE 1/4 of SE 1/4

40

Footings Carried Forward,

640

2188

918 x 5089

918 1st Half Paid OCT 31 1916

918 2nd Half Paid MAY 26 1916

918 1st Half Paid OCT 31 1916

918 2nd Half Paid MAY 26 1916

918 x 5089

3672 Paid in full MAY 17 1916

3672 ✓

✓

✓

✓

3672 Paid in Full JAN 10 1916

14688

9357

4367

3639

5126

5127

5128

5129

3672

918

918

3672

918

918

1055 Paid subsequent to Cert. No. 2065

1055 Paid subsequent to Cert. No. 2066

1055 Paid subsequent to Cert. No. 2067

1055 Paid subsequent to Cert. No. 2068



Tax List of Real Property in the Town of Pine River

Cass County, Minnesota, for Taxes of the Year 1915

Kimball-Storer Co., Minneapolis, Minn.—19065

IN WHOSE NAME ASSESSED	TO WHOM TRANSFERRED	Sold for Taxes	SUBDIVISION	Sec. or Lot	Town or Block	No. of Acres	VALUATION	GENERAL TAXES				SCHOOL DISTRICT		TOTAL TAXES	PAID	WHEN PAID	No. of Receipt	March Settlement	June Settlement	Penalty	November Settlement	Penalty	Collections to First Monday in January	Penalty	Delinquent on First Monday in January	REMARKS
								State	County	Town	Local	District No.	District Rate													
Footings Brought Forward,																										
H. D. & Gile H. Anderson			NE 1/4 of NE 1/4		Lot 1	3 1/8	5041 75	172																		
Weyerhaeuser et al			NW 1/4 of NE 1/4				2080	172																		
H. D. Gile H. Anderson			SW 1/4 of NE 1/4				40	336																		
"			SE 1/4 of NE 1/4				40																			
Footings Brought Forward,																										
Daisy A. Thabes			NE 1/4 of NW 1/4		" 3		41 22	172																		
Ed. Thompson			NW 1/4 of NW 1/4				40	172																		
"			SW 1/4 of NW 1/4				40	336																		
"			SE 1/4 of NW 1/4				40																			
Footings Brought Forward,																										
Henry S. Mc Bride, Jay P. Brewer & John J. Allen			NE 1/4 of SW 1/4				40	168																		
J. P. Brewer			NW 1/4 of SW 1/4				40	168																		
Ed. Thompson			SW 1/4 of SW 1/4				40	168																		
"			SE 1/4 of SW 1/4				40	168																		
Footings Brought Forward,																										
Ray S. Burch			NE 1/4 of SE 1/4				40																			
"			NW 1/4 of SE 1/4				40	672																		
"			SW 1/4 of SE 1/4				40																			
"			SE 1/4 of SE 1/4				40																			
Footings Carried Forward,																										
						643 77	5704																			

14772

918  
918  
918  
918

2nd Half Paid OCT 31 1916 9259  
939 1st Half Paid MAY 31 1916 6602  
2nd Half Paid OCT 2 1916 7752  
939 1st Half Paid MAY 13 1916 3438  
2nd Half Paid OCT 31 1916 9259  
1836 1st Half Paid MAY 31 1916 6602

2nd Half Paid OCT 31 1916 9259  
939 1st Half Paid MAY 31 1916 6602  
939 Paid in Full MAY 25 1916 4814  
1836 Paid in Full MAY 26 1916 4435

918 Paid in Full MAY 26 1916 4435  
2nd Half Paid OCT 30 1916 8979  
918 1st Half Paid MAY 31 1916 6342  
2nd Half Paid OCT 20 1916 8710  
918 1st Half Paid MAY 22 1916 3958  
918 Paid in Full 5-26-1916 4435

2672 Paid May 11 1917 6541



Tax List of Real Property in the Town of Pine River

Cass County, Minnesota, for Taxes of the Year 1915

Standard-Store Co., Minneapolis, Minn. - 70000

IN WHOSE NAME ASSESSED	TO WHOM TRANSFERRED	Sold for Taxes	SUBDIVISION	Sec. or Lot	Town or Block	Rag.	No. of Acres	VALUATION	GENERAL TAXES			SCHOOL DISTRICT		TOTAL TAXES	PAID	WHEN PAID	No. of Receipt	March Settlement	June Settlement	Penalty	November Settlement	Penalty	Collections to First Monday in January	Penalty	Delinquent on First Monday in January	REMARKS
									State	County	Local	District No.	District Rate													
Footings Brought Forward,																										
Gustave R. Schuman			NE 1/4 of NE 1/4	4	138	30	40.89	336	1836	155	74	14														
"			NW 1/4 of NE 1/4				39.57			153	74	14														
Daisy A. Shales			SW 1/4 of NE 1/4				32.80	269	12470	155	74	14														
"			SE 1/4 of NE 1/4				40			155	74	14														
N. J. Rugg			NE 1/4 of NW 1/4			Lot 3	44.43			136	87	1														
"			NW 1/4 of NW 1/4			" 4	36.90	321	1754	136	87	1														
"			SW 1/4 of NW 1/4			" 5	39.50			136	87	1														
"			SE 1/4 of NW 1/4			" 6	12.60			136	23	1														
Florence H. Foulk			NE 1/4 of SW 1/4				40			136	87	1														
"			NW 1/4 of SW 1/4				40	672	3672	136	87	1														
Ethel Elder			SW 1/4 of SW 1/4				40			136	87	1														
"			SE 1/4 of SW 1/4				40			136	87	1														
Hensy S. McBride	Jay P. Brewer + John J. Allen		NE 1/4 of SE 1/4				40	168	918	116	74	14														
Florence H. Foulk			NW 1/4 of SE 1/4				40	336	1836	116	74	14														
"			SW 1/4 of SE 1/4				40			116	74	14														
Wm H. Miller			SE 1/4 of SE 1/4				40	168	918	116	74	14														
Footings Carried Forward,																										
60669 2270 12404 2172 1230 15800																										

1st Half Paid OCT 31 1916 9104  
 2294 1st Half Paid MAY 31 1916 3894  
 1928 Paid in Full MAY 25 1916 4314

2nd Half Paid OCT 9 - 1916 7854  
 4564 1st Half Paid OCT 9 - 1916 2832  
 2nd Half Paid OCT 16 1916 8011  
 2nd Half Paid MAY 31 1916 6581

2nd Half Paid OCT 30 1916 8979  
 1108 1st Half Paid MAY 31 1916 6342  
 2nd Half Paid OCT 9 - 1916 7854  
 2216 1st Half Paid APR 22 1916 2832  
 2nd Half Paid AUG 1 1916 7446  
 1108 1st Half Paid MAY 20 1916 3307



Tax List of Real Property in the Town of Pine River

Cass County, Minnesota, for Taxes of the Year 1915

Assessed - Cass Co., Minnesota, Minn. - 1915

IN WHOSE NAME ASSESSED	TO WHOM TRANSFERRED	Sold for Taxes	SUBDIVISION	Sec. or Lot	Town or Block	No. of Acres	VALUATION	GENERAL TAXES			SCHOOL DISTRICT		TOTAL TAXES	PAID	WHEN PAID	No. of Receipt	March Settlement	June Settlement	Penalty	November Settlement	Penalty	Collections to First Monday in January	Penalty	Delinquent on First Monday in January	REMARKS	
								State	County	Town	District No.	District Rate														Rate
Footings Brought Forward,																										
Em. Land Co.			NE 1/4 of NE 1/4	5	138 30	39 30	165	902	70	74																
Florence W. Touck			NW 1/4 of NE 1/4			40	179	972	70	112																
Thos. H. Francis			SW 1/4 of NE 1/4			39	168	918	70	112																
Florence W. Touck			SE 1/4 of NE 1/4			46	168	918	70	112																
Frank E. Holt			46.7 ft. x 66 ft. Lot 6			1																				
Carl E. Brown			NE 1/4 of NW 1/4			39 73	168	918	70	112																
M. Cosgrove			NW 1/4 of NW 1/4			40	168	918		149																
J. D. Barnes			SW 1/4 of NW 1/4			40	168	918		149																
Carl E. Brown			SE 1/4 of NW 1/4			40	168	918		149																
"			NE 1/4 of SW 1/4			40	168	918		112																
J. D. Barnes			NW 1/4 of SW 1/4			40	504	2754		149																
"			SW 1/4 of SW 1/4			40				112																
"			SE 1/4 of SW 1/4			40				112																
Florence W. Touck			NE 1/4 of SE 1/4			40	168	918	70	112																
J. A. Shoon	Florence W. Touck		NW 1/4 of SE 1/4			40	168	918	70	112																
J. D. Barnes			SW 1/4 of SE 1/4			40	336	1836		112																
"			SE 1/4 of SE 1/4			40				112																
Footings Carried Forward,																										
6 39 03 2696 14733 499 1902																										

17124











Tax List of Real Property in the Town of Pine River

Cass County, Minnesota, for Taxes of the Year 1915

IN WHOSE NAME ASSESSED	TO WHOM TRANSFERRED	Sold for Taxes	SUBDIVISION	Sec. or Lot	Town or Block	Rag.	No. of Acres	VALUATION				GENERAL TAXES				SCHOOL DISTRICT		TOTAL TAXES	PAID	WHEN PAID	No. of Receipt	March Settlement	June Settlement	Penalty	November Settlement	Penalty	Collections to First Monday in January	Penalty	Delinquent on First Monday in January	REMARKS									
								Acres	100ths	State	County	Local	Total	State	County	Local	Total														District No.	District Rate	District No.	District Rate					
Footings Brought Forward,																																							
Ray Eveland			NE 1/4 of NE 1/4	8	138	30	40	1672	3672	163	74	1	1	4620	Paid in Full	MAY 27 1916	4535																						
"			NW 1/4 of NE 1/4				40			163	74																												
"			SW 1/4 of NE 1/4				40			163	74																												
"			SE 1/4 of NE 1/4				40			163	74																												
Christ Arbogast			NE 1/4 of NW 1/4				40	168	918	163	74	1	1	1153	2nd Half Paid	OCT 31 1916	9004																						
L. Troutman			NW 1/4 of NW 1/4				40	536	1836	163	74	1	1	2310	1st Half Paid	APR 20 1916	2786					577		577															
"			SW 1/4 of NW 1/4				40			163	74	1	1		Paid in Full	JAN 18 1916	139				2310																		
Christ Arbogast			SE 1/4 of NW 1/4				40	238	1300	163	74	1	1	1537	2nd Half Paid	OCT 31 1916	9004																						
"							40			163	74	1	1		1st Half Paid	APR 20 1916	2786																						
<del>Grace Dick</del>	B. H. Kelley		NE 1/4 of SW 1/4				40	168	918	163	74	14	14	1153	2nd Half Paid	OCT 31 1916	9004																						
John & Randall			NW 1/4 of SW 1/4				40	168	918	163	74			1153	1st Half Paid	APR 20 1916	2786					578		577															
Christ Arbogast			SW 1/4 of SW 1/4				40	168	918	163	74			1153	Paid in Full	MAR 9 1916	2122					1153																	
"			SE 1/4 of SW 1/4				40	168	918	163	74			1153	Paid in Full	MAY 26 1916	4357					1153																	
John Kane	R. Louisa French		NE 1/4 of SE 1/4				40	151	825	163	74			1062	1st Half Paid	OCT 31 1916	10003																						
Christ Arbogast			NW 1/4 of SE 1/4				40	168	918	163	74			1153	2nd Half Paid	OCT 31 1916	9004																						
Axel Berge	K. H. Truett		SW 1/4 of SE 1/4				40	336	1836	163	74			1153	1st Half Paid	APR 20 1916	2786					578		577															
"			SE 1/4 of SE 1/4				40			163	74			2310	Paid in Full	OCT 12 1916	7926																						
Footings Carried Forward,																																							
							640	2741	14977	2608	1184			18769																									



Tax List of Real Property in the Town of Pine River

Cass County, Minnesota, for Taxes of the Year 1915

IN WHOSE NAME ASSESSED

TO WHOM TRANSFERRED

Sold for Taxes

SUBDIVISION

Sec. or Lot

Town or Block

Rag.

No. of Acres

Acres 100ths

VALUATION

State

Mills

State

School

Bonds

Dollars

\$

cts.

\$

cts.

\$

cts.

\$

cts.

\$

cts.

\$

cts.

\$

cts.

\$

cts.

\$

cts.

\$

cts.

\$

cts.

\$

cts.

\$

cts.

\$

cts.

\$

cts.

\$

cts.

\$

cts.

\$

cts.

\$

cts.

\$

cts.

\$

cts.

\$

cts.

\$

cts.

\$

cts.

\$

cts.

\$

cts.

\$

cts.

\$

cts.

\$

cts.

\$

cts.

\$

cts.

\$

cts.

\$

cts.

\$

cts.

\$

cts.

\$

cts.

\$

cts.

\$

cts.

\$

cts.

\$

cts.

\$

cts.

\$

cts.

\$

cts.

\$

cts.

\$

cts.

\$

cts.

\$

cts.

\$

cts.

\$

cts.

\$

cts.

\$

cts.

\$

cts.

\$

cts.

\$

cts.

\$

cts.

\$

cts.

\$

cts.

\$

cts.

\$

cts.

\$

cts.

\$

cts.

\$

cts.

\$

cts.

\$

cts.

\$

cts.

\$

cts.

\$

cts.

\$

cts.

\$

cts.

\$

cts.

\$

cts.

\$

cts.

SCHOOL DISTRICT

District No.

Rate

Mills

\$

cts.

\$

cts.

\$

cts.

\$

cts.

\$

cts.

\$

cts.

\$

cts.

\$

cts.

\$

cts.

\$

cts.

\$

cts.

\$

cts.

\$

cts.

\$

cts.

\$

cts.

\$

cts.

\$

cts.

TOTAL TAXES

PAID

WHEN PAID

No. of Receipt

March Settlement

June Settlement

Penalty

November Settlement

Penalty

Collections to First Monday in January

Penalty

Delinquent on First Monday in January

REMARKS

\$

cts.

\$

cts.

\$

cts.

\$

cts.

\$

cts.

\$

cts.

\$

cts.

\$

cts.

\$

cts.

\$

cts.

\$

cts.

\$

cts.

\$

cts.

\$

cts.

\$

cts.

\$

cts.

\$

cts.

\$

cts.

\$

cts.

\$

cts.

\$

cts.

\$

cts.

\$

cts.

\$

cts.

\$

cts.

\$

cts.

\$

cts.

\$

cts.

\$

cts.

\$

cts.

\$

cts.

\$

cts.

\$

cts.

\$

cts.

\$

cts.

\$

cts.

Month

Day

Year

\$

cts.

\$

cts.

\$

cts.

\$

cts.

\$

cts.

\$

cts.

\$

cts.

\$

cts.

\$

cts.

\$

cts.

\$

cts.

\$

cts.

\$

cts.

\$

cts.

\$

cts.

\$

cts.

\$

cts.

\$

cts.

\$

cts.

\$

cts.

\$

cts.

\$

cts.

\$

cts.

\$

cts.

\$

cts.

\$

cts.

\$

cts.

\$

cts.

\$

cts.

\$

cts.

\$

cts.

\$

cts.

\$

&lt;



Tax List of Real Property in the Town of Pine River

Shaded Green Co., Minnesota, 1900

IN WHOSE NAME ASSESSED

TO WHOM TRANSFERRED

Sold for Taxes

SUBDIVISION

Sec. or Lot, Town or Block, Range

No. of Acres

VALUATION

GENERAL TAXES

State, County, Local, Total

Mills, Dollars, Cts.

School, Bonds

P.R.H. No.

Pin

SCHOOL DISTRICT

District No., Rate

District No., Rate

TOTAL TAXES

PAID

WHEN PAID

No. of Receipt

March Settlement

June Settlement

Penalty

November Settlement

Penalty

Collections to First Monday in January

Penalty

Delinquent on First Monday in January

REMARKS

Footings Brought Forward,

C. B. Finsoas, H. D. Tolvenger, Adolph M. Jerome, C. B. Finsoas

NE 1/4 of NE 1/4, NW 1/4 of NE 1/4, SW 1/4 of NE 1/4, SE 1/4 of NE 1/4

30 10 138 30 40, 40, 40, 40

238 1300, 168 918, 168 918, 168 918

H. D. Tolvenger, H. J. Blakely, Ralph M. Jerome

NE 1/4 of NW 1/4, NW 1/4 of NW 1/4, SW 1/4 of NW 1/4, SE 1/4 of NW 1/4

40, 40, 40, 40

336 1836, 168 918, 168 918, 168 918

233, 233, 233, 233

H. J. Blakely, Ralph M. Jerome

NE 1/4 of SW 1/4, NW 1/4 of SW 1/4, SW 1/4 of SW 1/4, SE 1/4 of SW 1/4

40, 40, 40, 40

168 918, 336 1836, 168 918, 168 918

233, 233, 233, 233

H. J. Blakely, A. B. Allen, Hugh Trazier

NE 1/4 of SE 1/4, NW 1/4 of SE 1/4 Lot 2, SW 1/4 of SE 1/4, SE 1/4 of SE 1/4

40, 54 40, 59 25

468 918, 1836 1011, 248 1353

233, 233, 254

Footings Carried Forward,

233 65, 2687, 14682

254

Cass County, Minnesota, for Taxes of the Year 1915

Table with columns for School District, Total Taxes, PAID, WHEN PAID, No. of Receipt, March Settlement, June Settlement, Penalty, November Settlement, Collections to First Monday in January, Delinquent on First Monday in January, and REMARKS. Includes handwritten entries for tax payments and dates.



Tax List of Real Property in the Town of Pine River

Shelby County, Minnesota, 1915

IN WHOSE NAME ASSESSED

TO WHOM TRANSFERRED

Sold for Taxes

SUBDIVISION

Sec. or Lot, Town or Block, Reg.

No. of Acres

Acres 100ths

VALUATION

GENERAL TAXES

State, County, Town, Local Sch., Total

Mills

State, School, Bonds

Ditch No.

Dollars 0 cts. 0 cts. 0 cts.

Footings Brought Forward,

NE 1/4 of NE 1/4

NW 1/4 of NE 1/4

SW 1/4 of NE 1/4

SE 1/4 of NE 1/4

NE 1/4 of NW 1/4

NW 1/4 of NW 1/4

SW 1/4 of NW 1/4

SE 1/4 of NW 1/4

NE 1/4 of SW 1/4

NW 1/4 of SW 1/4

SW 1/4 of SW 1/4

SE 1/4 of SW 1/4

NE 1/4 of SE 1/4

NW 1/4 of SE 1/4

SW 1/4 of SE 1/4

SE 1/4 of SE 1/4

Footings Carried Forward,

M. B. Darby  
H. P. Ry Co.

A. A. McManes

M. B. Darby

Susan + Alexander Tollefson

Mrs. S. S. Goodrich

Allen S. Goodrich

H. P. Ry Co. Des. L. Johnson

Cass County, Minnesota, for Taxes of the Year 1915

SCHOOL DISTRICT

District No., District No., Rate, Rate

TOTAL TAXES

PAID

WHEN PAID

No. of Receipt

March Settlement

June Settlement

Penalty

November Settlement

Penalty

Collections to First Monday in January

Penalty

Delinquent on First Monday in January

REMARKS

0 cts. 0 cts.

0 cts.

Month Day Year

0 cts.

0 cts.

0 cts.

0 cts.

0 cts.

0 cts.

0 cts.

0 cts.

0 cts.

1043 Paid in Full FEB 7 - 1916 430

1836 Paid in Full JUN 19 1916 6947

918 Paid in Full FEB 7 - 1916 430

2nd Half Paid OCT 31 1916 9609  
3672 1st Half Paid MAY 25 1916 4266

2 1/2 Sw - Pa. APR 19 1916 2772

3672

3672 Paid in Full MAR 11 1916 2159

14813

1043 ✓

918 ✓

1836

1836

3672

1836 - 184

1836

1836 2<sup>nd</sup> Sw



Tax List of Real Property in the Town of Pine River

Cass County, Minnesota, for Taxes of the Year 1915

IN WHOSE NAME ASSESSED	TO WHOM TRANSFERRED	Sold for Taxes	SUBDIVISION	Sec. or Lot	Town or Block	Rag.	No. of Acres		VALUATION	GENERAL TAXES			Ditch No.	SCHOOL DISTRICT		TOTAL TAXES	PAID	WHEN PAID	No. of Receipt	March Settlement	June Settlement	Penalty	November Settlement	Penalty	Collections to First Monday in January	Penalty	Delinquent on First Monday in January	REMARKS					
							Acres	100ths		State	Mills	State		School	Ditch														No.	Rate	No.	Rate	Rate
Footings Brought Forward,																																	
H. S. Gilbert			NE 1/4 of NE 1/4				12	138	30																								
"			NW 1/4 of NE 1/4																														
"			SW 1/4 of NE 1/4																														
"			SE 1/4 of NE 1/4																														
David L. Bowman			NE 1/4 of NW 1/4																														
"			NW 1/4 of NW 1/4																														
"			SW 1/4 of NW 1/4																														
"			SE 1/4 of NW 1/4																														
H. S. Gilbert			NE 1/4 of SW 1/4																														
"			NW 1/4 of SW 1/4																														
"			SW 1/4 of SW 1/4																														
"			SE 1/4 of SW 1/4																														
J. Kline			NE 1/4 of SE 1/4																														
"			NW 1/4 of SE 1/4																														
"			SW 1/4 of SE 1/4																														
"			SE 1/4 of SE 1/4																														
Footings Carried Forward,																																	

2nd Half Paid OCT 31 1916 9222  
1st Half Paid MAY 31 1916 6930

2nd Half Paid OCT 31 1916 9222  
1st Half Paid MAY 31 1916 6930

1st Half Paid in Full MAY 23 1916 4092

Abatement No. 44571



Tax List of Real Property in the Town of Pine River

Kimball-Clover Co., Minneapolis, Minn.-1916

IN WHOSE NAME ASSESSED	TO WHOM TRANSFERRED	Sold for Taxes	SUBDIVISION	Sec. or Lot	Town or Block	No. of Acres	VALUATION	GENERAL TAXES			Ditch No.		
								State	Mills	State			
							Dollars	\$	cts.	\$	cts.	\$	cts.
Footings Brought Forward,													
J. H. Kimball			NE 1/4 of NE 1/4	13	138	20	40						
"			NW 1/4 of NE 1/4			40	672						
"			SW 1/4 of NE 1/4			40							
"			SE 1/4 of NE 1/4			40							
Mahlum Lbr. Co.													
"			NE 1/4 of NW 1/4			40							
"			NW 1/4 of NW 1/4			40	672						
"			SW 1/4 of NW 1/4			40							
"			SE 1/4 of NW 1/4			40							
J. H. Kimball			NE 1/4 of SW 1/4			40	168						
H. S. Gilbert			NW 1/4 of SW 1/4			40	168						
J. H. Kimball			SW 1/4 of SW 1/4			40	336						
"			SE 1/4 of SW 1/4			40							
"			NE 1/4 of SE 1/4			40							
"			NW 1/4 of SE 1/4			40							
"			SW 1/4 of SE 1/4			40	672						
"			SE 1/4 of SE 1/4			40							
Footings Carried Forward,													
						640	2688						

Cass County, Minnesota, for Taxes of the Year 1915

SCHOOL DISTRICT		TOTAL TAXES	PAID	WHEN PAID	No. of Receipt	March Settlement	June Settlement	Penalty	November Settlement	Penalty	Collections to First Monday in January	Penalty	Delinquent on First Monday in January	REMARKS	
District No.	District Rate														
0	cts.	0	cts.	Month Day Year		0	cts.	0	cts.	0	cts.	0	cts.	0	cts.
		36 72		2nd Half Paid OCT 20 1916 1st Half Paid MAY 31 1916											
		36 72		2nd Half Paid OCT 20 1916 1st Half Paid MAY 31 1916											
		9 18		2nd Half Paid OCT 20 1916 1st Half Paid MAY 31 1916											
		9 18		2nd Half Paid OCT 20 1916 1st Half Paid MAY 31 1916											
		18 36		2nd Half Paid OCT 20 1916 1st Half Paid MAY 31 1916											
		36 72		2nd Half Paid OCT 20 1916 1st Half Paid MAY 31 1916											
		146 88													

8184  
5470  
7344  
7344 ✓











Tax List of Real Property in the Town of Pine River

Cass County, Minnesota, for Taxes of the Year 1915

IN WHOSE NAME ASSESSED	TO WHOM TRANSFERRED	Sold for Taxes	SUBDIVISION	Sec. or Lot	Town or Block	No. of Acres	VALUATION			GENERAL TAXES			SCHOOL DISTRICT	TOTAL TAXES	PAID	WHEN PAID	No. of Receipt	March Settlement	June Settlement	Penalty	November Settlement	Penalty	Collections to First Monday in January	Penalty	Delinquent on First Monday in January	REMARKS		
							Dollars	Cts.	Mills	State	County	Town															Local	Total
Footings Brought Forward,																												
Carl C. Carnahan	Farmers State Bank Pine River		NE 1/4 of NE 1/4	16	138	30	40	336	18	36		349	2534	PAID in Full	FEB 26 1916	1238		2534										
"	"		NW 1/4 of NE 1/4				40					349																
Wm. J. J. Lott	"		SW 1/4 of NE 1/4				40	351	19	18		349	2616	2nd Half Paid	OCT 21 1916	9483		654		654								
"	"		SE 1/4 of NE 1/4				40					349	2616	1st Half Paid	OCT 21 1916	8790		654		654								
A.O. Miller & Ed J. Staede	"		NE 1/4 of NW 1/4				40					349																
"	"		NW 1/4 of NW 1/4				36	491	26	83		319	4025	1/2 2nd Paid	MAY 31 1916	4748		1020										
"	"		SW 1/4 of NW 1/4				37					325																
"	"		SE 1/4 of NW 1/4				39					349																
R. Louisa French	"		NE 1/4 of SW 1/4				40	168	9	18		349																
Jardyce G. Eastvold	"		NW 1/4 of SW 1/4					363	19	84		499	1267	2nd Half Paid	OCT 31 1916	10005		633		634								
R. Louisa French	Arnt Olson		SW 1/4 of SW 1/4				57					499	2483	PAID	Nov 7 1916	6307									2483			
"	"		SE 1/4 of SW 1/4				38	162	8	85		336																
Harry H. Downes	"		NE 1/4 of SE 1/4				48					425																
"	"		NW 1/4 of SE 1/4				32	479	26	17		284	3618	2nd Half Paid	OCT 9 1916	7863		1809		1809								
"	"		SW 1/4 of SE 1/4				33					292		1st Half Paid	APR 4 1916	2452												
Footings Carried Forward,																												
						56371	2350	12841	4933																			17764



Tax List of Real Property in the Town of Pine River

Cass County, Minnesota, for Taxes of the Year 1915

IN WHOSE NAME ASSESSED	TO WHOM TRANSFERRED	Sold for Taxes	SUBDIVISION	Sec. or Lot	Town or Block	No. of Acres	VALUATION			GENERAL TAXES			SCHOOL DISTRICT	TOTAL TAXES	PAID	WHEN PAID	No. of Receipt	March Settlement	June Settlement	Penalty	November Settlement	Penalty	Collections to First Monday in January	Penalty	Delinquent on First Monday in January	REMARKS	
							Dollars	Cts.	Mills	State	County	Town															State
Footings Brought Forward,																											
Arthur O. Miller			NE 1/4 of NE 1/4	17	138	30	40	336	18	36		344															
"			NW 1/4 of NE 1/4				40					349															
Daniel G. Rice			SW 1/4 of NE 1/4				40	326	18	36		349															
"			SE 1/4 of NE 1/4				40					349															
Arthur O. Miller			NE 1/4 of NW 1/4				40	405	22	13		291															
"			NW 1/4 of NW 1/4	Lot 1			56					407															
"			SW 1/4 of NW 1/4																								
"			SE 1/4 of NW 1/4	" 2			39	25	164	896		324															
Elmer E. Martin			NE 1/4 of SW 1/4				40	168		918		233															
Keyerhouser et al			NW 1/4 of SW 1/4	" 3			26	277		895		152														576	
M. P. Ry Co.			SW 1/4 of SW 1/4				40	168		918		233														374	
Jotham S. Rice			SE 1/4 of SW 1/4				40	168		918		233														13.23 Paid subsequent to Cert. No. 2075	
"			NE 1/4 of SE 1/4				40					291															
"			NW 1/4 of SE 1/4				40	675		3672		291															
"			SW 1/4 of SE 1/4				40					291															
"			SE 1/4 of SE 1/4				40					291															
Footings Carried Forward,																											
						601	25	2526	1390		4433																

18235















Tax List of Real Property in the Town of Pine River

Cass County, Minnesota, for Taxes of the Year 1915

IN WHOSE NAME ASSESSED	TO WHOM TRANSFERRED	Sold for Taxes	SUBDIVISION	Sec. or Lot	Town or Block	No. of Acres	VALUATION	GENERAL TAXES			S.P.H. No.	
								State	County	Total		
								Dollars	¢	¢	¢	¢
Footings Brought Forward,												
R. I. Geddes			NE 1/4 of NE 1/4 Lot 1	21	138	30	31	75				297
"			NW 1/4 of NE 1/4			40		638	34	87		349
"			SW 1/4 of NE 1/4			40						349
"			SE 1/4 of NE 1/4			40						349
St. Paul & Chicago			NE 1/4 of NW 1/4			40	168	918				291
R. I. Geddes			NW 1/4 of NW 1/4 2			29	55	126	688			257
"			SW 1/4 of NW 1/4 3			39	85	168	918			291
"			SE 1/4 of NW 1/4			40	168	918				291
Chas. Rohl			NE 1/4 of SW 1/4			40		336	1836			233
"			NW 1/4 of SW 1/4			40						233
St. Paul & Chicago			SW 1/4 of SW 1/4			40	168	918				233
Chas. Rohl			SE 1/4 of SW 1/4			40	168	918				233
Robert E. Snell R.E. Snell			NE 1/4 of SE 1/4			40	168	918				291
"			NW 1/4 of SE 1/4			40	168	918				291
Arthur M. Handeslich			SW 1/4 of SE 1/4			40	168	918				291
"			SE 1/4 of SE 1/4			40	168	918				291
Footings Carried Forward,												
						621	15	2612	14273			4551

SCHOOL DISTRICT	TOTAL TAXES	PAID	WHEN PAID	No. of Receipt	March Settlement	June Settlement	Penalty	November Settlement	Penalty	Collections to First Monday in January	Penalty	Delinquent on First Monday in January	REMARKS
	4811		2nd Half Paid OCT 5 - 1916 1st Half Paid MAY 31 1916	7806 5669		2406		2405					
	1209		2nd Half Paid OCT 5 - 1916 1st Half Paid MAY 31 1916	7806 5669		604		605					
	945		Paid in Full MAR 14 1916	2190		945							
	1209		2nd Half Paid OCT 5 - 1916 1st Half Paid MAY 31 1916	7806 5669		1209		1209					
	2302		2nd Half Paid OCT 24 1916 1st Half Paid MAY 31 1916	8448 5509		1151		1151					
	1151		Paid in Full MAR 14 1916 2nd Half Paid OCT 24 1916	2190 8448		1151							See Rec.
	1151		1st Half Paid MAY 31 1916	5509		450		701					
	1209		Paid in Full APR 19 1916	4786		4786							
	1209		Paid in Full APR 19 1916	4786		4786							
	1209		Paid in Full JAN 6 1916	178		3418							
	1209		Paid in Full JAN 6 1916	178		3418							
Footings Carried Forward,													
						18823							







Tax List of Real Property in the Town of Pine River

Cass County, Minnesota, for Taxes of the Year 1915

IN WHOSE NAME ASSESSED	TO WHOM TRANSFERRED	Sold for Taxes	SUBDIVISION	Sec. or Lot	Town or Block	No. of Acres	VALUATION	GENERAL TAXES			S.P.H. Dist. No.	SCHOOL DISTRICT		TOTAL TAXES	PAID	WHEN PAID	No. of Receipt	March Settlement	June Settlement	Penalty	November Settlement	Penalty	Collections to First Monday in January	Penalty	Delinquent on First Monday in January	REMARKS		
								State	County	Local		District No.	Rate														Rate	
							Dollars	\$	cts.	\$	cts.	\$	cts.	Month	Day	Year	\$	cts.	\$	cts.	\$	cts.	\$	cts.	\$	cts.	\$	cts.
Footings Brought Forward,																												
Robert a Rice	Herbert B. Oliver		all NE Sw. 27 of NE 1/4 of NE 1/4 K. Ry	22	138	30	13	92	497		182																	
John J. Vaughn			NW 1/4 of NE 1/4 5 acres of Sw NW				5	23	126		59																	
P. Benjamin			SW 1/4 of NE 1/4 " " SE..				1	14	76		12																	
Albert Castoldo			SE 1/4 of NE 1/4 " " " "				1	14	76		12																	
J. A. Taylor	R. E. Snell		NE 1/4 of NW 1/4 4.81 acs. of SW NW				4	81	45		56																	
Joe Mueller			NW 1/4 of NW 1/4 " " NE SW				1	49	267		12																	
			SW 1/4 of NW 1/4																									
			SE 1/4 of NW 1/4																									
			NE 1/4 of SW 1/4																									
			NW 1/4 of SW 1/4																									
			SW 1/4 of SW 1/4																									
			SE 1/4 of SW 1/4																									
			NE 1/4 of SE 1/4																									
			NW 1/4 of SE 1/4																									
			SW 1/4 of SE 1/4																									
			SE 1/4 of SE 1/4																									
Footings Carried Forward,							25	81	236	1288	303																	

649 Paid in Full FEB 29 1916 1747  
 173 Paid in Full APR 18 1916 2719  
 88 Paid Feb 27 1916 627  
 88 is Half Paid DEC 30 1916 1042  
 88 is Half Paid MAY 31 1916 6350  
 2nd Half Paid OCT 2 1916 8210  
 302 is Half Paid MAY 31 1916 6742  
 279 ✓  
 649 ✓  
 175 ✓  
 44 ✓  
 151 ✓  
 151 ✓  
 101 Pd Sub to Cert no. 843.







Tax List of Real Property in the Town of Pine River

Cass County, Minnesota, for Taxes of the Year 1915

IN WHOSE NAME ASSESSED	TO WHOM TRANSFERRED	Sold for Taxes	SUBDIVISION	Sec. or Lot	Town or Block	No. of Acres	VALUATION	GENERAL TAXES			S. R. No.	SCHOOL DISTRICT		TOTAL TAXES	PAID	WHEN PAID	No. of Receipt	March Settlement	June Settlement	Penalty	November Settlement	Penalty	Collections to First Monday in January	Penalty	Delinquent on First Monday in January	REMARKS	
								State	County	Local		District No.	District Rate														
Footings Brought Forward,																											
L. Lawrence Sleeper	J. B. Westwick		NE 1/4 of NE 1/4	24	138	30	40	168	918			1		918 x 50 99													
J. H. Kimball			NW 1/4 of NE 1/4			40	1268	918				1		918 1st Half Paid OCT 20 1916			8184								918		
L. Lawrence Sleeper			SW 1/4 of NE 1/4			40	359	1961				1		1961 1st Half Paid MAY 31 1916			5470	459		459							
"			SE 1/4 of NE 1/4			40						1														1961	
J. H. Kimball	J. B. Westwick		NE 1/4 of NW 1/4			40	168	918				14		918 1st Half Paid OCT 20 1916			8184										
H. S. Gilbert			NW 1/4 of NW 1/4			40	168	918				14		918 1st Half Paid OCT 31 1916			8222	459		459							
J. H. Kimball	J. B. Westwick		SW 1/4 of NW 1/4			40	336	1836				14		1836 1st Half Paid OCT 31 1916			8184	459		459							
"			SE 1/4 of NW 1/4			40						14					5470	918		918							
J. Ray Blackburn			NE 1/4 of SW 1/4			40																					233
"			NW 1/4 of SW 1/4			40	679	3710				14		4642 Paid in Full FEB 29 1916			1576	4642									233
"			SW 1/4 of SW 1/4			40																					233
"			SE 1/4 of SW 1/4			40																					233
Minna Park Assn			NE 1/4 of SE 1/4			40	168	918				1		1093 Paid in Full FEB 8 - 1916			449	1093									
L. Lawrence Sleeper			NW 1/4 of SE 1/4			40	168	918				1		1093 x 50 99													175
H. S. Gilbert			SW 1/4 of SE 1/4			40	336	1836				1		2186 1st Half Paid OCT 31 1916			9222										175
"			SE 1/4 of SE 1/4			40						1					6930	1093		1093							175
Footings Carried Forward,																											
				640		2918	14851		1632																		







Tax List of Real Property in the Town of Pine River

Cass County, Minnesota, for Taxes of the Year 1915

IN WHOSE NAME ASSESSED	TO WHOM TRANSFERRED	Sold for Taxes	SUBDIVISION	Sec. or Lot	Town or Block	No. of Acres	VALUATION	GENERAL TAXES			SCHOOL DISTRICT	TOTAL TAXES	PAID	WHEN PAID	No. of Receipt	March Settlement	June Settlement	Penalty	November Settlement	Penalty	Collections to First Monday in January	Penalty	Delinquent on First Monday in January	REMARKS																				
								State	County	Local															District No.	Rate	Rate	Rate	Rate	Rate	Rate	Rate	Rate	Rate	Rate	Rate	Rate	Rate	Rate	Rate	Rate	Rate		
Footings Brought Forward,																																												
Daniel C. Rice			NE 1/4 of NE 1/4	26	138	30	40	179	978		349	14																																
Charley Strawsell			NW 1/4 of NE 1/4			40		336	1836		349	14																																
Chas. E. Webber & H. H. Hill			SW 1/4 of NE 1/4			40					349	14																																
			SE 1/4 of NE 1/4			40		168	918		349	14																																
Charley Strawsell			NE 1/4 of NW 1/4			40		214	1169		349	14																																
J. M. McDowell	Chas. E. Webber & Harry H. Hill		NW 1/4 of NW 1/4			40		336	1836		349	14																																
	do		SW 1/4 of NW 1/4			40					349	14																																
Louis & Wm. Tollefson			SE 1/4 of NW 1/4			40		168	918		349	14																																
			NE 1/4 of SW 1/4			40		336	1836		291	1																																
John Martin Lbr. Co.			NW 1/4 of SW 1/4			40					291	1																																
Louis & Wm. Tollefson			SW 1/4 of SW 1/4			40		168	918		291	1																																
			SE 1/4 of SW 1/4			40		168	918		291	1																																
C. E. Webber & H. H. Hill			NE 1/4 of SE 1/4			40		168	918		349	1																																
			NW 1/4 of SE 1/4			40		336	1836		349	1																																
Geo. Robideau			SW 1/4 of SE 1/4			40		140	765		349	1																																
C. E. Webber & H. H. Hill			SE 1/4 of SE 1/4			40		140	765		349	1																																
Footings Carried Forward,																																												

Ref. Warr # 9155 - 8/5/15  
Abatement 612



Tax List of Real Property in the Town of Pine River

Kimberly-Clower Co., Minneapolis, Minn. - 1900

IN WHOSE NAME ASSESSED

TO WHOM TRANSFERRED

Sold for Taxes

SUBDIVISION

Sec. or Lot, Town or Block, No. of Acres

VALUATION

GENERAL TAXES: State, County, Local, Total

Mills, State, School, Bonds, No.

S.R. 21

SCHOOL DISTRICT

District No., Rate, District No., Rate

TOTAL TAXES

PAID

WHEN PAID

No. of Receipt

March Settlement

June Settlement

Penalty

November Settlement

Penalty

Collections to First Monday in January

Penalty

Delinquent on First Monday in January

REMARKS

Footings Brought Forward,

A. G. Alden

NE 1/4 of NE 1/4

27 138 30 40

672 96 72

349

"

NW 1/4 of NE 1/4

40

349

"

SW 1/4 of NE 1/4

40

349

"

SE 1/4 of NE 1/4

40

349

Lillie Emerick

NE 1/4 of NW 1/4

40

191 10 44

291

Asa D. Trout

NW 1/4 of NW 1/4

40

225 12 30

291

A. G. Alden

SW 1/4 of NW 1/4

40

291

"

SE 1/4 of NW 1/4

40

168 9 18

291

St. Paul & Chicago

NE 1/4 of SW 1/4

40

168 9 18

233

"

NW 1/4 of SW 1/4

40

233

"

SW 1/4 of SW 1/4

40

506 27 54

233

"

SE 1/4 of SW 1/4

40

233

Bessie J. Hood

NE 1/4 of SE 1/4

40

168 9 18

233

Chas. H. Coate

John E. Sawyer

NW 1/4 of SE 1/4

40

233

"

SW 1/4 of SE 1/4

40

504 27 54

233

"

SE 1/4 of SE 1/4

40

233

Footings Carried Forward,

640

2600 242 08

2221

Cass County, Minnesota, for Taxes of the Year 1915

TOTAL TAXES

PAID

WHEN PAID

No. of Receipt

March Settlement

June Settlement

Penalty

November Settlement

Penalty

Collections to First Monday in January

Penalty

Delinquent on First Monday in January

REMARKS

5068

PAID in Full MAY 27 1916 4514

5068

1335

2nd Half Paid OCT 31 1916 9283  
1st Half Paid MAY 27 1916 4533

668

668

1812

PAID in Full MAY 4 1916 3100

1812

1209

PAID in Full MAY 27 1916 4514

1209

1157

PAID in Full MAY 27 1916 4514

1157

3453

PAID in Full MAR 14 1916 2190

3453

1151

PAID in Full MAY 23 1916 4053

1151

3453

2nd Half Paid OCT 30 1916 8888  
1st Half Paid MAY 31 1916 6343

1727

1727

18632







Tax List of Real Property in the Town of Pine River

IN WHOSE NAME ASSESSED	TO WHOM TRANSFERRED	Sold for Taxes	SUBDIVISION	Sec. or Lot	Town or Block	Rag.	No. of Acres		VALUATION	GENERAL TAXES			Ditch No.	
							Acres	100ths		State	County	Local		State
Footings Brought Forward,														
J. J. Stehly			NE 1/4 of NE 1/4	29	138	30	40	672						
"			NW 1/4 of NE 1/4				40							
"			SW 1/4 of NE 1/4				40							
"			SE 1/4 of NE 1/4				40							
E. A. Peterson			NE 1/4 of NW 1/4				40	672						
"			NW 1/4 of NW 1/4				40							
"			SW 1/4 of NW 1/4				40							
"			SE 1/4 of NW 1/4				40							
Evelyn Williams	R. E. Snell		NE 1/4 of SW 1/4				40	168						
E. A. Peterson			NW 1/4 of SW 1/4				40	168						
H. Gruber			SW 1/4 of SW 1/4				40	168						
Evelyn Williams	R. E. Snell		SE 1/4 of SW 1/4				40	168						
Henry Franke	<del>C. G. Webber</del>		NE 1/4 of SE 1/4				40	168						
Evelyn Williams	R. E. Snell		NW 1/4 of SE 1/4				40	336						
"			SW 1/4 of SE 1/4				40							
Henry Franke	<del>C. G. Webber</del>		SE 1/4 of SE 1/4				40	168						
Footings Carried Forward,														
							640	2688						

Cass County, Minnesota, for Taxes of the Year 1915

SCHOOL DISTRICT	TOTAL TAXES	PAID	WHEN PAID	No. of Receipt	March Settlement	June Settlement	Penalty	November Settlement	Penalty	Collections to First Monday in January	Penalty	Delinquent on First Monday in January	REMARKS
77	3672	x 5101											
		x 5102										918	
		x 5103										918	
		x 5104										918	
	3672	Paid in Full	DEC 13 1916	10840									3672 ✓ 367
	918	x 5105										918	
	918	Paid in Full	DEC 13 1916	10410									918 ✓ 918
	918	Paid	MAR 28 1917	6369									918 ✓ 918
	918	x 5106										918	
	918	Paid in Full	JAN 12 1916	535									918 ✓
	1836	x 5107										1836	
	918	Paid in Full	JAN 12 1916	535									918 ✓
Footings Carried Forward,													
14688													



Tax List of Real Property in the Town of Pine River

Standard Form No. 100, Minnesota, 1915

IN WHOSE NAME ASSESSED	TO WHOM TRANSFERRED	Sold for Taxes	SUBDIVISION	Sec. or Lot	Town or Block	Rng.	No. of Acres		VALUATION	GENERAL TAXES			Ditch No.			
							Acres	100ths		State	County	Local		Mills	State	School
										Dollars	¢	cts.	¢	cts.	¢	cts.
Footings Brought Forward,																
S. E. Whitcomb			NE 1/4 of NE 1/4	30	138	20	40		168							
J. J. Howe			NW 1/4 of NE 1/4		40				168							
S. E. Whitcomb			SW 1/4 of NE 1/4		40				336							
"			SE 1/4 of NE 1/4		40											
L. A. Walker			NE 1/4 of NW 1/4		40				168							
Wm + E. P. Price			NW 1/4 of NW 1/4		40				168							
E. E. Martin			SW 1/4 of NW 1/4		40				168							
Wm + E. P. Price			SE 1/4 of NW 1/4		40				168							
L. H. Wallace			NE 1/4 of SW 1/4		40				168							
H. Drake	B. C. Wideman		NW 1/4 of SW 1/4		40				336							
F. C. Hill			SW 1/4 of SW 1/4		40											
			SE 1/4 of SW 1/4		40				168							
L. H. Wallace			NE 1/4 of SE 1/4		40				504							
"			NW 1/4 of SE 1/4		40											
			SW 1/4 of SE 1/4		40											
Chas. A. Fall			SE 1/4 of SE 1/4		40				168							
Footings Carried Forward,										600		258				

Cass County, Minnesota, for Taxes of the Year 1915

SCHOOL DISTRICT	TOTAL TAXES	PAID	WHEN PAID	No. of Receipt	March Settlement	June Settlement	Penalty	November Settlement	Penalty	Collections to First Monday in January	Penalty	Delinquent on First Monday in January	REMARKS															
														District No. 14	District No. 14	Rate	Rate	Mills	Mills									
														Month	Day	Year	¢	cts.	¢	cts.	¢	cts.	¢	cts.	¢	cts.	¢	cts.
			2nd Half Paid																									
			1st Half Paid																									
			918 Paid in full																									
			2nd Half Paid																									
			1st Half Paid																									
			918 Paid																									
			918 Paid																									
			918 Paid																									
			918 Paid																									
			918 Paid																									
			918 Paid																									
			918 Paid																									
			918 Paid																									
			918 Paid																									
			918 Paid																									
			918 Paid																									
			918 Paid																									
			918 Paid																									
			918 Paid																									
			918 Paid																									
			918 Paid																									
			918 Paid																									
			918 Paid																									
			918 Paid																									
			918 Paid																									
			918 Paid																									
			918 Paid																									
			918 Paid																									
			918 Paid																									
			918 Paid																									
			918 Paid																									
			918 Paid																									
			918 Paid																									
			918 Paid																									
			918 Paid																									
			918 Paid																									
			918 Paid																									
			918 Paid																									
			918 Paid																									
			918 Paid																									
			918 Paid																									
			918 Paid																									
			918 Paid																									
			918 Paid																									
			918 Paid																									
			918 Paid																									
			918 Paid																									
			918 Paid																									
			918 Paid																									
			918 Paid																									
			918 Paid																									
			918 Paid																									
			918 Paid																									
			918 Paid																									
			918 Paid																									
			918 Paid																									
			918 Paid																									
			918 Paid																									
			918 Paid																									
			918 Paid																									
			918 Paid																									
			918 Paid																									
			918 Paid																									
			918 Paid																									
			918 Paid																									



Tax List of Real Property in the Town of Pine River

Cass County, Minnesota, for Taxes of the Year 1915

IN WHOSE NAME ASSESSED	TO WHOM TRANSFERRED	Sold for Taxes	SUBDIVISION	Sec. or Lot	Town or Rng. Block	No. of Acres	VALUATION	GENERAL TAXES					SCHOOL DISTRICT		TOTAL TAXES	PAID	WHEN PAID	No. of Receipt	March Settlement	June Settlement	Penalty	November Settlement	Penalty	Collections to First Monday in January	Penalty	Delinquent on First Monday in January	REMARKS				
								State	Mills	State Sch.	County	Local	Total	District No.														District 1 No.			
							Dollars	¢	cts.	¢	cts.	¢	cts.	¢	cts.	Month	Day	Year	¢	cts.	¢	cts.	¢	cts.	¢	cts.	¢	cts.	¢	cts.	
Footings Brought Forward,																															
W. Grubler			NE 1/4 of NE 1/4	31	13830	40	336																								
"			NW 1/4 of NE 1/4			40																									
Irue Dabill			SW 1/4 of NE 1/4			40	168																								
Mary Jaenische			SE 1/4 of NE 1/4			40	168																								
J. J. Peterson			NE 1/4 of NW 1/4			40																									
"			NW 1/4 of NW 1/4			40	672																								
"			SW 1/4 of NW 1/4			40																									
"			SE 1/4 of NW 1/4			40																									
"			NE 1/4 of SW 1/4			40	336																								
"			NW 1/4 of SW 1/4			40																									
J. E. Newman			SW 1/4 of SW 1/4			40	336																								
"			SE 1/4 of SW 1/4			40																									
A. E. Brown			NE 1/4 of SE 1/4			40	168																								
E. L. Townsend			NW 1/4 of SE 1/4			40	168																								
"			SW 1/4 of SE 1/4			40	168																								
"			SE 1/4 of SE 1/4			40	168																								
Footings Carried Forward,							640	2688																							

1836 ✓

5720

1055 Paid subsequent to Cert. No. 3807.

918 Paid in Full OCT 30 1916 8980

572 ✓

1055 Paid subsequent to Cert. No. 3808.

918 Paid in Full APR 27 1916 2957

918

2nd Half Paid OCT 31 1916 9752

3672 1st Half Paid MAY 22 1916 4012

1836

1836

2nd Half Paid OCT 31 1916 9752

1836 1st Half Paid MAY 22 1916 4012

918

918

1836 Paid in Full MAY 10 1916 3288

1836

918 Paid in Full MAY 31 1916 6038

2nd Half Paid OCT 16 1916

918 1st Half Paid MAY 10 1916

918

2nd Half Paid OCT 16 1916 8019

918 1st Half Paid MAY 10 1916 3294

2nd Half Paid OCT 16 1916

918 1st Half Paid MAY 10 1916

1377

1377

14688



Tax List of Real Property in the Town of Pine River

Cass County, Minnesota, for Taxes of the Year 1915

IN WHOSE NAME ASSESSED	TO WHOM TRANSFERRED	Sold for Tax	SUBDIVISION	Sec. or Lot	Town or Block	No. of Acres	VALUATION	GENERAL TAXES				Ditch No.	SCHOOL DISTRICT		TOTAL TAXES	PAID	WHEN PAID	No. of Receipt	March Settlement	June Settlement	Penalty	November Settlement	Penalty	Collections to First Monday in January	Penalty	Delinquent on First Monday in January	REMARKS	
								State	County	Local	Total		District No.	District Rate														
								\$	cts.	\$	cts.		\$	cts.														\$
			Footings Brought Forward,																									
A. E. Brown			NE 1/4 of NE 1/4	32	138	30	40						14															
"			NW 1/4 of NE 1/4				40						14															
"			SW 1/4 of NE 1/4				40						14															
Cooper & Gray			SE 1/4 of NE 1/4				40						14															
H. Gruber			NE 1/4 of NW 1/4				40						1															
"			NW 1/4 of NW 1/4				40						1															
A. E. Brown			SW 1/4 of NW 1/4				40						1															
"			SE 1/4 of NW 1/4				40						1															10 50 Paid subsequent to Cert. No. 3809.
H. Gruber			NE 1/4 of SW 1/4				40						1															
"			NW 1/4 of SW 1/4				40						1															
"			SW 1/4 of SW 1/4				40						1															
A. E. Brown			SE 1/4 of SW 1/4				40						1															
Louise Lahl			NE 1/4 of SE 1/4				40						1															
A. E. Brown			NW 1/4 of SE 1/4				40						1															
J. S. Rice			SW 1/4 of SE 1/4				40						1															
"			SE 1/4 of SE 1/4				40						1															
			Footings Carried Forward,				40																					

14688

See Receipt



Tax List of Real Property in the Town of Pine River

Cass County, Minnesota, for Taxes of the Year 1915

IN WHOSE NAME ASSESSED	TO WHOM TRANSFERRED	Sold for Taxes	SUBDIVISION	Sec. or Lot	Town or Block	No. of Acres	VALUATION	GENERAL TAXES				Ditch No.	SCHOOL DISTRICT		TOTAL TAXES	PAID	WHEN PAID	No. of Receipt	March Settlement	June Settlement	Penalty	November Settlement	Penalty	Collections to First Monday in January	Penalty	Delinquent on First Monday in January	REMARKS
								State	County	Town	Local		District No.	District Rate													
			Footings Brought Forward,																								
M. D. Obeasani			NE 1/4 of NE 1/4	33	138	30	40																				
"			NW 1/4 of NE 1/4			40	672					14															
"			SW 1/4 of NE 1/4			40																					
"			SE 1/4 of NE 1/4			40																					
Minn. Park Association			NE 1/4 of NW 1/4			40	168					14															
E. L. Atwood			NW 1/4 of NW 1/4			40	168					14															
Belle G. Hagen			SW 1/4 of NW 1/4			40	168					14															
Minn. Park Association			SE 1/4 of NW 1/4			40	168					14															
N. P. Ry Co.			NE 1/4 of SW 1/4			40	168					1															
Belle G. Hagen			NW 1/4 of SW 1/4			40	168					1															
Pearl E. Richards			SW 1/4 of SW 1/4			40	168					1															
<del>E. M. Hansen</del> Jan Root			SE 1/4 of SW 1/4			40	168					1															
Martin Mattison			NE 1/4 of SE 1/4			40	168					1															
<del>E. O. Smith</del>	E. E. Martin		NW 1/4 of SE 1/4			40						1															
"	"		SW 1/4 of SE 1/4			40	504					1															
"	"		SE 1/4 of SE 1/4			40						1															
			Footings Carried Forward,			40	2688																				

2nd Half Paid OCT 27 1916 8712  
1st Half Paid MAY 31 1916 4844

See Receipt

1055 Paid subsequent to Cert. No. 2091

1055 Paid subsequent to Cert. No. 2092

1055 Paid subsequent to Cert. No. 2810

918 ✓ 92

2nd half paid May 31 1916 5481  
1st half paid MAY 31 1916 6832

1377  
1377

14688



Tax List of Real Property in the Town of Pine River

Cass County, Minnesota, for Taxes of the Year 1915

IN WHOSE NAME ASSESSED	TO WHOM TRANSFERRED	Sold for Taxes	SUBDIVISION	Sec. or Lot	Town or Block	No. of Acres	VALUATION	GENERAL TAXES			No. CRH	SCHOOL DISTRICT		TOTAL TAXES	PAID	WHEN PAID	No. of Receipt	March Settlement	June Settlement	Penalty	November Settlement	Penalty	Collections to First Monday in January	Penalty	Delinquent on First Monday in January	REMARKS
								State	County	Local		District No.	District Rate													
Footings Brought Forward,																										
C. E. Brown			NE 1/4 of NE 1/4	34	138	30	40	168	918		233			1151	Paid in full MAY 30 1916	4715										
Arthur O. Miller			NW 1/4 of NE 1/4				40	168	918		233			1151	1st Half Paid OCT 31 1916	9979										
			SW 1/4 of NE 1/4								233					6794										
C. E. Brown			SE 1/4 of NE 1/4				40	168	918		233															
H. E. Lode			NE 1/4 of NW 1/4				40	168	918		175															
A. B. Allen			NW 1/4 of NW 1/4				40	168	918		175															
H. E. Lode			SW 1/4 of NW 1/4				40	336	1836		175															
"			SE 1/4 of NW 1/4				40				175															
"			NE 1/4 of SW 1/4				40	168	918																	
Mpls. & St. L. Ry Co.	E. E. Martin		NW 1/4 of SW 1/4				40																			
"	"		SW 1/4 of SW 1/4				40																			
"	"		SE 1/4 of SW 1/4				40	504	2754																	
"	"						40																			
John Buck			NE 1/4 of SE 1/4				40	336	1836																	
"			NW 1/4 of SE 1/4				40																			
P. E. Lindberg			SW 1/4 of SE 1/4				40	168	918																	
John Buck			SE 1/4 of SE 1/4				40	168	918																	
Footings Carried Forward,																										
						600	2520	13770		1632				15403												



Tax List of Real Property in the Town of Pine River

Cass County, Minnesota, for Taxes of the Year 1915

IN WHOSE NAME ASSESSED	TO WHOM TRANSFERRED	Sold for Taxes	SUBDIVISION	Sec. or Lot	Town or Block	No. of Acres	VALUATION	GENERAL TAXES			S.P. No.	SCHOOL DISTRICT		TOTAL TAXES	PAID	WHEN PAID	No. of Receipt	March Settlement	June Settlement	Penalty	November Settlement	Penalty	Collections to First Monday in January	Penalty	Delinquent on First Monday in January	REMARKS										
								State	County	Local		District No.	District Rate																							
Footings Brought Forward,																																				
Albina Hokanson			NE 1/4 of NE 1/4	35	138	30	40	168	918		249			1267	Paid in Full	FEB 22 1916	968																			
Chas. Anderson	Morris Billeaden		NW 1/4 of NE 1/4	Lot 1		32	50	108	690		284			874	Paid in Full	APR 7 - 1916	2498																			
Albin Hokanson			SW 1/4 of NE 1/4	" 2		29	20	290	1585		251			2188	Paid in Full	FEB 22 1916	968																			
"			SE 1/4 of NE 1/4			40					349																									
F. J. Thomas			NE 1/4 of NW 1/4	" 5																																
"			NW 1/4 of NW 1/4			43	50	181	989		316			1305	2nd Half Paid	OCT 21 1916	8212																			
Levi Garlock			SW 1/4 of NW 1/4	" 4		39	99	349	1907		291			2514	1st Half Paid	MAY 25 1916	4318		653		653															
"			SE 1/4 of NW 1/4	" 3		43	50				316															2891 Paid subsequent to Cert. No. 3814										
Pine River Land Co.	Jay P. Brewer		NE 1/4 of SW 1/4	H		40		168	918		175			1093	Paid in Full	MAY 16 1916	3567																			
Levi Garlock			NW 1/4 of SW 1/4			40		168	918		175			1093																						
Nels Holman			SW 1/4 of SW 1/4			40		168	918		175			1093	2nd Half Paid	OCT 31 1916	5725																			
Pine River Land Co.	Jay P. Brewer		SE 1/4 of SW 1/4			40		168	918		175			1093	1st Half Paid	MAY 31 1916	6334										1257 Paid subsequent to Cert. No. 3815									
Jay P. Brewer			NE 1/4 of SE 1/4			40		168	918		233			1093	Paid in Full	MAY 16 1916	3567																			
Henry Caron	Jay P. Brewer		NW 1/4 of SE 1/4			40		336	1836		232			2302	2nd Half Paid	OCT 20 1916	8160																			
"			SW 1/4 of SE 1/4			40					232			1277	1st Half Paid	MAY 22 1916	3958																			
Jay P. Brewer			SE 1/4 of SE 1/4			40		191	1044		233			1277	2nd Half Paid	OCT 20 1916	8160																			
Footings Carried Forward,																																				
						588	69	2463	13459		2791			17257																						



Tax List of Real Property in the Town of Pine River

Cass County, Minnesota, for Taxes of the Year 1915

IN WHOSE NAME ASSESSED	TO WHOM TRANSFERRED	Sold for Taxes	SUBDIVISION	Sec. or Lot	Town or Block	No. of Acres	VALUATION	GENERAL TAXES			S. R. H. Dist. No.	SCHOOL DISTRICT		TOTAL TAXES	PAID	WHEN PAID	No. of Receipt	March Settlement	June Settlement	Penalty	November Settlement	Penalty	Collections to First Monday in January	Penalty	Delinquent on First Monday in January	REMARKS	
								State	County	Town		Local	State														School
Footings Brought Forward,																											
J. J. McNeal H. J. McNeal H. J. Middlecoff E. W. Knapp	Farmers St. Pine River		NE 1/4 of NE 1/4 Lot 1	36	138	30	51	159	869		319				2nd Half Paid DEC 28 1916 10331												
			NW 1/4 of NE 1/4			40		159	869		319				1218 1st Half Paid MAY 31 1916 5113			609									
	Ed. J. P. Staede		SW 1/4 of NE 1/4			40		159	869		319				1218 Paid in Full NOV 21 1916 10154												
			SE 1/4 of NE 1/4			40		159	869		319				1218 2nd Half Paid OCT 31 1916 9974												
						40		159	869		319				1218 1st Half Paid MAY 31 1916 8784			609		609							
Chas. E. Heber Frank L. Hill Chas. E. Heber Harry L. Hill	Garet Harris		NE 1/4 of NW 1/4 less Ry Rt way	39	23		164	896		341					1237 2nd Half Paid OCT 30 1916 8889												
			NW 1/4 of NW 1/4	36	07		174	850		314					1237 1st Half Paid MAY 31 1916 6345			619		618							
			SW 1/4 of NW 1/4	40			168	918		349					1264 1st Half Paid MAY 31 1916 9864			633		632							
			SE 1/4 of NW 1/4	36	74		154	841		322					1267 2nd Half Paid OCT 30 1916 8889												
John N. Chas. Schumacher Gearey + Hill John N. J. P. Leaf M. H. Davis H. J. Middlecoff J. P. Leaf M. H. Davis			NE 1/4 of SW 1/4	40						291					1163 2nd Half Paid OCT 30 1916 6345			1215		1265							
			NW 1/4 of SW 1/4	40						291					4836 Paid in Full MAY 31 1916 5241			4836									
			SW 1/4 of SW 1/4	40			672	3672		291																	
			SE 1/4 of SW 1/4	40						291																	
			8 1/2 of SE 1/4 SE 1/4	30			140	765		175					2nd Half Paid OCT 31 1916 9499												
			NE 1/4 of SE 1/4	40						291					940 1st Half Paid MAY 15 1916 3517			470		470							
	Ed. J. P. Staede		NW 1/4 of SE 1/4	40			168	918		349					1267 2nd Half Paid OCT 31 1916 9974												
			SW 1/4 of SE 1/4 less 7 ac. in late	33			139	759		288					1267 1st Half Paid MAY 31 1916 5971			634		633							
			7 1/2 SE 1/4 of SE 1/4	30			84	468		288					1047 2nd Half Paid OCT 31 1916 9499			529		518							
															1047 1st Half Paid MAY 15 1916 3517												
Footings Carried Forward,																											
55649 3415 13195 4695 17893																											

See Rec.



Tax List of Real Property in the Town of Pine River

Standard-Grain Co., Minneapolis, Minn. - 1900

IN WHOSE NAME ASSESSED

TO WHOM TRANSFERRED

Sold for Taxes

SUBDIVISION

Sec. or Lot, Town or Block, Reg.

No. of Acres, Acres, 100ths

VALUATION

GENERAL TAXES

State, State Sch., County, Town, Local Sch., Total

Mills

State

School

Bonds

Ditch No.

Dollars, cents, etc.

SCHOOL DISTRICT

District No., District No., Rate, Rate

TOTAL TAXES

PAID

WHEN PAID

No. of Receipt

March Settlement

June Settlement

Penalty

November Settlement

Penalty

Collections to First Monday in January

Penalty

Delinquent on First Monday in January

REMARKS

Mildred

Footings Brought Forward,

Albert Castold

NE 1/4 of NE 1/4

1

NW 1/4 of NE 1/4

2

SW 1/4 of NE 1/4

3

SE 1/4 of NE 1/4

4

NE 1/4 of NW 1/4

5

NW 1/4 of NW 1/4

6

SW 1/4 of NW 1/4

7

SE 1/4 of NW 1/4

8

NE 1/4 of SW 1/4

9

NW 1/4 of SW 1/4

10

SW 1/4 of SW 1/4

11

SE 1/4 of SW 1/4

12

NE 1/4 of SE 1/4

13

NW 1/4 of SE 1/4

14

SW 1/4 of SE 1/4

15

SE 1/4 of SE 1/4

16

Footings Carried Forward,

187

E. W. James

Albert Castold

John E. + J. P. Batchelder

Albert Castold

46

28

21

84

8

10421 Paid DEC 30 1916  
257 as Half Paid MAY 31 1916 6350

125

126 12

3138 Paid in Fall MAY 5 1916

153

10421 Paid DEC 30 1916  
115 as Half Paid MAY 31 1916 6350

58

57 06

3072 Paid in Fall MAY 3 1916

459

10421 Paid DEC 30 1916  
44 as Half Paid MAY 31 1916 6350

22

22 12

Cass County, Minnesota, for Taxes of the Year 1915



Tax List of Real Property in the Town of Pine River

Cass County, Minnesota, for Taxes of the Year 1915

IN WHOSE NAME ASSESSED	TO WHOM TRANSFERRED	Sold for Taxes	SUBDIVISION	Sec. or Lot	Town or Block	No. of Acres	VALUATION	GENERAL TAXES			Ditch No.	SCHOOL DISTRICT		TOTAL TAXES	PAID	WHEN PAID	No. of Receipt	March Settlement	June Settlement	Penalty	November Settlement	Penalty	Collections to First Monday in January	Penalty	Delinquent on First Monday in January	REMARKS
								State	County	Local		District No.	District Rate													
			Footings Brought Forward,																							
<i>Albert Eastrol</i>			NE 1/4 of NE 1/4	22	2		59																			
"			NW 1/4 of NE 1/4	23																						
"			SW 1/4 of NE 1/4	24																						
"			SE 1/4 of NE 1/4	1																						
"			NE 1/4 of NW 1/4	2																						
"			NW 1/4 of NW 1/4	3																						
"			SW 1/4 of NW 1/4	4																						
"			SE 1/4 of NW 1/4	5																						
"			NE 1/4 of SW 1/4	6																						
"			NW 1/4 of SW 1/4	7																						
"			SW 1/4 of SW 1/4	8																						
"			SE 1/4 of SW 1/4	9																						
"			NE 1/4 of SE 1/4	10		25																				
"			NW 1/4 of SE 1/4	11		4																				
"			SW 1/4 of SE 1/4	12		4																				
"			SE 1/4 of SE 1/4	13		4																				
			Footings Carried Forward,				100																			

322 is Half Paid DEC 30 1916 10421  
 is Half Paid MAY 31 1916 6350  
 161  
 161 16  
 137 is Half Paid DEC 30 1916  
 is Half Paid MAY 31 1916  
 22 is Half Paid DEC 30 1916  
 is Half Paid MAY 31 1916 10421  
 22 is Half Paid DEC 30 1916 6350  
 113  
 22 is Half Paid DEC 30 1916  
 is Half Paid MAY 31 1916  
 22 is Half Paid DEC 30 1916  
 is Half Paid MAY 31 1916  
 112 11

547







Tax List of Real Property in the Town of Pine River

Cass County, Minnesota, for Taxes of the Year 1915

IN WHOSE NAME ASSESSED	TO WHOM TRANSFERRED	Sold for Taxes	SUBDIVISION	Sec. or Lot	Town or Block	Reg.	No. of Acres	VALUATION	GENERAL TAXES			Ditch No.	SCHOOL DISTRICT		TOTAL TAXES	PAID	WHEN PAID	No. of Receipt	March Settlement	June Settlement	Penalty	November Settlement	Penalty	Collections to First Monday in January	Penalty	Delinquent on First Monday in January	REMARKS	
									State	County	Local Sch.		District No.	District Rate														
			Nowood					Dollars	0	cts.	0	cts.	0	cts.														
			Footings Brought Forward,																									
W. A. Spurrier			NE 1/4 of NE 1/4	12	1			6																				
"			NW 1/4 of NE 1/4	13				6																				
E. C. Shope			SW 1/4 of NE 1/4	14				112																				
W. A. Spurrier			SE 1/4 of NE 1/4	15																								
	Anna Dalton			16																								
	"		NE 1/4 of NW 1/4	17																								
	"		NW 1/4 of NW 1/4	18				39																				
	"		SW 1/4 of NW 1/4	19																								
W. A. Spurrier			SE 1/4 of NW 1/4	1	2																							
			NE 1/4 of SW 1/4	2																								
Maurice Richer			NW 1/4 of SW 1/4	3				70																				
Joseph Underleak			SW 1/4 of SW 1/4	4				112																				
W. A. Spurrier			SE 1/4 of SW 1/4	5				98																				
	Florence J. Bowler	Rayln M. Ball		6																								
W. A. Spurrier			NE 1/4 of SE 1/4	7				112																				
			NW 1/4 of SE 1/4	8				126																				
			SW 1/4 of SE 1/4	9																								
			SE 1/4 of SE 1/4	10				11																				
				11																								
J. K. Carpenter				12				56																				
			Footings Carried Forward,																									
								748																				

1st half Paid OCT 24 1916  
 33 Is Half Paid MAY 31 1916  
 33<sup>rd</sup> half Paid OCT 24 1916 } 8474  
 2nd half Paid MAY 31 1916 } 6169  
 612 Is Half Paid OCT 24 1916 }  
 1st half Paid MAY 31 1916 } 8474  
 2.15-1218 MAY 31 1916 6169

213 Lots 16 to 19 OCT 24 1916 7964

1st half Paid OCT 24 1916 } 8474  
 Lots 17 & 218 MAY 31 1916 6169

383 Paid Mar 30 1917 6371

612 Paid In Full MAY 29 1916 4606

5335

Lot 6 Paid APR 12 1916 2582

2nd half Paid OCT 24 1916 }  
 612 Is Half Paid MAY 31 1916 } 8474

2nd half Paid OCT 24 1916 }  
 688 Is Half Paid MAY 31 1916 } 6169

Lot 10 - PR. 5 5 1916 3127

60<sup>th</sup> half Paid OCT 24 1916 } 8474  
 Lot 11-1218 MAY 31 1916 6169

306

4087

306







Tax List of Real Property in the Town of Pine River

Cass County, Minnesota, for Taxes of the Year 1915

IN WHOSE NAME ASSESSED	TO WHOM TRANSFERRED	Sold for Taxes	SUBDIVISION	Sec. or Let	Town or Block	No. of Acres	VALUATION	GENERAL TAXES			SCHOOL DISTRICT		TOTAL TAXES	PAID	WHEN PAID	No. of Receipt	March Settlement	June Settlement	Penalty	November Settlement	Penalty	Collections to First Monday in January	Penalty	Delinquent on First Monday in January	REMARKS	
								State	County	Local	District No.	District 1														
Chickama Beach																										
Footings Brought Forward,																										
<del>Sereny Johnson</del>	Ella Holman		NE 1/4 of NE 1/4	4	2		13																			
				NW 1/4 of NE 1/4	5			13																		
				SW 1/4 of NE 1/4	6			13																		
E. D. Miller				SE 1/4 of NE 1/4	7			84																		
<del>A. B. Rose</del>	Jacob A. Kung		NE 1/4 of NW 1/4	8																						
				NW 1/4 of NW 1/4	9			25																		
				SW 1/4 of NW 1/4																						
				SE 1/4 of NW 1/4																						
Hannah Kinder			Lillespie's Add. P.R.		1		6																			
M. M. Jones			NE 1/4 of SW 1/4 Lots 2 & 3				84																			
Edward W. Parker			NW 1/4 of SW 1/4 " 4, 5 & 6				84																			
Hannah Kinder			SW 1/4 of SW 1/4 " 7-8-9-10-11-12				84																			
Leo Glover			SE 1/4 of SW 1/4 " " 1, 2				56																			
Jennise Kinder			NE 1/4 of SE 1/4 Lots 2-3-4-5 & 6				45																			
Peter Holmquist			NW 1/4 of SE 1/4 " 7-8-9 & 10																							
<del>Peter Holmquist</del>			SW 1/4 of SE 1/4 " 11 & 12				8																			
Dora Burrell (Lot 8)	Chas. E. Weber (Lots 1-2-3-4-5-6)		SE 1/4 of SE 1/4 " 1-2-3-4-5-6-7-8		3		18																			
Bessie Burrell			" 9-7		10		62																			
Footings Carried Forward,																										
578																										

71<sup>1/2</sup> Paid OCT 31 1916  
 71<sup>1/2</sup> Paid MAY 31 1916 } 9640  
 71<sup>1/2</sup> Paid OCT 31 1916 } 6334  
 71<sup>1/2</sup> Paid MAY 31 1916 }  
 71<sup>1/2</sup> Paid OCT 31 1916 } 8382  
 459<sup>1/2</sup> Paid MAY 31 1916 }  
 459<sup>1/2</sup> Paid OCT 24 1916 } 230  
 153 Paid in Full OCT 27 1916 8674 } 153. 15  
 33 Paid in Full MAR 17 1916 2228 } 33  
 459 Paid in Full APR 24 1916 2872 } 459  
 459 }  
 459 Paid in Full MAR 17 1916 2228 } 459  
 306 Paid in Full JAN 19 1916 } 146 } 552  
 246 Paid in Full JAN 19 1916 }  
 44 Paid in Full JUL 21 1916 7382 }  
 98<sup>1/2</sup> Paid DEC 9 1916 3212 } 20  
 229 Paid in Full MAY 8 1916 3212 } 229 } 73 } 07



Tax List of Real Property in the Town of Pine River

Cass County, Minnesota, for Taxes of the Year 1915

15

IN WHOSE NAME ASSESSED	TO WHOM TRANSFERRED	Sold for Taxes	SUBDIVISION	Sec. or Lot	Town or Block	No. of Acres	VALUATION	GENERAL TAXES			Ditch No.	SCHOOL DISTRICT		TOTAL TAXES	PAID	WHEN PAID	No. of Receipt	March Settlement	June Settlement	Penalty	November Settlement	Penalty	Collections to First Monday in January	Penalty	Delinquent on First Monday in January	REMARKS	
								State	County	Local		District No.	District Rate														
Gillespie's Add. P. R.																											
Footings Brought Forward,																											
Bessie Burrell	John Crossman		NE 1/4 of NE 1/4	11	12	3	42																				
E. B. Harmon	John Crossman		NW 1/4 of NE 1/4	1	2	3	17																				
Alice Crossman	John Crossman		SW 1/4 of NE 1/4		4	5	17																				
Helen Russell	Chas. E. Hebler		SE 1/4 of NE 1/4		6	7	34																				
Orman Stanley	Edw. O. & Emily K. Franks		NE 1/4 of NW 1/4		8		20																				
Marie H. Brundrett			NW 1/4 of NW 1/4		9	10	56																				
Catherine A. Kline			SW 1/4 of NW 1/4		11	12	11																				
Dorothy Countryman			SE 1/4 of NW 1/4		1		6																				
Hannah Kinkler			NE 1/4 of SW 1/4		1		6																				
Rosa Gillespie	John McAllister		NW 1/4 of SW 1/4		2																						
Webber + Hill			SW 1/4 of SW 1/4		3		78																				
"			SE 1/4 of SW 1/4		4																						
Annie Francis			NE 1/4 of SE 1/4		5																						
"			NW 1/4 of SE 1/4		6		42																				
"			SW 1/4 of SE 1/4																								
"			SE 1/4 of SE 1/4																								
Footings Carried Forward,																											
							329																				

17 95

229 Paid in Full MAY 8 1916 3212

92 Paid in Full MAY 31 1916 6498

92

Let 6.00 DEC 19 1916 10263

183 Paid in Full FEB 1 - 1916 348

110 Paid in Full MAY 31 1916 6487

306 Paid in Full APR 7 - 1916 2505

60 Paid in Full APR 19 1916 2762

33 Paid in Full MAR 17 1916 2228

33 Paid in Full APR 18 1916 2729

426

Let 485-27 APR 10 30 '16 8969

Let 485-61 MAY 23 1916 4091

1st Half Paid OCT 2 4 1916 8475

229 1st Half Paid MAY 31 1916 6168











Tax List of Real Property in the Town of Pine River

Cass County, Minnesota, for Taxes of the Year 1915

IN WHOSE NAME ASSESSED	TO WHOM TRANSFERRED	Sold for Taxes	SUBDIVISION	Sec. or Lot	Town or Block	Rng.	No. of Acres	VALUATION	GENERAL TAXES			SCHOOL DISTRICT		TOTAL TAXES	PAID	WHEN PAID	No. of Receipt	March Settlement	June Settlement	Penalty	November Settlement	Penalty	Collections to First Monday in January	Penalty	Delinquent on First Monday in January	REMARKS
									State	County	Town	Local	District No.													
			Snell's Addition																							
			Footings Brought Forward,																							
			NE 1/4 of NE 1/4																							
			NW 1/4 of NE 1/4																							
			SW 1/4 of NE 1/4																							
			SE 1/4 of NE 1/4																							
			NE 1/4 of NW 1/4																							
E. E. Helman			<del>NW 1/4 of NW 1/4</del> Lots 8-10					1.94																		
			SW 1/4 of NW 1/4																							
			SE 1/4 of NW 1/4																							
Mrs. Amarella Daves			n 1/2 Lot 7					2.0																		
Helen Williams			NE 1/4 of SW 1/4 L. 1 to 6					2.0																		
Robert Snell			NW 1/4 of SW 1/4 L. 12-14-15					6.0																		
			SW 1/4 of SW 1/4 s 1/2 Lot 7					.50																		
			SE 1/4 of SW 1/4																							
			NE 1/4 of SE 1/4																							
			NW 1/4 of SE 1/4																							
			SW 1/4 of SE 1/4																							
			SE 1/4 of SE 1/4																							
			Footings Carried Forward,					2.94																		

E. E. Helman

Mrs. Amarella Daves

Helen Williams

Robert Snell

~~Robert Snell~~

Wells Ladue  
 Mrs E. E. Holman  
 Mrs W. E. Holman  
 Mrs E. E. Holman

And Half Paid OCT 31 1916 9090  
 1060 is Half Paid MAY 31 1916 6500

Rel. Pd. 10/31 1916 9736  
 110 Paid 5/31 1916 6790

110  
 Lot 1 to 6 2/28 1916 1135  
 328 " 1-28 6/28 1916 7107

14715 AP 5/31 " 6717  
 s 1/2 Lot 7 - JAN 31 1916 327

32,589.23 146,744 8,018.38 53,274 7978

1608  
 892890