

Assessment & Tax List - 1963
Pike Bay

INDEX TO SECTIONS

SECTION PAGE

Sec. 1.....	
" 2.....	
" 3.....	
" 4.....	
" 5.....	
" 6.....	
" 7.....	
" 8.....	
" 9.....	
" 10.....	
" 11.....	
" 12.....	
" 13.....	
" 14.....	
" 15.....	
" 16.....	
" 17.....	
" 18.....	
" 19.....	
" 20.....	
" 21.....	
" 22.....	
" 23.....	
" 24.....	
" 25.....	
" 26.....	
" 27.....	
" 28.....	
" 29.....	
" 30.....	
" 31.....	
" 32.....	
" 33.....	
" 34.....	
" 35.....	
" 36.....	

For Convenience of Auditor in Showing Boundaries of School Districts

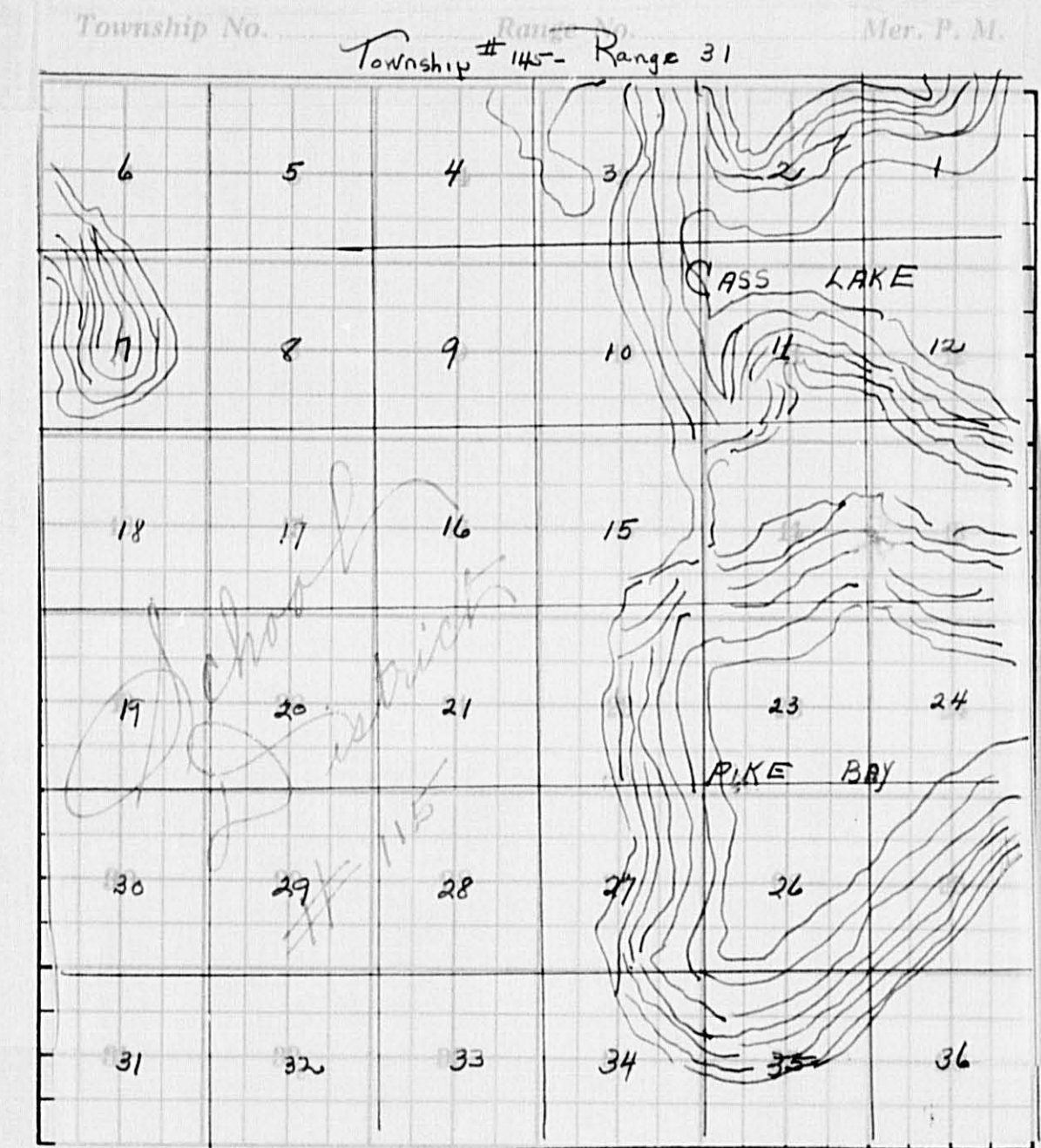

Returns Showing Grain Received in or Handled by Elevators, Warehouses and Mills in the _____ of _____ in the
County of _____ for the Year Ending May 1, 1963.

NAMES OF OWNERS	ADDRESS	SUBDIVISION 1			Total Subdivision 1 No. Bushels	★ Tax of 1/4 Mill per Bushel		SUBDIVISION 2						Total Subdivision 2 No. Bushels	★ Tax of 1/4 Mill Per Bushel		★ Total Tax	REMARKS
		Bushels of Wheat	Bushels of Soy Beans	Bushels of Flax		Dollars	Cts.	Bushels of Corn	Bushels of Barley	Bushels of Rye	Bushels of Oats	Bushels of Buckwheat	Bushels of all Other Grains		Dollars	Cts.		

Note ★ Assessors will not fill these Columns

Real Estate
 HARDING-CONDHAM A.D.M.
 SUPPLEMENTAL PLAT OF
 AUDITOR'S PLAT #3

REAL PROPERTY BECOMING SUBJECT TO TAXATION SINCE THE LAST PREVIOUS ASSESSMENT OR OMITTED FROM ASSESSMENT ROLLS THE PREVIOUS YEARS.
Assessment of Taxable Real Property in the _____ **of** _____ **County of** _____ **Minn., for the Year 19** ____.

* Indicate Type of Property: R-Residential, C-Commercial, I-Industrial, U-Utility, F-Farm, L-Lakeshore, T-Timber, M-Mineral

NAME OF OWNER	School District	DESCRIPTION OF PROPERTY					TRUE AND FULL VALUATIONS										FINAL EQUALIZED VALUE						
							ASSESSED VALUATIONS		RURAL									ALL OTHER					
		Subdivision	Sec. or Lot	Twp. or Block	Rng.	Number of Acres of Land	Indicate Homestead Yes or No	Indicate Agricultural Yes or No	Indicate Type of Property	BY WHOM VALUED	LAND Exclusive of Structures and Improvements	BUILDINGS and Other Structures	MACHINERY Permanently Attached to Real Estate	TOTAL True and Full Value	Homestead Up to \$4,000	Over \$4,000 and Non-Homestead		Homestead Up to \$4,000	Over \$4,000 and Non-Homestead	MACHINERY Permanently Attached to Real Estate	TOTAL ASSESSED VALUE		
Acres	100ths							Dollars	Dollars	Dollars	Dollars	Dollars	20%	33 1/3 %	25%	40%	33 1/3 %	Dollars	Dollars				

Total No. of Acres _____

Total Value as Equalized by _____

Total Value as Assessed by _____

SUMMARY OF TAX COLLECTION

Original Levy	\$ 46,355.96
Additions	\$ _____
Abatements	\$ 579.24
	\$ 59,776.72
COLLECTIONS	
March Settlement	\$ 30,320.00
June Settlement	\$ 15,100.24
November Settlement	\$ 10,838.44
January Settlement	\$ 383.80
	\$ _____
Over Collected	\$ 33.15
Under Collected	\$.20
Delinquent	\$ 3,167.19
Total	\$ 59,776.72

REAL PROPERTY
 HARBING-ORDINAL ADD'N
 SUPPLEMENTAL PLAT OF
 REC'D-20-11-JUNE BRACE
 AUDITOR'S PLAT #3

NAME OF OWNER

TABULAR SCHEDULE OF VALUATIONS,

LEVIED IN THE Town OF Pike Bay

RATES AND TAXES

COUNTY OF CASS, STATE OF MINNESOTA

School District No.	VALUATION BY SCHOOL DISTRICTS				RATE OF STATE TAXES	RATE OF COUNTY TAXES								RATE OF TOWN TAXES								RATE OF																
	Agricultural Lands	Non-Agricultural Lands	Personal Property	Total Value of all Property except Money and Credits	Total Rate of State Tax	Rev.	R. & B.	Welfare	Bonds and Int.	C. H. Bldg.	Pera.	Total Rate of County Tax	Rev.	R. & B.	State Loan	Pera.	Local	Special	State Loan	Deficiency	Tuition	Transportation	S. O.	B. L.	Pera.	Local	Special	State Loan	Deficiency	Tuition	Transportation	S. O.	B. L.	Pera.				
115	36,998	43,620	25,417	177,968	8.22	3151	20.	5951	1.92	2.	5.17	122.83	1.7	394	1.7	734	1750	25.	115.								1750	25.	115.									

Assessed Value	Rural	All Other	Personal Property	Total
Homestead	25,805	13,451		39,256
Non-Homestead	38,516	2846	97,350	138,712
Total	64,321	16,297	97,350	177,968

cr 6779
90571
97,350

P.P. excluding State rate

a. 305.19
na. 330.17

LOCAL 1 MILL AND SPECIAL SCHOOL TAXES BY DISTRICTS								ALL OTHER TAXES			
Local 1 Mill	Special	State Loan	Def.	C.O.	B. L.	Pera	Total School Taxes	FUNDS	Rate	Amounts	
								State - Non-Homestead,		117706	
								State - Homestead,		140724	
								County Revenue,		560797	
								County Road and Bridge,		355936	
								County Welfare,		1059087	
								Bonds and Interest		34190	
								C. H. Bldg		35594	
								Pera		92009	
								Town Revenue,		30254	
								Town Road and Bridge,		70117	
								Town State Loan.		30254	
								Misc		130627	
								School Local 1 Mill,		790993	
								School Special,		2046632	
								School State Loan,			
								Deficiency			
								Tuition			
								Transportation			
								C.O.		231359	
								B. L.		266957	
								Pera		124577	
										34,60512	

County
Co. Nurse 15669
Civil Def. 3203
Agric Assn. 8542
Transp. 21000
21,860.27

Total Levied, \$60,355.96

Total Number of Acres 8103.20

State of Minnesota, ss. _____

COUNTY OF CASS

Auditor of said County and State aforesaid, do hereby certify that the foregoing is a true and correct Schedule, showing the valuation of all the taxable property, in the Town of Pike Bay, in said County, the several rates of Taxation and Totals of the several Tax Funds levied thereon for the year A. D. 1963 payable December day of December A. D. 1963

Witness my hand and official seal, this _____ day of _____ A. D. 1963

SEAL

County Auditor

60,355.96

Total Taxes Real Estate 26,724.72

Pers. Prop. 33,631.24

Total 60,355.96

Assessment of T

COLLECTIONS OF TAXES OF 1966 OF CASS COUNTY, MINNESOTA

NAME OF OWNER	FUNDS				REDUCTIONS	Total Reductions and Collected	BALANCE UNCOLLECTED	ADDITIONS	Total Uncollected to First Monday in January, 1966
	MARCH SETTLEMENT 1966	JUNE SETTLEMENT 1966	NOV. SETTLEMENT 1966	Amount Collected from Nov. 1964 to First Monday in Jan. 1966					
	State-Non-Homestead, 749.48	230.46	154.20	676					
	State-Homestead, 691.34	373.58	258.49	900					
	County Revenue, 2763.58	1431.01	1023.31	3677					
	County Road and Bridge, 1784.10	908.29	649.52	3334					
	County Welfare, 5219.32	2702.63	1932.63	6945					
	County Bond and Interest, 168.39	87.21	62.35	251					
	<i>Cg. Mchru</i> , 77.18	39.96	28.58	103					
	<i>P&A</i> , 4533.44	234.79	1679.0	603					
	<i>Cw. Ref.</i> , 15.99	8.17	5.85	22					
	Town Revenue, 149.11	77.20	55.21	198					
	Town Road and Bridge, 345.56	178.93	127.95	464					
	Town State Loan, <i>Fire</i> , 149.41	77.21	55.21	198					
	School Local 1 Mill, 4306.85	1772.39	1329.00	4104					
	School Special, 10086.07	5222.68	3734.72	13421					
	School State Loan, 1140.16	590.39	422.19	1518					
	Deficiency, 315.58	681.21	487.14	1751					
	Tuition, 613.93	317.91	227.33	818					
	Transportation, 1315.58	681.21	487.14	1751					
	<i>C.O.</i> , 1140.16	590.39	422.19	1518					
	<i>B+D</i> , 1315.58	681.21	487.14	1751					
	<i>PERA</i> , 613.93	317.91	227.33	818					
	<i>C.H. Berg</i> , 175.42	90.83	64.95	233					
	<i>Agree Assn</i> , 42.10	21.80	15.59	56					
	<i>Transf</i> , 103.49	53.59	38.32	138					
	30320.00	15100.24	10838.44	38380					

MARCH SETTLEMENT	School District No.	LOCAL 1 MILL	SPECIAL	STATE LOAN	<i>Deficiency</i>	<i>C.O.</i>	<i>B+D</i>	<i>PERA</i>	TOTALS
Totals			4306.85		10086.07	1140.16	1315.58	613.93	17462.59
JUNE SETTLEMENT	115a 115na		498.35 1274.04		2292.40 2930.28	359.14 331.25	299.00 382.21	134.54 178.37	3488.43 5096.15
Totals			1772.39		5222.68	590.39	681.21	317.91	8584.58
NOVEMBER SETTLEMENT	115a 115na		296.78 1030.22		1365.20 2369.52	154.33 267.86	178.07 309.07	83.10 144.23	2077.48 4120.90
Totals			1327.00		3734.72	422.19	487.14	227.33	6198.38
NOVEMBER to JANUARY	115a 115na		1730 2374		7958 5463	900 618	1038 713	485 333	1211 9501
Totals			4104		13421	1518	1751	818	21602
ADDITIONS									
Totals									
REDUCTIONS									
Totals									

Real Estate

AUDITOR'S PLAT #3
SUPPLEMENTAL PLAT OF
BIG POND - MINN. RANGE

AUDITOR'S PLAT #3

Assessment Roll and Tax List of Real Property in the Town of Pike Bay

Cass County, Minnesota, for Taxes for the Year 1963.

Form 5CD MILLER-DAVIS CO., MINNEAPOLIS

* Indicate Type of Property: R-Residential, C-Commercial, I-Industrial, U-Utility, F-Farm, L-Lakeshore, T-Timber, M-Mineral

Table with columns: IN WHOSE NAME ASSESSED, DESCRIPTION OF PROPERTY, TRUE AND FULL VALUATIONS, ASSESSED VALUATIONS, VALUATIONS BY SCHOOL DISTRICTS AS EQUALIZED BY DEPARTMENT OF TAXATION, SOLD FOR TAXES, PAID, WHEN PAID, Number of Receipt, March Settlement, June Settlement, November Settlement, Collections to First Monday in January 1965, Delinquent on First Monday in January 1965, Total Delinquent Tax and Penalty, REMARKS.

1 145-31

1

1 N E 1/4 of N E 1/4 1 145 31 115
2 N W 1/4 of N E 1/4
3 S W 1/4 of N E 1/4
4 S E 1/4 of N E 1/4
5
6 N E 1/4 of N W 1/4 GOV'T LOT 1
7 N W 1/4 of N W 1/4 Flatted "Whung Point" (Star Island)
8 S W 1/4 of N W 1/4
9 S E 1/4 of N W 1/4
10
11 N E 1/4 of S W 1/4
12 N W 1/4 of S W 1/4
13 S W 1/4 of S W 1/4
14 S E 1/4 of S W 1/4
15
16 N E 1/4 of S E 1/4
17 N W 1/4 of S E 1/4
18 S W 1/4 of S E 1/4
19 S E 1/4 of S E 1/4
20

Auditor's Plat #3, Supplemental Plat of, Hardinc-Orndahl Add'n, Hardinc-Orndahl Add'n

Assessment Roll and Tax List of Real Property in the Town of Lake Park

Cass County, Minnesota, for Taxes for the Year 1963.

Form 50D - MILLER-DAVIS CO., MINNEAPOLIS

* Indicate Type of Property: R-Residential, C-Commercial, I-Industrial, U-Utility, F-Farm, L-Lakeshore, T-Timber, M-Mineral

Real Estate 145-31

IN WHOSE NAME ASSESSED	DESCRIPTION OF PROPERTY				No. School District	Indicate Homestead Yes or No	Agri. Rec. Yes or No	Indicate Type of Property	TRUE AND FULL VALUATIONS				ASSESSED VALUATIONS							FINAL EQUALIZED VALUE	
	SUBDIVISION	Sec. or Lot	Town or Block	Rng.					Number of Acres of Land	LAND Exclusive of Structures and Improvements	BUILDINGS and Other Structures	MACHINERY Permanently Attached to Real Estate	TOTAL True and Full Value	RURAL					TOTAL ASSESSED VALUE		Total Assessed Value as Equalized by the Board of Review
														Acres	100ths	Homestead Up to \$4,000 20%	Over \$4,000 and Non-Homestead 33 1/2%	Timber Land Class 3e 20%			
									Dollars	Dollars	Dollars	Dollars	Dollars	Dollars	Dollars	Dollars	Dollars	Dollars			
	NE 1/4 of NE 1/4		2	145-31																	
	NW 1/4 of NE 1/4																				
	SW 1/4 of NE 1/4																				
	SE 1/4 of NE 1/4																				
	NE 1/4 of NW 1/4																				
	NW 1/4 of NW 1/4																				
Charles R. + Clara M. J. Hansen	SW 1/4 of NW 1/4				25-25		No	70	R												
	SE 1/4 of NW 1/4																				
	NE 1/4 of SW 1/4																				
	NW 1/4 of SW 1/4																				
	SW 1/4 of SW 1/4																				
	SE 1/4 of SW 1/4																				
	NE 1/4 of SE 1/4																				
	NW 1/4 of SE 1/4																				
	SW 1/4 of SE 1/4																				
	SE 1/4 of SE 1/4																				
					25-25																

SOLD FOR TAXES	VALUATIONS BY SCHOOL DISTRICTS AS EQUALIZED BY DEPARTMENT OF TAXATION						Tax including State Homestead	State Tax on Non-Homestead	SPECIAL TAXES	SPECIAL TAXES	TOTAL TAXES	PAID	WHEN PAID	Number of Receipt	March Settlement 1964	June Settlement 1964	Penalty	November Settlement 1964	Penalty	Collections to First Monday in January 1965	Penalty	Delinquent on First Monday in January 1965	Total Delinquent Tax and Penalty	REMARKS
	District No.	District No.	District No.	District No.	District No.	District No.																		
	Rate	Rate	Rate	Rate	Rate	Rate																		
	115																							
	1497						50656	1336		51992														
	1497						na 50656	1336		51992														

LIST

AUDITORS' REPORT

AUDITORS' REPORT

AUDITORS' REPORT

Assessment Roll and Tax List of Real Property in the Town of Lake Park

Cass County, Minnesota, for Taxes for the Year 1963.

Form 5CD MILLER-DAVIS CO., MINNEAPOLIS

* Indicate Type of Property: R-Residential, C-Commercial, I-Industrial, U-Utility, F-Farm, L-Lakeshore, T-Timber, M-Mineral

Main table with columns: IN WHOSE NAME ASSESSED, DESCRIPTION OF PROPERTY, TRUE AND FULL VALUATIONS, ASSESSED VALUATIONS, VALUATIONS BY SCHOOL DISTRICTS AS EQUALIZED BY DEPARTMENT OF TAXATION, TAXES, PAID, WHEN PAID, Number of Receipt, March Settlement 1964, June Settlement 1964, Penalty, November Settlement 1964, Penalty, Collections to First Monday in January 1965, Delinquent on First Monday in January 1965, Total Delinquent Tax and Penalty, REMARKS.

145-31 Real Estate

145-31 Real Estate

HARDING-TOWNSH. ADD'N

IS SUPPLEMENTAL PLAT OF REC'D-20-77-PLUM BRANCH

AUDITOR'S PLAT #3

Assessment Roll and Tax List of Real Property in the Town of Lake Park

Cass County, Minnesota, for Taxes for the Year 1963.

* Indicate Type of Property: R-Residential, C-Commercial, I-Industrial, U-Utility, F-Farm, L-Lakeshore, T-Timber, M-Mineral

IN WHOSE NAME ASSESSED	DESCRIPTION OF PROPERTY				No. School District	Indicates Home-Stead Yes or No	Agricultural Yes or No	Indicates Type of Property	TRUE AND FULL VALUATIONS			ASSESSED VALUATIONS							TOTAL ASSESSED VALUE	Total Assessed Value as Equalized by the Board of Review	FINAL EQUALIZED VALUE	SOLD FOR TAXES	VALUATIONS BY SCHOOL DISTRICTS AS EQUALIZED BY DEPARTMENT OF TAXATION								PAID	WHEN PAID	Number of Receipt	March Settlement 1964	June Settlement 1964	Penalty	November Settlement 1964	Penalty	Collections to First Monday in January 1965	Penalty	Delinquent on First Monday in January 1965	Total Delinquent Tax and Penalty	REMARKS													
	SUBDIVISION								Sec. or Lot	Town or Block	Number of Acres of Land	LAND Exclusive of Structures and Improvements	BUILDINGS and Other Structures	MACHINERY Permanently Attached to Real Estate	RURAL			ALL OTHER					Tax Including State Homestead	State Tax on Non-Homestead	SPECIAL TAXES	SPECIAL TAXES	TOTAL TAXES	PAID	WHEN PAID	Number of Receipt														March Settlement 1964	June Settlement 1964	Penalty	November Settlement 1964	Penalty	Collections to First Monday in January 1965	Penalty	Delinquent on First Monday in January 1965	Total Delinquent Tax and Penalty	REMARKS			
	Acres 100ths														Dollars	Dollars	Dollars	Dollars																																				Dollars	Dollars	Dollars
									Homestead Up to \$4,000 20%	Over \$4,000 and Non-Homestead 33 1/2%	Timber Land Class 3e 20%	Homestead Up to \$4,000 25%	Over \$4,000 and Non-Homestead 40%	MACHINERY Permanently Attached to Real Estate 33 1/2%									Seasonal and Recreational Cabins 33 1/2%	TOTAL ASSESSED VALUE	Total Assessed Value as Equalized by the Board of Review	Dollars	Dollars	\$	cts.	\$														cts.	\$	cts.	\$	cts.	\$	cts.	\$	cts.	\$			
State of Minnesota <i>Deerger Lillian Currier</i>	NE 1/4 of NE 1/4 <i>less 1 ac.</i>																																																							
D. J. Gangelhoff	GOV'T LOT 1																																																							
"	GOV'T LOT 2																																																							
Kenneth J. & Ethel Marie Johnson	Part of GOV'T LOT 6																																																							
Percy E. & Janet Runwald	GOV'T LOT 8																																																							
John E. & Rozella Miller	Part of GOV'T LOT 6																																																							
Edmer A. Sr. & Elizabeth M. Lawson	Part of GOV'T LOT 5																																																							
Albert & E. Marie Kolkin	GOV'T LOT 6 <i>less 1/2 acre #2</i>																																																							
E. A. Drew	GOV'T LOT 6 <i>less 1/2 acre #2</i>																																																							
Charles M. & Grace K. Bengaman	GOV'T LOT 5 "42x92"																																																							
Stanley A. Johnson	GOV'T LOT 3																																																							
James M. & Julia M. Stoda	GOV'T LOT 4 <i>less 2x.225'</i>																																																							
Otto & Amy Neuwander	GOV'T LOT 4																																																							

IN WHOSE NAME ASSESSED
 No. School District
 Ind. Agricultural
 State of Minnesota
 Auditor's Plat #3

Assessment Roll and Tax List of Real Property in the Town of Little Bay, Cass County, Minnesota, for Taxes for the Year 1963.

Cass County, Minnesota, for Taxes for the Year 1963.

Table with columns: IN WHOSE NAME ASSESSED, DESCRIPTION OF PROPERTY, TRUE AND FULL VALUATIONS, ASSESSED VALUATIONS, and FINAL EQUALIZED VALUE. Includes handwritten entries for various property owners like Donald F. & Isabelle Bohm, Carl & Beverly J. Kauppi, etc.

Table with columns: VALUATIONS BY SCHOOL DISTRICTS AS EQUALIZED BY DEPARTMENT OF TAXATION, TAXES, PAID, WHEN PAID, and REMARKS. Includes handwritten entries for tax payments and dates.

(Continued on next page)

Handwritten calculations: 41171 + 4620 = 45791, 745 + 513 = 1258, 7910 + 1133 = 3049

Handwritten calculations: a 600 48, m 383 38, 983 86

995 08

344 65

595 77

74 66

Assessment Roll and Tax List of Real Property in the Town of Lake Bay

Table with columns: IN WHOSE NAME ASSESSED, DESCRIPTION OF PROPERTY, ASSESSED VALUATIONS (RURAL, ALL OTHER, MICHIGAN, Seasonal and Recreational Cabins, TOTAL ASSESSED VALUE), and FINAL EQUALIZED VALUE.

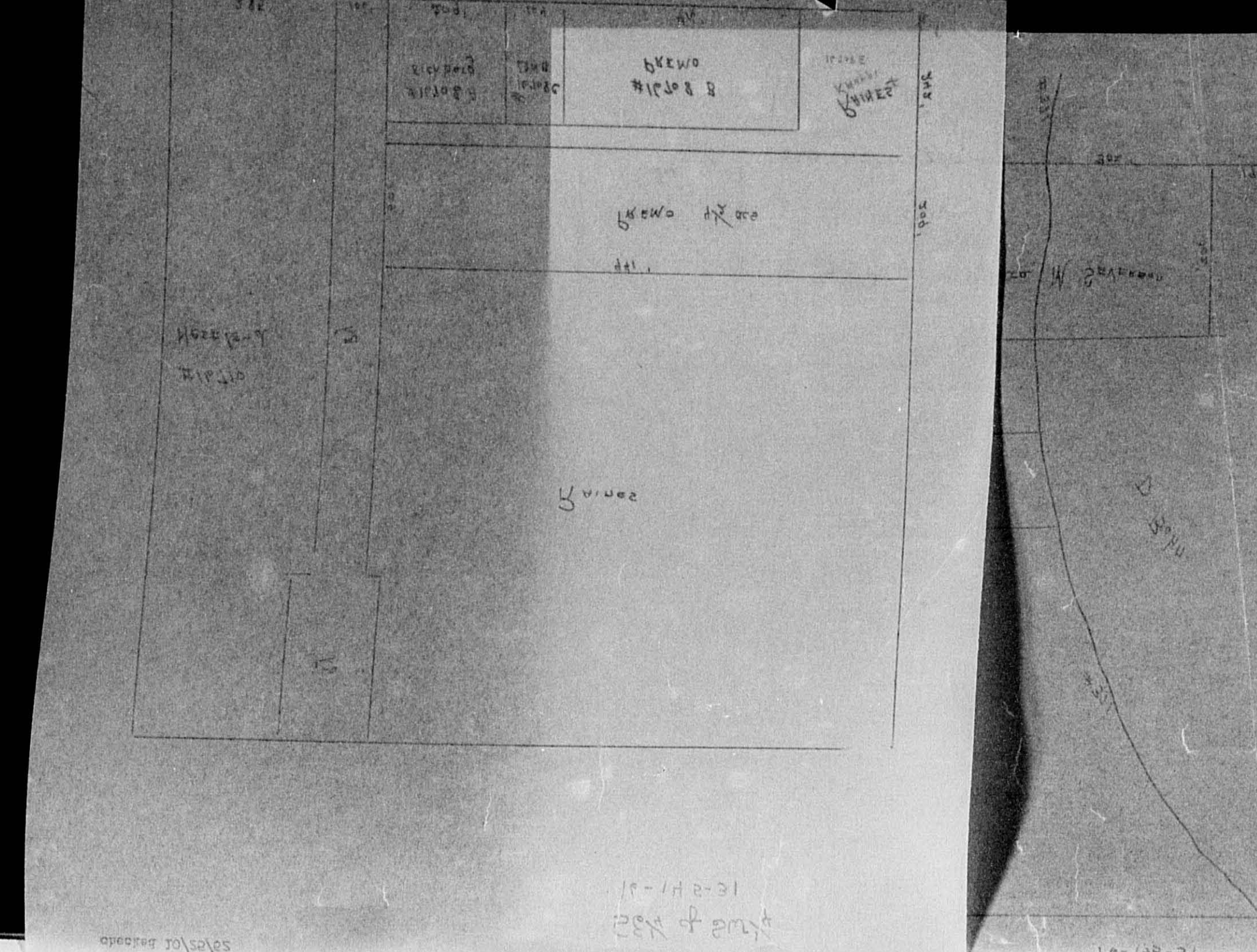

Cass County, Minnesota, for Taxes for the Year 1963.

Table with columns: VALUATIONS BY SCHOOL DISTRICTS AS EQUALIZED BY DEPARTMENT OF TAXATION, TAX INCLUDING STATE HOMESTEAD, SPECIAL TAXES, PAID, WHEN PAID, Number of Receipt, March Settlement, June Settlement, November Settlement, Collections to First Monday in January, Delinquent on First Monday in January, Total Delinquent Tax and Penalty, REMARKS.

Assessment Roll and Tax List of Real Property in the Town of Pike Bay

Form SCD - MILLER-DAVIS CO., MINNEAPOLIS

* Indicate Type of Property: R-Residential, C-Commercial, I-Industrial, U-Utility, F-Farm, L-Lakeshore, T-Timber, M-Mineral

Cass County, Minnesota, for Taxes for the Year 1963.

Table with columns: IN WHOSE NAME ASSESSED, DESCRIPTION OF PROPERTY, TRUE AND FULL VALUATIONS (RURAL, ALL OTHER, MACHINERY, Seasonal and Recreational Cabins, TOTAL ASSESSED VALUE), and FINAL EQUALIZED VALUE.

Continued next page 38094

Table with columns: SOLD FOR TAXES, VALUATIONS BY SCHOOL DISTRICTS AS EQUALIZED BY DEPARTMENT OF TAXATION, Tax including State Homestead, State Tax on Non-Homestead, SPECIAL TAXES, TOTAL TAXES, PAID, WHEN PAID, Number of Receipt, March Settlement 1964, June Settlement 1964, Penalty, November Settlement 1964, Penalty, Collections to First Monday in January 1965, Penalty, Delinquent on First Monday in January 1965, Total Delinquent Tax and Penalty, REMARKS.

Handwritten calculations: 11051, 286, 1257 + 58 = 1315, 39394, 1962, 41356, 202, 41558

Vertical text on the right edge: REAL ESTATE, HARDING-TORNBEL ADD'N, SUPPLEMENTAL PLAT OF SEC. 20-37-21-22-23-24-25-26-27-28-29-30-31-32-33-34-35-36-37-38-39-40-41-42-43-44-45-46-47-48-49-50-51-52-53-54-55-56-57-58-59-60-61-62-63-64-65-66-67-68-69-70-71-72-73-74-75-76-77-78-79-80-81-82-83-84-85-86-87-88-89-90-91-92-93-94-95-96-97-98-99-100

Assessment Roll and Tax List of Real Property in the Town of Pike Bay. * Indicate Type of Property: R-Residential, C-Commercial, I-Industrial, U-Utility, F-Farm, L-Lakeshore, T-Timber, M-Mineral

Cass County, Minnesota, for Taxes for the Year 1963.

Table with columns: IN WHOSE NAME ASSESSED, DESCRIPTION OF PROPERTY, TRUE AND FULL VALUATIONS (RURAL, ALL OTHER, MACHINERY, Seasonal and Recreational Cabins, TOTAL ASSESSED VALUE), FINAL EQUALIZED VALUE.

Table with columns: VALUATIONS BY SCHOOL DISTRICTS AS EQUALIZED BY DEPARTMENT OF TAXATION, PAID, WHEN PAID, Number of Receipt, March Settlement 1964, June Settlement 1964, November Settlement 1964, Penalty, Collections to First Monday in January 1965, Delinquent on First Monday in January 1965, Total Delinquent Tax and Penalty, REMARKS.

Real Estate

Real Estate

145-31

145-31

AUTIOR'S PLAT #3

AUTIOR'S PLAT #3

Assessment Roll and Tax List of Real Property in the Town of Pike Bay

Cass County, Minnesota, for Taxes for the Year 1963.

* Indicate Type of Property: R-Residential, C-Commercial, I-Industrial, U-Utility, F-Farm, L-Lakeshore, T-Timber, M-Mineral

Table with columns: IN WHOSE NAME ASSESSED, DESCRIPTION OF PROPERTY, TRUE AND FULL VALUATIONS, ASSESSED VALUATIONS, and FINAL EQUALIZED VALUE. Includes handwritten entries for 'The Northwest Paper Company', 'State of Minnesota', and 'Adolph + Edward Lebke'.

Table with columns: VALUATIONS BY SCHOOL DISTRICTS AS EQUALIZED BY DEPARTMENT OF TAXATION, Tax Including State Homestead, State Tax on Non-Homestead, SPECIAL TAXES, TOTAL TAXES, PAID, WHEN PAID, Number of Receipt, March Settlement 1964, June Settlement 1964, November Settlement 1964, Collections to First Monday in January 1965, Delinquent on First Monday in January 1965, Total Delinquent Tax and Penalty, REMARKS. Includes handwritten tax calculations and dates like 'PAID IN FULL APR 20 1964'.

Real Estate

Real Estate

HANDING-GONHASH ADD N

SUPPLEMENTAL PAGE OF

AUDITOR'S FILE #3

Assessment Roll and Tax List of Real Property in the Town of Pike Bay, Cass County, Minnesota, for Taxes for the Year 1963.

Form 502 MILLER-DAVIS CO., MINNEAPOLIS

* Indicate Type of Property: R-Residential, C-Commercial, I-Industrial, U-Utility, F-Farm, L-Lakeshore, T-Timber, M-Mineral

Table with columns: IN WHOSE NAME ASSESSED, DESCRIPTION OF PROPERTY, TRUE AND FULL VALUATIONS, ASSESSED VALUATIONS, and FINAL EQUALIZED VALUE. Includes handwritten entries for George & Hazel Elliott, State of Minnesota, The Northwest Paper Company, Beatrice Kelsch Warner, Leland E. Russell, and Robert J. Richards.

Cass County, Minnesota, for Taxes for the Year 1963.

Table with columns: SOLD FOR TAXES, VALUATIONS BY SCHOOL DISTRICTS AS EQUALIZED BY DEPARTMENT OF TAXATION, TAX INCLUDING STATE HOMESTEAD, SPECIAL TAXES, TOTAL TAXES, PAID, WHEN PAID, Number of Receipt, March Settlement 1964, June Settlement 1964, November Settlement 1964, Penalty, Collections to First Monday in January 1965, Delinquent on First Monday in January 1965, Total Delinquent Tax and Penalty, and REMARKS. Includes handwritten notes and dates like 'PAID IN FULL MAY 8 1964'.

Real Estate

AT KUNG POINT

HEADINGS-JOURNAL ADD'N

SUPPLEMENTAL PLAT OF

AUDITOR'S PLAT #3

Assessment Roll and Tax List of Real Property in the Town of Pike Bay

* Indicate Type of Property: R-Residential, C-Commercial, I-Industrial, U-Utility, F-Farm, L-Lakeshore, T-Timber, M-Mineral

Cass County, Minnesota, for Taxes for the Year 1963.

Table with columns: IN WHOSE NAME ASSESSED, DESCRIPTION OF PROPERTY, TRUE AND FULL VALUATIONS, ASSESSED VALUATIONS, VALUATIONS BY SCHOOL DISTRICTS AS EQUALIZED BY DEPARTMENT OF TAXATION, TAXES, PAID, WHEN PAID, Number of Receipt, March Settlement, June Settlement, November Settlement, Collections to First Monday in January 1965, Delinquent on First Monday in January 1965, Total Delinquent Tax and Penalty, REMARKS.

Charles Millard
Loretta P. & Karen Hoglund

Loretta P. & Karen Hoglund
U. S. of America (Trust for James Brunette)

Franklin Olson
Melvin & Millie Thompson

Herschel L. & Ruby Striwalz
Ernest Hinkemeyer

Elmer Olson
Herman & Hilding A. Kling

Herschel L. & Ruby B. Striwalz
Lewis A. & June E. Hinkemeyer

312.29
8.92
322.21

Real Estate

HAIRDING-JORDAN, ADD'N

SUPPLEMENTAL PLAT OF

AUDITOR'S PLAT #3

Assessment Roll and Tax List of Real Property in the Town of Little Bay, Minnesota

Form 500 MILLER-DAVIS CO., MINNEAPOLIS

* Indicate Type of Property: R-Residential, C-Commercial, I-Industrial, U-Utility, F-Farm, L-Lakeshore, T-Timber, M-Mineral

Cass County, Minnesota, for Taxes for the Year 1963.

Table with columns: IN WHOSE NAME ASSESSED, DESCRIPTION OF PROPERTY, TRUE AND FULL VALUATIONS, ASSESSED VALUATIONS, VALUATIONS BY SCHOOL DISTRICTS AS EQUALIZED BY DEPARTMENT OF TAXATION, TAX INCLUDING STATE HOMESTEAD, PAID, WHEN PAID, Number of Receipt, March Settlement 1964, June Settlement 1964, November Settlement 1964, Collections to First Monday in January 1965, Delinquent on First Monday in January 1965, Total Delinquent Tax and Penalty, REMARKS.

Assessment Roll and Tax List of Real Property in the Town of Lake Park
* Indicate Type of Property: R-Residential, C-Commercial, I-Industrial, U-Utility, F-Farm, L-Lakeshore, T-Timber, M-Mineral

Form SCD - MILLER-DAVIS CO., MINNEAPOLIS

Table with columns: IN WHOSE NAME ASSESSED, DESCRIPTION OF PROPERTY, TRUE AND FULL VALUATIONS, ASSESSED VALUATIONS, and FINAL EQUALIZED VALUE. Includes entries for Carl D. & Emily Foster, State of Minnesota, Carl D. & Emily Foster, Carl D. & Emily Foster, Adolph & Emma Hornblad, Nora Reuter, Virgil F. & Ethel M. Foster, Nora Reuter, David F. & Mary Louise, Virgil F. & Ethel M. Foster, State of Minnesota, State of Minnesota, David F. & Mary Louise, Virgil F. & Ethel M. Foster, and State of Minnesota.

478 79

Cass County, Minnesota, for Taxes for the Year 1963.

Table with columns: SOLD FOR TAXES, VALUATIONS BY SCHOOL DISTRICTS AS EQUALIZED BY DEPARTMENT OF TAXATION, Tax including State Homestead, State Tax on Non-Homestead, SPECIAL TAXES, TOTAL TAXES, PAID, WHEN PAID, Number of Receipt, March Settlement, June Settlement, November Settlement, Collections to First Monday in January 1965, Delinquent on First Monday in January 1965, Total Delinquent Tax and Penalty, and REMARKS. Includes entries for districts 1 through 20.

4885
154
1039

a 32558 138

326 96

15830 13866

Real Estate
AUDITOR'S PLAT #3
AUDITOR'S PLAT #3

Assessment Roll and Tax List of Real Property in the Town of Lake Park

* Indicate Type of Property: R-Residential, C-Commercial, I-Industrial, U-Utility, F-Farm, L-Lakeshore, T-Timber, M-Mineral

Form SCD MILLER-DAVIS CO., MINNEAPOLIS

Table with columns: IN WHOSE NAME ASSESSED, DESCRIPTION OF PROPERTY, TRUE AND FULL VALUATIONS, ASSESSED VALUATIONS, FINAL EQUALIZED VALUE. Includes entries for The Northwest Paper Company, State of Minnesota, and individuals like Earl D. & Emily K. Foster.

280

Cass County, Minnesota, for Taxes for the Year 1963.

Table with columns: VALUATIONS BY SCHOOL DISTRICTS AS EQUALIZED BY DEPARTMENT OF TAXATION, TAX INCLUDING STATE HOMESTEAD, SPECIAL TAXES, TOTAL TAXES, PAID, WHEN PAID, Number of Receipt, March Settlement, June Settlement, Penalty, November Settlement, Collections to First Monday in January 1965, Delinquent on First Monday in January 1965, Total Delinquent Tax and Penalty, REMARKS. Includes handwritten notes and dates like 'PAID IN FULL MAY 29 1964'.

4258
538
996

249 48 4 82

254 30

83 93

112 33

322 4

25 80

25062

Real Estate

AT MOUND POINT

HARDING-JONDAH ADD'N

SUPPLEMENTAL PLAT OF SEC. 10-20-11-12-13-14

AUDITOR'S PLAT #3

Assessment Roll and Tax List of Real Property in the Town of Lake Park

* Indicate Type of Property: R-Residential, C-Commercial, I-Industrial, U-Utility, F-Farm, L-Lakeshore, T-Timber, M-Mineral

Form 5CD MILLER-DAVIS CO., MINNEAPOLIS

Cass County, Minnesota, for Taxes for the Year 1963.

Table with columns for Property Description, Valuations (True and Full, Assessed), Taxes (SOLD FOR TAXES, Districts, State, Special, Total), and Payments (PAID, WHEN PAID, March, June, November, Collections, Delinquent, Total). Includes handwritten entries for Steve Swinson, Clifford Nestlund, Herman & Widing A. Kling, Robert H. Campbell, etc.

Real Estate

Real Estate

HARDING-JONDAHL ADDN #1

SUPPLEMENTAL PLAT OF

AUDITOR'S PLAT #3

Assessment Roll and Tax List of Real Property in the Town of Lehigh

* Indicate Type of Property: R-Residential, C-Commercial, I-Industrial, U-Utility, F-Farm, L-Lakeshore, T-Timber, M-Mineral

Cass County, Minnesota, for Taxes for the Year 1963.

Form 5C MILLER-DAVIS CO., MINNEAPOLIS

Supplemental Plat
Bug-E-Zo-We-Nine Beach

IN WHOSE NAME ASSESSED

DESCRIPTION OF PROPERTY

TRUE AND FULL VALUATIONS

ASSESSED VALUATIONS

VALUATIONS BY SCHOOL DISTRICTS AS EQUALIZED BY DEPARTMENT OF TAXATION

Table with columns: IN WHOSE NAME ASSESSED, SUBDIVISION, Sec. of Lot, Town or Block, Rng., Number of Acres of Land, No. School District, Indicate Home-lead Yes or No, Agri. or Rec. Yes or No, Indicate Type of Property, LAND Exclusive of Structures and Improvements, BUILDINGS and Other Structures, MACHINERY Permanently Attached to Real Estate, TOTAL True and Full Value, RURAL (Homestead Up to \$4,000 20%, Over \$4,000 and Non-Homestead 33%), ALL OTHER (Timber Land Class 3e 20%, Homestead Up to \$4,000 25%, Over \$4,000 and Non-Homestead 40%), MACHINERY Permanently Attached to Real Estate 33%, Seasonal and Recreational Cabins 33%, TOTAL ASSESSED VALUE, Total Assessed Value as Equalized by the Board of Review, FINAL EQUALIZED VALUE.

Table with columns: SOLD FOR TAXES, District No., District Rate, District No., District Rate, District No., District Rate, District No., District Rate, District No., District Rate, Tax Including State Homestead, State Tax on Non-Homestead, SPECIAL TAXES, SPECIAL TAXES, TOTAL TAXES, PAID, WHEN PAID, Number of Receipt, March Settlement 1964, June Settlement 1964, Penalty, November Settlement 1964, Penalty, Collections to First Monday in January 1965, Penalty, Delinquent on First Monday in January 1965, Total Delinquent Tax and Penalty, REMARKS.

Paul D. Smith
" "
Alfred H. & Alyce M. Heitschmidt
" "
" "
" "
" "
" "
" "

A.30' of Lot 1

Value included in line 1 above

1 # 23 778 778 1 1st HALF PAID MAY 18 1964
2 # 1000 608 544.14 542 549.56 2 1st HALF PAID MAY 18 1964
3 # 23 423 143.14 378 146.92 3 1st HALF PAID OCT 1 5 1964
4 # 303 102.54 270 105.24 4 1st HALF PAID OCT 1 5 1964
5 # 297 100.50 264 103.14 5 1st HALF PAID OCT 1 5 1964
6 # 657 222.32 222.32 6 1st HALF PAID OCT 1 5 1964
7 # 53 179.4 48 18.42 7 1st HALF PAID OCT 1 5 1964

1680
1894
3364
79113836 1502
115338

57669 29802 27867

25022 Paid Under Protest
10369 Paid Under Protest
25027 Paid Under Protest
10193 Paid Under Protest
18717 Paid Under Protest
12219 Paid Under Protest
10193 Paid Under Protest

Assessment Roll and Tax List of Real Property in the Town of Pike Bay
* Indicate Type of Property: R-Residential, C-Commercial, I-Industrial, U-Utility, F-Farm, L-Lakeshore, T-Timber, M-Mineral

Form 5C - MILLER-DAVIS CO., MINNEAPOLIS

IN WHOSE NAME ASSESSED	DESCRIPTION OF PROPERTY				No. School District	Indicate Homestead Yes or No	Agr. or Seas. Use Yes or No	Indicate Type of Property	TRUE AND FULL VALUATIONS				ASSESSED VALUATIONS								Total Assessed Value as Equalized by the Board of Review	FINAL EQUALIZED VALUE	
	SUBDIVISION	Sec. or Lot	Town or Block	Number of Acres of Land					LAND Exclusive of Structures and Improvements	BUILDINGS and Other Structures	MACHINERY Permanently Attached to Real Estate	TOTAL True and Full Value	RURAL										TOTAL ASSESSED VALUE
													Homestead Up to \$4,000 20%	Over \$4,000 and Non-Homestead 33 1/2%	Timber Land Class 3e 20%	ALL OTHER		MACHINERY Permanently Attached to Real Estate 33 1/2%	Seasonal and Recreational Cabins 33 1/2%	TOTAL ASSESSED VALUE			
																Homestead Up to \$4,000 25%	Over \$4,000 and Non-Homestead 40%						
Dollars	Dollars	Dollars	Dollars	Dollars	Dollars	Dollars	Dollars	Dollars	Dollars	Dollars	Dollars	Dollars	Dollars	Dollars	Dollars	Dollars							
<i>Kenneth L. & Eva L. Hudson</i>		<i>16</i>		<i>115</i>	<i>Yes</i>	<i>No</i>	<i>R</i>																
"		<i>2</i>			<i>No</i>	<i>Yes</i>	<i>L</i>																
"		<i>3</i>			<i>No</i>	<i>Yes</i>	<i>L</i>																
"		<i>4</i>			<i>No</i>	<i>Yes</i>	<i>L</i>																
<i>Ruth Engel</i>		<i>5</i>			<i>No</i>	<i>Yes</i>	<i>R</i>																
"		<i>6</i>			<i>No</i>	<i>Yes</i>	<i>L</i>																
"		<i>7</i>			<i>No</i>	<i>Yes</i>	<i>L</i>																
"		<i>8</i>			<i>No</i>	<i>Yes</i>	<i>L</i>																
<i>Earl H. & Genevieve Coombs</i>		<i>9</i>			<i>Yes</i>	<i>No</i>	<i>L</i>																
"		<i>10</i>			<i>Yes</i>	<i>No</i>	<i>L</i>																
"		<i>11</i>			<i>Yes</i>	<i>No</i>	<i>L</i>																
"		<i>12</i>			<i>Yes</i>	<i>No</i>	<i>L</i>																
<i>Leon & Naomi L. Stadel</i>		<i>13</i>			<i>Yes</i>	<i>No</i>	<i>L</i>																
<i>Leon & Naomi L. Stadel</i>		<i>14</i>			<i>No</i>	<i>Yes</i>	<i>L</i>																
<i>Otto Rosenberg</i>		<i>15</i>			<i>No</i>	<i>Yes</i>	<i>L</i>																
"		<i>16</i>			<i>No</i>	<i>Yes</i>	<i>L</i>																

Cass County, Minnesota, for Taxes for the Year 1963.

SOLD FOR TAXES	VALUATIONS BY SCHOOL DISTRICTS AS EQUALIZED BY DEPARTMENT OF TAXATION						Tax Including State Homestead	State Tax on Non-Homestead	SPECIAL TAXES	SPECIAL TAXES	TOTAL TAXES	PAID	WHEN PAID	Number of Receipt	March Settlement 1964	June Settlement 1964	November Settlement 1964	Penalty	Collections to First Monday in January 1965	Penalty	Delinquent on First Monday in January 1965	Total Delinquent Tax and Penalty	REMARKS
	District No.	District No.	District No.	District No.	District No.	District No.																	
	Rate	Rate	Rate	Rate	Rate	Rate																	
	Mills	Mills	Mills	Mills	Mills	Mills																	
<i>1</i>						<i># 800</i>	<i>270.72</i>			<i>270.72</i>		<i>PAID IN FULL OCT 5 1964</i>										<i>10366</i>	
<i>2</i>						<i>192</i>	<i>60.18</i>	<i>172</i>		<i>61.90</i>		<i>2 PAID IN FULL OCT 5 1964</i>										<i>10366</i>	
<i>3</i>						<i>192</i>	<i>60.18</i>	<i>172</i>		<i>61.90</i>		<i>3 PAID IN FULL OCT 5 1964</i>										<i>10366</i>	
<i>4</i>						<i>151</i>	<i>47.32</i>	<i>134</i>		<i>48.66</i>		<i>4 PAID IN FULL OCT 5 1964</i>										<i>10366</i>	
<i>5</i>						<i>390</i>	<i>122.22</i>	<i>348</i>		<i>125.70</i>		<i>5 1st HALF PAID OCT 2 9 1964</i>										<i>10268 25082</i>	
<i>6</i>						<i>18</i>	<i>5.64</i>	<i>16</i>		<i>5.80</i>		<i>6 1st HALF PAID MAY 12 1964</i>										<i>10268</i>	
<i>7</i>						<i>18</i>	<i>5.64</i>	<i>16</i>		<i>5.80</i>		<i>7 1st HALF PAID MAY 12 1964</i>										<i>10268</i>	
<i>8</i>						<i>36</i>	<i>11.28</i>	<i>32</i>		<i>11.60</i>		<i>8 1st HALF PAID MAY 12 1964</i>										<i>10268</i>	
<i>9</i>						<i># 12</i>	<i>4.06</i>			<i>4.06</i>		<i>9 1st HALF PAID MAY 29 1964</i>										<i>10268</i>	
<i>10</i>						<i># 12</i>	<i>4.06</i>			<i>4.06</i>		<i>10 1st HALF PAID MAY 29 1964</i>										<i>10268</i>	
<i>11</i>						<i># 12</i>	<i>4.06</i>			<i>4.06</i>		<i>11 1st HALF PAID MAY 29 1964</i>										<i>10268</i>	
<i>12</i>						<i># 513</i>	<i>173.60</i>			<i>173.60</i>		<i>12 Part Paid MAY 29 1964</i>										<i>10268</i>	
<i>13</i>						<i># 12</i>	<i>4.06</i>			<i>4.06</i>		<i>13 1st HALF PAID MAY 29 1964</i>										<i>10268</i>	
<i>14</i>						<i>18</i>	<i>5.64</i>	<i>16</i>		<i>5.80</i>		<i>14 PAID IN FULL MAY 22 1964</i>										<i>10268</i>	
<i>15</i>						<i>18</i>	<i>5.64</i>	<i>16</i>		<i>5.80</i>		<i>15 1st HALF PAID MAY 29 1964</i>										<i>10268</i>	
<i>16</i>						<i>153</i>	<i>47.94</i>	<i>136</i>		<i>49.30</i>		<i>16 1st HALF PAID MAY 29 1964</i>										<i>10268</i>	
<i>17</i>																							
<i>18</i>																							
<i>19</i>																							
<i>20</i>																							

1186 #1261 #1261 a 371.68
2547 1186 na 460.56 1058
832.24

842.82

LITTLE WOLF LOOKOUT
HIGHLAND INN SUBDIVISION
AUDITOR'S FILE #3

Assessment Roll and Tax List of Real Property in the Town of Pike Bay, Cass County, Minnesota, for Taxes for the Year 1963.

Cass County, Minnesota, for Taxes for the Year 1963.

Table with columns: IN WHOSE NAME ASSESSED, DESCRIPTION OF PROPERTY, TRUE AND FULL VALUATIONS, ASSESSED VALUATIONS, and FINAL EQUALIZED VALUE.

Table with columns: VALUATIONS BY SCHOOL DISTRICTS AS EQUALIZED BY DEPARTMENT OF TAXATION, TAX INCLUDING STATE HOMESTEAD, SPECIAL TAXES, TOTAL TAXES, PAID, WHEN PAID, Number of Receipt, March Settlement 1964, June Settlement 1964, November Settlement 1964, Collections to First Monday in January 1965, Delinquent on First Monday in January 1965, Total Delinquent Tax and Penalty, REMARKS.

Real Estate, HARDING JORDAHL ADD'N, SUPPLEMENTAL PLAT OF UC-E-20-WE-NING BEACH

Real Estate, HIGHLAND INN SUBDIVISION, AUDITOR'S PLAT #3

Assessment Roll and Tax List of Real Property in the Town of Pine Bay

* Indicate Type of Property: R-Residential, C-Commercial, I-Industrial, U-Utility, F-Farm, L-Lakeshore, T-Timber, M-Mineral

Form 50 - MILLER-DAVIS CO., MINNEAPOLIS

Real Estate

Harding Jordahl Add'n

Supplemental Plat of Sec 2-20-14-15-16 Beach

Auditors Plat #3

Table with columns: IN WHOSE NAME ASSESSED, DESCRIPTION OF PROPERTY, TRUE AND FULL VALUATIONS, ASSESSED VALUATIONS, FINAL EQUALIZED VALUE. Includes handwritten entries for Loren & Jeanette Quelow, Laura Morris, State of Minnesota, etc.

Cass County, Minnesota, for Taxes for the Year 1963.

Table with columns: SOLD FOR TAXES, VALUATIONS BY SCHOOL DISTRICTS AS EQUALIZED BY DEPARTMENT OF TAXATION, Tax including State Homestead, SPECIAL TAXES, TOTAL TAXES, PAID, WHEN PAID, Number of Receipt, March Settlement, June Settlement, November Settlement, Collections to First Monday in January 1965, Delinquent on First Monday in January 1965, Total Delinquent Tax and Penalty, REMARKS. Includes handwritten entries for various districts and tax amounts.

Real Estate

Highland Inn Subdivision

Personal

Assessment Roll and Tax List of Real Property in the Town of Little Wolf, Minn.

Form 50 MILLER-DAVIS CO., MINNEAPOLIS

* Indicate Type of Property: R-Residential, C-Commercial, I-Industrial, U-Utility, F-Farm, L-Lakeshore, T-Timber, M-Mineral

DESCRIPTION OF PROPERTY

TRUE AND FULL VALUATIONS

ASSESSED VALUATIONS

IN WHOSE NAME ASSESSED

Little Wolf Look-out

Subdivision: Look-out 7 & Part Look-out 6 (13 1/2 acs)

Conrad M. & Anna E. Olson

" " " "

" " " "

" " " "

" " " "

Conrad M. & Anna E. Olson

Henry H. & Edith J. Washington

Jack L. & Alysse J. Gibson

" " " "

Louis J. & Josephine

Harry & Doris Larsen

" " " "

" " " "

" " " "

George F. & Lois H. Barr

" " " "

Table with columns: No. School District, Ind. or Home-Stead, Agr. or Recr., Land Exclusive of Structures, BUILDINGS and Other Structures, MACHINERY Permanently Attached to Real Estate, TOTAL True and Full Value, RURAL (Homestead, Over \$4,000, Timber, etc.), ALL OTHER, MACHINERY Attached to Real Estate, Seasonal and Recreational Cabins, TOTAL ASSESSED VALUE, Total Assessed Value as Equalized by the Board of Review, FINAL EQUALIZED VALUE.

Cass County, Minnesota, for Taxes for the Year 1963.

Table with columns: SOLD FOR TAXES, VALUATIONS BY SCHOOL DISTRICTS AS EQUALIZED BY DEPARTMENT OF TAXATION, Tax including State Homestead, State Tax on Non-Homestead, SPECIAL TAXES, TOTAL TAXES, PAID, WHEN PAID, Number of Receipt, March Settlement 1964, June Settlement 1964, Penalty, November Settlement 1964, Collections to First Monday in January 1965, Delinquent on First Monday in January 1965, Total Delinquent Tax and Penalty, REMARKS.

Real Estate, LITTLE WOLF LOOKOUT, HARDING JORDAHL ADD'N, SUPPLEMENTAL PLAT OF UG-P-20-ME-LING BEACH, AUDITORS PLAT #3

HIGHLAND INN SUBDIVISION, Personal

