

Assessment & Tax List - 1953

Pike Bay

SUMMARY OF TAX COLLECTION

Original Levy	- - - - -	\$ 40,194.76	
Additions	- - - - -	\$ 68.07	
			\$
Abatements	- - - - -	\$ 162.96	
			\$ 40,099.87

COLLECTIONS

March Settlement	- - - - -	\$ 23,782.42	
June Settlement	- - - - -	\$ 9,149.92	
November Settlement	- - - - -	\$ 5,206.52	
January Settlement	- - - - -	\$ 321.79	\$ 38,460.65
			\$
Over Collected	- - - - -	\$ 27.96	
Under Collected	- - - - -	\$.03	
Delinquent	- - - - -	\$ 1627.10	\$ 1639.17
Total	- - - - -		\$ 40,099.87

Ah Nung Point
 Harding-Jordan
 Addition
 Supplemental Plat of
 Sec 1 to Ring B.
 Auditor's plat #3

COLLECTIONS OF TAXES OF 1952

Town OF Pike Bay

CASS COUNTY, MINNESOTA

FUNDS	MARCH SETTLEMENT 1952	JUNE SETTLEMENT 1952	NOV. SETTLEMENT 1952	Amount Collected from Nov. 1952 to First Monday in Jan. 1953	REDUCTIONS	Total Reductions and Collected	BALANCE UNCOLLECTED	ADDITIONS	Total Uncollected to First Monday in January, 1953
State-Non-Homestead,	525 30	127 81	66 55	6 36					
State-Homestead,	479 12	192 50	1 08 85	6 61					
County Revenue,	2398 84	963 79	545 01	53 11					
County Road and Bridge,	1218 11	489 40	276 74	16 81					
County Welfare,	4196 78	1686 15	953 49	57 93					
County Bond and Interest,									
R. & B. Ad. Proj.	406 00	163 13	92 25	5 60					
Co. Nurse	162 42	65 25	36 90	2 25					
R. & B. Bldg.	162 42	65 25	36 90	2 25					
Town Revenue,	173 78	67 82	39 48	2 40					
Town Road and Bridge,	145 36	58 40	33 03	2 00					
Town Drag,	81 21	32 63	18 45	1 12					
Town State Loan,									
Wire	43 85	17 62	9 96	6 1					
School Local 1 Mill,	81 21	32 63	18 45	1 12					
School Special,	4 011 92	1289 90	767 55	49 77					
School State Loan,									
Deficiency	7389 81	2969 04	1678 93	102 00					
Tuition									
Transportation	117 75	47 30	26 76	1 62					
C.O.	406 03	163 14	92 25	5 61					
B. & D.	1218 10	489 40	276 75	16 81					
PERA	243 63	97 88	55 35	3 38					
PERA Agri. Assn	280 17 40 61	112 56 16 32	63 65 9 22	3 87 5 6					
Totals	23782 42	9149 92	5206 52	321 79					

	LOCAL 1 MILL	SPECIAL	STATE LOAN	Deficiency	Transp.	C.O.	B. & D.	PERA	TOTALS
MARCH SETTLEMENT	School District No.								
	115a	194	4842	17624	281	968	2905	582	27396
	1157a	7927	396350	721357	11494	39635	118905	23781	1319449
Totals	8121	401192	738981	11775	40603	121810	24363		1346845
JUNE SETTLEMENT	School District No.								
	115a	1366	34143	124282	1980	6829	20486	4097	193183
	1157a	1897	94847	172622	2750	9485	28454	5691	315746
Totals	3263	128990	296904	4730	16314	48940	9788		508929
NOVEMBER SETTLEMENT	School District No.								
	115-a	620	15494	56399	899	3099	9297	1859	87667
	115-7a	1225	61261	111494	1777	6126	18378	3676	203957
Totals	1845	76755	167893	2676	9225	27675	5535		291604
NOVEMBER to JANUARY	School District No.								
	115a	25	627	2283	36	126	376	76	3549
	1157a	87	4350	7917	126	435	1305	262	17782
Totals	112	4977	10200	162	561	1681	338		18031
ADDITIONS									
REDUCTIONS									
Totals									

An Hing Point
 Harding-Jordahl
 Auditor's Plat #3
 Supplemental Plat of
 Sec. 3 no. 10 No. 100 B.

Assessment Roll and Tax List of Real Property in the Town of Pike Bay,
 * Indicate Type of Property: R-Residential, C-Commercial, I-Industrial, U-Utility, F-Farm, L-Lakeshore, T-Timber, M-Mineral

Form SCD WILLIS-DAVE COMPANY, MINNEAPOLIS

IN WHOSE NAME ASSESSED	TO WHOM TRANSFERRED	DESCRIPTION OF PROPERTY				TRUE AND FULL VALUATIONS										FINAL EQUALIZED VALUE			
		SUBDIVISION	Sec. or Lot	Town or Block	Reg. Number of Acres of Land	LAND EXCLUSIVE OF STRUCTURES AND IMPROVEMENTS				BUILDINGS AND OTHER STRUCTURES				MACHINERY Permanently Attached to Real Estate			TOTAL ASSESSED VALUE	Total Assessed Value as Equalized by the Board of Review	
						Acres	100ths	No. School District	Indicate Homestead Yes or No	Indicate Agricultural Yes or No	Indicate Type of Property	RURAL		ALL OTHER					Machinery Permanently Attached to Real Estate
												Homestead Up to \$4,000 20%	Over \$4,000 and Non-Homestead 33 1/3%	Timber Land Class 3e 20%	Homestead Up to \$4,000 25%				
						Dollars	Dollars	Dollars	Dollars	Dollars	Dollars	Dollars	Dollars	Dollars	Dollars	Dollars	Dollars		
1		NE 1/4 of NE 1/4			1 145 31														
2		NW 1/4 of NE 1/4																	
3		SW 1/4 of NE 1/4																	
4		SE 1/4 of NE 1/4																	
5																			
6		NE 1/4 of NW 1/4																	
7		NW 1/4 of NW 1/4																	
8		SW 1/4 of NW 1/4																	
9		SE 1/4 of NW 1/4																	
10																			
11		NE 1/4 of SW 1/4																	
12		NW 1/4 of SW 1/4																	
13		SW 1/4 of SW 1/4																	
14		SE 1/4 of SW 1/4																	
15																			
16		NE 1/4 of SE 1/4																	
17		NW 1/4 of SE 1/4																	
18		SW 1/4 of SE 1/4																	
19		SE 1/4 of SE 1/4																	
20																			

Lot 1
 Platted
 Ad. Nung Point
 (Star Island)

Cass County, Minnesota, for Taxes for the Year 1958.

SOLD FOR TAXES	VALUATIONS BY SCHOOL DISTRICTS AS EQUALIZED BY DEPARTMENT OF TAXATION						Tax including State Homestead	State Tax on Non-Homestead	SPECIAL TAXES	TOTAL TAXES	PAID	WHEN PAID	Number of Receipt	March Settlement 1959	June Settlement 1959	Penalty	November Settlement 1959	Penalty	Collections to First Monday in January 1960	Penalty	Delinquent on First Monday in January 1960	Total Delinquent Tax and Penalty	REMARKS
	District No.	District No.	District No.	District No.	District No.	District No.																	
	Rate	Rate	Rate	Rate	Rate	Rate																	
	Mills	Mills	Mills	Mills	Mills	Mills																	
1																							
2																							
3																							
4																							
5																							
6																							
7																							
8																							
9																							
10																							
11																							
12																							
13																							
14																							
15																							
16																							
17																							
18																							
19																							
20																							

Ah Hung Point
 Handling - Jondahl
 Addition
 Supplemental Plat of
 Sec 1 No 10 Nung P.
 Auditor's Plat #3

Assessment Roll and Tax List of Real Property in the Town of Pike Bay

Indicate Type of Property: R-Residential, C-Commercial, I-Industrial, U-Utility, F-Farm, L-Lakeshore, T-Timber, M-Mineral

Cass County, Minnesota, for Taxes for the Year 1958.

Table with columns: IN WHOSE NAME ASSESSED, TO WHOM TRANSFERRED, DESCRIPTION OF PROPERTY, TRUE AND FULL VALUATIONS, ASSESSED VALUATIONS, FINAL EQUALIZED VALUE.

Table with columns: VALUATIONS BY SCHOOL DISTRICTS AS EQUALIZED BY DEPARTMENT OF TAXATION, Tax including State Homestead, SPECIAL TAXES, TOTAL TAXES, PAID, WHEN PAID, Number of Receipt, March Settlement, June Settlement, November Settlement, Penalty, Collections to First Monday in January 1960, Delinquent on First Monday in January 1960, Total Delinquent Tax and Penalty, REMARKS.

Supplemental Plat of Auditor's Plat #3

Assessment Roll and Tax List of Real Property in the Town of Pike Bay

Indicate Type of Property: R-Residential, C-Commercial, I-Industrial, U-Utility, F-Farm, L-Lakeshore, T-Timber, M-Mineral

Table with columns: IN WHOSE NAME ASSESSED, TO WHOM TRANSFERRED, SUBDIVISION, TRUE AND FULL VALUATIONS (LAND, BUILDINGS, MACHINERY, TOTAL), ASSESSED VALUATIONS (RURAL, ALL OTHER, MACHINERY, TOTAL ASSESSED), FINAL EQUALIZED VALUE.

Cass County, Minnesota, for Taxes for the Year 1958.

Table with columns: VALUATIONS BY SCHOOL DISTRICTS AS EQUALIZED BY DEPARTMENT OF TAXATION, Tax including State Homestead, State Tax on Non-Homestead, SPECIAL TAXES, TOTAL TAXES, PAID, WHEN PAID, Number of Receipt, March Settlement, June Settlement, November Settlement, Penalty, Collections to First Monday in January 1960, Delinquent on First Monday in January 1960, Total Delinquent Tax and Penalty, REMARKS.

Supplemental Plat of Auditor's Plat #3

Assessment Roll and Tax List of Real Property in the Town of Pike Bay, Minnesota

Indicate Type of Property: R-Residential, C-Commercial, I-Industrial, U-Utility, F-Farm, L-Lakeshore, T-Timber, M-Mineral

Table with columns: IN WHOSE NAME ASSESSED, TO WHOM TRANSFERRED, DESCRIPTION OF PROPERTY, TRUE AND FULL VALUATIONS, ASSESSED VALUATIONS, FINAL EQUALIZED VALUE.

Cass County, Minnesota, for Taxes for the Year 1958.

Table with columns: VALUATIONS BY SCHOOL DISTRICTS AS EQUALIZED BY DEPARTMENT OF TAXATION, TAXES, PAID, WHEN PAID, Number of Receipt, March Settlement, June Settlement, November Settlement, Collections to First Monday in January 1960, Delinquent on First Monday in January 1960, Total Delinquent Tax and Penalty, REMARKS.

Vertical text on the right edge: Ah Nung Point, Harding-Jordan, Auditor's Plat #3

Assessment Roll and Tax List of Real Property in the Town of Rice Bay

Indicate Type of Property: R-Residential, C-Commercial, I-Industrial, U-Utility, F-Farm, L-Lakeshore, T-Timber, M-Mineral

Table with columns: IN WHOSE NAME ASSESSED, TO WHOM TRANSFERRED, DESCRIPTION OF PROPERTY, TRUE AND FULL VALUATIONS, ASSESSED VALUATIONS, FINAL EQUALIZED VALUE.

Cass County, Minnesota, for Taxes for the Year 1958.

Table with columns: VALUATIONS BY SCHOOL DISTRICTS AS EQUALIZED BY DEPARTMENT OF TAXATION, Tax including State Homestead, State Tax on Non-Homestead, State Tax on Special Taxes, TOTAL TAXES, PAID, WHEN PAID, Number of Receipt, March Settlement 1959, June Settlement 1959, November Settlement 1959, Penalty, Collections to First Monday in January 1960, Delinquent on First Monday in January 1960, Total Delinquent Tax and Penalty, REMARKS.

Supplemental Plat of Auditor's Plat #3

Assessment Roll and Tax List of Real Property in the Town of Pike Bay

* Indicate Type of Property: R-Residential, C-Commercial, I-Industrial, U-Utility, F-Farm, L-Lakeshore, T-Timber, M-Mineral

Table with columns: IN WHOSE NAME ASSESSED, TO WHOM TRANSFERRED, SUBDIVISION, TRUE AND FULL VALUATIONS, ASSESSED VALUATIONS, FINAL EQUALIZED VALUE. Includes handwritten entries for various property owners like 'The Northwest Paper Company' and 'Howard & Edna Braman'.

(Cont on next page)

Cass County, Minnesota, for Taxes for the Year 1958.

Table with columns: VALUATIONS BY SCHOOL DISTRICTS AS EQUALIZED BY DEPARTMENT OF TAXATION, TAXES, PAID, WHEN PAID, Number of Receipt, March Settlement 1959, June Settlement 1959, Penalty, November Settlement 1959, Penalty, Collections to First Monday in January 1960, Penalty, Delinquent on First Monday in January 1960, Total Delinquent Tax and Penalty, REMARKS. Includes handwritten notes and calculations.

Vertical text on the right edge: Auditor's Plat #3, Supplemental Plat of No. 10, Auditor's Plat #3, Auditor's Plat #3

Assessment Roll and Tax List of Real Property in the Town of Pike Bay, Cass County, Minnesota

Form 500

Indicate Type of Property: R-Residential, C-Commercial, I-Industrial, U-Utility, F-Farm, L-Lakeshore, T-Timber, M-Mineral

Table with columns: IN WHOSE NAME ASSESSED, TO WHOM TRANSFERRED, SUBDIVISION, TRUE AND FULL VALUATIONS, ASSESSED VALUATIONS, FINAL EQUALIZED VALUE. Includes handwritten entries for Gladys Syre and Cyrus A. & Thelma M. Braman.

Cass County, Minnesota, for Taxes for the Year 1958.

Table with columns: VALUATIONS BY SCHOOL DISTRICTS AS EQUALIZED BY DEPARTMENT OF TAXATION, SOLD FOR TAXES, SPECIAL TAXES, TOTAL TAXES, PAID, WHEN PAID, Number of Receipt, March Settlement, June Settlement, November Settlement, Collections to First Monday in January 1960, Delinquent on First Monday in January 1960, Total Delinquent Tax and Penalty, REMARKS.

Vertical text on the right edge: Ah Nung Print, Harding-Jordan Addition, Supplemental Plat of Sec 3 to No. 146 B, Auditor's Plat #3

Assessment Roll and Tax List of Real Property in the Town of Pike Bay

* Indicate Type of Property: R-Residential, C-Commercial, I-Industrial, U-Utility, F-Farm, L-Lakeshore, T-Timber, M-Mineral

Table with columns: IN WHOSE NAME ASSESSED, TO WHOM TRANSFERRED, DESCRIPTION OF PROPERTY, TRUE AND FULL VALUATIONS, ASSESSED VALUATIONS, FINAL EQUALIZED VALUE. Includes handwritten entries for various property owners like Kenneth Burns and Wheeler Lumber Bridge & Supply Co.

(Cont on next page)

Cass County, Minnesota, for Taxes for the Year 1958.

Table with columns: SOLD FOR TAXES, VALUATIONS BY SCHOOL DISTRICTS AS EQUALIZED BY DEPARTMENT OF TAXATION, Tax including State Homestead, State Tax on Non-Homestead, SPECIAL TAXES, TOTAL TAXES, PAID, WHEN PAID, Number of Receipt, March Settlement, June Settlement, Penalty, November Settlement, Collections to First Monday in January 1960, Delinquent on First Monday in January 1960, Total Delinquent Tax and Penalty, REMARKS. Includes handwritten entries for various tax payments and dates.

Supplemental Plat of Auditor's Plat #3

Assessment Roll and Tax List of Real Property in the Town of Pike Bay

Indicate Type of Property: R-Residential, C-Commercial, I-Industrial, U-Utility, F-Farm, L-Lakeshore, T-Timber, M-Mineral

Form SCD WILLIS-DAVIS COMPANY, MINNEAPOLIS

Table with columns: IN WHOSE NAME ASSESSED, TO WHOM TRANSFERRED, DESCRIPTION OF PROPERTY, TRUE AND FULL VALUATIONS, ASSESSED VALUATIONS, and FINAL EQUALIZED VALUE. Includes handwritten entries for Philip M. & Helen A. Larson and Paul D. & Ruth A. Smith.

Cass County, Minnesota, for Taxes for the Year 1958.

Table with columns: VALUATIONS BY SCHOOL DISTRICTS AS EQUALIZED BY DEPARTMENT OF TAXATION, TAXES, PAID, WHEN PAID, Number of Receipt, March Settlement 1959, June Settlement 1959, November Settlement 1959, Collections to First Monday in January 1960, Delinquent on First Monday in January 1960, Total Delinquent Tax and Penalty, and REMARKS. Includes handwritten entries for tax amounts and payment dates.

Vertical text on the right edge: Ah Nung Point, Harding-Jondahl, Auditor's Plat #3

Assessment Roll and Tax List of Real Property in the Town of Pike Bay

Form 5CD

Indicate Type of Property: R-Residential, C-Commercial, I-Industrial, U-Utility, F-Farm, L-Lakeshore, T-Timber, M-Mineral

Table with columns: IN WHOSE NAME ASSESSED, TO WHOM TRANSFERRED, DESCRIPTION OF PROPERTY, TRUE AND FULL VALUATIONS, ASSESSED VALUATIONS, FINAL EQUALIZED VALUE.

Cass County, Minnesota, for Taxes for the Year 1958.

Table with columns: VALUATIONS BY SCHOOL DISTRICTS AS EQUALIZED BY DEPARTMENT OF TAXATION, TAXES, PAID, WHEN PAID, Number of Receipt, March Settlement, June Settlement, November Settlement, Collections to First Monday in January, Delinquent on First Monday in January, Total Delinquent Tax and Penalty, REMARKS.

Vertical text on the right edge: An Ning Point, Harding-Jordan Addition, Supplemental Plat of No. 10, Auditor's Plat #3.

Assessment Roll and Tax List of Real Property in the Town of Pike Bay

Indicate Type of Property: R-Residential, C-Commercial, I-Industrial, U-Utility, F-Farm, L-Lakeshore, T-Timber, M-Mineral

Table with columns: IN WHOSE NAME ASSESSED, TO WHOM TRANSFERRED, SUBDIVISION, TRUE AND FULL VALUATIONS, ASSESSED VALUATIONS, FINAL EQUALIZED VALUE. Includes handwritten entries for Fred J. Langelhoff and State of Minnesota.

Cass County, Minnesota, for Taxes for the Year 1958.

Table with columns: VALUATIONS BY SCHOOL DISTRICTS AS EQUALIZED BY DEPARTMENT OF TAXATION, TAXES, PAID, WHEN PAID, Number of Receipt, March Settlement, June Settlement, November Settlement, Collections to First Monday in January 1960, Delinquent on First Monday in January 1960, Total Delinquent Tax and Penalty, REMARKS. Includes handwritten tax amounts and dates.

At Ming Point Harding-Jordan's Supplemental Plat of Sec 3 no 10 to Ming P. Auditor's Plat #3

Assessment Roll and Tax List of Real Property in the Town of Pike Bay

Indicate Type of Property: R-Residential, C-Commercial, I-Industrial, U-Utility, F-Farm, L-Lakeshore, T-Timber, M-Mineral

Table with columns: IN WHOSE NAME ASSESSED, TO WHOM TRANSFERRED, DESCRIPTION OF PROPERTY, TRUE AND FULL VALUATIONS, ASSESSED VALUATIONS, FINAL EQUALIZED VALUE. Includes handwritten entries for various property owners like U.S. of America, Rolland L. & Carroll Brano, Nellie E. Drough, R. W. Campbell, etc.

Cass County, Minnesota, for Taxes for the Year 1958.

Table with columns: SOLD FOR TAXES, VALUATIONS BY SCHOOL DISTRICTS AS EQUALIZED BY DEPARTMENT OF TAXATION, Tax including State Homestead, State Tax on Non-Homestead, SPECIAL TAXES, TOTAL TAXES, PAID, WHEN PAID, Number of Receipt, March Settlement 1959, June Settlement 1959, Penalty, November Settlement 1959, Penalty, Collections to First Monday in January 1960, Delinquent on First Monday in January 1960, Total Delinquent Tax and Penalty, REMARKS. Includes handwritten entries for various property owners and tax amounts.

Vertical text on the right edge of the page: Ah Hing Point, Harding-Jordan Addition, Supplemental Plat of Sec 3 to No. 100, Auditor's Plat #3

Assessment

of Pike Bay
R-Residential, C-Commercial, I-Industrial, U-Utility, F-Farm, L-Lakeshore, T-Timber, M-Mineral

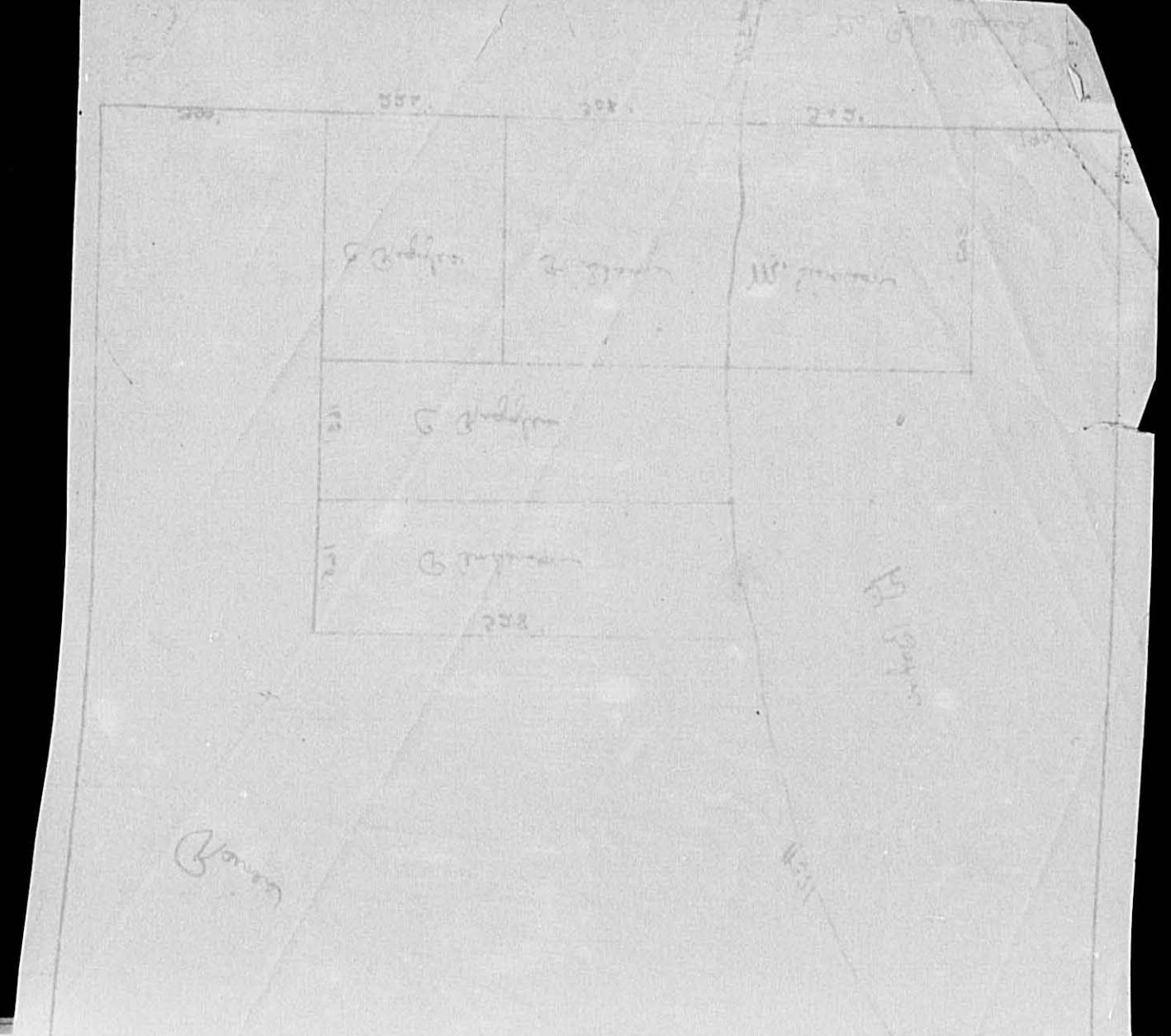

IN WHOSE NAME ASSESSED	TO WHOM TRANSFERRED	SUBDIVISION	Sec. or Lot	Town or Block	Rng.	Number of Acres of Land	No. School District	TRUSTED FULL VALUATIONS													Total Assessed Value as Equalized by the Board of Review	FINAL EQUALIZED VALUE				
								LAND Exclusive of Structures and Improvements	BUILDINGS and Other Structures	MACHINERY Permanently Attached to Real Estate	TOTAL Trng and Full Value	RURAL		ALL OTHER				MACHINERY Permanently Attached to Real Estate	TOTAL ASSESSED VALUE							
					Acres 100ths			Dollars	Dollars	Dollars	Dollars	Dollars	Dollars	Dollars	Dollars	Dollars	Dollars	Dollars	Dollars	Dollars	Dollars	Dollars	Dollars	Dollars	Dollars	
State of Minnesota		That part of NW 1/4 of SW 1/4 of Creek				16	145	31																		
Elmer + Margaret Tallstrom		That part of NE 1/4 of SW 1/4 of Section 10				10			60	375		435		145												
"		Approx. 30 acres of NW 1/4 of SW 1/4 of Section 30				30			180			180		60												
Elmer + Margaret Tallstrom		E. 165' of NW 1/4 of SW 1/4 of Section 2				2			30	300		230	46	46												
Mrs. Mary Severson		SW 1/4 of SW 1/4 of Section 2				2			30	300		230	46	46												
Bert Lang		SW 1/4 of SW 1/4 of Section 2				2			30	300		230	46	46												
		NW 1/4 of NW 1/4 of Section 8				2			50			50	10	10												
Pike Bay Township		SW 1/4 of SW 1/4 of Section 8				2			50			50	10	10												
Palmer J. + Bertha M. Anderson		SW 1/4 of SW 1/4 of Section 11				2			50	300		350	71	71												
William Eickberg		SW 1/4 of SW 1/4 of Section 13				1			50	55		85	17	17												
Ronald Rook		SW 1/4 of SW 1/4 of Section 15				6	80		60			60	12	12												
Wheeler Lumber Bridge + Supply Co.		NW 1/4 of SW 1/4 of Section 16				30			180			180	60	60												
"		NW 1/4 of SW 1/4 of Section 17				10			81			81	27	27												
Clifford + Clara Reggler		SW 1/4 of SW 1/4 of Section 19				2			40	350		390	79	79												
Clifford R. + Clara A. Reggler		SW 1/4 of SW 1/4 of Section 20				2			50			50	10	10												
					96				950	1310		2260	245	345												
					791							2101		292												
					590							590		537												

Cass County, Minnesota, for Taxes for the Year 1958.

SOLD FOR TAXES	VALUATIONS BY SCHOOL DISTRICTS AS EQUALIZED BY DEPARTMENT OF TAXATION						Tax Including State Homestead	State Tax on Non-Homestead	SPECIAL TAXES	TOTAL TAXES	PAID	WHEN PAID	Number of Receipt	March Settlement 1959	June Settlement 1959	November Settlement 1959	Penalty	Collections to First Monday in January 1960	Delinquent on First Monday in January 1960	Total Delinquent Tax and Penalty	REMARKS
	District No.	Rate	District No.	Rate	District No.	Rate															
1																					
2																					
3																					
4																					
5																					
6																					
7																					
8																					
9																					
10																					
11																					
12																					
13																					
14																					
15																					
16																					
17																					
18																					
19																					
20																					

Supplemental Plat of Auditor's Plat #3

Assessment Roll and Tax List of Real Property in the Town of Pike Bay

Indicate Type of Property: R-Residential, C-Commercial, I-Industrial, U-Utility, F-Farm, L-Lakeshore, T-Timber, M-Mineral

Table with columns: IN WHOSE NAME ASSESSED, TO WHOM TRANSFERRED, DESCRIPTION OF PROPERTY, TRUE AND FULL VALUATIONS, ASSESSED VALUATIONS, and FINAL EQUALIZED VALUE. Includes handwritten entries for various lots and owners.

Cass County, Minnesota, for Taxes for the Year 1958.

Table with columns: VALUATIONS BY SCHOOL DISTRICTS AS EQUALIZED BY DEPARTMENT OF TAXATION, TAXES, PAID, WHEN PAID, and REMARKS. Includes handwritten entries for tax payments and dates.

Vertical text on the right edge: Auditor's Plat #3, Supplemental Plat of Addition, Harding-Jordan

Assessment Roll and Tax List of Real Property in the Town of Pike Bay

Indicate Type of Property: R-Residential, C-Commercial, I-Industrial, U-Utility, F-Farm, L-Lakeshore, T-Timber, M-Mineral

Cass County, Minnesota, for Taxes for the Year 1958.

Table with columns: IN WHOSE NAME ASSESSED, TO WHOM TRANSFERRED, DESCRIPTION OF PROPERTY, TRUE AND FULL VALUATIONS, ASSESSED VALUATIONS, VALUATIONS BY SCHOOL DISTRICTS AS EQUALIZED BY DEPARTMENT OF TAXATION, SOLD FOR TAXES, PAID, WHEN PAID, Number of Receipt, March Settlement, June Settlement, Penalty, Collections to First Monday in January 1960, Delinquent on First Monday in January 1960, Total Delinquent Tax and Penalty, REMARKS.

Supplemental Plat of Auditor's Plat #3

Assessment Roll and Tax List of Real Property in the Town of Pike Bay, Cass County, Minnesota, for Taxes for the Year 1958.

Form SCD 1958-59 SUMMARY, MINNESOTA

Table with columns: IN WHOSE NAME ASSESSED, TO WHOM TRANSFERRED, DESCRIPTION OF PROPERTY, TRUE AND FULL VALUATIONS, ASSESSED VALUATIONS, and FINAL EQUALIZED VALUE. Includes handwritten entries for George & Hazel Ellish, State of Minnesota, Beatrice Polach Warner, George J. Russell, and Robert J. Richards.

Cass County, Minnesota, for Taxes for the Year 1958.

Table with columns: VALUATIONS BY SCHOOL DISTRICTS AS EQUALIZED BY DEPARTMENT OF TAXATION, TAXES, PAID, WHEN PAID, and REMARKS. Includes handwritten entries for 'SOLD FOR TAXES', 'PAID IN FULL', and '2nd HALF PAID'.

Vertical text on the right edge: 'An Hing Point', 'Harding-Jordan', 'Supplemental Plat of', 'Auditor's Plat #3'.

Assessment Roll and Tax List of Real Property in the Town of Lake Bay, Cass County, Minnesota, for Taxes for the Year 1958.

Cass County, Minnesota, for Taxes for the Year 1958.

Form 5017 (MAY 1956 EDITION) MINNESOTA

Table with columns: IN WHOSE NAME ASSESSED, TO WHOM TRANSFERRED, DESCRIPTION OF PROPERTY, TRUE AND FULL VALUATIONS, ASSESSED VALUATIONS, VALUATIONS BY SCHOOL DISTRICTS AS EQUALIZED BY DEPARTMENT OF TAXATION, TAXES, PAID, WHEN PAID, Number of Receipt, March Settlement, June Settlement, November Settlement, Collections to First Monday in January 1960, Delinquent on First Monday in January 1960, Total Delinquent Tax and Penalty, REMARKS.

Handing Jordan, Supplemental Plat of Sec 3 to Ring B, Auditor's Plat #3

* Indicate Type of Property: R-Residential, C-Commercial, I-Industrial, U-Utility, F-Farm, L-Lakeshore, T-Timber, M-Mineral

Table with columns: IN WHOSE NAME ASSESSED, TO WHOM TRANSFERRED, DESCRIPTION OF PROPERTY, TRUE AND FULL VALUATIONS, ASSESSED VALUATIONS, VALUATIONS BY SCHOOL DISTRICTS AS EQUALIZED BY DEPARTMENT OF TAXATION, TAXES, PAID, WHEN PAID, Number of Receipt, March Settlement, June Settlement, November Settlement, Collections to First Monday in January 1960, Delinquent on First Monday in January 1960, Total Delinquent Tax and Penalty, REMARKS.

Vertical text on the right edge: Ah Hung Point, Harding-Jordan, Auditor's Plat #3

Assessment Roll and Tax List of Real Property in the Town of Duke Bay, Cass County, Minnesota, for Taxes for the Year 1958.

Form 300 UNIFORM COUNTY REPORT

Table with columns: IN WHOSE NAME ASSESSED, TO WHOM TRANSFERRED, DESCRIPTION OF PROPERTY, TRUE AND FULL VALUATIONS, ASSESSED VALUATIONS, and FINAL EQUALIZED VALUE. Includes handwritten entries for Robert J. Richards, George F. + Anna M. Russell, and Vern L. + Adelle Marie Duncan.

Cass County, Minnesota, for Taxes for the Year 1958.

Table with columns: VALUATIONS BY SCHOOL DISTRICTS AS EQUALIZED BY DEPARTMENT OF TAXATION, TAXES, PAID, WHEN PAID, and REMARKS. Includes handwritten tax amounts and payment dates.

Vertical text on the right edge: An Wang Point, Harding-Jordan Addition, Supplemental Plat of Sec. 2 to An Wang P., Auditor's Plat #3

Assessment Roll and Tax List of Real Property in the Town of Pike Bay, Cass County, Minnesota, for Taxes for the Year 1958.

* Indicate Type of Property: R-Residential, C-Commercial, I-Industrial, U-Utility, F-Farm, L-Lakeshore, T-Timber, M-Mineral

Table with columns: IN WHOSE NAME ASSESSED, TO WHOM TRANSFERRED, DESCRIPTION OF PROPERTY, TRUE AND FULL VALUATIONS, ASSESSED VALUATIONS, and FINAL EQUALIZED VALUE. Includes handwritten entries for Russell, Wintermeyer, and Wittner families.

Cass County, Minnesota, for Taxes for the Year 1958.

Table with columns: VALUATIONS BY SCHOOL DISTRICTS AS EQUALIZED BY DEPARTMENT OF TAXATION, TAXES, PAID, WHEN PAID, and REMARKS. Includes handwritten tax amounts and payment dates.

Vertical text on the right edge: Auditor's Plat #3, Supplemental Plat of...

Assessment Roll and Tax List of Real Property in the Town of Pike Bay

Indicate Type of Property: R-Residential, C-Commercial, I-Industrial, U-Utility, F-Farm, L-Lakeshore, T-Timber, M-Mineral

Table with columns: IN WHOSE NAME ASSESSED, TO WHOM TRANSFERRED, DESCRIPTION OF PROPERTY, TRUE AND FULL VALUATIONS, ASSESSED VALUATIONS, FINAL EQUALIZED VALUE. Includes entries for Earl P. & Emily Foster, Adolph & Emma Hornblad, Nora Reuter, David J. & Mary Louise, Virgil J. & Ethel M. Foster.

Cass County, Minnesota, for Taxes for the Year 1958.

Table with columns: VALUATIONS BY SCHOOL DISTRICTS AS EQUALIZED BY DEPARTMENT OF TAXATION, Tax including State Homestead, State Tax on Non-Homestead, SPECIAL TAXES, TOTAL TAXES, PAID, WHEN PAID, Number of Receipt, March Settlement, June Settlement, November Settlement, Penalty, Collections to First Monday in January 1960, Delinquent on First Monday in January 1960, Total Delinquent Tax and Penalty, REMARKS. Includes entries for Earl P. & Emily Foster, Adolph & Emma Hornblad, Nora Reuter, David J. & Mary Louise, Virgil J. & Ethel M. Foster.

Supplemental Plat of Auditor's Plat #3

* Indicate Type of Property: R-Residential, C-Commercial, I-Industrial, U-Utility, F-Farm, L-Lakeshore, T-Timber, M-Mineral

Table with columns: IN WHOSE NAME ASSESSED, TO WHOM TRANSFERRED, DESCRIPTION OF PROPERTY, TRUE AND FULL VALUATIONS, ASSESSED VALUATIONS, FINAL EQUALIZED VALUE. Includes handwritten entries for various property owners like 'Pike Northwest Paper Co' and 'Earl D. & Emily W. Foster'.

Table with columns: SOLD FOR TAXES, VALUATIONS BY SCHOOL DISTRICTS AS EQUALIZED BY DEPARTMENT OF TAXATION, Tax including State Homestead, SPECIAL TAXES, TOTAL TAXES, PAID, WHEN PAID, Number of Receipt, March Settlement, June Settlement, November Settlement, Collections to First Monday in January 1960, Delinquent on First Monday in January 1960, Total Delinquent Tax and Penalty, REMARKS. Includes handwritten entries for tax payments and dates.

At King Point

Harding-Jordan Addition

Supplemental Plat of Sec 3 to No 1148 B.

Auditor's Plat #3

Assessment Roll and Tax List of Real Property in the Town of Pike Bay

* Indicate Type of Property: R-Residential, C-Commercial, I-Industrial, U-Utility, F-Farm, L-Lakeshore, T-Timber, M-Mineral

Table with columns: IN WHOSE NAME ASSESSED, TO WHOM TRANSFERRED, DESCRIPTION OF PROPERTY, TRUE AND FULL VALUATIONS, ASSESSED VALUATIONS, FINAL EQUALIZED VALUE. Includes handwritten entries for property owners like Steve Swenson and Herman & Holding & Kling.

Cass County, Minnesota, for Taxes for the Year 1958.

Table with columns: VALUATIONS BY SCHOOL DISTRICTS AS EQUALIZED BY DEPARTMENT OF TAXATION, Tax including State Homestead, State Tax on Non-Homestead, SPECIAL TAXES, TOTAL TAXES, PAID, WHEN PAID, Number of Receipt, March Settlement, June Settlement, November Settlement, Collections to First Monday in January 1960, Delinquent on First Monday in January 1960, Total Delinquent Tax and Penalty, REMARKS. Includes handwritten entries for tax payments and dates.

Vertical text on the right edge: Ah Nung Print, Harding-Jordan, Auditor's Plat #3

Assessment Roll and Tax List of Real Property in the Town of Pike Bay

Cass County, Minnesota, for Taxes for the Year 1958.

At Mang Point

Table with columns: IN WHOSE NAME ASSESSED, TO WHOM TRANSFERRED, DESCRIPTION OF PROPERTY, TRUE AND FULL VALUATIONS, ASSESSED VALUATIONS, FINAL EQUALIZED VALUE. Includes handwritten entries for various property owners like Florence B. Munger and Charles Boreman.

Table with columns: SOLD FOR TAXES, VALUATIONS BY SCHOOL DISTRICTS AS EQUALIZED BY DEPARTMENT OF TAXATION, Tax including State Homestead, SPECIAL TAXES, TOTAL TAXES, PAID, WHEN PAID, March Settlement, June Settlement, November Settlement, Collections to First Monday in January 1960, Delinquent on First Monday in January 1960, Total Delinquent Tax and Penalty, REMARKS. Includes handwritten notes on tax payments and delinquencies.

Harding-Jordan's Supplemental Plat of Sec 1 to Mang B. Auditor's Plat #3

Assessment Roll and Tax List of Real Property in the Town of Pike Bay

Cass County, Minnesota, for Taxes for the Year 1958.

Form 30 - MINN. STAT. COMP. 1957, MINNAPOLIS. *Indicate Type of Property: R-Residential, C-Commercial, I-Industrial, U-Utility, F-Farm, L-Lakeshore, T-Timber, M-Mineral

Point Nung Ah

Harding-Jondahl Addition

Table with columns: IN WHOSE NAME ASSESSED, TO WHOM TRANSFERRED, SUBDIVISION, DESCRIPTION OF PROPERTY, TRUE AND FULL VALUATIONS, ASSESSED VALUATIONS, FINAL EQUALIZED VALUE. Includes handwritten entries for Nelson D. Helland, Donald C. Norenberg, Elmer Kallstrom, etc.

Table with columns: VALUATIONS BY SCHOOL DISTRICTS AS EQUALIZED BY DEPARTMENT OF TAXATION, TAX INCLUDING STATE HOMESTEAD, SPECIAL TAXES, TOTAL TAXES, PAID, WHEN PAID, Number of Receipt, March Settlement 1959, June Settlement 1959, November Settlement 1959, Collections to First Monday in January 1960, Delinquent on First Monday in January 1960, Total Delinquent Tax and Penalty, REMARKS.

Supplemental Plat of Sec 1 so No Nung B. Auditor's Plat #3

Assessment Roll and Tax List of Real Property in the Town of Pike Bay

Cass County, Minnesota, for Taxes for the Year 1958.

Indicate Type of Property: R-Residential, C-Commercial, I-Industrial, U-Utility, F-Farm, L-Lakeshore, T-Timber, M-Mineral

Table with columns: IN WHOSE NAME ASSESSED, TO WHOM TRANSFERRED, DESCRIPTION OF PROPERTY, TRUE AND FULL VALUATIONS, ASSESSED VALUATIONS, and FINAL EQUALIZED VALUE. Includes handwritten entries for various lots and owners like Frank & Margaret Polaris.

Table with columns: VALUATIONS BY SCHOOL DISTRICTS AS EQUALIZED BY DEPARTMENT OF TAXATION, TAXES, PAID, WHEN PAID, and various settlement/penalty columns. Includes handwritten entries for tax amounts and payment dates.

Vertical text on the left margin: Ah Nung Point, Harding-Jondahl Addition

Vertical text on the right margin: Supplemental Plat of Dist. # 50 No. 10 Nung B. Auditor's Plat #3

Assessment Roll and Tax List of Real Property in the Town of Pike Bay

* Indicate Type of Property: R-Residential, C-Commercial, I-Industrial, U-Utility, F-Farm, L-Lakeshore, T-Timber, M-Mineral

Cass County, Minnesota, for Taxes for the Year 1958.

An Nung Point

Harding-Jordahl Addition

Supplemental Plat of Bug # 20 to Ring Beach

Table with columns: IN WHOSE NAME ASSESSED, TO WHOM TRANSFERRED, DESCRIPTION OF PROPERTY, TRUE AND FULL VALUATIONS, ASSESSED VALUATIONS, and FINAL EQUALIZED VALUE. Includes handwritten entries for Otto Norenberg, Edna B. Hanson, etc.

Table with columns: SOLD FOR TAXES, VALUATIONS BY SCHOOL DISTRICTS AS EQUALIZED BY DEPARTMENT OF TAXATION, Tax including State Homestead, State Tax on Non-Homestead, SPECIAL TAXES, TOTAL TAXES, PAID, WHEN PAID, Number of Receipt, March Settlement, June Settlement, Penalty, November Settlement, Penalty, Collections to First Monday in January 1960, Delinquent on First Monday in January 1960, Total Delinquent Tax and Penalty, REMARKS.

Auditor's Plat #3

Assessment Roll and Tax List of Real Property in the Town of Pike Bay

Indicate Type of Property: R-Residential, C-Commercial, I-Industrial, U-Utility, F-Farm, L-Lakeshore, T-Timber, M-Mineral

Cass County, Minnesota, for Taxes for the Year 1958.

Point Ah Ming Harding-Jordahl Addition Supplemental Plat of Bug # 20 No Ming Beach

Table with columns: IN WHOSE NAME ASSESSED, TO WHOM TRANSFERRED, SUBDIVISION, TRUE AND FULL VALUATIONS, ASSESSED VALUATIONS, FINAL EQUALIZED VALUE. Includes handwritten entries for Gerald A. & Florence V. Fuller and Tract in Blk 3.

Table with columns: VALUATIONS BY SCHOOL DISTRICTS AS EQUALIZED BY DEPARTMENT OF TAXATION, TAXES, PAID, WHEN PAID, March Settlement, June Settlement, November Settlement, Collections to First Monday in January 1960, Delinquent on First Monday in January 1960, Total Delinquent Tax and Penalty, REMARKS. Includes handwritten tax amounts and payment dates.

Auditor's Plat #3

Assessment Roll and Tax List of Real Property in the Town of Pike Bay

Indicate Type of Property: R-Residential, C-Commercial, I-Industrial, U-Utility, F-Farm, L-Lakeshore, T-Timber, M-Mineral

Form 30

Harding-Jondahl Addition

Supplemental Plat of Section 20 to the Harding Beach

Auditor's Plat #3

Table with columns: IN WHOSE NAME ASSESSED, TO WHOM TRANSFERRED, SUBDIVISION, DESCRIPTION OF PROPERTY, TRUE AND FULL VALUATIONS, ASSESSED VALUATIONS, FINAL EQUALIZED VALUE. Includes entries for Loren & Jeanette Zuelow, Les. P. & Irene J. Schaak, Adjalmer Hanson, etc.

Cass County, Minnesota, for Taxes for the Year 1958.

Table with columns: SOLD FOR TAXES, VALUATIONS BY SCHOOL DISTRICTS AS EQUALIZED BY DEPARTMENT OF TAXATION, Tax Including State Homestead, State Tax on Non-Homestead, SPECIAL TAXES, TOTAL TAXES, PAID, WHEN PAID, Number of Receipt, March Settlement 1959, June Settlement 1959, November Settlement 1959, Collections to First Monday in January 1960, Delinquent on First Monday in January 1960, Total Delinquent Tax and Penalty, REMARKS. Includes entries for Loren & Jeanette Zuelow, Les. P. & Irene J. Schaak, etc.

Assessment Roll and Tax List of Real Property in the Town of Pike Bay

Indicate Type of Property: R-Residential, C-Commercial, I-Industrial, U-Utility, F-Farm, L-Lakeshore, T-Timber, M-Mineral

Cass County, Minnesota, for Taxes for the Year 1958.

Form 30 Ah Nung Point Hardings-Jordahl Addition Supplemental Plat of Bug # 20 We Nung Beach Auditor's Plat #3

Table with columns: IN WHOSE NAME ASSESSED, TO WHOM TRANSFERRED, DESCRIPTION OF PROPERTY, TRUE AND FULL VALUATIONS, ASSESSED VALUATIONS, and FINAL EQUALIZED VALUE. Includes handwritten entries like 'Louis F. Zoff' and 'Grand Total'.

Table with columns: SOLD FOR TAXES, VALUATIONS BY SCHOOL DISTRICTS AS EQUALIZED BY DEPARTMENT OF TAXATION, Tax including State Homestead, State Tax on Non-Homestead, SPECIAL TAXES, TOTAL TAXES, PAID, WHEN PAID, Number of Receipt, March Settlement 1959, June Settlement 1959, November Settlement 1959, Penalty, Collections to First Monday in January 1960, Delinquent on First Monday in January 1960, Total Delinquent Tax and Penalty, REMARKS. Includes handwritten calculations and 'Grand Total'.