

ASSESSMENT & TAX LIST - 1956

Pike Bay

Assessor's Return

NAMES OF OWNERS

#1. Sec. 9-10-11-12-13-15-16-17-18-19-20-21-27-28-29-30-31-32-33-34
Harding Jordahl - big E. and Old #3 + all P.P.
#2. Sec. 2-3-4-5-6-7-8 + 14 + all Mang.

TABULAR SCHEDULE OF VALUATIONS,

LEVIED IN THE Town OF Pike Bay

School District No.	VALUATION BY SCHOOL DISTRICTS				RATE OF STATE TAXES	RATE OF COUNTY TAXES					RATE OF TOWN TAXES					RATE OF								
	Agri-cultural Lands	Non-Agri-cultural Lands	Personal Property	Total Value of all Property except Money and Credits		Rev.	R. & B.	Welfare	Bonds and Int.	R. & B. Co. Agri. Loan.	Total Rate of County Tax	Rev.	R. & B.	Drag Tax	State Loan	Total Rate of Town Tax	Local	Special	State Loan	Deficiency	Tuition	Transportation	C.O. B.S.	
1. 3	17,303	14,879	80,898	118,133	H. 3.81	27.08	14.18	47.70	7.74	2.00	15	106.42	2.26	1.9	1.	57	5.73	1.25	14.	30.	.73	10.	5.	
2. 3	8752	5637		14,389				7.22	Welfare Ref									1.	50.	14.	30.	.73	10.	5.
				132,522																				
						N.H. 5.34																		
						9.15																		

Assessed Value	Rural	All Other	Personal Property	Total
Homestead	16,492	7316		23,808
Non-Homestead	14,207	8556	85951	108,714
Total	30,699	15,872	85,951	132,522

RATES AND TAXES

COUNTY OF CASS, STATE OF MINNESOTA

SCHOOL TAXES		LOCAL 1 MILL AND SPECIAL SCHOOL TAXES BY DISTRICTS										ALL OTHER TAXES		
Total Rate of Sch'l Tax	Total Rate of all Taxes	Local 1 Mill	Special	State Loan	Def. Jan'y.	C.O. B.S.	Total School Taxes	FUNDS	Rate	Amounts				
85.73	201.69	2236	55890	31298	67068	1632	22356	11178			191658	State - Non-Homestead,		57106
110.73	226.69	9578	478885	134088	287331	6991	95777	47888			1060538	State - Homestead,		50491
71.73	187.69	875	21880		26256	639	8752	4376			62778	County Revenue,		358858
96.73	212.69	564	28185		16911	411	5637	2819			54527	County Road and Bridge,		187916
												County Welfare,		632130
												Bonds and Interest		102572
												R. & B. Bldg.		26584
												Land to Ag. Loan.		6626
												Welfare Deficiency		95681
												Town Revenue,		29950
												Town Road and Bridge,		20779
												Town Drag,		13252
												Town State Loan,		
												Fire		7554
														75735
												School Local 1 Mill,		13253
												School Special,		584840
												School State Loan,		165386
												Deficiency		397566
												Tuition		
												Transportation		9673
												Capital Outlay		132522
												Bond & Int.		66261
														13,69501

Total Taxes Real Estate 9816.38
Pers. Prop. 19816.82
Total 29633.20

Total Number of Acres 9272.01
Total Levy \$29,633.20
I, L. C. Peterson
Auditor of said County and State aforesaid, do hereby certify that the foregoing is a true and correct Schedule, showing the valuation of all the taxable property, in the Town of Pike Bay, in said County, the several rates of Taxation and Totals of the several Tax Funds levied thereon for the year A. D. 1956.
Witness my hand and official seal, this 5th day of December, A. D. 1956.

L. C. Peterson County Auditor.
By Helen Bilber, Deputy

SEAL

Real Estate
In-Ming Point
Harding-Jordahl
Addition
Special Assessor
Pike Bay
Assessor's Plat #3

Assessment Roll and Tax List of Real Property in the Town of Pike Bay, Cass County, Minnesota, for Taxes for the Year 1956.

Cass County, Minnesota, for Taxes for the Year 1956.

Form SCID (56) MILLAGE-RATE REPORT, MINNESOTA. Indicate Type of Property: R-Residential, C-Commercial, I-Industrial, U-Utility, F-Farm, L-Lakeshore, T-Timber, M-Mineral

Table with columns: IN WHOSE NAME ASSESSED, TO WHOM TRANSFERRED, DESCRIPTION OF PROPERTY, TRUE AND FULL VALUATIONS, ASSESSED VALUATIONS, VALUATIONS BY SCHOOL DISTRICTS AS EQUALIZED BY DEPARTMENT OF TAXATION, TAXES, PAID, WHEN PAID, Number of Receipt, March Settlement 1957, June Settlement 1957, Penalty, November Settlement 1957, Penalty, Collections to First Monday in January 1958, Penalty, Delinquent on First Monday in January 1958, Total Delinquent Tax and Penalty, REMARKS.

Assessment Roll and Tax List of Real Property in the Town of Lake Park, Cass County, Minnesota

Cass County, Minnesota, for Taxes for the Year 1956.

Table with columns: IN WHOSE NAME ASSESSED, TO WHOM TRANSFERRED, DESCRIPTION OF PROPERTY, TRUE AND FULL VALUATIONS, ASSESSED VALUATIONS, VALUATIONS BY SCHOOL DISTRICTS AS EQUALIZED BY DEPARTMENT OF TAXATION, TAXES, PAID, WHEN PAID, etc.

(continued on next page)

Point Harding - Ondahn! Supplemental Plat of Sec. 20 - Mc-Ming Plat #3

Assessment Roll and Tax List of Real Property in the Town of Pike Bay

* Indicate Type of Property: R-Residential, C-Commercial, I-Industrial, U-Utility, F-Farm, L-Lakeshore, T-Timber, M-Mineral

IN WHOSE NAME ASSESSED	TO WHOM TRANSFERRED	DESCRIPTION OF PROPERTY				No. School District	Indicate Homestead Yes or No	Indicate Agricultural Yes or No	Indicate Type of Property	TRUE AND FULL VALUATIONS										Total Assessed Value as Equalized by the Board of Review	FINAL EQUALIZED VALUE		
		SUBDIVISION	Sec. or Lot	Town or Block	Rng.					Number of Acres of Land	LAND Exclusive of Structures and Improvements	BUILDINGS and Other Structures	MACHINERY Permanently Attached to Real Estate	TOTAL True and Full Value	RURAL			ALL OTHER				TOTAL ASSESSED VALUE	
															Acres	100ths	Homestead Up to \$4,000 20%	Over \$4,000 and Non-Homestead 33 1/3%	Timber Land Class 3e 20%				Homestead Up to \$4,000 25%
Kenneth Burns		NE 1/4 of NE 1/4 Sec 9 T14S31R40	9	14531	40			T	240								80	80					
Frank Gehke		NW 1/4 of NE 1/4			40			F	264	100							128	384					
Wheeler Lumber Bridge & Supply Co		SW 1/4 of NE 1/4																					
Kenneth Burns		SE 1/4 of NE 1/4 Sec 9 T14S31R40			30			T	120								40	120					
"		N 1/2 of SE 1/4 Sec 9 T14S31R40			41				246								82	246					
Corcoran Lumber Company		NE 1/4 of NW 1/4			40				240								80	240					
"		NW 1/4 of NW 1/4			40				240								80	240					
L.C. & Leah Kirpatrick		SW 1/4 of NW 1/4			40				240								80	240					
Wheeler Lumber Bridge & Supply Comp		SE 1/4 of NW 1/4																					
Clifford B. & Grace C. Swenson		NE 1/4 of NE 1/4 of SE 1/4 Sec 9 T14S31R40			20			R	200	3800							800	4000					
Kenneth Burns		NE 1/4 of SW 1/4			40			T	240								80	240					
Floyd L. & Dagmar Baird		NW 1/4 of SW 1/4			40				264								88	264					
Roy Stai		SW 1/4 of SW 1/4 Sec 9 T14S31R40			20			R	100	860							320	960					
		SE 1/4 of SW 1/4																					
Hallace T. & Anne S. Wischart		SE 1/4 of NE 1/4 of SE 1/4 Sec 9 T14S31R40			10			R	95	850							189	945					
Willard & Gloria Hansche		W. 950' of SW 1/4 of SW 1/4 Sec 9 T14S31R40						R	75	195							54	270					
		NW 1/4 of SE 1/4																					
		SW 1/4 of SE 1/4																					
		SE 1/4 of SE 1/4																					
Village of Cass Lake		SE 1/4 of NW 1/4 of SE 1/4			401				2564	5825							1043	8389					

(continued on next page)

Cass County, Minnesota, for Taxes for the Year 1956.

SOLD FOR TAXES	VALUATIONS BY SCHOOL DISTRICTS AS EQUALIZED BY DEPARTMENT OF TAXATION						Tax including State Homestead	State Tax on Non-Homestead	SPECIAL TAXES	TOTAL TAXES	PAID	WHEN PAID	Number of Receipt	March Settlement 1957	June Settlement 1957	Penalty	November Settlement 1957	Penalty	Collections to First Monday in January 1958	Penalty	Delinquent on First Monday in January 1958	Total Delinquent Tax and Penalty	REMARKS
	District No.	District No.	District No.	District No.	District No.	District No.																	
	Rate	Rate	Rate	Rate	Rate	Rate																	
1																							
2																							
3																							
4																							
5																							
6																							
7																							
8																							
9																							
10																							
11																							
12																							
13																							
14																							
15																							
16																							
17																							
18																							
19																							
20																							

Printed and Bound by the State of Minnesota, Department of Taxation, St. Paul, Minnesota

Assessment Roll and Tax List of Real Property in the Town of Pike Bay

Indicate Type of Property: R-Residential, C-Commercial, I-Industrial, U-Utility, F-Farm, L-Lakeshore, T-Timber, M-Mineral

Cass County, Minnesota, for Taxes for the Year 1956.

Table with columns: IN WHOSE NAME ASSESSED, TO WHOM TRANSFERRED, DESCRIPTION OF PROPERTY, TRUE AND FULL VALUATIONS, ASSESSED VALUATIONS, VALUATIONS BY SCHOOL DISTRICTS AS EQUALIZED BY DEPARTMENT OF TAXATION, TAXES, PAID, WHEN PAID, Number of Receipt, March Settlement 1957, June Settlement 1957, Penalty, November Settlement 1957, Penalty, Collections to First Monday in January 1958, Delinquent on First Monday in January 1958, Total Delinquent Tax and Penalty, REMARKS.

SW 1/4 of SE 1/4
16-145-31

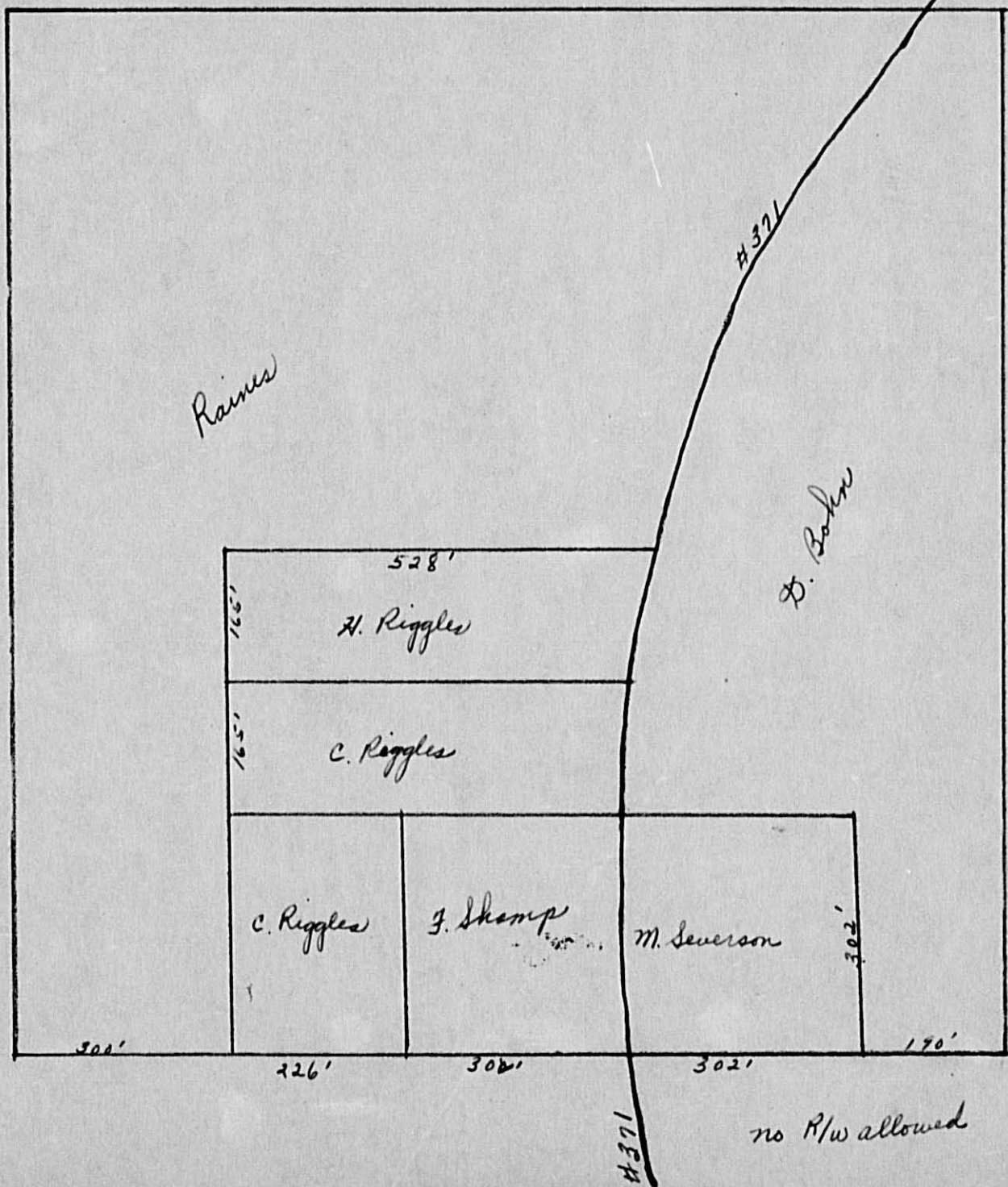

no R/W allowed

1371

Assessment Roll and Tax List of Real Property in the Town of Lake Park

Indicate Type of Property: R-Residential, C-Commercial, I-Industrial, U-Utility, F-Farm, L-Lakeshore, T-Timber, M-Mineral

Table with columns: IN WHOSE NAME ASSESSED, TO WHOM TRANSFERRED, DESCRIPTION OF PROPERTY, TRUE AND FULL VALUATIONS, ASSESSED VALUATIONS, and FINAL EQUALIZED VALUE. Includes entries for Christ Millard, Ole Hendrickson, Floyd S. & Margaret S. Baird, Oscar & Ethelwyn Edsmore, Frank & Johanna Elliott, Fred C. Benckey, Leo P. & Irene J. Schack, Harry & Bertha Graman.

Cass County, Minnesota, for Taxes for the Year 1956.

Table with columns: SOLD FOR TAXES, VALUATIONS BY SCHOOL DISTRICTS AS EQUALIZED BY DEPARTMENT OF TAXATION, Tax including State Homestead, State Tax on Non-Homestead, SPECIAL TAXES, TOTAL TAXES, PAID, WHEN PAID, Number of Receipt, March Settlement 1957, June Settlement 1957, Penalty, November Settlement 1957, Penalty, Collections to First Monday in January 1958, Penalty, Delinquent on First Monday in January 1958, Total Delinquent Tax and Penalty, REMARKS. Includes entries for 1 through 20 with tax amounts and payment dates.

Supplemental Plat of Harding-Jordan Addition - 20-Meeting Beach Auditor's Plat #3

Assessment Roll and Tax List of Real Property in the Town of Pike Bay

Indicate Type of Property: R-Residential, C-Commercial, I-Industrial, U-Utility, F-Farm, L-Lakeshore, T-Timber, M-Mineral

Cass County, Minnesota, for Taxes for the Year 1956.

Form SCID (56) BILLS-BAYE DEPART. MINNAPOLIS

Table with columns: IN WHOSE NAME ASSESSED, TO WHOM TRANSFERRED, DESCRIPTION OF PROPERTY, TRUE AND FULL VALUATIONS, ASSESSED VALUATIONS, VALUATIONS BY SCHOOL DISTRICTS AS EQUALIZED BY DEPARTMENT OF TAXATION, TAXES, PAID, WHEN PAID, Number of Receipt, March Settlement 1957, June Settlement 1957, November Settlement 1957, Collections to First Monday in January 1958, Delinquent on First Monday in January 1958, Total Delinquent Tax and Penalty, REMARKS.

Handwritten notes and signatures on the right margin, including 'Supplemental Plat #89' and 'Auditor's Plat #3'.

Assessment Roll and Tax List of Real Property in the Town of Pike Bay

Indicate Type of Property: R-Residential, C-Commercial, I-Industrial, U-Utility, F-Farm, L-Lakeshore, T-Timber, M-Mineral

Cass County, Minnesota, for Taxes for the Year 1956.

Form 301 (56) STATE-STATE UNIVERSITY, MINNEAPOLIS

Main table with columns: IN WHOSE NAME ASSESSED, TO WHOM TRANSFERRED, DESCRIPTION OF PROPERTY, TRUE AND FULL VALUATIONS, ASSESSED VALUATIONS, VALUATIONS BY SCHOOL DISTRICTS AS EQUALIZED BY DEPARTMENT OF TAXATION, TAXES, PAID, WHEN PAID, Number of Receipt, March Settlement 1957, June Settlement 1957, Penalty, November Settlement 1957, Penalty, Collections to First Monday in January 1958, Delinquent on First Monday in January 1958, Total Delinquent Tax and Penalty, REMARKS.

Handwritten notes on the right margin: 'Harding - Fondahl', 'Supplemental Plat B88', 'Muditor's Plat #3'.

Assessment Roll and Tax List of Real Property in the Town of Pike Bay

* Indicate Type of Property: R-Residential, C-Commercial, I-Industrial, U-Utility, F-Farm, L-Lakeshore, T-Timber, M-Mineral

Table with columns: IN WHOSE NAME ASSESSED, TO WHOM TRANSFERRED, DESCRIPTION OF PROPERTY, TRUE AND FULL VALUATIONS, ASSESSED VALUATIONS, FINAL EQUALIZED VALUE. Includes entries for Carcoran Timber Co., Earl D. & Emily W. Foster, Albert Fuhrman, Louis & Bertha Bisson, and Fred F. DeWitt.

Cass County, Minnesota, for Taxes for the Year 1956.

Table with columns: SOLD FOR TAXES, VALUATIONS BY SCHOOL DISTRICTS AS EQUALIZED BY DEPARTMENT OF TAXATION, Tax including State Homestead, SPECIAL TAXES, TOTAL TAXES, PAID, WHEN PAID, Number of Receipt, March Settlement 1957, June Settlement 1957, Penalty, November Settlement 1957, Penalty, Collections to First Monday in January 1958, Penalty, Delinquent on First Monday in January 1958, Total Delinquent Tax and Penalty, REMARKS. Includes entries for 1-20 with tax amounts and payment dates.

Vertical text on the right edge: Auditor's Plat #3, Suppl. General Plat Beach, Hardin-Donald Addition

Assessment Roll and Tax List of Real Property in the Town of Pike Bay

Indicate Type of Property: R-Residential, C-Commercial, I-Industrial, U-Utility, F-Farm, L-Lakeshore, T-Timber, M-Mineral

Cass County, Minnesota, for Taxes for the Year 1956.

Table with columns: IN WHOSE NAME ASSESSED, TO WHOM TRANSFERRED, DESCRIPTION OF PROPERTY, TRUE AND FULL VALUATIONS, ASSESSED VALUATIONS, FINAL EQUALIZED VALUE.

Table with columns: SOLD FOR TAXES, VALUATIONS BY SCHOOL DISTRICTS AS EQUALIZED BY DEPARTMENT OF TAXATION, TAX INCLUDING STATE HOMESTEAD, SPECIAL TAXES, TOTAL TAXES, PAID, WHEN PAID, Number of Receipt, March Settlement, June Settlement, Penalty, November Settlement, Penalty, Collections to First Monday in January 1958, Delinquent on First Monday in January 1958, Total Delinquent Tax and Penalty, REMARKS.

Contd next page

Harding-Jonahln Supplemental Plat Beach Auditor's Plat #3

Assessment Roll and Tax List of Real Property in the Town of Pike Lake

Cass County, Minnesota, for Taxes for the Year 1956.

* Indicate Type of Property: R-Residential, C-Commercial, I-Industrial, U-Utility, F-Farm, L-Lakeshore, T-Timber, M-Mineral

Table with columns: IN WHOSE NAME ASSESSED, TO WHOM TRANSFERRED, SUBDIVISION, TRUE AND FULL VALUATIONS (LAND, BUILDINGS, MACHINERY, TOTAL), ASSESSED VALUATIONS (RURAL, ALL OTHER, MACHINERY, TOTAL), VALUATIONS BY SCHOOL DISTRICTS AS EQUALIZED BY DEPARTMENT OF TAXATION, SOLD FOR TAXES, SPECIAL TAXES, TOTAL TAXES, PAID, WHEN PAID, Number of Receipt, March Settlement, June Settlement, November Settlement, Collections to First Monday in January 1955, Delinquent on First Monday in January 1955, Total Delinquent Tax and Penalty, REMARKS.

At-Hung Point

Harding-Jonahall Supplemental Plat of Bugbee-Goette-Ming Beach Auditor's Plat #3

Assessment Roll and Tax List of Real Property in the Town of Pike Lake

Indicate Type of Property: R-Residential, C-Commercial, I-Industrial, U-Utility, F-Farm, L-Lakeshore, T-Timber, M-Mineral

Cass County, Minnesota, for Taxes for the Year 1956.

Harding-Jondahl Addition

Table with columns: IN WHOSE NAME ASSESSED, TO WHOM TRANSFERRED, DESCRIPTION OF PROPERTY, TRUE AND FULL VALUATIONS, ASSESSED VALUATIONS, VALUATIONS BY SCHOOL DISTRICTS AS EQUALIZED BY DEPARTMENT OF TAXATION, TAX INCLUDING STATE HOMESTEAD, SPECIAL TAXES, TOTAL TAXES, PAID, WHEN PAID, Number of Receipt, March Settlement 1957, June Settlement 1957, Penalty, November Settlement 1957, Penalty, Collections to First Monday in January 1955, Penalty, Delinquent on First Monday in January 1955, Total Delinquent Tax and Penalty, REMARKS.

Special Assessed Plat #8

Auditor's Plat #3

Assessment Roll and Tax List of Real Property in the Town of Pike Bay

Cass County, Minnesota, for Taxes for the Year 1956.

Indicate Type of Property: R-Residential, C-Commercial, I-Industrial, U-Utility, F-Farm, L-Lakeshore, T-Timber, M-Mineral

Al-Nu...
Harding-Jondahl
Addition
Supplemental Plat of
But-Be-Me-Ming Beach

Table with columns: IN WHOSE NAME ASSESSED, TO WHOM TRANSFERRED, DESCRIPTION OF PROPERTY, TRUE AND FULL VALUATIONS, ASSESSED VALUATIONS, VALUATIONS BY SCHOOL DISTRICTS AS EQUALIZED BY DEPARTMENT OF TAXATION, SOLD FOR TAXES, PAID, WHEN PAID, Number of Receipt, March Settlement 1957, June Settlement 1957, November Settlement 1957, Collections to First Monday in January 1958, Delinquent on First Monday in January 1958, Total Delinquent Tax and Penalty, REMARKS.

Auditor's Plat #3

Assessment Roll and Tax List of Real Property in the Town of Pillsbury

Cass County, Minnesota, for Taxes for the Year 1956.

Form 50 (56) Indicate Type of Property: R-Residential, C-Commercial, I-Industrial, U-Utility, F-Farm, L-Lakeshore, T-Timber, M-Mineral

Al-Nung Harding-Jordahl Supplemental Plat of Bur-E-Zo-We-Ning Beach

Table with columns: IN WHOSE NAME ASSESSED, TO WHOM TRANSFERRED, DESCRIPTION OF PROPERTY, TRUE AND FULL VALUATIONS, ASSESSED VALUATIONS, VALUATIONS BY SCHOOL DISTRICTS AS EQUALIZED BY DEPARTMENT OF TAXATION, TAXES, PAID, WHEN PAID, Number of Receipt, March Settlement 1957, June Settlement 1957, Penalty, November Settlement 1957, Collections to First Monday in January 1958, Delinquent on First Monday in January 1958, Total Delinquent Tax and Penalty, REMARKS.

Auditor's Plat #3

Assessment Roll and Tax List of Real Property in the Town of Pike Bay

Indicate Type of Property: R-Residential, C-Commercial, I-Industrial, U-Utility, F-Farm, L-Lakeshore, T-Timber, M-Mineral

Cass County, Minnesota, for Taxes for the Year 1956.

Table with columns: IN WHOSE NAME ASSESSED, TO WHOM TRANSFERRED, DESCRIPTION OF PROPERTY, TRUE AND FULL VALUATIONS, ASSESSED VALUATIONS, VALUATIONS BY SCHOOL DISTRICTS AS EQUALIZED BY DEPARTMENT OF TAXATION, TAXES, PAID, WHEN PAID, Number of Receipt, March Settlement 1957, June Settlement 1957, November Settlement 1957, Collections to First Monday in January 1958, Delinquent on First Monday in January 1958, Total Delinquent Tax and Penalty, REMARKS.

Supplemental Plat of Harding-Jordahl Addition, Supplem. Plat of Bug-E-Zo-We-Ming Beach

Auditor's Plat #3

Assessment Roll and Tax List of Real Property in the Town of Pike Bay

* Indicate Type of Property: R-Residential, C-Commercial, I-Industrial, U-Utility, F-Farm, L-Lakeshore, T-Timber, M-Mineral

Table with columns: IN WHOSE NAME ASSESSED, TO WHOM TRANSFERRED, DESCRIPTION OF PROPERTY, TRUE AND FULL VALUATIONS, ASSESSED VALUATIONS, FINAL EQUALIZED VALUE. Includes handwritten entries for Loren & Jeanette Zuelow, Leonard & Esther DeWitt, State of Minnesota, etc.

Cass County, Minnesota, for Taxes for the Year 1956.

Table with columns: SOLD FOR TAXES, VALUATIONS BY SCHOOL DISTRICTS AS EQUALIZED BY DEPARTMENT OF TAXATION, TAX INCLUDING STATE HOMESTEAD, STATE TAX ON NON-HOMESTEAD, SPECIAL TAXES, TOTAL TAXES, PAID, WHEN PAID, Number of Receipt, March Settlement 1957, June Settlement 1957, November Settlement 1957, Collections to First Monday in January 1958, Delinquent on First Monday in January 1958, Total Delinquent Tax and Penalty, REMARKS. Includes handwritten entries for 1st Half Paid, 2nd Half Paid, PAID IN FULL, etc.

