

Assessment & Inventory List - 1982  
May

INDEX TO SECTIONS

SECTION PAGE

Sec. 1	
" 2	
" 3	
" 4	
" 5	
" 6	
" 7	
" 8	
" 9	
" 10	
" 11	
" 12	
" 13	
" 14	
" 15	
" 16	
" 17	
" 18	
" 19	
" 20	
" 21	
" 22	
" 23	
" 24	
" 25	
" 26	
" 27	
" 28	
" 29	
" 30	
" 31	
" 32	
" 33	
" 34	
" 35	
" 36	

For Convenience of Auditor in Showing Boundaries of School Districts

Township No. <sup>Part of</sup> 133 Range No. 31 Mer. P. M.

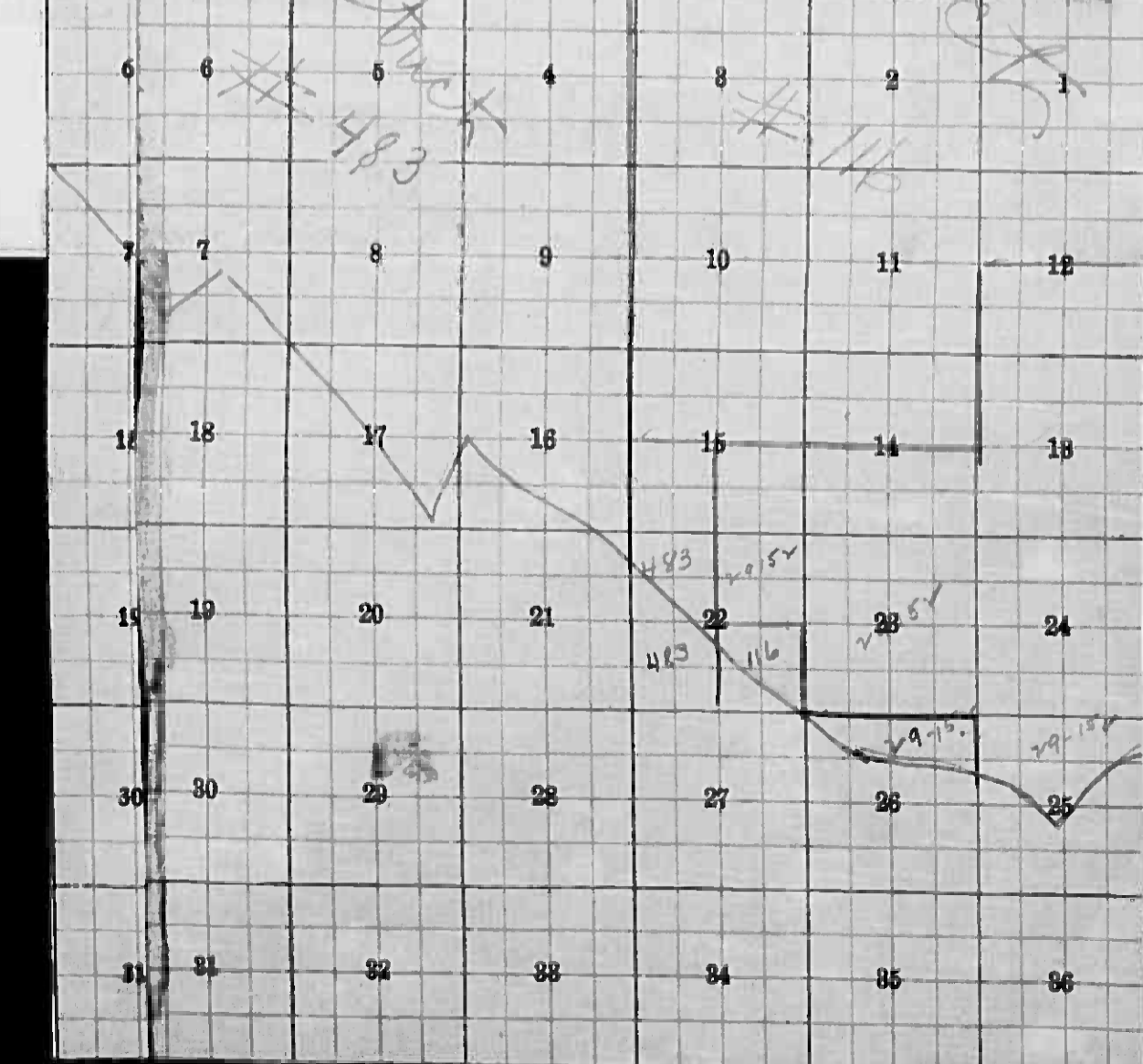
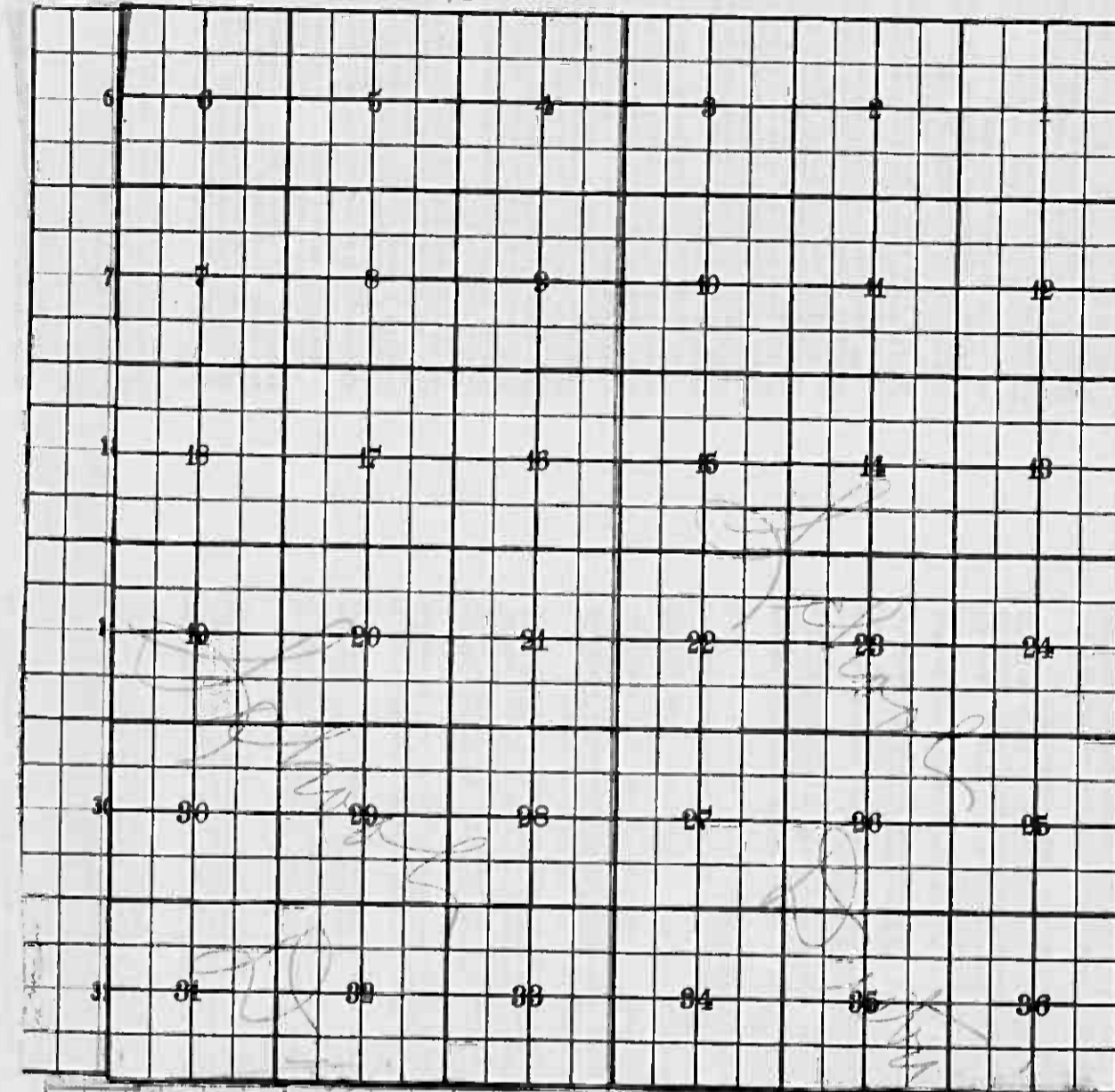

C# 27 W Row #483  
as of Sept. 6, 1957

Pt 29-15-2 W Row #116  
as of Sept. 6, 1957

Returns Showing Grain Received in or Handled by Elevators, Warehouses and Mills in the \_\_\_\_\_ of \_\_\_\_\_ in the County of \_\_\_\_\_ for the Year Ending May 1, 1958.

NAMES OF OWNERS	ADDRESS	Bushels of Wheat	Bushels of Soy Beans	Bushels of Flax	Total No. of Bushels of Wheat, Soy Beans and Flax	★ Tax of 1/4 Mill per Bushel		Bushels of Corn	Bushels of Barley	Bushels of Rye	Bushels of Oats	Bushels of Buckwheat	Bushels of all Other Grains	★ Tax of 1/4 Mill Per Bushel		★ Total Tax		REMARKS
						Dollars	Cts.							Dollars	Cts.	Dollars	Cts.	

Note ★ Assessors will not fill these Columns

Real Estate

**SUMMARY OF TAX COLLECTION**

Original Levy	- - - - -	\$ 26,865.74	
Additions	- - - - -	\$	
			\$ 26,865.74
Abatements	- - - - -	\$ 51.98	
			\$ 26,813.76

**COLLECTIONS**

March Settlement	- - - - -	\$ 6,652.76	
June Settlement	- - - - -	\$ 10,222.29	
November Settlement	- - - - -	\$ 7,371.98	
January Settlement	- - - - -	\$ 141.34	\$ 24,189.37
			\$
Over Collected	- - - - -	\$ 0.1	
Under Collected	- - - - -	\$ 0.1	
Delinquent	- - - - -	\$ 26,243.6	\$ 26,243.9
Total	- - - - -	\$ 26,813.76	

Real Estate

Personal

TABULAR SCHEDULE OF VALUATIONS,

LEVIED IN THE Town OF May

RATES AND TAXES

COUNTY OF CASS, STATE OF MINNESOTA

School District No.	VALUATION BY SCHOOL DISTRICTS				RATE OF STATE TAXES		RATE OF COUNTY TAXES										RATE OF TOWN TAXES										RATE OF		
	Agri-cultural Lands	Non-Agri-cultural Lands	Personal Property	Total Value of all Property except Money and Credits	Total Rate of State Tax	Total Rate of County Tax	Rev.	R. & B.	Welfare	Bonds and Int.	Other	Total Rate of County Tax	Rev.	R. & B.	Drag Tax	State Loan	Other	Total Rate of Town Tax	Local	Special	State Loan	Deficiency	Tuition	Transportation	Other	Total Rate of Sch'l Tax	Total Rate of all Taxes		
116	36908		15,242	52,150	5.90	29.54	15.	5.68			5.	3.40	109.17	5.	25.	1.		32.	1.	25.	59.	1.45	2.5	.65	34.14	123.74	270.81		
483	39360	3769	13649	55,290																					34.14	148.74	295.81		
	76,268	376	30,796	107,440	N.H. 6.52																				34.6	100.22	247.29		

Assessed Value	Rural	All Other	Personal Property	Total
Homestead	46,743			46,743
Non-Homestead	29,901		30,796	60,697
Total	76,644		30,796	107,440

LOCAL 1 MILL AND SPECIAL SCHOOL TAXES BY DISTRICTS										ALL OTHER TAXES		
Local 1 Mill	Special	State Loan	Def. Transp.	Tuition	Transportation	Other	FUNDS	Rate	Amounts			
10744	2743	02	335	108	155	79	State - Non-Homestead		395.89			
							State - Homestead		633.76			
							County Revenue		3173.78			
							County Road and Bridge		1611.60			
							County Welfare		5552.40			
							Bonds and Interest		370.60			
							Co. Murree		214.88			
							R & B Fed. Prop.		537.20			
							Town Revenue		537.20			
							Town Road and Bridge		2686.00			
							Town Drag		1074.4			
							Town State Loan		1074.4			
							Here		3438.08			
							School Local 1 Mill		1074.4			
							School Special		2743.02			
							School State Loan					
							Deficiency		335.108			
							Tuition					
							Transportation		155.79			
							C.O.		470.95			
							PERA		147.25			
							B. & Int.		3693.43			
									10,668.96			

County: R & B Bldg. 214.88  
 Agric. Res. 537.20  
 11,724.06

Total Taxes Real Estate 19,032.06  
 Pers. Prop. 7,833.68  
 Total 26,865.74

Total Number of Acres 33,836.55  
 State of Minnesota, }  
 COUNTY OF CASS }  
 I, L. C. Peterson, Auditor of said County and State aforesaid, do hereby certify that the foregoing is a true and correct Schedule, showing the valuation of all the taxable property, in the Town of May, in said County, the several rates of Taxation and Totals of the several Tax Funds levied thereon for the year A. D. 1958.  
 Witness my hand and official seal, this 16 day of January A. D. 1959.  
L. C. Peterson County Auditor.  
By Helen Wilken, Deputy



Real Estate



Assessment Roll and Tax List of Real Property in the Town of May, Minnesota

Indicate Type of Property: R-Residential, C-Commercial, I-Industrial, U-Utility, F-Farm, L-Lakeshore, T-Timber, M-Mineral

Cass County, Minnesota, for Taxes for the Year 1958.

Real Estate 133-31

Table with columns: IN WHOSE NAME ASSESSED, TO WHOM TRANSFERRED, SUBDIVISION, TRUE AND FULL VALUATIONS, ASSESSED VALUATIONS, and FINAL EQUALIZED VALUR. Includes handwritten entries for George H. & Ruth E. Hix, Ernest Axelberg, and others.

Table with columns: VALUATIONS BY SCHOOL DISTRICTS AS EQUALIZED BY DEPARTMENT OF TAXATION, TAXES, PAID, WHEN PAID, and REMARKS. Includes handwritten entries for tax amounts and payment dates.

133-31

Personal



Assessment Roll and Tax List of Real Property in the County of May

\* Indicate Type of Property: R-Residential, C-Commercial, I-Industrial, U-Utility, F-Farm, L-Lakeshore, T-Timber, M-M...

Cass County, Minnesota, for Taxes for the Year 1958.

Table with columns: IN WHOSE NAME ASSESSED, TO WHOM TRANSFERRED, DESCRIPTION OF PROPERTY, TRUE AND FULL VALUATIONS, ASSESSED VALUATIONS, VALUATIONS BY SCHOOL DISTRICTS, TAXES, PAID, WHEN PAID, etc. Includes handwritten entries for Carl J. & Hazel D. Fox and Celestine L. Harper.





Assessment Roll and Tax List of Real Property in the Town of May

Cass County, Minnesota, for Taxes for the Year 1958.

Table with columns: IN WHOSE NAME ASSESSED, TO WHOM TRANSFERRED, DESCRIPTION OF PROPERTY, TRUE AND FULL VALUATIONS, ASSESSED VALUATIONS, VALUATIONS BY SCHOOL DISTRICTS AS EQUALIZED BY DEPARTMENT OF TAXATION, TAXES, PAID, WHEN PAID, etc.

Assessment Roll and Tax List of Real Property in the Down of May

Cass County, Minnesota, for Taxes for the Year 1958.

\* Indicate Type of Property: R-Residential, C-Commercial, I-Industrial, U-Utility, F-Farm, L-Lakeshore, T-Timber, M-Mineral

Table with columns for IN WHOSE NAME ASSESSED, TO WHOM TRANSFERRED, DESCRIPTION OF PROPERTY, TRUE AND FULL VALUATIONS, ASSESSED VALUATIONS, VALUATIONS BY SCHOOL DISTRICTS, and TAXES. Includes handwritten entries for various lots and owners like Grace & Clarence Barnes, George F. & Adeline Peterson, and others.

[See 6, continued on next page]

Real Estate

Personal



Assessment Roll and Tax List of Real Property in the Down of May

Indicate Type of Property: R-Residential, C-Commercial, I-Industrial, U-Utility, F-Farm, L-Lakeshore, T-Timber, M-Mineral

Cass County, Minnesota, for Taxes for the Year 1958.

Table with columns for Property Description, Valuations (True and Full, Assessed), Taxes (Total, Sold for), and Payment Status. Includes handwritten entries for owners like Peter & Christine Sampson and various lot descriptions.



Assessment Roll and Tax List of Real Property in the Town of May, Minnesota

Indicate Type of Property: R-Residential, C-Commercial, I-Industrial, U-Utility, F-Farm, L-Lakeshore, T-Timber, M-Mineral

Table with columns: IN WHOSE NAME ASSESSED, TO WHOM TRANSFERRED, DESCRIPTION OF PROPERTY, TRUE AND FULL VALUATIONS, ASSESSED VALUATIONS, and FINAL EQUALIZED VALUE.

Cass County, Minnesota, for Taxes for the Year 1958.

Table with columns: SOLD FOR TAXES, VALUATIONS BY SCHOOL DISTRICTS AS EQUALIZED BY DEPARTMENT OF TAXATION, SPECIAL TAXES, TOTAL TAXES, PAID, WHEN PAID, Number of Receipt, March Settlement 1959, June Settlement 1959, Penalty, November Settlement 1959, Penalty, Collections to First Monday in January 1960, Penalty, Delinquent on First Monday in January 1960, Total Delinquent Tax and Penalty, REMARKS.







Assessment Roll and Tax List of Real Property in the Town of May of May

Cass County, Minnesota, for Taxes for the Year 1958.

Table with columns: IN WHOSE NAME ASSESSED, TO WHOM TRANSFERRED, DESCRIPTION OF PROPERTY, TRUE AND FULL VALUATIONS, ASSESSED VALUATIONS, VALUATIONS BY SCHOOL DISTRICTS AS EQUALIZED BY DEPARTMENT OF TAXATION, TAXES, PAID, WHEN PAID, SPECIAL TAXES, TOTAL TAXES, and REMARKS. Includes handwritten entries for names like Edna Knight Topp and Bert W. + Delphine Luine.

Assessment Roll and Tax List of Real Property in the Down of May

Cass County, Minnesota, for Taxes for the Year 1958.

Form 300... Indicate Type of Property: R-Residential, C-Commercial, I-Industrial, U-Utility, F-Farm, L-Lakeshore, T-Timber, M-Mineral

Table with columns: IN WHOSE NAME ASSESSED, TO WHOM TRANSFERRED, DESCRIPTION OF PROPERTY (SUBDIVISION, Sec. of Lot, Town or Block, Rng., Number of Acres of Land), TRUE AND FULL VALUATIONS (LAND, BUILDINGS, MACHINERY, TOTAL), ASSESSED VALUATIONS (RURAL, ALL OTHER, MACHINERY, TOTAL ASSESSED VALUE), FINANCED EQUALIZED VALUE.

State of Minnesota  
E.P. Sullivan The Northwest Paper Co  
Geo. N. & Grace Wilson

State of Minnesota  
Cecelia Anderson  
State of Minnesota

State of Minnesota  
Cecelia Anderson  
" "

Marvin R. Oliphant  
Arthur T. Betto  
Jane Bergman  
Arthur T. Betto  
Ole Hauge

Table with columns: VALUATIONS BY SCHOOL DISTRICTS AS EQUALIZED BY DEPARTMENT OF TAXATION (District No., Rate, etc.), Tax Including State Homestead, State Tax on Non-Homestead, SPECIAL TAXES, TOTAL TAXES, PAID, WHEN PAID, Number of Receipt, March Settlement 1959, June Settlement 1959, Penalty, November Settlement 1959, Penalty, Collections to First Monday in January 1960, Penalty, Delinquent on First Monday in January 1960, Total Delinquent Tax and Penalty, REMARKS.

1  
70  
66  
80

2  
56

12  
13  
14

16  
17  
18  
19  
20

56  
216  
272  
546  
33  
579  
249  
851

PAID IN FULL MAY 20 1959  
Balance Paid OCT 28 1959  
Part Paid MAY 29 1959  
Balance Paid OCT 28 1959  
Part Paid MAY 29 1959

2nd HALF PAID OCT 28 1959  
1st HALF PAID MAY 18 1959

2nd HALF PAID OCT 20 1959  
1st HALF PAID MAY 18 1959  
2nd HALF PAID OCT 20 1959  
1st HALF PAID MAY 18 1959

PAID IN FULL MAY 14 1959  
PAID IN FULL MAY 14 1959  
PAID IN FULL MAY 13 1959  
PAID IN FULL MAY 14 1959  
2nd HALF PAID OCT 21 1959  
1st HALF PAID MAY 29 1959

23046  
164  
23210  
19186  
5024

134-3

Personal

Assessment Roll and Tax List of Real Property in the Down of May

Cass County, Minnesota, for Taxes for the Year 1958.

Form 303, 1-15-58, Minnesota Department of Taxation. Indicate Type of Property: R-Residential, C-Commercial, I-Industrial, U-Utility, F-Farm, L-Lakeshore, T-Timber, M-Mineral

Table with columns: IN WHOSE NAME ASSESSED, TO WHOM TRANSFERRED, DESCRIPTION OF PROPERTY, TRUE AND FULL VALUATIONS, ASSESSED VALUATIONS, VALUATIONS BY SCHOOL DISTRICTS AS EQUALIZED BY DEPARTMENT OF TAXATION, TAXES, PAID, WHEN PAID, etc.

Real Estate

134-21

Personal

Assessment Roll and Tax List of Real Property in the Down of May, Cass County, Minnesota, for Taxes for the Year 1958.

Indicate Type of Property: R-Residential, C-Commercial, I-Industrial, U-Utility, F-Farm, L-Lakeshore, T-Timber, M-Mineral

Table with columns: IN WHOSE NAME ASSESSED, TO WHOM TRANSFERRED, DESCRIPTION OF PROPERTY, TRUE AND FULL VALUATIONS, ASSESSED VALUATIONS, VALUATIONS BY SCHOOL DISTRICTS AS EQUALIZED BY DEPARTMENT OF TAXATION, TAXES, PAID, WHEN PAID, etc. Includes handwritten entries for names like Pete Laalswyk, Leslie & Leslie Carlson, and John H & Edith M Jacobs.



Assessment Roll and Tax List of Real Property in the Town of May, Minnesota

Cass County, Minnesota, for Taxes for the Year 1958.

Table with columns: IN WHOSE NAME ASSESSED, TO WHOM TRANSFERRED, DESCRIPTION OF PROPERTY, TRUE AND FULL VALUATIONS, ASSESSED VALUATIONS, VALUATIONS BY SCHOOL DISTRICTS AS EQUALIZED BY DEPARTMENT OF TAXATION, TAXES, PAID, WHEN PAID, etc.

Real Estate

Personal





Assessment Roll and Tax List of Real Property in the

*Down* of *Map*

Indicate Type of Property: R-Residential, C-Commercial, I-Industrial, U-Utility, F-Farm, L-Lakeshore, T-Timber, M-Mineral

Table with columns for Description of Property, True and Full Valuations, Assessed Valuations, and Final Equalized Value. Includes handwritten entries for 'John A. Pogreba' and 'Raymond L. Grace & Muller'.

Cass County, Minnesota, for Taxes for the Year 1958.

Table for tax payments with columns for Valuations by School Districts, Sold for Taxes, Paid, When Paid, Number of Receipt, March Settlement, June Settlement, Penalty, Collections to First Monday, Delinquent on First Monday, Total Delinquent Tax and Penalty, and Remarks.







Assessment Roll and Tax List of Real Property in the Town of May, Cass County, Minnesota, for Taxes for the Year 1958.

Cass County, Minnesota, for Taxes for the Year 1958.

Table with columns: IN WHOSE NAME ASSESSED, TO WHOM TRANSFERRED, DESCRIPTION OF PROPERTY, TRUE AND FULL VALUATIONS, ASSESSED VALUATIONS, VALUATIONS BY SCHOOL DISTRICTS AS EQUALIZED BY DEPARTMENT OF TAXATION, TAXES, PAID, WHEN PAID, Number of Receipt, March Settlement, June Settlement, November Settlement, Collections to First Monday in January 1960, Delinquent on First Monday in January 1960, Total Delinquent Tax and Penalty, REMARKS.













Assessment Roll and Tax List of Real Property in the Down of May

Indicate Type of Property: R-Residential, C-Commercial, I-Industrial, U-Utility, F-Farm, L-Lakeshore, T-Timber, M-Mineral

Table with columns: IN WHOSE NAME ASSESSED, TO WHOM TRANSFERRED, DESCRIPTION OF PROPERTY, TRUE AND FULL VALUATIONS, ASSESSED VALUATIONS, FINAL EQUALIZED VALUE. Includes handwritten entries for D.P. Rudbeck, Trustee D. and C.A. Larson, Walblom.

Cass County, Minnesota, for Taxes for the Year 1958.

Table with columns: SOLD FOR TAXES, VALUATIONS BY SCHOOL DISTRICTS AS EQUALIZED BY DEPARTMENT OF TAXATION, Tax including State Homestead, SPECIAL TAXES, TOTAL TAXES, PAID, WHEN PAID, Number of Receipt, March Settlement, June Settlement, November Settlement, Collections to First Monday in January 1960, Delinquent on First Monday in January 1960, Total Delinquent Tax and Penalty, REMARKS. Includes handwritten notes like '1st HALF PAID MAY 29 1959'.

Assessment Roll and Tax List of Real Property in the Town of May

Cass County, Minnesota, for Taxes for the Year 1958.

Indicate Type of Property: R-Residential, C-Commercial, I-Industrial, U-Utility, F-Farm, L-Lakeshore, T-Timber, M-Mineral

Table with columns: IN WHOSE NAME ASSESSED, TO WHOM TRANSFERRED, DESCRIPTION OF PROPERTY, TRUE AND FULL VALUATIONS, ASSESSED VALUATIONS, and FINAL EQUALIZED VALUE.

Table with columns: SOLD FOR TAXES, VALUATIONS BY SCHOOL DISTRICTS AS EQUALIZED BY DEPARTMENT OF TAXATION, SPECIAL TAXES, TOTAL TAXES, PAID, WHEN PAID, Number of Receipt, March Settlement, June Settlement, Penalty, November Settlement, Penalty, Collections to First Monday in January 1960, Delinquent on First Monday in January 1960, Total Delinquent Tax and Penalty, and REMARKS.





Assessment Roll and Tax List of Real Property in the Town of May

Cass County, Minnesota, for Taxes for the Year 1958.

Indicate Type of Property: R-Residential, C-Commercial, I-Industrial, U-Utility, F-Farm, L-Lakeshore, T-Timber, M-Mineral

Table with columns: IN WHOSE NAME ASSESSED, TO WHOM TRANSFERRED, DESCRIPTION OF PROPERTY, TRUE AND FULL VALUATIONS, ASSESSED VALUATIONS, VALUATIONS BY SCHOOL DISTRICTS AS EQUALIZED BY DEPARTMENT OF TAXATION, TAXES, PAID, WHEN PAID, Number of Receipt, March Settlement 1959, June Settlement 1959, November Settlement 1959, Collections to First Monday in January 1960, Delinquent on First Monday in January 1960, Total Delinquent Tax and Penalty, REMARKS.

Assessment Roll and Tax List of Real Property in the *Down* of *May*, Cass County, Minnesota, for Taxes for the Year 1958.

\* Indicate Type of Property: R-Residential, C-Commercial, I-Industrial, U-Utility, F-Farm, L-Lakeshore, T-Timber, M-Mineral

Main data table with columns for 'IN WHOSE NAME ASSESSED', 'TO WHOM, TRANSFERRED', 'DESCRIPTION OF PROPERTY', 'TRUE AND FULL VALUATIONS', 'ASSESSED VALUATIONS', 'VALUATIONS BY SCHOOL DISTRICTS AS EQUALIZED BY DEPARTMENT OF TAXATION', 'SOLD FOR TAXES', and 'REMARKS'. Includes handwritten entries for William Kasper, Otis Gay, and Carl A. Lorber.











Assessment Roll and Tax List of Real Property in the Town of May

Indicate Type of Property: R-Residential, C-Commercial, I-Industrial, U-Utility, F-Farm, L-Lakeshore, T-Timber, M-Mineral

Table with columns: IN WHOSE NAME ASSESSED, TO WHOM TRANSFERRED, SUBDIVISION, TRUE AND FULL VALUATIONS (LAND, BUILDINGS, MACHINERY, TOTAL), ASSESSED VALUATIONS (RURAL, ALL OTHER, MACHINERY, TOTAL ASSESSED), FINAL EQUALIZED VALUE.

Cass County, Minnesota, for Taxes for the Year 1958.

Table with columns: SOLD FOR TAXES, VALUATIONS BY SCHOOL DISTRICTS AS EQUALIZED BY DEPARTMENT OF TAXATION, SPECIAL TAXES, TOTAL TAXES, PAID, WHEN PAID, Number of Receipt, March Settlement, June Settlement, November Settlement, Penalty, Collections to First Monday in January 1960, Delinquent on First Monday in January 1960, Total Delinquent Tax and Penalty, REMARKS.

Assessment Roll and Tax List of Real Property in the Town of May of May

Indicate Type of Property: R-Residential, C-Commercial, I-Industrial, U-Utility, F-Farm, L-Lakeshore, T-Timber, M-Mineral

Cass County, Minnesota, for Taxes for the Year 1958.

Table with columns: IN WHOSE NAME ASSESSED, TO WHOM TRANSFERRED, DESCRIPTION OF PROPERTY, TRUE AND FULL VALUATIONS, ASSESSED VALUATIONS, VALUATIONS BY SCHOOL DISTRICTS AS EQUALIZED BY DEPARTMENT OF TAXATION, TAXES, PAID, WHEN PAID, Number of Receipt, March Settlement 1959, June Settlement 1959, Penalty, November Settlement 1959, Penalty, Collections to First Monday in January 1960, Penalty, Delinquent on First Monday in January 1960, Total Delinquent Tax and Penalty, REMARKS.

Assessment Roll and Tax List of Real Property in the Town of Down of May

Indicate Type of Property: R-Residential, C-Commercial, I-Industrial, U-Utility, F-Farm, L-Lakeshore, T-Timber, M-Mineral

Cass County, Minnesota, for Taxes for the Year 1958.

Table with columns for: IN WHOSE NAME ASSESSED, TO WHOM TRANSFERRED, DESCRIPTION OF PROPERTY, TRUE AND FULL VALUATIONS, ASSESSED VALUATIONS, VALUATIONS BY SCHOOL DISTRICTS, SPECIAL TAXES, TOTAL TAXES, PAID, WHEN PAID, Number of Receipt, March Settlement 1959, June Settlement 1959, Penalty, November Settlement 1959, Penalty, Collections to First Monday in January 1960, Penalty, Delinquent on First Monday in January 1960, Total Delinquent Tax and Penalty, REMARKS.

PERSONAL





Assessment Roll and Tax List of Real Property in the Town of May

Cass County, Minnesota, for Taxes for the Year 1958.

Table with columns for Assessed Valuations, School Districts, and Taxes. Rows include property details for Park A. & Alice G. Lorange, Harvey & Marie Schmalz, and George H. & Grace Appelsheimer.



Assessment Roll and Tax List of Real Property in the Town of May

Cass County, Minnesota, for Taxes for the Year 1958.

Table with columns: IN WHOSE NAME ASSESSED, TO WHOM TRANSFERRED, DESCRIPTION OF PROPERTY, TRUE AND FULL VALUATIONS, ASSESSED VALUATIONS, VALUATIONS BY SCHOOL DISTRICTS AS EQUALIZED BY DEPARTMENT OF TAXATION, SOLD FOR TAXES, PAID, WHEN PAID, Number of Receipt, March Settlement 1959, June Settlement 1959, Penalty, November Settlement 1959, Penalty, Collections to First Monday in January 1960, Penalty, Delinquent on First Monday in January 1960, Total Delinquent Tax and Penalty, REMARKS.

Assessment Roll and Tax List of Real Property in the Town of May, Cass County, Minnesota, for Taxes for the Year 1958.

Cass County, Minnesota, for Taxes for the Year 1958.

Indicate Type of Property: R-Residential, C-Commercial, I-Industrial, U-Utility, F-Farm, L-Lakeshore, T-Timber, M-Mineral

Table with columns: IN WHOSE NAME ASSESSED, TO WHOM TRANSFERRED, DESCRIPTION OF PROPERTY, TRUE AND FULL VALUATIONS, ASSESSED VALUATIONS, VALUATIONS BY SCHOOL DISTRICTS AS EQUALIZED BY DEPARTMENT OF TAXATION, TAXES, PAID, WHEN PAID, Number of Receipt, March Settlement 1959, June Settlement 1959, November Settlement 1959, Collections to First Monday in January 1960, Delinquent on First Monday in January 1960, Total Delinquent Tax and Penalty, REMARKS.





Assessment Roll and Tax List of Real Property in the Town of May, of May

Indicate Type of Property: R-Residential, C-Commercial, I-Industrial, U-Utility, F-Farm, L-Lakeshore, T-Timber, M-Mineral

Table with columns: IN WHOSE NAME ASSESSED, TO WHOM TRANSFERRED, DESCRIPTION OF PROPERTY, TRUE AND FULL VALUATIONS, ASSESSED VALUATIONS, FINAL EQUALIZED VALUE. Includes entries for Elgen, Kober, Lehlar, and Korner.

Cass County, Minnesota, for Taxes for the Year 1958.

Table with columns: #1 VALUATIONS BY SCHOOL DISTRICTS AS EQUALIZED BY DEPARTMENT OF TAXATION, SOLD FOR TAXES, SPECIAL TAXES, TOTAL TAXES, PAID, WHEN PAID, Number of Receipt, March Settlement 1959, June Settlement 1959, Penalty, November Settlement 1959, Collections to First Monday in January 1960, Delinquent on First Monday in January 1960, Total Delinquent Tax and Penalty, REMARKS.

Assessment Roll and Tax List of Real Property in the Town of... of May...

\* Indicate Type of Property: R-Residential, C-Commercial, I-Industrial, U-Utility, F-Farm, L-Lakeshore, T-Timber, M-Mineral

Cass County, Minnesota, for Taxes for the Year 1958.

Main table with columns for property description, valuations, taxes, and payments. Includes handwritten entries for names like Ferdinand Martin and James B. Shirley.

Personal





















Assessment Roll and Tax List of Real Property in the Town of May

Cass County, Minnesota, for Taxes for the Year 1958.

Table with columns: IN WHOSE NAME ASSESSED, TO WHOM TRANSFERRED, DESCRIPTION OF PROPERTY, TRUE AND FULL VALUATIONS, ASSESSED VALUATIONS, VALUATIONS BY SCHOOL DISTRICTS AS EQUALIZED BY DEPARTMENT OF TAXATION, TAXES, PAID, WHEN PAID, Number of Receipt, March Settlement 1959, June Settlement 1959, November Settlement 1959, Collections to First Monday in January 1960, Delinquent on First Monday in January 1960, Total Delinquent Tax and Penalty, REMARKS.

184-3

Personal

Assessment Roll and Tax List of Real Property in the *Down* *of May*

\* Indicate Type of Property: R-Residential, C-Commercial, I-Industrial, U-Utility, F-Farm, L-Lakeshore, T-Timber, M-Mineral

Cass County, Minnesota, for Taxes for the Year 1958.

Table with columns for IN WHOSE NAME ASSESSED, TO WHOM TRANSFERRED, DESCRIPTION OF PROPERTY, TRUE AND FULL VALUATIONS, ASSESSED VALUATIONS (RURAL, ALL OTHER), VALUATIONS BY SCHOOL DISTRICTS AS EQUALIZED BY DEPARTMENT OF TAXATION, SOLD FOR TAXES, SPECIAL TAXES, TOTAL TAXES, PAID, WHEN PAID, and REMARKS. Includes handwritten entries for property owners like Edward & Jadie Ackerson and Edward L. Schmit.

Assessment Roll and Tax List of Real Property in the Town of Map

Indicate Type of Property: R-Residential, C-Commercial, I-Industrial, U-Utility, F-Farm, L-Lakeshore, T-Timber, M-Mineral

Table with columns: IN WHOSE NAME ASSESSED, TO WHOM TRANSFERRED, DESCRIPTION OF PROPERTY, TRUE AND FULL VALUATIONS, ASSESSED VALUATIONS, FINAL EQUALIZED VALUE. Includes handwritten entries for Alfred Barnett, Edward Acterson, Jack A + Stella M Barnett, etc.

Cass County, Minnesota, for Taxes for the Year 1958.

Table with columns: VALUATIONS BY SCHOOL DISTRICTS AS EQUALIZED BY DEPARTMENT OF TAXATION, TAXES, PAID, WHEN PAID, Number of Receipt, March Settlement 1959, June Settlement 1959, Penalty, Collections to First Monday in January 1960, Delinquent on First Monday in January 1960, Total Delinquent Tax and Penalty, REMARKS. Includes handwritten entries for tax amounts and payment dates.



