

ASSESSMENT & TAX LIST

Hiram

1953

Assessment of

COLLECTIONS OF TAXES OF 1953

Town OF Hiram, CASS COUNTY, MINNESOTA

FUNDS	MARCH SETTLEMENT 1953	JUNE SETTLEMENT 1953	NOV. SETTLEMENT 1953	Amount Collected from Nov. 1952 to First Monday in Jan. 1953	REDUCTIONS	Total Reductions and collected	BALANCE UNCOLLECTED	ADDITIONS	Total Uncollected to First Monday in January, 1953
State - Non-Homestead, State - Homestead,	4706 5660	18665 19575	2741 5951	361 501					
County Revenue, County Road and Bridge, County Welfare, County Bond and Interest, <i>A. & B. sinking</i>	30339 17046 54161 11460 2144	104919 58947 187297 39632 7415	31899 17922 56945 12050 2254	2687 1510 4798 1015 190					
Town Revenue, Town Road and Bridge, Town Drag, Town State Loan,	5360 16510 1072	18537 57094 3707	5636 17358 1127	475 1462 95					
School Local 1 Mill, School Special, School State Loan, Deficiency Tuition Transportation C.O.	1072 37359 42883 2144 16081	3708 108543 148295 7414 55611	1127 30764 45087 2254 16907	95 2901 3798 190 1424					
	247997	835359	250022	21502					

	SCHOOL DISTRICT NO.	LOCAL 1 MILL	SPECIAL	STATE LOAN	Transport	Deficiency	C. O.	TOTALS
MARCH SETTLEMENT	<i>A Un</i> <i>Na Un</i>	276 796	5524 31835		552 1592	11049 31834	4143 11738	21544 77995
	Totals	1072	37359		2144	42883	16081	99539
JUNE SETTLEMENT	<i>A Un</i> <i>Na Un</i>	1988 1720	37753 68790		3975 3439	79503 68790	29815 25796	155036 168535
	Totals	3708	108543		7414	148295	55611	323571
NOVEMBER SETTLEMENT	<i>A Un</i> <i>Na Un</i>	716 411	14324 16440		1432 822	28649 16438	10743 6164	55864 40275
	Totals	1127	30764		2254	45087	16907	96139
NOVEMBER to JANUARY	<i>A Un</i> <i>Na Un</i>	45 50	899 2002		90 100	1798 2000	674 750	3506 4902
	Totals	95	2901		190	3798	1424	8408
ADDITIONS	School District No.							
	Totals							
REDUCTIONS	School District No.							
	Totals							

1
2
3
4
5
6
7
8

NAME OF OWNER

Forest Lakes
Embarras
Long Beach
Shady Shores
Pine Beach
Plainview Beach
Re-arrangement Lot
White Pine Beach

Assessment Roll and Tax List of Real Property in the Town of Linn of Linn

Cass County, Minnesota, for Taxes for the Year 1953.

IN WHOSE NAME ASSESSED	TO WHOM TRANSFERRED	DESCRIPTION OF PROPERTY				TRUE AND FULL VALUATIONS										FINAL EQUALIZED VALUE		
		SUBDIVISION	Sec. or Lot	Town or Block	Rng.	Number of Acres of Land	Machinery Permanently Attached to Real Estate	LAND Exclusive of Structures and Improvements	BUILDINGS and Other Structures	TOTAL True and Full Value	RURAL		ALL OTHER		Machinery Permanently Attached to Real Estate		TOTAL ASSESSED VALUE	Total Assessed Value as Equalized by the Board of Review
											Acres	100ths	Homestead Up to \$4,000 20%	Over \$4,000 and Non-Homestead 33 1/3%				
State of Minnesota		1				18 1/4 31												
John Carlson		2				4.08												
William H & Edna L. Katz		3				3.98												
State of Minnesota		4																
Leo C. & Selma R. Brown		5				4.08												
Robert J. Cooke		6				4.14												
Edward O. Schaffer & Jim Armstrong		7				4.17												
Charles Kuback		8				4.19												
Ruth Swenson		9				8.21												
Harold & Alice M. Kostka		10				3.95												
Raymond M. Young		11				4.00												
Jerome F. & Patricia A. Katz		12				3.92												
State of Minnesota		13																
State of Minnesota		14																
Blanche H. Stokes		15				3.94												
State of Minnesota		16																
State of Minnesota		17																
State of Minnesota		18																
State of Minnesota (cont. to Mrs. Beulah Gray)		19																
		20																

SOLD FOR TAXES	VARIATIONS BY SCHOOL DISTRICTS AS EQUALIZED BY DEPARTMENT OF TAXATION						Tax including State Homestead	State Tax on Non-Homestead	SPECIAL TAXES	TOTAL TAXES	PAID	WHEN PAID	Number of Receipt	March Settlement 1954	June Settlement 1954	November Settlement 1954	Penalty	Collections to First Monday in January 1955	Penalty	Delinquent on First Monday in January 1955	Total Delinquent Tax and Penalty	REMARKS
	District No.	District No.	District No.	District No.	District No.	District No.																
	Rate	Rate	Rate	Rate	Rate	Rate																
1																						
2						17	3.60	08	3.68		PAID IN FULL APR 30 1954	5790		3.68								
3						56	11.88	26	12.14		PAID IN FULL MAY 15 1954	6309		12.14								
4																						
5	SOLD FOR TAXES					56	11.88	26	12.14													
6						17	3.60	08	3.68		PAID IN FULL OCT 18 1954	13794					3.68	13		12.14		
7						45	9.54	20	9.74													
8						19	4.02		4.02		PAID IN FULL MAY 15 1954	6313		4.02						9.74	10.71	
9						108	22.90	50	23.40		Penalty DEC 27 1954	16214										
10	SOLD FOR TAXES					17	3.60	08	3.68		Balance Paid DEC 4 1954	15368		12.40						11.00	9.74	
11						45	9.54	20	9.74													
12						45	9.54	20	9.74		PAID IN FULL MAY 31 1954	9228		9.74						9.74	10.71	
13																						
14																						
15						45	9.54	20	9.74		PAID IN FULL FEB 27 1954	3396		9.74								
16																						
17																						
18																						
19	SOLD FOR TAXES					36	7.64		7.64		PAID IN FULL OCT 30 1954	15789										
20																						

Long Beach Shady Shores Pine Beach Plainview Beach Re-arrangement Lot 16

checked 3-16-54

1650'

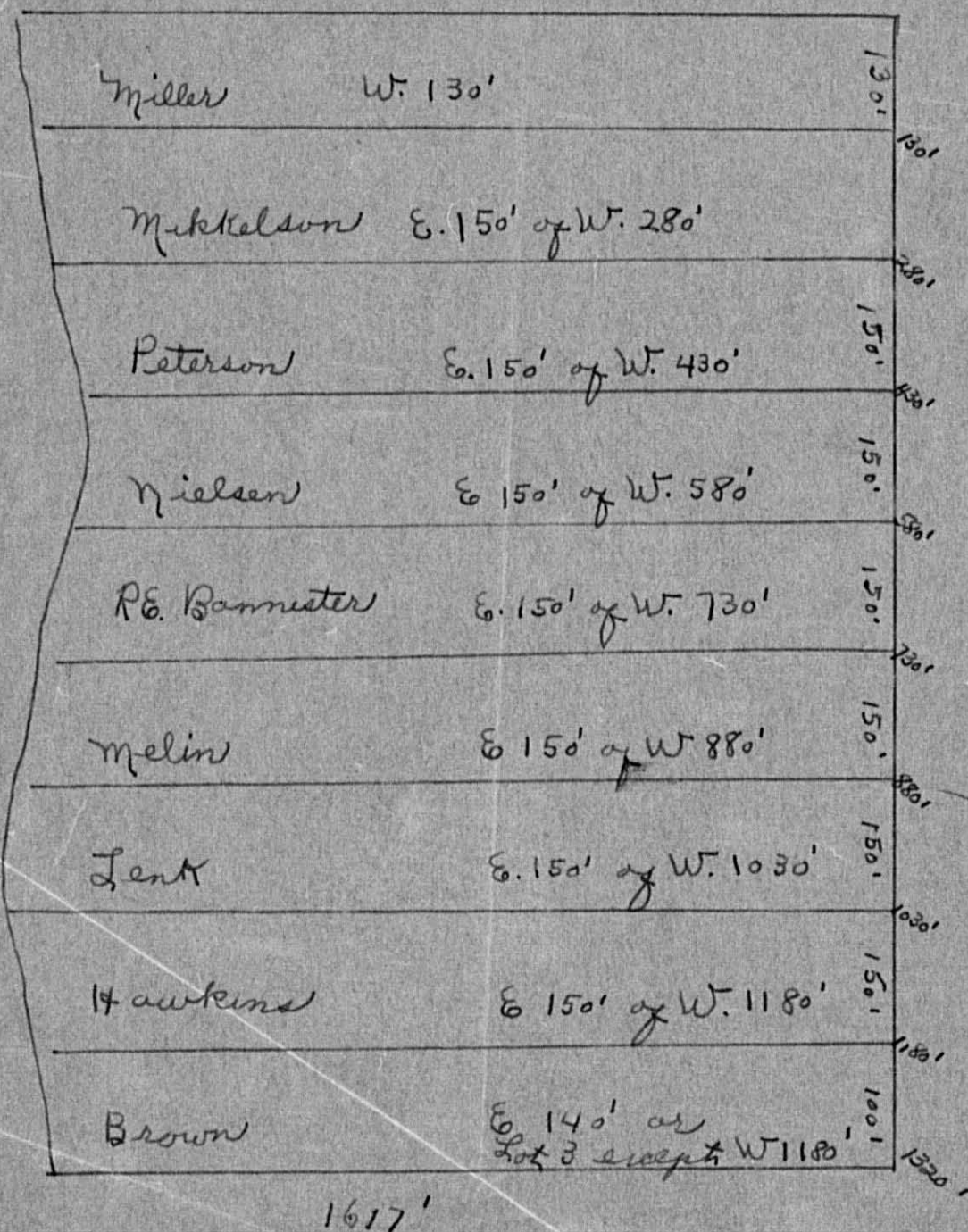

Lot 3 18-140-31

1617'

Checked 3-16-54

1584'

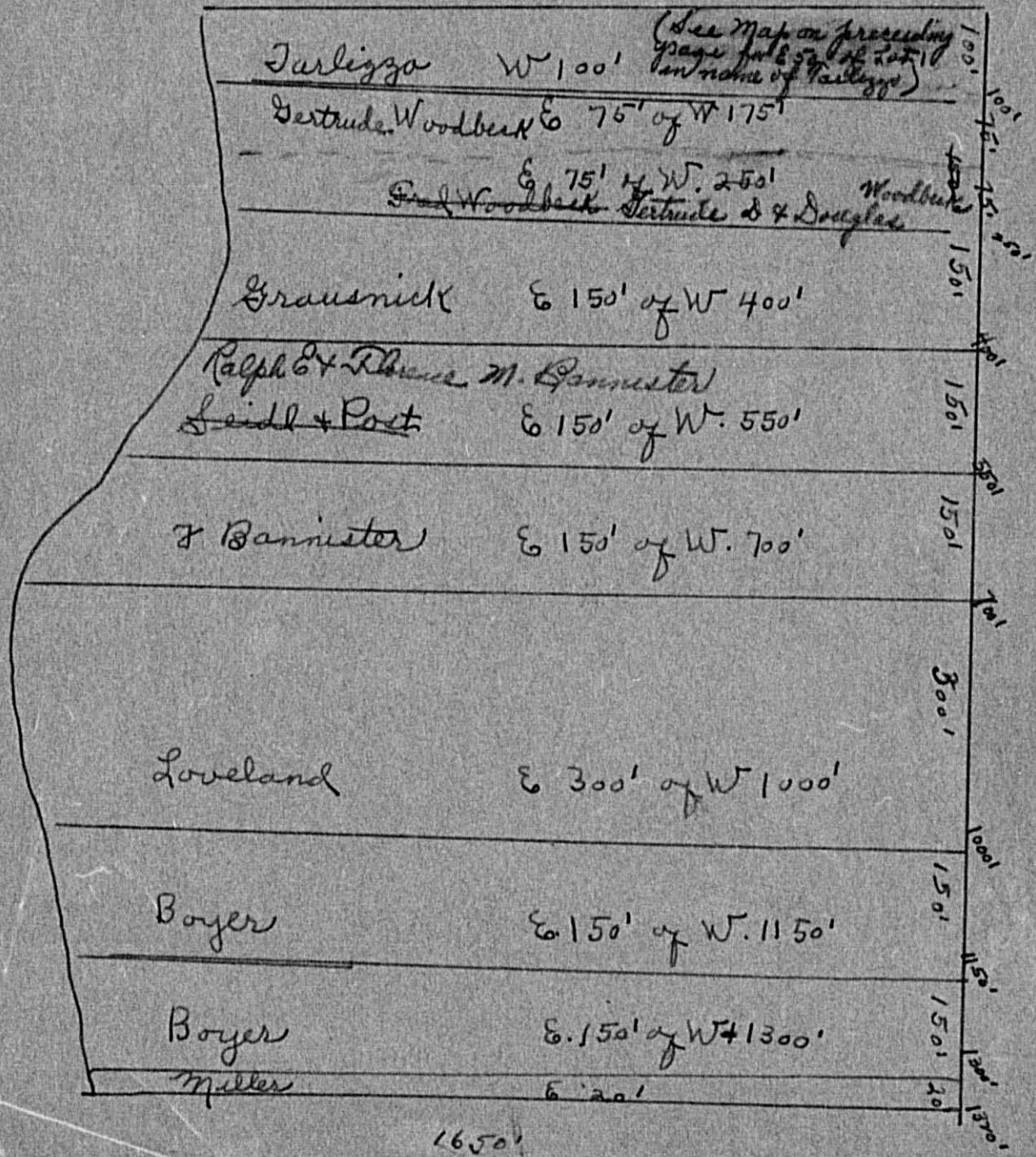

Lots 18-140-31

Jarliggo W 100' (See map on preceding page for E 50' of Lot 18 in name of Jarliggo)

Gertrude Woodbeck E 75' of W 175'

Gertrude Woodbeck E 75' of W 250'

Grausnick E 150' of W 400'

Ralph & Rhene M. Bannister
Leidl & Post E 150' of W 550'

F Bannister E 150' of W 700'

Loveland E 300' of W 1000'

Boyer E 150' of W 1150'

Boyer E 150' of W 1300'

Miller E 200'

1650'

Assessment Roll and Tax List of Real Property in the Town of Loran of St. Louis

Cass County, Minnesota, for Taxes for the Year 1953.

IN WHOSE NAME ASSESSED	TO WHOM TRANSFERRED	DESCRIPTION OF PROPERTY				TRUE AND FULL VALUATIONS										FINAL EQUALIZED VALUE			
		SUBDIVISION	Sec. or Lot	Town or Block	Rng.	Number of Acres of Land	Machinery Permanently Attached to Real Estate	LAND Exclusive of Structures and Improvements	BUILDINGS and Other Structures	TOTAL True and Full Value	RURAL		ALL OTHER				Machinery Permanently Attached to Real Estate	TOTAL ASSESSED VALUE	Total Assessed Value as Equalized by the Board of Review
											Acres	100ths	Homestead Up to \$4,000 20%	Over \$4,000 and Non-Homestead 33 1/3%	Homestead Up to \$4,000 25%				
State of Minnesota		NE 1/4 of NE 1/4		20 140 31															
State of Minnesota		NW 1/4 of NE 1/4																	
Byron Selves		SW 1/4 of NE 1/4			40														
		SE 1/4 of NE 1/4																	
Byron Selves		NE 1/4 of NW 1/4			40														
Arnold F. Kading	Northwest Paper Co.	NW 1/4 of NW 1/4			40														
		SW 1/4 of NW 1/4			40														
Byron Selves		SE 1/4 of NW 1/4			40														
Ralph A. & Lorraine S. Hoopman		NE 1/4 of SW 1/4			40														
"	"	NW 1/4 of SW 1/4			40														
"	"	SW 1/4 of SW 1/4			40														
"	"	SE 1/4 of SW 1/4			40														
State of Minnesota		NE 1/4 of SE 1/4																	
Byron Selves		NW 1/4 of SE 1/4			40														
State of Minnesota		SW 1/4 of SE 1/4																	
Arnold F. & Margaret B. Kading		SE 1/4 of SE 1/4			40														
					440														

SOLD FOR TAXES	VALUATIONS BY SCHOOL DISTRICTS AS EQUALIZED BY DEPARTMENT OF TAXATION						Tax including State Homestead	State Tax on Non-Homestead	SPECIAL TAXES	TOTAL TAXES	PAID	WHEN PAID	Number of Receipt	March Settlement 1954	June Settlement 1954	November Settlement 1954	Collections to First Monday in January 1955	Penalty	Delinquent on First Monday in January 1955	Total Delinquent Tax and Penalty	REMARKS
	District No.	District No.	District No.	District No.	District No.	District No.															
	Rate	Rate	Rate	Rate	Rate	Rate															
1																					
2																					
3																					
4																					
5																					
6																					
7																					
8																					
9																					
10																					
11																					
12																					
13																					
14																					
15																					
16																					
17																					
18																					
19																					
20																					

Long Beach, Shady Shores, Pine Beach, Plainview Beach, Re-arrangement Lot 19, White Pine Beach

Assessment Roll and Tax List of Real Property in the Down of Liram

Cass County, Minnesota, for Taxes for the Year 1953.

Form 5C (53) UNIFORM STATE REPORT, MINNESOTA

IN WHOSE NAME ASSESSED	TO WHOM TRANSFERRED	DESCRIPTION OF PROPERTY				TRUE AND FULL VALUATIONS				ASSESSED VALUATIONS					FINAL EQUALIZED VALUE			
		Subdivision	Sec. or Lot	Town or Block	Rng.	Number of Acres of Land	LAND Exclusive of Structures and Improvements	BUILDINGS and Other Structures	MACHINERY Permanently Attached to Real Estate	TOTAL True and Full Value	RURAL		ALL OTHER			MACHINERY Permanently Attached to Real Estate	TOTAL ASSESSED VALUE	Total Assessed Value as Equalized by the Board of Review
											Acres	100ths	Homestead Up to \$4,000 20%	Over \$4,000 and Non-Homestead 33 1/3%				
						Dollars	Dollars	Dollars	Dollars	Dollars	Dollars	Dollars	Dollars	Dollars	Dollars	Dollars		

Shanview Beach
(Part of Lot 1, Sec 15-140-31)

Joe Kelsch
 Helie M. & Agnes M. Brickner
 Geo. St. Clara B. Page
 Geo. S. Page
 William A. Fox
 W. H. Fox
 Martin & Gunvor Horn
 George Benish
 Oscar & Caroline Bakken
 " " " "

W

SOLD FOR TAXES	VALUATIONS BY SCHOOL DISTRICTS AS EQUALIZED BY DEPARTMENT OF TAXATION						Tax including State Homestead	State Tax on Non-Homestead	SPECIAL TAXES	TOTAL TAXES	PAID	WHEN PAID	Number of Receipt	March Settlement 1954	June Settlement 1954	Penalty	November Settlement 1954	Penalty	Collections to First Monday in January 1955	Penalty	Delinquent on First Monday in January 1955	Total Delinquent Tax and Penalty	REMARKS
	District No.	District No.	District No.	District No.	District No.	District No.																	
	Rate	Rate	Rate	Rate	Rate	Rate																	

H 288
632
420

21348 294

21642

20526

1116

White Pine Beach Shady Shores Long Beach
White Pine Beach
Plainview Beach

Shady Shores
Sunset
Sunset Beach
Carlton Beach
Peaceful Shores
Re-arrangement Lot 10
White Pine Beach

Assessment Roll and Tax List of Real Property in the Towns of Hiram

Cass County, Minnesota, for Taxes for the Year 1953.

Form 5C (53) BULLOCK-BAYNE COMPANY, MINNEAPOLIS

IN WHOSE NAME ASSESSED	TO WHOM TRANSFERRED	DESCRIPTION OF PROPERTY				TRUE AND FULL VALUATIONS				ASSESSED VALUATIONS					FINAL EQUALIZED VALUE			
		Subdivision	Sec. or Lot	Town or Block	Rng.	Number of Acres of Land	LAND Exclusive of Structures and Improvements	BUILDINGS and Other Structures	MACHINERY Permanently Attached to Real Estate	TOTAL True and Full Value	RURAL		ALL OTHER			MACHINERY Permanently Attached to Real Estate	TOTAL ASSESSED VALUE	Total Assessed Value as Equalized by the Board of Review
											Acres	100ths	Homestead Up to \$4,000 20%	Over \$4,000 and Non-Homestead 33 1/3%				
Claude E. Sheldon			1															
"			2															
"			3															
Harry R. Signe & Kneeland			4															
Clayton W. E. Shelton & Reed			5															
John W. Anthonson			6															
			7															
			8															
			9															
			10															
			11															
			12															
			13															
			14															
			15															
			16															
			17															
			18															
			19															
			20															

SOLD FOR TAXES	VALUATIONS BY SCHOOL DISTRICTS AS EQUALIZED BY DEPARTMENT OF TAXATION						Tax including State Homestead	State Tax on Non-Homestead	SPECIAL TAXES	TOTAL TAXES	PAID	WHEN PAID	Number of Receipt	March Settlement 1954	June Settlement 1954	Penalty	November Settlement 1954	Penalty	Collections to First Monday in January 1955	Penalty	Delinquent on First Monday in January 1955	Total Delinquent Tax and Penalty	REMARKS	
	District No.	District No.	District No.	District No.	District No.	District No.																		
	Rate	Rate	Rate	Rate	Rate	Rate																		
1																								
2																								
3																								
4																								
5																								
6																								
7																								
8																								
9																								
10																								
11																								
12																								
13																								
14																								
15																								
16																								
17																								
18																								
19																								
20																								

White Pine Beach Shady Shores Long Beach
White Pine Beach
Plainview Beach
Re-arrangement Lot 19
White Pine Beach

Emhurst
Riverside
Sunset Beach
Horton Beach
Peaceful Shores
Hawken Beach
Parkling

Assessment Roll and Tax List of Real Property in the Town of Hiram

Form 5C (53) (MAY 1954) MINN. STAT. ANN. § 260.01

IN WHOSE NAME ASSESSED	TO WHOM TRANSFERRED	DESCRIPTION OF PROPERTY					TRUE AND FULL VALUATIONS										FINAL EQUALIZED VALUE	
		Subdivision	Sec. of Lot	Town or Block	Rng.	Number of Acres of Land	LAND Exclusive of Structures and Improvements	BUILDINGS and Other Structures	MACHINERY Permanently Attached to Real Estate	TOTAL True and Full Value	RURAL		ALL OTHER		MACHINERY Permanently Attached to Real Estate	TOTAL ASSESSED VALUE		Total Assessed Value as Equalized by the Board of Review
											Acres	100ths	Homestead Up to \$4,000	Over \$4,000 and Non-Homestead				
Carl W. & Clara Johnson	Emma Dixon	Elmhurst	1															
"	"		2															
"	"		3															
Frank E. & Lotta H. Murray	"		4															
"	"		5															
"	"		6															
"	"		7															
N. A. & Emma G. Kiff	"		8															
"	"		9															
"	"		10															
"	"		11															
Arthur C. & Mildred F. Loeffl	"		12															
"	"		13															
Ruth W. Abrahamson	"		14															
"	"		15															
Ada & Leida Rausch	"		16															
"	"		17															
Mabel Bostrom	"		18															
"	"		19 less S. 10'															
Edwin & Willard Bostrom	"		S. 10' of 19															

Cass County, Minnesota, for Taxes for the Year 1953.

SOLD FOR TAXES	VALUATIONS BY SCHOOL DISTRICTS AS EQUALIZED BY DEPARTMENT OF TAXATION						Tax Including State Homestead	State Tax on Non-Homestead	SPECIAL TAXES	TOTAL TAXES	PAID	WHEN PAID	Number of Receipt	March Settlement 1954	June Settlement 1954	Penalty	November Settlement 1954	Penalty	Collections to First Monday in January 1955	Penalty	Delinquent on First Monday in January 1955	Total Delinquent Tax and Penalty	REMARKS
	District No.	District No.	District No.	District No.	District No.	District No.																	
	Rate	Rate	Rate	Rate	Rate	Rate																	
1																							
2																							
3																							
4																							
5																							
6																							
7																							
8																							
9																							
10																							
11																							
12																							
13																							
14																							
15																							
16																							
17																							
18																							
19																							
20																							

White Pine Beach, Shady Shores, Sun, Sunset Beach, Carlton Beach, Peaceful Shores, Hokenburg, Park, Re-arrangement Lot 19, White Pine Beach

Peaceful Shores, Hokenburg, Park, Re-arrangement Lot 19, White Pine Beach

