

ASSESSMENT & TAX LIST

Hiram

1943























NAME OF OWNER

Treasurer's Office, Cass County, Minnesota

RECEIVED this, the first Monday (being the 3<sup>rd</sup> day) of January,  
 A. D. 1944, of L. G. Peterson, Auditor of said County, Minnesota,  
 the Tax List of all Taxable Real and Personal Property in the Township  
 of Hiram in said County for the year A. D. 1943,  
 as specified above and amounting to six thousand three hundred  
eighty five  $\frac{74}{100}$  dollars.  
W. J. McKeown  
 County Treasurer.

Office of County Treasurer, Cass County, Minnesota

To L. G. Peterson, County Auditor:

Sir:—I herewith return to you the Tax List for the Township  
 of Hiram in said County for the year 1943, heretofore  
 received from you. I certify that I have compared the same with the duplicate receipts in  
 your office, and have written opposite the amount of each tax so receipted the words "First  
 Quarter Paid", "Second Quarter Paid", "Third Quarter Paid" or "Paid in full" as the  
 case may be, and the number of my receipt given in discharge of said tax, and each tract  
 or lot of real property against which the taxes remain unpaid is delinquent for said year.

Yours respectfully,  
W. J. McKeown  
 County Treasurer.

Auditor's Office, Cass County, Minnesota

I, \_\_\_\_\_ Auditor of said County, and State  
 of Minnesota, do hereby certify that the following is a correct list of the Taxes levied on the  
 Real and Personal Property in the \_\_\_\_\_ of \_\_\_\_\_  
 for the year 1943.

WITNESS my hand and official seal, the \_\_\_\_\_ day of \_\_\_\_\_  
 1944.

(SEAL) \_\_\_\_\_ County Auditor.

Auditor's Office, Cass County, Minnesota

I hereby certify that on the first Monday in January 1945, I received of \_\_\_\_\_  
 \_\_\_\_\_ County Treasurer, the Tax List of the \_\_\_\_\_  
 of \_\_\_\_\_ in said  
 County for the year 1943; that I have compared the said list with the Statements receipted  
 for by said Treasurer, which are on file in my office, and that each tract or lot of real  
 property therein against which the taxes, or any part thereof, remains unpaid are delin-  
 quent for said year.

(SEAL) \_\_\_\_\_ County Auditor.



NAME OF OWNER

TABULAR SCHEDULE OF VALUATIONS,

LEVIED IN THE Township OF Hiram

RATES AND TAXES

COUNTY OF CASS, STATE OF MINNESOTA

$\frac{172.6}{177.8} = 153.6$   
 $\frac{153.6}{157.8}$

School District No.	VALUATION BY SCHOOL DISTRICTS					RATE OF STATE TAXES					RATE OF COUNTY TAXES					RATE OF TOWN TAXES															
	Valuation of Money and Credits	Value of Lands other than Town Lots including Structures	Value of Town and City Lots including Structures thereon	Personal Property	Total Value of all Property except Money and Credits	State Rev.	State Sch'l	Tchr. Ins.	State Debt	Total Rate of State Tax	Rev.	R. & B.	Welfare	Bonds and Int.	Sewer	Total Rate of County Tax	Rev.	R. & B.	Drag Tax	State Loan											Total Rate of Town Tax
	Dollars	Dollars	Dollars	Dollars	Dollars	Mills	Mills	Mills	Mills	Mills	Mills	Mills	Mills	Mills	Mills	Mills	Mills	Mills	Mills	Mills	Mills	Mills	Mills	Mills	Mills	Mills	Mills	Mills	Mills		
<u>Un.</u>		<u>22878</u>	<u>12547</u>	<u>3241</u>	<u>38666</u>					<u>4.2</u>	<u>1.2</u>	<u>21.7</u>	<u>4.5</u>	<u>35.2</u>	<u>19.4</u>	<u>6</u>	<u>81.4</u>	<u>5</u>	<u>13</u>	<u>1</u>											<u>19</u>

RATE OF SCHOOL TAXES										TAXES LEVIED									
										LOCAL 1 MILL AND SPECIAL SCHOOL TAXES BY DISTRICTS					ALL OTHER TAXES				
Local	Special	State Loan	Def.	C.O.	B+D	Total Rate of Sch'l Tax	Total Rate of all Taxes	Local 1 Mill	Special	State Loan	Def.	C.O.	B+D	Total School Taxes	FUNDS	Rate	Amounts		
1	20	10	10	8	3	52	153.6	2288	45761	22883	22883	18307	6863	118985	State Revenue,				
1	40	10	10	8	3	72	173.6	1578	63157	15793	15793	12635	4726	113697	State School,				
															Teachers Insurance,				
															State Debt—Non-Homestead,		13012		
															State Debt—Homestead,		4653		
															County Revenue,		83910		
															County Road and Bridge,		17400		
															County Welfare,		136109		
															Bonds and Interest		75017		
															<u>Hiram</u>		2320		
															Town Revenue,		19338		
															Town Road and Bridge,		50271		
															Town Drag,		3867		
															Town State Loan,				
															School Local 1 Mill,		3866		
															School Special,		108918		
															School State Loan,		38676		
															Deficiency		38676		
															Capital Outlay		20942		
															Bond & Interest		11599		
															Money and Credits,				
																	638574		

Total Number of Acres 7129 }  
 State of Minnesota, }  
 COUNTY OF CASS }  
 Auditor of said County and State aforesaid, do hereby certify that the  
 foregoing is a true and correct Schedule, showing the valuation of all the taxable property, in the Town  
 of Hiram, in said County, the several rates of Taxation and Totals of the  
 several Tax Funds levied thereon for the year A. D. 1943.  
 Witness my hand and official seal, this DEC 31 1943 day of Dec, A. D. 1943.  
J. B. Peterson County Auditor.  
 Total Levy, \$ 638574

SEAL



FORM 34

NAME OF OWNER

FUNDS	MARCH SETTLEMENT 1943	JUNE SETTLEMENT 1943	NOV. SETTLEMENT 1943	Amount Collected from Nov. 1942 to First Monday in Jan. 1943	REDUCTIONS	Proposed Cancellations	Total Reductions and Collected	BALANCE UNCOLLECTED	ADDITIONS	Total Uncollected to First Monday in January, 1943
State Revenue, State School, Teachers Insurance, State Debt—Non-Homestead, State Debt—Homestead,	2504 812	5637 2232	1590 671	35 19						
County Revenue, County Road and Bridge, County Welfare, County Bond and Interest, <i>Leaver</i>	14688 3046 23824 13131 406	40265 8371 65477 26087 1116	12114 2512 14651 10831 335	322 67 523 288 09						
Town Revenue, Town Road and Bridge, Town Drag, Town State Loan,	3384 8790 677	9300 24182 1860	2791 7257 559	74 193 15						
School Local 1 Mill, School Special, School State Loan, <i>Deficiency</i> <i>B. D. J.</i>	678 22005 6768 6768 5414 2030	1860 53316 18602 18602 14880 5580	558 14569 5582 5583 4466 1674	15 574 148 148 119 45						
Money and Credits,										
	114934	307467	90743	2594	12880	17430			3934	96460

School District No.	LOCAL 1 MILL	SPECIAL	STATE LOAN	Deficiency	B. D.	B. D. J.	TOTALS
Un.	252 422	5068 16927	2524 4234	2524 4234	2027 3387	760 1270	13176 30487
Totals	678	22005	6768	6768	5414	2030	43663
Un.	1054 806	21090 32226	10545 8057	10545 8057	8435 6445	28163 2417	54832 58008
Totals	1860	53316	18602	18602	14880	5580	112840
Un.	15	574	148	148	119	45	2594
Totals	15	574	148	148	119	45	2594
Totals							
Totals							







































Assessment Roll and Tax List of Unplatted Real Property in the \_\_\_\_\_ of \_\_\_\_\_  
Unplatted Real Estate Assessed at 33 1/3 Per Cent of True and Full Value; Attached Machinery at 33 1/3 Per Cent of True and Full Value, Homesteads, up to True and Full Value of \$4000, Assessable at 20 per Cent, Class 3B; Remainder at 33 1/3 Per Cent, Class 3.

Form 4 CD VALUE-BASED COUNTY, MINNEAPOLIS

IN WHOSE NAME ASSESSED	TO WHOM TRANSFERRED	DESCRIPTION OF PROPERTY					ASSESSOR'S VALUATION					EQUALIZED VALUES					SOLD FOR TAXES
		Subdivision	Sec. or Lot	Town or Block	Range	Number of Acres of Land	True and Full Value of Lands Exclusive of Structures and Improvements	STRUCTURES & IMPROVEMENTS	True and Full Value of Buildings and Other Structures	True and Full Value of Machinery Permanently Attached to Real Estate	Total True and Full Value of Lands Including all Structures, Improvements and Machinery	Assessed Value of Homesteads up to \$4,000 at 20 per cent Class 3B	Assessed Value of Remainder at 33 1/3 per cent Class 3	Total Assessed Value of Lands Including all Structures, Improvements and Machinery	Total Assessed Value as Equalized by the Board of Review	Total Assessed Value as Equalized by the County Board	
		1				NE 1/4 of NE 1/4	10	140	31								
		2				NW 1/4 of NE 1/4											
		3				SW 1/4 of NE 1/4											
		4				SE 1/4 of NE 1/4											
Victor P. + Fern E. Altan		5				.05 ac. in SW cor. of Lot 4											05
H. Harold + Virginia B. Cox		6				W 100' of E 68' from N 1/2 to Lake N-E 1/4 of NW 1/4 of Lot 2											4
Lillian Margaret + Jennie R. Wilson		7				NW 1/4 of NW 1/4 6 1/2 ac. of Lot 2											6.50
E. M. Jaeger + Louise S. Jaeger + Helen Hill		8				SW 1/4 of NW 1/4 4 - of " 2											4
		9				SE 1/4 of NW 1/4											
Mary Forest Happe		10				80' x 408' x 200' x 380' of Lot 3											1.25
John Foreman		11				NE 1/4 of SW 1/4 } Lot 3 less 300' x 400' lease 80' x 408' x 200' x 380' lease											10.25
		12				NW 1/4 of SW 1/4 joining the E. 700' } less 100' x 400' lease x 400'											
		13				SW 1/4 of SW 1/4 } Lot 4 less .05 acres											39.95
		14				SE 1/4 of SW 1/4 }											
Russell Carl + Wilma W. Mc Gillivray		15				100' x 400' x 100' x 400' of Lot 3											
		16				NE 1/4 of SE 1/4											
Hilmer + Mary Engstrom		17				200' x 400' on Lake - W. joining the E. 700' } NW 1/4 of SE 1/4 out of Lot 3											2
Florence Ogden Padgett		18				SW 1/4 of SE 1/4 Lot 2 less 14 1/2 ac.											34.75
Louise S. Jaeger + Helen Hill		19				SE 1/4 of SE 1/4 Lot 1											52.50
P. L. Cranak		20				E. 100' x 400' of Lot 3											1
Arthur R. Driscoll						Beginning 400' from N. + S. quarter line thence 400' } W. along Lake, thence S. 390' - thence E. 103' - thence } northwesterly to point of beginning of Lot 3.											2
																	158.25

Abate # 7805

Abate # 2010

Abate # 7805

Cass County, Minnesota, for Taxes for the Year 1943.

No.	VALUATIONS BY SCHOOL DISTRICTS AS EQUALIZED BY DEPARTMENT OF TAXATION				Rate and Tax Less Homestead Exemption	Slate Tax on Non-Homestead	TOTAL GENERAL TAX	SPECIAL TAXES				TOTAL TAXES	PAID	WHEN PAID	Number of Receipt	March Settlement 1944	June Settlement 1944	November Settlement 1944	Penalty	Collections to First Monday in January 1945	Penalty	Delinquent on First Monday in January 1945	Total Delinquent Tax and Penalty	REMARKS	
	District No.	District No.	District No.	District No.				District No.	District No.	District No.	District No.														
	Rate	Rate	Rate	Rate				Rate	Rate	Rate	Rate														
1																									
2																									
3																									
4																									
5	3				46																				
6	123				1890	52																			
7	120				1844	50																			
8	122				200	5																			
9																									
10	7				108	02																			
11	43				660	18																			
12																									
13	174				2672	74																			
14																									
15																									
16																									
17	11				168	04																			
18	397				7234	198																			
19	340				3134	86																			
20	5				76																				
	11				168	04																			
	116				18200	488																			
	1185																								

PAID IN FULL MAY 1 1944 4143

PAID IN FULL JUN 23 1944 6625

PAID IN FULL JUN 23 1944 6624

PAID IN FULL MAR 10 1944 2096

PAID IN FULL JUN 23 1944 6618

PAID IN FULL JUL 18 1944

PAID IN FULL JUL 18 1944

PAID IN FULL JUL 19 1944

PART PAID FEB 28 1944

PAID IN FULL MAR 10 1944

PAID IN FULL JUN 23 1944

PAID IN FULL JUN 16 1944

49.47 Bal. due



Assessment Roll and Tax List of Unplatted Real Property in the of Cass County, Minnesota, for Taxes for the Year 1943.

Cass County, Minnesota, for Taxes for the Year 1943.

Table with columns: IN WHOSE NAME ASSESSED, TO WHOM TRANSFERRED, DESCRIPTION OF PROPERTY, ASSESSOR'S VALUATION, EQUALIZED VALUES, VALUATIONS BY SCHOOL DISTRICTS AS EQUALIZED BY DEPARTMENT OF TAXATION, SPECIAL TAXES, TOTAL TAXES, PAID, WHEN PAID, Number of Receipt, March Settlement 1944, June Settlement 1944, Penalty, November Settlement 1944, Penalty, Collections to First Monday in January 1945, Penalty, Delinquent on First Monday in January 1945, Total Delinquent Tax and Penalty, REMARKS.

Robert L. & Mabel Meyer

Clara J. Moore

Louise L. Jaeger & Helen Hill

E. G. Magdanz & P. W. Luedtke

The L. M. Company

Part of Lot 3 - formerly Lots 58 & 78 - Shady Shore 6.50

Lot 3 less Shady Shore - lots to Otter 8.90

Lot 4 36

Part of Lot 1 - 300' on lake 1

Lot 2 40

9.40

Adapt #1805

SOLD FOR TAXES

SOLD FOR TAXES

PAID IN FULL JUL 1 2 1944 46.74

2nd Half Paid NOV 2 4 1944 114.33  
1st Half Paid JUN 1 6 1944 65.67

PAID IN FULL MAR 1 0 1944 25.96

18.30

19.06



Assessment Roll and Tax List of Unplatted Real Property in the of Cass County, Minnesota, for Taxes for the Year 1943.

Table with columns: IN WHOSE NAME ASSESSED, TO WHOM TRANSFERRED, DESCRIPTION OF PROPERTY, ASSESSOR'S VALUATION, EQUALIZED VALUES, VALUATIONS BY SCHOOL DISTRICTS AS EQUALIZED BY DEPARTMENT OF TAXATION, Rate and Tax Less Exemption, State Tax on Non-Homestead, TOTAL GENERAL TAX, SPECIAL TAXES, TOTAL TAXES, PAID, WHEN PAID, Number of Receipt, March Settlement 1944, June Settlement 1944, Penalty, November Settlement 1944, Penalty, Collections to First Monday in January 1945, Delinquent on First Monday in January 1945, Total Delinquent Tax and Penalty, REMARKS.



Assessment Roll and Tax List of Unplatted Real Property in the of Cass County, Minnesota, for Taxes for the Year 1943.

Table with columns: IN WHOSE NAME ASSESSED, TO WHOM TRANSFERRED, DESCRIPTION OF PROPERTY, ASSESSOR'S VALUATION, EQUALIZED VALUES, VALUATIONS BY SCHOOL DISTRICTS AS EQUALIZED BY DEPARTMENT OF TAXATION, SPECIAL TAXES, TOTAL TAXES, PAID, WHEN PAID, Number of Receipt, March Settlement 1944, June Settlement 1944, Penalty, November Settlement 1944, Penalty, Collections to First Monday in January 1945, Penalty, Delinquent on First Monday in January 1945, Total Delinquent Tax and Penalty, REMARKS.



































































Assessment Roll and Tax List of Unplatted Real Property in the \_\_\_\_\_ of \_\_\_\_\_, Unplatted Real Estate Assessed at 33 1/2 Per Cent of True and Full Value; Attached Machinery at 33 1/2 Per Cent of True and Full Value, Homesteads, up to True and Full Value of \$4000, Assessable at 20 per Cent, Class 3B; Remainder at 33 1/2 Per Cent, Class 3.

Form 4 CD DALLAS-BAY COMPANY, MINNEAPOLIS

IN WHOSE NAME ASSESSED	TO WHOM TRANSFERRED	DESCRIPTION OF PROPERTY					ASSESSOR'S VALUATION							SOLD FOR TAXES			
		SUBDIVISION	Sec. or Lot	Town or Block	Range	Number of Acres of Land	Indicate Homestead	STRUCTURES & IMPROVEMENTS		Total True and Full Value of Land including all Structures, Improvements and Machinery	Assessed Value of Homesteads up to \$4,000 at 20 per cent Class 3B	Assessed Value of Remainder at 33 1/2 per cent Class 3	Total Assessed Value of Land including all Structures, Improvements and Machinery		Total Assessed Value as Equalized by the Board of Review	Total Assessed Value as Equalized by the County Board	Total Assessed Value as Equalized by the Department of Taxation
								True and Full Value of Structures and Improvements	True and Full Value of Buildings and Other Structures								
William H. Dering	State of Minnesota	NE 1/4 of NE 1/4	30	140	31	40											
State of Minnesota		NW 1/4 of NE 1/4															
State of Minnesota		SW 1/4 of NE 1/4															
William H. Dering		SE 1/4 of NE 1/4 less 1 ac. school				39											
State of Minnesota		NE 1/4 of NW 1/4															
State of Minnesota		NW 1/4 of NW 1/4 Lot 1															
State of Minnesota - Dept. Rur. Cr.		SW 1/4 of NW 1/4 " 3															
State of Minnesota - Dept. Rur. Cr.		SE 1/4 of NW 1/4															
Walter R. Hoopman		NE 1/4 of SW 1/4				40											
"		NW 1/4 of SW 1/4 " 3				39.98											
State of Minnesota		SW 1/4 of SW 1/4 " 4															
"		SE 1/4 of SW 1/4				40											
State of Minnesota (Cont to Herman Kestner)		NE 1/4 of SE 1/4				40											
Federal Land Bank, St Paul Florence & Walter R. Hoopman		NW 1/4 of SE 1/4				40											
"		SW 1/4 of SE 1/4				40											
"		SE 1/4 of SE 1/4				40											
						358.98											

SOLD FOR TAXES Abate #3068

Cass County, Minnesota, for Taxes for the Year 1943.

District No.	VALUATIONS BY SCHOOL DISTRICTS AS EQUALIZED BY DEPARTMENT OF TAXATION				Rate and Tax Less Homestead Exemption	State Tax on Non-Homestead	TOTAL GENERAL TAX	SPECIAL TAXES				TOTAL TAXES	PAID	WHEN PAID	Number of Receipt	March Settlement 1944	June Settlement 1944	Penalty	November Settlement 1944	Penalty	Collections to First Monday in January 1945	Penalty	Delinquent on First Monday in January 1945	Total Delinquent Tax and Penalty	REMARKS		
	District No.	District No.	District No.	District No.																							
	Rate	Rate	Rate	Rate																							
1	87				1336	36	1372						1 PAID IN FULL	MAR 8 1944	2366	1372											
2													2														
3													3														
4	85				1306	36	1342						4 PAID IN FULL	MAR 8 1944	2366	1342											
5													5														
6													6														
7													7														
8													8														
9													9														
10													10														
11	61				936		936						11	2nd Half Paid	OCT 24 1944	10406											
12	61				936		936						12	1st Half Paid	MAY 4 1944	4205	936		936								
13													13														
14	108				1658		1658						14	2nd Half Paid	OCT 24 1944	10406											
15													15	1st Half Paid	MAY 4 1944	4205	829		829								
16	74				1136	52	1136						16	2nd Half Paid	OCT 24 1944	10406											
17	87				1336	36	1372						17	1st Half Paid	MAY 4 1944	4205	568		568							8.20 Abated	
18	87				1336	36	1372						18	2nd Half Paid	OCT 24 1944	10406											
19	87				1336	36	1372						19	1st Half Paid	MAY 4 1944	4205	2058		2058								
20	230				12084	732	12316						20	2nd Half Paid	OCT 24 1944	10406											
	557																										
	787																										

8.20 abated























































Assessment Roll and Tax List of Platted Real Property in the of Cass County, Minnesota, for Taxes for the Year 1943.

Table with columns: IN WHOSE NAME ASSESSED, TO WHOM TRANSFERRED, DESCRIPTION OF PROPERTY, ASSESSOR'S VALUATION, EQUALIZED VALUES, VALUATIONS BY SCHOOL DISTRICTS AS EQUALIZED BY DEPARTMENT OF TAXATION, Rate and Tax Less Homestead Exemption, State Tax on Non-Homestead, TOTAL GENERAL TAX, SPECIAL TAXES, PAID, WHEN PAID, Number of Receipt, March Settlement 1941, June Settlement 1941, Penalty, November Settlement 1941, Penalty, Collections to First Monday in January 1945, Delinquent on First Monday in January 1945, Total Delinquent Tax and Penalty, REMARKS.

White Pine Beach Part of Lot 2 - Sec. 14 - 140-31

H. P. Juanita C. Kilander Mrs. Mrs. A. B. Hertzman

Mrs. Julia Aasen

Katherine J. Hartzell

R. P. Johnson Katherine J. Hartzell

Katherine J. Hartzell

John A. Mull

Mabel Sigvald Margaret M. & Jane A. Mull

Joe B. Sigvald

Mrs. M. Berry

Claude & Margaret Sheldon

For Lot 19 see Rearrangement of Lot 19 - Page 12

1771074

18656 448

19104

1178











































SHINGOSEE TOWNSHIP  
HIRAM TOWNSHIP

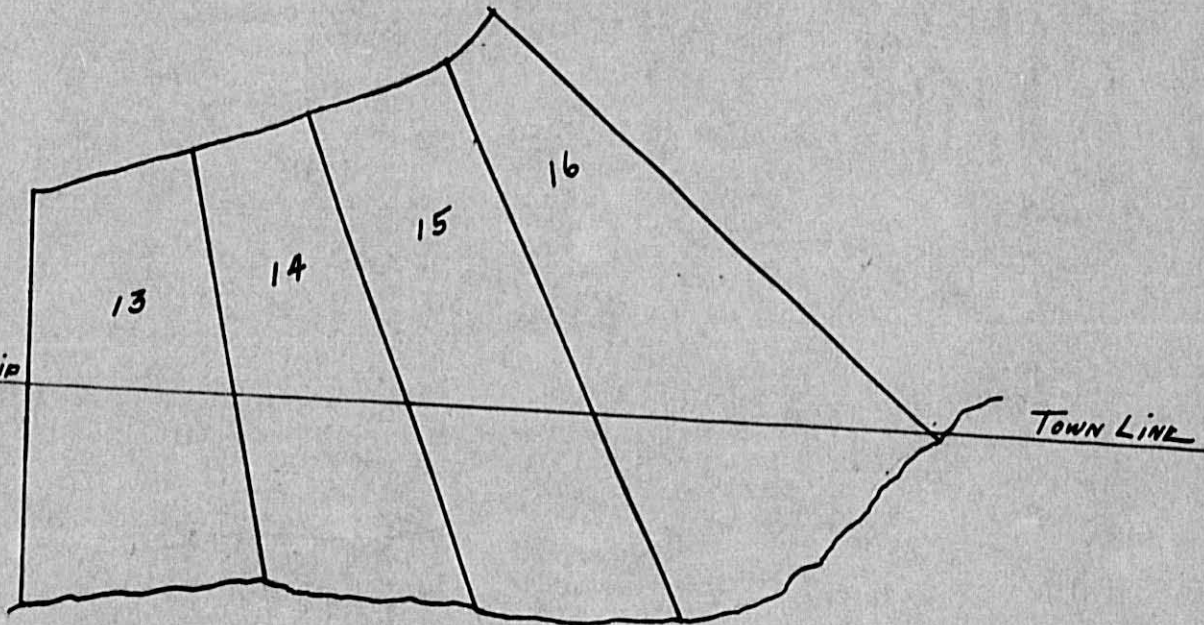

TEN MILE LAKE

LOTS 13-14-15-16 @ HARITON BEACH