

ASSESSMENT & TAX LIST

Hiram

1945

Assessment of

COLLECTIONS OF TAXES OF 1945

Town of Hiram

CASS COUNTY, MINNESOTA

NAME OF OWNER

FUNDS	MARCH SETTLEMENT 1945	JUNE SETTLEMENT 1945	NOV. SETTLEMENT 1945	Amount Collected from Nov. 1st to First Monday in Jan. 1946	REDUCTIONS	Total Reductions and Collected	BALANCE UNCOLLECTED	ADDITIONS	Total Uncollected to First Monday in January, 1946
State Revenue, State School, Teachers Insurance, State Debt—Non-Homestead, State Debt—Homestead,	3390 876	12574 3855							
County Revenue, County Road and Bridge, County Welfare, County Bond and Interest,	12023 4775 20450 10056	52886 21006 89956 44237							
Town Revenue, Town Road and Bridge, Town Drag, Town State Loan,	2809 8427 562	12357 37070 2471							
School Local 1 Mill, School Special, School State Loan, Deficiency, C.O., B.V.D.	117 1764 2350 587 527	2471 52089 49427 12357 32127							
	444 13329 8886 2222 5776								
	100370	424883							

	SCHOOL DISTRICT NO.	LOCAL 1 MILL	SPECIAL	STATE LOAN	Deficiency	C.O.	B.V.D.	TOTALS
MARCH SETTLEMENT	Un Un P.L. Un	117 444	1764 13329		2350 8886	587 2222	1527 5776	6345 30657
	Totals	561	15093		11236	2809	7303	37002
JUNE SETTLEMENT	Un	2471	52089		49427	12357	32127	148471
	Totals	2471	52089		49427	12357	32127	148471
NOVEMBER SETTLEMENT								
	Totals							
NOVEMBER to JANUARY								
	Totals							
ADDITIONS								
	Totals							
REDUCTIONS								
	Totals							

Long Beach

Shady Shores

Plainview Beach Sea Wall

Assessment Roll and Tax List of Unplatted Real Property in the Town of Hiram, Unplatted Real Estate Assessed at 33 1/3 Per Cent of True and Full Value; Attached Machinery at 33 1/3 Per Cent of True and Full Value; Homesteads, up to True and Full Value of \$1000, Assessable at 20 Per Cent, Class 3B; Remainder at 33 1/3 Per Cent, Class 3.

Cass County, Minnesota, for Taxes for the Year 1945.

Table with columns: IN WHOSE NAME ASSESSED, TO WHOM TRANSFERRED, DESCRIPTION OF PROPERTY, ASSESSOR'S VALUATION, EQUALIZED VALUES, VALUATIONS BY SCHOOL DISTRICTS AS EQUALIZED BY DEPARTMENT OF TAXATION, TOTAL GENERAL TAX, SPECIAL TAXES, PAID, WHEN PAID, Number of Receipt, March Settlement 1946, June Settlement 1946, Penalty, November Settlement 1946, Collections to First Monday in January 1947, Delinquent on First Monday in January 1947, Total Delinquent Tax and Penalty, REMARKS.

Long Beach

Shady Shores

Platview Beach Sea Wall

Assessment Roll and Tax List of Unplatted Real Property in the Town of Winam

Cass County, Minnesota, for Taxes for the Year 1945.

Table with columns: IN WHOSE NAME ASSESSED, TO WHOM TRANSFERRED, DESCRIPTION OF PROPERTY, ASSESSOR'S VALUATION, EQUALIZED VALUES, VALUATIONS BY SCHOOL DISTRICTS AS EQUALIZED BY DEPARTMENT OF TAXATION, SPECIAL TAXES, TOTAL GENERAL TAX, PAID, WHEN PAID, Number of Receipt, March Settlement 1946, June Settlement 1946, November Settlement 1946, Collections to First Monday in January 1947, Delinquent on First Monday in January 1947, Total Delinquent Tax and Penalty, REMARKS.

Red River Lbr. Co.
Mary C. Peterson, Joseph D. Peterson
Geo. B. Leonard, Frank J. Hagan, A. E. Wood

Red River Lbr. Co.

Geo. B. Leonard, Frank J. Hagan, A. E. Wood

Long Beach
Shady Shores
Plainview Beach Sea Wall

Assessment Roll and Tax List of Unplatted Real Property in the Town of Hiram, Cass County, Minnesota, for Taxes for the Year 1945.

Cass County, Minnesota, for Taxes for the Year 1945.

Table with columns: IN WHOSE NAME ASSESSED, TO WHOM TRANSFERRED, DESCRIPTION OF PROPERTY, ASSESSOR'S VALUATION, EQUALIZED VALUES, VALUATIONS BY SCHOOL DISTRICTS AS EQUALIZED BY DEPARTMENT OF TAXATION, SPECIAL TAXES, TOTAL GENERAL TAX, PAID, WHEN PAID, Number of Receipts, March Settlement 1946, June Settlement 1946, Penalty, November Settlement 1946, Penalty, Collections to Date Monday in January 1947, Penalty, Delinquent on First Monday in January 1947, Total Delinquent Tax and Penalty, REMARKS.

Long Beach

Shady Shores

Plainview Beach Sea Wall

Assessment Roll and Tax List of Unplatted Real Property in the Town of Hiram, Unplatted Real Estate Assessed at 33 1/3 Per Cent of True and Full Value; Attached Machinery at 33 1/3 Per Cent of True and Full Value, Homesteads, up to True and Full Value of \$1000, Assessable at 20 Per Cent, Class 3B; Remainder at 33 1/3 Per Cent, Class 3.

Cass County, Minnesota, for Taxes for the Year 1945.

Table with columns: IN WHOSE NAME ASSESSED, TO WHOM TRANSFERRED, DESCRIPTION OF PROPERTY, ASSESSOR'S VALUATION, EQUALIZED VALUES, VALUATIONS BY SCHOOL DISTRICTS AS EQUALIZED BY DEPARTMENT OF TAXATION, Rate and Tax Less Homestead Exemption, State Tax on Non-Homestead, TOTAL GENERAL TAX, SPECIAL TAXES, TOTAL TAXES, PAID, WHEN PAID, Number of Receipt, March Settlement 1946, June Settlement 1946, November Settlement 1946, Penalty, Collections to First Monday in January 1947, Delinquent on First Monday in January 1947, Total Delinquent Tax and Penalty, REMARKS.

Long Beach

Shady Shores

Plainview Beach, Sea Wall

Assessment Roll and Tax List of Unplatted Real Property in the Town of Hiram, Unplatted Real Estate Assessed at 33 1/2 Per Cent of True and Full Value; Attached Machinery at 33 1/2 Per Cent of True and Full Value, Homesteads, up to True and Full Value of \$4000, Assessable at 20 Per Cent, Class 3B; Remainder at 33 1/2 Per Cent, Class 3.

Cass County, Minnesota, for Taxes for the Year 1945.

Table with columns: IN WHOSE NAME ASSESSED, TO WHOM TRANSFERRED, DESCRIPTION OF PROPERTY, ASSESSOR'S VALUATION, EQUALIZED VALUES, VALUATIONS BY SCHOOL DISTRICTS AS EQUALIZED BY DEPARTMENT OF TAXATION, SOLID FOR TAXES, SPECIAL TAXES, TOTAL GENERAL TAX, TOTAL TAXES, PAID, WHEN PAID, Number of Receipt, March Settlement 1946, June Settlement 1946, November Settlement 1946, Penalty, Collections to First Monday in January 1947, Delinquent on First Monday in January 1947, Total Delinquent Tax and Penalty, REMARKS.

Assessment Roll and Tax List of Unplatted Real Property in the Town of Hiram, Minnesota. Unplatted Real Estate Assessed at 33 1/2 Per Cent of True and Full Value; Attached Machinery at 33 1/2 Per Cent of True and Full Value, Homesteads, up in True and Full Value of \$4000, Assessable at 29 Per Cent, Class 3B; Remainder at 33 1/2 Per Cent, Class 3.

Cass County, Minnesota, for Taxes for the Year 1945.

Table with columns: IN WHOSE NAME ASSESSED, TO WHOM TRANSFERRED, DESCRIPTION OF PROPERTY, ASSESSOR'S VALUATION, EQUALIZED VALUES, VALUATIONS BY SCHOOL DISTRICTS AS EQUALIZED BY DEPARTMENT OF TAXATION, Rate and Tax Less Homestead Exemption, State Tax on Non-Homestead, TOTAL GENERAL TAX, SPECIAL TAXES, TOTAL TAXES, PAID, WHEN PAID, Number of Receipt, March Settlement 1946, June Settlement 1946, Penalty, November Settlement 1946, Penalty, Collections to First Monday in January 1947, Penalty, Delinquent on First Monday in January 1947, Total Delinquent Tax and Penalty, REMARKS.

SOLD FOR TAXES

Part of same

335
1165
1500

Long Beach Shady Shores Plainview Beach Sea Wall

Assessment Roll and Tax List of Unplatted Real Property in the Town of Hiram

Cass County, Minnesota, for Taxes for the Year 1945.

Table with columns: IN WHOSE NAME ASSESSED, TO WHOM TRANSFERRED, DESCRIPTION OF PROPERTY, ASSESSOR'S VALUATION, EQUALIZED VALUES, VALUATIONS BY SCHOOL DISTRICTS AS EQUALIZED BY DEPARTMENT OF TAXATION, Rate and Tax Less Homestead Exemption, State Tax on Non-Homestead, TOTAL GENERAL TAX, SPECIAL TAXES, TOTAL TAXES, PAID, WHEN PAID, Number of Receipt, March Settlement 1946, June Settlement 1946, November Settlement 1946, Collections to First Monday in January 1947, Delinquent on First Monday in January 1947, Total Delinquent Tax and Penalty, REMARKS.

Edw. L. & Margery Wood - Gerald L. Wood
Alfred Wood
A. G. Wood

Anna C. Blanchard
Alfred K. Voss

Albert Majerus
Zue W. Carlson
Victor Martin
State of Minnesota - Norman & Mary Sieber

State of Minnesota
Albert Majerus
Arne Carlson
State of Minnesota

450
605
481
1096

Long Beach
Shady Shores
Plainview Beach Sea Wall

Assessment Roll and Tax List of Unplatted Real Property in the Town of Wau of Wanam
Unplatted Real Estate Assessed at 33 1/2 Per Cent of True and Full Value; Attached Machinery at 33 1/2 Per Cent of True and Full Value, Homesteads, up to True and Full Value of \$1000, Assessable at 20 Per Cent, Class 3B; Remainder at 33 1/2 Per Cent, Class 3.

IN WHOSE NAME ASSESSED	TO WHOM TRANSFERRED	DESCRIPTION OF PROPERTY				No. School District	Indicate Homestead Yes or No	ASSESSOR'S VALUATION					EQUALIZED VALUES			SOLD FOR TAXES			
		SUBDIVISION	Sec. or Lot	Town or Block	Range			Number of Acres of Land	True and Full Value of Land Exclusive of Structures and Improvements	STRUCTURES & IMPROVEMENTS	True and Full Value of Land Including all Structures, Improvements and Machinery	Assessed Value of Homesteads up to \$1,000 at 20 per cent Class 3B	Assessed Value of Remainder at 33 1/2 per cent Class 3	Total Assessed Value of Land including all Structures, Improvements and Machinery	Total Assessed Value as Equalized by the Board of Review		Total Assessed Value as Equalized by the County Board	Total Assessed Value as Equalized by the Department of Taxation	
Andrew + Katherine Slattery		W. 50' of E. 150' of Lot 2	16	40	31	1	24												
Anne C. Mc Grath		NE 1/4 of NE 1/4				1													
		SW 1/4 of NE 1/4				1													
Frank Frederick		SE 1/4 of NE 1/4 Lot 1				1													
Willmer + Virginia Olson		E. 100' of Lot 2				1													
		NE 1/4 of NW 1/4																	
		NW 1/4 of NW 1/4																	
		SW 1/4 of NW 1/4																	
		SE 1/4 of NW 1/4																	
Hals Augfeth		Lot 3 less platy "Sea Wall"				10													
Anchor Property Co		NE 1/4 of SW 1/4				12													
		SW 1/4 of SW 1/4				13													
		SE 1/4 of SW 1/4				14													
		E. 100' of W. 675.14' of Lot 2				15													
		NE 1/4 of SE 1/4				16													
		NW 1/4 of SE 1/4				17													
		SW 1/4 of SE 1/4				18													
		SE 1/4 of SE 1/4				19													
Clara L. Trettle		2 lots each 100' x 200' of Lot 4				20													

Cass County, Minnesota, for Taxes for the Year 1945.

VALUATIONS BY SCHOOL DISTRICTS AS EQUALIZED BY DEPARTMENT OF TAXATION	Rate and Tax Less Homestead Exemption	State Tax on Non-Homestead	TOTAL GENERAL TAX	SPECIAL TAXES				TOTAL TAXES	PAID	WHEN PAID	Number of Receipt	March Settlement 1946	June Settlement 1946	November Settlement 1946	Penalty	Collections to First Monday in January 1947	Penalty	Delinquent on First Monday in January 1947	Total Delinquent Tax and Penalty	REMARKS
				District No.	District Rate	District No.	District Rate													
1 H 46	740		740					PAID IN FULL	MAY 7 1946	4702		740								
2 H 173	2782		2782					PAID IN FULL	MAR 18 1946	3614		2782								
3 367	5900	240	6140					PAID IN FULL	JUN 17 1946	6959		6140								
4 H 105	1688		1688					1st Half Paid	SEP 13 1946	10559		844								
5 171	2748	112	2860					PAID IN FULL	APR 29 1946	4476		2860								
6																				
7																				
8																				
9																				
10 H 427	6864		6864					1st Half Paid	JUL 22 1946	9848		3432								
11																				
12 H 148	2380		2380					PAID IN FULL	APR 17 1946	4328		2380								
13																				
14																				
15																				
16																				
17																				
18																				
19																				
20 18	290	12	302					PAID IN FULL	FEB 1 1946	765		302								
71 899	23392	364	23756																	
556																				
1455																				

Long Beach Shady Shores Plainview Beach Sea Wall

Assessment Roll and Tax List of Unplatted Real Property in the Town of Hiram, Minnesota

Cass County, Minnesota, for Taxes for the Year 1945.

Table with columns: IN WHOSE NAME ASSESSED, TO WHOM TRANSFERRED, DESCRIPTION OF PROPERTY, ASSESSOR'S VALUATION, EQUALIZED VALUES, VALUATIONS BY SCHOOL DISTRICTS AS EQUALIZED BY DEPARTMENT OF TAXATION, Rate and Tax Less Homestead Exemption, State Tax on Non-Homestead, TOTAL GENERAL TAX, SPECIAL TAXES, TOTAL TAXES, PAID, WHEN PAID, Number of Receipts, March Settlement 1946, June Settlement 1946, November Settlement 1946, Collections to First Monday in January 1947, Delinquent on First Monday in January 1947, Total Delinquent Tax and Penalty, REMARKS.

Assessment Roll and Tax List of Unplatted Real Property in the Town of Hiram, Cass County, Minnesota, for Taxes for the Year 1945.

Form 1 CD - 1944

Table with columns: IN WHOSE NAME ASSESSED, TO WHOM TRANSFERRED, DESCRIPTION OF PROPERTY, ASSESSOR'S VALUATION, EQUALIZED VALUES, VALUATIONS BY SCHOOL DISTRICTS AS EQUALIZED BY DEPARTMENT OF TAXATION, SPECIAL TAXES, TOTAL TAXES, PAID, WHEN PAID, Number of Receipt, March Settlement 1946, June Settlement 1946, Penalty, November Settlement 1946, Penalty, Collections to First Monday in January 1947, Delinquent on First Monday in January 1947, Total Delinquent Tax and Penalty, REMARKS.

State of Minnesota 1 NE 1/4 of NE 1/4 21 140 31 40
Albert Majerus 2 NW 1/4 of NE 1/4 40
State of Minnesota 3 SW 1/4 of NE 1/4
State of Minnesota 4 SE 1/4 of NE 1/4
5
State of Minnesota 6 NE 1/4 of NW 1/4
State of Minnesota 7 NW 1/4 of NW 1/4
State of Minnesota 8 SW 1/4 of NW 1/4
9
10
State of Minnesota 11 NE 1/4 of SW 1/4
Wilbert Johnson 12 NW 1/4 of SW 1/4 40
State of Minnesota 13 SW 1/4 of SW 1/4
State of Minnesota 14 SE 1/4 of SW 1/4
15
State of Minnesota 16 NE 1/4 of SE 1/4
State of Minnesota 17 NW 1/4 of SE 1/4
18
19
20

1 1
2 70 11 26 46 11 72
3
4
5
6
7
8
9
10
11
12 70 11 26 46 11 72
13
14
15
16
17
18
19
20 140 22 52 92 23 44
PAID IN FULL JUN 21 1946 7151 11 72
2nd Half Paid NOV 7 1946 12039
1st Half Paid JUL 17 1946 9757 580

Long Beach Shady Shores Plainview Beach Sea Wall

Assessment Roll and Tax List of Unplatted Real Property in the Town of Hiram, Cass County, Minnesota, for Taxes for the Year 1945.

Table with columns: IN WHOSE NAME ASSESSED, TO WHOM TRANSFERRED, DESCRIPTION OF PROPERTY, ASSESSOR'S VALUATION, EQUALIZED VALUES, and SOLD FOR TAXES. Includes entries for State of Minnesota, Leon + Ira H. Kleisher, Vernon + Lola Pesheck, Fred M. + Margaret Hewitt, Helen H. Schultz, and D. E. Kendall.

Cass County, Minnesota, for Taxes for the Year 1945.

Table with columns: VALUATIONS BY SCHOOL DISTRICTS AS EQUALIZED BY DEPARTMENT OF TAXATION, SPECIAL TAXES, TOTAL TAXES, PAID, WHEN PAID, Number of Receipt, March Settlement 1946, June Settlement 1946, November Settlement 1946, Collections to First Monday in January 1947, Delinquent on First Monday in January 1947, Total Delinquent Tax and Penalty, and REMARKS. Includes handwritten entries for payments and settlements.

Long Beach, Shady Shores, Plainview Beach, Sea Wall

Assessment Roll and Tax List of Unplatted Real Property in the Town of Hiram, Cass County, Minnesota, for Taxes for the Year 1945.

Cass County, Minnesota, for Taxes for the Year 1945.

Table with columns: IN WHOSE NAME ASSESSED, TO WHOM TRANSFERRED, DESCRIPTION OF PROPERTY, ASSESSOR'S VALUATION, EQUALIZED VALUES, VALUATIONS BY SCHOOL DISTRICTS AS EQUALIZED BY DEPARTMENT OF TAXATION, Rate and Tax Less Homestead Exemption, State Tax on Non-Homestead, TOTAL GENERAL TAX, SPECIAL TAXES, TOTAL TAXES, PAID, WHEN PAID, Number of Receipt, March Settlement 1946, June Settlement 1946, November Settlement 1946, Penalty, Collections to First Monday in January 1947, Delinquent on First Monday in January 1947, Total Delinquent Tax and Penalty, REMARKS.

Long Beach Shady Shores Plainview Beach Sea Wall

Assessment Roll and Tax List of Unplatted Real Property in the Town of Wiram, Cass County, Minnesota, for Taxes for the Year 1945.

Cass County, Minnesota, for Taxes for the Year 1945.

Table with columns: IN WHOSE NAME ASSESSED, TO WHOM TRANSFERRED, DESCRIPTION OF PROPERTY, ASSESSOR'S VALUATION, EQUALIZED VALUES, VALUATIONS BY SCHOOL DISTRICTS AS EQUALIZED BY DEPARTMENT OF TAXATION, Rate and Tax Less Homestead Exemption, State Tax on Non-Homestead, TOTAL GENERAL TAX, SPECIAL TAXES, TOTAL TAXES, PAID, WHEN PAID, Number of Receipt, March Settlement 1946, June Settlement 1946, November Settlement 1946, Penalty, Collections to First Monday in January 1947, Delinquent on First Monday in January 1947, Total Delinquent Tax and Penalty, REMARKS.

State of Minnesota
Ray M. + Viola K. Forrest

State of Minnesota
Ray M. + Viola K. Forrest

Long Beach Shady Shores
Rainyview Beach Sea Wall

Assessment Roll and Tax List of Unplatted Real Property in the Town of Niram

Cass County, Minnesota, for Taxes for the Year 1945.

Table with columns: IN WHOSE NAME ASSESSED, TO WHOM TRANSFERRED, DESCRIPTION OF PROPERTY, ASSESSOR'S VALUATION, EQUALIZED VALUES, VALUATIONS BY SCHOOL DISTRICTS AS EQUALIZED BY DEPARTMENT OF TAXATION, SOLID FOR TAXES, TOTAL GENERAL TAX, SPECIAL TAXES, PAID, WHEN PAID, Number of Receipt, March Settlement 1946, June Settlement 1946, November Settlement 1946, Collections to First Monday in January 1947, Delinquent on First Monday in January 1947, Total Delinquent Tax and Penalty, REMARKS.

William H. Deering

William H. Deering

Walter R. Hoopman

Walter R. Hoopman

Herman Kastner & Albert Kastner

Florence M. + Walter R. Hoopman

Donald M. ...

Long Beach Shady Shores

Plainview Beach Sea Wall

Assessment Roll and Tax List of Unplatted Real Property in the Town of Hiram, Cass County, Minnesota, for Taxes for the Year 1945.

Cass County, Minnesota, for Taxes for the Year 1945.

Table with columns: IN WHOSE NAME ASSESSED, TO WHOM TRANSFERRED, DESCRIPTION OF PROPERTY, ASSESSOR'S VALUATION, EQUALIZED VALUES, VALUATIONS BY SCHOOL DISTRICTS AS EQUALIZED BY DEPARTMENT OF TAXATION, Rate and Tax Less Homestead Exemption, State Tax on Non-Homestead, TOTAL GENERAL TAX, SPECIAL TAXES, PAID, WHEN PAID, Number of Receipt, March Settlement 1946, June Settlement 1946, November Settlement 1946, Penalty, Collections to First Monday in January 1947, Delinquent on First Monday in January 1947, Total Delinquent Tax and Penalty, REMARKS.

Henry + Leota M. Blade

Henry + Leota M. Blade

(Cont to John Cameron + Ida L. Kenney)

SOLD FOR TAX

Long Beach, Shady Shores, Plainville Beach, Sea Wall

Assessment Roll and Tax List of Unplatted Real Property in the Town of Hiram
Unplatted Real Estate Assessed at 3 3/4 Per Cent of True and Full Value; Attached Machinery at 3 3/4 Per Cent of True and Full Value; Homesteads, up to True and Full Value of \$1000, Assessable at 20 Per Cent, Class 3B; Remainder at 3 3/4 Per Cent, Class 3.

Cass County, Minnesota, for Taxes for the Year 1945.

Table with columns: IN WHOSE NAME ASSESSED, TO WHOM TRANSFERRED, DESCRIPTION OF PROPERTY, ASSESSOR'S VALUATION, EQUALIZED VALUES, VALUATIONS BY SCHOOL DISTRICTS AS EQUALIZED BY DEPARTMENT OF TAXATION, SOLID FOR TAXES, TOTAL GENERAL TAX, SPECIAL TAXES, PAID, WHEN PAID, Number of Receipt, March Settlement 1946, June Settlement 1946, November Settlement 1946, Penalty, Collections to First Monday in January 1947, Delinquent on First Monday in January 1947, Total Delinquent Tax and Penalty, REMARKS.

State of Minnesota
State of Minnesota
W.M. + St Paul Ry Co.
State of Minnesota
Chas. W. + Lena Ketcham
State of Minnesota
Jessie + Agnes Larson + Le. Howard
Chas. W. Ketcham
Jessie + Agnes M. Larson
State of Minnesota (cont. to John Cameron + Ida L. Kenney)
State of Minnesota
State of Minnesota
Ed L. Bencke
State of Minnesota
State of Minnesota
State of Minnesota

SOLD FOR TAXES
SOLD FOR TAXES

1
2
3 55 884 36 920
4
5
6 71 37 594 594 PAID IN FULL OCT 30 1946 1148
7
8 106 1704 70 1774 PAID IN FULL APR 26 1946 4452 1774
9 153 2460 2460 PAID IN FULL OCT 30 1946 1148 2460 86
10
11 67 1110 46 1156 PAID IN FULL APR 26 1946 4452 1156
12
13 70 1126 46 1172 1172
14
15
16
17
18
19
20 190 200 490 7878 198 8076

Long Beach
Shady Shores
Pleasure Beach Sea Wall

Assessment Roll and Tax List of Unplatted Real Property in the Town of Hiram, Cass County, Minnesota, for Taxes for the Year 1945.

Cass County, Minnesota, for Taxes for the Year 1945.

Table with columns for IN WHOSE NAME ASSESSED, TO WHOM TRANSFERRED, DESCRIPTION OF PROPERTY, ASSESSOR'S VALUATION, EQUALIZED VALUES, VALUATIONS BY SCHOOL DISTRICTS AS EQUALIZED BY DEPARTMENT OF TAXATION, and various tax and payment columns.

Atlas Realty Co.

Long Beach, Shady Shores, Pleasant Beach, Sea Wall

Assessment Roll and Tax List of Unplatted Real Property in the Town of Niram

Cass County, Minnesota, for Taxes for the Year 1945.

Table with columns: IN WHOSE NAME ASSESSED, TO WHOM TRANSFERRED, DESCRIPTION OF PROPERTY, ASSESSOR'S VALUATION, EQUALIZED VALUES, VALUATIONS BY SCHOOL DISTRICTS AS EQUALIZED BY DEPARTMENT OF TAXATION, SPECIAL TAXES, TOTAL GENERAL TAX, PAID, WHEN PAID, Number of Receipt, March Settlement 1946, June Settlement 1946, November Settlement 1946, Collections to First Monday in January 1947, Delinquent on First Monday in January 1947, Total Delinquent Tax and Penalty, REMARKS.

Long Beach, Shady Shores, Plainview Beach, Sea Wall

Assessment Roll and Tax List of Platted Real Property in the Town of Niram

Platted Real Estate Assessed at 40 Per Cent of True and Full Value; Attached Machinery at 33 1/2 Per Cent of True and Full Value; Homesteads, up to True and Full Value of \$1000, Assessable at 25 Per Cent, Class 3C; Attached Machinery at 33 1/2 Per Cent, Class 3; Remainder at 40 Per Cent, Class 4.

Cass County, Minnesota, for Taxes for the Year 1945.

Long Beach
Shady Shores

IN WHOSE NAME ASSESSED	TO WHOM TRANSFERRED	DESCRIPTION OF PROPERTY		No. School District	Indicate Homestead Yes or No	ASSESSOR'S VALUATION						EQUALIZED VALUES			SOLD FOR TAXES	VALUATIONS BY SCHOOL DISTRICTS AS EQUALIZED BY DEPARTMENT OF TAXATION				TOTAL GENERAL TAX	SPECIAL TAXES												REMARKS							
						True and Full Value of Land Exclusive of Structures and Improvements	True and Full Value of Buildings and Other Structures	True and Full Value of Machinery Permanently Attached to Real Estate	Total True and Full Value of Land including all Structures, Improvements and Machinery	Assessed Value of Homesteads up to \$4,000 at 25 per cent Class 3C	Assessed Value of Machinery Permanently Attached to Real Estate at 33 1/2 per cent Class 3	Assessed Value of Remainder at 40 per cent Class 4	Total Assessed Value of Land including all Structures, Improvements and Machinery	Total Assessed Value as Equalized by the Board of Review		Total Assessed Value as Equalized by the County Board	Total Assessed Value as Equalized by the Department of Taxation	District No. Rate	District No. Rate		District No. Rate	District No. Rate	Rate and Tax Less Exemption	State Tax on Non-Homestead	TOTAL TAXES	PAID	WHEN PAID	Number of Receipt	March Settlement 1946	June Settlement 1946	Penalty	November Settlement 1946		Penalty	Collections to First Monday in January 1947	Penalty	Delinquent on First Monday in January 1947	Total Delinquent Tax and Penalty		
Shady Shores		Lot	Block																																					
Harriet Stange		1	E 1/2 of 21													1	10		176	06																				
Florence N. Walls		2	W 1/2 of 21 - all of 22													2	12		2144	80																				
Alice Pearson Fahr		3	23													3	139		2444	90																				
"		4	24													4	20		352	14																				
Louis L. Jaeger + Helen Hill	Helen G. Baltes	5	25													5	20		352	14																				
Paul B. K. Purwin	Catherine G. Cram	6	26													6	14		246	10																				
G. E. Roberts		7	27													7	136		2390	88																				
Peter B. + Alice V. Rasmussen		8	28													8	20		352	14																				
"		9	29													9	20		352	14																				
"		10	30													10	20		352	14																				
"		11	31													11	20		352	14																				
"		12	32													12	20		352	14																				
"		13	33													13	20		352	14																				
"		14	34													14	137		2408	90																				
Arthur + Myrtle Bakker		15	35													15	20		352	14																				
Olafson + "Eli M. Rasmussen"		16	36													16	101		1776	66																				
Chas. W. Estrand		17	37													17	108		1898	70																				
L. J. Burns		18	38													18	20		352	14																				
Geo. J. + Lydia L. Handry		19	39													19	105		1846	68																				
Peter Larson + Mary Larson		20	40													20	20		352	14																				
																1098			19200	722																				

Estimate
H. L. Young
White Pine Beach
Pleasantview Beach Sea Wall

Assessment Roll and Tax List of Platted Real Property in the Town of Hiawatha
Platted Real Estate Assessed at 40 Per Cent of True and Full Value; Attached Machinery at 33 1/2 Per Cent of True and Full Value. Homesteads, up to True and Full Value of \$1000, Assessable at 25 Per Cent, Class 3C; Attached Machinery at 33 1/2 Per Cent, Class 3; Remainder at 40 Per Cent, Class 4.

Long Beach
Lady Shores
White Pine Beach

IN WHOSE NAME ASSESSED	TO WHOM TRANSFERRED	DESCRIPTION OF PROPERTY	No. School District	Initiate Homestead Yes or No	ASSESSOR'S VALUATION					EQUALIZED VALUES			SOLD FOR TAXES		
					True and Full Value of Land Exclusive of Structures and Improvements	True and Full Value of Buildings and Other Structures	True and Full Value of Machinery Permanently Attached to Real Estate	Total True and Full Value of all Structures, Improvements and Machinery	Assessed Value of Homesteads up to \$1,000 at 25 per cent Class 3C	Assessed Value of Machinery Permanently Attached to Real Estate at 33 1/2 per cent Class 3	Assessed Value of Remainder at 40 per cent Class 4	Total Assessed Value of Land (including all Structures, Improvements and Machinery)		Total Assessed Value as Equalized by the Board of Review	Total Assessed Value as Equalized by the County Board
H. J. + Juanita C. Kelander + Mr. + Mrs. A. B. Hartzman		White Pine Beach (Part of Lot 2 - Sec 12 - 140-31)													
Mrs. Julia A. Aason															
Katherine J. Hartzell															
"															
"															
"															
"															
"															
John Mull															
"															
Margaret M. + Jane A. Mull															
Selmer M. + Louise deHass Johnson															
"		No. 25 ft													
Maud M. Berry		So. 25 ft													
"															
"															
Claude + Margaret Sheldon															
"		For Lot 19 see "Re-arrangement Lot 19" Page 12													

Cass County, Minnesota, for Taxes for the Year 1945.

VALUATIONS BY SCHOOL DISTRICTS AS EQUALIZED BY DEPARTMENT OF TAXATION	Rate and Tax Less Homestead Exemption	State Tax on Non-Homestead	TOTAL GENERAL TAX	SPECIAL TAXES								TOTAL TAXES	PAID	WHEN PAID	Number of Receipt	March Settlement 1946	June Settlement 1946	Penalty	November Settlement 1946	Penalty	Collections to First Monday in January 1947	Penalty	Delinquent on First Monday in January 1947	Total Delinquent Tax and Penalty	REMARKS				
				District No. Rate	District No. Rate	District No. Rate	District No. Rate	District No. Rate	District No. Rate	District No. Rate	District No. Rate																		
1	10	176	06																										
2	20	352	14																										
3	20	352	14																										
4	20	352	14																										
5	20	352	14																										
6	20	352	14																										
7	228	5764	214																										
8	20	352	14																										
9	20	352	14																										
10	20	352	14																										
11	149	2618	98																										
12	103	1810	68																										
13	117	2056	76																										
14	10	176	06																										
15	10	176	06																										
16	20	352	14																										
17	80	1406	52																										
18	20	352	14																										
19	57	1002	38																										
20																													
1064		18704	704																										

Estimurst
Hiawatha
Suns of Beach
Reservoir, Lot 19
Plainview Beach
Sea Wall

Assessment Roll and Tax List of Platted Real Property in the

Town of *Hiawatha*

Platted Real Estate Assessed at 40 Per Cent of True and Full Value; Attached Machinery at 33 1/2 Per Cent of True and Full Value, Homesteads, up to True and Full Value of \$1000, Assessable at 25 Per Cent, Class 3C; Attached Machinery at 33 1/2 Per Cent, Class 3; Remainder at 40 Per Cent, Class 4.

Cass County, Minnesota, for Taxes for the Year 1945.

Long Beach
Shady Shores
White Pine Beach
Plainview Beach

IN WHOSE NAME ASSESSED	TO WHOM TRANSFERRED	DESCRIPTION OF PROPERTY		No. School District	Insti- tute Home- stead Yea or No	ASSESSOR'S VALUATION					EQUALIZED VALUES			SOLD FOR TAXES		
		SUBDIVISION	Block			True and Full Value of Lands Exclusive of Structures and Improvements Dollars	STRUCTURES & IMPROVEMENTS		Total True and Full Value of Lands Including all Structures, Improvements and Machinery Dollars	Assessed Value of Homesteads up to \$1,000 at 25 per cent Class 3C Dollars	Assessed Value of Machinery Formerly Attached to Real Estate 33 1/2 per cent Class 3 Dollars	Assessed Value of Remainder at 40 per cent Class 4 Dollars	Total Assessed Value as Equalized by the Board of Review Dollars		Total Assessed Value as Equalized by the County Board Dollars	Total Assessed Value as Equalized by the Department of Taxation Dollars
							True and Full Value of Build- ings and Other Structures Dollars	True and Full Value of Machi- nery Perma- nently Attached to Real Estate Dollars								
Joe Welsch		Plainview Beach	1	2th												
Clarence Fox Arboine & Donald Dickerson		Part of Lot 1- See 15-146-31	2													
Geo. S. + Clara B. Page			3													
Geo. S. Page			4													
Chas. S. Page	William Page		5													
W. H. Fox			6													
Margaret Carlson			7									SOLD FOR TAXES				
George Benich			8													
Wesley Bakken + McPhillip	Carolina Bakken		9													
Christina McPhillip			9									SOLD FOR TAXES				
Oscar B. + Caroline Bakken			10													
			11													
			12													
			13													
			14													
			15													
			16													
			17													
			18													
			19													
			20													

No.	VALUATIONS BY SCHOOL DISTRICTS AS EQUALIZED BY DEPARTMENT OF TAXATION				Rate and Tax Less Homestead Exemption Mills	State Tax on Non- Homestead Cents Mills	TOTAL GENERAL TAX	SPECIAL TAXES							PAID	WHEN PAID	Number of Receipt	March Settlement 1946	June Settlement 1946	November Settlement 1946	Collections to First Monday in January 1947	Delinquent on First Monday in January 1947	Total Delinquent Tax and Penalty	REMARKS
	District No.	District Rate	District No.	District Rate																				
	Dollars	Dollars	Dollars	Dollars				\$ cts.	\$ cts.	\$ cts.	\$ cts.	\$ cts.	\$ cts.	\$ cts.										
1	116				20.38		2038						PAID IN FULL	MAY 31 1945	5737	2038								
2	94				16.52		1714						PAID IN FULL	JUN 1 3 1946	6832	1714								
3	20				3.52		366						PAID IN FULL	APR 1 8 1946	4250	366								
4	65				11.47		1184						PAID IN FULL	APR 1 8 1946		1550								
5	20				3.52		366						PAID IN FULL	FEB 1 1 1946	1176	366								
6	87				14.47		1496						PAID IN FULL	SEP 1 1 1946	10543		1496							
7	20				3.52		366						PAID IN FULL	APR 1 7 1946	4334	366								
8	115				20.22		2098						PAID IN FULL	APR 2 5 1946	4558	2098								
9	20				3.52		366						PAID IN FULL	MAR 1 6 1946	5219	366								
10	107				17.97		1858						PAID IN FULL	APR 1 8 1946	4247	1858								
11																								
12																								
13																								
14																								
15																								
16																								
17																								
18																								
19																								
20																								

#116
538
654

11496 256

11852

Elmhurst
Ritzmound
Sunset Beach
Re-arrange Lot 19
Sea Wall

Assessment Roll and Tax List of Platted Real Property in the Town of Hiram, Minnesota. Platted Real Estate Assessed at 40 Per Cent of True and Full Value; Attached Machinery at 33 1/2 Per Cent of True and Full Value, Homesteads, up to True and Full Value of \$1000, Assessable at 25 Per Cent, Class 3C; Attached Machinery at 33 1/2 Per Cent, Class 3; Remainder at 40 Per Cent, Class 4.

Long Beach, White Pine Beach, Shady Shores, Plainview Beach, Sea Wall

Table with columns: IN WHOSE NAME ASSESSED, TO WHOM TRANSFERRED, DESCRIPTION OF PROPERTY (Lot, Block, Subdivision), ASSESSOR'S VALUATION (True and Full Value of Land, Structures & Improvements, etc.), EQUALIZED VALUES, and SOLD FOR TAXES.

Nels Angeltz

The Sea Wall (Part of Lot 3 - Sec. 16 - 40-31)

2th

Cass County, Minnesota, for Taxes for the Year 1945.

Table with columns: VALUATIONS BY SCHOOL DISTRICTS AS EQUALIZED BY DEPARTMENT OF TAXATION, Rate and Tax Less Homestead Exemption, State Tax on Non-Homestead, TOTAL GENERAL TAX, SPECIAL TAXES, PAID, WHEN PAID, Number of Receipt, March Settlement 1946, June Settlement 1946, November Settlement 1946, Collections to First Monday in January in 1947, Delinquent on First Monday in January in 1947, Total Delinquent Tax and Penalty, and REMARKS.

Elmhurst, Ritzmound, Sunset Beach, Re-arrange Lot 19, White Pine Beach

Assessment Roll and Tax List of Platted Real Property in the

Town of Swan

Platted Real Estate Assessed at 40 Per Cent of True and Full Value; Attached Machinery at 33 1/2 Per Cent of True and Full Value, Homesteads, up to True and Full Value of \$1000, Assessable at 25 Per Cent, Class 3C: Attached Machinery at 33 1/2 Per Cent, Class 3: Remainder at 40 Per Cent, Class 4.

Cass County, Minnesota, for Taxes for the Year 1945.

Time Beach, Elmhurst, Beach, Shores, Lot 19, White Pine Beach, Sea Wall

Table with columns: IN WHOSE NAME ASSESSED, TO WHOM TRANSFERRED, SUBDIVISION, Block, No. School District, Indicate Homestead, True and Full Value of Land, Structures & Improvements, ASSESSOR'S VALUATION, EQUALIZED VALUES, VALUATIONS BY SCHOOL DISTRICTS AS EQUALIZED BY DEPARTMENT OF TAXATION, Rate and Tax Less Homestead Exemption, State Tax on Non-Homestead, TOTAL GENERAL TAX, SPECIAL TAXES, TOTAL TAXES, PAID, WHEN PAID, Number of Receipt, March Settlement 1946, June Settlement 1946, November Settlement 1946, Collections to First Monday in January 1947, Delinquent on First Monday in January 1947, Total Delinquent Tax and Penalty, REMARKS.

Rt around, Sunset Beach, Charlton Beach

Assessment Roll and Tax List of Platted Real Property in the

Town of Ham

Platted Real Estate Assessed at 40 Per Cent of True and Full Value; Attached Machinery at 33 1/2 Per Cent of True and Full Value; Homesteads, up to True and Full Value of \$4000, Assessable at 25 Per Cent, Class 3C; Attached Machinery at 33 1/2 Per Cent, Class 3; Remainder at 40 Per Cent, Class 4.

Cass County, Minnesota, for Taxes for the Year 1945.

Sea Wall, White Pine Beach, Re-arrang. Lot 19, Sunset Beach, Charlton Beach

Table with columns: IN WHOSE NAME ASSESSED, TO WHOM TRANSFERRED, DESCRIPTION OF PROPERTY, ASSESSOR'S VALUATION, EQUALIZED VALUES, VALUATIONS BY SCHOOL DISTRICTS AS EQUALIZED BY DEPARTMENT OF TAXATION, SPECIAL TAXES, TOTAL TAXES, PAID, WHEN PAID, Number of Receipt, March Settlement 1946, June Settlement 1946, Penalty, November Settlement 1946, Penalty, Collections to First Monday in January 1947, Delinquent on First Monday in January 1947, Total Delinquent Tax and Penalty, REMARKS.

Handwritten names: Fred Ritzman, Edw. L. + Margery Wood, W. W. Mitchell, Everett O + Lucille Haugham, Maude A. Donahue, Cecil + Dora E. Haugham, Perry Haugham, Everett O + Lucille Haugham, Everett O + Lucille Haugham

Handwritten notes: Plat of Ritzmann (5.2 ac. of Govt Lot 4 - Sec 14-140-31)

Handwritten notes: 9002, 4101, 9002, 8319, 4249, 8319

Handwritten note: Refund W. #85655 12/17/47 17.32

Handwritten totals: 450, 7914, 284, 8198

Assessment Roll and Tax List of Platted Real Property in the Town of Ocean
 Platted Real Estate Assessed at 40 Per Cent of True and Full Value; Attached Machinery at 33 1/2 Per Cent of True and Full Value, Homesteads, up to True and Full Value of \$1000, Assessable at 25 Per Cent, Class 3C; Attached Machinery at 33 1/2 Per Cent, Class 3; Remainder at 40 Per Cent, Class 4.

Cass County, Minnesota, for Taxes for the Year 1945.

IN WHOSE NAME ASSESSED	TO WHOM TRANSFERRED	DESCRIPTION OF PROPERTY			No. School District	Include Homestead Yes or No	ASSESSOR'S VALUATION					EQUALIZED VALUES			SOLD FOR TAXES	VALUATIONS BY SCHOOL DISTRICTS AS EQUALIZED BY DEPARTMENT OF TAXATION				Rate and Tax Less Homestead Exemption	State Tax on Non-Homestead	TOTAL GENERAL TAX		SPECIAL TAXES								REMARKS																																					
		SUBDIVISION	Lot	Block			True and Full Value of Land Exclusive of Structures and Improvements	STRUCTURES & IMPROVEMENTS	True and Full Value of Land Including all Structures, Improvements and Machinery	Assessed Value of Homestead up to \$6,000 at 25 per cent Class 3C	Assessed Value of Machinery Permanently Attached to Real Estate at 33 1/2 per cent Class 3	Assessed Value of Remainder at 40 per cent Class 4	Total Assessed Value of Land Including all Structures, Improvements and Machinery	Total Assessed Value as Equalized by the Board of Review		Total Assessed Value as Equalized by the County Board	Total Assessed Value as Equalized by the Department of Taxation	District No.	District No.			District No.	District No.	Rate	Rate	Rate	Rate	TOTAL TAXES		PAID	WHEN PAID		Number of Receipt	March Settlement 1946	June Settlement 1946	Penalty	November Settlement 1946	Penalty	Collections to First Monday in January 1947	Penalty	Delinquent on First Monday in January 1947	Total Delinquent Tax and Penalty																											
																		Dollars	Dollars			Dollars	Dollars	Dollars	Dollars	Dollars	Dollars	Dollars	Dollars	Dollars	Dollars												Dollars	Dollars	Dollars	Dollars	Dollars	Dollars	Dollars	Dollars	Dollars	Dollars	Dollars	Dollars	Dollars	Dollars	Dollars	Dollars	Dollars	Dollars	Dollars	Dollars	Dollars	Dollars					
A. E. Woock + Selma N. Woock		Sunset Beach	1	3										1	20		352	14			366	1			PAID IN FULL	NOV 7 1946																																											
Geo. Goode + Louis Nichols			2											2	20		352	14			366	2			PAID IN FULL	NOV 7 1946																																											
Eldar Strommen			3											3	20		352	14			366	3			PAID IN FULL	FEB 8 1946																																											
Caroline Magdanz			4											4	20		352	14			366	4			PAID IN FULL	APR 11 1946																																											
"			5											5	20		352	14			366	5			PAID IN FULL	APR 11 1946																																											
"			6											6	20		352	14			366	6			PAID IN FULL	APR 11 1946																																											
"			7											7	20		352	14			366	7			PAID IN FULL	JUN 5 1946																																											
"			8											8	20		352	14			366	8			PAID IN FULL	JUN 5 1946																																											
"			9											9	20		352	14			366	9			PAID IN FULL	JUN 5 1946																																											
"			10											10	20		352	14			366	10			PAID IN FULL	JUN 5 1946																																											
The L. M. Company			11											11	20		352	14			366	11			PAID IN FULL	JUN 5 1946																																											
"			12											12	20		352	14			366	12			PAID IN FULL	JUN 5 1946																																											
"			13											13	20		352	14			366	13			PAID IN FULL	NOV 6 1946																																											
"			14											14	20		352	14			366	14			PAID IN FULL	NOV 6 1946																																											
"			15											15	20		352	14			366	15			PAID IN FULL	NOV 6 1946																																											
"			16											16	20		352	14			366	16			PAID IN FULL	NOV 6 1946																																											
"			17											17	20		352	14			366	17			PAID IN FULL	NOV 6 1946																																											
"			18											18	20		352	14			366	18			PAID IN FULL	NOV 6 1946																																											
			19											19																																																							
			20											20																																																							
															360		6336		257		6588																																																

Elmhurst
 Ritzmound
 Sunset Beach
 Lot 19
 White Pine Beach
 Sea Wall

Charlton Beach

Assessment Roll and Tax List of Platted Real Property in the Town of Hiawatha
 Platted Real Estate Assessed at 40 Per Cent of True and Full Value; Attached Machinery at 33 1/2 Per Cent of True and Full Value; Homesteads, up to True and Full Value of \$1000, Assessable at 25 Per Cent, Class 3C; Attached Machinery at 33 1/2 Per Cent, Class 3; Remainder at 40 Per Cent, Class 4.

Cass County, Minnesota, for Taxes for the Year 1945.

IN WHOSE NAME ASSESSED	TO WHOM TRANSFERRED	DESCRIPTION OF PROPERTY		No. School District	Indicate Homestead Yes or No	ASSESSOR'S VALUATION					EQUALIZED VALUES			SOLD FOR TAXES
		SUBDIVISION	Lot Block			True and Full Value of Land Exclusive of Structures and Improvements	STRUCTURES & IMPROVEMENTS	True and Full Value of Land Including Structures and Improvements	Total True and Full Value of Land Including all Structures, Improvements and Machinery	Assessed Value of Homesteads up to \$4,000 at 25 per cent Class 3C	Assessed Value of Machinery Permanently Attached to Real Estate at 33 1/2 per cent Class 3	Assessed Value of Remainder at 40 per cent Class 4	Total Assessed Value of Land Including all Structures, Improvements and Machinery	
A.E. Wasek + Selma N. Wasek		Sunset Beach	A 3	Un										
The L.M. Company	The L.M. Company	"	B	less part sold										
Bessie A. Crabb		Part of "	B											

VALUATIONS BY SCHOOL DISTRICTS AS EQUALIZED BY DEPARTMENT OF TAXATION	Rate and Tax Less Homestead Exemption	State Tax on Non-Homestead	TOTAL GENERAL TAX	SPECIAL TAXES										PAID	WHEN PAID	Number of Receipt	March Settlement 1946	June Settlement 1946	Penalty	November Settlement 1946	Penalty	Collections to First Monday in January 1947	Penalty	Delinquent on First Monday in January 1947	Total Delinquent Tax and Penalty	REMARKS					
				District No. 1	District No. 2	District No. 3	District No. 4	District No. 5	District No. 6	District No. 7	District No. 8	District No. 9	District No. 10														District No. 11	District No. 12	District No. 13	District No. 14	District No. 15
1	16	282 10	292 10											2nd Half Paid NOV 7 1946	2635																
2	10	176 00	182 00											PAID IN FULL NOV 6 1946	11718																
3	16	282 10	292 10											PAID IN FULL NOV 6 1946	11718																
4	10	176 00	182 00											PAID IN FULL NOV 30 1946	11975																

Elmhurst
 Ritzmound
 Sunset Beach
 Re-arrang. Lot 19 White Pine Beach
 Sea Wall

Charlton Beach

59 916 37 948

Assessment Roll and Tax List of Platted Real Property in the

Platted Real Estate Assessed at 40 Per Cent of True and Full Value: Attached Machinery at 33%
The Central Tax and Assessment Law, Minnesota, as amended, and the True and Full Value Law, Minnesota, as amended, are hereby incorporated by reference into this assessment roll.

County of Hennepin, State of Minnesota

Remainder at 40 Per Cent, Class 1.

Cass County, Minnesota, for Taxes for the Year 1945.

Elmhurst
Ritzmound
Sunset Beach
Chariton Beach
Sea Wall

IN WHOSE NAME ASSESSED	TO WHOM TRANSFERRED	DESCRIPTION OF PROPERTY
J. R. Buck		Chariton Beach Lots 1+2 - Sec. 3-
Olle L. Kridelbaugh		
Helen Reese		
Ruth A. Gookin		
William Eikensberg		
"		
Jane + Allen L. Dewey		
Mary E. Shelton		
William Eikensberg		
Olle C. + June Cochran		
Alfred C. + Sigrid West		
Elmer L. Gookin		
Olle L. Kridelbaugh		
Elmer L. Gookin		
Olle L. Kridelbaugh		
William Eikensberg		

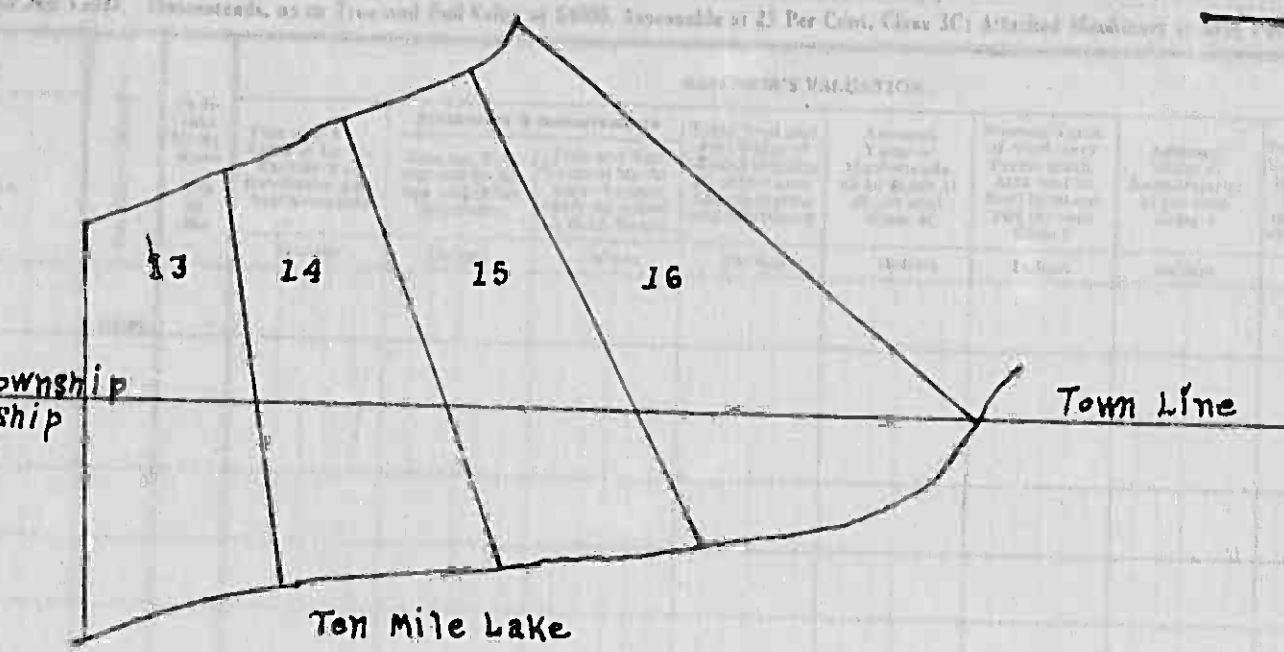

Total Assessed Value as Equalized by the Board of Review	Total Assessed Value as Equalized by the County Board	Total Assessed Value as Equalized by the Department of Taxation	SOUTH FOR TAXES	VALUATIONS BY SCHOOL DISTRICTS AS EQUALIZED BY DEPARTMENT OF TAXATION				Rate and Tax Less Homestead Exemption	State Tax on Non-Homestead	TOTAL GENERAL TAX	SPECIAL TAXES				TOTAL TAXES	PAID	WHEN PAID	Number of Receipt	March Settlement 1946	June Settlement 1946	Penalty	November Settlement 1946	Penalty	Collections to First Monday in January 1947	Penalty	Delinquent on First Monday in January 1947	Total Delinquent Tax and Penalty	REMARKS		
				District No.	District No.	District No.	District No.				\$	cts.	\$	cts.															\$	cts.
1	196	3444	128						65.4	3572					PAID IN FULL	FEB 22 1946	1967												3572	
2	107	1880	70							1950				PAID IN FULL	APR 23 1946	4376												1950		
3	133	2338	86							2424				PAID IN FULL	JUL 18 1946	9509												2424		
4	75	1318	50							1368				PAID IN FULL	APR 15 1946	4290												1368		
5	166	2918	108							3026				PAID IN FULL	JUL 19 1946	9384												3026		
6	187	3286	122							3408				PAID IN FULL	APR 23 1946	4401												3408		
7	203	3568	137							3700				PAID IN FULL	MAY 13 1946	4889												3700		
8	154	2706	100							2806				PAID IN FULL	JUL 10 1946	8485												2806		
9	30	528	20							548				PAID IN FULL	APR 8 1946	3888												548		
10	30	528	20							548				PAID IN FULL	FEB 13 1946	1204												548		
11	30	528	20							548				PAID IN FULL	JUN 1 1946	6007												548		
12	30	528	20							548				PAID IN FULL	APR 15 1946	4290												548		
13	20	352	14							366				PAID IN FULL	MAY 20 1946	5294												366		
14	20	352	14							366				PAID IN FULL	APR 15 1946	4290												366		
15	20	352	14							366				PAID IN FULL	MAY 20 1946	5294												366		
16	20	352	14							366				PAID IN FULL	MAY 13 1946	4889												366		
17																														
18																														
19																														
20																														

Grand Total: 1421, 24978 937, 25910

Assessment Roll and Tax List of Platted Real Property in the Town of Niram

Platted Real Estate Assessed at 40 Per Cent of True and Full Value; Attached Machinery at 33 1/2 Per Cent of True and Full Value; Homesteads, up to True and Full Value of \$1000, Assessable at 25 Per Cent, Class 3C; Attached Machinery at 33 1/2 Per Cent, Class 3; Remainder at 40 Per Cent, Class 4.

Elmhurst
Ritzmound
Sunset Beach
Chariton Beach
Sea Wall

Table with columns: IN WHOSE NAME ASSESSED, TO WHOM TRANSFERRED, SUBDIVISION (Chariton Beach), Lot, Block, No. School District, Indicate Homestead, ASSESSOR'S VALUATION (True and Full Value of Land, Structures & Improvements, Total True and Full Value of Land), EQUALIZED VALUES (Total Assessed Value, Total Assessed Value as Equalized by Board, Total Assessed Value as Equalized by Department of Taxation), SOLD FOR TAXES.

J. R. Beck
Ollie L. Kridelbaugh
Helen Reese
Ruth A. Gookin
William Eickenberry
Jane + Allen L. Dewey
Mary E. Shelton
William Eickenberry
Ollie C. + June Cochran
Alfred C. + Sigrid West
Elmer L. Gookin
Ollie L. Kridelbaugh
Elmer L. Gookin
Ollie L. Kridelbaugh
William Eickenberry

Chariton Beach
Lots 1 + 2 - Sec. 3-140-31

That part of lot 13 lying S of N line of T 140 R 31

Cass County, Minnesota, for Taxes for the Year 1945.

Table with columns: VALUATIONS BY SCHOOL DISTRICTS AS EQUALIZED BY DEPARTMENT OF TAXATION (District No., Rate, etc.), Rate and Tax Law Homestead Exemption, State Tax on Non-Homestead, TOTAL GENERAL TAX, SPECIAL TAXES, TOTAL TAXES, PAID, WHEN PAID, Number of Receipt, March Settlement 1946, June Settlement 1946, Penalty, November Settlement 1946, Penalty, Collections to First Monday in January 1947, Penalty, Delinquent on First Monday in January 1947, Total Delinquent Tax and Penalty, REMARKS.

Grand Total
1421
24978 932
228214

Assessment Roll and Tax List of Platted Real Property in the _____ of _____
 Platted Real Estate Assessed at 40 Per Cent of True and Full Value; Attached Machinery at 33 1/2 Per Cent of True and Full Value. Homesteads, up to True and Full Value of \$1000, Assessable at 25 Per Cent, Class 3C; Attached Machinery at 33 1/2 Per Cent, Class 3; Remainder at 40 Per Cent, Class 4.

Elmhurst
 Ritzywood
 Sunset Beach
 Chariton Beach
 Sea Wall

IN WHOSE NAME ASSESSED	TO WHOM TRANSFERRED	DESCRIPTION OF PROPERTY		No. School District	Inst. rate Home-stead Yes or No	ASSESSOR'S VALUATION							EQUALIZED VALUES			SOLD FOR TAXES		
		SUBDIVISION	Lot			Block	True and Full Value of Land Exclusive of Structures and Improvements	STRUCTURES & IMPROVEMENTS		Total True and Full Value of Land Including all Structures, Improvements and Machinery	Assessed Value of Homesteads up to \$4,000 at 25 per cent Class 3C	Assessed Value of Machinery Permanently Attached to Real Estate at 33 1/2 per cent Class 3	Assessed Value of Remainder at 40 per cent Class 4	Total Assessed Value of Land Including all Structures, Improvements and Machinery	Total Assessed Value as Equalized by the Board of Review		Total Assessed Value as Equalized by the County Board	Total Assessed Value as Equalized by the Department of Taxation
								True and Full Value of Buildings and Other Structures	True and Full Value of Machinery Permanently Attached to Real Estate									
		Chariton Beach	41															
			42															
			43															
			44															
			45															
			46															
			47															
			48															
			49															
			50															
		Chariton Beach																

1947
 11 June
 to [unclear] [unclear]
 [unclear] [unclear]