

ASSESSMENT & TAX LIST

**Crooked Lake**

**1950**





Assessor's Return of Exempt Real Property in the \_\_\_\_\_ of \_\_\_\_\_ County of \_\_\_\_\_, Minnesota, for the Year 1950

FORM 2 HALL-HEATH COMPANY, MINNEAPOLIS

NAMES OF OWNERS	DESCRIPTION	Sec. or Lot	Town or Block	Range	No. of Acre	FOR WHAT PURPOSE USED	TRUE AND FULL VALUATIONS				ASSESSED VALUATIONS		REMARKS
							LAND Exclusive of Structures and Improvements	BUILDINGS and Other Structures	MACHINERY Permanently Attached to Real Estate	TOTAL True and Full Value	Rural Including Machinery	All Other	
							Dollars	Dollars	Dollars	Dollars	33 1/3%	40%	
<i>Univ. School Dist of Dodge County</i>	<i>E 1/2 of 100 acres</i>	<i>10</i>	<i>2</i>				<i>57</i>	<i>250</i>		<i>201</i>	<i>67</i>		

THE STATE OF MINNESOTA  
 MINNEAPOLIS  
 ROOSEVELT LANE HEIGHTS  
 TWIN LANE HEIGHTS  
 WANA HEIGHTS  
 TWIN LANE HEIGHTS  
 TWIN LANE HEIGHTS



Assessor's Return

FORM 2

NAMES OF OWNERS

Treasurer's Office, Cass County, Minnesota

RECEIVED this, the first Monday (being the 2nd day) of January, A. D. 1951, of L. C. Peterson Auditor of said County, Minnesota, the Tax List of all Taxable Real and Personal Property in the Town of Crooked Lake in said County for the year A. D. 1950, as specified above and amounting to Dollars

Paul W. Jewell, County Treasurer by F.M.P.

Office of County Treasurer, Cass County, Minnesota

To L. C. Peterson, County Auditor:

Sir:—I herewith return to you the Tax List for the Town of Crooked Lake in said County for the year 1950, heretofore received from you. I certify that I have compared the same with the duplicate receipts in your office, and have written opposite the amount of each tax so receipted the words "First Quarter Paid", "Second Quarter Paid", "Third Quarter Paid" or "Paid in full" as the case may be, and the number of my receipt given in discharge of said tax, and each tract or lot of real property against which the taxes remain unpaid is delinquent for said year.

Yours respectfully,

County Treasurer.

Auditor's Office, Cass County, Minnesota

Auditor of said County, and State of Minnesota, do hereby certify that the following is a correct list of the Taxes levied on the Real and Personal Property in the Town of Crooked Lake in said County for the year 1950.

WITNESS my hand and official seal, the 2nd day of January, 1951.

(SEAL) County Auditor.

Auditor's Office, Cass County, Minnesota

I hereby certify that on the first Monday in January 1951 I received of L. C. Peterson, County Treasurer, the Tax List of the Town of Crooked Lake in said County for the year 1950; that I have compared the said list with the Statements receipted for by said Treasurer, which are on file in my office, and that each tract or lot of real property therein against which the taxes, or any part thereof, remains unpaid are delinquent for said year.

(SEAL) County Auditor.

MINNESOTA FILE OF TAXPAYER'S RECORDS ROOSEVELT TRAILS MANA HEIGHTS CROOKED LAKE HEIGHTS

Assessor's Return

FORM 2 - 1951

TABULAR SCHEDULE OF VALUATIONS, RATES AND TAXES

LEVIED IN THE Town OF Crooked Lake

COUNTY OF CASS, STATE OF MINNESOTA

NAMES OF OWNERS

VALUATION BY SCHOOL DISTRICTS

RATE OF STATE TAXES

RATE OF COUNTY TAXES

RATE OF TOWN TAXES

RATE OF

SCHOOL TAXES

TAXES LEVIED

Consolidated Aug 1951

Table with columns for School District No., Valuation by School Districts (Agricultural, Non-Agricultural, Personal), Rate of State Taxes (Mills), Rate of County Taxes (Mills), Rate of Town Taxes (Mills), and Rate of School Taxes (Mills).

Summary table for Assessed Value: Rural Homestead (779), All Other (0), Personal Property (2384), Total (7791). Non-Homestead (34458), Total (42249).

LOCAL 1 MILL AND SPECIAL SCHOOL TAXES BY DISTRICTS

ALL OTHER TAXES

Table for Taxes Levied: School Taxes (Local 1 Mill, Special, State Loan, Deficiency, Tuition, Transportation, Pub. Emp. Ret.), Local 1 Mill and Special School Taxes by Districts (Local 1 Mill, Special, State Loan, Deficiency, Tuition, Transportation, Pub. Emp. Ret., C.O., B+J), and All Other Taxes (Funds, Rate, Amounts).

Summary of All Other Taxes: State-Non-Homestead (163.12), State-Homestead (183.88), County Revenue (1151.55), County Road and Bridge (607.02), County Welfare (1892.46), Bonds and Interest (745.40), Pub. Emp. Ret. (17.87), Town Revenue (249.96), Town Road and Bridge (669.52), Town Drain (446.5), Town State Loan (111.60), Fire Telephone (111.60), School Local 1 Mill (446.4), School Special (8993.6), School State Loan (2231.65), Deficiency (1339.0), Tuition (111.6), Transportation (446.33), Pub. Emp. Ret. (2231.7), B+J (3990.21).

Auditor's Declaration: I, L. C. Peterson, Auditor of said County and State aforesaid, do hereby certify that the foregoing is a true and correct Schedule, showing the valuation of all the taxable property, in the town of Crooked Lake, in said County, the several rates of Taxation and Totals of the several Tax Funds levied thereon for the year A. D. 1950. Witness my hand and official seal, this 5th day of December, A. D. 1950.

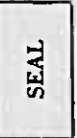

Total Taxes Real Estate 9382.52, Pers. Prop. 556.32, Total 9938.84

Vertical text on the right edge of the page: TOWN OF CROOKED LAKE, COUNTY OF CASS, STATE OF MINNESOTA.











Assessment Roll and Tax List of Real Property in the Town of Crooked Lake

Cass County, Minnesota, for Taxes for the Year 1950.

IN WHOSE NAME ASSESSED	TO WHOM TRANSFERRED	DESCRIPTION OF PROPERTY					TRUE AND FULL VALUATIONS				ASSESSED VALUATIONS					FINAL EQUALIZED VALUE	SOLD FOR TAXES	VALUATIONS BY SCHOOL DISTRICTS AS EQUALIZED BY DEPARTMENT OF TAXATION						Tax including State Homestead	State Tax on Non-Homestead	SPECIAL TAXES	TOTAL TAXES	PAID	WHEN PAID	Number of Receipt	Mar Settlement 1951	June Settlement 1951	November Settlement 1951	Penalty	Collections to First Monday in January 1952	Penalty	Delinquent on First Monday in January 1952	Total Delinquent Tax and Penalty	REMARKS				
		SUBDIVISION	Sec. or Lot	Town or Block	Rng.	Number of Acres of Land	LAND EXCLUSIVE OF IMPROVEMENTS	BUILDINGS AND OTHER STRUCTURES	MACHINERY PERMANENTLY ATTACHED TO REAL ESTATE	TOTAL TRUE AND FULL VALUE	RURAL		ALL OTHER		MACHINERY PERMANENTLY ATTACHED TO REAL ESTATE			TOTAL ASSESSED VALUE	Total Assessed Value as Equalized by the Board of Review	District No.	Rate	District No.	Rate																	District No.	Rate	District No.	Rate
											Up to \$4,000 20%	Over \$4,000 and Non-Homestead 33 1/3%	Up to \$4,000 25%	Over \$4,000 and Non-Homestead 40%																													
State of Minnesota		NE 1/4 of NE 1/4	4	139	26																																						
Moneta Improvement Co.		NW 1/4 of NE 1/4			40	07		264			80			88																													
State of Minnesota		SW 1/4 of NE 1/4						240																																			
State of Minnesota		SE 1/4 of NE 1/4																																									
Clover Land Co.		Lot 3			40	13		264			80			88																													
		Lot 4 part of Washburn "Quiss"						240																																			
Frank E. + Marie E. Lecher		SW 1/4 of NW 1/4			33	18		387			129			129																													
		Lot 5						351			117			129																													
W. A. Patterson		NW 1/4 of SW 1/4																																									
		NW 1/4 of SW 1/4																																									
Carl O. Hendrickson		Lot 7			36	15		225			75			83																													
Richard E. + Andre Sealge		part of NW 1/4 of Lot 10			1	88		42																																			
State of Minnesota		NE 1/4 of SE 1/4						39			190			226																													
Moneta Improvement Co.		Lot 6			25	16		450			165			165																													
Clem + Leone Nelles		Lot 8			21	12		231	216		149			165																													
		Lot 7 less 2.200'			39	57		108	180		130			149																													
Herbert + Ella L. Ott		2.200' of Lot 7						33			33			36																													

TOWN OF CROOKED LAKE, MINNESOTA, TAX MAP, 1950

Table with columns: IN WHOSE NAME ASSESSED, TO WHOM TRANSFERRED, DESCRIPTION OF PROPERTY, TRUE AND FULL VALUATIONS, ASSESSED VALUATIONS, VALUATIONS BY SCHOOL DISTRICTS AS EQUALIZED BY DEPARTMENT OF TAXATION, SOLD FOR TAXES, PAID, WHEN PAID, Number of Receipt, March Settlement 1951, June Settlement 1951, Penalty, November Settlement 1951, Collections to First Monday in January 1952, Delinquent on First Monday in January 1952, Total Delinquent Tax and Penalty, REMARKS. Includes handwritten entries for various lots and owners like Bert & Myrtle Mahlin, William D. Stiles, etc.

Assessment Roll and Tax List of Real Property in the Town of Crooked Lake

Cass County, Minnesota, for Taxes for the Year 1950.

IN WHOSE NAME ASSESSED	TO WHOM TRANSFERRED	DESCRIPTION OF PROPERTY					TRUE AND FULL VALUATIONS							FINAL EQUALIZED VALUE Dollars			
		SUBDIVISION	Sec of Lot	Town or Block	Rug.	Number of Acres of Land	LAND Exclusive of Structures and Improvements	BUILDINGS and Other Structures	MACHINERY Permanently Attached to Real Estate	ASSESSED VALUATIONS					Total Assessed Value as Equalized by the Board of Review		
										RURAL		ALL OTHER				MACHINERY Permanently Attached to Real Estate 33 1/3 %	TOTAL ASSESSED VALUE
										Homestead Up to \$4,000 20%	Over \$4,000 and Non-Homestead 33 1/3 %	Homestead Up to \$4,000 25%	Over \$4,000 and Non-Homestead 40%				
Williams D. Stiles	State of Minnesota	NE 1/4 of NE 1/4	6	139	26	40 10	207					63	67				
Clover Land Co.		NW 1/4 of NE 1/4 Lot 1				165					52	55					
Moneta Improvement Co.		SE 1/4 of NE 1/4			40	231					70	77					
		NE 1/4 of NW 1/4															
		NW 1/4 of NW 1/4															
Clover Land Co.		SW 1/4 of NW 1/4 Lot 3			32 22	198					60	66					
		SE 1/4 of NW 1/4															
Clover Land Co.		NE 1/4 of SE 1/4 Lot 4			49 60	420					127	140					
		NW 1/4 of SE 1/4				381											
		SW 1/4 of SE 1/4															
		SE 1/4 of SE 1/4															
Clover Land Co.		NE 1/4 of SE 1/4			40	198					60	66					
"	"	NW 1/4 of SE 1/4			40	180					60	66					
Geo. S. Thacker		SW 1/4 of SE 1/4 Lot 5			52 75	178					60	66					
William B. Cox		SE 1/4 of SE 1/4			40	198					60	66					
						180					60	66					
					363 85	2013					610	671					
						1830					610	671					

SOLD FOR TAXES	VALUATIONS BY SCHOOL DISTRICTS AS EQUALIZED BY DEPARTMENT OF TAXATION	Tax Including State Homestead	State Tax on Non-Homestead	SPECIAL TAXES	TOTAL TAXES	PAID	WHEN PAID	Number of Receipt	March Settlement 1951	June Settlement 1951	November Settlement 1951	Collections to First Monday in January 1952	Delinquent on First Monday in January 1952	Total Delinquent Tax and Penalty	REMARKS							
																District No.	District No.	District No.	District No.	District No.	District No.	District No.
																Rate	Rate	Rate	Rate	Rate	Rate	Rate
1	23 Mill		4.75 Mills		69										SOLD FOR TAXES							
2					55																	
3					77																	
4					66																	
5																						
6																						
7																						
8					140																	
9																						
10																						
11					66																	
12																						
13																						
14																						
15																						
16					66																	
17					66																	
18					66																	
19					66																	
20																						

WILSON'S PART OF... LAKESIDE BROOK... ROOSEVELT LAKE HEIGHTS... ROOSEVELT LAKE HEIGHTS







Assessment Roll and Tax List of Real Property in the Town of Crooked Lake

Cass County, Minnesota, for Taxes for the Year 1950.

IN WHOSE NAME ASSESSED	TO WHOM TRANSFERRED	DESCRIPTION OF PROPERTY	TRUE AND FULL VALUATIONS				ASSESSED VALUATIONS				FINAL EQUALIZED VALUE	SOLD FOR TAXES	VALUATIONS BY SCHOOL DISTRICTS AS EQUALIZED BY DEPARTMENT OF TAXATION						Tax including State Homestead	State Tax on Non-Homestead	SPECIAL TAXES	TOTAL TAXES	PAID	WHEN PAID	Number of Receipts	March Settlement 1951	June Settlement 1951	Penalty	November Settlement 1951	Penalty	Collections to First Monday in January 1952	Penalty	Delinquent on First Monday in January 1952	Total Delinquent Tax and Penalty	REMARKS
			LAND Exclusive of Structures and Improvements	BUILDINGS and Other Structures	MACHINERY Permanently Attached to Real Estate	TOTAL True and Full Value	RURAL Homestead Up to \$4,000 20%	Over \$4,000 and Non-Homestead 33 1/4%	ALL OTHER Homestead Up to \$1,000 25%	Over \$1,000 and Non-Homestead 40%			MACHINERY Permanently Attached to Real Estate 33 1/4%	TOTAL ASSESSED VALUE	Total Assessed Value as Equalized by the Board of Review	District No. 21	District No. 22	District No. 23																	
Ed Nyström		Lot 1 NW 1/4 of NE 1/4 SW 1/4 of NE 1/4	290 275 565	130 113	113	130			113	130		4130	2780	2780	PAID IN FULL MAY 1 2 1951	6172		2780																	
Lloyd A. Brown Lawrence L. + Naomi Tallander State of Minnesota State of Minnesota		Lot 2 E 1/4 of Lot 5 except E 15' of W 1/2 83' plus E 15' of E 1/2 of W 1/2 225'	350 66 61 417 378 785	100 888 740 139 126 139	150 318 267 126	168 318	150	168	150	168		168	3594	74 3668	PAID IN FULL JAN 24 1951	430		6942	6942													3668			
Harold L. + Eva L. Hamilton State of Minnesota		Lot 8 Lot 9 E 15' of E 65' of W 1/2 225' of Lot 5	280 15 15 417 378	276 5 5 139 126	170 5 5	195 5		170	195		195	4170	86 4256	PAID IN FULL MAY 3 1 1951	8408		4256	4256																	
Fred C. + Mae Hitz State of Minnesota		Lot 6 Lot 7 Lot 5 less E. 264'	270 246 246 30 10 375	90 82 82 11 11 138	90 90			90	90		90	1924	40 1964	PAID IN FULL MAY 3 1 1951	8418		1964	1964																	
John W. + Katherine H. Walters Alfie Wilson Lloyd A. Brown		E 15' of W 1/2 83' of Lot 5 Lot 3 NW 1/4 of SE 1/4 SW 1/4 of SE 1/4	30 30 375 414 375	10 11 138 125	10 11			10	11		10	236	06 242	PAID IN FULL MAY 1 6 1951	6776		242	242														1210 133			
Lloyd A. Brown Henrietta Hitz		Lot 4 E 15' of E 65' of W 1/2 160' of Lot 5	414 375 15 15 2657 2415	138 125 5 5 130 113	125 131			125	131		131	2952	60 3012				3012	3012														3012			
			26380	1178	1337			1178	1337		1337	26594	532 29126				29126	29126														9813			

TOWN OF CROOKED LAKE  
 CASS COUNTY, MINN.  
 TAX MAP  
 JOHN W. WALTERS  
 LAND SURVEYOR  
 TALL MOUNTAIN SURVEYING  
 ROOSEVELT FRATTS  
 DWAIN HEIGLINS  
 TALLEY FLOES  
 ROOSEVELT LAKE HEIGHTS







Assessment Roll and Tax List of Real Property in the Town of Crooked Lake

Cass County, Minnesota, for Taxes for the Year 1950.

IN WHOSE NAME ASSESSED	TO WHOM TRANSFERRED	DESCRIPTION OF PROPERTY		TRUE AND FULL VALUATIONS					ASSESSED VALUATIONS					FINAL EQUALIZED VALUE	SOLD FOR TAXES	VALUATIONS BY SCHOOL DISTRICTS AS EQUALIZED BY DEPARTMENT OF TAXATION						SPECIAL TAXES	TOTAL TAXES	PAID	WHEN PAID	Number of Receipts	March Settlement 1951	June Settlement 1951	Penalty	November Settlement 1951	Penalty	Collections to First Monday in January 1952	Penalty	Delinquent on First Monday in January 1952	Total Delinquent Tax and Penalty	REMARKS												
		SUBDIVISION	Sec. or Lot	Town or Block	Rng.	Number of Acres of Land	LAND Exclusive of Structures and Improvements	BUILDINGS and Other Structures	MACHINERY Permanently Attached to Real Estate	TOTAL True and Full Value	RURAL		ALL OTHER			MACHINERY Permanently Attached to Real Estate	TOTAL ASSESSED VALUE	Total Assessed Value as Equalized by the Board of Review	District No.	Rate	District No.																Rate	District No.	Rate	District No.	Rate							
											Acres (80th)	Dollars	Dollars																													Dollars	Dollars	Dollars	Dollars	Dollars	Dollars	Dollars
State of Minnesota		NE 1/4 of NE 1/4	13	139	26																																											
State of Minnesota		NW 1/4 of NE 1/4																																														
State of Minnesota		SW 1/4 of NE 1/4																																														
State of Minnesota		SE 1/4 of NE 1/4																																														
Robert L. Rogers		W 1/2 of NE 1/4 of SW 1/4				20	105	117	105		39	35		35	39		39						834	18		852		5	PAID IN FULL	MAY 9 1951	8396		852															
State of Minnesota		NE 1/4 of NW 1/4																																														
State of Minnesota		NW 1/4 of NW 1/4																																														
State of Minnesota		SW 1/4 of NW 1/4																																														
State of Minnesota		SE 1/4 of NW 1/4																																														
Robert L. Rogers		W 1/2 of SE 1/4 of SW 1/4				20	105	117	105		39	35		35	39		39						834	18		852		10																				
Nathanial J. & Ida York		E 1/2 of NW 1/4 of SW 1/4				20	105	117	105		39	35		35	39		39						834	18		852		11	PAID IN FULL	MAY 2 5 1951	752		852															
Bear Ridge Land Co.		W 1/2 of NW 1/4 of SW 1/4				20	105	117	105		39	35		35	39		39						834	18		852		12	PAID IN FULL	MAY 8 1951	6281		852															
"		SW 1/4 of SW 1/4				40	231	231	210		77	70		70	77		77						1646	34		1680		13	2nd Half Paid	OCT 2 8 1951	13468		840		840													
Nathanial J. & Ida York		E 1/2 of SE 1/4 of SW 1/4				20	105	117	105		39	35		35	39		39						834	18		852		14	PAID IN FULL	MAY 2 6 1951	1152		852															
Norold C. & Grace M. Ehlers		E 1/2 of NW 1/4 of SW 1/4				20	105	117	105		39	35		35	39		39						834	18		852		15	2nd Half Paid	OCT 2 9 1951	13608		852															
State of Minnesota		NE 1/4 of SE 1/4																																														
State of Minnesota		NW 1/4 of SE 1/4																																														
State of Minnesota		E 1/2 of SW 1/4 of SE 1/4																																														
State of Minnesota		SE 1/4 of SE 1/4																																														
Frank Miller & Leo & Bertie Bittola		W 1/2 of SW 1/4 of SE 1/4				20	190	210	143		50	48		48	54		48						1154	42		1154		20																				
						180	1143	1203	1080		54	48		48	54		48						7804	142		7946																						

TOWN OF CROOKED LAKE  
 TOWN CLERK  
 ROOSEVELT TRAILS MANA HEIGHTS  
 ROOSEVELT TRAILS MANA HEIGHTS  
 ROOSEVELT TRAILS MANA HEIGHTS



IN WHOSE NAME ASSESSED	TO WHOM TRANSFERRED	DESCRIPTION OF PROPERTY					No. School District	Indicate Homestead Yes or No	Indicate Agricultural Yes or No	TRUE AND FULL VALUATIONS							ASSESSED VALUATIONS						FINAL EQUALIZED VALUE	SOLD FOR TAXES	VALUATIONS BY SCHOOL DISTRICTS AS EQUALIZED BY DEPARTMENT OF TAXATION							Tax including State Homestead	State Tax on Non-Homestead	SPECIAL TAXES	TOTAL TAXES	PAID	WHEN PAID	Number of Receipt	March Settlement 1951	June Settlement 1951	Penalty 1951	November Settlement 1951	Penalty 1951	Collections to First Monday in January 1952	Penalty	Delinquent on First Monday in January 1952	Total Delinquent Tax and Penalty	REMARKS				
		SUBDIVISION	Sec. or Lot	Town or Block	Rng.	Number of Acres of Land				LAND Exclusive of Structures and Improvements	BUILDINGS and Other Structures	MACHINERY Permanently Attached to Real Estate	TOTAL True and Full Value	RURAL			ALL OTHER			MACHINERY Permanently Attached to Real Estate	TOTAL ASSESSED VALUE	Total Assessed Value as Equalized by the Board of Review			EQUALIZED BY DEPARTMENT OF TAXATION																											
														Acres	100ths	Homestead Up to \$4,000 20%	Over \$4,000 and Non-Homestead 33 1/3%	Homestead Up to \$4,000 25%	Over \$4,000 and Non-Homestead 40%						Mills	Mills	Mills	Mills	Mills	Mills	Mills																		Mills	Mills	Mills	Mills
Bjorne + Orna M. Anderson		NE 1/4 of NE 1/4	15	139	26	40		Yes		230	210	46			42	46		1	H 46	984			984	1	PAID IN FULL MAY 3 1951																											
E. F. Anderson	State of Minnesota	NW 1/4 of NE 1/4				40		No		231	210			70		70		2	SOLD FOR TAXES 77	1646	34		1680	2	Forfeited																16.80 cancelled											
	State of Minnesota	SE 1/4 of NE 1/4				40												3	SOLD FOR TAXES					3	Forfeited																											
U. S. of America		SE 1/4 of NE 1/4				40												4						4																												
																		5						5																												
E. F. Anderson		NE 1/4 of NW 1/4				40		No		231	210			70		70		6	SOLD FOR TAXES 77	1646	34		1680	6																				46.80								
"	"	NW 1/4 of NW 1/4				40		No		231	210			70		70		7	SOLD FOR TAXES 77	1646	34		1680	7																				46.80								
State of Minnesota		SE 1/4 of NW 1/4																8						8																												
State of Minnesota		SE 1/4 of NW 1/4																9						9																												
																		10						10																												
State of Minnesota		NE 1/4 of SE 1/4																11						11																												
State of Minnesota		NW 1/4 of SE 1/4																12						12																												
State of Minnesota		SE 1/4 of SE 1/4																13						13																												
State of Minnesota		SE 1/4 of SE 1/4																14						14																												
																		15						15																												
E. L. + Pearl D. Ihon		NE 1/4 of SE 1/4				40		Yes		230	210	46			42	46		16	SOLD FOR TAXES H 46	984			984	16																				984/1082								
State of Minnesota		NW 1/4 of SE 1/4																17						17																												
Edward F. + Lodye E. Meyer		SE 1/4 of SE 1/4				40		No		219	198			73	66	73		18		73	75.62	32		1594	18	PAID IN FULL MAY 15 1951 65-93																			1594							
Clifford L. + Pearl Ihon		SE 1/4 of SE 1/4				40		Yes		200	180	198.00	436		366	436		19	SOLD FOR TAXES H 436	9324			9324	19																			9324/10252									
																		20						20																												
										1572	1428	1980	436		726	832				H 558	17792	134		17926																			2578		13668	16.80						

ROOSEVELT LATE HEIGHTS ROOSEVELT EARLY HEIGHTS ROOSEVELT EARLY HEIGHTS ROOSEVELT EARLY HEIGHTS









Assessment Roll and Tax List of Real Property in the Town of Crooked Lake

Cass County, Minnesota, for Taxes for the Year 1950.

Main table with columns: IN WHOSE NAME ASSESSED, TO WHOM TRANSFERRED, DESCRIPTION OF PROPERTY, TRUE AND FULL VALUATIONS, ASSESSED VALUATIONS, VALUATIONS BY SCHOOL DISTRICTS AS EQUALIZED BY DEPARTMENT OF TAXATION, TAXES, PAID, WHEN PAID, and REMARKS.

ROOSEVELT LANE HEIGHTS, CROOKED LAKE, MINN.

Assessment Roll and Tax List of Real Property in the Town of Crooked Lake

Table with columns: IN WHOSE NAME ASSESSED, TO WHOM TRANSFERRED, DESCRIPTION OF PROPERTY, TRUE AND FULL VALUATIONS, ASSESSED VALUATIONS, FINAL EQUALIZED VALUE.

360 1863 1701 1863 1701 621 567 621 567

Cass County, Minnesota, for Taxes for the Year 1950.

Table with columns: SOLD FOR TAXES, VALUATIONS BY SCHOOL DISTRICTS AS EQUALIZED BY DEPARTMENT OF TAXATION, SPECIAL TAXES, TOTAL TAXES, PAID, WHEN PAID, Number of Receipt, March Settlement 1951, June Settlement 1951, Penalty, November Settlement 1951, Penalty, Collections to First Monday in January 1952, Penalty, Delinquent on First Monday in January 1952, Total Delinquent Tax and Penalty, REMARKS.

621 13284 270 13554 5271 3765 4518

WILSON'S PLAT OF L.A.E. HIGHLAND HEIGHTS ROOSEVELT HEIGHTS WANA HEIGHTS ROOSEVELT LAKE HEIGHTS





Assessment Roll and Tax List of Real Property in the Town of Crooked Lake

Cass County, Minnesota, for Taxes for the Year 1950.

Table with columns: IN WHOSE NAME ADRESSED, TO WHOM TRANSFERRED, DESCRIPTION OF PROPERTY, TRUE AND FULL VALUATIONS (LAND, BUILDINGS, MACHINERY, TOTAL), ASSESSED VALUATIONS (RURAL, ALL OTHER, MACHINERY, TOTAL ASSESSED VALUE), and FINAL EQUALIZED VALUE.

Table with columns: VALUATIONS BY SCHOOL DISTRICTS AS EQUALIZED BY DEPARTMENT OF TAXATION (District No., Rate, etc.), Tax including State Homestead, State Tax on Non-Homestead, SPECIAL TAXES, TOTAL TAXES, PAID, WHEN PAID, Number of Receipt, March Settlement, June Settlement, November Settlement, Penalties, Collections to First Monday in January 1952, Delinquent on First Monday in January 1952, Total Delinquent Tax and Penalty, and REMARKS.

ROOSEVELT LAKE HEIGHTS





IN WHOSE NAME ASSESSED TO WHOM TRANSFERRED

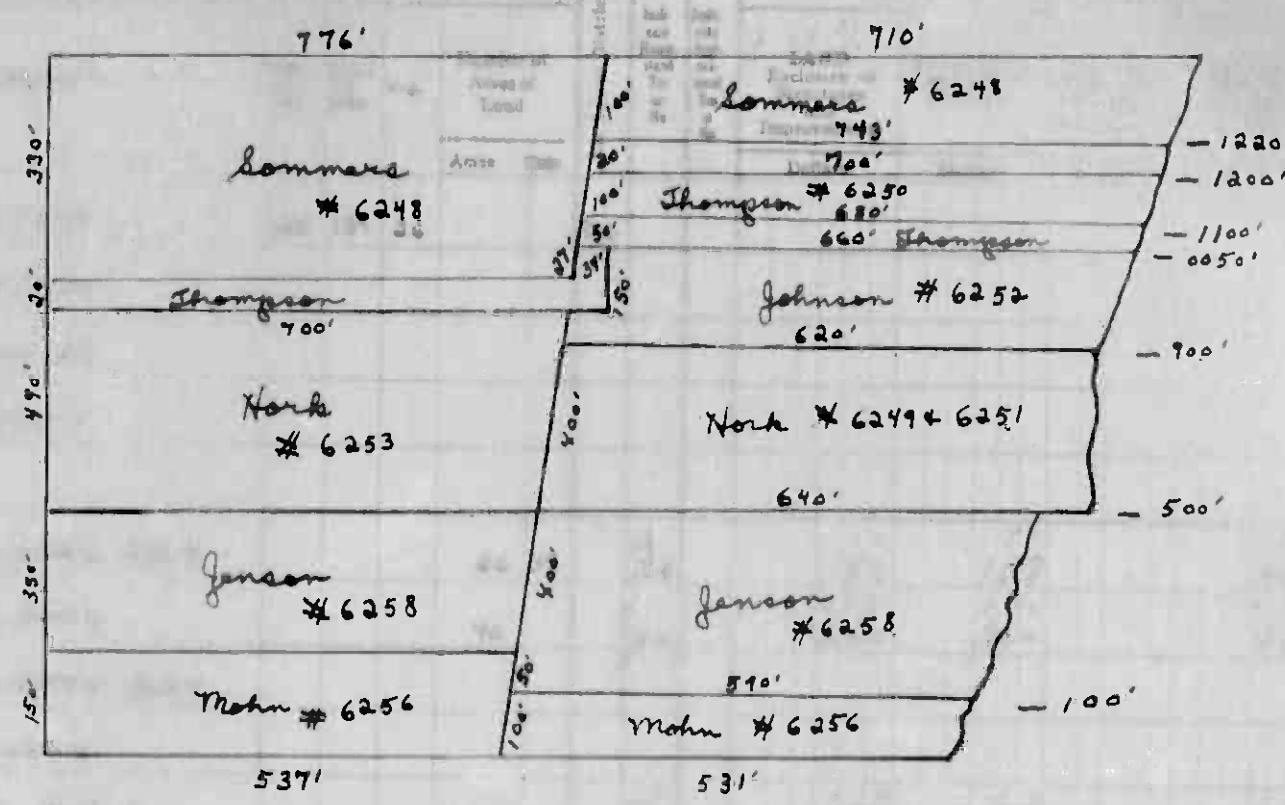

ASSESSED VALUATIONS

RURAL	ALL OTHER	MACHINERY	TOTAL	Total Assessed	FINAL
Over \$4,000 and Non-Homestead 20%	Over \$4,000 and Non-Homestead 25%	Permanently Attached to Real Estate 33 1/3%	ASSESSED VALUE	Value as Equalized by the Board of Review	EQUALIZED VALUE
Dollars	Dollars	Dollars	Dollars	Dollars	Dollars
133	116		116	133	
101	88		88	101	
72	64		64	72	
87	78		78	87	
125	105		105	125	
22	20		20	22	
78	60		60	78	
176	152		152	176	
226	193		193	226	
490	490		490	490	
683	786		786	683	

VALUATIONS BY SCHOOL DISTRICTS AS EQUALIZED BY DEPARTMENT OF TAXATION						Tax Including State Homestead	State Tax on Non-Homestead	SPECIAL TAXES	TOTAL TAXES	PAID	WHEN PAID	Number of Receipt	March Settlement 1951	June Settlement 1951	Penalty	November Settlement 1951	Penalty	Collections to First Monday in January 1952	Penalty	Delinquent on First Monday in January 1952	Total Delinquent Tax and Penalty	REMARKS
District No.	District No.	District No.	District No.	District No.	District No.	\$	\$	\$	\$		Month Day Year		\$	\$	\$	\$	\$	\$	\$	\$	\$	
1										1												
2										2												
3										3												
4										4												
5										5												
6	133					28.44	58		29.02	6	PAID IN FULL MAR 7 1951	3279		29.02								
7	101					21.60			21.60	7	PAID IN FULL MAY 15 1951	1761		21.60								
8										8												
9										9												
10	72					15.40	32		15.72	10	PAID IN FULL DEC 3 1 1951	15318					15.72	126				
11	87					18.60	38		18.98	11	2nd Half Paid OCT 8 1951	12877								18.98	2088	
12	125					26.74			26.74	12	2nd Half Paid APR 10 1951	4433		13.37		13.37						
13										13												
14	22					4.70	18		4.80	14											4.80	528
15										15												
16										16												
17										17												
18	78					14.98	30		15.28	18	PAID IN FULL MAY 2 5 1951	7153		15.28								
19										19												
20	176					37.64	78		38.42	20												
	226																					
	490																					
	683																					
	786																					
	168.40					2.46			170.86					179.27		13.37		15.72		62.30		

This map is not drawn to scale & is not considered accurate.

Ray W. & Alice E. Schimmel  
 Clyde Rowen  
 State of Minnesota  
 Allen & Ruby Sommers  
 Larry Hork  
 Peter C. & Selma O. Thompson  
 Victor E. & Edna O. Johnson  
 Ingvald & Bertha Mohn  
 John Frederick Jansen



Assessment Roll and Tax List of Real Property in the Town of Crooked Lake

Cass County, Minnesota, for Taxes for the Year 1950.

IN WHOSE NAME ASSESSED	TO WHOM TRANSFERRED	DESCRIPTION OF PROPERTY					TRUE AND FULL VALUATIONS										FINAL EQUALIZED VALUE	
		SUBDIVISION	Sec. of Lot	Town or Block	No. of Acres of Land	No. School District	LAND EXCLUSIVE OF STRUCTURES AND IMPROVEMENTS	BUILDINGS AND OTHER STRUCTURES	MACHINERY Permanently Attached to Real Estate	TOTAL True and Full Value	RURAL		ALL OTHER		MACHINERY Permanently Attached to Real Estate	TOTAL ASSESSED VALUE		Total Assessed Value as Equalized by the Board of Review
											Over \$4,000 Homestead Up to \$4,000 20%	Over \$4,000 and Non-Homestead 33 1/3%	Homestead Up to \$4,000 25%	Over \$4,000 and Non-Homestead 40%				
State of Minnesota		NE 1/4 of NE 1/4	24	139	26													
Carl O. R. Edberg + George Pittalla		NW 1/4 of NE 1/4			40		363	30	393		131				118	131		
State of Minnesota		SW 1/4 of NE 1/4					330	24	354		118							
State of Minnesota		SE 1/4 of NE 1/4																
Carl Edberg		NE 1/4 SW 1/4			40		273		273		91				93	91		
Henry H. Young		NW 1/4 of NW 1/4			40		249		249		58				53	58		
Justin J. + Anna Frolich		SW 1/4 of NW 1/4			40		159		159		53				53	58		
State of Minnesota		SE 1/4 of NW 1/4			40		175	35	160	32					32	35		
Ralph Ode		NE 1/4 of SW 1/4			40		189		171		63				57	63		
State of Minnesota		NW 1/4 of SW 1/4																
Edward E. + Della Schermacher		SW 1/4 of SW 1/4			40		198		180		66				60	66		
State of Minnesota		SE 1/4 of SW 1/4																
H. J. Co.		NE 1/4 of SE 1/4			40		198		180		66				60	66		
State of Minnesota		NW 1/4 of SE 1/4																
State of Minnesota		SW 1/4 of SE 1/4			23	64	174		159		58				53	58		
H. J. Co.		SE 1/4 of SE 1/4																
				30364			1744	130	1774	35	533				516	568		
							1588	24	1612	32	484							

SOLD FOR TAXES	VALUATIONS BY SCHOOL DISTRICTS AS EQUALIZED BY DEPARTMENT OF TAXATION						Tax including State Homestead	State Tax on Non-Homestead	SPECIAL TAXES	TOTAL TAXES	PAID	WHEN PAID	Number of Receipt	March Settlement 1951	June Settlement 1951	Penalty	November Settlement 1951	Penalty	Collection to First Monday in January 1952	Penalty	Delinquent on First Monday in January 1952	Total Delinquent Tax and Penalty	REMARKS
	District No.	District No.	District No.	District No.	District No.	District No.																	
	Rate	Rate	Rate	Rate	Rate	Rate																	
	1																						
	2						2802	38		2860	2	PAID IN FULL JUL 27 1951	1144										2860 42
	3																						
	4																						
	5																						
	6						1946	40		1986	6	PAID IN FULL JUL 17 1951	1144										1986 30
	7						1240	26		1266	7	PAID IN FULL											
	8						748			748	8	PAID IN FULL JUL 27 1951	2839										748
	9																						
	10																						
	11						1348	28		1376	11	PAID IN FULL											
	12																						
	13						1412	30		1442	13	PAID IN FULL MAY 2 5 1951	7155										1442
	14																						
	15																						
	16						1412	30		1442	16	PAID IN FULL MAY 3 1 1951	8407										1442
	17																						
	18																						
	19						1240	26		1266	19	PAID IN FULL MAY 3 1 1951	8407										1266
	20																						
							12148	238		12386													4150
																							5594
																							26420

ROOSEVELT LAKE HEIGHTS ROOSEVELT HEIGHTS



Assessment Roll and Tax List of Real Property in the Town of Crooked Lake

Cass County, Minnesota, for Taxes for the Year 1950.

IN WHOSE NAME ASSESSED	TO WHOM TRANSFERRED	DESCRIPTION OF PROPERTY				TRUE AND FULL VALUATIONS				ASSESSED VALUATIONS					FINAL EQUALIZED VALUE			
		SUBDIVISION	Sec. or Lot	Town or Block	Rng.	Number of Acres of Land	LAND Exclusive of Structures and Improvements	BUILDINGS and Other Structures	MACHINERY Permanently Attached to Real Estate	TOTAL True and Full Value	RURAL		ALL OTHER			MACHINERY Permanently Attached to Real Estate	TOTAL ASSESSED VALUE	Total Assessed Value as Equalized by the Board of Review
											Acres	100ths	Homestead Up to \$4,000 20%	Over \$4,000 and Non-Homestead 33 1/3%				
Floyd C. + Shelma M. Simmons	State of Minnesota	NE 1/4 of NE 1/4	27	131	26	40	231 310		231 216	27				70	21			
H. S. Wilson, O. A. Olson + C. A. Appelton	State of Minnesota	SW 1/4 of NE 1/4				40	174 159		174 159					53	58			
Chas. B. + Marie Baenziger	State of Minnesota	SW 1/4 of NW 1/4				2 80	90 80	456 379	90 459					182	282			
Clover Land Co.	State of Minnesota	SE 1/4 of NW 1/4				40	198 180		198 180	60				60	66			
State of Minnesota	State of Minnesota	NE 1/4 of SW 1/4				40	172 174		172 174	64				58	64			
State of Minnesota	State of Minnesota	NW 1/4 of SW 1/4																
State of Minnesota	State of Minnesota	SW 1/4 of SW 1/4																
State of Minnesota	State of Minnesota	SE 1/4 of SW 1/4																
State of Minnesota	State of Minnesota	NE 1/4 of SE 1/4																
Samuel D. Williams	State of Minnesota	NW 1/4 of SE 1/4				40	216 195		216 195	72				65	72			
State of Minnesota	State of Minnesota	SW 1/4 of SE 1/4				40	198 180		198 180	76				68	66			
State of Minnesota	State of Minnesota	SE 1/4 of SE 1/4																
						242 80	1299 1178	456 379	1755 1557	585 519				519	585			

SOLD FOR TAXES	VALUATIONS BY SCHOOL DISTRICTS AS EQUALIZED BY DEPARTMENT OF TAXATION						Tax including State Homestead	State Tax on Non-Homestead	SPECIAL TAXES	TOTAL TAXES	PAID	WHEN PAID	Number of Receipts	March Settlement 1951	June Settlement 1951	Penalty	November Settlement 1951	Penalty	Collections to First Monday in January 1952	Penalty	Delinquent on First Monday in January 1952	Total Delinquent Tax and Penalty	REMARKS	
	District No.	District Rate	District No.	District Rate	District No.	District Rate																		
	Dollars	Dollars	Dollars	Dollars	Dollars	Dollars																		
1	9	22	22				4.40		16 46	34	16 80	2nd Half Paid OCT 28 1951 1st Half Paid MAY 31 1951	3483 3379		240	840								
2																								
3	58								12 40	26	12 66	PAID IN FULL APR 23 1951	4801		12 66									
4			182						41 60	80	42 40	PAID IN FULL MAY 31 1951	8411		42 40									
9	66								14 12	30	14 42										14 40			
11	64								13 68	28	13 96										13 96			
16	72								15 40	32	15 72	2nd Half Paid OCT 23 1951 1st Half Paid MAY 31 1951	3566 3324		786	786								
18	66								14 12	30	14 42	2nd Half Paid OCT 23 1951 1st Half Paid MAY 31 1951	3566 3324		224	721								
20	403		182 = 585						86 18 41 66	260	127 84				28 57	23 47					28 38			

ROOSEVELT HRS. - LIABLE PROS. - AVAIL. PROS. - ROOSEVELT HRS. - AVAIL. PROS. - ROOSEVELT HRS. - AVAIL. PROS.

Assessment Roll and Tax List of Real Property in the Town of Crooked Lake

Cass County, Minnesota, for Taxes for the Year 1950.

Table with columns: IN WHOSE NAME ASSESSED, TO WHOM TRANSFERRED, DESCRIPTION OF PROPERTY, TRUE AND FULL VALUATIONS (LAND, BUILDINGS, MACHINERY, TOTAL), ASSESSED VALUATIONS (RURAL, ALL OTHER, MACHINERY, TOTAL), FINAL EQUALIZED VALUE.

2796 1072 4097 5169 795 398 4384 674 338 1012 1193

Table with columns: SOLD FOR TAXES, VALUATIONS BY SCHOOL DISTRICTS AS EQUALIZED BY DEPARTMENT OF TAXATION, Tax including State Homestead, State Tax on Non-Homestead, SPECIAL TAXES, TOTAL TAXES, PAID, WHEN PAID, Number of Receipt, March Settlement 1951, June Settlement 1951, Penalty, November Settlement 1951, Collections to First Monday in January 1952, Delinquent on First Monday in January 1952, Total Delinquent Tax and Penalty, REMARKS.

14 181 795 834 26412 176 27422 100 3982 13346

TOWN'S PART OF T. 156 N. 1/2 R. 10 W. 1/2 ROSSELL BROOKS, ROSSELL HEALTS, WAVA HEIGHTS, ROSSELL LAKE HEIGHTS

Assessment Roll and Tax List of Real Property in the Town of Crooked Lake

Table with columns: IN WHOSE NAME ASSESSED, TO WHOM TRANSFERRED, DESCRIPTION OF PROPERTY, TRUE AND FULL VALUATIONS, ASSESSED VALUATIONS, FINAL EQUALIZED VALUE. Includes rows for State of Minnesota with various subdivisions like NE 1/4 of NE 1/4.

Cass County, Minnesota, for Taxes for the Year 1950.

Table with columns: SOLD FOR TAXES, VALUATIONS BY SCHOOL DISTRICTS AS EQUALIZED BY DEPARTMENT OF TAXATION, SPECIAL TAXES, TOTAL TAXES, PAID, WHEN PAID, Number of Receipts, March Settlement 1951, June Settlement 1951, Penalty, November Settlement 1951, Penalty, Collections to First Monday in January 1952, Penalty, Delinquent on First Monday in January 1952, Total Delinquent Tax and Penalty, REMARKS. Includes rows 1 through 20.

Vertical text on the right edge of the page, possibly a page number or reference: 101'S PLAT OF... ILLICIAE BROS... ROOSEVELT PLATS... WANA HEIGERS... ROOSEVELT LAKE HEIGERS

Assessment Roll and Tax List of Real Property in the Town of Crooked Lake

Cass County, Minnesota, for Taxes for the Year 1950.

IN WHOSE NAME ASSESSED	TO WHOM TRANSFERRED	DESCRIPTION OF PROPERTY						TRUE AND FULL VALUATIONS										FINAL EQUALIZED VALUE	SOLD FOR TAXES	VALUATIONS BY SCHOOL DISTRICTS AS EQUALIZED BY DEPARTMENT OF TAXATION						TAX INCLUDING STATE HOMESTEAD	STATE TAX ON NON-HOMESTEAD	SPECIAL TAXES	TOTAL TAXES	PAID	WHEN PAID	Number of Receipt	March Settlement 1951	June Settlement 1951	Penalty	November Settlement 1951	Penalty	Collection to First Monday in January 1952	Penalty	Delinquent on First Monday in January 1952	Total Delinquent Tax and Penalty	REMARKS			
		SUBDIVISION	Sec. of Lot	Town or Block	Rdg.	Number of Acres of Land	No. School District	Indicate Homestead Yes or No	Indicate Agricultural Yes or No	LAND Exclusive of Structures and Improvements	BUILDINGS and Other Structures	MACHINERY Permanently Attached to Real Estate	TOTAL True and Full Value	RURAL		ALL OTHER				MACHINERY Permanently Attached to Real Estate	TOTAL ASSESSED VALUE	Total Assessed Value as Equalized by the Board of Review	District No.	District No.	District No.																		District No.	District No.	District No.
														Homestead Up to \$4,000 20%	Over \$4,000 and Non-Homestead 33 1/3%	Homestead Up to \$4,000 25%	Over \$4,000 and Non-Homestead 40%																												
State of Minnesota		NE 1/4 of NE 1/4	1	139	36	24																																							
State of Minnesota		NW 1/4 of NE 1/4																																											
State of Minnesota		SW 1/4 of NE 1/4																																											
State of Minnesota		SE 1/4 of NE 1/4																																											
State of Minnesota		NE 1/4 of NW 1/4																																											
Monta Improvement Co.		NW 1/4 of NW 1/4			40	20		198	180		178	180		66	60		60	66																											
State of Minnesota		SW 1/4 of NW 1/4																																											
State of Minnesota		SE 1/4 of NW 1/4																																											
State of Minnesota		NE 1/4 of SW 1/4																																											
State of Minnesota		NW 1/4 of SW 1/4																																											
State of Minnesota		SW 1/4 of SW 1/4																																											
State of Minnesota		SE 1/4 of SW 1/4																																											
State of Minnesota		NE 1/4 of SE 1/4																																											
State of Minnesota		NW 1/4 of SE 1/4																																											
State of Minnesota		SW 1/4 of SE 1/4																																											
State of Minnesota		SE 1/4 of SE 1/4																																											
State of Minnesota								198	180		178	180		66	60		60	66																											

2nd Half Paid OCT 31 1951 151.93  
1st Half Paid MAY 31 1951 112.57  
721 ✓ 721 ✓

ROOSEVELT LAKE HEIGHTS



Table with columns: IN WHOSE NAME ASSESSED, TO WHOM TRANSFERRED, SUBDIVISION, TRUE AND FULL VALUATIONS, ASSESSED VALUATION'S, VALUATIONS BY SCHOOL DISTRICTS AS EQUALIZED BY DEPARTMENT OF TALEATION, TAXES, PAID, WHEN PAID, Number of Receipts, etc.

ROOSEVELT LANE HEIGHTS ROOSEVELT HILLS WANA HEIGHTS

Assessment Roll and Tax List of Real Property in the Town of Crooked Lake

Cass County, Minnesota, for Taxes for the Year 1950.

IN WHOSE NAME ASSESSED	TO WHOM TRANSFERRED	DESCRIPTION OF PROPERTY				No. School District	Indicate Homestead Exemption or No.	Indicate Agricultural Tax or No.	TRUE AND FULL VALUATIONS					ASSESSED VALUATIONS					FINAL EQUALIZED VALUE	SOLD FOR TAXES	VALUATIONS BY SCHOOL DISTRICTS AS EQUALIZED BY DEPARTMENT OF TAXATION						Tax including State Homestead	State Tax on Non-Homestead	SPECIAL TAXES	TOTAL TAXES	PAID	WHEN PAID	Number of Receipts	March Settlement 1951	June Settlement 1951	November Settlement 1951	Penalty	Collections to First Monday in January 1952	Penalty	Delinquent on First Monday in January 1952	Total Delinquent Tax and Penalty	REMARKS			
		SUBDIVISION	Sec. or Lot	Town or Block	No. Acres				LAND EXCLUSIVE OF STRUCTURES AND IMPROVEMENTS	BUILDINGS AND OTHER STRUCTURES	MACHINERY PERMANENTLY ATTACHED TO REAL ESTATE	TOTAL True and Full Value	RURAL		ALL OTHER		MACHINERY Permanently Attached to Real Estate	TOTAL ASSESSED VALUE			Total Assessed Value as Equalized by the Board of Review	District No.	District Rate	District No.	District Rate	District No.																	District Rate	District No.	District Rate
													Homestead Up to \$4,000	Over \$4,000 and Non-Homestead	Homestead Up to \$4,000	Over \$4,000 and Non-Homestead																													
													20%	33 1/3%	25%	40%																													
Moneta Improvement Co.	"	NE 1/4 of NE 1/4	31	139	26	40	198		60			180	60	66	1	66							1412	30	1442	2nd Half Paid OCT 31 1951	5775		721																
"	"	NW 1/4 of NE 1/4				40	198		60			180	60	66	2	66							1412	30	1442	1st Half Paid MAY 31 1951	5775		721																
State of Minnesota		SW 1/4 of NE 1/4													3																														
Moneta Improvement Co.		SE 1/4 of NE 1/4				40	198		60			180	60	66	4	66							1412	30	1442	2nd Half Paid OCT 31 1951	5775		721																
"	"	NE 1/4 of NW 1/4				40	198		60			180	60	66	5	66							1412	30	1442	1st Half Paid OCT 31 1951	5775		721																
State of Minnesota		NW 1/4 of NW 1/4													6																														
State of Minnesota		SW 1/4 of NW 1/4													7																														
State of Minnesota		SE 1/4 of NW 1/4													8																														
															9																														
															10																														
A.C. Kaveli		SW 1/4 of SW 1/4 Lot 3				36	198		60			180	60	66	11	66							1412	30	1442	Balance Paid AUG 7 1951	12088																		
"		NW 1/4 of SW 1/4 Lot 1				39	198		60			180	60	66	12	66							1412	30	1442	1st Half Paid MAY 31 1951	8390		721																
"		SW 1/4 of SW 1/4 Lot 2				41-32	198		60			180	60	66	13	66							1412	30	1442	Balance Paid AUG 7 1951	8390		721																
"		SE 1/4 of SW 1/4													14																														
"		NE 1/4 of SE 1/4				40	198		60			180	60	66	15	66																													
"		NW 1/4 of SE 1/4				49	198		60			189	60	69	16	69							1412	30	1442	Balance Paid AUG 7 1951	12088		721																
"		SW 1/4 of SE 1/4				49	198		60			189	60	69	17	69							1476	30	1506	Balance Paid AUG 7 1951	12088		721																
"		SE 1/4 of SE 1/4				33	198		60			180	60	66	18	66																													
"		SE 1/4 of SE 1/4 Lot 5				33	198		60			180	60	66	19	66							1412	30	1442	Balance Paid AUG 7 1951	12088		721																
						400	1989		603			1809	603	663	20	663							14184	300	14484				7242		7192														

ROOSEVELT LATE HEIGHTS





Table with columns: IN WHOSE NAME ASSESSED, TO WHOM TRANSFERRED, DESCRIPTION OF PROPERTY, TRUE AND FULL VALUATIONS, ASSESSED VALUATIONS, FINAL EQUALIZED VALUE.

Table with columns: SOLD FOR TAXES, VALUATIONS BY SCHOOL DISTRICTS AS EQUALIZED BY DEPARTMENT OF TAXATION, Tax Including State Homestead, State Tax on Non-Homestead, SPECIAL TAXES, TOTAL TAXES, PAID, WHEN PAID, Number of Receipt, March Settlement 1951, June Settlement 1951, Penalty, November Settlement 1951, Collections to First Monday in January 1952, Delinquent on First Monday in January 1952, Total Delinquent Tax and Penalty, REMARKS.

Assessment Roll and Tax List of Real Property in the Town of Crooked Lake

Cass County, Minnesota, for Taxes for the Year 1950.

Table with columns for IN WHOSE NAME ASSESSED, TO WHOM TRANSFERRED, DESCRIPTION OF PROPERTY, TRUE AND FULL VALUATIONS, ASSESSED VALUATIONS, VALUATIONS BY SCHOOL DISTRICTS AS EQUALIZED BY DEPARTMENT OF TAXATION, TAXES, PAID, WHEN PAID, and REMARKS. Includes entries for Harry H. + Maybelle Wells, Wm. D. Stiles, Leo. H. + Frances A. Stauff, Clarence Lohse, State of Minnesota, Ambrose Amolini, Harry G. + Maybelle Wells, and Bernard E. + Olga E. Dixon.

Assessment Roll and Tax List of Real Property in the Town of Crooked Lake

Cass County, Minnesota, for Taxes for the Year 1950.

Main table with columns: IN WHOM NAME ASSESSED, TO WHOM TRANSFERRED, DESCRIPTION OF PROPERTY, TRUE AND FULL VALUATIONS, ASSESSED VALUATIONS, VALUATIONS BY SCHOOL DISTRICTS AS EQUALIZED BY DEPARTMENT OF TAXATION, TAXES, PAID, WHEN PAID, Number of Receipt, etc.

Grand Total 990099

ROOSEVELT LAKE HEIGHTS ROOSEVELT JUNIOR HIGH SCHOOL









Assessment Roll and Tax List of Real Property in the Town of Crooked Lake

Cass County, Minnesota, for Taxes for the Year 1950.

Balance of list in Crooked Lake for 1950

Main table with columns: IN WHOSE NAME ASSESSED, TO WHOM TRANSFERRED, SUBDIVISION, TRUE AND FULL VALUATIONS, ASSESSED VALUATIONS, VALUATIONS BY SCHOOL DISTRICTS AS EQUALIZED BY DEPARTMENT OF TAXATION, TAXES, PAID, WHEN PAID, etc.

THE MARGINS THE NARROWS AUDITOR'S PLAT OF LAKE WASHINGTON OUTLOOKS THE LAKE BROS. ROOSEVELT TRAILS

THE NARROWS THE LAKE BROS. ROOSEVELT TRAILS TOWANA HEIGHTS ROOSEVELT LAKE HEIGHTS

Plat of Auditor's Plat of Lake Washington

Plat of TOWANA HEIGHTS

Plat of ROOSEVELT LAKE HEIGHTS





Assessment Roll and Tax List of Real Property in the Town of Crooked Lake

Cass County, Minnesota, for Taxes for the Year 1950.

THE BARRONS  
AUDITOR'S PLAT OF  
LAKE WASHINGTON OUTLOTS  
LAKE WASHINGTON  
ROOSEVELT TRAILS  
ROOSEVELT TRAILS  
IOWAIA HEIGHTS  
ROOSEVELT LAKE HEIGHTS

Table with columns: IN WHOSE NAME ASSESSED, TO WHOM TRANSFERRED, SUBDIVISION, TRUE AND FULL VALUATIONS (LAND, BUILDINGS, MACHINERY, TOTAL), ASSESSED VALUATIONS (RURAL, ALL OTHER, MACHINERY, TOTAL ASSESSED VALUE), FINAL EQUALIZED VALUE.

Table with columns: VALUATIONS BY SCHOOL DISTRICTS AS EQUALIZED BY DEPARTMENT OF TAXATION, Tax Including State Homestead, State Tax on Non-Homestead, SPECIAL TAXES, TOTAL TAXES, PAID, WHEN PAID, Number of Receipt, March Settlement 1951, June Settlement 1951, November Settlement 1951, Collection to First Monday in January 1952, Delinquent on First Monday in January 1952, Total Delinquent Tax and Penalty, REMARKS.

Assessment Roll and Tax List of Real Property in the Town of Crooked Lake

Table with columns: IN WHOSE NAME ASSESSED, TO WHOM TRANSFERRED, SUBDIVISION, DESCRIPTION OF PROPERTY, TRUE AND FULL VALUATIONS, ASSESSED VALUATIONS, FINAL EQUALIZED VALUE.

Cass County, Minnesota, for Taxes for the Year 1950.

Table with columns: SOLD FOR TAXES, VALUATIONS BY SCHOOL DISTRICTS AS EQUALIZED BY DEPARTMENT OF TAXATION, SPECIAL TAXES, TOTAL TAXES, PAID, WHEN PAID, Number of Receipts, March Settlement, June Settlement, November Settlement, Collections to First Monday in January, Delinquent on First Monday in January, Total Delinquent Tax and Penalty, REMARKS.









Table with columns: IN WHOSE NAME ASSESSED, TO WHOM TRANSFERRED, DESCRIPTION OF PROPERTY, TRUE AND FULL VALUATIONS, ASSESSED VALUATIONS, VALUATIONS BY SCHOOL DISTRICTS, TAXES, PAID, WHEN PAID, etc.

ROOSEVELT SCOO  
AUDITOR'S PLAT OF  
Plat of Original of  
of  
BROWN'S WASHBURN LAKE  
IOWA HEIGHTS  
ROOSEVELT LAKE HEIGHTS

MINNAPOLIS  
WASHBURN  
ROOSEVELT  
STORRS  
Tabular Statement  
WASHBURN PILES ROOSEVELT STORRS



Table with columns: IN WHOSE NAME ASSESSED, TO WHOM TRANSFERRED, SUBDIVISION, TRUE AND FULL VALUATIONS, ASSESSED VALUATIONS, VALUATIONS BY SCHOOL DISTRICTS, SOLD FOR TAXES, and various tax payment columns (March, June, November, Delinquent).

ROOSEVELT 500, AUDITOR'S PLAT OF, PLAT OF OUTLOT OF, BROWN'S WASHBURN LAKE, WASHBURN PINES, WASHBURN LAKE HEIGHTS, PLATS-A-PLENTY ON, TABULAR STATEMENT



Assessment Roll and Tax List of Real Property in the Town of Crooked Lake

Table with columns: IN WHOSE NAME ASSESSED, TO WHOM TRANSFERRED, SUBDIVISION, TRUE AND FULL VALUATIONS, ASSESSED VALUATIONS, FINAL EQUALIZED VALUE. Includes entries for Martin + Martha Honning, Donald L. Anderson + Samont D. Williams, Embert Hanson, Dwight W. Humberg, Stanley Steff, etc.

Summary totals for the assessment roll, including columns for TRUE AND FULL VALUATIONS, ASSESSED VALUATIONS, and FINAL EQUALIZED VALUE.

Cass County, Minnesota, for Taxes for the Year 1950.

Table with columns: SOLD FOR TAXES, VALUATIONS BY SCHOOL DISTRICTS AS EQUALIZED BY DEPARTMENT OF TAXATION, TAXES, PAID, WHEN PAID, Number of Receipt, March Settlement, June Settlement, November Settlement, Collections to First Monday in January, Delinquent on First Monday in January, Total Delinquent Tax and Penalty, REMARKS. Includes entries for 1950 taxes and payment status.

Summary totals for the tax list, including columns for TAXES, PAID, WHEN PAID, and Settlement amounts.

Vertical text on the left margin: ROOSEVELT SHOES, WASHINGTON PINES, BROWN'S WASHINGTON LAKE, PLAT OF OUTLOT A OF PLAT OF LOT 1'S PLAT OF LAKE, ROOSEVELT SHORES, WASHINGTON PINES, BROWN'S WASHINGTON LAKE, PLAT OF OUTLOT A OF PLAT OF LOT 1'S PLAT OF LAKE, ROOSEVELT SHOES.

Vertical text on the right margin: PLAT OF OUTLOT A OF PLAT OF LOT 1'S PLAT OF LAKE, WASHINGTON PINES, BROWN'S WASHINGTON LAKE, ROOSEVELT SHOES, Tabular Statement.

Assessment Roll and Tax List of Real Property in the Town of Crooked Lake

Cass County, Minnesota, for Taxes for the Year 1950.

Main table containing property details, valuations, and tax information. Columns include: IN WHOSE NAME ASSESSED, TO WHOM TRANSFERRED, SUBDIVISION, TRUE AND FULL VALUATIONS (LAND, BUILDINGS, MACHINERY, TOTAL), ASSESSED VALUATIONS (RURAL, ALL OTHER, MACHINERY, TOTAL), VALUATIONS BY SCHOOL DISTRICTS AS EQUALIZED BY DEPARTMENT OF TAXATION, Tax including State Homestead, State Tax on Non-Homestead, SPECIAL TAXES, TOTAL TAXES, PAID, WHEN PAID, Number of Receipts, March Settlement, June Settlement, November Settlement, Collection to First Monday in January, Delinquent on First Monday in January, Total Delinquent Tax and Penalty, and REMARKS.

Donald L. Anderson + Lamont O. Williams

Edward + Gillian Wilchoke

51.50 21.50

42.80 80 43.60

180 300

600 540 200 180







ROOSEVELT SHORES WASHBURN Pines-A Plant of LAKE WASHBURN ANDRESEN BAY LAKE WASHBURN BROWN'S WASHBURN LAKE WASHBURN

IN WHOSE NAME ASSESSED	TO WHOM TRANSFERRED	DESCRIPTION OF PROPERTY			TRUE AND FULL VALUATIONS					ASSESSED VALUATIONS					FINAL EQUALIZED VALUE	SOLD FOR TAXES	VALUATIONS BY SCHOOL DISTRICTS AS EQUALIZED BY DEPARTMENT OF TAXATION						SPECIAL TAXES	TOTAL TAXES	PAID	WHEN PAID	Number of Receipts	March Settlement 1951	June Settlement 1951	Penalty	November Settlement 1951	Penalty	Collections to First Monday in January 1952	Penalty	Delinquent on First Monday in January 1952	Total Delinquent Tax and Penalty	REMARKS													
					LAND Exclusive of Structures and Improvements	BUILDINGS and Other Structures	MACHINERY Permanently Attached to Real Estate	TOTAL True and Full Value	RURAL		ALL OTHER		MACHINERY Permanently Attached to Real Estate	TOTAL ASSESSED VALUE			Total Assessed Value as Equalized by the Board of Review	District No.	Rate	District No.	Rate	District No.																Rate	District No.	Rate										
									Homestead Up to \$4,000	Over \$4,000 and Non-Homestead	Homestead Up to \$4,000	Over \$4,000 and Non-Homestead																													Homestead	Over \$4,000 and Non-Homestead	Rate	Rate	Rate	Rate				
Thorvald + Olivine Andresen		Subdivision Andresen Bay	79																	8						170	04	174																						
"	"		20																	8							170	04	174																					
"	"		21																	8							170	04	174																					
"	"		22																	8							170	04	174																					
"	"		23																	8							170	04	174																					
"	"		24																	8							170	04	174																					
Conrad + Mary Engler			25																	8							170	04	176																					
"	"		26																	8							170	04	176																					
Harold B. + Florence + Elaine Johnson			27																	8							170	04	176																					
Thorvald + Olivine Andresen			28																	8							170	04	176																					
"	"		29																	8							170	04	176																					
			30																																															

273 340 513 171  
 241 200 441 147  
 667 05 75 62 4 77 91 374 58 171  
 60583 63116 123699 6645 30158 36803 42249

171 3656 80 3736 875 679 2160

Tabular Statement





