

1969 ASSESSMENT
1970 TAX LIST
Becker

Form 1

DIRECTIONS TO ASSESSOR

OFFICE OF COUNTY AUDITOR,

County, Minn. 1969,

To Assessor of the of

According to the requirements of law, I herewith deliver to you the Assessment Books for the of for the year 1969, contained a list of all Real Estate that has become subject to taxation since the Assessment of January 2, 1968, so far as the same has come to my knowledge from any source, and I hereby direct you to assess such Real Estate and make such changes in Real Estate as are required in the odd-numbered year, and you are further directed to assess all Personal Property with reference to its value on May 1, 1969 and make return thereof as required by the laws of the State of Minnesota prescribing the duties of the assessor.

A form of the return to be signed by you is appended in this book.

County Auditor.

Minnesota Statutes, Section 270.07. The commissioner of taxation shall prescribe the form of all blanks and books required under this chapter . . .

Minnesota Statutes, Section 273.03. The county auditor shall annually provide the necessary assessment books and blanks at the expense of the county, for and to correspond with each assessment district. He shall make out, in the real property assessment book, complete lists of all lands or lots subject to taxation, showing the names of the owners, if to him known; and, if unknown, so stated opposite each tract or lot, the number of acres, and the lots or parts of lots or blocks included in each description of property. The list of real property becoming subject to Assessment and Taxation every odd-numbered year may be appended to the personal property assessment book.***

Minnesota Statutes, Section 273.03. The assessors and at least one member of each local board of review shall meet at the office of the county auditor on a day to be fixed by the commissioner of taxation for the purpose of receiving instructions as to their duties under the laws of the state. Each assessor and board of review member attending such meetings shall receive as compensation for such service the sum of \$10.00 per day for each day necessarily consumed in attending such meeting, and mileage at the rate of 7½ cents per mile, for each mile necessarily traveled in going from his home to and returning from the county seat, to be computed by the usually traveled route, and paid out of the county treasury upon the warrant of the county auditor.

The forms in this book are prescribed for the 1969 assessment by The Commissioner of Taxation

Real Estate

1-32

134-32

INDEX TO SECTIONS

SECTION PAGE

Sec. 1.....	
" 2.....	
" 3.....	
" 4.....	
" 5.....	
" 6.....	
" 7.....	
" 8.....	
" 9.....	
" 10.....	
" 11.....	
" 12.....	
" 13.....	
" 14.....	
" 15.....	
" 16.....	
" 17.....	
" 18.....	
" 19.....	
" 20.....	
" 21.....	
" 22.....	
" 23.....	
" 24.....	
" 25.....	
" 26.....	
" 27.....	
" 28.....	
" 29.....	
" 30.....	
" 31.....	
" 32.....	
" 33.....	
" 34.....	
" 35.....	
" 36.....	

For Convenience of Auditor in Showing Boundaries of School Districts

Township No. 133-134 Range No. 32 Mer. P. M.

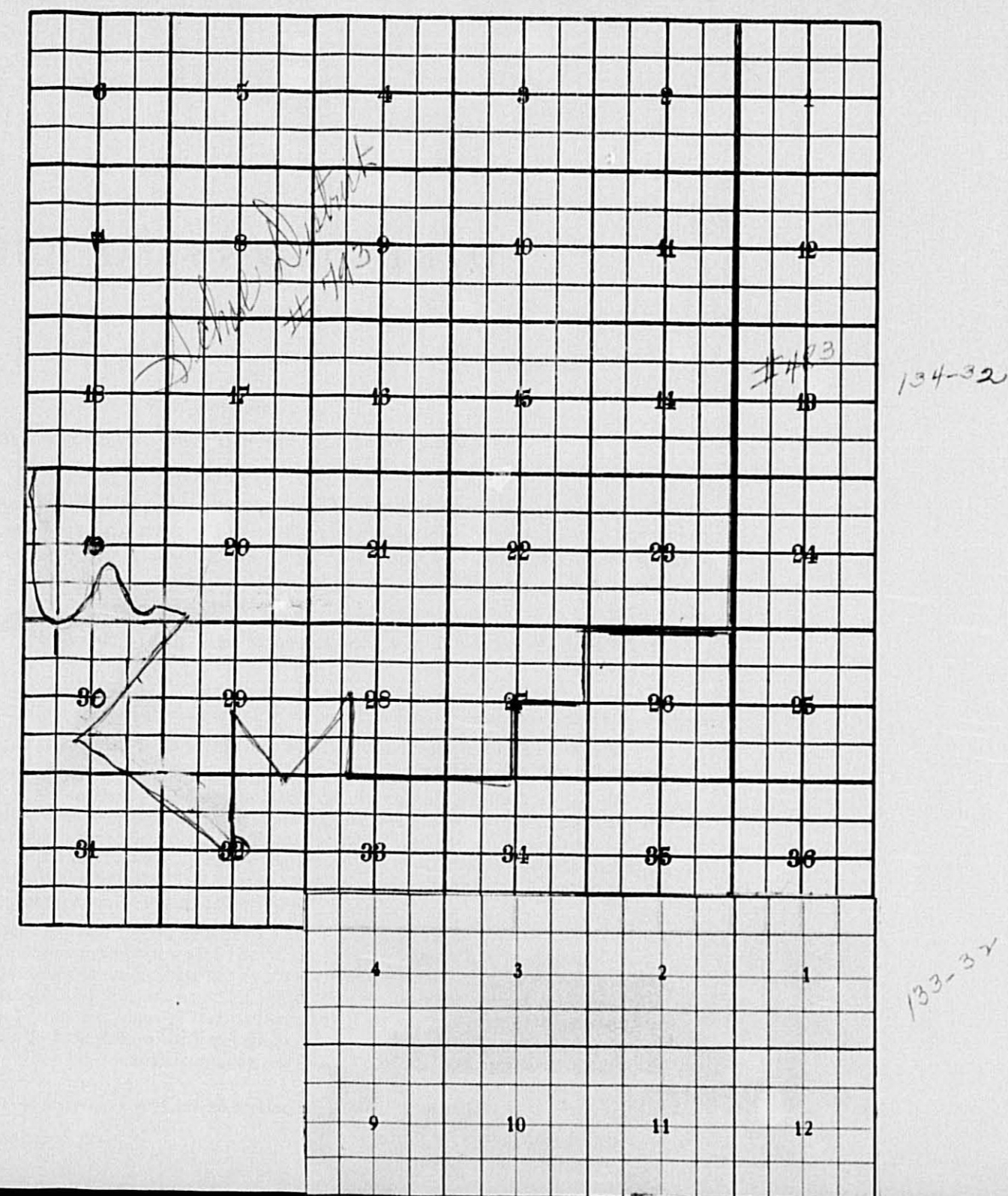

Returns Showing Grain Received in or Handled by Elevators, Warehouses and Mills in the _____ of _____ in the _____ for the Year Ending May 1, 1969.

NAMES OF OWNERS	ADDRESS	SUBDIVISION 1			Total Subdivision 1 No. Bushels	★ Tax of 1/4 Mill per Bushel Dollars Cts.	SUBDIVISION 2					Total Subdivision 2 No. Bushels	★ Tax of 1/4 Mill Per Bushel		★ Total Tax		REMARKS	
		Bushels of Wheat	Bushels of Soy Beans	Bushels of Flax			Bushels of Corn	Bushels of Barley	Bushels of Rye	Bushels of Oats	Bushels of Buckwheat		Bushels of all Other Grains	Dollars	Cts.	Dollars		Cts.

Note ★ Assessors will not fill these Columns

SUMMARY OF TAX COLLECTION

Original Levy	- - - - -	\$ 16,114.26	
Additions	- - - - -	\$ 9.82	
\$ 16,124.08			
Abatements	- - - - -	\$ -	
\$ 16,124.08			
COLLECTIONS			
March Settlement	- - - - -	\$ 664.08	
June Settlement	- - - - -	\$ 661.55	
November Settlement	- - - - -	\$ 4,787.23	
January Settlement	- - - - -	\$ ^{62.00} 12,124.86	
Replacement	2,427.94	2,427.94	
Over Collected	- - - - -	\$ -	
Under Collected	- - - - -	\$ -	
Delinquent	- - - - -	\$ 1,571.38	
Total	- - - - -	\$ 16,124.18	

Homesteads or Ceased to be Homesteads

TO BE HOMESTEADS

Twp	Sec. of Lot	Town or Block	Range	Number of Acres of Land	
				Acres	100th

Recd Estate 3-32 131-32

COLLECTIONS OF TAXES PAYABLE IN 1970

Town

OF Berken

CASS COUNTY, MINNESOTA

FUNDS	MARCH SETTLEMENT 1970	JUNE SETTLEMENT 1970	NOV. SETTLEMENT 1970	Amount Collected from Nov. 19, 1970, to First Monday in Jan. 1971	REDUCTIONS	Total Reductions and Collected	BALANCE UNCOLLECTED	ADDITIONS	Total Uncollected to First Monday in January, 1971
State-Non-Homestead, State-Homestead,									
County Revenue,	5566	55173	43699	514					
County Road and Bridge,	3875	38338	30420	358					
County Welfare,	10725	106113	84195	790					
County Bond and Interest,	208	2606	745	29					
Transportation									
P. E. R. A.	778	7700	6112	71					
Co. Rd. Dist.	337	3335	2647	31					
Civ. Dist.	126	1250	994	12					
Well. Dist.	946	7368	7435	87					
Agri. Adv.	76	750	597	67					
Town Revenue,	1412	13969	11085	130					
Town Road and Bridge,	3130	36905	29283	344					
Bonds & Interest									
Fee	843	8335	6615	78					
School Special,	4212	44668	34672	389					
Deficiency	19838	197282	157047	1305					
Bonds & Interest	10451	103113	37593	762					
Tuition									
P. E. R. A.	1991	20050	16074	211					
C.O.	957	8965	6863	51					
	66408	661155	478723	6200					

	SCHOOL DISTRICT NO.	LOCAL 1 MILL	SPECIAL	STATE LOAN	Deficiency	C.O.	P. E. R. A.	Ad. Int.	TOTALS
MARCH SETTLEMENT	School District No. 483A		2279		9861	957	766	7599	21462
	793A		1933		9917		1225	2852	15787
	Totals		4212		19838	957	1991	10451	37449
JUNE SETTLEMENT	School District No. 483A		18676		80823	7844	6275	45297	157915
	483NA		5339		11549	1121	897	6972	25877
	793A		19998		103216	12672	12670	49965	185849
	793NA		656		1694		208	879	3437
Totals		44668		197282	8965	20050	103113		374078
NOVEMBER SETTLEMENT	School District No. 483A		14732		63752	6188	4951	24541	114164
	483NA		3208		6941	675	521	2877	14222
	792A		16732		86354		60602	10175	123863
Totals		34672		157047	6863	16074	37593		252249
NOVEMBER to JANUARY	School District No. 483A		122		526	51	42	296	1037
	793A		267		1379		149	666	2481
	Totals		389		1905	51	211	962	3518
ADDITIONS	School District No.								
Totals									
REDUCTIONS	School District No.								
Totals									

Homesteads or Ceased to be Homesteads

LAND TO BE HOMESTEADS

TY	Sec. or Lot	Town or Block	Range	Number of Acres of Land
				Acres 100th

Real Estate 3-32

131-32

Assessment Roll For the Year 1969 and Tax List of Real Property in the

Town of Becker

Where "Yes" is Indicated in Homestead Column, Identify Description on Which House is Located by Letter "H" under the Word "Yes" - **Indicate Type of Property: R-Residential, C-Commercial, I-Industrial, U-Utility, F-Farm, L-Lakeshore, T-Timber, M-Mineral

Cass County, Minnesota, for Taxes Payable in the Year 1970.

133-32-1 Estate

Table with columns: IN WHOSE NAME ASSESSED, SUBDIVISION, Sec or Lot, Town or Block, Rng., Number of Acres of Land, No. School District, Estimated Market Value, ADJUSTED MARKET VALUES (LAND, BUILDINGS, ATTACHED MACHINERY, TOTAL ADJUSTED MARKET VALUE), ASSESSED VALUATIONS (AGRICULTURAL, ALL OTHER), Homestead, etc.

Table with columns: Final Equalized Value, SOLD FOR TAXES, VALUATIONS BY SCHOOL DISTRICTS AS EQUALIZED BY DEPARTMENT OF TAXATION, Non-Homestead General Tax, Homestead General Tax, 3% Homestead Credit, SPECIAL TAXES, SPECIAL TAXES, TOTAL TAXES, PAID, WHEN PAID, Number of Receipt, March Settlement 1970, June Settlement 1970, Penalty, November Settlement 1970, Penalty, Collections to First Monday in January 1971, Penalty, Delinquent on First Monday in January 1971, Total Delinquent Tax and Penalty, REMARKS.

131-32

Assessment Roll For the Year 1969 and Tax List of Real Property in the Town of Down of Becker County, Minnesota

Where "Yes" is Indicated in Homestead Column, Identify Description on Which House is Located by Letter "H" under the Word "Yes" - **Indicate Type of Property: R-Residential, C-Commercial, I-Industrial, U-Utility, F-Farm, L-Lakeshore, T-Timber, M-Mineral

Table with columns: IN WHOSE NAME ASSESSED, SUBDIVISION, Sec. or Lot, Town or Block, Rng., Number of Acres of Land, No. School District, Estimated Market Value, ADJUSTED MARKET VALUES (LAND, BUILDINGS, ATTACHED MACHINERY, TOTAL ADJUSTED MARKET VALUE), ASSESSED VALUATIONS (AGRICULTURAL: Homestead, Non Homestead, Attached Machinery; ALL OTHER: Total Assessed Value, Homestead Tax Credit).

Cass County, Minnesota, for Taxes Payable in the Year 1970.

Table with columns: Final Equalized Value, SOLD FOR TAXES, VALUATIONS BY SCHOOL DISTRICTS AS EQUALIZED BY DEPARTMENT OF TAXATION (District No., Rate, etc.), Non-Homestead General Tax, Homestead General Tax, 35% Homestead Credit, CO 501 Rate 1.02, SPECIAL TAXES, SPECIAL TAXES, TOTAL TAXES, PAID, WHEN PAID (Month, Day, Year), Number of Receipt, March Settlement 1970, June Settlement 1970, Penalty, November Settlement 1970, Penalty, Collections to First Monday in January 1971, Penalty, Delinquent on First Monday in January 1971, Total Delinquent Tax and Penalty, REMARKS.

133-32 al Estate

134-32

Assessment Roll For the Year 1969 and Tax List of Real Property in the

Town of Becker

Where "Yes" is Indicated in Homestead Column, Identify Description on Which House is Located by Letter "H" under the Word "Yes." - **Indicate Type of Property: R-Residential, C-Commercial, I-Industrial, U-Utility, F-Farm, L-Lakeshore, T-Timber, M-Mineral

Cass County, Minnesota, for Taxes Payable in the Year 1970.

133-32 Al Estate

Table with columns: IN WHOSE NAME ASSESSED, SUBDIVISION, Sec. or Lot, Town or Block, Rng., Number of Acres of Land, No. School District, ESTIMATED MARKET VALUE, ADJUSTED MARKET VALUES (LAND, BUILDINGS, ATTACHED MACHINERY, TOTAL ADJUSTED MARKET VALUE), ASSESSED VALUATIONS (AGRICULTURAL, ALL OTHER), Final Equalized Value, SOLD FOR TAXES, VALUATIONS BY SCHOOL DISTRICTS AS EQUALIZED BY DEPARTMENT OF TAXATION, Non-Homestead General Tax, Homestead General Tax, 3% Homestead Credit, SPECIAL TAXES, TOTAL TAXES, PAID, WHEN PAID, Number of Receipt, March Settlement 1970, June Settlement 1970, Penalty, November Settlement 1970, Penalty, Collections to First Monday in January 1971, Penalty, Delinquent on First Monday in January 1971, Total Delinquent Tax and Penalty, REMARKS.

Rose + Ruby D. Dickey
Jessie Pety
Rose + Ruby D. Dickey
Ella Carpenter
Ella Carpenter
Emil + June Kurtti

Table with columns: Final Equalized Value, SOLD FOR TAXES, VALUATIONS BY SCHOOL DISTRICTS AS EQUALIZED BY DEPARTMENT OF TAXATION, Non-Homestead General Tax, Homestead General Tax, 3% Homestead Credit, SPECIAL TAXES, TOTAL TAXES, PAID, WHEN PAID, Number of Receipt, March Settlement 1970, June Settlement 1970, Penalty, November Settlement 1970, Penalty, Collections to First Monday in January 1971, Penalty, Delinquent on First Monday in January 1971, Total Delinquent Tax and Penalty, REMARKS.

134-32

Assessment Roll For the Year 1969 and Tax List of Real Property in the

Where "Yes" is Indicated in Homestead Column, Identify Description on Which House is Located by Letter "H" under the Word "Yes." - Indicate Type of Property: R-Residential, C-Commercial, I-Industrial, U-Utility, F-Farm, L-Lakeshore, T-Timber, M-Mineral

Town of Becker

Cass County, Minnesota, for Taxes Payable in the Year 1970.

133-32 al Estate

Martha Elvira Moser

Table with columns: IN WHOSE NAME ASSESSED, DESCRIPTION OF PROPERTY, ADJUSTED MARKET VALUES, ASSESSED VALUATIONS. Includes handwritten entries for Martha Elvira Moser and various subdivision descriptions.

Table with columns: Final Equalized Value, SOLD FOR TAXES, VALUATIONS BY SCHOOL DISTRICTS AS EQUALIZED BY DEPARTMENT OF TAXATION, Non-Homestead General Tax, Homestead General Tax, 35% Homestead Credit, SPECIAL TAXES, TOTAL TAXES, PAID, WHEN PAID, Number of Receipt, March Settlement, June Settlement, November Settlement, Penalty, Collections to First Monday in January 1971, Delinquent on First Monday in January 1971, Total Delinquent Tax and Penalty, REMARKS. Includes handwritten tax amounts and settlement dates.

131-32

Assessment Roll For the Year 1969 and Tax List of Real Property in the

Town of Peck

Cass County, Minnesota, for Taxes Payable in the Year 1970.

Where "Yes" is Indicated in Homestead Column, Identify Description on Which House is Located by Letter "H" under the Word "Yes." - **Indicate Type of Property: R-Residential, C-Commercial, I-Industrial, U-Utility, F-Farm, L-Lakeshore, T-Timber, M-Mineral

Table with columns: IN WHOSE NAME ASSESSED, DESCRIPTION OF PROPERTY, ADJUSTED MARKET VALUES, ASSESSED VALUATIONS (AGRICULTURAL, ALL OTHER), VALUATIONS BY SCHOOL DISTRICTS AS EQUALIZED BY DEPARTMENT OF TAXATION, and various tax and payment columns.

133-32 11 Estate

131-32

Assessment Roll For the Year 1969 and Tax List of Real Property in the

Town of Becker

Where "Yes" is Indicated in Homestead Column, Identify Description on Which House is Located by Letter "H" under the Word "Yes." - **Indicate Type of Property: R-Residential, C-Commercial, I-Industrial, U-Utility, F-Farm, L-Lakeshore, T-Timber, M-Mineral

DESCRIPTION OF PROPERTY

ADJUSTED MARKET VALUES

ASSESSED VALUATIONS

Table with columns: IN WHOSE NAME ASSESSED, SUBDIVISION, Sec. or Lot, Town or Block, No. of Acres of Land, ESTIMATED MARKET VALUE, ADJUSTED MARKET VALUES (LAND, BUILDINGS, ATTACHED MACHINERY, TOTAL), AGRICULTURAL (Homestead, Non Homestead, Attached Machinery, Seasonal Rec. Resid., Seasonal Rec. Comm.), ALL OTHER (Homestead, Non Homestead, Attached Machinery, Total All Other, Total Assessed Value, Homestead Tax Credit).

Robert L. Lamine Zimmerman

William A. & Nancy Collins

7904

312

Cass County, Minnesota, for Taxes Payable in the Year 1970.

Table with columns: Final Equalized Value, SOLD FOR TAXES, VALUATIONS BY SCHOOL DISTRICTS AS EQUALIZED BY DEPARTMENT OF TAXATION (District No., Rate, Mills), Non-Homestead General Tax, Homestead General Tax, 3% Homestead Credit, SPECIAL TAXES, TOTAL TAXES, PAID, WHEN PAID, Number of Receipt, March Settlement, June Settlement, November Settlement, Penalty, Collections to First Monday in January 1971, Delinquent on First Monday in January 1971, Total Delinquent Tax and Penalty, REMARKS.

77 = 77
748 284 = 409
125 284 = 409

2486
9876 3456
1550 542 3210
11426 3998

13124

5017

5017

3090

133-32-31

131-32

Assessment Roll For the Year 1969 and Tax List of Real Property in the

Town of Becker

Where "Yes" is Indicated in Homestead Column, Identify Description on Which House is Located by Letter "H" under the Word "Yes." - **Indicate Type of Property: R-Residential, C-Commercial, I-Industrial, U-Utility, F-Farm, L-Lakeshore, T-Timber, M-Mineral

Cass County, Minnesota, for Taxes Payable in the Year 1970.

133-32 al Estate
131-32

Table with columns: IN WHOSE NAME ASSESSED, SUBDIVISION, Sec. or Lot, Town or Block, Rng., Number of Acres of Land, ESTIMATED MARKET VALUE, ADJUSTED MARKET VALUES (LAND, BUILDINGS, ATTACHED MACHINERY, TOTAL), ASSESSED VALUATIONS (AGRICULTURAL, ALL OTHER), Final Equalized Value, SOLD FOR TAXES.

Table with columns: VALUATIONS BY SCHOOL DISTRICTS AS EQUALIZED BY DEPARTMENT OF TAXATION, Non-Homestead General Tax, Homestead General Tax, 35% Homestead Credit, SPECIAL TAXES, SPECIAL TAXES, TOTAL TAXES, PAID, WHEN PAID, Number of Receipt, March Settlement 1970, June Settlement 1970, Penalty, November Settlement 1970, Penalty, Collections to First Monday in January 1971, Penalty, Delinquent on First Monday in January 1971, Total Delinquent Tax and Penalty, REMARKS.

62880

375
7319 H 117 H 436
4588 H 558
1252 117 = 1369
4068
22400 18050 6304 10748
26468

21193 7523

20200

Assessment Roll For the Year 1969 and Tax List of Real Property in the

Town of Becker

Where "Yes" is indicated in Homestead Column, Identify Description on Which House is Located by Letter "H" under the Word "Yes." - Indicate Type of Property: R-Residential, C-Commercial, I-Industrial, U-Utility, F-Farm, L-Lakeshore, T-Timber, M-Mineral

133-32 al Estate

131-32

State of Minnesota

(Cont to: Walter B Johnson)

(" " " ")

Gordon Ramussen

James D. Loma Hayes

Martin T. & Edna M. Knapp

" " " " "

" " " " "

" " " " "

" " " " "

" " " " "

" " " " "

" " " " "

" " " " "

" " " " "

" " " " "

Table with columns: IN WHOSE NAME ASSESSED, SUBDIVISION, Sec or Lot, Town or Block, No. of Acres, ESTIMATED MARKET VALUE, ADJUSTED MARKET VALUES, ASSESSED VALUATIONS (AGRICULTURAL, ALL OTHER), Final Equalled Value, SOLD FOR TAXES, VALUATIONS BY SCHOOL DISTRICTS AS EQUALIZED BY DEPARTMENT OF TAXATION, SPECIAL TAXES, TOTAL TAXES, PAID, WHEN PAID, Number of Receipt, March Settlement 1970, June Settlement 1970, Penalty, November Settlement 1970, Penalty, Collections to First Monday in January 1971, Penalty, Delinquent on First Monday in January 1971, Total Delinquent Tax and Penalty, REMARKS.

Cass County, Minnesota, for Taxes Payable in the Year 1970.

Table with columns: Final Equalled Value, SOLD FOR TAXES, VALUATIONS BY SCHOOL DISTRICTS AS EQUALIZED BY DEPARTMENT OF TAXATION, SPECIAL TAXES, TOTAL TAXES, PAID, WHEN PAID, Number of Receipt, March Settlement 1970, June Settlement 1970, Penalty, November Settlement 1970, Penalty, Collections to First Monday in January 1971, Penalty, Delinquent on First Monday in January 1971, Total Delinquent Tax and Penalty, REMARKS.

Assessment Roll For the Year 1969 and Tax List of Real Property in the

City of Becker

Where "Yes" is Indicated in Homestead Column, Identify Description on Which House is Located by Letter "H" under the Word "Yes." - **Indicate Type of Property: R-Residential, C-Commercial, I-Industrial, U-Utility, F-Farm, L-Lakeshore, T-Timber, M-Mineral

133-32-11 J-STATE

131-32

Table with columns: IN WHOSE NAME ASSESSED, SUBDIVISION, Sec. or Lot, Town or Block, Number of Acres of Land, ESTIMATED MARKET VALUE, ADJUSTED MARKET VALUES (LAND, BUILDINGS, ATTACHED MACHINERY, TOTAL ADJUSTED MARKET VALUE), ASSESSED VALUATIONS (AGRICULTURAL, ALL OTHER), and Homestead columns.

45613

Cass County, Minnesota, for Taxes Payable in the Year 1970.

Table with columns: Final Equalized Value, SOLD FOR TAXES, VALUATIONS BY SCHOOL DISTRICTS AS EQUALIZED BY DEPARTMENT OF TAXATION, Non-Homestead General Tax, Homestead General Tax, 35% Homestead Credit, CO Rate, Rate and Tax Bonds & Interest, SPECIAL TAXES, SPECIAL TAXES, TOTAL TAXES, PAID, WHEN PAID, Number of Receipt, March Settlement 1970, June Settlement 1970, Penalty, November Settlement 1970, Penalty, Collections to First Monday in January 1971, Penalty, Delinquent on First Monday in January 1971, Total Delinquent Tax and Penalty, REMARKS.

272
4196
7633
1101

20745 12293

Assessment Roll For the Year 1969 and Tax List of Real Property in the

Town of Lester

Where "Yes" is Indicated in Homestead Column, Identify Description on Which House is Located by Letter "H" under the Word "Yes." - Indicate Type of Property: R-Residential, C-Commercial, I-Industrial, U-Utility, F-Farm, L-Lakeshore, T-Timber, M-Mineral

133-32 at Estate

131-32

Table with columns: IN WHOSE NAME ASSESSED, SUBDIVISION, Sec. or Lot, Town or Block, Number of Acres of Land, ESTIMATED MARKET VALUE, ADJUSTED MARKET VALUES, ASSESSED VALUATIONS (AGRICULTURAL, ALL OTHER), and Homestead Tax Credit.

Cass County, Minnesota, for Taxes Payable in the Year 1970.

Table with columns: Final Equalized Value, SOLD FOR TAXES, VALUATIONS BY SCHOOL DISTRICTS AS EQUALIZED BY DEPARTMENT OF TAXATION, Non-Homestead General Tax, Homestead General Tax, 3% Homestead Credit, SPECIAL TAXES, TOTAL TAXES, PAID, WHEN PAID, Number of Receipt, March Settlement 1970, June Settlement 1970, Penalty, November Settlement 1970, Collections to First Monday in January 1971, Delinquent on First Monday in January 1971, Total Delinquent Tax and Penalty, REMARKS.

Assessment Roll For the Year 1969 and Tax List of Real Property in the

Town of *Scott* of *Scott*

Where "Yes" is Indicated in Homestead Column, Identify Description on Which House is Located by Letter "H" under the Word "Yes." - **Indicate Type of Property: R-Residential, C-Commercial, I-Industrial, U-Utility, F-Farm, L-Lakeshore, T-Timber, M-Mineral

Table with columns: IN WHOSE NAME ASSESSED, SUBDIVISION, Sec. or Lot, Town or Block, No. of Acres, ESTIMATED MARKET VALUE, ADJUSTED MARKET VALUES (LAND, BUILDINGS, ATTACHED MACHINERY, TOTAL ADJUSTED MARKET VALUE), ASSESSED VALUATIONS (AGRICULTURAL, ALL OTHER), and Homestead Tax Credit.

Cass County, Minnesota, for Taxes Payable in the Year 1970.

Table with columns: Final Equalized Value, SOLD FOR TAXES, VALUATIONS BY SCHOOL DISTRICTS AS EQUALIZED BY DEPARTMENT OF TAXATION (District No., Rate, etc.), Non-Homestead General Tax, Homestead General Tax, 35% Homestead Credit, SPECIAL TAXES, TOTAL TAXES, PAID, WHEN PAID, Number of Receipt, March Settlement 1970, June Settlement 1970, Penalty, November Settlement 1970, Collections to First Monday in January 1971, Delinquent on First Monday in January 1971, Total Delinquent Tax and Penalty, REMARKS.

133-32 al Estate

134-32

Florence Mason

Grant Vasecka

The Northwest Paper Company

The Northwest Paper Company

The Northwest Paper Company

The Northwest Paper Company

2nd HALF PAID AUG 7 1970

1st HALF PAID MAY 1 1970

2nd HALF PAID AUG 7 1970

1st HALF PAID MAY 1 1970

2nd HALF PAID NOV 20 1970

1st HALF PAID JUN 1 1970

2nd HALF PAID NOV 20 1970

1st HALF PAID JUN 1 1970

2nd HALF PAID NOV 20 1970

1st HALF PAID JUN 1 1970

2nd HALF PAID NOV 20 1970

1st HALF PAID JUN 1 1970

2nd HALF PAID NOV 20 1970

1st HALF PAID JUN 1 1970

9762 1972

9761 1975

9762 1976

9761 1975

9762 1976

9761 1975

9762 1976

9761 1975

9762 1976

9761 1975

9762 1976

9761 1975

9762 1976

Assessment Roll For the Year 1969 and Tax List of Real Property in the

Town of Becker

Where "Yes" is Indicated in Homestead Column, Identify Description on Which House is Located by Letter "H" under the Word "Yes." - "Indicate Type of Property: R-Residential, C-Commercial, I-Industrial, U-Utility, F-Farm, L-Lakeshore, T-Timber, M-Mineral

DESCRIPTION OF PROPERTY

ADJUSTED MARKET VALUES

ASSESSED VALUATIONS

VALUATIONS BY SCHOOL DISTRICTS AS EQUALIZED BY DEPARTMENT OF TAXATION

Cass County, Minnesota, for Taxes Payable in the Year 1970.

Table with columns: IN WHOSE NAME ASSESSED, SUBDIVISION, Sec. or Lot, Town or Block, Rng., Number of Acres of Land, No. School District, Homestead Yes or No, Indicate Type of Property, ESTIMATED MARKET VALUE, ADJUSTED MARKET VALUES (LAND, BUILDINGS, ATTACHED MACHINERY, TOTAL), ASSESSED VALUATIONS (AGRICULTURAL, ALL OTHER), Final Equalized Value, SOLD FOR TAXES.

Table with columns: Final Equalized Value, SOLD FOR TAXES, VALUATIONS BY SCHOOL DISTRICTS AS EQUALIZED BY DEPARTMENT OF TAXATION, Non-Homestead General Tax, Homestead General Tax, 3% Homestead Credit, CO SALES TAX, SPECIAL TAXES, SPECIAL TAXES, TOTAL TAXES, PAID, WHEN PAID, Number of Receipt, March Settlement, June Settlement, Penalty, November Settlement, Penalty, Collections to First Monday in January 1971, Penalty, Delinquent on First Monday in January 1971, Total Delinquent Tax and Penalty, REMARKS.

133-32 al Estate

131-32

Assessment Roll For the Year 1969 and Tax List of Real Property in the

Town of Becker

Where "Yes" is Indicated in Homestead Column, Identify Description on Which House is Located by Letter "H" under the Word "Yes." - Indicate Type of Property: R-Residential, C-Commercial, I-Industrial, U-Utility, F-Farm, L-Lakeshore, T-Timber, M-Mineral

Cass County, Minnesota, for Taxes Payable in the Year 1970.

Table with columns for IN WHOSE NAME ASSESSED, SUBDIVISION, ADJUSTED MARKET VALUES, ASSESSED VALUATIONS, VALUATIONS BY SCHOOL DISTRICTS AS EQUALIZED BY DEPARTMENT OF TAXATION, and various tax and payment details.

Assessment Roll For the Year 1969 and Tax List of Real Property in the

of

Cass County, Minnesota, for Taxes Payable in the Year 1970.

IN WHOSE NAME ASSESSED	DESCRIPTION OF PROPERTY						ESTIMATED MARKET VALUE Dollars	ADJUSTED MARKET VALUES														Final Equalized Value Dollars	SOLD FOR TAXES	VALUATIONS BY SCHOOL DISTRICTS AS EQUALIZED BY DEPARTMENT OF TAXATION							Non-Homestead General Tax Ex. Bonds	Homestead General Tax Ex. Bonds	35% Homestead Credit	SPECIAL TAXES	SPECIAL TAXES	TOTAL TAXES	PAID	WHEN PAID	Number of Receipt	March Settlement 1970	June Settlement 1970	Penalty	November Settlement 1970	Penalty	Collections to First Monday in January 1971	Penalty	Delinquent on First Monday in January 1971	Total Delinquent Tax and Penalty	REMARKS		
	SUBDIVISION	Sec. or Lot	Town or Block	Rng.	Number of Acres of Land	No. School District		ASSESSED VALUATIONS																																											
								AGRICULTURAL							ALL OTHER																																				
								Homestead Up To \$4,000 20%	Homestead Over \$4,000 33 1/3%	Non Homestead 33 1/3%	Attached Machinery 33 1/3%	Seasonal Rec. Resid. 33 1/3%	Seasonal Rec. Comm. 33 1/3%	Total Agri. Cultural Assessed Value	Homestead Up To \$4,000 20%	Homestead Over \$4,000 40%	Non Homestead 40%	Attached Machinery 33 1/3%	Total All Other	Total Assessed Value	Homestead Tax Credit																														
								Dollars	Dollars	Dollars	Dollars	Dollars	Dollars	Dollars	Dollars	Dollars	Dollars	Dollars	Dollars	Dollars	Dollars			Dollars	Dollars	Dollars																									
District No. 750	District No. Rate 60	District No. Rate 60	District No. Rate 60	District No. Rate 60	District No. Rate 60	District No. Rate 60	District No. Rate 60	District No. Rate 60	District No. Rate 60	District No. Rate 60	District No. Rate 60	District No. Rate 60	District No. Rate 60	District No. Rate 60	District No. Rate 60	District No. Rate 60	District No. Rate 60																																		
State of Minnesota	1				793																																														
Melvin & Delores Hutchison	2				70 S	1398																																													
"	3				70 S	1052																																													
Melvin & Delores Hutchison	4				70 S	694																																													
John L. Ernst & Joe W. Knoblauch	5				MINNESOTA TREE GROWTH																																														
"	6				MINNESOTA TREE GROWTH																																														
Melvin & Delores Hutchison	7				70 S	360																																													
D. H. Lewis	8				70 S	229																																													
State of Minnesota	9				70 S	311																																													
D. H. Lewis	10				70 S	47																																													
"	11				70 T	96																																													
Leonard L. Draton	12				70 T	42																																													
"	13				70 T	42																																													
"	14				70 T	42																																													
"	15				70 T	42																																													
"	16				70 T	42																																													
"	17				70 T	42																																													
"	18				70 T	42																																													
"	19				70 T	42																																													
"	20				70 T	42																																													
																	409		13930		1146		15076																												

133-32 al Estate
134-32

Assessment Roll For the Year 1969 and Tax List of Real Property in the

Town of Becker

Where "Yes" is Indicated in Homestead Column, Identify Description on Which House is Located by Letter "H" under the Word "Yes." - **Indicate Type of Property: R-Residential, C-Commercial, I-Industrial, U-Utility, F-Farm, L-Lakeshore, T-Timber, M-Mineral

Table with columns: IN WHOSE NAME ASSESSED, DESCRIPTION OF PROPERTY, ADJUSTED MARKET VALUES, ASSESSED VALUATIONS (AGRICULTURAL, ALL OTHER), ESTIMATED MARKET VALUE, and Homestead Tax Credit.

Cass County, Minnesota, for Taxes Payable in the Year 1970.

Table with columns: Final Equalized Value, SOLD FOR TAXES, VALUATIONS BY SCHOOL DISTRICTS AS EQUALIZED BY DEPARTMENT OF TAXATION, Non-Homestead General Tax, Homestead General Tax, 35% Homestead Credit, SPECIAL TAXES, TOTAL TAXES, PAID, WHEN PAID, Number of Receipt, March Settlement 1970, June Settlement 1970, Penalty, November Settlement 1970, Collections to First Monday in January 1971, Delinquent on First Monday in January 1971, Total Delinquent Tax and Penalty, REMARKS.

133-32 al Estate

131-32

Ed + Anna Katanek
John A. + Mildred E. Anderson
Eugene Jones + Jeanne Jones
State of Minnesota, M. Johnson
State of Minnesota
State of Minnesota
Ralph + Audrey Droll
Marcus + Evelyn Droll
State of Minnesota
State of Minnesota
Marcus + Evelyn Droll

Value assessed by State
Oct 1965

SOLD FOR TAXES 168

549 = 549
4183 + 237 = 4420
732 237 969

8242 2884
5906 2068 7608
14148 4952

PAID IN FULL JUN 1 1970
PAID IN FULL JUN 1 1970
PAID IN FULL JUN 1 1970
PAID IN FULL JUN 1 1970

8032

4616 18082 5084

6740

9782

9745

9745

9778

9777

9780

Assessment Roll For the Year 1969 and Tax List of Real Property in the

Where "Yes" is Indicated in Homestead Column, Identify Description on Which House is Located by Letter "H" under the Word "Yes." - **Indicate Type of Property: R-Residential, C-Commercial, I-Industrial, U-Utility, F-Farm, L-Lakeshore, T-Timber, M-Mineral

Town of Becker

DESCRIPTION OF PROPERTY

ADJUSTED MARKET VALUES

ASSESSED VALUATIONS

Table with columns: IN WHOSE NAME ASSESSED, SUBDIVISION, Sec. or Lot, Town or Block, Rng., Number of Acres of Land, No. School District, Indicate Homestead Yes or No, Type of Property, ESTIMATED MARKET VALUE, LAND Excludes of Structures and Improvements, BUILDINGS and Other Structures, ATTACHED MACHINERY, TOTAL Adjusted Market Value, AGRICULTURAL (Homestead, Non Homestead, Attached Machinery, Seasonal Rec. Resid., Seasonal Rec. Comm., Total Agricultural Assessed Value), ALL OTHER (Homestead, Non Homestead, Attached Machinery, Total All Other, Total Assessed Value, Homestead Tax Credit).

Cass County, Minnesota, for Taxes Payable in the Year 1970.

Table with columns: Final Equalized Value, SOLD FOR TAXES, VALUATIONS BY SCHOOL DISTRICTS AS EQUALIZED BY DEPARTMENT OF TAXATION (District No., Rate, District No., Rate, District No., Rate, District No., Rate, District No., Rate), Non-Homestead General Tax, Homestead General Tax, 35% Homestead Credit, 20 1/2% Rate, 1.02 Rate, SPECIAL TAXES, SPECIAL TAXES, TOTAL TAXES, PAID, WHEN PAID, Number of Receipt, March Settlement 1970, June Settlement 1970, Penalty, November Settlement 1970, Penalty, Collections to First Monday in January 1971, Penalty, Delinquent on First Monday in January 1971, Total Delinquent Tax and Penalty, REMARKS.

133-32 al Estate

131-32

Assessment Roll For the Year 1969 and Tax List of Real Property in the Town of Becker

Where "Yes" is Indicated in Homestead Column, Identify Description on Which House is Located by Letter "H" under the Word "Yes." - Indicate Type of Property: R-Residential, C-Commercial, I-Industrial, U-Utility, F-Farm, L-Lakeshore, T-Timber, M-Mineral

Table with columns: IN WHOSE NAME ASSESSED, DESCRIPTION OF PROPERTY, ADJUSTED MARKET VALUES, ASSESSED VALUATIONS (AGRICULTURAL, ALL OTHER), ESTIMATED MARKET VALUE, and various tax-related fields.

Cass County, Minnesota, for Taxes Payable in the Year 1970.

Table with columns: Final Equalized Value, SOLD FOR TAXES, VALUATIONS BY SCHOOL DISTRICTS AS EQUALIZED BY DEPARTMENT OF TAXATION, Non-Homestead General Tax, Homestead General Tax, 35% Homestead Credit, SPECIAL TAXES, TOTAL TAXES, PAID, WHEN PAID, Number of Receipt, March Settlement 1970, June Settlement 1970, Penalty, November Settlement 1970, Collections to First Monday in January 1971, Delinquent on First Monday in January 1971, Total Delinquent Tax and Penalty, REMARKS.

133-32 al Estate
131-32

Assessment Roll For the Year 1969 and Tax List of Real Property in the Town of Becker

Table with columns: IN WHOSE NAME ASSESSED, DESCRIPTION OF PROPERTY, ADJUSTED MARKET VALUES, ASSESSED VALUATIONS (AGRICULTURAL, ALL OTHER), ESTIMATED MARKET VALUE, and various tax-related fields.

Cass County, Minnesota, for Taxes Payable in the Year 1970.

Table with columns: Final Equalized Value, SOLD FOR TAXES, VALUATIONS BY SCHOOL DISTRICTS AS EQUALIZED BY DEPARTMENT OF TAXATION, Non-Homestead General Tax, Homestead General Tax, 35% Homestead Credit, SPECIAL TAXES, TOTAL TAXES, PAID, WHEN PAID, Number of Receipt, March Settlement 1970, June Settlement 1970, Penalty, November Settlement 1970, Collections to First Monday in January 1971, Delinquent on First Monday in January 1971, Total Delinquent Tax and Penalty, REMARKS.

133-32 al Estate 131-32

Assessment Roll For the Year 1969 and Tax List of Real Property in the

Town of Becker

Where "Yes" is Indicated in Homestead Column, Identify Description on Which House is Located by Letter "H" under the Word "Yes." - Indicate Type of Property: R-Residential, C-Commercial, I-Industrial, U-Utility, F-Farm, L-Lakeshore, T-Timber, M-Mineral

Table with columns: IN WHOSE NAME ASSESSED, SUBDIVISION, Sec. or Lot, Town or Block, Rng., Number of Acres of Land, ESTIMATED MARKET VALUE, ADJUSTED MARKET VALUES (LAND, BUILDINGS, ATTACHED MACHINERY, TOTAL), ASSESSED VALUATIONS (AGRICULTURAL, ALL OTHER), Homestead Tax Credit.

Cass County, Minnesota, for Taxes Payable in the Year 1970.

Table with columns: Final Equalized Value, SOLD FOR TAXES, VALUATIONS BY SCHOOL DISTRICTS AS EQUALIZED BY DEPARTMENT OF TAXATION (District No., Rate, etc.), Non-Homestead General Tax, Homestead General Tax, 35% Homestead Credit, SPECIAL TAXES, TOTAL TAXES, PAID, WHEN PAID, Number of Receipt, March Settlement 1970, June Settlement 1970, Penalty, November Settlement 1970, Penalty, Collections to First Monday in January 1971, Penalty, Delinquent on First Monday in January 1971, Total Delinquent Tax and Penalty, REMARKS.

133-32 al Estate

De Lyle + Catherine L. Johnson

PAID IN FULL SEP 20 1970

9786

Assessment Roll For the Year 1969 and Tax List of Real Property in the Town of Becker

Where "Yes" is Indicated in Homestead Column, Identify Description on Which House is Located by Letter "H" under the Word "Yes." - Indicate Type of Property: R-Residential, C-Commercial, I-Industrial, U-Utility, F-Farm, L-Lakeshore, T-Timber, M-Mineral

Table with columns: IN WHOSE NAME ASSESSED, SUBDIVISION, Sec. or Lot, Town or Block, Rng., Number of Acres of Land, No. School District, Estimated Market Value, ADJUSTED MARKET VALUES (LAND, BUILDINGS, ATTACHED MACHINERY, TOTAL), ASSESSED VALUATIONS (AGRICULTURAL, ALL OTHER), ESTIMATED MARKET VALUE, and Homestead Tax Credit.

Handwritten names: Alex & Hildur Krantz, Reinhold & Emma Krueger, Alex & Hildur Krantz, Alex & Hildur Krantz, Alex & Hildur Krantz, Alex & Hildur Krantz, Alex & Hildur Krantz, Alex & Hildur Krantz, Alex & Hildur Krantz, Alex & Hildur Krantz.

44000

Cass County, Minnesota, for Taxes Payable in the Year 1970.

Table with columns: Final Equalized Value, SOLD FOR TAXES, VALUATIONS BY SCHOOL DISTRICTS AS EQUALIZED BY DEPARTMENT OF TAXATION (District No., Rate, etc.), Non-Homestead General Tax Ex. Bonds, Homestead General Tax Ex. Bonds, 35% Homestead Credit, SPECIAL TAXES, TOTAL TAXES, PAID, WHEN PAID, Number of Receipt, March Settlement, June Settlement, Penalty, November Settlement, Collections to First Monday in January 1971, Delinquent on First Monday in January 1971, Total Delinquent Tax and Penalty, REMARKS.

Handwritten notes: Co 101, Sch 2704, 34 Mills, 18.8 Mills

Handwritten notes: 2nd HALF PAID OCT 27 1970, 1st HALF PAID JUN 1 1970, PAID IN FULL OCT 5 1970, etc.

11416 13408

Assessment Roll For the Year 1969 and Tax List of Real Property in the

Town of Becker

Where "Yes" is Indicated in Homestead Column, Identify Description on Which House is Located by Letter "H" under the Word "Yes." - Indicate Type of Property: R-Residential, C-Commercial, I-Industrial, U-Utility, F-Farm, L-Lakeshore, T-Timber, M-Mineral

Table with columns: IN WHOSE NAME ASSESSED, SUBDIVISION, Sec. or Lot, Town or Block, Rng., Number of Acres of Land, No. School District, Estimated Market Value, ADJUSTED MARKET VALUES, ASSESSED VALUATIONS (AGRICULTURAL, ALL OTHER), and Homestead Tax Credit.

Cass County, Minnesota, for Taxes Payable in the Year 1970.

Table with columns: Final Equalized Value, SOLD FOR TAXES, VALUATIONS BY SCHOOL DISTRICTS AS EQUALIZED BY DEPARTMENT OF TAXATION, Non-Homestead General Tax, Homestead General Tax, 3% Homestead Credit, SPECIAL TAXES, TOTAL TAXES, PAID, WHEN PAID, Number of Receipt, March Settlement 1970, June Settlement 1970, Penalty, November Settlement 1970, Collections to First Monday in January 1971, Delinquent on First Monday in January 1971, Total Delinquent Tax and Penalty, REMARKS.

133-32 al Estate

131-32

695 09

484
#652
#777
1933

27140
38686

484
#652
#1812
215 = 2148

9498
2750
6028

24566
4898

Assessment Roll For the Year 1969 and Tax List of Real Property in the Town of Becker

Where "Yes" is Indicated in Homestead Column, Identify Description on Which House is Located by Letter "H" under the Word "Yes." - Indicate Type of Property: R-Residential, C-Commercial, I-Industrial, U-Utility, F-Farm, L-Lakeshore, T-Timber, M-Mineral

Cass County, Minnesota, for Taxes Payable in the Year 1970.

Table with columns: IN WHOSE NAME ASSESSED, DESCRIPTION OF PROPERTY, ADJUSTED MARKET VALUES, ASSESSED VALUATIONS (AGRICULTURAL, ALL OTHER), and Final Equalized Value.

Table with columns: VALUATIONS BY SCHOOL DISTRICTS AS EQUALIZED BY DEPARTMENT OF TAXATION, Non-Homestead General Tax, Homestead General Tax, 35% Homestead Credit, SPECIAL TAXES, TOTAL TAXES, PAID, WHEN PAID, Number of Receipt, March Settlement 1970, June Settlement 1970, Penalty, November Settlement 1970, Collections to First Monday in January 1971, Delinquent on First Monday in January 1971, Total Delinquent Tax and Penalty, REMARKS.

133-32 al Estate

134-32

Assessment Roll For the Year 1969 and Tax List of Real Property in the

Town of Becker

Where "Yes" is Indicated in Homestead Column, Identify Description on Which House is Located by Letter "H" under the Word "Yes." - Indicate Type of Property: R-Residential, C-Commercial, I-Industrial, U-Utility, F-Farm, L-Lakeshore, T-Timber, M-Mineral

Table with columns: IN WHOSE NAME ASSESSED, DESCRIPTION OF PROPERTY, ADJUSTED MARKET VALUES, ASSESSED VALUATIONS (AGRICULTURAL, ALL OTHER), ESTIMATED MARKET VALUE, etc.

Cass County, Minnesota, for Taxes Payable in the Year 1970.

Table with columns: VALUATIONS BY SCHOOL DISTRICTS AS EQUALIZED BY DEPARTMENT OF TAXATION, Final Equalized Value, SOLD FOR TAXES, Homestead General Tax, SPECIAL TAXES, TOTAL TAXES, PAID, WHEN PAID, Number of Receipt, etc.

133-32 al Estate

FORM BC MILLER-DAVIS CO., MINNEAPOLIS

Assessment Roll For the Year 1969 and Tax List of Real Property in the Town of Becker

Cass County, Minnesota, for Taxes Payable in the Year 1970.

Main table with columns: IN WHOSE NAME ASSESSED, SUBDIVISION, Sec. or Lot, Town or Block, No. School District, ESTIMATED MARKET VALUE, ADJUSTED MARKET VALUES, ASSESSED VALUATIONS (AGRICULTURAL, ALL OTHER), VALUATIONS BY SCHOOL DISTRICTS AS EQUALIZED BY DEPARTMENT OF TAXATION, Final Equalized Value, SOLD FOR TAXES, District No. and Rate, Non-Homestead General Tax, Homestead General Tax, 35% Homestead Credit, SPECIAL TAXES, SPECIAL TAXES, TOTAL TAXES, PAID, WHEN PAID, Number of Receipt, March Settlement 1970, June Settlement 1970, Penalty, November Settlement 1970, Penalty, Collections to First Monday in January 1971, Penalty, Delinquent on First Monday in January 1971, Total Delinquent Tax and Penalty, REMARKS.

Handwritten notes on agricultural and other valuations: 20- 280.00, 10- 100.00, 5- 80.00, 1- 19.00 480.00, 50- 18.00, 25- 6.00 45.00, 10- 3.10 45.00, 5- 1.70, 1- 2.20

Handwritten tax payment records and calculations: 204, 306, 408, 476, 648, 408, 374, 716, 1056, 1142, 2294, 18354, 1512, 1022, 1106, 184, 5788, 21486, 7520, 2246, 22000. Includes 'PAID IN FULL' entries with dates.

Handwritten entries for 'DeLyle & Catherine Johnson' and 'Luben & Esther Catherine Fisher' across rows 6-19 and 20. Includes acreage and assessment details.

131-32 al Estate

Assessment Roll For the Year 1969 and Tax List of Real Property in the

Town of Becker

Where "Yes" is Indicated in Homestead Column, Identify Description on Which House is Located by Letter "H" under the Word "Yes" - Indicate Type of Property: R-Residential, C-Commercial, I-Industrial, U-Utility, F-Farm, L-Lakeshore, T-Timber, M-Mineral

Table with columns: IN WHOSE NAME ASSESSED, SUBDIVISION, Sec. or Lot, Town or Block, Rng., Number of Acres of Land, ESTIMATED MARKET VALUE, ADJUSTED MARKET VALUES, ASSESSED VALUATIONS (AGRICULTURAL, ALL OTHER), and Homestead Tax Credit.

Cass County, Minnesota, for Taxes Payable in the Year 1970.

Table with columns: Final Equalized Value, SOLD FOR TAXES, VALUATIONS BY SCHOOL DISTRICTS AS EQUALIZED BY DEPARTMENT OF TAXATION, Non-Homestead General Tax, Homestead General Tax, 35% Homestead Credit, SPECIAL TAXES, SPECIAL TAXES, TOTAL TAXES, PAID, WHEN PAID, Number of Receipt, March Settlement 1970, June Settlement 1970, Penalty, November Settlement 1970, Penalty, Collections to First Monday in January 1971, Penalty, Delinquent on First Monday in January 1971, Total Delinquent Tax and Penalty, REMARKS.

133-32 at Estate 134-32

Assessment Roll For the Year 1969 and Tax List of Real Property in the

Town of Becker

Where "Yes" is Indicated in Homestead Column, Identify Description on Which House is Located by Letter "H" under the Word "Yes." - **Indicate Type of Property: R-Residential, C-Commercial, I-Industrial, U-Utility, F-Farm, L-Lakeshore, T-Timber, M-Mineral

Table with columns: IN WHOSE NAME ASSESSED, SUBDIVISION, Sec. or Lot, Town or Block, Rng., Number of Acres of Land, ESTIMATED MARKET VALUE, ADJUSTED MARKET VALUES, ASSESSED VALUATIONS (AGRICULTURAL, ALL OTHER), and Homestead Tax Credit.

Cass County, Minnesota, for Taxes Payable in the Year 1970.

Table with columns: Final Equalized Value, SOLD FOR TAXES, VALUATIONS BY SCHOOL DISTRICTS AS EQUALIZED BY DEPARTMENT OF TAXATION, Non-Homestead General Tax, Homestead General Tax, 85% Homestead Credit, SPECIAL TAXES, TOTAL TAXES, PAID, WHEN PAID, Number of Receipt, March Settlement 1970, June Settlement 1970, Penalty, November Settlement 1970, Penalty, Collections to First Monday in January 1971, Delinquent on First Monday in January 1971, Total Delinquent Tax and Penalty, REMARKS.

133-32 al Estate
131-32

Assessment Roll For the Year 1969 and Tax List of Real Property in the

of

"Where "Yes" is Indicated in Homestead Column, Identify Description on Which House is Located by Letter "H" under the Word "Yes." - "Indicate Type of Property: R-Residential, C-Commercial, I-Industrial, U-Utility, F-Farm, L-Lakeshore, T-Timber, M-Mineral

FORM 50 MILLER-DAVIS CO., MINNEAPOLIS

DESCRIPTION OF PROPERTY

ADJUSTED MARKET VALUES

ASSESSED VALUATIONS

Table with columns: IN WHOSE NAME ASSESSED, SUBDIVISION, Sec. or Lot, Town or Block, Reg., Number of Acres of Land, ESTIMATED MARKET VALUE, ADJUSTED MARKET VALUES (LAND, BUILDINGS, ATTACHED MACHINERY, TOTAL ADJUSTED MARKET VALUE), ASSESSED VALUATIONS (AGRICULTURAL, ALL OTHER), and Homestead Tax Credit.

Cass County, Minnesota, for Taxes Payable in the Year 1970.

Table with columns: Final Equalized Value, SOLD FOR TAXES, VALUATIONS BY SCHOOL DISTRICTS AS EQUALIZED BY DEPARTMENT OF TAXATION, Non-Homestead General Tax, Homestead General Tax, 3% Homestead Credit, SPECIAL TAXES, SPECIAL TAXES, TOTAL TAXES, PAID, WHEN PAID, Number of Receipt, March Settlement 1970, June Settlement 1970, Penalty, November Settlement 1970, Penalty, Collections to First Monday in January 1971, Penalty, Delinquent on First Monday in January 1971, Total Delinquent Tax and Penalty, REMARKS.

133-32 al Estate 131-32

39225

62
4301
4383
746
426 = 1192

2002
11718
27194
486
14814
12360
9512
486
5184
4328
9198

Balance Paid NOV 2 1970 19699A
Part Paid JUN 1 1970 11387A

9812-19147

Assessment Roll For the Year 1969 and Tax List of Real Property in the

Town of Becker

Where "Yes" is Indicated in Homestead Column, Identify Description on Which House is Located by Letter "H" under the Word "Yes." - *Indicate Type of Property: R-Residential, C-Commercial, I-Industrial, U-Utility, F-Farm, L-Lakeshore, T-Timber, M-Mineral

FORM 90 MILLER-DAVIS CO., MINNEAPOLIS

Table with columns: IN WHOSE NAME ASSESSED, SUBDIVISION, Sec. or Lot, Town or Block, Rng., Number of Acres of Land, No. School District, Indicate Homestead, Indicate Type of Property, ESTIMATED MARKET VALUE, ADJUSTED MARKET VALUES, ASSESSED VALUATIONS (AGRICULTURAL, ALL OTHER), Final Equalized Value, SOLD FOR TAXES, VALUATIONS BY SCHOOL DISTRICTS AS EQUALIZED BY DEPARTMENT OF TAXATION, Non-Homestead General Tax, Homestead General Tax, 35% Homestead Credit, SPECIAL TAXES, SPECIAL TAXES, TOTAL TAXES, PAID, WHEN PAID, Number of Receipt, March Settlement 1970, June Settlement 1970, Penalty, November Settlement 1970, Penalty, Collections to First Monday in January 1971, Penalty, Delinquent on First Monday in January 1971, Total Delinquent Tax and Penalty, REMARKS.

Arthur J. Hazel & Nelson 1, 2, 3, 4, 5, 6, 7, 8, 9, 10, 11, 12, 13, 14, 15, 16, 17, 18, 19, 20
Joseph V. & John Tootny
Marie B. & John Winkelman
Leo F. & Marian O. Engstrom

Cass County, Minnesota, for Taxes Payable in the Year 1970.

Table with columns: Final Equalized Value, SOLD FOR TAXES, VALUATIONS BY SCHOOL DISTRICTS AS EQUALIZED BY DEPARTMENT OF TAXATION, Non-Homestead General Tax, Homestead General Tax, 35% Homestead Credit, SPECIAL TAXES, SPECIAL TAXES, TOTAL TAXES, PAID, WHEN PAID, Number of Receipt, March Settlement 1970, June Settlement 1970, Penalty, November Settlement 1970, Penalty, Collections to First Monday in January 1971, Penalty, Delinquent on First Monday in January 1971, Total Delinquent Tax and Penalty, REMARKS.

1, 2, 3, 4, 5, 6, 7, 8, 9, 10, 11, 12, 13, 14, 15, 16, 17, 18, 19, 20

7778 2722 1892 6448 1 PAID IN FULL APR 23 1970
1614 392 2006 2 PAID IN FULL APR 23 1970
1452 354 1806 3 PAID IN FULL APR 23 1970
1808 632 440 1616 4 PAID IN FULL APR 23 1970
1484 362 1846 5 2nd HALF PAID OCT 23 1970
5454 1908 1326 4872 6 1st HALF PAID JUN 1 1970
2066 502 2568 7 1st HALF PAID JUN 1 1970
2872 1006 698 2564 8 1st HALF PAID JUN 1 1970
2324 566 2890 9 1st HALF PAID JUN 1 1970
2712 950 660 2422 10 PAID IN FULL MAY 25 1970
14394 5038 3502 12858 11 PAID IN FULL MAY 25 1970
2162 526 2688 12 PAID IN FULL MAY 25 1970
63 494 2528 13 2nd HALF PAID OCT 14 1970
85 668 3412 14 1st HALF PAID JUN 1 1970
191 1500 7664 15 1st HALF PAID JUN 1 1970
137 1076 5498 16 1st HALF PAID JUN 1 1970
476 26466 35018 12256 14958 64186 17 48710 15476

133-32 al Estate
131-32

Assessment Roll For the Year 1969 and Tax List of Real Property in the Town of Lecker

Where "Yes" is Indicated in Homestead Column, Identify Description on Which House is Located by Letter "H" under the Word "Yes." - Indicate Type of Property: R-Residential, C-Commercial, I-Industrial, U-Utility, F-Farm, L-Lakeshore, T-Timber, M-Mineral

FORM 80 MILLER-DAVIS CO., MINNEAPOLIS

Table with columns: IN WHOSE NAME ASSESSED, SUBDIVISION, Sec. or Lot, Town or Block, Number of Acres of Land, No. School District, ESTIMATED MARKET VALUE, ADJUSTED MARKET VALUES, ASSESSED VALUATIONS (AGRICULTURAL, ALL OTHER), and REMARKS.

Cass County, Minnesota, for Taxes Payable in the Year 1970.

Table with columns: Final Equalized Value, SOLD FOR TAXES, VALUATIONS BY SCHOOL DISTRICTS AS EQUALIZED BY DEPARTMENT OF TAXATION, Non-Homestead General Tax, Homestead General Tax, 35% Homestead Credit, SPECIAL TAXES, SPECIAL TAXES, TOTAL TAXES, PAID, WHEN PAID, Number of Receipt, March Settlement 1970, June Settlement 1970, Penalty, November Settlement 1970, Penalty, Collections to First Monday in January 1971, Penalty, Delinquent on First Monday in January 1971, Total Delinquent Tax and Penalty, REMARKS.

133-32 11 Estate

131-32

Assessment Roll For the Year 1969 and Tax List of Real Property in the

Town of Becker

Where "Yes" is Indicated in Homestead Column, Identify Description on Which House is Located by Letter "H" under the Word "Yes." - **Indicate Type of Property: R-Residential, C-Commercial, I-Industrial, U-Utility, F-Farm, L-Lakeshore, T-Timber, M-Mineral

Table with columns: IN WHOSE NAME ASSESSED, SUBDIVISION, Sec. or Lot, Town or Block, Number of Acres of Land, No. School District, Indicate if Homesteaded Yes or No, Indicate Type of Property, ESTIMATED MARKET VALUE, ADJUSTED MARKET VALUES (LAND, BUILDINGS, ATTACHED MACHINERY, TOTAL ADJUSTED MARKET VALUE), ASSESSED VALUATIONS (AGRICULTURAL, ALL OTHER), Total Assessed Value, Homestead Tax Credit.

Cass County, Minnesota, for Taxes Payable in the Year 1970.

Table with columns: Final Equalized Value, SOLD FOR TAXES, VALUATIONS BY SCHOOL DISTRICTS AS EQUALIZED BY DEPARTMENT OF TAXATION (District No., Rate, Mills), Non-Homestead General Tax, Homestead General Tax, 3% Homestead Credit, SPECIAL TAXES, TOTAL TAXES, PAID, WHEN PAID (Month, Day, Year), Number of Receipt, March Settlement 1970, June Settlement 1970, Penalty, November Settlement 1970, Penalty, Collections to First Monday in January 1971, Penalty, Delinquent on First Monday in January 1971, Total Delinquent Tax and Penalty, REMARKS.

Assessment Roll For the Year 1969 and Tax List of Real Property in the

Town of Becker

Where "Yes" is Indicated in Homestead Column, Identify Description on Which House is Located by Letter "H" under the Word "Yes." - Indicate Type of Property: R-Residential, C-Commercial, I-Industrial, U-Utility, F-Farm, L-Lakeshore, T-Timber, M-Mineral

Table with columns: IN WHOSE NAME ASSESSED, DESCRIPTION OF PROPERTY, ADJUSTED MARKET VALUES, ASSESSED VALUATIONS (AGRICULTURAL, ALL OTHER), ESTIMATED MARKET VALUE, and various tax-related fields.

Cass County, Minnesota, for Taxes Payable in the Year 1970.

Table with columns: Final Equalized Value, SOLD FOR TAXES, VALUATIONS BY SCHOOL DISTRICTS AS EQUALIZED BY DEPARTMENT OF TAXATION, Non-Homestead General Tax, Homestead General Tax, 35% Homestead Credit, SPECIAL TAXES, TOTAL TAXES, PAID, WHEN PAID, Number of Receipt, March Settlement 1970, June Settlement 1970, Penalty, November Settlement 1970, Penalty, Collections to First Monday in January 1971, Penalty, Delinquent on First Monday in January 1971, Total Delinquent Tax and Penalty, REMARKS.

133-32 al Estate
131-32

Assessment Roll For the Year 1969 and Tax List of Real Property in the

Town of Becker

Where "Yes" is Indicated in Homestead Column, Identify Description on Which House is Located by Letter "H" under the Word "Yes" - **Indicate Type of Property: R-Residential, C-Commercial, I-Industrial, U-Utility, F-Farm, L-Lakeshore, T-Timber, M-Mineral

Table with columns: IN WHOSE NAME ASSESSED, DESCRIPTION OF PROPERTY, ADJUSTED MARKET VALUES, ASSESSED VALUATIONS (AGRICULTURAL, ALL OTHER), ESTIMATED MARKET VALUE, and various tax-related fields.

Cass County, Minnesota, for Taxes Payable in the Year 1970.

Table with columns: VALUATIONS BY SCHOOL DISTRICTS AS EQUALIZED BY DEPARTMENT OF TAXATION, SPECIAL TAXES, TOTAL TAXES, PAID, WHEN PAID, Number of Receipt, March Settlement 1970, June Settlement 1970, November Settlement 1970, Collections to First Monday in January 1971, Delinquent on First Monday in January 1971, Total Delinquent Tax and Penalty, REMARKS.

133-32 al Estate

134-32

1489

9830

9832

9838

9833

9834

9838

9830

Assessment Roll For the Year 1969 and Tax List of Real Property in the

Dawn of Becker

Cass County, Minnesota, for Taxes Payable in the Year 1970.

FORM 80 MILLER-DAVIS CO., MINNEAPOLIS "Where "Yes" is Indicated in Homestead Column, Identify Description on Which House is Located by Letter "H" under the Word "Yes." - "Indicate Type of Property: R-Residential, C-Commercial, I-Industrial, U-Utility, F-Farm, L-Lakeshore, T-Timber, M-Mineral

Table with columns: IN WHOSE NAME ASSESSED, DESCRIPTION OF PROPERTY, ADJUSTED MARKET VALUES, ASSESSED VALUATIONS (AGRICULTURAL, ALL OTHER), VALUATIONS BY SCHOOL DISTRICTS AS EQUALIZED BY DEPARTMENT OF TAXATION, Final Equalized Value, SOLD FOR TAXES, SPECIAL TAXES, TOTAL TAXES, PAID, WHEN PAID, Number of Receipt, March Settlement 1970, June Settlement 1970, Penalty, November Settlement 1970, Collections to First Monday in January 1971, Delinquent on First Monday in January 1971, Total Delinquent Tax and Penalty, REMARKS.

133-32 al Estate

134-32

227.75
71.51
401.26

CO. 1.02
Sch. 22.49

78.51
Mills

Harriet Eisenlohn
" "
" "
" "
Mary M. Stone
Leonard L. Lrator
" "
Mary M. Stone
Henry L. & Harriet Humphreys
" "
" "
" "
" "
" "
NAVILLUS LAND CO.
NAVILLUS LAND CO.
NAVILLUS LAND CO.
Mike & Leona J. Bjerga

2nd HALF PAID NOV 2 1970
1st HALF PAID JUN 1 1970
2nd HALF PAID NOV 2 1970
1st HALF PAID JUN 1 1970
2nd HALF PAID NOV 2 1970
1st HALF PAID JUN 1 1970
2nd HALF PAID NOV 2 1970
1st HALF PAID JUN 1 1970

9834-19155

9840-19156

9773

9840-19156

9835

9841-19157

Where "Yes" is Indicated in Homestead Column, Identify Description on Which House is Located by Letter "H" under the Word "Yes." - **Indicate Type of Property: R-Residential, C-Commercial, I-Industrial, U-Utility, F-Farm, L-Lakeshore, T-Timber, M-Mineral

DESCRIPTION OF PROPERTY

ADJUSTED MARKET VALUES

ASSESSED VALUATIONS

Table with columns: IN WHOSE NAME ASSESSED, SUBDIVISION, Sec. or Lot, Town or Block, Rng., Number of Acres of Land, No. School District, Estimated Market Value, ADJUSTED MARKET VALUES (LAND, BUILDINGS, ATTACHED MACHINERY, TOTAL ADJUSTED MARKET VALUE), ASSESSED VALUATIONS (AGRICULTURAL, ALL OTHER), and REMARKS.

Cass County, Minnesota, for Taxes Payable in the Year 1970.

Table with columns: Final Equalized Value, SOLD FOR TAXES, VALUATIONS BY SCHOOL DISTRICTS AS EQUALIZED BY DEPARTMENT OF TAXATION (District No., Rate, etc.), Non-Homestead General Tax, Homestead General Tax, 35% Homestead Credit, SPECIAL TAXES, SPECIAL TAXES, TOTAL TAXES, PAID, WHEN PAID, Number of Receipt, March Settlement 1970, June Settlement 1970, Penalty, November Settlement 1970, Penalty, Collections to First Monday in January 1971, Penalty, Delinquent on First Monday in January 1971, Total Delinquent Tax and Penalty, REMARKS.

133-32 al Estate

Leo P. & Marion C. Engstrom
Leo F. & Marion Engstrom
Leo P. & Marion C. Engstrom
Clarence & Lulu Peterson
Larkin B. & Gladys Blake

2nd HALF PAID OCT 13 1970
1st HALF PAID JUN 1 1970
2nd HALF PAID OCT 27 1970
1st HALF PAID MAY 13 1970
2nd HALF PAID OCT 27 1970
1st HALF PAID MAY 13 1970
2nd HALF PAID OCT 27 1970
1st HALF PAID MAY 13 1970
2nd HALF PAID OCT 27 1970
1st HALF PAID JUL 7 1970
2nd HALF PAID MAR 20 1970
1st HALF PAID JUL 7 1970
2nd HALF PAID MAR 20 1970
1st HALF PAID JUL 7 1970
2nd HALF PAID MAR 20 1970

9815.1949
7230.1917
9842
116.18
116.18

Assessment Roll For the Year 1969 and Tax List of Real Property in the

Town of Becker

Where "Yes" is Indicated in Homestead Column, Identify Description on Which House is Located by Letter "H" under the Word "Yes." - **Indicate Type of Property: R-Residential, C-Commercial, I-Industrial, U-Utility, F-Farm, L-Lakeshore, T-Timber, M-Mineral

Table with columns: IN WHOSE NAME ASSESSED, SUBDIVISION, Sec. or Lot, Town or Block, Number of Acres of Land, ESTIMATED MARKET VALUE, ADJUSTED MARKET VALUES, ASSESSED VALUATIONS (AGRICULTURAL, ALL OTHER).

Grand Total 16 970 42
16 930 42

Cass County, Minnesota, for Taxes Payable in the Year 1970.

Table with columns: Final Equalized Value, SOLD FOR TAXES, VALUATIONS BY SCHOOL DISTRICTS AS EQUALIZED BY DEPARTMENT OF TAXATION, Non-Homestead General Tax, Homestead General Tax, SPECIAL TAXES, TOTAL TAXES, PAID, WHEN PAID, Number of Receipt, March Settlement 1970, June Settlement 1970, Penalty, November Settlement 1970, Penalty, Collections to First Monday in January 1971, Delinquent on First Monday in January 1971, Total Delinquent Tax and Penalty, REMARKS.

Grand Total 6202 - 5904 = 2106
73647 7117 75165 48929
7913 72279 410313 7215 720726
17762 2396 21382 215 41755

A# 483 3178 80 255396 89394
7a# 483- 4068 79254 27736

A# 793 3769 40 351178 122914
7a 793 7858 2760

698888 693686 242174 158252 60610 13,686,428