

ASSESSMENT & TAX LIST

Barclay  
1948







SUMMARY OF TAX COLLECTION

Original Levy	- - - - -	\$ 8557.60	
Additions	- - - - -	\$ 12.82	8570.42
<b>Cancellations</b>	- - - - -	\$ 22.74	
Abatements	- - - - -	\$ 47.28	
			\$ 8500.40

COLLECTIONS

March Settlement	- - - - -	\$ 825.09	
June Settlement	- - - - -	\$ 3,708.86	
November Settlement	- - - - -	\$ 2,075.45	
January Settlement	- - - - -	\$ 174.47	6,783.87
Over Collected	- - - - -	\$ 25.66	
Under Collected	- - - - -	\$	
Delinquent	- - - - -	\$ 174.29	1,716.53
Total	- - - - -		\$ 8,500.40

Chiama Beach  
 Norwood  
 REM  
 Gillespie's Addition  
 My Point  
 Dutch Town  
 White Pine Point Add.



Treasurer's Office, Cass County, Minnesota

RECEIVED this, the first Monday (being the 3rd day) of January, A. D. 1949, of L. C. Peterson, Auditor of said County, Minnesota, the Tax List of all Taxable Real and Personal Property in the Town of Barclay in said County for the year A. D. 1948, as specified above and amounting to \_\_\_\_\_ Dollars

Paul S. Jewell  
County Treasurer  
E. C. P.

Auditor's Office, Cass County, Minnesota

I, \_\_\_\_\_ Auditor of said County, and State of Minnesota, do hereby certify that the following is a correct list of the Taxes levied on the Real and Personal Property in the \_\_\_\_\_ of \_\_\_\_\_ for the year 1948.

WITNESS my hand and official seal, the \_\_\_\_\_ day of \_\_\_\_\_ 1949.

(SEAL) \_\_\_\_\_ County Auditor.

Office of County Treasurer, Cass County, Minnesota

To L. C. Peterson, County Auditor:

Sir: I herewith return to you the Tax List for the Town of Barclay in said County for the year 1948, heretofore received from you. I certify that I have compared the same with the duplicate receipts in your office, and have written opposite the amount of each tax so receipted the words "First Quarter Paid", "Second Quarter Paid", "Third Quarter Paid" or "Paid in full" as the case may be, and the number of my receipt given in discharge of said tax, and each tract or lot of real property against which the taxes remain unpaid or delinquent for said year.

Yours respectfully,  
Paul S. Jewell  
County Treasurer.

Auditor's Office, Cass County, Minnesota

I hereby certify that on the first Monday in January 1950, I received of \_\_\_\_\_ County Treasurer, the Tax List of the \_\_\_\_\_ of \_\_\_\_\_ in said County for the year 1948; that I have compared the said list with the Statements receipted for by said Treasurer, which are on file in my office, and that each tract or lot of real property therein against which the taxes, or any part thereof, remains unpaid are delinquent for said year.

(SEAL) \_\_\_\_\_ County Auditor.

January 2nd 1950

Chicama Beach  
Norwood  
Gillespie's Addition  
Dutch Town  
White Pine Point Add.







COLLECTIONS OF TAXES OF 1949 OF \_\_\_\_\_, CASS COUNTY, MINNESOTA

FUNDS	MARCH SETTLEMENT 1949	JUNE SETTLEMENT 1949	NOV. SETTLEMENT 1949	Amount Collected from Nov. 1949 to First Monday in Jan. 1950	REDUCTIONS	Total Reductions and Collected	BALANCE UNCOLLECTED	ADDITIONS	Total Uncollected to First Monday in January, 1950
State - Non-Homestead, State - Homestead,	1025 1209	2737 4687	1738 2688						
County Revenue, County Road and Bridge, County Welfare, County Bond and Interest, SK6.	8240 2536 17080 2782 2289	37693 11598 78124 12725 10470	21617 6651 44805 7298 6005						
Town Revenue, Town Road and Bridge, Town Drag, Town State Loan,	2536 2536 352	11598 11598 1611	6657 6657 924						
School Local 1 Mill, School Special, School State Loan, Deficiency Tuition Transportation A. Bonds B. Bonds Due #1-	352 59773 17150 1634 2289 6937 4789	1610 40978 78447 2900 31733 10470 21907	924 18181 44990 1663 6005 18199 12563						
	82509	370886	207545						

	SCHOOL DISTRICT NO.	LOCAL 1 MILL	SPECIAL	STATE LOAN	TRANS.P.	TUITION	DUE #1	B. BONDS	A. BONDS	DEFICIENCY	TOTALS
MARCH SETTLEMENT	School District No. 18 A 18 71A 19	53 299	796 8982		95 539		717 4072	1039 5898	343 1946	2569 14581	5607 36317
	Totals	352	9778		1634		4789	6937	2289	17150	41924
JUNE SETTLEMENT	School District No. A 19 71A 19	489 1121	7348 33630		882 2018		6662 15245	9650 22083	3184 7286	23856 54591	52071 136974
	Totals	1610	40978		2900		21907	31733	10470	78447	188045
NOVEMBER SETTLEMENT	School District No. A-19 71A-19 Chickma Beach	636 288	9535 8676		1144 519		8644 3919	12522 5677	4132 1873	30955 14035	
	Totals	924	18181		1663		12563	18199	6005	44990	102525
NOVEMBER to JANUARY	School District No.										
	Totals										
ADDITIONS	School District No.										
	Totals										
REDUCTIONS	School District No.										
	Totals										

Chickma Beach  
Horrood  
Gillespie's Addition  
Dutch Town  
White Pine Point Add.























































Assessment Roll and Tax List of Real Property in the Town of Barclay

Form 50-D - 1948 - 1949 - 1950 - 1951

IN WHOSE NAME ASSESSED	TO WHOM TRANSFERRED	DESCRIPTION OF PROPERTY			TRUE AND FULL VALUATIONS				ASSESSED VALUATIONS					FINAL EQUALIZED VALUE			
		SUBDIVISION	Sec. or Lot	Town or Block	Number of Acres of Land	LAND Exclusive of Structures and Improvements	BUILDINGS and Other Structures	MACHINERY Permanently Attached to Real Estate	TOTAL True and Full Value	RURAL		ALL OTHER			MACHINERY Permanently Attached to Real Estate	TOTAL ASSESSED VALUE	Total Assessed Value as Equalized by the Board of Review
										Acres	100ths	Homestead Up to \$4,000 20%	Over \$4,000 and Non-Homestead 33 1/3%				
Paul Hehn		NE 1/4 of NE 1/4			28 138.29	40	Yes	300					300	60		60	
Frank Seifert		NW 1/4 of NE 1/4				40	No	279					279	93		93	
"		SW 1/4 of NE 1/4				40	"	279					279	93		93	
Paul Hehn		SE 1/4 of NE 1/4				40	Yes	300	400				700	140		140	
State of Minnesota		NE 1/4 of NW 1/4															
State of Minnesota		NW 1/4 of NW 1/4															
Clarence B. Paey		SW 1/4 of NW 1/4				40	Yes	300	100				400	80		80	
"		SE 1/4 of NW 1/4				40	"	300					300	60		60	
Charley R. Vance		NE 1/4 of SW 1/4				40	"	320	100				420	84		84	
Laurence J. & Ethel Linn		NW 1/4 of SW 1/4				40	"	480					480	96		96	
"		SW 1/4 of SW 1/4				40	"	480	200				680	136		136	
Olaf Hennuse		SE 1/4 of SW 1/4				40	"	400	100				500	100		100	
Emma Benson State of Minnesota		NE 1/4 of SE 1/4				40	"	280	100				380	76		76	
State of Minnesota (Cons. S. P. Hanson)		NW 1/4 of SE 1/4				40	No	279					279	93		93	
Olaf Hennuse		SW 1/4 of SE 1/4				40	Yes	300					300	60		60	
Henry M. Jabele		SE 1/4 of SE 1/4				40	"	240					240	48		48	
						560		4537	1000				5537	940	379	1219	

Cass County, Minnesota, for Taxes for the Year 1948.

SOLD FOR TAXES	VALUATIONS BY SCHOOL DISTRICTS AS EQUALIZED BY DEPARTMENT OF TAXATION						Tax including State Homestead	State Tax on Non-Homestead	SPECIAL TAXES	TOTAL TAXES	PAID	WHEN PAID	Number of Receipt	March Settlement 1949	June Settlement 1949	Penalty	November Settlement 1949	Penalty	Collections to First Monday in January 1950	Penalty	Delinquent on First Monday in January 1950	Total Delinquent Tax and Penalty	REMARKS	
	District No.	District No.	District No.	District No.	District No.	District No.																		
	Rate	Rate	Rate	Rate	Rate	Rate																		
1																								
2																								
3																								
4																								
5																								
6																								
7																								
8																								
9																								
10																								
11																								
12																								
13																								
14																								
15																								
16																								
17																								
18																								
19																								
20																								

Chilama Beach, Norwood, Gillespie's Addition, City Point, Dutch Town, White Pine Point























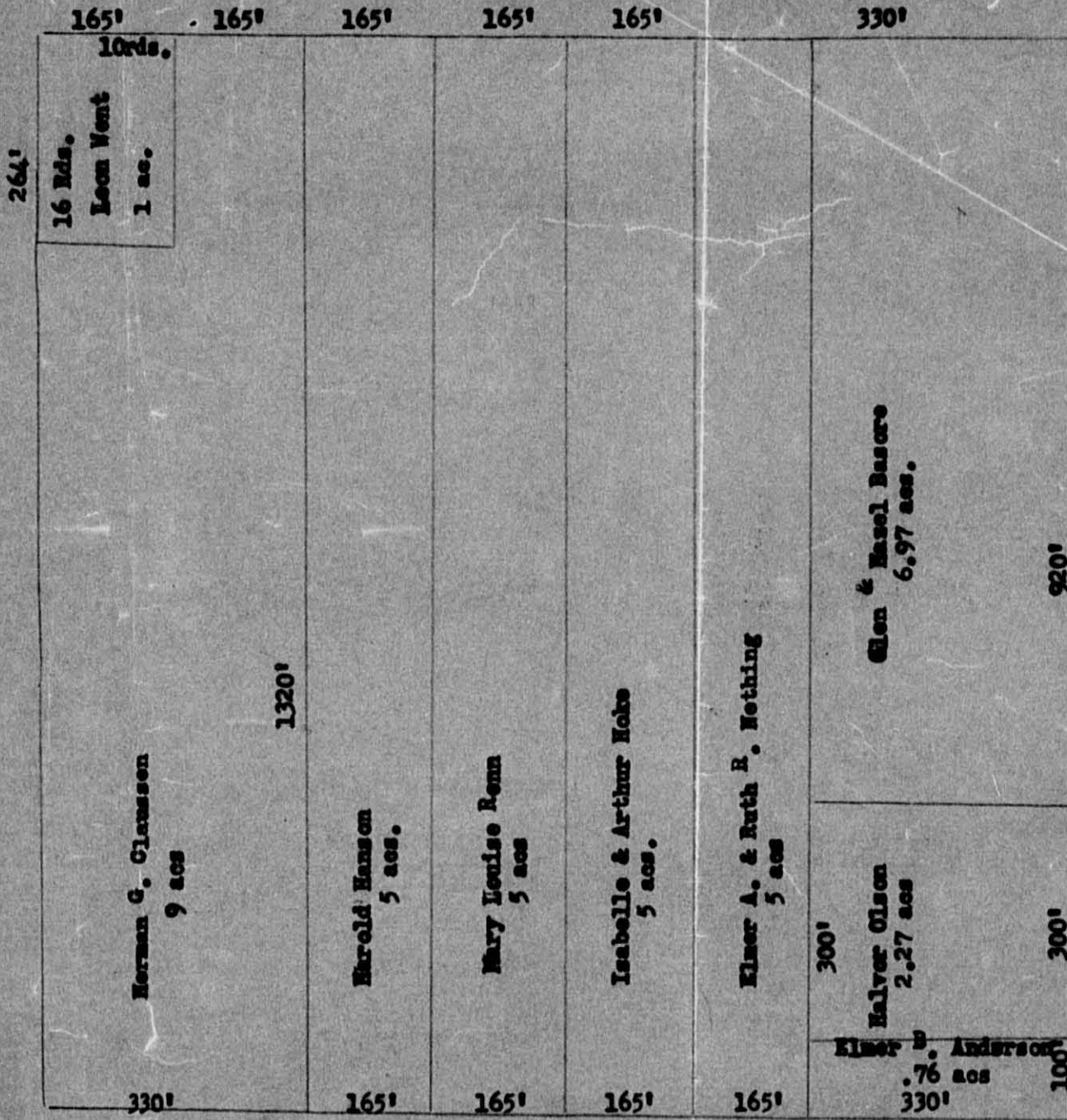

Leon Went - N 16 rds. of W 10 rds of SE 1/4 of NE 1/4 1 ac.  
 Herman G. Claussen— W 20 rds of SE 1/4 of NE 1/4 less  
 N 16 rds of W 10 rds 9 acs.  
 Harold E. Hanson — E 10 rds of W 30 rds of SE 1/4 of NE 1/4 5 acs.  
 Mary Louise Renn— E 10 rds of W 40 rds of SE 1/4 of NE 1/4 5 acs.  
 Isabelle & Arthur Hoke— E 10 rds of W 50 rds of SE 1/4 of NE 1/4 5 acs.  
 Elmer B. Anderson — S 100' of E 330' of SE 1/4 of NE 1/4 .76 acs.  
 Halver Olson — N 300' of S 400' of E 300' of SE 1/4 of NE 1/4 2.27 acs.  
 Glen & Hazel Basore— N 920' of E 330' of SE 1/4 of NE 1/4 6.97 acs.  
 Elmer A. & Ruth E. Nething— E 10 rds of W 60 rds of SE 1/4 of NE 1/4 5 acs.















Bar clay Truf

Chas Herman lot 4 less platten sec 30-138-29  
listed at 70.60 claims only 1+ are and  
also most Bog checks ✓

---

Gabley & Adella Brewer

<sup>SW 1/4 of SE 1/4</sup>  
N. W 1/4 of N. E 1/4 of sec. 19-138  
-29. Building value raised  
to \$500.00 in stead of \$100.  
by order of Town Board ✓

---

C. J. Cliff, K. Kaufman

S. W. 1/4 of S. E 1/4 17-138-29 ✓

value raised from \$240. to \$400.  
by Board



Barclay

Arthur Macaul

S. E.  $\frac{1}{4}$  of S. W  $\frac{1}{4}$  sec, 29-138-29

Value raised on Buildings from  
\$500. to \$650. by Board.

---

Charles Lewis + Anna E. Thompson

Part of lot about  $2\frac{1}{2}$  acres  
sec, 30-138-29

Value raised from \$600. to \$800.  
ordered by Board, (on Buildings)

---

Carl a Ryan 10 acres of lot 3  
W. of Norway Brook, sec, 31-138-29.

Value of Buildings raised from  
\$700. to \$900.

ordered by Board



Bunday

Lena Mabel, Anna, Martha Matilda  
Harbach. Chicama - Black lot 1 Block 1.  
Value on Buildings front \$200. to \$300.  
also lot 3 to be raised from \$150. to \$200.  
ordered by Board

---

Claire M. Morgan Lot 7. <sup>Block 2</sup> Woodward  
value raised from \$225 to \$350.  
on buildings ordered by board.

---

H. J. Whitten No. 61 of lot 8.  
raised from \$200. to \$300. on Buildings  
as ordered by board.

---

near Nelson Market lot less  
N. N. 75 of E. 140. lot 2.  
value of building raised from  
\$400. to \$400. as ordered by board.

---



John L. and Virginia A. Rossi  
Shady Point Lot 4

Raised from \$270. to \$300.

lot 5 raised from \$60. to \$100.

lot 6 raised from \$400. to \$600.

lot 7 from \$80. to \$100.

lot 8 from \$302 to \$400.

as ordered by board.

---

Will L. and Maude M. King  
lot 2. block 1. <sup>White Pine Point</sup>

It be raised \$200. to \$300.

on buildings

as ordered by board.

---

Dr. Madeline Dempster lot 30 block A

valuation on building from

\$300. to \$400.

lot 33 Cottage to raised \$100. to \$200.

lot 34 " " " " \$100. to 200.

as ordered by board.



White Pine Point  
James & Edith M. Wilson lot 43  
~~to be a building to be raised~~  
from 150 to 200.

lot 44 Cottages of location to be  
raised from \$150 to \$200.

ordered by board

---











































Assessment Roll and Tax List of Real Property in the Town of Barclay

Cass County, Minnesota, for Taxes for the Year 1948.

IN WHOSE NAME ASSESSED	TO WHOM TRANSFERRED	DESCRIPTION OF PROPERTY				TRUE AND FULL VALUATIONS										FINAL EQUALIZED VALUE	
		SUBDIVISION	Sec. or Lot	Town or Block	Rng.	Number of Acres of Land	LAND EXCLUSIVE OF STRUCTURES AND IMPROVEMENTS					ASSESSED VALUATIONS					
							Acres	100ths	Dollars	Dollars	Dollars	Dollars	Dollars	Dollars	Dollars		Dollars
V. Madeline Tempelad		White Pine Saint Addition	21	1				20								5na	
"	"		22					20								5na	
"	"		23					20								5na	
"	"		24					20								5na	
"	"		25					20								5na	
"	"		26					20								5na	
"	"		27					20								5na	
"	"		28					20								5na	
"	"		29					20								5na	
"	"		30					20	400 Sup. Bt.	420						5na	
"	"		31					20	800 Chg.	320						80na	105
"	"		32					20								5na	
"	"		33					20	200 Sup. Bt.	220						5na	
"	"		34					20	100 Chg.	120						48na	88
"	"		35					20	200 Sup. Bt.	220						48na	88
"	"		36					20	100 Chg.	120						8na	8
Arling R. & Lillian Grand	J. H. Cora H. Hanson		36					36								9na	
"	"		37					36								9na	
"	"		38					34	350	584						96na	
Geo. H. & Clara H. Leitner			39					35	200	235						94na	
"	"		40					35		35						14na	
								496	1350	1826						224	292

SOLD FOR TAXES	VALUATIONS BY SCHOOL DISTRICTS AS EQUALIZED BY DEPARTMENT OF TAXES						Tax including State Homestead	SPECIAL TAXES	TOTAL TAXES	PAID	WHEN PAID	Number of Receipt	March Settlement 1949	June Settlement 1949	November Settlement 1949	Penalty	Collections to First Monday in January 1950	Penalty	Delinquent on First Monday in January 1950	Total Delinquent Tax and Penalty	REMARKS	
	District No.	District No.	District No.	District No.	District No.	District No.																
	Rate	Rate	Rate	Rate	Rate	Rate																
1																						
2																						
3																						
4																						
5																						
6																						
7																						
8																						
9																						
10																						
11																						
12																						
13																						
14																						
15																						
16																						
17																						
18																						
19																						
20																						

Beach  
Norwood  
Liespie's Addition  
Shady Point  
White

B. F. Rhoades Plat  
Norway  
North Shore  
Pleasant View



















