

ASSESSMENT & TAX LIST

**Bardley**

**1950**

DIRECTIONS TO ASSESSOR

OFFICE OF COUNTY AUDITOR,
County, Minn.,
1950.

To \_\_\_\_\_, Assessor of the \_\_\_\_\_,
According to the requirements of law, I herewith deliver to you the Real and Personal Property Assessment Books for the \_\_\_\_\_ of \_\_\_\_\_ for the year 1950, containing a list of all Real Estate subject to taxation, so far as the same have come to my knowledge from any source, and I hereby direct you to assess all Property and make return thereof to me as required by the laws of the State of Minnesota prescribing the duties of the assessor.

A form of the return to be signed by you is appended in this book.

County Auditor.

Extracts from Laws Relating to the Listing of Personal Property.

(Section Numbers Refer to Minnesota Statutes 1945)

Sec. 272.01. PROPERTY SUBJECT TO TAXATION. All real and personal property in this state, and all personal property of persons residing therein, is taxable, except such as is by law exempt from taxation.

WHEN LISTED AND ASSESSED

Sec. 273.01. Personal property shall be listed and assessed annually with reference to its value on May 1, and if acquired on that day, shall be listed by or for the persons acquiring it.

Sec. 273.22. By whom listed. Personal property shall be listed in the manner following:

- 1. Every item of real estate and every item of personal property owned by a person shall be listed by such person.
2. If the property is owned by a partnership, it shall be listed by one of the partners.
3. If the property is owned by a corporation, it shall be listed by one of its officers.
4. If the property is owned by a trust, it shall be listed by the trustee.
5. If the property is owned by a partnership, it shall be listed by one of the partners.
6. If the property is owned by a corporation, it shall be listed by one of its officers.
7. If the property is owned by a trust, it shall be listed by the trustee.

Sec. 273.23. Merchants, consignees, and persons in possession of property. Every merchant and consignee shall list the property in his hands as if it were his own. Every person in possession of property shall list the property in his hands as if it were his own.

Sec. 273.24. Farm property. Farm property shall be listed and assessed annually with reference to its value on May 1, and if acquired on that day, shall be listed by or for the persons acquiring it.

Sec. 273.25. Certain personal property. Where listed, all personal property used by the owner for personal and domestic purposes shall be listed and assessed in the manner following:

- 1. The property of a firm or company, by the proper agent thereof.
2. The property of a partnership, by one of the partners.
3. The property of a corporation, by one of its officers.
4. The property of a trust, by the trustee.
5. The property of a partnership, by one of the partners.
6. The property of a corporation, by one of its officers.
7. The property of a trust, by the trustee.

Sec. 273.26. False statement regarding taxes. Every person who makes a false statement regarding taxes shall be liable to a fine of not more than \$100.

Sec. 273.27. False statement regarding taxes. Every person who makes a false statement regarding taxes shall be liable to a fine of not more than \$100.

Sec. 273.28. False statement regarding taxes. Every person who makes a false statement regarding taxes shall be liable to a fine of not more than \$100.

Sec. 273.29. False statement regarding taxes. Every person who makes a false statement regarding taxes shall be liable to a fine of not more than \$100.

Sec. 273.30. False statement regarding taxes. Every person who makes a false statement regarding taxes shall be liable to a fine of not more than \$100.

Sec. 273.31. False statement regarding taxes. Every person who makes a false statement regarding taxes shall be liable to a fine of not more than \$100.

Sec. 273.32. False statement regarding taxes. Every person who makes a false statement regarding taxes shall be liable to a fine of not more than \$100.

Sec. 273.33. False statement regarding taxes. Every person who makes a false statement regarding taxes shall be liable to a fine of not more than \$100.

Sec. 273.34. False statement regarding taxes. Every person who makes a false statement regarding taxes shall be liable to a fine of not more than \$100.

Sec. 273.35. False statement regarding taxes. Every person who makes a false statement regarding taxes shall be liable to a fine of not more than \$100.

Sec. 273.36. False statement regarding taxes. Every person who makes a false statement regarding taxes shall be liable to a fine of not more than \$100.

Sec. 273.37. False statement regarding taxes. Every person who makes a false statement regarding taxes shall be liable to a fine of not more than \$100.

Sec. 273.38. False statement regarding taxes. Every person who makes a false statement regarding taxes shall be liable to a fine of not more than \$100.

Sec. 273.39. False statement regarding taxes. Every person who makes a false statement regarding taxes shall be liable to a fine of not more than \$100.

Sec. 273.40. False statement regarding taxes. Every person who makes a false statement regarding taxes shall be liable to a fine of not more than \$100.

Sec. 273.41. False statement regarding taxes. Every person who makes a false statement regarding taxes shall be liable to a fine of not more than \$100.

Sec. 273.42. False statement regarding taxes. Every person who makes a false statement regarding taxes shall be liable to a fine of not more than \$100.

INDEX TO SECTIONS

SECTION	PAGE
Sec. 1	
" 2	
" 3	
" 4	
" 5	
" 6	
" 7	
" 8	
" 9	
" 10	
" 11	
" 12	
" 13	
" 14	
" 15	
" 16	
" 17	
" 18	
" 19	
" 20	
" 21	
" 22	
" 23	
" 24	
" 25	
" 26	
" 27	
" 28	
" 29	
" 30	
" 31	
" 32	
" 33	
" 34	
" 35	
" 36	

For Convenience of Auditor in Showing Boundaries of School Districts

All Sch. Dist. # 19

Township N<sup>o</sup> 138 N. Range N<sup>o</sup> 29 W. 5<sup>th</sup> Mer.

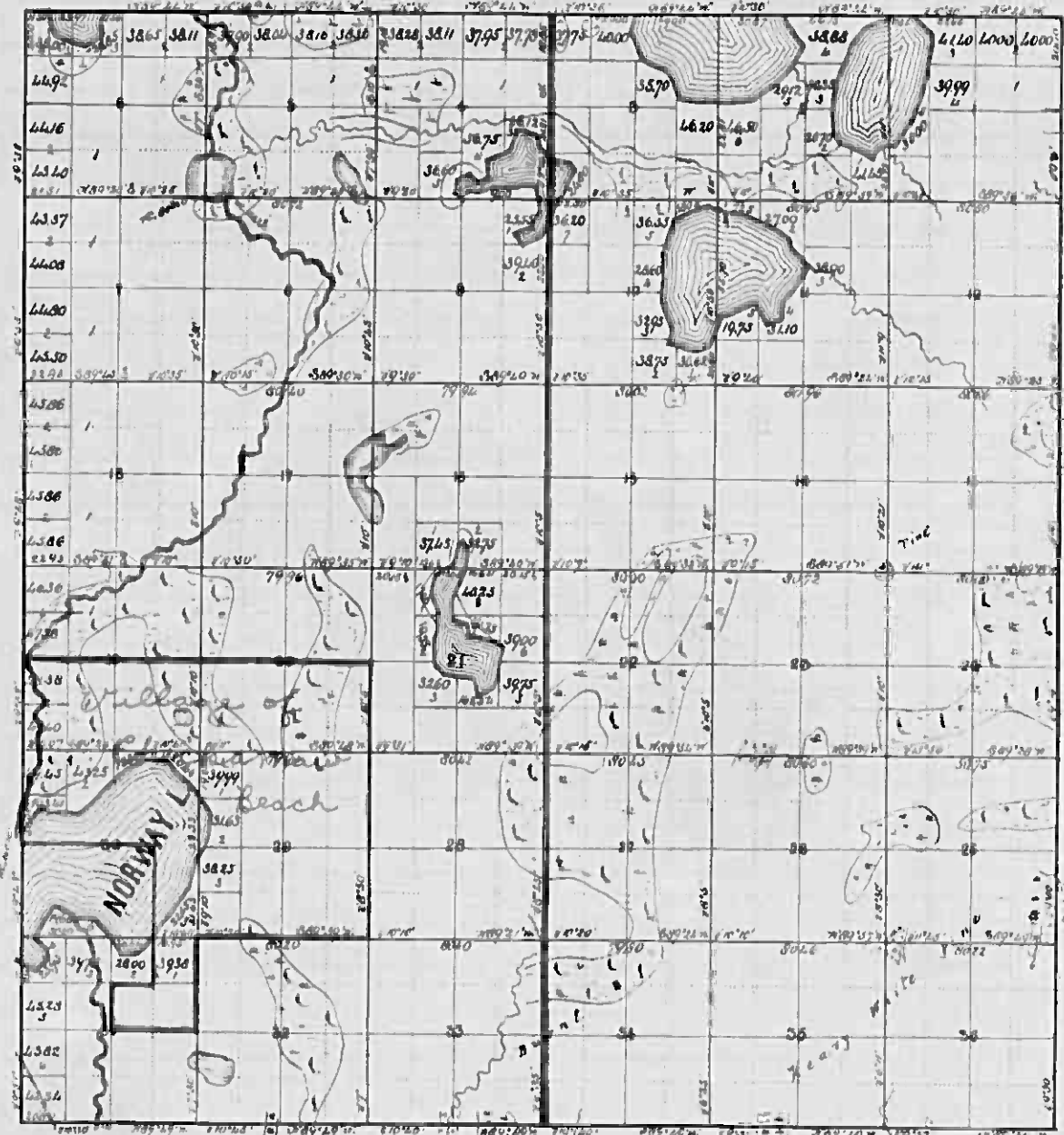

ITASCA COUNTY ABSTRACT COMPANY  
GRAND RAPIDS, MINN.

Returns Showing Grain Received in or Handled by Elevators, Warehouses and Mills in the \_\_\_\_\_ of \_\_\_\_\_ in the \_\_\_\_\_ County of \_\_\_\_\_ for the Year Ending May 1, 1950.

NAMES OF OWNERS	ADDRESS	Bushels of Wheat	Bushels of Soy Beans	Bushels of Flax	Total No. of Bushels of Wheat, Soy Beans and Flax	★ Tax of 1/2 Mill per Bushel		Bushels of Corn	Bushels of Barley	Bushels of Rye	Bushels of Oats	Bushels of Buckwheat	Bushels of all Other Grains	Total No. Bushels of Corn, Barley, Rye, Oats, Buckwheat and all Other Grains	★ Tax of 1/4 Mill Per Bushel		★ Total Tax		REMARKS		
						Dollars	Cts.								Dollars	Cts.	Dollars	Cts.			

Note ★ Assessors will not fill these Columns

Assessor's Return of Exempt Real Property in the \_\_\_\_\_ of \_\_\_\_\_ County of \_\_\_\_\_, Minnesota, for the Year 1950

FORM 2

NAMES OF OWNERS	DESCRIPTION				No. of Acres	FOR WHAT PURPOSE USED	TRUE AND FULL VALUATIONS			ASSESSED VALUATIONS		REMARKS	
	SUBDIVISION	Sec. or Lot	Town or Block	Range			LAND Exclusive of Structures and Improvements	BUILDINGS and Other Structures	MACHINERY Permanently Attached to Real Estate	TOTAL True and Full Value	Rural Including Machinery		All Other
											Dollars		Dollars
					Acres								
					100ths								

SUMMARY OF TAX COLLECTION

Original Levy	\$ 9254.62
Additions	\$ 7234.62
Cancelled	\$ 54.42
Abatements	\$ 140.24
	\$ 194.66

COLLECTIONS

March Settlement	\$ 520.90
June Settlement	\$ 4059.05
November Settlement	\$ 2218.28
January Settlement	\$ 194.41
	\$ 6992.64
Over Collected	\$ 12.18
Under Collected	\$
Delinquent	\$ 2079.50
	\$ 2067.32
Total	\$ 9254.62

58

QUINCY'S ADULTIC  
 HAVY POH  
 DORCH TERN  
 ADDITION  
 WHITE PINE PLANT  
 B. F. ROAD'S PLANT

Assessor's Return

FORM 2

NAMES OF OWNERS

Treasurer's Office, Cass County, Minnesota

RECEIVED this, the first Monday (being the 2 day) of January, A. D. 1951, of L. C. Peterson, Auditor of said County, Minnesota, the Tax List of all Taxable Real and Personal Property in the Town of Barclay in said County for the year A. D. 1950, as specified above and amounting to 100 Dollars

Paul D Jewell County Treasurer E.C.P.

Office of County Treasurer, Cass County, Minnesota

To L. C. Peterson, County Auditor:

Sir: I herewith return to you the Tax List for the Town of Barclay in said County for the year 1950, heretofore received from you. I certify that I have compared the same with the duplicate receipts in your office, and have written opposite the amount of each tax so receipted the words "First Quarter Paid", "Second Quarter Paid", "Third Quarter Paid" or "Paid in full" as the case may be, and the number of my receipt given in discharge of said tax, and each tract or lot of real property against which the taxes remain unpaid is delinquent for said year. Yours respectfully,

County Treasurer.

Auditor's Office, Cass County, Minnesota

I, Auditor of said County, and State of Minnesota, do hereby certify that the following is a correct list of the Taxes levied on the Real and Personal Property in the Town of Barclay in said County for the year 1950.

WITNESS my hand and official seal, the day of 1951.

(SEAL) County Auditor.

Auditor's Office, Cass County, Minnesota

I hereby certify that on the first Monday in January 1952, I received of County Treasurer, the Tax List of the County for the year 1950; that I have compared the said list with the Statements receipted for by said Treasurer, which are on file in my office, and that each tract or lot of real property therein against which the taxes, or any part thereof, remains unpaid are delinquent for said year.

(SEAL) County Auditor.

Assessor's Return

TABULAR SCHEDULE OF VALUATIONS,

RATES AND TAXES

LEVIED IN THE Town OF Barclay

COUNTY OF CASS, STATE OF MINNESOTA

School District No.	Agri-cultural Lands	Non-Agri-cultural Lands	Personal Property	Total Value of all Property except Money and Credits	Rate of State Tax	Rate of County Taxes	Rate of Town Taxes	Rate of School Taxes
	Dollars	Dollars	Dollars	Dollars	Mills	Mills	Mills	Mills
28-117	30,659	11,439	2,114	44,212	4.12	25.8	13.6	42.4
19								
Assessed Value	Rural	All Other	Personal Property	Total				
Homestead	14,737	16,283		25,020				
Non-Homestead	12,090	4,988	2,114	19,192				
Total	26,827	15,271	2,114	44,212				

VALUATION BY SCHOOL DISTRICTS				RATE OF STATE TAXES		RATE OF COUNTY TAXES					RATE OF TOWN TAXES										RATE OF SCHOOL TAXES			TAXES LEVIED																
School District No.	Agri-cultural Lands	Non-Agri-cultural Lands	Personal Property	Total Value of all Property except Money and Credits	Rate of State Tax	Rev.	R. & B.	Welfare	Bonds and Int.	Pub. Emp. Ret.	Total Rate of County Tax	Rev.	R. & B.	Drag Tax	State Loan	Total Rate of Town Tax	Local	Special	State Loan	Deficiency	Tuition	Transportation	"A" Bonds	"B" Bonds	Total Rate of Sch'l Tax	Total Rate of all Taxes	Local 1 Mill	Special	State Loan	Ref. Transp.	"A" Bonds	"B" Bonds	C.O.	Total School Taxes	FUNDS	Rate	Amounts			
28-117	30,659	11,439	2,114	44,212	4.12	25.8	13.6	42.4	16.7	.4	98.9	6.2	6.2	1.	13.4	1.	15.	42.1	42.1		3.	6.4	7.7	11.2	86.4	202.87	3065	45989	129073	9196	23607	34338	19622	264889	State-Non-Homestead, State-Homestead,		8462	18215		

LOCAL 1 MILL AND SPECIAL SCHOOL TAXES BY DISTRICTS										ALL OTHER TAXES																													
Local 1 Mill	Special	State Loan	Ref. Transp.	"A" Bonds	"B" Bonds	C.O.	Total School Taxes	FUNDS	Rate	Amounts																													
86.4	202.87	3065	45989	129073	9196	23607	34338	19622	264889	8462																													
101.4	217.87	1355	40657	57086	4066	10435	15178	8674	137421	18215																													
							4420	86645		114062																													
							186129	13262	34042	49516	28296	402310	60125	187456	73831	1765	4372.39	27409	27409	4418	592.36																		

Total Number of Acres 8725.24  
 State of Minnesota,  
 COUNTY OF CASS  
 Auditor of said County and State aforesaid, do hereby certify that the foregoing is a true and correct Schedule, showing the valuation of all the taxable property, in the Town of Barclay, in said County, the several rates of Taxation and Totals of the several Tax Funds levied thereon for the year A. D. 1950 day of December, A. D. 1950  
 Witness my hand and official seal, this 11 day of December, A. D. 1950  
 L. C. Peterson  
 County Auditor

Total Taxes Real Estate 8784.90  
 Pers. Prop. 469.72  
 Total 9254.62



Assessor's Return

COLLECTIONS OF TAXES OF 1950, Town OF Baraboo, CASS COUNTY, MINNESOTA

FUNDS	MARCH SETTLEMENT 1950	JUNE SETTLEMENT 1950	NOV. SETTLEMENT 1950	Amount Collected from Nov. 1st to First Monday in Jan. 1951	REDUCTIONS	Total Reductions and Collected	BALANCE UNCOLLECTED	ADDITIONS	Total Uncollected to First Monday in January, 1951
State—Non-Homestead, State—Homestead,	1056 974	2853 8012	1671 4379	160 373					
County Revenue, County Road and Bridge, County Welfare, County Bond and Interest, Pub. Emp. Ret.	6122 3280 10225 4027 76	50170 26446 82450 32474 778	27423 14433 45067 17750 425	2457 1296 4041 1592 38					
Town Revenue, Town Road and Bridge, Town Drag, Town State Loan,	1495 1495 241	12055 12056 1745	6590 6590 1063	591 591 95					
School Local 1 Mill, School Special, School State Loan, Deficiency Tuition Transportation "A" Bonds "B" Bonds	242 5240 10152 724 1543 1857 2701	1945 37823 81866 5834 12445 14973 21779	1063 20524 44748 3187 6803 8184 11904	95 1430 4073 286 610 734 1067					
	52070	405905	221928	19441					

	LOCAL 1 MILL	SPECIAL	STATE LOAN	G.O.	Deficit	Transp.	"A" Bonds	"B" Bonds	TOTALS
MARCH SETTLEMENT									
School District No. <u>A#19</u> <u>A#19</u>	100 142	1493 4247		637 906	4178 5961	277 425	767 1090	1115 1586	8602 14357
Totals	242	5740		1543	10152	724	1857	2701	22959
JUNE SETTLEMENT									
School District No. <u>A#19</u> <u>A#19</u>	1368 577	20514 17309		8753 3692	57577 24287	4103 1731	10531 4442	15317 6462	118163 58502
Totals	1945	37823		12445	81866	5834	14973	21779	176665
NOVEMBER SETTLEMENT									
School District No. <u>A#19</u> <u>A#19</u>	758 305	11364 9160		4849 1954	31894 12854	2273 916	5833 2351	8485 3419	65456 30959
Totals	2063	20524		6803	44748	3187	8184	11904	96415
NOVEMBER to JANUARY									
School District No. <u>A#19</u> <u>A#19</u>	95	1430		610	4013	286	734	1067	8235
Totals	95	1430		610	4013	286	734	1067	8235
ADDITIONS									
School District No.									
Totals									
REDUCTIONS									
School District No.									
Totals									

58.55

GILLESPIE'S ADDRESS BOOK  
 WHITE PINE COUNTY  
 B. F. ROADERS PUBLISHER







Table with columns for Description of Property, True and Full Valuations, Assessed Valuations, Final Equalized Value, Sold for Taxes, and Tax details (District, State, Special, Total, PAID, etc.). Includes handwritten entries for property owners like Mark Westfall, Owen & Doris Brown, Lloyd Turk, etc.















Assessment Roll and Tax List of Real Property in the Town of Barclay

Cass County, Minnesota, for Taxes for the Year 1950.

Table with multiple columns: IN WHOSE NAME ASSESSED, TO WHOM TRANSFERRED, DESCRIPTION OF PROPERTY, TRUE AND FULL VALUATIONS, ASSESSED VALUATIONS, VALUATIONS BY SCHOOL DISTRICTS AS EQUALIZED BY DEPARTMENT OF TAXATION, TAX INCLUDING STATE HOMESTEAD, SPECIAL TAXES, TOTAL TAXES, PAID, WHEN PAID, Number of Receipt, March Settlement, June Settlement, November Settlement, Collection to First Monday in January 1951, Delinquent on First Monday in January 1952, Total Delinquent Tax and Penalty, REMARKS. Includes handwritten entries for Arthur Macal, Evangelin Bjurstrom, Charles Bjurstrom, Albert Alvin Jansen, Thomas J. & Lloyed J. Riley, Atlas Realty Co, Minnesota Farms Company, Harold R. Kline.

Assessment Roll and Tax List of Real Property in the Town of Barley

Cass County, Minnesota, for Taxes for the Year 1950.

Table with columns: IN WHOSE NAME ASSESSED, TO WHOM TRANSFERRED, DESCRIPTION OF PROPERTY, TRUE AND FULL VALUATIONS, ASSESSED VALUATIONS, VALUATIONS BY SCHOOL DISTRICTS AS EQUALIZED BY DEPARTMENT OF TAXATION, SOLD FOR TAXES, SPECIAL TAXES, TOTAL TAXES, PAID, WHEN PAID, Number of Receipt, March Settlement 1951, June Settlement 1951, November Settlement 1951, Penalty, Collections to First Monday in January 1952, Delinquent on First Monday in January 1952, Total Delinquent Tax and Penalty, REMARKS. Includes entries for State of Minnesota, Charles P. + Gloria Bates, and Mrs. T. Riley.

Assessment Roll and Tax List of Real Property in the Town of Barclay

Table with columns: IN WHOSE NAME ASSESSED, TO WHOM TRANSFERRED, DESCRIPTION OF PROPERTY (SUBDIVISION, Acres, etc.), TRUE AND FULL VALUATIONS (LAND, BUILDINGS, MACHINERY, TOTAL), ASSESSED VALUATIONS (RURAL, ALL OTHER, MACHINERY, TOTAL ASSESSED VALUE), and FINAL EQUALIZED VALUE.

Cass County, Minnesota, for Taxes for the Year 1950.

Table with columns: SOLD FOR TAXES, VALUATIONS BY SCHOOL DISTRICTS AS EQUALIZED BY DEPARTMENT OF TAXATION (District No., Rate, etc.), Tax Including State Homestead, State Tax on Non-Homestead, SPECIAL TAXES, TOTAL TAXES, PAID, WHEN PAID, Number of Receipts, March Settlement, June Settlement, November Settlement, Collection to First Monday in January 1952, Delinquent on First Monday in January 1952, Total Delinquent Tax and Penalty, REMARKS.

GILBERT'S ADPTD. SECT. POL. DITCH TOWN WHITE PINE POLICE B. F. HOWARD PART 1

Assessment Roll and Tax List of Real Property in the Town of Burley

Cass County, Minnesota, for Taxes for the Year 1950.

Form 504 - 5-15-50 - Minnesota, 1948 Edition

Table with columns for Description of Property, True and Full Valuations, Assessed Valuations, Final Equalized Value, and Remarks. Includes handwritten entries for Wayne Hoff and Joseph Pigeon.

Table with columns for Sold for Taxes, Validations by School Districts, Tax Including State Homestead, State Tax on Non-Homestead, Special Taxes, Total Taxes, Paid, When Paid, Number of Receipt, March Settlement, June Settlement, November Settlement, Collections to First Monday in January, Delinquent on First Monday in January, Total Delinquent Tax and Penalty, and Remarks.







1951  
Book copy  
in all of  
from  
Book  
Went  
9-19-50

Assessment Roll and Tax List of Real Property in the Town of Barley

Cass County, Minnesota, for Taxes for the Year 1950.

Table with columns: DESCRIPTION OF PROPERTY, TRUE AND FULL VALUATIONS, ASSESSED VALUATIONS, VALUATIONS BY SCHOOL DISTRICTS AS EQUALIZED BY DEPARTMENT OF TAXATION, SOLID FOR TAXES, PAID, WHEN PAID, Number of Receipt, March Settlement 1951, June Settlement 1951, November Settlement 1951, Collections to First Monday in January 1952, Delinquent on First Monday in January 1952, Total Delinquent Tax and Penalty, REMARKS.





IN WHOSE NAME ASSESSED	TO WHOM TRANSFERRED	DESCRIPTION OF PROPERTY					TRUE AND FULL VALUATIONS				ASSESSED VALUATIONS							FINAL EQUALIZED VALUE	SOLD FOR TAXES	VALUATIONS BY SCHOOL DISTRICTS AS EQUALIZED BY DEPARTMENT OF TAXATION						Tax including State Homestead	State Tax on Non-Homestead \$ .40 Mills	SPECIAL TAXES	TOTAL TAXES	PAID	WHEN PAID	Number of Receipt	March Settlement 1951	June Settlement 1951	Penalty	November Settlement 1951	Penalty	Collections to First Monday in January 1952	Penalty	Delinquent on First Monday in January 1952	Total Delinquent Tax and Penalty	REMARKS
		SUBDIVISION	Sec or Lot	Town or Block	Rng.	Number of Acres of Land	LAND Exclusive of Structures and Improvements	BUILDINGS and Other Structures +20%	MACHINERY Permanently Attached to Real Estate	TOTAL True and Full Value	RURAL		ALL OTHER		MACHINERY Permanently Attached to Real Estate 33 1/3%	TOTAL ASSESSED VALUE	Total Assessed Value as Equalized by the Board of Review			District No.	District No.	District No.	District No.	District No.	District No.																	
Alice M. Amy											NE 1/4 of NE 1/4	32	R	29				4	19	Jpa	470	875	730	1345	269	269	240	269	1	SOLD FOR TAXES		H	269	5456	5456			2nd Half Paid OCT 31 1951	4119			
		NW 1/4 of NE 1/4				4	"		480			480	76	76	96		2			H	96	1948	1948			2nd Half Paid OCT 31 1951	1419												2728			
Robert D. + Rena M. Holloway		SW 1/4 of NE 1/4				4	"		400	200	200	600	120	120	120	120	3			H	120	2596	2596			2nd Half Paid OCT 31 1951	2388											2728				
		SE 1/4 of NE 1/4				4	"		390			390	78	78	78		4			H	78	1582	1582			2nd Half Paid OCT 31 1951	631											2728				
																	5																									
Nile K. Elizabeth A. Anderson		NE 1/4 of NW 1/4				4	"		390			390	78	78	78		6			H	78	1582	1582			2nd Half Paid OCT 29 1951	1348															
		NW 1/4 of NW 1/4				4	"		500			500	100	100	100		7			H	100	2028	2028			2nd Half Paid OCT 29 1951	1348															
		SW 1/4 of NW 1/4				4	"		520	1035	1035	1765	353	353	312	353	8			H	353	7160	7160			2nd Half Paid OCT 29 1951	1348															
		SE 1/4 of NW 1/4				4	"		410			410	82	82	82		9			H	82	1664	1664			2nd Half Paid OCT 29 1951	1348															
																	10																									
		NE 1/4 of SW 1/4				4	"		310			310	62	62	62		11			H	62	1258	1258			2nd Half Paid OCT 29 1951	1348															
		NW 1/4 of SW 1/4				4	"		385			385	77	77	77		12			H	77	1562	1562			2nd Half Paid OCT 29 1951	1348															
J. A. + Irene Goranson		SW 1/4 of SW 1/4				4	"		531	504	420	1035	325	325	317	345	13					345	6998	152	7150		PAID IN FULL MAY 3 1951	8248														
		SE 1/4 of SW 1/4				4	"		390			390	130	130	130		14					130	2636	58	2694		PAID IN FULL MAY 3 1951	8248														
																	15																									
William J. + Margaret Kraus		NE 1/4 of SE 1/4				4	"	Jpa	565	720	600	1285	267	267	233	257	16					5212	5212			PAID IN FULL APR 23 1951	4668															
		NW 1/4 of SE 1/4				4	"		445			445	89	89	89		17					1806	1806			PAID IN FULL APR 23 1951	4668															
Roderic C. + Leah E. Gilchrist		SW 1/4 of SE 1/4				4	"		525	270	1060	1585	359	317	309	359	18					7282	7282			PAID IN FULL APR 23 1951	3972															
		SE 1/4 of SE 1/4				4	"		440			440	88	88	88		19					1784	1784			PAID IN FULL APR 23 1951	3972															
						640			7161	4844	4040	12005	2116	2116	475		20					52554	210	52764																		

CASS COUNTY ADJUTANT GENERAL DUTCH TOWN ADJUTANT WHITE PINE TOWN ADJUTANT B. F. RIGGOLD'S PLAN



IN WHOSE NAME ASSESSED	TO WHOM TRANSFERRED	DESCRIPTION OF PROPERTY				TRUE AND FULL VALUATIONS							FINAL EQUALIZED VALUE	VALUATIONS BY SCHOOL DISTRICTS AS EQUALIZED BY DEPARTMENT OF TAXATION																		REMARKS						
		SUBDIVISION	Sec. or Lot	Town or Block	No. of Acres of Land	LAND Exclusive of Structures and Improvements	BUILDINGS and Other Structures	MACHINERY Permanently Attached to Real Estate	TOTAL True and Full Value	RURAL		ALL OTHER		MACHINERY Permanently Attached to Real Estate	TOTAL ASSESSED VALUE	Total Assessed Value as Equalized by the Board of Review	SCHOOL DISTRICTS						SPECIAL TAXES	TOTAL TAXES	PAID	WHEN PAID	Number of Receipts	March Settlement 1951	June Settlement 1951	Penalty	November Settlement 1951		Penalty	Collections to First Monday in January 1952	Penalty	Delinquent on First Monday in January 1952	Total Delinquent Tax and Penalty	
										Homestead Up to \$4,000 20%	Over \$4,000 and Non-Homestead 33 1/3%	Homestead Up to \$4,000 25%					Over \$4,000 and Non-Homestead 40%	No. District	Rate	No. District	Rate	No. District																Rate
		Acres	100ths	Yes or No	Yes or No	Dollars	Dollars	Dollars	Dollars	Dollars	Dollars	Dollars		Dollars	Dollars	Dollars	Dollars	Dollars	\$ cts.	\$ cts.	\$ cts.	\$ cts.	\$ cts.	\$ cts.	\$ cts.	Month	Day	Year	\$ cts.	\$ cts.	\$ cts.		\$ cts.	\$ cts.	\$ cts.	\$ cts.	\$ cts.	

GIMESPIES'S ADDITION CHAZY POIN DUTCH TOWNS WHITE PINE POINT B. F. RHOADS'S PLAT

Assessment Roll and Tax List of Real Property in the \_\_\_\_\_ of \_\_\_\_\_

IN WHOSE NAME ASSESSED	TO WHOM TRANSFERRED	DESCRIPTION OF PROPERTY			TRUE AND FULL VALUATIONS									FINAL EQUALIZED VALUE	
		SUBDIVISION	Sec. of Lot	Town or Block	Number of Acres of Land		LAND Exclusive of Structures and Improvements	BUILDINGS and Other Structures	MACHINERY Permanently Attached to Real Estate	ASSESSED VALUATIONS					Total Assessed Value as Equalized by the Board of Review
					20%	33 1/3%				RURAL		MACHINERY Permanently Attached to Real Estate	TOTAL ASSESSED VALUE		
										Homestead Up to \$4,000	Over \$4,000 and Non-Homestead				
Acres	100ths	Dollars	Dollars	Dollars	Dollars	Dollars	Dollars	Dollars	Dollars	Dollars					
		NE 1/4 of NE 1/4													
		NW 1/4 of NE 1/4													
		SW 1/4 of NE 1/4													
		SE 1/4 of NE 1/4													
		NE 1/4 of NW 1/4													
		NW 1/4 of NW 1/4													
		SW 1/4 of NW 1/4													
		SE 1/4 of NW 1/4													
		NE 1/4 of SW 1/4													
		NW 1/4 of SW 1/4													
		SW 1/4 of SW 1/4													
		SE 1/4 of SW 1/4													
		NE 1/4 of SE 1/4													
		NW 1/4 of SE 1/4													
		SW 1/4 of SE 1/4													
		SE 1/4 of SE 1/4													

Cass County, Minnesota, for Taxes for the Year 1950.

SOLD FOR TAXES	VALIDATIONS BY SCHOOL DISTRICTS AS EQUALIZED BY DEPARTMENT OF TAXATION												SPECIAL TAXES	TOTAL TAXES	PAID	WHEN PAID	Number of Receipt	March Settlement 1951	June Settlement 1951	November Settlement 1951	Penalty	Collections to First Monday in January 1952	Penalty	Delinquent on First Monday in January 1952	Total Delinquent Tax and Penalty	REMARKS				
	District No.	District No.	District No.	District No.	District No.	District No.	Including State Homestead	State Tax on Non-Homestead	Rate	Rate	Rate	Rate																		
	Rate	Rate	Rate	Rate	Rate	Rate	Mills	Mills	Mills	Mills	Mills	Mills																		
	Dollars	Dollars	Dollars	Dollars	Dollars	Dollars	\$ cts.	\$ cts.	\$ cts.	\$ cts.	\$ cts.	\$ cts.																		
1																														
2																														
3																														
4																														
5																														
6																														
7																														
8																														
9																														
10																														
11																														
12																														
13																														
14																														
15																														
16																														
17																														
18																														
19																														
20																														

GILLESPIE'S ADJUTIC SHAFF FOLI DUGCH TON WHITE PINE POLICE B.F. ROARDS PLAT 1





Table with columns: IN WHOSE NAME ASSESSED, TO WHOM TRANSFERRED, SUBDIVISION, TRUE AND FULL VALUATIONS (LAND, BUILDINGS, MACHINERY, TOTAL), ASSESSED VALUATIONS (RURAL, ALL OTHER, MACHINERY, TOTAL ASSESSED), VALUATIONS BY SCHOOL DISTRICTS, SOLD FOR TAXES, TAXES, PAID, WHEN PAID, March Settlement, June Settlement, November Settlement, Collections to First Monday in January, Delinquent on First Monday in January, Total Delinquent Tax and Penalty, REMARKS.











Assessment Roll and Tax List of Real Property in the Town of Barclay of County of Cass

IN WHOSE NAME ASSESSED	TO WHOM TRANSFERRED	DESCRIPTION OF PROPERTY					TRUE AND FULL VALUATIONS											FINAL EQUALIZED VALUE
		Subdivision	Sec. or Lot	Town or Block	Rng.	Number of Acres of Land	LAND EXCLUSIVE OF STRUCTURES AND IMPROVEMENTS					ASSESSED VALUATIONS						
							Acres	100ths	LAND EXCLUSIVE OF STRUCTURES AND IMPROVEMENTS	BUILDINGS AND OTHER STRUCTURES	MACHINERY PERMANENTLY ATTACHED TO REAL ESTATE	TOTAL True and Full Value	RURAL	ALL OTHER	MACHINERY	TOTAL ASSESSED VALUE	Total Assessed Value as Equalized by the Board of Review	
<p>White Pine Point Addition</p> <p>James I. &amp; Edith M. Wilson</p> <p>James I. &amp; Edith M. Wilson</p> <p>Peter J. &amp; Margaret Darrell</p> <p>James H. &amp; Clara E. Benson</p> <p>Oswell A. &amp; Dorothy King</p> <p>Robert L. &amp; Lillian Sales</p> <p>Richard B. &amp; Anna E. Holmstrom</p> <p>Oswell A. King</p> <p>R. L. &amp; Mary J. Lewis</p> <p>Oswell A. King</p> <p>Frank A. &amp; Shirley Kall</p> <p>Olav B. &amp; Anna S. Norgren</p>																		

SOLD FOR TAXES	VALUATIONS BY SCHOOL DISTRICTS AS EQUALIZED BY DEPARTMENT OF TAXATION						Tax Including State Homestead	Sale Tax on Non-Homestead	SPECIAL TAXES	TOTAL TAXES	PAID	WHEN PAID	Number of Receipts	March Settlement 1951	June Settlement 1951	Penalty	November Settlement 1951	Penalty	Collections to First Monday in January 1952	Penalty	Delinquent on First Monday in January 1952	Total Delinquent Tax and Penalty	REMARKS	
	District No.	District No.	District No.	District No.	District No.	District No.																		
	Rate	Rate	Rate	Rate	Rate	Rate																		
	Mills	Mills	Mills	Mills	Mills	Mills																		

WHITE PINE POINT DUTCH TOWN SHADY POINT TO PINE RIVER ADDITION

Tabular Statement B. F. REARDS FIN 21





