

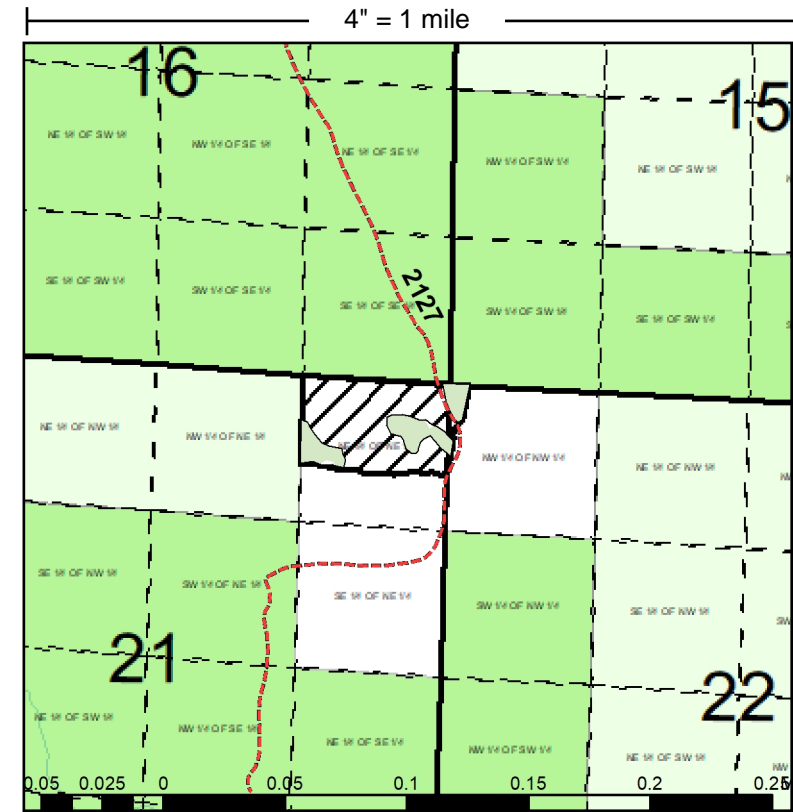

Permitee:	Sale Administrator:	Permit Number:
MICHAEL THOMAS	ERIK LINDQUIST	124072
49269 317TH AVE		Date Purchased: 10/31/2024
CASS LAKE MN 56633		Date Expires: 3/1/2027
		ExtendedTo:
		Sale Type: REGULAR AUCTION SALE
		Season: Winter Access Only
		Access: Public Access

Legal Description: NENE, Sect. 21, Twp. 144, Rng. 26.	<b>Sale Acres</b>
	ASPEN 20.10
	LOWLAND HARDWOODS 6.20
	Total Sale Acres 26.30
	<b>Block # Latitude Longitude</b>
	1 47° 17' 0.11" -93° 58' 7.43"



- STANDARD REGULATIONS** Ref. ms282
- 1.This timber sale is not transferable.
  - 2.Prior to any sale activity notify Sale Administrator.
  3. Permittee responsible for following Minnesota Site-Level Forest Management Guidelines
  4. Reserve all painted boundary trees.
  5. Trees, slash and landings to be kept in sale area.
  6. Permittee responsible for ensuring conformance with cutting regulations.
  7. Roads and trails are to be left in as good or better than pre-sale condition.
  8. All tipped or leaning trees are to be felled.
  9. Dead and den trees may be left standing.
  10. Do not leave garbage or waste on permit area.
  11. All equipment and cut timber not removed from permit area within 30 days of permit expiration date, becomes the property of the County of Cass and removal of such will constitute trespass. (ms 282.04 Subd 2). All uncut timber becomes property of the County of Cass on the permit expiration date and removal of such will constitute trespass (MN 282.04 Subd 2).
  12. Harvest operations will be halted if rutting occurs. Ask administrator for specific guidelines.
  13. Tree damage exceeding 5% of the residual trees/acre on clearcuts and 3% of the residual trees/acre on thinnings will be charged as trespass. Ask administrator for specific guidelines.

**SPECIAL REGULATIONS:**  
Access is off forest road 2127. Logger required to notify appropriate road authority and acquire permits prior to moving into sale. Harvest aspen, ash, maple and birch; reserve basswood, bur oak and cedar. No activity allowed in red painted reserve patch.

APPRAISAL OF TIMBER				Price		Value	
Code	Species	Volume	Unit	Appr.	Bid	Appr.	Bid
+	ASPEN	480.00	Cords	\$22.00	\$39.60	\$10,560.00	\$19,008.00
+	ASH	80.00	Cords	\$9.00	\$16.20	\$720.00	\$1,296.00
+	MAPLE	10.00	Cords	\$10.00	\$18.00	\$100.00	\$180.00
+	BIRCH	10.00	Cords	\$12.00	\$21.60	\$120.00	\$216.00
Total						\$20,700.00	

**Codes** + = area estimate

Receipt of payment on this permit is confirmation of agreement of terms between the permittee and Cass County. The permit holder agrees to and will abide by the terms and conditions set forth in this permit.

Report Date: 5/28/2025

**Cass County Forest Lands are FSC Certified by NEPCon FSC-100% PBN-FM/COC-000117**  
Must be an equal opportunity employer, hire, supervise, pay, have adequate Worker's Compensation, Social Security, required insurance coverage for labor, and provide appropriate safety measures based on relevant OSHA Standards.