

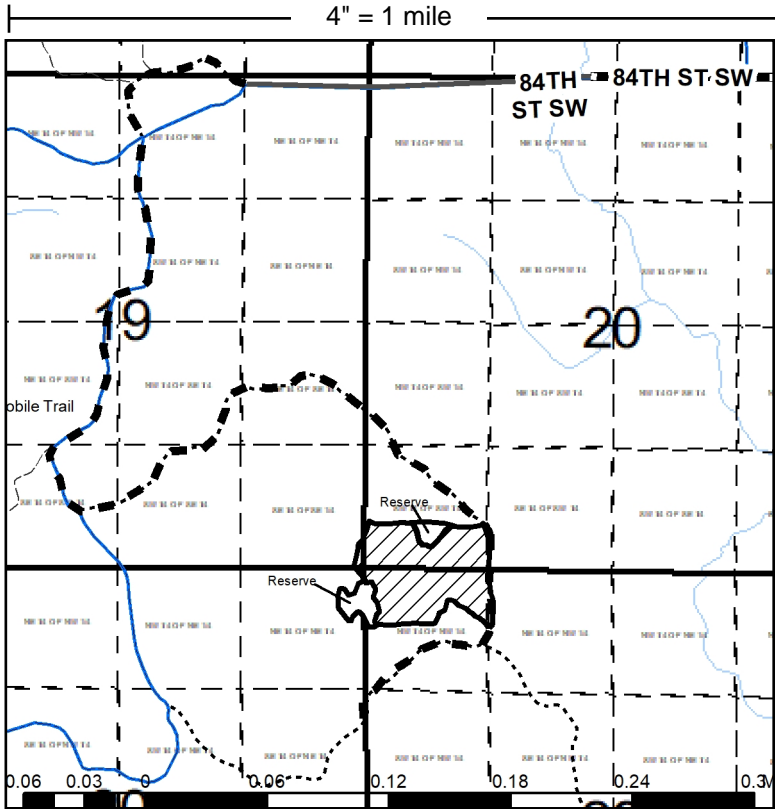

Permittee:  MINNESOTA TIMBER LLC PO BOX 315  BRAINERD MN 56401	Sale Administrator:  PAT BUNDY	Permit Number: 123002 Date Purchased: 1/26/2023 Date Expires: 3/1/2025 ExtendedTo: Sale Type: INTERMEDIATE AUCTION Season: Winter Access Only Access: Public Access
Legal Description: SESE, Sect. 19, Twp. 135, Rng. 30. S½SW , Sect. 20, Twp. 135, Rng. 30. N½NW , Sect. 29, Twp. 135, Rng. 30. NENE , Sect. 30, Twp. 135, Rng. 30.		<b>Sale Acres</b> OAK 33.24 Total Sale Acres 33.24 <b>Block #</b> <b>Latitude</b> <b>Longitude</b> 1                      46° 29' 10.38"                      -94° 29' 43.84"

STANDARD REGULATIONS                      Ref. ms282

- 1.This timber sale is not transferable.
- 2.Prior to any sale activity notify Sale Administrator.
3. Permittee responsible for following Minnesota Site-Level Forest Management Guidelines
4. Reserve all painted boundary trees.
5. Trees, slash and landings to be kept in sale area.
6. Permittee responsible for ensuring conformance with cutting regulations.
7. Roads and trails are to be left in as good or better than pre-sale condition.
8. All tipped or leaning trees are to be felled.
9. Dead and den trees may be left standing.
10. Do not leave garbage or waste on permit area.
11. All equipment and cut timber not removed from permit area within 30 days of permit expiration date, becomes the property of the County of Cass and removal of such will constitute trespass. (ms 282.04 Subd 2). All uncut timber becomes property of the County of Cass on the permit expiration date and removal of such will constitute trespass (MN 282.04 Subd 2).
12. Harvest operations will be halted if rutting occurs. Ask administrator for specific guidelines.
13. Tree damage exceeding 5% of the residual trees/acre on clearcuts and 3% of the residual trees/acre on thinnings will be charged as trespass. Ask administrator for specific guidelines.



SPECIAL REGULATIONS:

CUT ALL SPECIES LISTED IN A PROGRESSIVE MANNER WITHIN SALE AREA. RESERVE ALL ELM & CHERRY. CUT ALL STEMS GREATER THAN 2" DBH. DAMAGE TO 5% OR MORE OF RESIDUAL TREES SHALL BE CHARGED AS TRESPASS PER CASS COUNTY TREE DAMAGE GUIDELINES. LOP & SCATTER ALL SLASH TO WITHIN 2' OF GROUND ON SALE AREA. FROZEN GROUND ONLY, DUE TO ACCESS AND SOIL TYPE. NO SKID TRAILS, SLASH PILES, LANDINGS, OR NEW ROADS ALLOWED WITHIN 50 FEET OF ANY WETLAND, TO MAINTAIN FILTER STRIP INTEGRITY. 3-4 INCHES OF SNOW MUST BE LEFT ON GIA SNOWMOBILE TRAIL TO FACILITATE SNOWMOBILE TRAFFIC FROM DEC 1 - APRIL 1.

APPRAISAL OF TIMBER

Code	Species	Volume	Unit	Price		Value	
				Appr.	Bid	Appr.	Bid
+	ASPEN	78.00	Cords	\$18.00	\$18.00	\$1,404.00	\$1,404.00
+	RED OAK	610.00	Cords	\$18.00	\$18.00	\$10,980.00	\$10,980.00
+	BUR OAK	33.00	Cords	\$10.00	\$10.00	\$330.00	\$330.00
+	BIRCH	67.00	Cords	\$12.00	\$12.00	\$804.00	\$804.00
+	BASSWOOD	77.00	Cords	\$10.00	\$10.00	\$770.00	\$770.00
+	MAPLE	31.00	Cords	\$10.00	\$10.00	\$310.00	\$310.00
+	ASH	92.00	Cords	\$8.00	\$8.00	\$736.00	\$736.00
				Total		\$15,334.00	

Codes    + = area estimate

Receipt of payment on this permit is confirmation of agreement of terms between the permittee and Cass County. The permit holder agrees to and will abide by the terms and conditions set forth in this permit.

Report Date:                      5/22/2025

Cass County Forest Lands are FSC Certified by NEPCon FSC-100% PBN-FM/COC-000117

Must be an equal opportunity employer, hire, supervise, pay, have adequate Worker's Compensation, Social Security, required insurance coverage for labor, and provide appropriate safety measures based on relevant OSHA Standards.