

340200

Number.....

99

.....Chippewa.....National Forest

CORNER.....1/4 cor. common to sections 28 and 33.....T. 147...., R. 27. W., 5th. P. Mer.

CORNER DESCRIPTION AND MARKINGS

Corner not found.

WITNESSES

T 147 N R 27 W  
S 33  
B T  
Bur oak  
Diam. 5"  
Bear. ?  
Dist. ?

-

T 147 N R 27 W  
S 28  
B T  
Wh. pine  
9"  
Bear. ?  
Dist. ?

GENERAL LOCATION

(Relation to other corners by alignment and measurement, also with topographic features, roads, streams, trails, fence corners or other distinctive objects which will enable others to locate. Mention blazing done if any).

Probably brass capped stake some where out on felowage grass. Probably surveyed and set during Williams Narrows controversy, 1926-27. B Ts on edge of flowage.

.....C. B. STOTT.....

Forest.....Chippewa.....

Date Found.....7/18/29.....

340200

Form 874-9—Revised May, 1918

U. S. DEPARTMENT OF AGRICULTURE  
FOREST SERVICE

Chippewa NATIONAL FOREST

CORNERS OF THE PUBLIC SURVEY

T. 147 N R. 27 W 5 p Mer.

1/4 Corner common to Sections

28, and 33

Corner consists of a not found (not) in place  
State condition L

Dimensions above ground \_\_\_\_\_ inches.

Sketch grooves, letters, figures, or notches, on proper face or edge.

CARDINAL POSITION

DIAGONAL POSITION

N	W	S	E

NW	SW	SE	NE

Mound of \_\_\_\_\_ is located \_\_\_\_\_

\_\_\_\_\_ Pits are located \_\_\_\_\_

Sketch markings of Bearing Trees (or Rocks) in proper box and fill blanks below, giving bearings from Corner to Trees and Distances in Links.

T147N R27W S33
----------------------

--

T147N R27W S28
----------------------

--

BT
----

--

BT
----

--

Species Bur oak \_\_\_\_\_ W. Pine \_\_\_\_\_

Diameter 5" \_\_\_\_\_ 9" \_\_\_\_\_

Bearing ? \_\_\_\_\_ ? \_\_\_\_\_

Distance ? \_\_\_\_\_ ? \_\_\_\_\_

Do you believe this to be a genuine Land Office Corner? Yes

If not, why? \_\_\_\_\_

C. Stott  
Signature.

Forest Ranger  
Title.

7-18-29  
Date.



T. 147N R. 27 W Sp Mer.

8-3027

(Make sketch of topography near Corner.)

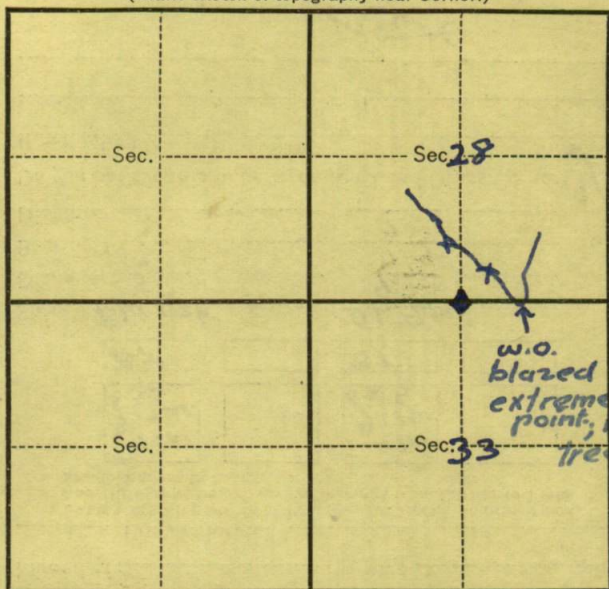

Metal Location Poster is on a None  
tree    inches diameter, on the     
side of     
from which this Corner bears     
   chains distant.

Give any further facts which will aid in finding this Corner again.

Probably brass capped  
stake some where out on flowage  
grass. Probably surveyed and  
set during Wms narrow  
controversy. B.T's on edge of  
flowage.