

700400

70

Miner National Forest

Township 144 Range 26 Meridian

27

Corner 18-19 on Range Line.

Corner Description

New Stake

Corner Markings

None

Witnesses

18" N P NE 1.10 ch
18" J P NW .25
18" N P Stump W 1 ch

General Location

(Relation to other corners by alignment and measurement, also with topographic features, roads, streams, trails, fence corners or other distinctive objects which will enable others to locate. Mention blazing done if any.)

Aug 1925

Petheram + Rodenback

Forest _____

checked
1/25
H.W.
SH
3-28

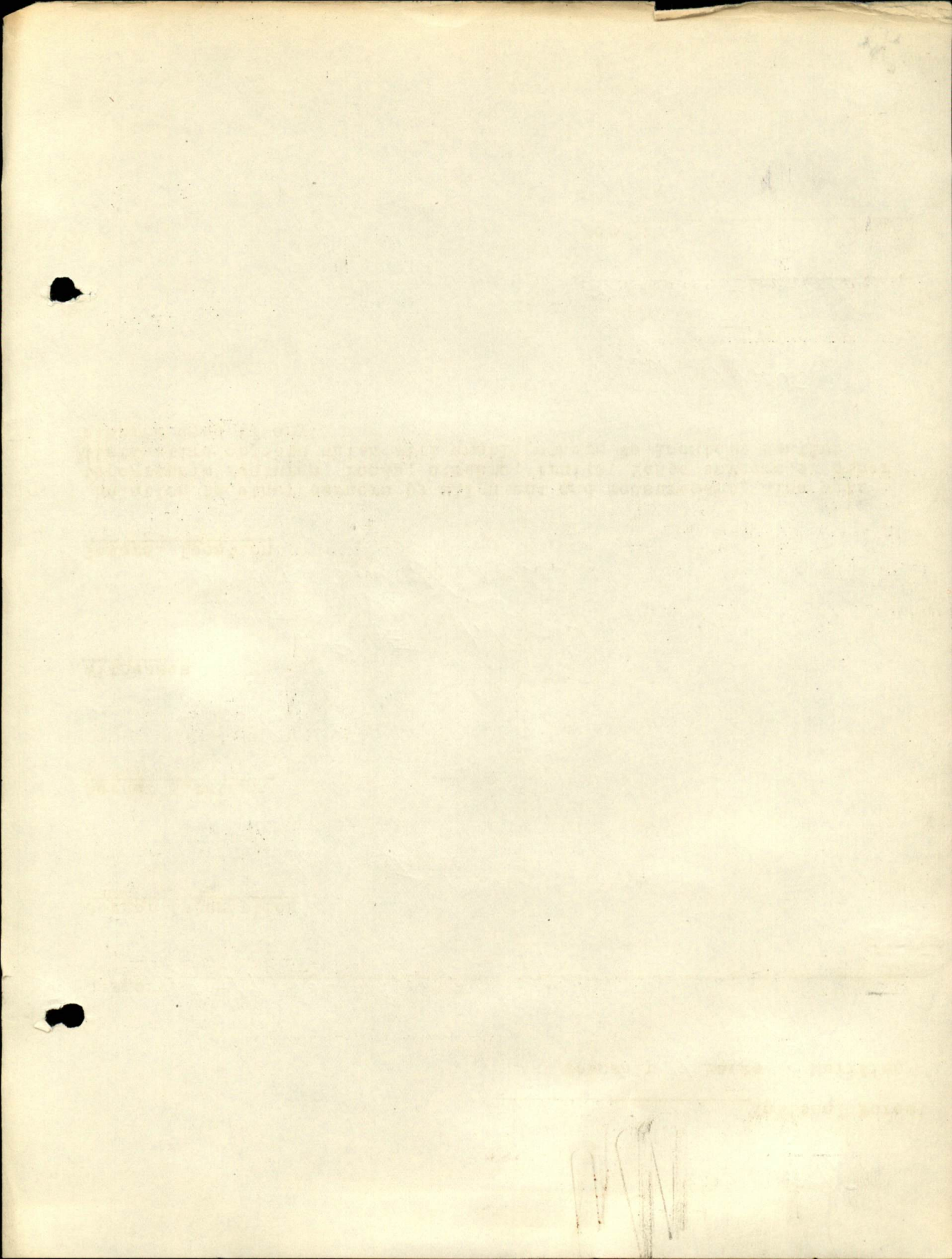

U. S. DEPARTMENT OF AGRICULTURE

FOREST SERVICE

Min

NATIONAL FOREST

CORNERS OF THE PUBLIC SURVEY

T. *14* R. *56 + 27 W 5th* Mer.

Section Corner common to Sections

15, *+4*, *13*, and *24*

Corner consists of a *2 x 2 stake* (not) in place

State condition *Very loose*

Dimensions above ground *3 6* inches.

Sketch grooves, letters, figures, or notches, on proper face or edge.

CARDINAL POSITION

DIAGONAL POSITION

N	W	S	E

NW	SW	SE	NE

Mound of _____ is located _____

Pits are located _____

Sketch markings of Bearing Trees (or Rocks) in proper box and fill blanks below, giving bearings from Corner to Trees and Distances in Links.

T144
R27
S13

X

144
R26

Species *IP* *Aspen Norway*

Diameter *14"* *16"* *18"*

Bearing *N45W* *N30E* *N60E*

Distance *248* *748* *638*

Do you believe this to be a genuine Land Office Corner? *yes*

If not, why? _____

246W

W.L.G.

Signature.

11/30/27

Date.

For R.

Title.

T. 24 N R. 26 W 5th Mer.

8-3027

(Make sketch of topography near Corner.)

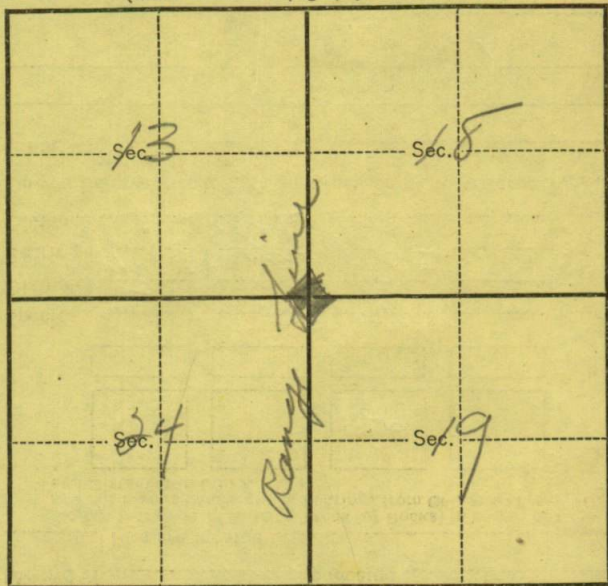

Metal Location Poster is on a J.P.
 tree 4 inches diameter, on the East
 side of tree
 from which this Corner bears N40E
4 chains distant.

Give any further facts which will aid in finding this
 Corner again.

Just N.E. of
a little low 1/2 x 1/2
may have an
unexplained