

#3

NEW

TISON

TISON

BOOK

NEW

Book 3

USFS 263

LAND CORNER MONUMENTS

INDEX

T 150N R 26W 5th Principle MER.

| | | | | | | | | | | | | | | | | | | | | | | | | | |
|---|---|---|---|---|---|---|---|---|---|----|----|----|----|----|----|----|----|----|----|----|----|----|----|----|----|
| | 1 | 2 | 3 | 4 | 5 | 6 | 7 | 8 | 9 | 10 | 11 | 12 | 13 | 14 | 15 | 16 | 17 | 18 | 19 | 20 | 21 | 22 | 23 | 24 | 25 |
| A | | | | | | | | | | | | | | | | | | | | | | | | | |
| B | | | | | | | | | | | | | | | | | | | | | | | | | |
| C | | | | | | | | | | | | | | | | | | | | | | | | | |
| D | | | | | | | | | | | | | | | | | | | | | | | | | |
| E | | | | | | | | | | | | | | | | | | | | | | | | | |
| F | | | | | | | | | | | | | | | | | | | | | | | | | |
| G | | | | | | | | | | | | | | | | | | | | | | | | | |
| H | | | | | | | | | | | | | | | | | | | | | | | | | |
| I | | | | | | | | | | | | | | | | | | | | | | | | | |
| J | | | | | | | | | | | | | | | | | | | | | | | | | |
| K | | | | | | | | | | | | | | | | | | | | | | | | | |
| L | | | | | | | | | | | | | | | | | | | | | | | | | |
| M | | | | | | | | | | | | | | | | | | | | | | | | | |
| N | | | | | | | | | | | | | | | | | | | | | | | | | |
| O | | | | | | | | | | | | | | | | | | | | | | | | | |
| P | | | | | | | | | | | | | | | | | | | | | | | | | |
| Q | | | | | | | | | | | | | | | | | | | | | | | | | |
| R | | | | | | | | | | | | | | | | | | | | | | | | | |
| S | | | | | | | | | | | | | | | | | | | | | | | | | |
| T | | | | | | | | | | | | | | | | | | | | | | | | | |
| U | | | | | | | | | | | | | | | | | | | | | | | | | |
| V | | | | | | | | | | | | | | | | | | | | | | | | | |
| W | | | | | | | | | | | | | | | | | | | | | | | | | |
| X | | | | | | | | | | | | | | | | | | | | | | | | | |
| Y | | | | | | | | | | | | | | | | | | | | | | | | | |
| Z | | | | | | | | | | | | | | | | | | | | | | | | | |

Handwritten numbers on the grid:
 Row A: 27, 26, 25
 Row G: 7, 8, 5
 Row X: 6, 4
 Row Z: 3, 2, 1

INDEX

| Description | Page |
|--|-------|
| Traverse diagram for south Line of Section 35 | 11 |
| Traverse south line sec 35 | 12-19 |
| Angles @ Property Corners to line | 24 |

TISON R26W Z-21

SE Sec Cor S.35

October 25, 1875 Original Govt
Survey by J.P. Hinchilwood

Set a B. Pine post, 5 x 5
from which:

B. Pine, 12" S31°E, 10 lks 6.60'

B. Pine, 15" S40°W, 10 lks 6.60'

B. Pine, 10" N44°E, 32 lks 21.12'

B. Pine, 9" N31°W, 29 lks 19.14'

December 2, 1935 CCC Notes

Set new J.P. stake, no scribe.

Found:

N. Pine, 15" at base, S14°W, 16 lks (10.56')
badly burned

3 old BT stumps found, only one
standing, all badly burned, illegible

Metal location poster on 9" N. Pine
from which corner bears S64°E, 22.44'

September 9, 1985 Recovery by: G. Kasenko

B. Avsk

R. Feltus

Decl = 5° East

CERTIFICATE FILED

Set a 5 ft. long by 2 1/2 inch outside diameter
galvanneal iron pipe with a 3 inch diameter
domed brass cap,
stamped as shown
up, 1.5 from which:

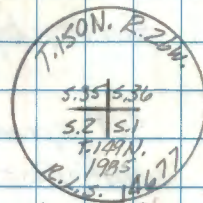

(at this point we recovered a 4' x 4'
scribed J. Pine post.

I do not feel it is an original post, must
of been scribed sometime afterwards)

Recovered: stamp

O.G.S. B. Pine, S29°E, 6.60 ft w/ blaze
visible but badly burnt.

O.G.S. B. Pine stump hole, S39°W, 6.60 ft

Established:

Red Pine, 6.3", N12°E, 19.45 ft to a 16d nail on
SE FACE FACE Double BLAZE SCR "S36 BT" w/ 60d SPIKE

Red Pine, 9.0", S43°E, 35.04 ft to a 16d nail on
SW FACE Double BLAZE SCR "S18T" w/ 60d SPIKE

Red Pine, 11.2 in S64°W, 43.36 ft to a 16d nail on
N. FACE Double BLAZE SCR "S2 BT" w/ 60d SPIKE

Red Pine 23.2" N54°W, 18.09 ft to a 16d nail
on SW FACE Double BLAZE SCR "S35 BT" w/ 60d SPIKE

Metal fence post 3.0 ft N. w/ 54-2 x 54-9

Metal fence post 3.0 ft E. w/ 54-2

All BLAZES AND RINGS PAINTED RED

2

T150N R26W Z-19

S 114 S. 35

October 25, 1875 Original Gov't
Survey by J.P. Hinchilwood

Set spruce post, $3\frac{1}{2} \times 5$ for $\frac{1}{4}$ sec
cor in swamp from which:

Tam, 10", $S14^{\circ}W$, 38.2 lbs 25.08'

Aspen, 12", $N44^{\circ}E$, 51 lbs 33.66'

September 8, 1985 B. Kasenko, B. Aust
R. Feltus

Inverse & Monumentation info to set S 114

S35 T150N R26W

STA 1st H&D 2nd H&R

(E)
H. Dist

H &

FS 701 174-39-17 354-39-55

BS 6 00-00-00 179-59-50

T@ 7 174-39-17 174-39-05 37.95

Decl = 5° East

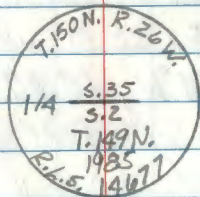

CERTIFICATE FILED

2

Set a 8 foot long by $\frac{5}{8}$ inch diameter
aluminum rod with a $3\frac{1}{4}$ inch diameter
aluminum cap stamped as shown,
up 1.5 feet from which:

White Spruce, 8.6 in, $N44^{\circ}E$, 81.50 ft to 16d nail
in W. face, double blaze, scr: " $\frac{1}{4}$ 535 BT" w/60d spike

Aspen, 11.7 in, $S35^{\circ}E$, 56.33 ft to 16d nail in
NE face, double blaze, scr: " $\frac{1}{4}$ 52 BT" w/60d spike

Aspen, 11.6 in, $S53^{\circ}W$, 57.76 ft to 16d nail in SE
face double blaze, scr: " $\frac{1}{4}$ 52 BT" w/60d spike

Metal fence post, east, 3.0 ft w/54-2

Metal fence post, west, 3.0 ft w/54-2, 54-9

Searched 10 man-hours for the original
evidence here but recovered none. Pro-
portioned this corner on a parallel of
latitude section line, equal distance from
the SE & SW corners of S35.

Ph. P. Kasenko

OK
W

TISON R26W Z-17

SW Sec cor S35

October 25, 1875 Original Gov't
Survey by J. P. Hinchilwood

Set B Pine post 5x5
from which:

B. Pine, 13" N88°E, 20 lbs, 18.48'

B. Pine, 7" N59°W, 13 lbs, 8.58'

B. Pine, 12" S18°E, 22 lbs, 14.52'

B. Pine, 12" S67°W, 30 lbs, 19.80'

Found ~~possible~~ probable J. Pine
BT in the NE quad. No
scribing visible but old blaze
facing the iron at the proper
bearing and distance.

J. Pine, fallen snag, stump rotted, blaze decayed,
N85°E, 18.35 ft to 60 d spike in stump hole

June 4, 1985 Recovery by: G. Kasenko
B. Musk
G. Robertson

Recovered a 1½ inch outside diameter
rusted iron pipe, 3 feet long, set loosely
in ground from which:

J. Pine, 12.5 in, N02°E, 17.38 ft to
a tree w/ FSLP which says "N03°E
26 lbs.

Also recovered:

J. Pine stump, 15" N85°W, 7.50 ft to
tree stump w/ "BT" (very little) on base blaze
Fallen J. Pine, 7" N88°W, 3.50 ft to
fallen w/ base blaze + "BT" (very little)

Both the J. Pine BT's are about
32 years old since they were cut.

The base blazes on these trees do not
face the iron where it sits now.

Will need to do more record research

R. P. Kasenko
6/4/85

See: this book pg 21

T150N R26W X-21

E 1/4 S 35

May 25th 1882 Original Gov't
survey by J. R. King

Set a post 5 ft. long 4 in. square
for 1/4 sec cor mtd:

"1/4 S" in the W face

From which:

W. Pine, 10", N47°E, 85 lbs 56.10'

" 1/4 S BT"

Cedar, 24", S69°W, 30 lbs 19.80'

" 1/4 S BT"

25 APR 85 K. Whitehorn & G. Kosenko chained
to this area from NE cor
(see pp 5). found Balsam
blazed on 4 sides just
west of where we ended (in
a balsam blowdown). One
huge white pine snag but
no marks were visible.
About 150-200 ft north are
remains of huge cedars &
some pines. might prove
to be better search-area

or possibly west. Ran out
of time.

5 TISON R26W V-21

NE Sec Cor 535

May 25, 1882 Original Gov't
Survey by J.R. King

Set a post 5 ft long, 4 in. square
for cor to secs 25 26 35 & 36

mkd

TISON 5.25" on NE

"R26W 5.36" on SE

"535" on SW

"526" on NN

with 1 notch in E & S

edges from which:

Ash, 4", N53°E, 23.14 15.18'

"TISON R26W 525 BT"

Ash, 6", S57°E, 20.14 13.20'

"TISON R26W 536 BT"

Cedar, 8", S37°W, 22.14 14.52'

"TISON R26W 535 BT"

Cedar, 9", N30°W, 8.14 5.28'

"TISON R26W 526 BT"

24 APR 85 K. Whitehorn & G. Kosenko
chained to area from
possible NW cor (see page 7).

5
didn't find anything. My
intuition tells me I'm about
150-200 ft to far south. Ran
out of time this day.

6 TISON R26W X-17.

W 1/4 S.35

May 27, 1882 Original Gov't
Survey by J. R. King

Set a post 5 ft. long 4 in. square
for 1/4 Sec Cor mkd:

"1/4 S" on W face from which:
Tamarack, 3", N50°E, 50.00, 33.00'
" 1/4 S BT"

Tamarack, 4", S87°W, 35.00, 23.10'
" 1/4 S BT"

June 6, 1885 Recovery by G. Kosenko

B. Ausk

G. Robertson

C. Krause

G. Brama

Recovered the following:

Down Tamarack snag, dead, with scribbling
"1/4 S" to a partial "B". It's the
tree in the SW quad. 23.10'

Pulled Dist. and Dist from two GLO TREES

Tam Stump hole (N⁵⁰°E) 33.10'
N51°E

6 Sept. 10, 1985

G. Kosenko

B. Ausk

R. Feltus

Set A 1/2 inch diameter Aluminum Rod
15 feet long with a 3/4 inch diameter
Aluminum Cap Up 1.5 feet.
From which:

Decl. 5° East

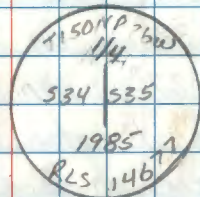

Metal Fence Post, 351°E, 14.11', w/ 54-3

JACK PINE, 9.9°, 338°W, 215.36, to a 16d nail on
W FACE Double BLAZE for "1/4 S34 BT" w/ code spike

Metal Fence Post, 46.0', North, w/ 54-2 + 54-9

BT BLAZES AND RING PAINTED

TISON R26W V-17

NW Sec cor S.35

May 27, 1882 Original Gov't
survey by J.R. King

Set a post 5 ft long, 4 in. square
for cor to secs 26 27 34 + 35

mkd:

"TISON 526" on NE

"R26W 535" on SE

"S 34" on SW

"527" on NN

with 1 notch on S and 2

notches on E edges from which:

Spruce, 24" S38°E, 30 lbs, 19.80'

"TISON R26W S.35 BT"

B. Gilead, 20" S59°W, 55 lbs, 36.30'

"TISON R26W 534 BT"

Balm Gilead, 10" N69°W, 25 lbs, 16.53'

"TISON R26W 527 BT"

Balm Gilead, 12" N17°E, 10 lbs, 6.60'

"TISON R26W 526 BT"

24 APR 85 K. Whitehorn & G. Kasenko

Pulled a position from the
land calls (330 ft North and

429 ft East) and searched for
bearing trees. Found stumps
in the SE & SW quadrants
that fit but nothing in the
NE & NW. Took samples of
the stumps in SE & SW to
send to Wood Products Lab,
Madison, WI, for identification.
Both stumps had new trees
growing on the top. will have
to await results from Madison
before proceeding.

May 16, 1985 - We received the
results of the identification
of the wood sample from
Madison. It came back as
White Pine, (Pinus sp). This
is not a spruce

TISON R26W V-19

N 1/4 S 35

May 27, 1882 Original Gov't Survey
by J.R. King

Set a post 5 ft. long 4 in square
for 1/4 Sec cor mkd:

"1/4 S" on N. face from which:

Elm, 4", S 04° W, 4. lks, 2.64'

"1/4 S BT"

Elm, 8", N 79° E, 14 lks, 9.24'

"1/4 S. BT"

24 APR 85 K. Whitehorn & G. Kosenko
chain to area from NW Cor
(see pp 7) a Giant aspen clear
cut all around. Doubt it
will ever find anything here.

9

9

2:

A page with horizontal blue lines and three vertical red margin lines. The page is otherwise blank.

A page with a blue grid pattern and a vertical red margin line. The page is otherwise blank.

TRAVERSE

T150N R26W

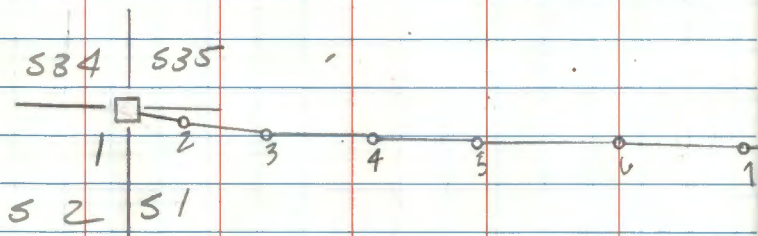

T149N R26W

DIAGRAM

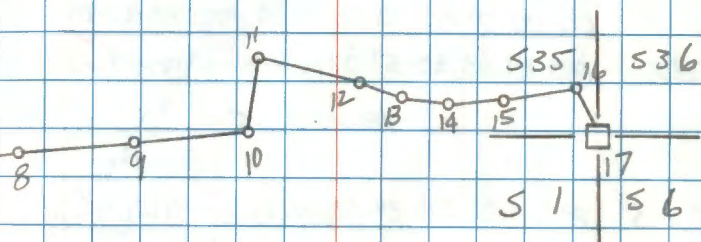

12

T150N R26W

Traverse of the South line of S. 35

| STA | 1 st H&D | 2 nd H&R | 3 rd H&D | 4 th H&R |
|-----|---------------------|---------------------|---------------------|---------------------|
| | | | H&F | |

Dist 1-2 89-57-09 270-02-58 89-57-05 424.14 424.14

Dist 2-1 90-08-14 269-51-58 90-08-08 424.16 424.16

FS 3 180-59-12 00-59-07 180-59-10 00-59-05

BS 1 00-00-09 180-00-00 00-00-02 180-00-04

TQ2 180-59-03 180-59-07 180-59-08 180-59-01

180-59-05 ✓

Dist 2-3 89-35-07 270-24-53 89-35-07 460.45 460.44

Dist 3-2 90-29-44 269-30-20 90-29-42 460.45 460.43

FS 4 176-22-42 356-22-41 176-22-39 356-22-39

BS 2 00-00-24 180-00-19 00-00-20 180-00-15

TQ3 176-22-18 176-22-22 176-22-19 176-22-24

176-22-21 ✓

Dist 3-4 90-14-34 269-45-34 90-14-30 469.68 469.68

Dist 4-3 89-50-10 270-10-07 89-50-02 469.65 469.65

✓ OK OK 8/28/85

August 26, 1985 12

Clear, mild, calm

T-2 S/M 265184

Red/A SW 4863

BPR = 29.7

Temp = 72.8

ECF = +1

424.15 ✓

8" J. Pine

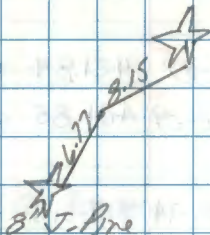

460.44 ✓

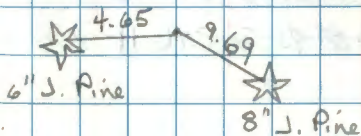

469.66 ✓

PC T T → B. Kasenku

C. Houtari

Aid. R. Huelman

STA 1 = 1" Iron Pipe

SW Sec corner 35

See this book, pg. 3

STA 2 = 60d spike

sta 3 = 60d spike

13

TISON R26W

Traverse, cont'd from pg 12

STA 1st H&D 2nd H&D 3rd H&D 4th H&D
H&D

FS 5 178-51-21 358-51-17 178-51-20 358-51-18

BS 3 00-00-25 180-00-15 00-00-20 180-00-15

T@4 178-50-56 178-51-02 178-51-00 178-51-03

178-51-00 ✓

Dist 4-5 91-42-38 268-17-25 91-42-37 421.84 421.65 ✓

Dist 5-4 88-22-35 271-37-37 88-22-29 421.85 421.68 ✓

FS 6 177-31-12 357-31-05 177-31-14 357-31-16

BS 4 00-00-29 180-00-28 00-00-30 180-00-31

T@5 177-30-43 177-30-37 177-30-44 177-30-45

177-30-42

Dist 5-6 91-24-17 268-35-58 91-24-10 276.12 276.04 ✓

Dist 6-5 88-44-00 271-16-08 88-43-56 276.11 276.04 ✓

August 26, 1985 13

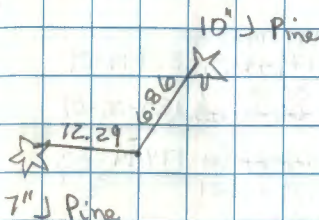

sta 4 = 60d spike

421-67 ✓

10" Aspen



6.96

6.96

6.96

6.96



8" Aspen

Sta 5 = 60d spike

276.04 ✓

✓ OK Gr 8/28/85

14

TISON R26W

Traverses, cont'd from p. 13

STA 1st H&D 2nd H&R 3rd H&D 4th H&R

H&R

FS 7 179-14-31 359-14-30 ¹⁷⁹⁻¹⁴⁻²⁸ ~~179-14-31~~ 359-14-29BS 5 00-00-17 180-00-08 ⁰⁰⁻⁰⁰⁻⁰⁷ ~~00-00-08~~ 180-00-07TE 6 179-14-14 179-14-22 ¹⁷⁹⁻¹⁴⁻³¹ ~~179-14-21~~ 179-14-22

179-14-20

Dist 6-7 90-42-13 269-17-43 90-42-15 560.03 559.99

Dist 7-6 89-21-37 270-38-23 89-21-37 560.00 559.97

FS 8 176-49-18 356-49-17 176-49-14 356-49-14

BS 6 20-00-20 180-00-15 00-00-11 180-00-13

TE 7 176-48-58 176-49-02 176-49-03 176-49-01

176-49-01

Dist 7-8 90-25-56 269-34-08 90-25-54 879.92 879.90

Dist 8-7 89-37-45 270-21-50 89-37-58 879.90 879.88

VOK Gk 8/28/85

August 26, 1985 14

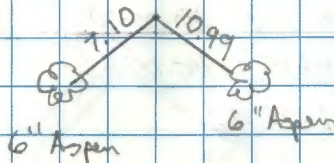

Sta 6 = 60 d spike

559.98

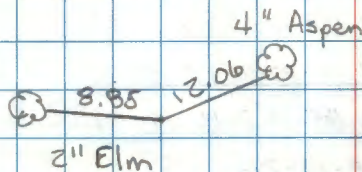
Sta 7 = 60 d spike
Approx 1/4 corner

879.89

15 TISON R26W

Traverse cont'd from pg. 14

STA 1st H40 2nd H42 3rd H40 4th H42
H*

FS 9 ~~184-05-49~~ ⁰⁵⁻⁴⁹ ~~04-05-40~~ ⁰⁵⁻³⁴ 184-05-25 04-05-42

BS 7 ~~00-00-18~~ ⁰³ ~~179-59-55~~ 00-00-45 180-00-00

K@ 8 ~~184-05-40~~ ⁰⁵⁻⁴⁰ ~~184-05-40~~ ⁰⁵⁻³⁹ 184-05-40 184-05-42

184-05-42

Dist 8-9 89-51-30 270-08-36 89-51-27 248.36 248.36

Dist 9-8 90-17-25 269-42-51 90-17-17 248.35 248.35

FS 10 188-17-42 08-17-33 188-17-22 08-17-22

BS 8 00-00-17 180-00-03 00-00-02 179-59-55

K@ 9 188-17-25 188-17-30 188-17-20 188-17-27

188-17-26

Dist 9-10 89-29-28 270-30-38 89-29-25 175.46 175.45

Dist 10-9 90-42-59 269-17-06 90-42-57 175.48 175.47

VOK R2 8/28/85

August 27, 1985 15

Clear, mild, calm

T-2 S/N 265184 PC PAT R G. Kasenko

Red IA S/N 4863 Aide B. Husk

EGF = +1

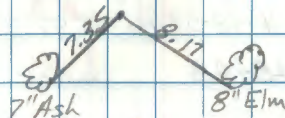

STA 8 = 60d spike

248.35

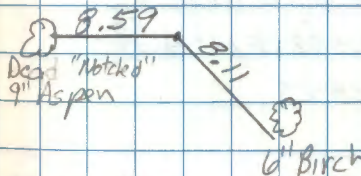

STA 9 = 60d spike

175.46

16 TISON R26W

Traverse cont'd from pg 15

STA 1st H&D 2nd H&R 3rd H&D 4th H&R

H&R

FS 11 136-49-11 316-49-⁰³21 316-49-13 316-49-07

BS 9 00-00-22 180-00-²⁰22 00-00-21 180-00-20

T@ 10 136-48-49 136-48-⁴³40 136-48-52 136-48-47

136-48-48

Dist 10-11 76-12-46 283-47-16 76-12-45 116.83 113.46

Dist 11-10 104-05-44 255-54-20 104-05-42 116.98 113.46

FS 12 243-28-36 63-28-36 243-28-40 63-28-⁴⁴37

BS 10 00-00-15 180-00-16 00-00-12 180-00-21

T@ 11 243-28-21 243-28-20 243-28-28 243-28-²³10

243-28-23

Dist 11-12 90-03-43 269-51-37 90-03-33 188.08 188.08

Dist 12-11 90-03-22 269-56-38 90-03-22 188.06 188.06

VOK BR 8/28/85

August 27, 1985 16

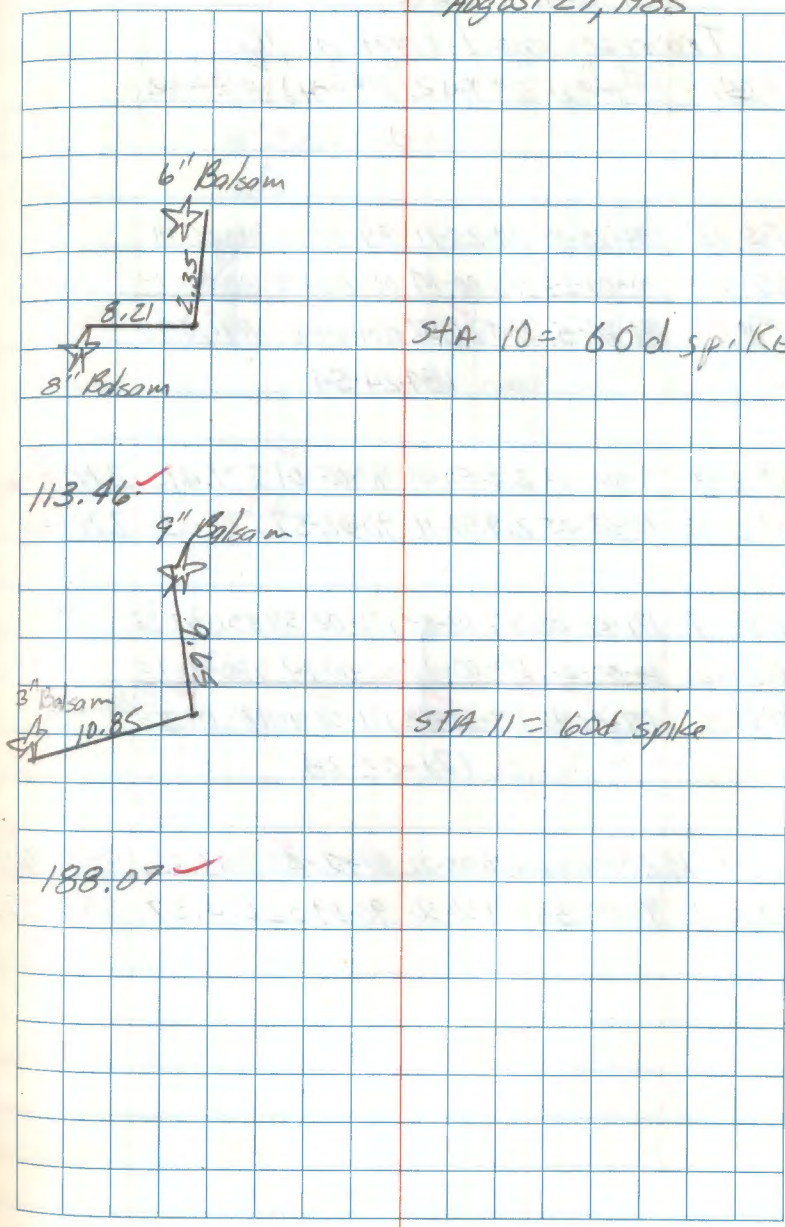

STA 10 = 60 d spike

STA 11 = 60 d spike

188.07

MADE 8/28/85

17

TISON R264

Traverse cont'd from pg 16

STA 1st HAD 2nd HXR 3rd HAD 4th HXR

HXR

FS 13 184-25-15 04-25-11 184-25-14 04-25-14

BS 11 00-00-24 180-00-14 00-00-20 180-00-19

T@12 184-24-51 184-24-57 184-24-54 184-24-55

184-24-54

Dist 12-13 90-05-03 269-55-01 90-05-01 279.41 279.41

Dist 13-12 90-03-05 269-57-11 90-02-57 279.43 279.43

FS 14 171-03-02 351-02-55 171-02-54 351-02-52

BS 12 00-00-22 180-00-17 00-00-14 180-00-18

T@13 171-02-40 171-02-38 171-02-40 171-02-34

171-02-38

Dist 13-14 89-56-46 270-03-22 89-56-42 353.36 353.36

Dist 14-13 90-09-33 269-50-30 90-09-32 353.37 353.37

✓ OK G.L. 8/28/85

August 27, 1985 17

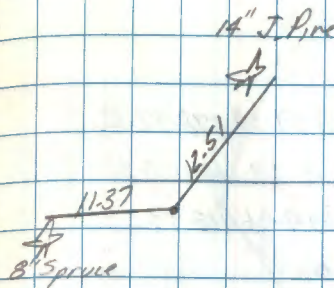
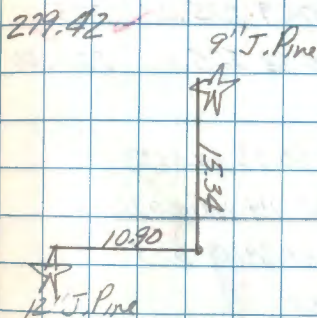
STA 12 = 60d spike
in roadSTA 13 = 60d spike
in road

353.36

18

TISON R26W

Traverse cont'd from pg 17

STA 1st H&D 2nd H&R 3rd H&D 4th H&R

H&R

FS 15 ~~118-39-31~~
90-07 298-39-27 118-39-33 298-39-32BS 13 ~~20-00-24~~
180-00-29 00-00-27 180-00-31

T@ 14 118-39-07 118-38-58 118-39-06 118-39-01

118-39-03

Dist 14-15 90-07-32 269-52-34 90-07-29 275.02 275.02

Dist 15-14 90-00-33 269-59-27 90-00-33 275.00 275.00

FS 16 209-53-53 29-53-52 209-53-53 29-53-55

BS 14 00-00-16 180-00-13 00-00-14 180-00-20

T@ 15 209-53-37 209-53-39 209-53-39 209-53-35

209-53-38

Dist 15-16 90-39-07 269-21-01 90-39-03 298.85 298.83

Dist 16-15 89-28-19 270-31-50 89-28-14 298.87 298.86

✓ OK OK 8/28/85

August 27, 1985

18

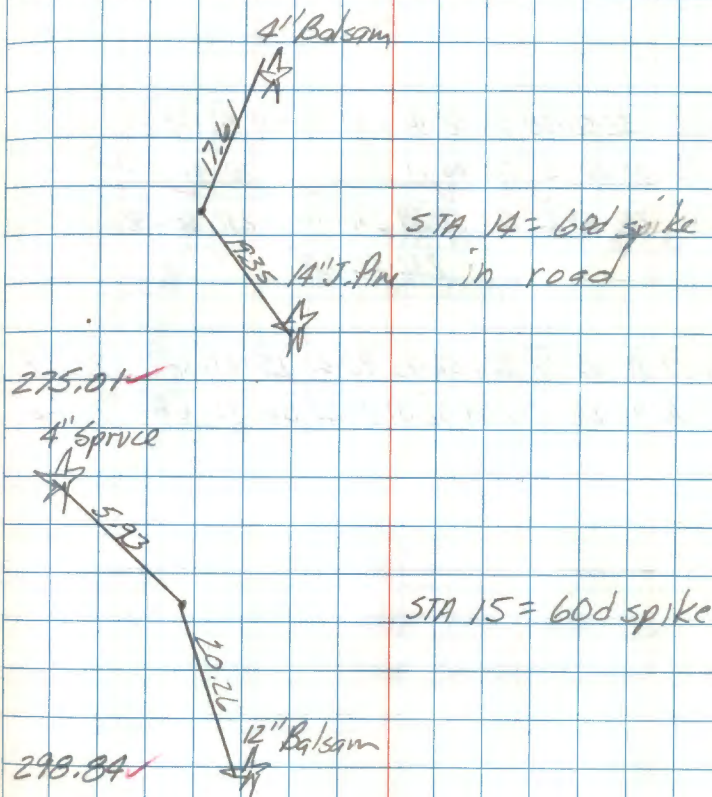

19 TISON R26W

Traverse cont'd from pg. 18

STA 1st H&D 2nd H&R 3rd H&D 4th H&R
H&R

FS 17 232-58-38 52-58-40 232-58-40 52-58-37

BS 15 00-00-13 180-00-11 00-00-12 180-00-09

TA 16 232-58-25 232-58-29 232-58-28 232-58-28
232-58-28

Dist 16-17 90-03-17 270-56-48 90-03-15 71.67 71.67

Dist 17-16 90-28-00 269-32-09 90-27-56 71.66 71.66

17

✓ OK file 8/28/85

August 27, 1985 19

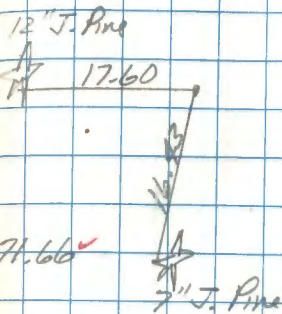

STA 16 = 60d spike
in road

STA 17 = point for
SE Section Corner S35

18.89

19.85

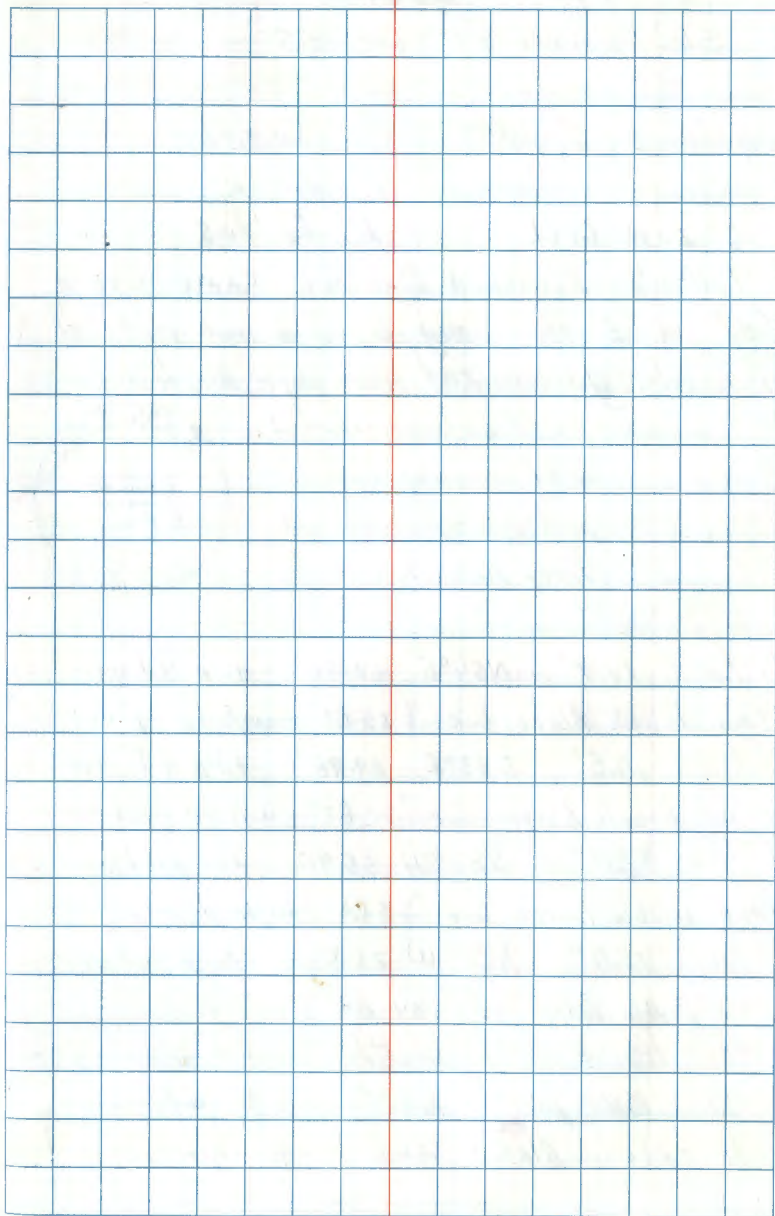
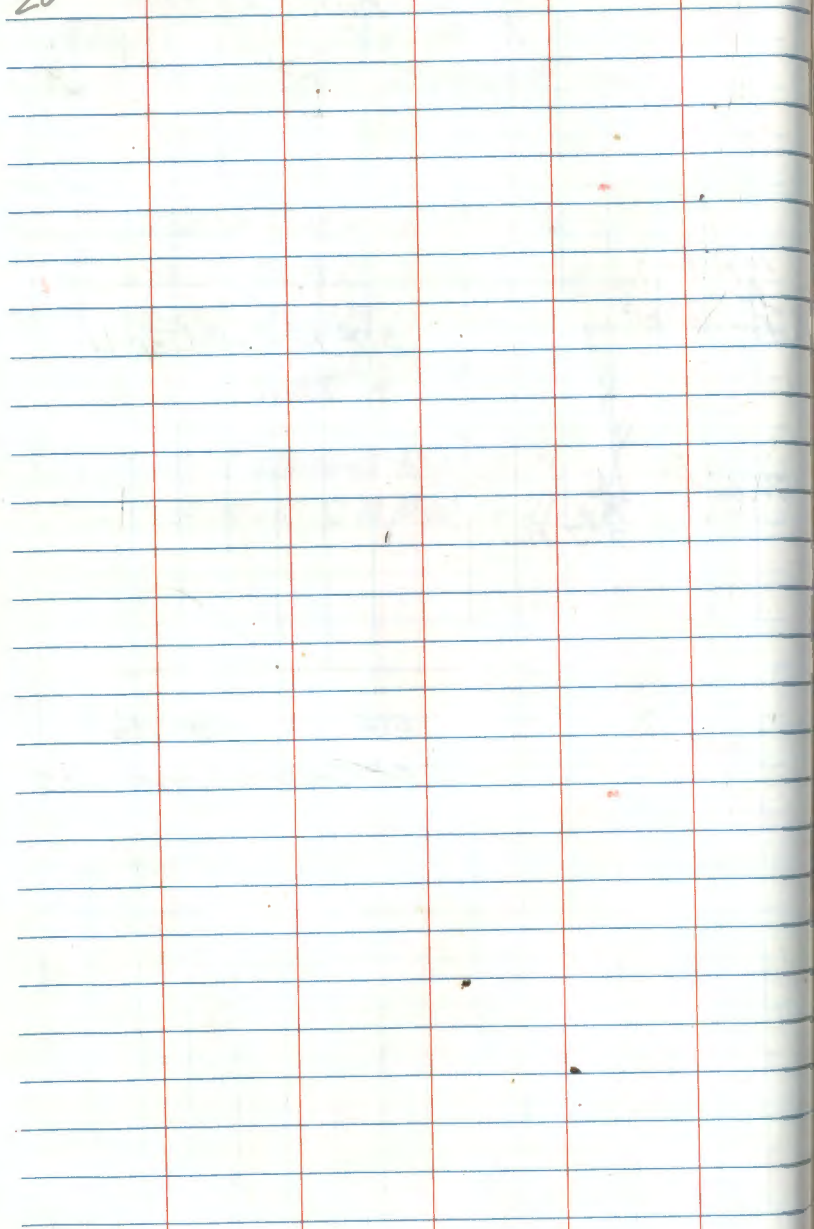

21 TISON R26W

SW Corner of sec 35

September 9, 1985 G. Kosenko

B. Ausk

5° EAST Decl. R. Feltus

9-10-85 Finished CORNER SAME CREW

Set a 5 foot long by 2½ inch outside diameter galvanized iron pipe with a break off magnetized bottom and a 3 inch diameter domed brass cap, stamped as shown, up 1.5 feet from which:

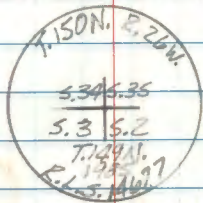

Established:

J. Pipe 14.9" N54°E 62.56' to a 16d NAIL ON SE FACE Double BLAZE SCR "535 BT" w/60d SPIKE

J. Pipe 10.5" S33°E 29.98' to a 16d NAIL ON SW FACE Double BLAZE SCR "52 BT" w/60d SPIKE

J. Pipe 7.0" S82°W 38.90' to a 16d NAIL ON S. FACE Double BLAZE SCR "53 BT" w/60d SPIKE

J. Pipe 13.0" N03°W 23.30' to a 16d NAIL ON E. FACE Double BLAZE SCR "534 BT" w/60d SPIKE

Metal fence post, south, 3.0 ft w/54 2 1/2 x 4

Metal fence post, west, 3.0 ft w/54 2

All TREE BLAZES AND RINGS Painted Red

21

The 1" Iron pipe we recovered is now buried beside the new iron pipe

See this book, pg 3

22

TISON R26W

Z-18

Inverses and monumentation info to

set STA 401, W 1/16 35-2

STA 1st HSD 2nd HSE H Dist

HX

FS 401 64-09-33 290-09-20

BS 3 00-00-00 180-00-00

T@ 4 64-09-33 64-09-20 68.91

Decl. 5° East

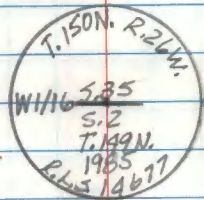

Set a 5 ft long by 2 1/2 in outside diameter concrete
filled galvanized iron pipe with a snap off magnetic
base and 3 in brass cap stamped as shown.

Up 1.5 ft

From which

Red Pine, 20.0 in, 559°E, 29.24 ft. to a 1/2 in nail in S

Red Pine, 6.1 in, 521°W, 25.92 ft. to a 1/2 in nail in

Red Pine, 17.5 in, N04°W, 36.01 ft. to a 1/2 in nail in

Metal fence post, south, 3.0 ft W/54-2, 54-9

Metal fence post, east, 3.0 ft W/54-9

CERTIFICATE FILED

22

August 9, 1985
Cloudy drizzle

PCT RD G. Kosenko

Aide B. Ausk

T60D S/N

face, double blazed, ser: "W/1/16 52 BT" w/60d spike

E face, double blaze, ser: "W/1/16 52 BT" w/60d spike

E face, double blaze, ser: "W/1/16 535 BT" w/60d spike

23

T150N R26W

Z-20

Inverse and Monumentation info to

set sta 1001, E 1/16 35-2

STA 1st H&D 2nd H&R H. Dist

H&R

FS 1001 231-04-55 51-04-40

BS 9 00-00-00 180-00-05

T@10 231-04-55 231-04-35 116.44

Decl = 5° East

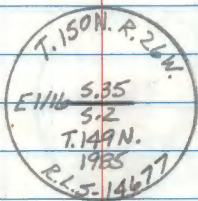

Set a 10 foot long by 5/8 inch diameter aluminum rod with a 3/4 inch diameter aluminum cap stamped as shown, up 18 inches from which:

From which =

White Spruce, 12.3 in, N67°E, 40.90 ft to 16d nail in

Cedar, 14.4 in, S02°E, 35.81 ft to 16d nail in

Cedar, 11.3 in, N73°W, 44.68 ft to 16d nail in SW

Metal fence post, south, 3.0 ft w/ 54-2

Metal fence post, west, 3.0 ft w/ 54-2, 54-9

CERTIFICATE FILED

23

September 9, 1995

P.L. G. Losenko

B. Ausk

R. Feltus

This corner was set by simple proportionate measurement between the S 1/4 & SW Sec cor of S. 35. No other survey evidence available.

P.L. Losenko

SE face, double blaze, scr: "E 1/16 S35BT" w/ 60d spike
 East face, double blaze, scr: "E 1/16 S2BT" w/ 60d spike
 face, double blaze, scr: "E 1/16 S35BT" w/ 60d spike

24

TISON R26W

Angles @ Property Corners to Property Lines
on the south side of S. 35STA 1st HAD 2nd HAD

HA

FS 701 295-15-48 115-15-40

BS 4 00-00-00 180-00-00

IT@ 401 295-15-48 295-15-40

09-09-00

FS 1001 189-09-06 187-44-05

BS 7 00-00-00 261-21-15

IT@ 701 189-09-06 25-16-50

189-09-03

FS 701

BS 10

IT@ 1001 303-31-19

24

TISON, R. 26W
W 1/4 S. 35
S. 2
T. 149N.
R. 1985-17
P. S. 14617

STA 401 =

TISON, R. 26W
S. 35
S. 2
T. 149N.
R. 1985-17
P. S. 14617

STA 701 =

TISON, R. 26W
E 1/4 S. 35
S. 2
T. 149N.
R. 1985-17
P. S. 14617

STA 1001 =

25 NORTH BOUNDRY
QUARTER CORNER BET SEC'S. 2+35
ORIG. GOV'T. SURVEY 1882
SET WOOD POST

CEDAR 8 S57E 15 LKS = 9.90'

SPRUCE 14 N65E 15 LKS = 9.90'

SEE INSIDE COVER

25

CORNER TO SECTIONS 2-3-34+35

ORIG. GOV'T. SURVEY 1882

SET WOOD POST

BIRCH 12 SSW 10 LKS. 6.60'

CEDAR 10 STIE 15 LKS. 9.90'

27 NORTH BOUNDARY
QUARTER CORNER BET. SEC'S, 3 & 34

ORIG. GOV'T. SURVEY 1882

SET WOOD POST

BALSAM 9 S27E 45 LKSF 29.70'

BALSAM 9 N68E 40 LKSF 26.40'

SEE INSIDE COVER

27

Remainder of
Book -

Blank
Pages