

CORNER RESTORATION
T150N R25W

THE
FIELD BOOK

82 0012
BOOK #2

CORNER RESTORATION T150N R25W #2

T150N R25W

Book 2 of 3

13	14	15	16	17	18	19	20	21	22	23	24	25
76	6	12	5		4		3		2		1	26
75	11	9	10									27
74	7	8	8		9		10		11		12	28
73	7	5	6									29
72	18	4	17		16		15		14		13	30
71	3	1	2									31
70	19		20		21		22		23		24	32
69	77											33
68	30		29		28		27		26		25	34
67												35
66	31		32		33		34		35		36	36
65	1A	63, ⁶¹ 62	60, ⁵⁹ 54	57, ⁵⁸ 56	55, ⁵⁴ 54	53	52	51, ^{49A} 46, ^{48A} 43, 42	41		40, 38, 37	

Surveyed by Josias R. King
 Survey commenced March 28 1882
 Survey completed April 28 1882

1 N-5

SECTION CORNER TO SECTIONS 19, 18, 19 & 20
FROM ORIGINAL GOVT. SURVEY OF 188280.00 SET 4" X 4" X 5' POST
ELM 4" S50W 42 IN 27.72'

BIRCH 5" N22E 38 IN 25.08'

SPRUCE 5" N65W 30 IN 19.80'

SPRUCE 12" S87E 28 IN 18.48'

10/23/78 PULLED CHAIN FROM RANGE LINE

WEST 1 MILE: FOUND 3" X 3" X 36"

BALSAM POST, 20-30 YEARS OLD &

SEVERAL BLAZED TREES - COULD NOT

PUT ORIGINAL STUMPS TOGETHER.

BLAZED LINE NORTH & EAST. MED.

10/26/78 PULLED CHAIN FROM SOUTH 1/2 MILE.

FELL S58°W, 48.0' - FOUND NO FURTHER

EVIDENCE.

5/7/81 Stebbins, Hayes, Olson & Robertson

At double proportionate position set a 2 1/2" x 30"
aluminum monument w/ alum. cap stamped:

T150N R25W

S. 18 | S. 17

S. 19 | S. 20

1981

R.L.S. 12261

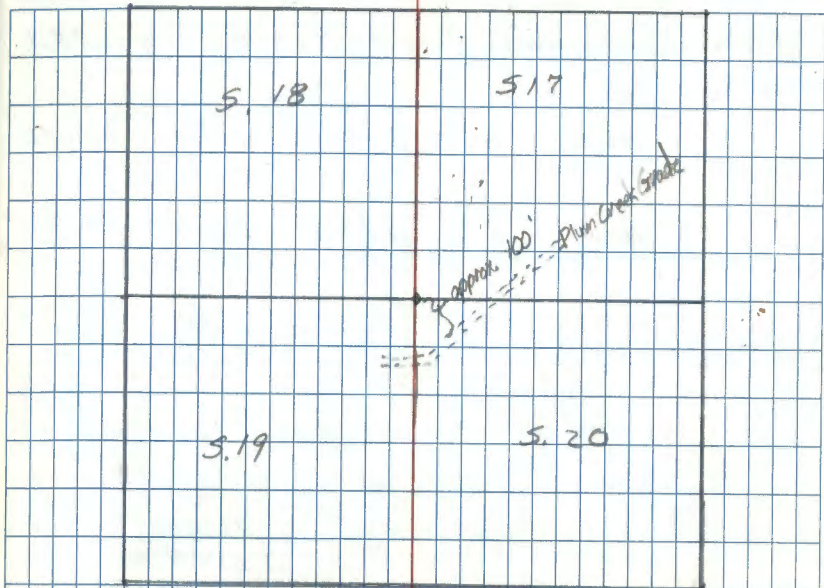

from which:

	scribed:
W. Oak 4" N34°E 25.16'	S. 17 BT
Cedar 10" N20°W 34.00'	S. 18 BT
Cedar 13" S49°W 31.63	S. 19 BT
W. Spruce 3 S76°E 20.20	X BT

all trees w/ nail on side and double blazed

Sign 54-9 on a tree NW 7.0'

All bearings are true assuming a 5° declination

This corner was set at double proportionate position from
the 1/4 cor. half mile west, 1/4 cor. half mile South, Sec. cor.
one mile North and Sec. cor. 2 miles East. The balsam post
appears to be set at 2640' North of 1/4 cor. sec. 19 & 20.It does not reoccupy the original cor. and is therefore
rejected. This post fulfills a 40' South-East of reestablish position
Corner was set from an aerial photo target.

Data entered this book 5/14/81 by TACZ

2

N-7

1/4 CORNER BETWEEN SECTIONS 17 & 20
FROM ORIGINAL GOV'T. SURVEY OF 1882
40.00 SET 4" X 4" X 5' POST

ASH 3" S 49 W 25 IN 16.50'

ASH 8" N 89 W 26 IN 19.16'

1978 - Searched in ash swamp - no evidence found

5/7/81 - Searched for orig. evidence. None found.

At the single proportionate position ~~set~~
a 2 1/2" x 30" alum. pipe w/ alum. cap stamped:

T150 N R25 W

1/4 5.17
5.20

1981
RLS 1220'

from which:

Ash 8" N 66° E 6.88' 1/4 S BT

Ash 11" S 61° E 5.40' 1/4 S BT

Cedar 13" S 17° W 21.44' 1/4 S BT

All trees double blazed, scribed & w/nail on side

This corner position was established from an
aerial photo target.

Hayes, Stefan, Olesen & Robertson

Entered this book 5/14/81 by M.H.

RA-7150-4

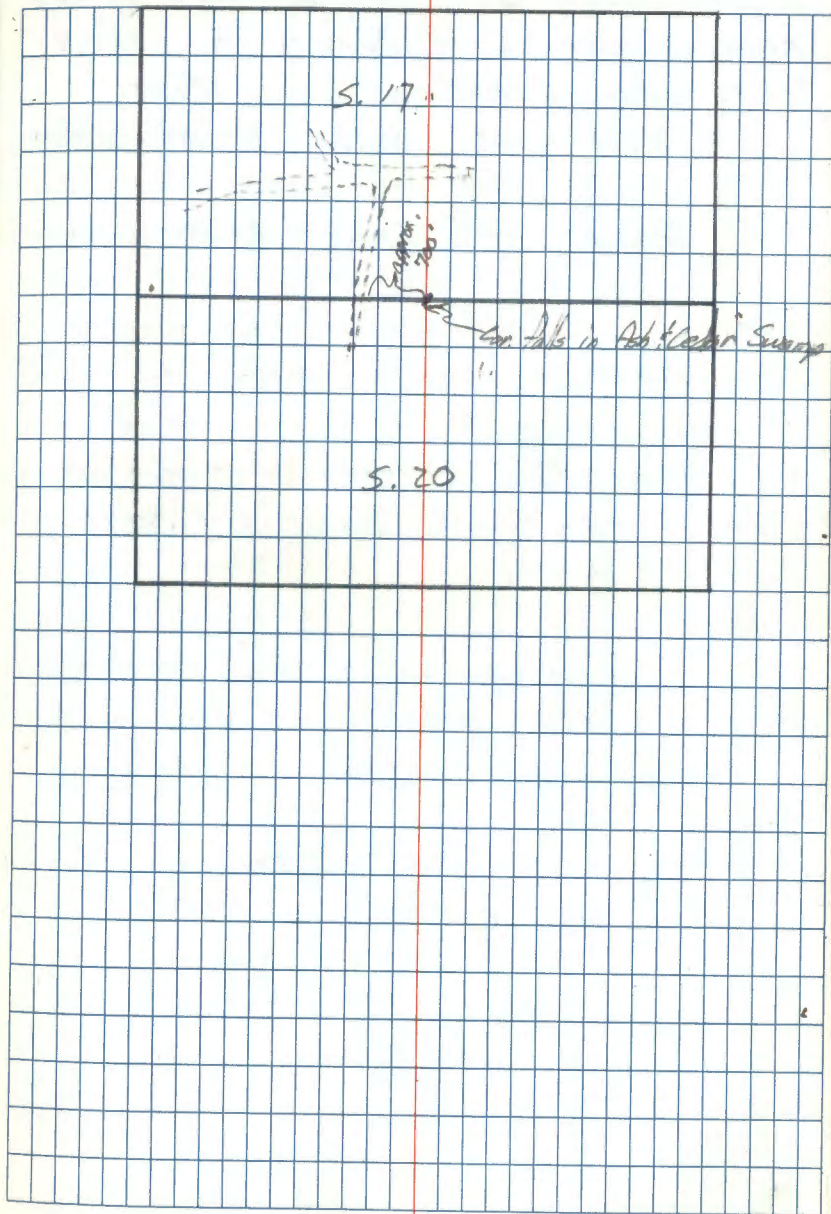

3 ~~3~~

offshoot

1/4 CORNER BETWEEN SECTIONS 18419
 FROM ORIGINAL GOVT. SURVEY OF 1882
 42.85 SET 4" X 4" X 5' WOOD POST
 ELM 10" N28E 50 IN 33.00'
 SPRUCE 4" S6W 25 IN 16.50'

10/23/78: PULLED CHAIN FROM RANGE
 LINE WEST, 2828.1'. FAINT BLUE
 PAINT LINE NORTH & WEST AT 2040'.
 AT 2845 TWO STUMPS FIT FOR SPECIES
 & BEARING, DISTANCE SHORT 6-8' FROM
 WEST DISTANCE.

12/7/78

To perpetuate this corner I
 set a 2" x 36" galv. steel pipe with
 brass cap marked as follows

T150 N R25W

$$\frac{1}{4} \frac{S18}{019}$$

1978

RAS 12261

from which bear a
 9" Ash, S35W, 18.68' mk'd
 1/4 S19 BT, 16" Cedar S71E
 30.45 mk'd 1/4 S19 BT,
 8" Ash N18W 7.25' mk'd
 1/4 S18 BT and one 8'
 steel post due North-S'
 w/ F.S. sign 54-2 and 54-9,
 one 8' steel post due west
 53' w/ F.S. sign 54-2 and
 54-9

2/17/78
 12/17/78

A 2-5

1/4 CORNER BETWEEN SECTIONS 17 & 18
FROM ORIGINAL GOV'T. SURVEY OF 1882
40.00 SET 4" x 4" x 5' POST

B. FIR 10" S57E 11 INCH 7.26'

TAMARAC 13" N57W 55 INCH 36.30'

10/23/78: PULLED CHAIN FROM POST
LOCATED AT SECTION CORNER 18, 19, 20 & 21
1/2 MILE SOUTH. FELL IN CREEK BOTTOM,
NO TAMARAC STUMPS, MANY BALSAM &
SPRUCE. OLD BLAZED LINE EAST 20-30"
MCL

5/7/91 Steger, Hayes, Olesen & Robertson

No original evidence located. At the single proportionate
position set a 2" x 3" alum. pipe w/ alum. cap stamped:

T1504 R25W
1/4
S18/S17
1981
RLS 1226'
scribed

from which:

Spruce 16" N35°E 50.54' 1/4 S BT

B. Ash 8" S39°W 7.55' 1/4 S BT

B. Ash 7" N09°W 16.19' 1/4 S BT

All trees double blazed & scribed w/ nail on side

Corner position established from aerial photo target.

Entered this book 5/19/91 MCR

Corner is approx. 50' west of creek in an ash swamp.

19-7150-4 by Hayes

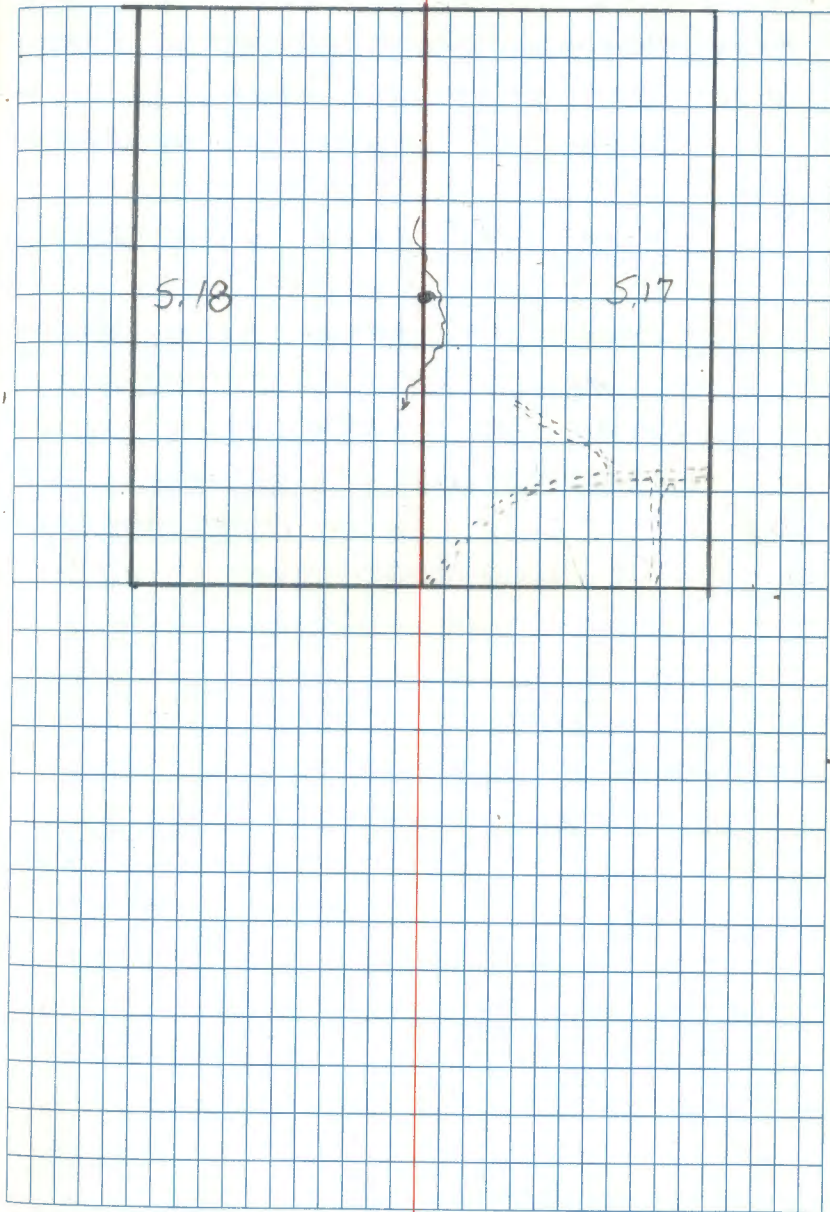

5 J-5

SECTION CORNER TO SECTIONS 7, 8, 17 & 18

FROM ORIGINAL GOV'T. SURVEY OF 1882

80.00 SET 4" X 4" X 5' POST - NONE

CEDAR 18" N35E 55 INS 36.30'

NOTHING REMAINS

CEDAR 12" S44E 50 INS 33.00'

NOTHING REMAINS (TAKEN OUT BY RD.)

CEDAR 20" S84W 40 INS 26.40'

LARGE CEDAR & BUTT-OFF

CEDAR 20" N38W 40 INS 26.40'

LARGE CEDAR & BUTT-OFF

10/23/78: PULLED CHAIN FROM SOUTH,

ONE 16"-18" CEDAR WITH FLAT FACE,

NUMEROUS OTHER LARGE CEDAR IN AREA.

NOTHING SURE,

10/24/78: PULLED CHAIN FROM NORTH 1/2
MILE.

10/24/78: PULLED CHAIN FROM NORTH &

FOUND TWO LARGE CEDAR BOTH BUTTED

OFF ABOUT 4' AT BEARING AND

DISTANCE TO FIT FOR CORNER.

CORNER FALLS IN OLD R.R. GRADE:

12/07/78

Stefan Krause, Harwin

To perpetuate this corner I set a 2" X 36"
galv. iron pipe, concrete filled, with a brass
cap stamped as follows:

T150 N R25W

57 58

S18 S17

P.L.S. 1978 No. 12361

From which the following bear:

6" B. Ash N07°E 34.60' MADISON R25W S18 BT

8" B. Ash S82°E 58.99' MADISON R25W S17 BT

13" Cedar S07°W 75.29' MADISON R25W S18 BT

6" B. Ash N84°W 35.20' MADISON R25W S17 BT

8" steel sign posts North 3.0' & South 07.6'
with 54-2 & 54-9 attached.OK
11/12/78
MK

6
1/4 CORNER BETWEEN SECTIONS 8 & 17.
FROM ORIGINAL GOVT. SURVEY OF 1882
39.88 SET 4" x 4" x 5' POST
SPRUCE 15" S27W 9 IKS 5.94'

B. ASH 4" N69W 8 IKS 5.28'

THIS IS FOR 1/4 BETWEEN SECTIONS 7 & 18 !!
~~10/24/78 KRAUSE & HAYES POLLED CHAIN FROM
WEST 1/4 MILE & STEPHAN & OLESEN PAVED
IN FROM EAST, WE FELL ABOUT 50'
APART. AREA UNDER WATER 2-5' DEEP,
SEVERAL LARGE SPRUCE STUMPS NEAR-
BY (SEE PAGE 7) MEB~~

1978-79 Area searched but no evidence found.

5/7/81 Stephan, Hayes, Olesen & Robertson

No orig. evidence found. At single prop. position

set a 2" x 30" alum. pipe w/ alum. cap stamped:

T15.0025W
5.8
1/4 5/18/81
91.5 12

from which:

Ash 8" N39E 89.08' 1/4.5 BT

Cedar 6" S30E 52.45' 1/4.5 BT

Cedar 8" N63W 69.74' 1/4.5 BT

All trees double blazed & scribed w/ nail on side.

Sign 54-9 on a cedar post (stud) East 30'

Corner falls in a willow swamp w/ old cedar, spruce & hem. stumps

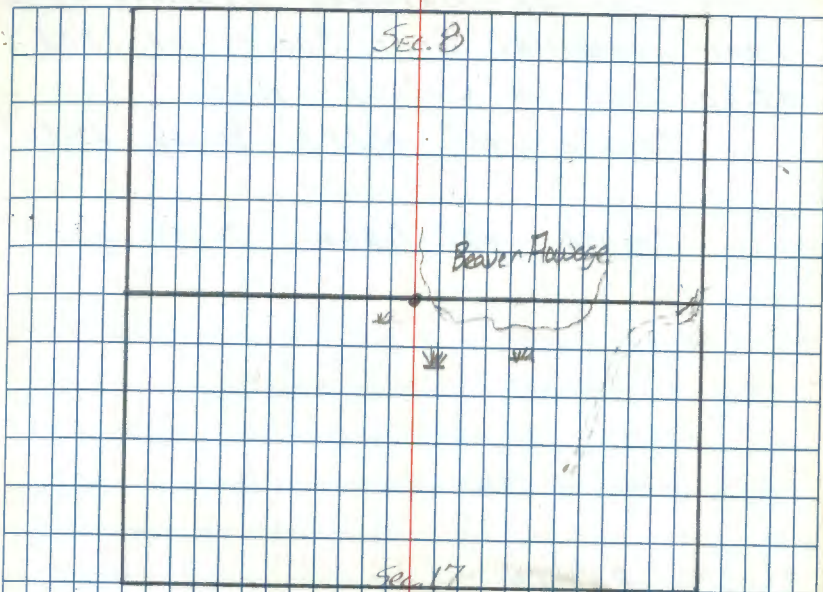

Corner position was established from aerial photo target
Entered this book 5/19/81 MEB

RA 7152-4

7 J-3

1/4 CORNER BETWEEN SECTIONS 7+18
FROM ORIGINAL GOVT. SURVEY OF 1882

43.80 SET 4" X 4" X 5' POST

SPRUCE 11" N27E 30 MS 19.80'

SPRUCE 10" S26W 20 MS 13.20'

(SEE PAGE 6) 6/24/78 Krause & Hayes pulled drain from
West 1/2 mile and Stefan & Oleson paced in from East.
We fell about 50' apart. Area under water 2-5'
deep. Several lg. spruce stumps nearby.

3/23/91 R. MAIN

RAN STRING BOX EAST FROM 7-12-13-18.

PROPORTIONATE DIST. PLACED FSLP ON

8" ASH (DEAD) IN FLOODED AREA. BEAVER LODGE

IS S 30 W \pm 200 FT FROM TAG.

8 G-5
1/4 CORNER TO SECTIONS 7+8
FROM ORIGINAL GOV'T. SURVEY OF 1882
40.00 SET 4"X4"X5' POST
CEDAR 5" N15E 20 IN 13.20'
NOW A LIVE 10" SCRIBED 1/4 S BT -
CEDAR 6" S67W 11 IN 7.26'
NOW 8" WINDFALL, SCRIBED 1/4 S BT
STUMP HAS MOVED NORTH 3'-4' BUT
DEPRESSION FROM STUMP AT BEARING
& DISTANCE.

10/24/78 - FOUND BOTH CEDAR BT'S, PLACED
BT TAGS ON BOTH & PLACED
PICKET AT CORNER POSITION.
MSS & OLSEN

12/7/78 OLSEN & HANSEY
TO PERPETUATE THIS CORNER I SET A
2"X36" GALV IRON PIPE, CONCRETE
FILLED, WITH BRASS CAP STAMPED
AS FOLLOWS:

T150N R25W

1/4 S7.38

1978

RLS 12261

FROM WHICH THE FOLLOWING BEARS:

13" CEDAR, N76°E, 26.65' HHD 1/4 S8 BT
11" CEDAR, S84°E, 52.80' HHD 1/4 S8 BT
9" ASH, N27°W, 62.19' HHD 1/4 S7 BT
8' STEEL SIGN POSTS SOUTH 1.9' & NORTH 1.8'
WITH 54-1 & 9' ATTACHED.

MCS OR
12/1/78

9 E-5

affidavit

SECTION CORNER TO SECTIONS 5, 6, 7 & 8

FROM ORIGINAL GOVT. SURVEY OF 1882

80.00 SET 4" X 4" X 5" POST NONE

CEDAR 18" N33E 36 INCHS 29.76'

NONE

CEDAR 5" S11E 6 INCHS 3.96'

NONE

CEDAR 10" S5W 15 INCHS 9.90'

NONE

CEDAR 16" N82W 10 INCHS 6.60'

REVERSED IMPRESSION OF ORIGINAL
SCRIBING ON THIS TREE.

11/2/77

STEFAN, STEWARD

FOUND LARGE CEDAR WITH SCRIBING
VISIBLE, CEDAR FALLEN & SHATTERED. FROM
THIS TREE STAMP PLACED PICKET FOR
CORNER. FROM PICKET COULD FIND NO
TRACE OF BT, SW, SE or NE. LOCATED
B.T. WAS QUITE POSITIVE AS BEING THE
BT. IN SECTION 6.

PLACED PICKET IN CORNER POSITION.

MCS

12/6/78

STEFAN

TO PERPETUATE THIS CORNER I REPLACED
PICKET WITH A 2" X 36" GALV. STEEL
PIPE, FILLED WITH CONCRETE, WITH
BRASS CAP STAMPED AS FOLLOWS:

T150N X 25W

S6 | S5

S7 | S8

1978

R.L.S. NO. 1226

FROM WHICH THE FOLLOWING BEARS:

7" B. ASH, N56°E, 48.82', MHD T150N

R25W S5 BT

11" CEDAR, S62°E, 80.27', MHD T150N

R25W S8 BT

12" CEDAR, S62°W, 14.55' MHD. T150N

R25W, S7, BT

6" BASSWOOD N37°W, 44.31' MHD T150N

R25W, S6 BT

8' STEEL SIGN POSTS 2.6' WEST & 2.4' EAST
WITH 54-2492 ATTACHED.OK
12/11/78

10 E-7 off diary
1/4 CORNER BETWEEN SECTIONS 548
FROM ORIGINAL GOVT. SURVEY OF 1882 -
40.22 SET 4" X 4" X 5' POST

1) CEDAR 8" N65E 30 INCH 19.80'

2)

SPRUCE 5" S25E 15 INCH 9.90'

2)

11/2/77

STEFAN, STEWARD

FOUND: 1) FALLEN 10" CEDAR WITH OBH
& STUMP FACES ROTTED OUT. REVERSED
IMPRESSION OF "BT" SCRIBING FOUND
IN BT BLAZE.

2) SET NEW POST FROM FALLEN
CEDAR & AT S23°E, 9.9' IS A
14" W. PINE STUMP.
THIS HAD TO BE A BAD CALL
ON THE SPRUCE BT.

MEB

12/7/78

STEFAN, HAYES & HANSEY

TO PERPETUATE THIS CORNER I SET A 2" X 36"
GALV. IRON PIPE, CONCRETE FILLED, WITH
BRASS CAP STAMPED AS FOLLOWS:

TISON R25W

1/4 S 5
S 8

1978

A.L.S. No. 12261

FROM WHICH THE FOLLOWING BEAR:

12" CEDAR, S66°E, 45.05', AND 1/4 S 8 BT

18" W. PINE, S10°W, 47.51', AND 1/4 S 8 BT

5" W. OAK, S70°W, 15.77', AND 1/4 S 8 BT

8' STEEL SIGN POSTS WEST 2.0' & EAST 2.0'
WITH 54-249 W ATTACHED.

OK 11/2/78
MEB

11 E-3
1/4 CORNER BETWEEN SECTIONS 6 & 7

FROM ORIGINAL GOV'T. SURVEY OF 1882

43.25 SET 4" X 4" X 5' POST

CEDAR 10" N74W 71X3 4.62'

SPRUCE 20" S65W 301X3 19.80'

10/28

NO EVIDENCE LOCATED

CH & MH

11/80

STEFAN

SET POSITION PROPORTIONALLY FROM
TARGET & FOUND LARGE SPRUCE STUMP
ROTTED TO GROUND LINE. WE SET
CORNER POSITION FROM THIS SPRUCE
AS DISTANCE & BEARING TO SEC.
CORNERS EAST & WEST ARE VERY GOOD.

WE SET A 2" X 5' ALUM PIPE WITH
CAP STAMPED AS FOLLOWS:

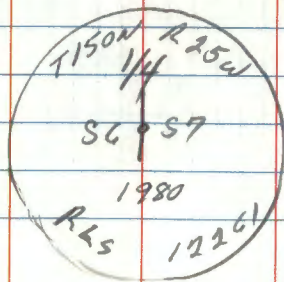

FROM WHICH THE FOLLOWING BEAR.

W. PINE

W. PINE

B. ASH

18"

18"

6"

N01W

N61W

S15E

153.00'

70.45'

94.65'

8' STEEL POST

NORTH 1.6'

11/4/80

MCS

Jeffy Macdonald

RR4750-4

1211 C-~~2~~5

1/4 SECTION CORNER TO SECTIONS 546

FROM ORIGINAL GOVT SURVEY OF 1882

39.82 SET 4" X 4" X 5' POST

BALM-OF-GILEAD 18", N67W, 20MS, 19.2'

TAMARAC 20" S67E 40MS 26.4'

11/24/78 PULLED CHAIN FROM SOUTH
1/2 MILE. FOUND TWO LARGE TAMARAC
STUMPS BUT NO B-O-G. AREA IN BEAVER
POND 1-3' DEEP THIS DAY

MES

11/5/80

STEFAN

FROM TARGET, SET POINT FOR CORNER
& PUT TOGETHER A LARGE TAM STUMP
& VERY LARGE BALM STUMP 38.2'
APART. ACCEPTED THESE TWO STUMPS
AS REMAINS OF ORIGINAL BTN.

WE PLACED A 2" X 5' ALUM
PIPE 3 1/2' IN GROUND WITH CAP
STAMPED AS FOLLOWS:

29-7150-4

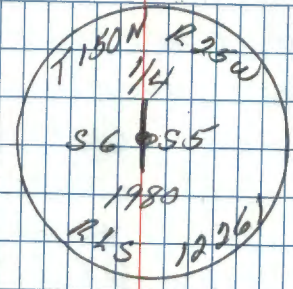

FROM WHICH THE FOLLOWING BEAR:

B. ASH	B. ASH	B. ASH	8' STEEL
6"	2"	4"	POST
S 7° W	N 56° W	N 38° W	NORTH
13.53'	66.50'	23.99'	1.3'

MES
11/5/80

13 SECTION CORNER TO SECTIONS A-1
1, 6, 31 & 36
T150 & T151 N, R25 & 26 W - FROM NOTES
OF ORIGINAL SURVEY OF 1882
80.00 SET WOOD POST 6' X 5' X 5"

ELM 8" N47°E 46 IHS 30.36'

FIR 6" N38°W 38 IHS 25.08'

SPRUCE 5" S48°E 37 IHS 24.42'

BIRCH 15" S45°W 58 IHS 38.28'

11/4/77

STEFAN

PULLED CHAIN FROM EAST. A BLAZED LINE
BEARS E-W TO A 4 SIDED FIR SNAK ON
THE TOWN CORNER. NOTHING POSITIVE
REMAINS OF ORIGINAL CORNER THAT WE
LOCATED THIS DAY. *MCS*

7/25/80

STEFAN & HAYES

BY SURVEY WE POSITION THIS CORNER
& FOUND A LARGE BIRCH STUMP.

FROM BIRCH STUMP WE SET CORNER
POSITION & FOUND EVIDENCE OF THE
NE & NW ORIGINAL BT'S ON VERY
ROTTEN STUMP REMAINS.

I ACCEPT THIS AS THE REMAINS
OF THIS ORIG. BT'S. *MCS E Hayes*

11/4/80

STEFAN

WE PLACED A 2" X 36" ALUM PIPE
WITH CAP STAMPED AS FOLLOWS:

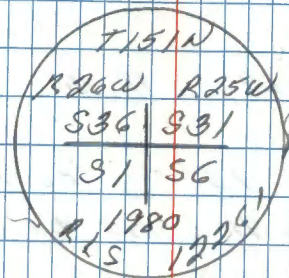

FROM WHICH THE FOLLOWING BEARS:

ASH	ASH	W. BIRCH	W. SPRUCE
5"	6"	3"	12"
N71°E	S79°E	S75°W	N57°W
42.39	41.74	20.84'	46.39'

8' STEEL SIGN POST SOUTH 4.0'

MCS
11/4/80

R9-7150-4

14 N¹/₄ CORNER TO SECTION 6 A-3

FROM ORIG. GOVY. SURVEY OF 1882

40.00 SET 4"X4"X5 POST

SPRUCE 15" N69°W 18 INS

FIR 9" S69°W 18 INS

RESURVEY IN 1895 FOUND CORNER
IN PLACE, 43.71 CHAIN EAST OF TOWN-
SHIP CORNER WEST & 6.65 CHAINS WEST
OF S¹/₄ TO SECTION 31.

11/4/77

STEFANY STEWARD
PULLED CHAIN FROM THE EAST, A BLAZED LINE
RUNS EAST-WEST HERE. NO EVIDENCE OF
A CORNER WAS LOCATED THIS DAY.

msd

1 15 SECTION CORNER TO SECTIONS 5 & 6 A-5
FROM ORIG. GOVT. SURVEY OF 1882

80.00 SET 4" X 4" X 5' POST

JAM. 10" N35°E ¹²30 IKS } DEFACED BY
ELM 14" N36°W 30 IKS } 1895 RESURVEY

ELM 22" S28°E 97 IKS

ELM 15" S52°W 23 IKS

(306.58')

4.63 CHAINS EAST TO SECTION
CORNER TO SECTIONS 31 & 32 AS
CALLED IN 1895 RESURVEY OF
THIS TOWNSHIP LINE. DEFACED
BT₂ IN SECTION 31 & 32 (TISON).

11/4/77

STEFAN & STEWART

PULLED CHAIN FROM EAST & FELL 350' SOUTH
OF BLAZED LINE. FOUND 26-28" ELM WITH
OPEN DBH & STUMP BLAZES THAT INDICATE
BT evidence. CREEK CALL WEST IS WITHIN
REASON.

12/7/78

STEFAN & WARCHER

TO PERPETUATE THIS CORNER I SET A
2" X 36" GALV. IRON PIPE, CONCRETE FILLED
WITH BRASS CAP STAMPED AS FOLLOWS:

TISON R25W

S31

S6 | S5

TISON

1978
R15 No 12961

FROM WHICH THE FOLLOWING BEARS:

7" B. ASH S61E, 49.29' AND TISON R25W

12" W. SPRUCE S11E, 14.68' S5 BT
AND TISON R25W
S5 BT

9" B. ASH, S35°W, 49.37' AND TISON R25W

S6 BT

5" B. ASH, N78°W, 13.27' AND "X" BT

8' STEEL SIGN POSTS 8.0' EAST WITH
54-9 ATTACHED.

WATER
MNS
OK

R9-7150-4

116

A-7

N¹/₄ CORNER TO SECTION 5

FROM ORIG. GOVT SURVEY OF 1882

40.00 SET 4" X 4" X 5' POST

ASH 10" N32°W 30 IKS

ASH 3" S45°W 20 IKS

RESURVEY IN 1895 FOUND CORNER IN
PLACE 36.10 CHAINS EAST OF CORNER
TO SECTIONS 31932 & 3.90 CHAINS
WEST OF S¹/₄ TO SECTION 32.

11/4/77

STEFAN

PULLED CHAIN FROM EAST & FOUND NO
EVIDENCE OF THIS CORNER. WHEN GOING
TO SECTION CORNER WEST, FELL SOUTHERLY
350' - THEREFORE MUST SEARCH NORTHERLY

MS

11/5/80

STEFAN

FROM TARGET SET CORNER POSITION
& PLACED A 2" X 30" ALUM PIPE
WITH CAP STAMPED AS FOLLOWS:

R4-1150-4

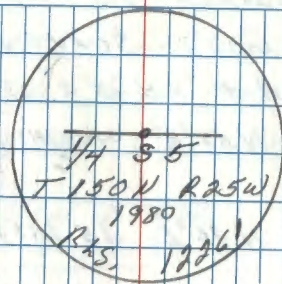

FROM WHICH THE FOLLOWING BEAR:

W. OAK	B. ASH	B. ASH	8' STEEL
4"	4"	5"	POST
S81E	S28E	S39W	WEST
28.82	5.76	44.88'	2.2'

MS
11/5/80

M

Affidavit A-9

SECTION CORNER TO SECTIONS 445
FROM ORIG. GOV'T SURVEY OF 1882
80.00 SET A 4" X 4" X 5" POST
CEDAR 24" N58°W 40 IHS } DEFACED BY
1895 RESURVEY }
E.L.M. 15" N26°E 35 IHS }
CEDAR 16" S57°W 46 IHS
ASH 10" S87°E 52 IHS

3.32 CHAINS EAST TO SECTION
CORNER TO SECTIONS 32433 AS
CALLED IN RESURVEY OF 1895 OF
THIS TOWNSHIP LINE. DEFACED
BT IN T151N.

11/3/78

STEFAN

FOUND 2 1/2" IRON PIPE 30" OUT OF
GROUND FROM WHICH REMAINS OF ASH
BT BEARS S87°E, 52 IHS & LARGE
CEDAR SNAG, BURNT & MUCH CHOPPING & BRAZING
N58°W, DISTANCE BAD, THOUGH TO BE DEFACED
BT N58°W, 40 IHS. AND

A9-7157-11

12/7/78

STEFAN & WANCHEK

TO PERPETUATE THIS CORNER I SET
A 2" X 36" GALV. IRON PIPE, CONCRETE
FILLED, WITH BRASS CAP STAMPED AS
FOLLOWS:

T151N R25W

S 32

S5 | S4

T150N

1978

A.L.S. No. 12261

FROM WHICH THE FOLLOWING BEARS

5" B. ASH, S56°E, 17.14', MHO "X" BT

6" B. ASH, S34°E, 81.01', MHO T150N R25W

S4 BT

6" B. ASH, S12°W, 17.48', MHO T150N R25W

S5 BT

6" R. MAPLE, S84°W, 21.89', MHO. T150N, R25W

S5 BT

8' STEEL SIGN, 2.4' SOUTH & 2.0' WEST
WITH 54-1496 ATTACHED.

12/7/78 OK

MEX

18

A-11

N $\frac{1}{4}$ TO SECTION 4
FROM ORIG. GOV'T. SURVEY OF 1882

40.00 SET A 4"X4"X5' POST

CEDAR 20" S61°W 15 IHS

CEDAR 14" N33°W 36 IHS

RESURVEY IN 1895 FOUND CORNER IN
PLACE, 36.84 EAST OF CORNER TO
SECTIONS 32 & 33 & 3.16 CHAINS WEST
OF S $\frac{1}{4}$ TO SECTION 33.

11/3/77

STEFAN

NO EVIDENCE LOCATED THIS DAY.

19

Affidavit

A-13

SECTION CORNER TO SECTIONS 374

80.00 SET A 4" X 4" X 5' POST

CEDAR 10" S 65° E 12 IKS 7.92'

SCARING VISIBLE

CEDAR 9" N 16° E 30 IKS } 19.8'
DEFACED ON
RESURVEY OF 1895

CEDAR 9" N 60° W 38 IKS } 25.08'

CEDAR 8" S 3° W 30 IKS 19.8

3.00 CHAINS EAST TO SECTION
CORNER TO SECTIONS 33 & 34 AS
CALLED IN RESURVEY OF 1895 OF
THIS TOWNSHIP LINE. DEFACED
BT² IN T 151 N.

11/1/77

STEFAN

FOUND: OLD ROTTEN POST, FALLEN & POINT -

1) DEAD 12" CEDAR WITH BT & DBM

BIASES ROTTED OUT. S 3° W 15.8'

2) LEAVING 12" DEAD CEDAR S 65° E, 7.9'

3) 9" DOWN ROTTED OUT CEDAR

N 16° E, 15.0'

4) 12" CEDAR, LIVE, N 60° W, 15.5', FACE
CHOPPED OFF MANY YEARS AGO.

MCS

R 9-7150-4

2/23/78

STEFAN & OLSEN

FROM ORIGINAL EVIDENCE PLACED A
GALV. IRON PIPE 2" X 5' FILLED WITH
CONCRETE WITH BRASS CAP STAMPED
AS FOLLOWS:

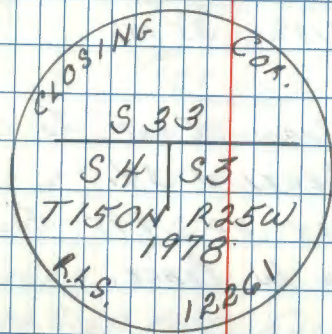

REFERENCES:

CEDAR	CEDAR	BL. ASH
10"	8"	4"
S 57° W	S 34° W	S 26° W
21.12'	56.28'	21.36'

STEEL SIGN POST, SOUTH 4.5'
STEEL SIGN POST, EAST 5.0'

20

affidavit 6/14/79 A-15
N $\frac{1}{4}$ TO SECTION 3

FROM ORIG. GOVT SURVEY OF 1882

40.00 SET A 4" X 4" X 5' POST

FIX 8" S30°E 7 IHS

FIX 9" N13°W 35 IHS

2.18 CHAINS EAST TO S $\frac{1}{4}$
OF SECTION 34.

RESURVEY OF 1895 FOUND
CORNER IN PLACE.

11/1/77

CRK

NO EVIDENCE LOCATED.

2/79 BY SURVEY OF LINE FROM SEC.
344 TO SEC. COR. 34435, T151N, R25W
AT PROPORTIONAL DISTANCE I
RE-ESTABLISHED THE NORTH $\frac{1}{4}$
TO SECTION 3, T150N, R25W

TO PERPETUATE THIS CORNER
WE SET A 2" X 36" GALV. IRON
PIPE 30" IN THE GROUND WITH
BRASS CAP MARKED:

RA-7150-4

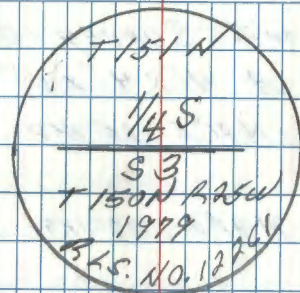

FROM WHICH THE FOLLOWING BEARS:

W. BIRCH 5", S65°E, 25.95'

B. ASH 5", S6°W, 37.50'

W. SPRUCE 7" S58°W, 56.46'

8' STEEL SIGN POST, EAST 3.5'

me
2/13/79

CERTIFICATE FILED

9-15-81 Steffan

Affidavit 4/14/79 A-17

SECTION CORNER TO SECTIONS 293
FROM ORIG. GOV'T SURVEY OF 1882

80.00 SET A 4" X 4" X 5" POST

CEDAR 10" N21°E 25 IKS 16.50' } DAMAGED
By 1895

CEDAR 14" N31°W 22 IKS 14.5' } RESURVEY

CEDAR 7" S47°W 18 IKS 11.9'

CEDAR 16" S21°E 9 IKS 5.9'

1.95 CHAINS EAST TO SECTION CORNER
TO SECTIONS 34 & 35 AS CALLED
FOR IN RESURVEY OF 1895, DAMAGED
BT'S IN T151 N.

2/13/79 (CONT)

8" CEDAR, S70°E, 6.54'

16" CEDAR, S12°W 28.19' ←

6" CEDAR, S80°W 25.79'

8' STEEL SIGN POST SOUTH 5.0'

M.G.
2/13/79

R9-7150-4

Chained 1.95 CHAINS OR 128.7' WEST OF STD. COR.
TO SEC'S. 34 & 35 - SEARCHED AREA FOR EVIDENCE
OF BT'S NONE WAS FOUND - WILL SEARCH AGAIN
SET A 3" SQUARD CEDAR POST 6' LONG AS APPROX.
CORNER - PUT FSLP ON 9" CEDAR 5' EAST OF POST
chained south from above point to E. of old
woods trail bks. W-NE 870' TO ORIG. EVIDENCE
AT 1/4 COR. 11-2-77 CRK-RC

1/31/79

STEFAN, HAYES & OLESEN
SET POSITION BY SURVEY AT PROPORTIONAL
POSITION BETWEEN SECTION CORNER EAST 1.95
& SECTION CORNER WEST 21.05 CHS & ON
LINE BETWEEN THEM.

2/13/78

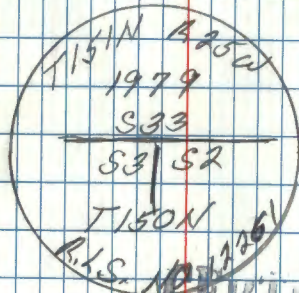
STEFAN & OLESEN
SET A 2" X 5' CONCRETE FILLED GALV. IRON
PIPE 3/8" IN GROUND WITH BRASS CAP MARKED

9-15-81 Stefan

FROM WHICH THE FOLLOWING BEAR:

22

A-19

N $\frac{1}{4}$ TO SECTION 2

FROM ORIG. GOV'T. SURVEY OF 1882

40.00 SET A 4" X 4" X 5' POST

SPRUCE 8" N21°W 25 IHS 16.50'

SPRUCE 7" S47°W 15 IHS 9.90'

1.82 CHAINS EAST TO S $\frac{1}{4}$ OF
SECTION 35. RESURVEY OF
1895 FOUND CORNER IN PLACE.

10/18/77

OLESEN

FOUND NO EVIDENCE OF CORNER BY
PULLING WEST FROM STANDARD CORNER

SECTION CORNER TO SECTIONS 142
FROM ORIG. GOV'T. SURVEY OF 1882

80.00 SET A 4" X 4" X 5' POST

BIRCH 10" N65°W 30 IHS }
DEFACED ON
1895 RESURVEY

BIRCH 9" N40°E 44 IHS

BIRCH 14" S40°W 40 IHS

BIRCH 16" S9°E 30 IHS

1.37 CHAINS EAST TO SECTION
CORNER TO SECTIONS 35 & 36 AS
CALLED FOR IN 1895 RESURVEY.
DEFACED BT₂ IN T151N.

10/17/77

FOUND:

STEFAN, KRAUSE
OLESEN

1) 2" X 4 1/8" IRON PIPE, 90.2'
WEST OF CORNER TO SECTIONS
35 | 36

AREA DISTURBED BY SKIDDING, NO
EVIDENCE OF BIRCH BT₂
LOCATED.

To perpetuate this cor I set a
2" dia X 3' long Iron pipe with
Brass cap marked

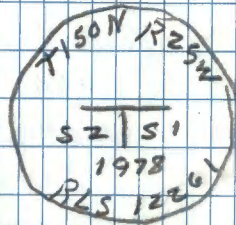

from which bears

Ash 6" S45W 10.25'
Cedar 9" S36W 65.70
Cedar 17" S45E 38.33'
Cedar 11" S85E 60.34

8" Long steel sign post with sign
54-9 West 1.8'

12/5/78

Ronald Olsen

2A

Confidential

 N $\frac{1}{4}$ TO SECTION 1

A-23

FROM ORIG. GOV'T SURVEY OF 1882

40.00 SET A 4" X 4" X 5' POST

FIR 5" S 56° W 16 IKS

Fd. stp. hole at top of hole

SPRUCE 16" N 32° E 28 IKS

no evidence found

.70 CHAINS EAST TO S $\frac{1}{4}$
OF SECTION 36. CORNER IN
PLACE AT TIME OF RE-
SURVEY OF 1895.

10/17/77

STEFAN, KRUSE,
OLESENFound 2" IRON PIPE 4 $\frac{1}{2}$ ' long - brass cap

30" above ground (reset 12/5/78 16" above ground)

Found 11" Spruce lying on ground scribed

S 42° W 20.8'

Put FSLP on 5" Aspen 1.5' West of iron

10-17-77 CRK

10/18/77 FROM UN SIGNED COUNTY CERTIFICATE

9" SPRUCE, S 38° W, 31 $\frac{1}{2}$ ' IKS (20.77') - 1948

cut new BT's

Ash 7" S 18° W 14.33'

Ash 6" S 50° E 12.58'

Ash 8" S 15° E 21.93'

Set a 8' long steel sign post
with sign 54-9 West of cor

12/5/78

Ronald Oleson

Brass cap marked

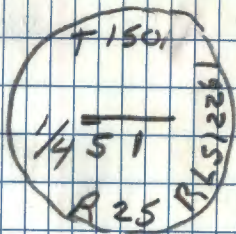
OK 189
12/1/78
M

25

A-25

SECTION CORNER TO SECTIONS 1 & 36
T151 & 150N, R25W - FROM NOTES
OF ORIGINAL GOVT SURVEY OF ~~1876~~
1876

90.00

SET POST, 3 SIDED 3" BALSAM GILEAD

BALSAM OF
GILEAD

4" N89°W 151KS 9.90'

BALSAM OF
GILEAD

5" S18°W 331KS 21.78'

FROM SURVEY OF STATE ROAD #2 (#6 Now)

By ROY H. BAKER IN 1913:

ASH 7" N50°W 46.2'

ASH 3" S64°W 63.3'

25

26 C-25
E 1/4 CORNER OF SECTION 1

FROM GOVT SURVEY OF 1876

40.00 SET A 3" FIR POST

TAM. 8" N31°E 201HS 13.2'

FIR 4" S65°W 601HS

(NOT LOCATED ON ROAD SURVEY)
FROM SURVEY OF STATE ROAD 2 (NOW #6)

BIRCH 10" N75°W 59.8'

TAM 16" S52°W 58.3'

27 E-23 25

SECTION CORNER TO SECTIONS 14 12

FROM ORIG. GOVT. SURVEY OF 1876

80.00 SET A 4" BIRCH POST -

TAM. 8" N34°W 25.1KS 16.50'

BIRCH 4" S54°W 45.1KS 29.70'

FROM SURVEY OF STATE ROAD #2 (NOW #6)

ASPEN 12" N42°E 63.6'

TAM. 10" N72°W 58.6'

15

28

G-25

E¹/₄ CORNER TO SECTION 12

FROM ORIG. GOVT. SURVEY OF 1876

40.00 SET A 3" CEDAR POST

TAM. 6" N78°W 3 IHS

TAM 10" S49°E 8 IHS

FROM SURVEY OF STATE ROAD #2 (Now #6)

ASPEN 6" N54°E 51.8'

SPRUCE 7" S54°W 66.7'

29 J-23-25

SECTION CORNER TO SECTIONS 12 & 13
FROM ORIG. GOVT. SURVEY OF 1876

80.00 SET A 4" TAM POST IN SWAMP-
TAM 5" S36°W 18.145

TAM 5" N17°W 70.145

FROM SURVEY OF STATE ROAD #2 (Now #6)
(EVIDENCE OF ORIGINAL SURVEY NOT FOUND)

TAM 6" S65°W 37.7'

TAM 6" N61°W 59.1'

30 L-25

E 1/4 CORNER TO SECTION 13

FROM ORIG. GOVT SURVEY OF 1876

40.00 SET A 3" CEDAR POST IN SWAMP.

CEDAR 6" S89°W 15HS 9.90'

TAM. 5" N69°E 5HS 3.30'

FROM SURVEY OF STATE ROAD #2 (Now #6)

BIRCH 14" N74°W 43.4'

CEDAR 14" S30°W 60.7'

FROM COUNTY SURVEYOR'S RECORDS

BIRCH 9" N76°W 77.35'

BALM
OF GILEAD 10" S77°W 65.50'

13

31 N-25
SECTION CORNER TO SECTIONS 13 & 24

FROM ORIG. GOVT SURVEY OF 1876

80.00 SET 5" CEDAR POST

CEDAR 5" N66W 15 IHS 9.90'

REMOVED IN ROAD CLEARING

BIRCH 6" S78W 16 IHS 10.56'

REMOVED IN ROAD CLEARING

FROM SURVEY OF STATE ROAD #2 (Now #6)

CEDAR 12" N70W 36.5'

LYING ON EDGE OF CLEARING

CEDAR 14" S78W 56.3'

3' FALLEN STUMP / FRAT. FACE - GOOD.

FROM COUNTY SURVEYOR'S RECORDS

ASPEN 6" ^{S46W - ERROR IN COUNTY DIST} S37E 70.65' 10"

CHOPPED OUT - SCRIBED DBH FACE - LIVE

CEDAR 8" N47W 100.85' N33W

OVER CROWN LIVE 12" CEDAR.

To perpetuate this cor I put a
P.K. nail in center of Road at
Cor Location ^{from County B75} witnessed by.

5' Long W/B Brass
2" Iron pipe Mech.

Ash White Spruce

S88-54-25W 5" 5"

60.45' N63W 576W

100.97' 51.55

513 BT 524 BT

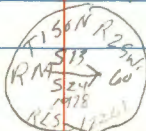

8/78
Ronald Olson

T150N

R25W

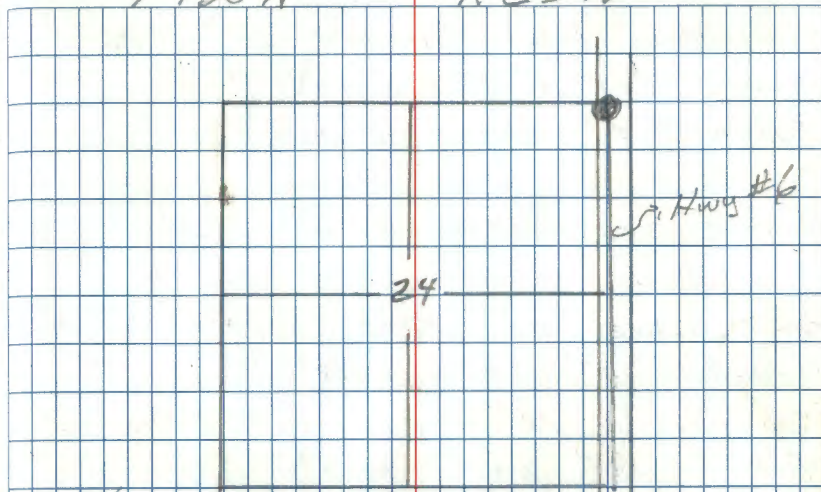

11/15/79

TIES TO W.C. SEC. COR

ASH 5" N35W 52.93 MKD 513 BT

W. SPRUCE 5" S44E 14.24 MKD 524 BT

W. SPRUCE 12" N73E 15.01 MKD 513 BT

RM

Set a 4" x 4" x 8' long wood post
S88-54-25W 50.0' with signs 54-2
54-4 E 54-6

32 P-25

E14 to SECTION 24

FROM ORIG. GOVT SURVEY OF 1876

40.00 SET A 3" FIR POST

BIRCH 6" N38°E 6 IHS

W. PINE 10" N39°W 20 IHS 13.2'

FROM SURVEY OF STATE ROAD #2 (Now #6)

CEDAR 10" S70°W 49.8' ~~SCARCE~~

FALLEN 12" CEDAR LOG & STUMP

FIR 8" N40°W 45.0'

REMOVED IN ROAD CLEARING

NEW EAM 6" N66°W 71.20 Found N57W
good shape scribe
over grown

NEW CEDAR 12" S58°W 89.60 Found S66W
good shape scribe
visible

from County BT's above
I put RK nail in road for cor position
from which bears

USGS AZ 2" x 5" long

Monument 5" x 1" pipe
with brass cap

Cabin S89-36-38 W

S63°W

48.50'

60.0'

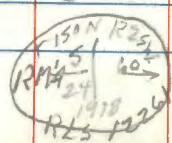

8/78
Rounded above

T150N

R25W

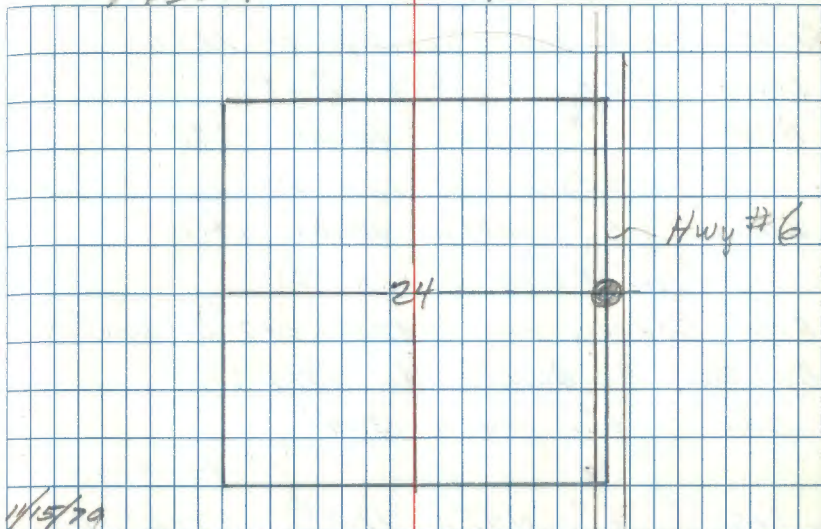

11/15/79

TIES TO THE W. 1/4 COR:

B. ASH 4" N55°W 45.30' MKD WC BT

B. ASH 5" S96°W 18.72 MKD NE BT

MCD

Set 4" x 4" x 8' Wood post with signs

54-2 54-6 589-36-38W 50.0'

33 R-25

SECTION CORNER TO SECTIONS 24 & 25

FROM ORIG. GOVT SURVEY OF 1876:

80.00 SET 4" ASH POST

ASH 5" S58°W 15 IKS 9.90'

* IN ROAD CLEARING

BIRCH 4" N23°W 20 IKS 13.2'

* IN ROAD CLEARING

FROM SURVEY OF STATE ROAD #2 (Now #6)

By Roy H. BLIER IN 1913:

OAK 8" S45°W 31.4'

FIR 6" N42°W 19.2'

* IN ROAD
CLEARING

FROM COUNTY SURVEYOR'S RECORDS

"OLD" CEDAR 7" N70°W 51.85' * 8" LIVE

BIRCH 10" S54°W 78.80' * 10" x 21" STUB.

CEDAR 10" N41°W 95.20' * 14" & LIVE

* 1978 NOTES. - SCRIBING VISIBLE IN ALL TREES

OLD CEDAR IS S70°W & 50.85'

from county BTs above

To perpetuate this cor I set a PK

Nail in ϕ of Hwy #6 at cor location
witnessed by - (opposite page) →

T150 N

R25 W

EE

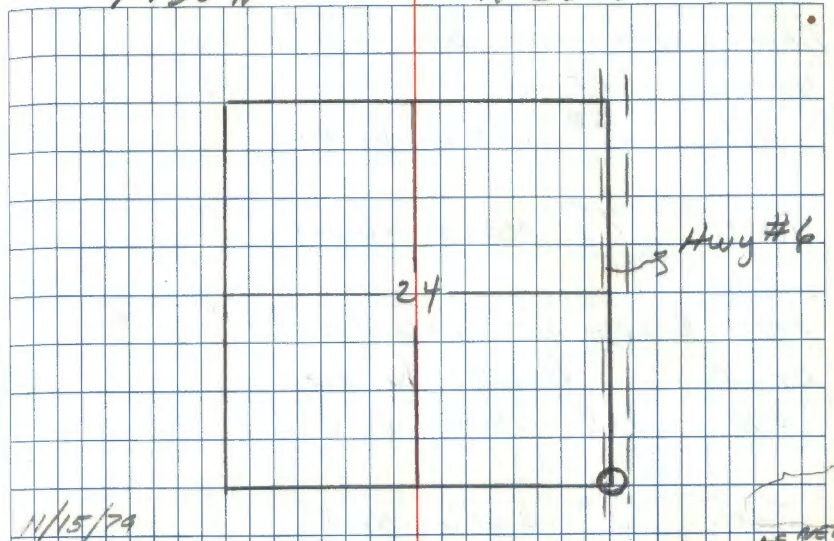

N/15/78

TIES TO W.C. SEC. COR. (SAME TREES AS W.C. SEC. COR.)

CEDAR 7" N39°W 28.28' MKD S24 BT

CEDAR 12" S41°W 56.25' MKD S25 BT

New BTs

Cedar

Cedar

Monument 2" x 5"
steel pipe w/ Brass cap

7"

12"

N71°W

S69°W

S89-44-53 W

80.98'

109.47'

60.00'

S24 BT

S25 BT

Set a 4" x 4" x 8" post

with signs 54-2-54+4

54-6 S89-44-53 W 50.0'

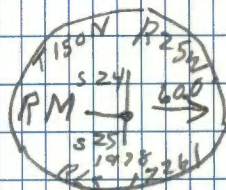
8/78
Ronald Ober

34T-25
E 1/4 To SECTION 25

FROM ORIGINAL ^{SURVEY} GOVT A OF 1876

40.00 SET A 3" FIR POST

TAM. 5" S66°W 60 WS

TAM. 7" N55°E 10 WS

FROM SURVEY OF STATE ROAD #2 (Now #6)

By Roy K. BLILER IN 1913:

FIR 12" S80°E 53.4'

TAM. 7" S65°W 41.5'

FROM COUNTY SURVEYOR'S RECORDS

ELM 10" N55 1/2°W 82.60'

A 16" LIVE TREE, FACES OVER GROWN

FIR 7" S61°W 62.00'

A 12" LIVE TREE, FACES OVER GROWN

35 V-25

SECTION CORNER TO SECTIONS 25436

FROM ORIG. GOVT SURVEY OF 1876

80.00 SET 4" X 4" FIR POST

SPRUCE 10" N80°W 60.1HS }
IN ROAD
CLEARING

SPRUCE 8" S76°W 50.1HS

FROM SURVEY OF STATE ROAD #2 (Now #6)

BY ROY M. BLILER IN 1913:

ASPEN 12" S50°W 42.3' }
IN ROAD
CLEARING

FIR 7" N80°W 44.9'

FROM COUNTY SURVEYOR'S RECORDS

IRON MONUMENT S47½W 50.60' * OK IN PLACE

IRON MONUMENT N59½W 50.60' * " " "

* BOTH COUNTY WITNESS, OK 8/17/88
MCS

36

X-25

E 1/4 CORNER TO SECTION 36

FROM ORIG. GOV'T SURVEY OF 1876

40.00 SET 4" X 4" ELM POST IN SWAMP

ASPEN 10" S74°W 15.14S 9.90'

FIR 3" N59°E 10.14S 6.60'

FROM SURVEY OF STATE ROAD #2 (NOW #6)

BY ROY K. BLIZZER IN 1913:

ASPEN 10" S71°W 15.0'

FIR 3" N49°E 12.9'

FROM COUNTY SURVEYOR'S RECORDS

ASH 9" S49°W 71.70'

10" ASH ^{OK}

ELM 10" N61°W 65.90'

12" ELM ²⁵

5/1/79

FOUND ABOVE BT- IN GOOD CONDITION

38 BIG FORK RIVER
MC ON EAST SIDE OF BOWSTRING

BETWEEN SECTIONS 1 & 36

NOTES OF ORIG. GOVT. SURVEY 1875

SET ASH POST

ASPEN 6 N72E 50 IKS. 33.0'

ASPEN 6 S50E 65 IKS. 42.9'

MC ON WEST SIDE OF BIG FORK RIVER

BETWEEN SECTIONS 1-36

NOTES OF ORIG. GOVT. SURVEY 1875

SET ASPEN POST

ASPEN 15 S57W 201KS. 13.2'

ASPEN 15 N12W 301KS. 19.8'

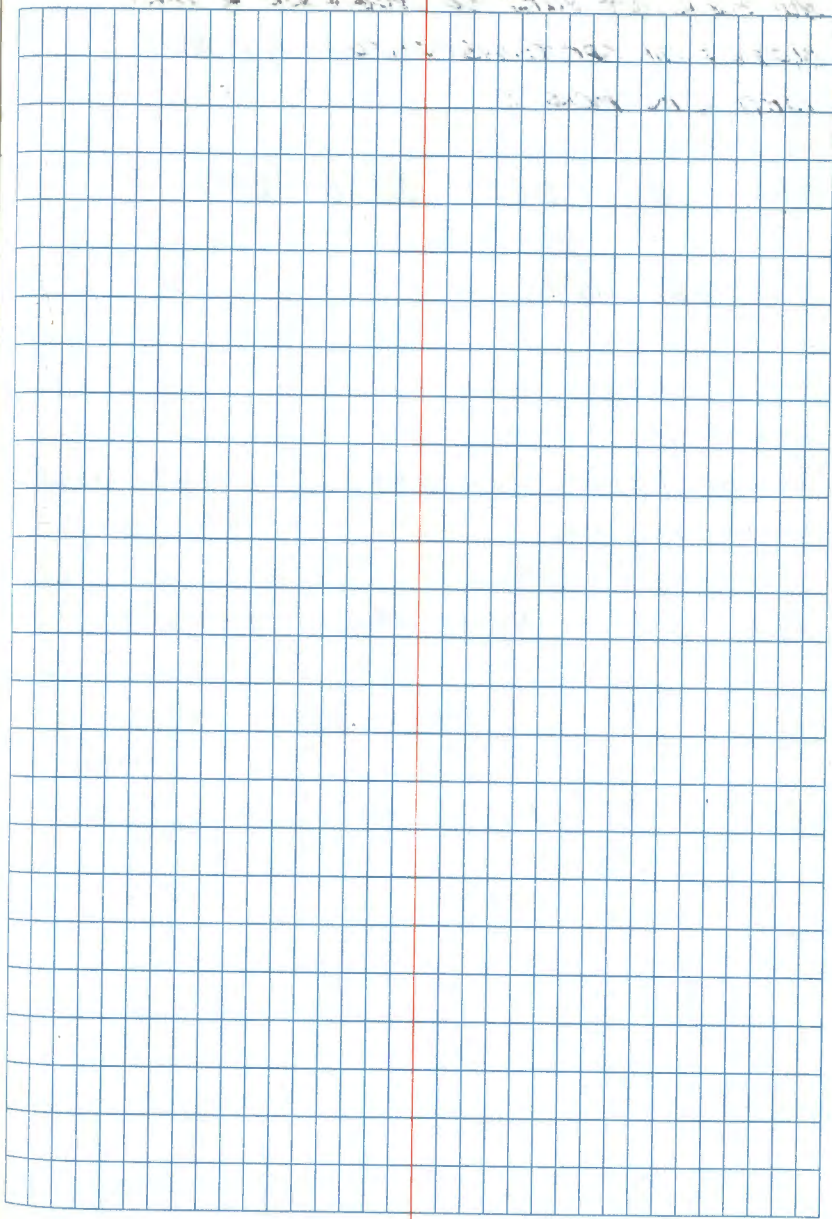

40

Z-23

QUARTER CORNER BETWEEN SEC'S. 1-36

NOTES OF ORIG. GOVT. SURVEY 1875

SET FIR POST

ASH 6 S65W 351Ks. 23.1'

NO OTHER NEAR

8-05-2008 ITASCA CO

REFERTO CORNER CERT

REMOVE MANDCT MONUMENT. SET 5/8" X 4' REBAR
W/ ALLUM CAP.

ASH 12" N17E 19.24 SPK/WASHER

ASH 12" S70W 6.65 "

ASH 13" N24W 15.85 "

SECTION CORNER TO SECTIONS 1-2-35-36

NOTES OF ORIG. GOVT. SURVEY 1875

SET ASPEN POST

ASH 10 S68E 2601KS. 171.6'

ELM 9 S28W 2781KS. 183.5'

NO OTHERS NEAR

5/8/91

NO EVIDENCE OF THE ORIGINAL
SURVEY REMAINS.

M. E. Steyer

5/8/91

At single proportionate position determined
from aerial photo target:

SET A 2" x 30" ALUM. PIPE W/ ALUM. CAP STAMPED:

FROM WHICH BEARS

BASSWOOD 10" N46°E 230.16'

B. ASH 6" S54°E 4.59'

R. MAPLE 8" S32°W 32.69'

B. ASH 6" N76°W 14.47'

ALL TREES DOUBLE BLAZED & SCRIBED W/ NAIL OUTSIDE

9-03-2008 ITASCA COUNTY

REFER TO CORNER CERT. REBET 1981 MONUMENT

1981 BASSWOOD 11" N9W 19.7 SPK/WASHER

1981 ASH 7½ S25W 18.16 "

1981 ASH 7½ S75W 27.62 "

NEW ASH 4" S58E 1.91 "

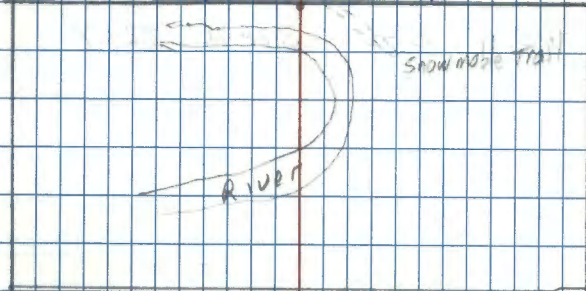

3/12/82 Hayes Oleson

While traversing to establish the ¼ cor.
to secs. 35 & 36 it was discovered that this
corner as established on 5/8/91 was out of position. Based
on traverse data we reestablished position for this corner and
took the following ties: (monument must be moved when ground thaws)

Basswood 10" N0°W 25.22'

Maple 8" S36°W 46.90'

B. Ash 6" S34°W 12.85'

B. Ash 6" S84°W 24.55'

5/19/82 Hayes, Whittemorn, Fallon

Reopened Alum. Man. established on 5/8/91 and
set it at corrected position as per 3/12/82.

42

MC ON EAST SIDE OF BIG FORK RIVER
BETWEEN SECTIONS 2-35
NOTES OF ORIG. GOVT. SURVEY 1875
SET ASH POST

ASH 9 N83W 320 IKS. 211.2'

ASH 10 S80W 348 IKS. 229.7'

MC ON WEST SIDE OF BIG FORK RIVER

BETWEEN SECTIONS 2-35

NOTES OF ORIG. GOVT. SURVEY 1875

SET ELM POST

ASH 10 S85E 2801KS. 184.8'

ELM 9 N79E 2661KS. 175.6'

44 2-19

QUARTER CORNER BETWEEN SECTIONS 2-35

NOTES OF ORIG. GOVT. SURVEY 1875

MARKED 3" ASH TREE

ELM 8 S30E 401Ks. 26.4'

MAPLE 5 N45W 301Ks. 19.8'

5/8/81

NO EVIDENCE OF THE ORIGINAL

SURVEY REMAINS

Mt. E. H. H.

*Due to erroneous
coordinates on
target.*

5/8/81 by STEFAN & ROBERTSON

SET A 2" 130" ALUM PIPE W/ALUM CAP STAMPED:

FROM WHICH BEARS:

B. ASH 6" S67E 17.51'

B. ASH 8" S63W 12.25'

B. ASH 8" N75W 17.02'

ALL TREES DOUBLE BLAZED & SCRIBED W/NAIL ON SIDE

5/23/91 Dan Delmire from MUDAT called and reported that his GPS values confirm that the 1981 monument is not yet the 1st position as dilo intended. I gave him permission to pull our monument and he will set his own.

Mike Hays

12-01-2008 ITASCA CO

REFER TO CORNER CERT

SET MONUMENT 5/8" X 2' REBAR W/ALUM CAP

ASH 12" N12E 25.80 SPK/WASHER

ASH 9 1/2" S73E 33.48 "

ASH 10 1/2" S83W 41.98 "

46
MC ON WEST SIDE OF BIG FORK RIVER
BETWEEN SECTIONS 2-35
NOTES OF ORIG. GOVT. SURVEY 1875
SET ASH POST

ASH 10 N88W 220 IKS. 145.2'

ASH 10 S87W 214 IKS. 141.2'

Pages

47 thru 50

Blank

51 2-17

SECTION CORNER TO SECTIONS 2-3-34-35.

NOTES OF ORIG. GOVT. SURVEY 1875

SET ASPEN POST

TAM. 6 S9W 101KS. 6.6'

TAM. 7 S34E 251KS. 16.5'

DEAD
SPRUCE 10 N23E 181KS. 11.9'SET 2" DIA. X 30" LONG ALUM. MONUMENT WITH
3" DIA. ALUM. CAP MKD. TISON R25W

S34 | S35

S3 | S2

T149N

1980

RLS NO 12261

WITNESSED BY

ASPEN 6 N7E 33.00' MKD. S35 BT

ASPEN 8 S49E 26.33 " S2 BT

ASPEN 7 N64W 109.20 " S34 BT

ASPEN 7 N25W 18.10 " S34 BT

TRIANGLE
STA. 1557 3"X3"X4" N36W 9.25 ▽

1/16-3-80

Ant Kanan

Jeff Allison

Bill Olson

12

FSLP ON 6" CEDAR POST 10.9' NORTH OF MONUMENT

2-19-85 by K Whitehorn (per Hayes)

This corner position was

reestablished using the

old road survey as
evidence of the obliterated
position

7-24-2007 ITASCA CO

REFER TO CORNER CERT.

RESET 1980 MONUMENT

1980 ASPEN 12" N60W 11.09 SPK/WASHER

1980 ASPEN 12" S30E 33.46 "

TAMARACK 9" S25W 50.60 "

USGS BENCHMARK S63W 7.96

SEG N POST 12' SOUTH

52

Z-15

QUARTER CORNER BETWEEN SEC'S. 3-34

NOTES OF ORIG. GOVT. SURVEY 1875

SET TAM POST

SPRUCE 6 NSW 101KS. 6.6'

TAM. 8 S68E 651KS. 42.9'

LOCATION POSTER ON TELEPHONE (POWER) POLE

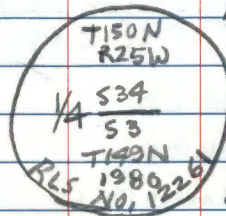
SET 2 1/2" X 30" ALUM. PIPE WITH 3/4" CAP
MARKED: MON. IS UP 0.5'MON. APPROX 20'
SOUTH OF EDGE OF
BITUMINOUS SURFACE
OF ROAD.

WITNESSED BY:

SPRUCE 10" N9°W 123.59' ^{MRD:} 1/4 S34BT

SPRUCE 5" S38°W 23.62' 1/4 S 3 BT

SPRUCE 6" S2°E 19.53' 1/4 S 3 BT

8 FT. LONG STEEL POST 4.0' WEST W. #554-9

11/6/80 William M. Olson

5-27-2009 ITASCA CO.

REFER TO CORNER LEFT

RESET 1980 MONUMENT

1980 SPRUCE 11 N16W 63.75 SPK/WASHER

1980 SPRUCE 10 SOUTH 80.55 "

1980 SPRUCE 10 S10W 80.55 "

POWER POLE N72W 98.68 NAIL/DESC

SIGN POST 60.4 SOUTH

53

Z-13

SECTION CORNER TO SECTIONS 3-4-33-34

NOTES OF ORIG. GOVT. SURVEY 1875

SET TAM POST

TAM. 4 N22E 161K. 10.6'

SPRUCE 8 S27W 241K. 15.8'

NO OTHERS NEAR

SET: 2" x 30" ALUM PIPE WITH 3/4"

Cap marked:

mon is up 0.6'

in wet area, APPROX. 50'

ft south of E of

Road. 2" I.P. up

2.5' is N90E 2.6'

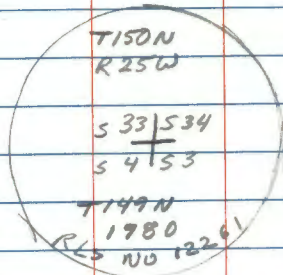

Witnessed By:

Ash	8"	S80W	39.60	T149N R25W S4 BT
Cedar	14"	S52W	74.90	T149N R25W S4 BT
Ash	9"	S12E	48.99	T149N R25W S3 BT
steel sign post	8'	West	3.7'	W FS. 54-9

11/6/80 William M. Olson

20

5-27-2009 ITASCA CO

REFER TO CORNER CERT

REMOVE 1980 MONUMENT REPLACE /W/ COUNTY IRON

POWER POLE N34E 56.45 NAIL/DISC

ASH 5 1/2 S50W 77.80 SPK/WASHER

CEDAR (1980) 14 S34W 110.03 11

54

2-11

QUARTER CORNER BETWEEN SEC'S. 4-33

NOTES OF ORIG. GOV'T. SURVEY 1875

SET TAM POST

ASH 8 S4W 131KS 8.6'

ELM 8 N7E 551KS. 36.3'

SET: 2" x 5' Iron pipe with 3"

Brass capped MKD:

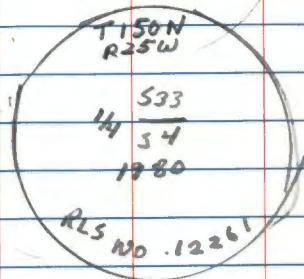
Mon. up 2.0' in wet south road
ditch.

Witnessed By:

Elm	17"	N34E	130.0	^{MKD.} 1/4 533 BT
Oak	12"	N49E	157.75	1/4 533 BT
Power Pole	8"	N60E	155.53'	w FS 54-3 ^{Gal. Nail in center}
Steel sign post	8'	East	5.7'	w FS 54-9

11/6/80 William N. Dean

S-27-2609 ITASCA Co

REFER TO CORNER CERT

REMOVE 1980 MONUMENT, REPLACE W/CO IRON

OAK (TWIN) 5 NZW 78.47 SPR/WASHER

SPRUCE 5 S27W 52.32 "

SPRUCE 5 S46E 60.36 "

56 MC ON WEST SIDE OF BIG FORK RIVER

BETWEEN SECTIONS 4-33

NOTES OF ORIG. GOVT. SURVEY 1875

SET OAK POST

OAK 8 N33W 284 lks, 1874'

NO OTHER NEAR

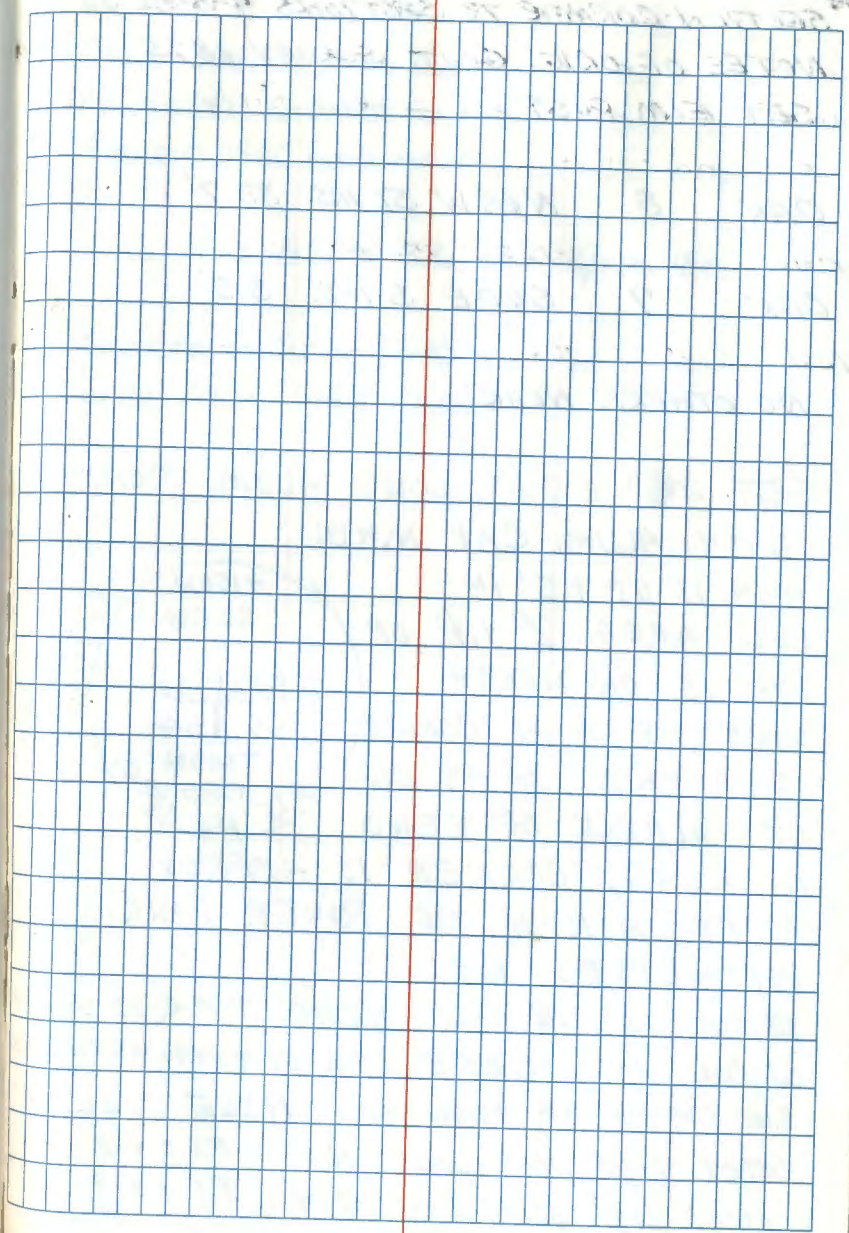

57 Z-9
SECTION CORNER TO SECTIONS 4-5-32-33
NOTES OF ORIG. GOVT. SURVEY 1875
SET ELM POST

OAK 8 N64W 51 IKS. 33.7'

OAK 7 S60E 5 IKS. 3.3'

NO OTHERS NEAR.

SET 2 1/2" X 5 FT. LONG ALUM. MON.
WITH ALUM. CAP MKD:

MON IS UP 1.5' IN

LOW AREA. 2' I.P. UP

1.4' IS ON NORTH

SIDE OF MON. CORNER

IS APPROX. 60 FT. SW

OF MIDDLE OF BEND

IN ROAD. CORNER IS APPROX
40 FT. NORTH OF RIVER BANK.

WITNESSED BY:

Red Oak 13" N40W 47.40 T150R25S32BT

W. Oak 14" S85E 152.84 T149NR25W54BT

SW CORNER OF TOWN HALL N36E 126.18'

Steel sign post West 4.1' FS 54-9

steel sign post East 3.9' FS 54-9

11/6/80 William N Olson

72
7-24-2007 ITASCA CO
REFER TO CORNER CERT
RESET 1980 MONUMENT

OAK 18 1/2 N56W 33.72 SPK/WASHER

SIGN POST S8W 17.65

SIGN POST S16E 19.38

58

MC ON EAST SIDE OF BIG FORK RIVER
BETWEEN SECTIONS 5-32
NOTES OF ORIG. GOV'T. SURVEY 1875
SET OAK POST

OAK 7 N83E 1761K. 116.2'

ASH 6 S86E 1851K. 122.1'

59 MC ON WEST SIDE OF BIG FORK RIVER
BETWEEN SECTIONS 5-32
NOTES OF ORIG. GOVT. SURVEY 1875
SET ASH POST

WILLOW 6 S24E 331KS. 21.8'

NO OTHER NEAR

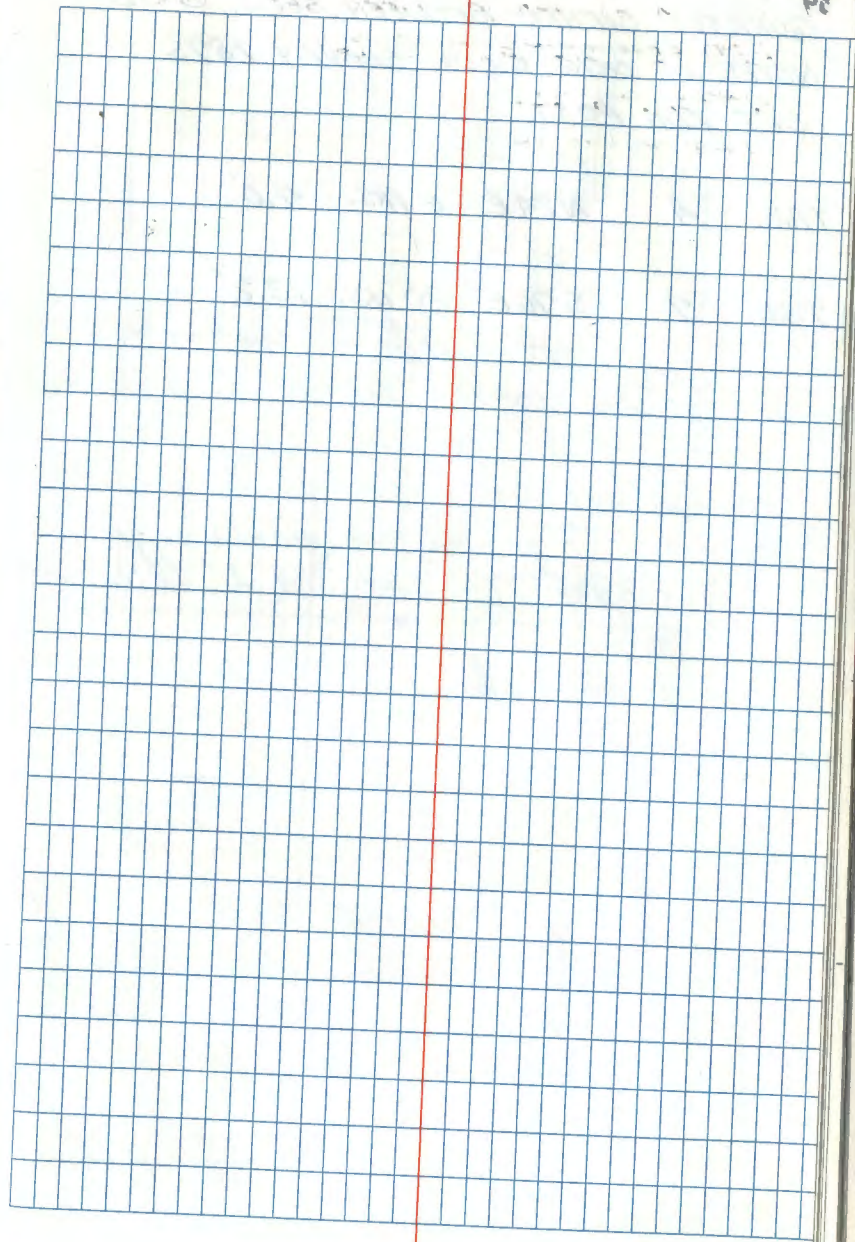

60 2-7
 QUARTER CORNER BETWEEN SEC'S. 5-32
 NOTES OF ORIG. GOVT. SURVEY 1875
 SET ELM POST

not found

TAM. 4 N24E, 61KS. 4.0'

not found

TAM. 7 S76E, 201KS. 13.2'

not found

(Stellan, Hayes, Hansley, Harmon)

Reestablished corner position at proportionate position btwn. sec. corgs. East & West. Position was determined from aerial photo target. This position generally agrees with a blaze line East and an old cut-out line South.

Set a 30" x 2 1/2" aluminum pipe w/ cap stamped:

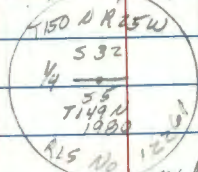

from which bears:

Cedar 14" N27°E 85.65' (Single Blaze) 1/4 532 BT

W. Birch 10" S22°W 87.64' (Double Blaze) 1/4 55 BT

Ash 4" N14°W 75.0' (Single Blaze) 1/4 532 BT

Steel Sign Post 8' long. West 1.4'

11/7/80
 J. Hayes

R9-7150-4 by Hayes

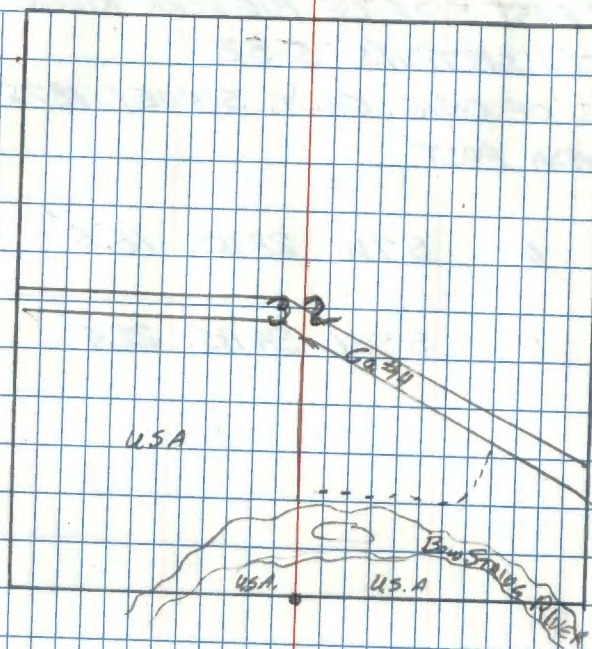

MC. ON EAST SIDE OF BIG FORK RIVER
 BETWEEN SECTIONS 5-32
 NOTES OF ORIG. GOVT. SURVEY 1825
 SET ASH POST

TAM. 6 S7W 281Ks. 18.5'

FIR 7 S56E 341Ks. 22.4'

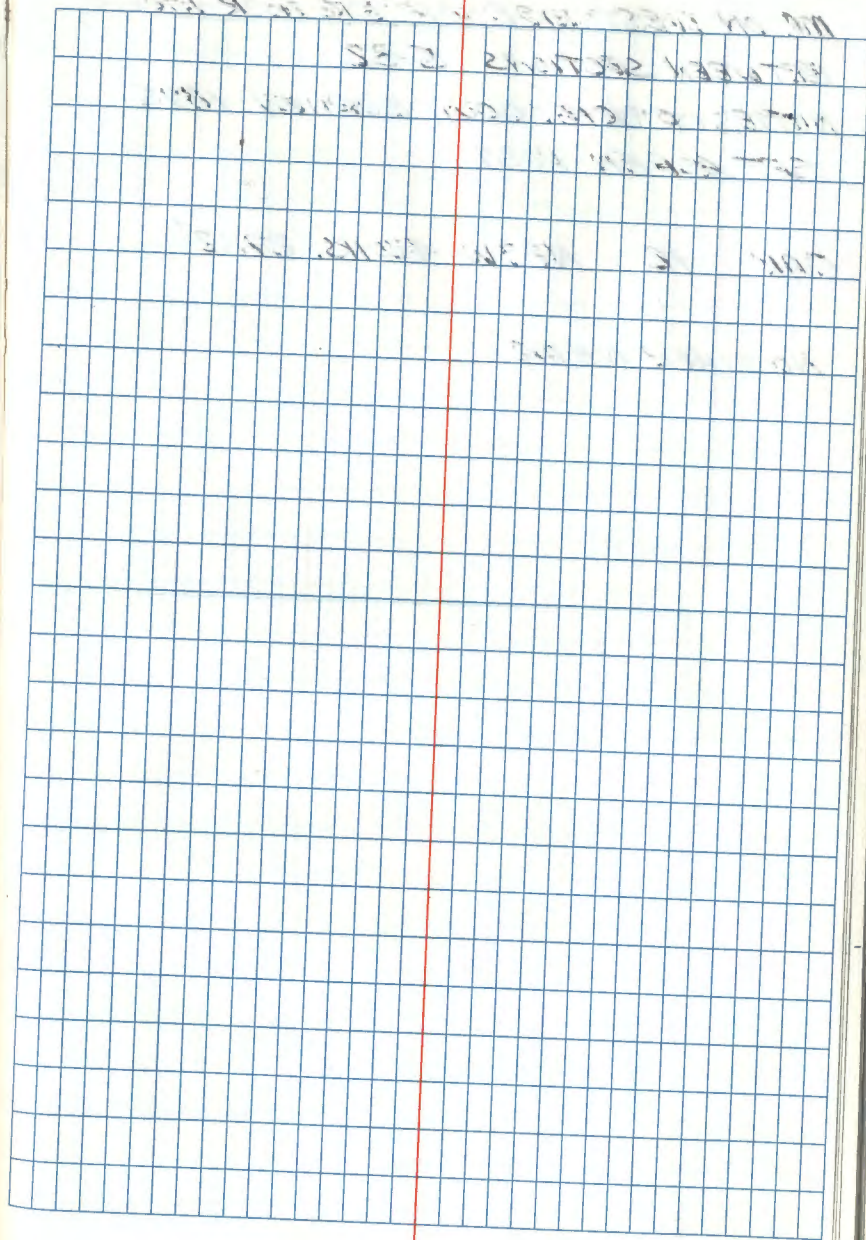

62

MC ON WEST SIDE OF BIG FORK RIVER

BETWEEN SECTIONS 5-32

NOTES OF ORIG. GOVT. SURVEY 1875

SET ASPEN POST

OAK 12 NB3W 4201K5 277.2'

NO OTHER NEAR

63 SECTION CORNER TO SECTIONS 5-6-31-32

NOTES OF ORIG. GOV'T. SURVEY 1875

SET ASPEN POST

not found

ASPEN 6 N64E 201KS. 13.2'

not found

ASPEN 7 N13W 181KS. 11.9'

not found

SPRUCE 6 S45E 251KS. 16.5'

not found

NO OTHERS NEAR

11-4-80 Hayes, Brama, Main, Sherwood

No evidence of original post or B.T. 3

Found a very old fence line which

runs southerly from the 1/4 cor. secs. 31³²

At 2659.18' South of 1/4 cor. secs. 31³²

remains of fence line runs East to

Big Fork River. Distance to river of

1220' checks well with original call of 18.40

POSITION RESTORED AT FENCE LINE

& TOWNSHIP LINE INTERSECTION.

Mike C. Saylor

64
QUARTER CORNER BETWEEN SEC'S. 6-31

NOTES OF ORIG. GOV'T SURVEY 1875

SET FIR POST

not found

ASPEN 7 South 10 IKS. 6.6'

not found

ASPEN 6 N28W 24 IKS. 15.8'

not found

11/5/80 Hayes, Main, Sherwood

No evidence of Orig. found. Positioned cor.
a proportionate position ptwn, sec. cor.
East and Town Cor. West. Determined
location from aerial photo target.

11/7/80 Hayes & Harney

Set a 2 3/4" x 30" aluminum pipe with cap stamped:

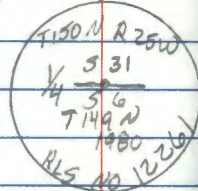

from which bears:

Ash 5" N81°E 61.27' Mtd. X BT

Ash 7" S12°W 11.78' Mtd. 1/4 5.6 BT

Ash 6" N49°W 22.55' Mtd. X BT

Steel Sign Post N50°W 17.0'

M.C. Hayes

Aerial photo target bears S49°52'E 106.78'

R9-7150-4 by Hayes

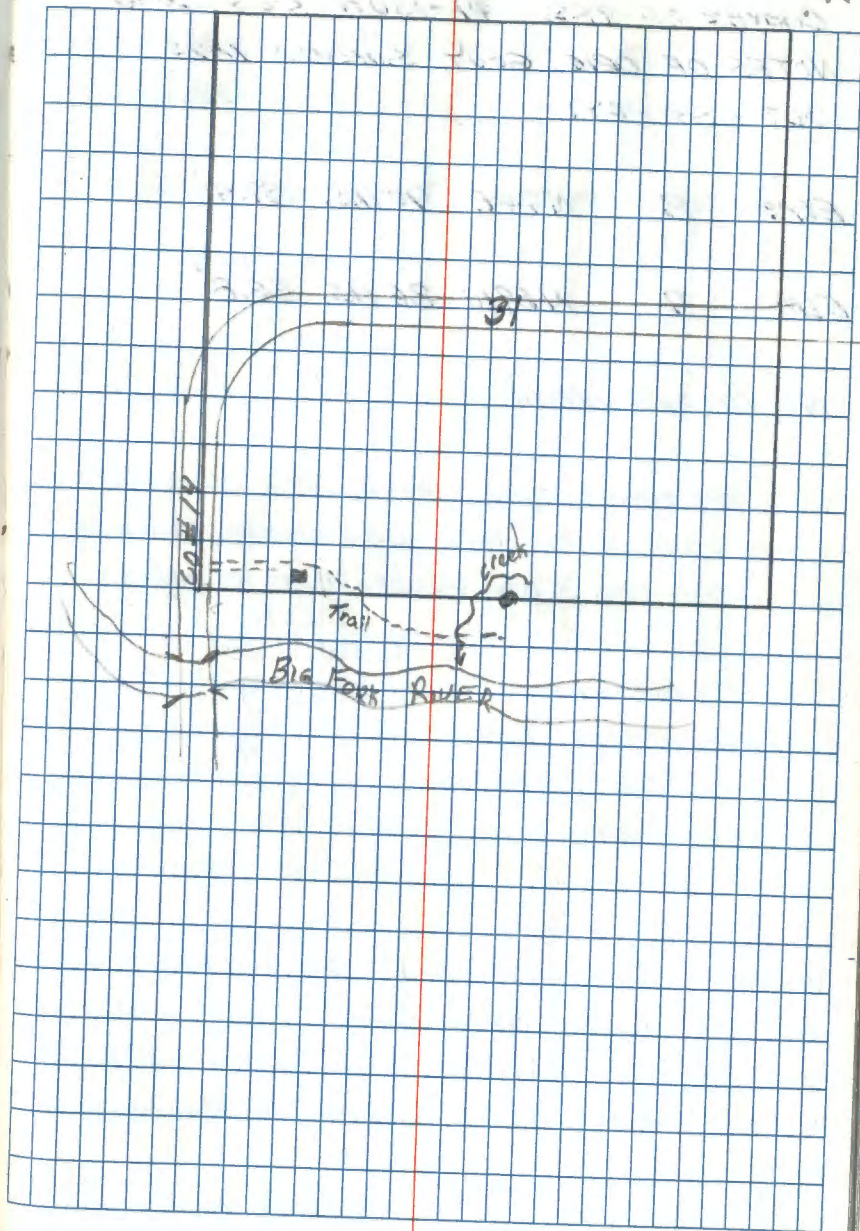

65 2-1

CORNER OF T.P.S. 149-150N R25-26W

NOTES OF ORIG. GOV'T. SURVEY 1875

SET ASH POST

ELM 8 N74E 90'KS. 59.4'

ELM 7 N69W 86'KS. 56.8'

NO OTHERS NEAR

TO PERPETUATE THIS CORNER SET 2" DIA. X 24" LONG
GALVANIZED STEEL PIPE WITH CONCRETE INSIDE
AND CAPPED WITH 3" DIA. BRASS TABLET MARKED

TISON	
R26W	R25W
536	531
51	56
T149N	
1980	
RHS NO 12261	

3" BELOW BLACKTOP
SURFACE IN EAST BOUND
LANE - 5' EAST OF PRESENT
E. OF HIGHWAY

W. OAK	21	N39W	175.43	^{mkd} TISON R26W S36 BT
ASH	13	N19W	257.64	TISON R26W S36 BT
W. OAK	8	N13E	302.85	TISON R25W S31 BT
ELM	20	N69E	115.49	TISON R25W S31 BT

11-3-80

Curtis R. Kerner

20

FROM BRASS CAPPED IRON MONUMENT WEST
TO BIGFORK RIVER 224'

SET MONUMENT 1.05' NORTH OF PRIVATE
ROAD

66 X-1
QUARTER CORNER BETWEEN SEC'S. 31-36

NOTES OF ORIG. GOUT. SURVEY 1875

SET WOOD POST

SPRUCE 8 N71E 111KS. 7.3'

SPRUCE 10 N56W 181KS. 11.9'

SET 2" DIA. X 24" LONG GALVANIZED STEEL
PIPE WITH CONCRETE INSIDE AND CAPED
WITH 3" DIA. BRASS TABLET MARKED

TISON

6" BELOW SURFACE R26W R25W

OF GRAVEL ROAD N-S $\frac{1}{4}$

RESET IRON PIN AT S36/S31

NORTH SIDE OF MONUMENT 1980

RLS NO 12261

WITNESSED BY

W. OAK 6 S 41° E 103.89' MKD $\frac{1}{4}$ S31 BT

BALM 8 S 52° W 119.50' $\frac{1}{4}$ S36 BT

ASH 7 N 80° W 79.50' $\frac{1}{4}$ S36 BT

6" CEDAR POST DUE WEST 17.7' WITH FSLP

FL. 1" X 6" STEEL PIN IN PLACE

11-3-80 Curtis R. Kimmel

FOUND $\frac{3}{4}$ " X $\frac{1}{4}$ " IRON PIN 8" BELOW ROAD SURFACE
TIES TO IRON PIN

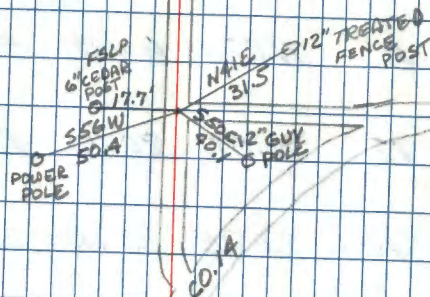

6-1-94 OK

TALKED TO TIM WOTZIKA AT ITASCA COUNTY

HE TOLD ME THEY FOUND 2" X 24" BRASS CAP IRON OUT OF
PLACE - LYING BY A BT ON WEST SIDE OF COUNTY ROAD

5/2/94
THEY SET $\frac{1}{2}$ " X 48" REBAR AT $\frac{1}{4}$ COR 10" BELOW ROAD

GRADER OPERATOR CALLED COUNTY SURVEYOR OFFICE

SAID HE BLADED IRON OUT IN LATE APRIL - FROST HEAVED

6-2-94 OK+RM

PICKED UP FS MONUMENT FROM W BT AREA

67 V-1

SECTION CORNER TO SECTIONS 25-30-31-36

NOTES OF ORIG. GOVT. SURVEY 1875

SET WOOD POST

SPRUCE 8 N37W 6 IKS. 4.0'

SPRUCE 12 N10E 20 IKS. 13.2'

ASPEN 10 S67E 33 IKS. 21.8'

FIR 10 S65W 52 IKS. 34.3'

TO PERPETUATE THIS CORNER WE
Set 2" DIA. X 24" LONG GALVANIZED STEEL

PIPE WITH 3" DIA. BRASS CAP MARKED:

 $\frac{1}{2}$ " IRON PIPE AND
POINT OF OAK WOODPOST AT NORTH SIDE
OF MONUMENT.MON. DOWN 1.0' UNDER
ROAD SURFACE APPROX.3 FEET EAST OF $\frac{1}{2}$ OF ROAD.

WITNESSED BY:

ELM 6 S72°W 114.80' MKD: T150N R26W S36 BT

ASH 7 S50°W 108.51' T150N R26W S36 BT

GAL. NAIL IN SIDE OF CORNER FENCE POST N72°E 15.85'

F.S. 54-6 ON POWER POLE 61.0' N52°E.

11/5/80 William M. Olson

FOUND $\frac{1}{2}$ " X 14" IRON PIPE AND 10" POINT OF OLD WOOD POST
8" BELOW ROAD SURFACE

MKD TEMPERAY TIES

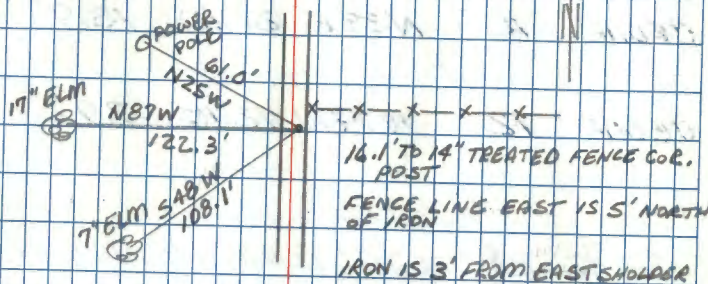

6-2-94 RMYCK

DROVE BRASS CAP TO 10" BELOW ROAD - TIES OK

68 T-1

QUARTER CORNER BETWEEN SEC'S, 25-30

NOTES OF ORIG. GOVT. SURVEY 1875

SET WOOD POST

CEDAR 12 N39E 21 HS. 13.9'

CEDAR 12 N74W 12 HS. 7.9'

SET 2 1/2" X 24" LONG IRON PIPE WITH
3" BRASS CAP MKD:

MONUMENT IS DOWN

0.6' UNDER ROAD SURFACE

AT APPROX $\frac{1}{4}$ OF ROAD,

OLD FENCE LINE RUNS

EAST FROM CORNER.

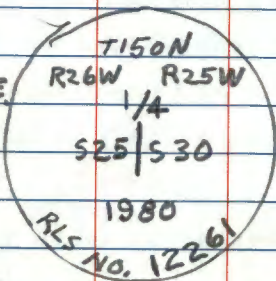

Witnessed By:

8 FT. STEEL SIGN POST S45°W 71.88' with FS 54-9

8 FT. STEEL SIGN POST S45°E 64.22' with FS 54-9

GAL. NAIL IN POWER POLE N68°W 52.81' w/ FS 54-3

11/5/80 William N. Olson

6-2-94 RML & CK

DROVE BRASS CAP TO 10" BELOW ROAD - TIES OK

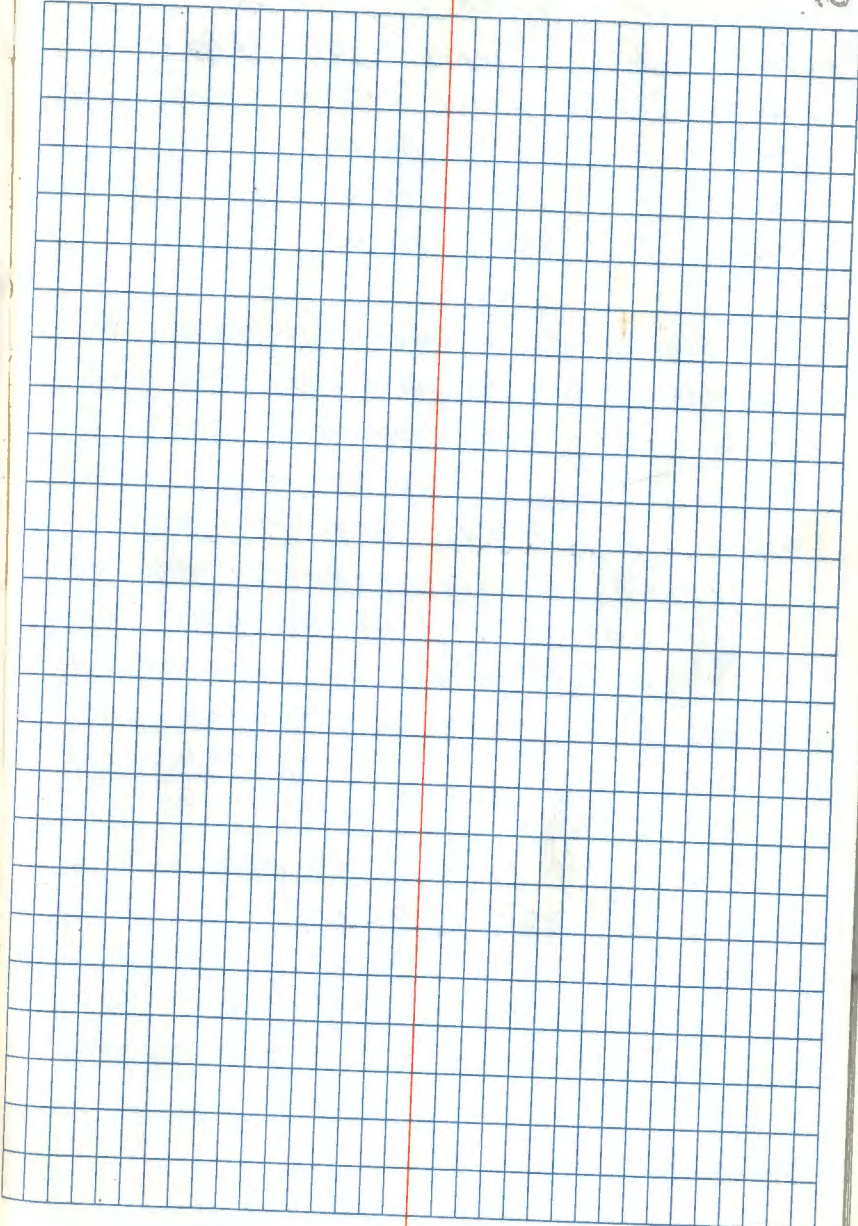

69 R-1 SECTION CORNER TO SECTIONS $\frac{24}{25} | \frac{19}{30}$

FROM ORIG. GOV'T. SURVEY OF 1882

80.00 SET POST 5' X 4' X 4'

ASPEN 15" N17°E 192 IKS

ASPEN 20" S34°E 200 IKS

FROM COUNTY ROAD SURVEY OF 1935 - SET
ANTRON MONUMENT FOR CORNER -

SPRUCE 12" S68°E 125.85'

SPRUCE 12" N15°E 87.85'

FOUND: 15" SPRUCE STUMP 24" WITH

BT SCRIBE. N18°E, 87.4'

+ 3/4" IRON 20" LONG 12" BELOW ROAD.

MADE NEW TEMPORARY TIES

8" CEDAR POST

17" SPRUCE WITH NAIL

9" SPRUCE WITH NAIL

N45°W
30.9'

N19°E
139.76'

N42°E
85.26'

CK -

N44°W
66.1'

POWER POLE

6-2-94 RNDCK

DROVE BRASS CAP TO 10" BELOW ROAD - TIES OK

TO PERPETUATE THIS CORNER WE
SET 2 1/2" X 24" LONG IRON PIPE WITH
3" BRASS CAP MKD:

MON. 15 DOWN 0.8'
UNDER ROAD SURFACE
APPROX 1 FT. WEST OF C.

3/4" IRON PIPE ON

NORTH SIDE OF MON.

MON. APPROX. 1 FT. SOUTH OF C. OF ROAD
TO THE EAST.

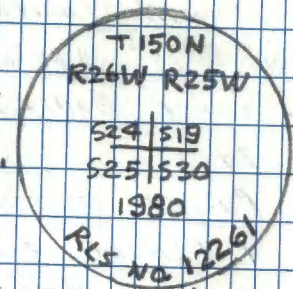

WITNESSED BY:

SPRUCE 17" N11°E 139.76' MKD: T150N R25W S19 BT

SPRUCE 10" N42°E 85.26' T150N R25W S19 BT

8 FT. STEEL SIGN POST N45°W 68.02' WITH FS54-9

TOP CENTER OF TEL. PEDESTAL N30°E 45.00'

11/5/80 William N. Olson

70 P-1 CORNER TO SECTIONS 19498²⁴

40.00 SET A 4"X4"X5' POST
BALM OF GILEAD 15" N41°W 30 INS

ASPEN 24" S80°E 40 INS

FROM COUNTY ROAD SURVEY OF 1935-

SET AN IRON MONUMENT FOR CORNER

FIR 8" S64°E 67.00'

NOW A FALLEN 13" SNAG & ROTTEN STUMP

SPRUCE 13" S37°W 116.15'

NOW A BADLY DECAYED 18-20" STUMP.

4/23/79

PULLED DISTANCE FROM TWO STUMPS

& PLACED NAIL 6" BELOW ROAD SURFACE.

MS

11/3/80

STEFAN

REPLACED NAIL WITH A 2"X24"

IRON PIPE WITH BRASS CAP

STAMPED AS FOLLOWS:

T150W
R26W R25W
324 + 319
1980
KLS 12261

FROM WHICH THE FOLLOWING BEAR:

5" W. OAK, N24°W, 91.60'

7" W. SPRUCE, S80°W, 79.20'

7" W. SPRUCE, S58°W, 102.88'

MS III

71 N-1 ^{Offical Govt} SECTION CORNER TO SECTIONS $\frac{13}{24} | \frac{18}{19}$

FROM ORIG. GOVT. SURVEY OF 1882:

80.00 SET A POST 4" X 4" X 5'

SPRUCE 18" S34°W 85 IN

BALM OF GILEAD 9" N14°E 150 IN 99.00'

FROM COUNTY ROAD SURVEY OF 1935 - SET AN IRON MONUMENT

TAM 4" N43°W 64.20'

Now A 12" WITH OVERBROWN FACE

TAM 7" N11°E 48.20'

Now A 13" WITH UNDERBROWN FACE

SPRUCE 8" S60°E 77.15'

Now A 8-10" VERY ROTTED SPRUCE

STUMP

A SCRIBED 4" X 4" X 18" POST NINED

TO FENCE POST. POINT OF POST IN

GROUND BY FENCE POST. BEARINGS &

DISTANCES TO POST POINT TO COUNTY

B.T. 2 GOOD. PLACED BT TAGS ON TO

TAM BT.

12-7-78 Hayes, Johnson, Goetz

To perpetuate, set a 2" X 3' galvanized pipe

with brass cap stamped

T150N

ROW R25W

S13 S18

S24 S19

ALG. No 1978 12241

8' steel post driven along side monument from which bear:

Assumed 10" N07°W 89.07'

Mkd T150N R25W S18 BT

Tam 13" N24°W 53.85'

Mkd T150N R25W S13 BT

Tam 7" N50°W 106.33'

Mkd T150N R25W S13 BT

(Old BT) Tam 13" N10°E 48.20' (County-1935)

(Old) BT Tam 12" N37°W 64.20' (County-1935)

Set steel post North 2.0' South 2.0'

Mkd OK 11/7/78

M.C. Hayes

72 2-1

QUARTER CORNER BETWEEN SEC'S. 13-18

NOTES OF ORIG. GOVT. SURVEY 1875

SET WOOD POST

BALM OF GILEAD 10 S68E 201KS, 13.2'

BALM OF GILEAD 20 S58W 381KS, 25.1'

10/23/78

NO EVIDENCE FOUND - PULLED CHAIN
FROM 1/2 MILE SOUTH

CK & MH

SET 2" DIA. X 30" LONG ALUM. PIPE WITH 3" DIA.

ALUM. CAP MARKED TISON

R26W R25W

12" ABOVE GROUND

1/4
S13 S18

1980

RLS NO 12261

HSH 7 NB1E 38.30 MKD. 1/4 S18 BT

W. OAK 6 S3E 49.00 " 1/4 S18 BT

ELM 5 S52W 31.67 " 1/4 S13 BT

ELM 6 N67W 23.28 " 1/4 S13 BT

73 J-1

Affidavit
SECTION CORNER TO SECTIONS 7-12-13-18

NOTES OF ORIG. GOVT. SURVEY 1825

SET WOOD POST

NO POST FOUND

SPRUCE 10 S25W 25 IKS. 16.5'

FOUND SPRUCE WINDFALL WITH SCRIBE T15 R2 S13 BT

ASPEN 18 N66E 33 IKS. 21.8'

FIR 8 S80E 52 IKS. 34.3'

SPRUCE 12 N26W 70 IKS. 46.2'

12-7-78

Hayes, Johnson, Gaste

To perpetuate, set 2" x 3" galvanized pipe
with brass cap stamped:

T150N	
R26W	R25W
S12	S7
S13	S18
R.L.S. No. 12261	

from which bear:

W. Oak 23" N12°E 88.09'

Scribed: T150N R25W S7 BT

W. Ash 11" S49°E 75.64'

T150N R25W S18 BT

B. Ash 8" N47°W 71.10'

T150N R26W S12 BT

B. Ash 8" S71°W 59.31'

T150N R26W S13 BT

Set steel post 3.8' North
3.6' Easton mls
12/7/78

ET

PUT FSLP ON 23" W. OAK N2E - 27.0' FROM ASPEN PICKET
SET AT CORNER LOCATION 10-23-78 CK-MH

74 G-1

QUARTER CORNER BETWEEN SEC'S, 7-12

NOTES OF ORIG. GOVT. SURVEY 1875

SET WOOD POST

CEDAR 12 N14E 121KS. 7.9'

LARGE BURNED STUMP N14E 7.9' NO SCRIBE

CEDAR 6 S44W 101KS. 6.6'

ROTTED CEDAR STUMP AND LOG-BURNED S44W 6.6'

10/23/78 PULLED DISTANCE FROM

SOUTH 1/2 MILE. FOUND NO EVIDENCE

SEARCH 8 man hrs. CK Y MH

SET 2" DIA. X 30" LONG ALUM. PIPE WITH 3" DIA.

ALUM. CAP MARKED TISON

R26W R25W

1/4

S12 | S7

1980

RLS NO 12281

CEDAR 10 N2E 44.15' MKD. 1/4 S7 BT

ELM 7 S24E 21.60 " 1/4 S7 BT

CEDAR 8 S80W 27.30 " 1/4 S12 BT

CEDAR 8 N60W 35.60 " 1/4 S12 BT

8' STEEL POST SET DUE NORTH 2.2'

11-5-80

AT

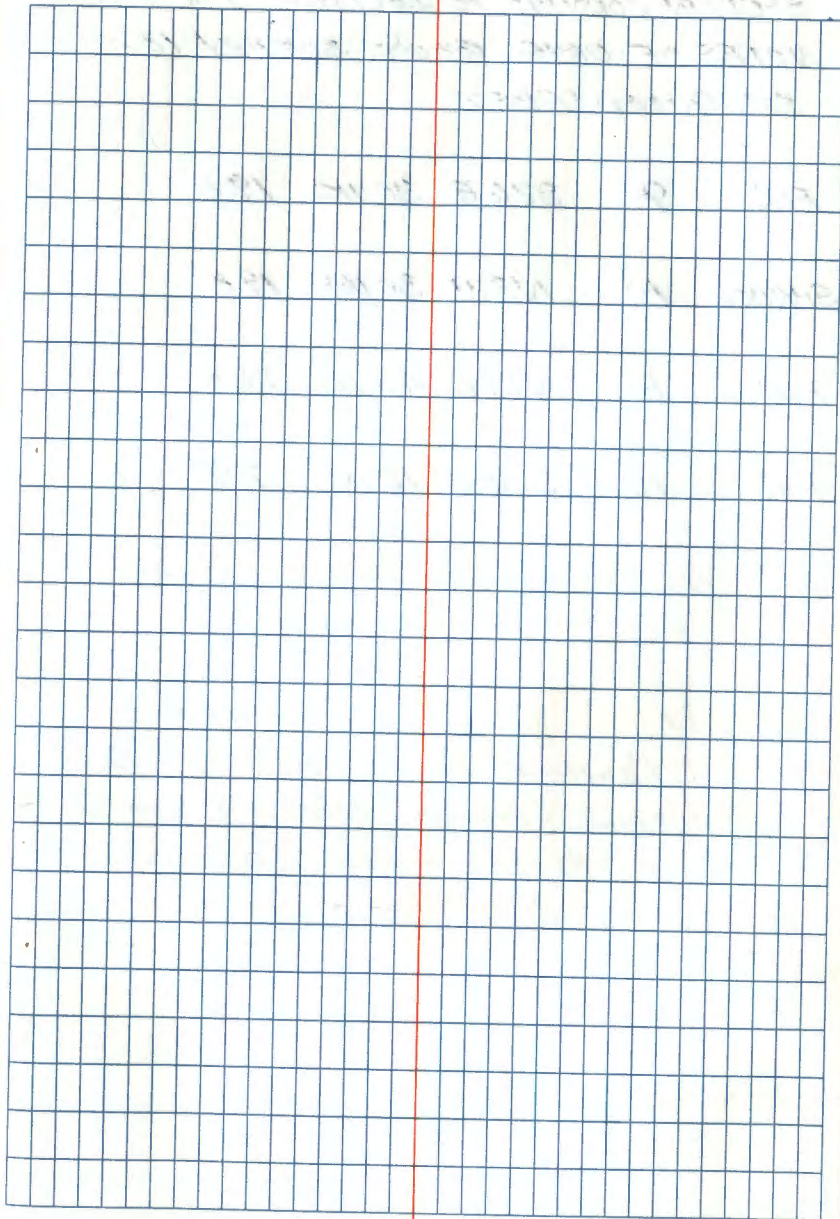

75 E-1

SECTION CORNER TO SECTIONS 1-6-7-12

NOTES OF ORIG. GOVT. SURVEY 1875

SET WOOD POST

FIR 9 S26E 30 IKS. 19.8'

SPRUCE 10 N3W 30 IKS. 19.8'

FIR 8 N21E 40 IKS. 26.4'

FIR 10 S58W 12 IKS. 7.9'

10/28/78 NO EVIDENCE FOUND

THIS DAY CH & MH

11/4/80

STEFAN

SET POSITION PROPORTIONALLY FROM

SECTION CORNER NORTH & SOUTH

FOUND BLAZED LINES EAST-WEST &

NORTH. NO MONUMENT SET THIS DAY.

76 C-1

QUARTER CORNER BETWEEN SECS. 1-6

NOTES OF ORIG. GOVT. SURVEY 1875

SET WOOD POST

TAM. 8 N15W 201KS. 13.2'

SPRUCE 8 N51E 201KS. 13.2'

10/77 & 78

NO EVIDENCE LOCATED

CK

11/4/80

STEFAN

SET POSITION PROPORTIONALLY FROM

TARGET & FOUND:

- 1) BEAVER BLAZE ON 6" CEDAR
- 2) LARGE BLAZE ON 8" B. ASH.
- 3) 10"-12" VERY ROTTEN TAM
STUMP BELOW GROUND LINE.

WE SET THIS CORNER FROM TAM
STUMP AS ALL OTHER EVIDENCE
SUPPORT (BEARING & DISTANCE TO
SECTION CORNERS NORTH & SOUTH)
WE PLACED A 2' X 5' ALUM.
PIPE WITH CAP STAMPED AS
FOLLOWS:

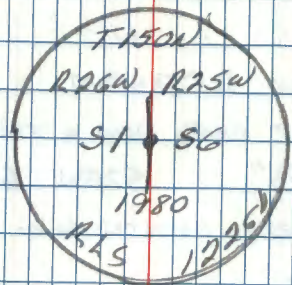

FROM WHICH THE FOLLOWING BEAR:

CEDAR	CEDAR	CEDAR	8" STEEL
8"	11"	12"	POST
N50°W	N51°E	S47°E	NORTH
6.82'	45.72'	40.79'	4.48'

MES
10/4/80

M R-3

REFER to Pg 77 BOOK 1

2/4/93 R. MAEN D. OJANEN

FOUND ELM BT DEAD, NOW A TALL SNAG. REPLACED WITH; ASH 8" S25W 64.38 FT MKD 4530 BT BT DOUBLE BLAZED PAINTED RED. DISTANCE TO 40 D SPEKLE.

STEEL SIGN POST SOUTH 17.85 FT

SET 2 1/2" X 24" LONG IRON PIPE WITH 3" BRASS CAP MKD:

MONUMENT IS DOWN 0.6' UNDER SURFACE OF TRAIL AT APPROX. Φ OF TRAIL.

OLD FENCE RUNS SOUTH FROM CORNER,

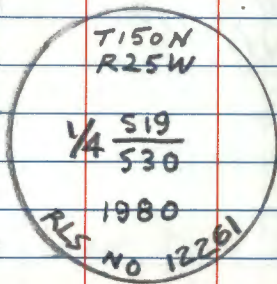

WITNESSED BY:

ASH	N7°E	82.50'	MKD: 1/4 519 BT
ELM	S12°W	62.65'	1/4 530 BT
SPRUCE	S74°E	78.78'	1/4 530 BT

11/5/80 William M. Olson

