

Corner  
Restoration

T149N

R25W

T149N R25W

Book 1

T149 N R25 W

5th P.M.

## INDEX

6	5	4	53	3	35	2	16	1			
			67	66	54	52	33	34	14	15	
7	8	66	9	50	10	32	11	13	12		
	86	64	65	48	49	38	38	11	12		
18	79	17	63	16	47	15	<sup>29</sup> 28	14	10	13	
78	76	77	61	62	46	<del>45</del>	27	25	26	8	9
				43							
19	75	20	60	21	42	22	24	23	7	24	
74	72	73	58	59	40	41	22	23	5	6	
30	71	29	57	28	39	27	20	26	4	25	
70		69	55	56	37	38	18	20	2	3	
31	32	54	33	36	34	17	35	1	36		

Colored numbers refer to page on which notes for that corner may be found

1

Quarter Corner Sec's 35-36  
Notes of original Gov't. Survey  
of 1875-6

Post

Maple 7" N27°E 14 1ks (9.24')

Maple 5" N76°W 16 1ks. (10.56')

T149N R25W

F.S.

State.

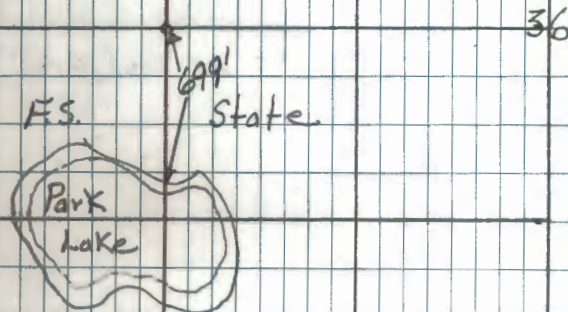

2

Section Corner 25-26-35-36

Notes of orig. Gov't Survey

Ironwood post

Ironwood 6" N20°W 13 1ks. (8.58')

Fir 6" S30°E 10 1ks. (6.6')

Fir 6" S30°W 16 1ks. (10.56')

Maple 8" NB°E 28 1ks. (18.48')

26

T149N R25W

25

FS

State

FS

State

35

36

3

Quarter Corner Secs. 25-36  
 Notes of orig. Govt. Survey  
 Post  
 White Birch 10" N71°E 8 1ks (5.28')

Fir 6" S21°E 10 1ks. (6.6')

T149N

R25W

25

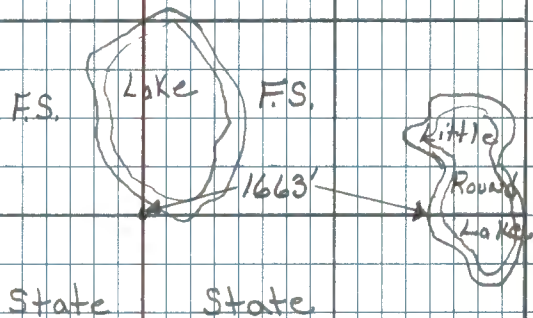

36

4

Quarter Corner Sec's. 25-26

Notes of Orig. Govt Survey

Post

White Birch 8" S66°W 51ks. (3.3')

Aspen 14" N27°E 151ks. (9.9')

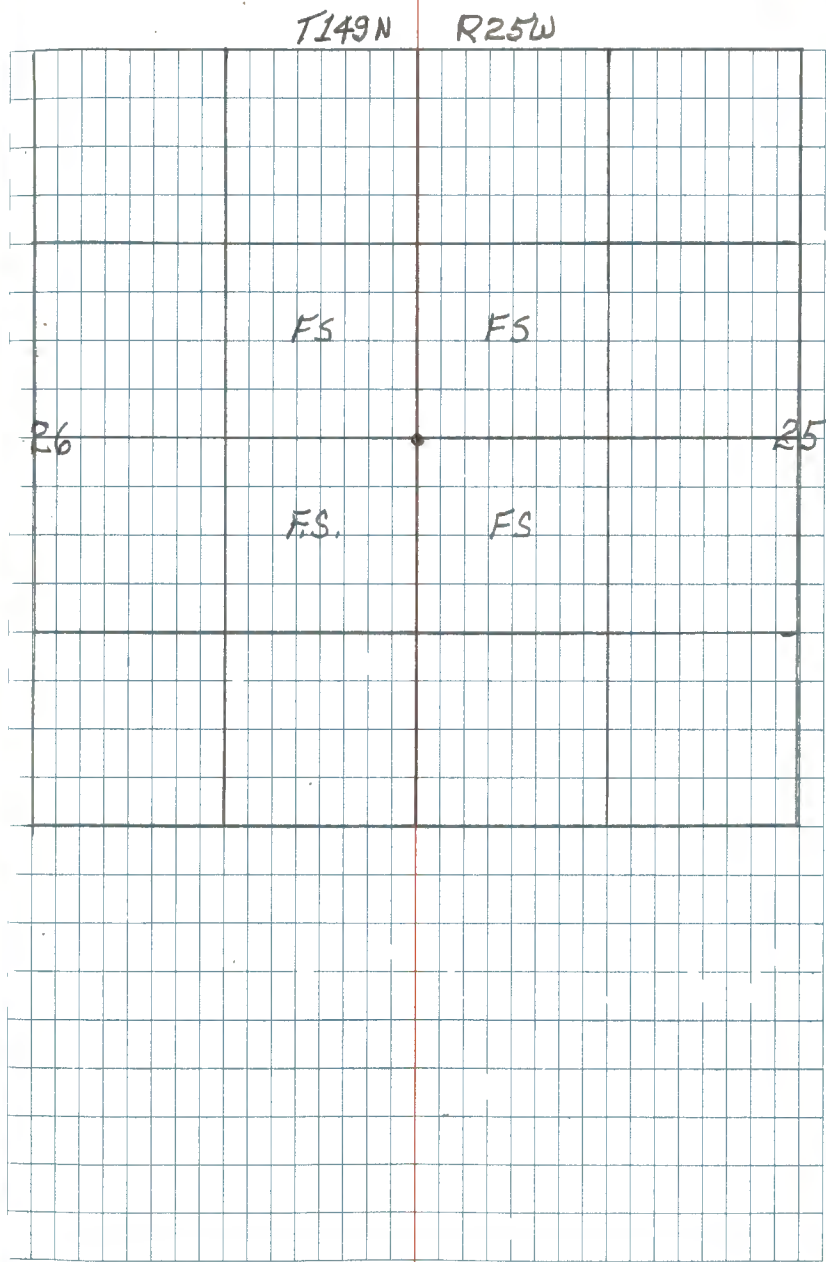

5

Section Corner 23-24-25-26

Notes of orig. Govt. Survey  
PostWhite Birch  $10^{\circ}$  N  $3^{\circ}$  W 61ks. (3.96')White Birch  $10^{\circ}$  N  $55^{\circ}$  E 261ks. (17.16')White Birch  $6^{\circ}$  S  $73^{\circ}$  E 321ks. (21.12')White Birch  $14^{\circ}$  S  $22^{\circ}$  W 301ks. (19.8')

T149N R25W

23

24

F.S.

State

Swamp

F.S.

F.S.

26

25

2 chains East to swamp (132')

6

Quarter Corner Sec's 24-25

Notes of orig. Gov't. Survey

Post

White Birch 6" N27°E 11 lks. (7.26')

White Birch 12" S6°W 8 lks. (5.28')

24

State

Other

Swamp

FS

FS.

25



Quarter Corner Sec's 23-24

Notes of orig. Govt. Survey

Post

White Birch 6" N85°W 2 1/2 ks. (132')

White Birch 6" S5°E 4 1/2 ks. (2.64')

8

N-2'

Section Corner 13-14-23-24

Notes of orig. Govt. Survey

Post

Fir 6" N43°E 7 kcs. (4.62')

White pine 7" S54°E 20 kcs. (13.2')

Tamarack 8" S86°W 22 kcs. (14.52')

Spruce 10" N21°W 30 kcs. (19.8')

Searched 4 man hours but no evidence of orig. corner was found. high water in search area hampered search, Beaver dam is flooding area. 4-23-69 ~~RAM~~

R9-7150-7  
RAM

T149N R25W

14

13

Other

FS

FS

FS

Pickereel  
Lake

23

24

Corner is <sup>(132')</sup> 2.0 chains South of creek" " <sup>(9.0')</sup> <sub>(594')</sub> " West of Lake

Quarter Corner Sects. 13-24

Notes of orig. Govt. Survey

Post

White Birch 10" N50°W 20 lks.

White Birch 14" S30°W 17 lks.

Found a cut out line E-W up to lake  
 approx. 130' North is a blue paint  
 line also E-W to lake. No evidence  
 of corner was found. KAM 4-24-69  
 3 man hours search time

T149N

R25W

13

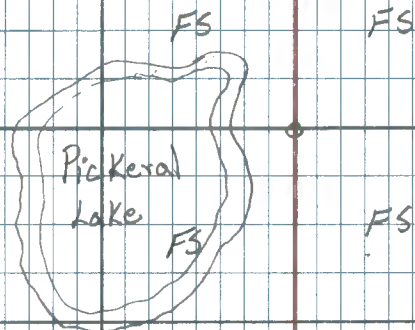

24

(367.6')

5.57 chains East of Pickeral lake

L-21

Quarter Corner Sec's. 13-14

Notes of orig. Gov't. Survey.

Post

White Birch 8" N72°E 13 lks. (8.58')

Spruce 8" N29°W 15 lks. (9.9')

No evidence of bearing trees was  
 found. 2 hours search time 4-24-69  
 FHM

R9-7150-4  
FHM

T149N R25W

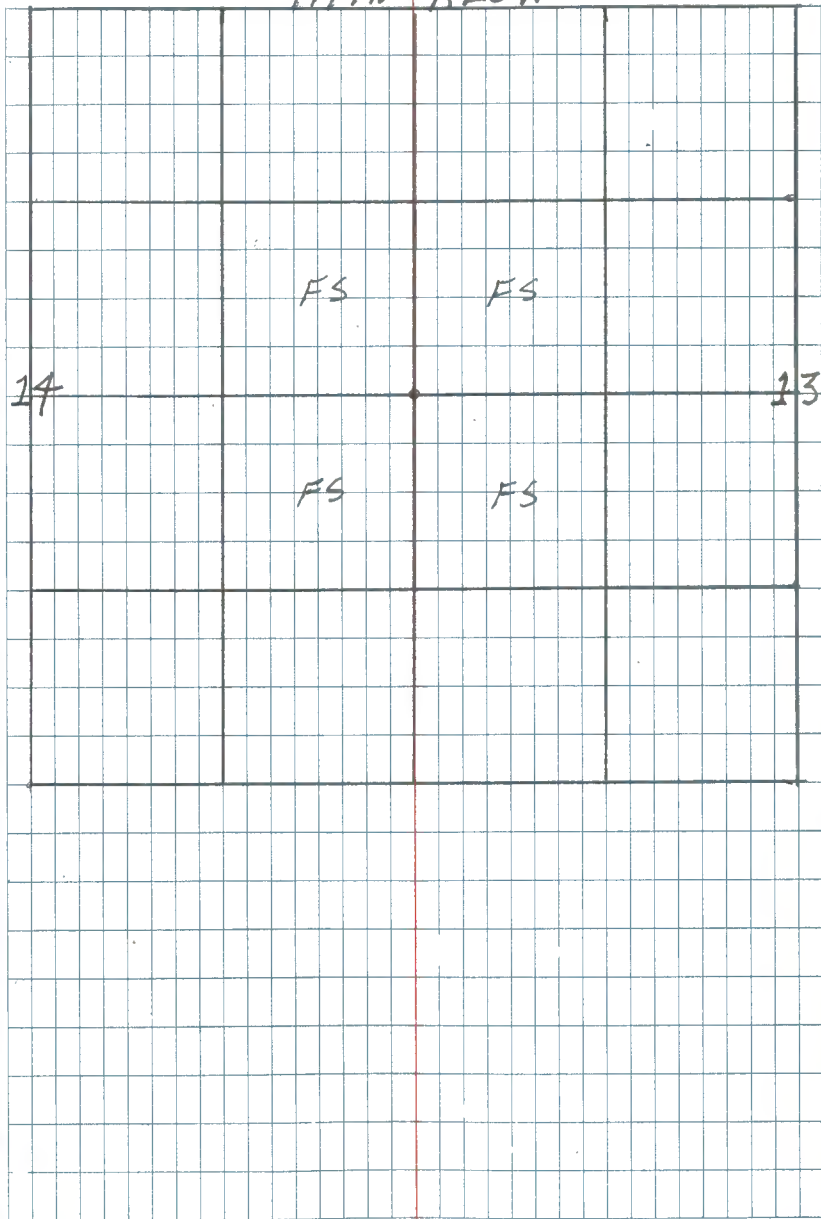

11

J-21

Section Corner 11-12-13-14

Notes of orig. Gov't. Survey  
Post

Tamarack 10" S49°E 3 lks. (1.98')

Tamarack 8" N55°E 26 lks. (17.16')

Cedar 12" S37°W 13 lks. (8.58')

Cedar 8" N43°W 10 lks. (6.6')

Found F.S. metal location post on a  
12" cedar. Placed in 1956 by Kaiser &  
Stewart - says approx. corner. We searched  
4 man hours but could find no evidence  
of original B.T.s. Numerous cedar stumps  
& windfalls are in this area. 4-24-69 ~~AM~~

R9. T160 ~~AM~~

T149N

R25W

11			12
		FS	Other
		Other	FS
14			13

Quarter Corner Sects. 12-13

Notes of orig. Govt. Survey

Post

Cedar 6" N39°E 8 lks. (5.28')

Cedar 8" S82°E 11 lks. (7.26')

T149N

R25W

12

other

other

FS

other

13

Quarter Corner Sect's 11-12

Notes of orig. Govt. Survey

Post

Tamarack 10" N50°W 40 lks. (26.4')

Spruce 6" S45°E 30 lks. (19.8')

T149N R26W

11

12

14

E. 21

## Section Corner 1-2-11-12

Notes of original Govt. Survey  
Post

Tamarack 8" N80°E 15 Iks. (9.9)

Tamarack 10" S35°W 15 Iks. (9.9)

Tamarack 8" N17°W 30 Iks. (19.8)

Tamarack 6" S60°E 20 Iks. (13.2)

2-27-2002 DAN DOMERER (REFER TO CORNER CERT)  
SET 2"X2" STEEL PIPE WITH ALUMINIUM CAP  
UP 0.4 FEET

CEDAR 12" N68°W 42.72' TO NAIL AND DISC

CEDAR 10" N10°W 17.75' TO NAIL AND DISC

CEDAR 7" N59°E 18.57' TO NAIL AND DISC

CEDAR 7" S3°E 46.85' TO NAIL AND DISC

SURVEY SIGN POST 1.3' NORTH

R9-7150-9  
RAM

T149N

R25W

2

1

FS

FS

FS

other

11

12

Ran line south from Hwy. Found FS location  
poster on 7" Cedar put up by Stewart's Kaiser  
in 1958. I could not find BTs 3 man  
hours search time 4-23-69 RAM



15

Quarter Corner Sec's 1 &amp; 2

Notes of orig. Gov't. Survey

# 6" Tamarack Tree for corner.

Tamarack 6" N40°W 30 lks. (19.8')

Tamarack 6" S35°E 25 lks. (16.5')

1-2 Notes of Itasca county road survey  
Gov't. BT S25°E 23.1'

Balm-of-Gilead 12" N28°E 182.3'

Spruce 7" N27°W 59.4'

T149N

R25W

12

## Quarter Corner Sections 1-2

Notes of original Govt. Survey.

Post

Spruce 6" N80°E 30 1ks (19.8')

Spruce 6" S30°W 35 1ks (23.1')

R2-04-2001 PAN DOMBIER (REFERT O CORNER LET) 2

SET 3/4 IRON PIN WITH ALUMINUM CAP  
DOWN 0.35 FT. 1

ASPEN 5" N6°W 84.90' TO NAIL AND DISC

SPRUCE 6" S6°E 56.36' TO NAIL AND DISC

ASPEN 8" S19°W 61.45' TO NAIL AND DISC

SPRUCE 6" S32°W 55.58' TO NAIL AND DISC

T149N

R25W

Quarter Corner Sections 34-35

Notes of original Govt. Survey

Post

Fir 6" N 37° E 3 lks. (1.98')

Aspen 18" S 22° W 15 lks. (9.9')

T149N

R25W

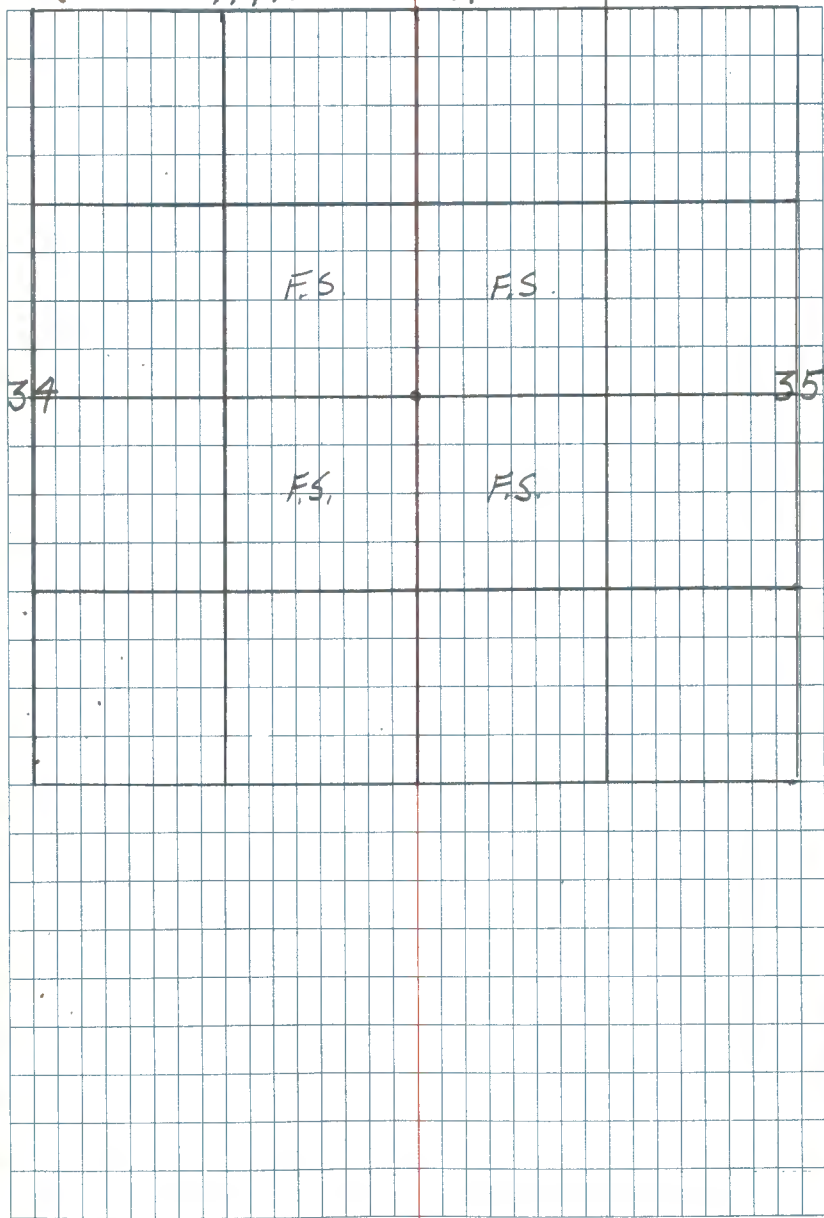

18

V, W-17

W.C. For Section corner of 26-27-34-35

Notes of original Govt. Survey.

At 8.60 chains South of <sup>sec.</sup> CORNER

set W.C. Post

Aspen 10" N36°E 51 lks. (33.66')

Aspens 6" N63°W 32 lks. (21.12')

Searched 2 man hours - no evidence  
of corner was found. Search area located  
by photo s' type map 4-29-69 RHM

R9-7150-9

27

T149N

R25W

26

34

35

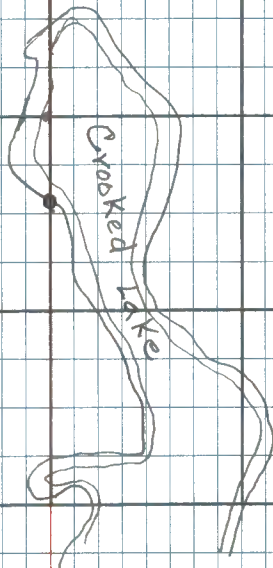

Quarter Corner Sec's. 26-35  
Notes of original Gov't. Survey  
Post

Maple 5" N77°E 16 kts. (10.56)

Linden 4" S25°E 15 kts. (9.9')

NOTE: THERE  
IS NO PAGE 19

T149N

R25W

26

F.S.

F.S.

F.S.

F.S.

35

21

Quarter Corner Sections 26-27

Notes of original Govt. Survey

Post

Maple 6" S85°E 6 lks. (3.96')

Cedar 6" S58°W 12 lks. (7.92')

T149N R26W

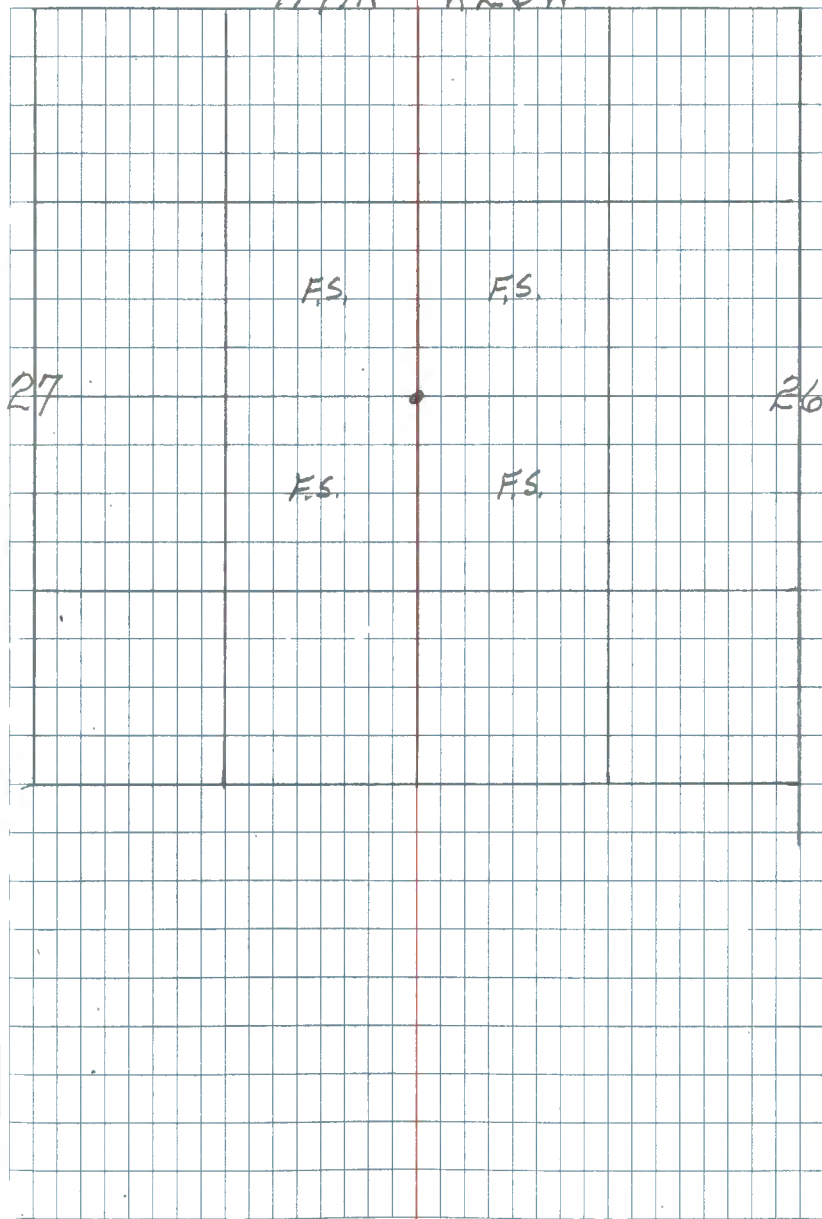

Section Corner 22-23-26-27

Notes of original Govt. Survey  
PostCedar 10" S44°W 8 lks. (5.28') (Now a  
10" cedar stump S46°W 5.28')

Spruce 7" S14°E 14 lks. (9.24')

Fir 6" N52°E 16 lks. (10.56')

Tamarack 14" N49°W 35 lks. (23.1') (Now  
a Tam stump 16" w/ part of scribe "BT"  
visible at record bearing & dist.Dec. 13, 1967 *RHM Donald*Set a 2" inside dia. 5 foot long galvanized  
steel pipe filled with concrete and  
capped with a 3" dia. bronze tablet stamped

T144NR25W

S22 S 23

S27 S 26

RLS 1967  
NO 6807

Ash 10" North 23.4' MKD S22 BT

Balm-of-Gilead 16" N61°E 68.1' MKD S23 BT

Birch 5" S78°E 66.3' MKD S26 BT

Steel sign post 72" long with F.S. standard

Sign 54 4 attached set S42½°W 10.0'

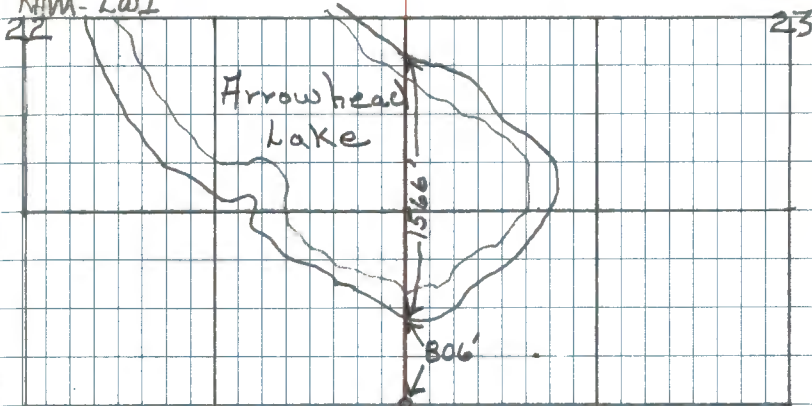
Dec. 13, 1967 *RHM Donald*Dec. 13, 1967  
Pty Cloudy 20°  
RHM-LWIR-9-7450-4  
*RHM*

27

26

Corner is (959')  
11.5 chains South of Arrowhead  
Lake. chained dist. is 806'*Sketch  
10/15/70*

23

R-19

Quarter Corner Sec'ts. 23-26  
Notes of original Gov't. Survey  
Post

Aspen  $20^{\circ} N 6^{\circ} E$  24 lks. (15.84')

White pine  $6^{\circ} S 20^{\circ} E$  24 lks. (15.84')

Searched 2 man hours no corner  
evidence was found ~~PHM~~

R9-7150-4

~~PHM~~

T149N

23

R25W

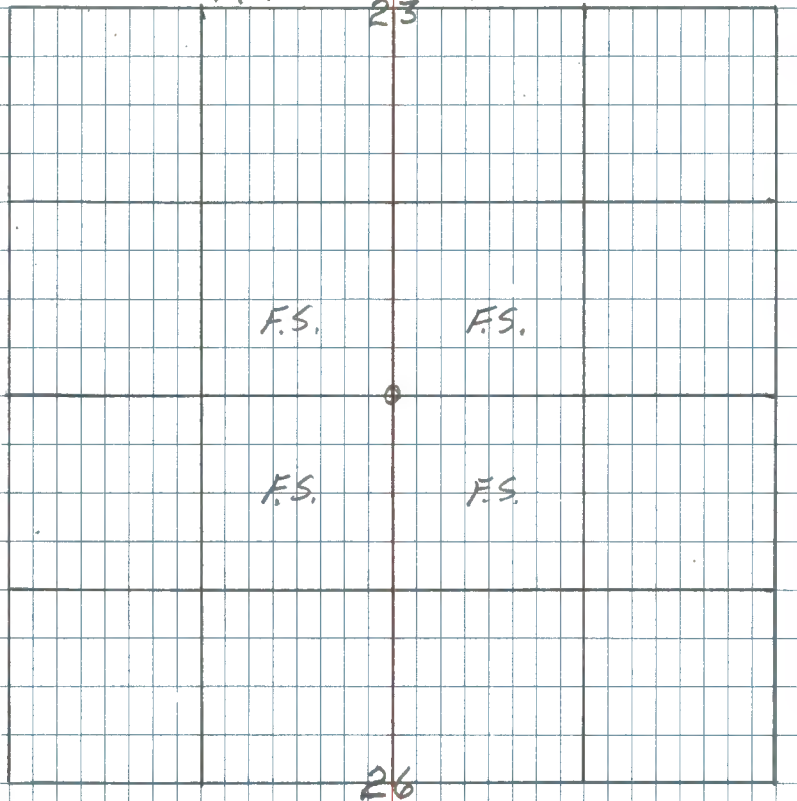



Quarter Corner Sects 22-23

Notes of orig. Govt. Survey

Post

Linden 12" East 15 Iks (9.9')

White Birch 8" N85°W 10 Iks. (6.6')

(Found birch stump 6.6' West of line  
at 236' North of Lake shore. I  
ran line from Sec. Cor on North &  
intersected Sec. Cor. on South)

12/13/67 RHM

Found a F.S. location poster on a  
10" Aspen approx 45' West of cor.  
poster states Approx 1/4 cor. date 1954.

RHM

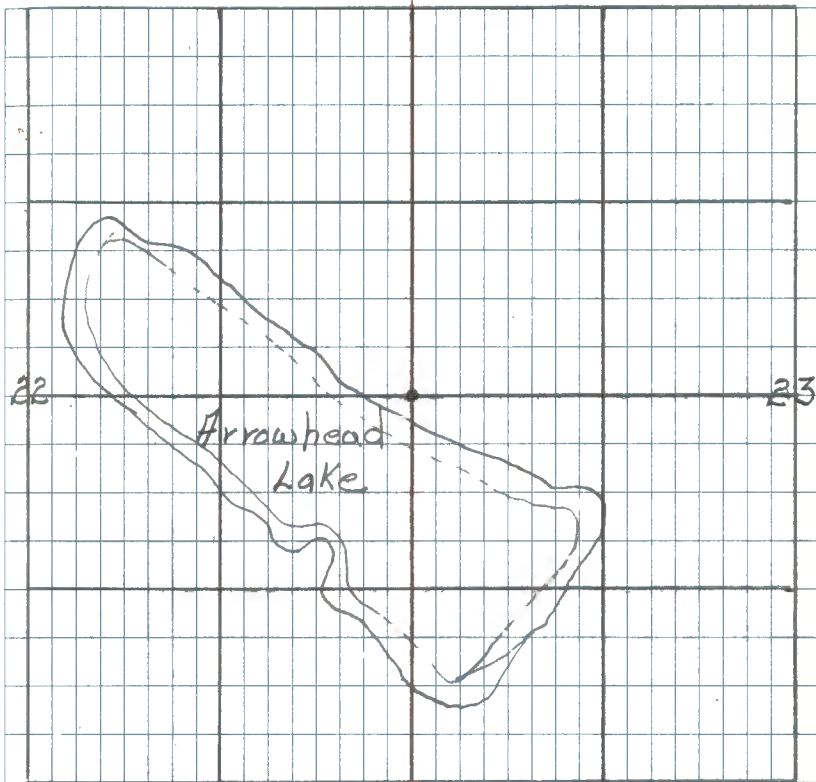

5.58 chains north of lake (236.28')

25

Affidavit RHM

N-17

Section Corner of 14-15-22-23

Notes of orig. Govt. Survey  
Post

Maple 8" N25°W 6 lks. (3.96)

Maple 10" S42°E 30 lks. (19.8')

Maple 6" N43°E 3 lks. (19.8') (Now a  
16" Maple scribe "BT" visible.)

Aspen 20" S46°W 21 lks. (13.868')

Set a 2" inside dia, 5 foot long galvanized  
steel pipe filled with concrete and  
capped with a 3 inch dia. bronze  
tablet stamped:

T149N R25W

S15 S14

S22 S23

RLS <sup>1967</sup> NO 6807

Ash 5" S10°E 58.6 Ft. MKD S28 BT

Maple 10" S65°W 62.5 Ft. MKD S22 BT

Birch 5" N37°W 53.0 Ft. MKD S15-BT

Steel sign post 72" long w/ FS standard sign  
54-9 attached set S77°E 7.0 Ft.

12/13/67 RHM Donald

R9-7150-4

T149N

R25W

15

14

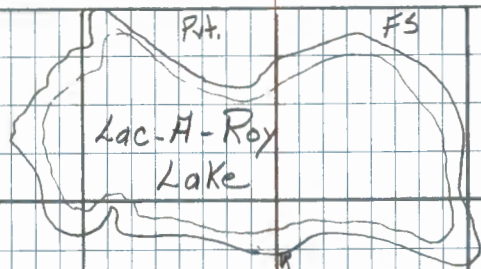

FS.

FS.

808.5

Approx. 500'

FS.

FS.

Woods Road

FR 2187

22

23

Found old FS metal location post on  
a 10" Basswood from which corner bears  
N45°E 11.5 Ft.

See page 3, Book #3

26

N-19

Quarter Corner Sects. 14-23

Notes of orig. Govt. Survey

Post

White birch 8" S24°W 9 lks. (5.94')

Cedar 6" N53°W 11 lks. (7.26')

Searched 3 man hours, no corner  
evidence was found Dec 1967 ~~1971~~

R9-7150-4

T149N R25W

14

23

27

M.N-17

M.C. Sections 14-15 South Shore Lac-H-Roy

Notes of orig. Govt. Survey

MC #3

Post

Aspen 6" S 14° W 12 kcs. (7.92')

Ash 6" S 37° E 32 kcs. (21.12')

Searched 2 man hours, NO evidence found.

12/13/67 RHM

See page #5 of Book 3

R9-7150-f

T149N

R25W

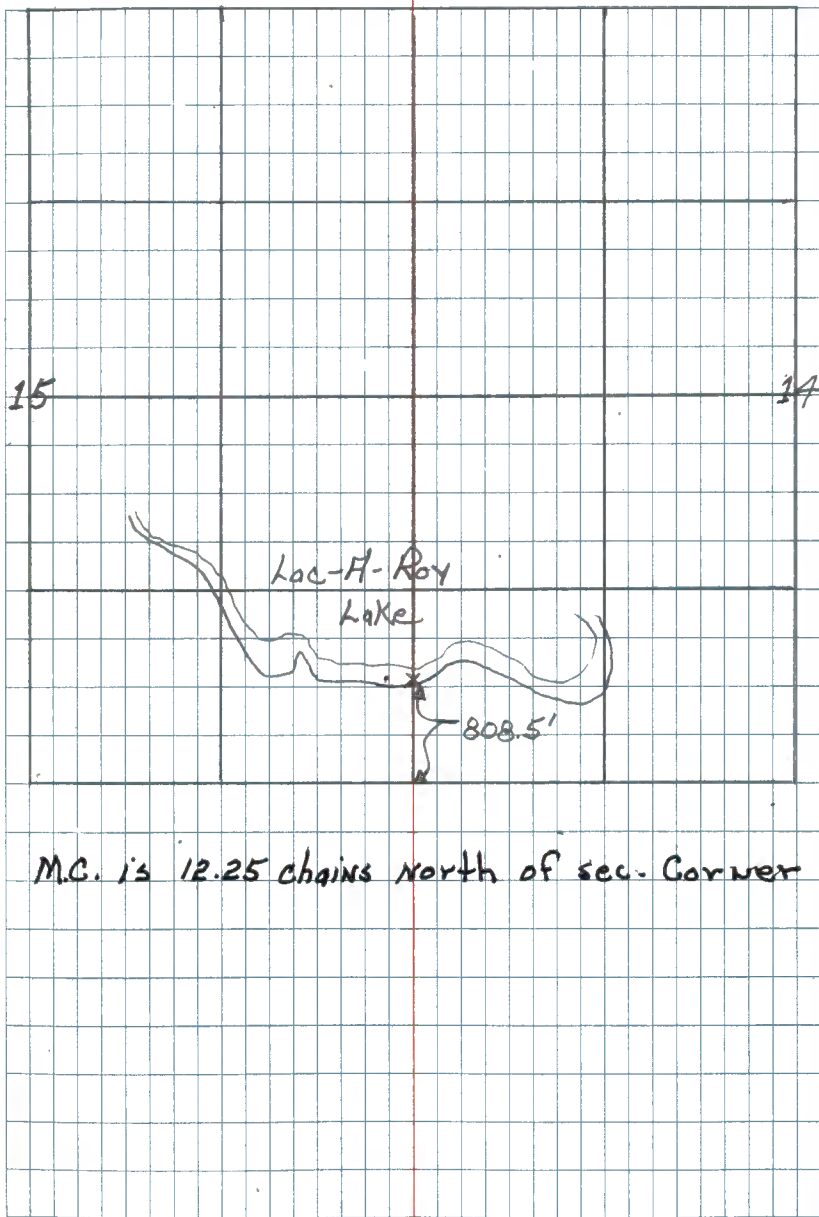

M.C. is 12.25 chains north of sec. Corner

28

L, M-17

M.C. Sections 14 &amp; 15 North Shore Lac-H-Roy

MC #4 Notes of original Govt. survey 5-3-77

Post Fd. top of old post imbedded in sand

Norway Pine 24" N13°E 56 lks. (36.96')

No evidence found 5-3-77

Norway Pine 8" N23°W 28 lks. (18.48') 5-3-77

Fd. large Pine stp. at bry. dist. with scribe BT visible

Searched 2 man hours no evidence found

12/14/67 RHM

Aug 17, 1982 Ken Whitehorn, RLS &amp; GLENN KOSENKO, USFS,

searched 2 man hours at record distance

from P. Pine stump scribed "BT" (see pictures)

no post point found. Set 3/4" x 3ft alum

rod with 3in magnetized Alum cap stamped.

T149N, R25W.

S. 23°E 18.48f from

M.C.

old pine stump

5/15/84

filed stone around Mon

1982

Mon flush w/ ground C. -ft underwater RLS. 14677

3 ft into Lac-H-Roy Lake, Referenced by

W. Birch C. 8 in N 71 1/2° W 34.80

to 16 d nail

W. Birch 8.5 in N 43 1/2° W 24.70ft

to N face

W. Birch 6.2 in N 13° E 45.60ft

to 16 d nail

Sign Post

5/15/84

Ken Whitehorn

R9-7150-4

T149N

R25W

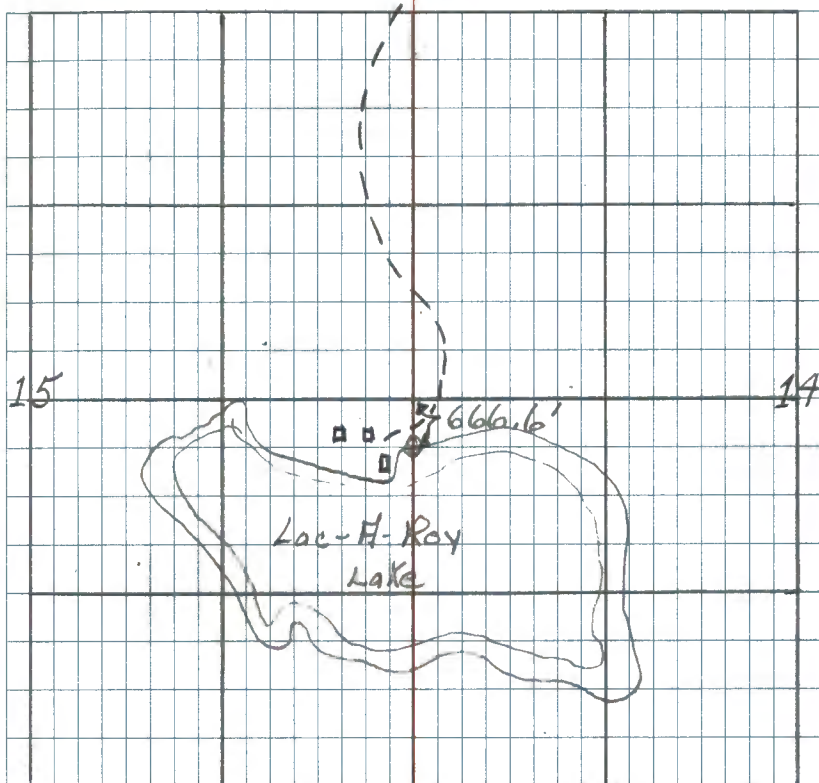

M.C. is 10.1 chains South of 1/4 corner

Fd. pine stump (large) with scribe BT on ridge

above lake - next to old root seller in bank

Put drift wood 2" x 4" x 5' long in place of stake

pile rocks around 2x4 at edge of lake

approx. 350' south of woods road to summer

home on lake

Believe size on original BT's may be switched in notes

as we found large pine NW

5-3-77 CRK-RO

29

Quarter Corner Sections 14-15

Notes of original Gov't. Survey  
Post

Linden 6" S32°W 13 kcs. (8.58)

Aspen 6" S81°E 70 kcs. (46.2')

T149N

R25W

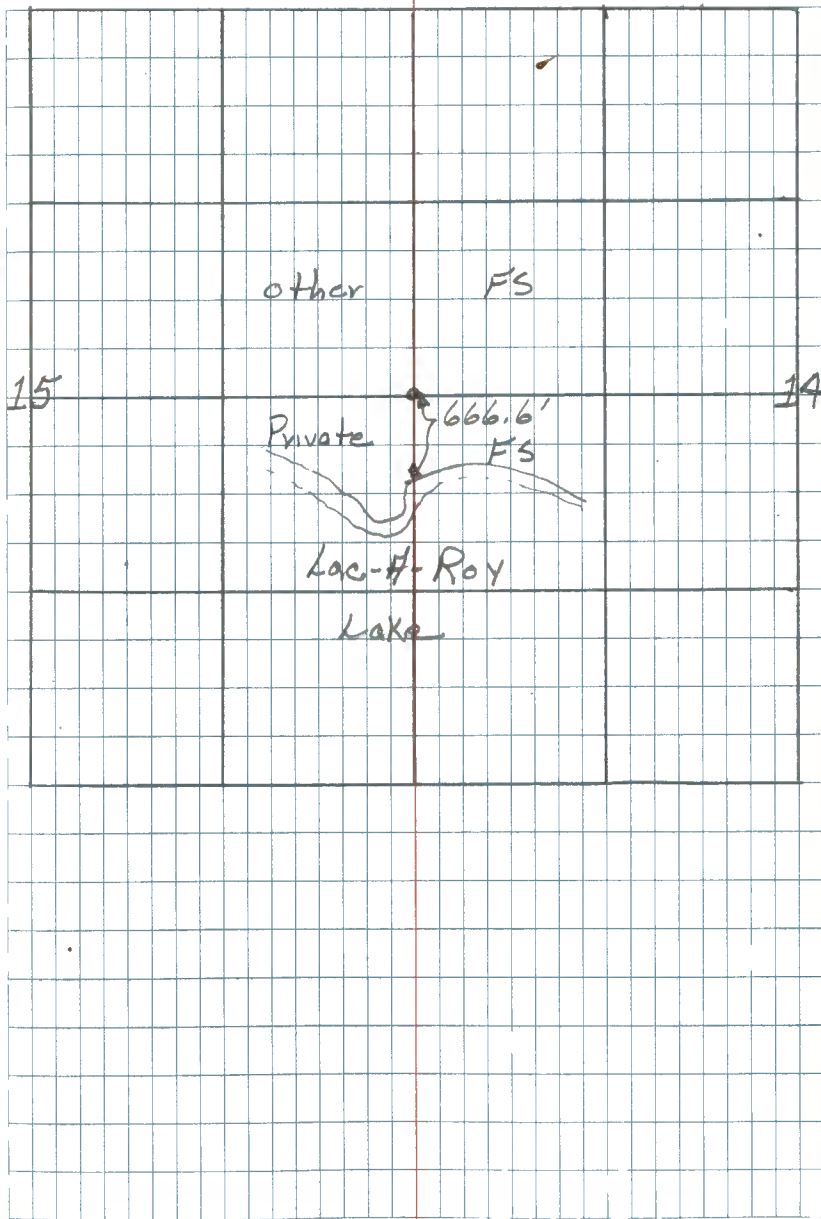

Quarter Corner Sect's. 11-14  
Notes of original Gov't. Survey  
Post

Spruce 4" N69°W 15 lks.

Elm 6" South 12 lks.

T149N R25W

11

14

31

Section Corner of 10-11-14-15

Notes of orig. Gov't. Survey

Post

Ash 6" N21°E 64 lks. (42.2')

Ash 7" S60°E 45 lks. (29.7')

Spruce 7" S14°W 20 lks. (13.2')

Spruce 7" N55°W 30 lks. (19.8')

6-12-96 R. MAEN C. KRAUSE

Fd NO EVIDENCE OF CORNER AT THIS TIME.

Logging has taken place recently east of  
FR 2183. Area has seen disturbance.

T149N R25W

10

11

15

17



32

Quarter Corner Sect's. 10-11  
 G-17

Notes of orig. Govt. Survey

Post

Elm 6" N64°W 30 lks. (19.8')

White Pine 4" S85°E 25 lks. (16.5')

Searched 2 man hours no corner evidence  
 was found. search area near "T" in road

Dec. 1967 ~~GA~~

6-12-96 R MAIN KRAUSE

Fd NO EVIDENCE AT THE TIME. THERE  
 ARE LARGE W. PINE IN THIS AREA. IF THE  
 CORNER FALLS IN THE ROAD THE ROAD WOULD  
 HAVE OBLITERATED BY EVIDENCE.

R9-7150-4

T149N R25W

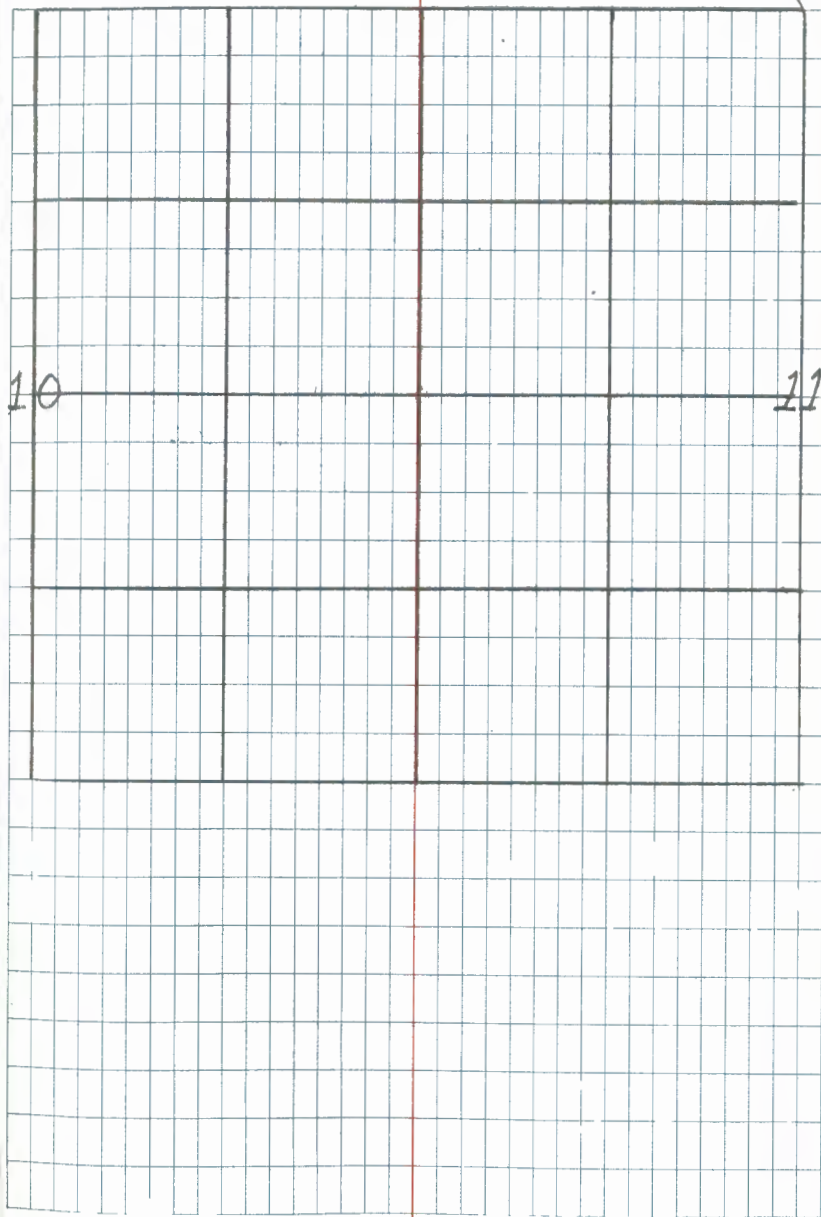

Section CORNER 2-3-10-11

Notes of original Govt. Survey  
Post

White pine 15" N40°W 1001ks (66.0')

Aspen 5" S60°E 401ks (26.4')

6-12-96 R. MAEN C. KRAUSE

No EVIDENCE FOUND. SEARCHED

AREA @ 90° BEND OF FR 2183, ORIG  
DIST WAS 5200.8 FROM NE of 3 to SE of 3.My GPS DISTANCE FROM NE of 3 (MONUMENT) TO  
SE of 3 PROJECTED INTERSECTION OF EAST & SOUTH  
FR 2183 IS 5280.84 FT.

T149N R25W

3

2

10

11

34

E-19

Quarter Corner Sections 2-11  
Notes of original Gov't Survey  
Post

Spruce  $4^{\circ} S 70^{\circ} W$  50 lks (33.0')

Tamarack  $15^{\circ} N 84^{\circ} E$  200 (132.0')

Searched 3 man hours for this corner  
at "T" in road no evidence of corner  
was found. RHM Dec. 1967

6-12-96 R MAIN CRAUSE

NO EVIDENCE OF CORNER FOUND. SEARCHED  
90° bend of FR 2183. AREA HAS BEEN  
CUT OVER IN EVERY DIRECTION.

R9-7150-4

T149N

R25W

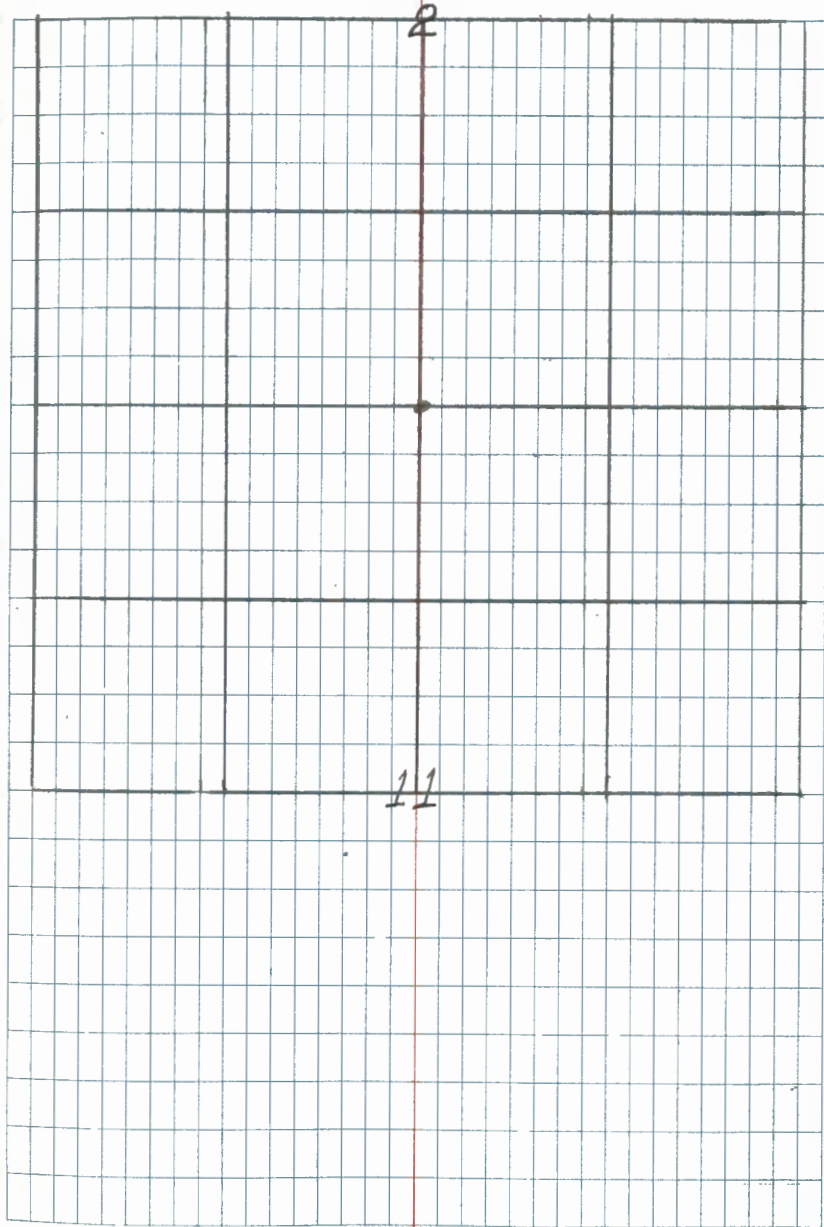

## Quarter Corner Sections 2-3

Notes of original Govt. Survey

~~Post~~ Tamarack Tree 6" is corner.

Tamarack 8" S45°W 85 lks. (56.1')

Tamarack 8" S10°E 120 lks. (79.2')

T149N

R25W

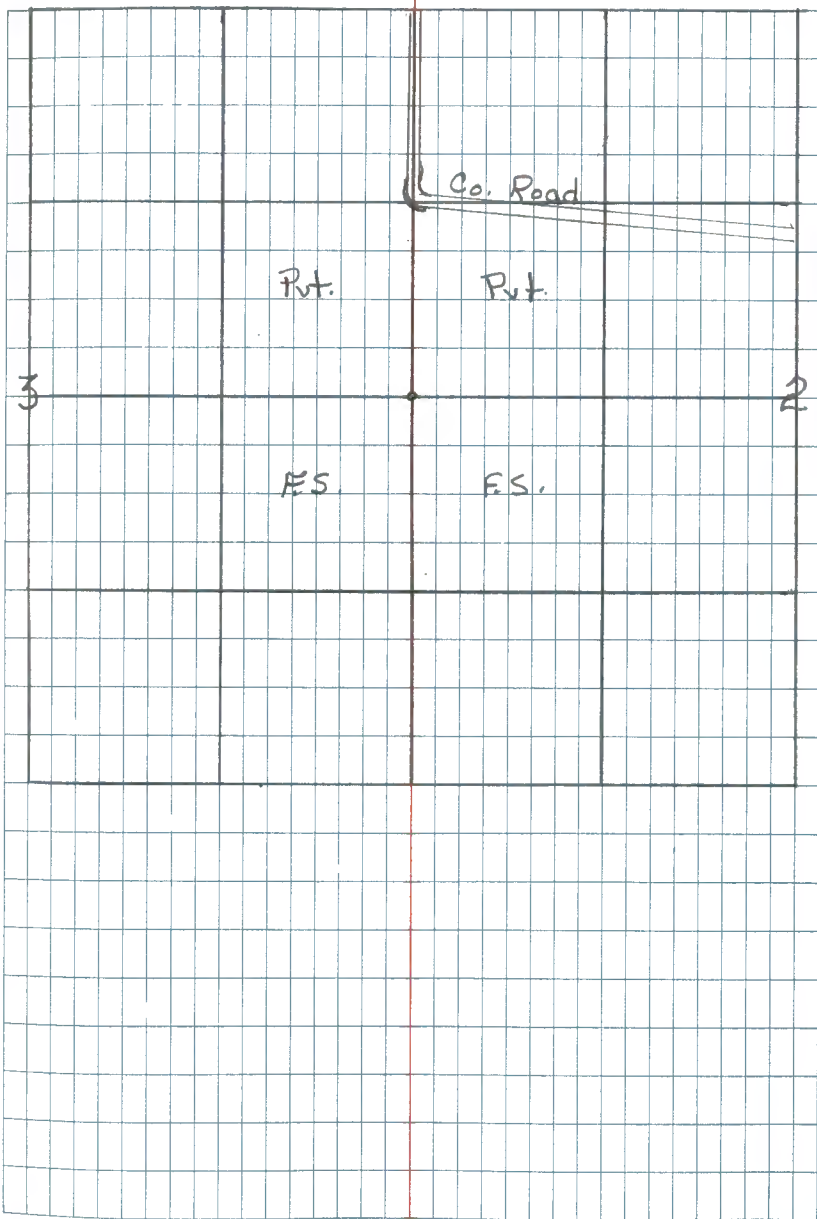

36

X-13

Quarter Corner Sect's 33-34

Notes of orig. Gov't. Survey

Post

White pine  $8^{\circ} S 43^{\circ} W$  9 lxs. (5.94')White pine  $6^{\circ} S 47^{\circ} E$  3 lxs. (1.98')

Searched 2 man hours for this corner  
after chaining North from Std. Cor.  
of 33-34 2640 Ft. many burned  
pine stumps in area. found a plantation  
post nearby. 11/28/67 RHM.

R9-715B-4

T149N

R25W

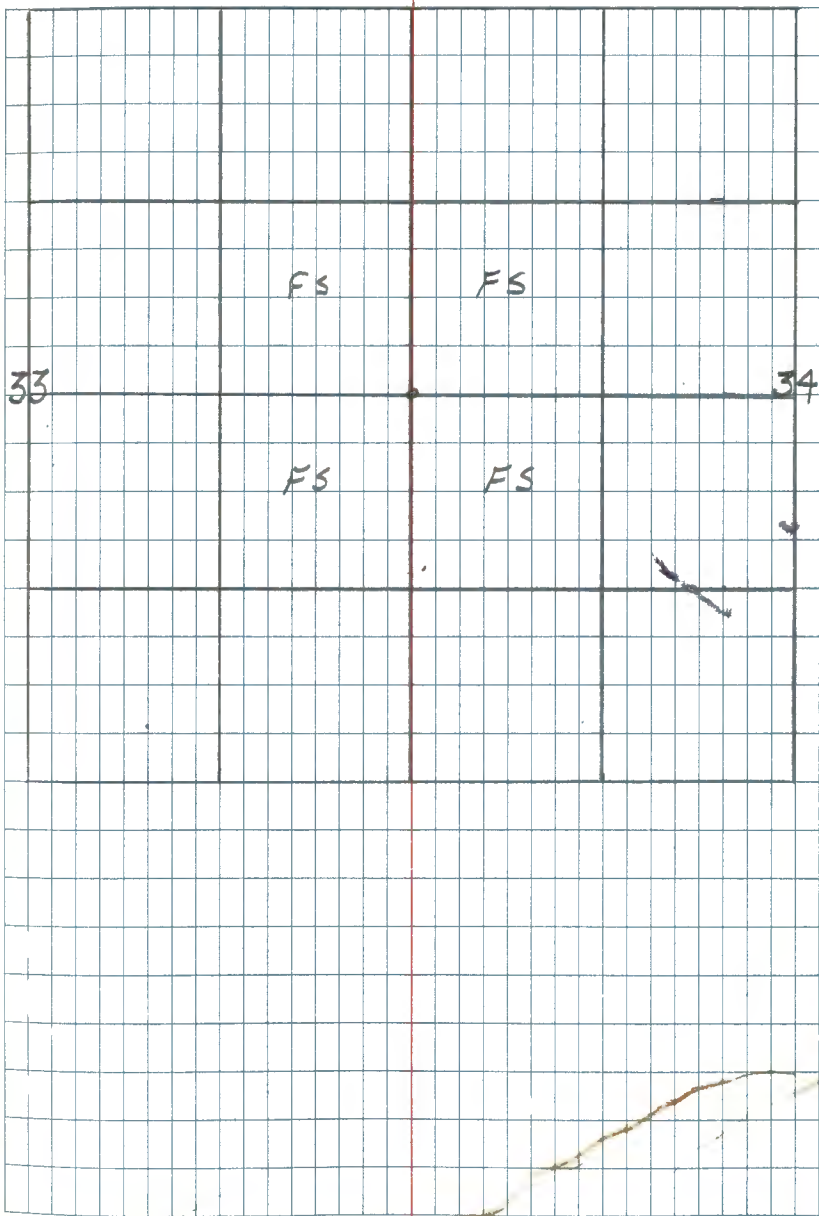

37

V-13

Section Corner 27-28-33-34

Notes of original Gov't. Survey

Post

Maple 8" S21°W 16 lks. (10.56')

Linden 7" N40°W 15 lks. (9.9')

Aspen 14" S52°E 5 lks. (3.3')

Fir 8" N36°E 56 lks. (36.96')

I chained in from West & searched 2 man hours. No evidence of orig. cov. was found. I placed F.S. metal location post on 8" black ash for corner. It falls on north edge of a small ash slough.

5/22/69 B.F.H. McDonald

R9-7150-4

T149N R25W

28

27

33

34

Quarter Corner Sections 27-34  
Notes of original Gov't. Survey  
of 1875

Post

Spruce 7" N45°E 27 lks. (17.82')

Spruce 6" S24°W 60 lks. (39.6')

T149N R25W

27

34

Quarter Corner Sections 27-28

Notes of orig. Govt. Survey

Post

Cedar 10" S80°W 6 lks. (3.96')

White Birch 10" N29°E 27 lks (17.82')

I chained south from Sec. corner of 21-22-27-28  
at 2640' came on east edge of brush slough  
many cedar stumps all badly burned searched  
2 man hours no evidence found 12/7/67 RHM

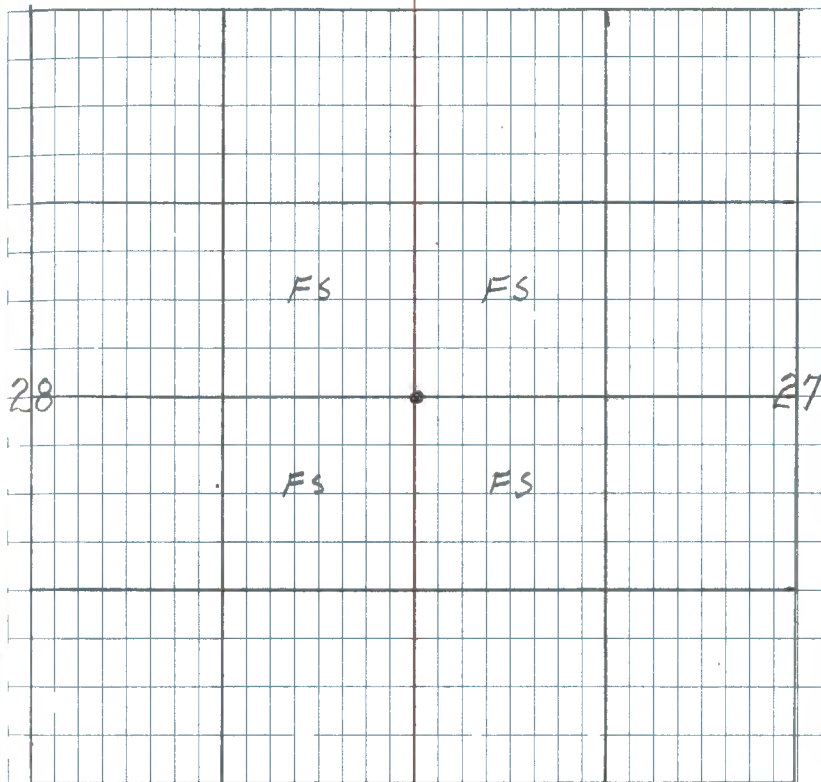





41

Quarter Corner Sect's. 22-27

Notes of orig. Gov't Survey

Post

Cedar 10" S40°E 27 1ks. (15.84')

Spruce 12" N43°E 36 1ks. (23.76')

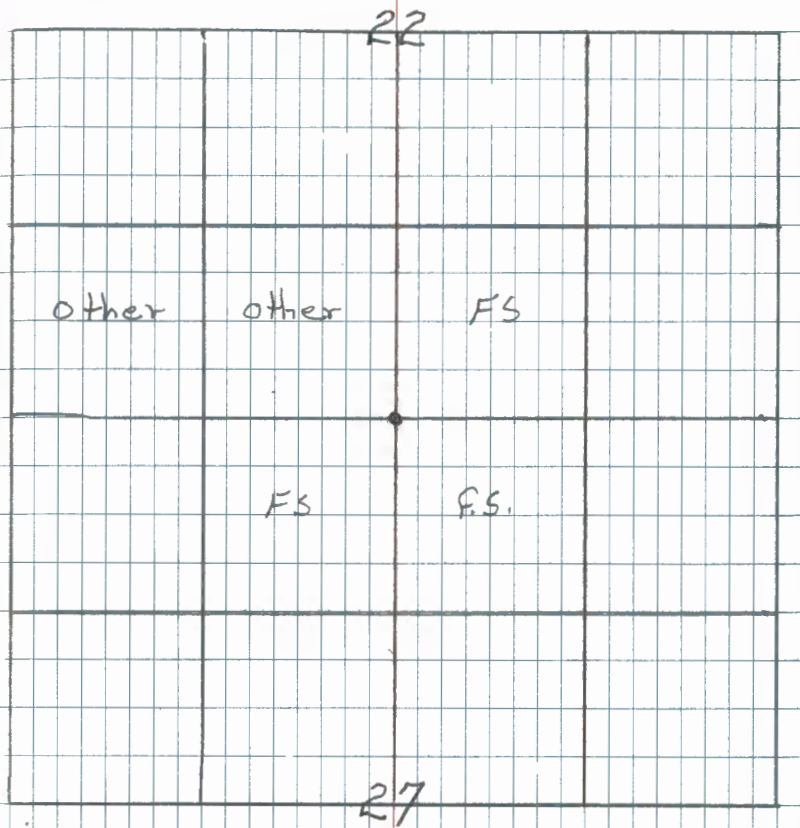

Quarter Corner Sec's 21-22

Notes of Orig. Govt. Survey

Post

Cedar  $14^{\circ}$  N  $46^{\circ}$  E 16 lks. (10.56')

Cedar  $8^{\circ}$  N  $50^{\circ}$  W 13 lks. (8.58')

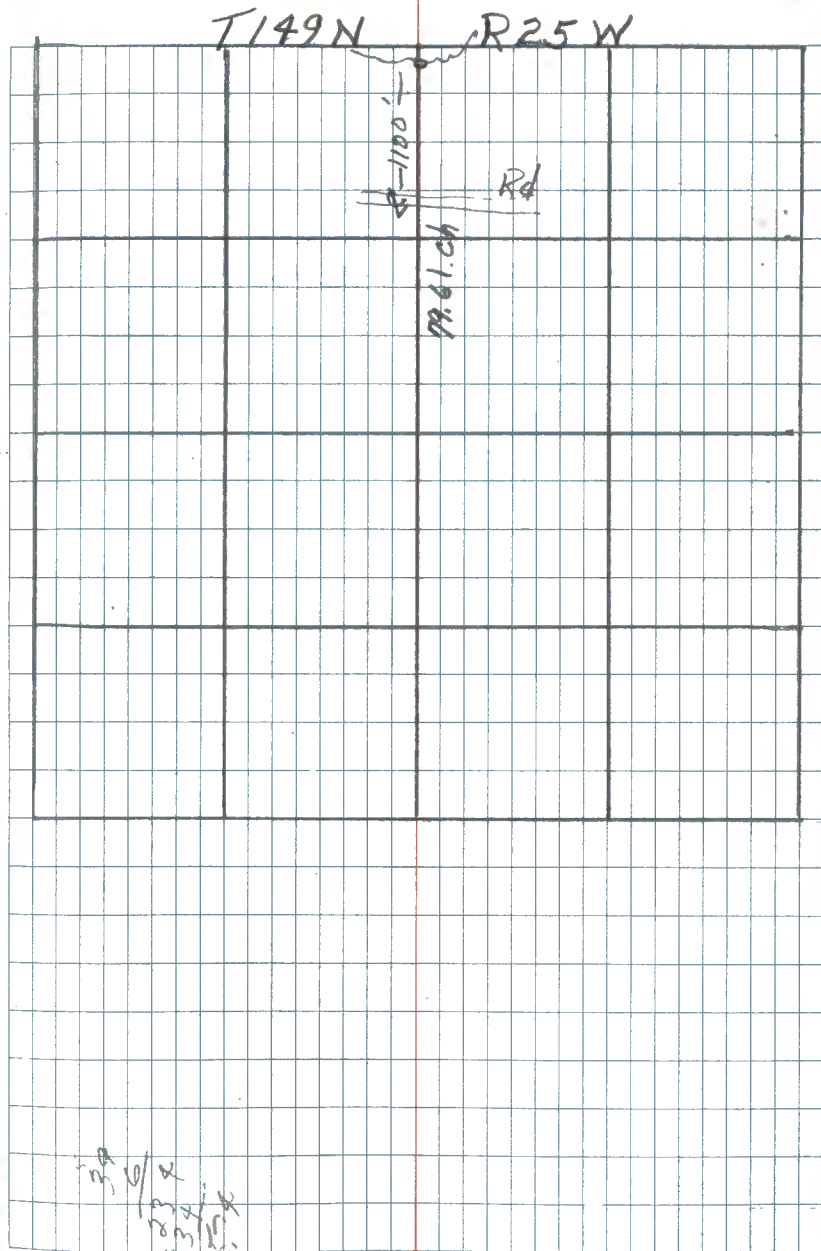

43

M.C. Between Sects 21-22

Notes of orig. Govt. Survey

Post

Balm-of-Gilead  $7^{\circ}S 46^{\circ}E$  18 lks. (11.88')

Fir  $8^{\circ}S 34^{\circ}W$  23 lks. (15.18')

T149N

R25W

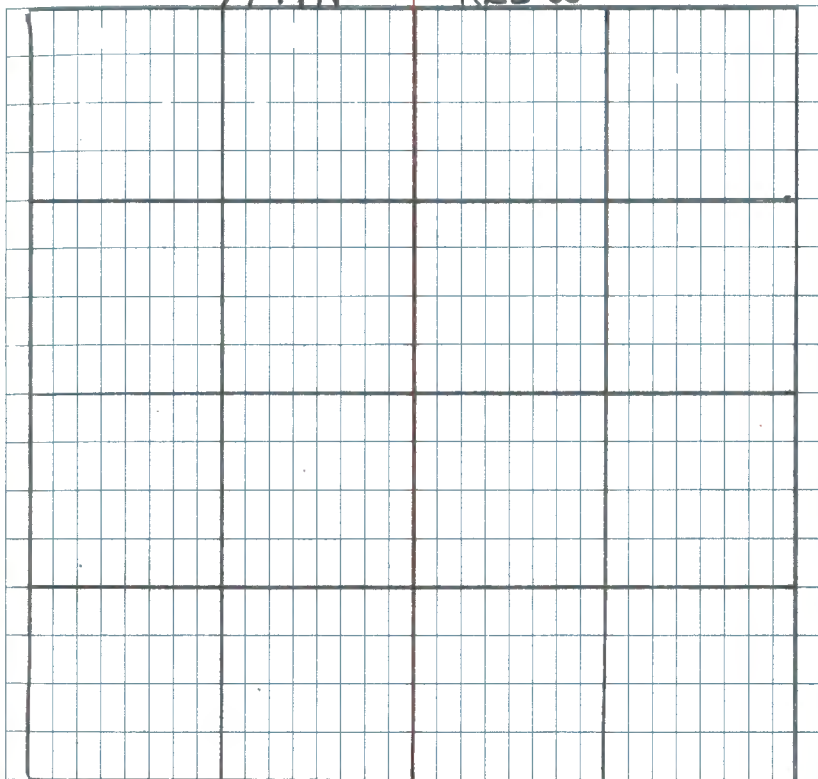

44

Quarter Corner Sections 15-22  
Notes of original Govt. Survey  
Post

Fir 10" North 61ks. (3.96)

White Birch 16" S 6°W 51ks. (3.30')

T149N R25W

15

22

45

MC East shore Trestle Lake Sects 15-22

Notes of orig. Govt. Survey

Post

Tamarack 10" N75°E 55 1ks. (36.3')

Tamarack 6" S67°E 52 1ks. (34.32')

T149N R25W

15

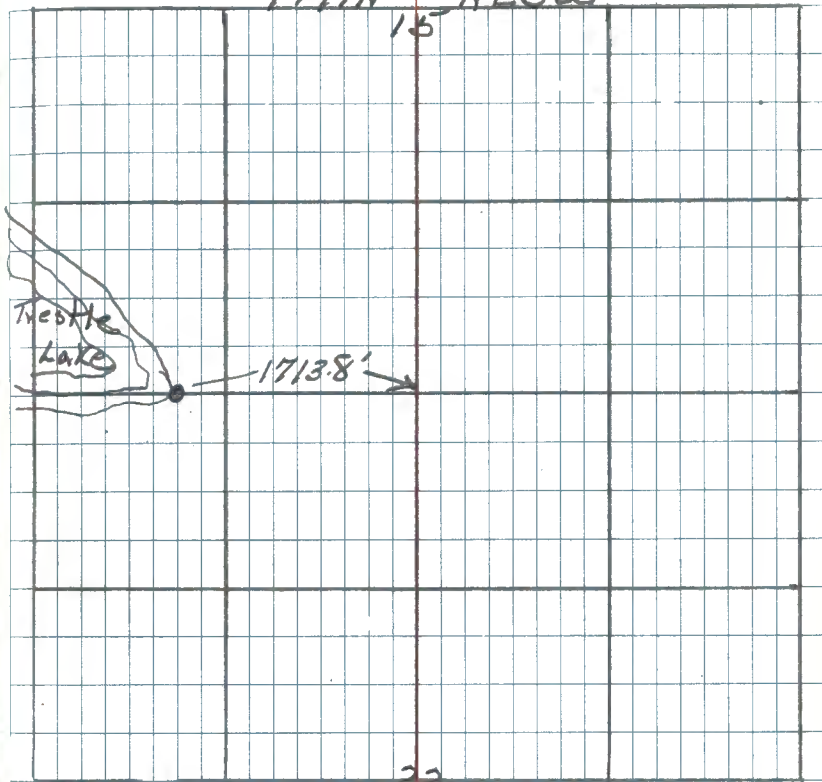

3  
4  
5  
6  
7  
8  
9  
10  
11  
12  
13  
14  
15  
16  
17  
18  
19  
20  
21  
22  
23  
24  
25  
26  
27  
28  
29  
30  
31  
32  
33  
34  
35  
36  
37  
38  
39  
40  
41  
42  
43  
44  
45  
46  
47  
48  
49  
50  
51  
52  
53  
54  
55  
56  
57  
58  
59  
60  
61  
62  
63  
64  
65  
66  
67  
68  
69  
70  
71  
72  
73  
74  
75  
76  
77  
78  
79  
80  
81  
82  
83  
84  
85  
86  
87  
88  
89  
90  
91  
92  
93  
94  
95  
96  
97  
98  
99  
100

46

L<sub>1</sub> M-13

M.C. between 15-16 North Shore Trestle Lake

Notes of orig. Govt. Survey  
PostTamarack 6" N 66° E 8 lks. (5.28') now  
in lakeNorway Pine 10" N 2° W 38 lks. (25.08')  
(Now a 14" Norway pine stump scribed  
"BT")point for corner Falls approx. 10'  
in LakeSet a 2" dia. 5 foot long galvanized  
steel pipe filled with concrete and  
capped with a 3 inch dia. bronze tablet  
stamped:NoteWitness Corner is  
Set 30 feet North of  
point for M.C.

Dec. 7°

T149N R25W

S16 S15

WC MC

1968

RLS NO 6807

Oak 11" N 15° W 66.5 ft MKD WC MCS 16 BT

Birch 9" S 88½° E 13.3 ft MKD WC MCS 15 BT

Steel sign post with FS. standard signs

54-2 &amp; 54-4 attached set North 5.0 ft.

May 16, 1968 R.H.M. Donald

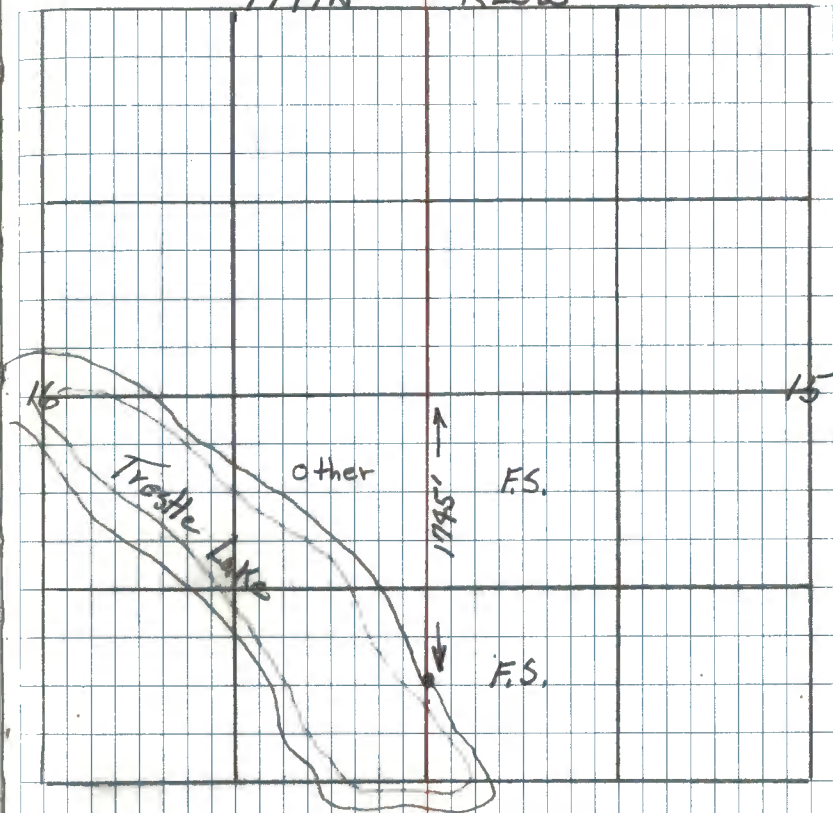
Affidavit L, M-13 R9-7150-<sup>2</sup>  
RHM T149N R25W RHM

26.00
17.95
8.95

*[Handwritten signature]*

47

Quarter Corner Sects. 15-16

Notes of orig. Govt. Survey

Post

Spruce 6" N44°E 20 lks. (13.2')

Spruce 7" S26°W 35 lks. (23.1')

Chained to this location from Sec. cor. to  
north searched in very brushy spruce swp.  
no evidence of orig. post or B's. could be  
found.

Ron Oleson Gert Krause

8-22-75

T149N

R25W

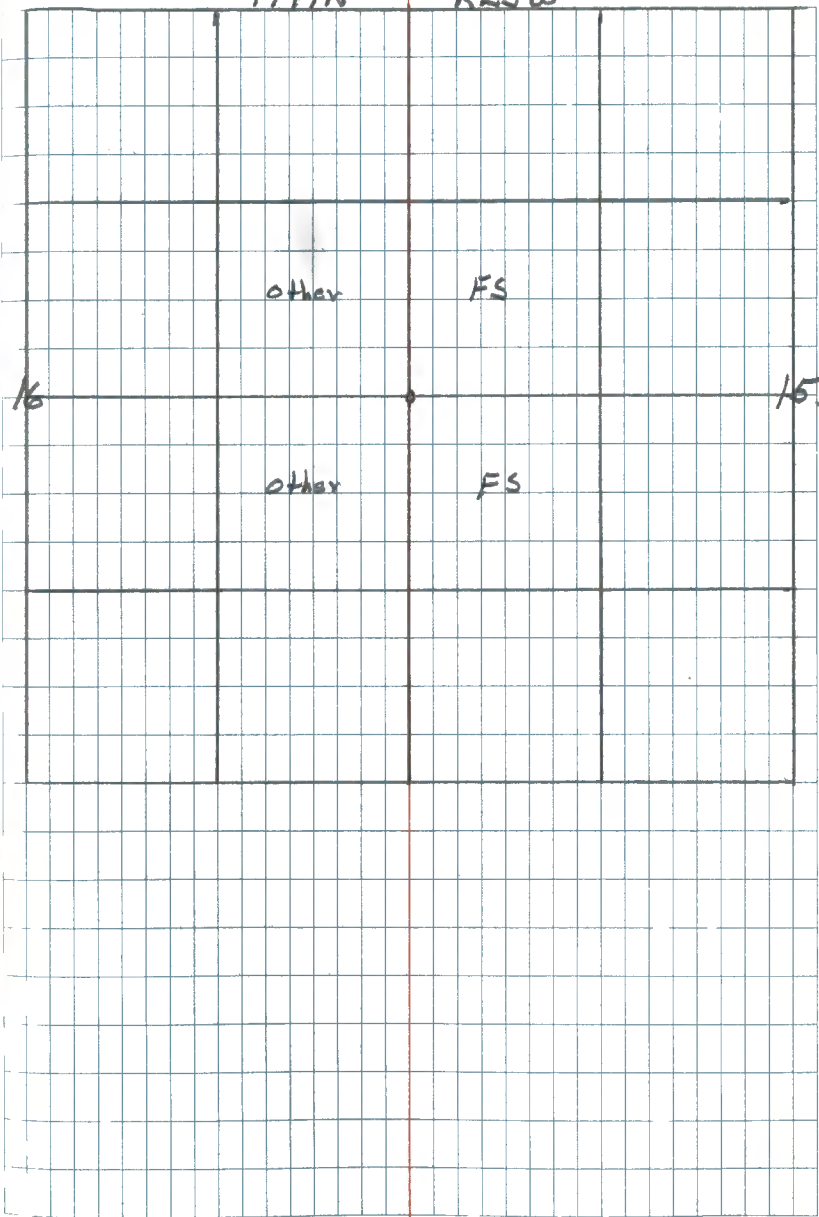



J-13

## Corner Sections 9-10-15-16

Notes of orig. Govt. Survey

Post

Maple 8" N20°W 29 lxs. (19.19')

New 14" Maple w/scribe. <sup>beating & dist.</sup> ~~variable of record~~

Maple 8" S15°W 5 lxs. (3.3')

No evidence found

Maple 12" N40°E 23 lxs. (15.18')

found depression at brg  $\frac{2}{3}$  dist.

W. Birch 12" S7°E 30 lxs. (19.8')

found depression at brg  $\frac{2}{3}$  dist.

To perpetuate this corner I set a 2" dia. X 60" long  
galvanized steel pipe, filled with concrete and  
capped with a 3" dia. brass tablet marked

T149N R25W

S9 | S10

S14 | S15

1975

RLS NO.

Basswood 8" S30°E 17.25' mkd. T149NR25WS15BT

Basswood 9" N43°E 33.2' T149NR25WS10BT

Basswood 9" N38°W 33.95' T149NR25WS9BT

H. Maple 7" S63°W 33.7' S16 BT

W. Pine snag 37" NB3°E 86.8' nail on face of BT

Set 8' steel sign post due south 4.5' w/FS. 54-2:54-4

Set 8' steel sign post due west 5.3' w/FS. 54-2:54-4

8-22-75 Carter R. Kinnell

T149N

R25W

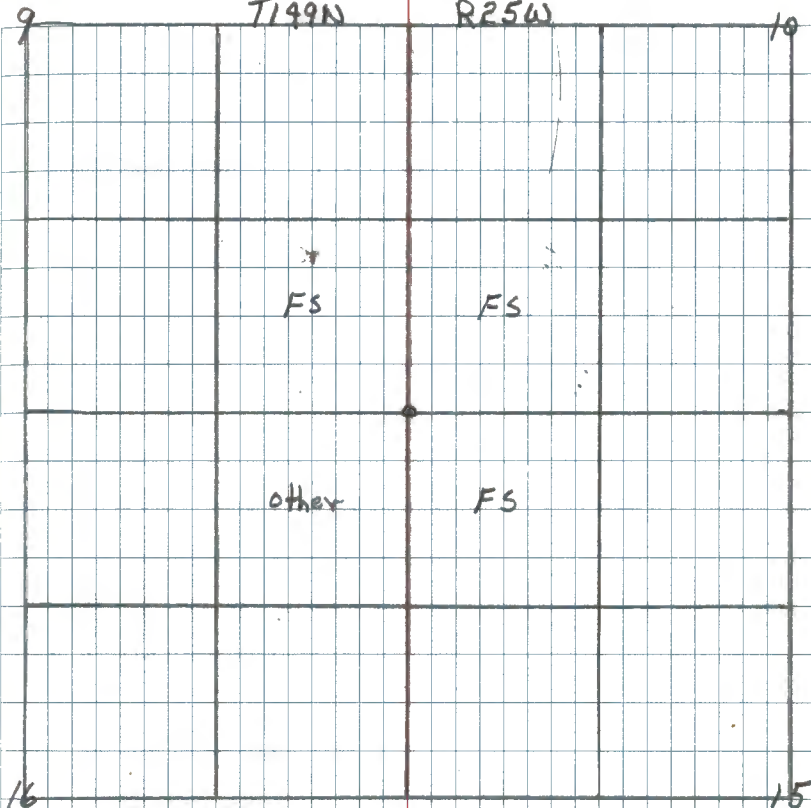

EOP of OBR 36 x 17.2' EW

then north 1721.9' to Sec. Cor.

49

W.C. For  $\frac{1}{4}$  Cor. Sections 10-15

(ON East shore of David Lake)

Notes of orig. Govt. Survey

Post

Balm-of-Gilead  $6''$  N  $42^\circ$  E 121ks. (7.92')

Balm-of-Gilead  $4''$  S  $12^\circ$  E 41ks. (2.69')

T149N R25W

10

15

50

G-13

Quarter Corner Sects. 9-10

Notes of orig. Govt. Survey  
Post

Tamarack 10" S47°E 171ks. (11.22')

Tamarack 12" S71°W 241ks. (15.84')

Searched 2 man hours for this  
corner No evidence found 11-22-67  
RHM

R9-7150-4

T149N R25W

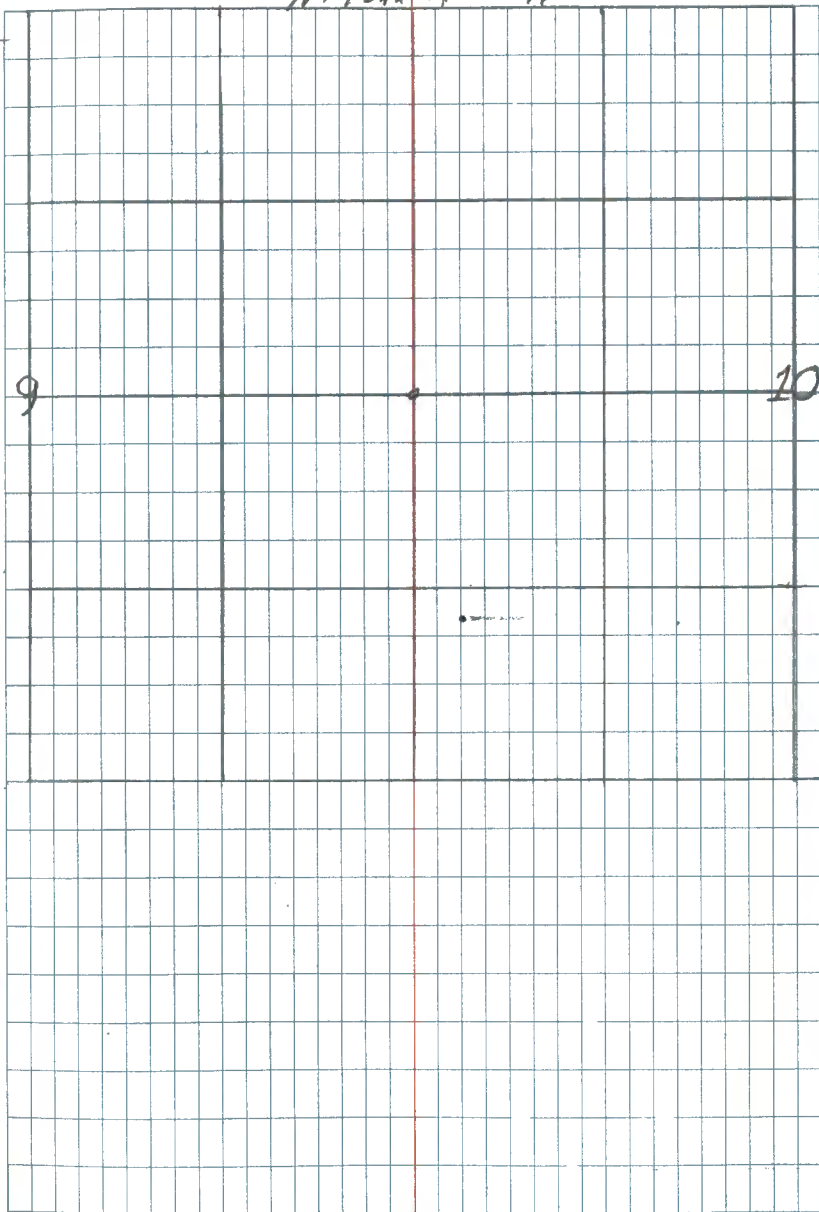

51

Section Corner of 3-4-9-10

Notes of orig. Govt. Survey

Post

Tamarack 6" N27°W 242ks (15.84')

Dead spruce 8" N21°E 501ks (33.0')

Dead spruce 10" S60°W 291ks (19.14')

T149N R25W

4

3

9

10

52

Quarter Corner Sections 3-10

Notes of orig. Govt. Survey

Post

Aspen 4" S33°E 140 lks. (92.4')

Spruce 4" N15°W 95 lks. (62.7')

53

Quarter Corner Sections 3-4

Notes of orig. gov't. survey

Past

White birch 10" S61°E 27 kcs. (17.82')

Cedar 9" West 15 kcs. (9.9')

54

Quarter Corner Sec's. 32-33

Notes of orig. Gov't. survey

Post

White Birch  $10^{\circ} N 35^{\circ} E$  24 ks. (15.84')

Fir  $6^{\circ} N 39^{\circ} W$  37 ks. (24.42')

55

V.9

Section Corner of 28-29-32-33

Notes of original Govt. Survey

Post

White pine 20" N2°E 2 kcs. (132')

Cedar 10" S21°W 22 kcs. (14.52')

Fir 6" N46°W 14 kcs. (9.24')

chained East from  $\frac{1}{4}$  of 29-32 & South  
 from  $\frac{1}{4}$  of 28-29 come out 100' South of  
 a blue paint line. No two stumps were  
 checked out all stumps badly burned.

3 man hours.

1/8/68 RHM

R9-7150-4

T149N

R25W

29

28

State

FS

FS 2402

FS

2095 to Sta. 202+00  
 on new Road  
 FS

32

33



56

V-11

Quarter Corner Sec's. 28-33  
 Notes of original Gov't. Survey  
 Post  
 Maple 7" N12°W 14 lks. (9.24')

Maple 7" S86°E 3 lks. (1.98')

Chained East from Sec. Cor 28-29-32 & 33  
 searched 2 man hours no evidence of  
 orig. corner was found. (ATM O'neal)  
 May 1969

T149N

R25W

28

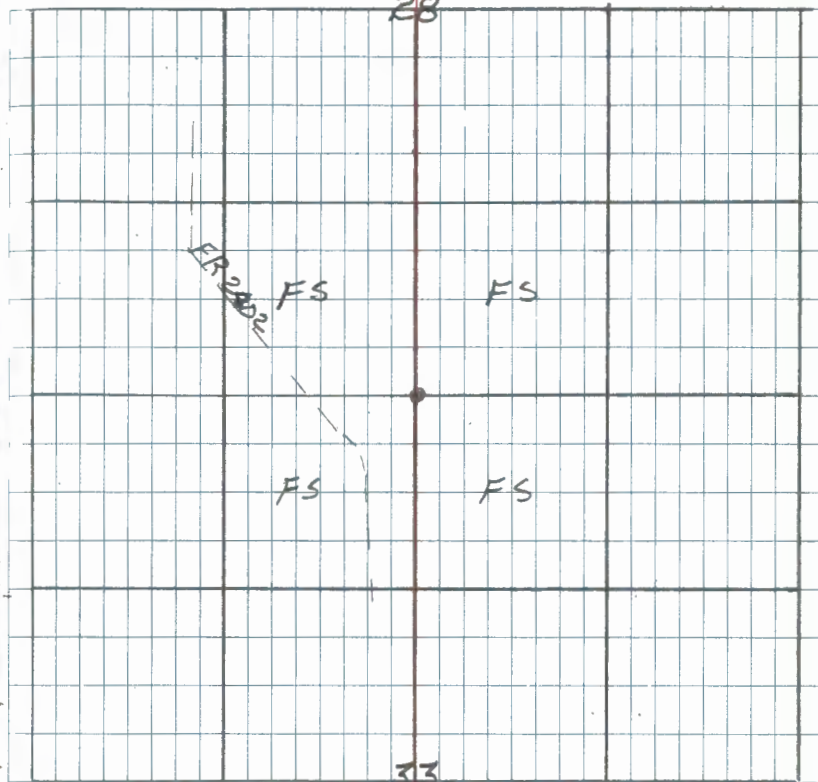

33

57

1.9

Quarter Corner Sec's. 28-29

Notes of orig. Gov't. Survey

Post

Maple 7" N24°W 15 lks. (9.9')

Maple 6" S64°E 26 lks. (17.16')

Chained South from pond 1288' but  
 were unable to identify orig. BTs  
 I placed FS metal location post on  
 on a 18" maple from which approx  
 cor is West 17.0' 5/22/69 JHM  
 3 man hours.

R9-7150-4

T149N R25W

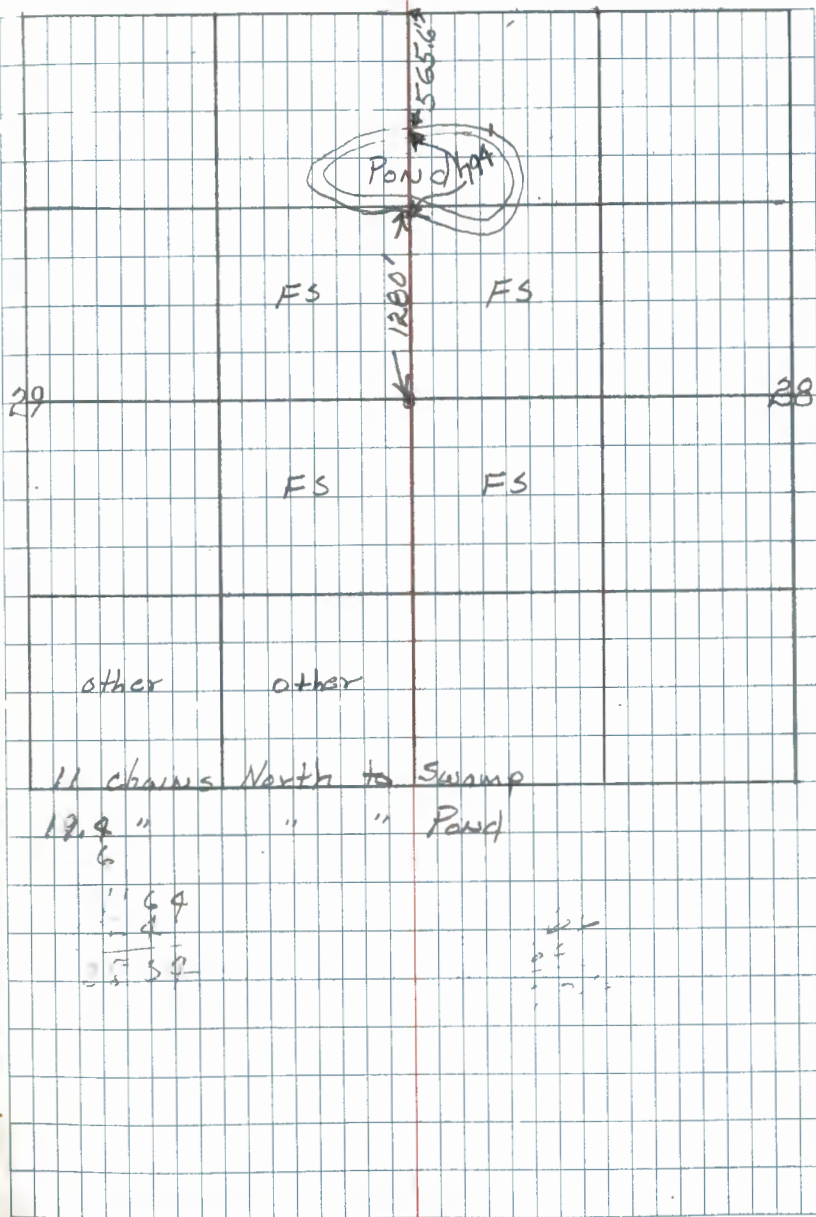

58

Corner sections 20-21-28-29

Notes of orig. Gov't. Survey

Post

White pine 12" S14°W 161ks. (10.56')

Possible (a burned stump.)

White birch 14" N22°E 151ks. (9.9')

Fir 6" S81°E 201ks. (13.2')

Fir 6" N47°W 121ks. (7.92')

R9-7150-4

T149N

R25W

20

21

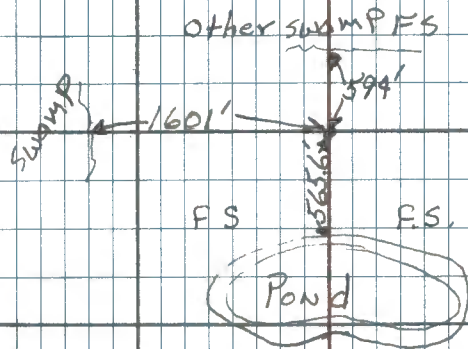

29

28

Placed F.S. metal location poster on a 4" Aspen Approx 8' west of corner. Cor. located by ties to natural features. Lake on South, Swamp on West <sup>566'</sup> Cor's to West & North. 12/28/67 RHM <sup>1</sup> 9 man hours

59

Quarter Corner Sections 21-28

Notes of orig. Govt. Survey

Post

Aspen  $6^{\circ} N 13^{\circ} W$  5 lks. (3.3')

Fir  $8^{\circ} S 62^{\circ} W$  23 lks. (15.18')

60

p. 9

Quarter Corner Sects. 20-21

Notes of orig. Govt. survey

Post

Cedar 10" S 30° E 20 lks. (13.2')

Cedar 10" West 9 lks (5.94')

Searched 2 man hours after chaining  
between Section Corners many cedar  
stumps badly burned 12-27-67 RHM

R9-7150-4

T149N

R25W

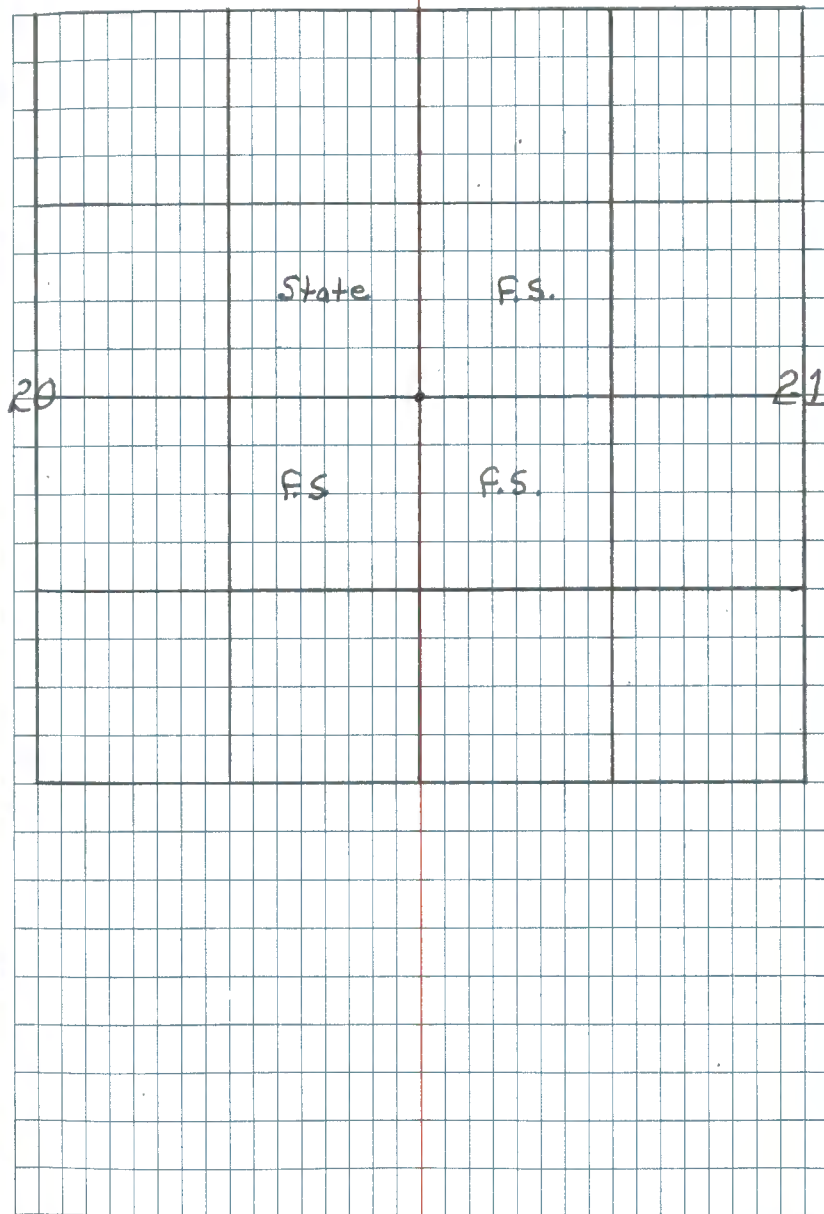

61

8-9

Corner Sections 16-17-20-21

Notes of orig. Gov't Survey  
Post

Tamarack 12" N 67° W 8 lks. (5.28')

Tamarack 6" S 51° E 15 lks. (9.9')

Tamarack 14" N 59° E 16 lks. (10.56')

Cedar 6" S 42° E 14 lks. (9.24')

R9-7150-4

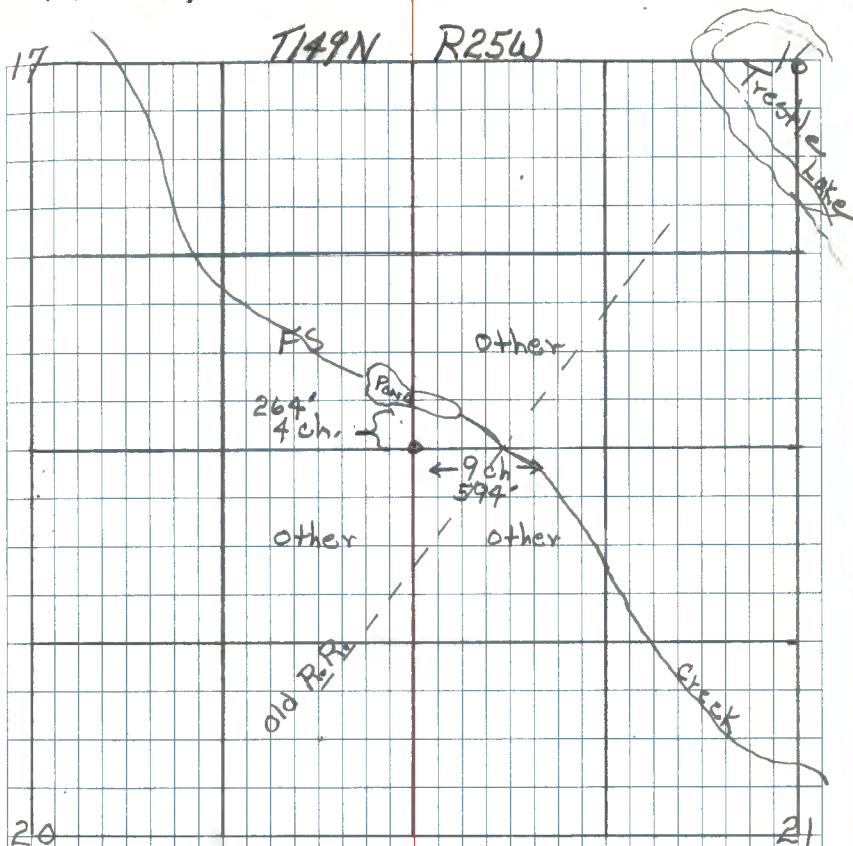

20

chained West from M.C. on trestle lake  
crossed creek at 2035' from 1/4 cor.  
From corner location pulled <sup>North</sup> 265' to creek  
marked cor w/ wood stakes & ribbon  
11/21/67 JAM

21

Chained South from Cor. 8-9-16-17 shot stadia  
across Holland lake & sheared area cross creek  
at 5005'

62

N-11

## Quarter Corner Sections 16-21

Notes of orig. Govt Survey

Post

White birch  $10''$   $N61^{\circ}W$  21 kts. (13.86')Cedar  $12^{\circ}S29^{\circ}E$  16 kts. (10.56')

Found a 14" Cedar stump w/ window  
blaze facing North. Stump is hollow  
No scribe visible. This is 1735'  
West of M.C.

R9-7150-4

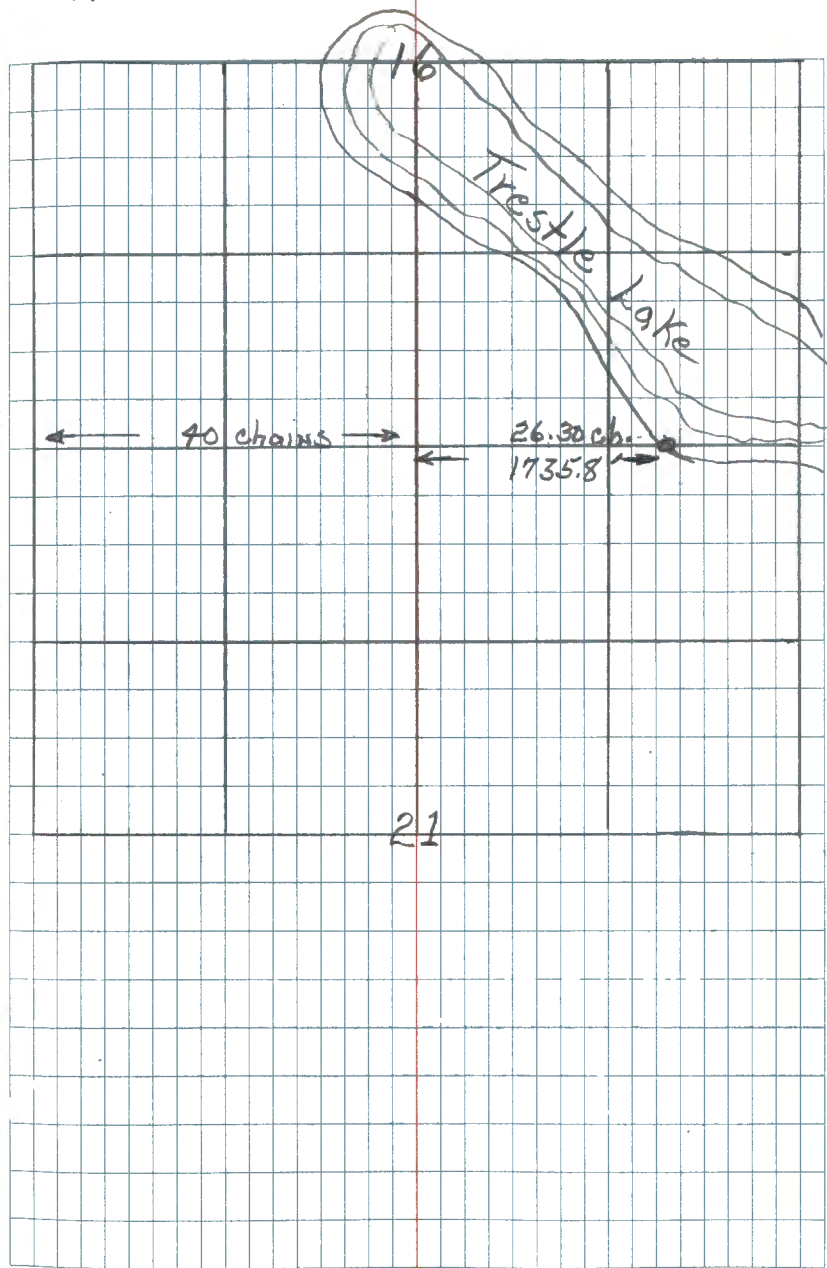

63

L<sup>9</sup>  
Quarter Corner Sections 16-17

Notes of orig. Govt Survey

Post

Maple 8" S 13°W 16 kcs (10.56')

Fir 6" S 85°E 24 kcs. (15.84')

Land clearing by State F.S. has sheared  
off all trees in area - have trespassed  
west of line. 12-26-67 RAM

Ran transit line South from Sec.  
Cor. of 8-9-16-17 at 2640 set a  
Red top cedar post 4"x4"x6' for  
approx. 1/4 Corner 5/24-68 RAM

R9-7150-8

RAM

T149N R25W

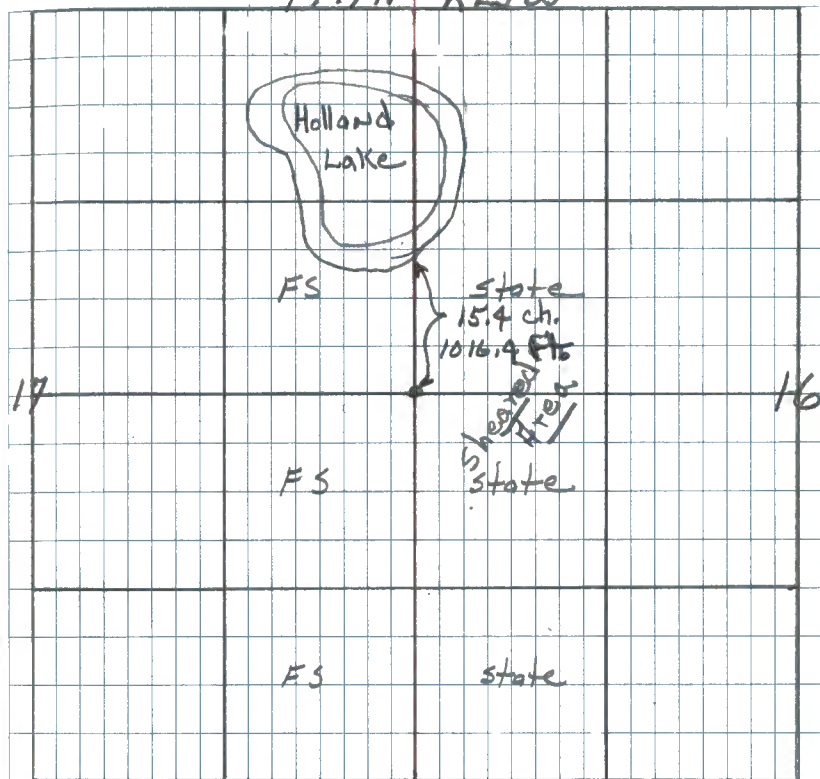



Corner Sections 8-9-16-17

Notes of orig. Govt. Survey

Post

White pine 8" S70°E 21 lks. (13.86')

(Now Buried pine stump S67°E 13.8')

White pine 6" N41°E 4 lks. (2.64')

(Now 24" W. Pine w/ window Blazes N41°E 2.64')

Black oak 6" S18°W 12 lks. (7.92')

(Now oak clump S20°W 8.0')

Aspen 6" N68°W 7 lks. (4.62')

Found F.S. metal location poster on The

24" White pine BT poster dated 11-3-46

11-22-67 RHM &amp; L.F.

Set a 2" inside dia, 5 foot long  
galvanized steel pipe filled with concrete  
and capped with a 3" dia.

T149N R25W

bronze tablet stamped:

S 8 | S 9

S 17 | S 16

1967

RLS No 6807

Oak 6" S24°W 8.4' NOW 12" 2009 MKD S17 BT

Spruce 4" S51°E 28.9' NOW 10" 2009 MKD S16 BT

Spruce 5" N84°E 52.2' GONE FALLS IN OLD PCT MKD S17 BT

Steel sign post 72" long w/ FS standard sign

54-25 54-4 attached set South 45'

12-7-67 RHM &amp; L.F.

08-27-09 RMAIN

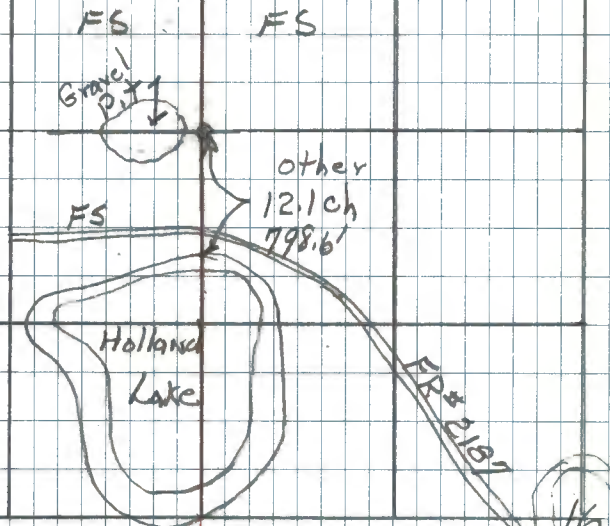
IRON IN PLACE AND GPS. ORIGINAL W/PINE  
IS STILL ALIVE.

17 I brushed a line south to lake at  
552 Feet Found a cedar post & F.S.  
metal location poster on North side of  
FR 2187. At 675' set hub on top  
of hill overlooking lake.

*[Signature]*

65

## Quarter Corner Sections 9-16

Notes of orig. Govt. Survey

Post

Aspen 6" S10°W 18 lks. (11.88')

Aspen 8" N36°E 37 lks. (24.42')

T149N

R25W

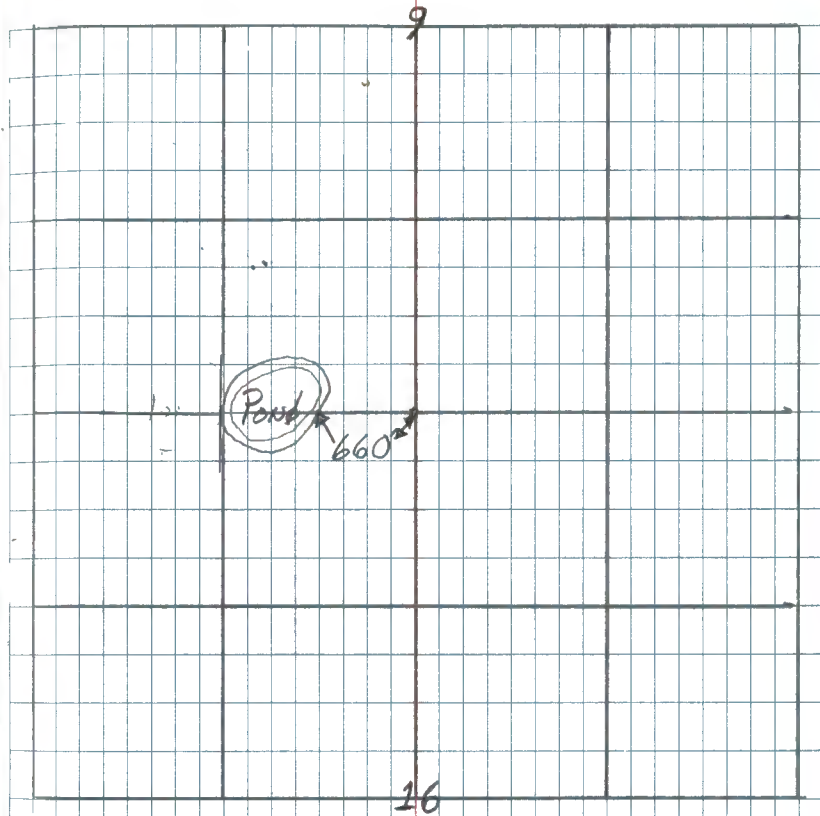

Corner is 10 chains East of pond

66

Affidavit RHM

G-9

Quarter Corner Sections 8-9

Notes of orig. Govt. Survey

Post

Tamarack 7" S22°W 20 lks (13.2')

Tamarack 5" N2°E 7 lks (4.62') (Now  
a dead 5" Tam. w/ scribe visible N2°E  
4.62 Feet

Set a 2" inside diameter 5 foot long  
galvanized steel pipe filled with concrete  
and capped with a 3 inch dia. bronze  
tablet stamped:-

T149N R25W

1/4

S 8 | S 9

1967

RLS No 6801

Cedar 5" S65°W 31.8 ft MKD 1/4 S 8 BT

Tamarack 5" S12°E 19.0 ft MKD 1/4 S 9 BT

Steel sign post 72" long w/ FS. Standard signs

54-2 &amp; 54-4 attached set West 4.6 feet

Dec. 19, 1967 RHM

R9-7150-4

T149N

R25W

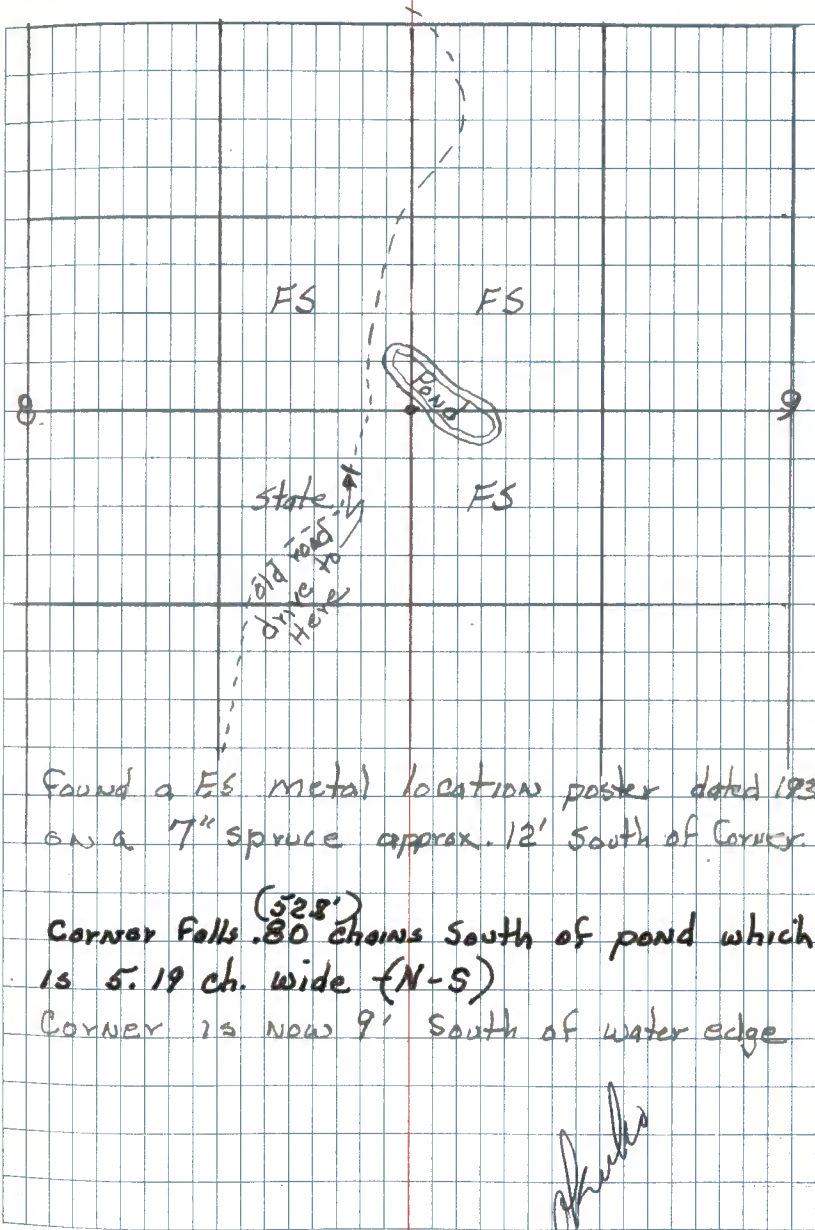

Found a FS metal location poster dated 1935  
on a 7" spruce approx. 12' South of corner.

(528')  
Corner Falls .80 chains South of pond which  
is 5.19 ch. wide (N-S)

Corner is now 9' South of water edge

*RHM*

67

Corner Sections 4-5-8-9

Notes of orig. Govt. Survey

Post

Spruce 7" S24°E 30 lks. (19.8')

Spruce 8" S30°W 42 lks. (27.72')

White pine 16" N17°W 38 lks. (25.08')

T149N

R25W

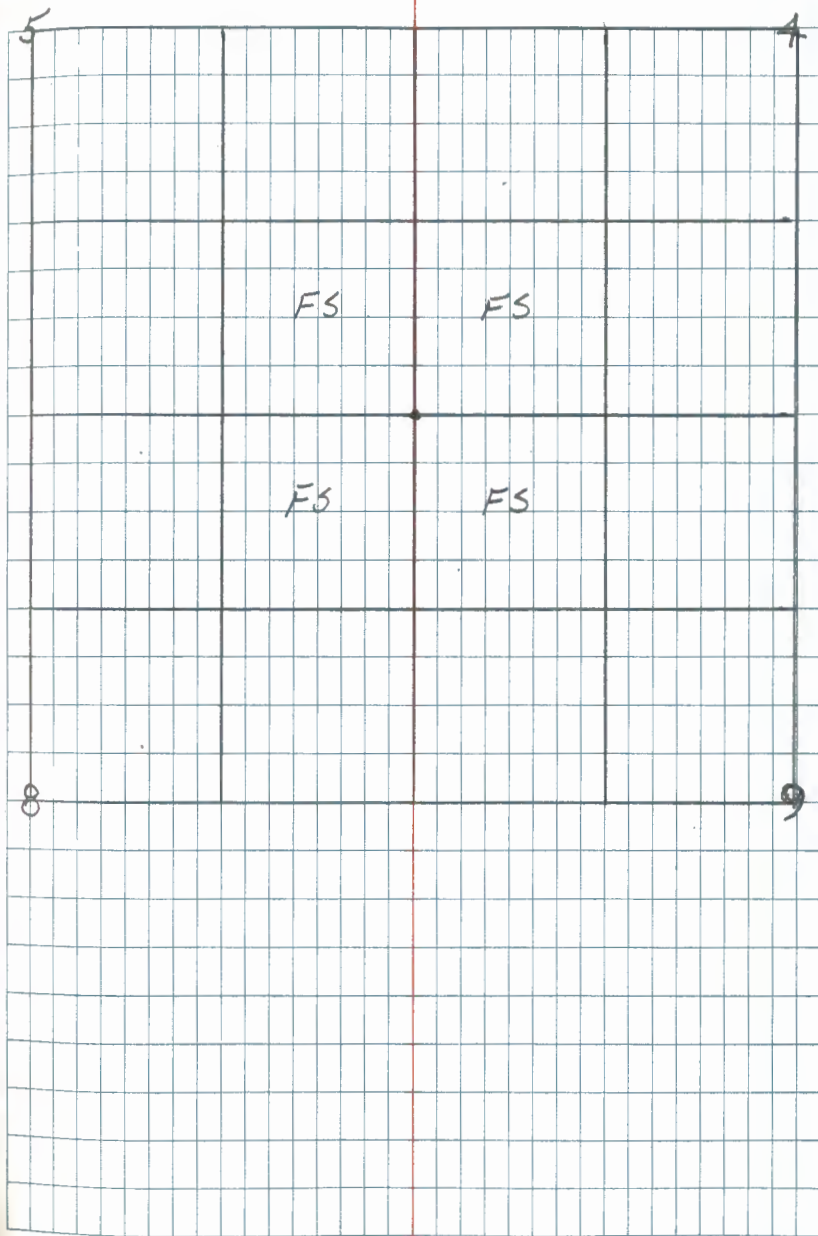

68

E-11

Quarter Corner Sections 4-9

Notes of orig. Govt. Survey

Post

Fir 5" N53°W 25 lks. (16.5')

White pine 15" S73°E 15 lks. (9.9')

I Chained South & East from Sec. 4 cor. 45, 32 & 33 to search for the post. Several old burned pine stumps in the area but too much snow to do a good search. Found nothing but put up F.S.L.P. on the south side of 8" Spruce for Approx Cor. Older blazed line running north.

2/77 Ronald Clew

T149N

R25W

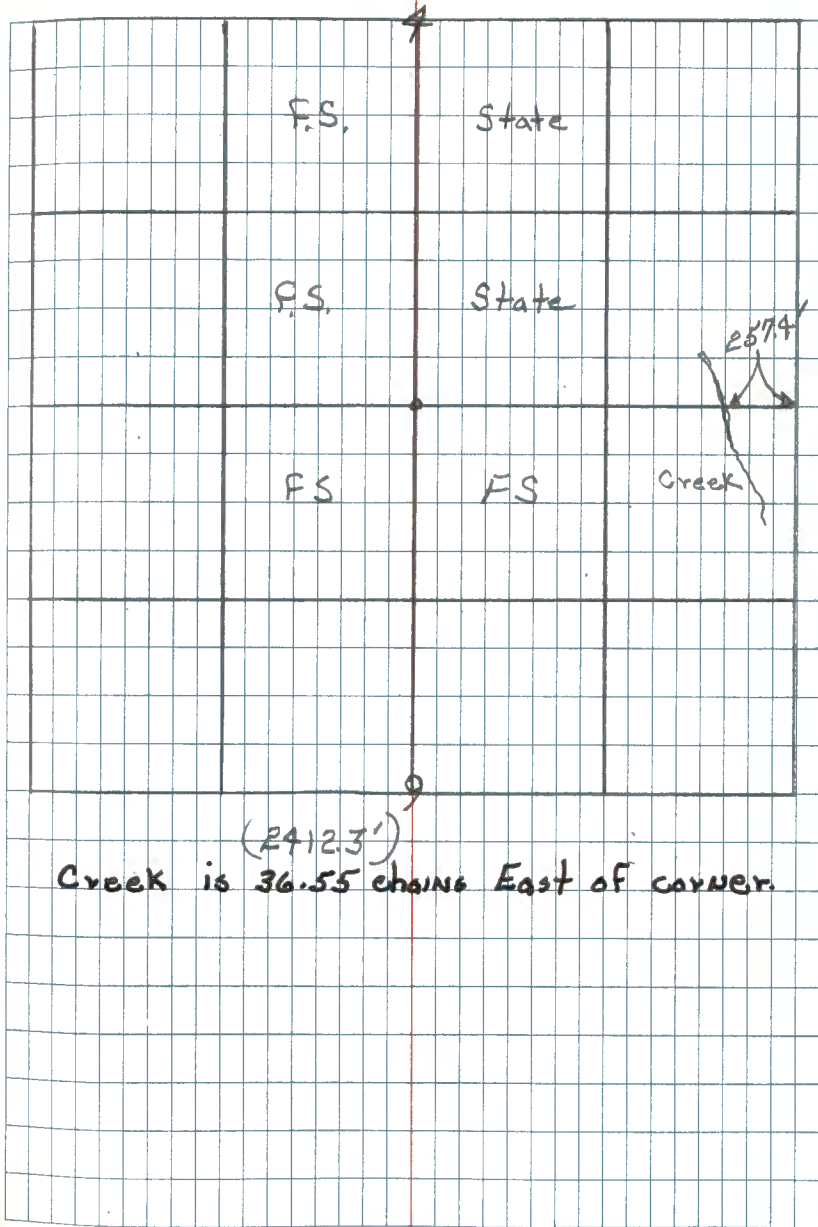

(24123')

Creek is 36.55 chains East of corner.

69

Affidavit RAM

V-7

Quarter Corner Sects 29-32  
Notes of orig. Govt Survey  
Post

Cedar 8" S7°W 12.1ks (7.92') Now partly  
dead cedar at record bearing & Dist. scribing visible.

Cedar 9" N57°W 6.1ks (3.96') (Now broken  
down & stamp decayed at record bearing & dist.)

Found old square post laying at corner  
Set a 2" inside dia. 5 Foot long  
galvanized steel pipe filled with  
concrete and capped w/a 3" dia.  
bronze tablet stamped:

T149NR25W

1/4 S29

1/4 S32

1967

RLS NO 6807

Cedar 8 " N55°E 8.3 Ft MKD 1/4 S29 BT

Cedar 9 " S37°E 19.5 Ft MKD 1/4 S32 BT

Cedar 6 " S37°W 15.5 Ft MKD 1/4 S32 BT

Steel sign post 72" long w/ F.S. standard  
signs 54-2 & 54-4 attached set East 7.45 Ft

12-22-67 R.H.M. Donald

RP-7150-4  
RAM

T149N

R25W

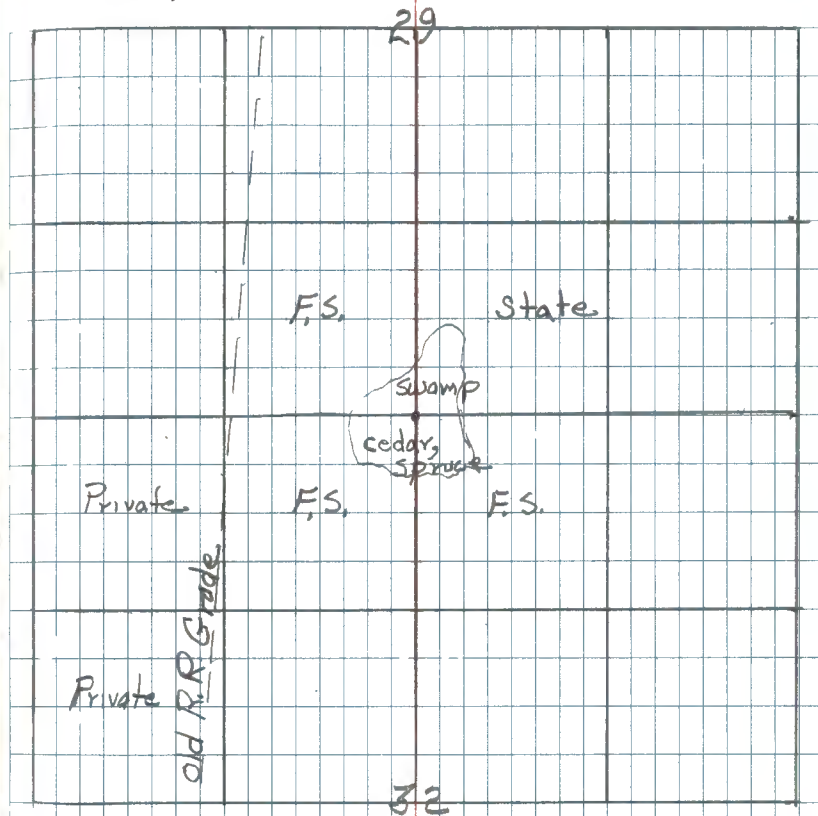

32

*R.H.M. Donald*

70

Quarter Corner Sect's. 30-31

Notes of orig. Gov't. Survey

Post

Tamarack 8" N59°W 26 lks. (17.16')

Tamarack 9" S42°E 3 lks. (1.98')

T149N

R25W

30

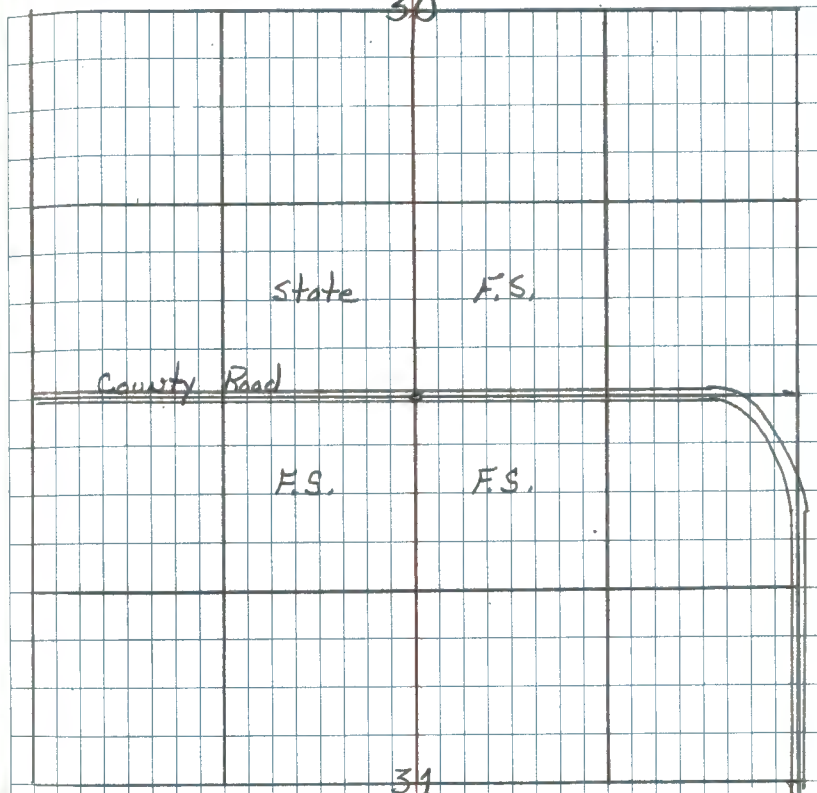

71

Quarter Corner Sect's 29-30

Notes of orig. Gov't Survey

Post

Aspen 10" N6°W 15' 1ks. (9.9')

No other



## Corner Sections 19-20-29-30

Notes of orig. Govt. Survey

Post (Found old squared post marking corner)

Tamarack  $7^{\circ} S 51^{\circ} W$  38 lks. (25.08')(Now a 10" Tam. Stub scribe visible at record bearing <sup>distance</sup>)Tamarack  $8^{\circ} N 80^{\circ} W$  8 lks. (5.28')Tamarack  $9^{\circ} N 10^{\circ} E$  21 lks. (13.86')Tamarack  $10^{\circ} S 77^{\circ} E$  18 lks. (11.88')

Set a 2 inch inside diameter, 5 foot long  
galvanized steel pipe filled with concrete  
and capped with a 3 inch diameter bronze  
tablet stamped:-

T149N R25W

S 19 | S 20

S 30 | S 29

1969

RLS NO 6807

Cedar  $11^{\circ} S 68^{\circ} W$  35.3 FT MKD S 30 BTCedar  $10^{\circ} S 33^{\circ} E$  47.1 FT MKD S 29 BTCedar  $12^{\circ} N 73\frac{1}{2}^{\circ} E$  54.5 FT MKD S 20 BTSteel sign post 72" long with F.S. standard  
signs 54-2 and 54-4 attached set West 4.8May 23, 1969 ~~STAMP~~ ~~TABLET~~Affidavit T149N  
RAM

R-5

R25W R9-7150-9  
RAM

19

20

F.S.

State

State

F.S.?

30

29

Corner is in south edge of old Tam. swamp  
now a brush swamp.

Quarter Corner Sects 20-29

Notes of orig. Govt. Survey

Post

White Birch 10" S36°W 20 lks. (13.2')

Fir 7" N81°E 5 lks. (3.36')

Chained west from Sec. Corner, searched  
1 man hour no evidence found. Old running  
Notes place corner 24.4' west of swamp.

" " " 470.6' East " "

Dec. 1967 ~~CAH~~

20

State

State

Swamp Sink Hole

F.S.

F.S.

Old R.R. Grade

29

74

Quarter Corner Sects. 19-30

Notes of orig. Govt. Survey

Past

White Birch 7" S 30° W 24 ks. (15.84')

Maple 6" N 72° E 13 ks. (8.58')

T149N

R25W

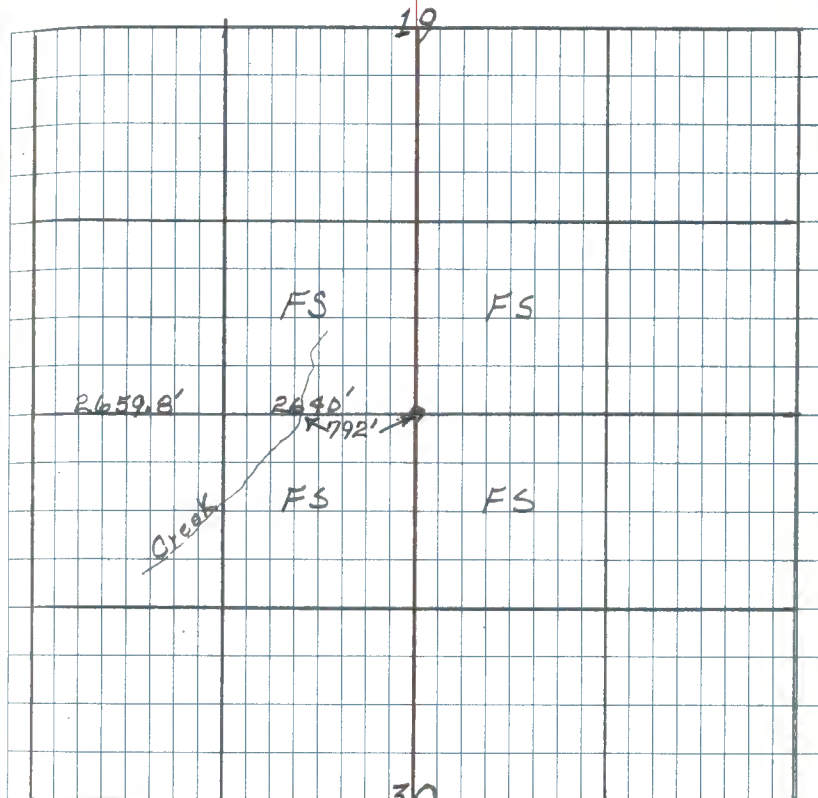

Creek lies 12 chains west of corner  
(792')

75

p. 5

Quarter Corner Sects. 19-20

Notes of orig. Govt. Survey

Post

White birch 8" N60°E 5 lks. (3.30')

White birch 8" N62W 15 lks. (9.9')

Searched one man hour for this corner  
 no evidence found. Area has been  
 heavily burned

May 1969

RP-7150-4  
15/2/71

T149N

R25W

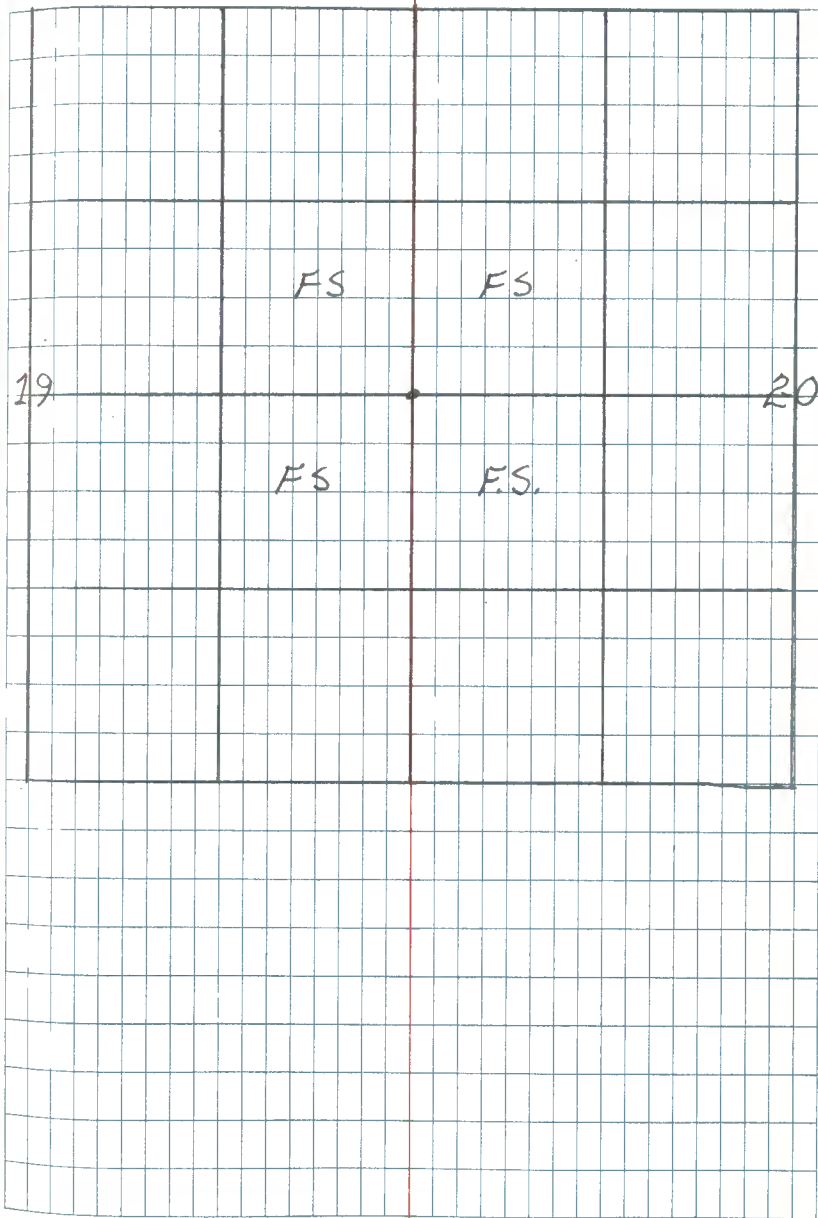

76

N-5

## Corner Sections 17-18-19-20

Notes of orig. Govt. Survey

Post

Spruce 6" S 57° W 26 lks. (17.16')

Spruce 8" N 16° W 23 lks. (15.18')

Spruce 7" N 28° E 12 lks. (7.92')

Tamarack 8" S 50° E 48 lks. (31.68')

I chained East 1 mile from Sec. Cor.  
 Found a squared post marking corner.  
 U.S. FS Farm 874-9 on record states  
 they found sq. post marking corner &  
 placed FS poster on 5" cedar N 23° E  
 32 lks (21.3') Now fallen & decayed cedar  
 w/ tag attached N 23° E 21.3'  
 Cedar Stp 4" S 12° E 12 lks (Now decayed cedar  
 stp. S 12° E)

Tam stp. scribed RT N 31° E 20 lks (Now decayed  
 Tam. N 31° E 13.2')

Farm 874-9 dated Dec 4, 1935 by HC Norman

I placed FS. metal location poster on  
 a 11" cedar N 33° E 18.0' ~~RAM~~ 5/20/67  
 6 man hours

R9-7150-4  
RAM

T149N

R25W

18

17

F.S.

F.S.

F.S.

F.S.

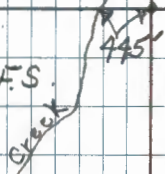

19

20

Creek 6.75 chains west of corner  
 445.5'

I chained North from sec. corner 19-20-29-30  
 & East from Creek 445.5'. Area has  
 been badly burned - could not identify  
 any stumps to match notes. RAM  
 12/67

Quarter corner sections 17-20

Notes of orig. Govt. Survey

Post

White birch 7" N54°W 6 lks. (3.96')

White birch 6" S1°E 10 lks. (6.6')

T149N

R25W

17

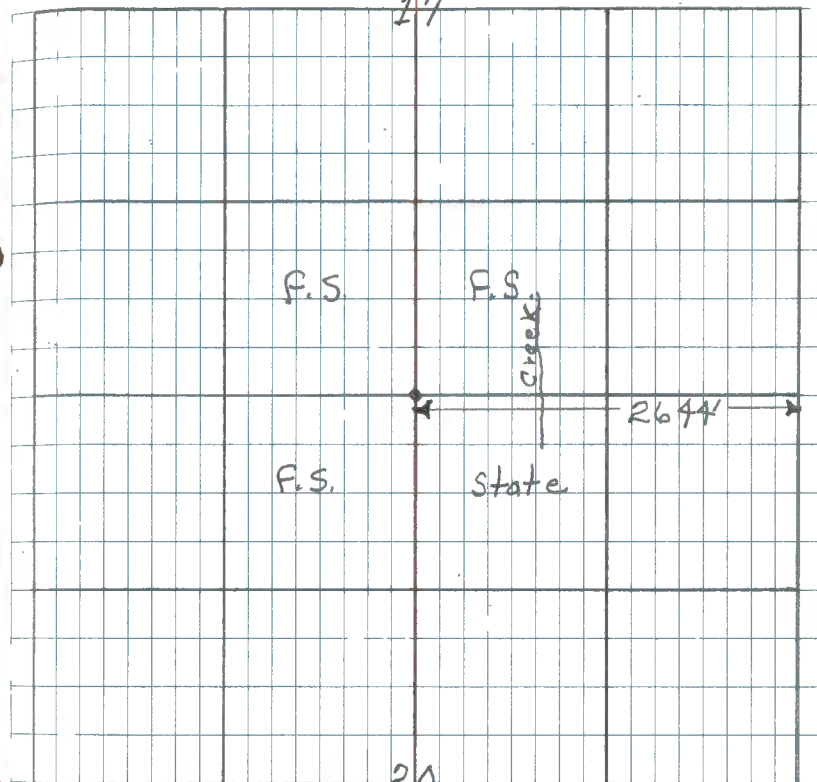

Creek is  $13.\overset{19}{\cancel{25}}$ <sup>20</sup> chains East of corner.  
(870.5')

7B

N-3

## Quarter corner sections 18-19

Notes of orig. Govt. Survey

Post

White birch 8" S3°E 11 lks. (7.26')

White birch 10" North 23 lks. (15.18')

Searched area 2 man hours but no evidence of corner was found. I chained East from sec. cor. of 18-19-13-24 & placed F.S. location poster on a 6" birch  
 May 14, 1969 JAM

R9-7150-4  
JAM

18

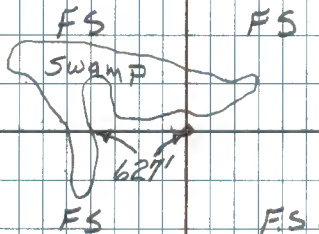

19

Enter swamp 9.5 chains west of corner.

Quarter Corner Sections 17-18

Notes of orig. Govt. Survey

Post

Tamarack 6" S83°E 7 lks. (4.62')

Tamarack 6" N34°W 22 lks. (14.52')

Searched 4 man hours for this corner  
using ties to natural features but  
no evidence of orig. corner was found

Dec. 1967 ~~STW~~

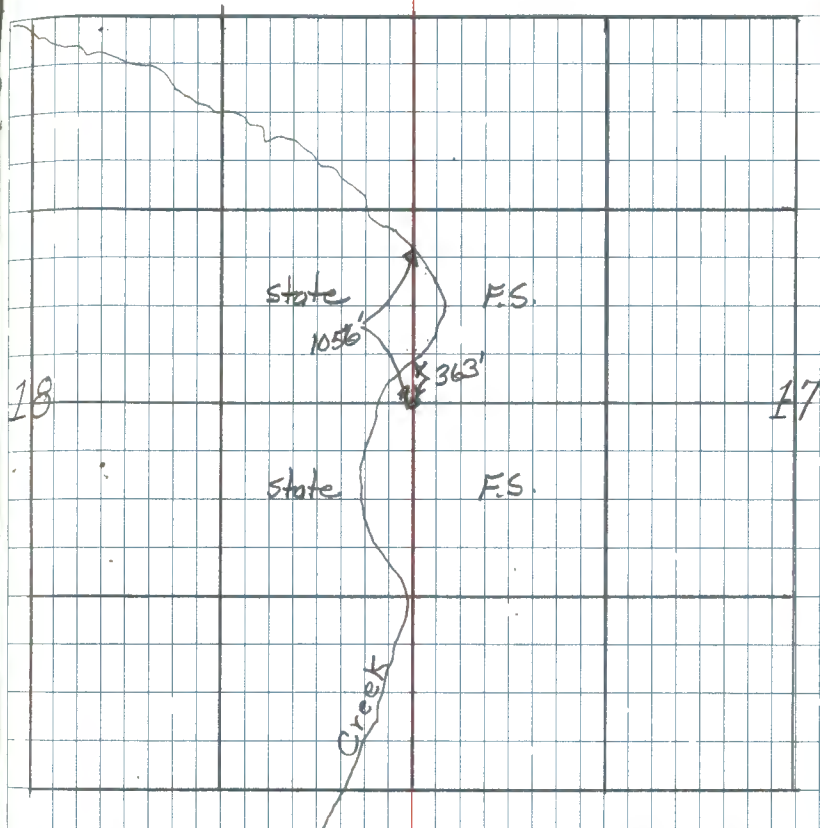

Creek is 5.5 ch. north of corner (363')

" " 16.0 " " " " (1056')



3.5  
Corner Sections 7-8-17-18

Notes of orig. Govt. Survey  
Post

White birch 12" S40°E 17 lks. (11.22')

" "

White birch 14" S70°W 28 lks. (18.48')

White birch 10" N16°E 14 lks. (9.24')

White birch 10" N6°W 7 lks. (4.62')

Dec. 1967 No evidence of  
corner or orig. BT's was found  
4 man hours. P.H.M. Donald

R9-7150-4  
T149N R25W

