

CORNER
RESTORATION
T148N R25W



BOOK #1

U.S. DEPARTMENT OF AGRICULTURE
FOREST SERVICE
CHIPPEWA NATIONAL FOREST, MINNESOTA

17

12

1413

13

9

24

6

25

3

26

page

number

wood

T148N R25W 5th P.M.
ITASCA COUNTY

| | | | | | | | | | | | | | |
|----|----|----|----|----|----|----|----|----|----|----|----|----|---|
| | | 74 | | 55 | | 38 | | 19 | | | | | |
| 6 | 5 | 73 | 4 | 54 | 3 | 37 | 2 | 18 | 1 | | | | |
| | | 71 | 72 | 51 | 50 | 35 | 36 | 16 | 17 | | | | |
| 7 | 8 | 70 | 9 | 52 | 10 | 34 | 11 | 15 | 12 | | | | |
| | | 67 | 68 | 69 | 49 | 48 | 32 | 33 | 11 | 12 | 14 | 13 | |
| 18 | 17 | 65 | 16 | 47 | 15 | 31 | 14 | 10 | 13 | | | | |
| | | 64 | 65 | 45 | 46 | 29 | 30 | 8 | 9 | | | | |
| 19 | 20 | 63 | 21 | 44 | 22 | 28 | 23 | 7 | 24 | | | | |
| | | 61 | 62 | 41 | 40 | 26 | 27 | 5 | 6 | | | | |
| 30 | 29 | 60 | 28 | 42 | 27 | 25 | 26 | 4 | 25 | | | | |
| | | 78 | 76 | 77 | 57 | 58 | 59 | 24 | 23 | 21 | 20 | 2 | 3 |
| 31 | 75 | 32 | 56 | 33 | | 34 | 22 | 35 | 1 | 36 | | | |
| | | | | | 39 | | | | | | | | |

Colored numbers refer to page
on which notes for that corner
may be found

Orig. Survey by J.P. Hinchlwood
September 14th to 30th 1875

1
1/4 Cor. Sec. 35-36
Orig. Notes: Cedar post
Cedar 8" S 73W 20 LKs or

Cedar 10" N 68E 30 LKs or

T148N R25W



2

Sec. Cor. 25-26-35-36

Orig. Notes: Spruce post

Tap. 6" S44E 22 Lks.

Tap. 10" S51W 50 Lks.

Tap. 10" N79W 48 Lks.

Tap. 8" N25E 30 Lks.

T148N

R25W

| | | | |
|--|--|--|--|
| | | | |
| | | | |
| | | | |
| | | | |

3

1/4 Cor. 25-36

Orig. Notes: W. Birch post

Ash 4" N 3° W 5 LKs

Fir 8" S 5° W 75 LKs

T198N

R25W

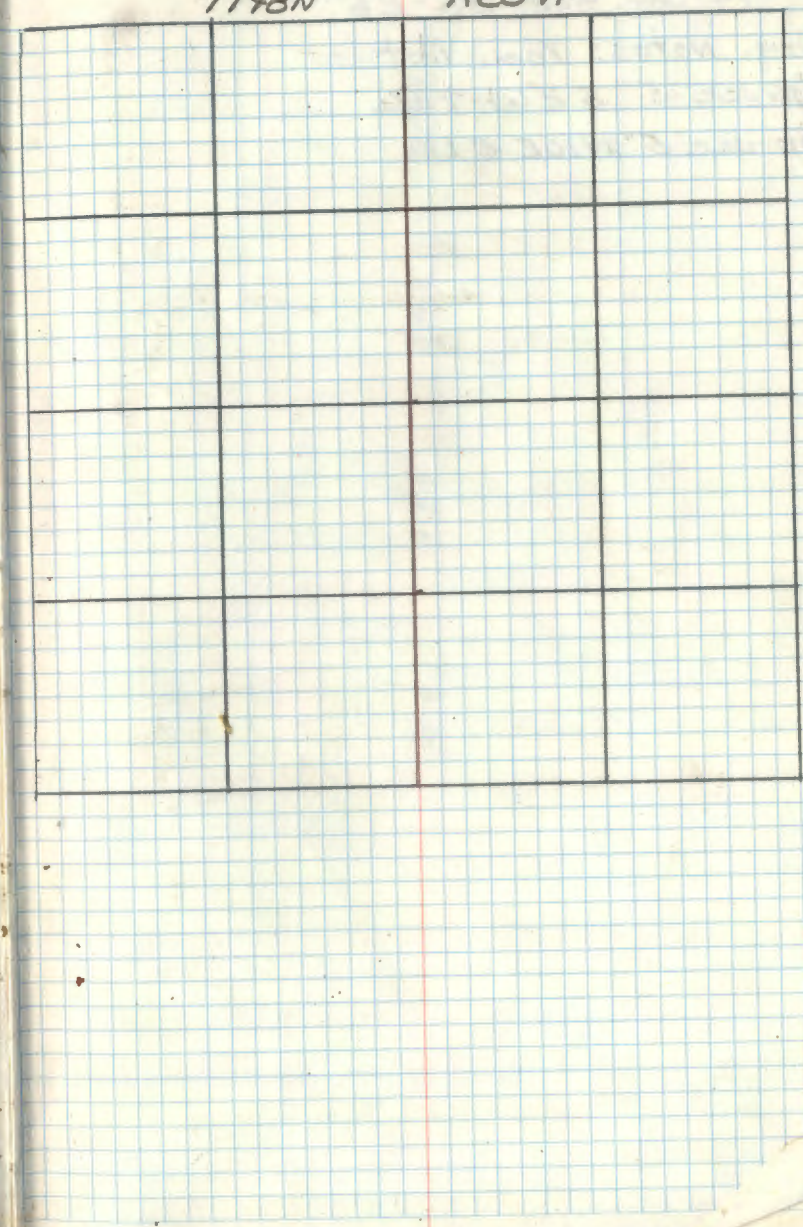

7

1/4 Cor. Sec. 25-26

Orig. Notes: Tom. Post.

Spruce 5" S 2' W 4 Lks.

Spruce 5" NIDE 3 Lks.

T148N

R25W

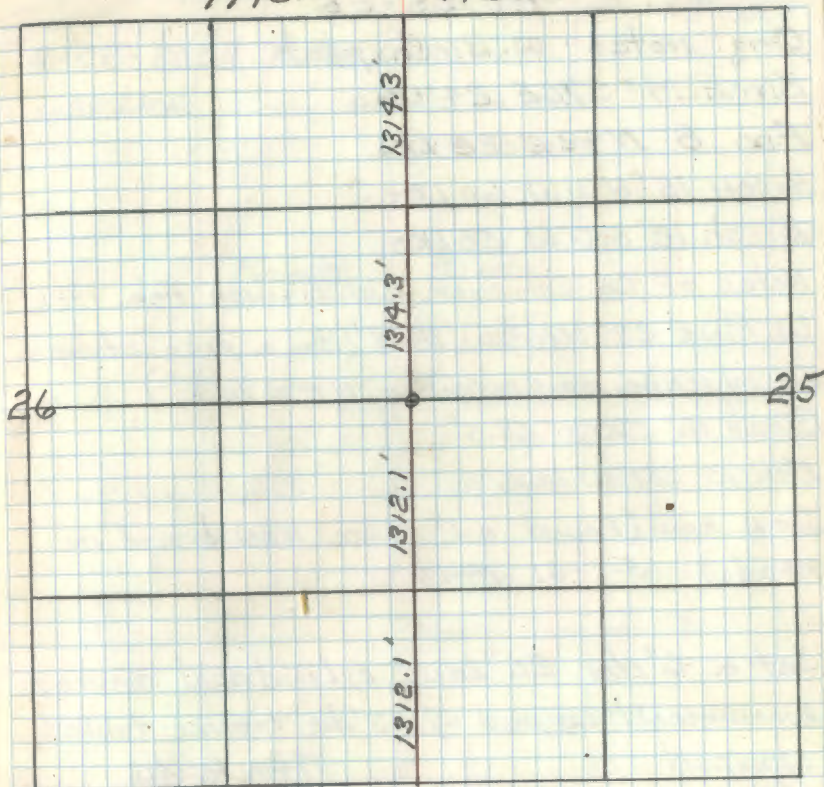

5 p-at Affidavit RHM

Sec. 23-24-25-26

Orig. Notes: W. Birch post

Birch 19" S70E 24 LKS

Fir 8" N92E 22 LKS

Aspen 15" N31W 60 LKS

Birch 12" S51W 50 LKS

Notes of Co. Surveyor L.W. Johnson Feb. 1926

W. Pine 22" N10 1/2 W 116.8' (Now a pine stump)

Log w/ scribe marks visible N20W 116.8')

Birch 12" S70E 68.5'

Hsh 10" S81W 116.6'

Iron mon. (Found a 1" square iron buried in road) 5-1-61 RHM

Set a 6" dia. 26" long cylindrical concrete monument capped w/a 3" dia. bronze tablet stamped

T198N R26W

523524

526525

1961

RLS No. 3628

Granite Rock 2.5' x 2' x 1' ^{547W} above ground 134.5' MKD X

Granite Rock 6' x 3.5' x 1' ^{above ground} N22E 132.5' " X

Cedar Post S54E 50.2'

Cedar Post N40 1/2 W 25.6'

4" x 4" x 6.5' penta-treated w/red top

6/23/61 R.H. McDonald

R9-5680-11 JMB

T198N

R25W

23

24

4-08-2009 R. MAZIN

GAS IRON!

Private

Private

W. Lind

Co. Road

FS

Private

26

25

Placed F.S. Poster on a 12" Balsam from which cor. bears N43°E 76.0'

Sign 54-4 on cedar post N-W of corner

12-7" M
O.K.
R. A. Wolden

6
R23 1/4 Cor. Sec. 24-25

Orig. Notes: Fir post

Birch 19" N40W 31 LKS

Tam 12" S71W 28 LKS

Notes of Co. Surveyor L.W. Johnson Feb. 1926

Pine stp. 12" N32°E 51.7'

Pine stp. 18" S24W 28.2'

1967 EARL PELOGUEN

SET IRON PIPE IN ROAD AT PRORATED DISTANCE.

WITNESSED BY:

ANCHOR POLE N30W 26.84'

CO MONUMENT SOUTH 33.0'

6/14/89 ITASCA CO G. ROBERTSON B. BRUCE

FD 1" I.P. IN E OF RD NORTH 2 1/2 FT NORTH OF

E OF RD EAST-WEST .4 FT BELOW SURFACE.

1967 ANCHOR POLE IS GONE FD CO MONUMENT.

NEW PTS.

BIRCH 15 S16E 49.53 NAE1

J. PINE 10 S60E 77.22 NAE1

ASPEN 7 1/2 N73W 113.93 NAE1

T148N

R25W

| | | | |
|--|--|--|--|
| | | | |
| | | | |
| | | | |
| | | | |
| | | | |
| | | | |
| | | | |
| | | | |
| | | | |
| | | | |

AUG 9 18 P.C. WARNER SURVEY OF JESSIE LAKE ROAD

ESTABLISHED PRO-RATA

PINE STP 12 N30E 53.4?

PINE STP 18 S16W 26.9

PINE STP 26 N46E 10.5

DEC 19 19 L.W. JOHNSON SURVEY OF JESSIE LAKE ROAD

PINE STP 12" N32E 51.7

PINE STP 18" S24W 28.2

7 p. 21 Affidavit R25W

1/4 Cor. Sec. 23-24

Orig. notes: Spruce post

W. Pine 14" N83°W 19 LKs or 12.54' (Now pine stp w/ BT visible)

Aspen 6" N67°E 21 LKs (Now mostly decayed N33°E 13.8')

Notes of Co. Surveyor L.W. Johnson Feb. 1926

Balsam 8" N76°E 33.0' (Now Balsam stp. mostly decayed N59°E 33.0')

Balsam 5" N52°W 26.0' (Now Balsam windfall mostly decayed N39°W 26.0')

Govt. BTs

5-2-61 R25W

Set a 2" inside dia. 5' Long gal. wrought iron pipe filled w/ concrete & capped w/ a 3" dia. bronze tablet, stamped:

T148N R25W

1/4

523 | 524

1961

R.L.S. NO. 3628

From which bears:-

Elm 9" S75°1/2W 12.42 mko 1/4 523 BT

Rock 2.5 x 3.0 x 1' high x Top center N75°E 32.2'

Rock 3.5 x 3.0 x 1' high x Top center N32°W 26.4'

7/5/61 R.L.S. McDonald

R9-5680-11 946

T148N

R25W

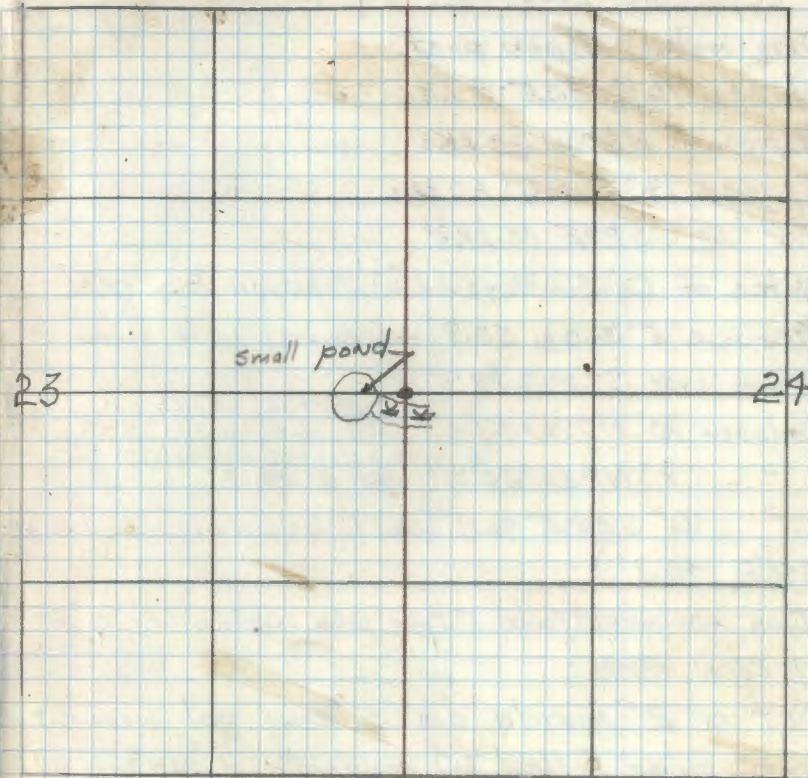

F.S. Postex was found on a 8" Palm of Gr. From which Cor. bears N79°W 6.7'

12-7-61
D.L. Johnson

See: T148N R25W BK 4 pg 24

8 N 2' Affidavit RHM

Sec. Cor. 13-14-23-24

Orig. notes: Aspen post

Aspen 16" N80E 8 LKs

Aspen 8" N20W 32 LKs

Spruce 14" S66W 60 LKs

Fir 12" S29E 10 LKs

Notes of Co. Surveyor L.W. Johnson Feb. 1926

Spruce 5" S60W 33.8' (New Spruce 12" w/scribe

grown over S62W 33.8')

Balsam 10" N77W 51.1' (N74°W 51.1' (Mostly decayed stp "BT" vis)

" 8" N33E 30.2' (New Gal. windfall w/ "BT" vis)

" 6" S57E 46.1' (New 10" Balsam w/scribe visible S48E 46.1')

Iron monument (Found 1" Iron pipe in place)

7-28-61 RHM

Set a 2" inside dia. 5' long gal. wrought iron pipe filled w/ concrete & capped w/ a 3" dia. bronze tablet stamped:-

T148N R25W

S19 S13

S23 S24

PLS No 3628

From which bears:-

Aspen 14" S59E 7.2' MKD S24 BT

Aspen 16" N29E 24.7' " S13 BT

Spruce 7" N80W 52.3' " S19 BT

Spruce 8" S41W 17.93' " S23 BT

6/27/61 R.H. McDonald

R9-5680-11 gll
CERTIFICATE FILED

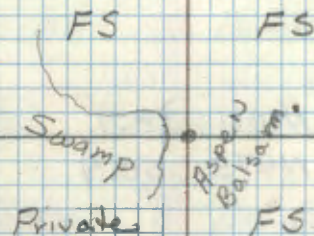

23

24

Placed FS. Metal location poster on a 5" Balsam from which Cor. bears East 13.0'

12-12-61
OK

R.H. McDonald

See T148N R25W BK4 pg 23

9

1/4 Cor. Sec. 13-24

Orig. notes: Fir Post

Birch 5" N20W 5 LKs

Aspen 8" S31W 15 LKs

DEC 2-4 1919 L.W. JOHNSON JESSE LAKE TOWN ROAD
SURVEY.

BIRCH 13" N60W 38.9

ASPEN 15" N67E 50.4

1926 L.W. JOHNSON ITASCA CO SURVEYOR. PLAT OF
SEC 24 SUBDIVISION.

PLAT SHOWS SYMBOL OF ORIG GOV CORNER Fd.

OCT 12
1931 ITASCA CO TOO MUCH LAKE ROAD SURVEY

GOVT PINE STD 14" N59W 39.1

ASPEN 17" N66E 50.7

1989 BELL OSUTSEN UNDER CONTRACT/W/ USFS.
SUBDIVISION OF SECTION 12 & 13.R9-5680-11 JHE
CERTIFICATE FILED

1989 CONT

OAK 5" N80W 108.40 FT

ASPEN 8" S59W 113.50 FT

BASSWOOD 12" S89E 28.91 FT

STEEL SIGN POST WEST 16.00 FT

F.S.

Private

F.S.

Private

Co. Road

24

10

1/4 Cor. Sec. 13-14

Orig. Notes: Birch post

Birch 17" NG3E 10 Lks

N. Pine 8" NG6W 18 Lks

R9-5680-11 Jhe
1718N
R25W
CERTIFICATE FILED

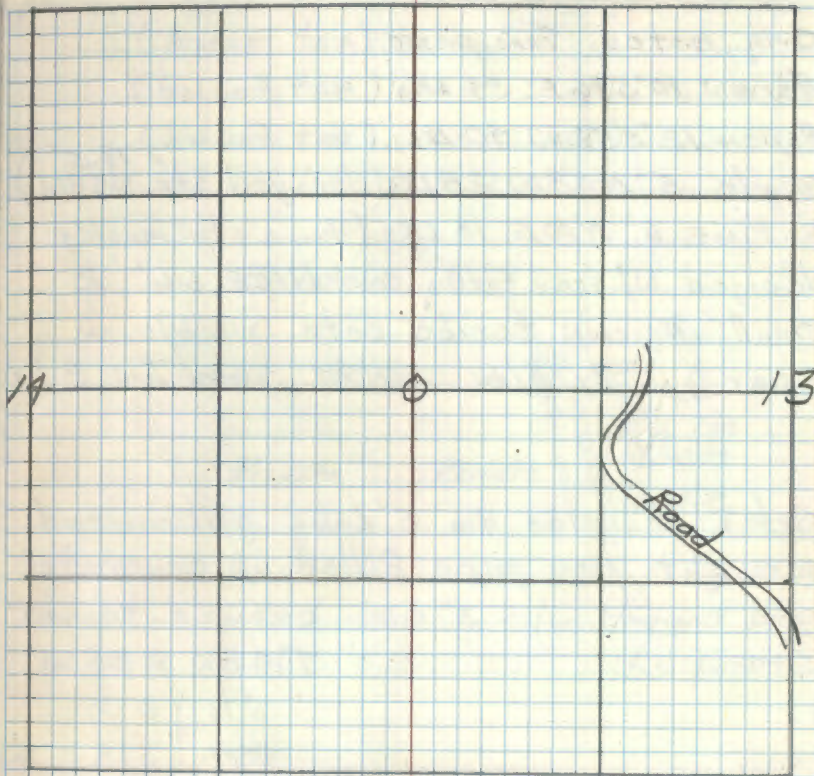

11 Affidavit RHM

Sec. Cor. 11-12-13-14

Orig. Notes: Tam. post (not found)

Aspen 10°S36E 37 LKs (not found)

Aspen 12°S52W 70 LKs (not found) 18.5'

Maple 5°N58W 28 LKs (decayed str. N58W)

W. Pine 6°N10E 10 LKs (Now a str. mostly

decayed w/ scar facing cor. N10E 6.6' 2

small ingrown scribe cuts visible in

scar) 7/18/61 RHM search time 2 hr.

Set a 2" inside dia. 5' Long galvanized
wrought iron pipe filled w/ concrete
and capped w/ a 3" dia. bronze tablet
stamped:

T148N R25W

S11 | S12

S14 | S13

1961

PLS NO 3628

From which bears

Red pine 17°S52°W 88.3' MKD S14 BT

Ash 5°N10W 47.6' MKD S11 BT

Ash 9°N71°E 49.5' MKD S12 BT

Ash 6°S36°E 57.3' MKD S13 BT

12-4-61 R.H. McDonald

R9-5680-11 246
CERTIFICATE FILED

T148N

R25W

Private

Private

Private

Big Too
Moch
Lake

14 Placed F.S. metal location poster
on a 11" Balsam from which cor. bears
S74E 3.2'

IF-28-61
O.K.

R. McDonald

12J-21,22 Affidavit RHM

M.C. Sec. 12-13 West bank Big Top Mch

Orig. Notes: Cedar Post

ELm 12" N74W 60 LKs

ELm 8" S80W 8 LKs

Found GLO Brass cap

Stamped:

W.C.
7148N
S12/MC
S13
R25W
1948

From which bears:

Cedar 20" S7°W 38.25' MKD MC BT

6/14-61 RHM McDonald

Survey by B.L.M. October 1948

Set the above cor. monument from which

Cedar 18" S8°W 58 LKs or 38.25' - OK

ELm 8" N36½°W 135½ LK or 89.43'

To perpetuate this corner I marked new

Bt - Fish 5" N40°E 20.7' MKD x BT

Set a 4" x 4" x 6.5' Cedar post painted-treated w/
red top west 1.75'

12-4-61 RHM McDonald

R9-5680-11 etc
CERTIFICATE FILED
7148N 12 R25W

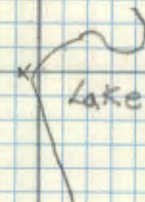

13
F.S. Postor is on a 12" ELm from which
Cor. bears N70W 4.0'

13 J-24, 25

M.C. Sec. 12-13 west bank of Boggy Lake

Orig. notes: Tam. post.

Tam. 6" N70W 26 Lks.

Tam 6" S38°W 40 Lks.

Searched 4 man hours no evidence found

7/28/61 RSM

B9-5680-11 H8=1
CERTIFICATE FILED

TITON

12

R25W

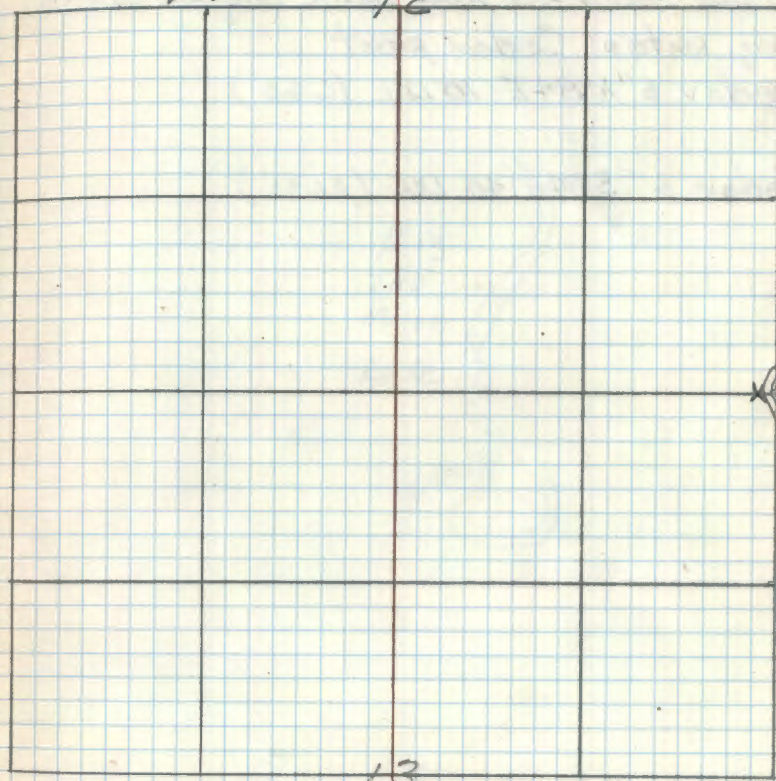

13

17

M.C. Sec. 12-13 East bank Big Too Much

Orig. notes: Cedar post

Cedar 6" NB4E 10 Lks. (6.60')

Cedar 6" S39E 40 Lks. (26.40')

T148N

12

R25W

Big
Too
Much
Lake

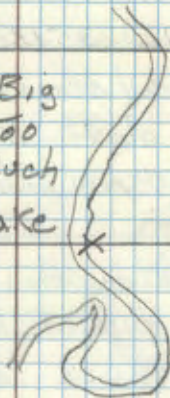

13

15 6-2 Affidavit RHM

1/4 Cor. Sec. 11-12

Orig. notes: Tam. post (Not Found)

Cedar 14" N9E 16.4Ks or 10.56' (Now a decayed cedar stp. N31W 10.56')

Spruce 10" N61W 35LKs or 23.10' (Now a 15"

Spruce stub w/ scribe "BT" visible & a window blaze above N70W 23.10')

Search time 4 man hours 8/1/61 RHM & W.M.M.

Set a 2" inside dia. 5' Long galvanized wrought iron pipe filled w/ concrete & capped w/ a 3" dia. bronze tablet stamped:-

T148NR25W

1/4

S 11 S 12

1961

RLS NO 3628

Cedar 9" N18°W 75.1' MKD 1/4 S 11 BT

Cedar 7" S77 1/2°W 26.4' MKD 1/4 S 11 BT

Cedar 10" S2°W 38.9' MKD 1/4 S 12 BT

11-30-61 RHM & Donald

CERTIFICATE FILED

1148W

R25W

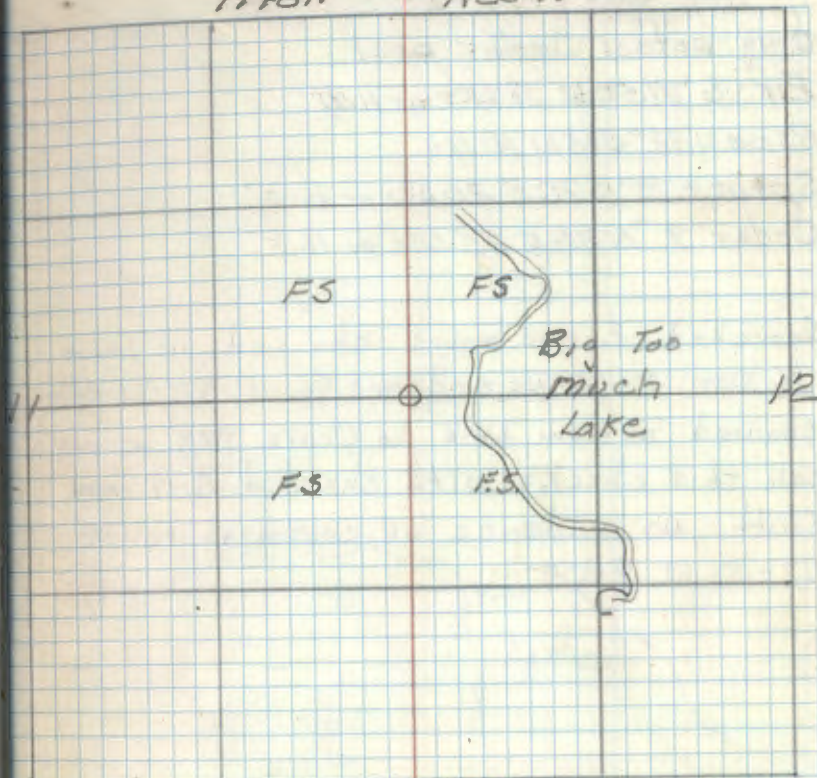

Placed F.S. Metal Location poster on a 7" Cedar from which cor. bears N78E 26.4'

12+28-61
S.K.

R. O. [Signature]

16 E-24

Sec. Cor. 1-2-11-12

C Orig. notes: Cedar post

C Fir 6" N50W 18 LKs or 11.88'

C Aspen 12" S15W 10 LKs

S Spruce 8" S70E 20 LKs or 12.2'

S Cedar 9" N38E 25 LKs or 16.5'

S Searched 2 man hours - chained in from
W 1/4 Cor 11-12 No evidence found 8/1/61 RH24
S Chained in from Lake La Croix 109' as per
U call this checks with chained dist from
S South - no evidence of cor. was found
12-5-61 RH24

R 9-5680-11 JAC

CERTIFICATE FILED

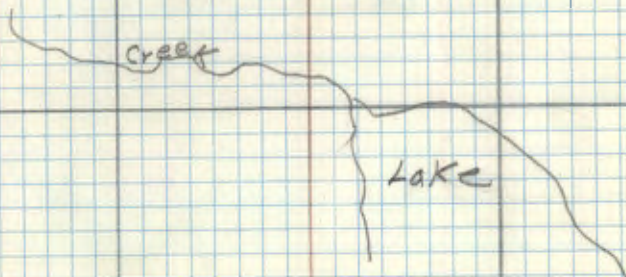

11/29/73 C. KRAUSE

Fd. 1 1/4" I.P. WITH ALUMINUM CAP 30" ABOVE GROUND
SET BY ITASCA COUNTY

BIRCH 7" S48W 766

BIRCH 7" NORTH 4361

BASSWOOD 7" S 72E 2860

PLACED TAGS ON COUNTY BTS

17

1/4 Cor. Sec. 1-12

Orig. notes: Cedar post

Birch 8" N5E 11 Lks

Birch 10" S11W 18 Lks

R-9-5680-11 Jhe

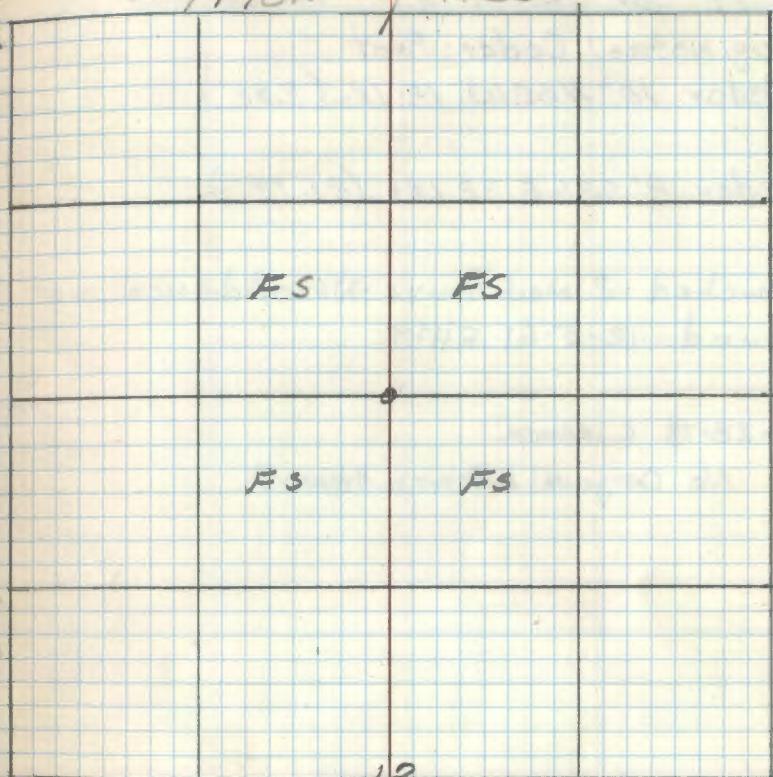
CERTIFICATE FILED

19

Closing Cor. Sec 1-2 1.70 ch. W. of Std. Cor.

Orig. notes: Aspen post

Birch 7" S 21 W 15 LKs

Spruce 9" S 18 E 27 LKs

R 9-5680-11 Hk

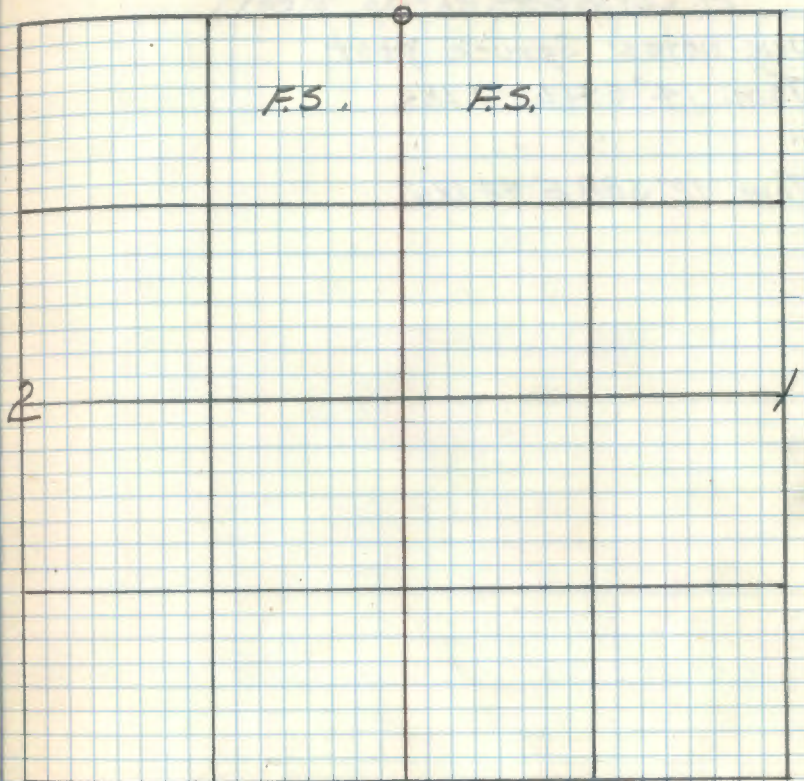

20

1/4 Cor. Sec. 26-35

Orig. notes: Spruce post

Tam. 14" S 41 W 7 Lks.

Tam. 12" S 88 E 92 Lks.

T148N

R25W

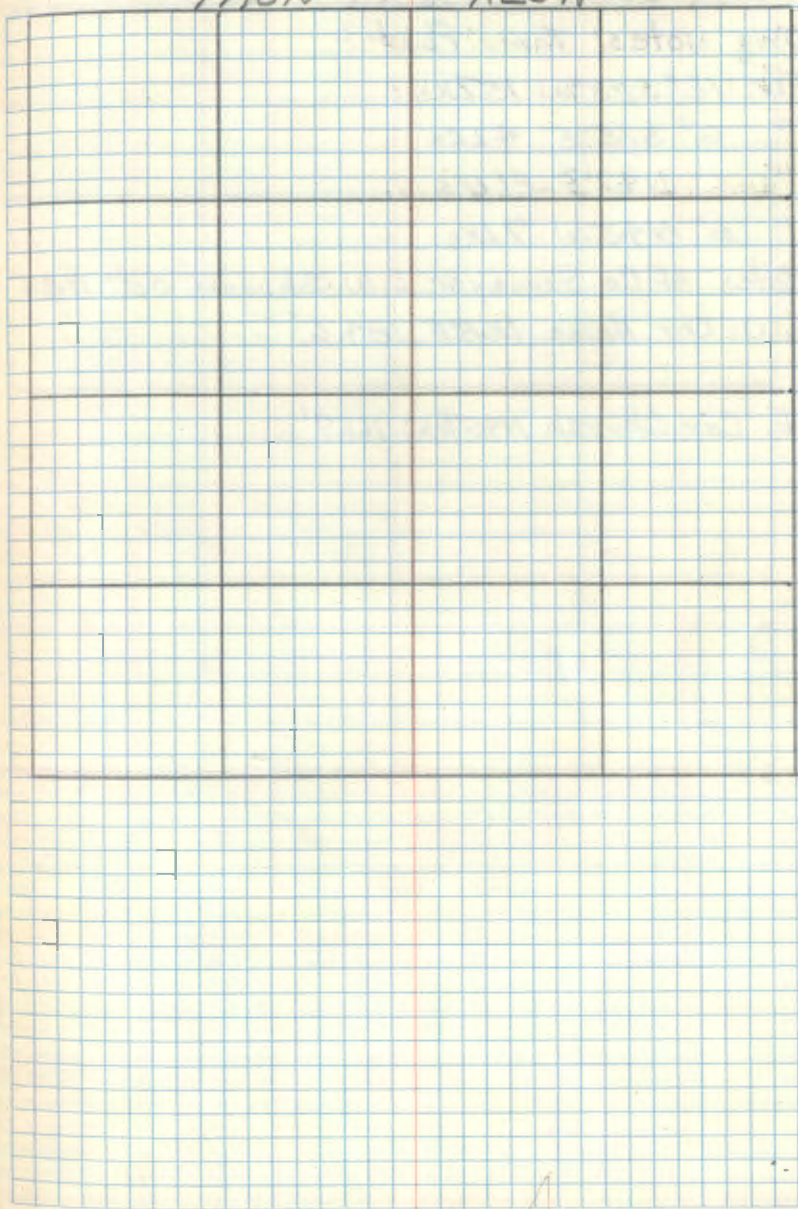

Sec. Cor. 26-27-34-35

Orig. Notes: Tam. Post

Fir 12° 52' 3" W 15 Lks

" 6" S 15° E 4 Lks

" 6" N 97° E 21 Lks

" 6" N 43° W 7 Lks

Notes of Co. Surveyor L. W. Johnson Oct. 1929

S.W. Cor. House N 68° E 189.6'

SE. Cor. Church N 95 1/2° W 161.7'

T148N

R25W

| | | | |
|--|--|--|--|
| | | | |
| | | | |
| | | | |
| | | | |

22

M.C. Sec. 34-35 North bank Jessie Lake

Orig. notes: Elm post

Willow 12" N6E 214s

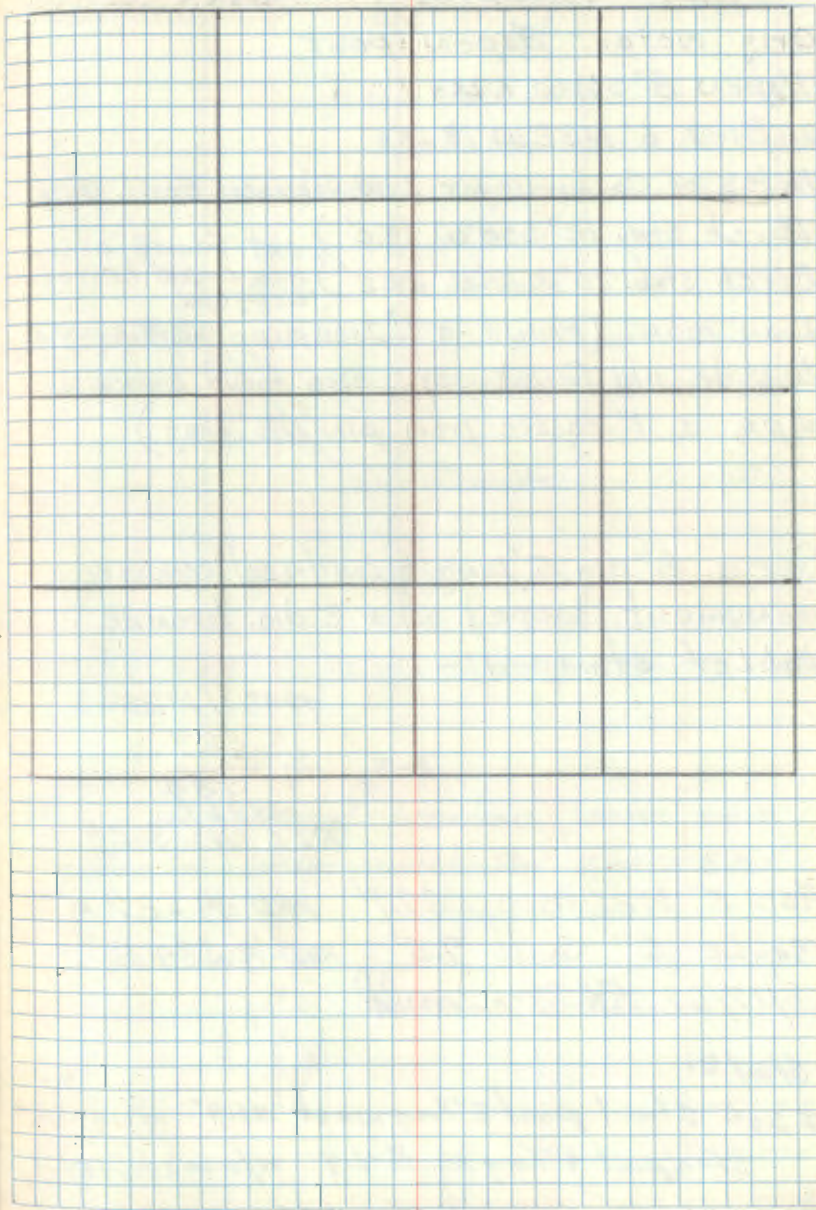

23 V-15 Affidavit RHM

1/4 Cor. Sec. 27-34

Orig. Notes: Aspen post

Aspen 8" S61W 6 LKs

W. Birch 6" N32W 13 LKs

Notes of Co. Surveyor L.W. Johnson April 1926

Birch str. 12" S08°W 15.0' } Not found area
Birch stub. 10" S25E 29.2' } has been heavily
tagged.

Iron mon. (Found a 1" Iron pipe marking cor.
beside old fence cor. also found buried beside
pipe a 1" square iron pin 12" long)

Set a 6" dia 5' long cylindrical concrete
monument capped w/ a 3" dia. bronze
tablet stamped:-

T198NR25W

1/4 527

534

1961

RLS NO 3628

Ash 5" N22 1/2 W 37.1' MKD 1/4 527 RT

Maple 6" South 7.5' MKD 1/4 534 BT

8/17/61 R.H. McDonald

5/6/81

I set steel post 8' long west 51.9' w/sign 54-9

steel post 8' long North 4.4' w/sign 54-2/54-9

RT 7504 by Olson

5/6/81 Ronald Olson

R9-5680-11 916

T198N

27 R25W

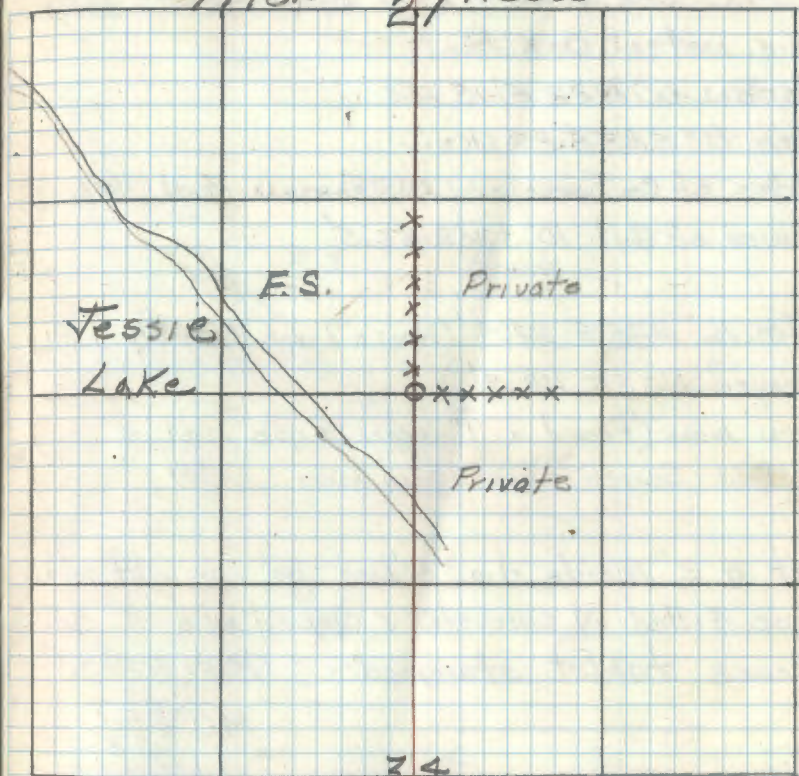

Placed F.S. Metal Location poster on a
12" Aspen from which Cor. bears S75E
15.0'

12-7-61
OK
RAV.

29 V-14 Affidavit RHM

M.C. Sec. 27-34 East bank Jessie Lake

Orig. Notes: Oak Post

Ash 6" N32E 15 Lks

Ash 8" S85E 23 Lks

Notes of Co. Surveyor L.W. Johnson April 1926

Baum of Gil. 10" S30E 56.5'

Elm 16" N25E 112.4' (Now a large Elm stp. badly decayed N32E 112.4')

Iron mon. (Found a 1" iron pipe marking cor.)

8/17/61 Search time 3 man hours RHM

Set a 2" inside dia. 5' long gal. wrought iron pipe filled w/ concrete & capped w/ a 3" dia. bronze tablet stamped:- T198N R25W

M.C. 527
534
1961

PLS NO 3628

From which bears:-

Elm 7" N 10° W 19.1' MKD M.C. 527 BT

Ash 6" S53°E 19.15' MKD MC 534 BT

9/19/61 R.H. McDonald

5/6/81 E cut new BT

Ash 4" N36W 7.08 X BT

Steel post 8' Long East 3.7' w/sign

54-2954-9

Ronald Olsen R9-7150-4 by Olsen

R9-5680-11 JH

T198N 27 R25W

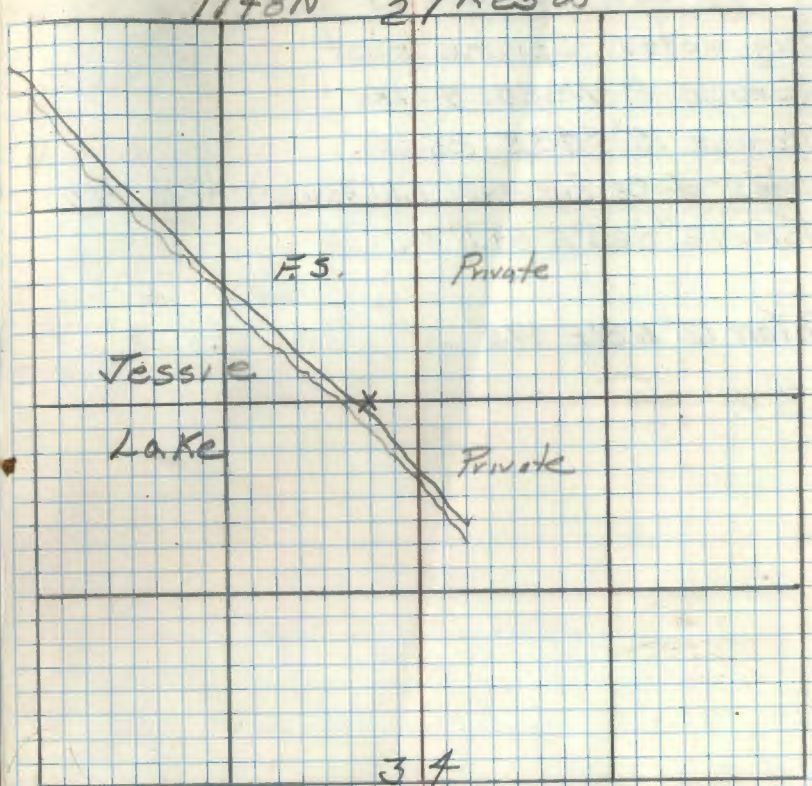

12-7-61
OK
R.G. Weller

25

1/4 Cor. Sec. 26-27

Orig. notes: Spruce post

Spruce 8" N62W 40 Lks

Spruce 15" S78E 25 Lks

Notes of Co. Surveyor L.W. Johnson Oct. 1924

Tom. 12" S26°E 84.0'

D. Tom 12" N80E 47.9'

T148N

R25W

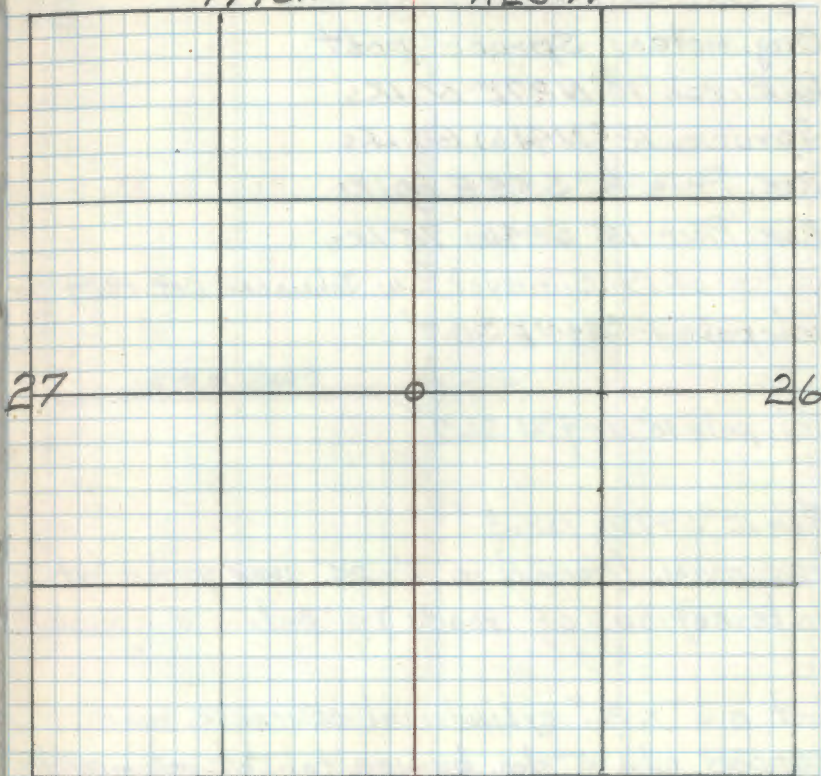

26 p-17

Affidavit RWH

Sec. Cor. 22-23-26-27

Orig. notes: Spruce post

W. Birch 10" N27E 60 LKs

Spruce 12" N41W 60 LKs

BLK. Pine 8" S55E 20 LKs

BLK. Pine 13" S24W 75 LKs

Notes of Co. Surveyor L.W. Johnson Oct. 1924

Tel. pole 8" S44E 30.7'

Tel. pole 10" N44W 26.7'

Ash 12" S47W 133.5'

Iron man. (Found a 1"x24" iron pipe at intersection of roads) 6" below surface)

Set a 6" x 26" cylindrical concrete man. capped w/ a 3" dia. bronze tablet stamped:

T148N R25W

S22/S23

S27/S26.

1961

RLS NO 3628

From which bears

R.E.H. Pole 15" N64E 56.5'

Cedar Post 4"x4"x6.5' S43W 49.1'

Cedar Post 4"x4"x6.5' N59W 33.4'

Posts are penta-treated w/ red tops

7/18/61 R.H. McDonald

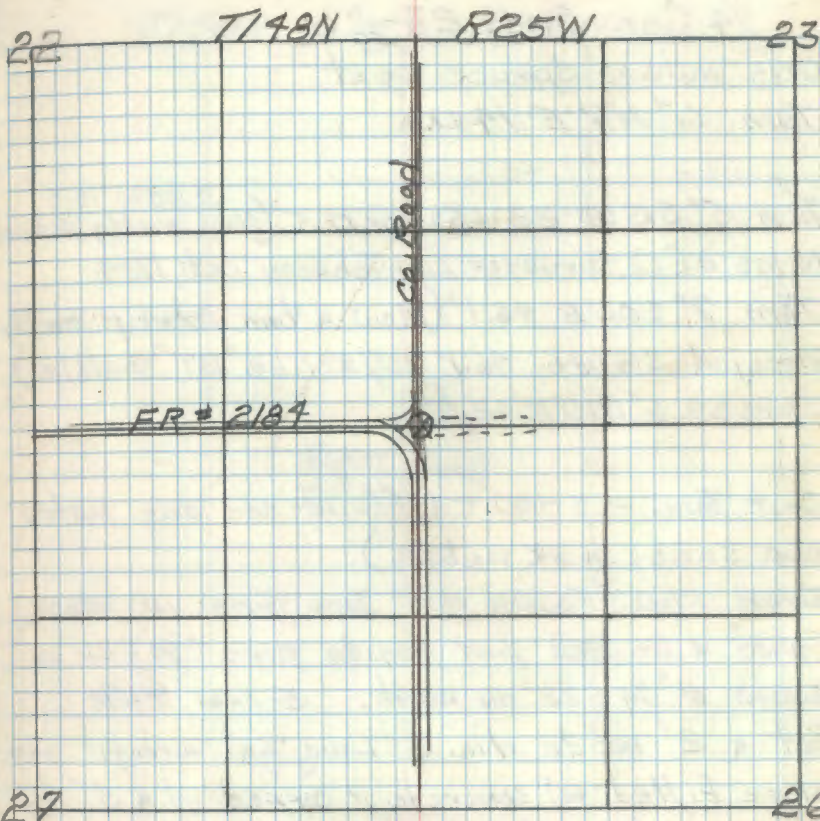

Placed R.E.H. post on the cedar post from which cor. bears N43E 49.1'

27 R-19 Affidavit RHM

1/4 Cor. Sec. 23-26

Orig. Notes: Spruce post

Tam. 6" N7°E 14 Lks.

Tam. 5" S13W 22 Lks. or 17.5' (^{S 20°W 14.5'} Now mostly decayed)

Notes of Co. Surveyor L.W. Johnson Oct. 1924

Tam 7" S05E 46.1' (Now a tam stump mostly decayed south 46.1' w/scribe "BT" visible)

Spruce 6" N10°E 62.2'

Gait Tam. - S-W - (Found - see orig. notes one scribe mark visible)

Iron Mon. (Found a 1" Iron pipe in place)

Found a scribed post beside pipe "1/4 S26" on south & "1/4 S23" on north. 5-1-61 RHM

Set a 2" inside dia. 5' Long gal. wrought iron pipe filled w/ concrete & capped w/ a 3" dia bronze tablet stamped: - T198NR25W

1/4 S 23

S 26

1961

RLS NO 3628

Tam. 11" N53E 44.2' MKD "1/4 S 23"

Post, Cedar - Penta-treated 4" x 4" x 6.5'

North 2.8' 9/18/61 RHM Donald

R9-5680-11 212

T198N

23

R25W

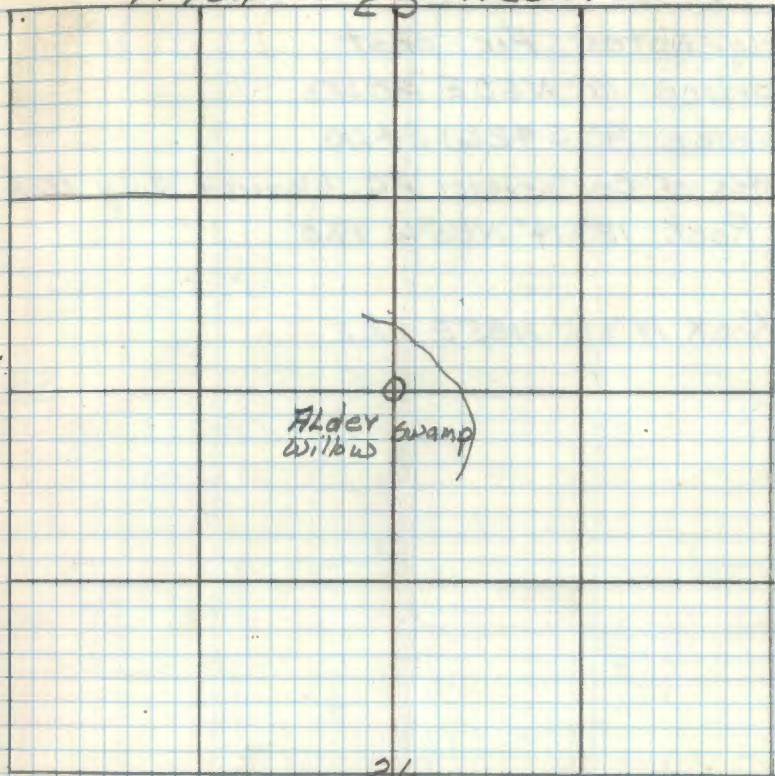

Placed F.S. Location poster on a 11" Tam from which cor. bears S53°W 44.0'

12-7-61

OK

R. G. Willson

28.

1/4 Cor. Sec. 22-23

Orig. notes: Fir past

Spruce 10" N60E 30 LKs

Spruce 8" S42W 34 LKs

Notes of Co. Surveyor P.C. Warner July 1928

+ Rock 12"x14" N85°W 17.0'

+ Rock 14"x16" N85°E 18.2'

T148N

R25W

22

23

Co. Road

29

Affidavit RHM

N-17

Sec. Cor. 14-15-22-23

Orig. Notes: Spruce post

Spruce 8" S30E 21 LKs

Spruce 6" S64W 18 LKs

" 7" N3E 6 "

" 6" N40W 20 "

Notes of Co. Surveyor R.G. Warner July 1928

Tam. 6" N98°E 53.9'

Cedar 12" S15°W 115.7 (Now a Cedar stump
w/ scribe "S22 BT" visible S25°W 115.7')Corner was found to be marked w/ a squared scribed
cedar post.

7-28-61 RHM

Set a 6" dia. 5' long cylindrical concrete
monument capped w/ a 3" dia. bronze tablet
stamped:-

T198N R25W

S15/S14

S22/S23

1961

RLS No 5628

Tam 6" N23W 87.4 MKD S15 BT

ELM 6" S79°W 55.1 MKD S22 BT

Cedar post 4" x 4" x 6.5' pent-a-treated
w/ red top N78½E 6.8'

6/13/61 RHM Donald

R9-5680-11 810

15

T198N

R25W

19

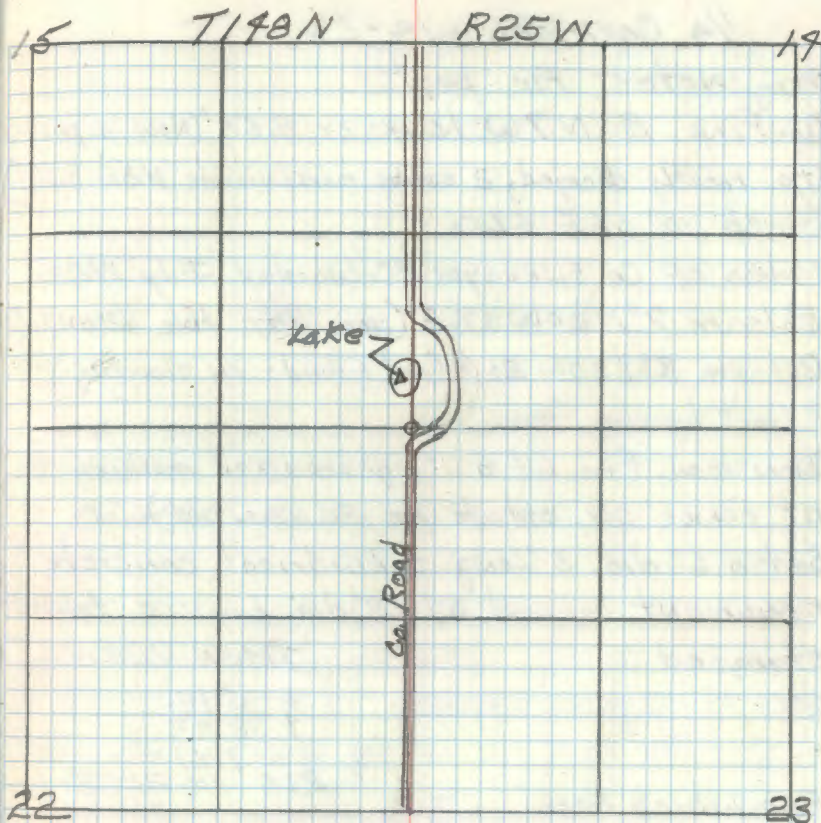

22

23

12-12-61
OK

R.G. Warner

1/4 Cor. Sec. 14-23

Orig. Notes: Fir post

W. Pine 8" N7W 13.4Ks or 8.58' (Now a pine
stp. mostly decayed, 2 scribe marks visible N3W 8.58')

Birch 10" S6E 6Lks

Notes of Co. Surveyor P.C. Warner July 1928

Balsam 7" N20W 17.6' (Now stp. Hole N20W 17.6')

Balsam 8" S30W 21.7' (Not Found - in clearing)

2 Gov't bearing trees

Iron man. (Found a 1" sq. iron rod marking cor.
at fence cor. est. to be 30 yrs. old)

Set a 6" dia. 5' long cylindrical concrete
manument capped w/ a 3" dia. bronze tablet
stamped

T148N R25W

1/4 S14
S23
1961

RLS NO 3628

From which bears

Elm 11" N64°E 85.6' MKD "BT"

Cedar Post 4" x 4" x 6.5' penta treated & w/
red top North 2.23'

6/13/61 R.H. McDonald

T148N 1/4 R25W

Private FS.

XXXXXXXXXXXX

Field Pasture
Private Private FS

23

Placed FS. metal location poster on a
9" Birch from which cor. bears West 38.8'

12-12-01
OK
R.A. Walker

1/4 Cor. Sec 14-15

Orig. Notes: Tam. post
Tam. 8" West 12 Lks

Fir 6" S46E 15 Lks.

1967 L.L.TWP NOTES Pg 26

MAPLE 9" S43°E 39.21

ANCHOR POLE S20°W 51.05

6-22-89 ITASKA COUNTY

SET 3/4" PIPE IN NORTH SOUTH MAIN ROAD

MAPLE 12" S36°W 96.53 SPK & WASHER

R PINE 5" N51W 43.73 " "

R PINE 4 1/2" N49°E 45.40 " "

T148N

R25W

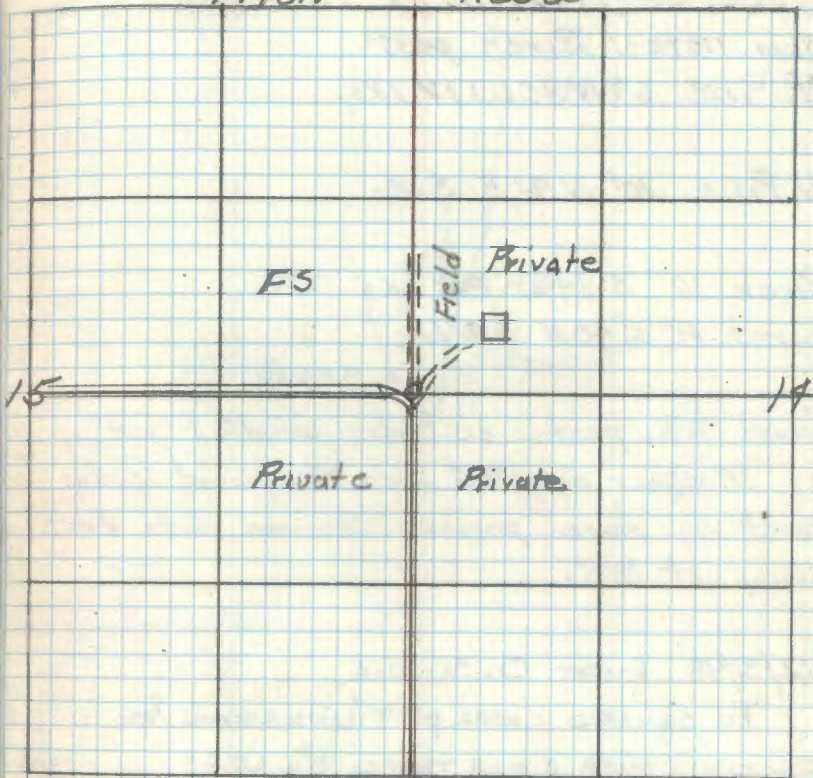

Sec. Cor. 10-11-14-15

Orig. Notes: Birch post
N. Pine 6" N30W 17 Lks.

W. Pine 10" N9° E 8 Lks

Birch 10" S 14W 22 Lks

Birch 8" S 40E 24 Lks

Found FS. poster on Cedar windfall put up
by Meagher in 1935 also a squared cedar
post by same person. Chained North cont.
Swamp 9+ 1900'.

12/31/48 ROBERT O. Schaar

Fd SQUARED CEDAR POST UNSCRIBED FOR
SECTION CORNER PLACED THERE BY USFS:

USFS Tag ON FALLEN CEDAR 25 FT NE FROM CEDAR
POST

T148N

R25W

10

11

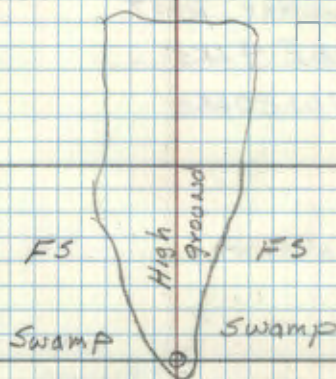

FS

FS

Swamp

Swamp

FS

Private

15

14

1/4 Cor. Sec. 11-14'

Orig. Notes: Cedar post

Birch 6" S26E 44ks

" 10" N21W 20ks

T14BN 11 R25W

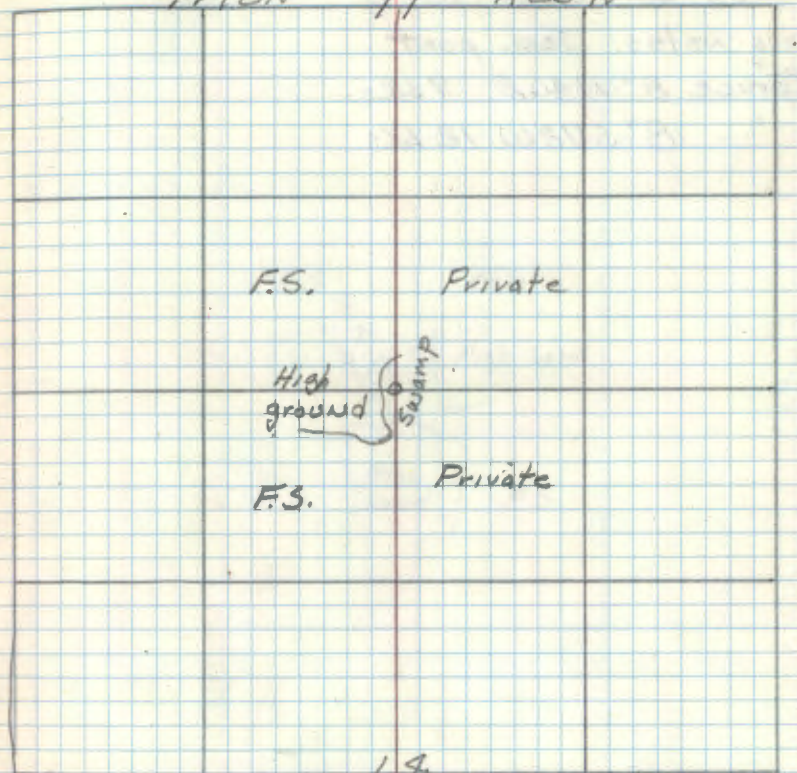

34

1/4 Cor. Sec. 10-11

Orig. notes: Tam. post

Spruce 8" N40E 74s

" 8" S72W 124s

R9-5680-11 JH

T148N

R25W

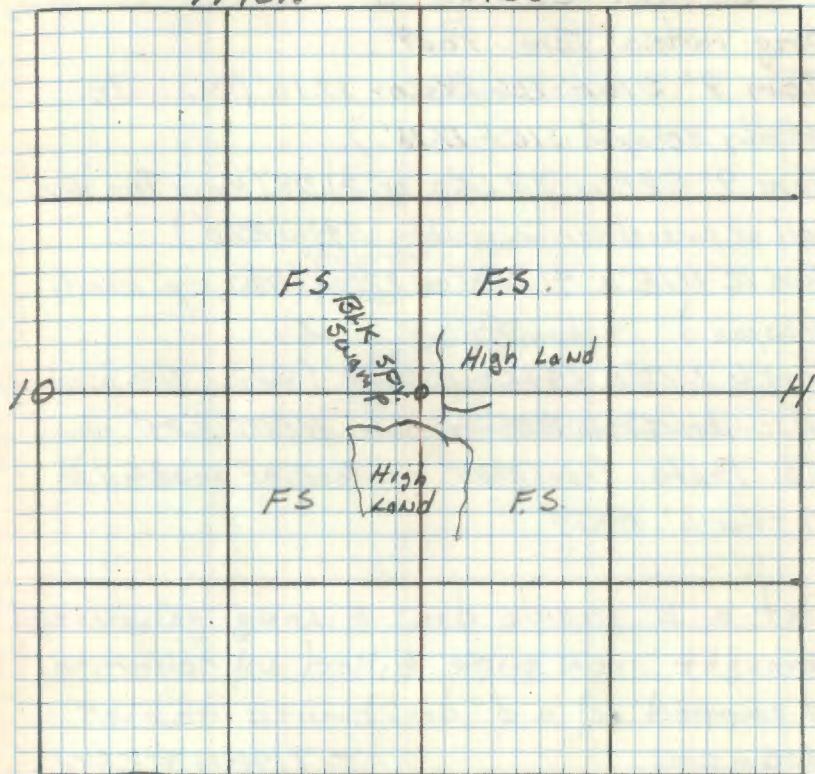

Sec. Cor. 2-3-10-11

Orig. Notes: Tam. Post

Tam 9" S16E 26 LKs or 17.16' (Now a stp.
mostly decayed S16E 17.16')Tam 9" S22W 33 LKs or 21.78' (Now a Tam wind
fall w/ partial scribe visible S71W 27.0')Tam 12" N18W 91 LKs or 27.06' (Now stp. mostly
decayed)Tam 6" N50E 14 LKs or 9.24' (Now a Tam. wind fall
w/ scribe "T198 R25" visible N50E 9.24' also
F.S. Poster from 1935 on face of wind fall)

4-26-61 RHM

Set a 2" inside dia. 5' Long galvanized
wrought iron pipe filled w/ concrete
& capped w/ a 3" dia. bronze tablet
stamped

T198N R25W

S3 | S2

S10 | S11

From which bears:

RLS¹⁹⁶¹ No. 3628Elm 6" N39¹²E 21.6' MKD S2 BT

Ash 13" N31W 36.4' MKD S3 BT

Cedar post 4"x4"x6.5' penta-treated w/
red top West 2.45' N75W

12-9-61 R.H. McDonald

Private

FS Beaver Pond FS
Aspen & Birch

Alder swamp

Private

FS

FS

Placed F.S. metal location poster on a 7"
Elm from which cor. bears S39W 21.6'R.H. McDonald
10-5-63

36 E-19

1/4 Cor. sections 2-11

Orig. notes: W. Birch post

Birch 8" N25°W 8 LKs

" 12" S11°E 28 LKs

Searched 1 man hour no evidence of BTs
was found. can be tied in from lake but
no N-S ties. 12-4-61 RHM

T148N

R25W

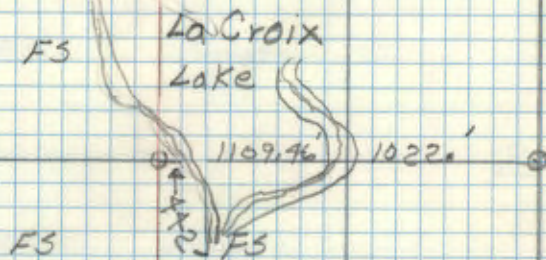

37

1/4 Cor. Sec. 2-3

Orig. notes: Spruce post

Spruce 8" N87E 64Ks

" 7" N50W 124Ks

T148N

R25W

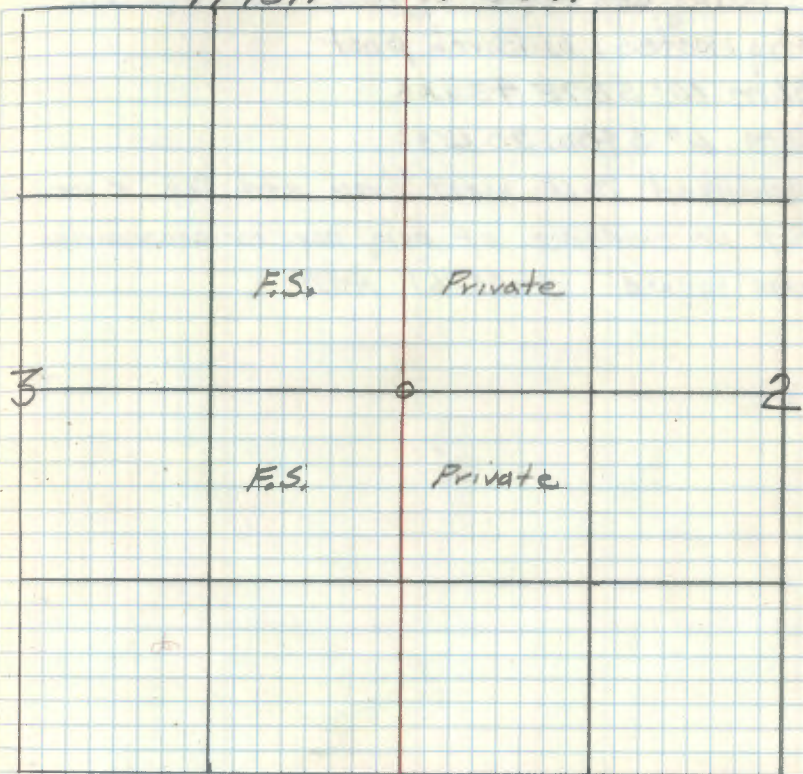

38

A-17

Closing Cor. Sec. 2-3 70Lks west std. Cor.

Orig. notes: W. Birch post

ELM 10° S 27° E 43 Lks

ELM 6" S 40° W 30 Lks

Measured 70 Lks west from std. Cor. & searched,
 but no evidence of orig. cor. or accessories
 was found 7-25-61 RHM

R956.80-11 H.W.

T198N

R25W

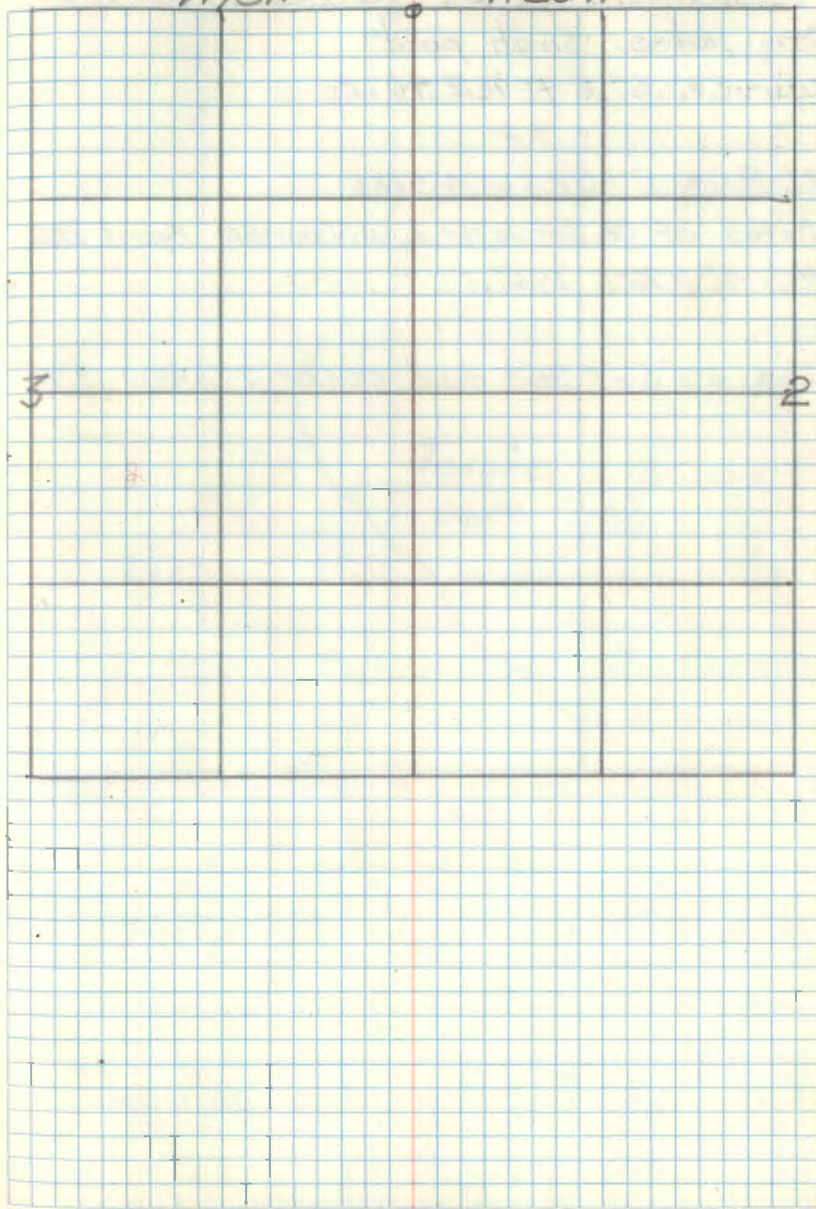

39

M.C. Sec. 33-34 South Bank Jessie Lake

Orig. Notes: Birch post

Spruce 6" S 42½° E 40 Lks

N. Pine 8" S 23° W 43 Lks

Notes of Co. Surveyor L.W. Johnson April 1926

Fish 4" N 76° E 10.6'

Iron 22' S of Gov't dead cedar 7" S 85° W 13.7'

CERTIFICATE FILED

T178N

R25W

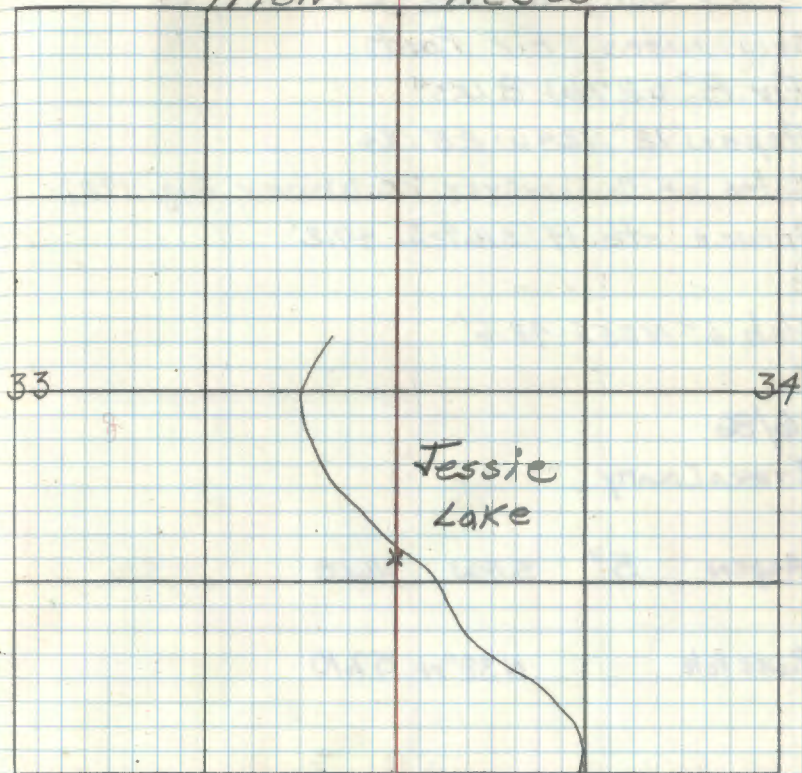

40

1/4 Cor. Sec. 22-27

Orig. Notes: Fir Post

Fir 8" S27W 84ks

Aspen 12" N24W 254ks

Notes of Co. Surveyor P.C. Warner Aug. 1921

Spruce stb. 14" S16 1/2 W 49.2'

Ash 6" N25E 42.6'

6/86

ITASCA COUNTY

ASPEN 5" S18W 46.05

POWER POLE N38°W 57.10

6/1989 ITASCA COUNTY

ASH 10" S21°E 101.05 SPK/W/WASHER

ASH 6" N28°E 105.08 SPK/W/WASHER

R9-5680-11 JMW

22

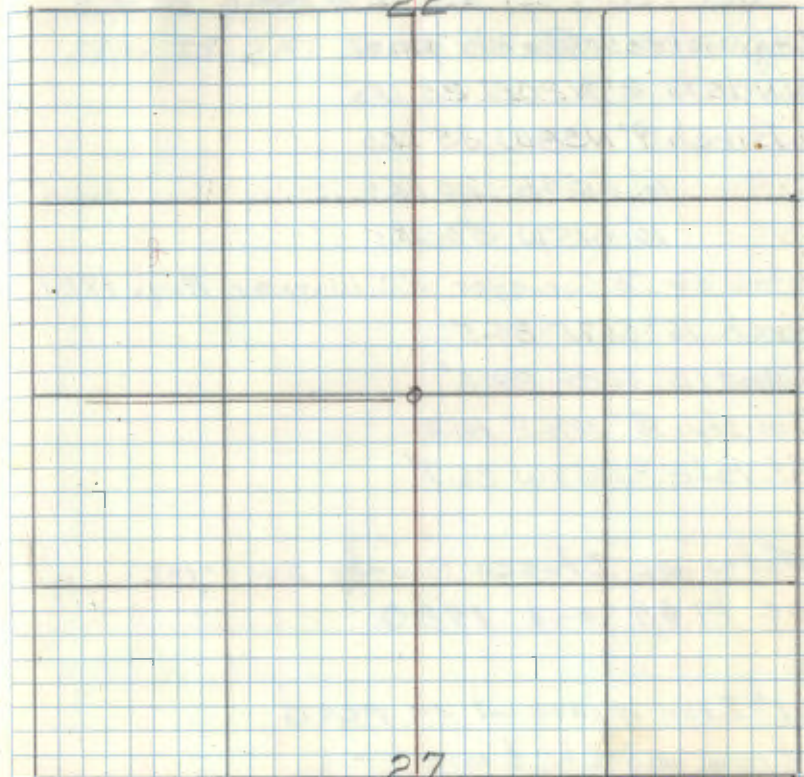

27

71 R-13

Sec. Cor. 21-22-27-28

Orig. notes: Birch post

Linden 6" N20E 25 LKs

W. Birch 9" N58W 35 LKs

" 6" S54E 30 LKs

" 10" S15W 50 LKs

Notes of Co. Surveyor P.C. Warner Aug. 1921

Birch 16" S67E 84.5

B. Wood 12" South 29.2'

Elm stp. 18" N76E 101.3'

Tel. Pole - N53W 26.7'

Notes of Itasca County surveyor
of 1968 and 1980

1" Iron monument in road

From which bears

Ash 4" N37W 34.14' Now 7" COSPK

Tel. Pole N70E 80.32 GONE

Basswood 9" S9W 75.57 GONE

P. Pole S58E 55.49

Ash 8" N38W 30.27 Now 10" COSPK

Cedar Post 4"x4" South 28.5' GONE

Monument and BTE are in good condition

5/6/81 Arvid Olesen

RA-7150-4 by Olesen

R9-5680-11 JWB

6-20-05 RMAIN

IRON IS 2 FT SOUTH OF NORTH RD EDGE.

1925 J. Schwartz Sec Subdivision of
SECTION 27 USED SAME TIES AS P.C. WARNER

1/4 Cor. Sec. 27-28

Orig. notes: Birch post

W. Birch 18" N51E 64ks

Cedar 15" S62W 75Lks

Notes of Co. Surveyor L.W. Johnson June 1925

ELM 24" N05E 13.9' (Now a 39" ELM with broken
Top N9°E 13.9' Scribe grown over)

ELM 12" S11W 119.0' (Now elm stump & windfall
S18°W 119.0' to blaze on str.)

Iron monument (Found 1" Iron pipe marking Cor.)
4-13-61 RHM

Set a 6" dia. 5' long cylindrical concrete
mon. capped w/ a 3" dia. bronze tablet
Stamped:-

T198N R25W

1/4

S28 | S27

From which bears:

1961
PLS NO 362B

ELM (TWIN 20") S37E 32.2' MKD 1/4 S27 BT

Ash 8" S83°W 35.1' " 1/4 S28 BT

Ash 9" N5°W 24.2' " 1/4 S28 BT

6/1/61 RHM Donald

Steel sign post 72" long w/ F.S. standard

signs 54-2 & 54-4 attached set North 3.4'
4-24-61 RHM

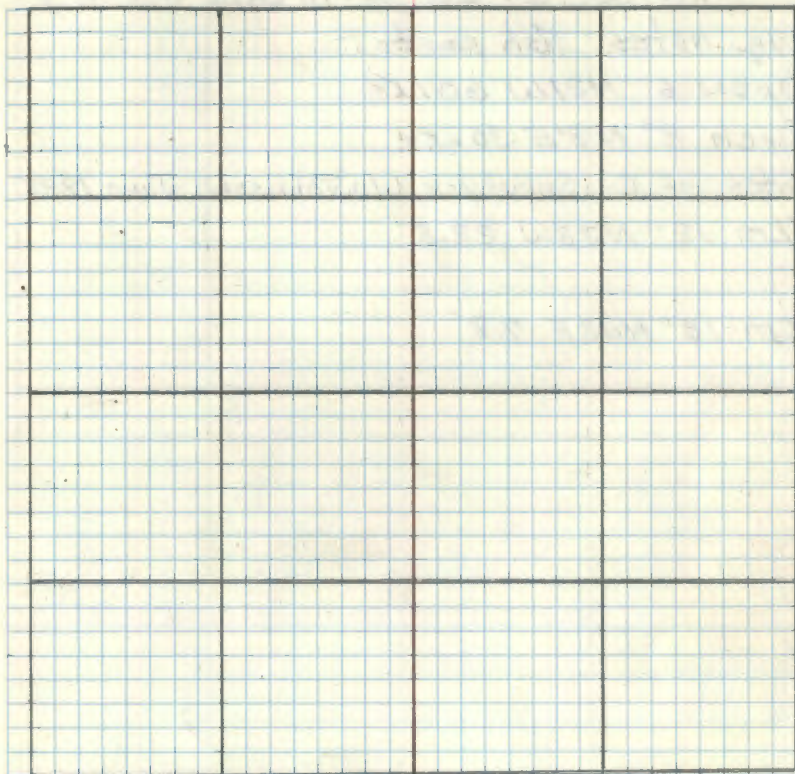

Placed F.S. Location poster on a 7" Ash from
which cor bears N83°E 35.0'

12'-6"
OK
RAV

43

M.C. Sec. 27-28 North bank Jessie Lk.

Orig. notes: Ash post

Aspen 6" N21W 60 LKs

Birch 8" N3°E 30 LKs

Notes of Co. Surveyor L.W. Johnson June 1925

ELM 12" N32W 22.8'

ELM 12" N63E 2.8'

R9-5680-11 H

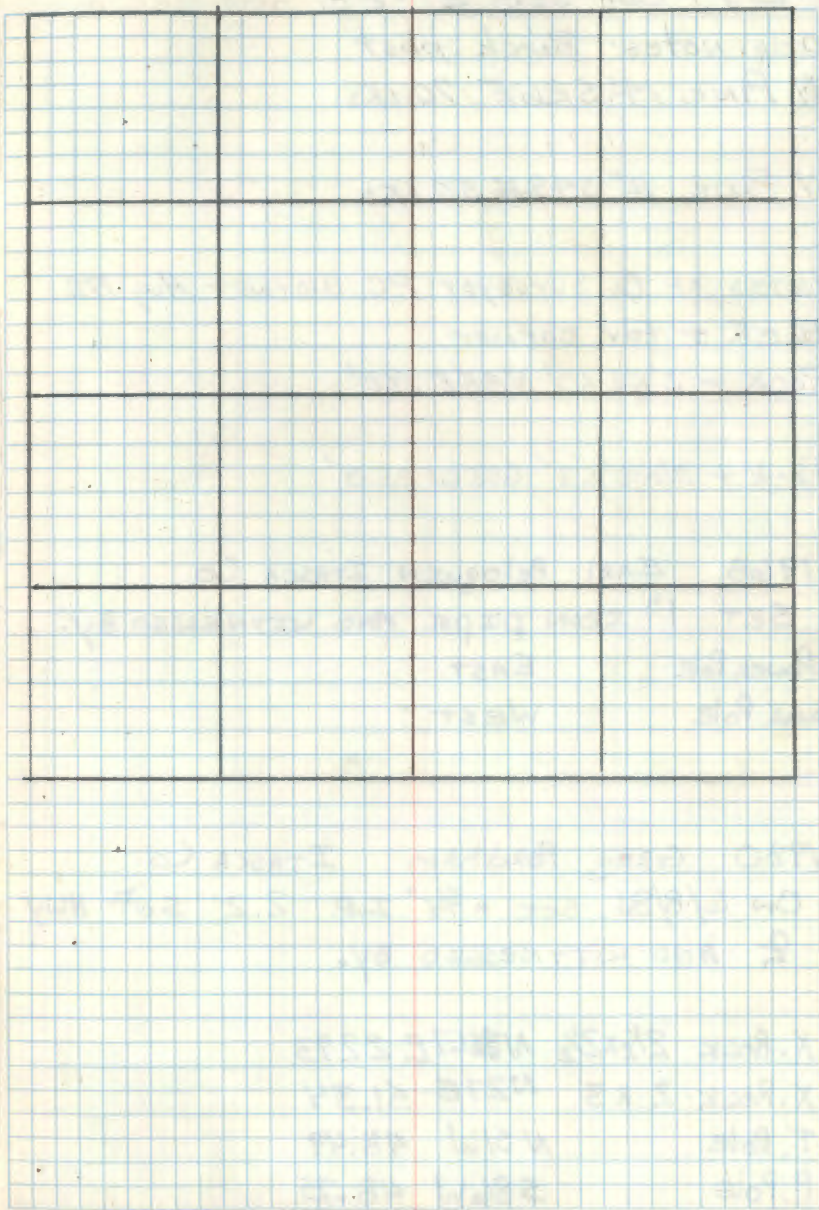

44

P-13 1/4 Cor. Sec. 21-22

Orig. Notes: Birch post

N. Pine 14° S26E 70 LKs

N. Pine 16° S49E 50 LKs

Notes of Co. Surveyor P.C. Warner Aug. 1921

Rock + for corner

Rock + 2'x2'x3' N85E 19.0'

Rock + 2'x2'x3' S55W 25.3'

1968 EARL PELQUIN ITASCA CO

SET 1" IRON PIPE AND WITNESSED BY:

POWER POLE EAST

POWER POLE WEST

1980 GREG FORDHAM ITASCA CO

ON 6/8/81 SET A 3/4" I.P. 2.2' S OF HWY

& AND WITNESSED BY.

X. ROCK 2 1/2 x 2 1/2 N 67E 22.93

X. ROCK 2 x 3 N 27E 51.34

T. POLE N 51W 48.49

P. POLE S 86W 48.75

R9-5680-11 ME

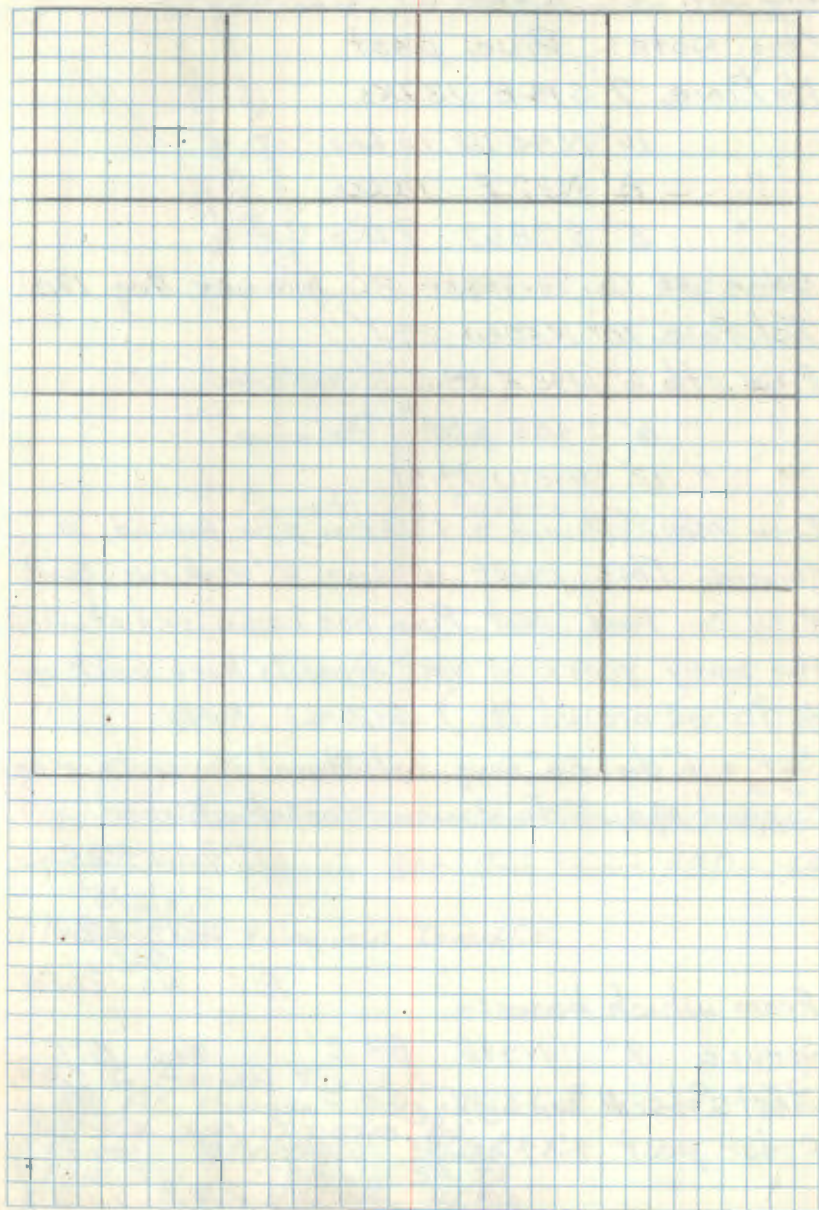

45

Affidavit RHM

N-13 Cor. Sec. 15-16-21-22

Orig. Notes: Pine post

N. Pine 7 S14E 13 LKs

" 10" N45W 16 LKs

" 8" N37E 10 LKs

" 5" S78W 7 LKs

Notes of Co. Surveyor P.C. Warner Aug. 1981

Tel. Pole 10" N50W 24.1'

Pine stb 6" N45E 34.5'

" " 6" S40E 61.4'

" " 12" N65W 84.4'

Iron man. (Found a 1" Iron pipe buried in ground. This point in line w/ Highway South & W/ Co. Road West Pipe has been undisturbed for many years as rust deposits have built up to 1/2" all around it.) 5-3-61 RHM

Set a 6" dia. 26" long cylindrical concrete man. capped w/ a 3" dia. bronze tablet stamped:

T148N R25W

516 | 515

521 | 522

RLS NO 3628

From which bears:-

Spruce 9" N49E 88.2" MKD "B.T."

REF Pole 11" S60W 54.7'

Cedar post 4' x 4' x 6.5' N50W 2.13'

" " " " " S39 1/2 E 22.8'

7/6/61 R.H. McDonald

clearing for roads & utilities have obliterated B.T.s

5856

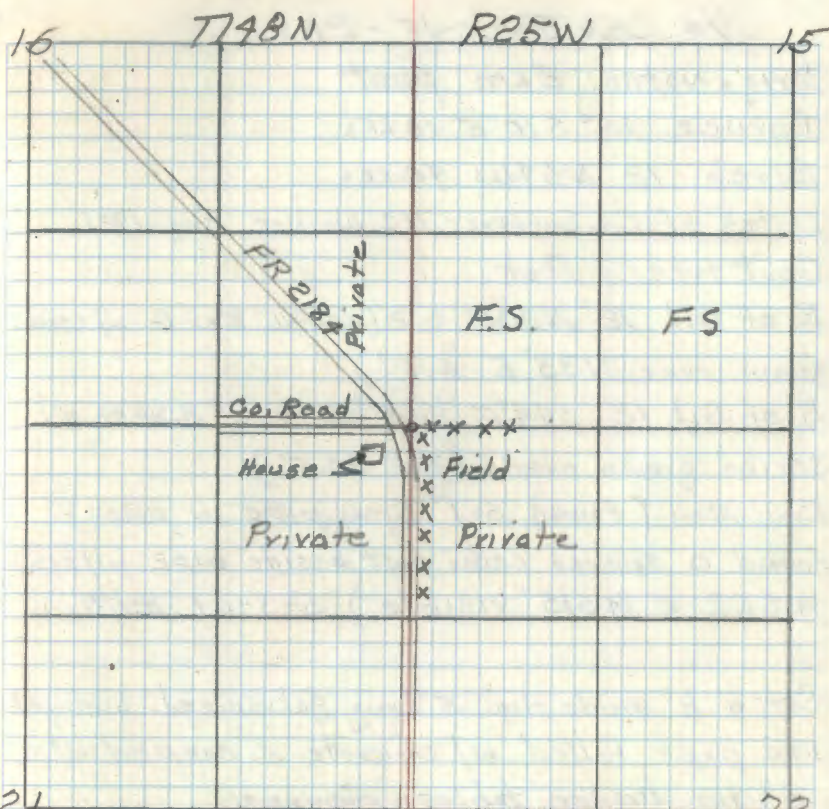

21

22

Placed F.S. Metal Post on fence corner post from which Sec. Cor. bears N85W 14.8'

1968 EARL PELAGUEN ITASCA CO.

1980 G. FOREHAM ITASCA CO.

FL F.S. MONUMENT 1/2" ON GROUND RESET 2" BELOW SURFACE AND WITNESSED BY:
 R. PINE 9" N54E 56.75
 P. POLE 50S W 58.25
 X ROCK 1X1 N32W 14.86

CONT ON BK #4 Pg 31

46

Affidavit RHH

N-15

 $\frac{1}{4}$ Cor. Sec. 15-22

Orig. Notes: Elm post

Spruce 10" S10°E 10 LKs

Birch 12" N64°W 90 LKs

Notes of Co. Surveyor R.G. Warner Aug. 1921

Gov't trees & Post

B. of Gil. 12" N20°E 6.2' (Now 16" B. of G. w/ scribe
grown over N33°E 6.2')B. of Gil 12" S49°E 20.5' (Now a 16" B. of G. w/
scribe grown over S35°E 20.5')

Iron Mon. (Found a 1" Iron pipe in place)

Found a squared cedar post beside pipe w/ scribe
"1/4 S22 & 1/4 S15" visible) 5-3-61 RHHSet a 2" inside dia. 5' long galvanized wrought
iron pipe filled w/ concrete & capped w/ a
3" dia. bronze tablet stamped:-

T148N R25W

$$\frac{1}{4} \frac{S15}{S22}$$

1961

RLS NO 3628

Ash 10" N83°W 14.6' MKD 1/4 S15 BT

Ash 8" N6°E 23.4' MKD 1/4 S15 BT

B. Spruce 9" S23°E 70.2' MKD 1/4 S22 BT

9/19/61 R.H. McDonald

R 9-5680-11 RHL

T148N 15 R25W

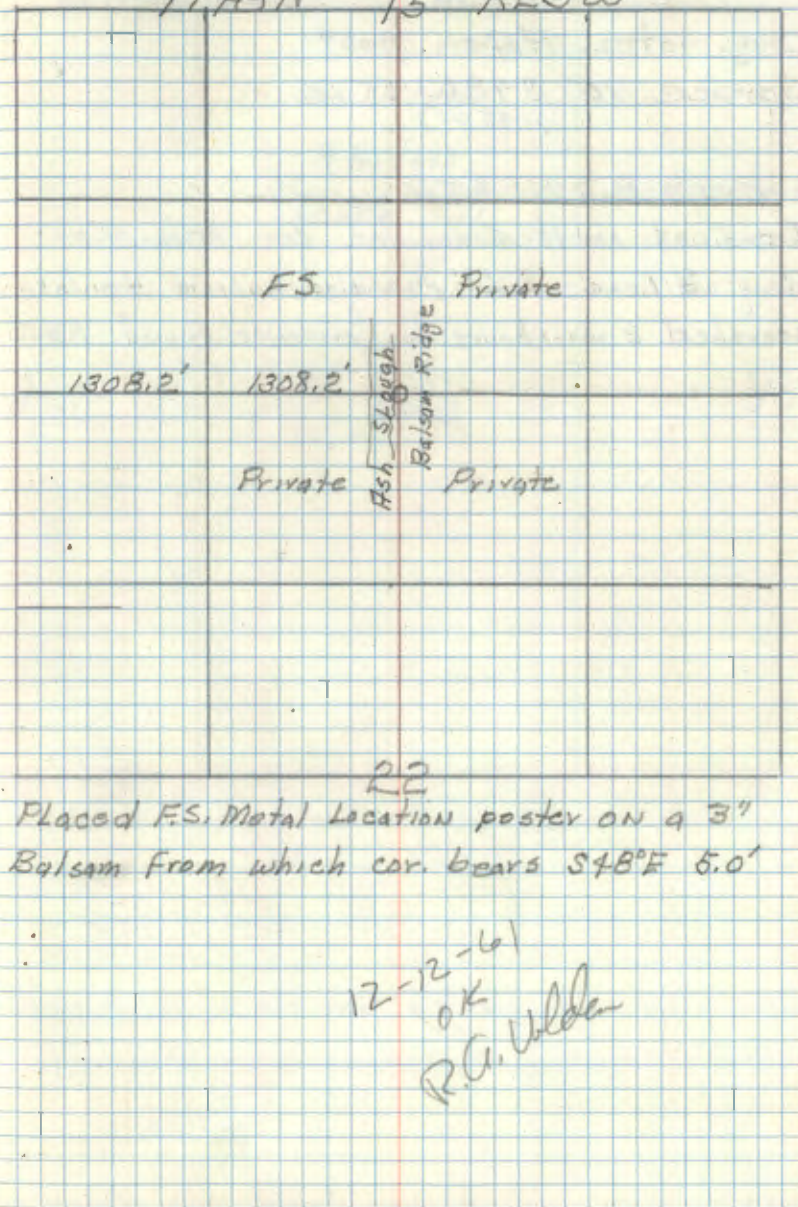

R2

Placed F.S. Metal Location poster on a 3"
Balsam from which cor. bears S48°E 5.0'12-12-61
OK

R.G. Warner

47

LM-13

M.C. Sec. 15-16 South bank Peterson

Orig. notes: Aspen post

Spruce 10" S 48 W 15 LKs
(W 48 W)

W. Birch @ S 41 E 65 LKs

I chained north from soc. cor 15-16-21-22
along old fence line & a blazed line to lake
searched 2 man hours no evidence found. RTH

R 9 56 80-11 H 0

T148N

R25W

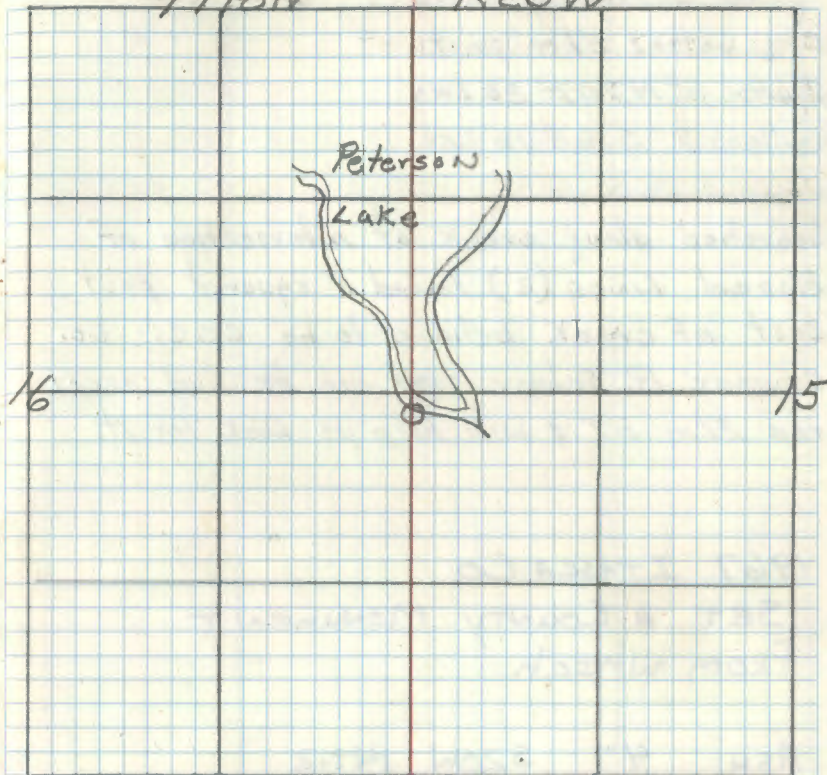

48

5-15

1/4 Cor. Sec. 10-15

Orig. notes: Elm post

Elm 6" N70E 20 LKS

Willow 7" S16E 16 LKS

Searched along creek at intersection of
blazed lines (2) found a squared post
east of creek believe to be CCC. Co.
Cruiser R. Schoar told me he had seen
the Elm BT & will help us look for it.

1967 ITASCA CO

SET A COUNTY MONUMENT
FROM WHICH

ASH 4" S20W 14.12

ASH N6E 10.95

2/11/91 R. MAIN

Ed ITASCA COUNTY MONUMENT UP AND

STAMPED: T148

+

R25

49

J-13, 14

M.C. Sec. 10-15 East bank Peterson Lk.
 orig. notes: Birch post
 Aspen 8" S38E 9 Lks.

Followed a blazed line from quarter cor.
 to Peterson lake - searched 2 m. hrs but
 found no evidence. 4-27-61 RHM

R9 5680-11 JHE

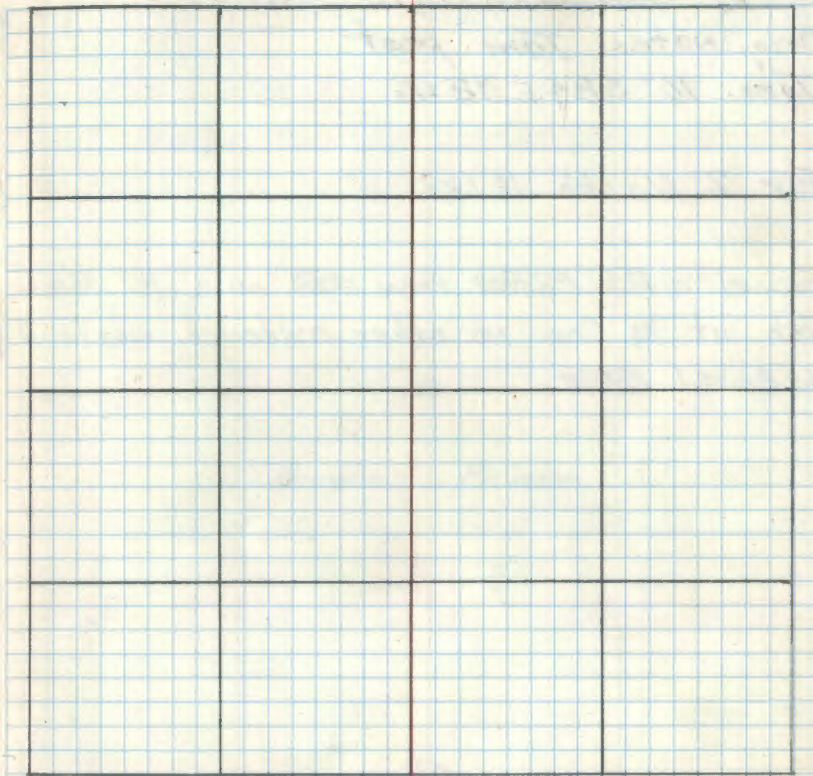

50

E. 15

 $\frac{1}{4}$ Cor. Sec. 3-10

Orig. Notes: Tam. post

Tam. 10" S84E 12 LKs

Fir 7" North 16 LKs

Found a F.S. Poster from 1935 on a 14" Black
 Ash at $\frac{1}{4}$ Cor. No other evidence was found
 4-26-61 RHM

R9-5680-11 HE

T148N 3 R25W

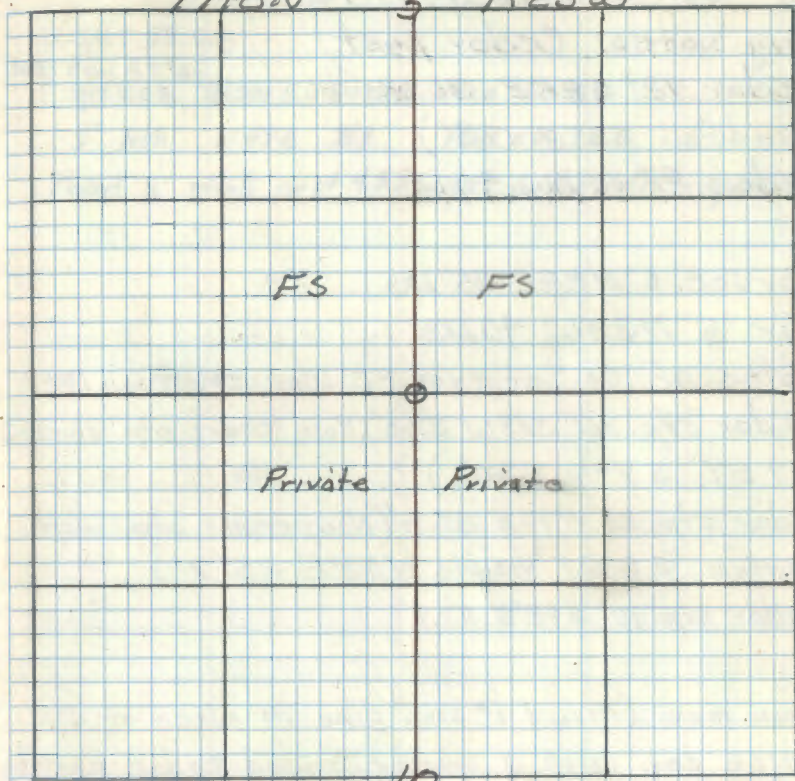

51

Hoffidavit RHM
E-13

Cor. Sec. 3-9-9-10

Orig. notes: Cedar post

Cedar 12" S 25° E 30 LKS (Now a 18" cedar
windfall S 25° E 19.8')

Cedar 8" S 80° W 40 LKS

Spruce 6" N 28° E 25 LKS

Fir 6" N 33° W 40 LKS

Notes of Co. Surveyor P.C. Warner Jan. 1922

Cedar stp. 16" S 68° W 27.0' (Now cedar stp. scribed
"S 9° BT" S 79° W 27.0')Cedar stp. 24" N 47° E 25.7' (Now cedar stp. with
scribe "S 3° BT" visible N 53° E 25.7')

Cedar stp. 10" S 42° E 53.9'

Iron mon. (Found 1" Iron pipe in place at old
fence cor. also a squared scribed cedar post
beside pipe) 9-12-61 RHMSet a 2" inside dia. 5' Long gal. wrought
iron pipe filled w/ concrete & capped w/
a 3" dia. bronze tablet stamped:-

Fd. B.C. set 20" high

T198N R25W

S 91.83

S 91.510

1961

R.L.S. NO 3628

12-22-61
61K

R.A. Walker

R 9-5680-11 21E

4

T198N

R25W

3

2/25/05 JS. GB
Mkd New BT's:
9" Ash S 24° E 31.20 Mkd S 10° BT
5" Ash N 43° E 21.1 Mkd S 5° BT
Placed 8' steel post 4.53 west with both signs.

F.S.

F.S.

* FENCE * * * * *

Private

F.S.

9

10

Placed F.S. Poster on a 8" Elm from which
Cor. bears N 25° W 13.4'

New BTs

ELM 8" S 24° E 13.65' MKD T198N R25W S 10° BT

Fd stp 2/25/05
ELM 7" S 83° E 23.05' T198N R25W S 3° BTwindfall 2/25/05
Cedar 6" S 58° W 78.15' T198N R25W S 9° BTFd. 8" cedar
Cedar post 4" x 4" x 6 1/2' penta-treated andchewed top
w/ red top N 36° W 3.6'

3/24/61 RHM/Donald

1/4 Cor. Sec. 9-10

Orig. notes: Cedar post

ELM 8" N88E 40 LKs

Cedar 9" West 39 LKs

Notes of Co. Surveyor R.C. Warner Jan. 1922

Cedar 10" S40W 23.4' (Several pieces of
burned cedar wood were found at this location)

D. Birch 18" S80E 49.3' (Not Found)

Iron mon (Found 1" Iron pipe at old fence cor.
also a squared post scribed 1/4 S10 1/4 S9)

4-12-61 RHM

Set a 6" dia. 5' long cylindrical concrete
monument capped w/a 3" dia. bronze tablet
stamped:-

T148N R25W

1/4
S9 | S10

1961

R.L.S. NO 3628

From which bears

Birch 8" N11°E 26.4' MKD 1/4 S10 B.T.

Rock 1.7' x 1.5' Flush w/ ground S56 1/2°E 14.8'

Cedar Post 4" x 4" x 6 1/2' penta treated and
with a red top, West 2.8

5/22/61 RHM & Donald

T148N

R25W

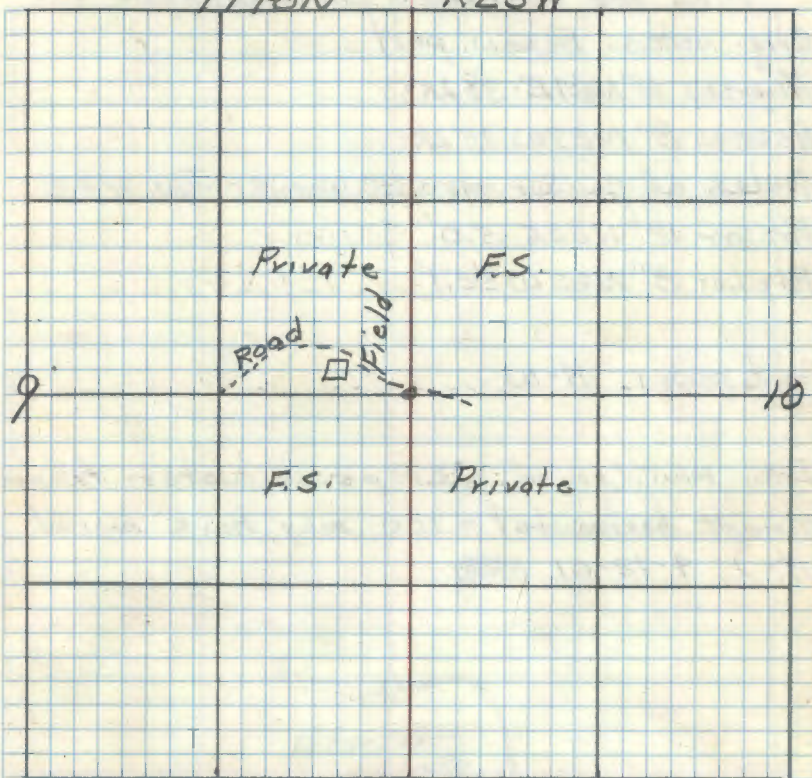

F.S. Poster is on the 4" x 4" cedar
post

Ed 15" Birch 2/24/05 2-16'

MK "X" ON top Ed 3/24/08

2/24/05 R.C. JS, CG

replaced new 8" Birch N64W at 31.72' 1/4 S9 BT
line to std. west. Maint. L.T.S. north

53

HJ-13

M.C. Sec 9-10 North bank Peterson LK.

Orig. notes: Aspen post

Aspen 6" N61E 38 LKs

Aspen 8" N27W 15 LKs

Notes of Co. Surveyor R.C. Warner Jan. 1922

Poplar 12" N20E 5.0'

Poplar 8" N25W 20.1'

Govt. poplar N-W

Iron mon. (Found 1" I. Pipe in water tipped
almost horizontal - ice may have moved
it) 9-12-61 RHM

T148N

R25W

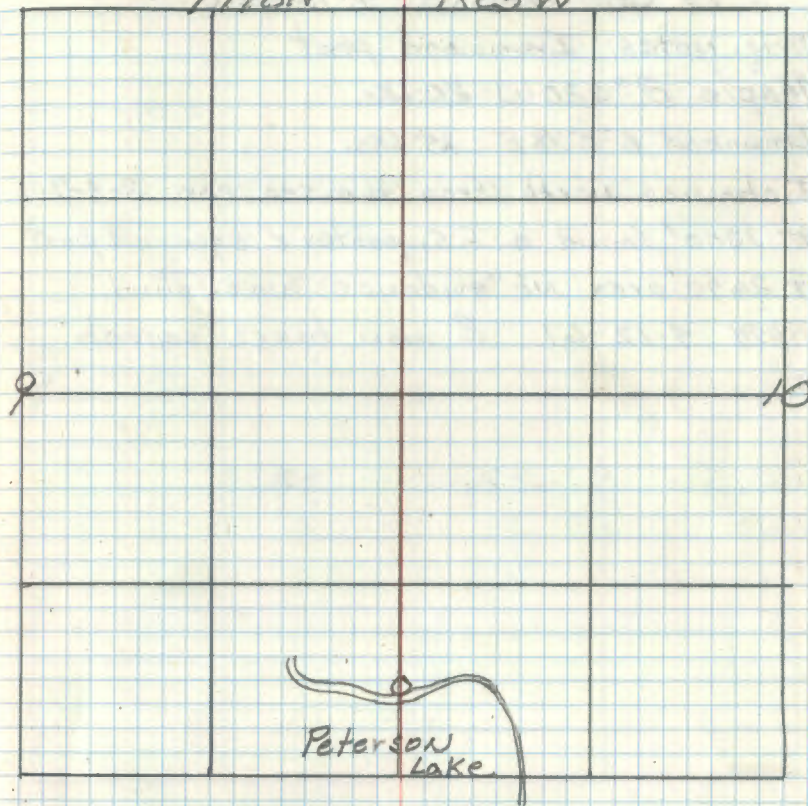

Placed F.S. Post on 3" Ash from which
pipe bears S25°W 10.0'

54

C-13

1/4 Cor. Sec. 3-4

Orig. notes: Ironwood post

Maple 8" S20W 20 LKs.

Ironwood 6" S38E 15 LKs.

I chained north from the sec. cor. 3-4-9-10
 at 1300' found a F.S. post & squared post
 at 2690' area no evidence was found.

RHM 7-12-61 2 man hours search

R9 5680-11 H6

T148N

R25W

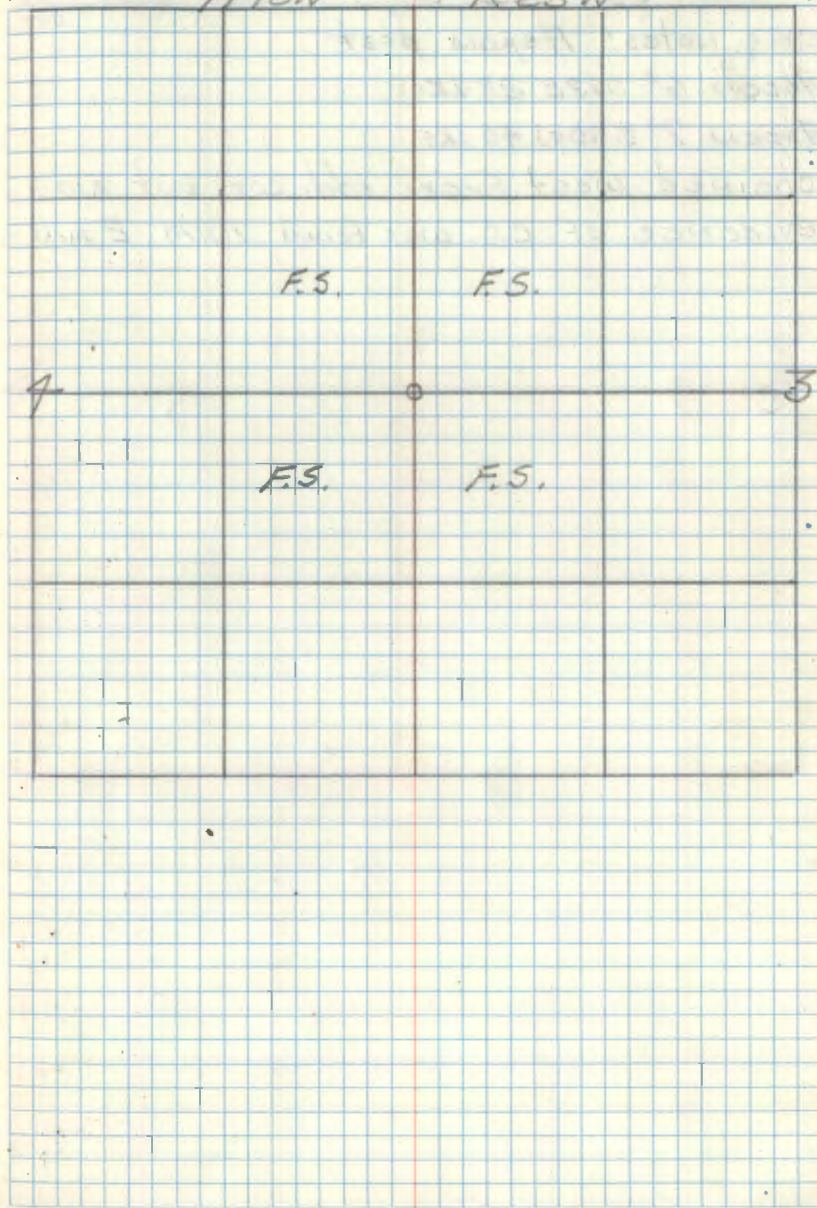

55 A-13

Closing Cor. Sec 3-4 130 LKs West ^{of} Std. Cor.

Orig. Notes: Aspen post

Aspen 6" S13E 28 LKs

Aspen 7" S40W 40 LKs

Chained west from std. cor. but no
evidence of C.C. was found P.M. 2 men hrs.

R9-5680-11 JWB

T198

R25

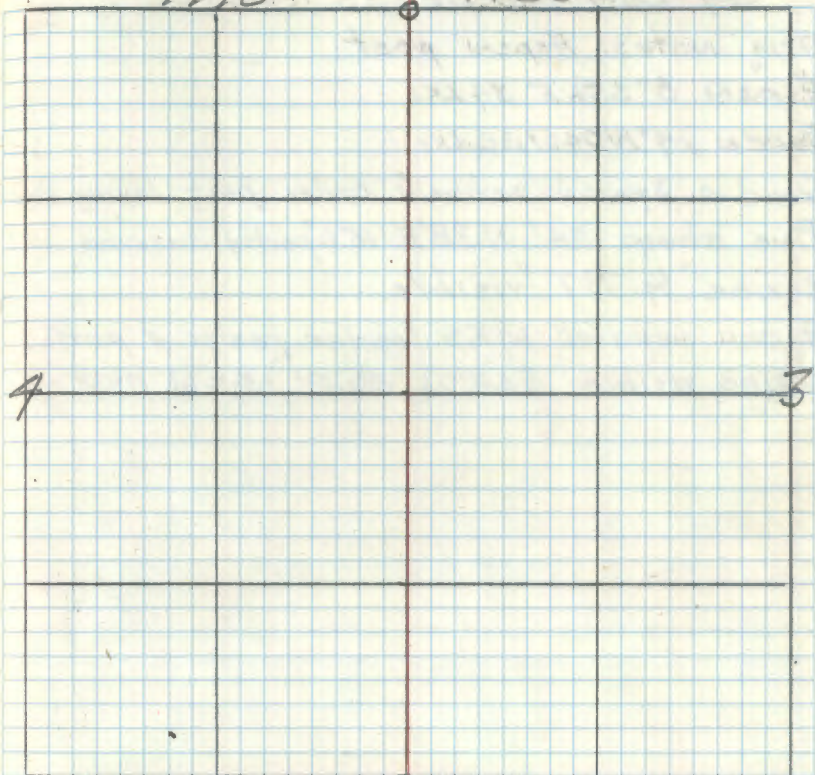

56

X-9

 $\frac{1}{4}$ Cor. Sec. 32-33

Orig. Notes: Aspen post

Aspen 8" S56E 34 LKs

Aspen 19" N74W 32 LKs

Found a squared scribed cedar post lying down

Pine stump 29" N38E 15.6' partly decayed w/

scribe $\frac{1}{4}$ BT visible

Aspen windfall w/ F.S. Location poster & partial

scribe visible S62°W 26.2' 5-9-61 RAY

CERTIFICATE FILED

T148N

32

33

Placed F.S. Poster on 7" Soft maple from which
Cor. bears N51°E 28.0'

57

Affidavit RHM

V-9

Sec. Cor. 28-29-32-33

Orig. Notes: Tam. Tree 6"

Tam 12" N46W 6 LKs. or 3.96' (Now large tam.
stump mostly decayed N45W 6.3')Tam 8" S68W 38 LKs. or 25.08' (Now a tam windfall)
w/ scribe marks visible S68W 25.7')Tam 10" S55E 18 LKs. or 11.88' (Now tam. stump
mostly decayed S56E 12.6')Tam 8" N74E 14 LKs. or 9.24' (Now tam. stump
mostly decayed N73E 10.0')

Found - Birch 10" N20E 17.6' w/ scribe "528"

Cedar 8" N38W 18.8' w/ scribe mostly grown over

Birch - dead 5" S57E 30.6' w/ scribe "S33 BT"

A 1 3/4" Iron pipe was found marking cor. - A squared
scribed post was found laying beside pipe.5-9-61 RHM A brushed line leads to cor. from
South & East

Notes of Co. Surveyor Sam Benzing 1956

Birch 12" N03E 17.57'

Cedar 6" N25W 18.86'

Birch 7" S75E 30.60'

Set a 2" inside dia. 5' long gal. wrought iron pipe
filled w/ concrete & capped w/ a 3" dia. bronze
tablet stamped:

T148N R25W

S29S28

S32S33

1961

RLS NO 3628

R9-5680-11 346
CERTIFICATE FILED

29

T148N

R25W

28

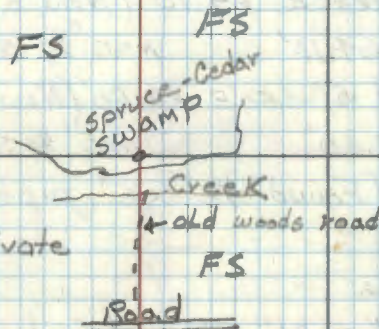

32

Placed FS. Poster on a 8" Balsam from which
Cor. bears S23E 3.6'

New BTs

Cedar 8" N 89° E 48.6' MKD "528 BT"

Cedar 9" N17° W 15.3' MKD S29 BT"

BLK. Spruce 8" S55° W 30.4' MKD S32 BT

9/15/61 R.H. McDonald

12-6-61
OK
RAV

33

58

Affidavit RHM

V-11

1/4 Cor. Sec. 28-33

Orig. Notes: Spruce post

Spruce 10°N16W 15 LKs

LYNN. 8" S4E 29 LKs

Notes of Co. Surveyor Sam Benzling 1956

ELM 8" N65E 64.10' (Now a 9" ELM

N63 1/2 E 64.10' MKD 1/4 S28 BT')

Basswood 5" S50E 63.60' (Now a 7" Basswood

S50E 63.60' MKD 1/4 S33 BT')

Iron mon (Found 1/2" x 6" pipe marking cor.)

Set a 6" x 26" cylindrical concrete mon
capped w/ a 3" dia. bronze tablet.

Stamped:-

T198N R25W

MON. is buried 6" under
road surface1/4 S28
1/4 S33
1961

R.L.S. No. 3628

From which bears.

White Pine 26" N53W 108.5' MKD 1/4 S28 BT

The 2 BTs of 1956 are still in good
condition.

RHM 7/17/61 RHM Donald

7/16/61

CERTIFICATE FILED

T198N

R25W

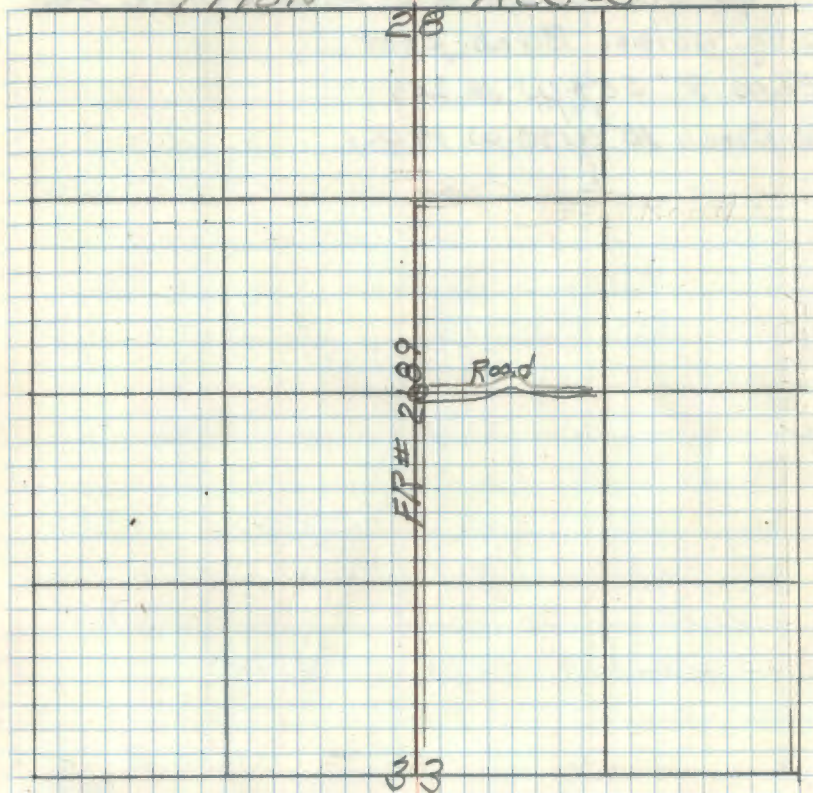
Placed P.S. metal location poster on
the 26" w/ Pine B.T. From which cor. bears
S53°E 108.4'

59

M.C. Sec. 28-33 West bank Jessie Lake

Orig. notes: Birch post

ELM 8" 55' W 16 LKs

W. Birch 10" ^N 40' W 19 LKs
P

89-5680-11 HU
CERTIFICATE FILED

T19BN

R25N

60

Affidavit RHM

T-9

1/4 Cor. Sec. 28-29

Orig. notes: Spruce post

Spruce 5" S70E 15.45

Spruce 6" S64W 35.45

Found - Spruce 5" N40°W 48.6' MKD "1/4 S29 E"

Spruce 3" N43°E 13.45 MKD "1/4 S28 BT"

Cor. is marked by a pipe in old road.

Believe this to be Co. Cor. approx 3 years old

5-10-61 RHM

Found Co. notes of Co. Surveyor Sam Benzing 1957

Spruce 4" N35E 13.45 (Found)

Notes of Dep. Co. Surveyor FE Williams 1916

Spruce 5" N47W 48.6 (Found)

Spruce 5" S77E 76.5

Iron monument (Found in place)

Set a 6" x 26" cylindrical concrete mon.
capped w/ a 3" dia. bronze tablet stamped:Mon set flush
with ground

T198N R25W

S29 1/4 S28

1961
RLS NO 3628Cedar Post 4" x 4" x 6.5' penta-treated
w/ red top East 1.0'

7/18/61 R.H. McDonald

R9-5680-11 216

T198N

R25W

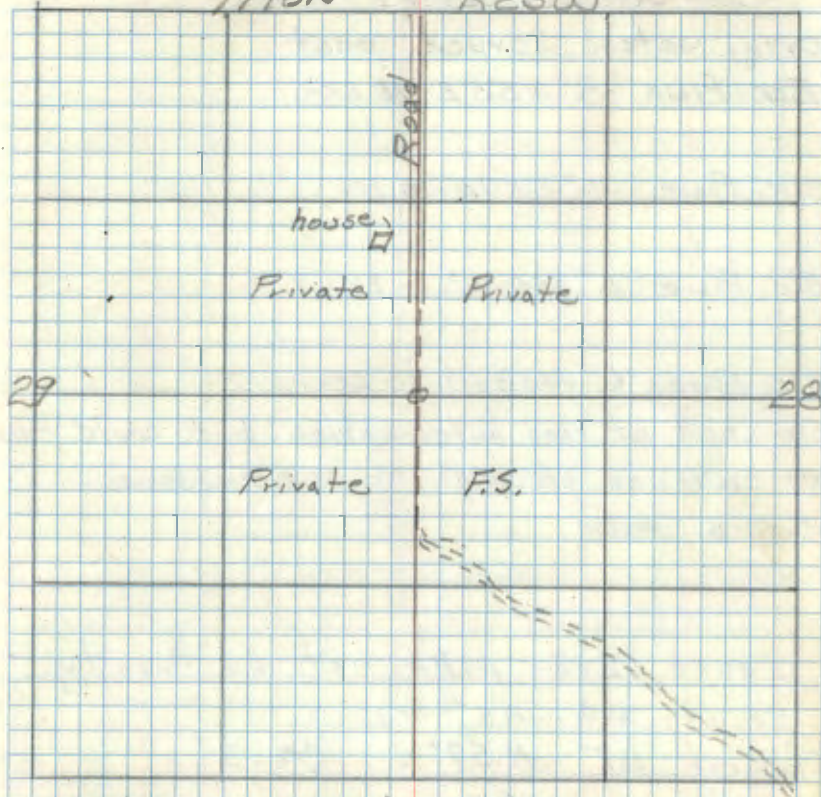
Post is on the red top cedar
post.12-6-61
OK
RAV

61 R-9

Cor. Sec. 20-21-28-29

Orig. Notes: Spruce post
BLK. Pine 8" N55E 10 Lks.

BLK. Pine 10" S57E 10 Lks.

BLK. Pine 6" S44W 30 Lks.

BLK. Pine 6" N32W 30 Lks.

Searched at road intersection but could find
no evidence of orig. cor. or accessories.

5-10-61 RHM

Found Iron pipe set by County.

County W.C. 25' N.E.

10" Birch BT N57°W 32.3'

9/14/73 RDD

1968 EARL PELAGUEN ITASCA CO. B68 OFF BOSE

leaf field bk. Set 1" I.P. IN ROAD

JUNCTIONS N & S & E. WITNESSED BY:

BIRCH 9 N65W 37.82

BIRCH 9 S65W 32.28

BASSWOOD 7 S43E 85.05

Co Mon N17E 25.0

R9-5680-1 JHE
CERTIFICATE FILED

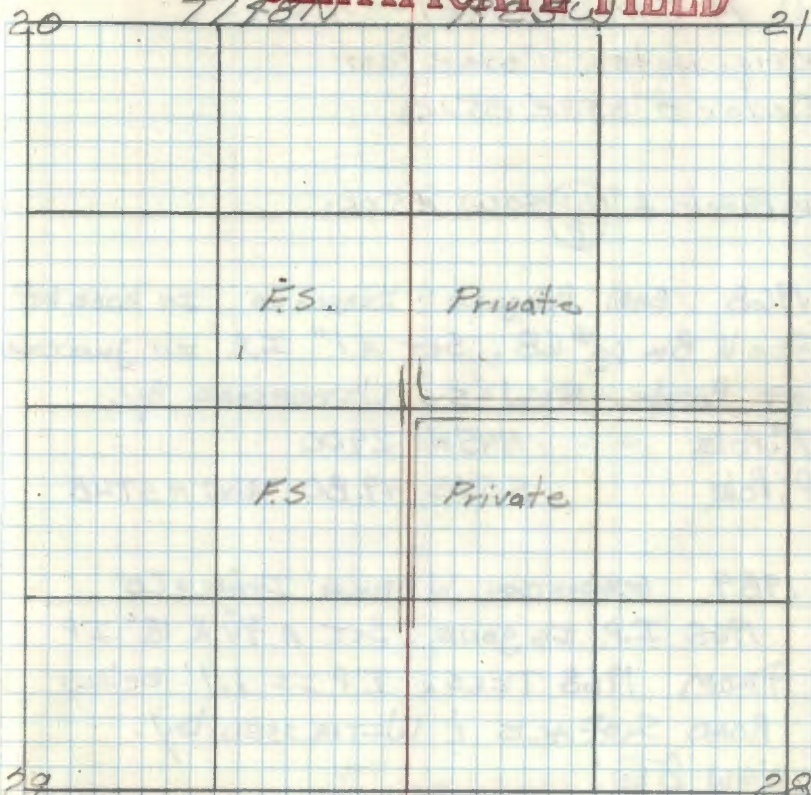

29

28

1989G. ROBERTSON W. BRUCE ITASCA CO.
Fd 1" I.P. IN ROAD AND WITNESSED BY.

1968 BTs

| | | | |
|--------------|------|-------|---------|
| BIRCH STUMP | N55W | | To BT |
| BIRCH 15 | S73W | 31.77 | To NAEI |
| BASSWOOD 10" | S37E | 85.77 | To NAEI |
| Co. Mon 46" | N25E | 25.0 | |
| NEW BT | | | |
| BASSWOOD 12" | N56W | 47.33 | To NAEI |

R-11 1/4 Cor. Sec. 21-28

Orig. notes: Cedar Post

Cedar 8" S53E 25 Lks

W. Birch 6" (W) 40W 25 Lks

1968 EARL PELQUIN ITASCA CO IN LOOSE LEAF
 FIELD BK pg*68. SET A 1" I.P. IN JUNCTIONS
 OF ROADS E & W'S. WITNESSED BY.

T. Pole N45W 29.00

P. Pole S54E 49.80 NW A STUB

1989. G. ROBERTSON W. BRUCE ITASCA CO

1968 I.P. IS GONE. SET A 3/4 X 18" IP
 FROM 1968 TICS. IP IS 1.1' BELOW
 ROAD SURFACE & WITNESSED BY.

NEW BITS:

ASH 11" N34E 123.02 TO NAIL

ASH 5" S62E 125.97 TO NAIL

P. Pole " S53E 52.43 TO NAIL

Guy Pole N54E 50.29 TO NAIL

T148N 21 R25W

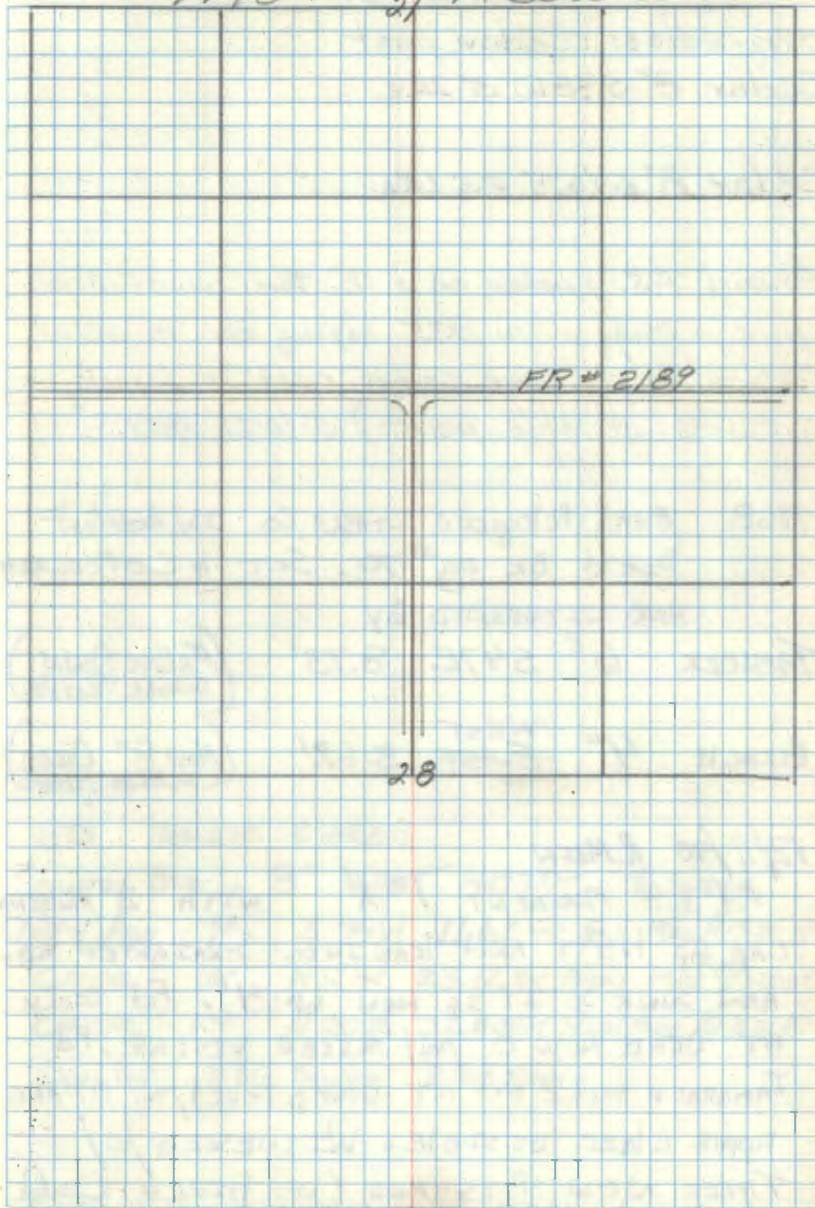

63

P. 9

1/9 Cor. Sec. 20-21

orig. notes: Cedar post

Cedar 8" S 78 W 5 Lks.

Cedar 8" N 16° E 25 Lks.

Found F.S. poster on a 12" Tam. wind fall put up by Meager in 1935 saying cor. is S 6° W 85 LINKS (a square cedar post is laying on ground at this point) 5-10-61 RMM.

1968 EARL PELQUEN ITASCA CO IN loose CAT
FIELD BK pg # 70. SET A CO MONUMENT
AND WITNESSED BY

TAMARACK 6" S 47 E 8.73' (FALLEN DOWN
SCRIBE VISIBLE)

BIRCH 4" WEST EAST 3.62' (NOW 8" DEAD
SCRIBE VISIBLE)

12/11/90 R. MAIN

Fd CO MONUMENT 1" X WITH 2" ALUMINUM
CAP UP 1.5 FT AND LEANING. STRAIGHTEN UP
AND SUNK SO IP IS NOW UP 4". Fd BIRCH
BT DEAD NOW 8" W/ SCRIBE VISIBLE. Fd
TAMARACK BROKE OFF AT STUMP level W/ BT AND
UPPER BLAZE VISIBLE. WITNESSED W/
THREE NEW BTS AND CO BIRCH. COULD
NOT FIND 1935 METAL TAG AT THIS TIME.

R 9-5680-11

CERTIFICATE FILED

T148N

R 25 W

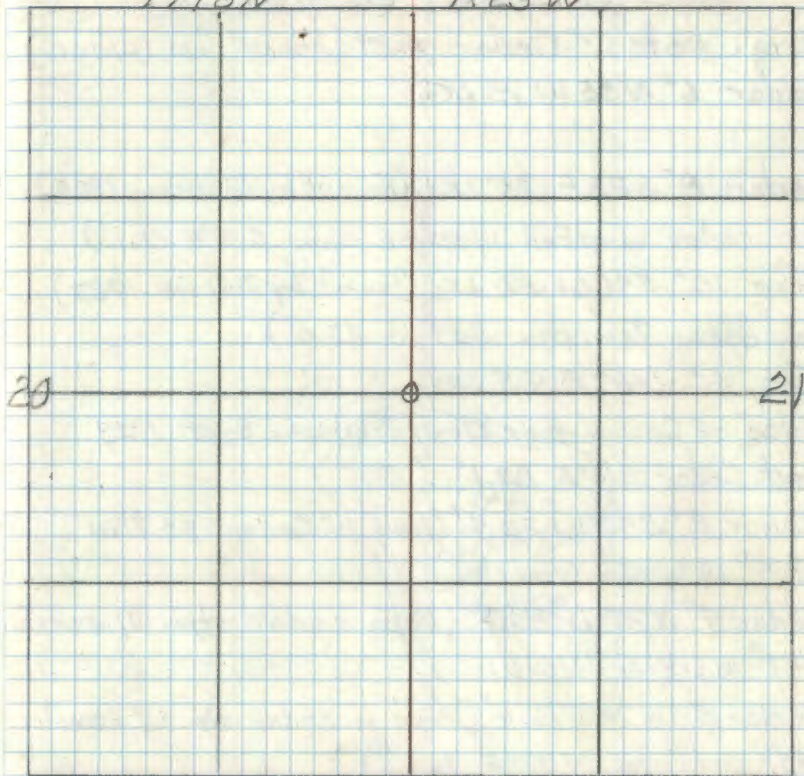

BTS DOUBLE BLAZED

COUNTY BIRCH 8" WEST 407 FT TO SPIKE
(NEW) ASH 7" S 74 W 11.62 FT Spk MKD 4/520 BT
CEDAR 10" N 12 W 23.12 FT NAEI MKD 4/520 BT
CEDAR 10" N 20 E 32.58 FT NAEI MKD 4/521 BT
SIGN POST 3.85 SOUTH 2.85 NORTH

67

Affidavit RHM

N-9

Sec. Cor. 16-17-20-21

Orig. Notes: Cedar post (Found in place)

Cedar 6" N85W 10 Lks.

* Cedar 8" S23E 35 Lks. (Found by Johnson 1923)

Now cedar windfall w/ scribe plain S12E 23.1'

Tam 10" S41W 50 Lks. (Found by Johnson 1923)

(Now decay Tam. stp. S39W 33.0')

Tam 6" N67E 25 Lks.

Notes of Co. Surveyor Lloyd Johnson Sept. 1923

Govt. Cedar S16E 23.1' (OK)

Cedar 8" S40W 32.4' (Now 11" Cedar S47W
32.4' w/ scribe visible)Cedar 4" N70W 20.7' (Now cedar stp. w/ scribe
"BT" visible N61W)Cedar 5" N70E 16.6' (Now a cedar stp w/ scribe
"BT" visible N77E 16.6')

Govt. Tam 12" S39W 33.0' (OK)

Iron Man. (Found 2" dia. I.P. beside post)

Set a 2" inside dia. 5' long gal. wrought
iron pipe filled w/ concrete & capped w/ a 3"
dia. bronze tablet stamped:

T198N R25W

S17/S16

S20/S21

1961

RLS. NO 3628

5/17/61 RHM/Emal

R9-5680-11 JMC
CERTIFICATE FILED

17

T198N

R25W

16



20

21

Found FS. Post on the cedar BT S40W 32.4'
steel sign post 72" long w/ FS signs S4-20 S4-4
attached set North 3.4 ft. 4/26/67 RHM

New BTs

Cedar 9" S58W 28.8' MKD T198NR25WS 20 BT

Cedar 12" S14E 45.55" T198NR25WS 21 BT

Cedar 11" N38E 56.9" " X BT

Cedar 10" North 40.85" " X BT

check O.K. by Volden
12-14-61

65

N-11

1/4 Cor. Sec. 16-21

orig. notes: Birch post

Birch 8° N 72° W 30.1Ks

Birch 6° 51' 8" W 25.1Ks

Cor. is in intersection of roads I believe all
orig. evidence has been obliterated. 5-10-61 R.H.

6/8/1920 J. ROSE

Fd 1/4 while surveying Sec 16

1967 EARL PELOQUIN ITASCA CO Pg 39 of
loose leaf field bk.Set Co Monument in Road and Witnessed
by:

BIRCH 6 563W 42.0

ELM 8 N 17E 67.5

1989 ROBERTSON & BRUCE ITASCA CO

Fd Co Monument bent over in old Rd bed now
a corner of yard. Fd Elm & Birch stumps.
Replaced old IP with 2 1/2 ft long new mark
below ground.

R9-5680-11 ME

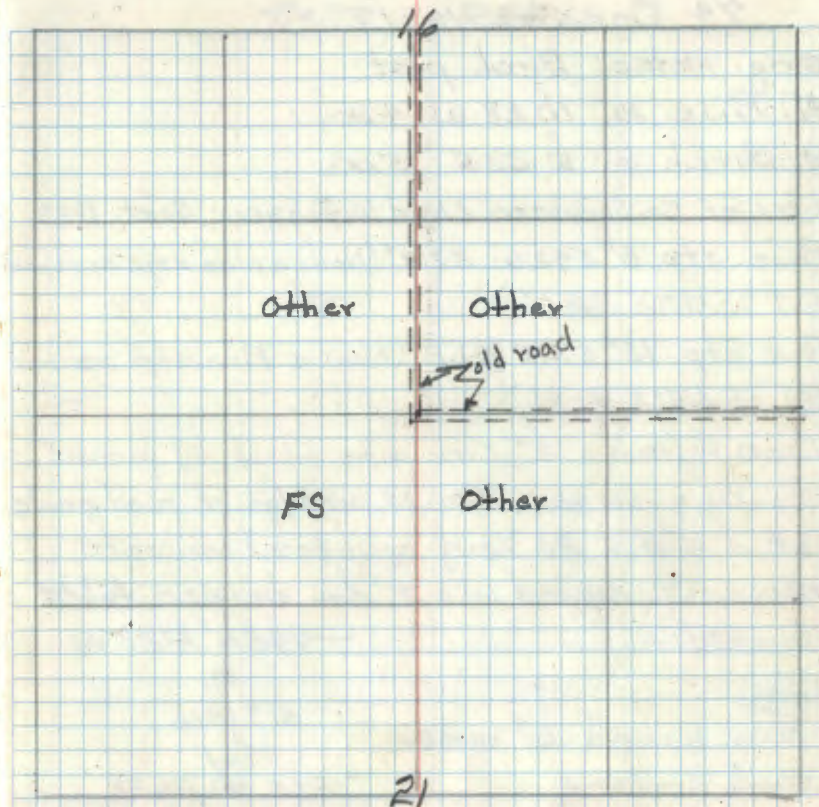

NEW BT'S

TAMARAC 8" N 79° W 103.1 To NAE 1

ASH 8" N 31° W 79.64 To NAE 1

P. PINE
(NOT BLAZED) 7" S 73° E 73.67 To NAE 1

ASPEN 5" N 19° E 74.04 To NAE 1

66

Affidavit RHM

L-9

1/9 Cor. Sec. 16-17

Orig. notes: Birch post

N. Pine 10" W 28 W 4 LKs

W. Birch 6" W 23 E 15 LKs

Notes of Cal. Surveyor Lloyd W. Johnson Sept. 1923

Pine stp. 8" S 92 W 53.3' (Now a pine stp. scribed
"BT" S 50 W 53.3')Pine stp. 15" S 73 E 41.8' (Now a Pine stp scribed
"BT" S 65 E 41.8')Iron - (Now a 2" Iron pipe flush w/ ground
marking corner) Cor. is on edge of road grade.Set a 6" dia. 26" long cylindrical concrete
monument capped w/ a 3" dia. bronze tablet
stamped: -

T148N R25W

1/4

S17 S16

1961

RLS NO 3628

Note

mon. buried 6" under
road surface

New BTs

Red Pine 11" N 47 W 93.7 MKD 1/4 S17 BT

Jack Pine 6" N 68 1/2 W 52.25 MKD 1/4 S17 BT

W. Spruce 12" S 36 W 117.0 MKD 1/4 S17 BT

M.L. Johnson
7/16/61 RHM & Donald

T148N

R25W

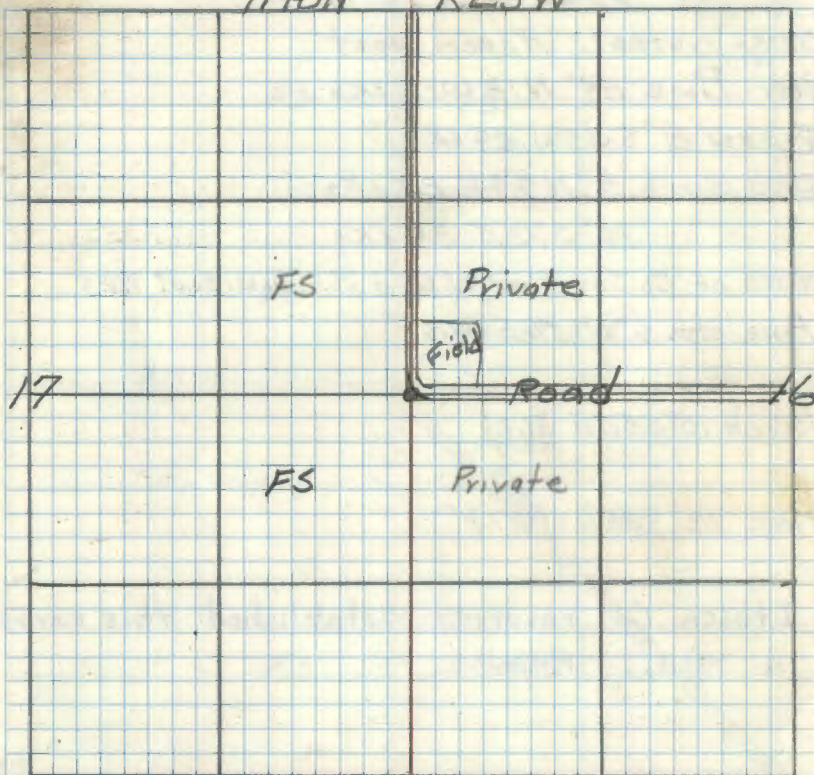
Placed F.S. metal Location poster on
The 6" Jack pine BT from which cor.
bears S 69 E 51.9'4" x 4" x 6' Red topped cedar post w/ property
boundary sign 57-2 attached set south 29.9 ft.
4/26/67 RHM

67

J-9

Cor. Sec. 8-9-16-17

Orig. notes: Aspen post

Nor. Pine 29" N18W 34Ks

Aspen 8" S35W 24Ks

Wht. Birch 8" N44E 25Ks

" " 10" S73E 26Ks

Notes of Co. Surveyor Lloyd Johnson, Sept 1923

Pine stp. 6" N35½E 53.6'

Birch 10" S52°E 31.2'

Pine 12" S35½W 37.8'

Itasca Co. resurvey established this corner
in 1966. R.H.M.

R9-5680-11 HLU

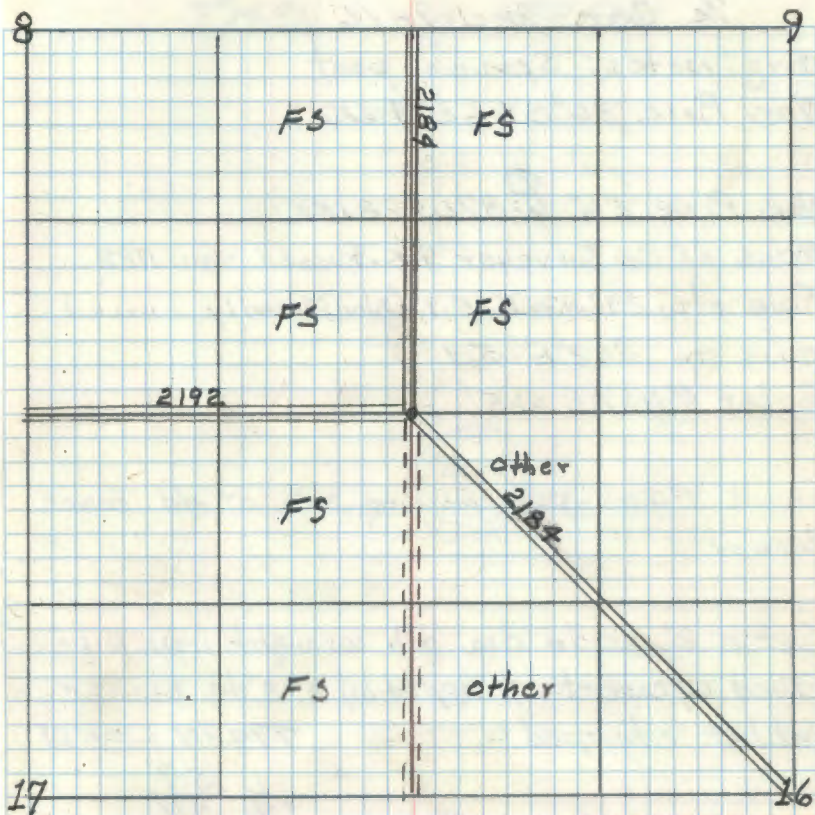

68

Affidavit RHM

J-11

 $\frac{1}{4}$ Cor. Sec 9-16Orig. notes: Spruce post
Nor. Pine 26" S 66° E 4 LKsNor. Pine 26" [⊙] W 87° W 22 LKs

Notes of Co. Surveyor K.K. Russell Jan. 1922

Pine str. 29" S 26° E 5.9' (Now badly burned
pine str. S 62° E 5.9')
Poplar 6" N 6½° E 61.5'Found 1" Iron pipe marking cor. at old fence
cornerSet a 2" inside dia. galv. wrought iron pipe
filled w/ concrete & capped w/ a 3" dia. bronze
tablet stamped:-

T148N R25W

 $\frac{1}{4}$ $\frac{S9}{516}$
1961

From which bears:-

RLS NO 3628

Oak 9" N 10° W 104.3' MKD 1/4 S 9° BT

Oak 7" N 73½° E 48.85' MKD 1/4 S 9° BT

Cedar post 4" x 4" x 6½' pent-a-treated &
w/ a red top West 3.2'

5/17/61 RHM/Rhald

Placed F.S. standard signs 57-2154 & on the
cedar post. 4-27-67 RHM

558W

R9-5680-11 216

T148N

9

R25W

F.S.

Private

Private



16

12-20-61
OK

RHM/Rhald

- See BK4 pg 25 T148N R25W

69

M.C. Sec 9-16 west bank Peterson Lk.

orig. notes: Aspen post

Willow 8" N69W 170 Lks

" 7" S80W 210 Lks

Notes of Co. Surveyor K.K. Russell Jan. 1922

Birch 8" S88W 60.9'

Birch 12" S52°W 39.3'

R 9-5680-11 JH

9

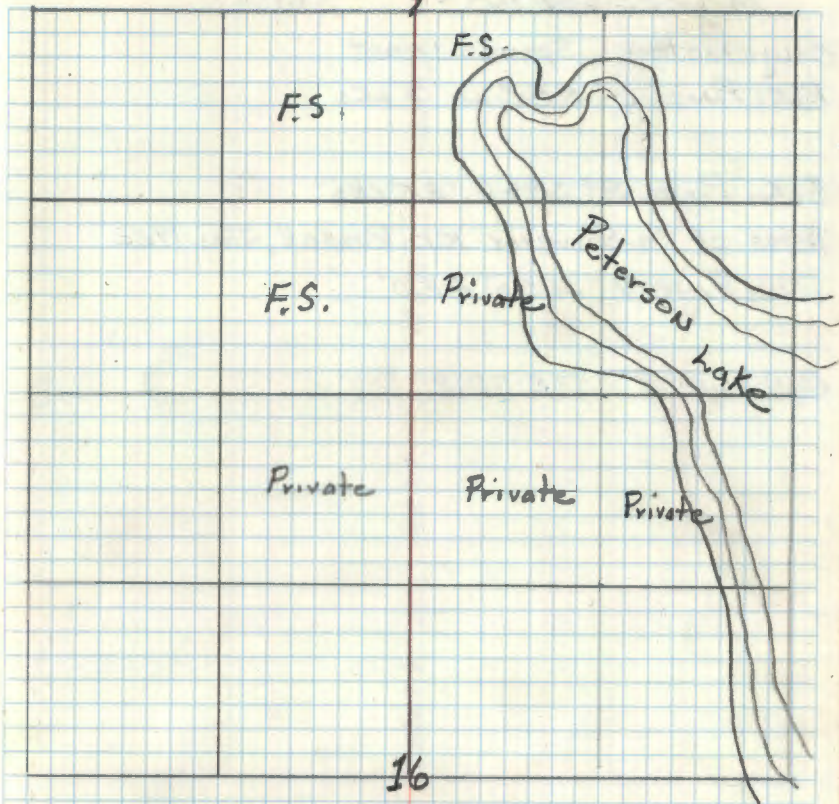

70

 $\frac{1}{4}$ Cor. Sec. 8-9

Orig. Notes: Spruce post

BLK. Pine 6" SB2W 6 LKs

BLK. Pine 8" SB4E 25 LKs

Notes of Co. Surveyor K.K. Russell, Jan. 1922

D.W. Pine 7" SB2W 82.0'

D.W. Pine 9" SB3E 32.8'

R 9-5680-11 H2

T18N

R25W

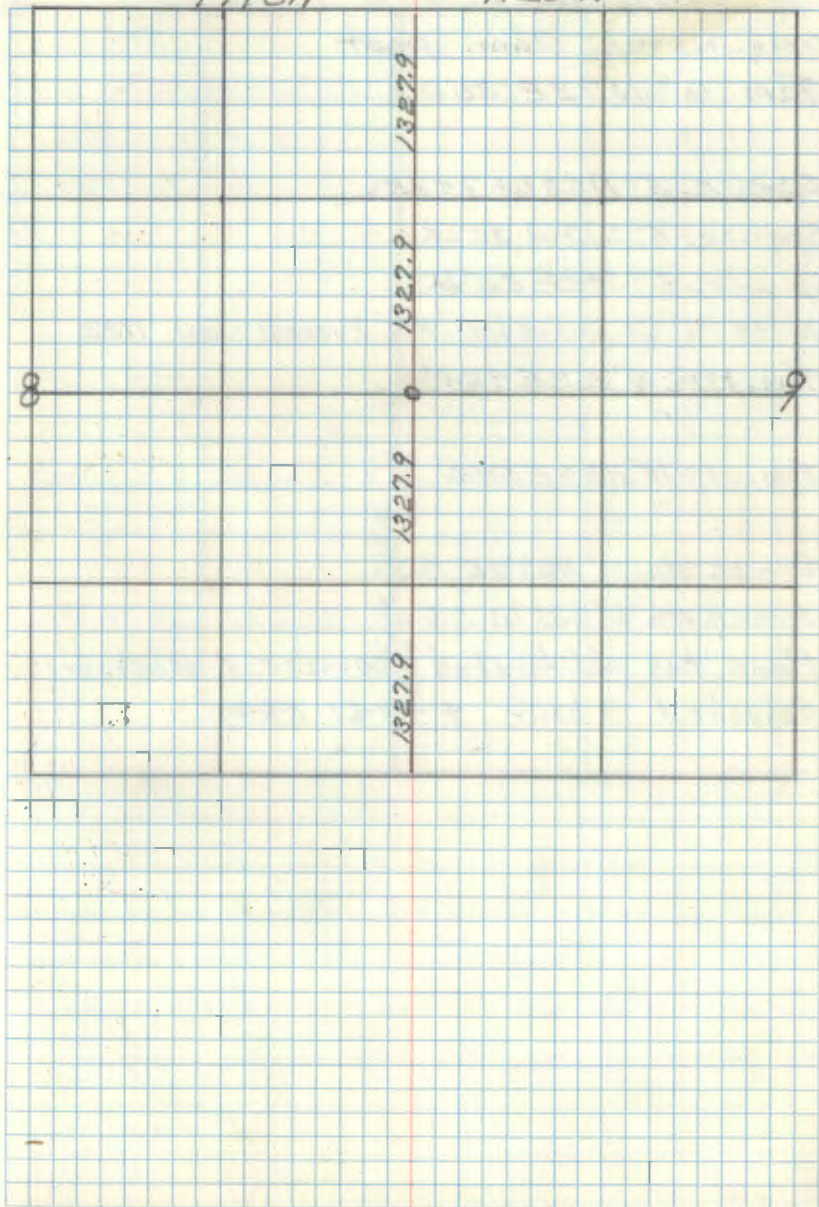

71

E-9

Cor. Sec. 4-5-8-9.

Orig. notes: Tam. post

Tam. 6" N73E 30 LKs

Spruce 5" N53W 15 LKs

Spruce 8" S17W 30 LKs

Spruce 5" S48E 25 LKs

Notes of Co. Surveyor K.K. Russell Jan. 1922

Tam. stp. 10" S62E 42.0'

Tam. stp. 10" N24E 58.0'

Spruce stp. 10" N63½E 19.3'

Spruce stp. 6" S33W 35.0'

Road has obliterated corner & accessories

Searched 1 hour 7-13-61 RHM

R9-5680-11 JH

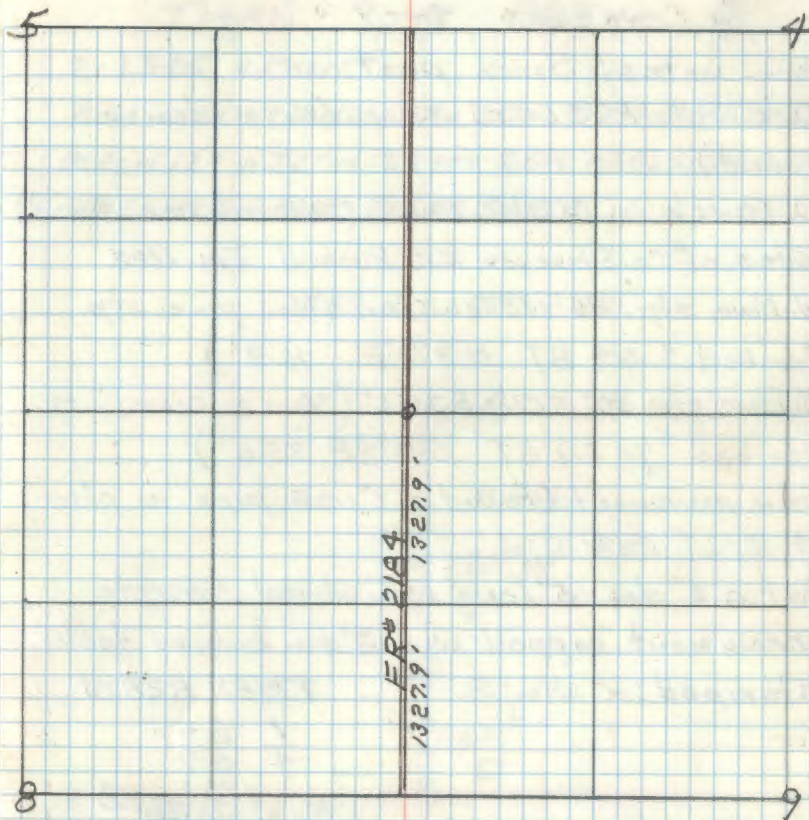

1/4 Cor. Sec. 4-9

Orig. notes: Birch post

W. Birch 8" S65°W 25' LKs (No evidence found)

W. Birch 6" N3°E 10' LKs (No evidence found)

Notes of Co. Surveyor K.K. Russell Jan. 1922

N. Pine stp. 36" N5 1/2°W 16.9' (Now pine stp.)

Scribed "S 4 BT" N3 1/2°E 16.9'

N. Pine stp 20" S17 1/2°E 35.6' (Now a pine stp.)

Scribed "1/4 S 9 BT" S8 1/2°E 35.6'

Iron monument (Found a 1" iron pipe in place)

4-12-61 RHM

Set a 6" dia. 5' Long cylindrical concrete monument capped w/ a 3" dia. bronze tablet stamped:-

T148N R25W

1 S 4
4 S 9

R.L.S. 1961 NO 3628

From which bears

Tam 10" N74°W 82.2 MKD 1/4 S 4 BT

Birch 6" N8 1/2°E 20.0' MKD 1/4 S 9 BT

Cedar Post 4"x4"x6 1/2' penta-treated and w/ a red top East 3.3'

5/22/61 RHM Donald

T148N 4 R25W

2-23-05 R. MAIN

Add NEW BT AND BRUSH LINE TO STANDARD SOUTH.
BIRCH 12" N32°W 76.54 FT TO SPR MKD: 1/4 S 4 BT
STEEL SIGN POST 30.3 FT SOUTH

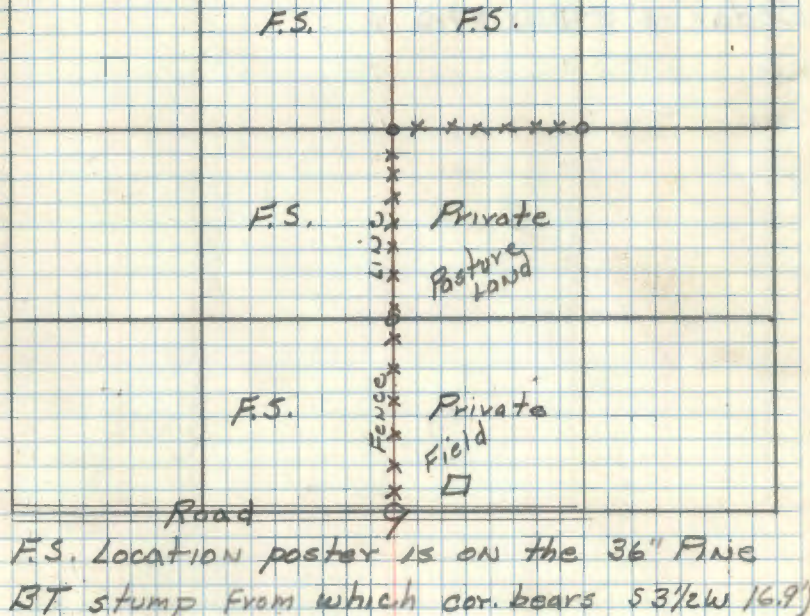

12-22-61
OK

R. Q. Walker

73

1/4 Cor. Sec. 4-5

Orig. notes: Fir post

Fir 6" N74W 75 Lks

Blk. pine 8" N80E 50 Lks

Notes of Co. Surveyor P.C. Warner July 1918

Birch 12" S73E 35.8'

Cedar 13" S93W 69.0

R9-5680-11 JH

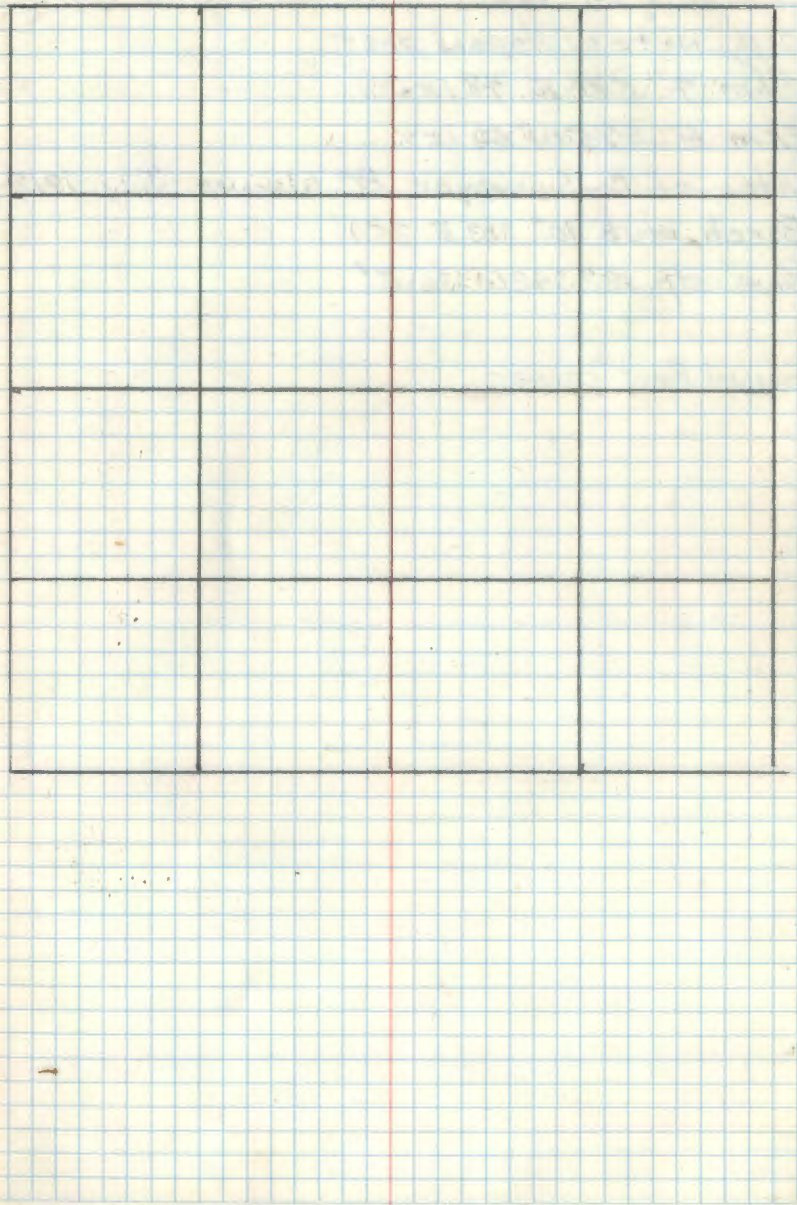

74

A-9

Closing Cor. Sec 4-5 174 Lks west of Std. Cor.

Orig. Notes: Aspen post

ELM 4" S20E 78 Lks.

ELM 6" S75W 60 Lks.

Notes of Co. Surveyor P.C. Warner July 1918

Birch stub 10" S13E 25.1'

Pine stp. 18" S42W 36.5'

Found Govt corner

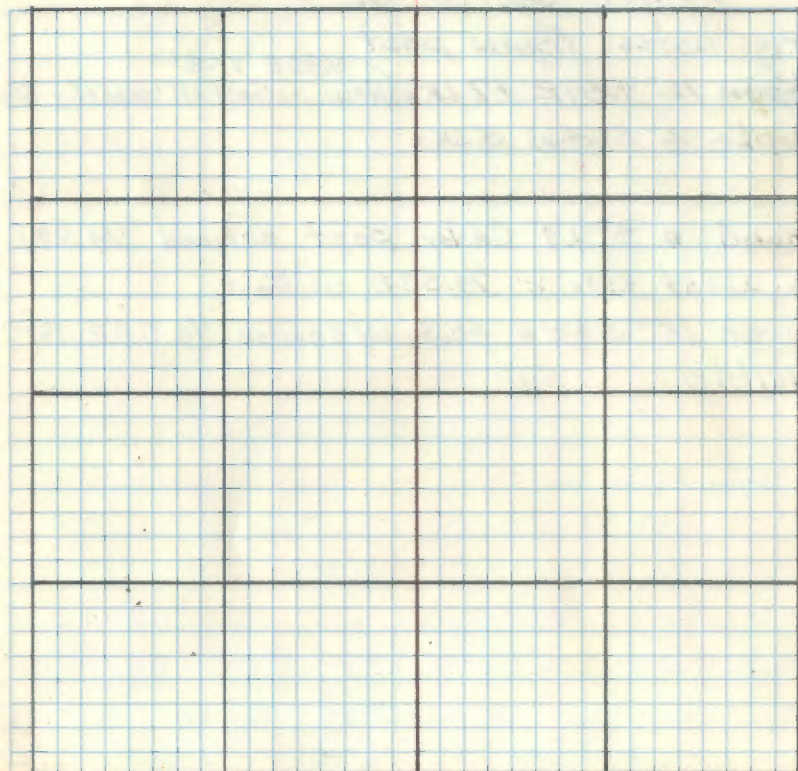

75

X-5

 $\frac{1}{4}$ Cor. Sec. 31-32

Orig. notes: Aspen post

Aspen 12" N89E 17 Lks ^{N80E 17.2'} (New windfall mostly decay)

Maple 6" S67W 5 Lks

Found a 4" x 4" Cedar post scribed $\frac{1}{4}$ S 31on West side of $\frac{1}{4}$ S 32 on EastBirch 15" S 42° E 20.5' w/ scribe " $\frac{1}{4}$ S 32 BT"
visiblePlaced FS Post on a 4" Balsam from which
Com bears N81° E 6.4'

76

V-5

Sec. Cor. 29-30-31-32

Orig. notes: Aspen post

Aspen 20" 579E 20 LKs

" 19 N61W 14 LKs

" 20 N62E 29 LKs

" 18 S62W 28 LKs

Found a Squared post scribed S29, S30, S31, S32
 in a rock pile along fence line on North
 side of Wicklands Field. Found F.S. post
 on a 12" Aspen stub 32' West of Corner.
 5-11-61 KRM

CERTIFICATE FILED

30

T148N

R25W

29

Private

Private

xoxox Fence

x Field [shouse

Private

Private

31

32

77

1/4 Cor Sec. 29-32

Orig. notes: Tam post

Tam 6" N31E 13 Lks

Tam 6" S36W 25 Lks

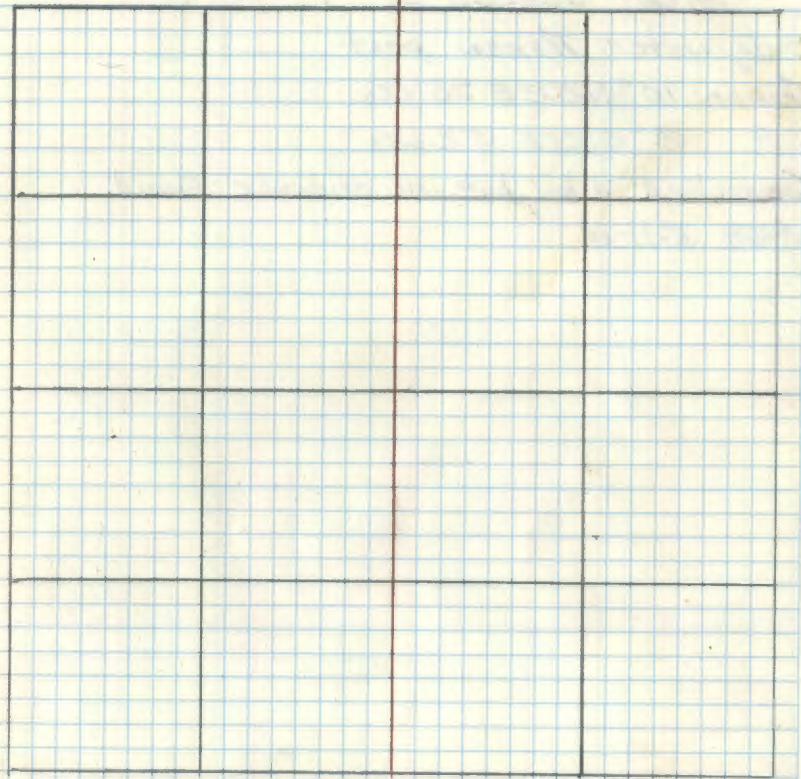

78

V-3

1/4 Cor Sec. 30-31

orig. notes: Aspen post

Aspen 10" N52 E 35 LKs

" 8" S55 E 52 LKs

Searched 1 hr. but no evidence found.

RHM 5-11-61

R9-5680-11 H4

CERTIFICATE

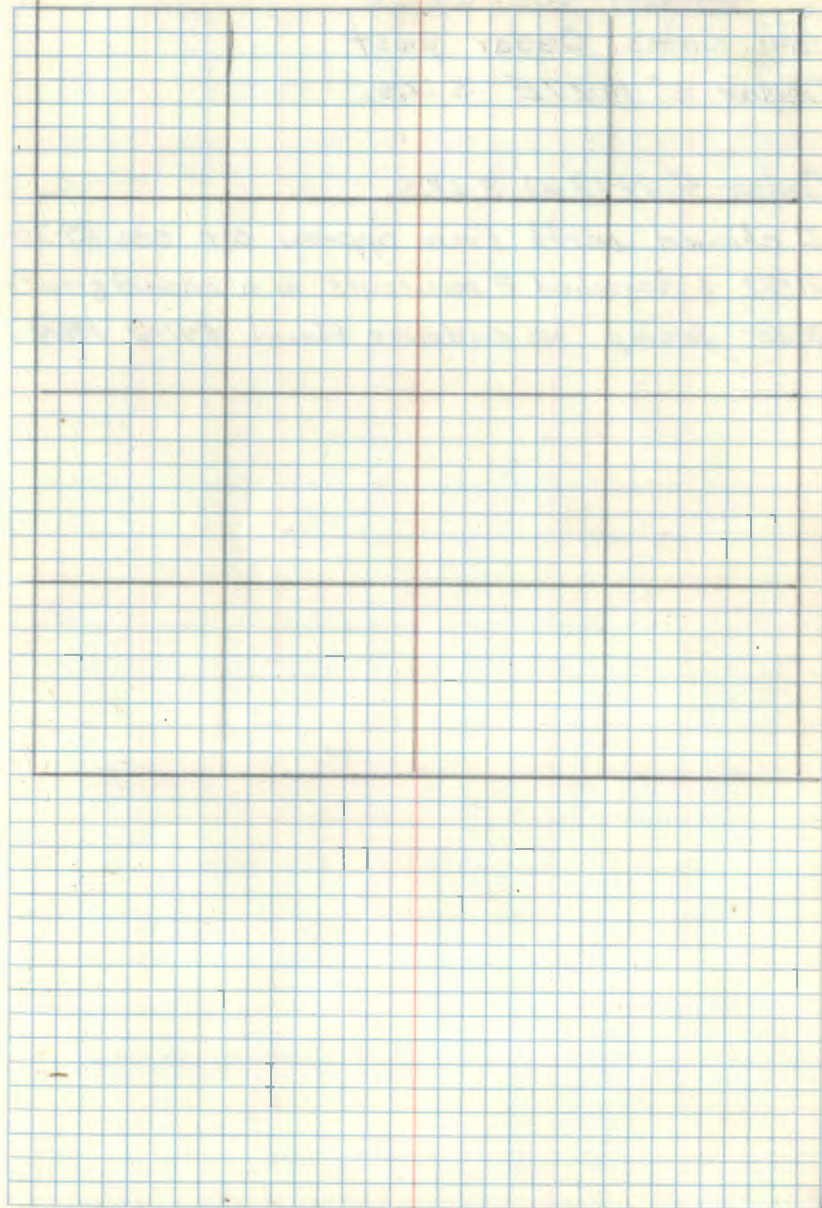

79

1-5

1/4 Cor. Sec. 29-30

Orig. notes: Cedar post

Cedar 6" N77E 3 Lks.

Cedar 4" N17W 3 Lks.

I chained north from approx. cor. sec. 29-30-31-32 & searched 2 man hours in a second growth cedar swamp no evidence found 5-11-61 R.H.S.

R9-5680-11 J.H.

CERTIFICATE FILED