

CORNER
RESTORATION

T 147 N R 31 W

RF
FIELD BOOK
820012

BOOK 2

CORNER RESTORATION T 147 N R 31 W

T. 147N P. 31W

BOOK # 2 5th

Mo.

USFS

Cut or

10
11
12
13
14
15
16
17
18
19
20
21
22
23
24
25
26
27
28
29
30
31
32
33
34
35
36
37
38
39
40

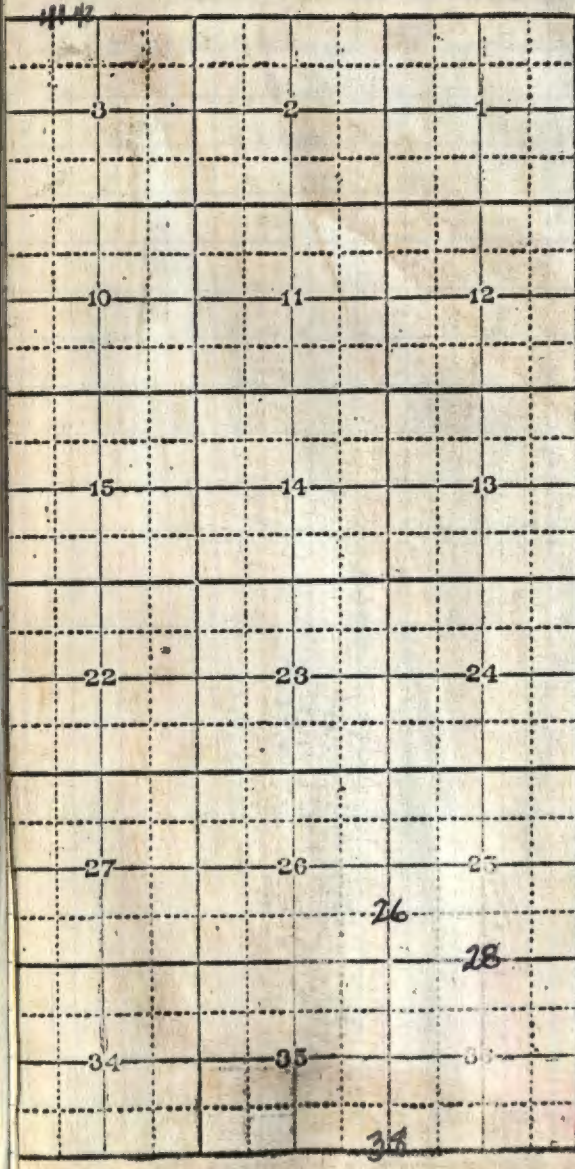
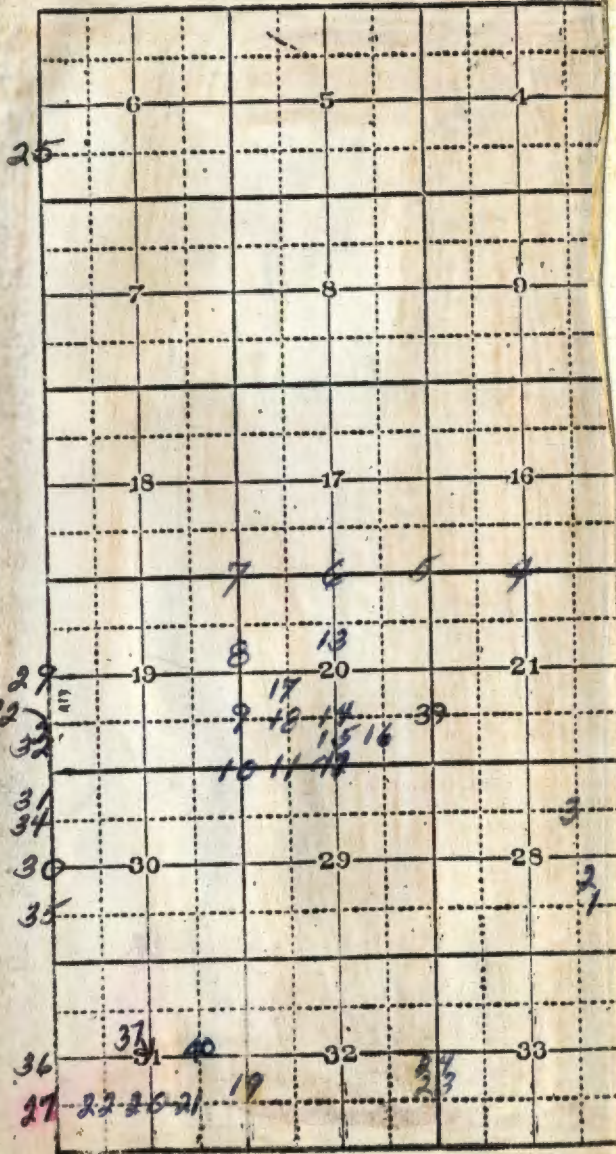

Scale - One

inch = 1 mile.

4-12, 13

Special Meander Cor. Sec. 28

G.L.O. Resurvey notes of 1931

Iron post 3' long 1" diam. with brass cap marked

S
35 / S S
C 28
1931

B. Ash 11" N18°E 22 1/2 - 14.52'

B. Ash 7" S66 1/4°E 47 1/2 - 31.02'

T₃4-12

Special Meander Cor. Sec. 28

G.L.O. Resurvey notes of 1931

Iron post 3' long 1" diam. with brass cap marked

S
M
C

S28

AP2

TR 121

1931

2

5-12

North East 1/16 Cor. Sec. 28

G.L.O. Resurvey notes of 1931

Iron post 3' long 1" diam. with brass cap marked

NE 1/16 S28

1931

Poplar 5" N74 $\frac{1}{2}$ °E 9 KS - 5.94'

Birch 4" S12 $\frac{1}{2}$ °W 26 KS - 17.16'

3

Cut or

KEU.

Quarter Cor. Sec's. 16-21

G.L.O. Resurvey notes of 1931

Iron post 3' long 1" diam. with brass cap marked

1	S 16
4	S 21
	1921

N. Pine 7" S57 $\frac{1}{2}$ °E 148.1K5- 97.68'

NOW N. PINE STP AT S57E 97.7'

J. Pine 5" N42 $\frac{3}{4}$ °E 90.1K5- 59.40'

NOW 10" J. PINE AT N43W 59.4'

TO PERPETUATE THIS CORNER I SET 5 $\frac{1}{2}$ " X 5 $\frac{1}{2}$ " X 24"

CONCRETE MONUMENT 14" BELOW SURFACE OF ROAD

WITH 3" DIA. BRASS TABLET MARKED

T147N R31W

1/4	S16
4	S21

1978

WITNESS BY

RLS NO. 12261

N. PINE 12 N69W 181.18 MKD 1/4 S16 BT

N. PINE 9 N48W 144.15 MKD 1/4 S16 BT

N. PINE 8 S57E 142.18 MKD 1/4 S21 BT

J. PINE 8 S1W 87.78 MKD 1/4 S21 BT

SET 4" X 4" X 8' CEDAR POST SOUTH 310' BOTH SIGNS

9-22-78

Curtis R. Keenan

BELT COUNTY REBUILT ROAD IN 1974

NEW TIES TO CORNER POSITION

BIRCH 9 N6E 100.83'

BIRCH 10 S46E 106.95'

J. PINE 9 S9E 86.35'

MONUMENT RESET FROM FOLLOWING BT'S.

1964 J. PINE BT N40E NOW STUB 5' HIGH

1974 J. PINE S9E 86.35 LIVING BT

1974 BIRCH S46E 106.95 LIVING BIRCH

MONUMENT NOT FOUND (GLO)

N-9

Sec. Cor. Sec's. 16-17-20-21

G.L.O. Resurvey notes of 1931

Brass Tablet 3'12" diam. 3" stem marked

T 147 N R 31 W

S 17 S 16

S 20 S 21

1931

BT's marked by C.C. Spencer

N. Pine 8" N21³/₄E 84 lks - 55.44'Burned N.
Pine Stump

N37°W 67 lks - 44.22'

New BT's

N. Pine 6" S31°E 283 lks - 186.78'

N. Pine 12" S75¹/₂°W 152 lks - 100.32'

N. Pine 10" N48°W 95 lks - 62.70'

9-28-79 G. BRANA

4x4x8 WOOD POST w/ SIGNS NORTH 42.54

N-7

Quarter Cor. Sec's. 17-20

G.L.O. Resurvey notes of 1931

Iron post 3' long 1" diam. with brass cap marked

1	S17
4	S20
	1931

BT's marked by local surveyor

N. Pine 12" S18°E 108 lks - 71.28'

J. Pine 8" N52½°W 106 lks - 69.96'

New BT

W. Pine 17" N35½°E 165 lks - 108.90'

8-25-65 W. OKERMAN

SET 6" X 24" CONCRETE MONUMENT 6" BELOW ROAD SURFACE CORNER

3" BRASS CAP MKD: T147NR31W

N51

S20

1964

RLS#66807

CORNER: 15" S18E 70.0FT

GLO W. PINE 22" N35½E 108.9FT

NEW R. PINE 15" S25W 56.8FT MKD: 4S20 BT

CEDAR 4" X 4" X 72" POST NORTH 180.1 FT

Sec. Cor. Sec's. 17-18-19-20

G. I. O. Resurvey notes of 1931

Brass Tablet $3\frac{1}{2}$ diam. 3"~~Iron post 3 long 1 diam.~~ stem marked

T 147N R 31W

S 18 S 17

S 19 S 20

1931

BT's marked by Local Surveyor

Burned N. ^{Stub}
Pine Stump 10' High 7" N134°W 124 lks - 81.84'Burned N.
Pine Stump N22 $\frac{3}{4}$ °W 57 lks - 37.62'

N. Pine 8" N29°W 92 lks - 60.72'

New BT's

N. Pine 12" N39 $\frac{1}{4}$ °E 329 lks - 217.14'W. Pine 8" S84 $\frac{1}{2}$ °E 303 lks - 199.98'N. Pine 12" S64 $\frac{3}{4}$ °W 115 lks - 75.96'N. Pine 12" N55 $\frac{3}{4}$ °W 208 lks - 137.28'

QP-5

8

- ≡ Meander Cor. of fracs. Sec's 19-20
- ⊥ G.L.O. Resurvey notes of 1931
- ⊥ Iron post 3' long 1" diam. with brass cap marked

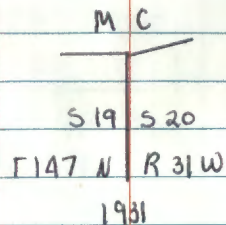

⊥
⊥
⊥
Original BT's

⊥
⊥
Fallon Cedar 12" S 65° W 50 1/2 - 33.00'

⊥
⊥
N New BT's
N. Pine 10" N 49 1/2° E 21 1/2 - 13.86'

⊥
⊥
N Cedar 5" N 72 1/4° W 33 1/2 - 21.78'

⊥
⊥
W

⊥
⊥
N.

⊥
⊥
N.

Q-5

South 1/16 Cor. Secs. 19-20

G.L.O. Resurvey notes of 1931

Iron post 3' long 1" diam. with brass cap marked

S 1/16

S 19 S 20

1931

Birch 8' S 19 1/2° E 16 1/2 - 10.56'

W. Pine 8' N 60 1/2° E 29 1/2 - 19.14'

R-5

Sec. Cor. Secs. 19-20-29-30

G. L. O. Resurvey notes of 1931

Brass Tablet

~~Iron post~~ 3 1/2" diam., 3" stem marked.

147 N	R31 W
5 19	5 20
5 30	5 29
1931	

Original BT's

Rotting Tam. Stump	12"	N 42° E	40 1/2 -	26.40'
-----------------------	-----	---------	----------	--------

Dead Tam.	6"	S 45° E	12 1/2 -	7.92
--------------	----	---------	----------	------

Rotting Tam. Stump	12"	S 65° W	36 1/2 -	23.76
-----------------------	-----	---------	----------	-------

Dead Tam.	8"	N 16° W	4 1/2 -	2.64'
--------------	----	---------	---------	-------

New BT's

Cedar	5"	N 68 1/2° E	52 1/2 -	37.32'
-------	----	-------------	----------	--------

Cedar	6"	S 52 1/2° E	21 1/2 -	13.86'
-------	----	-------------	----------	--------

Cedar	5"	S 21 1/2° W	36 1/2 -	23.76'
-------	----	-------------	----------	--------

Spruce	12"	N 20 1/2° W	17 1/2 -	11.22
--------	-----	-------------	----------	-------

R-6
West 1/16 Cor. Sec's 20-29
G.L.O. Resurvey notes of 1931
Iron post 3' long 1" diam. with brass cap marked

	S 20
W 1/16	<hr/> S 29
	1931

Cedar 6" S16°W 17 1/2' - 11.22'

Birch 8" N38½°W 2 1/2' - 1.32'

Meander Cor. of frac. Sec's. 20-29

G.L.O. Resurvey notes of 1931

Iron post 3' long 1" diam. with brass cap marked

T 147N R 31 W

S 20

S 29

MC

1931

Birch 10" S 89° W 105 ks - 69.30'

Cedar 10" N 53½° W 62 ks - 40.92'

O₃P-7

Special Meander Cor. Sec. 20

G. L. O. Resurvey notes of 1931

Iron post 3' long 1" diam. With brass cap marked

S M C

C

S 20

C

1931

Poplar 10" S 44 $\frac{1}{4}$ ° E 58 1/5 - 38.28'

Cedar 10" S 68 $\frac{1}{4}$ ° W 64 1/5 - 42.24'

Center
South 1/16 Cor. Sec. 20

Q-7

G.L.O. Resurvey notes of 1931

Iron post 3' long 1" diam. with brass cap marked

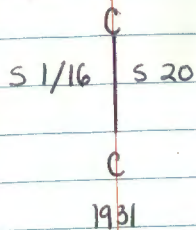

Maple 8" S 19 3/4° E 19 1/5 - 12.54'

Maple 6" N 88 1/2° W 18 1/5 - 11.88'

Q1R-7

Special Meander Cor. Sec. 20

G. L. O. Resurvey notes of 1931

Iron post 3' long 1" diam. with brass cap marked

C
S | 20
—|—
E

SMC

1931

Birch 4" N56³/₄°E 99 1/2' - 65.34'

Cedar 15" N10¹/₂°W 300 1/2' - 198.00'

Q, R-8

Special Meander Cor. Sec. 20

G.L.O. Resurvey notes of 1931

Iron post 3' long 1" diam. with brass cap marked

E
S | 20
—
E

SMC

1931

Elm 12" N4 $\frac{1}{2}$ °E 128.1K5- 84.48'

B. Oak 10" N11 $\frac{1}{2}$ °W 156.1K5- 102.96'

P, Q-6

Special Meander Con. Sec. 20

G. L. O. Resurvey notes of 1931

Iron post 3' long 1" diam. with brass cap marked

SMC
W
S 20
W
1931

Cedar 4" S55°E 12 1/2 - 7.92'

Birch 8" S20 1/4°W 21 1/2 - 13.86'

Q-6

South West 1/16 Cor. Sec. 20

G.L.O. Resurvey notes of 1931

Iron post 3' long 1" diam. with brass cap marked

SW 1/16 S 20

1931

Maple 12" N60°E 21 1/2 - 13.86'

Maple 16" S38 1/2°W 23 1/2 - 15.18'

X, Y-5

Meander Cor of frac. Sec 31-32

G.L.O. Resurvey notes of 1931

Iron post 1" diam. 28" in ground marked

T 147 N R 31 W

S 31 S 32

MB

1931

Original BT

B. Oak
Stump 16" N50°E 150 1K5- 99.00'

New BT's

Elm 8" N68³/₄°E 203 1K5- 133.98'

Elm 7" N11°E 117 1K5- 77.22'

Elm 10" N18³/₄°W 244 1K5- 161.04'

43

South 1/16 Cor. Sec. 31

G.L.O. Resurvey notes of 1931

Iron post 3' long 1" diam. with brass cap marked

C
S 1/16 | S 31
C
1931

Poplar 5" N 75 1/2° E 26 1/2 S - 17.16'

Poplar 8" S 54 1/2° W 26 1/2 S - 17.16'

20

Special Meander Cor. Sec. 31

G.L.O. Resurvey notes of 1931

Iron post 3' long 1" diam. with brass cap marked

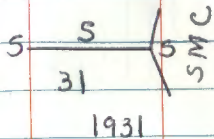

Ash 6" S82³/₄W 325 1/2 - 247.50'

Ash 4" N87°W 326 1/2 - 215.16'

South West 1/16 Cor. Sec. 31

G.L.O. Resurvey notes of 1931

Iron post 3' long 1" diam. with brass cap marked

SW 1/16 S 31

1931

N. Pine 9' N25°E 1.32 chs.

J. Pine 5' S47°4'W 37 1/3 - 24.42'

Meander Cor. Secs. 32-33

G.L.O. Resurvey notes of 1931

Iron post 3' long 1" diam. with with brass cap marked

T 147 N R31W

S 32 S33

MC

1931

Elm 16" S78 $\frac{3}{4}$ °E 89 1/3 - 58.74'

B. Oak 5" N55°W 98 1/3 - 64.68'

Meander Cor. Secs. 32-33

G.L.O. Resurvey notes of 1931

Iron post 3' long 1" diam. with brass cap marked

MC
532 533
T147 N R31W
1931

Basswood 9" S13°E 64 1/3 - 42.24'

Elm 16" S88 1/4°W 61 1/3 - 40.26'

affidavit 9/13/78

D-1

SOUTH 1/16 CORNER BETWEEN SECTION 1 & 6

DEC 22, 1977

BY STEFAN & HANE

POSITIONED THIS CORNER BY SURVEY FROM SECTION CORNER SOUTH & MEANDER CORNERS ON ROADSIDE LAKE.

1/4 CORNER FALLS IN LAKE, 239.6'

SOUTH OF MEANDER CORNER ON NORTH SIDE OF ROADSIDE LAKE, FROM 1923 PLOT BY SPENCER OF SUBDIVISION OF SECTION 1, T147N, R32W.

AT MID-POINT BETWEEN SECTION CORNER SOUTH & 1/4 CORNER NORTH IN LAKE AND ON LINE BETWEEN SECTION CORNER SOUTH & MEANDER CORNER ON SOUTH SHORE OF ROADSIDE LAKE I PLACED A 2" X 5', GALV. IRON PIPE, FILLED WITH CONCRETE, CAPPED WITH A 3" BRASS CAP, MARKED AS FOLLOWS:

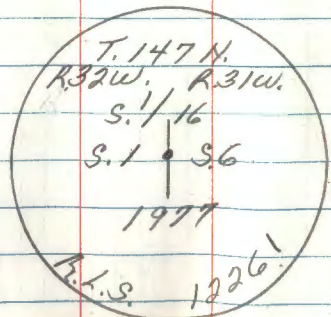

12/12/77

STEFAN & HANE

FROM WHICH THE FOLLOWING BEAR:			
CEDAR	CEDAR	B. ASH	POST-8'
10"	13"	6"	STEEL
N62°E	S33°E	S40°W	SOUTH
39.70'	32.50'	32.75'	3.2'

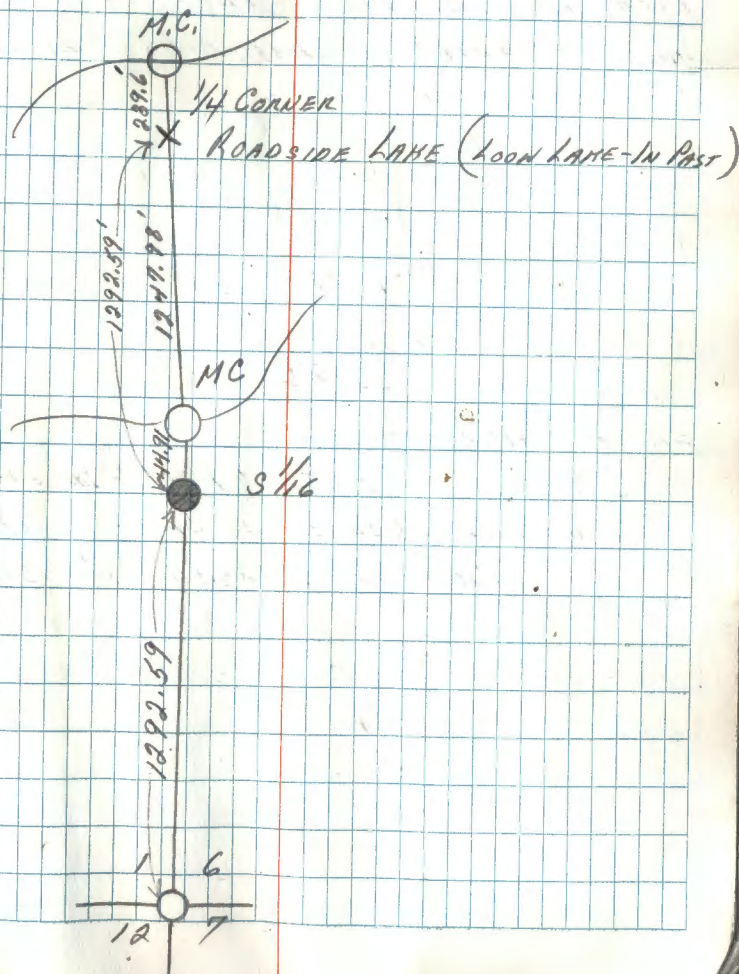

21-21
 SOUTH 1/16 BETWEEN SECTIONS 25 & 26
 JULY 24, 1978 STEFANY KRAUSE
 REPLACED 2 1/4" x 18" IRON PIPE, WHICH
 WAS PLACED AT MID-POINT BETWEEN
 SECTION CORNER SOUTH & 1/4 CORNER
 NORTH, WITH A 2" x 5' GALV. IRON
 PIPE FILLED WITH CONCRETE, WITH
 BRASS TABLET STAMPED AS FOLLOWS

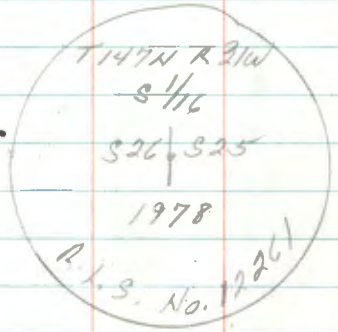

FROM WHICH BEAR:
 5" W. OAK, N 27° E, 22.70 " X " BT
 7" W. OAK S 10° E, 18.56' S 1/16 S 25 BT
 6" W. OAK N 74° W, 24.55 S 1/16 S 26 BT
 8' SIGN. POST SOUTH 2.6' WITH 54-284.
 FOUND IRON ON SOUTH EDGE OF
 OUR MONUMENT

Y-1

SOUTH $\frac{1}{16}$ BETWEEN SECTION 31 & 36
 SET 3' X 1" DIA IRON POST WITH
 BRASS CAP - BROKEN & BENT, 36" BELOW
 ROAD SURFACE
 FROM WHICH:

BURR OAK 7" N 65 $\frac{1}{2}$ ° E 325/MS 214.50

NOW A 14" LIVE W. OAK

BURR OAK 7" S 70° W 427/MS

IN FIELD (PASTURE) NO TRACE

11/8/78 -

STEFAN, KRAUSE, HAYNES

SET 2" X .36" STEEL GALV PIPE, CONCRETE
 FILLED WITH BRASS CAP MARKED AS FOLLOWS:

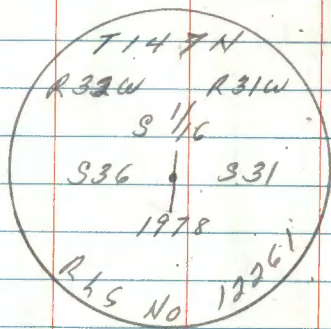

FROM WHICH:

8" TAM, S 89° E, 51.09, MKD - S $\frac{1}{16}$ S 31 BT

4" TAM, S 33° E, 96.30 MKD - X, BT

8' STEEL SIGN POST, EAST 30.0' $\frac{1}{16}$ S 31

SEE PLAT

27

28 Y-23

QUARTER CORNER BET. SEC'S. 25-36

NOTES OF ORIG. GOVT. SURVEY 1875

WOOD POST

N. PINE 10 S54E 24 LKS. 15.8'

BRG. AND DIST. FALLS IN DITCH

N. PINE 17 N2E 60 LKS. 39.6'

NOW ROTTED AND BURNED PINE STUMP FLAT BLAZE

AREA FAGING CORNER

BELT. COUNTY ROAD SURVEY 1923 BY E. ROGHOLT

FOUND BOTH ORIG. BT'S. MARKED

SET 1 1/2" X 24" GAS PIPE AND MARKED NEW BT.

N. PINE 10 S25E 28.7'

FD. LARGE PINE STUB MKD. 1/4 S 3 B - 7' HIGH X 18"

FD. 1 1/2" X 24" IRON PIPE JUST BELOW ROAD

TO PERPETUATE THIS CORNER I SET 5 1/2" X 5 1/2" X 24"

CONCRETE MONUMENT 12" BELOW SURFACE OF ROAD

WITH 3" DIA. BRASS TABLET MARKED T147N R31W

1/4 S25
S36

1978

RLS NO 12261

WITNESSED BY

TRIPLE W. OAK 8 S45W 28.52' MKD. 1/4 S36 BT

N. PINE 6 S37W 75.97' MKD. 1/4 S36 BT

N. PINE 8 S11W 106.54' MKD. 1/4 S36 BT

N. PINE 12 S25E 93.00' MKD. 1/4 S36 BT

SET 4" X 4" X 8' CEDAR POST SOUTH 14.0' BOTH SIGNS

OK
MJS

9-14-78

Curtis R. Krasow

28

06-08-2010 R. MAIN

FD MONUMENT IN PLACE, ALL 1978 BT'S ARE
LIVE. GPS IRON.

29 P-1

1/4 CORNER BT. SECTIONS 19 & 24

FROM ORIGINAL SURVEY OF
40.00 SET POST FOR 1/4 CORNER.

7" TAM S 5° W 369 LHS (243.54')

6" TAM S 89° E 179 LHS (118.14')

FROM COUNTY SURVEYORS NOTES OF
SECTION 19 SUBDIVISION SURVEY OF 1909BY RAY H. BLIXER; HE FOUND SE, BT
STANDING, SW BT A ROTTEN STUMP & SLIGHT
EVIDENCE OF POST.HE SET A NEW POST & CUT ONE
NEW BT, AN 8" TAM., N 1° E, 15'

5/17/79

STEFAN & HRAUSE

POSITIONED CORNER BY SINGLE PROPORTIONAL
METHODS FROM SECTION CORNER 1 1/2 MILES
NORTH & 1 MILE SOUTH FROM SURVEY BY
MILO STEFAN, 1979. SEARCHED AREA
VERY CAREFULLY AND NO TRACE OF PAST
CORNERS WERE FOUND.TO PERPETUATE THIS CORNER I SET
A 2" X 5' GALV. IRON PIPE, CONCRETE
FILLED WITH BRASS CAP STAMPED AS
FOLLOWS:

500 PLAT

29

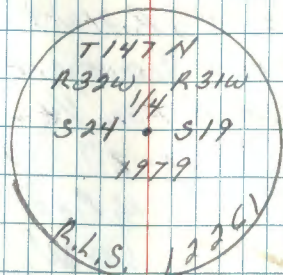

FROM WHICH THE FOLLOWING BEAR:

12" CEDAR, N 5° E, 91.33'

8" B. ASH, S 10° W, 26.22'

10" W. OAK, N 65° W, 91.81'

8' SIGN POST, EAST, 4.5'

8' SIGN POST, NORTH, 5.0'

T-1 1/4 CORNER BET SECTION 25430

T147N, R31W & R32W

FROM ORIGINAL SURVEY OF 9/1871

40.00 SET POST FOR 1/4 CORNER

18"

8"

Y. PINE

W. PINE

N71E

S19W

15 IHS

50 IHS

FROM COUNTY ROAD SURVEY OF

A LARGE BOLT AT SECTION CORNER.

5/16/79

KRAUSE & STERAN

FOUND BOLT (2" X 18" WITH FLAT TOP)

LEANING OVER AT INTERSECTION OF

OF ROAD WEST & SOUTH. AS OUR

PROPORTIONED POSITION OF THIS CORNER

ALONG THE RANGE LINE IS VERY CLOSE

I ACCEPT THE BOLT AS THE TRUE

LOCATION OF THE SECTION CORNER.

TO PERPETUATE THIS CORNER WE

PLACED A 2" X 36" GALV IRON PIPE

10" BELOW ROAD SURFACE WITH

BRASS CAP STAMPED AS FOLLOWS

SEE PLAT

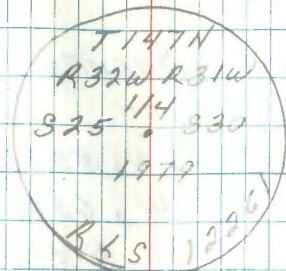

FROM WHICH THE FOLLOWING BEAR:

10" W. OAK, N 55° E, 90.98'

6" W. OAK, S 77° E, 44.58'

22" W. PINE, S 24° E, 126.85'

16" P. PINE, S 60° W, 186.65'

6" X 6" CEDAR POST, SOUTH, 15.75'

R, S-1 MEANDER COR. BET. SECTIONS ^{25/}30

FROM ORIGINAL SURVEY OF 1871

74.65 SET M.C.

5" TAM, S28W, 53 LKS

5" TAM, S4W, 63 LKS

5/17/79

STEFAN & KRAUSE

NO EVIDENCE FOUND OF THIS M.C.

BY SURVEY WE ESTABLISHED A
WITNESS CORNER ON THE SECTION
LINE SOUTH OF THE SECTION
CORNER WHICH IS IN THE LAKE.

POSITION MARKED BY A 2" X 36" GALV.
IRON PIPE, CONCRETE FILLED WITH
BRASS CAP MARKED AS FOLLOWS:

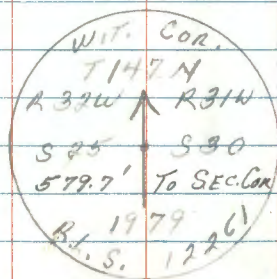

FROM WHICH THE FOLLOWING BEAR:

14" J. PINE, S4°E, 38.60'

7" R. PINE, S30°W, 50.95'

8" R. PINE, S75°W, 65.21'

8' SIGN POST, NORTH, 3.5'

8' SIGN POST, SOUTH, 4.2'

SEE PLAT

31

S 1/16 BT. SECTION 19424

5/17/79

STEFAN & KRAUSE

CORNER POSITION ESTABLISHED BY
SURVEY OF RANGE LINE AND PLACED
AT MID-POINT BETWEEN 1/4 CORNER
NORTH 4 SECTION CORNER SOUTH 4
ON LINE.

TO PERPETUATE THIS POSITION I SET
A 2" X 36" GALV. IRON PIPE, 32" IN
THE GROUND, CONCRETE FILLED, WITH
BRASS CAP STAMPED AS FOLLOWS:

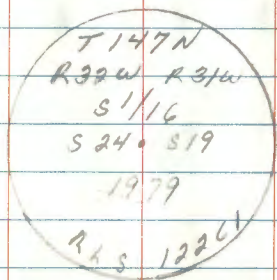

14" R. PINE, N 60° E, 53.45

14" R. PINE, S 60° E, 104.83

6" R. PINE, N 5° W, 34.421

8' SIGN POST, EAST, 4.9'

8' " " , SOUTH, 5.4'

ms

SEE PLAT

Q,R-1 MEANDER COR. BET. SEC. 24/19

SEE PLAT

33

FROM ORIGINAL SURVEY OF 1871

3.06 SET M.C.

5" TAN, N45°E, 38.145

6" " , N11°E, 63.145

5/17/79

STEFANY KRAUSE

NO EVIDENCE FOUND OF THIS M.C.

BY SURVEY WE ESTABLISHED A
WITNESS CORNER ON SECTION LINE

NORTH OF THE SECTION CORNER, MARKED

BY A 2" X 36" GALV. IRON PIPE FILLED
WITH CONCRETE, STRAPPED AS FOLLOWS:

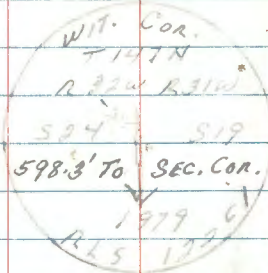

FROM WHICH THE FOLLOWING BEARS:

6" B. ASH, N 61° E, 47.50'

8" B. ASH, S 86° W, 85.65'

8" B. ASH, N 30° W, 23.10'

8' SIGN POST SOUTH 4.0'

8' " " " " NORTH 3.4'

WICK

SEE PLAT

S-1 N 1/4 BT. SECTIONS 25 & 30
BY SURVEY I ESTABLISHED
POSITION OF THIS CORNER ON
LINE & MID-POINT BETWEEN
THE SECTION CORNER NORTH &
1/4 CORNER SOUTH.

5/18/79

STEFANY HROUSE

TO PERPETUATE THIS CORNER WE
SET A 2" X 5' GALV. IRON PIPE
CONCRETE FILLED, 42" IN THE GROUND
WITH BRASS CAP STAMPED AS FOLLOWS:

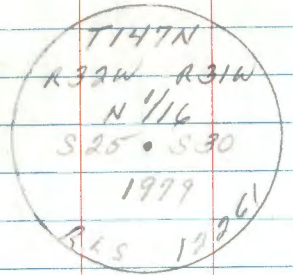

FROM WHICH THE FOLLOWING BEAR:

- 8" ASH, N14°E, 25.85'
- 8" ASH, S85°E, 25.37'
- 14" W. SPRUCE, S63°W, 45.12'
- 8' SIGN POST, EAST, 3.2'
- 8' SIGN POST, NORTH, 2.6'

MES

21-1 S¹/₄ BT. SECTION 30 & 25

By SURVEY WE ESTABLISHED
THE CORNER POSITION AT MID-
POINT & ON LINE BETWEEN THE
SECTION CORNER SOUTH & ¹/₄ CORNER
NORTH.

5/22/79

STEFAN & KRUSE

TO PERPETUATE THIS CORNER WE
SET A 2" X 36" GALV. IRON PIPE,
CONCRETE FILLED WITH BRASS CAP
STAMPED AS FOLLOWS:

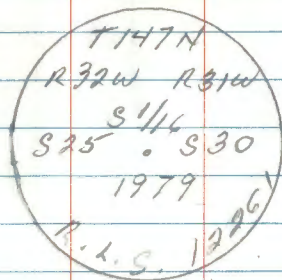

FROM WHICH THE FOLLOWING BEAR:

- 6" R. PINE, N 48° E, 62.46'
- " R. PINE, N 70° E, 139.32'
- 17" R. PINE, S 46° E, 121.20'
- 6" X 6" CEDAR SIGN POST, EAST, 35.31'

SEE PLAT

X-1 1/4 CORNER BT. SECTIONS 31 & 36

SEE BOOK 3, PAGE 72

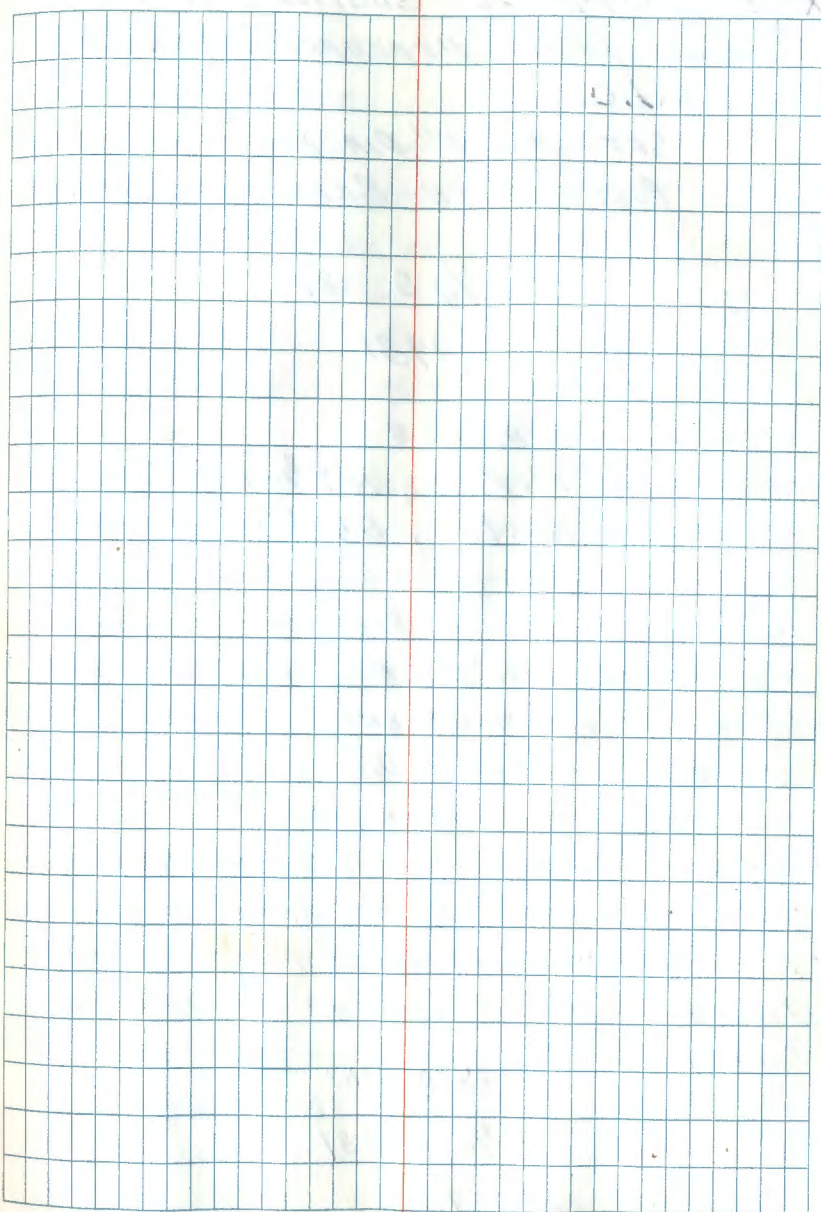

X-3 C¹/₄ To SECTION 31

FROM 1931 DEPENDENT RESURVEY
By G.L.O.

SET A 2" DIA X 3' LONG IRON
POST WITH BRASS CAP MARKED

C¹/₄S 31

1931

FROM WHICH B

*
4" W. PINE, N 9³/₄° E, 38¹/₂ IN 25.4'
4" Non. PINE, S 47¹/₂° W, 17¹/₂ IN 11.5'

11/8/78

STEFAN, HAYES, HRAUSE

WE FOUND N 10° E A 12" R. PINE, 25.4'
FROM ABOVE MONUMENT. NO TRACE
OF W. PINE. B.T. DISTANCE WEST TO
POSITIONED ¹/₄ CORNER, OK.

5/22/79

STEFAN & HRAUSE

TO REEVALUATE THIS CORNER WE SET
A 2" X 36" GALV. IRON PIPE, CONCRETE
FILLED, WITH BRASS CAP STAMPED AS
FOLLOWS:

T147N R31W

C¹/₄ • S31

1979

R.L.S. 12261

FROM WHICH THE FOLLOWING BEARS:

12" R. PINE, N 10° E, 31.82' *

13" R. PINE, N 10° W, 54.72'

13" R. PINE, N 44° W, 100.78'

6" X 6" CEDAR POST, NORTH, 34.1'

* THIS IS G.L.O. 1931 BT WHICH IS
AS RECORDED ABOVE. UPON REMOVAL OF
BENT G.L.O. PIPE WITH CAP GONE, WE
DUG TO BASE OF PIPE & 30" DOWN WE
LOCATED VERY DECAYED POST POINT. WE
PLACED BASE OF OUR NEW MONUMENT
AT BASE OF G.L.O. PIPE & PLUMBED
OURS UP. BRASS CAP IS FLUSH WITH
GROUND SURFACE, 2' SOUTH OF ROAD
CUT.

2-2/

SECTION CORNER TO SECTIONS
1, 2, 35 & 36, T147 & 146N, R31W
ORIGINAL SURVEY OF 1874

RESURVEY OF 1931 BY GLO
SET 6" X 24" CONCRETE MONUMENT
WITH B.C. - GLO BT

7" R. OAK, N20°E, 66.7'

5" W. OAK, N89°E, 36.3'

COUNTY BT'S

6" R. OAK, S89°W, 48.2'

6" " " , N88°W, 27.7'

9/14/78

KRAUSE & TOBIN

MONUMENT HAS BEEN REMOVED BY
30" CUT IN ROAD.

FOUND 3 ABOVE R. OAK BT, STUMPS
W. OAK IS 12" & LIVING.

NEED REMONUMENTATION.

MIES 6/7/79

9/14/78 Krause & Tobin (from form R9-7150-4)

No monument found - road has been cut approx. 30" at
corner location. Set ^{temp} spike at location 6" deep - from
NE. Red Oak and SE. W. Oak as recorded below:

Found: Red Oak Stp, 30" high 16" dia., S29°W 48.2'
with scribe visible

38

9/14/79 cont.

Found: Red Oak Stp, well decayed, N88°W, 27.7' BT visible

Found: Red Oak Stp, 18", N20°E 66.7' all scribe visible

OK Found: W. Oak, living, 12", S89°E, 36.3', Overgrown and has
scar and wire grown into tree

The NE BT has been cut down and split open to
expose scribe approx. 10 years ago. Negative scribe on
stump, also pieces lying by stump with scribe visible.

1980 Krause & Brama (from form R9-7150-4)

No monument found. From the NE and SE BT's
found in 1978 set a galvanized, concrete filled 2" dia
by 34" long iron pipe with brass tablet marked:

T147NR31W

35 | 36

2 | 1

T146N

1930

ALS 40

Set 12" below road.

From which the following bear:

OK R. Pine 7" N76°W 69.10' scribed T147NR31W S36 BT

OK R. Oak 8" N22°E 116.90' scribed T147NR31W S36 BT

GONE WINDFALL Pine 11" N64°E 59.77' scribed T147NR31W S36 BT

G.L.O. W. Oak 12" S89°E 36.5' rescribed BT

Corner falls 2' East of 4 N-S gravel road on
side hill of ridge in 30" cut of road. Paced rocks
around monument. (above data entered this book 10/19/83
by ~~me~~ from forms R9-7150-4)

6-08-2010 R MAEN.

GPS IRON

Q-9

M.C. ON NORTH SHORE OF BIG LAKE BET SEC'S 20-21

NOTES OF GLO RESURVEY 1931

SET IRON POST 1" DIA. X 36" LONG

WITH BRASS CAP MARKED

FD. IRON AND CAP - NOT IN PLACE T147N R31W

PUSHED NORTH 25' BY ICE S20 | S21

AND WATER - LOCATION OF CORNER MC

IS NOW IN 14" OF WATER 1931

WITNESSED BY

POPLAR 9 • N33½E 63 LKS. = 41.6'

FD. POPLAR STUMP AND LOG N33E - 41.6' ^{INSIDE TREE} SCRIBE VISIBLE

BIRCH 7 • N88W 35 LKS. 23.1'

ICE RIDGE HAS BEEN PUSHED NORTH - NO EVIDENCE

REMAINS ON PRESENT LAKE SHORE

TO PERPETUATE THIS CORNER - SET 2" DIA. X 36" LONG

GALVANIZED STEEL PIPE WITH CONCRETE INSIDE

AND CAPPED WITH 3" DIA. BRASS TABLET MARKED

BRASS CAP IS 6" ABOVE T147N R31W

GROUND - HIGH RIDGE NORTH S20 | S21

GRASS SWAMP WITH ASH AND BRUSH MC

SOUTH TO LAKE ↓ WC

WITNESSED BY

RLS NO 12261

ASH 5 S62E 23.60 MKD WCMC S21 BT

ASH 6 S7E 34.12 MKD WCMC S21 BT

ASH 6 S70W 34.00 MKD WCMC S20 BT

9-20-79 Curtis R. Krause

TEMPARY TIES '78
BOX ELDER 5" WEST 9.00'
ASH 3" SW 11.53'

39

TO REESTABLISH GLO LOCATION - MEASURE DISTANCE

SOUTH OF ¼ COR. 20.50 LKS. OR 1353' THEN

PULL DISTANCE AND BEARING FROM POPLAR STUMP

THIS NOW GAVE US TRUE LINE. WE ESTABLISH OUR

POINT ON TRUE LINE AT BASE OF 40' HILL AND

APPROXIMATELY 60' NORTH OF PRESENT SHORE LINE

LINE NORTH OF THIS CORNER IS TO F.S. STANDARD

2/17/81 Newly established monument is

100.0' North of 1931 position. Stamped

arrow on monument pointing South.

MCFoy

R9-7150-41

CENTER EAST 1/16 IN SECTION 31

SET AT PROPORTIONAL DISTANCE BETWEEN
C 1/4 AND E 1/4 - FOUND 1 1/4 X 24" BY 10" HIGH IRON PIPE
AT APPROX. LOCATION 9-25-79 CK

RAN TRAVERSE BETWEEN C 1/4 OF SEC 31 AND
E 1/4 SEC. 31 TOTAL DISTANCE 2640.5'

IRON FOUND AT CE 1/16 NEEDS TO BE MOVED

• .35 NORTH AND .31 EAST OR N 40° 57' 43" E

• .47 FROM LOCATION NOW

TO PERPETUATE THIS CORNER SET 2" DIA X 36" LONG

GALVANIZED STEEL PIPE WITH CONCRETE INSIDE AND

CAPPED WITH 3" DIA. BRASS TABLET MARKED

RESET IRON PIPE BESIDE

T147NR31W

F.S. MONUMENT

C E 1/16 C

S31

1979

FROM WHICH BEAR

RLS NO 12261

W. PINE 13 N13E 35.23' MKD. CE 1/16 S31 BT

W. PINE 13 N46E 79.42

W. PINE 14 N83E 96.33

8' STEEL POST SET EAST 3.65' WITH BOTH SIGNS

8' STEEL POST SET NORTH 3.70' WITH BOTH SIGNS

10-17-79

R9-7150-4

LINE EAST OF CE 1/16 IS MARKED TO F.S.

STANDARD BY D. KANE BLACKDUCK DISTRICT

9-24-79

West $\frac{1}{16}$ Between Sections 3 & 34 of
T148N

Notes of CC Spencer FB 240184 Belt. Co.

1925 SET Cedar post to mark corner

Cedar Plank 6" S. 15.9'

Tam. 6" S40E 14.5'

Notes by AL BYE FF 148-31 Belt. Co.

1927 Fd BTS (recorded wrong)

SET Iron pipe

3/25/87 JA RF

Chained 1328.5 (CC Spencer's Dist) from
SEC COR NE 4 East - Fd Iron pipe

Dist checks and is on line from $\frac{1}{16}$ COR
TO SEC COR

Fd: $\frac{3}{4}$ " Iron pipe up 2" in ice

Left as found

BT: Tam 8" N40E 14.5' base in ice

cut off - now 10' stubs leaning - Tag

SET

BT: Tam 5" S31W 32.15' W $\frac{1}{16}$ S3BT

Tam 5" S78E 27.85' W $\frac{1}{16}$ S3BT

N. Pine 22 N70W 105.50' BT

all trees have spikes, tags, red rings

Corner falls in swamp - high ground
WEST 100' EAST 150'

Line TO STANDARD East and West
Fiber glass sign post EAST 30'

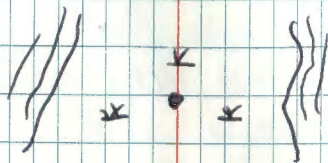

meander CoR sec 3E 34

West Bank of South Twin Lake

For history of original and 1964 monumentations
see Book 4 p. 79

1914 Everts or Spencer FB M2429 Relt. Co.

Fd: two original BTS:

W. Pine 20" S09W 19.1'

Aspen Stamp N72W 22.4'

SET:

Aspen 5" N83W 27.0'

1962 AH Bye RLS for John K. Stol+ener
property indicates Iron in place
established from original BST

W. Pine 10" S7-30W 19.1'

1976 W H Okerman RLS Plat of Twin
Lake Estates First Add indicates
this corner

4/6/87 JA GB

Chained 2215' East from 114 (iron pipe)

Fd: dist checks - Brass capped concrete
monument up 18' OK

1964 BTS:

Cedar 12" N29W 15.1'

N. Pine 15" S51E 11.8' steel sign post

W. Pine 29" S09W 19.14' 6' west 12.4' OK

SCAPE visible on All BTS

new tags and red rings

3/4 From pipe East 15.5' up 1' and 1'

south of proper line East-West

SET:

Fiberglass sign post 8' East 13.9'

" " " " West 4.0'

Line to standard run west - Lot Irons

along this line - Lot 15 of Block 3

the SW corner Lot Irons had been moved

approx 12' south - left as found

Corner falls on high ground 20' west of shore

JH Allison
4/27/87

CENTER QUARTER SECTION 36

9-5-2012 R. MAIN

SET A 4' X 2" GALVANIZED STEEL PIPE
WITH 3" BRASS CAP 8" ABOVE GROUND.

CAP STAMPED THTNR3IW
C# 536
2012
U.S.P.S.

R PINE 13" S50W 5.32' TO SPK MKD: 536 BT

R PINE 5" S20E 4.70' TO SPK MKD: 8 X BT

REMAINDER OF
BOOK IS EMPTY