

T146NR31W

TRAVERSE

BOOK #4

FIELD BOOK

82.0012

T146NR31W

TRAVERSE BK4

### DISTANCES FROM SIDE STAKES FOR CROSS-SECTIONING

Roadway of any Width. Side Slopes 1½ to 1.

In the figure below: opposite 7 under "Cut or Fill" and under .3 read 11.0, the distance out from the side stake at left. Also, opposite 11 under "Cut or Fill" and under .1 read 16.7, the distance out from the side stake at right.

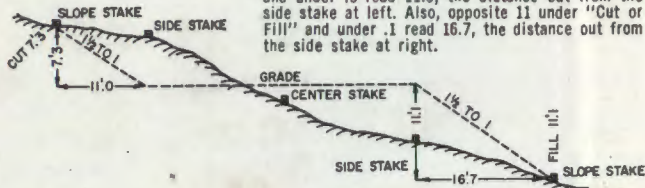

Cut or Fill	Distance out from Side or Shoulder Stake									Cut or Fill	
	0	.1	.2	.3	.4	.5	.6	.7	.8		.9
0	0.0	0.2	0.3	0.5	0.6	0.8	0.9	1.1	1.2	1.4	0
1	1.5	1.7	1.8	2.0	2.1	2.3	2.4	2.6	2.7	2.9	1
2	3.0	3.2	3.3	3.5	3.6	3.8	3.9	4.1	4.2	4.4	2
3	4.5	4.7	4.8	5.0	5.1	5.3	5.4	5.6	5.7	5.9	3
4	6.0	6.2	6.3	6.5	6.6	6.8	6.9	7.1	7.2	7.4	4
5	7.5	7.7	7.8	8.0	8.1	8.3	8.4	8.6	8.7	8.9	5
6	9.0	9.2	9.3	9.5	9.6	9.8	9.9	10.1	10.2	10.4	6
7	10.5	10.7	10.8	11.0	11.1	11.3	11.4	11.6	11.7	11.9	7
8	12.0	12.2	12.3	12.5	12.6	12.8	12.9	13.1	13.2	13.4	8
9	13.5	13.7	13.8	14.0	14.1	14.3	14.4	14.6	14.7	14.9	9
10	15.0	15.2	15.3	15.5	15.6	15.8	15.9	16.1	16.2	16.4	10
11	16.5	16.7	16.8	17.0	17.1	17.3	17.4	17.6	17.7	17.9	11
12	18.0	18.2	18.3	18.5	18.6	18.8	18.9	19.1	19.2	19.4	12
13	19.5	19.7	19.8	20.0	20.1	20.3	20.4	20.6	20.7	20.9	13
14	21.0	21.2	21.3	21.5	21.6	21.8	21.9	22.1	22.2	22.4	14
15	22.5	22.7	22.8	23.0	23.1	23.3	23.4	23.6	23.7	23.9	15
16	24.0	24.2	24.3	24.5	24.6	24.8	24.9	25.1	25.2	25.4	16
17	25.5	25.7	25.8	26.0	26.1	26.3	26.4	26.6	26.7	26.9	17
18	27.0	27.2	27.3	27.5	27.6	27.8	27.9	28.1	28.2	28.4	18
19	28.5	28.7	28.8	29.0	29.1	29.3	29.4	29.6	29.7	29.9	19
20	30.0	30.2	30.3	30.5	30.6	30.8	30.9	31.1	31.2	31.4	20
21	31.5	31.7	31.8	32.0	32.1	32.3	32.4	32.6	32.7	32.9	21
22	33.0	33.2	33.3	33.5	33.6	33.8	33.9	34.1	34.2	34.4	22
23	34.5	34.7	34.8	35.0	35.1	35.3	35.4	35.6	35.7	35.9	23
24	36.0	36.2	36.3	36.5	36.6	36.8	36.9	37.1	37.2	37.4	24
25	37.5	37.7	37.8	38.0	38.1	38.3	38.4	38.6	38.7	38.9	25
26	39.0	39.2	39.3	39.5	39.6	39.8	39.9	40.1	40.2	40.4	26
27	40.5	40.7	40.8	41.0	41.1	41.3	41.4	41.6	41.7	41.9	27
28	42.0	42.2	42.3	42.5	42.6	42.8	42.9	43.1	43.2	43.4	28
29	43.5	43.7	43.8	44.0	44.1	44.3	44.4	44.6	44.7	44.9	29
30	45.0	45.2	45.3	45.5	45.6	45.8	45.9	46.1	46.2	46.4	30
31	46.5	46.7	46.8	47.0	47.1	47.3	47.4	47.6	47.7	47.9	31
32	48.0	48.2	48.3	48.5	48.6	48.8	48.9	49.1	49.2	49.4	32
33	49.5	49.7	49.8	50.0	50.1	50.3	50.4	50.6	50.7	50.9	33
34	51.0	51.2	51.3	51.5	51.6	51.8	51.9	52.1	52.2	52.4	34
35	52.5	52.7	52.8	53.0	53.1	53.3	53.4	53.6	53.7	53.9	35
36	54.0	54.2	54.3	54.5	54.6	54.8	54.9	55.1	55.2	55.4	36
37	55.5	55.7	55.8	56.0	56.1	56.3	56.4	56.6	56.7	56.9	37
38	57.0	57.2	57.3	57.5	57.6	57.8	57.9	58.1	58.2	58.4	38
39	58.5	58.7	58.8	59.0	59.1	59.3	59.4	59.6	59.7	59.9	39
40	60.0	60.2	60.3	60.5	60.6	60.8	60.9	61.1	61.2	61.4	40

## U.S. DEPARTMENT OF AGRICULTURE FOREST SERVICE CUMBERLAND NATIONAL FOREST, MINNESOTA



The paper in this book is made of 50% high grade rag stock with a WATER RESISTING surface sizing.

KEUFFEL & ESSER CO.

PG#

INDEX

USFS

I

50-66 TRAV AROUND SW<sup>1</sup>/<sub>4</sub> SECTION 5. POSITION  
FOR SW<sup>1</sup>/<sub>16</sub> 55 ON PG#65

---

PG

2-56 TRAV SE 16

II

R

1917

1917

1917

1917

1917

1917

1917

1917

III

1917

1917

1917

1917

1917

1917

1917

1917

1917

1917

1917

1917

1917

1917

1917

1917

1917

1917

1917

1917

1917

1917

1917

1917

1917

1917

1917

1917

1917

1917

1917

1917

1917

1917

1917

1917

1917

1917

1917

1917

1917

1917

1917

1917

1917

1917

1917

1917

1917

1917

1917

1917

1917

1917

1917

1917

1917

1917

1917

1917

1917

1917

1917

1917

1917

1917

1917

1917

1917

1917

1917

1917

1917

1917

1917

1917

1917

1917

1917

1917

1917

1917

1917

1917

STATION OCCUPIED	STATION SIGHTED	1st & VERTICAL ANGLE	2nd ANGLE SLOPE DISTANCE	MEAN ANGLE	HORIZONTAL DISTANCE
12/21/81	T.146 N R. 31W	bet sec. 8/9			
		BRAMA, Klaus - Clear, 32°F			
12	11	391° 59.00	449.89		449.62

This info. was placed in the  
 this book as it was the  
 only book available on 12/21/81

T146 NR 31W  
 Distance Tie to W 1/4 sec. 9

Pt. 11 is 1/4 cor bet. sec. 8/9

STATION OCCUPIED	STATION SIGHTED	1st & VERTICAL ANGLE	3rd ANGLE SLOPE	MEAN ANGLE	HORIZONTAL DISTANCE
	Pt. A	090 00 30			
Pt 1		180 00 36			
	Pt 2	092-16-38	092-16-09		
		272-16-46			
				92-16-07.25	check
	Pt A	090-00-35			
		270 00 40	092-16-05.5		
	Pt 2	182-16-39			
		092-16-47			
			5/16/85		
Pt 1	Pt A	Flat from previous survey	43	419.72	419.72
		11	43		
		42			
		33	37.5		
		9	5.5		

T146NR31W SEC 16  
5/16/85 JAT GBM LK

2

Pt. A is the point <sup>we</sup> painted in from previous survey as pt. #16.

Pt 1 is sec. cor. 8, 9, 10, 17

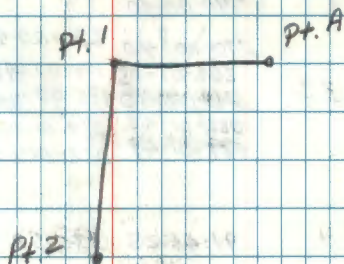

STATION OCCUPIED	STATION	1st & VERTICAL	3rd ANGLE SLOPE	MEAN ANGLE	HORIZONTAL DISTANCE
	Pt 1	000-00-30	00-00-30		
PT 2		180-00-13	180-00-40		
		180-00-12	180-00-40		
PT 3		<del>178-00-48</del>	<del>178-00-40</del>	178-00-45.5	
		178-00-40	178-00-37		
		358-01-15	178-01-21		178-00-45
		<del>358-01-16</del>	<del>358-01-20</del>		
					<del>178-00-40.75</del>
	1	<del>90-00-59</del>	090-00-30		<del>178-00-36.25</del>
		90-00-50			
		270-00-40	270-00-40		
3		268-01-15	178-00-41.5		
		268-01-10	178-00-35.5	178-00-44.5	
		088-01-43	268-01-16		
		088-01-49	088-01-23		
PT 2	1	91-46-25	335.53	335.37	
			.56		
	3	89-28-46	992.56	992.52	
PT 2		00-00-30			
PT 3		180-00-33			
PT 4		180-26-10	180-25-48.5		
		000-26-18			
					180-25-48.5
	2	090-00-36			
		270-00-40			
	4	270-26-19	180-25-44.5		
		90-26-26			
			89	74	7
			47.5	31.5	38
			42.5	43.3	44.5
		24.5			
		45			
		49.0			
58					
21					
37					

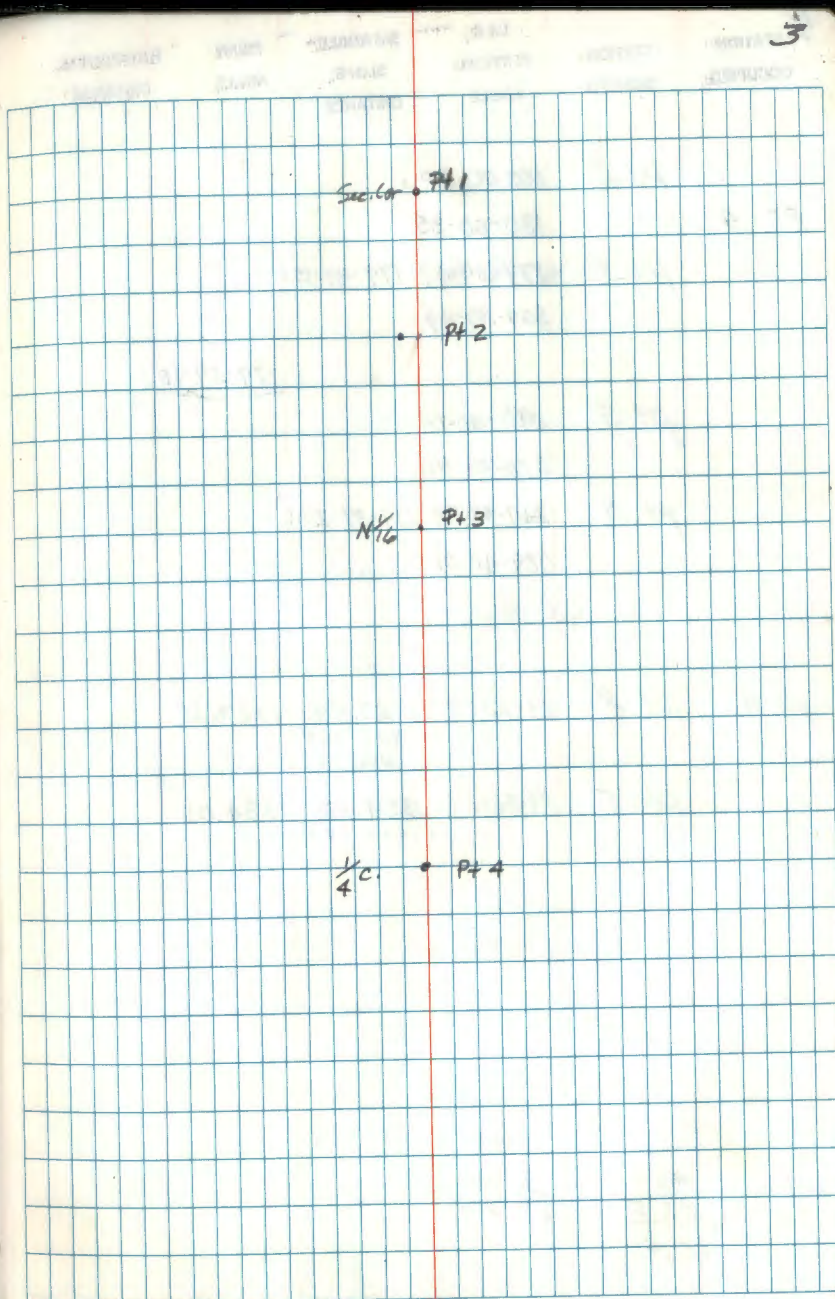

4. STATION OCCUPIED	STATION SIGHTED	1st & VERTICAL ANGLE	3rd ANGLE SLOPE DISTANCE	MEAN ANGLE	HORIZONTAL DISTANCE
---------------------	-----------------	----------------------	--------------------------	------------	---------------------

	pt 3	000-00-30			
pt 4		180-00-35			
	pt 5	179-39-47	179-39-15.5 ✓		
		359-39-49			

179-39-18 ✓

	pt. 3	090-00-34			
		270-00-40			

	pt. 5	269-39-54	179-39-20.5 ✓		
		089-40-01			

pt 4	pt. 3	89-36-07	1327.59	1327.56	
			↓ 1327.725		
			↑ 1404.691		

	pt. 5	89-56-29	1334.05	1334.05	
			↓ 1334.185		

	57.5
48	37
<u>32.5</u>	20.5
15.5	

7.25

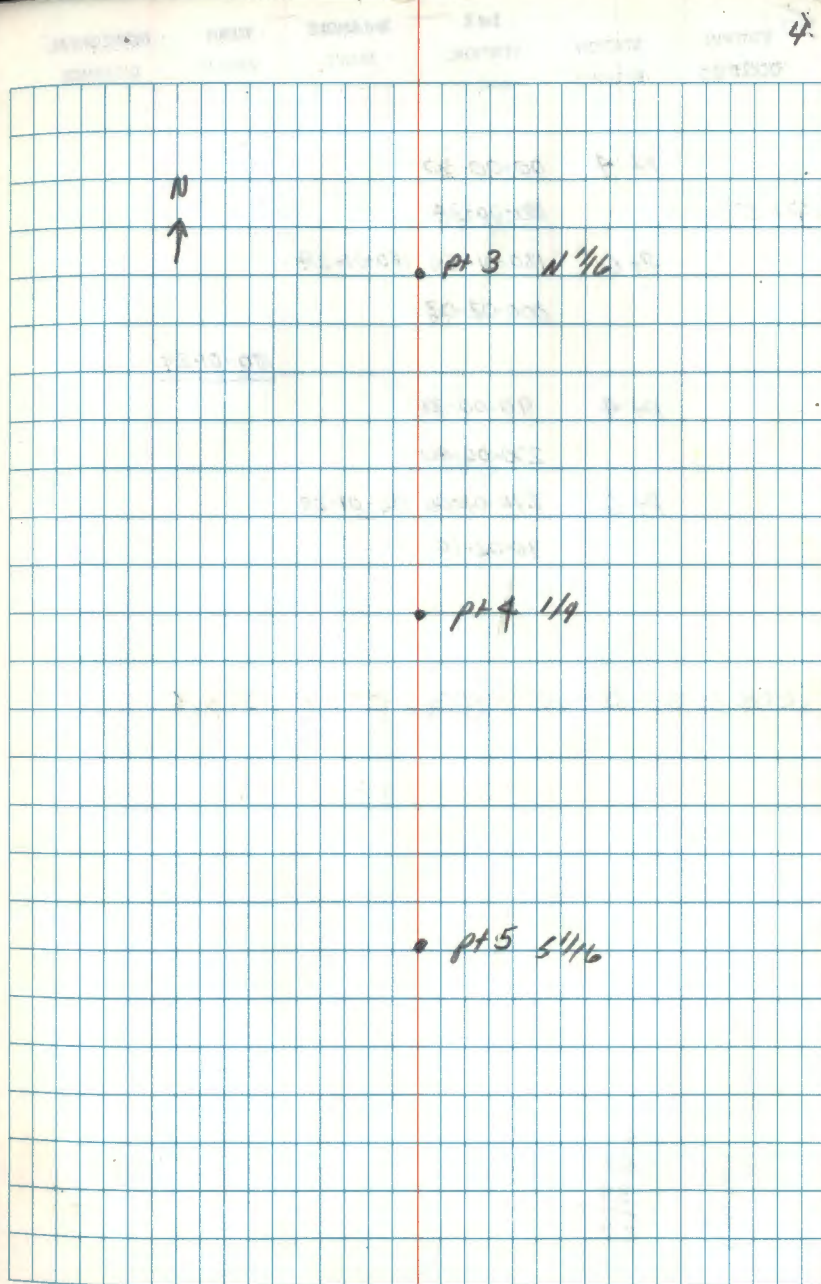



STATION OCCUPIED	STATION SIGHTED	1st & VERTICAL ANGLE	3rd ANGLE SLOPE	MEAN ANGLE	HORIZONTAL DISTANCE
	Pt 4	00-00-30			
Pt 5		180-00-34			
	Pt 6	180-01-59	180-01-29 ✓		
		000-02-03		<u>180-01-29</u> ✓	
	Pt 4	90-00-38			
		270-00-40			
	Pt 6	270-02-06	180-01-29 ✓		
		90-02-10			

5	5
61	68
32	<u>37</u>
<u>29</u>	29

• Pt 4

• Pt 5

• Pt 6 Sec Cor 16, 17, 20, 21

STATION OCCUPIED	STATION SIGHTED	1st ANGLE VERTICAL ANGLE	2nd ANGLE SLOPE DISTANCE	MEAN ANGLE	HORIZONTAL DISTANCE
	P+5	00-00-30			
P+6		180-00-38			
	P+7	86-39-26	86-38-55.5 ✓		
		266-39-33			
				<u>86-38-56.25</u> ✓	
	5	090-10-29			
		270-00-40			
	7	176-39-28	86-38-57 ✓		
		356-39-35			
P+6	5	89-49-58	1334.46	1334.45	
	7	89-02-22	555.31	555.23	555.2105 <sup>with</sup>

END OF USING HP3800

29.5	41.5
34	34.5
55.5	57.0

END OF DAY

P+5

P+6

P+7

STATION OCCUPIED	STATION SIGHTED	1st & VERTICAL ANGLE	3rd ANGLE SLOPE DISTANCE	MEAN ANGLE	HORIZONTAL DISTANCE
	pt 6	000 00 30			
pt 7		4 180-00-18			
(w/116) s.s. pt 8		2 180-06-26	180-06-14 ✓		
		5 000-06-50			
(114) pt 9		3 180-04-33	180-04-23.5 ✓		
		4 000-05-02			
pt 7	pt 6	6 090-00-52			
		1 270 00 40			
s.s. pt 8		5 270-06-47	180-06-16 ✓	180-06-15 ✓	
		2 090-07-17			
pt 9		4 270-05-02	180-04-30.5 ✓	180-04-27 ✓	
		3 090-05-31			
pt 7	pt 6	90-59-34	555.385	555.300	555.265
(w/116) pt 8		90-15-22	772.470	772.46	
(114) pt 9		89-48-30	2099.850	2099.84	
4 5		14.5			
29		38	33	46	76
		24	47.5	46	46
47.5	02	14	24	30	30
17		38	27.5	62	
62.5		27	46	46	
		76.5	16	562	47.5
		46		46	29
		30.5		16	57

JAT CK 613 7/2/85 7  
Topcon EDM

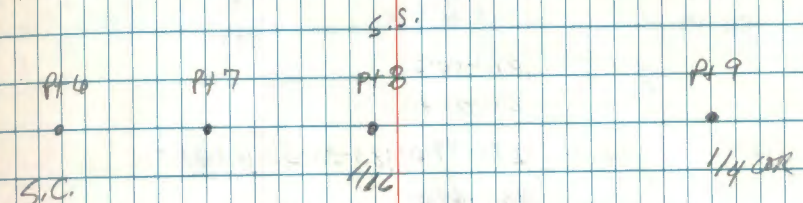

pt 7 ties:

8" J. Pine NE 6.12  
9" J. Pine SE 9.23  
spt on edge of furrow

STATION OCCUPIED	STATION SIGHTED	1st B VERTICAL	2nd ANGLE SLOPE	MEAN ANG B	HORIZONTAL DISTANCE
	pt 7	000 00 30			
pt 9		180-00-36			
	pt 10	183-39-00	183-38-44	183-38-31	
	side shot	003-39-08			
		<del>003-39-53</del>			
	pt 8	359-59-15	359-58-54	359-58-46	
		179-59-25			
		<del>360 00 00</del>			
	pt 7	090-00-22			
		270-00-40			
pt 9	pt 10	273-39-00	183-38-32	183-38-31.5	
	side shot	093-39-06			
	pt 8	089-59-23	359-58-51.5	359-58-48.75	
		269-59-22			
pt 9	pt 8	090-17-00	1327.43	1327.41	
		METERS	404.594	1327.41	
pt 9	pt 10	070-14-29	1111.410 <sup>36</sup>	1111.400	
			338.759m		
79	64	82.5	63	1327.43	
<u>33</u>	<u>33</u>	31	31	772.47	
46	31	51.5	32	2099.90	

Lots of heat waves occupying pt 9

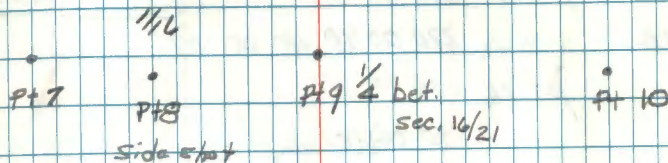

9

STATION OCCUPIED	STATION SIGHTED	1st & 2nd ANGLE VERTICAL ANGLE	3rd ANGLE SLOPE DISTANCE	MEAN ANGLE	HORIZONTAL DISTANCE
------------------	-----------------	--------------------------------	--------------------------	------------	---------------------

pt 9 000 00 30

pt 10 180 00 43

pt 11 180 00 37 180 06 05.5

000 00 47

pt 9 090 00 30

180-00-06.25

pt 10 270 00 40 180 00 07

pt 11 270 00 39

090 00 45

$$\begin{array}{r} 111 \\ 42 \\ \hline 36.5 \\ 5.5 \end{array}$$

$$\begin{array}{r} 1 \\ 42 \\ \hline 35 \\ 1 \end{array}$$

9

pt 9

pt 10

pt 11

•

•

•

1/4

Approx 1/6

pt 10

12" purple NE 22.55

12" purple SE 17.55

STATION OCCUPIED	STATION SIGHTED	1st & VERTICAL ANGLE	3rd ANGLE SLOPE DISTANCE	MEAN ANGLE	HORIZONTAL DISTANCE
	Pt 10	000 00 30			
Pt 11		180-00-34			
	Pt 12	179-04-59	179-04-29 ✓		
		359-05-03			
	Pt 10	090-00-35		179-04-29.75 ✓	
Pt 11		270 00 40			
	Pt 12	269-05-03	179-04-305 ✓		
		089-05-13			
Pt 11	Pt 10	89-47-54	1208.570		1208.563
			368.372M	1208.567	
	Pt 12	90-02-05	320.66		320.66
			97.737M	320.659	
		68.70			
		32			
		29			
		37.5			
		305			

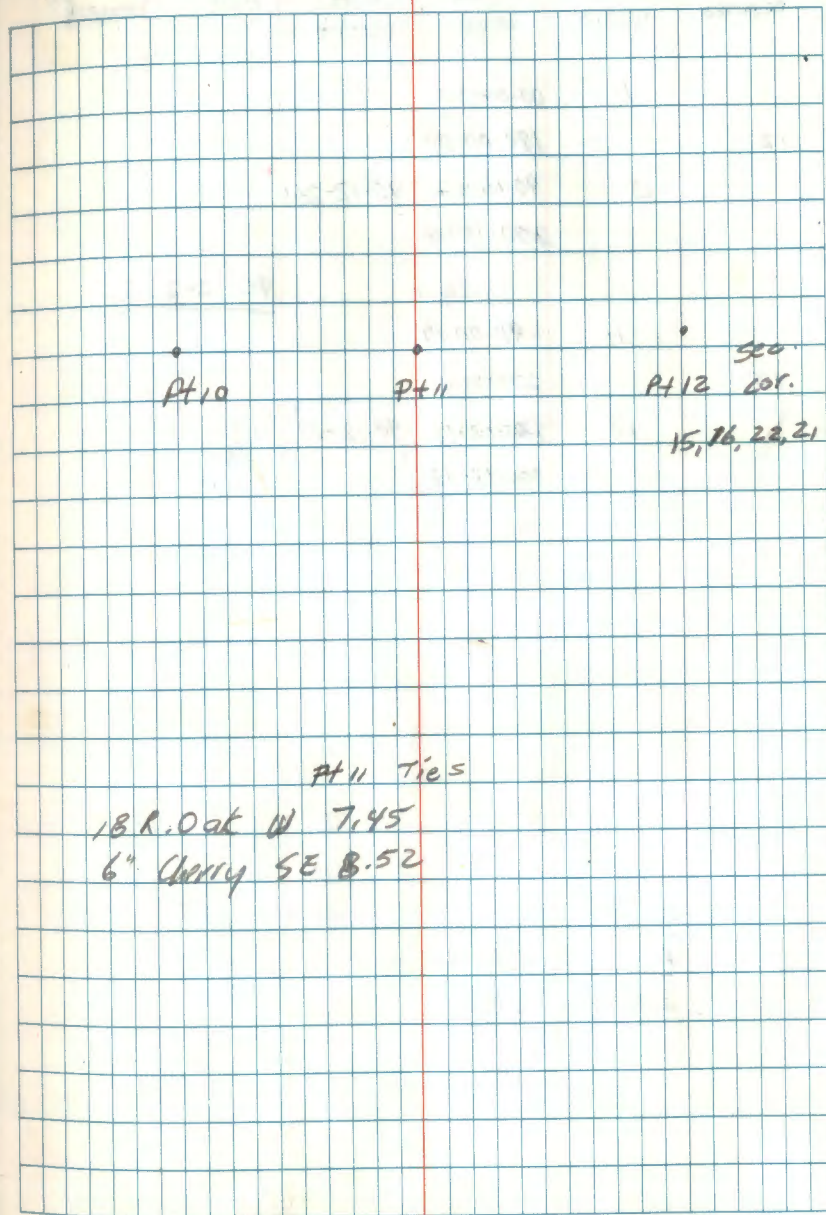

STATION OCCUPIED	STATION SIGHTED	1st & 2nd VERTICAL ANGLE	3rd ANGLE SLOPE DISTANCE	MEAN ANGLE	HORIZONTAL DISTANCE
	11	00-00-30			
12		180-00-50			
	13	90-13-04	90-12-26.5 ✓		
		270-13-09			
				<u>90-12-23.75</u>	
	11	90-00-19			
12		270-00-40			
	13	180-12-46	90-12-21 ✓		
		000-12-55			
		66.5 40 <hr/> 26.5	4 50.5 <hr/> 29.5 21 0	105 2121 <hr/> 210	

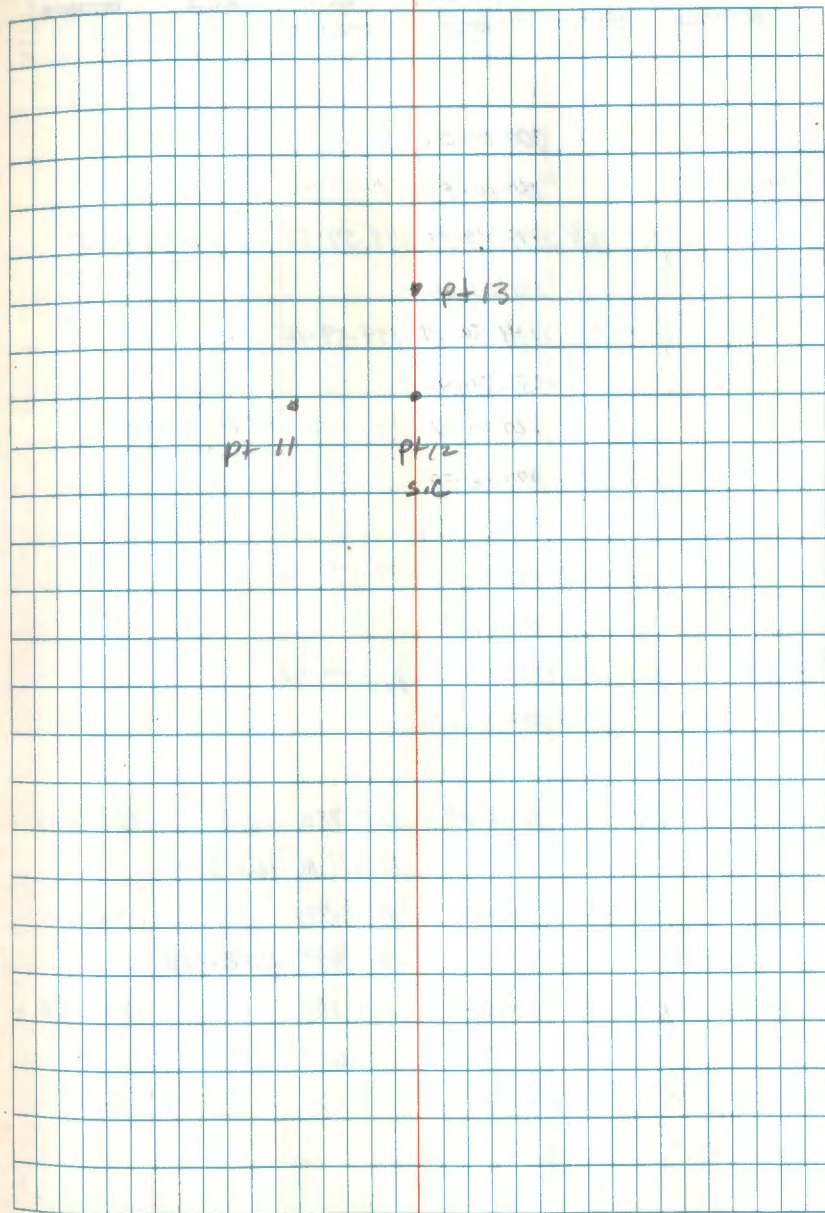





STATION OCCUPIED	STATION SIGHTED	1st & VERTICAL ANGLE	3rd ANGLE SLOPE DISTANCE	MEAN ANGLE	HORIZONTAL DISTANCE
	pt 13	000 00 30			
pt 15		180 00 42			
pt 16	180 00 20		179-59-48 ✓		
		000 00 28			
				<u>179-59-48.75</u> ✓	
pt 13	090 00 24				
	270 00 40				
pt 16	270 00 16		179-59-49.5 ✓		
	90 00 27				

2	7
<del>84</del>	21.5
36	32
<hr/>	<hr/>
48	49.5

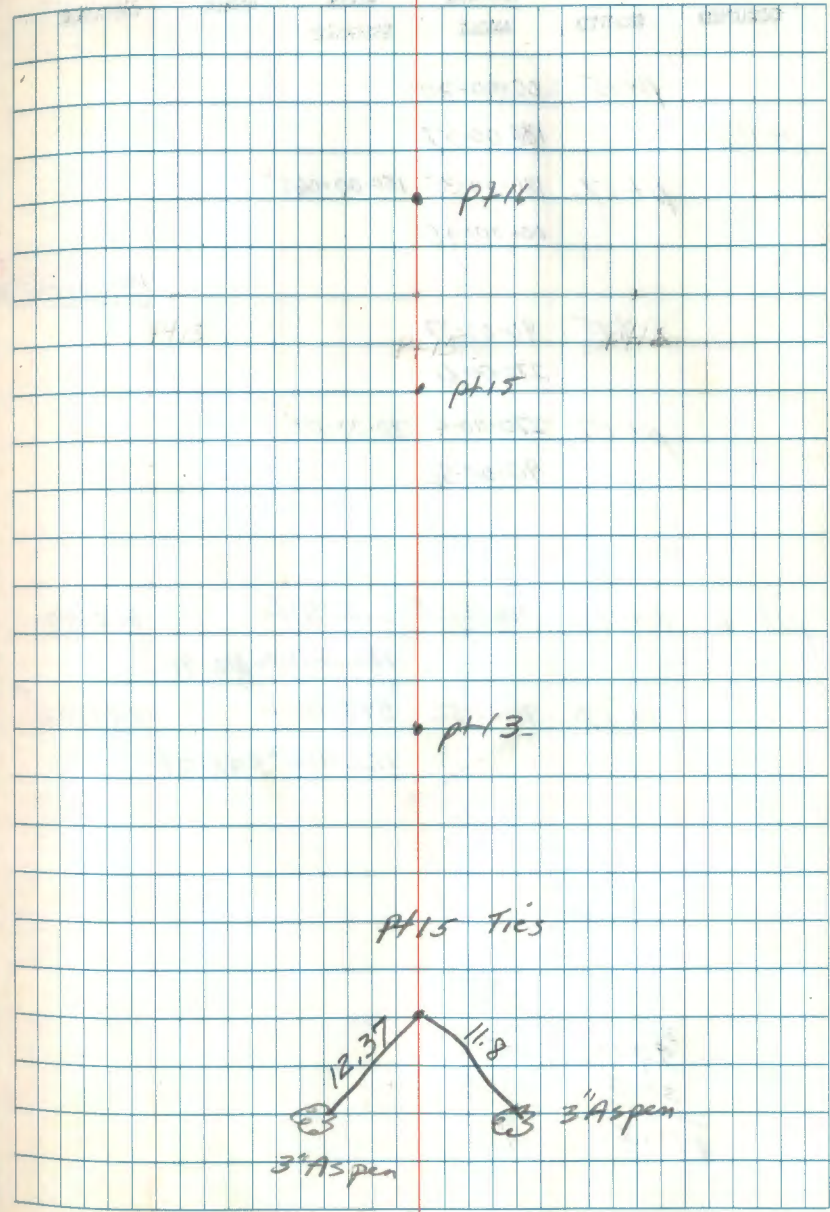

STATION OCCUPIED	STATION SIGHTED	1st & VERTICAL ANGLE	3rd ANGLE SLOPE DISTANCE	MEAN ANGLE	HORIZONTAL DISTANCE
	pt 15	00-00-30			
pt 16		180-00-37			
	pt 17	180-00-35	180-00-06.5 ✓		
		00-00-45			
					180-00-07.75 ✓
	pt 15	90-00-37			
		270-00-40			
	pt 17	270-00-43	180-00-09 ✓		
		90-00-52			

pt 16	pt 15	90-25-08	612.91 ft	612.89
			186.816 m 612.91	
pt 17		90-22-52	545.03 ft	545.02 ✓
			166.126 m 545.03	

<u>3</u>	<u>7.5</u>
49.10	38.5
33.5	90
<u>15.6</u>	

• pt 17 Ely SAC. 16

• pt 16

• pt 15

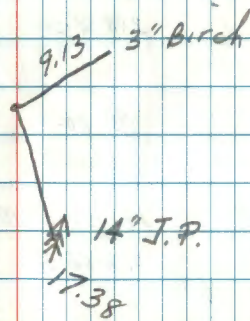

14" J.P.

17.38

STATION OCCUPIED	STATION SIGHTED	1st & VERTICAL ANGLE	3rd ANGLE SLOPE DISTANCE	MEAN ANGLE	HORIZONTAL DISTANCE
	pt 16	000-00-30			
pt 17		180-00-43			
	pt 18	181-05-50	181-05-205		
		001-06-04			
	pt 16	090-00-30		<u>181-05-18.5</u>	
		270-00-40			
	pt 18	271-05-49	181-05-16.5		
		091-05-54			
	George Pt 105	00-00-30			
17		180-00-40			
	18	108-56-26	108-55-56		
		288-56-36			
	105	90-00-35			
17		270-00-40			
	18	198-56-28	108-55-555		<u>108-55-555</u>
		018-56-38			
	56.10	54			
	36.5	26.5	16.5		
	0.5	20.5			
	8.1	8.2			
	35	37.5			
	56	55.5			

Go to Page 17

STATION OCCUPIED	STATION SIGHTED	1st & VERTICAL ANGLE	3rd ANGLE SLOPE DISTANCE	MEAN ANGLE	HORIZONTAL DISTANCE
	pt 18				
	pt 105				
	pt 17				
	pt 16				



STATION OCCUPIED	STATION SIGHTED	1st VERTICAL ANGLE	3rd SLOPE DISTANCE	MEAN ANGLE	HORIZONTAL DISTANCE
------------------	-----------------	--------------------	--------------------	------------	---------------------

	pt 28	100 00 30			
pt 29		6180-00-34			
pt 32	2	267-01-25	267-00-59	267-00-59.25	
		5087-01-37			
pt C	3	359-09-15	359-08-44.5	359-08-46.5	
		4179-09-18			
<del>pt F</del>					

pt 28	3	090-00-36			
		1270 00 40			

pt 32	1	357-01-39	267-00-59.5		
		2117-01-36			

pt C	6	089-09-25	359-08-49		
		2269-09-27			

<del>pt F</del>					
		0110-01-25			
		4			

pt 32	89-42-00	1316.57		1316.55	
-------	----------	---------	--	---------	--

pt C	89-46-49	1333.78		1333.77	
------	----------	---------	--	---------	--

<del>pt F</del>					
-----------------	--	--	--	--	--

3	2	1	8	86	76	32
16.5	31	32	47.5	32	32	41.5
	81		38	48	4	44.5
76.5	32		59.5	46		89.5
32	59			2/93		93.0
44.5				8		

5100 shots off County's Traverse

5/16/85

JA CB CK

T146 R 31 SEC 16

16

N  
↑

pt 28

pt C  
NE 1/4

~~pt E~~  
CK 1/16

pt 32

CK 1/4

pt 29

STATION OCCUPIED	STATION SIGHTED	1st & VERTICAL ANGLE	2nd ANGLE SLOPE DISTANCE	MEAN ANGLE	HORIZONTAL DISTANCE
	17	000 00 30			
18		180-00-44			
	19	179-56-33	179-55-59		
		359-56-39			
				179-55-59	
	17	90-00-30			
18		270 00 40			
	19	269-56-30	179-55-59		
		89-56-38			
18	17	92-58-52	210.985		210.90
			64.309M	210.987	
18	19	89-31-26	444.385		444.370
			135.449M	444.386	
	816	814			
	37	35			
	59	59			

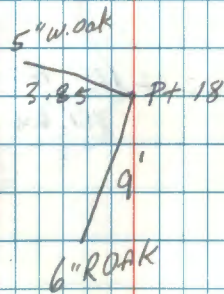

STATION OCCUPIED	STATION SIGHTED	1st & VERTICAL ANGLE	3rd ANGLE SLOPE DISTANCE	MEAN ANGLE	HORIZONTAL DISTANCE
	pt 18	00-00-30			
pt 19		180-00-38			
	pt 20	236-58-25	236-57-54		
		056-58-31			
				<u>236-57-53.25</u>	
	pt 18	090-00-35			
pt 19		270-00-40			
	pt 20	326-58-28			
		146-58-32	236-57-52.5		
		<del>326-58-28</del>			
pt 19	pt 20	90-22-52	1251.9854		1251.957
			381.606 m		1251.986

82	8910
<u>34</u>	<u>37.5</u>
54	525

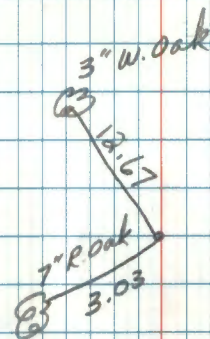

STATION OCCUPIED	STATION SIGHTED	1st & VERTICAL ANGLE	3rd ANGLE SLOPE DISTANCE	MEAN ANGLE	HORIZONTAL DISTANCE
---------------------	--------------------	----------------------------	--------------------------------	---------------	------------------------

pt 19 1000 00 30

pt 20

4180-00-33

pt 21 212-16-08 212-15-42

2032-16-19

212-15-39.5

pt 20

pt 19 090-00-28

5270 00 40

pt 21 302-16-07 212-15-37

1122-16-15

73.5

31.5

---

13.5

42.0

21

71

34

---

37

pt 19

pt 20

pt 21

pt 20 Aies

8" R. Oak NW 2.88

4" R. Oak SE 5.19

STATION OCCURRED	STATION SIGHTED	1st & VERTICAL ANGLE	3rd ANGLE SLOPE DISTANCE	MEAN ANGLE	HORIZONTAL DISTANCE
	Pt 20	1 000-00-30			
Pt 21		4 180-00-42			
	Pt 22	2 090-28-10	90-27-38.5		
		3 270-28-19			
					90-27-40.5
Pt 21	Pt 20	8 090-10-29			
		5 270-00-49	90-27-42.5		
	Pt 22	7 180-28-11			
		6 000-28-23			
Pt 21	Pt <del>19</del> <sup>20</sup>	090-56-11	279.745 85.267 M	279.747	279.71'
Pt 21	Pt 22	089-28-52	1324.785 403.795 M	1324.784	1324.731 BATTERY ON T

74.5

26

38.5

77

34.5

42.5

• Pt 22 W 1/16

Pt 20

• Pt 21 NW 1/4

TIES TO NW 1/16

10 BIRCH NW 9.40'

5 R. OAK SW 13.95'



STATION OCCUPIED	STATION SIGHTED	VERTICAL ANGLE	SLOPE DISTANCE	MEAN ANGLE	DISTANCE
	pt 21	000 00 30			
pt 22		180 00 32			
	pt 23	269 31 48	269 31 20 ✓		
		089 31 54			
					269-31-20.5
	pt 21	090 00 34			
		270 00 40			
	pt 23	359 31 57	269 31 20.5 ✓		
		179 31 58			
1					
pt 22	pt 23	90 07 57	1319.30	1319.30	
			402.123		

.10  
error in  
EDMI

51	57.5
31	37
<hr/>	<hr/>
20	20.5

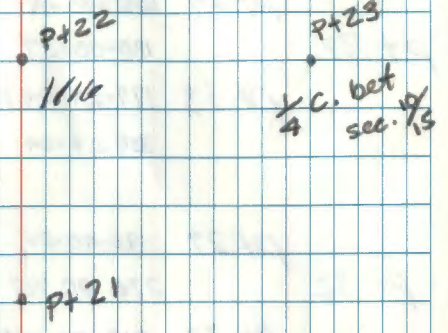

STATION OCCUPIED	STATION SIGHTED	1st VERTICAL ANGLE	3rd ANGLE SLOPE DISTANCE	MEAN ANGLE	HORIZONTAL DISTANCE
---------------------	--------------------	--------------------------	--------------------------------	---------------	------------------------

	Pt 29	100-00-30			
Pt 32		180-00-37			
Pt 33	179-24-04	179-23-25			
		359-24-04			
			179-23-31.25		
Pt 29	90-00-34				
Pt 32	270-00-40				
Pt 33	269-24-08	179-23-32			
	089-24-10				

64.10	69	32
33.5	37	30.5
20.5	32	62.5
		31.25

8/13/85 JAT GBM LR

22

CE 1/4 - WEST TO 1/4 COR

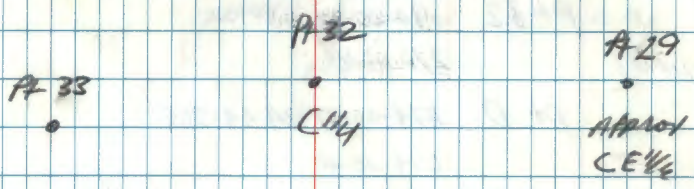

4/65

W. Oak 15" NW 35.27  
 W. Pine 22" NE 41.33'

8/13/85

23

STATION	STATION	1st & VERTICAL	3rd ANGLE SLOPE	MEAN ANGLE	HORIZONTAL DISTANCE
	pt 32	000 00 30			
pt 33		180-00-27			
ss. pt D		184-45-21	184-44-55.5	184-44-57.5	
		004-45-27			
pt 4		180-59-24	180-58-54	180-58-52.25	
		000-59-21			
pt 32		90-00-38			
pt 33		270 00 40			
pt D		274-45-37	184-44-59.5		
		094-45-40			
pt 4		270-59-28	180-58-50.5		
		90-59-31			
pt 32		90-35-41	1135.16	1135.10	
			345.998M		
ss. pt D		91-01-35	183.49	183.460	
			55.928M		
pt 4		90-35-57	1801.855	1501.77	
			457.765M		

$$\begin{array}{r} 73.10 \\ 24.1 \\ \hline 28.5 \\ 55.5 \end{array}$$

$$\begin{array}{r} 72.5 \\ 28.5 \\ \hline 54.0 \end{array}$$

$$\begin{array}{r} 88.5 \\ 26.5 \\ \hline 39 \\ 59.5 \end{array}$$

$$\begin{array}{r} 89.5 \\ 39 \\ \hline 50.5 \end{array}$$

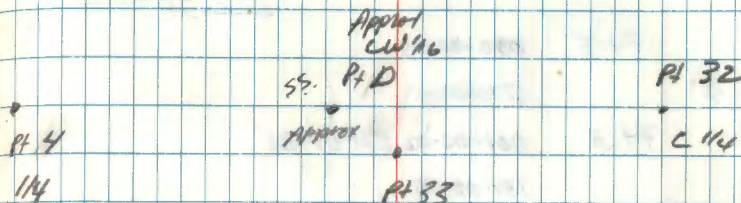

adjustments  
due to wrong  
prism constant in EDM  
trip

Ties

Popple 10" NE 31.92'

Red Oak 11" NW 45.65'

8/13/85

24

END OF DAY

STATION OCCUPIED	STATION SIGHTED	VERTICAL ANGLE	SLOPE DISTANCE	ANGLE	DISTANCE
	P+E	00-00-30			
P+4		180-00-30			
	P+3	271-01-54	271-01-26 ✓		
		091-01-58			
			271-01-26 ✓		
	P+E	090-00-35			
P+4		270-00-40			
	P+3	001-02-02	271-01-26 ✓		
		181-02-05			

56  
 30  
 24

63.5  
 37.5  
 26.0

P+4

P+3



STATION OCCUPIED	STATION SIGHTED	1st & VERTICAL ANGLE	3rd ANGLE SLOPE DISTANCE	MEAN ANGLE	HORIZONTAL DISTANCE
	22	00-00-30			
34		180-00-27			
	35	183-08-20	183-07-49.5 ✓		
		003-08-16			
			<u>183-07-47.5</u> <sup>47.50</sup>		
	22	090-00-39			
34		270-00-40			
	35	273-08-25	183-07-45.5 ✓		
		098-08-25			
				EDGE 1/100	
				644	
34	22	87-06-34	510.490		509.841
			155.598M		
34	35	87-58-50	810.420		809.917
			247.018		.720

$$\begin{array}{r} 67 \\ 78 \\ \hline 28.5 \\ 49.5 \end{array}$$

$$\begin{array}{r} 1 \\ 8.5 \\ \hline 39.5 \\ 45.5 \end{array}$$

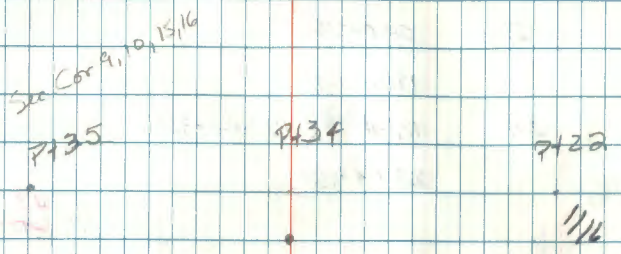

$$\begin{array}{r} 1000 \\ 10509.8410 \end{array}$$

STATION OCCUPIED	STATION SIGHTED	1st & VERTICAL ANGLE	3rd ANGLE SLOPE DISTANCE	MEAN ANGLE	HORIZONTAL DISTANCE
------------------	-----------------	----------------------	--------------------------	------------	---------------------

	34	00-00-30			
35		180-00-28			
	36	177-43-07	177-42-36.5 ✓		
		257-43-04			
			<del>177-42-34.75</del>	33.75	
	34	090-00-51			
35		270-00-40			
	36	267-43-15	177-42-33 <sup>31</sup>		
		087-43-18			

5	
65.5	17.5
29	14.5
<hr/>	
36.5	33.0

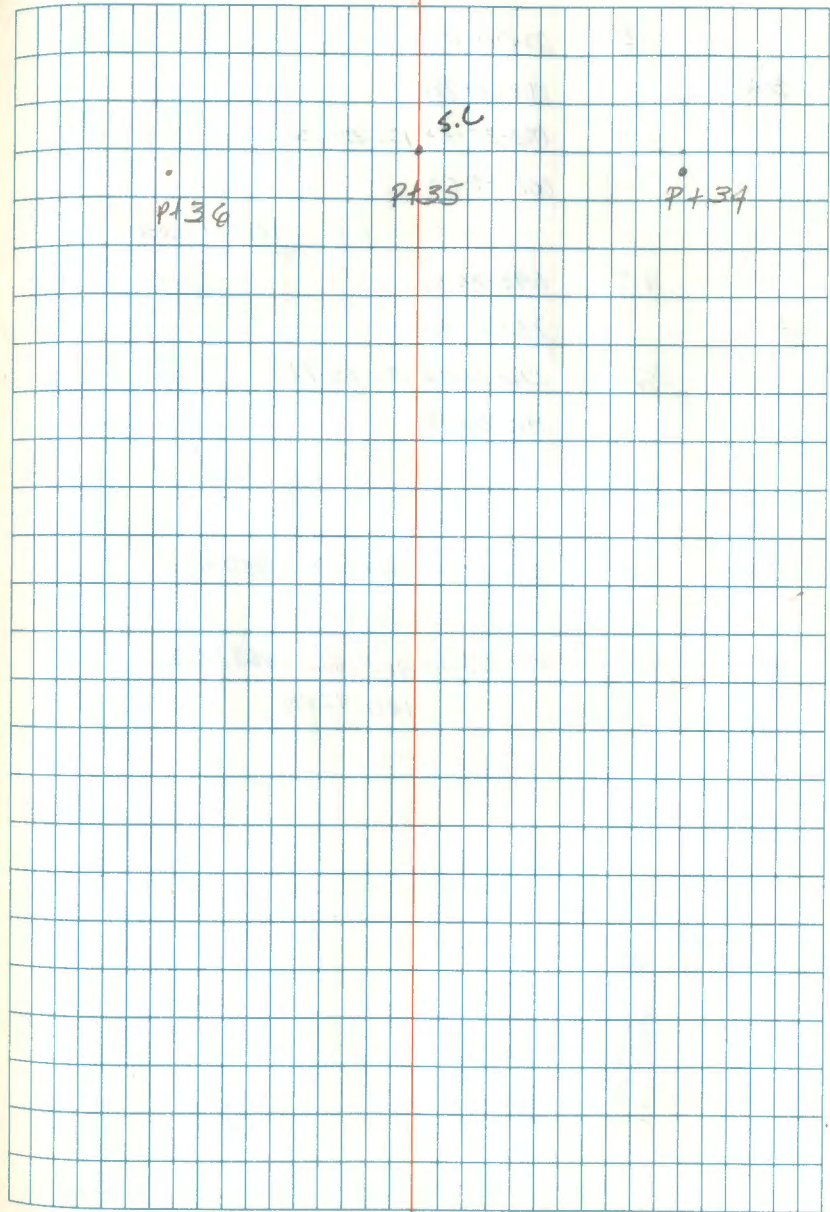

STATION OCCUPIED	STATION SIGHTED	1st & VERTICAL ANGLE	3rd ANGLE SLOPE DISTANCE	MEAN ANGLE	HORIZONTAL DISTANCE
	35	00-00-30			
36		180-00-28			
	37	182-25-55	182-25-25 ✓		
		002-25-53			
			<u>182-25-26.75</u> ✓		
	35	090-00-35			
36		270-00-40			
	37	272-26-04	182-25-28.5 ✓		
		092-26-08			
			<i>SOME WORK</i>		
			<i>.063</i>		
36	35	089-31-10	850-260	850.033 ✓	
			259.162 M		
			<i>.153</i>		
36	37	091-27-46	462.350	462.002 ✓	
			140.925M		

4	5
54	66
29	37.5
<hr/>	<hr/>
25	28.5

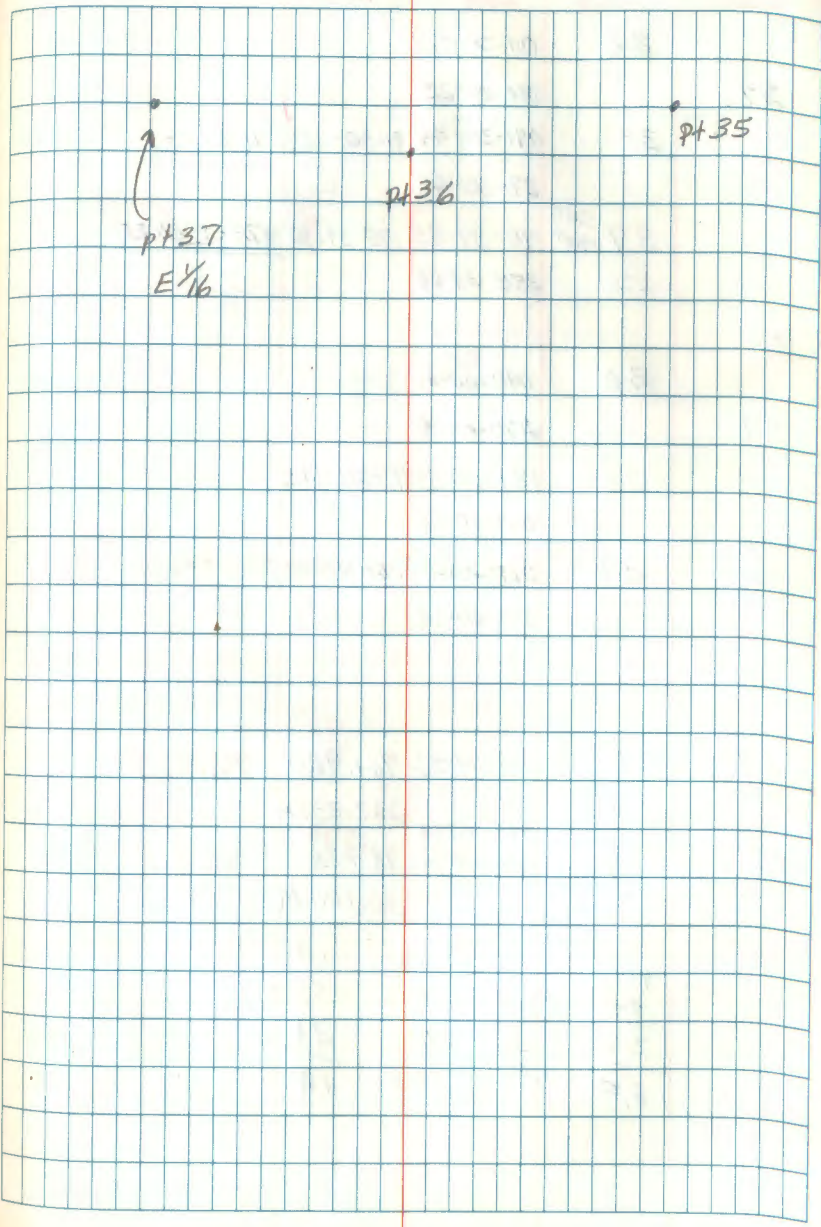



STACION OCCUPIED	STATION SIGHTED	1st & 2nd VERTICAL ANGLE	3rd ANGLE SLOPE DISTANCE	MEAN ANGLE	HORIZONTAL DISTANCE
	36	00-00-30			
37		180-00-25			
	38	091-30-46	91-30-16.5	91-30-15.5	
		271-30-42			
39	Side shot	178-39-55	178-39- <del>32.5</del> <sup>29</sup>	178-39- <del>32.5</del> <sup>29.75</sup>	
		358-39-58			
	36	090-00-42			
37		270-00-40			
	38	181-30-55	91-30-14.5		
		001-30-56			
	39	268-40-09	178-39-30.5		
		088-40-14			
37	38	089-04-56	761.920	761.625	
			232.232M		
37	39	095-10-34	98.775	98.176	
		<del>088-37-18</del>			
			30.105M		
			Z	L	
		44 <sup>313</sup>	57.5	71.5	55.5
		27.5	27.5	41	41
		16.5	30.0	30.5	14.5

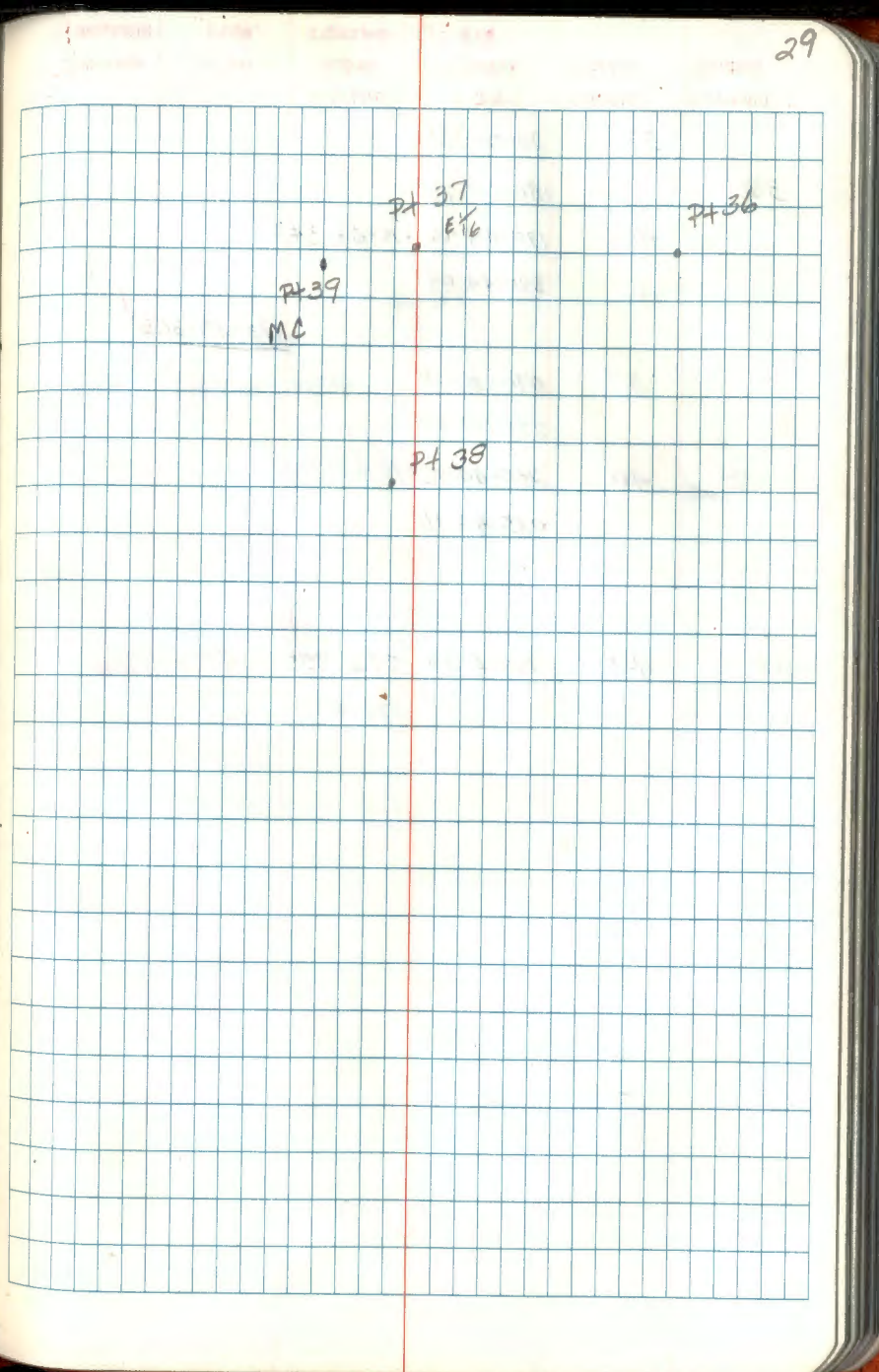

STATION OCCUPIED	STATION SIGHTED	1st & VERTICAL ANGLE	3rd ANGLE SLOPE DISTANCE	MEAN ANGLE	HORIZONTAL DISTANCE
	37	00-00-30			
38		180-00-29			
	40	175-44-04	175-43-34.5 ✓		
		355-44-04			
			<u>175-43-36.5</u> ✓		
	37	090-00-38			
38		270-00-40			
	40	265-44-15	175-43-36.5 ✓		
		085-44-16			
38	40	90-36-34	572.855 <sup>650</sup>		572.626
			174.607M		

513	65.5
6410	
29.5	39
345	36.5

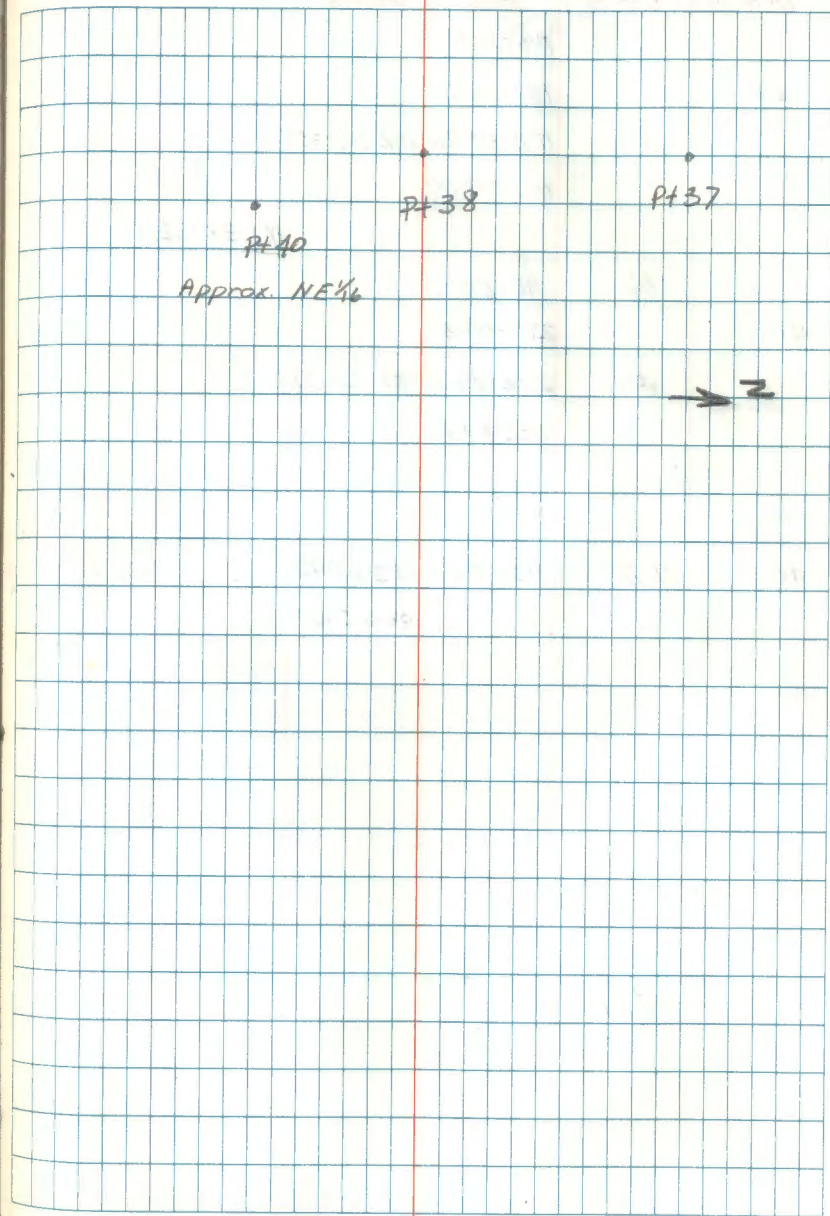

STATION OCCUPIED	STATION SIGHTED	1st & VERTICAL ANGLE	3rd ANGLE SLOPE DISTANCE	MEAN ANGLE	HORIZONTAL DISTANCE
	38	00-00-30			
29		180-00-25			
	41	182-37-02	182-36-33.5 ✓		
		002-37-00			
				182-36-32.5 ✓	
	38	90-00-42			
40		270-00-40			
	29	272-37-13	182-36-31.5 ✓		
		092-37-12			
40	29	90-17-03	1339.040		1334.021
			406.616M		

510	72.5
610	41
<u>27.5</u>	<u>315</u>
33.5	

END OF DAY

pt 29

pt 40

pt 38

→

E.M.I. mm

3.027

STATION OCCUPIED	STATION SIGNED	1st & 2nd VERTICAL ANGLE	3rd ANGLE SLOPE DISTANCE	MEAN ANGLE	HORIZONTAL DISTANCE
	pt B	000 00 30			
pt A		180-00-31			
	pt 1	179-34-08	179-33-37 ✓		
		359-34-07			
			179-33-36 ✓		
pt A	pt B	090-00-41			
		270-00-40			
	pt 1	269-34-16	179-33-35 ✓		
		089-34-15			
pt A	pt 1	89-55-08	419.740 127.937m		419.740
	pt B	91-47-43	397.150 121.051m		396.955

62.5      75.5  
 30.5      40.5  
 ---  
 370      25.6



STATION OCCUPIED	STATION SIGHTED	1st ANGLE VERTICAL ANGLE	3rd ANGLE SLOPE DISTANCE	MEAN ANGLE	HORIZONTAL DISTANCE
	Pt C	000 00 30			
Pt B		180 00 14	22		
	Pt A	181 36 11	181 35 43.5 ✓		
		001 36 00	05.5		
	Pt C	090 00 46		181 35 43.5 ✓	
Pt B		270 00 40	43		
	Pt A	271 36 29	181 35 43.5 ✓		
		091 36 24	26.5		
Pt B	Pt C	270 10 56	3165.255 ✓		3165.239
			964.772 m		

65.5	86.5
22	43
<hr/>	<hr/>
43.5	43.5

9/24/85

P+A

P+B

P+C

MC

416

STATION OCCUPIED	STATION SIGHTED	VERTICAL ANGLE	3rd ANGLE SLOPE DISTANCE	MEAN ANGLE	HORIZONTAL DISTANCE
------------------	-----------------	----------------	--------------------------	------------	---------------------

Pt 37 000-00-30

C (E4)

180-00-20

B

177-15-00 177-14-30

357-14-50

177-14-~~30.5~~

# 37

090-00-39

C

270-00-40

177-14-~~30.5~~

pt B

267-15-09

087-15-11

55  
26

44

33<sup>D</sup>

70

33.5

30.5

End of Part

9/24/85

pt B

mc

V106

pt C

pt 37

pt 36

STATION  
OCCUPIEDSTATION  
SIGHTEDVERTICAL  
ANGLESLOPE  
DISTANCEMEAN  
• ANGLEHORIZONTAL  
DISTANCE

pt. 18 000-00-30

pt. 17 180-00-26

E 1/4 pt. 41 90-31-21 70 30-52

SOC 1/6 270-31-19

90-30-53

pt. 18 090-00-42

270 00 40 90-30-54

pt. 41 180-31-35

000-31-35

1	95
80	41
20	54
52	

 T □  
 JA GB

12/30/85 35

Tieing in the  
C/W 1/16

pt. 18

pt. 17 1/4

pt. 41

12/30/85 36

STATION OCCUPIED	STATION SIGHTED	VERTICAL ANGLE	SLOPE DISTANCE	HORIZONTAL DISTANCE
------------------	-----------------	----------------	----------------	---------------------

pt 17 100 00 30

pt 41 180-00-29

pt 42 179-43-26 179-42-55.5

359-43-25

pt 17 90-00-43 179-42-54.75

pt 41 270 00 40

pt 42 269-43-36 179-42-54

089-43-35

pt 17 90-43-46 752.985 752.924

229.511 M.

pt 42 91-18-11 331.190 331.104

100.947 M.

7	85.5	95.5
	29	41.5
	<u>55.5</u>	54.0
		54.
		<u>109.5</u>
		10.5

114.

pt 17

pt 41

pt 42



STATION OCCUPIED	STATION SIGHTED	1st & VERTICAL ANGLE	3rd ANGLE SLOPE DISTANCE	MEAN ANGLE	HORIZONTAL DISTANCE
------------------	-----------------	----------------------	--------------------------	------------	---------------------

pt 41 00-00-30

pt 42 180-00-26

pt 43 173-57-18 173-56-49.5

CL 1116 353-57-17

pt 41 173-56-48.75

270-00-40

pt 43 090-00-39

083-57-29 173-56-47

263-57-24

pt 43 94-03-53 255.435' 254.792'

CL 1116

6	7
77.5	26.5
<u>28</u>	<u>39.5</u>
49.5	47.0

12/30/85 37

END OF DAY

CL 1116  
 pt 42 pt 43

END

STATION OCCUPIED	STATION SIGHTED	1st & VERTICAL ANGLE	2nd ANGLE SLOPE DISTANCE	MEAN ANGLE	HORIZONTAL DISTANCE
------------------	-----------------	----------------------	--------------------------	------------	---------------------

pt 33 000 00 30

pt 4

180-00-26

pt 44

08-35-35 08-35-065

08-35-05.5

188-35-34

pt 45

026-09-04 26-08-32.5

26-08-23

206-08-57

~~pt 46~~

pt 33

090-00-42

240 00 40

pt 44

098-35-46 09-35-09.5

278-35-45

pt 45

116-09-15 26-08-33.5

296-09-14

~~pt 46~~

pt 44

088-56-28 422.65 422.5778

pt 45

089-02-11 466.68 466.6140

34.5	.005	45.5	74.5
<u>28</u>	<u>28</u>	<u>41</u>	<u>41</u>
6.5	32.5	4.5	33.5

12/19/85 JA, GB, CK Cloudy, 5° F, calm

Cemetery  
Iron

W 114

pt 44

pt 33

pt 45

NE CORNER

SE CORNER

STATION OCCUPIED	STATION SIGHTED	1st & VERTICAL ANGLE	3rd ANGLE SLOPE DISTANCE	MEAN ANGLE	HORIZONTAL DISTANCE
	40	00-00-00			
38	46	NE 1/6 359-26-54	90-41-20 572.10	Setting the NE 1/6	
	46	90-41-20	572.10		572.06
	Moved north .06				
	46	90-41-20	572.04		572.00
40	38	Steel tape			5.58
				check JA 7/86	
	38	00-00-00			
46	47	182-45-20		Setting the CE 1/6	
	47	90-16-46	1331.825		1331.81
	Moved south .96				
	47	90-16-46	1332.81		1332.79
29	47	Steel tape			15.08
				check JA 7/86	

1/15/86 CK, JA, GB Clear, calm, 30°F

Ties To Pt 38

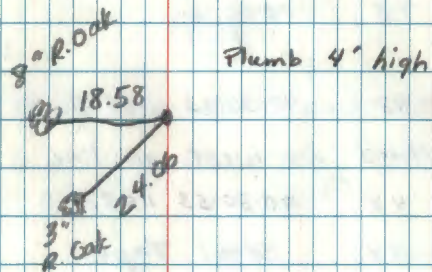

Pt 46 is NE 1/6 position

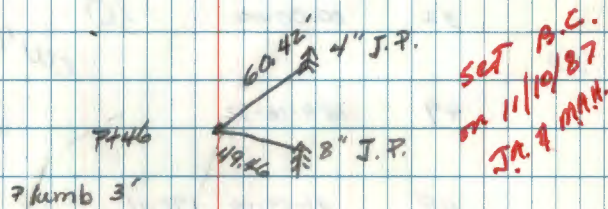

Pt 47 is CE 1/6 position



Set P.C.  
on 11/10/87  
JA. M.A.H.

STATION OCCUPIED	STATION SIGHTED	1st & VERTICAL ANGLE	3rd ANGLE SLOPE DISTANCE	MEAN ANGLE	HORIZONTAL DISTANCE
	32	00-00-00			
33	48	00-00-13			
	48	90-30-53	1158.41		1158.36
	Moved .06 west on line				
	48 C/4	90-30-53	1158.345		1158.298
32	48	Steel Tape			23.36
33	32	00-00-00			
	49	184-16-32			
	49	91-59-59	172.11		172.005
	Moved .02 west on line				
D	49	Steel Tape			11.22
33	49	91-59-59	172.13		172.025

Set B.C. on 11/13/87  
J.A.

Set C/4

checked J.A. 7/15/86

Set B.C. on 11/13/87  
J.A.

Set

CW 1/16

checked J.A. 7/15/86

1/16/86 - GK, JA, GB Cloudy 26°

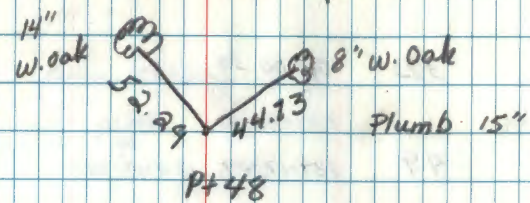

Pt 48 is the C/4 position

STATION OCCUPIED	STATION SIGHTED	1st & VERTICAL ANGLE	3rd ANGLE SLOPE DISTANCE	MEAN ANGLE	HORIZONTAL DISTANCE
	32	000 00 30			
33		180-00-10			
	49	184-17-09	<sup>16</sup> 184-17-39.5		
		004-16-50			184-16-39
	32	090-00-45			
33		270 00 40			
	49	274-17-22	<sup>16</sup> 184-17-38.5		
		094-17-20			
33	49	91-55-56	172.085		171.987

59.5  
20  
39.5

79<sup>10</sup>  
42.5  
38.5

1/16/86

(True CW 1/16)

PT 49

PT 32

PT 33

3" Aspen

2" Aspen

28.78

23.05

Plumb 2'

PT 49

STATION OCCUPIED	STATION SIGHTED	1st & VERTICAL ANGLE	3rd ANGLE SLOPE DISTANCE	MEAN ANGLE	HORIZONTAL DISTANCE
---------------------	--------------------	----------------------------	--------------------------------	---------------	------------------------

1/30/86 - CK, JA, GB, JA

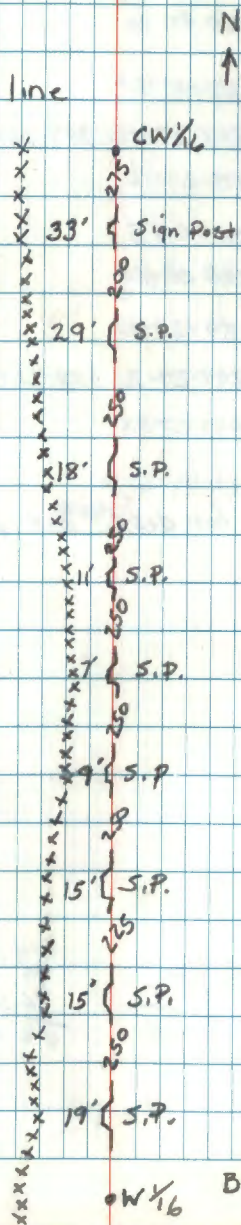
Fence Ties to W $\frac{1}{4}$  line

1/30/86 - JA, GB, CK, S.A., LW Clear -10°F Calm

STATION OCCUPIED	STATION SIGHTED	1st & VERTICAL ANGLE	3rd ANGLE SLOPE DISTANCE	MEAN ANGLE	HORIZONTAL DISTANCE
	40	000 00 30			
38		180-00-23			
	46	359-27-18	359-26-49.5		
		179-27-12			
	40	000 00 45		<u>359-26-49</u>	
38		270 00 40			
	46	89-27-23			
		↗ 269-27-31	359-26-49.5		
		↘ 089-27-33			

See page 39 for dist. bet. pt. 38 & 46

	41	614.10	320
45	42.10	75	42.5
	31.5	26.5	
26	<u>10.5</u>	<u>48.5</u>	
49			32
			51.10
			<u>42.5</u>
			49.5

• Pt 38

See page 39  
for Dist. bet. Pt 38 to 46

• • Pt 46 True NE 46  
Pt 40

STATION OCCUPIED	STATION SIGHTED	1st & VERTICAL ANGLE	3rd ANGLE SLOPE DISTANCE	MEAN ANGLE	HORIZONTAL DISTANCE
	38	00-00-30			
40		180-00-30			
	50	271-22-50	271-22-20.5		
		091-22-51			
			271-22-16.25		
	38	090-00-40			
40		270-00-40			
	50	001-22-53	271-22-13		
		181-22-53			

50.5      53      6.5  
 $\frac{30}{20.5}$        $\frac{40}{13}$       2.25

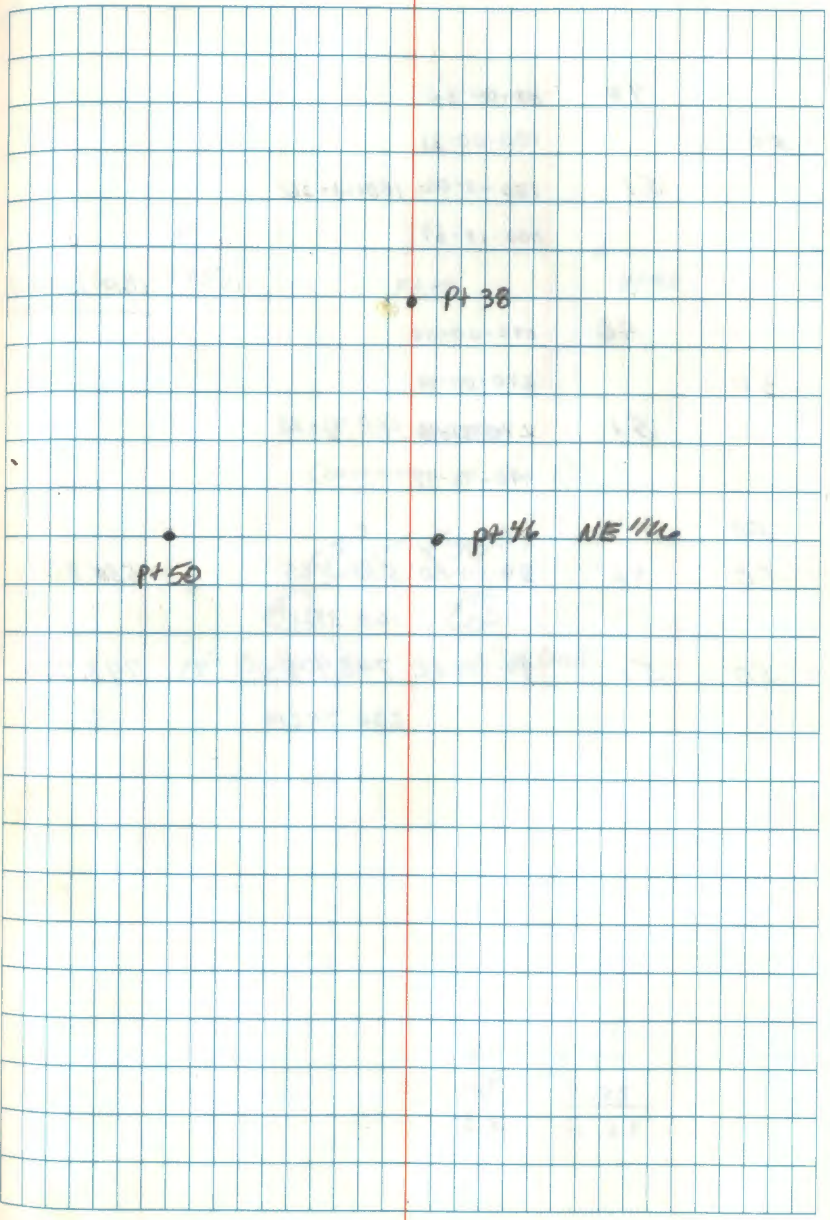



STATION OCCUPIED	STATION SIGHTED	1st & VERTICAL ANGLE	3rd ANGLE SLOPE DISTANCE	MEAN ANGLE	HORIZONTAL DISTANCE
	46	20-00-30			
50		180-00-21			
	51	180-12-06	180-11-36		
		000-17-57			
					<u>180-11-35.5</u>
	46	090-00-46			
50		270-00-40			
	51	270-12-18	180-11-35		
		90-12-18			
50					
50	46	89-50-00	535.865		535.86
			163.332M		
50	51	91-04-32	743.905		743.774
			226.742M		

5  
 61.5    98  
25.5    43  
 36.0    35

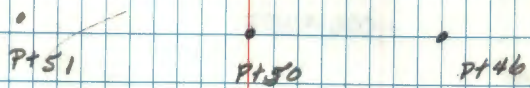

Ties for Pt 50  
(East edge of field)

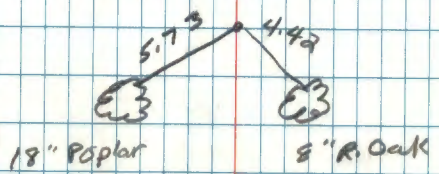

STATION OCCUPIED	STATION SIGHTED	1st & VERTICAL ANGLE	3rd ANGLE SLOPE DISTANCE	MEAN ANGLE	HORIZONTAL DISTANCE
	pt 50	180-00-30			
pt 51		180-00-28			
	pt 52	215-52-30	215-51-59.5		
		3 035-52-27			
				215-51-57.25	
pt 50	3090-00-47				
	5 270-00-40	215-51-55			
pt 52	305-52-40				
	6 125-52-37				
29					
28.5					
88.5		43.5			
		38.5			
-29		98.5			
59.5		43.5			
		55.0			
52.25		59.5			
		55			
		57.25			
		214.5			
		10			
		14			

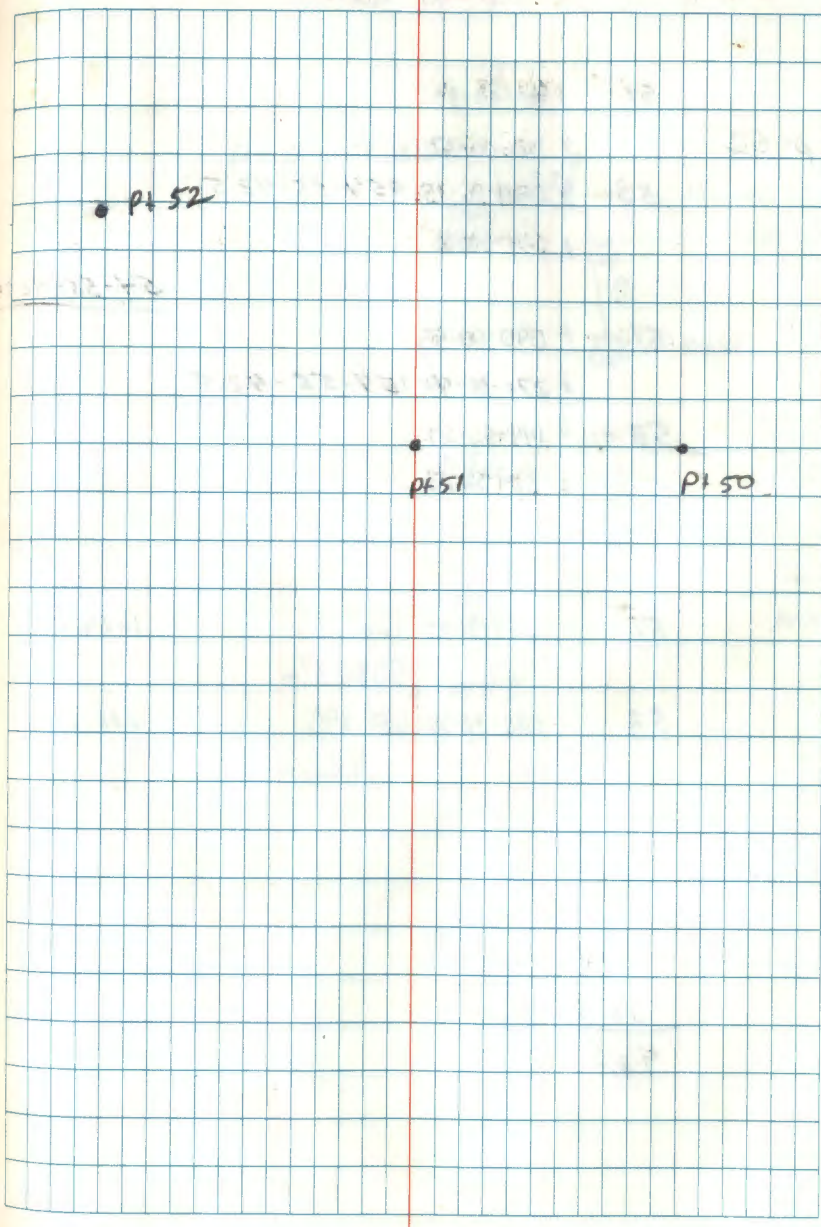

END OF DAY

STATION OCCUPIED	STATION SIGHTED	1st & 2nd VERTICAL ANGLE	3rd ANGLE SLOPE DISTANCE	MEAN ANGLE	HORIZONTAL DISTANCE
	51	000-00-30			
pt 52	4	180-00-27			
53	2	054-56-15	054-55-42.5		
	3	234-56-08			
				<u>54-55-42.5</u>	
51	8	090-00-45			
	5	270-00-40	154-55-42.5		
53	7	144-56-27			
	6	324-56-23			
51		089-54-44	1669.415		1669.413
			508.837m		
53		088-32-59	688.895		688.674
			209.976m		
		85.0			
		71.0	42.5		
		28.5	42.5		
		42.5			

pt 52 Ties

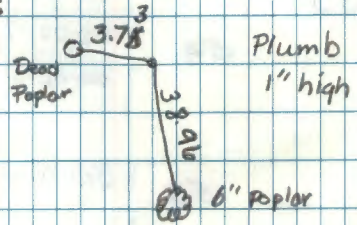

pt 52

pt 51

pt 53

2/3/86 - JA, GB, CK, L, W Cloudy, 25° light snow

STATION OCCUPIED	STATION SIGHTED	1st & VERTICAL ANGLE	3rd ANGLE SLOPE DISTANCE	MEAN ANGLE	HORIZONTAL DISTANCE
------------------	-----------------	----------------------	--------------------------	------------	---------------------

	52	1 00-00-30			
53		4 180-00-22	180-01-48		
	54	2 180-02-17			
		3 000-02-11		180-01-47	
	52	8 090-00-35			
53		9 270-00-40	180-01-46		
	54	7 270-02-26			
		6 090-02-21			

	83.5
44	37.5
26	46.0
48	



Pt 53 Ties

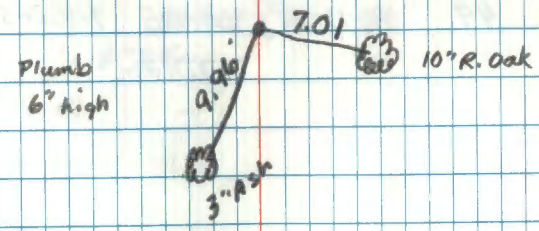

STATION OCCUPIED	STATION	1st & VERTICAL	3rd ANGLE SLOPE	MEAN ANGLE	HORIZONTAL DISTANCE
	53	1 00-00-30			
54		4 180-00-26			
	49	2 180-00-00	179-59-28		
		3 359-59-52			
				179-59-28	
	53	8 090-00-42			
54		5 270-00-40	179-59-28		
	49	7 270-00-10			
		6 090-00-08			
54	53	<del>090-51-00</del> 090-43-20	932.970 284.370m	932.896	932.821
54	49	090-18-24	714.275 217.712m	714.265	714.255

$$\begin{array}{r} 69 \\ 41 \\ \hline 29 \end{array}$$
  

$$\begin{array}{r} 56 \\ 28 \\ \hline 28 \end{array}$$

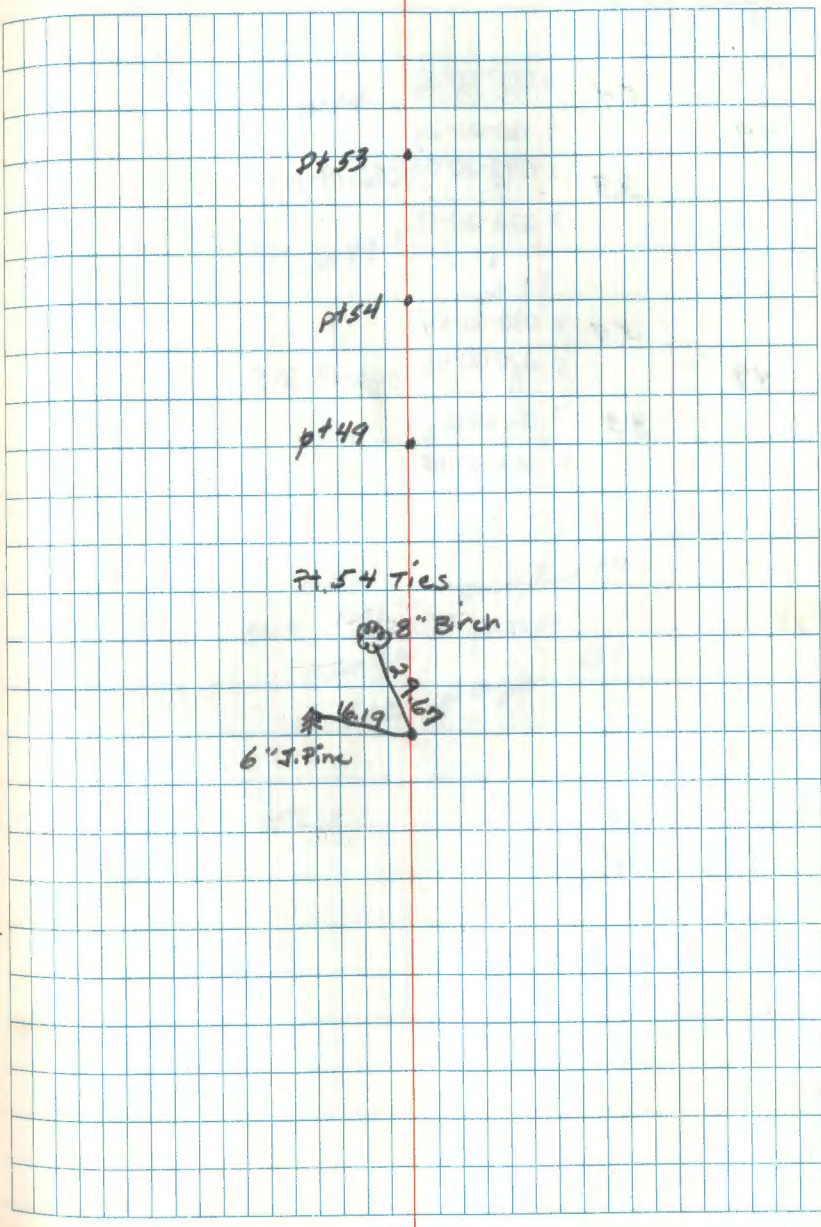

End of Day

STATION OCCUPIED	STATION SIGHTED	1st & VERTICAL ANGLE	3rd ANGLE SLOPE DISTANCE	MEAN ANGLE	HORIZONTAL DISTANCE
	54	1 000-00-30			
49		4 180-00-24			
	33	2 092-20-02	092-19-34.5		
		3 272-20-01		092-19-32.5	
	54	8 090-00-44			
49		5 270-00-40	092-19-30.5		
	33	7 182-20-13 <sub>2</sub>			
		6 002-20-18			

61.5	22.5
27.0	42.0
<u>34.5</u>	<u>30.5</u>

one more angle to  
close loop  
see page 41

STATION  
OCCUPIEDSTATION  
SIGHTED1st &  
VERTICAL  
ANGLE3rd ANGLE  
SLOPE  
DISTANCEMEAN  
ANGLEHORIZONTAL  
DISTANCESetting N<sup>1</sup>/<sub>6</sub> bet sec. 15, 16~~18 00-00-00<sub>21</sub>~~~~19 179-59-39~~~~55 180-07-49 180-~~~~359-07-23~~~~18 90-00-40~~~~19 270-00-40~~~~55 270-08-32 180-07-51~~~~90-08-30~~

18 00-00-30

19 180-00-28

55 180-08-25 180-07-53.5

00-08-20

See adjacent page  
for distance

? check

180-07-52 OK

18 90-00-44

19 270-00-40

55 270-08-36 180-07-50.5

90-08-29

5 10

29

86

81

36

36

31

40

15.5

14.5

655120.5

98.10

45.5

7 82.5

92.5

50.5

29

42

53.550.5

51

2/19/86 CK, GB Cloudy 5°F

N<sup>1</sup>/<sub>6</sub> bet sec. 15, 16  
pt 55

180-07-37

668.83

pt 19

pt 18

Occupy	Sight	Vert. Z	Slope Dist	Horz. Dist.
pt 19	pt 55	92-28-40	666.41	665.79

Move 3' north

"	"	92-28-25	669.48	668.86
---	---	----------	--------	--------

Moved .03' south and on correct bearing.

Set N<sup>1</sup>/<sub>6</sub> corner at this position.

STATION OCCUPIED	STATION SIGHTED	1st & VERTICAL ANGLE	3rd ANGLE SLOPE DISTANCE	MEAN ANGLE	HORIZONTAL DISTANCE
	pt 50	000-00-30			
pt 51		180-00-26	28		
	pt 56	240-11-42	240-11-9.5		
		060-11-33			
	pt 50	090-00-50	45	240-11-08	
pt 51		270-00-40			
	pt 56	330-11-54	240-11-06.5		
		150-11-49	51.5		

77.5  
28  
49.5

57.5  
49  
6.5

MH, GB, JA

3/21/86 52

meanders of SE side of  
Silver Lake

JA GB MH

56

51

50



3/21/46

STATION OCCUPIED	STATION SIGHTED	1st VERTICAL ANGLE	3rd ANGLE SLOPE DISTANCE	MEAN ANGLE	HORIZONTAL DISTANCE
	pt 51	000 00 30	.27		
pt 56	#57 B	180-00-24			
ml pt <del>52</del>	<del>52</del>	077-26-20	77-25-48		
		257-26-10			
			77-25-45.25		
pt 51	090-00-48		44		
pt 56	#57 B	270 00 40			
ml pt <del>52</del>	<del>52</del>	167-26-29	77-25-42.5		
		<del>347-26-24</del>	26.9		
		347-26-24			
pt 51	89-56-30	2250.550 ft	685.970 m		2250.5488
ml pt <del>52</del>	#57 B	89-56-52	999.705 ft		999.7076
			304.712 m		
75	.86 15				
27	44.0				
48	42.5				

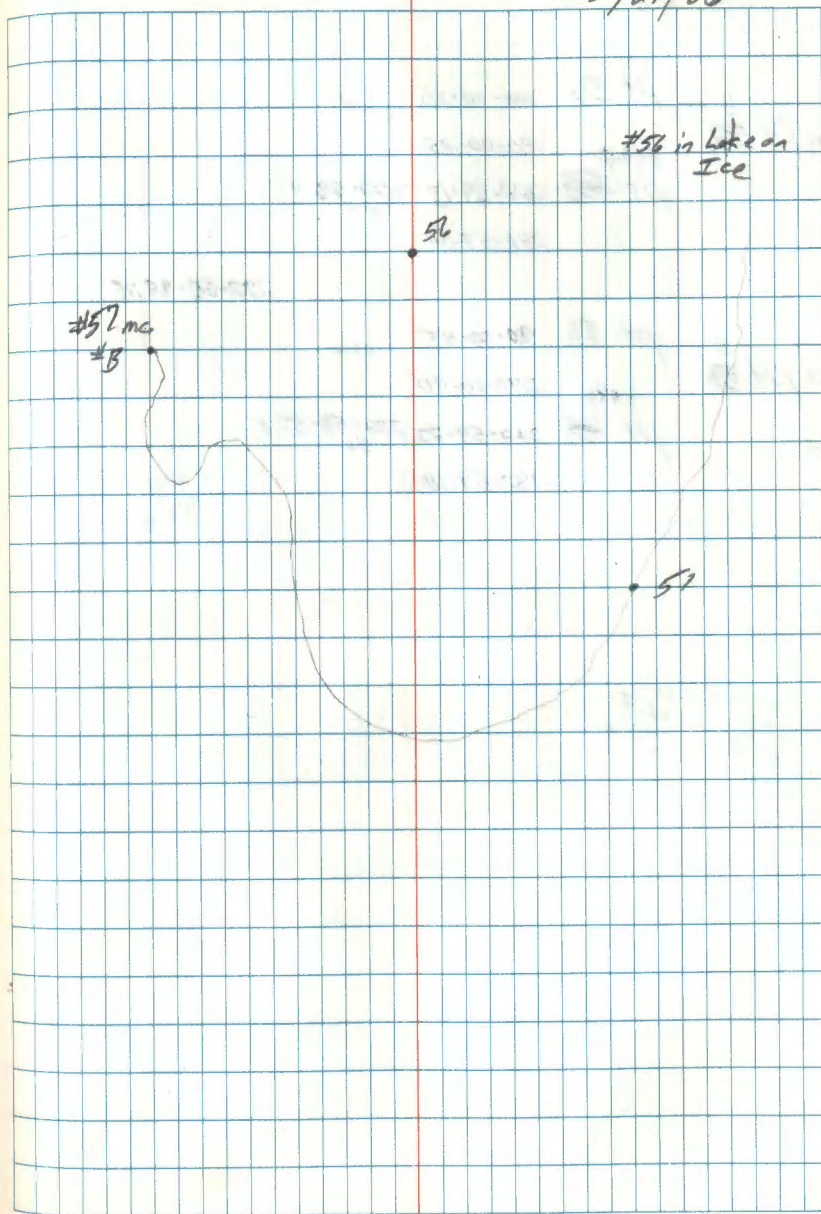

SECTION  
OCCUPIED

STATION  
SIGHTED

1st &  
VERTICAL  
ANGLE

3rd ANGLE  
SLOPE  
DISTANCE

MEAN  
ANGLE

HORIZONTAL  
DISTANCE

SECTION OCCUPIED	STATION SIGHTED	1st & VERTICAL ANGLE	3rd ANGLE SLOPE DISTANCE	MEAN ANGLE	HORIZONTAL DISTANCE
B	pt 56	000-00-30	27.5		
mc pt 52	#50A	180-00-25			
	pt 53	222-59-13	222-58-41 28.5		
		042-59-04			
				222-58-39.75	
B	pt 56	90-00-45	42.5		
mc pt 52	#50A	270-00-40			
	pt 53	312-59-22	222-58-37.5 20		
		132-59-18			

69.5	80
22.5	42.5
41.0	37.5

3/21/86 54

JAT LB MH

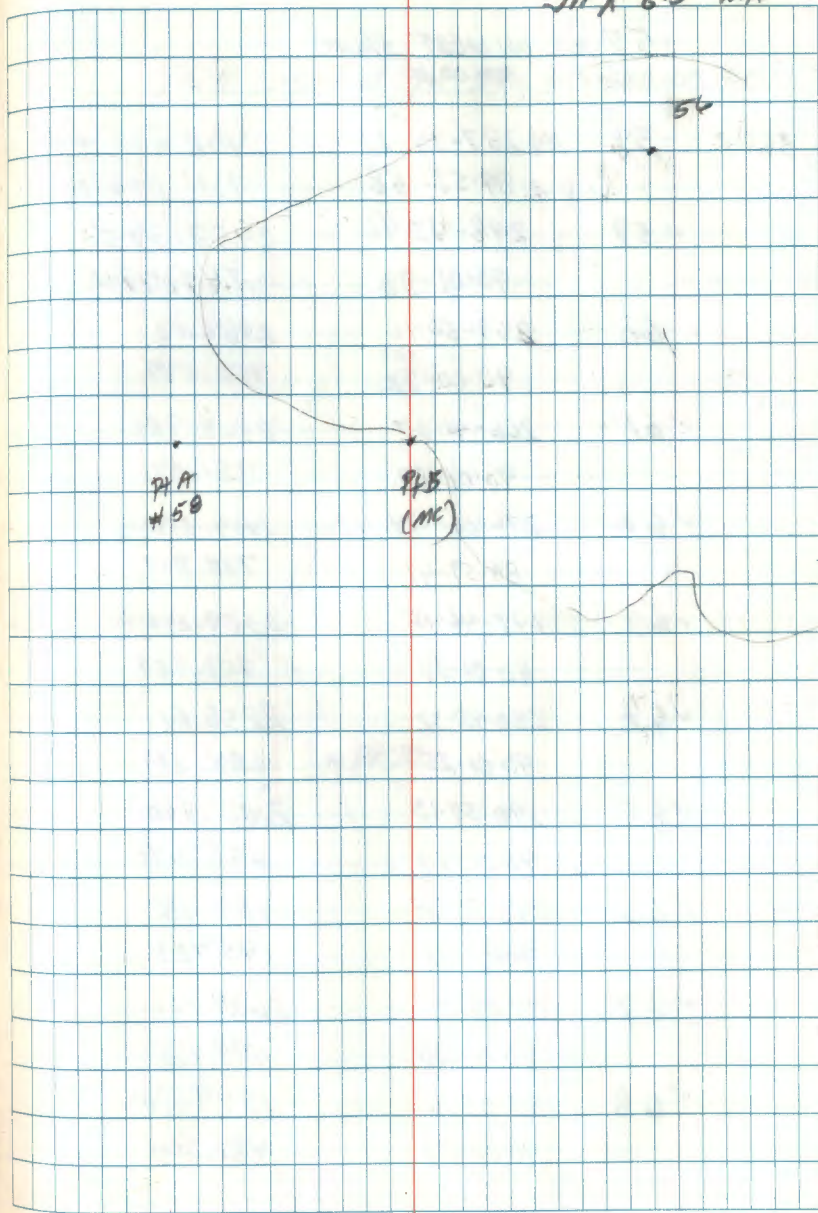

STATION  
OCCUPIEDSTATION  
SIGHTED1st  
VERTICAL  
ANGLE2nd ANGLE  
SLOPE  
DISTANCEMEAN  
ANGLEHORIZONTAL  
DISTANCE57 MC ON WEST SHORE  
000 00 00

✓ 36	39	HA 237-14-21	2408.295 ft
		V 2 89-53-58	734.050 m
✓ 59		248-42-46	2453.395
		90-01-38	747.794
✓ 60		259-50-16	2482.12
		90-00-52	756.549
✓ 61		266-41-37	2463.985
		90-01-29	751.022
✓ 62		276-00-44	2404.355
		89-59-41	732.850
✓ 63		277-46-15	2329.245
		90-01-35	709.959
✓ 64		280-48-32	2258.61
		90-01-25	688.427
✓ 65		290-57-13	2156.950'
		90-01-47	657.441
✓ 66		296-36-30	1954.485
		90-01-25	595.728
✓ 67		301-08-04	1639.720
		90-02-20	499.788
✓ 68		305-03-16	1579.070
		90-02-07	481.304

55

back sighted pt 57 at 000-00-00

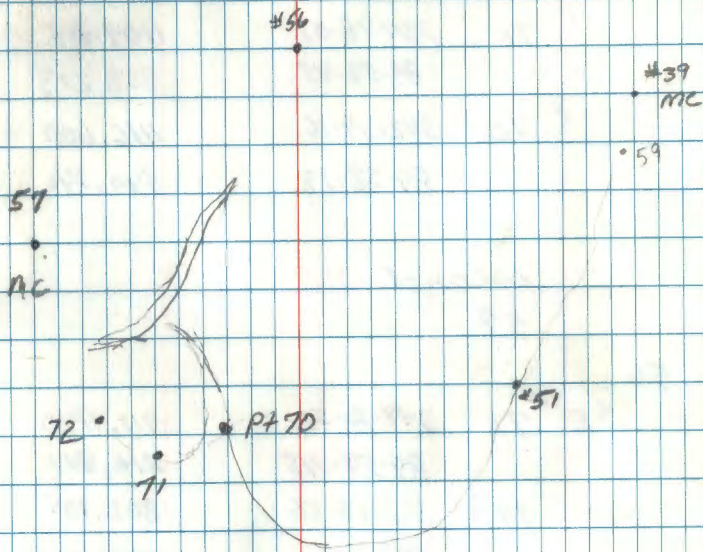

STATION OCCUPIED	STATION SIGHTED	1st ANGLE VERTICAL ANGLE	3rd ANGLE SLOPE DISTANCE	MEAN ANGLE	HORIZON DISTANCE
	57	000 00 00			
56	✓ 69 H <sub>9</sub>	315-25-45		1205.780	f.
	✓ 70	90-03-09		367.523	m.
tip of pt	70	322-14-24		898.510	
		89-58-48		273.867	
	✓ 71	334-18-07		1109.815	
		89-58-45		338.273	
	✓ 72	342-19-16		1116.600	
		89-58-19		340.340	
	Island				
	57				
56	SE ✓ 73	344-30-52		711.440	
		89-54-45		216.847	
	SW ✓ 74	352-23-56		802.105	
		89-57-29		244.520	
	North	75	351-41-05	485.400	
	End		89-56-00	147.956	

STATION  
OCCUPIED

STATION  
SIGHTED

2<sup>nd</sup> ANGLE  
VERTICAL  
ANGLE

3<sup>rd</sup> ANGLE  
SLOPE  
DISTANCE

MEAN  
ANGLE

HORIZONTAL  
DISTANCE

STATION OCCUPIED	STATION SIGHTED	1st VERTICAL ANGLE	2nd SLOPE DISTANCE	MEAN ANGLE	HORIZON. DISTANCE
------------------	-----------------	--------------------	--------------------	------------	-------------------

FS 3	199-40-27	19-40-22	199-40-15	19-40-48 <sup>74</sup>	
------	-----------	----------	-----------	------------------------	--

BS 1	00-00-00	180-00-00	359-59-50	180-00-24	
------	----------	-----------	-----------	-----------	--

PC 2	199-40-27	40 22	40 25	40-24	
------	-----------	-------	-------	-------	--

199-40-25

Z-3 155.88 ✓ 47.513m

FS 4	185-48-22	5-48-28	185-48-19	5-48-30	
------	-----------	---------	-----------	---------	--

BS 2	00-00-00	180-00-07	00-00-01	180 00 10	
------	----------	-----------	----------	-----------	--

PC 3	185-48-22	185-48-21	185-48-18	185-48-20	
------	-----------	-----------	-----------	-----------	--

185-48-20

Z-4 386.43 ✓ 117.783

FS 5	169-28-37	349-28-42	169-48-38	349-28-47	
------	-----------	-----------	-----------	-----------	--

BS 3	00-00-00	180-00-05	00-00-02	180-00-08	
------	----------	-----------	----------	-----------	--

PC 4	169-28-37	169-28-37	169-48-36	169-28-39	
------	-----------	-----------	-----------	-----------	--

169-28-37

Z-5 413.87 ✓ 126.147

RMAIN OT  
J. Schoonover  
C. GERTER 3-28-01 SNOW 30° TOP ON TOTAL STA

P.M. J.S. G.C.

58

SPK • PT#1 NORTH SHOULDER  
POWER DAM ROAD  
190 FT EAST OF  
BRIDGE

6.5  
7.8 PT#2

SPK • PT#3

SPK • PT#4

STATION OCCUPIED	STATION SIGHTED	VERTICAL ANGLE	ANGLE SLOPE DISTANCE	MEAN ANGLE	HORIZONTAL DISTANCE
		40			
F.S 6	213-29-05	33-29-06	213-28-58	<del>179-59-52</del>	37-29-11
B.S. 4	00-00-00	179-59-50	359-59-44	<del>33-29-03</del>	180-00-04
TA@ 5	213-29-05	213 29-16	213-29-14	<del>30 7</del>	213-29-07
		213-29-10			

SPLD PTS

5-6 251.63' / 76.697m

F.S. 7	115-08-24	295-08-10	115-08-26	295-08-07
B.S. 5	00-00-00	180-00-04	00-00-08	179-59-49
TA@ 6	115-08-24	115-08-06	115-08-26	115-08-18
		115-08-19		

SPLD PT6

6-7 18023' / 54.934

F.S 8	181-14-22	01-14-25	181 14 24	1-14-26
B.S 6	00-00-00	180-00-02	00 00 03	180-00-03
TA@ 7	181-14-22	181-14-23	181-14-21	181-14-23
		181-14-22		

5 1/10

6+5

TA@ 7

7-8 275.80' / 84.063

FS 9 186-14-42 186-14-49 186 14 43 6-14-48  
 BS 7 00-00-00 179-59-57 359 59 57 179 59 58  
 PE 8 186 14 42 186-14-52 186-14-46 186-14-50  
 186-14-48

8-9 556.325 ✓ 169.589 M

FS 10 248-16-54 68-17-07 248 17 02 68 17 08  
 BS 8 00 00 00 PC 00 13 00-00-10 180 00 18  
 PE 9 248-16-54 248-16-54 248-16-52 248-16-50  
 248-16-52

9-10 515.97 ✓ 157.267

FS 11 169-19-32 349-19-40 169-19-42 349-19-48  
 BS 9 00. 00 00 180-00-06 00 00 01 180 00 16  
 PE 10 169-19-32 169-19-34 169-19-41 169-19-32  
 169-19-35

10-11 237.35 ✓ 72.334



STATION OCCURRED	STATION SIGHTED	1st & VERTICAL ANGLE	3rd ANGLE SLOPE DISTANCE	MEAN ANGLE	HORIZONTAL DISTANCE
FS 12	237-48-58	57-49-02	237-48-54	57-49-07	
BS 10	00-00-00	180 00 04	00 00 180	00-00-05	
TI 11	237-48-58	237-48-58	237-48-54	237-49-02	
		237-48-58			
11-12	2622.33	✓ 799.286			
F.S. 13	272-22-08	92-22-12	272-22-12	92-22-23	
B.S. 11	00-00-00	180-00-06	359-59-57	180-00-04	
TI 12	272-22-08	272-22-06	272-22-15	272-22-18	
		272-22-12			
12-13	133.805	✓ 40.783			
FS 14	169-37-37	349-37-42	169-37-41	349-37-46	
BS 12	00-00-00	180-00-08	00-00-00	180-00-12	
TI 13	169-37-37	169-37-34	169-37-41	169-37-34	
		169-37-37			
13-14	285.965	✓ 83.163			

1/4  
6.5 PT 11

SPK PT 12

C+1/4 PT 13

STATION	STATION	1st & VERTICAL	3rd ANGLE SLOPE	MEAN ANGLE	HORIZONTAL DISTANCE
OCCUPIED	SIGHTED	ANGLE	DISTANCE		

FS 15	M3-37-20	13-37-17	M3-37-10	13-37-17	
BS 13	00-00-00	180 00 07	00 00 00	180 00 06	
TC 14	M3-37-20	M3-37-10	M3-37-10	M3-37-11	
		193-37-13			

14-15 1024.3 ✓ 312.206m

FS 16	222-40-07	42-40-08	222-40-09	42 40 05	
BS 14	00-00-00	180-00-03	00-00-00	180 00 00	
TC 15	222-40-07	222-40-05	222-40-09	222-40-05	
		222-40-07			

15-16 1878.65 ✓ 572.625

FS 17	53°44'38"	233-44-25	53 44 24	233-44-38	
BS 15	00-00-00	179 59 39	359-59-43	179 59 49	
TC 16	53-44-38	53-44-46	53-44-41	53-44-49	
		53-44-43			

16-17 956.75 ✓ 296.617

MAIN DIT  
SCHOONOVER  
3/29/01 PL 32° TOPCON TOTAL STA

62

SPK - PT 14

CS<sub>16</sub>  
○ PT #15

W<sub>16</sub>  
605 PT # 16

STATION	STATION	VERTICAL	3rd ANGLE SLOPE	MEAN ANGLE	HORIZONTAL DISTANCE
FS 18	148-10-48	328-10-56	148 10 44	328-10-54	
BS 16	00-00-00	180 00 01	<sup>00 00 00</sup> 359 59 37	174 59 57	
TC 17	148-10-48	148-10-55	148-10-44	148-10-57	
		148-10-51			
17-18	430.51 ✓	1316.22M			
FS 19	344-51-31	164 51-30	344-51-31	164 51 34	
BS 17	00-00-00	179 59 50	<sup>00-00-00</sup> 359 59 42	179 59 52	
TC 18	344-51-31	344-51-40	344-51-31	344-51-42	
		344-51-36			
18-19	194.175 ✓	59.184			
FS 20	209-21-50	29-22-00	209 21 49	29-22-00	
	209-22-18	29-22-19	209-22-18		
BS 18	00-00-00	180-00-11	<sup>00 00 00</sup> 20-00-24	180 00-00	
TC 19	209-21- <sup>43</sup> 48	209-21- <sup>40</sup> 54	209-21-49	209-22-00	
		209-21-50			
19-20	2255.145 ✓	1087.368			

SPK • PT 17

1/4 5 PT 16  
000

SPK • PT 19

STATION OCCUPIED	STATION SIGHTED	1st & VERTICAL ANGLE	3rd ANGLE SLOPE DISTANCE	MEAN ANGLE	HORIZONTAL DISTANCE
---------------------	--------------------	----------------------------	--------------------------------	---------------	------------------------

FS 1	187-14-37	07-14-39	187-14-51	07-14-58	
BS 19	00-00-00	180-00-20	00-00-15	180-00-19	
TP 20	187-14-37	187-14-19	187-14-36	187-14-39	
1		187-14-33			

20-1 149.67' / 45.619m.

FS 2	251-49-11	71-49-13	251-49-07	71-49-19	
BS 20	00-00-00	180-00-05	00-00-03	180-00-06	
TP 1	251-49-11	251-49-08	251-49-04	251-49-13	
		251-49-09			

1-2 451.64' / 137.66m

SPK . PT 20

CORNER

SPK . PT 1

STATION OCCUPIED	STATION SIGHTED	VERTICAL ANGLE	3rd ANGLE SLOPE DISTANCE	MEAN ANGLE	HORIZONTAL DISTANCE
---------------------	--------------------	-------------------	--------------------------------	---------------	------------------------

FS 1000	266-59-38	86-59-42	266-59-45	86-59-50	
BS 14	00-00-00	180-00-02	00-00-00	180-00-08	
Tc 15	266-59-38	266-59-40	266-59-45	266-59-42	
		266-59-40			

15-1000 10 12.25 ✓ 308.534

FS 1001	179-54-31	359-54-35	179-54-38	359-54-30	
BS 15	00-00-00	180-00-10	00-00-03	180 00 00	
Tc 1000	179-54-31	179-54-25	179-54-32	179-54-30	
		179-54-29			

1000-1001 314.235 ✓ 95.778

FS 1002	90-51-13	270-51-12 <sup>12</sup>	90 51 11 <sup>71</sup>	270-51-09 <sup>69</sup>	
BS 1000	00-00-00	179 59 54	359-59-53	179 59 45	
Tc 1001	90-51-13	90-51-18	90-51-18	90-51-24	
		90-51-18			

1001-1002 244.735 ✓ 74.596

4-2-2001 CLEAR 35° TOP CON TOTAL STA

MAIN STA  
SOUNDING 65  
GRIBER  
BRAMA

65 A15  
1/16

SPK #1000

SPK #1001 THEORETICAL POSITION  
SW TO SECTION 5

STATION OCCUPIED	STATION SIGHTED	VERTICAL ANGLE	SLOPE DISTANCE	MEAN ANGLE	HORIZONTAL DISTANCE
FS 1003	180-00-02	359-59-59	180-00-01	359-59-56	
BS 1001	00-00-00	179-59-49	359-59-51	179-59-46	
TC 1002	180-00-02	180-00-10	180-00-10	180-00-10	
		180-00-08			
1002-1003	648.46 FT	197.651 M			
FS 16	180-00-07	00-00-05	180-00-11	00-00-04	
BS 1002	00-00-00	180-00-01	00-00-01	180-00-00	
TC 1003	180-00-07	180-00-04	180-00-10	180-00-04	
		180-00-06			
1003-16	419.175	127.765 m			
FS 17	98-39-16	278-39-14	98-39-14	278-39-16	
BS 1003	00-00-00	180-00-10	00-00-13	180-00-11	
TC 16	98-39-16	98-39-04	98-39-01	98-39-05	
		98-39-07			
16-					

43-2001

 117 MAIN 66  
 SCHOONOVER  
 BRAMA  
 GEIGER

SPK • PT 1002

SPK • PT 1003

 Wt  
 6.5 PT 16

STATION OCCUPIED	STATION SIGHTED	1st & VERTICAL ANGLE	3rd ANGLE SLOPE DISTANCE	MEAN ANGLE	HORIZONTAL DISTANCE
FS 3	<del>222-05-48</del>	<del>42-01-15</del>	<del>222-05-40</del>	<del>42-01-12</del>	
BS 1	00-00-00	180-00-38	90-08-06	180-00-40	
TP 2	222-05-43	57-47	222-57-34	221-57-32	

(221-57-33)

VA 2-1	267-22-40 92-37-10	(92-37-10)	95.405 ft ✓	59.560 m
2-3	94-25-35 265-33-54	(94-25-35)	286.805 ✓	87.417 m

FS 4	90-43-35	270-44-00
BS 2	00-00-00	180-00-27
TP 3	90-43-35	90-43-33
	(90-43-34)	

FS 5	159-54-35	339-54-58
BS 3	00-00-00	180-00-30
TP 4	159-54-35	159-54-28
	(159-54-32)	

4-3	88-57-40	272-02-08	(88-57-46)	855.05 ✓	260.620
4-5	90-58-47	269-01-07	(90-58-50)	350.86 ✓	106.943

Rm π  
MH  
9/19/01

67

60° cloudy

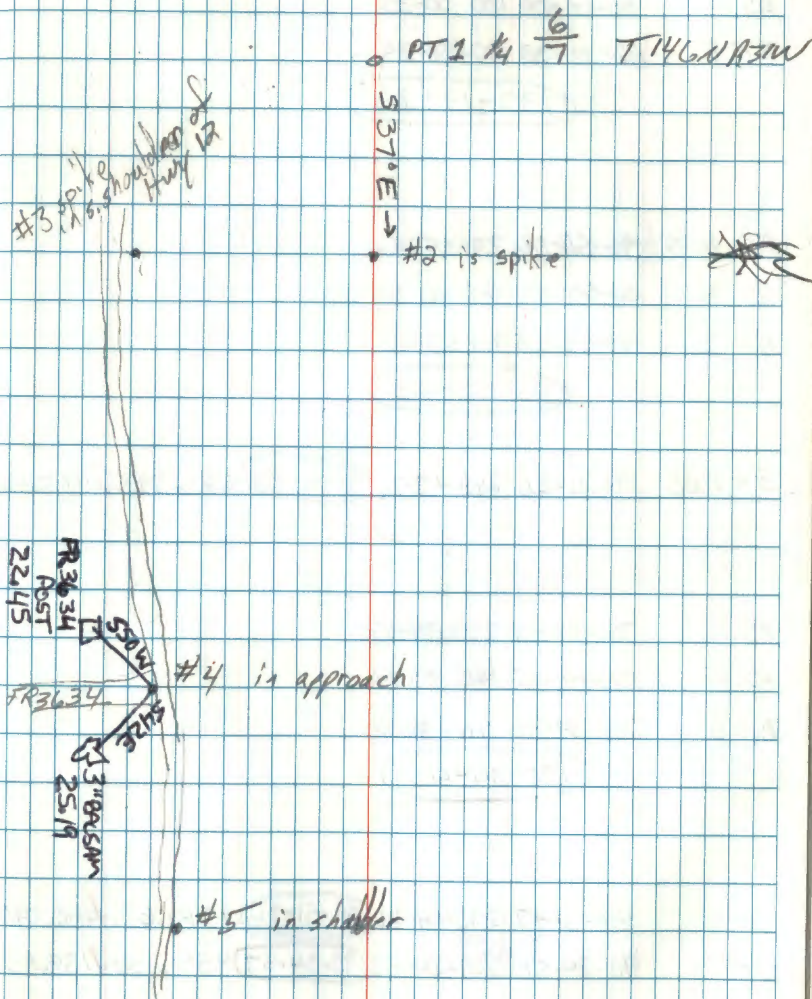

STATION OCCUPIED	STATION SIGHTED	VERTICAL ANGLE	SLOPE DISTANCE	HEAVY ANGLE	HORIZONTAL DISTANCE
FS 6	190-19-38	10-20-04			
BS 4	00-00-00	180 00-30			
IC 5	190-19-38	190-19-34			
		190-19-36			
FS 1000	96-55-55	276-56-26			
BS 4	00-00-00	180 00 30			
IC 5	96-55-55	96-55-56			
		96-55-55			
5-1000	91-11-26	268 48-26	91-11-25	483.595	147.400
FS 7	70-34-40	250-34-58			
BS 5	00-00-00	180 00 08			
IC 6	70-34-40	70-34-50			
		70-34-45			
6-5	89-51-17	270-08-26	89-51-26	1581.675	482.095
6-7	90-34-50	269-24-55	90-34-57	455.56	138.856

RM  
MH  
9/19/01

68

PT 1000 WIC TO E 1/6

PT 6

PT 7





STATION OCCUPIED	STATION SIGHTED	1st & VERTICAL ANGLE	3rd ANGLE SLOPE DISTANCE	MEAN ANGLE	HORIZONTAL DISTANCE
------------------	-----------------	----------------------	--------------------------	------------	---------------------

FS 100 87-23-17 267-23-45

BS 5 00-00-00 180 00-29

TP 4 87-23-17 87-23-16

(87-23-17)

FS 101 ~~214-39-17~~ 34 39-54 214-39-20 <sup>92 20</sup> 34-39-46 214-39-20

BS 4 00-00-00 180 00 10 359-59-52 180 00 08 359-59-50

TP 100 ~~214-39-17~~ 214-39-44 214-39-28 214-39-38 214-39-30

(214-39-35)

100-4 92-09-55 267-47-42 (92-10-06) 356.645 ✓ 108.706

100-101 87-52-05 272-07-40 (87-52-12) 394.06 ✓ 120.110

FS 102 154-01-20 334-01-50

BS 100 00-00-00 180 00 30

TP 101 154-01-20 154-01-20

(154 01-20)

RM & MH  
9/19/01

69

SPK 0 4

SPK 0 100

SPK 0 101

STATION OCCUPIED	STATION SIGHTED	1st & VERTICAL ANGLE	3rd ANGLE SLOPE DISTANCE	MEAN ANGLE	HORIZON DISTANCE
FS 103	53-03-56	233-04-32			
BS 101	0-00-00	180-00-30			
TR 102	53-03-56	53-04-02			
		<u>53-03-59</u>			
102-101	90-51-00	<del>269-08-45</del> 269-08-45	<u>90-51-08</u> 286.385 ✓		87.293
102-103	90-51-24	269-08-30	<u>90-51-27</u> 259.030 ✓		78.954
FS 104	188-43-55	08-44-20			
BS 102	00-00-00	180-00-25			
TR 103	188-43-55	08-43-55			
		<u>188-43-55</u>			
FS 105	299-04-35	119-05-00			
BS 103	0-00-00	180-00-25			
TR 104	299-04-35	299-04-35			
		<u>299-04-35</u>			
<del>104-103</del>	<del>85-56-50</del>	<del>274-03-00</del>	<del>85-56-51</del> 225.330		<del>71.</del>
<del>104-105</del>	<del>89-17-07</del>	<del>270-42-40</del>	<del>89-17-13</del>		
104-103	85-59-00	274-00-50	<u>85-59-05</u> 235.330 ✓		71.728
104-105	89-08-42	270-51-15	<u>89-08-44</u> 142.81 ✓		43.527

Rm & MH  
9/19/01

70

SPK 102

SPK 103

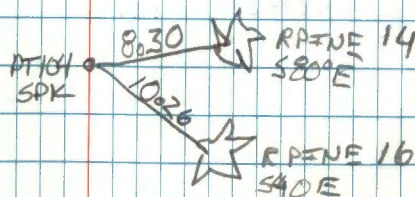

NE  $\frac{1}{16}$  105

9/20/01

STATION OCCUPIED    STATION SIGHTED    1st & VERTICAL ANGLE    3rd ANGLE SLOPE DISTANCE    MEAN ANGLE    HORIZON. DISTANCE

105 299-04-40 119-04-52  
 BS 103 00-00-00 180-00-30  
 T @ 104 299-04-40 299-04-22

FS 2000 STP 122-19-16 302-19-22 Horz Δ (122-19-04)  
 FS 3000 STP 122-13-22 302-14-03 Horz Δ (122-13-27)  
 FS 4000 STP 124-22-00 304-22-30 Horz Δ (124-22-00)  
 FS 5000 STP 130-16-08 310-16-31 Horz Δ (130-16-05)

VD 2000 88-46-10 117.80 ✓ 35.91  
 VD 3000 89-13-15 132.95 ✓ 40.528  
 VD 4000 89-10-40 141.09 ✓ 42.998  
 VD 5000 89-01-25 137.46 ✓ 41.90

Run Mt.  
 9/20/01

55° Foggy

NOTE: Pt 2000 3000 4000 5000 ARE  
 REAPENE STUMPS SHOT WITH RANGE POLE  
 AND SMALL LENS. THESE ARE SIDESHOTS.

