

TURNER
RESTORATION

T 146N R29W



MINING
TRANSIT BOOK

No. 384T

BOOK 1

TURNER
RESTORATION
T 146N R29W

Book #14

USFS

T196N R29W 526 P.M.

CASS and ITHACA COUNTIES

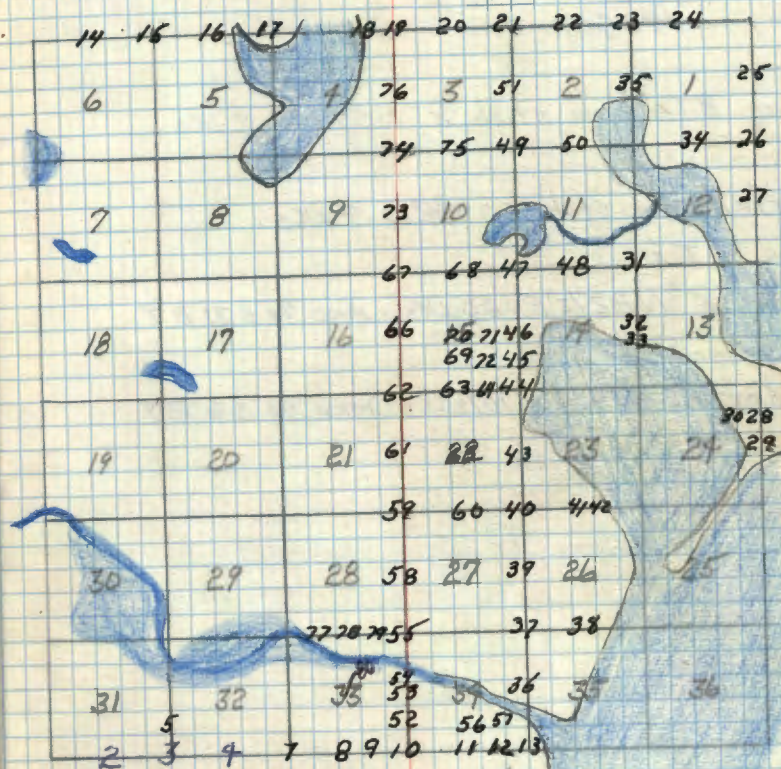

Notes of GLO Dependent Resurvey of
 - Surveyor Hal. D. Craig.
 June 21, 1934 to Sept. 19, 1935

ORIGINAL GOV'T SURVEY 1875 By B.C. BALDWIN
 SEPT. 24 - OCT. 9, 1875

2
Quarter Cor. Sec's 31 6 T195NR29W
T196NR29

Iron Post 3' long 2" dia. 28" in ground

MKD $\frac{1}{4}$ S31
S6
1934

Orig. B.T. - Tam stub 8" N59 $\frac{1}{2}$ E 4 LKs

Rotted tam. stub 537 $\frac{3}{4}$ W 9 LKs

New B.T.'s

Tam. 8" N22 $\frac{1}{2}$ E 60 LKs MKD $\frac{1}{4}$ S31 BT

Cedar 5" S59 $\frac{1}{2}$ W 10 $\frac{1}{2}$ LKs MKD $\frac{1}{4}$ S6 BT

3 7-5

31-32 T196N R29W

Cor. Sec's 5-6 T195N R29W

6" dia. 29" Long cyl. concrete mon. w/ 3 1/2"

dia. brass tablet stamped T196N R29W

(Found in place marking S31 S32

Cormex.) S6 S5

Orig. B.T.s

T195N
1934

Fallen Jack pine 8" dia. N34°E 18 Lks w/ old.

blaze & portion of scribe marks

Fallen Jack pine 15" S68°W 67 Lks w/ old blaze

& portion of scribe marks

New B.T.s

Jack Pine 6" N22°E 12 Lks - T196N R29W S32 BT

Not Found

Jack Pine 7" S17°E 11 Lks - T195N R29W S5 BT

(New stp scribed BT at record bearing & dist.)

Jack Pine 8" S57 1/2°W 78 Lks - T195N R29W S6 BT

(New stp. scribed "6 BT" at record bearing & dist.)

Jack Pine 6" N16°W 35 Lks - T196N R29W S31 BT

(Not Found)

Steel sign post 72" long, set 24" in ground w/

sign 54-A attached N78°W 3.2 feet

Two B.T.s marked in 1959

Jack pine 10" S65°W 16.5 ft. MKD T195 R29 S6 BT

Jack pine 12" N40°E 154.1 ft. MKD T196 R29 S32 BT

2-5

Affidavit

3-24-09 R. MAIN J. SCHOONOVER
 FOUND IRON IN PLACE FLUSH AND GPS. CORNER
 IN MATURE R PINE 115' FT WEST OF FR 2169
 (LYBE) & 6 FT STEEL SIGN POST STILL GOOD.
 FSLP ON 8" R PINE WEST SIDE LYBE RD FROM
 WHICH CORNER BEARS WEST 90 FT.

R. PINE 12" N78°E 13.72 FT TO SPK MKD S32 BT

R. PINE 12" N49°W 27.47 FT TO SPK MKD S31 BT

1959 J. PINE 20" @ BRG & DIST DEAD TOP.

1959 J. PINE 17" @ BRG & DIST GOOD HEALTH

Handwritten signature
 12/3/64

7 32 T146NR29W

Z-7 Quarter Cor. Sec's 5 T145NR29W

Iron Post 3' x 2' w/ brass cap mkd

$\frac{1}{4}$ 532
55
1934

Orig. BTs

J. Pine snag S20°W 28 lks w/ portion of orig.

Scribe

Burned J. Pine stp. 16" N51°W 21 lks

New B.T's.

Jack Pine 4" N39°E 70 $\frac{1}{2}$ lks mkd $\frac{1}{4}$ 532 BT

NOW 6" J. PINE STUB N39°E 46.5' SCRIBE VISABLE

Jack Pine 4" S42 $\frac{1}{4}$ °E 34 $\frac{1}{2}$ lks^{22.7} mkd $\frac{1}{4}$ 55 BT

NO EVIDENCE REMAINS AT BRG + DISTANCE

2/9/89 CK-GB

FOUND IRON CAP - IN PLACE - IN GOOD CONDITION

6" ABOVE GROUND - IN JACK PINE STAND - APPROX. 250'

WEST OF N+S WOODS TRAIL

MARKED NEW BT'S.

J. PINE 11 N55E 48.41' - mkd $\frac{1}{4}$ 532 BT

J. PINE 10 S47E 32.05' " $\frac{1}{4}$ 55 BT

J. PINE 10 S18W 24.82' $\frac{1}{4}$ 55 BT

8' STEEL POST NORTH 2.6' 549

CC DONE CK

5 Y-5

South 1/16 Cor Sec's 31-32

Notes of G.L.O. dependent resurvey of
1934. Cor. set by Proportionate measurementIron post 1" dia. x 36" long w/ brass cap mkd:
(Found under roots of a wind fall 5 1/16
Not in place.) 531 532

From which bears 1934

Jack Pine 6° S 3° E 46 LKs or 30.36' MKD 5 1/16
NOW A SNAG
S 32 BT (Now 11" w/ scribe plain at record bearing) 1' distJack Pine 8° S 50° W 42 LKs or 27.72' MKD 5 1/16
S 31 BT (Now a stump w/ blaze facing corner
at record bearing & distance.)I reset brass cap at point for corner and
set a steel sign post 72" long set 24 inches
in ground w/ signs 54-2 & 54-4 attached due
North 5.4 Feet 5-6-63 *G. Donald*

1-31-89 LAND LINE CREW

LINE TO STANDARD NORTH AND EAST

~~R PINE~~ NOW 7" N 20° W 15.8 1/16 NOW DEADR PINE 7" S 46° W 16.73 MKD 5 1/16 S 31 BT
NOW 8" 2009R PINE 8" S 50° W 21.96 MKD 5 1/16 S 31 BT
NOW 13" 2009
8" STEEL SIGN POST 4.2' EAST

Y-5

Affidavit

3-24-09 R. MAIN

FD IRON AND GPS. CORNER ON SOUTH EDGE
OF ALDER/ASPEN LOW AREA INSIDE ± 50 YEAR
OLD R. PINE PLANTATION.

6

31 T146N R29W

Z-3 Quarter Cor Sec's 6 T145N R28W

Iron post 3' x 2" w/brass Cap MKD.

$\frac{1}{4}$ S31

S6

1934

"Orig B.T.s"

Tam. stb 8" N54 $\frac{1}{2}$ °E 4 Lhs.

Revised
Tam. st.

S37 $\frac{1}{2}$ °W 9 Lhs.

"New B.T.s"

Tam 8" N22 $\frac{1}{2}$ °E 60 Lhs - MKD. $\frac{1}{4}$ S1 BT.

Cedar 5" S54 $\frac{1}{2}$ °W 10 $\frac{1}{2}$ Lhs - MKD. $\frac{1}{4}$ S6 BT

7

Sec. 32-33 T146NR29W

CL DONECK

Z-9 Section Cor. Sec. 5-4 T145NR29W

6" dia 24" Long Cyl. Concrete Mon
w/ 3 1/2" dia. brass tablet stamped

2/13/89 CK-GB

T146N R29W

FOUND CONCRETE MONUMENT & CAP

S32

S33

IN PLACE - BELIEVE MAY LEAN NORTH S5

S4

SOME 2" BELOW GROUND

T145N

1934

J. Pine 8" S51 1/2° E ^{328.68'} 498 LKS MKD T145NR29W

NO EVIDENCE AT S51°E 328.7' IN N. PINE PLANT & SNAG

J. Pine 16" N80°34'W ^{441.54'} 669 LKS MKD T146NR29W

ALL SCABE VISIBLE

NOW 16" J. PINE SNAG DEAD N80W 441.6' S32 BT

NO OTHER TREES WITHIN REASONABLE DISTANCE.

MARKED NEW B.T.S.

N. PINE 15 N8E 51.95' T146NR29W S33 BT

N. PINE 15 S36E 68.15' T145NR29W S4 BT

N. PINE 10 S71W 14.32' T145NR29W S5 BT

N. PINE 12 N46W 44.45' T146NR29W S32 BT

8' STEEL SIGN POST NORTH 3.0' WITH S4-9

8

T146N R29W

T145N R29W

Quarter Cor Sec's 4-33

Iron post 3'x2' w/brass Cap MKD.

 $\frac{1}{4}$ S 33

S 4

1934

Orig B.T.s

J. Pine snag 11" S49°E 8 Lks.

Pine stump 20" N73°W 23 Lks.

New B.T.s

N. Pine 22" N14°E ^{55.44} 84 Lks. MKD $\frac{1}{4}$ S33 BTJ. Pine 5" S58°W ^{15.84} 24 Lks. MKD $\frac{1}{4}$ S4 BT

4-9-96 R. MAIN 50° 2 FT OF SNO. JUST

Fd GLO IRON IN PLACE, STRING CHAINED WEST FROM SECTION CORNER. CORNER FALLS 50 FT INSIDE NORTH EDGE OF 30yr. old R. PINE PLANTATION. MKD NEW BTS

R. PINE 7" S36°W 28.34 FT TO TOP MKD $\frac{1}{4}$ S4 BTR. PINE 7 1/2" S48°E 8.13 FT TO TOP MKD $\frac{1}{4}$ S4 BTR. PINE 10" NORTH 8.22 FT TO TOP MKD $\frac{1}{4}$ S33 BTPLACED FSLP ON 10" R. PINE, NORTH SIDE
FR 2348 B FROM WHICH CORNER BEARS
NORTH 490 FT.

9

Sec. 33-T146NR29W
 East 1/6 Cor. Sec's. 4-T145NR29W
 Iron post 3'x2" w/brass Cap MKD.

E 1/6 ~~S 33~~
 S ~~4~~
 1934

Pine snag. 12" S 39 1/2° W 62 Lks. 40092 ft

4-10-96 R. MAEN 50° 2' of snow yet

Ed GLO IRON IN PLACE FLUSH WITH THE GROUND.

Ed GLO PINE SNAG WITH SCRIBES VISIBLE SNAG = 8'

TAIL CORNER FALLS 1/2 DIST SOUTH OF FR 2348.B

MKD NEW BTS AS FOLLOWS

R. PINE 5" N 43° E 20.05 FT TO SK MKD X BT

R. PINE 17" S 35° W 43.80 FT TO SK MKD E 1/6 34 BT

W. OAK 8" N 80° W 37.45 FT TO SK MKD S 33 BT

8 FT STEEL SIGN POST 10 FT WEST

33-34 T146 N R29 W

Section Cor. 3-4 T145 N R29 W

6" dia 24" long cly. Concrete Monument
w/ 3 1/2" dia. brass Cap MKD.

5/11/89 CK

Fd. CONCRETE MONUMENT T146 N R29 W

IN PLACE - 6" ABOVE GROUND S 33 S 34

IN JACK PINE STAND - 80' S 4 S 3

EAST OF WOODS ROAD NW 1/4 SE T145 N

FR # 2348 B 1934

Orig B.T.

Fallen pine snag - 14" S 84° W 53 1/2'. Orig ^{35.0'}

Blaze and scribe MKs.

" NOW DELAYED LOG NEARLY LEVEL

No New B.T.s

MARKED NEW BT's.

N. PINE 14 NIW 71.35' MKD S33 BT

NOW 17" 10-29-03
N. PINE 11 S85E 60.59' MKD S3 BTNOW 13" OVERGROWN SCRIBE
N. PINE 12 S39E 39.04' MKD S3 BTNOW 16"
N. PINE 7 S69W 65.50' MKD S4 BTNOW 9" DEAD ± SOFT TALL,
8' STEEL SIGN POST 4.0' EAST S49

8' STEEL SIGN POST 4.0' NORTH S49

FSLP ON J. PINE 11 N89W 74.0' FROM COR.

NOW 20 FT SNAG N/TAG

ON EAST SIDE OF FR 2348 B NW 1/4 SE

10-29-03 R. MAIN 2" SNOW

GASED IRON

11 2-15

Sec. 34 T146NR29W

Quarter Cor. Sec. 3 T145NR29W
 Iron post 3'x2" 4" beneath Road
 w/brass. Cap MKO.

Found Bent over.

1/4	S34
	S3
	1934

J. Pine 7" N78°W 248 Lks. 163.68

(Now a Fallen & rotted snag at record bearing & dist. ^{scribe marks visible})

Pine Post 6" N73°E 48 Lks. 31.68

(Not Found)

To perpetuate this corner I reset
 orig. q.u.a. Brass Cap 6" under surface
 of road, and scribed New bearing
 trees.

N. Pine 8" N73°W 24.5' Scribed 1/4 S24 BT

N. Pine 8" S50°W 33.9' Scribed 1/4 S3 BT

Red top Cedar post 4'x4'x5' long set
 24" in ground w/signs 54-2 & 54-4
 attached due East. 16.0'

11-21-65 James Johnston

2-15

Affidavit
1-17-67
DITE

Note: Additional B.T.'s set because
 of realignment of road.

R. Pine 7" N52°E ^{SR} 40.5 feet mtd 1/4 S3 BT

E. Pine 9" S80°E 28.6 feet mtd 1/4 S34 BT

1-10-66
JA

10-25-74 CRK - DM

Checked corner - monument in place 1' SW of 10"
 fence corner post Both bts. in good condition

Clear 60°

10/21/85 CRK JA

FD: GLO brass capped Iron Pipe down 8" ok
 GLO. BTS

J. Pine stump and log rotted N78W 163.68' ^{scribe visible}

Pine Post - gone - road activity

1965 BTS:

N. Pine N73W 24.5' - wiped out from road

N. Pine S50W 33.9' - wiped out from road

1966 BTS:

E. Pine 11" S80°E 40.5' ^{scribe visible} ^{new spike}R. Pine 14" N52°E 28.6' ^{scribe visible} ^{tag red} ^{paint}

4x4x5' Cedar post East 16.0' Both signs

Steel sign post 3'x8" North 3.6' Both signs
 (Set by line to standard contractor in 1985)

Fence line and line to standard North & East
 road west 24' running N-S
 SETS

R. Pine 13" S43W 70.05' set tag red ring blaza & scribed
C.C. Dore 11/85

12 Z-16

Sec 34. T146N R28W

East 1/6 Cor. Sec. 3. T145N R28W

Iron post 3'x1" w/brass Cap MKD.

Found in good
Condition:

E	1	S34
	16	
		S3

10-20-65

1934

James Ekstrom

N. Pine 16" N64 3/4 E 57 LKS 37.62'

(Now a snag at record bearing, dist ^{scribe} marks visible)

J. Pine 7" S75 1/4 E 145 LKS 95.75'

(Now a fallen snag at record bearing
& dist.)to perpetuate this corner I scribed
two new bearing trees

J. Pine 10" N4°W 27.1' scribed E 1/6 S34 BT

Now 10" J. Pine (Dead) N4°W 27.1' scribe showing

Oak 7" N60°E 15.2' scribed E 1/6 S34 BT

Now 9" W. Oak N60°E 15.2' scribe closed

Steel sign post 72" long set
24" in ground w/signs 54.2' & 54.4'
attached due west. 7.5'

10-21-65 James Ekstrom

Z-16

Affidavit.

1-17-67

SHE

10-25-74 CRK DM

found iron in place 6" above ground
J. Pine 11" N4°W 27.1' scribe open (this tree is dead)
W. Oak 9" N60°E 15.2' scribe closed
set 8" steel sign post due north 2.3' with both f.s. signs

I mark new BT's. this day

J. Pine 10" N23°E 42.2' mkd. E 1/6 S34 BT.

J. Pine 10" S20°E 83.0' mkd. E 1/6 S3 BT.

10-25-74

Curtis R. Krause

10/21/85 CK JA

FL: Brass Capped Iron Pipe up 6" OK (GLD)

GLD PTS:

N. Pine stub 16" x 8" N65 E 37.62' scribe visible

J. Pine stump S75 E 95.70' window of BT

1965 PTS:

J. Pine N04W 27.1' fallen down

Oak 10" N60E 15.2' overgrown ^{new} spike & tag

1974 PTS:

J. Pine 13" N23E 42.2' scribe visible

J. Pine 10" S20E 83.0' dead standing tree

steel sign post 3" x 8" North 2.3' both signs

" " 2" x 6" West 7.5' " "

Line to standard west
Corner falls on high ground in hardwoods

Power line south 50' and west 50'

marked BT:

W. Oak 4" S61 E 21.55' spike tag red ring

CC post
11/85

13 Z-17

34-35 T146NR29W

Section Cor. Sec. 3-2 T145NR28W

6" dia. 24" Long of Concrete Mon.

w/3 1/2" dia. Brass Cap MKD.

found concrete monument

in place under bog 30" T146N R29W

set 8' steel sign post at S34 S35

north edge w/54-4. S3 S2

attached - 30' from toe of T145N

south slope of ridge along lake 1934

J. Pine 13" S44 3/4° E 116 Lhs: 76.56'

Now 17" J. Pine S45° E 76.6' mkd T145NR29W S2 Bt

N. Pine 7" S40° W 50 Lhs - 33.00'

Now 12" N. Pine stub S40° W 33.0 scribe showing

Pine. sTp. 14" N16 3/4° W 42 Lhs 27.72'

falls in bog very soft bottom

Z-17

1974

Sec. cor. is in front of 3rd cabin (Green) from west corner is 30' out on bog grass
 Norway Pine has been chopped off 6' high-top is lying at base of slope in muck

found old Pine stub in front yard of 3rd cabin scribed T145N R29W S3 Bt old ESCP on NW side

10-25-74

Curt Kinnear

14

Sec 31 - T147N R29W
 A-3 Quarter Cor. Sec. 6 - T146N R29W
 Iron post 3'x2" w/brass Cap MND.

$\frac{1}{4}$ S31
 56
 1934

ELM 24" S9 $\frac{1}{2}$ °W 95 LKS - 62.70'

1980 Fd. 30" ELM AT S9W - 62.70'

Cedar 4" N71 $\frac{1}{2}$ °W 93 LKS 61.38'

1980 Fd. 11" CEDAR AT N71W - 61.38'

12-15-80 JAMES SCHOONOVER

Fd. MONUMENT - IN PLACE - IN GOOD CONDITION

12" ABOVE GROUND

MARKED NEW B.T.S.

ASH 9 S6W 40.28' MND. $\frac{1}{4}$ S6 BT

ASH 10 S34E 81.50' MND. $\frac{1}{4}$ S6 BT

CEDAR 11 N71W 61.19' RESCRIBED
 $\frac{1}{4}$ S31 BT.

CERTIFICATE BY GARY STEVENSON 6-15-83

DOCUMENT # 358179

ON CORNER CARD IN 146-29

15

Sec's 31-32 T147N R29W

A-5 Section Cor. Sec's-6,5, T146N R29W

6" dia. 24" Long cyl. Concrete Mon.
w/3/2" dia. Brass Cap MKD.

T147N R29W

S31 | S32

S6 | S5

T146N

1934

Bof. Gil. 6" N16 1/4 E 17 LKs - 11.22'

1980 NO TRACE

Bof. Gil. 8" S51 1/2 E 28 LKs - 18.48'

1980 NO TRACE

Poplar 16" S61 1/4 W 55 LKs - 36.30'

1980 Fd. WELL ROTTED STUMP S62W - 36.30'

Bof. Gil. 10" N13 3/4 W 31 LKs - 20.46'

1980 NO TRACE

12-11-80 JAMES SCHOONOVER
Fd. CONCRETE MONUMENT - IN PLACE - 6" HIGH
MARKED NEW BTs.

ELM 5 N18E - 59.20' MKD X S32 BT

POPLAR 7 N34W - 59.42' " T147N R29W S31 BT

W. OAK 4 S34E - 32.93' " X S5 BT

W. OAK 5 S35W - 63.71' " T146N R29W S6 BT

CERTIFICATE BY GARY STEVENSON 6/15/83

DOCUMENT # 358180

INFORMATION ON CORNER CARD IN 146-29

4-26-95 RM & CK

Fd. CONCRETE CYLINDER - IN PLACE - 4" ABOVE
GROUND - NEAR ASPEN TIPOUT - IN THICK BRUSH
WITH MANY ASPEN + BALMIE WINDFALLS

FOUND THE FOLLOWING

W. OAK 8 S34E - 32.93' TAG + SPK.

W. OAK 8 S35W - 62.71' TAG + SPK.

ASPEN STUB 9" x 10' HIGH WITH SCRIBE VISIBLE
AT N34W - 59.41'OLD TAG ON ASPEN STUB 20" DIA. X 8' HIGH
DATE 1-15-42 HADLOCK + EHBORN
S65E 20.95'Fd. FSLP ON 10" J. PINE ON SOUTH SIDE OF FR 3864
STATES S6W - 309' TO SEC. COR. 12-11-80 JS-KN

16. Sec 32 T147N R29W

A-7 Quarter Cor. Sec's 5-T146N R29W

Iron post 3'x2" w/brass cap MKD.

4-26-95 RM YCK

Fd. 2" IRON YCAP - IN PLACE $\frac{1}{4}$ 532

4" ABOVE SWAMP 55

1934

Tam 4" N65½°E 20 LHs - 18.48'

NOW 7" TAM N65E 18.48' SCAR FAGING IRON

Tam 4" S12½°W 35 LHs - 23.10'

NOW 7" TAM. STUMP S12W 23.10'

MARKED NEW BT'S.

TAM. 6 534W 15.08' MKD ¼ 55 BT

TAM. 7 N78W 7.35' MKD ¼ 532 BT.

OPEN BRUSH + YOUNG TAM + SPRUCE SOUTH OF
E+W LINE
STANDING TAM. + SPRUCE NORTH OF E+W LINE
CORNER IN TAM. + SPRUCE SWAMP

Sec's 32-33 T147NR29W

A-9 Section Cor. Sec's. 5-4 T146NR29W
 6" dia. 24" long cyl Concrete Mon.
 w/3 1/2" dia. Brass Cap MKD.

T147N R29W

S 32	S 33
------	------

S 5	S 4
-----	-----

T146N

1934

"Orig B.T.s"

Spruce stump "Booned" N47°E 11 LKs - 7.26'

Tan stump S71°W 7 LKs - 4.62'

"New B.T.s"

Spruce 5" N51 1/4°E 22 LKs - 14.52'

Spruce 5" S86°E 20 LKs - 13.20'

Spruce 6" S37 1/2°W 39 LKs - 25.74'

Spruce 6" N64 1/2°W 20 LKs - 13.20'

Sec 33, T147NR29W

Meander Cor. Sec. 4, T146NR29W

East Shore Kenogama, Lake.

Iron post 3' x 1" w/brass Cap MKD.

T147N	
R29W	
MC. 533	
54	
T146N	
1934	

Orig B.T.s

Rotted Tam stb, 8" N79°E 39 LHs 25.74'

Tam stub 6" S64°E 47 LHs 31.02'

"New B.T.s"

Tam 3" N58½°E 22 LHs 14.52'

Tam 5" S48°E 88 LHs 58.08'

Sec's 33-34 T147NR29W

Section Cor. Sec's, 3-4 T146NR29W
 6" dia 24" Long cyl. Concrete Mon.
 w/3/4" Brass tablet MKO.

T147N R29W

S33	S34
-----	-----

S4	S3
----	----

T146N

1934

"Orig B.T.s"

Stump Hole S42°W 26 Lhs - 17.16'

Rotted Bass wood ^{stp.} N35°W 23 Lhs - 15.18'

"Local B.T.s"

Maple stp S74°E 10 Lhs - 6.60'

Basswood 8" S72°E 4 Lhs - 2.64'

Poplar snag 14" S65°W 15 Lhs - 9.90'

"New B.T.s"

Poplar 6" N56 1/2°E 24 Lhs - 15.84'

Maple 12" S14 3/4°E 43 Lhs - 28.38'

Ironwood 6" S40 1/2°W 42 Lhs - 27.72'

Poplar 10" N29°W 66 Lhs - 36.96'

Sec 34-T147NR29W

Quarter Cor. Sec. 3-T146NR29W
Iron post 3'x1" w/brass cap MKD.

$$\frac{1}{4} \frac{533}{54} ?$$

"Orig B.T.s"

1934

Fallen Tan, 5" S54°E 3414s-

"New B.T.s"

Spruce 5" S39½°W 5414s- 35.64'

Spruce 5" N73°W 6314s- 41.58'

21 A-17

Sec. 34-35 T 147N R29W

Section Cor. Sec. 3-2. T 146N R29W
 6" dia. 24" ~~dia~~ Long Cyl. Concrete Mon.
 w/3/4" dia. brass cap MKD.

Found marking	T 147N R29W	
corner approx.	S 34	S 35
80' West of FR 2171	S 3	S 2
	T 146N	
	1934	

N. Pine 10" N24 3/4°E 233 LKs - 153.78'
 (Now a 19" N. Pine N25°E 153.78' scribe overgrown)
 N. Pine 7" S52°E 65 LKs - 42.90'
 (Now 12" N. Pine S52°E 42.9' scribed "T146NR29W")
 Spruce 6" S24 1/4°W 25 LKs - 16.50'
 (Now a 7" spruce S24 1/2°W 16.5' scribe visible)
 Spruce 3" N39 1/2°W 167 LKs - 110.22'
 (Not Found)

To perpetuate this corner I marked new BTs

Tamarack 5" N36 1/2°W 1170' MKD S34 BT
 Red Pine 19" N25°E 153.78' re-marked S 35 BT.
 3-23-62 J.P.H. McDonald

Steel sign post 72" long set 24" in ground
 w/sign 54" x 4" attached due East 3.85 Feet

Heidavit RHM
 5680-11 RHM

A-17

37

35

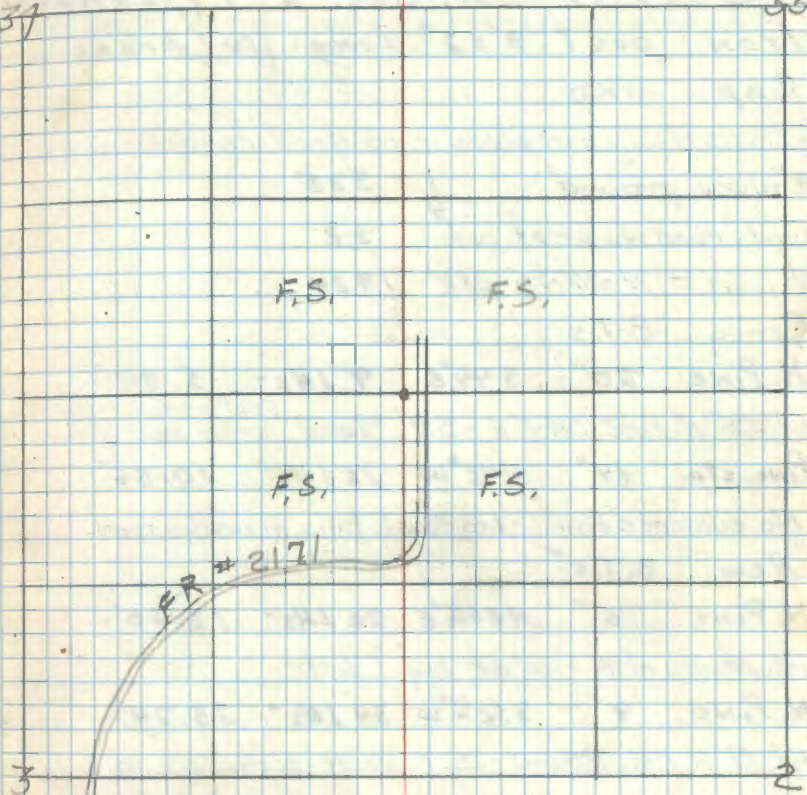

9/17/90 CR, GB

Found GLO concrete cylinder slightly leaning in the swamp.
 Found remains of GLO BT's recorded in 1934:

1. 23" Nor. Pine N25E at 153.78'
2. 14" N. Pine S52E at 42.9' scribe overgrown.

Found no evidence of Spruce S24W @ 16.50'
 Found Tam 6" N37W @ 117.0' recorded in 1962.

Reset concrete mon. so brass cap is flush with
 the swampy moss.
 Mark new BT - 18" N. Pine @ 73.5', S 2.0° W T146NR29W S34.
 Placed 8" steel sign post north 3.4' from corner
 with land survey sign attached.

22 A-19

Sec. 35-T147NR29W

Quarter Cor. Sec. 2-T146NR29W

Iron post 3'x2" Long w/brass

Cap MKD

Ed. iron cap - in place - in good condition

8" above ground $\frac{1}{4}$ 535

woods road to west side 52

of iron - 11-26-75 CRK 1934

Orig B.T.s

N. Pine 20" S44°E 9 LHs - 5.94'

Ed. 25" N. Pine. S44°E - 5.9' w/scar ^{FSLP on this tree (old)} scribe overgrown

Pine. stp. 14" N42°W 16 LHs - 10.56'

No evidence found - brq $\frac{1}{2}$ dist. falls in woods road

"New B.T.s"

N. Pine 6" N25½°E 20 LHs - 13.20'

Ed. stump of N. Pine at brq. $\frac{1}{2}$ dist.

N. Pine 9" S52½°W 39 LHs - 25.74'

Ed. 19" N. Pine S53W - 25.7' w/scar scribe overgrown

Blue line E ½ W from iron pipe - area north of corner
has been select cut past winter

23 A-21 Sec's 35-36. T147N R29W

Section Cor. Sec's -2.1. T146N R29W

6" dia 24" long Cyl Concrete Mon.
w/3/2" dia. Brass Cap MKD.

Ed. concrete cylinder T147N R29W

3' above ground - in place S35 S36

in good condition - in S2 S1

Tam. Swamp - 150' south to T146N

high ground aspen ridge 1934

Orig B.T.s

rotted Tam. stp. N40°E 28 Lks - 18.48'

rotted Tam. stp. N52°W 8 Lks - 5.28'

"Local B.T.s"

Tam 4" N43°E 28 Lks - 18.48'

Tam 3" N21 3/4°W 12 Lks - 7.92'

"New B.T.s"

Tam 4" N59°E 6 Lks - 3.96'

NOW LIVING TAM. N59E 4.0' SCRIBE VISIBLE

Tam 4" S74 3/8°E 27 Lks - 17.82'

NOW TAM. WINDFALL

Tam 6" S66°W 21 Lks - 13.86'

NOW LIVING TAM. S66W 13.9' SCRIBE VISIBLE

Tam 10" N26 3/4°W 56 Lks - 36.96'

NOW TAM. WINDFALL

10-31-73 CK

SET 3" X 8" TAM POST - ALONGSIDE CONCRETE MONUMENT
LOCAL BT-IN NOTES BY GLO IS NOW 4" TAM. SNAG
WITH SCRIBE VISIBLE.

TAGGED AND PAINTED LIVE BT'S.

SHOULD COME IN AGAIN AND MARK NEW BT'S.

284 A-23

Sec. 36 - T147N R29W.

Quarter Cor. Sec. 1 - T146N R29W

Iron post 3'x2" w/brass Cap MKD.

Ed. iron cap - in place $\frac{1}{4}$ S 36

12" above ground - in good condition S 1

1984

"Orig. B.T.s"

Dead Spruce, 24" S 40° E 109 LKs

"New B.T.s"

Poplar 10" N 4° E 10 LKs -

Poplar 12" S 19¼° E 78 LKs -

10-31-73 CK-GG

GARY GUSTAFSON

FROM SEC. COR. 35+36 - RAN LINE AT S89E
AND CHAINED 2544' - OUR LINE FELL 45' SOUTH OF COR.
FD. 2" IRON + CAP - IN PLACEBOTH ASPEN ARE ROTTED AWAY - NOW JUST STUMP HOLES
FD. LARGE WELL ROTTED SPRUCE STUMP SHOE - 71.9'
FROM IRONCORNER LOCATED IN BIRCH + ASPEN WITH THICK BRUSH
SMALL GRASS MARSH 150' DIA. IS 40' NW OF CORNER.
RAN NORTH 745' TO FW 20 - PUT FSLP ON 14" BIRCH ON SOUTH
SIDE OF ROAD - SAW MOOSE TRACK IN MUD ON ROAD

C-25 Quarter Cor. Sec's. 1-6

Iron post 3'x2" w/brass Cap. MKD.

12-16-83. CK-GB-JA

Ed. 2" IRON + CAP - IN PLACE

+

8" ABOVE SWAMP

S 1 | S 6

PLACED FSLP ON 8" TAM. SIBE

14.0' FROM IRON

1934

"Orig B.T.s"

rotted Tam. stp. S 34° E 11 LKs - 7.26'

rotted tam. stp. N 35° W 21 LKs - 13.86'

"New B.T.s"

Tam 4" N 73° E 8 LKs - 5.28'

NOW DEAD SNAG 7" TAM. N 73° E 5.3' SCRIBE OVERGROWN

Spruce 6" S 45° W 42 LKs - 27.72'

NOW SPRUCE STUB S 45° W 27.7' SCAR VISIBLE

PLACED FSLP ON 14" BIRCH ON SOUTH SIDE OF FR#2386H

ROAD BRS. NW-SE - 565' SOUTH OF 1/4 CORNER

SEE BOOK 2 Pg. 58

E-Section Cor. Sec. 1-6-12-7
6" dia. 24" Long cyl. Concrete Mon.
w/3 1/2" dia Brass Cap MKD.

12-16-83 CK-GB-JA

Fd. CONCRETE MONUMENT	T 146 N	
6" ABOVE GROUND - CORNER	51	56
15 IN CUTOVER AREA - AT	512	57
EDGE OF SWAMP TO WEST	R 29 W	R 28 W
	19 34	

Spruce 5" N 64 1/2° E 47 LKs - 31.02'

Fd. SPRUCE STUMP AT N 64 E - 31.0' + WINDFALL

Spruce 9" S 72 1/2° E 73 LKs - 48.18'

NO TRACE - PROBABLY UNDER FROZEN SWAMP

Birch 6" S 35 1/4° W 52 LKs - 34.32'

NOTHING FOUND AT THIS TIME AT S 35 W - 34.3'

Tam 5" N 63° W 46 LKs - 30.36'

NOW TAM WINDFALL WELL ROTTED N 63 W - 30.4'

PLACED FSLP ON 9" BALMIE N 76 E - 19.2'

FROM MONUMENT

FSLP ON 14" BIRCH ON SOUTH SIDE OF FR 2386 H

ROAD BR. NW-SE 2076' SOUTH TO SEC. COR.

Quarter Cor. Sec. 12-7
 Iron post 3'x2" w/brass Cap MKD.

$\frac{1}{4}$
 S12 S7

1934

Birch 8" N17 $\frac{1}{4}$ °E 19 LKs- 12.54'

Birch 5" N26°W 11 LKs- 7.26'

North $\frac{1}{4}$ Cor. Sec. 24-19

IRON post 3'x1" w/brass Cap MKD.

9/14/89 GB-CK

Ed. IRON + CAP - IN PLACE

N $\frac{1}{6}$

IN GOOD CONDITION 2" ABOVE

S 24 S 19

GROUND

1934

ELM 9" East 5 LKs - 3.30'

NOW ELM WINDFALL LYING BESIDE IRON

ELM 10" S 9° W 11 $\frac{1}{2}$ LKs - 7.59'

NOW ELM SNAG + WINDFALL

Cabin S.E. Corner N 66 $\frac{1}{2}$ ° W 138 LKs - 9.08'

TIE TO CABIN CHECKED OK

1930 L.W. JOHNSON ITASCA COUNTY SURVEYOR

SET IRON MONUMENT MIDPOINT ON LINE

$\frac{13118}{24119}$ AND $\frac{142419}{}$ (NOTE: THIS IRON IS N 60° W

39.65 FT FROM GLO'S 1934 MONUMENT TO JOHNSON

FD ORIG $\frac{142419}{}$. GLO DID NOT USE OR KNOW

OF JOHNSON'S SURVEY. WE ARE USING JOHNSON'S

SURVEY FOR OUR LINE TO STANDARD (R. MAIN)

1930 B.T.S.

ELM 17° N 37 E

ELM 9" S 48 W 35.00

Z-19-06 R. MAIN

LINE TO STANDARD WEST OF ITASCA COUNTY
IRON G.P.S.E.D IRON

8 FT STEEL SIGN POST 30.7 FT WEST

Quarter Cor. Sec. 24-19
 Iron post 3'x2" w/brass Cap MKD.

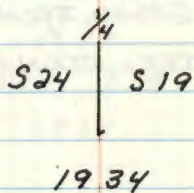

ELM 18" N45°E 34 Lks - 22.44'

ELM 36" S17½°W 19 Lks - 12.54'

SEPT 1875 ORIG GOVT SURVEY BALDWIN
 SET POST AND WITNESS

ELM 50" S60°E 67 Lks 44.22

ELM 8" S35°W 11 Lks 7.26

30. East shore. Sugar. Lake.

Meander Cor. Sec. 24

Iron post 3'x1" w/brass Cap. MKD.

9/14/89 GB-CK

NO IRON FOUND AT THIS TIME

3N	S	N
0	24	
1934		

DIDN'T HAVE LOCATOR WITH

Cedar 7" N17°E 41.14s- 27.06'

NOW CEDAR STUMP AT N17E 27.1'

ELM 16" S59 $\frac{3}{4}$ °E 139.24s- 91.74'

NOW DEAD 20" ELM AT S60E 91.7' - CUT INTO STUMP

AND FOUND SCRIBE S24 S

RAN COMPASS LINE WEST FROM N'16 - LINE FELL NEAR

BT'S. - POSITION IS 1.5' HIGHER THEN LAKE LEVEL

AND 8' FROM WATER EDGE

CABIN IS NE APPROX. 125' PAINTED (WHITE)

2-7-30 J_oW_o JOHNSON ITASCA COUNTY SURVEYOR

PLAT OF GOVT LOT 1 SECTION 24

SET IRON AT SMC. (NOTE^o THIS IRON IS

DIFFERENT FROM THE 1934 GLO IRON. JOHNSON

FD ORIG 1/4 24/19 AND GLO DID NOT USE OR KNOW OF

JOHNSONS SURVEY. WE ARE USING JOHNSONS

SURVEY FOR OUR LINE TO STANDARD. R Main

2-14-06 R MAIN

FD ITASCA CO TRIANGLE SHAPED IRON. EGISED
LINE TO STANDARD EAST OF ITASCA CO IRON.

8 FT STEEL SIGN POST 330.4 FT EAST

31. J-21

Section Cor. Sec. 11-12-14-13

6" dia. 24" Long Cyl. Concrete Mon.

w/3/2 dia Brass Cap MKD.

Fd. concrete cylinder - in place - in good

condition - 4" above grd. T146N R29W

in Tam-Ash swamp

S 11 | S 12

S 14 | S 13

19 34

Orig B.T.s

Tam 10" N30°E 65 Lks - 42.24' ^{90'}

Tam 8" S71°E 62 Lks - 40.92'

Tam snag 8" S62°W 59 Lks - 38.94'

Tam 8" N55°W 61 Lks - 40.26'

"New B.T.s"

Tam 6" N25°E 45 Lks - 29.70'

Fd. Tam. stump NZSE - 29.7' w/ base blaze

Tam 7" S83°E 23 Lks - 15.18'

Fd. Tam. stp. S9E - 15.2'

Tam 5" S55½°W 59 Lks - 38.94'

Fd. 11" Tam. snag SSSW - 39.0' scribe overgrown

Tam 8" N12¾°W 54 Lks - 35.64'

Fd. Tam. snag 13" N13W - 35.6' log under swp.

Set 5" Tam. post beside iron - post is 10' long and stands 7½" high

Put FSLP on 4" Ash N49W 3.2' from iron

Witness trees

Tam. 11" SSSW 39.0'

Ash 5" S15E 22.3'

Put FSLP on 12" Elm 4.55' south of corner on north side of E-W woods road

6-27-73 CRK

32 L-21

Quarter Cor. Sec's. 14-13

Iron post 3'x2" w/ brass Cap MKD

Fd. iron cap - in place

in good condition

12" above ground

in hardwood stand

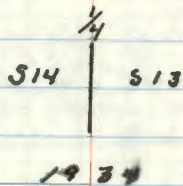

ELM 18" N87E 20LHs - 13.20'

Fd. Elm str. $\frac{1}{4}$ log on ground N87E - 13.2'

ELM 24" S56 $\frac{1}{2}$ W 56LHs - 36.96'

Fd. Elm 22" living S57W - 37.0' w/ scar scribe overgrown

"NOW ELM WINDFALL" w/TAG 11-16-93CK

11-16-93 CK-RM

Fd. IRON CAP IN PLACE

MARKED NEW BT's

MAPLE 13 N57E 8.85' MKD $\frac{1}{4}$ S13 BT

MAPLE 12 S4E 10.95' " " " "

MAPLE 13 WEST 21.85'

MAPLE 9 N40W 56.85'

8' STEEL SIGN POSTS SOUTH 3.25' & NORTH 3.8'

11-2-05 R. MAIN

GPSED IRON, BTs & S POSTS ARE GOOD

Put FSLP on 10" Maple S4E 11.0' from iron
BT Tag on 12" Maple N57E 9.0' from iron

6-22-73 CRK

AREA TO NE-E-SE HAS BEEN CUT OFF
STANDING TIMBER ON PUT LAND - (HAROWOODS)

83 North Shore Sugar Lake.
H-2) Meander Cor. Sec's 14-13
Iron post 3' x 1" w/brass Cap MKD.

Distance from bearing trees T 146 N R 29 W

falls 50' out in Sugar lake

iron is either sunk or gone

no evidence found

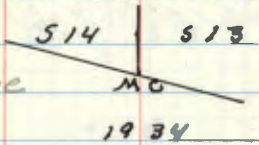

6-22-73 CRK

Maple 8" N 52 1/2° E 112 LKs - 73.92'

Fd. 10" Maple N 52° E - 73.9' w/scar

Maple 7" N 12° W 125 LKs - 82.50'

Fd. 10" Maple N 12° W - 82.5' w/scar

Placed BT Tags on BT's.

Quarter Cor. Sec. 1-12.

Iron post 3'x2" w/brass Cap M.D.

$$\frac{1}{4} \begin{array}{r} 51 \\ \hline 512 \\ 1934 \end{array}$$

Ash 5" S40½°E 34 LHs- 22.44'

Ash 3" N45°W 11 LHs- 7.26'

35 C-21

Quarter Cor. Sec. 2-1

Iron post 3'x2" w/brass Cap MND.

Ed. iron cap - in place $\frac{1}{4}$
in good condition 52 51

10" above ground - in Tam sup.

with heavy under brush 1934

210' south of aspen highland point - 50' south open swp.

Dead Tam 3" S2 $\frac{1}{2}$ E 23 Lhs 15.18'

Ed. Tam. stp. 3" S2E 15.2' no scribe - burned-rotted

Dead tam 3" N75 $\frac{1}{4}$ W 48 $\frac{1}{2}$ Lhs 32.61'

Ed. Tam. stp. 3" N76W - 32.0' no scribe - burned-rotted

Set 4" x 4" x 10' Tam. post beside iron pipe - 7' high
with FSLP on NE side of post

Put BT tags on following witness trees

Tam. 6 N69E 33.3' nail on side - blazed - Painted

Tam. 4 S63E 49.3' " " " "

Tam. 5 S45W 12.0' " " " "

11-25-75 Curtis R. Hauke

Quarter Cor. Sec's 34-35
 Iron post 3'x2" w/brass Cap MKD

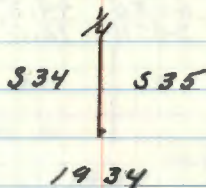

Orig B.T.s

Dead Jack Pine, 10" S 23° E 34 LHs - 22.44'

Jack Pine stump, 8" S 51° W 43 LHs - 29.38'

"New B.T.s"

N. Pine 11" S 71½° E 31 LHs - 20.46'

N. Pine 8" S 33½° W 16 LHs - 10.56'

37 V-17

Section Cor. Sec. 27-26-34-35.
6" dia. 24" Long Cyl. Concrete Mon.
w/ 3 1/2" dia Brass Cap MKD.

	T146N	R29W
Found as described	527	526
	534	535
	1934	

Orig B.T.s.

Stump Hole N37°E 47Lks - 31.02'

N. Pine stub 28" N88°W 155Lks - 102.30'

"New B.T.s"

N. Pine 6" N41°E 6Lks - 3.96'

(Now a 9" N41°E 3.96' scribe visible)

N. Pine 9" S9°E 4Lks - 2.64'

(Now a Pine snag S9°E 2.64' scribe visible)

N. Pine 11" S34 1/2°W 14Lks - 9.24'

(Now a 17" S34 1/2°W 9.24' scribe overgrown)

N. Pine 11" N7 1/2°W 16Lks - 10.56'

(Now a 16" N7 1/2°W 10.56' scribe visible)

V-17

 Hillville
1-17-67
9112

To perpetuate this Corner I rescribed
the South West bearing tree 534 BT.
I scribed one new bearing tree.

N. Pine 21 " 557°E 1.9' scribed 535 BT

E.S. Sign 54-4 on the North East
G.L.O. bearing tree.

7-14-66

James Estatum

38 V-19

Quarter Cor. Sec. 26-35
 Iron post 3'x2" w/brass Cap MKD.
 (Found in place
 marking corner.)

1	S26
4	S35

1934

Burr oak 10" N51½°W 20 Lks 13.20'

(New 13" oak N51½°W 13.2 Feet w/ scribe
 overgrown.) Now 18" 3-31-09

Burr Oak 6" S45¼°W 40 Lks 26.40'

(Now a 9" oak S45¼°W 26.4 Feet w/ scribe
 overgrown) Now 13" 3-31-09

To perpetuate this corner I remarked the two
 Govt. Bts and one new BT.

Govt. Oak 13" N51½°W 13.2 Feet MKD ¼ S26 BT

Govt. Oak 9" S45¼°W 26.4 Feet MKD ¼ S35 BT

Oak 7" S20°E ^{NOW 10"} 3-31-09 4.7 Feet MKD ¼ S35 BT

3-1-63 A.H. McDonald

Steel sign post 72 inches long set 24 inches in
 ground w/ signs 54-2 & 54-4 attached due East
 4.3 Feet. AM

Affidavit RHM

V-19

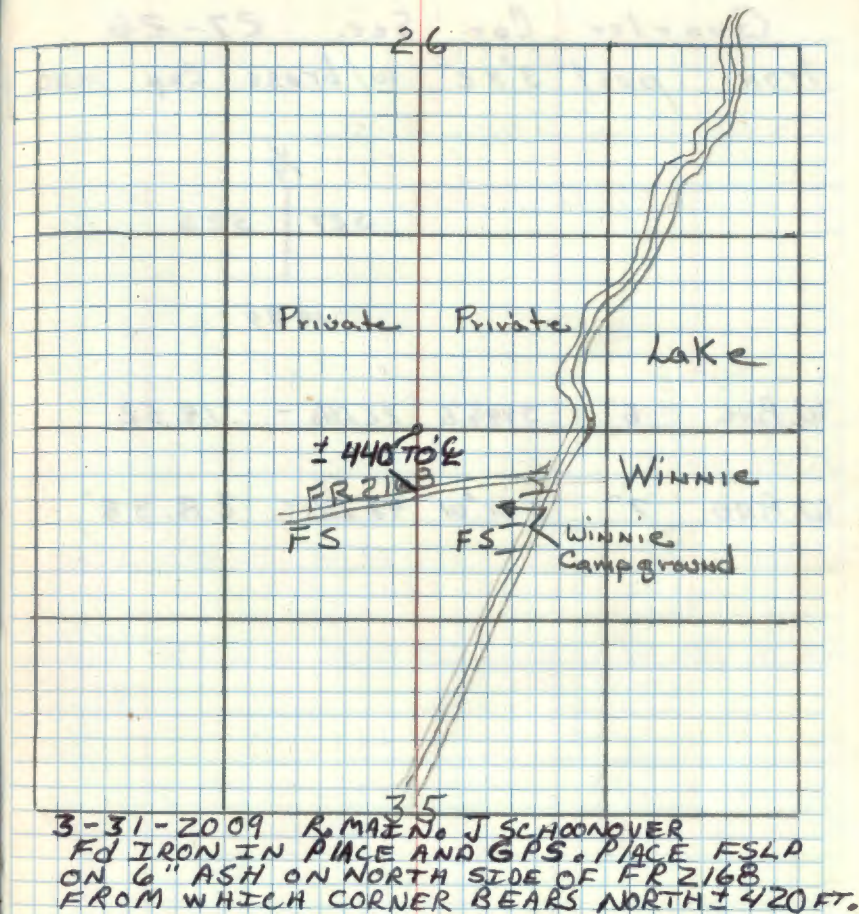

Quarter Cor. Sec. 27-26
 Iron post 3'x2" w/brass Cap MKD.

$\frac{1}{4}$
 527 | 526
 |
 1934

W. Pine. 6" S49 $\frac{1}{2}$ °E 22 LKs - 14.52'

W. Pine 7" S61°W 43 LKs - 28.38'

Section Cor. Sec. 22. 23. 26. 27.
 6" dia. 24" Long cyl. Concrete Mon.
 w/ 3/4" dia. Brass Cap MKD.

T146N	R29W
522	523
527	526
1934	

"Orig B.T.s"

Stump Hole N53°E 28 Lks -
 W. Pine. snag 30" S65°W 80 Lks 52.80'
 rotted. tan. st. N74°W 132 Lks 87.12'

"New B.T.s"

Birch 6" N42°E 51 Lks 33.66'
 R. Oak 5" S77 1/2°E 32 1/2 Lks 21.45'
 Birch 6" S84 1/4°W 17 Lks 11.22'
 Poplar 14" N39 1/2°W 33 Lks 21.28'

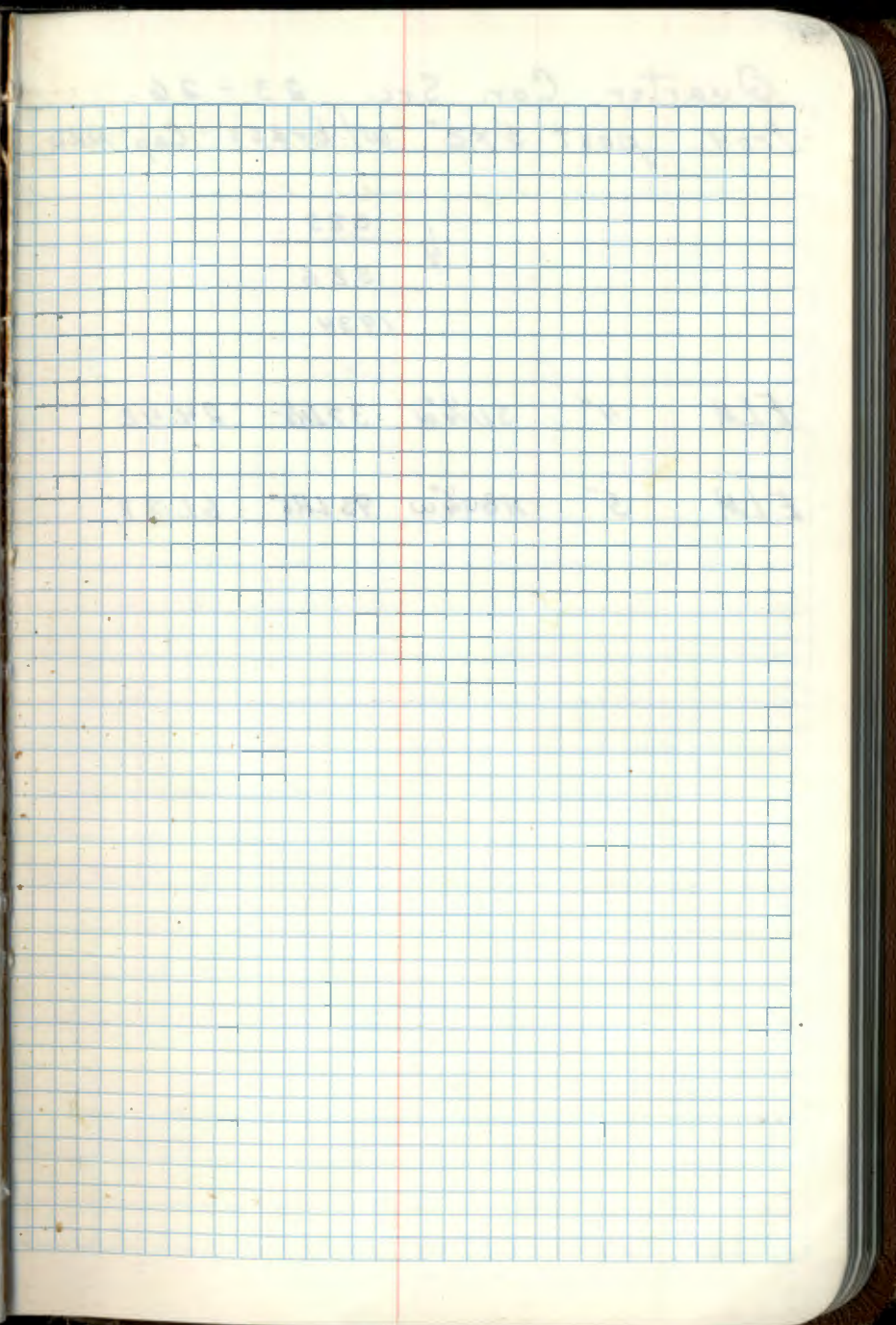

41
Quarter Cor. Sec. 23-26
Iron post 3'x2" w/brass Cap MHD

$\frac{1}{4}$ $\frac{523}{526}$
1934

ELM 4" S11 $\frac{1}{4}$ W 32LKs 24.42'

ELM 5" N80 $\frac{1}{4}$ W 93LKs 61.38'

Meander Cor. Sec.'s 23-26
 Iron post 3'x7" w/brass Cap MKD.

T146N

S23 | MC

S26

R29W

1934

ELM 12" S57 $\frac{1}{2}$ °W 162 LH $\frac{1}{2}$ 106.92'

ELM 14" N63 $\frac{1}{2}$ °W 235 LH $\frac{1}{2}$ 155.10'

Quarter Cor. Sec's 22-23
 Iron post 3' x 2" w/ brass Cap MKD

$\frac{1}{4}$
 S22 S23
 |
 1934

Maple 4" S89°E 11 Lks - 7.26'

W. Oak 14" N30½°W 32 Lks - 21.12'

Section Cor. Sec. 14-15-22-23
 6" dia. 24" Long cyl. Concrete
 Mon w/3/2" dia Brass Cap M4D.
 Ed. 6" CONCRETE MONU. 10/12/89 GB-MEH-CK
 4" ABOVE GROUND - IN HARDWOOD STAND

ON DOWN SLOPE FACING SOUTH T146N R29W

515	514
-----	-----

522	523
-----	-----

19 34

"Orig B.T.s"

Maple 11" N74°E 11 Lks - 7.26'

NOW ROTTEN STUMP N74E 7.3'

^{ROTTEN} Ironwood st. S33 1/2°E 28 Lks - 18.48'

NO TRACE

^{ROTTEN} Red Oak st. 17" N23°W 8 Lks - 5.28'

NOW DEPRESSION AT N23W 5.3'

"New B.T.s"

Ironwood 6" N30°E 57 Lks - 37.62'

NOW HOLLOW + ROTTEN IRON WOOD WINDFALL N30E - 37.6'

Maple 19" S88 1/2°E 19 Lks - 12.54'

NOW 25" W. OAK S88E 12.98' SCAR TO CORNER

Maple 6" S82 1/4°W 68 Lks - 44.88'

NOW 12" MAPLE S82W - 44.8' SCAR TO CORNER

Maple 12" N71 1/4°W 30 Lks - 19.80'

NOW 20" MAPLE N71W 19.8' SCAR TO CORNER

MKD NEW BT

MAPLE 13 S6E 41.6 MKD S23 BT

LOWLAND SWAMP + GRASS MARSH 125' TO SW OF COR.

220' WEST OF LAKE SHORE

South $\frac{1}{6}$ Cor. Sec's 15-14

Iron post 3' x 1" w/brass Cap MKD.

10/12/89 GB-MEN-CK

Fd IRON + CAP - IN PLACE

S $\frac{1}{6}$

IN GOOD CONDITION - 14" ABOVE S15 S14

GROUND - IN THICK MAPLE BRUSH

+ WINDFALLS - BT'S. LATER

35 ON CAP
19 34

Maple 24" N77°E 3 1/4" - 1.98'

NOW ROTTED MAPLE STUMP N77E 20'

Maple 14" N18°W 40 1/4" - 26.40'

NO EVIDENCE AT N18W - 26.4'

FSLP ON MAPLE 17 N71E 23.17' SPK + TAG
CORNER ON DOWN HILL SLOPE

Quarter Cor. Secs 15-14

Iron post 3'x2" w/brass Cap MKD

10/12/89 GB-MEH-CK

FD. 2" IRON CAP - IN PLACE

IN GOOD CONDITION

515 514

10" ABOVE SWP. - IN BRUSH AND

TAM SWP.

1934

"Orig B.T.s"

TAM. snag 6" N28°E 50 LHS 33.00'

TAM. "Fallen" 6" S88°W 62 LHS 40.92'

"New B.T.s"

TAM Snag 5" S42 $\frac{1}{4}$ °E 90 LHS 59.40'

NO TRACE

TAM Snag 6" N15 $\frac{1}{4}$ °W 68 LHS 44.88'

NO TRACE

MKD NEW BT

TAM. S N69E 19.20' MKD 1/4 S14 BT

8' ALUM SIGN POST WEST 5.45' 54-9

" " " SOUTH 5.45' "

" " " NORTH 5.55' "

47 J-17

Section Cor. Sec. 10-11-15-14
6" dia 24" Long Cyl. Concrete Mon
w/3/2" dia Brass Cap MKD.

Fd. concrete cylinder T146N R29W

in place in bog in good S10 S11

condition - Fd. Tam post S15 S14

beside monu - set tall Tam snag 1934

beside monument - no bearing trees near

"No B.T.s"

As accessory to Cor. set a
Tam stake 7' long 5" square
alongside the Monument.

Set 4" x 4" x 5' high tam. post beside iron and placed
FSLP on same - Post is 16" long

Fd. MK iron 191.4' north of Sec. Cor. Fd. Tam, post beside
iron 4' high

6-19-73 CRK

48 J-V9

Quarter Cor. Sec. 11-14
Iron post 3'x2" w/brass Cap MKD.

Fd. iron cap - in place - in good condition

10" above ground - in hardwoods $\frac{1}{4}$ 511

Put FSLP on 13" Maple S28E 514

10.0' from iron 1934

6-21-23 CRK

ELM 8" N44°E 54 LHs 35.64'

Fd. Elm 18" N44E - 35.6' w/scar-scribe overgrown

Maple 6" S41°W 36 LHs 23.76'

Fd. Maple windfall S41W - 23.8'

11-2-05 RMAIN

Fd IRON AND GPS. WITNESS WITH:

(973) MAPLE 17" S25°E 10.6 FT TO SPK

Put FSLP on 20" Elm 830' south of iron on north
side of E-W woods road

49
Section Cox. Sec's 2-3-10-11
6" dia. 24" Long cyl. Concrete
Monument w/ 3/2" dia Brass Cap
MHD.

T146N R29W	
S2	S3
S11	S10
1934	

"Orig B.T.s"

Cedar ^{rotted} stump N40°E 61Ks 3.96'

Cedar ^{Fallen} snag S70°E 33LKs 21.78'

Cedar ^{Fallen} snag S51°W 32LKs 21.12'

Cedar stump N83°W 18LKs 11.88'

"New B.T.s"

Spruce 5" N53 1/2°E 38LKs 25.08'

Spruce 6" S44°E 37LKs 24.42'

Cedar 6" S25 1/2°W 54LKs 35.64'

Spruce 7" N67 1/2°W 21LKs 13.86'

Quarter Cor. Sec. 2-11

Iron post 3'x1" w/brass Cap MKD.

$$\frac{1}{4} \begin{array}{r} 52 \\ \hline \end{array}$$

5 11

1934

Cedar 4" S 24° E 3 1/2 Lks - 2.31'

Cedar 5" N 41° W 15 Lks - 9.90'

51 C-17

Quarter Cor. Sec's 3-2.

Iron post 3'x2" w/brass Cap MKD

Ed. iron $\frac{1}{2}$ cap - 18" above ground $\frac{1}{4}$

in place - in good condition S3 S2

at south edge of Spruce

Swamp E-W 11-24-75 CRK 1934

Spruce 4" S56E 17 LKs 11.22'

Ed. Spruce 6" S56E-11.2' w/scar visible

N. Pine 8" S34 $\frac{1}{2}$ W 31 LKs 20.46'

Ed. N. Pine 18" S34W-20.5' w/scar-scribe overgrown

Put FSLP on 8" BK. Spruce due south 9.0' from iron

52 X-13

South $\frac{1}{6}$ Cor. Sec's 33-34
Iron post 3'x1" w/ brass Cap MKO.

found 1" Dia. iron in place S $\frac{1}{6}$
10" above ground, in good S33 S34
condition - in J. Pine plantation 10-29-74
swamp approx. 125' to east and 1934
170' to north, grass meadow and brush swamp
Dead pine snag 12" S89°E 48 LHs 31.68'
Now down pine snag 12" burned with no scribe
visible, but has flat blaze at S89°E 31.7'

mkd. new bt's.

J. Pine 7" S61°W 30.8' mkd. S'1/16 S33 Bt.
NOW A WINDFALL 10-24-03
J. Pine 8" N5°E 11.5' mkd. S'1/16 S34 Bt.
NOW 30 FT SNAG W/TAG
J. Pine 9" S44°E 36.2' mkd. S'1/16 S34 Bt.
NOW 3 FT STUMP

Put FSLP on 6" J. Pine S65°E 3.8' from iron
30 FT SNAG W/TAG

1988 R. MAEN G. BRAMA

Fd G10 MONUMENT IN GOOD CONDITION
8' ABOVE GROUND.

7" SPINE @ S61W IS STANDING DEAD.

Mkd NEW BT;

W. OAK 11" N39W 33.64 S'1/16 S33 BT
NOW 14" SCRIBE GROWN OVER

CC DONE

STEEL SIGN POST 3.10 NORTH
STEEL SIGN POST 3.88 WEST

10-29-03 R. MAEN

GPSed MONUMENT. MONUMENT IS \pm 5' 30 FT
SOUTH OF BIG FISH ROAD (FR 2167)

53 X-13

Quarter Cor. Sec. 33-34
Iron post 3'x2" w/ brass Cap MKO.

found 2" Dia. iron pipe $\frac{1}{4}$
w/ base in place, leaning north S33 S34
in good condition - set iron in upright position
12" above ground 1934

"Orig B.T.s"

pine stp. 12" S11½°E 95 LKs - 62.70'

found rotted burned J. pine stp. S11°E 62.7' ^{NO}marks

J. Pine ^{Fallen} 16" N52°W 15 LKs - 9.90'

found rotted-burned J. pine stp. N52°W 9.9' w/ flat ^{NO}marks.

"New B.T.s"

J. Pine 8" N54½°E 76 LKs - 50.16'

Now 13" J. Pine N54°E - 50.2' with scribe ¼ S34 Bt.

N. Pine 22" S3°W 310 LKs. 204.30'

Now 27" N. Pine S3°W 204.6' scribe closed, has scar
mkd. new bt's.

J. Pine 10" N24°W 22.0' mkd. ¼ S33 Bt.

J. Pine 11" N44°E 22.0' mkd. ¼ S34 Bt.

J. Pine 7" S53°E 52.8' mkd. ¼ S34 Bt.

Put FSLP on 12" J. Pine S38°W 17.0' from iron

10-29-74

Carlos R. Krause
Dave Morgan

corner is in J. Pine Plantation by CCC's,
iron on side slope approx. 80' east of open
grass meadow

Meander Cor. Sec's 33 - 34
 Iron post 3'x1" w/brass Cap MHD

M C	
S33	S34
T146N	R29W
1934	

"No B.T.s"

As necessary to Corner set
 a 5½' long 6" Sq. alongside
 iron post.

5 V-13

Section Cor. Sec's 28-27-33-34
 6" dia 24" Long Cyl. Concrete
 Monument w/3/4" Brass Cap MKD
 (found in place and marked
 as described)

T146N	R29W
S28	S27
S33	S34
1934	

"Orig B.T.s"

Fallen J. Pine.	12"	N53°E	34 Lks - 22.44'
Fallen J. Pine	12"	S33°E	56 Lks - 36.96'
Pine stump.		S47°W	65 Lks - 42.90'
Fallen Pine.		N48°W	38 Lks - 25.08'

"New B.T.s"

J. Pine	6"	N43 1/2°E	86 Lks - 56.76'
(Now a 12" J. Pine N43 1/2°E 56.76' scribed "T146N R29W")			
N. Pine	20"	S6°E	97 Lks - 64.02'
(Now N. Pine stp. scribed "S34 BT" S6°E 64.02')			
J. Pine	5"	S31°W	41 Lks - 27.06'
(Now 8" J. Pine S31°W 27.06' scribed T146N R29W S32 BT)			
J. Pine	5"	N75°W	7 Lks - 4.62'
(Now a 7" J. Pine N75°W 4.62' Scribed "T146N R29W S28 BT")			

Affidavit RHM
 5680-11 RHM

V-13

Marked one new Bearing Tree
 Jack Pine 10" S18°E 21.8' MKD S34 BT
 NOW A WIND FALL
 The three GLO BTs are in good condition.
 3/26/62 RHM & Donald

1988 R. MAIN G. BRAMA

FD MONUMENT BY GLO IN GOOD CONDITION
 3' ABOVE GROUND. All old BTs ARE
 DEAD.
 NEW BTs;

W. OAK	5"	N5°E	26.34	X BT
R. PINE	6"	N75°E	50.89	S27 BT
W. OAK	6"	S59°E	54.89	S34 BT
J. PINE	9"	S86°W	15.18	T146N R26W S33 BT

STEEL SIGN POST 3.4' NORTH
 PLACED A LOCATION POSTER ON A 7" J. PINE 120'
 SOUTH OF MONUMENT ON THE NORTH SIDE OF ROAD.
 3-31-2009 R. MAIN J. SCHOONOVER
 GPS IRON 1988 J. PINE BT STANDING DEAD.
 ALL OTHER BTs ARE GOOD.

56 Y-15

Center South $\frac{1}{16}$ Cor. Sec. 34.
Iron post 3'x1" w/brass Cap MKD

Found under
road surface.

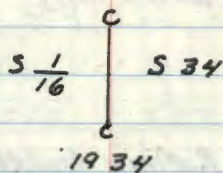

N. Pine 18" N59 $\frac{1}{2}$ ^E 367.14s - 242.22'
(Now a 21" N59 $\frac{1}{2}$ E 242.22' scribed
overgrown)

To perpetuate this corner I
set two new bearing trees

J. Pine 6" N58 $\frac{1}{2}$ W 47.3' Scribed CS# 534BT

NOW 10" J. PINE

J. Pine 10" N31 $\frac{1}{2}$ W 44.4' Scribed CS# 534BT

NOW 13 J. PINE

Cedar Post 4"x4"x60" due North.
24.4' LYING ON GROUND

10-20-65
James E. Brown

+15

17 Affidavit
1-17-67 2ITE

10/21/85 CK JH

Fd: IRON & CAP 8" BELOW ROAD SURFACE

J. Pine 10" N58 $\frac{1}{2}$ W 47.3' SPIKE + NEW TAG
J. Pine 13" N31 $\frac{1}{2}$ W 44.4' Scribe showing SPIKE + NEW TAG ^{SCRIBE VISIBLE}
N. PINE N60 E 242.22' Blaze over grown - spike & tag

3"x8" steel sign post SOUTH 66.95' Rd sign
(set by Contractor Landlines in 1985)

Corner is 30' north of Resort road running E-W
old township road west

line to standard south

CC Done 11/85

57 Y, Z-16

Meander Cor. Sec. 34

South shore of River.

Iron Post 3'x1" w/brass Cap MHO.

Corner falls in mississippi river and bt's
falls at edge of
bank of river there
is no remaining evidence
of iron or bt's.

10-25-74

Curtis R. Krause

J. Pine 6" S15°E 24 LHs- 15.84'

N. Pine 5" S37½°W 26 LHs- 17.16'

Chained north 960' to top of bank at
east edge of resort cabin - drop to river
is approx. 25' and shore of river would
be approx. 980'

2/6/91 Krause & Brama visit site and find river very
low. Resort owner says it is 2½ to 3 ft. low due
to work on Lillian Pam this post fall. At the edge of
the bank they found the Jack pine BT stump with scribe
smc BT visible, tipped face down with the scribbing buried into
the river bottom. Stump was 3½ high, 27" diameter. The
root clump which had been striking in the air, had obviously
been there for many years. The top of the stump had
been chopped off with an ax. A rigorous search was made
for the Norway BT and 660 monument with a metal locator.
Many logs, rails, junk was found but no monument.

From E 1/16 Bet. Sec. 5 3-34
N0°17'E 15.07 chs. (994.62')

January 1989 - USFS contract to Herman Surveying.

Established monuments on the E 1/16 line on the
north & south side of a cabin that encroaches
on Nat. Forest land. Set two 3" x 36" galvanized
iron monuments w/ brass caps, 1 foot above ground stamped

Southerly monument is 913.93' 7140 W RRW
northerly of E 1/16 cor.
Northerly monument is 954.55'
northerly of E 1/16 cor.

5.34
R 1989
ALS 6507

Ties to South monument:

Oak 11" S47°E	38.05'	38.04'
Oak 12" S84°E	35.25'	35.23'
SE cor. cabin N70°E	17.0'	16.91'
SW cor. cabin N67°W	26.1'	26.05'

Ties to North monument:

Jackpine 12" S78°E	44.44'	44.30'
Oak 8" S85°W	41.79'	41.71'
NE cor. cabin S53°E	23.48'	23.42'
NW cor. cabin S68°W	21.90'	21.83'

5/12/89 Brama, Hayes
Recovered the monuments & ties as noted
above. Because of greater hazard of monuments
sticking above ground, we poured them to 1"
below surface by pounding them down.

2/15/89 Hayes, Krause & Brama visit site and search again for monument at
western edge and under ice. We determine that BT was not in place and
traverse to E 1/16 to refine the search area.

2/18/91 Hayes, Krause & Brama search further up the bank for evidence of
where the BT came from. Directly upshore from where BT was set, we
found a depression filled with organic material where we believe BT was. A location
was also set for the Norway BT. Pulling record bearings and distance
from these locations we traverse to the location that I determined
that is the location to perpetuate the 660 smc. We set a
36" x 56" alum. nail w/ alum. cap w/ magnet 3' down river bed.

See Traverse Book

M. Hayes

Quarter Cor. Sec's 28-27

Iron post 3'x2" w/ brass cap MKD

$\frac{1}{4}$
 528 | 527
 1934

Poplar 6" N38 $\frac{1}{4}$ °E 192K5 - 12.54'

Poplar 5" N89°W 182K5 11.88'

59 R-13

Section Cor. Sec's 21-22-28-27
6" dia 24" Long Cyl. Concrete Mon.
w/3/8" Brass Cap MKD.

Ed. concrete cylinder-in place

in good condition - 3" above T146 N R29 W

ground - 10' NW of wood road S21 S22

NE-SW - corner in hardwoods S28 S29

3-3-77 Cont. Island 1934

"Orig B.T.s"

Burr Oak, 10" N4°E 23 LKs - 15.18' Ed OK

Burr. Oak, 14" S69°E 8 LKs - 5.28' Ed. OK

E.M. stp. S40°W 12 LKs - 7.92'

Oak stp. N42°W 12 LKs - 7.92'

"New B.T.s"

Burr, Oak 16" N21½°E 61 LKs 40.26'¹⁹⁹⁰

Ed. Oak stump at brg. dist with all scribe visible Same

Burr, Oak 9" S72½°E 47 LKs 31.02'

Ed. Oak stp. at brg. dist Falls in road clearing¹⁹⁹⁰

Burr, Oak 10" S26¾°W 23½ LKs 15.51

Ed. rotted Oak stump at brg. dist. Falls in road clearing¹⁹⁹⁰W. Oak 23" N40¾°W 50 LKs 33.00'¹⁹⁹⁰

Ed. Oak stump at brg. dist with all scribe visible Same condition

Put FSLP on 6" Maple N43W - 3.0' from monument

set 2" iron wood stake beside corner monument

11/5/90 CKGD

Ed. corner as previously described in 1977.

Ed. orig Burr Oak N4E 15.18' in good condition.

Ed. no evidence of other original BT's.

MKD. New BT's:

W. OAK 12" S50 E 67.47 S27 BT

W. OAK 11" S 1° E 67.35 S27 BT

W. OAK 9" N68°W 89.94 S21 BT

Quarter Cor. Sec's 22 - 27

Iron post 3'x2" w/ brass Cap MIRD

1/4 522

527

1934

Birch 12" S10 1/2° W 39 Lks - 25.74'

Birch 8" N27 1/4° W 14 Lks - 9.24'

384 50%

61 P-13

Quarter Cor Sec's 21-22

Iron post 3'x2" w/brass cap
MKD.

Found 2" iron w/cap $\frac{1}{4}$

in place - in good condition S21 S22

10" above ground

corner on aspen knoll - 25' north 1934

of Tam. Spruce sup. - 3-11-77 Cut knee

Poplar 12" S48 $\frac{3}{4}$ °E 241Ks - 15.84'

Ed. 18" Aspen living at brq. $\frac{1}{2}$ dist w/scar facing iron

Birch 7" S48°W 261Ks - 17.16'

Ed. 13" Birch living at brq. $\frac{1}{2}$ dist. w/scar - scribe visible inside
has center rot at scribe

62 N-13

Section Cor. Sec's. 16-15-21-22

6" dia 24" long Cyl. Concrete Mon.

w/3/2" dia Brass Cap M.M.D.

Ed. concrete cylinder - 3" above ground - in place
in good condition

T146N R29W

Corner in lowland area

S16 S15

with birch-aspens-balsam-cedar S21 S22

tam. spruce-ash - and thick under brush

Tam 9" N46³/₈°E 24 Lts - 15.84'

Tam 8" S56¹/₂°E 8 Lts - 5.28'

Tam 12" S4¹/₂°W 28 Lts - 18.48'

Ed. Tam. stub 30" high well rotted on back side scribe area.
is still very solid all marks visible

Tam 9" N22¹/₂°W 36 Lts - 23.76'

Put FSLP on 12" Cedar due north of monument 10.5'

Put FSLP on 10" Birch 540' north of corner along side

woods trail NW-SE - line blazed, painted to corner

from tag on Birch 3-4-77 Cant Krieger

Note: the other tam BT's. are either gone completely or
well rotted down and under the snow (12" deep now)
will search later in spring

63 N-15

Quarter Cor. Sec's 15-22.

Iron post 3'x2" w/brass Cap MHD.

Found in place marking corner $\frac{1}{4}$ S15

Maple 5' S31 $\frac{1}{2}$ ° 18 Lts - 11.88^{S22}

(Not found)

Birch 5" N25 $\frac{1}{2}$ W 19 Lts - 12.54'

(Now a 10" Birch N25 $\frac{1}{2}$ W 12.54 feet scribed
"1/4 S15 B")

Found the 3'x2" iron post with brass cap

MHD $\frac{1}{4}$ S15 S22 in place marking corner.

To perpetuate this corner I marked
new bearing trees

Maple 8" S44 $\frac{1}{2}$ °E 37.45 feet MKD 1/4 S22 BT

Elm 12" N87°E 44.0 feet MKD 1/4 S15 BT

Elm 6" S68°W 40.45 feet MKD 1/4 S22 BT

3-13-63 A.H. McDonald

Steel sign post 72" long, set 24" in ground
w/ signs 54-2 & 54-4 attached due North
4.15 feet

Affidavit RHM N-15

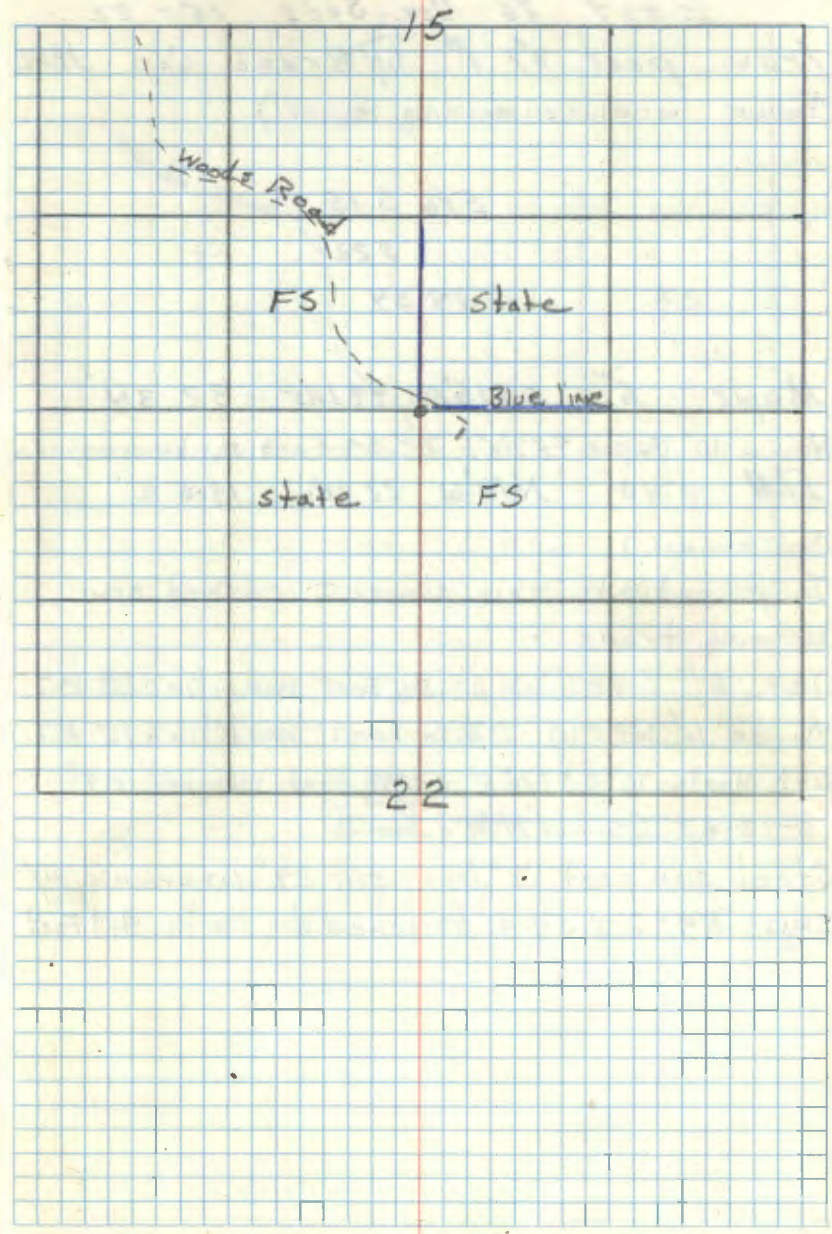

64 N-16

East $\frac{1}{16}$ Cor. Sec's 15-22

Iron post 3×1 " w/ Brass Cap MKD
(Found in place marking corner.)

• E $\frac{1}{16}$ S 15

S 22

1934

Maple 6" S $57\frac{1}{2}^{\circ}$ E 49 Lhs 32.34'

(Now a 10" Maple S $57\frac{1}{2}^{\circ}$ E 32.34 Feet scribe overgrown)

ELM 10" N 14° W 22 Lhs 14.52'

(Not Found)

To perpetuate this corner I marked new
bearing trees

Oak 8" S $68\frac{1}{2}^{\circ}$ W 29.55 Feet MKD E $\frac{1}{16}$ S 22 BT

Maple 6" N 40° W 23.6 Feet MKD E $\frac{1}{16}$ S 15 BT

Gov't. Maple 10" S $57\frac{1}{2}^{\circ}$ E 32.34 Feet rescribed BT

3-13-63 *Robert H. McDonald*

Steel sign post 72" long, set 24" in ground w/
signs 54-2 & 54-4 attached due North 4.1 Feet

Affidavit RHM

N-16

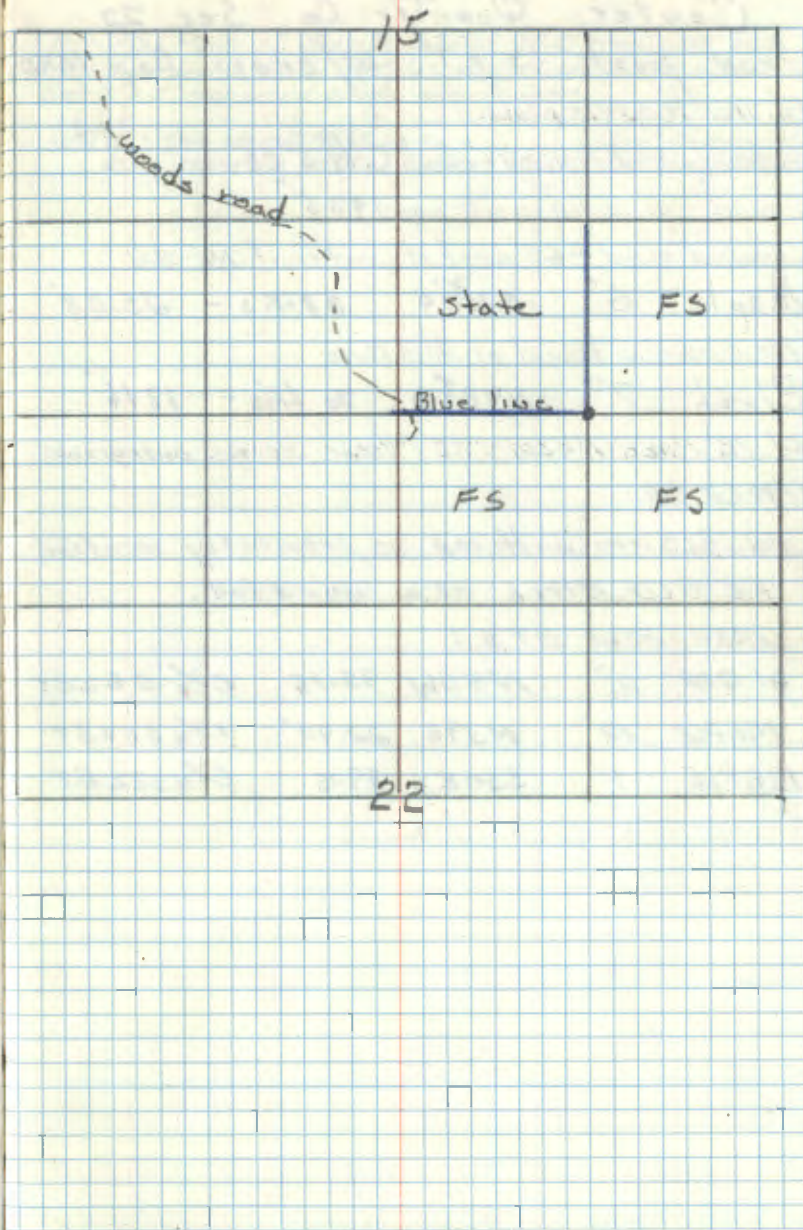

65 P-15

Center Quarter Cor Sec. 22.

Iron post 3' x 1" w/brass cap MKD

Fd. iron cap - in place

in good condition - 12" above C 1/4 S 22

ground - in aspen-birch-maple 1935

basswood stand - 65' west of wood trail NE-SW

Maple 6" 572 1/2' 39 1/2' - 25.08'

No evidence found at this time

Birch 7" N42 1/2' W 26 1/2' - 17.16'

Fd. 12" Birch N42W-17.2' 1/2" scar scribe over grain

1/5/90 CK, GB

Fd. GLO iron with cap as previously mention.

Fd. GLO Birch as a wind fall.

Mkd. New BT's:

W. OAK 11" N40W 95.15 C 1/4 S 22 BT

MAPLE 10" N39E 22.90' C 1/4 S 22 BT

MAPLE 8" S50E 39.15 C 1/4 S 22 BT

Put FSLP on 13" Maple S20W 10.0' from iron pipe
another woods trail N-S is approx 100' west of corner
Set 2" x 5" ironwood stake beside iron

1/5/90 - This corner falls in a ³⁻³⁻⁷⁷ ~~cut~~ ^{cut} ~~block~~ ^{cut} ~~cutting~~ ^{cutting} area.

Quarter Cor. Sec. 16. 15.
Iron post 3'x2" w/ Brass Cap MKD.

(Found in place
buried 12 inches
under Road FR 2171)

Fd. 2" IRON & CAP IN PLACE

15" BELOW ROAD 5-18-84

W. Pine 16" N69½°E 114 Lths - 75.0'
YEARS AGO - BY A CAT
THIS TREE & STUMP HAVE BEEN PUSHED IN WOODS 5-18-84

W. Pine 30" S30½°W 166 Lths - 109.56'

(Now a 31" White Pine with scribe visible
at record bearing & distance.)

NOW W. PINE STUB AT BRG & DIST. SCRIBE VISIBLE 5-18-84

To perpetuate this corner I marked

OAK 6 inch N38½°E 46.7 Feet MKD ¼ S15 BT

Cedar post 4" x 4" x 72" long penta-treated &
with red top set on North side of FR 2171

due north of corner 24.1 feet with signs

59-2 & 59-4 attached. 5-1-63 RHM Daniel

5-18-84 CKJA

MKD NEW BT's.

N. PINE 17 S64W 174.80' MKD ¼ S16 BT

W. OAK 11 N80W 159.30' " " " "

N. PINE 20 N69W 154.50' " " " "

4x4 NORTH 24.1' OK

1963 OAK NOW 9 N38E 46.7 SCRIBE CLOSED
MAY BE TAKEN OUT BY ROAD CLEARING

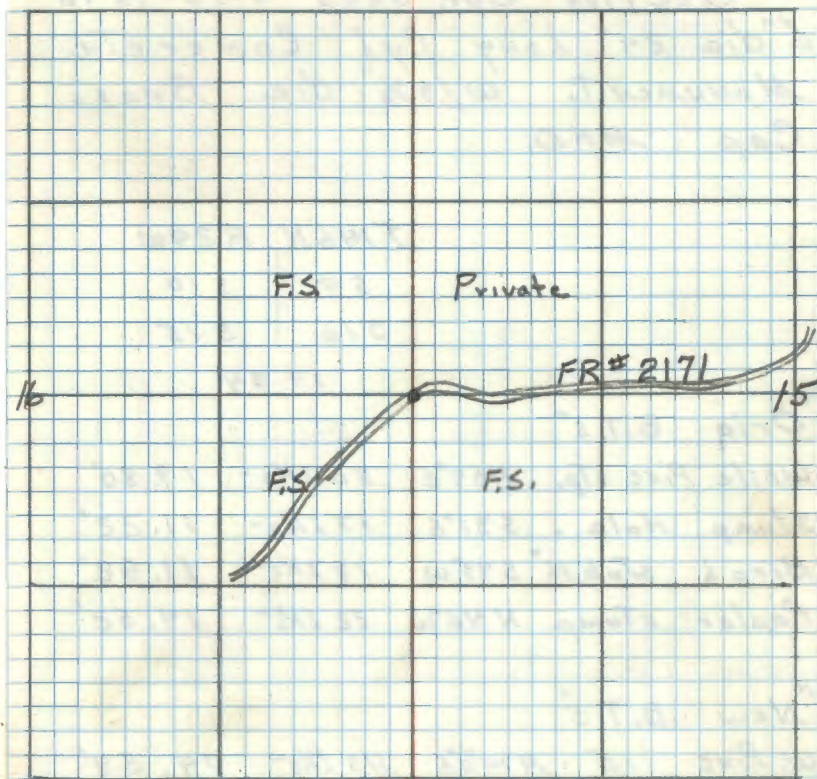

Section Cor. Sec's 9-10-15-16
 6" dia 24" Long Cyl Concrete
 Monument. w/3 1/2" dia. Brass
 Cap M.H.D.

T146N R29W

59 | 510

316 | 515

1934

"Orig B.T.s"

White Pine str. N59°E 30 Lks - 19.80'

Stump Hole. S31°E 17 Lks - 11.22'

Birch stub. 16" S43°W 18 Lks - 11.88'

Poplar stump N46°W 22 Lks - 14.52'

"New B.T.s"

W. Pine 10" N74 1/2°E 113 Lks - 74.58'

N. Pine 11" S31°E 78 Lks - 51.48'

W. Pine 13" S33 3/4°W 33 Lks - 21.78'

Spruce 10" N57 1/2°W 43 Lks - 28.38'

68 J-15

Quarter Cor. Sec's 10-15

Iron post 3'x1" w/brass Cap MKD

Fd good brass cap $\frac{1}{4}$ 510

in place 515

1934

Maple 6" N23°E 24 LH⁶ 15.84'

Fd 11" at record brg dist scribe overgrown

Maple 5" S12½°E 28 LH⁵ 18.48'

Fd stp hole at record brg dist

New B.T.'s;

Maple (G.L.O.) 11" N23°E 158 feet rescribed
 $\frac{1}{4}$ 510

Maple 8" S30°W 32.0 feet scribed 14515BT

Maple 12" N72°W 15.3 feet with sign 544
attached

Affidavit

1-17-67

ONE

J-15

W. Okerman
J. Ekstrom
9-9-67

69 M-15

Center South $\frac{1}{16}$ Cor. Sec. 15
 Iron post 3'x1" w/brass Cap MKD
 (Found in place marking corner.)

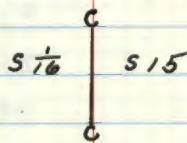

Birch 4" N60°E 15 1/16 - 9.90'

Birch 5" N48 1/2°W 22 1/16 - 14.52

(Now a 9" Birch N48 1/4°W 15.0 Feet scribe overgrown
 blaze facing corner.)

To perpetuate this corner I marked new
 bearing trees.

Maple 6" N49 1/2°E 33.5 Feet MKD CS 1/16 BT

Maple 5" N76 1/2°W 30.2 Feet MKD CS 1/16 BT

Cedar 7" S83°E 112.7 Feet MKD CS 1/16 S15 BT

3-13-63 R.H. McDonald

Steel sign post 72" long, set 24" in ground
 w/ signs 54-2 & 54-4 attached due South 4.7'

Affidavit RHM

M-15

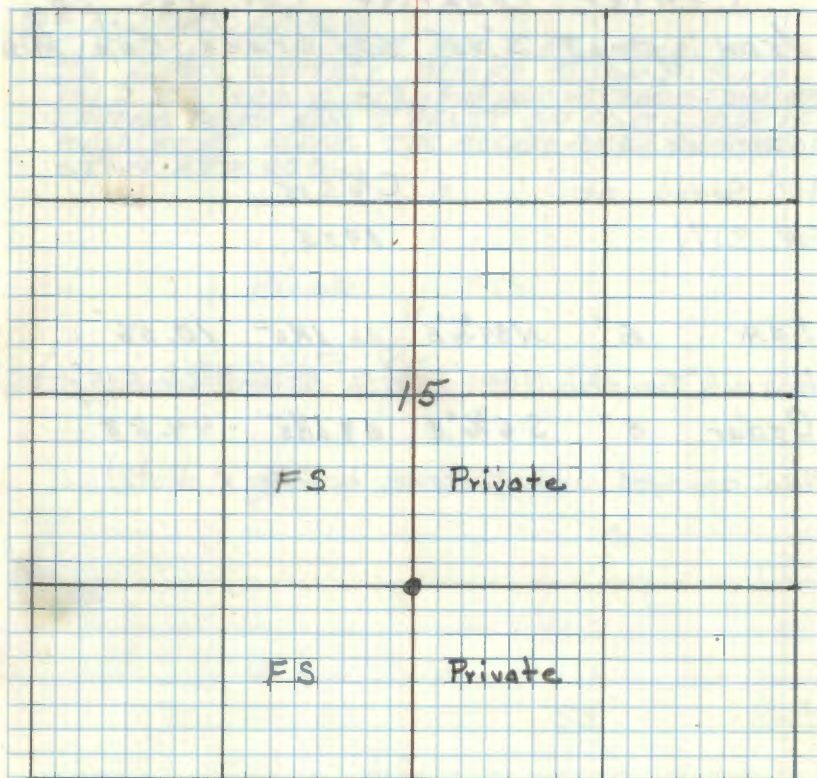

70. h-15

Center Quarter Cor. Sec. 15.

Iron post 3'x1" w/brass cap MKD.
(Found marking corner)

Corner is approx.

400' South of

C¹/₄S15

FR 2171

1935

Tan 6" N84³/₄°E 16.1K5- 10.56'

(Now a 6" Tan stub N84³/₄°E 10.56' scribed "C¹/₄S15")

Cedar 5" S6³/₄°E 68.1K5 44.88'

(Now decayed stump same bearing & dist.)

To perpetuate this corner I marked two
new cedar bearing trees:-

Cedar 9" S1°W 84.8' MKD C¹/₄S15 BT

Cedar 10" S31°W 66.3' MKD C¹/₄S15 BT

3-23-62 R.H.M. Donald

Affidavit RHM
5680-11 RHM

L-15

8-3-2010, RMAIN
FURNISHED IN PLACE AND GPS. CORNER IS
IN GRASS, CATTAIL, ALDER SWAMP. BOTH
1962 B.T.S. ARE GOOD. FOUND STEEL SIGN POST
LAYING DOWN AND I RESET ON SOUTH SIDE OF
MONUMENT ALONG THE EDGE. ONLY MONUMENT
SIGN ATTACHED.

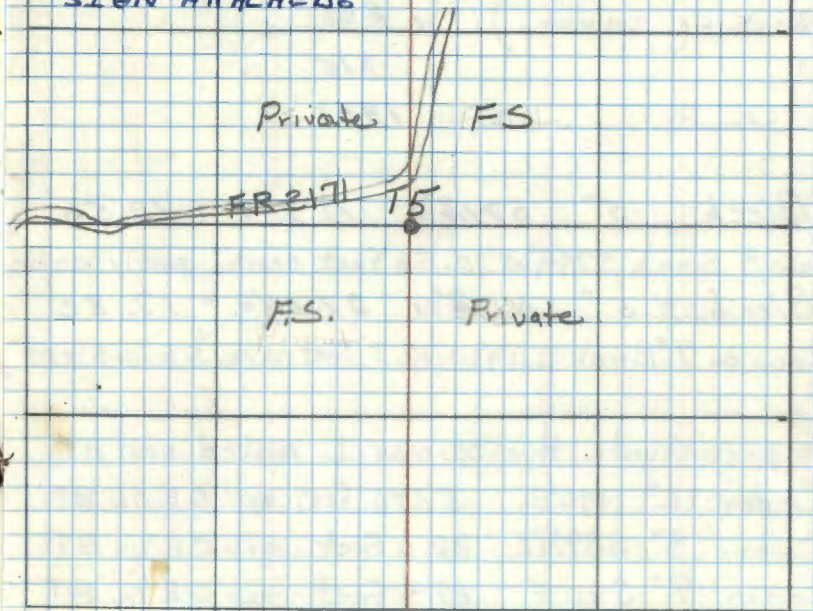

Steel sign post 72" long, set 24" in ground
4/ signs 54-2 & 54-4 attached due south 9.7 feet

21 L-16

Center East $\frac{1}{16}$ Cor. Sec. 15

Iron post 3'x1" w/brass cap

MKD

(Found in place

marking corner.)

C $E\frac{1}{16}$ C

S15

1935

Birch 5" S74 $\frac{1}{2}$ W 16 LHs - 10.56'

(New 8" Birch S74 $\frac{1}{4}$ W 10.56 feet scribe partly visible)

Birch 5" N11 $\frac{1}{2}$ W 27 LHs - 17.82'

(New 7" Birch N11 $\frac{1}{4}$ W 17.9 feet MKD "CE $\frac{1}{16}$ S15 BT")

To perpetuate this corner I marked new BTs

Cedar 12" N46 $\frac{1}{2}$ E 57.95 feet MKD CE $\frac{1}{16}$ BT

Cedar 8" S89 $\frac{1}{2}$ E 32.0 feet MKD CE $\frac{1}{16}$ BT

Cedar 7" S21 $\frac{1}{2}$ E 29.4 feet MKD CE $\frac{1}{16}$ BT

3-13-63 R.H. McDonald

L-16

Affidavit

1-17-67

RHE

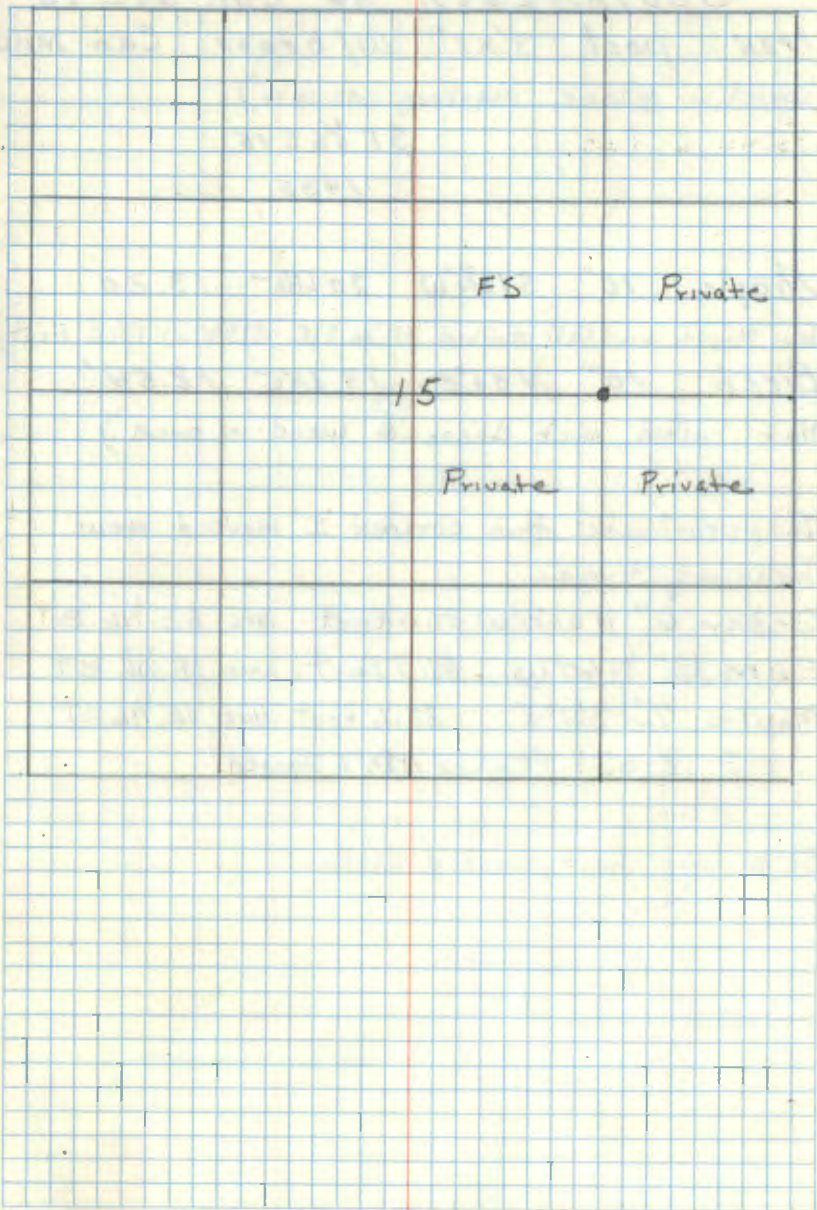

22 M-16

South East $\frac{1}{16}$ Cor. Sec. 15

Iron post 3'x1" w/brass Cap MKD.

(Found in place marking corner.)

SE $\frac{1}{16}$ S 15

1935

Maple 10" S $13\frac{1}{4}^{\circ}$ W 20 Lks - 13.20'

(New Maple wind fall scribed "SE $\frac{1}{16}$ S 15" S $13\frac{1}{4}^{\circ}$ W 13.2 Feet)

Birch 10" N 36° E 19 Lks - 12.54'

(Not found much decayed wood in area)

To perpetuate this corner I marked new bearing trees.

Cedar 6" N $36\frac{1}{2}^{\circ}$ W 39.6 Feet MKD SE $\frac{1}{16}$ BT

ELM 12" N 60° W 51.7 Feet MKD SE $\frac{1}{16}$ BT

Maple 7" S 11° E 32.6 Feet MKD SE $\frac{1}{16}$ BT

3-13-63 Robert H. McDonald

Blue line East, west & South

M-16

Affidavit

1-17-67

ATE

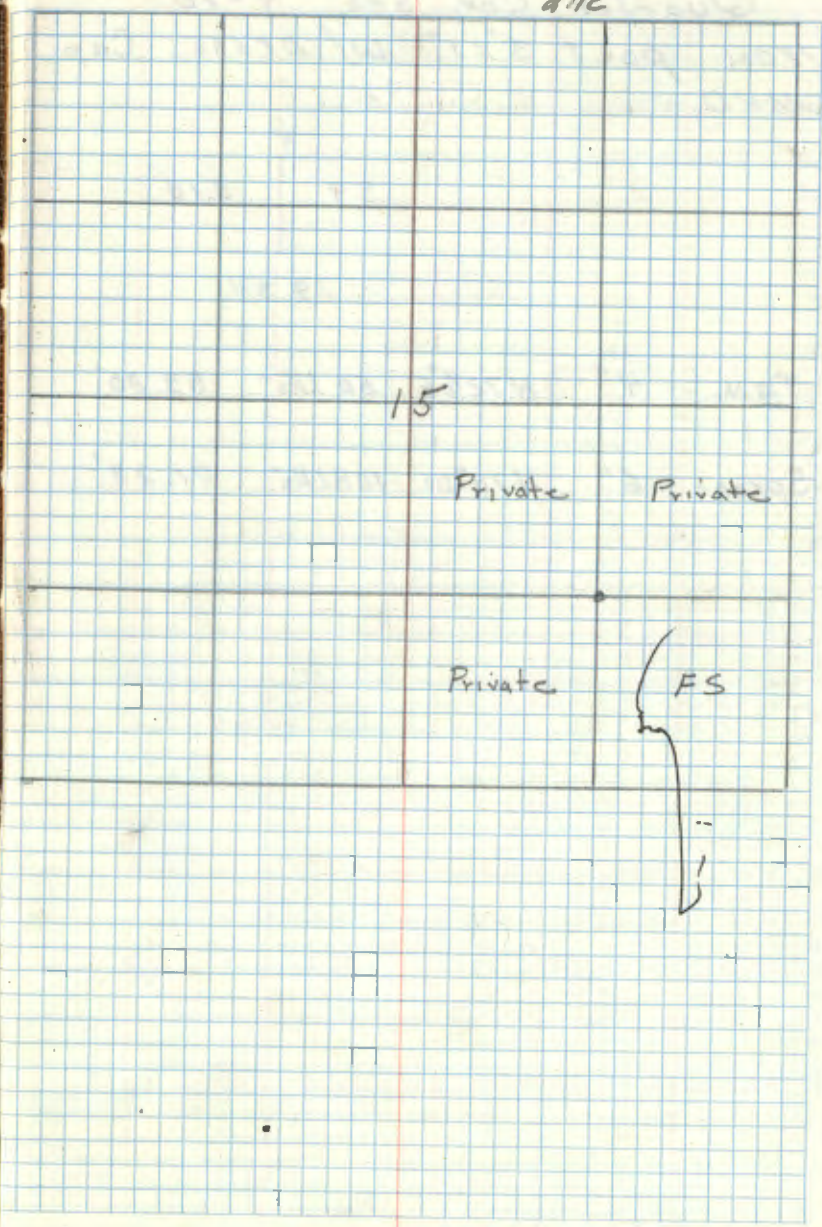

Quarter Cor. Sec. 9-10.
 Iron post 3'x1" w/ brass Cap
 MKD.

$\frac{1}{4}$
 39 310
 |
 19 34

Tan 4" N72 $\frac{1}{2}$ °E 50 LKs- 33.00'

Spruce 6" N78°W 108 LKs- 71.28'

Section Cor. Sec. 3-4-9-10
 6" dia 24" Long cyl Concrete
 Mon. w/ 3 1/2" ϕ Brass Cap MKD.

Fd. IN PLACE

IN TAM. SWAMP

T146N R29W

S4	S3
----	----

S9	S10
----	-----

1934

"Orig B.T.s"

Fallen tam. 6" N34°E 66 Lks - 43.56'

Fallen tam. 4" S54°W 71 Lks - 46.86'

Tam stub. 4" N46°W 12 Lks - 7.92'

"New B.T.s"

Tam 5" N26°E 21 Lks - 13.86'

Fd. TAM. WINDFALL FROZEN IN SWP ^{SCRIBE VISIBLE} N26E 13.86'

Tam 5" S75 1/4°E 31 Lks - 20.46'

Fd. TAM. STUB 7" S75E - 20.46' ^{SCRIBE VISIBLE} WITH NEGATIVE

Tam 4" S18 3/4°W 29 Lks - 19.14'

NOW TAM. WINDFALL FROZEN IN SWP S19W 19.14'

Tam 5" N44 1/4°W 50 Lks - 33.00'

Fd. 7'x7' TAM. STUB N45W 33.0' ^{SCRIBE VISIBLE}

12-15-82 OK-6B

Fd. CONCRETE MONUMENT TIPPED IN SWAMP
 STAND MONUMENT UPRIGHT AND PLACE SHIM
 AROUND MONU. TOP NOW 2" ABOVE SWAMP
 PLACE 2"x2"x8' TAM POST BESIDE MONUMENT

CHAINED FROM 1/4 COR. BET. SECS. 3 & 10

N89W - 26.30'

LINE FELL 18' SOUTH OF MONUMENT - DISTANCE
 WAS OK - W'1/16 EST. ALONG LINE - SHOULD BE
 MOVED NORTH 9' - DISTANCE OK

75 E-15

Quarter Cor. Sec's 3-10

Iron post 3'x2" w/ brass cap
MRD.

Ed. iron cap - lying under swamp grass

very wet and deep in $\frac{1}{4}$ S 3

area of corner - will need S 10

to place iron on long post 1934 4-25-75 CRK

to keep in upright position later - is now in beaver pond

Tam 5" N57 $\frac{1}{2}$ °E 88 LKs - 58.08'

Ed. Tam snag N57E-58.1' w/ scribe visible

Birch 5" S 50°W 36 LKs - 23.76'

Now rotted birch stump at brq $\frac{1}{2}$ dist. ^{MRD - Didn't} FIND

2/6/92 BRAMA

Ed GLO 2" iron pipe with brass cap laying

under swamp grass and ice. Stood iron

up and set brass cap 5" above ice. Found

GLO Tam as a windfall, N57E at 58.1.

Placed 2-8' steel sign post on north and

south side of iron and left them 2'

above ice. Bolted tops together so they

will hold iron in place. Placed wire

under brass cap and wrapped around posts.

Set reference objects:

12' of sign post over lap together N40W, 3.9' } signs

" " " " " " 580E, 4.0' } ATT.

" " " " " " 549W, 4.3' }

CC, Done 1992

Tam snag is 7" Dia. X 20' high mkd 1453 BT
270' east of corner to center of Third River Road N-S
Set 3" X 20' long aspen pole beside iron-ribbon on top
1992 - Corner is out in a flooded area about 90'
north of high ground, 115' west to high grd.
About 14" of water above swamp mat.

Quarter Cor. Sec. 3-4

Iron post 3'x2" w/brass cap MKD

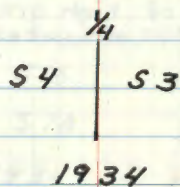

TAM 5" N78°E 118 LKs 77.88'

B.o.P. Gil. 6" N35°W 13 LKs 8.58'

77 V-10

West $\frac{1}{6}$ Cor. Sec's 28-33
IRON post 3'x1" w/brass Cap MKD
Found in place marking corner.

FD. IRON AND CAP W $\frac{1}{6}$ S28

IN PLACE IN GOOD CONDITION 333

10" ABOVE GRD. 11-24-81 1934
CK-68

J. Pine 6" S36°E 26 LHS - 17.16' ^{scribe}
(Now a 10" Jack pine at record bearing and distance visible)

J. Pine 6" N16 $\frac{1}{2}$ °W 17 $\frac{1}{2}$ LHS 11.55'
(Now a 8" Jack pine (dead) at record bearing and distance with scribe visible.)

To perpetuate this corner I marked

Jack pine 12 inch N20°E 22.7 Ft. MKD W $\frac{1}{6}$ S28 BT ^{ALIVE}

Jack pine 12 inch N71°E 9.7 Ft. MKD W $\frac{1}{6}$ S28 BT ^{DEAD}

Jack pine 8 inch S61°W 6.4 Ft MKD W $\frac{1}{6}$ S33 BT ^{ALIVE}

Steel sign post 72" long, set 24" in ground with
FS standard signs 54-2 and 54-9 attached ^{OK}
due north 3.65 feet 8-7-63 ^{ATM} Donald

R. MAINE 9/30/93

FD Monument in good condition. Needs a couple
new BTs. Placed an FSLP on 5" Birch at
gate where road enters put property.
Corner bears south 670 ft from Birch
W/ TAG. This should have been done before

Affidavit RHM

V-10

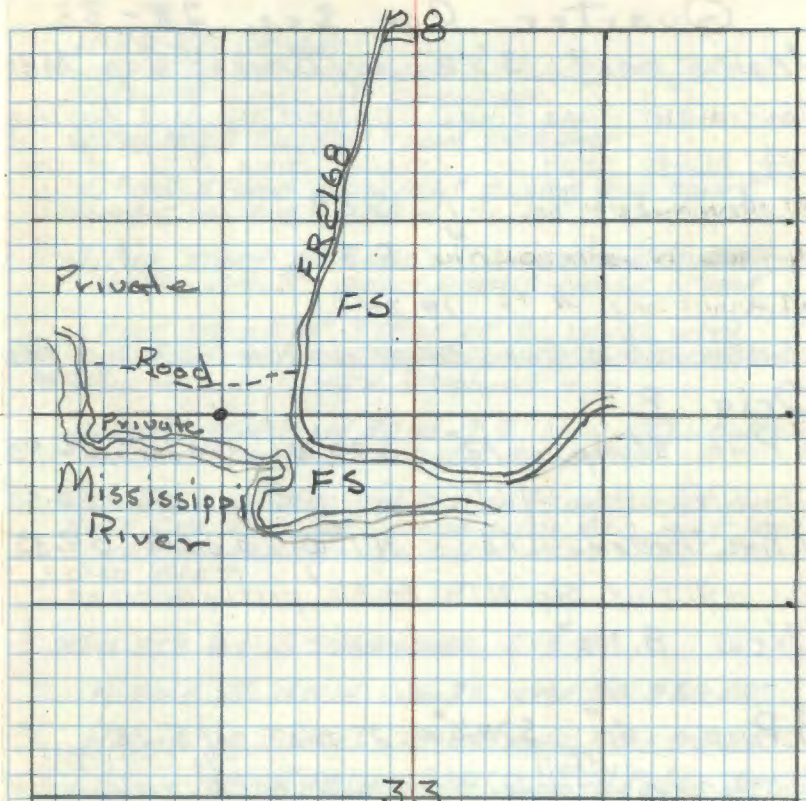

MONUMENT WITNESSED BY:

R. PINE (NEW) 25" S15°E 54.44 Ft ES & MKD W $\frac{1}{6}$ S33 BT

R. PINE (NEW) 14" N23°W 49.13 Ft To Spk. MKD: W $\frac{1}{6}$ S28 BT

J. PINE (1963) 10" S61°W 6.4

J. PINE (1963) 14" N20°E 22.7

8 FT STEEL SIGN POSTS 3.85 WEST & 3.85 NORTH

78 V-11

Quarter Cor. Sec. 28-33.

Iron post 3'x2" w/Brass Cap MKD.
(Monument was found pulled up and laying
8 ft. North west of corner. Area N-E of cor.
is clear-cut of $\frac{1}{4}$ S 28
Timber-Wheelers $\frac{4}{4}$ S 33
Land.) 1934

R.H. McDONALD MUST HAVE RESET IRON IN 1963 FROM TIES
BELOW

Orig B.T.s"

J. Pine stump. 12" S 27°W 40 Lks - 26.40'

(Now a J. Pine stp w/ blaze facing cor. S 27°W 26.40')

J. Pine, Fallen. 16" N 1°W 52 Lks - 34.32'

(Now a J. Pine stp. N 1°W 34.32' partly decayed)

"New B.T.s"

J. Pine. 6" S 78 1/4°W 23 Lks - 15.18'

(Now J. Pine stp. ^{E windfall} S 78 1/4°W 15.18' w/ scribe visible
"1/4 S 33 BT")

J. Pine. 6" N 30°W 12 Lks - 7.92'

(Now stp. hole of decayed wood N 30°W 7.92')

11-24-81 CK-68

FD. 2" DIA IRON AND CAP IN PLACE 12" ABOVE
GROUND - IN GOOD CONDITION

WITNESSES TO IRON FOUND THIS DAY

J. PINE STUMP WITH FLAT BLAZE AND FAINT
SCRIBE VISIBLE S 27°W 26.4'

J. PINE STUMP COVERED WITH DIRT AND GRASS
N 1°W - 34.3' BADLY ROTTED LARGE STUMP

J. PINE STUMP 8" S 78°W 15.2' LEVEL WITH
GROUND - OLD SKID TRAIL NOW CROSSES STUMP
WINDFALL HAS BEEN REMOVED

J. PINE STUMP N 30°W 7.9' NOW WELL ROTTED
AND NO SOLID EVIDENCE REMAINS

DISTANCES WHERE CHAINED EAST AND WEST AND
BOTH CHECKED VERY GOOD WITH GLO PLAT AND
NOTES RECORDED - OUR CHAIN WEST 1324' AND
1320' EAST

NEW BT'S BY J. SCHOONOVER 3-2-81

N. PINE 5 N 11°W 16.72 MKD 1/4 S 28 BT

N. PINE 10 S 52°E 18.33' MKD. 1/4 S 33 BT

N. PINE 12 S 82°W 32.11 MKD 1/4 S 33 BT

8' STEEL POST SET DUE EAST 5.0' BOTH SIGNS
8' STEEL POST SET DUE NORTH 5.0' BOTH SIGNS

CORNER IS 43' NORTH OF 4X4 CEDAR POST AT
NORTH SIDE OF FR # 2168G

79 y-12

East 1/6 Cor. Sec's 28-33.

Iron post 3'x1" w/brass Cap MKD.
(Found in place as described)

Fd. IRON AND CAP E 1/6 S 28

IN PLACE - 10" ABOVE GROUND S 33

IN GOOD CONDITION 1934

NEEDS TIES 11-24-81 CK-GB ALL BT'S HAVE BEEN CUT

J. Pine 7" N 21 1/2° E 18 LKs - 11.88'

(Now a stp N 21 1/2° E 11.88' scribe mks partly visible)

J. Pine 4" S 11 1/4° W 7 LKs - 4.62'

(Now a stp S 11 1/4° W 4.6' scribe mks partly visible)

6/3/86 - CK, GB, JA

Fd. iron & cap set in place. Lowered iron & cap to 3" below ground because of a new cat line going over it. Cat work has destroyed all remaining evidence of 1934 & 1962.

To perpetuate this corner I marked one New BT and set a cedar post

Jack pine 11" S 4° E 18.1' MKD E 1/6 S 33 BT

Cedar post 4" x 4" x 6.0' penta-treated #1 with red top West 1.3' w/signs 54-26 54-4

3-26-62 RHM Donald

Affidavit RHM
5650-11 RHM

y-12

6/3/86 - MKD. New BT'S:
N. Pine 9" N 67° W 68.35' E 1/6 S 28 BT
N. Pine 8" N 37° W 47.2 "
N. Pine 7" N 11° W 45.1 "

8' F.G.S.P. North 3.0' Both signs attached

8' F.G.S.P. West 2.35' " " "

Corner falls approx. 25' South of E-W + rail
C.C. Done 6/4/86

Center Quarter Cor. Sec 33
Iron post 3'x1" w/brass cap
Mkd.

2/13/89 Fd. iron
pipe with brass C 1/4 S 33
cap set in place. 1934
Brass cap set 12" above ground

J. Pine 10" N41 1/2° E 111 Lks - 73.26'
Fd. dead J. Pine snag ^{13"} N41 E 73.26'
J. Pine 8" N87 1/2° W 173 Lks - 114.18'
Fd J. Pine ^{small} 11" N88 W 114.18'

2/13/89 CK-GG
Mkd. New BT'S:
1. JACK PINE 8" S40W 10.85' C 1/4 S 33 BT
2. Norway Pine 7" N44W 16.20' C 1/4 S 33 BT
3 Jack Pine 11" N48E 52.05 C 1/4 S 33 BT

Placed 8' steel sign post south 3.5'
from corner with sign attached

Placed F.S.L.P. on Jack Pine 11"
on south side of road, north 140'
from corner.

IMPROVED TABLES AND INFORMATION

HORIZONTAL STADIA CORRECTIONS					
2°-00'	— 0.1	21°-00'	— 12.8	33°-00'	— 29.7
3°-00'	— 0.3	21°-30'	— 13.4	33°-15'	— 30.1
4°-00'	— 0.5	22°-00'	— 14.0	33°-30'	— 30.5
5°-00'	— 0.8	22°-30'	— 14.7	33°-45'	— 30.9
6°-00'	— 1.1	23°-00'	— 15.3	34°-00'	— 31.3
7°-00'	— 1.5	23°-30'	— 15.9	34°-15'	— 31.7
8°-00'	— 1.9	24°-00'	— 16.5	34°-30'	— 32.1
9°-00'	— 2.5	24°-30'	— 17.2	34°-45'	— 32.5
10°-00'	— 3.0	25°-00'	— 17.9	35°-00'	— 32.9
10°-30'	— 3.3	25°-30'	— 18.6	35°-15'	— 33.3
11°-00'	— 3.6	26°-00'	— 19.2	35°-30'	— 33.7
11°-30'	— 4.0	26°-30'	— 19.9	35°-45'	— 34.1
12°-00'	— 4.3	27°-00'	— 20.6	36°-00'	— 34.6
12°-30'	— 4.7	27°-30'	— 21.3	36°-15'	— 35.0
13°-00'	— 5.1	28°-00'	— 22.0	36°-30'	— 35.4
13°-30'	— 5.5	28°-30'	— 22.8	36°-45'	— 35.8
14°-00'	— 5.9	29°-00'	— 23.5	37°-00'	— 36.2
14°-30'	— 6.3	29°-30'	— 24.3	37°-15'	— 36.6
15°-00'	— 6.7	30°-00'	— 25.0	37°-30'	— 37.1
15°-30'	— 7.2	30°-15'	— 25.4	37°-45'	— 37.5
16°-00'	— 7.6	30°-30'	— 25.8	38°-00'	— 37.9
16°-30'	— 8.1	30°-45'	— 26.2	38°-15'	— 38.3
17°-00'	— 8.5	31°-00'	— 26.5	38°-30'	— 38.7
17°-30'	— 9.0	31°-15'	— 26.9	38°-45'	— 39.1
18°-00'	— 9.5	31°-30'	— 27.3	39°-00'	— 39.6
18°-30'	— 10.1	31°-45'	— 27.7	39°-15'	— 40.0
19°-00'	— 10.6	32°-00'	— 28.1	39°-30'	— 40.5
19°-30'	— 11.2	32°-15'	— 28.5		
20°-00'	— 11.7	32°-30'	— 28.9		
20°-30'	— 12.3	32°-45'	— 29.3		

Chains to Feet

1	66
2	132
3	198
4	264
5	330
6	396
7	462
8	528
9	594
10	660

Feet to Chains

100	1.515
200	3.030
300	4.545
400	6.060
500	7.575
600	9.090
700	10.606
800	12.121
900	13.636
1,000	15.151