

CORNER RESTORATION
T143N R29W

R29
FIELD BOOK

820012

BOOK #1

CORNER RESTORATION T143N R29W BOOK #1

T143N R29W

BOOK #1

USFS, CASS COUNTY, MN

Region _____ Forest _____

T 143

R 29

BOOK #1

Mer.

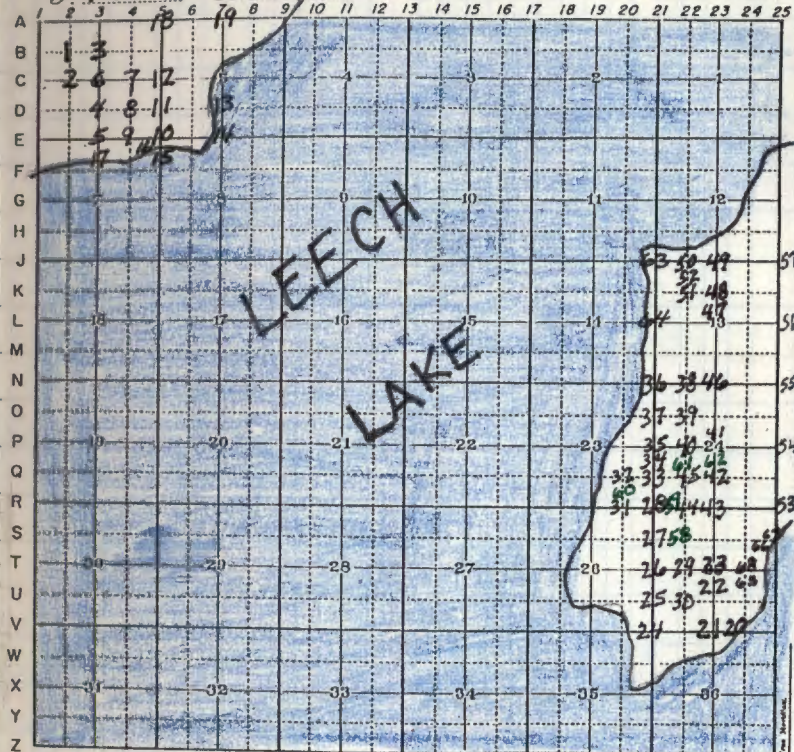

Sec. 11

Sec. 12



T143NR29W

BOOK #1

USFS, CASS COUNTY, MN

Region _____ Forest _____

T 143 R 29 BOOK #1 No.

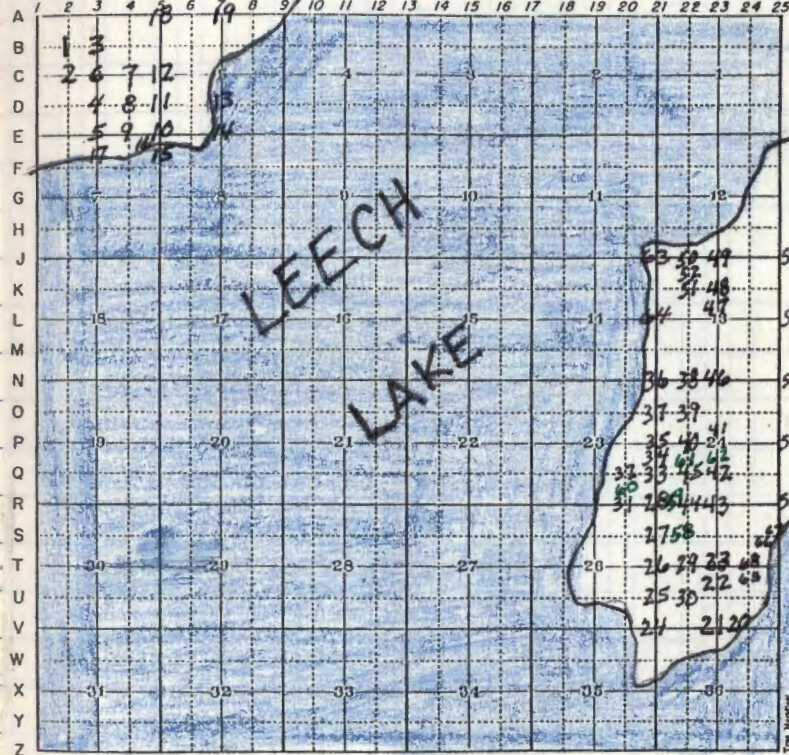

SCALE - One inch = 1 mile.

Sec. 11

Sec. 12



T143N R29W BOOK 1 OF 1

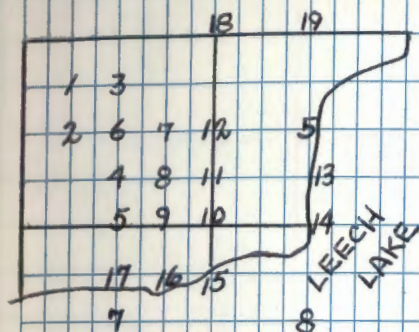

SECTIONS 5, 6, 7, 8 SURVEYED BY
EARL G. HARRINGTON U.S.C.E. 1924

NOTE:

WHEN RUNNING LINES IN THIS AREA - YOU
MAY HAVE TROUBLE WITH BEARINGS WHICH
ARE RECORDED BY GLO RESURVEY
APPEARS THERE MAY BE 3° ERROR IN THESE
SOLAR OBSERVATION AT TIME OF SURVEY 1924
RECORD YOUR FINDINGS WHEN RUNNING
LINES FOR FUTURE REFERENCE

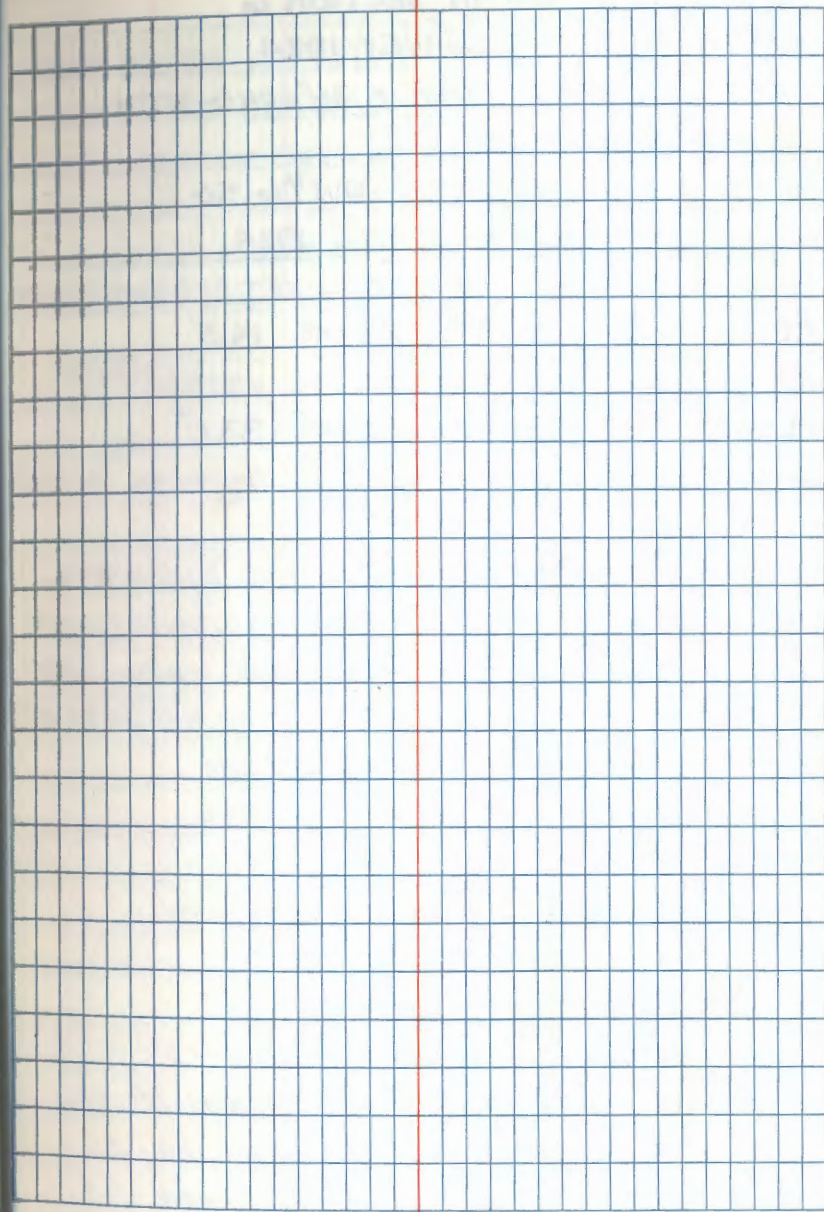

1 B-2

NORTH WEST 1/16 IN SECTION 6

NOTES OF GLO RESURVEY 1924

SET IRON POST 1" DIA. X 36" LONG WITH
BRASS CAP MARKED

FD. IRON AND CAP - IN PLACE NW 1/16 S6

IN GOOD CONDITION - 8" ABOVE GRD. 1924

APPEARS TO BE IN LOW WET POCKET BETWEEN RIDGES

CEDAR 5 N17E 22 LKS. 14.5'

NOW 8" CEDAR ^{LEANS SE} N17E 14.5' SCRIBE VISIBLE ^(OLD FSLP)

CEDAR 8 S1130'W 50 LKS. 33.0'

NOW 10" CEDAR WINDFALL S12W 33.0' SCRIBE ROTTED

TO PERPETUATE THIS CORNER I SCRIBED 3 NEW BT'S.

ASH 14 N56E 48.55' MKD. NW 1/16 S6 BT

ASH 5 N5E 8.87' MKD. NW 1/16 S6 BT

CEDAR 11 N73W 51.73' MKD. NW 1/16 S6 BT

8' STEEL POST NORTH 4.0' BOTH SIGNS

8' STEEL POST EAST 3.9' BOTH SIGNS

2-15-79

Curtis R. Krauss

OK
MEX 2/17/79

6/2/93 RM-CK

VISITED CORNER - EVERY THING IS ALIVE + OK

STANDING WATER NOW AROUND CORNER 12" DEEP

VERY WET SPRING + SUMMER SO FAR - MAY BE

REASON FOR HIGHER WATER LEVEL AROUND COR.

1
FROM CW 1/16 N0°40'W ^{1292.9'} 19.59 CHS. TO NW 1/16

FROM CN 1/16 S88°48'W ^{1316.0'} 19.94 CHS. TO NW 1/16

RAN LINE FROM CN 1/16 AT S89°W AND FELL 50' SOUTH
OF CORNER - RAN LINE BACK TO CN 1/16 AT S89E
AND CAME RIGHT ON IRON (6° DECL.) DISTANCE
CHECK WITH NOTES 1316.0'

CENTER WEST $\frac{1}{16}$ IN SECTION 6
 NOTES OF GLO RESURVEY 1924
 SET IRON POST 1" DIA. X 36" LONG WITH BRASS
 CAP MARKED

C $\frac{W \frac{1}{16} C}{S 6}$
 1924

MAPLE 12 N31°30'E 25 LKS. 16.5'

Fd ROTTED WOOD IN AREA - NO DEFINATE STUMP - LOGGED OVER

MAPLE 8 S75°30'E 59 LKS. 38.9'

NO TRACE AT BRG. + DISTANCE - LOGGED OVER

12-8-1930 874-9 R. Willis

Fd IRON PIPE IN GOOD CONDITION 10" ABOVE
 GROUND. Fd GLO BTS

MAPLE 14' N28W? 13'

MAPLE 9" S80°E 40'

6/8/93 CK MARKED NEW BTS.

MAPLE 12 N11W 39.00' MKD CW $\frac{1}{16}$ S6 BT

MAPLE 15 N28E 85.32' " CW $\frac{1}{16}$ S6 BT

BIRCH 5 NS3E 29.20' " BT

8' STEEL SIGN POSTS EAST 4.1' + WEST 4.05'

6/2/93 RM-CK

RAN LINE AT N89E FROM W $\frac{1}{4}$ SEC. 6 AND MEASURED
 1337' - SEARCH IN AREA - NO MONUMENT OR BTS. FOUND.

RAN LINE N1°W TO NW $\frac{1}{16}$ - OUR LINE FELL 70' WEST
 OF CORNER AND OUR DISTANCE OF 1292.9' FELL 51'
 NORTH OF CORNER - LINE SHOULD HAVE BEEN RUN AT
 N2°E - MY COMPASS HAD 4° DECLINATION AT THIS TIME
 WE HAVE HAD PROBLEMS IN THIS AREA BEFORE.

WALK BACK TO STARTING POINT AND MEASURED 51'
 SOUTH - SEARCH IN AREA WITH LOCATOR AND FOUND
 1" GLO MONUMENT - BENT AND UNDER GROUND - AREA
 WAS LOGGED OVER YEARS AGO - OLD TIMBER LINE E&W
 IS 60' NORTH OF CORNER - SOME OLD BLUE PAINT STILL
 VISIBLE ALONG LINE AND OLD BLAZES ON BIRCH STUBS

6/8/93 CK

DUG UP MONUMENT + STRAIGHTEN - FLANGES ARE RUSTED
 OFF, BUT WERE IN PLACE BELOW MONUMENT - RESET
 1" IRON + CAP - 2" ABOVE GROUND - MADE ROCK RING
 AROUND IRON (14 ROCKS) - CORNER IS IN HEAVY
 MAPLE SAPPLINGS + BRUSH - 20' EAST + NORTH OF
 WOODS ROAD NW-SE TO LEECH LAKE (PVT. HOME)
 PLACE FSLP ON 17" ASH N2E - 245' FROM COR.
 ON SOUTH SIDE OF SUCKER BAY ROAD TO OTTERTAIL
 POINT - TAG IS APPROX. 200' E OF WOODS ROAD SOUTH
 TO PVT. HOME ON LEECH LAKE

3 B-3

CENTERNORTH 1/16 IN SECTION 6

NOTES OF GLO RESURVEY 1924

SET IRON POST 1" DIA. X 36" LONG WITH BRASS
CAP MARKED

Fd. IRON CAP - IN PLACE

IN GOOD CONDITION 10" ABOVE

SWAMP-FROZEN IN ICE

8' STEEL POST WIRED TO IRON

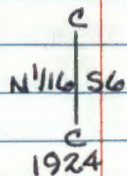

SPRUCE 5 N69E 18 LKS. 11.9'

NOW 10" SPRUCE STUB 36" HIGH N69E 7.3' ^{VISIBLE} SCRIBE INSIDE

TAM. 6 N78W 11 LKS. 7.3'

NOW 8" TAM STUB 5' HIGH N78W-11.9' ^{VISIBLE} SCRIBE INSIDETO PERPETUATE THIS CORNER I SCRIBE 3 NEW
BEARING TREES

CEDAR 9 S48E 65.43' MKD CN 1/16 S6 BT

CEDAR 9 S83E 47.85' MKD CN 1/16 S6 BT

CEDAR 8 N33E 52.90' MKD CN 1/16 S6 BT

SET 8' STEEL POST NORTH 4.2' BOTH SIGNS

SET 8' STEEL POST WEST 5.7' BOTH SIGNS

2-14-79

Curtis R. Krause

LINE TO NW 1/16 SHOULD BE RUN AT N89W (6° DECL.)

FOLLOWED OLD BLAZED LINE IN CEDAR BETWEEN
CORNERS - PAINTED BLUE TODAYOK
MCS
2/17/79

3

PUT FSLP ON

CENTER SOUTH $\frac{1}{16}$ IN SECTION 6

NOTES OF GLO RESURVEY 1924

SET IRON POST 1" DIA. X 36" LONG WITH BRASS
CAP MARKED

c
S $\frac{1}{16}$ | S6
c
1924

POPLAR 6 S67E 44 LKS. 29.0'

POPLAR 7 N39°30'W 2? LKS.

QUARTER CORNER BET. SEC'S. 6-7

NOTES OF GLO RESURVEY 1924

SET AT RECORD DISTANCE - NO ORIGINAL

EVIDENCE FOUND

SET IRON POST 1" DIA. X 36" LONG WITH BRASS

CAP MARKED

$$\frac{1}{4} \frac{56}{57}$$

1924

ASH 7 N36E 26 LKS. 17.2'

ELM 14 S28W 20 LKS. 13.2'

CENTER QUARTER OF SECTION 6

NOTES OF GLO RESURVEY 1924

SET IRON POST 1" DIA. X 36" LONG WITH BRASS
CAP MARKED

C/4.56
1924

BIRCH 4 N45E 52 LKS. 34.3'

BIRCH 6 N64W 92 LKS. 60.7'

12-8-30 874-9 R. Welles

Fd GLO IRON 9" ABOVE GROUND. ALSO GLO
BTS

BIRCH 5" N39°E 33'

BIRCH 8" N70W 65'

NO DATE USFS G.P. JAMNKE CORNER CARD

Fd BRASS CAP IN GOOD CONDITION. TAG ON
LINE ON THE OLD ROAD. NOTE: CORNER CARD
DIAGRAM SHOWS TAG NORTH OF CORNER ON ROAD

CENTER EAST 416 IN SECTION 6

NOTES OF GLO RESURVEY 1924

SET IRON POST 1" DIA. X 36" LONG WITH BRASS
CAP MARKED

C $\frac{E416}{S6}$ C

1924

BIRCH 7 N48°30'E 42 LKS. 27.7'

BIRCH 4 S7W 35 LKS. 23.1'

SOUTHEAST 1/16 IN SECTION 6

NOTES OF GLO RESURVEY 1924

SET IRON POST 1" DIA. X 36" LONG WITH BRASS
CAP MARKED

SE 1/16 S6

1924

POPLAR 5 N61°30'E 38 LKS. 25.1'

POPLAR 7 S31W NO DISTANCE GIVEN

9 EAST 1/16 BET. SEC'S. 6-7

NOTES OF GLO RESURVEY 1924

SET IRON POST 1" DIA. X 36" LONG WITH BRASS
CAP MARKED

E 1/16 $\frac{56}{57}$
1924

NO BT'S,

SET CEDAR POST 5" SQUARD 10' LONG 36"
IN SWAMP - BESIDE IRON POST

9

SECTION CORNER TO SECTIONS 5-6-7-8

NOTES OF GLO RESURVEY 1924

SET BY TWO POINT CONTROL METHOD

NO ORIGINAL EVIDENCE FOUND

SET IRON POST 2" DIA. X 36" LONG WITH BRASS

CAP MARKED

T143N R29W

S6	S5
S7	S8

NO BT'S MKD

1924

SET CEDAR POST 6" SQUARE 10' LONG 36" IN

SWAMP - BESIDE IRON POST

11

SOUTH 1/16 CORNER BET. SEC'S. 5+6

GLO RESURVEY 1924

SET 1" x 3/8" IRON POST WITH BRASS CAP MKD.

S 1/16

S6 | S5

1924

FROM WHICH

MAPLE 7 N 72 E 32 LKS = 21.12'

MAPLE 7 S 77 1/4 W 53 LKS = 34.98'

12

QUARTER CORNER BET. SEC'S. 546

GLO RESURVEY 1924

SET 1" x 36" IRON POST WITH BRASS CAP MKD.

$$\begin{array}{c} \frac{1}{4} \\ 56 \mid 55 \end{array}$$

1924

FROM WHICH

MAPLE 7 S62 $\frac{3}{4}$ E 21 LKS. = 13.86'Y. BIRCH 12 S71 $\frac{1}{2}$ W 82 LKS. = 54.12'

12

SPECIAL MEANDER CORNER IN SEC. 5

GLO RESURVEY 1924

SET 1" X 3/16" IRON POST WITH BRASS CAP MKD.

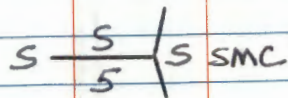

1924

FROM WHICH

ELM 5 S25W 8 LKS. = 5,28'

ASH 7 N7 1/4 W 25 LKS. = 16,50'

FROM S 1/4 BET. SEC'S. 5+6
EAST 26.05 CHS. = 1719.30'
TO SHORE OF LEECH LAKE

MEANDER CORNER BET. SECS. 5+8

GLO RESURVEY 1924

SET 1" X 3/8" IRON POST WITH BRASS CAP MKD.

T743N

$$\frac{55}{58} / MC$$

R29W

1924

FROM WHICH

ELM 18 N7 $\frac{1}{2}$ W 122 LKS. = 80.52'ASH 6 S89 $\frac{1}{2}$ W 229 LKS. = 151.14'

MEANDER CORNER BET. SEC'S. 7 & 8

GLO RESURVEY 1924

SET 1" X 3/16" IRON POST WITH BRASS CAP MKD.

T143N R29W

S7 | S8

MC

1924

NO BT'S.

NORTH AND ALONGSIDE IRON POST

SET 5" SQUARE CEDAR POST

10' LONG AND MARKED STAKE

S7 ON WEST & S8 ON EAST

AND MC ON SOUTH

SPECIAL MEANDER CORNER IN SEC. 7

GLO RESURVEY 1924

SET 1" X 3/16" IRON POST WITH BRASS CAP MKD.

E
 |
 S | 7
 /
 E
 SMC

1924

NO BT'S.

RAISED MOUND OF STONE 24" BASE

1 1/2' HIGH - NORTH OF CORNER

FROM E 1/16 COR. SOUTH 6.36 CHS. 419.76'
 TO SMC ON SHORE OF LEECH LAKE

SPECIAL MEANDER CORNER ON N&S
 CENTER LINE OF SECTION 7
 GLO RESURVEY 1924
 SET 1" X 36" IRON POST WITH BRASS CAP MKD.

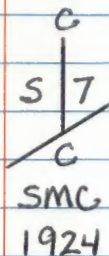

FROM WHICH

ASH 9 N51 $\frac{1}{2}$ W 366 LKS. = 241.56'

NO OTHER SUITABLE

FROM $\frac{1}{4}$ CORNER BET. SEC'S. 6 & 7
 SOUTH 12.70 CHS. = 838.20' TO SMC

SECTION CORNER TO SEC'S. 5-6-31-32

NOTES OF ORIG. GOV'T. SURVEY

SET WOOD POST

CEDAR 14 N88E 20 LKS. 13.2'

FIR 6 N64W 8 LKS. 5.3'

FIR 6 S63W 15 LKS. 9.9'

CEDAR 24 S60E 18 LKS. 11.9'

NOTES OF GLO RESURVEY 1924

SET 2" X 36" IRON POST WITH BRASS CAP MKD.

T144N R29W

S31 | S32

S6 | S5

T143N
1924

POPLAR 7 N41E 140 LKS.

BIRCH 4 S42E 23 LKS.

BIRCH 6 S79W 53 LKS.

POPLAR 6 N49W 39 LKS.

PERPETUATION OF CORNER 1-9-63 JHE

MKD. NEW BT'S. AS FOLLOWS

ELM 7 N68E 30.0'

BALSAM 8 S8E 10.8'

POPLAR 9 S59W 22.1'

STEEL SIGN POST N32W 56.5'

QUARTER CORNER BET. SECS. 5 & 32

PROPORTIONATE DISTANCE

GLO RESURVEY 1924

SET 1" x 36" IRON POST WITH BRASS CAP MKD.

$\frac{1}{4}$ $\frac{S32}{SS}$

1924

FROM WHICH

POPLAR 7 N7 $\frac{3}{4}$ E 52 LKS = 34.32'

BIRCH 6 S32 $\frac{1}{2}$ E 91 LKS = 60.06'

N $\frac{1}{4}$ Sec. 5-143-29

Tags on dead birch - need new BT's

0396123 Brass cap 6" Tall from
5232484 ground

Old Tag from 1942, New Tag 1976

Visited in 88 - 2 BT's found

6" birch dead stub, 12" birch dead stub

Garmin map 76 CSx +/- 20'
66 hits

From C.L. DNR

3/5/08

W.C. MC BET. SEC'S. 25 + 36

NOTES OF GLO RESURVEY 1918

SET 1" x 36" IRON POST WITH CAP TIED

FD. IRON & CAP IN PLACE

18" ABOVE GROUND

T143N R29W

$$\begin{array}{r|l} 525 & \text{WG} \\ 536 & \text{MC} \\ \hline & 1918 \end{array}$$

FROM WHICH

POPLAR 9 S54 $\frac{1}{2}$ W 37 LKS. 24.42'

NO EVIDENCE REMAINS (NEXT TO OUTHOUSE)

MAPLE 15 N18 $\frac{1}{2}$ W 104 LKS. 68.6'

NOW 22 MAPLE N18W 68.6' SCRIBE OVERGROUND

15' N OF EDGE OF WOODS + BALIN

40' N OF SUMMER CABIN (WHITE)

IN BARBED WIRE FENCE LINE (4) STANDS E & W

V-23

21 Quarter Corner Between Sec. 25 & 36

NOTES OF GLO Resurvey 1918

SET 1" x 36" Iron Pipe with Brass Cap marker

Elm 8" S43/4E 43 LK. 28.4' 1/4 ⁵²⁵
still living ₅₃₆
1918

Elm 7" N43/2W 15 LK 9.9'

Wiped out from road

NOTES OF BLM. Dependent Survey 1974

Fd: 1" Iron Pipe with Brass Cap

BT Elm 17" S43/4E 43 LK

Corner is 5 LK. East of gravel road

5/6/85 CK JA GB TF USFS & Cass Co.

Fd: GLO Brass Capped Iron Pipe bent
over - straighten up - to check this
position field checked angles & Dist. s
North and East. OK

BT: Elm 18" S04E 28.4' spk & tags

SET: Reset brass Cap Iron pipe flush with
Surface surrounded by rock ring

BTS:

Norway 6" S43W 90.22 spk "BT"

2" x 2" R3L sq R.F. NON. 560E 25.20 up 1' with rock on

East
5.60

21

Corner falls in East Ditch

18.4 East of E of Sugar Point Road
Co. Rd 136

Fence Line East - 4 strands

NW corner of Battle Point Resort

Closing Corner ON Reestablished Meander
Line on N-5¹⁴ Line

NOTES OF GLO RESURVEY 1921

SET: 1" x 36" Iron Pipe with Brass Cap
Maple 5" N37E 47 LKS marked
W. Oak 8" N71W 28 LKS C

NOTES OF BLM - Dependent Survey 1974 ⁵²⁵ | CC

Fd: Iron pipe with Brass Cap 10" ^C 1921
under gravel surface - Fd two BTS - NO RECORD
Maple 12" N56E 75 LKS 49.5 of them
W. Oak 7" N70W 83 LKS 54.8

5/6/85 CK JA GBT F - USFS & Cess Co.

Fd: GLO Brass capped Iron pipe down 1.5'
BTS recorded in 1974 - wrong species ^{new are} in road
^{TR} Basswood 12" N56E 49.54 } blaze spks
Ironwood 9" N70W 54.68 } overgrown tags

SET BTS:

W. Oak 14" N75E 61.73 "BT" } spks
W. Oaks 10" S74W 66.84 "BT" } tags
W. Oak 13" S36E 67.63 "BT" } red paint

(Fd no evidence of 1921 BTS)

Corner falls in Co Rd 136 2' East of $\frac{1}{4}$

Field checked angles and dists in this area
OK.

Center Quarter of SEC. 25

NOTES OF GLO RESURVEY 1921

SET: 1" x 36" Iron Pipe with Brass Cap
 maple 9" N07W 21 LKs 13.9 ^{marked}
 maple 12" N50E 43 LKs 28.4 C1/4 S25
 1921

NOTES OF BLM DEPENDENT SURVEY 1974

Fd: 1" Iron 6" under gravel surface
 also 1918 BT: stump hole N50E 43 LKs

SET: BTS

Basswood 14" S70W 89 LK 58.74
 Fd OK

Maple 14" N70W 92 LKs 60.72
 Fd OK

5/6/85 CK JA GB TF - USFS & Cass Co.

Fd: Iron pipe down 1 1/2' - left as found

Basswood 18" S70W 58.74 } scribe spks
 Maple 15" N70W 60.72 } overgrown tags

SET: 2" x 2" x 36" sq. mon. over top of Iron
 pipe down 6" in road mark 

BTS:

Maple 13" N68W 130.90 "BT" spk tags
 W. Oak 12 S34W 131.70 "BT" spk tags

Field checked position - dits and angles OK
 no evidence of 1921 BTS - road clearing

Corner falls in center of CO RD 136

T143N R29W

C1/4 - S25

1985

RLS ND

CORNER TO SECTIONS 25-26-35+36

GLO RESURVEY 1918

Fd. POST 4"X4"X24" PROPERLY MARKED

SET 2"X.36" IRON POST WITH BRASS CAP MKD.

T143NR29W

526|525

535|536

1918

FROM WHICH

ASH 5 S45 $\frac{1}{2}$ W 14 Lks. = 9.24'

1974 NOW 15" ASH WITH HEALED BLAZE

R. ELM 7 N51 $\frac{1}{4}$ W 99 Lks. = 65.34'

1974 NOW 18" ELM WITH HEALED BLAZE

MAPLE 20 N30 $\frac{1}{2}$ E 93 Lks. = 61.38'

1974 Fd. STP. HOLE

W. OAK 4 S15E 37 Lks. = 24.42'

1974 Fd. STP. HOLE

GLO RESURVEY 1974

FOUND IRON POST - IN PLACE - 6" ABOVE
GROUND

MARKED NEW BT'S.

ASH 16 N11E 21 $\frac{1}{2}$ Lks. = 14.19'

MAPLE 10 S52E 29 $\frac{1}{2}$ Lks. = 19.47'

25.
SOUTH 1/16 BET SEC'S, 25+26

GLO RESURVEY 1918

SET 1" X 36" IRON POST WITH BRASS CAP MKD.

S 1/16

526 | 525

1918

FROM WHICH

ELM 10 S58 1/2 E 326 LKS. = 215.16'

ASH 7 S34 W 827 LKS. = 545.82'

GLO RESURVEY 1974

NO EVIDENCE OF ABOVE CORNER

REMAINS - NOT MONUMENTED

QUARTER CORNER, BET. SEC'S. 25+26

GLO RESURVEY 1918

PROPORTIONATE DISTANCE

SET 1" X 36" IRON POST WITH BRASS CAP MKD.

$\frac{1}{4}$

S26 | S25

1918

FROM WHICH

POPLAR 8 S69 $\frac{3}{4}$ E 365 LKs. = 240.90'

NO OTHER TREE AVAILABLE

GLO RESURVEY 1974

NO EVIDENCE OF ABOVE CORNER

REMAINS - NOT MONUMENTED

NORTH $\frac{1}{16}$ BET SEC'S. 25+26

GLO RESURVEY 1918

SET 1" x 36" IRON POST WITH BRASS CAP MKD.

N $\frac{1}{16}$

526 | 525

1918

FROM WHICH

POPLAR 6 N72 $\frac{1}{2}$ E 26 LKS. 17.16'

NO EVIDENCE FOUND OF THIS TREE IN 1974

BIRCH 4 N80W 7 LKS. = 4.62'

1974 NOW 7" BIRCH WITH SCRIBE INSIDE SCAR

GLO RESURVEY 1974

FOUND IRON POST - IN PLACE - 8" ABOVE

GROUND

MARKED NEW BT

PINE 6 S39E 20 $\frac{1}{2}$ LKS. = 13.53'

CORNER TO SECTIONS 23-24-25 & 26

GLO RESURVEY 1918

PROPORTIONAL DISTANCE

SET 2" X 36" IRON POST WITH BRASS CAP MKD.

T143NR29W

S23	S24
S26	S25

1918

FROM WHICH

BASSWOOD 12 N46E 30 LKS. = 19.80'

ELM 6 S74E 81 LKS. = 53.46'

POPLAR 6 S12W 58 LKS. = 38.28'

POPLAR 6 N79¹⁵'W 20 LKS. 13.20'

GLO RESURVEY 1974

NO EVIDENCE REMAINS OF CORNER

SET BY KIMMELL IN 1918

SET 9/16" DIA. X 30" LONG STEEL ROD ¹/₄" CAP MKD

T143NR29W

S23	S24
S26	S25

1974

FROM WHICH

1974 BT'S.

BIRCH 10 N28³/₄E 131 LKS. = 86.46'
GONEPOPLAR 10 S31E 81 LKS. = 53.46'
FALLS IN POWER LINE CLEARINGIRON POST 2¹/₂" X 30" S10W - 81 LKS. ~~53.46~~
40.26ELM 8 N25W 81 LKS. = 53.46'
FALLS IN RD CLEARING

CORNER FALLS IN E+W ROAD

CAP IS 8" BELOW ROAD

3-18-02 R. MAIN

FD PK NAIL ON SOUTH EDGE OF BLACKTOP County
RD # 73. PK IS 8" FROM BLACKTOP EDGE. FD TIE
FOLLOWING & TIES ORIGIN UNKNOWN.(1974)
2" PIPE W/ 3" CAP UP 2 FT. S22°W 40.3 FT (BLM)
DIST STANDARD ON CAP

POWER POLE S44°W 49.3 FT TO SPK SCRIBED

ASH 7" N18W 74.23 FT TO SPK SCRIBED

ASH 9" N34E 80.26 FT TO SPK SCRIBED

THERE IS A HEAVY STEEL SIGN POST ON THE SOUTH SIDE
OF BLM MONUMENT UP 3 FT. ALL DIST ARE SLOPE

CENTER WEST $\frac{1}{16}$ TO SECTION 25

GLO RESURVEY 1918

SET 1" X 36" IRON POST WITH BRASS CAP MKD.

C $\frac{W \frac{1}{16}}{S 25}$ C

1918

FROM WHICH

ASH 6 N88E 42 LKS. = 27.72'

POPLAR 10 S34 $\frac{3}{4}$ E 53 LKS. = 34.98'

GLO RESURVEY 1974

FOUND 1918 IRON POST - IN PLACE

10" ABOVE GROUND

ABOVE BT'S. ARE GONE IN 1974

NONE AVAILABLE WITHIN REASONABLE
DISTANCE

SOUTHWEST $\frac{1}{16}$ TO SECTION 26

GLO RESURVEY 1918

SET 1" X 36" IRON POST WITH BRASS CAP MKD.

SW $\frac{1}{16}$ S25

~~1921~~

1921

FROM WHICH

MAPLE 8 N $47^{\circ}14'$ W 37 LKS. = 24.42'

OAK 20 S $27^{\circ}14'$ E 61 LKS. = 40.26'

EAST $1/16$ BET. SEC'S. 23+26

GLO RESURVEY 1918

SET 1" X 36" IRON POST WITH BRASS CAP MKD.

E $1/16$ $\frac{523}{526}$

1918

FROM WHICH

ELM 28 S $42\frac{1}{2}$ W 26 LKS. = 17.16'

BASSWOOD 8 N $48\frac{1}{4}$ E 34 LKS. = 22.44'

32

SOUTHEAST 1/16 IN SECTION 23

GLO RESURVEY 1918

SET 1" X 3/8" IRON POST WITH BRASS CAP MKD.

SE 1/16 S23

1918

FROM WHICH

POPLAR 6 S60W 4 LKS. = 2164'

BIRCH 6 N27 1/2 E 39 LKS. = 25.74'

32

33 SOUTH 1/16 BET. SEC'S. 23+24

GLO RESURVEY 1918

SET 1" X 3/8" IRON POST WITH BRASS CAP MKD.

S 1/16

S23 | S24

1918

FROM WHICH

SPRUCE 4 N58 1/2 E 5 LKS = 3.30'

SPRUCE 4 N49 W 7 LKS = 4.62'

GLO RESURVEY 1974

NO EVIDENCE OF BTS BY KIMMELL

1918 - FOUND 1918 MONUMENT - IN PLACE

CAP 10" ABOVE GROUND

NO BTS. CLOSE BY TO MARK

ANGLE PT#2 T.R. 1427 + ANGLE PT.#3

TR 1428 BET. SEC'S. 23+24

SET 1" x 36" IRON POST WITH BRASS CAP MKD.

	TR
	1428
TR	AP3
1413	AP2
	TR
	1427

1918

NO BT'S.

QUARTER CORNER. BET. SEC'S. 23+24

GLO RESURVEY 1918

PROPORTIONAL DISTANCE

SET 1" X 36" IRON POST WITH BRASS CAP MKD.

$\frac{1}{4}$
 S23 | S24
 1918

FROM WHICH

ASH 6 N14 $\frac{1}{4}$ W 40 LKS. = 26.40'

ASH 4 S27 $\frac{1}{4}$ E 45 LKS. = 29.70'

CORNER TO SECTIONS 13-14-23-24

GLO RESURVEY 1918

PROPORTIONATE POSITION

SET 2" X 36" IRON POST WITH BRASS CAP MKD,

T143NR29W

S14	S13
S23	S24

1918

FROM WHICH

RAISED MOUND OF STONE 24" BASE - 1 1/2' HIGH

WEST OF IRON 3.0'

NORTH 1/16 BET. SEC'S. 23+24
 GLO RESURVEY 1918
 SET 1" X 36" IRON POST WITH BRASS CAP MKD.

N 1/16

S23 | S24

1918

FROM WHICH

ELM 12 S68W 13 LKS = 8.58'

SAMPLE 10 S16 1/2 E 26 LKS = 17.16'

338 WEST 1/16 BET. SEC'S. 13+24

GLO RESURVEY 1918

SET 1" X 3/16" IRON POST WITH BRASS CAP MKD

W 1/16 $\frac{513}{524}$

1918

FROM WHICH

MAPLE 14 S48E 37 LKS = 24.42'

MAPLE 8 N61'41"W 63 LKS = 41.58'

NORTHWEST $\frac{1}{16}$ ^{IN} ~~BE~~ SEC. 24

GLO RESURVEY 1918

SET 1" X 36" IRON POST WITH BRASS CAP AND

NW $\frac{1}{16}$ S 24

1918

FROM WHICH

W. ASH 8 S $80\frac{3}{4}$ W 24 LKS. = 15.84'

BLK. ASH 15 S $25\frac{1}{2}$ E 25 LKS. = 16.50'

CENTER WEST $\frac{1}{16}$ IN SECTION 24

GLO RESURVEY 1918

SET 1" X 36" IRON POST WITH BRASS CAP MKD.

$$C \frac{W \frac{1}{16}}{524} C$$

1918

FROM WHICH

POPLAR 8 S12W 37 LKS. = 24.42'

ASH 4 N41 $\frac{3}{4}$ E 25 LKS. = 16.50'

41
CENTER QUARTER OF SECTION 24
GLO RESURVEY 1918
SET 1" X 3/8" IRON POST WITH BRASS CAP MKD.

C¹/₄ S24

1918

FROM WHICH

W. OAK 12 S43¹/₂E 20 LKS. = 13.20'

POPLAR 12 S41¹/₂W 27 LKS. = 17.82'

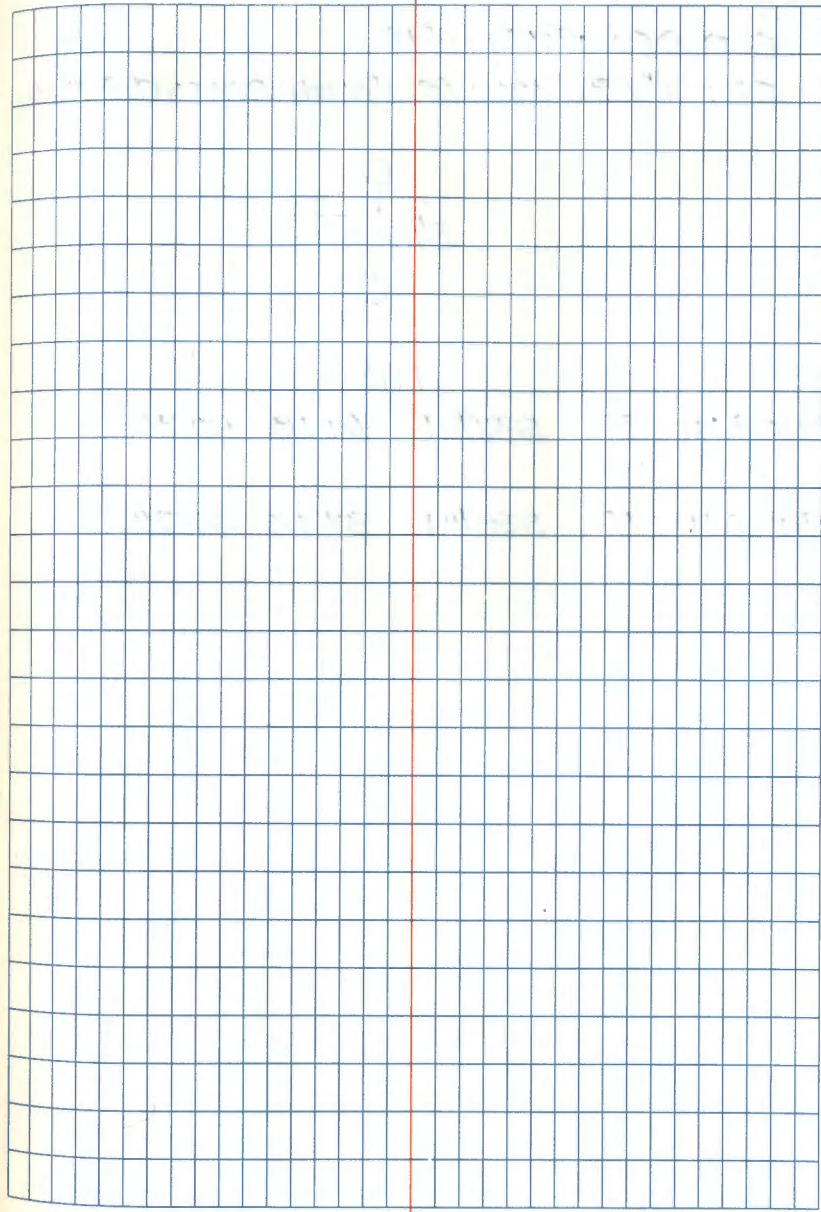

CENTER SOUTH $\frac{1}{16}$ IN SECTION 24

GLO RE SURVEY 1918

SET 1" X 36" IRON POST WITH BRASS CAP MKD.

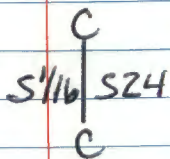

1918

BLK. ASH 7 S $32\frac{1}{2}$ E 61 LKS = 40.26'

BLK. ASH 5 S $50\frac{1}{4}$ W 33 LKS = 21.78'

43

QUARTER CORNER BET. SEC'S. ~~24 & 25~~ 24 & 25

GLO RESURVEY 1918

SET 1" X 36" IRON POST WITH BRASS CAP MKD.

$$\frac{1}{4} \frac{S24}{S25}$$

1918

FROM WHICH

ELM 7 N19 $\frac{1}{2}$ E 24 LKS = 15.84'ASH 14 S72 $\frac{3}{4}$ E 51 LKS = 33.66'

GLO RESURVEY 1974

NO EVIDENCE REMAINS OF CORNER

SET BY KIMMELL 1918

SET 9/16" X 30" LONG STEEL ROD w/ CAP MKD

T143N R29W

$$\frac{1}{4} \frac{S24}{S25}$$

1974

IRON POST 2 $\frac{1}{2}$ " X 30 S47E 67 $\frac{1}{2}$ LKS = 44.55'

MAPLE 6 N30W 70 LKS = 46.20'

44 WEST 1/16 BET SEC'S. 24 + 25
GLO RESURVEY 1918
SET 1" X 3/8" IRON POST WITH BRASS CAP MKD.

W 1/16 $\frac{S24}{S25}$
1918

FROM WHICH

MAPLE 10 N22W 45 LKS. = 29.70'

MAPLE 5 S36 1/2 W 46 LKS. = 30.36'

GLO RESURVEY 1974

NO EVIDENCE REMAINS OF ABOVE
CORNER - NOT MONUMENTED

SOUTHWEST 1/16 IN SECTION 24

GLO RESURVEY 1918

SET 1" X 3/16" IRON POST WITH BRASS CAP MKD.

SW 1/16 S24

1918

FROM WHICH

ELM 14 S70W 13 LKS. = 8.58'

W. ASH 8 S60E 17 LKS. = 11.72'

QUARTER CORNER BET. SEC'S. 13 + 24

GLO RESURVEY 1918

PROPORTIONATE DISTANCE

SET 1" X 36" IRON POST WITH BRASS CAP MKD.

$$\frac{1}{4} \frac{513}{524}$$

1918

FROM WHICH

CEDAR 10 S50 $\frac{1}{4}$ E 124 LKS. = 81.84'

ROPLAR 6 N59 $\frac{3}{4}$ E 35 LKS. = 23.10'

47
CENTER QUARTER TO SECTION 13

GLO RESURVEY 1918

SET 1" X 3/8" IRON POST WITH BRASS CAP MKD

C/4 513

1918

FROM WHICH

MAPLE 6 N48E 2 LKS. = 1.32'

MAPLE 5 S88 1/2 W 39 LKS. = 25.74'

CENTER NORTH $\frac{1}{16}$ CORNER IN SEC. 13

GLO RESURVEY 1918

SET 1" X 36" IRON POST WITH BRASS CAP MKD

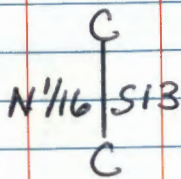

1918

FROM WHICH

OAK 5 N6W 10 LKS. = 6.60'

MAPLE 15 S57 $\frac{1}{2}$ E 39 LKS. = 25.74'

49 QUARTER CORNER BET. SEC'S. 12 & 13

GLO RESURVEY 1918

PROPORTIONATE DISTANCE

SET 1" X 3/8" IRON POST WITH BRASS CAP MKO

$$\frac{1}{4} \frac{S12}{S13}$$

1918

FROM WHICH

MAPLE 26 S28³/₄E 25 LKS. 16.50'

MAPLE 10 N52W 65 LKS. = 42.90'

50 WEST 1/16 CORNER BET. SEC'S. 12 & 13

GLOBE SURVEY 1918

SET 1" X 3/8" IRON POST WITH BRASS CAP MKD.

W 1/16 $\frac{S12}{S13}$

1918

FROM WHICH

ASH 16 N44E 8 LKS. = 5.28'

CEDAR 12 S47E 34 LKS. = 22.44'

51 NORTHWEST 1/16 IN SEC. 13

GLO RESURVEY 1918

SET 1" X 3/8" IRON POST WITH BRASS CAP MKD

NW 1/16 S13

1918

FROM WHICH

CEDAR 14 N 51 1/2 W 27 LKs. = 17.82'

CEDAR 12 S 72 E 45 LKs. = 29.70'

ANGLE POINT 1 TR1377 & ANGLE POINT 4

TR 1560

GLO RESURVEY 1918

SET 1" X 3/8" IRON POST WITH BRASS CAP MKD.

TR 1560	
AP 4	TR
AP 1	1230
TR 1377	

1918

NO BT'S.

53 EAST RANGE LINE
CORNER TO SECTIONS 19-24-25+30

GLO RESURVEY 1918

SET 2" X 36" IRON POST WITH BRASS CAP MKD.

T143N	
S24	S19
S25	S30
R29W	R28W

FROM WHICH

1918

S. MAPLE 12 S24 $\frac{1}{2}$ E 11 LKS. = 7.26'

BALSAM 7 N79 $\frac{1}{2}$ E 10 LKS. = 6.60'

S. MAPLE 18 N31 $\frac{1}{2}$ W 36 LKS. = 23.76'

BALSAM 6 S73 $\frac{1}{2}$ W 17 LKS. = 11.22'

GLO RESURVEY 1974

NO REMAINING EVIDENCE OF CORNER

SET BY KIMMELL IN 1921

NOT REMONUMENTED

CORNER FALLS IN POWER LINE R/W

E+W

54
QUARTER CORNER BET. SEC'S. 19+24

GLO RESURVEY 1918

SET 1"X36" IRON POST WITH BRASS CAP MKD.

$\frac{1}{4}$

524 | 519

1918

FROM WHICH

POPLAR 8 N78 $\frac{1}{2}$ E 198 LKS. = 130.68'

POPLAR 6 N2 $\frac{1}{2}$ E 283 LKS. = 186.78'

GLO RESURVEY 1974

FOUND 1918 IRON POST WITH BRASS CAP

NO EVIDENCE OF BEARING TREES

By KIMMELL IN 1918

54

55
CORNER TO SECTIONS 13-18-19-24

GLO RESURVEY 1918

SET 2" X 3/4" IRON POST WITH BRASS CAP MKO.

T143N

S13 | S18

S24 | S19

R29W R28W

1918

FROM WHICH

POPLAR 5 N27³/₄E 57 LKS. = 37.62'

POPLAR 5 N17³/₄W 116 LKS. = 76.56'

POPLAR 5 S52¹/₄W 198 LKS. = 130.68'

POPLAR 6 S8E 186 LKS. = 122.76'

QUARTER CORNER. BET. SEC'S. 13+18

GLO RESURVEY 1918

SET 1" X 36" IRON POST WITH BRASS CAP MKA

$\frac{1}{4}$
S13 | S18

1918

FROM WHICH

NO BT'S.

CORNER TO SECTIONS 7-12-13+18

GLO RESURVEY 1918

SET 2"X36" IRON POST WITH BRASS CAP MKD.

T143N

R29W R28W

S12	S7
S13	S18

1918

DUG PITS 18"X18"X12" IN EACH SECTION

3.0' DISTANCE AND SCATTERED DIRT

58

ANGLE PT 3 TR 1393 + ANGLE PT 4 TR 1425

IN SECTION 25

GLO RESURVEY 1921

SET 1" X 3/16" IRON POST WITH BRASS CAP MKD.

AP4	AP3
TR 1425	TR 1393
S25	

1918

NO BT'S.

58

N 1/16 BET. SECS. 25 + 26 N 88° 25' E

10.48 CHS. = 691.68' - AP3 + AP4

ANGLE PT 1 TR 1425 + ANGLE PT 2 TR 1393

GLO RESURVEY 1918

SET 1" x 36" IRON POST WITH BRASS CAP MKD.

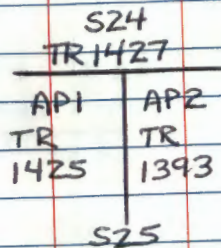

1918

NO BT'S.

GLO RESURVEY 1974

NO EVIDENCE REMAINS OF ABOVE
CORNER - NOT MONUMENTED

FROM SEC. COR. 23-24-25-26

N88°27'E - 10163 CHS. = 701.58'

ANGLE PT 4 TR 1516

GLO RESURVEY 1918

SET 1" x 3/8" IRON POST WITH BRASS CAP (M.D.)

TR 1516

AP4

TR 1425

S23

1918

NO BT'S.

E 1/16 BET. SEC'S. 23-26

N 0° 43' W - 10.02 CHS. = 661.32'

61

ANGLE PT 1 TR 1427 + ANGLE PT 4 TR 1428

GLO RESURVEY 1918

SET 1" x 36" IRON POST WITH BRASS CAP MKD.

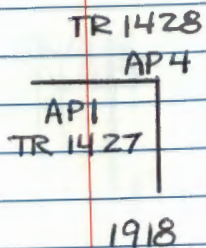

NO BT'S.

61

50°30'E - 10.03 CHS. = 661.98

FROM CW 1/16 SEC. 24

ANGLE PT 2 TR 1426

GLO RESURVEY 1918

SET 1" X 36" IRON POST WITH BRASS CAP MKD

TR 1426

AP 2
TR
1426

1918

NO BT'S.

$S 0^{\circ} 17' E - 10.03 CHS = 661.98$

FROM C/4 SEC. 24

CORNER TO SECTIONS 11-12-13-14

GLO RESURVEY 1918

RESTORED FROM ORIG. GOV'T. B.T'S.

MAPLE STP. 30 S76 $\frac{1}{2}$ W 46 LKS. = 30.36'

MAPLE STP. 20 N67W 12 LKS. = 7.92'

ELM 30 S1E 80 LKS. = 52.80'

ELM 20 S81 $\frac{3}{4}$ E 22 LKS. = 14.52'

SET 2" x .36" IRON POST WITH BRASS CAP MKD.

T143NR29W

S11 | S12

S14 | S13

FROM WHICH

1918

ASH 4 N35 $\frac{1}{4}$ E 69 LKS. = 45.54'ELM 8 S45 $\frac{1}{4}$ E 95 LKS. = 62.70'MAPLE 5 S47 $\frac{1}{4}$ W 47 LKS. = 31.02'ELM 12 N53 $\frac{1}{4}$ W 71 LKS. = 46.86'

N89°02'E FROM SEC. COR.

LINE TREE 438' MAPLE 28"

" " 1109' MAPLE 24"

" " 1288' BASSWOOD 20"

MARKED WITH 2 GROVES E+W SIDES
OF LINE TREES - MARKED BY GLO
RESURVEY IN 1918 - (NOT ORIGINAL)

QUARTER CORNER BET. SEC'S. 13 & 14

GLO RESURVEY 1918

SET 1" X 36" IRON POST WITH BRASS CAP MKD.

$\frac{1}{4}$

S14 | S13

1918

FROM WHICH

OAK 8 N57E 136 LKS. = 89.76'

ASH 6 N69 $\frac{3}{4}$ W 90 LKS. = 59.40'

ANGLE POINT #5 IN SECTION 25

GLO RESURVEY 1921

SET 1" X 3/16" IRON POST WITH BRASS CAP MKD.

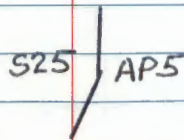

1921

FROM WHICH

ASH 16 S69 $\frac{1}{4}$ E 40 LKS. = 26.40'

MAPLE 20 N75 $\frac{1}{2}$ W 10 LKS. = 6.60'

FROM AP#4 N30°46'E - 15.36 CHS. = 1013.76
TO AP#5

66
ANGLE POINT #6 IN SECTION 25

GLO RESURVEY 1921

SET 1" X 36" IRON POST WITH BRASS CAP MKD.

S25 | AP6

1921

FROM WHICH

MAPLE 6 N46³/₄W 21 LKS. = 13.86'

MAPLE 8 S48¹/₂E 44 LKS. = 29.04'

66

FROM AP#5 N23°52'E 18.44 CHS = 1217.04'
TO AP#6

67

ANGLE POINT #7 IN SECTION 25

GLO RESURVEY 1921

SET 1" X 3/8" IRON POST WITH BRASS CAP MKD.

S25/AP7

1921

FROM WHICH

CEDAR 7 N89 $\frac{1}{2}$ E 19 LKS = 12.54'

CEDAR 7 S89W 74 LKS = 48.84'

67

FROM AP#6 N58°56'E - 20.56 CHS. = 1356.96'
TO AP#7FROM AP#7 N31°31'E - 7.40 CHS. = 488.40'
TO RESTORED MEANDER COR ON EAST
BOUNDARY OF TOWNSHIP

CLOSING CORNER ON E+W CENTERLINE
OF SECTION 25 AND THE RESTORED
MEANDER LINE

GLO RESURVEY 1921

SET 1" X 36" IRON POST WITH BRASS CAP MKD.

S25
C-----C
CC
1921

FROM WHICH

MAPLE 20 N20W 34 LKS = 22.44'

IRONWOOD 10 S55 1/2 W 88 LKS = 58.08'

GLO RESURVEY 1974

NO EVIDENCE OF 1921 BT'S

FOUND 1921 IRON POST - IN PLACE 14" HIGH
~~MARKED NEW BT'S.~~

~~MAPLE 12 N56E 75 LKS = 49.50'~~

~~OAK 7 N70W 83 LKS = 54.78'~~

1974 FOUND BURNED MAPLE STUMP

N20W 34 LKS. = NO MARKS

VISIBLE

INTERSECT MEANDER LINE AT
N23°52'E - 2.95 CHS. = 194.70'
FROM AP#5

REST OF BOOK
IS EMPTY