

CORNER RESTORATION

T142N R28W

R-E

FIELD BOOK

820012

BOOK 3

CORNER RESTORATION

T142N R28W



T. 142N.

R. 28W.

BOOK 3 of 6

Map.

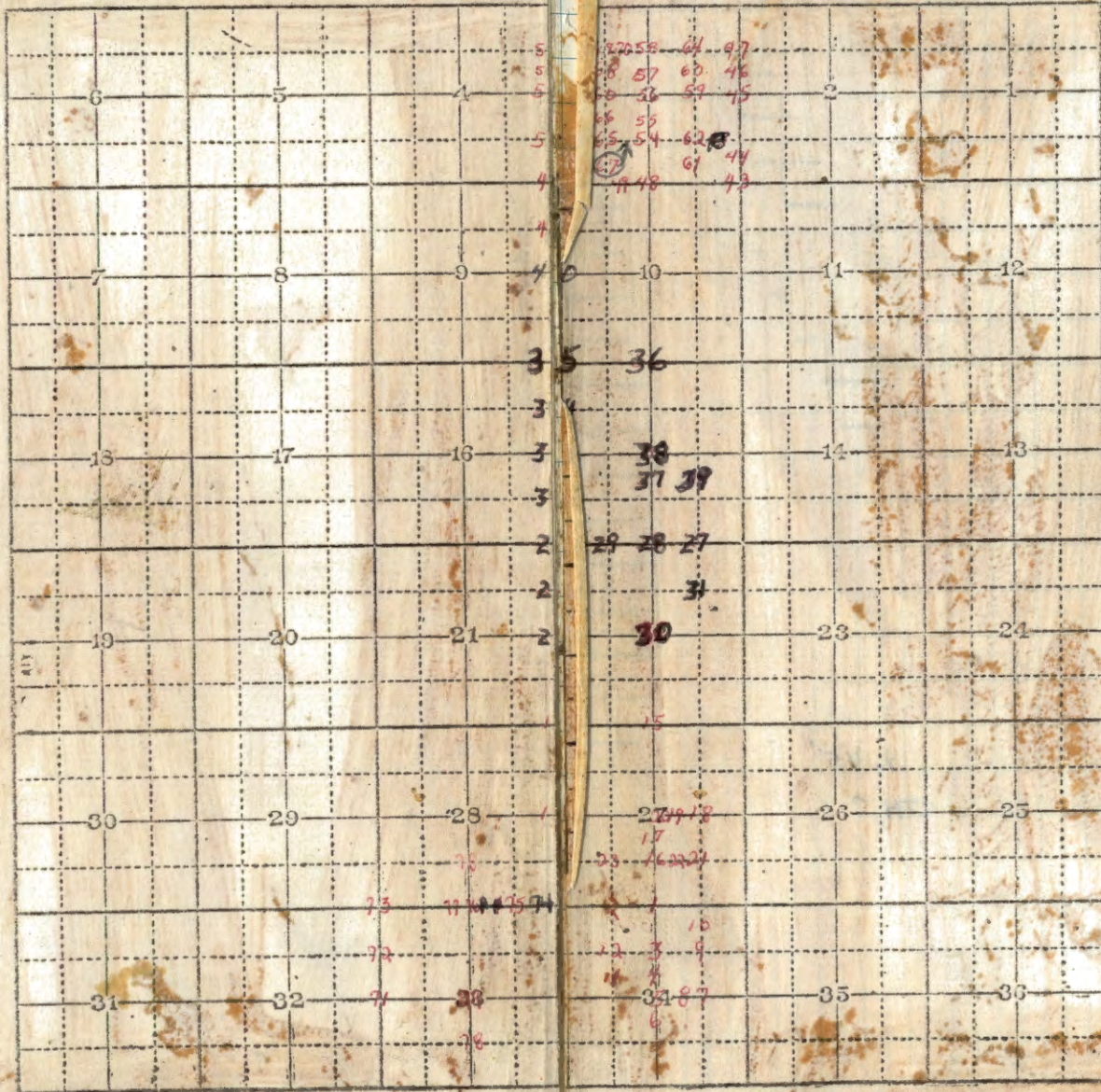

V-15

Quarter Cor. Secs. 27-34

G.L.O. Resurvey Notes of 1928

Iron post 3' long 1" diam. with brass cap marked

4/21/93 CK

Fd. IRON + CAP - IN PLACE 1 S 27

8" ABOVE GROUND 4 S 34

20' NORTH OF E+W ROAD - <sup>FR.</sup> 3098 1928

W. Oak 8" S79°15'E 350 lks - 2300'

R. Oak 3" N45°W 106 lks - 69.96'

7/19/93 RM-CK

Fd. IRON + CAP - IN PLACE

MKD. NEW BT's.

N. PINE 10" N47E 73.43'

R. OAK 9" S62E 22.42'

R. OAK 6" N6E 9.45'

8' STEEL SIGN POST NORTH 2.3'

V-14

West 1/16 Cor. Sec's. 27-34

G.L.O. Resurvey notes of 1928

Iron post 3' long 1" diam. with brass cap marked

W 1/16 S 27

S 34

1928

Poplar 5" S41°W 325 lks - 214.50'

5680-11 by ~~W. T. Tausch~~ TAUSCH 9/5/62

4/21/93 CK

FD, 1" IRON CAP - IN PLACE - ON NORTH SIDE OF WOODS

TRAIL E+W - 8" ABOVE GROUND - PLACED 3 ROCK

AROUND IRON - 15' NORTH OF TRAIL

MARKED NEW B.T'S.

N. PINE 7 N6W 30.85' MKD W 1/16 S 27 BT

N. PINE 9 N57W 12.90' " W 1/16 S 27 BT

W. OAK TWIN 5" N62E 10.23 " BT

8' STEEL SIGN POST DUE NORTH 3.0' - S49 ATTACHED

W-15

Center North 1/16 Cor. Sec. 34

G.L.O. Resurvey notes of 1928

Iron post 3' long 1" diam. with brass cap marked

C  
N 1/16 | S 34  
C  
1928

W. Oak 20" N28°30'E 68.1K5- 44.88'

W. Oak 5" S46°W 148.1K5- 97.68'

Angle Point 5 of Allotment 1367 of Sec. 34

G.L.O. Resurvey notes of 1928

Iron post 3' long 1" diam. with brass cap marked

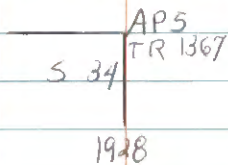

7-27-95 R MAIN

Fd GLO MONUMENT UP 2" AND IN PLACE CORNER  
IS IN MIXED HARDWOODS. Small slough N10W ± 75 FT  
FROM CORNER.

MKD NEW WITNESSES

WOAK 1 1/2" S88°E 20.68 FT TO SPK MED: AP534BT  
(CLUMD)

WOAK 1" N77°W 22.80 FT TO SPK MED: AP534BT

WOAK 4" S88°E 8.44 FT TO SPK NOT SCRIBED

NOTE: FROM AP4 on pg 11 to THIS AP GLO HAS A ARG OF  
EAST WEST SHOULD RUN S88° EAST

Center Quarter Cor. of Sec. 34

G.L.O. Resurvey notes of 1928

Iron post 3' long 1" diam. with brass cap marked

C $\frac{1}{4}$  S 34

1928

R. Oak 10" S34 $\frac{1}{2}$ W 57 1/2 - 37.62'

W. Oak 8" N53 $^{\circ}$ W 50 1/2 - 33.00'

8-3-95 R. MAIN

FD GLO. IR. IN PLACE UP  $\pm$  3" ALONG NORTH SOUTH FENCE LINE.

AM WALKING TAIL NEXT TO CORNER. GOES TO FARM HOUSE NEAR

CORNER

GLOW. OAK 22 N53 $^{\circ}$ W 33.40 TO SPE. SCRIPES OVERGROWN

GLOW. OAK 29" DYING S34 W 37.62 TO SPE. SCRIPES OVERGROWN

NE R. OAK 16" S64 $^{\circ}$ E 18.27 FT TO SPE. MKD: S34 BT

RAN SOUTH FROM AP 5 MISSED CORNER 30 FT TO EAST.

N $\frac{1}{4}$  LINE SHOULD BE RUN E S20 W



Special Meander Cor. Sec. 34

G.L.O. Resurvey notes of 1928

Iron post 3' long 1" diam. with brass cap marked

C  
S 34  
C

SMC

1928

W. Pine 12" N72°30'E 140 IKs- 92.40'  
NOW A 2 FT HIGH STUB THAT HAD BEEN CUT OFF.  
SCARCE VISIBLE

W. Pine 3" N18°W 54 IKs- 35.64'  
IN CATTAILS NO EVIDENCE FD.

8-9-95 RMAEN

FD GLO IRON IN PLACE ON SHORE OF TOWNLINE LAKE  
IN CATTAILS AT WATERS EDGE AND 50 FT SOUTH  
OF WOODS EDGE. FENCE RUNS TO SMC FROM CENTER 1/4  
MKD TWO NEW BTS

MAPLE 10" N27E 67.95 FT TO SPR MKD 534 BT

W. OAK 7" N60°E 81.22 FT TO SPR MKD 534 BT

Center East 1/16 Cor. Sec. 34

G.L.O. Resurvey notes of 1928

Iron post 3' long 1" diam. with brass cap marked

E 1/16  
S 34  
1928

W. Pine 10" S2°45'W 390.1K5- 257.40'

R. PINE 24"

No other BI's available

9-7-95 R. MAINE CLEAR 50° 1st cool day of 95 summer

Fd MONUMENT IN PLACE up 2 ft. CORNER FALLS

IN GRASS AND WILLOW MEADOW ABOUT 100 FT WEST

of woods. Should TIE w/ SIGNPOST @ LATER DATE ALSO

ONE COULD BE WIERED TO CORNER. CORNER WITNESSED

WITH:

G.L.O. PINE 24" S2W 257.4 w/ TAGS NOTE SPECIES  
NOT W. PINE. SCRIBE OVERGROWN

SIGNPOSTS

- Ce Special Meander Cor. Sec. 34
- G. G.L.O. Resurvey notes of 1928
- Ex Iron post 3' long 1" diam. with brass cap marked

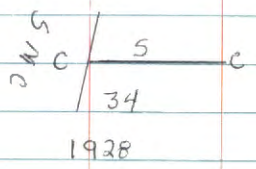

W. Oak 5" S37°30'E 202 1K5- 133.32'

- R.
- Nc
- 9-
- F.
- I
- 2
- ON
- W:
- GLL
- No
- S

W-16

North East 1/16 Cor. Sec. 34

G.L.O. Resurvey notes of 1928

Iron post 3' long 1" diam. with brass cap marked

NE 1/16 S34

1928

W. Birch 5" N68°E 13 1/2' 8.58'

Now 10" X 20 FT SNAG, ROLL-OVER BUT SCRIBE ROTTED

W. Oak 5" N68°W 31 1/2' 20.46'

7150-4 by Wittloft & Emery 4/2/69

7-26-95 R. MAIN

Ed GLO IRON IN PLACE UP 8" ABOVE GROUND

MONUMENT FALLS IN OLD CUT OVER AREA.

MKD 2 NEW WITNESSES.

GLO W. OAK 15" N68°W 26.10 FT TO SPK SCRIBE OVERGROWN

W. OAK 11" S31°E 30.40 FT TO SPK MKD: S34 BT

W. OAK 15" S81°W 34.43 FT TO SPK MKD: S34 BT

Angle Point 2 of Allotment 1505 Sec. 34

G.L.O. Resurvey notes of 1928

Iron post 3' long 1" diam. with brass cap marked.

AP 2

S 34

TR 1505

1928

7-26-95

Fd GLO IRON IN PLACE 4" ABOVE GROUND  
IRON FALLS IN MIXED HARDWOODS 30 FT WEST  
OF SWAMP.

MKD TWO NEW WITNESSES.

WOAK 11" N11°E 10.65 FT TO SPK MKD AP 534 BT

WOAK 13" N62°W 6.85 FT TO 1/2" DIA. MKD AP 534 BT

W, X-14

Angle Point 4 of Allotment 1367, Sec. 34

G.L.O. Resurvey notes of 1928

Iron post 3' long 1" diam. with brass cap marked

AP 4

S 34 TR 1367

1928

9-21-93 RM + CK

FD, IRON + CAP - IN PLACE - 15" ABOVE GROUND

AT OLD FENCE CORNER - FENCE RUNS SOUTH + WEST

PLACE ROCK NEXT TO IRON - 2.5' NORTH OF 12" CEDAR

FENCE CORNER POST - 175' E OF Q. OF COUNTY RD. #8

MARKED NEW BT'S.

W. OAK 12 N50E 68.48 MKD APS34 BT

W. OAK 7 S18E 52.83 MKD APS34 BT

W. OAK 12 S21W 100.58 MKD BT

8" STEEL SIGN POSTS NORTH 3.0' EAST 4.55'

W-14

North West 1/16 Cor. Sec. 34

G. L. O. Resurvey notes of 1928

Iron post 3' long 1" diam. with brass cap marked

NW 1/16 S 34

1928

Oak 5" S49°W 34 1K5 - 22.44'

Oak 4" N73°15'W 59 1K5 - 38.94'

NW 1/16 CORNER SECTION 34

9/21/93 RM + CRK

FD. IRON + CAP - IN PLACE - IN GOOD CONDITION

8" ABOVE GROUND - IN HARDWOODS

PLACE 3 ROCK AROUND IRON

MARKED NEW BT'S.

R. OAK 7" N15W - 16.35' MKD NW 1/16 S 34 BT

N. PINE 9" N77E - 62.75' " " "

N. PINE 8" S69E - 42.70' " " "

8' STEEL SIGN POSTS - SOUTH 4.1' + WEST 4.4'

FD. 10" R. OAK AT N73W - 38.94' SCAR FACING COR.

FD. TWIN R. OAK WINDFALLS + STUMP AT S49W - 22.44'

22.44' ROTTING ON GROUND

CORNER IS 125' WEST OF CASS CO. #8

T-13

Quarter Cor. Sec's 27-28

G.L.O. Resurvey notes of 1928.

Iron post 3/4 long 1" diam with brass cap mark at

2/8/90 Fd. GLO

iron pipe with

brass cap set 528 527

14" above ground. 1928

Iron leaning eastly.

Balsam 8" S49°15'E 117 LKS- 77.22'

2/8/90 Fd. no evidence

Cedar 14" West 103 LKS- 67.98'

NOW 18" CEDAR WEST 67.98' SCRIBE VISABLE

FOUND EVIDENCE OF ORIG. BT'S.

CEDAR 20 S80E 8 LKS. 5.3' MKD 1/4S BT

2/8/90 Fd. burnt Cedar snag at 5.3' 20d galv.

CEDAR STP. 14 NGOW 6 LKS. 4.0' NO MARKS

Fd. cedar stp. at brging + dist.

LOCAL BT FOUND AT CORNER

CEDAR 20 S30E 6 LKS. 4.0' MKD 1/4S

Fd. Cedar windfall at brging + dist

CORNER ON SOUTH SIDE OF CEDAR SWAMP NW-SE

2/8/90 MKD New BT'S:

Ash 7" N29 E 21.6' 1/4 527 BT

Ash 7" S68 W 17.3' 1/4 528 BT

Ash 6" N39 W 52.3' 1/4 528 BT

2/8/90 Beautiful day 50's Chained N2°E  
2680' from sec. corner. Line fell 28' east  
of corner. Distance fell 2585'. Rough line for chaining

1-05-2010 R. MAIN

GPS IRON



R-13

Sec. Cor. Sec's. 21-22-27-28

G. L. O. Resurvey notes of 1928

Iron post 3' long 2" diam with brass cap marked

T 142N R 28W

S 21 | S 22

S 28 | S 27

1928

Cedar 7" N46°E 16 IKS- 10.56'

Balsam 6" S29°30'E 72 IKS- 47.52'

Cedar 6" S38°W 38 IKS- 25.08'

Cedar 5" N3°45'W 37 IKS- 24.42'

2.  
R-15

Quarter Cor. Sec's. 22-27

G.L.O. Resurvey notes of 1928

Iron post 3' long 1" diam. with brass cap marked

$\frac{1}{4}$  5 22

5 27

1928

Cedar 6" N16°30'E 17 1K5- 11.22'

Cedar 6" S25°W 33 1K5- 21.78

U-15

Center South 1/16 Cor. Sec. 27

G.L.O. Resurvey Notes of 1928

Iron post 3' long 1" diam. with brass cap marked

9-21-93 RM + CK

Fd, IRON + CAP - IN PLACE C

6" ABOVE GROUND S 1/16 S 27

75' WEST OF Q. OF COUNTY C

ROAD #8 1928

Birch 4" S70°15'E 47 1/2 - 31.02'

R. Oak 4" S20°W 43 1/2 - 28.38'

5680-11 by TAUSCH - 9/5/62

MARKED NEW BT's.

R. PINE 8 N84W 39.47' MKD CS 1/16 S 27 BT

R. PINE 9 N26W 48.60' MKD " " "

R. OAK 15 S68E 12.77' MKD. " " "

8' STEEL SIGN POSTS NORTH 3.8' + WEST 3.8'

Fd, OLD FSLP ON R. OAK 16" NISE - 7.0'

CORNER IS 18' WEST OF WEST EDGE

OF TREE LINE ON WEST SIDE OF COUNTY

ROAD #8

Special Meander Cor. Sec. 27

G.L.O. Resurvey notes of 1928

Iron post 3/4 long 1" diam. with brass cap marked

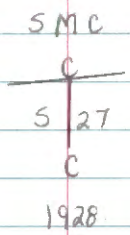

Cedar 9" N76°E 34.1K5- 22.44'

Cedar 6" S20°W 6.1K5- 3.96'

F-16

Center East 1/16 Cor. Sec. 27

G.L.O. Resurvey notes of 1928

Iron post 3' long 1" diam. with brass cap marked

E 1/16  
S 27  
1928

Poplar 8" S10°45'E 41 IKS- 27.06'

Poplar 5" N1°W 33 IKS- 21.78'

5680-11 by Wittkeft &amp; Cury - 1965

4/28/97 CK

RAN LINE FROM AP1 + AP2 DUE EAST  
678' BY STRING MEASURE. FD. GLO  
IRON + CAP - IN PLACE - 18" ABOVE GRD.

DROVE DOWN TO 8" ABOVE GROUND.

CORNER IS IN LOWLAND - WET NOW

MONUMENT COULD BE HIGHER AGAIN

OVER TIME AS THIS TYPE OF AREA

HAS BEEN KNOWN TO MOVE MONUMENTS

UP BY FROST EACH SPRING

ASPEN - BALSAM - ASH &amp; SCATTERED CEDAR

18

MARKED NEW BT's,

W. SPRUCE 13 N66E - 30.58

MKD CE 1/16 S27 BT

CEDAR 14 S85E - 28.92' MKD CE 1/16 S27 BT

ASH 7 S3E - 35.92' " CE 1/16 S27 BT

PLACE F.S. SIGN 54-9 ON 4" ASPEN

S57E 7.0' SET 3" SQ. ASPEN STAKE

5' HIGH NORTH ALONG SIDE OF IRON

8 FT STEEL SIGN POSTS 2.7' WEST 3.1' EAST

DIST TO C OF POST. LTS EAST AND WEST. R.M. NEW  
4-12-04

Angle Point 2 of Allotment 1502, and Angle Point  
1 of Allotment 1492, Sec. 27

G. L. O. Resurvey notes of 1928

Iron post 3" long 1" diam. with brass cap marked

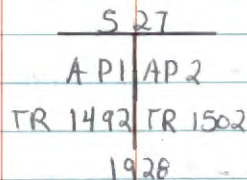

4/24/97 CK

STRING DISTANCE NORTH FROM AP3 & AP4  
TO THIS ABOVE CORNER - GOT DRAW IN  
CENTER OF NORTH BOUND LANE AND SIDE  
DRIVEWAY TO EAST - PAINTED  $\odot$  ON  
BLACKTOP AT DRAW - GLO DISTANCE  
WAS 1377.42' - STRING DISTANCE WAS  
1386' THIS REASONABLE FOR STRING  
MEASURE - Fd. LARGE ASPEN TO EAST 160'  
WITH OLD BLAZE ON EAST SIDE  
WILL RUN EAST TO CE'116 AND CHECK  
DISTANCE BY GLO OF 673.86'

4/28/97 CK

RAN LINE DUE EAST TO CE'116 SEC. 27

STRING DISTANCE WAS 678' - GLO

DISTANCE IS 10.21 CHS. OR 673.86'

FOUND CE'116 IN PLACE

POSITION OF AP1 & AP2 UNDER BLACKTOP  
IN COUNTY ROAD #8 IS IN CORRECT  
POSITION BASED ON DISTANCES  
WILL WITNESS POSITION WITH TIES  
TO DRAW IN ROAD

Special Meander Cor. Sec. 27

G.L.O. Resurvey notes of 1928

Iron post 3' long 1" diam. with brass cap marked

S	5	C
W	27	C

1928

Cedar 9" N58°30'E 61 IKS - 40.26'

Cedar 7" S43° E 15 IKS - 8.58'

12-17-03 R MAIN

FD GLO IRON IN PLACE @ GPSED POSITION. FD BOTH  
BTS 9" DIST DOESN'T MATCH WELL. IRON WAS STRAIGHT  
UP & DOWN / W/ CORRECT ORIENTATION SO BELIEVE ITS  
@ GLO POSITION.

CEGAR (DEAD) 9" N58E 41.4 FT TO SPK

CEGAR (DEAD) 7" S43E 7.95 FT TO SPK

8 FT STEEL SIGN POST 2.6 FT EAST. LTS EAST  
PLACE 8 FT STEEL SIGN POST ALONG SIDE MONUMENT  
ON SOUTHEAST SIDE. SIGN POST AND MONUMENT  
ARE FLUSH / W/ GROUND.

U-16

South East 1/16 Cor. Sec. 27

G.L.O. Resurvey notes of 1928

Iron post 3' long 1" diam. with brass cap marked

9-27-93 CK

Ed. IRON & CAP SE 1/16 S 27

IN PLACE - 12" ABOVE GRD. 1928

AT WEST EDGE OF N. PINE PLANTATION

W. Oak 5" S54°W 32 IK5 - 21.12'

FALLS AT EDGE OF PLANTATION - NO TRACE AT S54W 21.12'

W. Oak 5" N23°45'W 31 IK5 - 20.46'

FALLS IN PLANTATION - NO TRACE AT N24W 20.5'

PLACED 3 ROCKS AROUND IRON & CAP - CORNER IS JUST  
INTO HARDWOODS 15' FROM NYS EDGE OF N. PINE  
PLANTATION

RAN FROM AP TO WEST - RAN LINE AT S89E - HIPCHAIN  
FR 3099  
DISTANCE 676' - RAN NORTH TO TRAIL 220' PLACED

ESLP ON 6" N. PINE ON SOUTH SIDE OF TRAIL NE-SW

9-29-93 RM & CK

MARKED NEW B.T.S.

N. PINE 7 N43E 41.00' NYS SE 1/16 S 27 BT

W. OAK 10 SOUTH 22.30' " " " "

N. PINE 7 N54W 21.82' " " " "

8' STEEL SIGN POSTS SOUTH 3.7' & EAST 3.2'



4-15,16

Angle Point 3 of Allotment 1502 and Angle Point  
4 of Allotment 1492, Sec 27  
G. L. O. Resurvey notes of 1928  
Iron post 3' long 1" diam. with brass cap marked

AP 4	AP 3
TR 1492	TR 1502
S 27	
1928	

9-27-93 CK

Ed. IRON & CAP - IN PLACE, BUT BENT EASTERLY  
IN N. PINE PLANTATION - LARGE N. PINE 14" TO 20"  
JUST NORTH OF CORNER - 52' NORTH OF FR#3099

9-29-93 RM & CK

STRAIGHTEN IRON AND RESET 10" ABOVE GROUND  
MARKED NEW BT's.

N. PINE	14	N15W	35.00'	mko AP S27 BT
N. PINE	8	S78E	4.14'	mip AP S27 BT
N. PINE	19	N60W	15.78'	mip AP S27 BT

8' STEEL SIGN POST SOUTH 3.2'

22

4/24/97

EVERYTHING IN GOOD SHAPE AT THIS COR.  
RUN STRING NORTH TO AP1 + AP2 (1377)  
GLO

U-14

South West 1/16 Cor. Sec. 27

G. L. O. Resurvey notes of 1928

Iron post 3' long 1" diam. with brass cap marked

SW 1/16 S 27

1928

Poplar 4" N37°E 48 IKS- 31.68'

Poplar 5" S77°W 24 IKS- 15.84'

1-05-2010 R. MAIN J. SCHOONOVER

GPS IRON. MARK NEW BTS AS FOLLOWS.

WOAK 1/4" N76°W 25.70 FT TO SPK MKD 85Z7BT

ASH 7" N14°W 27.20 FT TO SPK MKD 85Z7BT

SPRING 825' W  
1342' FROM CS 1/16

23

S-494 CK

MEASURED FROM CS 1/16 WITH STRING 800' WEST  
HIT BEAVER FLOODED AREA - COULDN'T CONTINUE -  
FACED INTO AREA WEST OF LINE - FELL 100' SHORT  
OLD BLUE LINE ALONG PINE PLANTATION E+W  
IN LATE AFTERNOON FV. IRON + CAP - NO BTS. (EVIDENCE)  
PLACED FSLP ON 6" W. OAK ON NORTH SIDE - APPROX.  
CORNER IS N14E 10.4' FROM TAG  
IRON NEXT TO 20' ROUND POND IN HARDWOODS  
APPROX. 60' N OF E+W EDGE OF N. PINE PLANTATION

Quarter Cor. Sects. 21-22

G. L. O. Resurvey notes of 1928

Iron post 3' long 1" diam. with brass cap marked

	↓	
	4	
S 21		S 22
	↓	
	1928	

Birch 10" N42°45'E 280/1K5-184.80'

No trees available in Sec. 21

North 1/16 Sec's. 21-22

G.L.O. Resurvey notes of 1928

Iron post 3' long 1" diam. with brass cap marked

N 1	/ 16
S 21	S 22
1928	

W. Pine 14" East 492.1Ks - 324.72'

Sec. Cor. Secs. 15-16-21-22

G.L.O. Resurvey notes of 1928

Iron post 3' long 2" diam. with brass cap marked

T142N R28W

S 16 | S 15

S 21 | S 22

1928

Balsam 8" N43°E 84 IKs - 55.44'  
NO EVIDENCE

R. Oak 16" S75°30'E 91 IKs - 126.06'  
NO EVIDENCE IN TIMBER SALE AREA

Poplar 14" S16°30'W 68 IKs - 44.88'  
NO EVIDENCE

No trees available to the NW

3-27-02 R MAIN CLEAR 35° 6" SNOW

FD IRON IN PLACE IN MIXED HARDWOODS AND BLOWDOWN  
STEM DAMAGED TIMBER REMOVED SE OF CORNER.

W OAK 5" S86°E 21.62 FT TO SPR MKD: X BT

R OAK 4" S35°W 14.77 FT TO SPR MKD: X BT

8 FT STEEL SIGN POST 3.95 FT NORTH  
LINE TO STANDARD NORTH

PLACE FSLP ON 8" R OAK ON WEST SIDE OF  
FOREST ROAD FROM WHICH CORNER BEARS WEST  
± 175 FT

East 1/6 Cor. Secs. 15-22

G.L.O. Resurvey notes of 1928

Iron post 3' long 1" diam. with brass cap marked

E 1/6  $\frac{515}{522}$   
1928

Cedar <del>Oak</del>	10" <del>7"</del>	S 21° 30' E <del>S 73° 30' E</del>	60 KS - 39.60
-------------------------	----------------------	---------------------------------------	---------------

Cedar <del>Oak</del>	8"	N 6° W <del>N 60° 15' W</del>	51 KS - <del>63 KS -</del> 33.66'
-------------------------	----	----------------------------------	--------------------------------------

N-15

Quarter Cor. Sec's. 15-22

~~West 1/4 Cor. Sec's 15-22~~

G.L.O. Resurvey notes of 1928

Iron post 3' long 1" diam. with brass cap marked

1/31/90 CK, GB

Found GLO iron with

↓ S 15

brass cap set 8"

4 S 22

above ground in good

1928

condition.

Oak 7" S73°30'E 61/165- 40.26'

1/31/90  
Fd. no evidence at this time

Oak 6" N60°15'W 63/165- 41.58'

Fd. no evidence at this time

Place a F.S.L.P. on 8" R. Oak N75W 3.4' from cor.

9-29-93 RMYCK

MARKED NEW B.T'S.

W. OAK 6 S45E 48.40 MKD 1/4 S22 BT

R. OAK 7 S50W 21.04' " " " "

R. OAK 8 N22W 34.95' 1/4 S15 BT

8' STEEL SIGN POSTS NORTH 4.0' + EAST 4.9'

PLACED F.S.L.P. ON 4" ASH (3) ON WEST SIDE COUNTY RD #8

1/4 CORNER IS 245' WEST OF TAG

28

CC Done 1990

1/31/90 Corner falls in R. Oak + Aspen. Co. road #8  
is 265' east of corner.

West 1/16 Cor. Sec's. 15-22

G.L.O. Resurvey notes of 1928

Iron post 3' long 1" diam. with brass cap marked

W 1/16	S 15
	S 22
	1928

Poplar      8"      S 26° 30' E      113 / K5 - 74.58'

Elm          14"      N 74° W      183 / K5 - 120.78'



P-15

Center Quarter Cor. Sec. 22

G.L.O. Resurvey notes of 1928

Iron post 3' long 1" diam. with brass cap marked

C $\frac{1}{4}$  S22  
1928

Corner falls in soft marshy ground; no BT's available. Beside iron post, set a squared cedar post stake projecting 6' above ground, marked with scribe.

1/31/90 GB, GR

Fd. G.L.O. iron with cap set 5" above ground in good condition.

Placed a F.S.L.P. on 4" Cedar NBOW 9.3' from corner.

30

C.L. Don 1990

1/31/90 chained south from N $\frac{1}{4}$  S. 22, 2670'

Line fell 18' east. Distance checked good.

Corner falls in a young cedar swamp.

Placed a F.S.L.P. on 14" W. Pine on west side of Co. rd. 8 that says N89W 774' to corner.

North West 1/16 Cor. Sec. 22

G. L. O. Resurvey notes of 1928

Iron post 3' long 1" diam. with brass cap marked

|  
NW 1/16

S 22

1928  
|

Basswood 6" N16°15'W 265 1K5-174.90'

No other trees available

M-13

South 1/16 Cor. Sects. 15-16

G.L.O. Resurvey notes of 1928

Iron post 3' long 1" diam. with brass cap marked

S	1/16	S
S	16	S
	15	
	1928	

R. Oak 14" N83°E 202 1/2 S - 133.32'  
NO EVIDENCE

Tamarack 11" N14°30'W 102 1/2 S - 62.32'  
GONE

1992 - G. Roerick & J. Gustafson  
Found GLO iron pipe with  
brass cap 12" above ground.  
Placed a F.S.L.P. on 8" ash. Corner  
is 18' from tag @ N44°E

3-28-02 R MAIN 30° 4" SNOW  
Fd IRON IN PLACE IN ASH AND OTHER HARD WOODS  
ASH LOWLAND 200' X 50' NORTH AND WEST OF CORNER.  
IRON IS IN SOUTH EAST EDGE OF SAME.

W OAK 10" S45°W 55.70 FT TO SPK MARK: S 16 BT

W OAK 8" S30°E 73.8 FT TO SPK MARK: S 15 BT

8 FT STEEL SIGN POSTS 4.6 SOUTH 5.7 WEST

L-13

Quarter Cor. Sects. 15-16

G.L.O. Resurvey notes of 1928

Iron post 3' long 1" diam. with brass cap marked

↓  
4  
S. 16 | S15  
1928

R. Oak 18" N38°15'E 108.1K5 - 71.28'

Maple 10" S17°W 104.1K5 - 68.64'

1992 - G. Roerick & J. Gustafson

Located GLO iron pipe with brass cap 12" above ground.

Placed a FSLP on 10" Oak, corner is 8' from Oak @ 543°E.

2-8-96 R MAIN

MKD NEW WITNESSES

GLO MAPLE 17" S17°W 68.64 SCRIBE OVERGROWN  
NOW 4 FT STUB

W OAK 10" N 2° W 80.75 FT TO SPK MKD 1/4 S16 BT

W OAK 9" S 20° E 42.70 FT TO SPK MKD 1/4 S15 BT

3-29-35 874-9 L.B. HUTCHINSON ESTIMATOR  
Fd GLO IN PLACE UP 6" AND GLO BTS. FSLP  
ON WEST SIDE OF 14" MAPLE FROM WHICH  
CORNER BEARS WEST. LOCATED AT CORNER OF  
FENCE FOLLOWING SECTION LINE N, THEN  
SWINGING EAST AT QUARTER CORNER.

3-25-02 R MAIN

STORM DAMAGE NOW AROUND CORNER. 1992  
OAK/W/ FSLP IS NOW BLOWN DOWN. MY BTS FROM  
1996 ARE STILL OK. CORNER IS 170 FT EAST  
OF SNOW MOBILE TRAIL.

K-13

North 1/16 Cor. Sec's. 15-16

G.L.O. Resurvey notes of 1928

Iron post 3' long 1" diam. with brass cap marked

N 1/16  
S 16 | S 15  
1928

No BT's available

1992 G. Roerick, J. Gustafson

Found GLO iron with brass  
cap 4" above swamp level.

Placed F.S.L.P. on 9" tamarack

corner is 37' from F.S.L.P. DN S3E

2-8-96 RMAIN  $\pm 26"$  SNOW 350

FD GLO IRON IN ALDER SWAMP 40' NORTH OF  
TAMARACK WOODS. CORNER FALL  $\pm 100$  FT EAST OF  
WOODS ROAD THROUGH ALDER SWAMP.

TAMARACK 12" S 20° W 46.40 FT TO SPE MKD S16 BT

TAMARACK 9" S 40° W 42.78 FT TO SPE MKD S16 BT

J-13

Sec. Cor. Secs. 9-10-15-16

G.L.O. Resurvey notes of 1928

Galvanized pipe, 2" diam. with metal cap marked  
~~Iron post 3" long~~

T 142 N R 28 W

S 9 | 510

S 16 | 515

1928

Maple 4" S18°15'E 37 LKS - 24.42'

Basswood 14" S39°15'W 78 LKS - 51.48'

Ash 4" N77°45'W 287 LKS - 189.42'

No trees available in Sec. 10

1992 - G. Roerick &amp; J. Gustafson

Found 2" galvanized pipe w/ metal cap. Placed a F.S.L.P. on 12" Burr Oak. Corner is 21' from F.S.L.P. @ N32E.

DIFF CORRECTED 47°07'32.96  
GDS 94°13'28.25

35

NOTES OF ORIG. GOV'T. SURVEY 1874

SET WOOD POST

MAPLE 6 N27E 24 LKS. = 15.84'

IRONWOOD 12 N31W 18 LKS. = 11.88' GONE IN 1916

BASSWOOD 5 S56W 21 LKS. = 13.86'

BASSWOOD 9 S38E 13 LKS. = 8.58' GONE IN 1916

NOTES BY CASS COUNTY ROAD SURVEY 1916

BOOK B Pgs. 221 - RECORD SURVEY # 288

FOUND TWO GOV'T. BT'S. IN EVIDENCE

SET HUB FROM GOV'T. BT'S. AND TRUE CORNER

NOW STANDS FROM ORIG. BT'S.

MAPLE 6 N73E 14.67'

BASSWOOD 12 S72W 12.83'

Fd. ROOTS OF IRONWOOD

Fd. STUMP OF BASSWOOD SOME CRUISER HAS

MARKED WITH BT - N50W - 33.0'

PAGE 233 SET IRON MONUMENT AT TRUE COR.

1928 GLO RESURVEY ~~■~~ ACCEPTED AS TRUE COR.

FOUND CORNER MARKED WITH 2" DIA. GALVANIZED

IRON PIPE WITH METAL CAP - MARKED BY GLO.

MR. STEARNS - HOMESTEADED IN AREA - STATED

IRON SET BY COUNTY SURVEYOR FROM ORIG.

GOV'T. BT'S. - WHICH WERE LATER DESTROYED

BY ROAD CONSTRUCTION OF E+W ROAD

SEE BOOK 6 Pg. 9 142-28

J-15

Quarter Cor. Secs. 10-15

G.L.O. Resurvey notes of 1928 PG # 120

Galvanized pipe 2" diam. with metal cap marked

BEARINGS OF LINES W $\frac{1}{2}$  N89°23'W E $\frac{1}{2}$  N89°35'W

$\frac{1}{4}$	S 10
	S 15

1928

Elm 7" N20°45'E 55 LKS - 36.30'

NO EVIDENCE

Basswood 8" S38°15'E 75 LKS - 49.50'

NO EVIDENCE

PIPE WAS SET BY COUNTY SURVEYOR OF CASS COUNTY AND IS ACCEPTED LOCALLY AS THE TRUE POINT FOR THE  $\frac{1}{4}$  CORNER. 40.94 CHS. = 2702.04' MIDPOINT BETWEEN SECTION CORNERS E+W

COUNTY DISTANCES RECORDED IN RECORD SURVEY #288 BOOK B Pgs. 220 - 223 - MAY 24-1916

FOUND EVIDENCE OF ORIGINAL BT'S.

ELM WAS FOUND TO BE A BASSWOOD FROM GOV'T. BT'S. SET HUB FOR TRUE  $\frac{1}{4}$  COR. GOV'T BT'S. NOW STAND

BASSWOOD 13 N20W 6.40'

MAPLE 6 S26E 18.10'

COUNTY ROAD SURVEY SHOWS DISTANCES OF MILE AS 2702.00 W $\frac{1}{2}$  AND 2702.20 E $\frac{1}{2}$

PAGE 220 PLAT OF SURVEY BR6S. N88°30'W N88°14'W

NOTES OF ORIG. GOV'T. SURVEY 1874

SET WOOD POST

ELM 13 N10W 8 LKS. = 5.28'

MAPLE 6 S16W 23 LKS. = 15.18'

CASS COUNTY ROAD SURVEY - 1916

PAGE 233

SET IRON MONUMENT AT TRUE COR.

4-31-02 R MAIN

Angle Point 2 of Allotment 1315, Sec. 15

G. L. O. Resurvey notes of 1928

Iron post 3' long 1" diam. with brass cap marked

S 15

TR 1315

AP 2

1928

REFER TO BK #6 Pg 22



Center Quarter Cor. Sec. 15

G.L.O. Resurvey notes of 1928

Iron post 3' long 1" diam. with brass cap marked

$\begin{array}{c} | \\ C\frac{1}{4} \text{ S15} \\ | \\ 1928 \\ | \end{array}$

Poplar 12" N30°30'E 174 lks. 114.84'  
GONE

Poplar 14" S34°30'E 102 lks. 67.32'  
GONE

4-1-02 R MAIN 30° 6" SNOW CLEAR

FD IRON IN PLACE LEANING IN GRASS AND ALDER (± 2 IN RE)

SLOUGH. ASH & MIXED HARD WOODS EAST ± 40 FT. FD

TAG ON 12" ASH BY TS AND CC 2/5/1990 FROM WHICH

CORNER BEARS N40°W 36.5 FT. PLACE FSLP ON 7"

MAPLE ON EAST SIDE OF SNOWMOBILE TRAIL FROM

WHICH CORNER BEARS EAST ± 130 FT. STRAIGHTEN

FRON & MARK B.T.S.

ROAK 3 1/2" S45°E 45.40 FT TO SPK BRW SLICE  
X BT

W OAK 7" N72°W 107.75 FT TO SPK MKD S15 BT

Angle Point 1 of Allotment 1315, Sec. 15

G.L.O. Resurvey notes of 1928

Iron post 3' long 1" diam. with brass cap marked

• ——— S 5
   
 TR 1315
   
 AP 1
   
 1928

6-25-03 REMAIN

Ed IRON IN PLACE UP 6" IN MIXED HARDWOODS.

IRON IS UP AGAINST BASSWOOD CLUMP. GPS'ED

CORNER. PLACE FSLP ON EAST SIDE OF WDS

TRAIL. TAG ON 6" BIRCH FROM WHICH CORNER

BEARS EAST  $\pm$  90 FT.

G-13

Quarter Cor. Secs. 9-10

G.L.O. Resurvey notes of 1928

Iron post 3' long 1" diam. with brass cap marked

•  
 †  
 4  
 S 9 | S 10  
 1928

Maple 9" N61°30'E 73 IRS-48.18'

Spruce 8" S35°45'W 146 IRS-96.36'

5680-11 by Wittkeft & Emery 1965

7-8-03 R. MAIN

FD IRON IN PLACE IN MIXED HARDWOODS & BALSAM. FENCE RUNS NORTH AND WEST FROM CORNER. 1928 BTS ARE BOTH GONE. OLD LINE TO STANDARD RUNS NORTH. GASED IRON.

3-2-04 J. S. HOONOVER

FOUND IRON IN PLACE BUT BENT.

MKD NEW TIE TREES.

10" MAPLE N75°E 5.55' MKD S10 BT

7" W. OAK S4°E 5.80' MKD S10 13T

1-9-79 R. SILBAUGH

SET STEEL SIGN POSTS 307 NORTH 31 WEST

North 1/16 Cor. Sec's 9-10

G.L.O. Resurvey notes of 1928

Iron post 3' long 1" diam. with brass cap marked

N 1/16  
S 9 | S 10  
1928

Balsam 4" N19°30'E 179 1/2 - 118.74'

Balsam 4" N53°W 200 1/2 - 132.00'

E-13

Sec. Cor. Sec's 3-4-9-10

G. L. O. Resurvey notes of 1928

Iron post 3' long 1" diam. with brass cap marked

T 142 N R 28 W

S 4 S 3

S 9 S 10

1928

Maple 8" N65°30'E 126 IKS - 83.16'

Maple 10" S55°45'E 140 IKS - 92.40'

~~Ma~~

Maple 10" S51°15'W 213 IKS - 140.58'

Maple 6" N40°45'W 189 IKS - 124.74'

5680-11 by Wittkoff &amp; Emery - 1965

42

Z-25-96 ROMAIN

FD GLO IRON @ FENCE CORNER W/ FENCE RUNNING  
SOUTH, EAST AND WEST. CORNER IN MIXED  
HARDWOODS. TO MUCH SNOW TO LOOK FOR GLO STUMPS.  
Mkd NEW BTS AS FOLLOWS

W OAK 9" S21°W 66.70 FT TO SPK MKD 59 BT

W OAK 1 1/2" S86°E 19.86 FT TO SPK MKD 8510 BT

MAPLE 4" N12°E 28.34 FT TO SPK NOT SCRIBED

R OAK 10" N31°W 53.32 FT TO SPK MKD 54 BT

HEAVY 8 FT STEEL SIGN POSTS 4.6' SOUTH 4.4' EAST

E-17

Sec. Cor. Sec's. 2-3-10-11

G.L.O. Resurvey notes of 1928

Galvanized pipe, 2" diam. with metal cap marked

7/18/93	T 142 N	R 28 W
CAP MKD	S 3	S 2
ACCORDING TO	S 10	S 11
DRAWING	1928	

Maple 5" N64°45'E 98 lks - 64.68'

NOW 12" X 36" MAPLE STUB SCRIBE ROTTED OUT

Maple 8" S22°15'E 156 lks - 102.96'

NO TRACE - IN HOMESTEAD YARD

Maple 8" S29°45'W 117 lks - 77.22'

NOW 16" MAPLE S30W - 77.22' SCRIBE VISIBLE

Maple 10" N14°30'W 76 lks - 50.16'

NO TRACE TAKEN OUT BY WOODS TEAM

CORNER WAS FOUND TO BE MARKED BY 2" DIA.

GALVANIZED IRON PIPE WITH METAL CAP

NO GLO IRON WAS SET

PIPE WAS SET BY COUNTY SURVEYOR AND IS

ACCEPTED AS TRUE SEC. COR.

43

NOTES OF ORIG. GOVT. SURVEY 1874

SET WOOD POST

POPLAR 15 S40E 3 lks. = 1.98' 1916 STR + ROOTS

POPLAR 12 N45W 4 lks. = 2.64' 1916 " "

MAPLE 4 S30E 18 lks. = 11.88' GONE

MAPLE 4 N20W 32 lks. = 21.12' SCRIBE VISIBLE

NOTES OF CASS COUNTY ROAD SURVEY 1916

BOOK B Pg. 223 SURVEY RECORD # 288

FROM REMAINS OF ORIG. BT'S, SET HUB

FOR TRUE COR. AND MARKED NEW BT'S,

SOFT MAPLE 8 N78°W 37.40' <sup>NO TRACE</sup>  
NOW 18" MAPLE

MAPLE 7 S53E 78.00' - S51E 78.0'

PAGE 233

SET IRON MONUMENT AT TRUE COR.

7/19/93 RM-CK

Fd. 2 1/2" X 48" COUNTY IRON PIPE WITH CAP MKD.

IN PLACE - FLUSH WITH GROUND SURFACE

CAP NOW IS 2" BELOW SURFACE

MKD 2 BT'S.

ASH 6 N49W - 30.16 SPK + TAG

W. OAK 5 N10E - 37.35 SPK + TAG

CORNER IN LINE WITH TSP ROAD EAST + EAST

EDGE OF DRIVEWAY SOUTH TO HOME

4-27-2011 RMAIN

GPS IRON

D, E-17

Angle Point 4 of Allotment 1610

G.L.O. Resurvey notes of 1928

Iron post 3' long 1" diam. with brass cap marked

CAP IS 8" ABOVE GROUND AP 4

IRON RESET 9/20/95 RM TR 1610

CK - 3 LARGE ROCK AROUND S 3 52

IRON + CAP 1928

8' STEEL SIGN POST WEST 2.75'

5680-11 by Wittkeft & Emery - 1965

1965 TAG IS ON NORTH SIDE OF 7.5" W. OAK

2-23-95 CK

RAN COMPASS LINE AT N2W AND STRING LINE

MEASURE TO COR. - Fd. IRON + CAP WITH FLANGES

LEANING AGAINST HEAVY DUTY 8' STEEL SIGN

IRON POST WAS PULLED UP BY HUNTERS - TOLD TO ME

THIS DAY BY LOCAL RESIDENT GLENN PETERSON

Fd. ROCK MOUND DISTURBED AT COR. - SET 60<sup>th</sup>

SPIKE AT CORNER POSITION UNTIL GROUND HAS

THAWED OUT - TIES TO SPIKE

W. OAK 7.5" NSE 20.46' OLD KSLP N SIDE  
SPK + TAG

W. OAK 10.5" N42E 32.10 " "

R OAK 9" N21W 40.21ft To spk AND AP 53 BT

8' HEAVY DUTY SIGN POST 1.5' NORTH

CORNER IS 23' WEST OF WOODS TRAIL N+S

IN HARDWOODS AND ASPEN

DISTANCE AND BEARING OK - 642' - N2W

THERE MAY BE A ROCK UNDER MONUMENT

12/13/96 - GB, JS, CG EDM line to AP 3

a distance of 1347.5 GLO dist 1348.3

E.D.M line north to 5/16, 640.2

New L.T.S. west and maintenance L.T.S  
north.

Quarter Cor. Sec's. 2-3

G.L.O. Resurvey notes of 1928

Galvanized pipe 2" diam. with metal cap marked

↓  
4  
S3 | S2  
1928

Balsam 6" N44°15'E 144 IK5 - 95.04'

Maple 7" S83°W 88 IK5 - 58.08'

NOTES OF CASS COUNTY ROAD SURVEY - 1916

RECORD BOOK B - SURVEY RECORD # 288

PLAT ON PAGE 220 - NOTES ON PAGE 234

SET IRON MONUMENT AT TRUE 1/4 COR.

MKD NEW BT'S.

R. OAK 22 EAST 42.60'

MAPLE 10 S75W 32.20'

2-20-96 Re MAIN

Fd CASS CO IRON PIPE IN PLACE AND UP BIRCHES.

2" PIPE WITH THREADED ON CAP. CORNER

FALLS IN MIXED HARDWOODS. LINE TO STANDARD  
NORTH & SOUTH OF CORNER.

W OAK 9 1/2" N 82° W 54.97 FT TO SPK MKD 1/4 S 3 BT

W OAK 8 1/2" N 42° E 33.22 FT TO SPK MKD 1/4 S 2 BT

W OAK 7" S 4° W 54.90 FT TO SPK MKD 1/4 S 3 BT

HEAVY STEEL SIGN POST 3.2 FT SOUTH



Angle Point 1, of Allotment 1610, Sec. 3, and  
 Angle Point 4, of Allotment 1711  
 G.L.O. Resurvey notes of 1928  
 Iron post 3' long 1" diam. with brass cap marked

TR 1711	
AP 4	S2
AP 1	
TR 1610	
	1928

2-20-96 R MAIN

FD GLO IRON IN PLACE ON THE SOUTHEAST  
 CORNER OF A SMALL ALDER SLOUGH. CORNER  
 IS IN MIXED HARDWOODS. MKD NEW  
 BEARING TREES AS FOLLOWS

W OAK 11" N 6° E 72.15 FT TO SPK MKD° AP S2 BT

W OAK 5" S 27° W 73.95 FT TO SPK MKD° X BT

W OAK 5" S 62° W 90.28 FT TO SPK MKD° X BT

HEAVY STEEL SIGN POST 20.5 FT NORTH

B-17

47

North 1/16 Cor. Secs. 2-3

G.L.O. Resurvey notes of 1928

Iron post 3' long 1" diam. with brass cap marked

N 1/16

S 3/52

1928

Balsam 5" S54°30'E 184 IKS - 121.44'

Poplar 4" N81°30'W 31 IKS - 20.46'

5680 by Wittkoepf + Emery - 7/18/68  
Set approx corner!

2-15-96 R. MAIN 5° ± 28" SNOW

Fd GLO IN PLACE SOUTH EDGE OF COUNTY CLEARCUT.  
CORNER IN MIXED HARDWOODS. GLO BT EVIDENCE UNDER  
SNOW IF ANY IS LEFT. MKD NEW BTS.

MAPLE 7" S54° W 360 FT TO BK MKD N 1/16 S3 BT

R OAK 9 1/2" S36° E 807 FT TO BK MKD N 1/16 S2 BT

W OAK 7" N52° E 88.80 FT TO BK MKD N 1/16 S2 BT

Quarter Cor. Sec. 3. 310

G.L.O. Resurvey notes of 1928

Iron post 3' long 1" diam. with brass cap marked

$\frac{1}{4}$  53  
510  
1928

Maple 7" N13°30'E 621K5- 40.92'

Maple 8" S18°45'E 371K5- 24.42'

3-15-95

Fd. Monument IN  $\frac{1}{4}$  of old ROAD BED,  
BENT OVER. Monument FROZEN IN AT THIS  
TIME. Will RETURN TO DETERMINE IF MONUMENT  
IS IN PLACE. NO EVIDENCE OF BTs FROM 1928

9-20-95 RM-CK

Fd. CS'116-CHAINED DISTANCES FROM  
SEC. COR. WEST 2700.7' AND SOUTH FROM  
CS'116 - 1290' - PLACES CORNER IN SOUTH  
DITCH OF E+W WOODS ROAD - IRON WAS  
FOUND 10' WEST OF CHAINED DISTANCE.  
FROM SEC. COR. - IRON IS BENT WITH FLANGES  
IN PLACE - PROBABLY WAS BLADED OUT OF

POSITION WHEN ROAD WAS CONSTRUCTED  
AND ENDED UP IN FILL OF ROAD BED  
WE FOUND 13.5" MAPLE AT S19E-24.42'  
NO VISIBLE SCAR - HOLLOW IN SIDE AS  
THERE IS A SCAR ON WEST SIDE WE CAN  
SEE INTO - Fd. ROTTED MAPLE STUMP  
AT N14E-40.92' NEARLY LEVEL WITH GROUND  
BOTH TIE TO CHAINED POSITION  
WE WILL CUT INTO MAPLE ON THURS. 9/21/95

9-25-95 RM+CK

CUT INTO 13.5" MAPLE - CENTER ROTTED  
OUT - DON'T BELIEVE THIS MAPLE WAS  
MARKED BY GLO - DUG UP BENT IRON FROM  
ROAD BED - FLANGES WERE FOUND ATTACHED  
TO BASE OF IRON - BUT SHOW SIGNS OF BEING  
PULLED UP FROM IT'S ORIGINAL POSITION  
BROUGHT IRON IN FROM FIELD.

WE WILL PROBABLY HAVE TO TRAVERSE  
SOUTH LINE OF SEC. 3 LATER  
PLACED FSLP ON 7" ELM S26W-4.0'  
FROM APPROX. POSITION OF S $\frac{1}{4}$  SEC. 3

See Book # 6 page 18

E-14, 15

Angle Point 4 of Allotment 1414 Sec. 3

G.L.O. Resurvey notes of 1928

Iron post 3' long 1" diam. with brass cap marked

AP 4
TR 1414 S3
S 10
1928

5680-11 By Wittkeft & Emery - 1965

3-15-95 R. MAIN CKRAUSE

FD G.L.O. IRON PIPE IN ROCK MOUND UP  
10.7 FT. TWO STEEL SIGN POSTS WERE AT THE  
CORNER 30.3 FT NORTH 30.2 FT WEST

1/9/97 GB, JS

Mkd. NEW BT'S:

W. OAK 7" S53E 31.08 S10 BT

W. OAK 9" N64E 15.17 S3 BT

W. OAK 7" N8W 30.54 AP4S3 BT

MAINTENANCE L.T.S. done west + north

South 1/16 Cor. Sec's, 3-4

G. L. O. Resurvey notes of 1928

Iron post 3' long 1" diam. with brass cap marked

S 1/16

S 4 | S 3

1928

Basswood 14" N29°45'E 29 1/2 - 1914  
Now a Basswood Clump

Maple 12" N73°15'W 121 1/2 - 19.86'

Z-2296 R. MAIN

FD 640 IRON IN PLACE IN MIXED HARDWOODS

Old BLAZES RUN NORTH AND EAST OF CORNER

To much snow to find BT REMAINS. CHAINED SOUTH  
FROM 1/4 4+3

R. OAK 11" S 13° W 57.45 FT TO SPEK MKD 25 1/2 S 4 BT

W OAK 6 1/2" S 70° E 79.68 FT TO SPEK MKD 25 3 BT

ASH 8" S 88° E 62.40 FT TO SPEK MKD 25 1/2 S 3 BT

C-13

Quarter Cor. Secs. 3-4

G.L.O. Resurvey notes of 1928

Iron post 3' long 1" diam. with brass cap marked

10-4-95 RM + CK

Fd. IRON + CAP - IN PLACE

14" ABOVE GROUND

IN HARDWOOD STAND S 4 S 3

1928

Balsam 8" S33°45'E 951KS - 62.70'

NO TRACE AT S34E 62.7'

Balsam 10" S75°W 741KS - 48.84'

NOW WELL ROTTED <sup>LARGE</sup> BALSAM STA. AT S75W - 48.8'

5680-11 by Wittkeft & Emery - 1966

MARKED NEW BT'S.

W.OAK 8" N45°W 66.89 FT TO SPK MKD 1/4 54 BT

W.OAK 10 N88°E 68.65' FT TO SPK MKD 1/4 53 BT

W.OAK 6.5 S32W 75.90' MKD 1/4 54 BT

B, C-13

Angle Point 3 of Allotment 1693 Sec. 3

G.L.O. Resurvey notes of 1928

Iron post 3' long 1" diam. with brass cap marked

10.2-95 RM-CK

Fd. IRON CAP - IN PLACE

AP 3

4" ABOVE GROUND

TR

1389

TR 1693

AT NORTH EDGE OF ASH S 4 S 3

SWALE TO SOUTH

1928

568-11 by Wittkoft & Emery 1968

WITNESSED by

W. OAK 5 N62W 20.05' SPK + TAG

ASH 7 N53E 5.58' MKD APS3 BT

ASH 8 S 8 W 15.58' APS4 BT

8' STEEL SIGN POSTS SOUTH 3.35' + EAST 3.35'

CORNER IS 50' WEST OF WOODS TRAIL NW-SE

North 1/16 Cor. Secs. 3-4

G.L.O. Resurvey notes of 1928

Iron post 3' long 1" diam. with brass cap marked

10-2-95 RM+CK

FD. IRON+CAP-IN PLACE 1/16

7" ABOVE GROUND S 4 S 3

5" ASH NORTH OF IRON 1928

BLAZED+PAINTED NYS

Basswood 6" S 77° 15' E 58.1 KS - 38.28'

NOW ROTTED STUMP + SPROUTS S 77 E - 38.3'

Maple 10" S 24° W 28.1 KS - 18.48'

NOW WELL ROTTED STUMP S 24 W - 18.5'

MARKED NEW B.T'S.

W. OAK 7 NZW 16.25' MKD N 1/16 S 4 BT

W. OAK 9 S 85 W 50.40 MKD N 1/16 S 4 BT

ROCK 3' X 4' X 12" HIGH - S 70 E - 60.87' " X ON TOP

8' STEEL SIGN POST EAST 2.65'

WOOD TRAIL NYS IS 75' W OF COR.



D-15

Center South 1/16 Cor. Sec. 3

G.L.O. Resurvey notes of 1928

Iron post 3' long 1" diam. with brass cap marked

9-20-95 RM+CK

Ed. IRON + CAP - IN PLACE C

10" ABOVE GROUND S 1/16 | S 3

IN HARD WOODS C

1928

Maple 12" S 69° 15' E 65 IKS - 42.90'  
Ed NEAR DEAD MAPLE SNAG 14" <sup>ROTTED + HOLLOW CENTER</sup> S 69° E - 42.90'

Maple 14" N 85° 30' W 23 IKS - 15.18'

NO TRACE AT N 85° W - 15.18'

5680-11 by Wittneft + Emery - 1965

MARKED NEW BT's.

R. OAK 7 N 63° W 32.73' MKD. S 3 BT

R. OAK 8 S 35° E 34.35' MKD. CS 1/16 S 3 BT

R. OAK 9 N 75° E 45.70' MKD. CS 1/16 S 3 BT

8' HD SIGN POST WEST 3.25'

Angle Point 1 of Allotment 1415 and  
 Angle Point 4 of Allotment 1418  
 G.L.O. Resurvey notes of 1928  
 Iron post 3' long 1" diam. with brass cap marked

AP 4	
TR 1418	TR
AP 1	1611
TR 1415	
	1928

2-22-96 R. MAIN

FD GLO IRON IN PLACE. CORNER FALLS IN  
 MIXED HARDWOODS. LINE TO STANDARD NORTH AND  
 WEST OF CORNER.

WOAK 10" N86°W 62.33 FT TO SPK MKD AP 53 BT

WOAK 6½" N36°W 21.80 FT TO SPK MKD AP 53 BT

WOAK 9" N12°W 13.88 FT TO SPK MKD AP 53 BT

HEAVY 8 FT STEEL SIGN POST 3.5 FT NORTH 3.8 FT WEST

Center Quarter Cor. Sec. 3

G. L. O. Resurvey notes of 1928

Iron post 3' long 1" diam with brass cap marked

C  $\frac{1}{4}$

S 3

1928

Maple 12" N53°45'E 110 IKS- 72.60'

No EVIDENCE Fd. MAPLE TRUNK @ BRG<sup>E</sup> WEST HOWEVER

Balsam 9" N86°15'W 105 IKS- 69.30'

No EVIDENCE Fd.

11-2-95 R MAIN C. KRAUSE

Fd MONUMENT IN PLACE UP 5" IN MIXED HARDWOODS.

LINETO STANDARD RUNS NORTH & SOUTH OF CORNER.

W OAK 6  $\frac{1}{2}$ " N25° E 59.50 FT TO SP. MKD. C  $\frac{1}{4}$  S3BT

W OAK 11" S35° E 105.70 FT TO SP. MKD. C  $\frac{1}{4}$  S3BT

W OAK 9  $\frac{1}{2}$ " N 1° E 114.40 FT TO SP. MKD. C  $\frac{1}{4}$  S3BT

8 FT HEAVY STEEL SIGN POST 3.05 FT SOUTH

Angle Point 2 of Allotment 1611, Sec. 3

G.L.O. Resurvey notes of 1928

Iron post 3' long 1" diam. with brass cap marked

S 3  
AP 2  
TR 1611  
1928

11-2-95 R MAIN, CRAUSE

Fd GLO MONUMENT IN PLACE 40 9" CORNER FALLS

IN MIXED HARDWOODS WITH LINE TO STANDARD

RUNNING SOUTH

WOAK 8" N25°W 420.92 FT TO SPK MED APS3 BT

WOAK 9" S22°W 115.77 FT TO SPK MED APS3 BT

WOAK 8" S79°W 69.25 FT TO SPK MED APS3 BT

8 FT HEAVY STEEL SIGN POST 20' S SOUTH

Center North 1/16 Cor. Sec. 3

G. L. O. Resurvey notes of 1928

Iron post 3' long 1" diam. with brass cap marked

9-25-95 RM + CK

Ed. IRON + CAP - IN PLACE C

12" ABOVE GROUND N 1/16 S 3

IN HARDWOODS + ASPEN C

1928

Elm 6" N34°30'E 178 / K5 - 117.48'

NOW ELM SNAG - NO GROWTH N34E - 117.50' SCAR OPEN

No other trees available

MARKED NEW BT's.

W. OAK 7 N28E 61.75 MKD. CN 1/16 S3 BT

W. OAK 8 N80E 79.33' " " " "

ROCK 3' X 2' X 1' H S35W 54.55' X ON TOP

8' H.D. STEEL SIGN POST WEST 8.5'

Center East 1/16 Cor. Sec. 3

G.L.O. Resurvey notes of 1928

Iron post 3' long 1" diam. with brass cap marked

E 1/16

S 3

1928

Maple 10" S50°15'W 56.1K5 - 36.96'

Balsam 6" N68°W 25.1K5 - 16.50'

Center West 1/16 Cor. Sec. 3

G.L.O. Resurvey notes of 1928

Iron post 3' long 1" diam. with brass cap marked

W 1/16 C  
S 3  
1928

Balm of  
Gilead 5" N86° 15' E 65 1/2 KS - 42.90'  
NO EVIDENCE Fd

Balm of  
Gilead 6" S57° 15' W 82 1/2 KS - 54.12'

10/31/95 REMAIN C. KRAUSE

Fd GLO MONUMENT IN PLACE AND UP 7" CORNER

FALLS IN MATURE ASPEN AND MIXED HARDWOODS.

CHAINED EAST FROM 1/3 1/4 TO FIND THIS CORNER.

GLO BALM (TWIN) 1/4" S56° W 54.88 FT TO SK SCAR VISIBLE

W OAK 10" N60° E 74.05 FT TO SK MKD CW 1/6 S 3 BT

ASH 7" N40° E 34.45 FT TO SK MKD CW 1/6 S 3 BT

ASH 9" S 2° E 93.44 FT TO SK MKD CW 1/6 S 3 BT

D, E-16

Angle Point 3 of Allotment 1610, Sec. 3

G.L.O. Resurvey notes of 1928

Iron post 3' long 1" diam. with brass cap marked

AP 3

TR 1610

S 3

1928

5680-11 by Wittkoff & Gray - 1965

Z-395

Fd IRON  $\frac{1}{2}$ " CAP

12/13/96 G.B., J.S., C.G. EDM. line from  
angle point 4, 1347.5' GLO dist. 1348.3'  
new line to standard east & south.

Fd. BT'S MKD. by CK, RM 3/14/95

Fd. 14" R. OAK BT. N80W 19.30 AP3 BT

Fd 28" W. Pine BT S7W 91.97 AP3 BT

MKD New BT 6" MAPLE S76W 13.8 AP3 53 BT

set 8' steel sign posts east 3.1 and  
south 3.1 with both signs.



South East 1/16 Cor. Sec. 3

G.L.O. Resurvey notes of 1928

Iron post 3' long 1" diam. with brass cap marked

SE 1/16

S 3

1928

Maple 7" S64°15'E 57 1/2 - 37.62'

Basswood 14" N58°15'W 31 1/2 - 20.46'

Angle Point 2 of Allotment 1610, Angle Point 1 of  
Allotment 1611, and Angle Point 3 of Allotment 1711

G.L.O. Resurvey notes of 1928

Iron post 3" long 1" diam. with brass cap marked

	TR 1711	
S	3	AP 3
AP 1	AP 2	
TR 1611	TR 1610	
	1928	

9-28-95 CK

Ed. IRON & CAP - IN PLACE - 10" ABOVE GROUND  
IN HARDWOODS - ASH SWALE TO NE

MARKED NEW BT'S.

W. OAK	7	N73E	13.67'	MKD	AP 3	BT
ASH	9	S88W	16.94'	"	"	"
R. OAK	11	N32W	46.91'	"	"	"

North East 1/16 Cor. Sec. 3

G.L.O. Resurvey notes of 1928

Iron post 3' long 1" diam. with brass cap marked

7-23-95 OK

Fd. IRON CAP - IN PLACE

NE 1/16

9" ABOVE GROUND

S 3

IN HARDWOODS STAND

1928

ROCK MOUND AT SURFACE

Maple 12" N6°45'E 72 1/2 - 47.52'

Balsam 10" S13°30'W 150 1/2 - 99.00'

MARKED NEW BTs.

W. OAK 8 S13E 50.13' MKD NE 1/16 S3 BT

W. OAK 6 S69W 61.60' " " " "

W. OAK 7 N18W 62.11' " " " "

STRING MACHINE SOUTH OF E 1/16 - 1260'

DISTANCE FIT WITHIN 1.0'

D-14

67. South West 1/16 Cor. Sec. 3

G.L.O. Resurvey notes of 1928

Iron post 3' long 1" diam. with brass cap marked

SW 1/16

S 3

1928

Elm 6" S16°15'E 35.1K5 - 23.10'

Now 9" STANDING DEAD @ BRG & DIST SCARCE OVERGROWN

Maple 10" N26°15'W 34.1K5 - 22.44'

Now 16" AT BRG & DIST SCARCE VISIBLE

5680-11 by Wittkoft & Emery - 1966

Z-29-96 R MAIN

Fd GLO IRON IN PLACE @ MONUMENT

FALLS IN MIXED HARDWOODS

WOAK 8" N37°E 40.45 FT TO SPK MKD @ S 3 BT

WOAK 6" S71°W 43.81 FT TO SPK MKD @ S 3 BT

D, C-14

Angle Point 3 of Allotment 1418 and Angle

Point 2 of Allotment 1415

G.L.O. Resurvey notes of 1928

Iron post 3' long 1" diam. with brass cap marked

	AP 3
53	TR 1418
	AP 2
	TR 1415
	1928

5680-11 by Wittcraft & Emery - 1966

10-31-95

FD GLO MONUMENT IN PLACE AND 9" ABOVE GROUND.

CORNER FALLS IN MIXED HARDWOODS. LINE TO STANCHION

RUNS EAST OF CORNER.

W. OAK 7" N52°W 19.45 FT TO SPR MKD AP 53 BT

W. OAK 9" N84°E 56.47 FT TO SPR MKD AP 53 BT

W. OAK 9" N17°E 32.25 FT TO SPR MKD AP 53 BT

HEAVY 8 FT STEEL SIGN POST 2.85 FT EAST

D-14, 15

Angle Point 1 of Allotment 1414

G.L.O. Resurvey notes of 1928

Iron post 3' long 1" diam. with brass cap marked

TR 1415

API 53

TR 1414

1928

5620-11 by Wittbrecht & Co. - 1965

Z-29-96 REMAINS

FD GLO MONUMENT IN PLACE IN MIXED HARDWOODS

LINE TO STANDARD EAST AND SOUTH OF CORNER

FD TAG BY LWERE FROM 12-11-65 ON 9" MAPLE FROM WHICH

CORNER BEARS S33°E 52.15

WOAK 8" WEST 34.63

WOAK 8" N72°W 38.26

WOAK 9" N6°W 77.18

HEAVY STEEL SIGN POSTS 3.9 FT EAST & SOUTH

B, C-14

Angle Point 4 of Allotment 1693

G. L. O. Resurvey notes of 1928

Iron post 3' long 1" diam. with brass cap marked

S	3
AP 4	
TR 1693	TR
	1418
	1928

5680-11 by Wittkeft + Emery 1966

9-27-95

Fd. IRON & CAP - IN PLACE - 12" ABOVE GROUND

IN HARDWOODS - SMALL ASH SWALE TO NW

PLACED LARGE ROCK AT NORTH SIDE OF IRON

MAPLE 6" S73°E 48.3 FT TO SPK MKD @ S3 BT

ROCK 2 1/2 x 3 1/2 x 12" Hg<sup>60°</sup> 29.45' MND °X ON TOP

MAPLE 5" N33°E 16.36 FT TO SPK MKD APS3 BT

68

CHAINED SOUTH FROM NW 1/16 - 648 - FIT WITHIN  
.50'

North West 1/16 Cor. Sec. 3

G.L.O. Resurvey notes of 1928

Iron post 3' long 1" diam. with brass cap marked

9-26-95 CK-RM

Fd. IRON + CAP - IN PLACE NW 1/16

12" ABOVE GROUND S 3

IN HARDWOODS + ASH 1928

Elm 10" S34°30'E 35'1K5 - 23.10

NOW ELM STUB 14" X 15' HIGH S34E - 23.10' SCAR

Elm 14" N57°W 42'1K5 - 27.72'

NOW LARGE ELM WINDFALL N57W - 27.72' - HOLLOW

MARKED NEW BT's.

W. OAK 7 N39W 32.55' MKD NW 1/16 S3 BT

W. OAK 6 S20E 14.10' " " "

ASH 9 S84W 45.50' " " "

8' HEAVY DUTY SIGN POST EAST 4.40'



Angle Point 3 of Allotment 1702

G.L.O. Resurvey notes of 1928

Iron post 3' long 1" diam. with brass cap marked

~~AP 3~~  
~~TR 1702~~  
 S 3  
~~TR 1418~~

AP 3  
S 3 TR 1702  
 TR 1418  
 1928

9-26-95 CK

Ed. IRON & CAP - IN PLACE - 12" ABOVE GROUND

IN HARDWOODS & ASH

WITNESSED BY

W. OAK 8 N73W 20.95 MKD APS3 BT

W. OAK 9 S56E 45.55' " " "

ASH 10 N45E 35.35' " " "

8' HD SIGN POST EAST 3.7'

PAINTED BLAZES ALONG LINE BETWEEN NW 1/16

AND THIS AP

X-9

263304

Quarter Cor. Sec's. 32-33

G.L.O. Resurvey notes of 1928

Iron post 3 long 1" diam. with brass cap marked

4
S 32   S 33
1928

R. OAK 6" S13°45'W 339/ks- 223.74'

Fd  
OREG PINE STD 18" N40°W 341ks 220.44

1874 July ORIG GOVT SURVEY ^ CONGER

W PINE 14" N40°W 341ks 220.44ft

W PINE 5" S67E 19ks

3/28/94

Fd 1928 IRON IN PLACE IN ROCK PILE AND IN  
LINE WITH WOODS LINE EAST WEST AND  $\pm 15$  FT  
WEST OF NORTH SOUTH WOODS EDGE. CORNER FALLS  
ON SOUTH WEST CORNER OF POND  $\pm 80$  FT FROM WATERS  
EDGE ON A EAST FACING SLOPE. OAK WOODS AND  
THICK BRUSH. WITNESSED WITH:

71

W OAK 8" N68°W 29.13ft To Spk MKD 2/4 S32 BT

W OAK 7" S51°W 18.84ft To Spk MKD 1/4 S32 BT

W OAK 8" S12E 53.23ft To Spk MKD 1/4 S33 BT

8ft STEEL SIGN POST 4.45 NORTH 5.2ft SOUTH

North 1/16 Cor. Secs. 32-33

G.L.O. Resurvey notes of 1928

Iron post 3' long 1" diam. with brass cap marked

8/31/93 CK

Ed. IRON &amp; CAP - IN PLACE N 1/16 IN GOOD CONDITION

6" ABOVE GROUND S 32 S 33 PLACED 3 ROCKS

IN ASPEN &amp; SCATTERED R. OAK 1928 AROUND MONUMENT

ON HILL SIDE - IN THICK BRUSH &amp; WINDFALLS

R. OAK 6" N 50° E 55' 1/2 - 36.30'

NOW 17.5" R. OAK N 50° E - 36.3' <sup>RESURVED BT</sup> SCAR FACING IRON

R. OAK 5" N 52° 45' W 55' 1/2 - 36.30'

NOW 16.5" R. OAK N 53° W - 36.3' SLOPE DISTANCE

HAS SCAR FACING IRON - DISTANCE TO BASE OF IRON

RESURVED WITH BT

8/31/93

MARKED NEW BTs.

W. OAK 5.5" S 88° E 54.30' MKD. BT

R. OAK 16.5" S 32° E 38.90' MKD N 1/16 S 33 BT

MAPLE 5.5" N 6° E 9.40' MKD BT

8' STEEL SIGN POSTS NORTH 3.15' &amp; SOUTH 4.0'

CORNER IS 88' NORTH OF FR # 3101

PLACED FSLP ON 6" MAPLE - ON NORTH SIDE OF ROAD

63' NORTH TO CORNER

BLAZED 13" R. OAK STUB ON NORTH SIDE OF ROAD

74' SOUTH OF CORNER

Sec. Cor. Secs. 28-29-32-33

G.L.O. Resurvey notes of 1928

Iron post 3' long 2" diam. with brass cap marked

4/19/93 CK

W. IRON+CAP IN PLACE T142 N R 28 W

30' SOUTH OF WOOD TENDL S 29 S 28

RUNNING WESTERLY S 32 S 33

NEEDS WORK CAN DRIVE INTO COR 1928

4" ABOVE GROUND - N. PINE PLANTATION TO WEST OF COR.

R. Oak 10" N75°E 32 IKS - 21.12'

NOW STUMP HOLE AT N75E - 21.1'

Poplar 4" S27°30'E 24 IKS - 15.84'

NO TRACE

W. Oak 3" S57°W 32 IKS - 21.12'

NOW OAK 6" WINDFALL AT S57W 21.1'

R. Oak 7" N57°30'W 37 IKS - 24.42' NO TRACE

9-15-93 RM-CK

MARKED NEW BTs.

W. OAK 13" N37E 53.72' MKD. S28 BT

W. OAK 10.5" EAST 84.63' MKD BT

N. PINE 8" S69W 77.75' MKD S33 BT

N. PINE 6" N10W 46.10' MKD S29 BT

8' STEEL SIGN POSTS NORTH 3.7' - SOUTH 3.55'

SMALL POTHOLE NOW BEING FILLED BY BEAVER

ACTIVITY IN AREA - APPROX. 200' SOUTH OF COR.

2-3-2010 R. MAIN J. SE MOONOVER

GPS IRON LENETO STANDARD NORTH AND SOUTH

V-12,13

Angle Point 3 of Allotment 1332

G.L.O. Resurvey notes of 1928

Iron post 3' long 1" diam. with brass cap marked

PLACED 5 ROCKS	S 28
AROUND MONUMENT	S 33 AP 3
75' SOUTH OF ETW	TR 1332
WOODS TRAIL	1928

Pine 9" S 12° E 115 KS - 75.90'

NO EVIDENCE AT SIZE - 75.90'

Pine 10" N 62° W 195 KS 128.70'

Fd. 19" N. PINE AT N 62° W - 128.70' SCAR FACING COR.

9/22/93 C. KRAUSE R. MAEN

Fd GLO MONUMENT IN GOOD CONDITION UP 6".

R PINE 21" S 53° W 45.75 FT TO SPK MKD APS 33 BT

W OAK 10" N 59° E 11.14 FT TO SPK MKD APS 28 BT

W OAK 8" N 3° W 42.55 FT TO SPK MKD APS 28 BT

8' STEEL SIGN POSTS SOUTH 2.45 & WEST 3.95'

V-12

East 1/16 Cor. Sec's. 28-33

G.L.O. Resurvey notes of 1928

Iron post 3' long 1" diam. with brass cap marked

9-23-93 RM+CK

Ed. IRON+CAP

E 1/16 S 28

IN PLACE 5" ABOVE

S 33

GROUND - 106' SOUTH OF 1928

E+W WOODS TRAIL - CORNER IN HARDWOOD & ASPEN  
THICK BRUSH

Oak 5" N21°15'E 98 IKS - 64.68'

NOW 1 1/2" W. OAK AT N21E - 64.68' TAGGED + PAINTED  
SCRIBE AREA OVERGROWN

Poplar 3" S68°15'E 106 IKS - 69.96'

NO TRACE AT S68E - 69.96'

## MARKED NEW BT'S.

W. OAK 8 N46E 48.37' MKD E 1/16 S28 BT

W. OAK 8 S65E 38.03' E 1/16 S33 BT

W. OAK 11 N33W 43.54' E 1/16 S28 BT

8' STEEL SIGN POSTS NORTH 3.9' &amp; EAST 3.55'

75

Meander Cor. Secs. 28-33

G.L.O. Resurvey notes of 1928

Iron post 3' long 1" diam. with brass cap marked

~~T142N R28W~~

~~S 28~~

~~S 33~~

~~1928~~

T142N R28W

MC / S 28

S 33

1928

Poplar 6" N31°15'E 171K5- 11.22'

No trees available in Sec 33

9/23/93 R. MAIN C. KRAUSE

STRING CHAINED WEST FROM EAST 1/4 SECTION  
28 & 33 GLO DISTANCE. FOUND NO EVIDENCE  
OF IRON PIPE OR BEARING TREE. AREA APPEARS  
TO HAVE BEEN DISTURBED BY LOGGING CAMP  
ACTIVITY REFERRED TO IN GLO NOTES

Meander Cor. Sec's. 28-33

G.L.O. Resurvey notes of 1928

Iron post 3' long 1" diam. with brass cap marked

T 142 N R 28 W

S 28

S 33

MC

1928

Poplar 8" N21°30'W 24.1K5 - 15.84'

No trees available in Sec. 33



Center South 1/16 Cor. Sec. 33

G.L.O. Resurvey notes of 1928

Iron post 3' long 1" diam. with brass cap marked

C  
S 1/16 | 5.33  
C  
1928

No BT's available

Center Quarter Cor. Sec. 33

G. L. O. Resurvey notes of 1928

Iron post 3 long 1" diam. with brass cap marked

C 4

S 33

1928

No BT's available