

CORNER RESTORATION #7 T141N R29W

CORNER RESTORATION

T141N R29W

K&S

FIELD BOOK

820012

BOOK 7

USFS T141NR29W

T. -----
Rb. -----

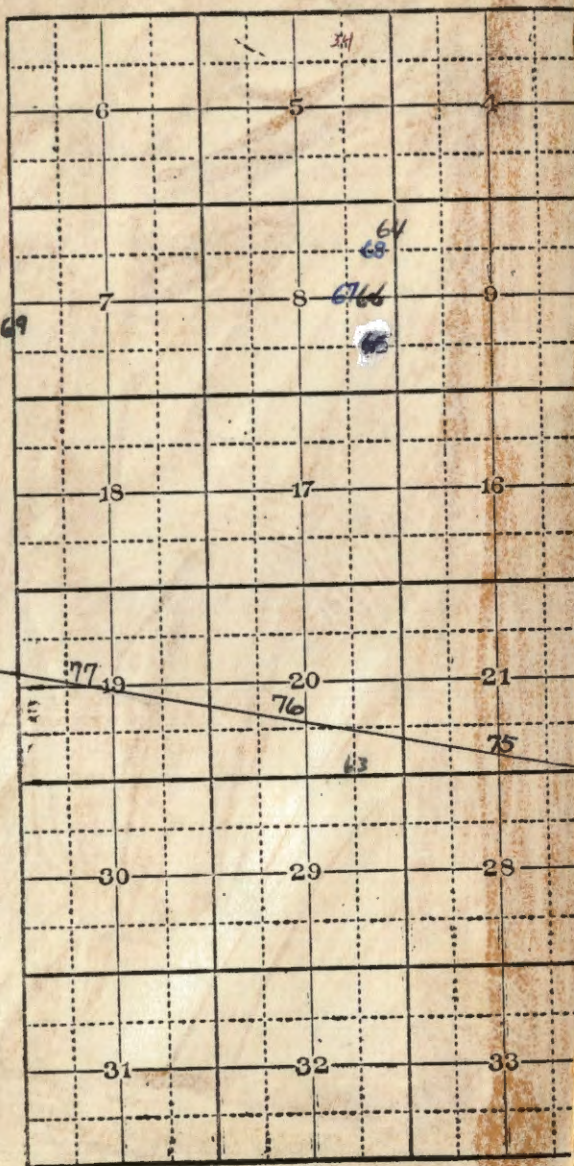

BOOK #7 of 8 CASS COUNTY

Mer.

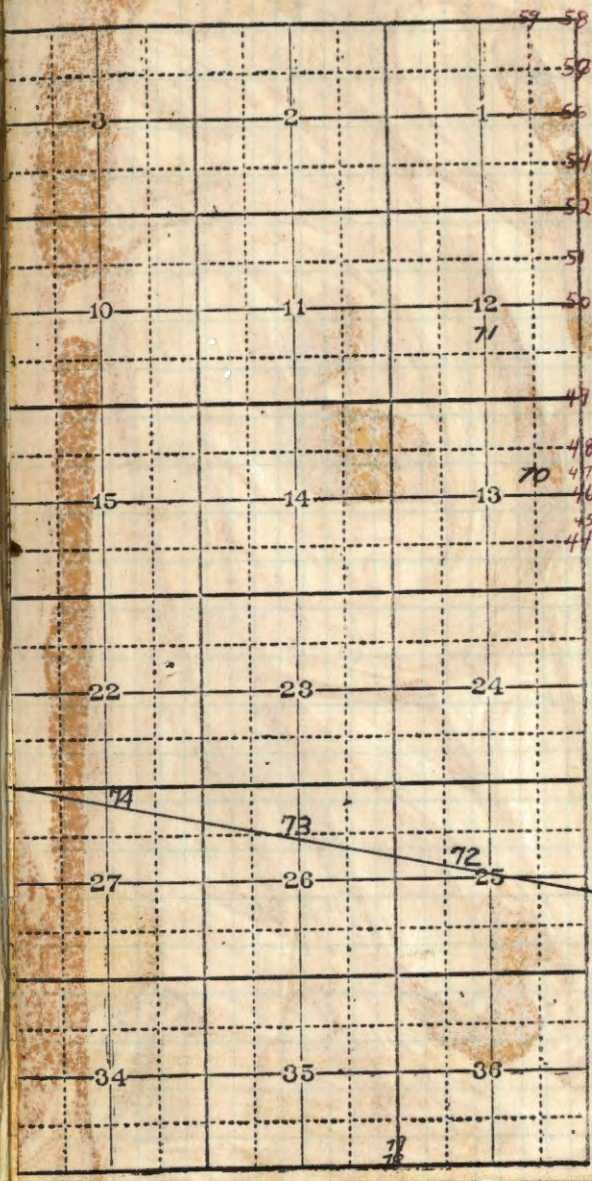

See pages 1 thru 5 for Anglos points in Sec. 23
 " " " " " " " " " " " "
 " " " " " " " " " " " "
 " " " " " " " " " " " "
 " " " " " " " " " " " "
 " " " " " " " " " " " "

Free Merit.

Angle Point ~~3~~ Sec. 23

G.L.O. Resurvey notes of 1918

Iron post 3' long 1" diam. with brass cap
marked

S 23	AP 3
T 141 N	R 29 W
1918	

Birch 14" bears West 24 KS - 15.84'

Birch 14" S 80° 15' E .63 KS - 41.58'

Angle Point 2 Sec. 23

G.L.O. Resurvey notes of 1918

Iron post 3' long 1" diam. with brass cap marked

AP 2
S 23
T 141N R 29W
1918

Birch 6" 50°15'E 135 1K5 - 89.10'

Angle Point 1 Sec. 23

G.L.O. Resurvey notes of 1918

Iron post 3' long 1" diam. with brass cap marked

API

S 23

T 141 N R 29 W

1918

Poplar	6"	N 23° 45' E	84	1KS - 55.44'
--------	----	-------------	----	--------------

R. Oak	10"	S 23° 30' W	318	1KS - 209.88'
--------	-----	-------------	-----	---------------

Angle Point 6 Sec. 14

G.L.O. Resurvey notes of 1918

Iron post 3' long 1" diam. with brass cap marked

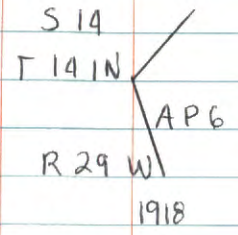

W. Oak 10" N8°15'E 110 KS - 72.60'

W. Oak 8" S72°E 87 KS - 57.42'

Angle Point 5 of Sec. 14

G.L.O. Resurvey notes of 1918

Iron post 3' long 1" diam. with brass cap marked

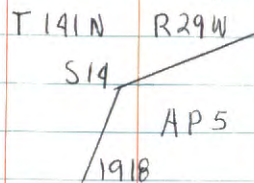

W. Dak 10" S18°15'W 95 1KS - 62.70'

Ash 10" N70°W 172 1KS - 113.52'

Angle Point 4 Sec. 14

G.L.O. Resurvey notes of 1918

Iron post 3 long 1" diam. with brass cap marked

T 141 N R 29 W

S 14

AP 4

1918

R. Oak 10" N10°30'E 139 1/2 KS - 91.74'

Poplar 8" S46°45'E 63 1/2 KS - 41.58'

Angle Point 3 Sec. 14

G.L.O. Resurvey notes of 1918

Iron post 3' long 1" diam. with brass cap marked

T 141 N R 29 W

~~S 14~~

AP 3

1918

W. Oak 16" N 45° E 132 1/2 - 87.12'

R. Oak 10" N 84° W 146 1/2 - 96.36'

Angle Point 2 Sec. 14

G. L. O. Resurvey notes of 1918

Iron post 3' long 1" diam. with brass cap marked

T 141 N R 29 W

~~S 14~~

AP 2

1918

Poplar 10" N 81° W 49 1/3 - 32.34'

W. Pine 16" N 77° 45' E 235 1/3 - 155.10'

Angle Point 1 Sec. 14

G.L.O. Resurvey notes of 1918

Iron post 3' long 1" diam. with brass cap marked

T 141 N R 29 W

~~S 14~~

API

1918

W. Pine 20" S 40° 30' E 195 1/2 - 128.70'

W. Dak 8" N 77° 45' E 242 1/2 - 159.72'

Angle Point 1 Sec. 3

G. L. O. Resurvey notes of 1918

Iron post 3' long 1" diam. with brass cap marked

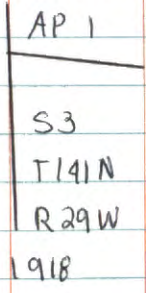

W. Oak 10" N43°30'E 35 1ks - 23.10'

W. Oak 14" S43°30'E 10 1ks - 6.60'

Angle Point 2 Sec. 3

G.L.O. Resurvey notes of 1918

Iron post 3' long 1" diam. with brass cap marked

AP2

T141N

R29W

S 3

1918

Ironwood 6" N10°15'W 28 1/2 - 18.48'

R. Oak 18" S26°45'W 83 1/2 - 54.78'

Angle Point B Sec. 17

G.L.O. Resurvey notes of 1918

Iron post 3' long 1" diam. with brass cap marked

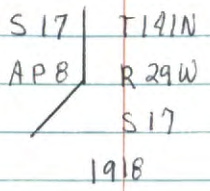

Maple 13" S 71° 45' E 63 1/2 KS - 41.58'

Maple 10" N 49° W 63 1/2 KS - 41.58'

Angle Point / Sec. 18

G.L.O. Resurvey notes of 1918

Iron post 3' long 1" diam. with brass cap
marked

API / S 18
S 18 / T 14 N
R 29 W
1918

Cedar 8" S 30° W 6 1/2 - 3.96'

Tamarack 14" N 83° W 29 1/2 - 19.14'

Angle Point 2 Sec. 18

G. L. O. Resurvey notes of 1918

Iron post 3' long 1" diam. with brass cap marked

S 18 T 14 N
R 29 W
AP 2
S 18
1918

Cedar 7" N35°E 19 KS - 12.54'

Cedar 16" S47°30'E 32 KS - 21.12'

Angle Point 3 Sec. 18

G.L.O. Resurvey notes of 1918

Iron post 3' long 1" diam. with brass cap marked

S18		T141N
AP3		R29W
		S18
		1918

Balsam 8" S74°E 27 1/2 - 17.82'

Ash 4" S44°E 31 1/2 - 20.46'

Angle Point 4 Sec. 18

G. L. O. Resurvey notes of 1918

Iron post 3' long 1" diam. with brass cap
marked.

S 18	T 14 N
AP 4	R 29 W
/ S 18	
1918	

W. Oak 14" S 80° W 106 1 KS - 69.96'

W. Oak 16" N 43° 30' W 73 1 KS - 48.18'

Angle Point 5 Sec. 18

G.L.O. Resurvey notes of 1918

Iron post 3' long 1" diam. with brass cap marked

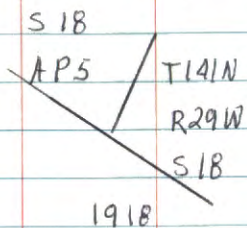

W. Oak 14" N87°30'E 36 IKS - 23.76'

W. Pine 8" N22°30'W 35 IKS - 23.10'

Angle Point 7 Sec. 18

G. L. O. Resurvey notes of 1918

Iron post 3' long 1" diam. with brass cap marked

S 18

AP 7

S 18

T 141 N

R 29 W

1918

R. Oak 6" N52°W 62 KS - 40.92'

Poplar 4" S68°30'W 46 KS - 30.34'

Angle Point B Sec 18

G. L. O. Resurvey notes of 1918

Iron post 3' long 1" diam. with brass cap marked

S 18

AP 8

T141N R29W

S 18

1918

Poplar 5" N55°W 19 1K5- 12.54'

Birch 5" N20°E 27 1K5- 12.82'

Angle Point 9 Sec. 18

G. L. O. Resurvey notes of 1918

Iron post 3' long 1" diam. with brass cap marked

S 18

AP 9

T 141N R 29W

S 18

1918

Poplar 8" N36°E 72 1/2 - 47.52'

R. Oak 5" N63°30'W 22 1/2 - 14.52'

Angle Point 10 Sec. 18

G.L.O. Resurvey notes of 1918

Iron post 3' long 1" diam. with brass cap marked

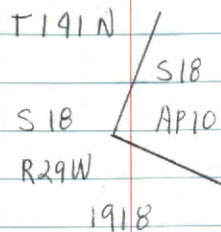

Poplar 6" N71°E 26 1/2 - 17.16'

Poplar 8" N84°E 43 1/2 - 28.38'

Angle Point 11 Sec. 18

G.L.O. Resurvey notes of 1918

Iron post 3' long 1" diam. with brass cap marked

T141N R29W

S18 / AP 11

| S18

1918

Tamarack 7" S57°E 57 KS - 37.62'

Tamarack 6" S52°30'E 45 KS - 29.70'

Angle Point 12 Sec. 18

G.L.O. Resurvey notes of 1918

Iron post 3' long 1" diam. with brass cap marked

T 191 N
 R 29 W
 S 18 AP 12
 S 18
 1918

Tamarack 4" N36°E 39 1/8 - 25.74'

W. Pine 6" S2°15'W 72 1/8 - 47.52'

Angle Point 13 Sec. 18

G. L. O. Resurvey notes of 1918

Iron post 3' long 1" diam. with brass cap marked

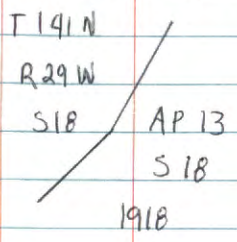

Poplar 6" S6°30'W 48 IKS - 31.68'

N. Pine 8" S5°45'E 96 IKS - 63.36'

Angle Point 14 Sec. 18

G. L. O. Resurvey notes of 1918

Iron post 3' long 1" diam. with brass cap
marked

T 141 N
R 29 W
AP 14
S 18 S 18
1918

N. Pine 6" N56°E 115 1K5 - 75.90'

Poplar 7" N87°45'E 89 1K5 - 58.74'

Angle Point 15 Sec. 18

G. L. O. Resurvey notes of 1918

Iron post 3' long 1" diam. with brass cap marked

T 141 N R 29 W

S 18 1 E

AP 15

S 18

1918

Cedar 9" S35°W 11 KS- 7.26'

Cedar 12" S26°E 12 KS- 7.92'

Angle Point 16 Sec. 18

G.L.O. Resurvey notes of 1918

Iron post 3' long 1" diam. with brass cap marked

T 141 N R 29 W

S 18

AP 16

S 18

1918

Tamarack 10" S29°W 38 1KS - 25.06'

Ash 7" N6°W 30 1KS - 19.80'

Angle Point 1 Sec. ~~#~~⁸

G.L.O. Resurvey notes of 1918

Iron post 3' long 1" diam. with brass cap marked

T 14 N R 29 W

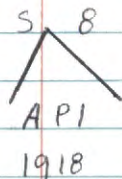

W. Dak 20" S49°45'W 60 IKS - 39.60'

W. Dak 7" N20°W 36 IKS - 23.76'

Angle Point 2 Sec. 8

G. L. O. Resurvey notes of 1918

Iron post 3' long 1" diam. with brass cap marked

T 141N R 29W

S 8

AP 2

1918

W. Oak 12" N 62° 15' W 43 KS - 28.38'

W. Oak 10" S 22° W 74 KS - 48.84'

Angle Point 3 Sec. 8

G. L. O. R. resurvey notes of 1918

Iron post 3' long 1" diam. with brass cap marked

T 141N R 29W

SB



AP 3

1918

Cedar 16" S 44° E 52 1/2 S - 34.32'

Ash 8" S 56° W 41 1/2 S - 27.06'

Angle Point 4 Sec. 8

G.L.O. Resurvey notes of 1918

Iron post 3' long 1" diam. with brass cap marked

T141N R29W

S 8

AP 3

1918

Maple 12" S62°30'E 79 IKS - 52.14'

Balsam 22" N76°W 47 IKS - 31.02'

Angle Point 5 Sec. 8

G. L. O. Resurvey notes of 1918

Iron post 3' long 1" diam. with brass cap marked

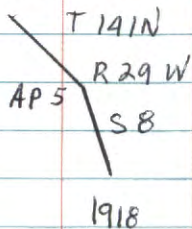

W. Dak 16" S87°E 76 1/2 - 50.16'

W. Dak 20" S49°W 33 1/2 - 21.78'

Angle Point 6 Sec. 8

G. L. O. Resurvey notes of 1918

Iron post 3' long 1" diam. with brass cap marked

T141N
R29W
AP 6 S8
1918

Cedar 18" N47°15'E 62 KS - 40.92'

Cedar 10" S82°30'E 23 KS - 15.18'

A.M.C. Sec. 5

G.L.O. Resurvey notes of 1918

Iron post 3' long 1" diam. with brass cap marked

T 141N R 29W

55

AMC

1918

Elm 20" N27°45'E 244 lks - 161.04'

Willow 6" N48°15'W 115 lks - 75.90'

Angle Point 2 Section 10

G. L. O. Resurvey notes of 1921

Iron post 3' long 1" diam. with brass cap marked

T 141 N

R 29 W AP 2

S 10

1921

Angle Point 3, Section 10

G.L.O. Resurvey notes of 1921

Iron post 3' long 1" diam. with brass cap marked

T 141 N

R 29 W | AP 3

S 10

1921

W. Oak 18" S 50 $\frac{1}{4}$ ° E 80 1/2 - 52.80'

Maple 8" N 71° E 76 1/2 - 50.16'

Angle Point 4 Section 10

G.L.O. Resurvey notes of 1921

Iron post 3' long 1" diam. with brass cap marked

AP4

T141N R29W

S10

1921

R. Oak 15" N28°E 76 1/2 - 50.16'

W. Oak 6" S22 1/4°W 62 1/2 - 40.92'

W. C. to Angle Point 5 Section 10

G. L. O. Resurvey notes of 1921

Iron post 3' long 1" diam. with brass cap marked

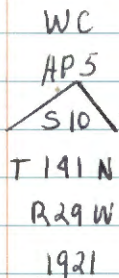

W. Oak 20" N24½°W 146 lks - 96.36'

W. Oak 18" S85°W 184 lks - 121.44'

W.C. to Angle Point 9 Section 10

G.L.O. Resurvey notes of 1921

Iron post 3' long 1" diam. with brass cap marked

W C

AP 9

T141N R29W

S 10

1921

Birch 6" S57 $\frac{1}{4}$ °E 65 1/2 - 42.90'

Poplar 10" S15 $\frac{3}{4}$ °W 42 1/2 - 27.72'

Angle Point 11 Section 10

G.L.O. Resurvey notes of 1921

Iron post 3' long 1" diam. with brass cap marked

T 141 N
 AP 11 R 29 W
 S 10
 1921

W. Oak 4" N17 $\frac{1}{4}$ °E 21 ks - 13.86'

Poplar 9" N82°E 33 ks - 21.78'

Angle Point 12 Section 10

G. L. O. Resurvey notes of 1921

Iron post 3' long 1" diam. with brass cap
marked

AP 12
T191N
R29W
S10
1921

Maple 14" N25 $\frac{1}{4}$ ° W 102 1K5- 62.32'

Birch 6" S16 $\frac{1}{4}$ ° E 11 1K5- 7.26'

Angle Point 13 Section 10

G. L. O. Resurvey notes of 1921

Iron post 3' long 1" diam. with brass cap marked

T 141 N
 AP 13 R 29 W
 S 10
 1921

W. Oak 8" N75°E 64 1KS - 42.24'

R. Oak 6" S74°W 33 1KS - 21.78'

W. C. to Angle Point 14 Section 10

G.L.O. Resurvey notes of 1921

Iron post 3' long 1" diam. with brass cap marked

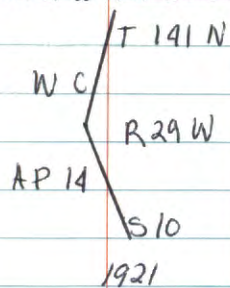

W. Oak 14" S $17\frac{1}{2}^{\circ}$ E 54 1K5- 35.64'

Maple 10" S $29\frac{1}{4}^{\circ}$ E 88 1K5- 58.08'

South 1/4 Cor. Secs. 13-18

B.L.O. Resurvey notes of 1918

Iron post 3' long 1" diam. with brass cap marked

11/27/85 CK, GB S1/16

Fd. 1" x 3/8" I.P. without S13 | S18

brass cap set in place. 1918

1' of G10 iron bent east.

N. Pine 7" N16°E 173 lks- 114.18'

Fd. 19" N.P. N16°E 114.3' to 50d. Scar vis.

Poplar 8" S50°W 176 lks- 116.16'

Mkd. New BT'S

BIRCH 13 N54E 30.10' SPR+TAG

TWIN BIRCH 12 N88E 18.60' " "

C.C. Done 12/21/85

11/27/85 Corner falls in the east wheel rut
of an old N-S road.

New road survey to the NE approx 50' from corner.

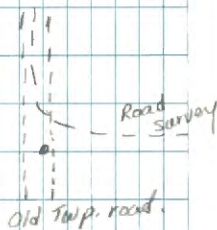

Angle Point 2 of Allotment 1563, Secs. 13-18

G. L. O. Resurvey notes of 1918

Iron post 3' long 1" diam. with brass cap marked

	S 18
S 13	—
	AP 2
	TR
	1563
	1918

L-25

Quarter Cor. Secs. 13-18

G.L.O. Resurvey notes of 1918

Iron post 3' long 1" diam. with brass cap marked

FD. IRON + CAP IN PLACE - IN BCG

ALSO 2" I.P. 12" HIGH LEARNING S13 S18

SOUTH - WOODS ROAD NW-SE

IS 65' NE OF COR.

1918

N. Pine 8" S76 1/4° E 238 IKS - 157.08'

NOW 24" N. PINE S76° E 156.90' SCAR FACING IRON

J. Pine 10" N59 1/4° W 246 IKS - 162.36'

NO EVIDENCE AT BRG. & Q15T.

C.C. Notes of 1935. Found a 2" Iron Pipe
Flush with ground. (Good Condition).

F.S.I.P. ON a T.R. west side of Range Line
Road. Corner bear's N.W. 34.3' in center
of road.

7150-4 By EMERY + KRUMP 4/15/74

11/27/85 CK-6B MHD NEW BT'S.

N. PINE 20 N26° E 71.4' SPK + TAG

N. PINE 18 N49° E 91.15' " "

C.C. Done 12/31/85

Angle Point 1 of Allotment 1386, Angle Point 4 of
Allotment 1727, Sec. 13 and Angle Point 2 of
Allotment 1568, Sec. 18

G. L. O. Resurvey notes of 1918

Iron post 3' long 1" diam. with brass cap marked

	TR	
	1727	
S 13	AP 4	S 18
	AP 1	AP 2
	TR	TR
	1386	1568

11/27/85 CK-6B

CHAINED NORTH ALONG OLD ROAD 681' Fd. TAG BY

DISTRICT ON W SIDE OF ROAD - TO APPROX. COR.

Fd. IRON CAP LYING ON WEST SIDE OF ROAD OUT OF
POSITION - REMOVED BACK TO CASS LAKE OFFICE

CONT. NORTH C.C. Done

K-25

North 1/16 Cor. Secs. 13-18

G. L. O. Resurvey notes of 1918

Iron post 3' long 1" diam. with brass cap
marked

N 1/16

Ed. IRON & CAP LYING ON S 13 | S 18

GROUND ON WEST SIDE OF N+S RD.

1918

Birch 4" N57°30'E 52 IKS - 34.32'

NO EVIDENCE AT BRG & DIST.

R. Oak 10" N22°W 193 IKS - 127.38'

NO EVIDENCE AT BRG. & DIST.

48

11-27-85 CK-6B

CHAINED DOWN ROAD NORTH 681' Ed. IRON & CAP OUT
OF LOCATION LYING BESIDE N+S ROAD ON WEST
SIDE - REMOVED BACK TO GASS LAKE OFFICE

BLAZED 8" R. OAK WEST SIDE OF ROAD & MKD BLAZE

APPROX. N 1/16 - NO TAG WITH AT THIS COR. C.C. Done

J-25

R 29 W R 28 W

Sec. Cor. Secs. 12-13-7-18

G.L.O. Resurvey notes of 1918

Iron post 3' long 2" diam. with brass cap marked

12/2/85 Ad. IRON + CAP CK, GB T141N

IN PLACE FLUSH WITH R 29 W R 28 W

TOP OF N65 WOODS TRAIL

S12 | S7

FROZEN IN ROAD

S13 | S18

PUT FSLP ON 12 ASPEN S82E 95918

S E C.C. Done

Poplar 8" N80°15'E 126 lks - 83.16'

Poplar 8" S77°30'E 113 lks - 74.58'

Poplar 7" S61°W 67 lks - 44.22'

Poplar 6" N89°15'W 112 lks - 72.97'

C-C Notes of 1935 Round Pipe &

Cap in good Condition Flush

with ground.

W. Pine 23" N 45°E 67.98'

Oak 7" S 72°E 71.28'

Elm 30" S 75°W 200.64'

49

Original survey

set post for corner

N. pine 16" N74W 80 lks

Dead tall tree standing plainly marked

N. Pine 5" N16E 71 lks

Birch 4" S16W 52 lks

stump at bearing and distance

Maple 6" S27E 43 lks

J. Curo. Co. Surveyor Dec 20, 1912

Book A p. 558

Fd: two original BTS - recorded above

set: corner from two BTS:

2"x2"x16" oak stake (possible iron pipe)

marked two BTS:

White Pine stump 30" S20°20'W 73.82'

Poplar 4" N66°W 21.70'

Poplar 4" N79E 82.60'

also found well marked stake about 8 yrs old

at N14°30'E 31.85'

G.L.O. 1918 (May) p. 242

Fd: Iron pipe 2" x 10" above ground

two original BTS:

pine stump 24" N74E 80 lks

decayed birch stump S16W 52 lks

Quarter Cor. Secs. 12-7

G.L.O. Resurvey notes of 1918

Iron post 3' long 1" diam. with brass cap marked

Found iron post $\frac{1}{4}$
in good condition. S12 S7

11-17-71

1918

W. Oak 10" N8°15'E 394 lks - 260.04'

N. Pine 24" S43°30'W 4.98 chs. -

To perpetuate this corner
I scribed three new bearing
tree's

Birch 8 " 18.4' S72°W scribed 1/4 512 BT

Birch 8 " 14.7' S6°W scribed 1/4 512 BT

Oak 10 " 10.5' N1°E scribed 1/4 57 1BT

Steel sign post 72" long with signs

54-2 E 54-4 attached set due

East 6.0'

OK
2/18/80
MMG

1-17-72

James Epton

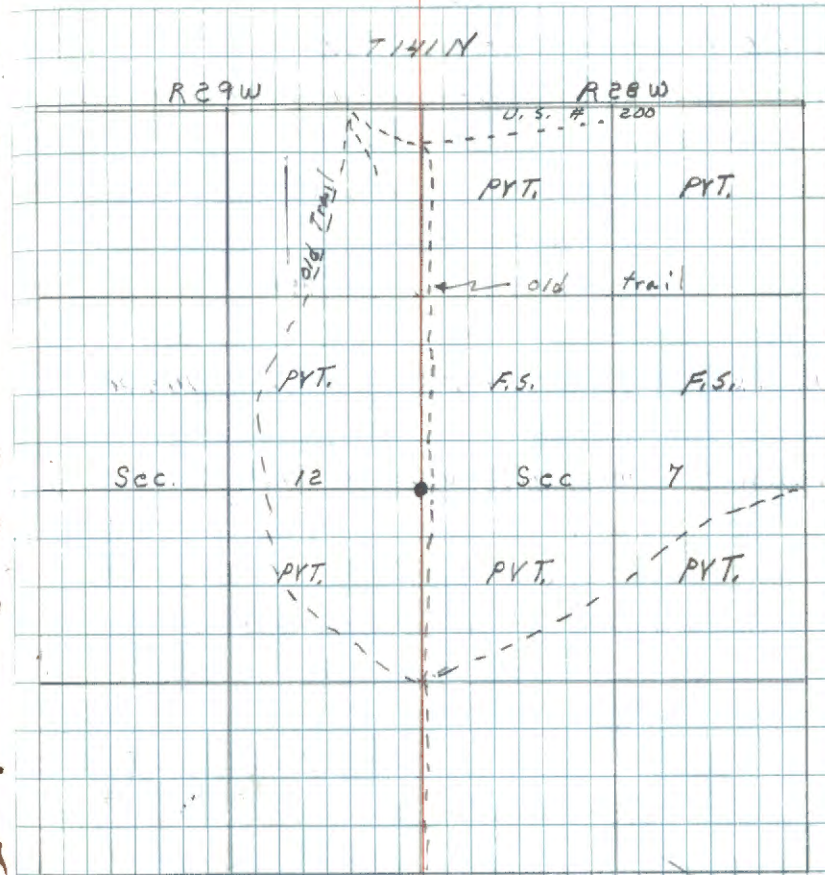

Original survey notes

set wood post

Poplar 3" N78W 64 lks

Cass County Surveyor

RB-B pg 170

Fd: Old post and two BTS:

poplar 6" N30W 60' paced } scribed
poplar NE of post }

F-25

North 1/16 Cor. Secs. 12-7

G.L.O. Resurvey notes of 1918

Iron post 3' long 1" diam. with brass cap
marked Found Iron Post N1/16

in good Condition. S12 S7

11-17-71 James Chestern

1918

W. Oak 6" S74°30'E 220 KS - 145.20'

Poplar 10" N72°30'W 327 KS - 215.82'

To perpetuate this Corner I
scribed three New bearing
tree's.

Oak 7 " 27.2' S76°E scribed N1/16 S7 BT

Oak 5 " 54.0' N10°E scribed N1/16 S7 BT

Oak 13 " 46.8' S33°W scribed N1/16 S12 BT

Steel sign post 72" long
set due East 6.6' with signs
54-2 5' 54-4 attached.

1-17-72

James Chestern

51

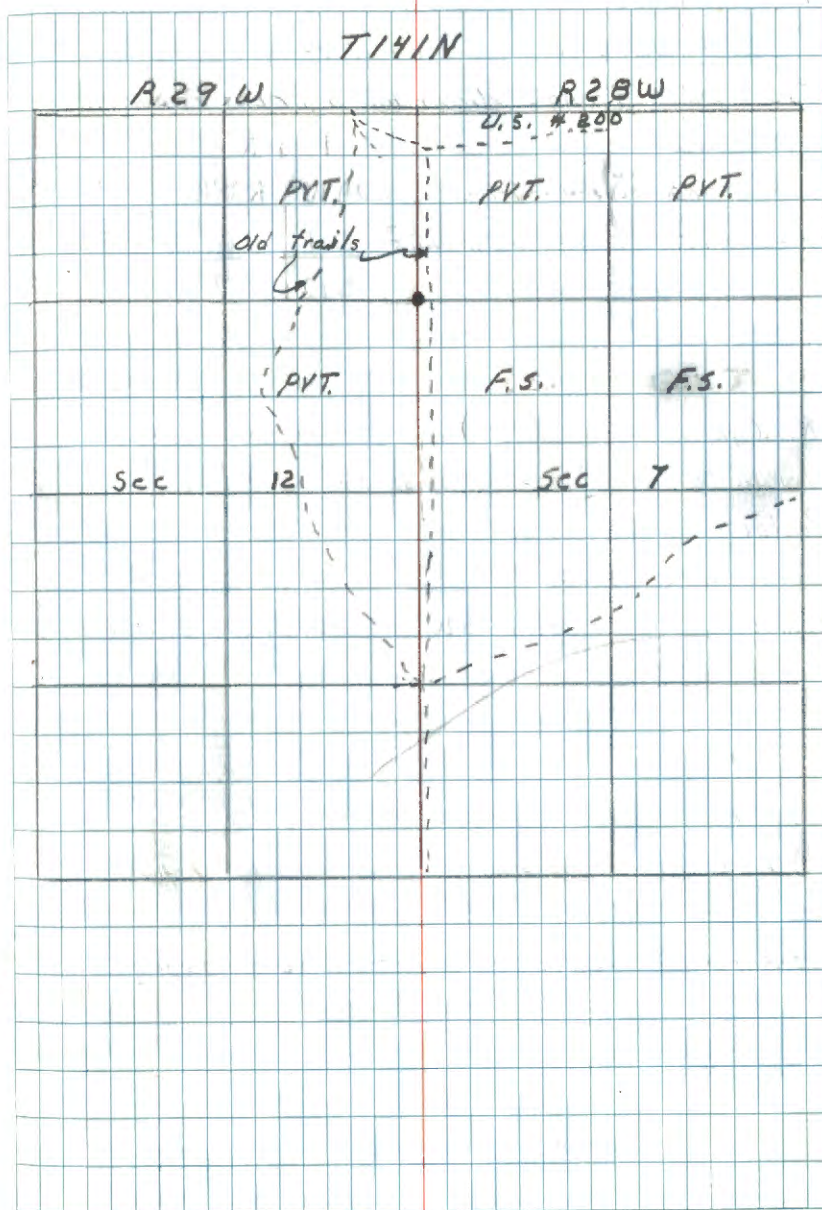

Sec. Cor. Secs. ^{R29W R28W} 1-12-6-7

G.L.O. Resurvey notes of 1918

Iron post 3' long 2" diam with brass cap marked

7/28/87 CK

T191N

F.S. 2" IRON + CAP # 11946

R29W R28W

ROGER MUSTONEN SET FS MANU.?

S1	S6
S12	S7

NO TIES COULD BE SEEN

1918

R. Oak 12" N35°30'E 608 LKS - 401.28'

FOUND LARGE OAK STP. BURNT & ROTTED AT BEARING & DISTANCE

Poplar 12" S18°15'W 127 LKS - 83.82'

FALLS IN HWY 200

Poplar 12" N76°15'W 208 LKS - 132.28'

(G.L.O.) IN YARD OF HOME

Fd: iron pipe 2" x 12" above ground

BTS:

poplar stump S26W 29 LKS

FALLS IN MOWED YARD AND BACKSLOPE OF HWY 200

N. Pine stump 20" S85W 191 LKS

BEARING & DISTANCE FALL IN BLACKTOP DRIVEWAY TO HOME

Original Survey

SET: wood post

poplar 12" S26W 29. LKS

N. Pine 12" S85W 191. LKS

Cass County Surveyor June 1915

Fd: Original BTS: RB-B pg 171

N. Pine stump 12" S85W 191 LKS (126.06')
(BT "vis'ble")

Rotted poplar stump S26W 29 LKS (19.14')

1941 HWY 200 DRAWING

SHOWS TIES TO CORNER WITH APPROX BEARINGS

ASH 10" N E 94.0 FT

BIRCH 12" S E 80.3 FT

BIRCH 20" S E 76.1 FT

BIRCH 8" S W 92.95
(TWIN)

Angle Point 3 of Allotment 1674 and Angle Point
3 of Allotment 1709, Secs. 1-6

G.L.O. Resurvey notes of 1918

Iron post 3' long 1" diam. with brass cap marked

		TR	
		1709	
S 1		AP 3	S 6
		AP 2	
		TR	
		1674	
		1918	

South 1/16 Cor. Secs. 1-6

G.L.O. Resurvey notes of 1918

Iron post 3' long 1" diam. with brass cap marked

S1/16
S1 | S6
|
1918

R. Oak 12" N82°E 161 1/2' - 166.26'

Poplar 6" S60°30'W 70 1/2' - 46.20'

Angle Point 1 of Allotment 1438, Angle Point 4 of
Allotment 1435 and a point on the West bdy.
of Allotment 1709, Secs. 56

G.L.D. Resurvey notes of 1918

Iron post 3' long 1" diam. with brass cap marked

	TR	
	1435	56
S1	AP4	TR
	API	1709
	TR	
	1438	
	1918	

~~R. Oak 20" N56°E 265 TRS.~~

~~R. Oak 5" N73°30'W 100 TRS.~~

Quartern
North 1/4 Cor. Secs. 1-6

G.L.O. Resurvey notes of 1918

Iron post 3' long 1" diam. with brass cap marked

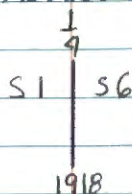

R. Oak 20" N58°E 265 LKS - 174.90'

R. Oak 5" N73°30'E 100 LKS - 66.00'

FD: iron pipe 2" x 12" above ground

original BT:

W. Pine 30" N56E 14 LKS

4-30-01 RMAFW

FD MONUMENT FLUSH WITH THE GROUND
IN EAST DITCH OF CO RD #39. MONUMENT IS
1/2 FT EAST OF & MONUMENT NOT STAMPED BUT
LOOKS LIKE FOREST SERVICE. 1/2 OF CAP IS BROKEN
AWAY. (LEARN THIS IS PROBABLY A ROGER MOSTONEN
PIPE.)

Original survey notes

SET: WOOD POST

W. Pine 25" N56E 14 LKS

W. Pine 20" N56W 74 LKS

North 1/16 Cor. Secs. 1-6

G.L.O. Resurvey notes of 1918

Iron post 3' long 1" diam. with brass cap marked

N 1/16
S 1 | S 6
1918

R. Oak 6" N 87 1/2° E 288 1/2 S - 190.08'
BEST COMES TO ROAK CLUMP COULD BE SPROUTS
OF GLO

W. Oak 9" S 62° 30' W 296 1/2 S - 195.36'

FALLS IN Co # 39 ROAD CLEARING

5-23-01 R MAIN

Fd GLO IRON IN PLACE IN MIXED HARDWOODS
ON EAST FACING SLOPE ± 170 FT EAST OF
♀ COUNTY ROAD # 39

Sec. Cor. Secs. ^{R29W R28W} 1-36-6-31

G.L.O. Resurvey notes of 1918

Iron post 3' long 3" diam. with brass cap marked

T141N
R29W | R28W
S36 | S31
S 1 | S 6
T141N
1918

N. Pine 12" N53°E 517 1KS - 391.22'

R. Oak 10" S63°E 325 1KS - 214.50'

R. Oak 14" S68°45'W 426 1KS - 281.16'

Poplar 5" N29°30'W 114 1KS - 75.24'

(G.L.O.)

Fd: iron pipe 2" x 16" above ground

Oak stump 16" N05E 22 LKS

Original Survey notes

set part

W. Birch 6" S45W 23 LKS

W. Birch 5" S25W 25 LKS

W. Oak 14" N05E 22 LKS

W. Oak 10" S70W 18 LKS

Cass County Surveyor 1915 October

Fd:

No Pine stump 12" S85W 191 LKS

E ast 1/16 Cor. Secs. 1-36

G. L. O. R. resurvey notes of 1918

Iron post 3' long 1" diam. with brass cap
marked S 36

1/27/88

E 1/16

JA, GB, MH

S 1

Fd. GLO iron set 12" 1918

above ground.

Birch 20" N74°30'E 25 1K5- 16.50'

Cedar 18" S48°W 21 1K5- 13.86'

Mkd. Temporary BT'S:

Ash 8" N84E 106.65 Tag + 20d

Basswood 6 N13W 8.15 FSLP, "

Cedar 5" S14E 53.50 " "

CC DONE

59

1/27/88 - Corner falls 30' north of East-West
road.

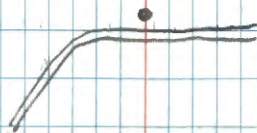

M.C. Sect 1-36 (shore of Leach L. bears NE & SW)

G.L.O. Resurvey notes of 1918

Iron post 3' long 1" diam. with brass cap marked

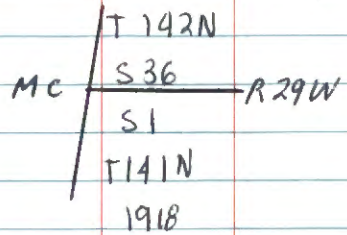

Cedar 18" N78°30'E 86 1/2 - 56.76'

Cedar 14" S7°W 35 1/2 - 23.10'

M.C. Secs. 3-~~5~~4 (shore of Leach L. bears NW & SE)

G.L.O. Resurvey notes of 1918

Iron post 3' long 1" diam. with brass cap marked

T 142 N
S 34 MC
R 29 W
S 3
T 141 N
1918

Basswood 8" N 65 1/2° W 37 1/2' - 24.42'

Maple 14" S 48° 15' W 27 1/2' - 17.82'

M.C. Secs. 3-34 (shore of Leech L. ^{bears} N & S)

G.L.O. Resurvey notes of 1918

Iron post 3' long 1" diam. with brass cap marked

MC | T 142 N
| S 34 → R 29 W
| S 3
| T 141 N
1918

W. Oak 10" N 61° 15' E 6 1ks - 3.96'

W. Oak 10" S 13° 45' E 11 1ks - 7.26'

EAST $\frac{1}{16}$ BETWEEN 20 & 29

Set by J.A. Gjelhu 9 2" x 4"
OAK POST $\frac{1}{2}$ " IRON PIN 4" ABOVE GROUND

4-23-81 CK+GB

Ed. 1" x 18" IRON PIPE AT E $\frac{1}{16}$ BET. SEC'S. 20 + 29

SET 3" OAK POST ALONGSIDE IRON

PLACE ROCK AROUND IRON

PUT E SLP ON 13" R. OAK SSW 46.6 FROM IRON

IN ASPEN + PINE + OAK - ON SIDE HILL

1918 GLO 1" x 36" I.P. w/BRASS CAP

6-19-81 Co. KRAUSE

Fd. 1" x 36" I.P. w/BRASS CAP SET 12"
Below ground in a cast IRON CASING.

No. Bts REMAIN 3 NEW Bts

11" Basswood N50°E 15.7'

9" Ash N178°E 19.9'

10" Maple S11°E 26.8'

MEANDER

NOTES OF GLO RESURVEY 1918

NO TRACE OF ORIGINAL POST OR BEARING TREES

SET 1" x 36" IRON POST WITH BRASS CAP MARKED

6/19/81 CK-GB

Fd. IRON & CAP IN PLACE

12" BELOW GROUND - WITH WELL CASING

AROUND MONUMENT - 3.5' E OF HOUSE 1918

R. OAK 14 S84°E 356 LKS.

NO EVIDENCE REMAINS AT BRG. + DIST.

BIRCH 12 N82°W 78 LKS.

NO EVIDENCE REMAINS AT BRG. + DIST.

NORTH CORNER OF INDIAN HOUSE BEARS S45°30'E

184 LKS. NO EVIDENCE REMAINS

CORNER FALLS ON SIDE SLOPE ABOVE LEECH LAKE 96'
SOUTH OF SHORE LINE AND 56' NORTH OF RIDGE TOP
AND 3.5' E OF SUMMER HOME

CHAINED DISTANCE FROM 1/4 BET. SEC'S. 8+9 NORTH TO

MC - DISTANCE CHECKED GOOD WITH GLO DISTANCE OF

31.71 CHS. OR 2092.90' - THIS LINE WAS USED TO ESTABLISH

N 1/4 BET. 8+9

1918 GLO 1" X 36" I.P. W/BRASS CAP

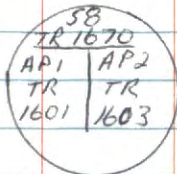

7-2-80 Main, Reimer, Fuller

Fol. I.P. set in place 10" Above SWAMP

Mat. CORNER FALLS in a round boggy
Swamp 30' west of high ground.

Bts

6" TAM, N36°W 17.45' scribed TR1670 58BT

9" W.OAK N76°E 69.20' " TR1670 58BT

CENTER EAST-EAST $\frac{1}{64}$, Sec. 8

Set a 2" x 36" galv. iron pipe filled
with concrete with B.C. mkd.

Monument set 10" above grd. T141N R29W

CE-E $\frac{1}{64}$

S-8

1981
R.L.S. NO. 14677

Mkd. BT'S:

1. W. Oak 5" N63E 58.48' "X" BT

2. W. Oak 11" S87E 97.00' CEE $\frac{1}{64}$ SB BT

3. Ash 8" S62W 28.15' CEE $\frac{1}{64}$ SB BT

8' Steel sign post west 3.0' and north 3.15'
with both signs attached.

Lines west & north are mkd. to F.S. Standard.

Old fence line mostly down runs west &
north of cor.

This corner was set proportionate between
 $\frac{1}{4}$ c. bet. s. 8/9 & C.E. $\frac{1}{64}$ sec 8. See traverse
field book.

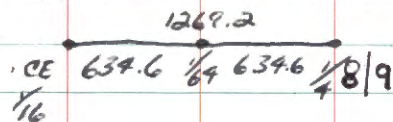

7/1/81 Gary Branno

67 CENTER-EAST $\frac{1}{16}$ Sec. 8

GLO Resurvey notes of 1918

Iron post 3' long 1" diam with brass cap mtd.
 Fd. iron pipe with Brass cap, set in
 place, set 8" above grd.

C $\frac{E \frac{1}{16}}{58}$ C
 1918

Ash 10" S73°W 1231ks. 81.18'

Ash 8" S31W 1471ks. 97.02'

Fd. 12 Ash at S31W at 97.02' Hollow inside

Mkd. New BT'S:

Mkd.

1. Oak 9" S51°W 44.53' CE $\frac{1}{16}$ SB BT2. Ash 6" S85°E 106.87' CE $\frac{1}{16}$ SB BT3. Ash 6" N61°W 58.02' CE $\frac{1}{16}$ SB BT

8' steel sign posts 3.15' east and 2.96' south

6/30/80 Gary Brana

Gary Stevenson
 Cert. 12/24/1980

6/30/80 - GB - RM - KF

Line to standard mkd. east & south from corner.
 Mon. is approx. 1' SW of an old fence corner post
 with broken down fence lines running east and north.
 Corner falls 50' west of a swamp.

68 CENTER-EAST-NORTHEAST $\frac{1}{64}$, Sec 8

Cass County Surveyor Harold Curo
set this corner in 1949. See Auditors
Plat No. 11

Set a iron monument

Fd. $1\frac{1}{2}$ x 16" iron pipe under road set
at proportionate distance between NE $\frac{1}{64}$ & N $\frac{1}{16}$.

Fd. two lot pipes north of corner at 40' & 100'

Mkd New BT's:

1. W. Oak 6" S19°E 101.18' "X" BT

2. J. Pine 8" S41°E 68.88' NE E $\frac{1}{64}$ SB BT

3. W. Oak 4" S65°E 121.41' "X" BT

Placed a penta-treated ^{cedar} wood post due south 47.25'

Both signs & F.S. L.P. attached.

7/1/81 - CK-BB

Traverse was run from NE $\frac{1}{64}$ to N $\frac{1}{16}$ to check
out C-E-NE $\frac{1}{64}$, Sec. 8 position. Total distance
measured 1249.6' Curo's distance 1249.2'



See traverse notes

Corner falls on north side of road.

Line to standard mkd. south of corner.

G.#-1

Angle point 4-1 between SEC. 7 & 12

1918 GLO

SET: 1" x 36" Brass Capped Iron Pipe

6/23/81 CK

Fd: 1" brass capped Iron pipe down 6"
below road in place

Chained from S $\frac{1}{4}$ to South - dist OK

Temp. ties:

Maple 8" N80W 47.0' spk on S side

Aspen 12" S56W 46.17' spk on S side

69

Angle Point 3 TR 1727

Angle Point 2 TR 1386

1918 GLO RESURVEY

Set A 1" by 36" IRON Post
26" in ground with BRASS
CAP MKD.

TR	
1727	
AP3	S13
AP2	
TR	
1386	

Angle Point 4 TR 1395

Angle Point 1 TR 1347

1918 GLO RESURVEY

Set a 1" by 36" Iron Post

26" in ground with BRASS CAP MKD.

	TR
	1395
SIC	AP4
	AP1
	TR
	1347
	1918

MILE POINT # 8 ON SOUTH BOUNDARY OF LEECH
LAKE RESERVATION IN SECTION 25

NOTES OF ORIGINAL SURVEY 1873

SET POST

N. PINE 30 N30W 49 LKS. = 3234'

ASPEN 10 N80W 50 LKS. = 3310'

NORTH BETWEEN SEC'S 25 & 26 - 51.25 CHS.
3382.5' INTERSECT RESERVATION BOUNDARY

MILE POINT #9 ON SOUTH BOUNDARY OF LEECH
LAKE RESERVATION IN SECTION 26

NOTES OF ORIGINAL SURVEY 1873

SET POST

HSPEN 4 N22W 16 LKS. = 10.56'

HSPEN 4 S53E 40 LKS. = 26.4'

NORTH BETWEEN SEC'S. 26 & 27 - 65.25 CHS.

4306.5' INTERSECT RES. BOUNDARY

MILE POINT #10 ON SOUTH BOUNDARY OF LEECH
LAKE RESERVATION IN SECTION 27.

NOTES OF ORIGINAL SURVEY 1873

SET POST

ASPEN 6 S77E 33 LKS. = 21.78'

ASPEN 4 N23E 15 LKS. = 9.9'

NORTH BETWEEN SECTIONS 27+28 - 79.20 CHS.
5227.2' - INTERSECT RESERVATION BOUNDARY

MILE POINT #11 ON SOUTH BOUNDARY OF LEECH
LAKE RESERVATION IN SECTION 21

NOTES OF ORIGINAL SURVEY 1873

SET POST

W. PINE 14 N50E 22 LKS. = 14.52'

W. PINE 26 S10E 26 LKS. = 17.16'

NORTH BETWEEN SECTIONS 20+21 - 15.10 CHS.

996.60' - INTERSECT RESERVATION BOUNDARY

EAST RANDOM BETWEEN SECTIONS 21+28

WEST TRUE LINE BET. SEC'S. 21+28 4.25 CHS.

280.5' INTERSECT RESERVATION LINE

MILE POINT #12 ON SOUTH BOUNDARY OF LEECH
LAKE RESERVATION IN SECTION 20

NOTES OF ORIGINAL GOV'T. SURVEY 1873
SET POST

OAK 8 N83E 52 LKS. = 34.32'

W. PINE 40 S24W 32 LKS. = 21.12'

NORTH BETWEEN SECTIONS 19 & 20 - 29.49 CHS.
1946.34' - INTERSECT RESERVATION BOUNDARY

MILE POINT #13 ON SOUTH BOUNDARY OF LEECH
LAKE RESERVATION IN SECTION 19

NOTES OF ORIGINAL GOV'T. SURVEY 1873

SET POST

N. PINE 28 N52E 32 LKS. = 21.12'

W. PINE 30 S32W 68 LKS. = 44.88'

NORTH BETWEEN SECTIONS 19 & 24 - 44.16 CHS.

2914.56' INTERSECT RESERVATION BOUNDARY

35.80 CHS. = 2362.8' N79°33'W OF MILE POST

#13

Witness Corner To Section Corner 35+36

Notes of the Gov't Survey of 1863

Set post 4.51 chs. west

W. Birch 14" N42W 351ks.

W. Birch 12" S60E 291ks.

Witness Corner To Section Corner 35,36

206.1' North of true section corner position.

6/18/83 Gary Stevenson set a 2" x 36"
galv. iron pipe with 3" mkd. brass cap

T141N R29W

S35 | S36

W.C.

1983
R25, 208 +

Mkd. Witness Trees:

Birch 8" N26E 44.13' Nail & Scribed

W. Oak 10" S62W 26.36' Nail & Scribed