

CORNER RESTORATION

T141N R29W

KX

FIELD BOOK

32 0012

BOOK 5

CORNER RESTORATION

T141N R29W #5

USFS T141N R29W

BOOK #5 of 8 CASS COUNTY

T. _____ P. _____

Mer.

6	5	4
7	8	9
18	17	16 74 75 65 75 73
19	20	21 67 72 66 71 74 65 67 63
30	29	28
31	32	33

49		
51	2	1
58	11	53 54
59	10	12
39	11	12
37	25	35
3	21	31
11	3	4
12	2	
5	15	11
10	6	
22	23	24
27	26	25
34	35	36

Cut or

From Merrill

L- 16, 17

Angle Point 5 of Allotment 1614, Angle Point 4
of Allotment 1604 and a point on the North
bdy. of Allotment 1234

TR	TR
1604	1614
AD4	AD5
TR	1234
1918	

5680-11 By WITTHOEFT & EMERY 1969

M, L - 15

Angle Point 1 of Allotment 1573 and Angle Point
4 of Allotment 1664, Sec. 15

G.L.O. Resurvey notes of 1918

Iron post 3' long 1" diam. with brass cap
marked

TR

1664

AP 4

AP 1

TR

1573

S 15

1918

7150-4 By WITTHOEFY & EMERY 6/90

Center North 1/16 Col. Sec. 15

G.L.O. Resurvey notes of 1918

Iron post 3' long 1" diam. with brass cap marked

C
N 1/16 | S 15
C
1918

N. Pine 4" S 65° 30' E 34 1/2 - 22.44'

N. Pine 5" N 14° W 59 1/2 - 38.94'

L-16

Center East 1/16 Cor. Sec. 15

G.L.D. Resurvey notes of 1918

Iron post 3' long 1" diam. with brass cap marked

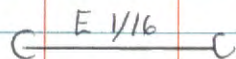

S 15

1918

J. Pine 7" N59°E 206 lbs - 135.96'

Spruce 7" N31°W 330 lbs - 217.80'

7150-4 By WITTHOFT & EMERY 6/70

Center West 1/16 Cor. Sec. 15

G.L.O. Resurvey notes of 1918

Iron post 3' long 1" diam. with brass cap marked

W1/16

C ——— C

S15

1918

N. Pine 8" S30°30'E 549 1/2 - 362.34'

Poplar 7" N85°15'E 942 1/2 - 621.72'

M-16

South East 1/16 Cor. Sec. 15

G.L.O. Resurvey notes of 1918

Iron post 3' long 1" diam. with brass cap marked

SE 1/16 S15

1918

Tamarack 4" S15°E 27 lks - 17.82'

Tamarack 4" S34°15'W 32 lks - 21.12'

7950-4 BY WITTHOEF & EMERY 6/70

K-16

North East 1/16 Cor. Sec. 15

G.L.O. Resurvey notes of 1918

Iron post 3' long 1" diam. with brass cap
marked

NE 1/16 Sec. 15

1918

Poplar 10" S66°45'E 36 1K5- 23.76'

Poplar 10" S34°30'W 60 1K5- 39.60'

7150-4 BY WITTHOFT 6/70

J, K-16

Angle Point 2 of Allotment 1614 and Angle Point
3 of Allotment, Sec. 15. G.L.O. Resurvey notes of 1918

Iron post 3' long	AP 3	
1" diam. with	TR	AP 2
brass cap marked	1623	TR
		1614
	S 15	
	1918	

7150-4 By WITTHOEFT 6/70

Angle Point 1 of Allotment 1604 and Angle Point
4 of Allotment 1614, S. 15

G.L.O. Resurvey notes of 1918

Iron post 3' long 1" diam. with brass cap
marked

TR
1614
AP 1 AP 4
TR
1604
S 15
1918

South West 1/16 Cor. Sec. 15

G.L.O. Resurvey notes of 1918

Iron post 3' long 1" diam. with brass cap marked

SW 1/16 S 15

1918

N. Pine 5" N43°15'E 51 1/2 - 33.66'

N. Pine 7" S18°15'W 136 1/2 - 89.76'

S.M.C. on the North 1/16 line Sec. 15 (Lake bears NW & SE)

G.L.O. Resurvey notes of 1918

Iron post 3' long 1" diam. with brass cap marked

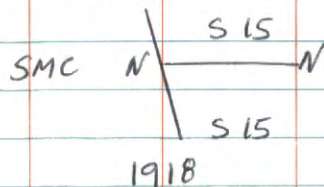

Poplar 8" S84°45'E 567 1ks- 374.22'

Birch 8" N41°45'E 362 1ks- 238.92'

S.M.C. Sec. 15 (shore of Lake bears N4S)

G.L.O. Resurvey notes of 1918

Iron post 3/4 long 1" diam. with brass cap marked

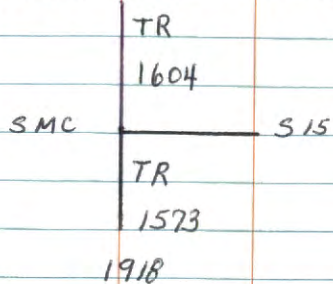

N. Pine 5" N78°15'E 538.1K5- 355.0B'

M.C. Secs. 9-10

G.L.O. Resurvey notes of 1918

Iron post 3' long 1" diam. with brass cap marked

T 141 N	R 29 W
---------	--------

S 9	S 10
-----	------

M C

1918

Poplar 12" S84°E 82 ks - 54.12'

W. Oak 10" S61°15'W 68 ks - 44.88'

South 1/16 Cor. Secs. 9-10

G.L.O. Resurvey notes of 1918

Iron post 3' long 1" diam. with brass cap
marked

S 1/16

S 9 | S 10

1918

W. Oak 10" S37°E 84 IKs - 55.44'

R. Oak 5" N87°W 14 IKs - 9.24'

Quarter Cor. Secs. 9-10

G.L.O. Resurvey notes of 1918

Iron post 3' long 1" diam. with brass cap
marked

10/28/88 CK Fd. IRON + CAP, IN PLACE S9 | S10

IN GOOD CONDITION - IN BIRCH - OAK - B. WOOD 1918

APPROX. 150' WEST OF OPEN SWP. TO EAST & SMALL LAKE

Y. Pine 20" N45°30'E 250 1K5 - 165.00'

NOW WELL ROTTED PINE STUMP N45E 165.0'

PUT FSLP'S ON 10 1/2 BIRCH NORTH 3.0' FROM IRON

ON RIDGE WHICH DROPS TO EAST - OLD FENCE LINE

N45 IS 25' EAST OF COR.

1/23/89 CK-GB

R. OAK 11 • S10W 59.30' MKD 1/4 S9 BT

W. OAK 10 S68W 51.65' 1/4 S9 BT

R. OAK 14 N32E 16.80' 1/4 S10 BT

8' STEEL SIGN POST 5.65' SOUTH AND 4.9' WEST

CC DONE

15

North 1/16 Cor. Secs. 9-10

G. L. O. Resurvey notes of 1918

Iron post 3' long 1" diam. with brass cap marked

N1/16

S9 | S10

1918

N. Pine 20" N45°E 43 IKS - 28.38'

Maple 16" S29°W 35 IKS - 23.10'

Angle Point 2 of Allotment 1487 and Angle
Point 3 of Allotment 1697, Secs. 9-10

G.L.O. Resurvey notes of 1918

Iron post 3' long 1" diam. with brass cap marked

TR

1697

AP 3

AP 2

TR

1487

S9 S 10

1918

M.C. Secs. 9-10 (shore of Leach L. bears NE & SW)

G.L.D. Resurvey notes of 1918

Iron post 3' long 1" diam. with brass cap marked

MC	
S 9	S 10
T 141 N	R 29 W
1918	

B. Oak 14" N78°30'E 63 1K3- 41.58'

Maple 6" S12°30'W 106 1K3- 69.96'

M.C. Secs. 3-10

G.L.O. Resurvey notes of 1918

Iron post 3' long 1" diam. with brass cap marked

T 141 N R 29 W

MC / 53

310

1918

B. Oak 13" N 77° E 53 1/2 - 34.98'

B. Oak 8" S 21° 30' E 38 1/2 - 25.08'

West 1/16 Cor. Secs. 3-10

G.L.O. Resurvey notes of 1918

Iron post 3' long 1" diam. with brass cap
marked

	53
W 1/16	<hr/>
	510
	1918

Poplar 5" N59°45'E 33 IKs - 21.78'
NO EVIDENCE @ THIS TIME

Poplar 6" S54°30'W 47 IKs - 31.02'
FALLS IN ROAD CLEARING

66-01 RMAEN

M.C. Secs. 3-10

G.L.O. Resurvey notes of 1918

Iron post 3' long 1" diam. with brass cap marked

T141 N R29 W

S3 / MC
S10 /
1918

Poplar 8" S16°15'W 190 LKS- 125.40'
LARGE ROTTED ASPEN LAYING DOWN @ BRG AND DIST.

Oak 10" N44°15'W 142 LKS- 93.72'

NOW 16" W OAK WINDFALL @ BRG AND DIST

6-7-01 R MAIN

FD IRON IN PLACE IN 2 FT OF WATER 15 FT
EAST OF SHORE. IRON IS NEXT TO BEAVER RUN.
NEED CHEST WADERS IN HIGH WATER YEARS LIKE
2001. Should RETURN AND WIRE AN 8 FT SIGN POST
TO IRON. WITNESS WITH.

W OAK (TWIN) 16" N 1° W 29.33 FT TO SPK NOT MKD

R OAK 13" N 65° W 33.93 FT TO SPK NOT MKD

M.C. Secs. 3-10

G.L.O. Resurvey notes of 1918

Iron post 3' long 1" diam. with brass cap marked

T 141 N R 29 W
 MC —————
 53
 S 10
 1918

W. Oak 8" N 19° E 56 1/2' 36.96'

M.C. Secs. 3-10

G.L.O. Resurvey notes of 1918

Iron post 3' long 1" diam. with brass cap marked

T 141 N R 29 W

S 3

MC

S 10

1918

W. Oak 12" S 25° 15' W 117 lks - 77.22'

Poplar 6" N 83° 15' W 130 lks - 91.08'

Angle Point 2 of Allotment 1483, Angle Point 3
of Allotment 1481 and a point on the East bdy.
of Allotment 1479, Sec. 10

G.L.O. Resurvey notes of 1918

Iron post 3' long 1" diam. with brass cap marked

	TR
	1481
TR	AP3
1479	AP2
	TR
	1483
S 10	
1918	

Center South 1/16 Cor. Sec. 10

G.L.O. Resurvey notes of 1918

Iron post 3" long 1" diam. with brass cap marked

C
S1/16 | S10
C
1918

B. Oak 12" N77°30'E 45 lks - 29.70'

Poplar 5" S83°N 33 lks - 21.78'

Center Quarter Cor. Sec. 10

G.L.V. Resurvey notes of 1918

Iron post 3' long 1" diam. with brass cap marked

C¹/₄ S10

1918

B. Oak 16" N32¹/₂° E 44 lks - 29.04'

Maple 8" S61°30' W 34 lks - 22.44'

S.M.C. on the center line of Sec. 10

G.L.O. Resurvey notes of ~~1921~~ 1921

Iron post 3' long 1" diam. with brass cap marked

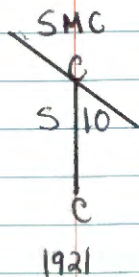

W. Oak 18" N45°E 109 1K5- 71.94'

W. Oak 4" S92°W 89 1K5- 58.74'

S.M.C. on the center line Sec. 10 (shore of Horseshoe L. bears N 4 SE)

G.L.D. Resurvey notes of 1918

Iron post 3' long 1" diam. with brass cap marked

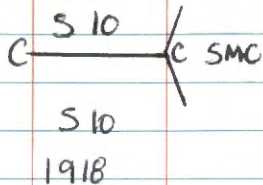

W. Oak 20" S $72\frac{1}{4}^\circ$ W 117 KS - 77.22'

W. Oak 7" N $46\frac{3}{4}^\circ$ W 169 KS - 111.54'

S.M.C. on the centerline Sec. 10

G.L.D. Resurvey notes of 1918

Iron post 3' long 1" diam. with brass cap marked

S M C

C / S
10
1918

W. Oak 20" S $22\frac{1}{2}^{\circ}$ W 64 KS - 42.24'

W. Oak 18" N $27\frac{1}{4}^{\circ}$ E 117 KS - 77.22'

S.M.C. on the center line Sec. 10

G.L.O. Resurvey notes of 1921

Iron post 3' long 1" diam. with brass cap marked

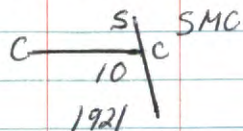

W. Oak 12" N43 $\frac{3}{4}$ °W 12 1/2 - 7.92'

Birch 6" S69°W 18 1/2 - 11.88'

S.M.C. on the center line of Sec. 10 (Shore of Horseshoe
L. Beav. NE & SW)

G.L.O. Resurvey notes of 1918

Iron post 3' long 1" diam. with brass cap marked

SMC $\begin{array}{c} \text{C} / \begin{array}{c} \text{S} \\ 10 \\ 1918 \end{array} \text{C} \end{array}$

Poplar 6" N78 $\frac{1}{4}$ °E 173 1KS - 114.18'

W. Oak 8" S22 $\frac{3}{4}$ °E 138 1KS - 91.08'

S.M.C. on the center line Sec. 10 (West shore of Horseshoe L., bears N45)

G.L.O. Resurvey notes of 1918

Iron post 3' long 1" diam. with brass cap marked

S 10	C SMC
S 10	
1918	

W. Oak 18" N58°W 86 1/2 - 56.76'

B. Oak 16" S89°W 106 1/2 - 69.96'

W.C. to the C.W. 4/16 Cor. Sec. 10 (shore of small L., bears N & S)

G.L.O. Resurvey notes of 1918

Iron post 3' long 1" diam with brass cap marked

W CC $\xrightarrow{\text{W 1/16}}$ C

S 10

1918

W. Oak 8" N39 $\frac{3}{4}$ °E 150 KS - 99.00'

Poplar 5" S38°E 32 KS - 21.12'

Angle Point 1 of Allotment 1483, Angle Point 2 of
Allotment 1309, Angle Point 3 of Allotment 1352
and Angle Point 4 of Allotment 1481, Sec. 10

G.L.O. Resurvey notes of 1918

Iron post 3' long 1" diam. With brass cap marked

TR	TR
1481	1352
AP 4	AP 3
AP 1	AP 2
TR	TR
1483	1309
1918	

South East 1/16 Cor. Sec. 10

G.L.O. Resurvey notes of 1918

Iron post 3' long 1" diam. with brass cap marked

SE 1/16 S 10

1918

W. Oak 10" N58 $\frac{3}{4}$ °E 104 1/2' - 68.64'

W. Oak 12" N10 $\frac{1}{2}$ °W 276 1/2' - 182.16'

S.M.C. on the E 1/16 line Sec. 10

G.L.O. Resurvey notes of 1921

Iron post 3' long 1" diam. with brass cap marked

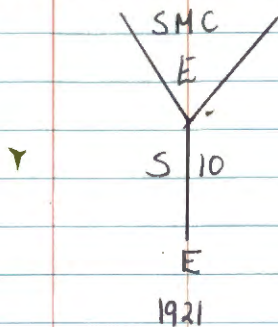

R. Oak 8" S61°E 15 1/2 - 9.90'

W. Oak 12" S66 1/2°W 62 1/2 - 40.92'

South West 1/16 Cor. Sec. 10

G. L. O. Resurvey notes of 1918

Iron post 3' long 1" diam. with brass cap marked

▼ SW 1/16 S10
1918

W. Dak 8" N76 $\frac{1}{2}$ °E 30 1/2 - 19.80'

Birch 14" S22 $\frac{3}{4}$ °W 30 1/2 - 19.80'

Witness Point on the West 1/16 line Section
10 (shore of small lake, bears NE & SW)

G.L.O. Resurvey notes of 1918

Iron post 3' long 1" diam. with brass cap marked

WP

W 1/16 S10

1918

Poplar 10" N42°E 23 1/2' - 15.18'

Poplar 8" S45 1/2°W 50 1/2' - 33.00'

Witness Point on the West 1/16 line Sec. 10 (north
shore of lake, bears NW & SE

G.L.O. Resurvey notes of 1918

Iron post 3' long 1" diam. with brass cap marked

W 1/16 S10

WP

1918

W. Oak 10" N65 $\frac{1}{4}$ °E 240 IKS - 158.40'
NOW ZZ''

Tamarack 7" N17 $\frac{1}{2}$ °W 270 IKS - 178.20'

12-2-14 R MAIN

FD IRON IN PLACE AND GPS SURVEY GRADE.
THE CAP SHOULD BE CW 1/16 WP.

North West 1/16 Cor. Sec. 10

G. L. O. Resurvey notes of 1918

Iron post 3' long 1" diam. with brass cap marked

NW 1/16 S10

1918

Birch 6" S83 $\frac{1}{4}$ °E 43 IKS- 28.38'

W. Oak 4" N14°W 11 IKS- 7.26'

12-2-14 R. MAIN

Fd IRON, CAP IS GONE UP \pm 3". IRON IS
 \pm 6 FT EAST OF $\frac{1}{2}$ OF WOODS TRAIL. GPS
 IRON SURVEY GRADE. WITNESS WITH.

W. OAK 4" S2°E 37.28' TO SPK

ASH 7" N82°W 21.20' TO SPK

Angle Point 1 of Allotment 1487, Angle Point 4
of Allotment 1697 and a point on the West bdy.
of Allotment 1386, Sec. 10

G.L.O. Resurvey notes of 1918

Iron post 3' long 1" diam. with brass cap marked

TR	
1697	
AP 4	TR
AP 1	1386
TR	
1487	
S	10
1918	

S.M.C. on the North 1/16 line Sec. 10

G.L.O. Resurvey notes of 1921

Iron post 3' long 1" diam. with brass cap
marked

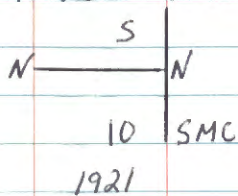

Maple 8" S51°W 50 IKS - 33.00'

R. Oak 16" N53½°W 13 IKS - 8.58'

S.M.C. on the center line of Sec. 3

G.L.O. Resurvey notes of 1918

Iron post 3' long 1" diam. with brass cap marked

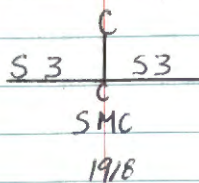

Basswood 6" N1°45'E 175 1K5 - 115.50'

Dak 8" N49°W 53 1K5 - 34.98'

Center South 1/16 Cor. Sec. 3

G.L.O. Resurvey notes of 1918

Iron post 3' long 1" diam. with brass cap marked

C
S 1/16 | S 3
C
1918

R. Oak 10" N26°E 29 1/2 - 19.14'
STUMP HOLE

W. Oak 10" N55°30'W 41 1/2 - 27.06'
W. OAK STUMP CUT OFF @ BRG & WEST

6-6-01 R MAIN

FD GLO IRON IN PLACE UP 7" CORNER IN
MATURE HARDWOODS ±250 FT NORTH OF 2 RUT
WDS TRAIL RUNNING EAST WEST. PLACE FSLP
ON 5" BIRCH ON NORTH EDGE OF TRAIL FROM
WHICH CORNER BEARS NORTH ±250 FT TO PUT LOT
IRONS NORTH AND WEST OF CORNER BY CURV.

W OAK 16" N64°E 81.25 FT TO SPK MKD: S3 BT

MAPLE 8" S26°W 34.34 FT TO SPK MKD: S3 BT

8 FT STEEL SIGN POSTS 3.65 NORTH 4.0 WEST

Center Quarter Sec. 3

G.L.O. Resurvey notes of 1918

Iron post 3' long 1" diam. with brass cap marked

C 1/4 S 3

1918

Maple 8" S 26° W 42 1/2 - 27.72'
NO EVIDENCE

Cherry 7" N 42° 30' W 38 1/2 - 25.08'

FALLS IN ROAD CLEARING

5-31-01 R MAIN

Fd GLO IN PLACE BENT OVER, STRAIGHTEN
AND RESET. CORNER IS 25 FT SOUTH OF SOUTH
EDGE POWER LINE CLEARING AND 25 FT
EAST OF E FR 2484 DIAMOND POINT ROAD.
CORNER RESET FLUSH/W/ GROUND AND WITNESSED
WITH:

POWER POLE 9.7" N 36° W 60.04 FT TO GALV NAIL UP 2'

W OAK 17 1/2" S 82° E 74.75 FT TO SPK NOT MKD

W OAK 10" S 10° E 50.8 FT TO SPK MKD S 3 BT

SERIES OF PUT HOT IRONS SOUTH OF CORNER ON

LINE TO STANDARD BY W. CURCO

8 FT STEEL SIGN POSTS 34 EAST 6.05 SOUTH

Angle Point 1 of Allotment 1637, Angle Point 2 of Allotment 1642, Angle Point 3 of Allotment 1629 and Angle Point 4 of Allotment 1537, Sec. 3

G. L. O. Resurvey notes of 1918

Iron post 3' long 1" diam. with brass cap marked

TR	TR
1537	1629
AP 4	AP 3
AP 1	AP 2
TR	TR
1637	1642

S 3

1918

Center North 1/16 Corn Sec. 3

G.L.O. Resurvey notes of 1918

Iron post 3' long 1" diam. with brass cap marked

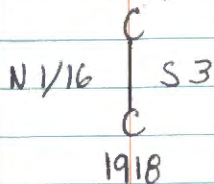

W. Oak 14" N68°E 41 IRS- 27.06'

Maple 14" S49°W 31 IRS- 20.46'

S.M.C. on the center line of Sec. 3

G.L.O. Resurvey notes of 1918

Iron post 3' long 1" diam. with brass cap marked

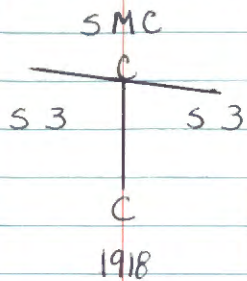

E/m 14" S30°E 63 IKS - 41.58

E/m 8" S82°45'W 69 IKS - 45.54'

Quarter Cor. Secs 3-34

G.L.O. Resurvey notes of 1918

Iron post 3' long 1" diam. with brass cap
marked

1/4

S 34

S 3

1918

Maple 14" S48°30'W 27 1X5- 17.82'

Basswood 8" N66°30'W 37 1X5- 24.42'

Center East 1/16 Cor. Sec. 3

G.L.O. Resurvey notes of 1918

Iron post 3' long 1" diam. with brass cap
marked

E 1/16
C ————— C

S3

1918

W. Oak 10" S28°15'E 70 IXS - 46.20'
NO EVIDENCE REMAINS

W. Oak 14" N19°45'W 89 IXS - 58.74'
FALLS IN POWER LINE CLEARING

5-31-01 R. MAZIN

Fd GLO IRON UP 3" IN MATURE MIXED HARDWOOD
CORNER IS 30 FT SOUTH OF SOUTH EDGE
OF POWER LINE CLEARING. MARK NEW BITS

W OAK 7½" S20°E 43.00 FT TO SPK MKD: S3BT

R OAK 20" S 30°W 48.95 FT TO SPK MKD: CE 1/2 S3BT

8 FT STEEL SIGN POSTS 3.0 EAST 4.0 WEST

THERE ARE A SERIES OF PVT LOT IRONS EAST TO
THE 1/4 S3/S2 ON OUR LINE TO STANDARD

Center West 1/16 Cor. Sec. 3

G.L.O. Resurvey notes of 1918

Iron post 3' long 1" diam. with brass cap marked

C — W 1/16 — C

S 3

1918

Maple 6" S35° 15' E 20 1/2 - 13.20'

Elm 9" N56° W 30 1/2 - 19.80'

S.M.C. Sta. 3 (shore of Leech L. bears NE & SW)

G.L.O. Resurvey notes of 1918

Iron post 3' long 1" diam. with brass cap marked

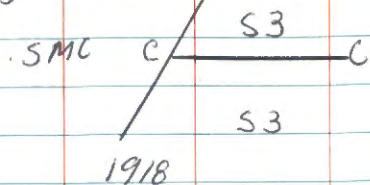

W. Oak 14" N87°30'E 69 IKS - 45.54'

Maple 8" S39°E 54 IKS - 35.64'

Angle Point 2 of Allotment 1717, Angle Point 3
of Allotment 1694 and a point on the East bdy
of Allotment 1694, Sec. 3

G. L. O. Resurvey notes of 1918

Iron post 3' long 1" diam. with brass cap marked

	TR
	1694
TR	AP 3
1694	AP 2
	TR
	1717
53	
1918	

5-30-01 R. MAEN

Fd GLO IN PLACE IN A SMALL DRAINAGE
WHICH RUNS NORTH SOUTH. Fd TOP 7" OF
MOVEMENT BROKEN OFF ALONG SIDE REMAINING
2' 3" OF IRON. CORNER IS IN MATURE HARDWOOD
STAND.

MAPLE 6" N 73° E 8.38 FT TO NAIL MKD 53 BT

MAPLE 5" N 40 W 40.65 FT TO NAIL MKD X BT

8 FT STEEL SIGN POST 5.1' SOUTH 8.0' EAST
LINE TO STD SOUTH AND EAST OF CORNER

South East 1/16 Col. Sec. 3

G.L.O. Resurvey notes of 1918

Iron post 3' long 1" diam. with brass cap marked

SE 1/16 S3

1918

Maple 16" S69°30'E 57 IKS - 37.62'

Now 18" @ BRG AND DIST

W. Dak 8" N65°W 44 IKS - 29.04'

Now 19" @ BRG AND DIST

5-30-01

Fd GLO IRON IN PLACE UP 8" CORNER IS IN MATURE MIXED HARDWOODS. Fd FSLP FROM AUG 1956 ON 20" MAPLE FROM WHICH CORNER BEARS S40W 6 FT. PLACE TAGS ON FRONTS OF GLO BTS. CORNER IS ±100 FT NORTH OF TWO RUT FOREST TRAIL.

8 FT STEEL SIGN POSTS 3.4' EAST 3.8' NORTH

LINE TO STD EAST AND NORTH

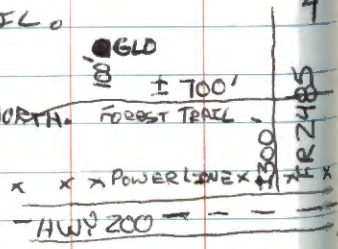

S.M.C. on the East 1/16 line Sec. 3 (shore of Horseshoe L. bears E40)

G.L.O. Resurvey notes of 1918

Iron post 3' long 1" diam. with brass cap marked

E
 S 3 | S 3

E

S.M.C.

1918

Poplar 8" N48°W 17 1/2 - 11.22'

R. Oak 8" N2°W 75 1/2 - 49.50'

Angle Point 1 of Allotment 1642, Angle Point 4 of Allotment 1629 and a point on the West body of Allotment 1696, Sec. 3

TR

1629

AP 4 TR

AP 1 1696

TR

1642

S 3

1918

S.M.C. on the East 1/16 line Sec. 3 (s. of Leech L. braks E & W)

G.L.O. Resurvey notes of 1918

Iron post 3' long 1" diam with brass cap marked

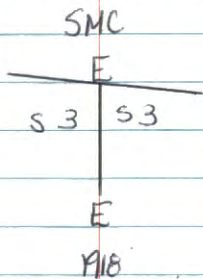

Maple 12" S 32° 30' E 47 1/2 - 31.02'

W. Oak 4" S 11° W 44 1/2 - 29.04'

South West 1/16 Cor. Sec. 3

G.L.O. Resurvey notes of 1918

Iron post 3' long 1" diam. with brass cap marked

SW 1/16 S3

1918

R. Oak 13" S26°E 58 IKS - 38.28'

ROAD AND POWER LINE CLEARING

W. Oak 10" N55°30'W 41 IKS - 27.06'

ROAD CLEARING

Fd 1 1/2 IP up 1" ± 30' WEST OF
GPS SURVEY GRADE LITS EAST

S.M.C. on the South 1/16 line Sec. 3 (shore of Leah L. bears N 45 W)

G.L.O. Resurvey notes of 1918

Iron post 3' long 1" diam. with brass cap marked

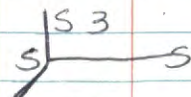
SMC 
S3
1918

Maple 6" N55°E 71 IXS - 46.86'

R.Oak 12" S15°W 22 IXS - 14.52'

S.M.C. on the West 1/16 line Sec. 3 (Shore of Leah L. bears NEXSW)

G.L.O. Resurvey notes of 1918

Iron post 3/4 long 1" diam. with brass cap marked

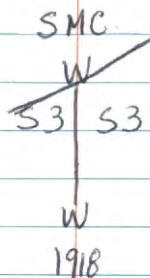

Basswood 24" 56°E 271 1/3 - 178.86'

Basswood 8" 54°W 270 1/3 - 178.20'

S.M.C. on the North 1/16 line Sec. 30 (shore of Leach h. bears N 1/2 Sec.)

G.L.O. Resurvey notes of 1918

Iron post 3' long 1" diam. with brass cap marked

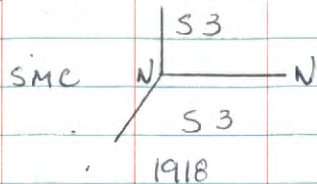

R. Oak 6" N58°E 18 1/2 - 11.88'

Maple 8" S34°W 71 1/2 - 46.86'

SMC Sec. 3 (shore of Leech L. bears NKS)

G.L.O. Resurvey notes of 1918

Iron post 3' long 1" diam. with brass cap
marked

TR

1537

SMC

— 53

TR

1637

1918

W. Oak 5" N61°E 62 1K3 - 40.92'

R. Oak 14" S56°E 68 1K3 - 44.88'

Quarter Cor. Secs 16-21

G.L.O. Resurvey notes of 1918.

Iron post 3' long 1" diam. with brass

cap marked

$\frac{1}{4}$ 516

521

1918

N. Pine 5" N89°30'E 203 1K5-133.98'

R. Oak 10" N59°45'E 196 1K5-129.36'

Found brass cap flush with ground

Found 458 on 5" ASPEN N12°W 25.74 FT

No date

West 1/16 Cor. Secs. 16-21

G.L.O. Resurvey notes of 1918

Iron post 3' long 1" diam. with brass cap
marked

W 1/16

S 16

S 21

1918

Oak 12" Bears West 129 lks - 85.14'
Now 26" @ BRG E DIST

Maple 8" N 21° W 250 lks - 165.00'
NO EVIDENCE

7-3-80 BRAMA HAYES MAIN

Fd IRON UP 4" CLEARING SOUTH OF CORNER
± 30 FT. MKD NEW BTS

ROAK 9 N 2° E 37.14 MKD W 1/16 S 1/16 BT

ROAK 10 N 74 W 50.94 MKD W 1/16 S 1/16 BT

ROAK 8 S 84 E 73.17 MKD W 1/16 S 1/16 BT

6 FT STEEL SIGN POST 2.53 EAST

8 FT STEEL SIGN POST 3.03 NORTH

SINE TO STANDARD EAST AND NORTH OF CORNER

Sec. Cor Secs. 16-17-20-21

G.L.O. Resurvey notes of 1918

Iron post 3' long 2" diam. with brass cap
marked

T141 N	R29 W
S17	S16
S20	S21
1918	

R. Oak 10" N67°E 107 1/2 - 70.62'

R. Oak 14" S11°30'E 252 1/2 - 166.32'

W. Pine 16" S26°30'W 202 1/2 - 133.32'

R. Oak 14" N82°15'W 193 1/2 - 127.38'

Angle Point 2 of Allotment 1310 and Angle
Point 3 of Allotment 1347, Secs 16-17

G.L.O. Resurvey notes of 1918

Iron post 3' long 1" diam. with brass cap marked

	TR		S17
	1347		S17 S16
S17	AP3	S16	1918
	AP2		
	TR		
	1310		
	1918		

South 1/16 Cor. Secs. 16-17

G.L.O. Resurvey notes of 1918

Iron post 3' long 1" diam with brass cap marked

S1/16

S17 | S16

1918

R. Oak 7" S71° E 178 1/2 - 117.48'

R. Oak 12" S6° 30' W 336 1/2 - 221.76'

Angle Point 3 of Allotment 1478 and Angle
Point 4 of Allotment 1484, Sacs. 9-16

G.L.O. Resurvey notes of 1918

Iron post 3' long 1" diam. with brass cap marked

TR	TR
----	----

1484	1478
------	------

AP 4	AP 3
------	------

TR	1484
----	------

516

1918

East 1/16 Cor. Secs. 9-16

G.L.O. Resurvey notes of 1918

Iron post 3' long 1" diam. with brass cap marked

E 1/16 59

516

1918

Poplar 6" N20°45'E 136.135 - 89.76'

Mound of Stone 2' base 1 1/2' high, north
of cor.

Form 458 on 4" ASPEN POST AT COR.

Quarter Cor. Secs. 9-16

G.L.O. Resurvey notes of 1918

Iron post 3' long 1" diam. with brass cap marked

$\frac{1}{4}$ 59

516

1918

Pine 18" N10°45'E 259 IKS - 170.94'

Poplar 5" S28°W 44 IKS - 29.04'

In old Field book

B.T. 12" R. pine N10°W 2.60 Ch. - 171.60 FT

Form 458 on B.T. This may be the

N10°45'E pine of G.L.O. - No date

J-10

West 1/16 Cor. Secs. 9-16

G.L.O. Resurvey notes of 1918

Iron post 3' long 1" diam with brass cap marked

S9

W 1/16

S 1/6

1918

R. Oak 14" N3°45'E 161 1/25 - 106.26'

Maple 10" S89°30'E 199 1/25 - 131.34'

Metal poster on 5" ASPEN

N 78°E 39.60 FT - No date

7150-4 By WITTHOEFT 2/10/70

78-80 Jo. SCHONOVER

Ed MONUMENT BENT. NO EVIDENCE OF 1918 B.T.S.

W. OAK 4 N65°E 9.16 FT

R. OAK 9 S72°E 41.94 FT

W. OAK 6 N39°E 33.48 FT

71

MARCH/2001 MAIN

HEAVY 8 FT STEEL SIGN POST 4064 WEST

LIGHT 8 FT STEEL SIGN POST 638 SOUTH

LINE TO STANDARD WEST AND SOUTH

Center South 1/16 Cor. Sec. 16

G.L.O. Resurvey notes of 1918

Iron post 3' long 1" diam. with brass cap marked

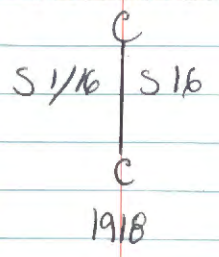

Mound of stone 2' base 1 1/2' high, west of cor.

CAP FLUSH WITH GROUND FORM 458 ON 4" ASPEN POST AT COR. NO DATE

5-8-2000 R. MAIN

FD IRON UP 2 FT AND BENT. STRAIGHTEN AND RESET NOW UP 6". PLACE FOUR ROCKS AROUND PIPE. CORNER IS ± 30 FT EAST OF A POND AND ± 50 FT WEST OF RED PINE PLANTATION. WITNESS WITH

W OAK 13" SSW 45.30 FT TO SPK MKD: S16 BT

R PINE 12" EAST 46.32 FT TO SPK MKD: S16 BT

Center Quarter Sec. 16

6 L.O. Resurvey notes of 1918

Iron post 3' long 1" diam. with brass cap marked

C¹/₄ S16

1918

R. Oak 12" S3°E 119.1X5 - 78.54'
No EVIDENCE

R. Oak 12" N83°45'W 64.1X5 - 42.24'
No EVIDENCE

Form 458 on ASPEN POST AT COR - No date

4-13-2000 R. MAIN

FD IRON IN PLACE UP 3" WITHOUT CAP. IRON
FALLS IN SMALL GRASS OPENING IN A PINE
PLANTATION. FD BARBED WIRE EAST OF CORNER
AND @ CORNER. FD PLANTATION POST FALLEN OVER
2 FT NORTH OF CORNER. IRON ± 700 FT NORTH OF FR2312

WITNESS WITH:

R PINE 6" S81E 21055 FT TO SPK MKD^o S16 BT

R PINE 7½" S36°W 25068 FT TO SPK MKD^o S16 BT

R PINE 8" N57°W 36.23 FT TO SPK MKD^o S16 BT

Angle Point 4 of Allotment 1654, Sec. 16

G.L.O. Resurvey notes of 1918

Iron post 3' long 1" diam. with brass cap
marked

S 16

TR

1654

AP 4

1918

K-16

Center North 1/16 Cor. Sec. 16

G.L.O. Resurvey notes of 1918

Iron post 3' long 1" diam. with brass cap marked

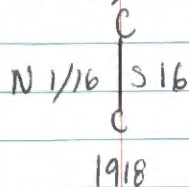

Tamarack 8" N35°E 18 lks - 11.88'
NO EVIDENCE

Tamarack 7" S20°E 283 lks - 186.70'
TAM STUMPS IN AREA NOT CONCLUSIVE

FORM 458 ON 4" ASPEN POST - NO DATE

7150-4 BY EMERY & WITTHOEFT 2/9/70

7-24-36 STEADLAND 874-9

FD IRON UP 12" FSLP ON 4" ASPEN POST @ CORNER

2-9-70 EMERY AND WITTHOEFT

FD IRON, PLACED TAG ON 4" SPRUCE N40°W 38 LKS
(25.08 FT)
TO CORNER.

75

5-1-2000 R MAIN

FD IRON IN PLACE IN GRASSY BOG w/ SPARSE
ALDER AND TAMARACK. BOG IS ± 10 ACRES AND
CORNER IS ± 200 FT FROM WEST SIDE.
NO CLOSE B.T.S. RECORDED GPS @ CORNER.

DEAD TAM 4 1/2" N48°W 14.6 FT TO NAEFL SOUTH SIDE OF
TREE.

8 FT STEEL SIGN POSTS 3.35 WEST 3.4 SOUTH
LINE TO STANDARD SOUTH AND WEST

L-10

Center West 1/16 Cor. Sec. 16

G.L.O. Resurvey notes of 1918

Iron post 3' long 1" diam. with brass cap marked

W 1/16
C ————— C

S 16

1918

Maple 8" S22°30'W 133 1/2 - 87.78'
NO EVIDENCE

R. Oak 16" N39°15'W 76 1/2 - 50.16'
NOW A CUT OFF ROTTED STUMP @ 80% DISTANCE

Form 458 on 14" oak N31°W - 50.16 FT
FD NAIL FROM THIS TAG ON GLO BT N 31 W IS MAGNETIC BRG

7150-4 By WITTHOEFT 2/10/90

5-1-2000 R. MAIN

Ed CORNER IN PLACE IN MIXED HARD WOODS.

FS PINE PLANTATION NORTH EAST OF CORNER.

3/4" REBAR SET BY PUT ON EAST EDGE OF
MONUMENT UP 2 FT. FIND WITTHOEFT TAG ON 8"
ROAK S 18° E 18 LKS FROM CORNER.

W OAK 7" N29°E 27.19 FT TO SPK MED; S 16 BT

R OAK 10" S47°E 32.97 FT TO SPK MED; S 16 BT

76

FD FSLP ON 13" ROAK @ LONGVILLE GRADE FR 2312
By WITTHOEFT. FROM WHICH CORNER BRG NORTH
7.46 ch (492 FT)

NEAR THIS FSLP OAK ± 4 FT WEST IS A 3/4"
REBAR SAME VINTAGE AS CORNER REBAR.

MARCH/2001 MAIN

8 FT STEEL SIGN POSTS 3065' NORTH 4015' SOUTH
LINE TO STANDARD NORTH AND SOUTH

North East 1/16 Cor. Sec. 16

G. L. O. Resurvey notes of 1918

Iron post 3/4 long 1" diam. with brass cap marked

NE 1/16 S16

1918

N. Pine 8" N31°30'E 192 1/2 - 126.72'

R. Oak 10" S27°15'W 146 1/2 - 96.36'

S.M.C. on the N 1/16 line Sec. 16 (shore of Lake near NKS)

G.H.O. Resurvey notes of 1918

Iron post 3' long 1" diam. with brass cap marked

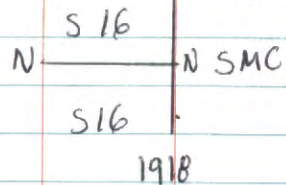

W. Oak 10" S40°W 129.15 - 85.14'

R. Oak 14" S4°45'W 396.15 - 261.36'

W.C. for Angle Point 1 of Allotment 1310,
 Angle Point 4 of Allotment 1347 and a point
 on the west bdy. of Allotment 1698, Sec. 16
 G.L.O. Resurvey notes of 1918
 Iron post 3 1/2 long 1" diam. with brass cap marked

S 16

TR	
1347	
AP4	TR
AD1	1698
TR	
1310	

WC
1918

5-8-2000 REMAIN

IRON FALLS OUT IN HAGEN LAKE WON'T
 BE ABLE TO LOOK FOR UNTILL FREEZE UP.