

T58N R26W 4¹⁵ P.M. Book 5

T58N R26W

Sec 1

South Smith

Lake Sale

Book 5

1881

FIELD BOOK

1881

TRAVERSE

DISTANCES FROM SIDE STAKES FOR CROSS-SECTIONING

Roadway of any Width. Side Slopes 1½ to 1.

In the figure below: opposite 7 under "Cut or Fill" and under .3 read 11.0, the distance out from the side stake at left. Also, opposite 11 under "Cut or Fill" and under .1 read 16.7, the distance out from the side stake at right.

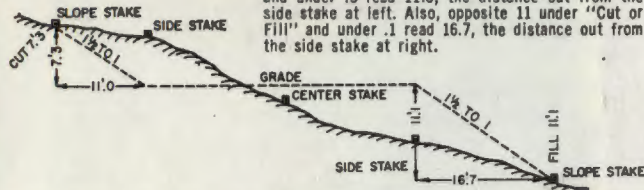

Cut or Fill	Distance out from Side or Shoulder Stake									Cut or Fill	
	0	.1	.2	.3	.4	.5	.6	.7	.8		.9
0	0.0	0.2	0.3	0.5	0.6	0.8	0.9	1.1	1.2	1.4	0
1	1.5	1.7	1.8	2.0	2.1	2.3	2.4	2.6	2.7	2.9	1
2	3.0	3.2	3.3	3.5	3.6	3.8	3.9	4.1	4.2	4.4	2
3	4.5	4.7	4.8	5.0	5.1	5.3	5.4	5.6	5.7	5.9	3
4	6.0	6.2	6.3	6.5	6.6	6.8	6.9	7.1	7.2	7.4	4
5	7.5	7.7	7.8	8.0	8.1	8.3	8.4	8.6	8.7	8.9	5
6	9.0	9.2	9.3	9.5	9.6	9.8	9.9	10.1	10.2	10.4	6
7	10.5	10.7	10.8	11.0	11.1	11.3	11.4	11.6	11.7	11.9	7
8	12.0	12.2	12.3	12.5	12.6	12.8	12.9	13.1	13.2	13.4	8
9	13.5	13.7	13.8	14.0	14.1	14.3	14.4	14.6	14.7	14.9	9
10	15.0	15.2	15.3	15.5	15.6	15.8	15.9	16.1	16.2	16.4	10
11	16.5	16.7	16.8	17.0	17.1	17.3	17.4	17.6	17.7	17.9	11
12	18.0	18.2	18.3	18.5	18.6	18.8	18.9	19.1	19.2	19.4	12
13	19.5	19.7	19.8	20.0	20.1	20.3	20.4	20.6	20.7	20.9	13
14	21.0	21.2	21.3	21.5	21.6	21.8	21.9	22.1	22.2	22.4	14
15	22.5	22.7	22.8	23.0	23.1	23.3	23.4	23.6	23.7	23.9	15
16	24.0	24.2	24.3	24.5	24.6	24.8	24.9	25.1	25.2	25.4	16
17	25.5	25.7	25.8	26.0	26.1	26.3	26.4	26.6	26.7	26.9	17
18	27.0	27.2	27.3	27.5	27.6	27.8	27.9	28.1	28.2	28.4	18
19	28.5	28.7	28.8	29.0	29.1	29.3	29.4	29.6	29.7	29.9	19
20	30.0	30.2	30.3	30.5	30.6	30.8	30.9	31.1	31.2	31.4	20
21	31.5	31.7	31.8	32.0	32.1	32.3	32.4	32.6	32.7	32.9	21
22	33.0	33.2	33.3	33.5	33.6	33.8	33.9	34.1	34.2	34.4	22
23	34.5	34.7	34.8	35.0	35.1	35.3	35.4	35.6	35.7	35.9	23
24	36.0	36.2	36.3	36.5	36.6	36.8	36.9	37.1	37.2	37.4	24
25	37.5	37.7	37.8	38.0	38.1	38.3	38.4	38.6	38.7	38.9	25
26	39.0	39.2	39.3	39.5	39.6	39.8	39.9	40.1	40.2	40.4	26
27	40.5	40.7	40.8	41.0	41.1	41.3	41.4	41.6	41.7	41.9	27
28	42.0	42.2	42.3	42.5	42.6	42.8	42.9	43.1	43.2	43.4	28
29	43.5	43.7	43.8	44.0	44.1	44.3	44.4	44.6	44.7	44.9	29
30	45.0	45.2	45.3	45.5	45.6	45.8	45.9	46.1	46.2	46.4	30
31	46.5	46.7	46.8	47.0	47.1	47.3	47.4	47.6	47.7	47.9	31
32	48.0	48.2	48.3	48.5	48.6	48.8	48.9	49.1	49.2	49.4	32
33	49.5	49.7	49.8	50.0	50.1	50.3	50.4	50.6	50.7	50.9	33
34	51.0	51.2	51.3	51.5	51.6	51.8	51.9	52.1	52.2	52.4	34
35	52.5	52.7	52.8	53.0	53.1	53.3	53.4	53.6	53.7	53.9	35
36	54.0	54.2	54.3	54.5	54.6	54.8	54.9	55.1	55.2	55.4	36
37	55.5	55.7	55.8	56.0	56.1	56.3	56.4	56.6	56.7	56.9	37
38	57.0	57.2	57.3	57.5	57.6	57.8	57.9	58.1	58.2	58.4	38
39	58.5	58.7	58.8	59.0	59.1	59.3	59.4	59.6	59.7	59.9	39
40	60.0	60.2	60.3	60.5	60.6	60.8	60.9	61.1	61.2	61.4	40

58 26 BOOK # 5 No.

A	2	3	4	5	6	7	8	9	10	11	12	13	14	15	16	17	18	19	20	21	22	23	24	25	
B																									
C	0																			2					
D																									
E																									
F																									
G	7													10					11						
H																									
J																									
K																									
L	16													15						11					13
M																									
N																									
O																									
P	10																								
Q																									
R																									
S																									
T	30																								
U																									
V																									
W																									
X	31																								
Y																									
Z																									

SCALE.—One inch = 1 mile.



The paper in this book is made of 50% high grade rag stock with a WATER RESISTING surface sizing.

KEUFFEL & ESSER CO.

21

50

49

48

47

46

45

44

43

42

451

2

3

4

5

6

7

8

9

10

11

12

13

14

15

16

17

18

19

20

51-34

34

33

32

31

30

29

28

27

26

25

24

23

22

21

20

19

36

35

51-40

39

38

37

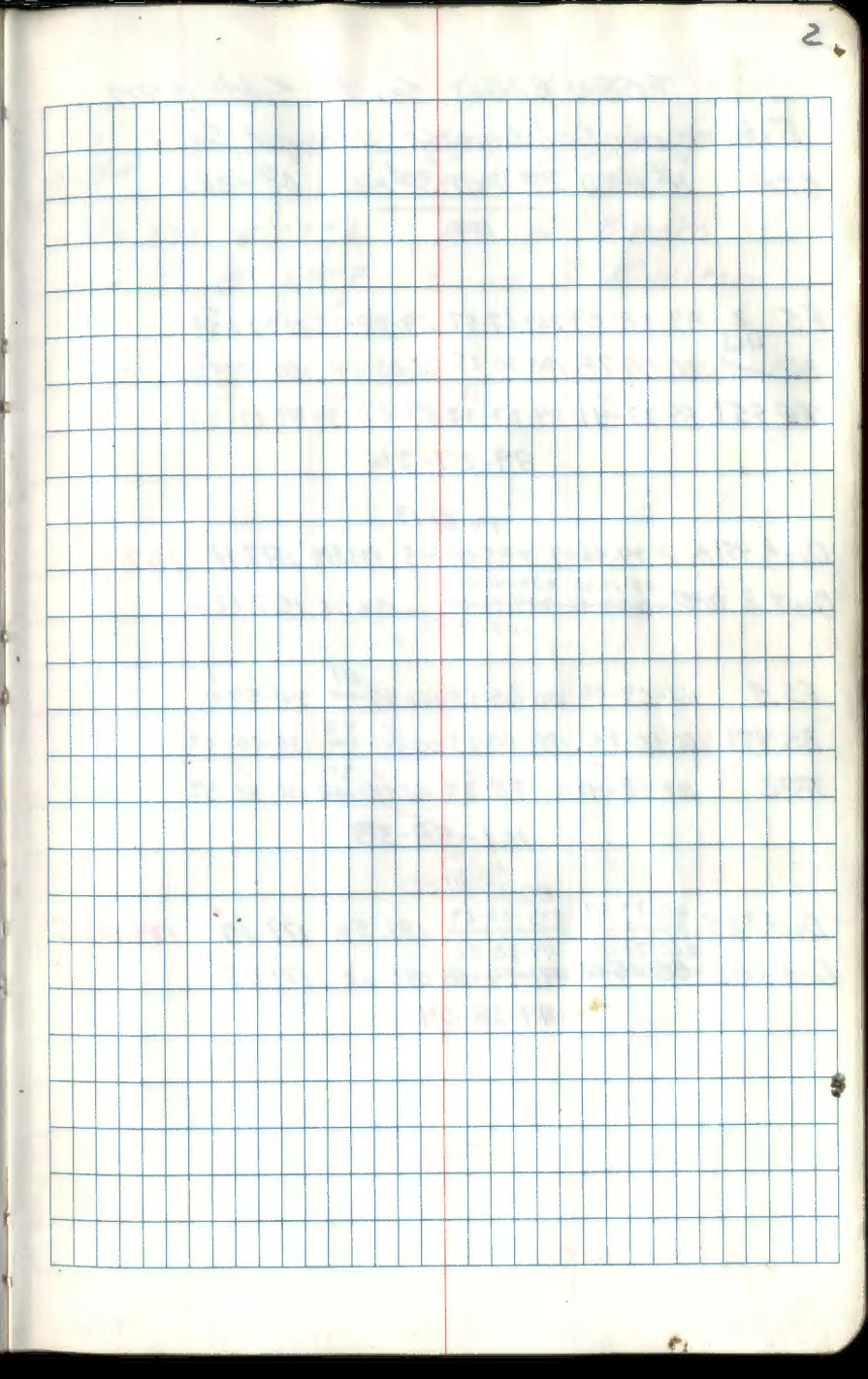
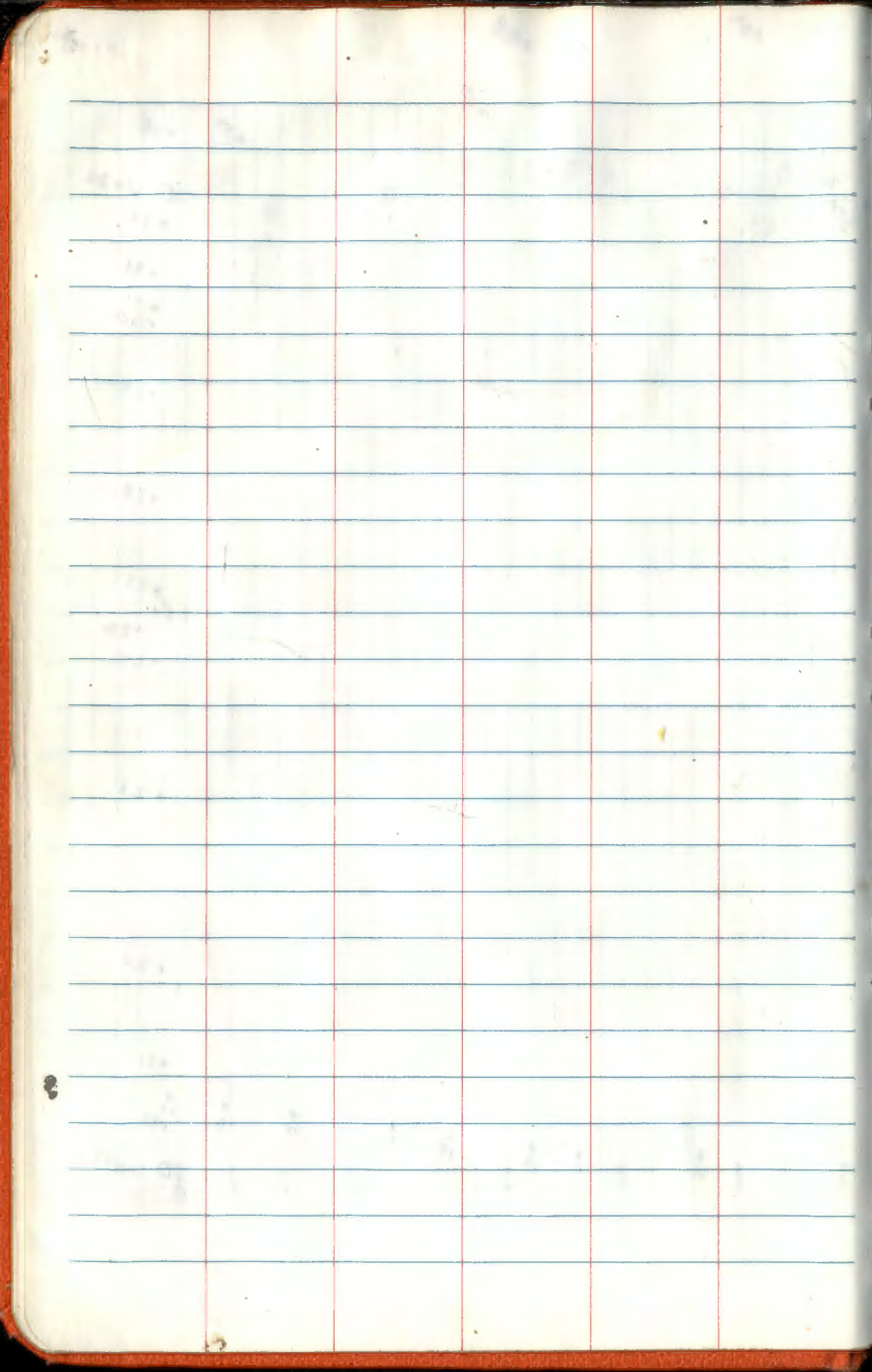

3
T58N R26W Sec 1 Subdivision

Exterior control traverse around Sec 1

STA 1st H&D 2nd H&D 3rd H&D 4th H&D

H&D

FS 2 89-28-09 269-27-57 89-28-02 269-27-52

BS ⁴⁶¹ 00-00-28 180-00-25 00-00-28 180-00-15

TO 451 89-27-41 89-27-32 89-27-34 89-27-37

89-27-36

74-51-13

Dist 451 to 2 74-51-09 285-08-43 193.84 187.11 187.12

Dist 2 to 451 ^{105-19-50 254-40-05} 80-27-37 279-26-29 194.02 187.12

105-19-53

FS 3 161-59-06 341-58-55 161-59-01 341-59-01

BS 451 00-00-26 180-00-23 00-00-24 180-00-22

TO 2 161-58-40 161-58-32 161-58-48 161-58-39

161-58-38

Dist 2 to 3 ^{80-33-37 80-33-34} 105-19-50 229-26-29 181.56 179.10 179.025

Dist 3 to 2 ^{260-21-05 99-38-52} 80-05-02 271-54-58 181.62 179.05

89-38-54

CK WA

3
Sept 6, 1983

T-2 SW 265184

SW

RPR = 27.1

ELF = +2

Temp @ 68°F

Clear, windy, mild

T. F. B. Husk

P.C. G. Kosanko

Surveyor G. Robertson

40d spike

4' SW

11.81'

5.21'

3' Birch

60d spike

T58N R20W Sec 1 Subdivision

Transect cont'd from pg 3

STA 1st H&D 2nd HAR 3rd H&D 4th HAR

H&D

FS 4 179-17-53 359-17-48 179-17-57 359-17-49

BS 2 00-00-33 180-00-30 00-00-31 180-00-29

STAD 3 179-17-20 179-17-18 179-17-26 179-17-20

179-17-21

3+04 88-05-02 271-54-58 88-05-02 268.69 268.54 268.51

4+03 267-56-27 92-03-35 268.69 268.52

92-03-34

FS 5 179-46-27 359-46-22 179-46-19 359-46-19

BS 3 00-00-30 180-00-24 00-00-25 180-00-22

TA 4 179-45-57 179-45-58 179-45-54 179-45-57

179-45-57

95-06-00

Dist 4 to 5 95-06-02 264-54-03 415.12 413.48 413.465

Dist 5 to 4 84-59-15 275-10-39 415.04 413.45

84-59-18

CKWA

Sept. 6, 1983

6' Birch
60 d spike
10' Birch

2"
3" MAPLE
4" Birch
60 d spike
7.79

T58N R26W Sec 1 Subdivision

Traverse cont'd from pg 4

STA 1st H&D 2nd H&R 3rd H&D 4th H&R

FS 6 181-24-52 01-24-50 181-24-54 01-24-54

BS 4 10-00-25 10-00-22 00-00-28 10-00-20

T@5 181-24-27 181-24-28 181-24-26 181-24-34

181-24-29

98-59-16

Dist 5 to 6 ~~98-59-17~~ 261-00-45 129.28 127.69 127.675

Dist 6 to 5 278-42-43 81-17-30 129.15 127.66

81-17-24

FS 7 179-58-28 359-58-25 179-58-33 359-58-28

BS 5 00-00-18 180-00-10 00-00-17 180-00-13

T@6 179-58-10 179-58-15 179-58-16 179-58-15

179-58-14

87-54-10

Dist 6 to 7 87-54-09 272-05-49 428.62 428.33 428.325

Dist 7 to 6 92-11-14 267-48-44 428.63 428.32

92-11-15

CKWA

8" Birch



2.13

2.13

60d spike



3" Birch

8" Birch

9.56

60d spike

15.14"
12" BALSAM

T58N R26W SEC 1 Subdivision

TRAVERSE CONT. FROM PAGE 5

STA 1st H&R 2nd H&R 3rd H&R 4th H&R

FS 8 184-48-06 04-47-55 184-49-06 04-47-59

BS 6 00-00-27 180-00-12 00-00-25 180-00-19

T@ 7 184-47-39 184-47-38 184-47-41 184-47-40

184-47-40 ✓

90-39-46

7+08 90-39-45 269-20-14 434.99 434.96 ✓ 434.95

8+07 270-34-30 89-25-29 434.96 434.94 ✓

89-25-30

FS 9 179-34-00 359-33-58 179-34-05 359-34-00

BS 7 00-00-10 180-00-06 00-00-09 180-00-08

T@ 8 179-33-50 179-33-52 179-33-56 179-33-52

179-33-53 ✓

90-06-04

8+09 90-06-05 269-53-58 367.62 367.62 ✓ 367.615

9+08 270-00-03 90-00-12 367.61 367.61 ✓

90-00-05

CKWA

9-7-83

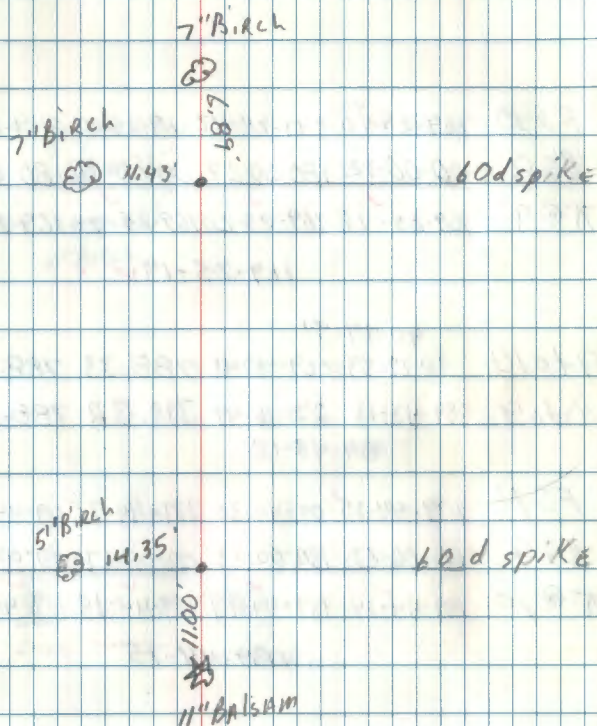

T58N R26W SEC. 1 Subd.

TRAVERSE CONT. FROM PAGE 6

STA 1st H&D 2nd H&R 3rd H&D 4th H&R

FS 10 169-25-50 349-25-42 169-25-46 349-25-38

BS 8 100-00-32 180-00-27 00-00-26 180-00-19

T@ 9 169-25-18 169-25-20 169-25-20 169-25-19

169-25-19 ✓

90-19-51

9 to 10 90-19-53 269-40-11 788.33 788.32 788.315

10 to 9 89-43-13 270-16-49 788.32 788.31 ✓

89-43-12

FS 11 189-44-35 09-44-30 189-44-35 09-44-27

BS 9 00-00-21 180-00-13 00-00-17 180-00-17

T@ 10 189-44-14 189-44-17 189-44-18 189-44-10

189-44-15 ✓

90-31-39

10 to 11 90-31-40 269-28-23 438.72 438.70 ✓ 438.715

11 to 10 270-26-28 89-33-38 438.74 438.73 ✓

89-33-35

C I C W A

3" spruce

6.76'

5.85'

4" birch

60 d spike

15.88'

31.87'

60 d spike

5" dead
birch

4" birch

T58N R26W SEC. 1 Subdivision

TRAVERSE Cont. from Page 7

STA 1st H&D 2nd H&R 3rd H&D 4th H&R

FS 12 180-17-33 00-17-22 180-17-25 00-17-22
 BS 10 180-00-18 180-00-06 00-00-10 180-00-07
 X@ 11 180-17-15 180-17-16 180-17-15 180-17-15
 180-17-15 ✓

88-07-42

11+012 88-07-43 271-52-19 186.08 185.98 ✓ 185.985

12+011 92-04-15 267-55-42 186.11 185.99 ✓

92-04-17

7

FS 13 179-28-18 359-28-16 ~~96-1~~ 179-28-19 359-28-14

BS 11 00-00-26 180-00-18 00-00-24 180-00-19

X@ 12 179-27-52 179-27-58 179-27-55 179-27-55

179-27-55

90-13-08

12+013 90-15-55 269-49-40 266.09 266.09 ✓ 266.095

13+012 270-07-19 89-52-45 266.10 266.10 ✓

89-52-43

OK WA

5' BALSAM
 1175'
 79'
 5' MAPLE

60d spike

8' MAPLE

831

60d spike

5' MAPLE

9 T58N R26W Sec. 1 Subdivision

TRAVERSE CONT. FROM PAGE 8

STA 1st H&D 2nd H&R 3rd H&D 4th H&R

FS 14 177-59-51 357-59-32 177-59-53 357-59-55

BS 12 10-00-30 180-00-23 10-00-30 180-00-25

X@ 13 177-59-21 177-59-29 177-59-23 177-59-30

177-59-26 ✓

98-04-57

13 to 14 98-04-58 261-55-04 203.17 201.15 ✓ 201.155

14 to 13 82-05-55 277-54-12 203.09 201.16 ✓

82-05-52

FS 15 178-43-18 358-43-15 178-43-17 358-43-13

BS 13 00-00-29 180-00-19 20-00-28 180-00-22

X@ 14 178-42-49 178-42-56 178-42-49 178-42-51

178-42-51 ✓

91-24-36

14 to 15 91-24-38 268-35-26 388.86 388.74 ✓ 388.75

15 to 14 271-18-40 88-41-23 388.87 388.76 ✓

88-41-22

CK WA

9

13" Birch

5.5'

60d spike

5.92'

Twin balsam

7" birch

5.69'

60d spike

16.13'

4" balsam

T58N R26W Sec. 1 Subdivision
 Traverse Contd from pg. 9

FS 16 180-46-13^{5 1/2} 00-46-08 180-46-08 00-46-03
 BS 14 00-00-27 180-00-21 00-00-29 180-00-21
 T@ 15 180-45-46 180-45-47 180-45-39 180-45-42
 180-45-44 ✓

91-50-47
 15 to 16 91-50-45 268-09-10 403.75 403.54 - 403.545
 16 to 15 88-14-49 271-45-09 403.74 403.55 ✓
 88-14-50

FS 17 179-40-25 359-40-14 179-40-25 359-³⁹⁻³⁰~~40-17~~
 BS 15 00-00-17 180-00-09 00-00-13 179-59-26
 T@ 16 179-40-08 179-40-05 179-40-12 179-40-⁰⁴51
 179-40-07 ✓

90-18-17
 16 to 17 90-18-19 269-41-46 243.66 243.66 - 243.675
 17 to 16 270-08-55 89-51-05 243.69 243.69 ✓
 89-51-05

CKWA

9-7-83

5" Balsam

★

7" Balsam

✕

60 d spike

10.49

4.17

6" ash

6" Elm

6.60

10.52

60 d spike

T58N R26W Sec. 1 Subdivision

Cont'd from pg. 10

FS 18	222-47-54	92-47-50	272-47-34	92-47-47
BS 16	00-00-17	180-00-12	00-00-16	180-00-15
T@ 17	272-47-37	272-47-38	272-47-38	272-47-32
		272-47-36		

90-00-47
Dist 17 to 18 90-00-49 269-59-15 424.96 424.96 ✓ 424.95

Dist 18 to 17 90-04-35 268-50-55 424.96 424.94 ✓
90-36-50

FS 19 15-52-46 195-52-42 15-52-44 195-52-40

BS 17 00-00-28 ¹⁸⁰⁻⁰⁰⁻²³ ~~195-52-42~~ 00-00-28 180-00-20

T@ 18 15-52-18 15-52-19 15-52-16 15-52-20
15-52-18 ✓

Dist 18 to 19 90-36-51
91-09-05 269-55-24 54.26 54.26 ✓ 54.26

Dist 17 to 18 89-32-21 270-27-48 54.26 54.26 ✓
89-32-17

CKWA

9-7-83

8" SPRUCE



8" BS

8" SPRUCE

60 d spike

9.63
7' Tam

9.63

6' Tam

60 d spike

T58N R26W Sec 1. Subdivision
Cont'd from pg 11

F5 20 160-29-50 ²⁹⁻³⁹ 340-29-27 160-29-46 340-29-43

BS 18 00-00-34 180-00-28 00-00-35 180-00-22

X @ 19 160-29-16 160-29-11 160-29-11 160-29-21

160-29-15 ✓

90-04-59

19-20 90-05-07 269-55-10 212.90 212.90 ✓ 212.89

20-19 90-05-42 269-59-16 212.88 212.88 ✓
90-05-43

FS 21 183-39-09 03-39-02 183-39-09 03-39-02

BS 19 180-00-29 180-00-23 00-00-34 180-00-18

X @ 20 183-38-40 183-38-39 183-38-35 183-38-45

183-38-40 ✓

89-47-36

20+021 89-47-37 270-12-26 386.14 386.14 ✓ 386.135

21+020 269-41-48 90-18-19 386.14 386.13 ✓
90-18-16

CK with

9-7-83

STA 19 - iron
pipe at location
of Section corner
SE. of Sec 1

12" ASPEN
14" ASPEN
36" 2'

40 d spike

T58N R26W Sec. 1 Subd.
Cont. from Page 12

FS 22 180-10-26 00-10-23 180-10-28 00-10-20

BS 20 00-00-33 180-00-23 00-00-32 180-00-24

T@ 21 180-09-53 180-10-00 180-09-56 180-09-56

180-09-56 ✓

86-40-04

21+22 86-40-07 273-20-00 431.26 430.53 ✓ 430.52

22+21 266-34-44 93-25-18 431.28 430.51 ✓

93-25-17

FS 23 180-03-~~24~~²⁴ 00-03-~~20~~²⁰ 180-03-31 00-03-22

BS 21 00-00-~~21~~²¹ 179-59-56 00-00-04 179-59-56

T@ 22 180-03-~~24~~²³ 180-03-24 180-03-27 180-03-26

180-03-25 ✓

88-46-35

22+23 88-46-35 271-13-26 724.56 724.39 ✓ 724.365

23-22 268-44-20 91-15-46 724.52 724.34 ✓

91-15-43

CKW 1A

6" ASPEN

⊙

2400'

⊙

640'

⊙

7" MAPLE

4" MAPLE

⊙

1203'

⊙

6" ASPEN

⊙

952'

County Point
60 d spike

60 d spike

T5BN R26W Sec. 1 Sub.

TRAVERSE Cont. from Page 13

STA 1st H&D 2nd H&R 3rd H&D 4th H&R

FS 24 180-06-08 00-06-01 180-06-06 00-05-59

BS 22 00-00-20 180-00-09 00-00-13 180-00-07

T@ 23 180-05-48 180-05-52 180-05-53 180-05-52

180-05-51

89-34-26

23 to 24 89-34-29 270-25-38 612.54 612.52 612.51

24 to 23 90-29-26 269-30-31 612.52 612.50

90-29-28

FS 25 179-34-31 359-34-22 179-34-27 359-34-27

BS 23 00-00-21 180-00-08 00-00-12 180-00-18

T@ 24 179-34-10 179-34-14 179-34-15 179-34-19

179-34-15

93-01-31

24 to 25 93-01-35 266-58-32 294.31 293.90 293.89

25 to 24 87-03-39 272-58-23 294.27 293.88

87-03-38

CKWA

5" ASPEN

5-05'

5" ASPEN

8-49'

60 d spike

P.O.S.

T58N R26W Sec 1 Subdivision

Traverse Cont'd from Pg 14

STA 1st H&D 2nd H&R 3rd H&D 4th H&RFS 26 349-51-55 169-51-48 ~~169-51-58~~ 349-51-54 169-51-53

BS 24 00-00-22 180-00-17 00-00-25 180-00-14

T@ 25 349-51-33 349-51-41³¹ 349-51-29 349-51-39

349-51-33 ✓

91-06-44

25-26 91-06-44 268-53-16 63.39 63.38 ✓ 63.38

26-25 270-31-11 89-28-59 63.38 63.38 ✓
89-28-54

FS 27 03-02-48 183-02-40 03-02-44 183-02-40

BS 25 00-00-30 180-00-20 00-00-27 180-00-23

T@ 26 03-02-18 03-02-20 03-02-17 03-02-17

03-02-18 ✓

89-57-55

26 to 27 89-57-56 270-02-07 92.03 92.03 ✓ 92.03

27 to 26 269-33-37 90-26-18 92.03 92.03 ✓
90-26-20

CIRWA

9-8-83

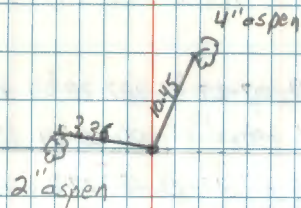
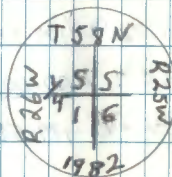
County PA.
60 d spike

T58N R26W Sect Subd.

TRAVERSE CONT, FROM PAGE 15

STA 1st H&D 2nd H&R 3rd H&D 4th H&R

FS 28 187-27-59 07-27-52 187-28-00 07-27-50

BS 26 180-00-34 180-00-26 00-00-34 180-00-22

T@ 27 187-27-25 187-27-26 187-27-26 187-27-28

187-27-26 ✓

27 to 28 89-55-31
89-55-31 270-04-24 410.08 410.08 ✓ 410.0928 to 29 269-54-22 90-05-33 410.10 410.10 ✓
90-05-36

FS 29 179-58-43 359-58-31 179-58-37 359-58-30

BS 27 00-00-25 180-00-18 00-00-27 180-00-17

T@ 28 179-58-18 179-58-13 179-58-10 179-58-13

179-58-14 ✓

28 to 29 90-08-55
90-09-01 269-51-11 688.20 688.20 ✓ 688.20529 to 28 270-05-35 89-54-26 688.21 688.21 ✓
89-54-25

CKWA

3.52
3" ASPEN
60d spike
3/8
4" ASPEN

3" ASPEN
County
60d spike
3.78
5" ASPEN

T58 N R26 W Sec. 1 Subd.

TRAVERSE Cont. From PAGE 16

Sta. 1st H&D 2nd H&R 3rd H&D 4th H&R

FS 30 180-52-26 00-52-23 180-52-30 00-52-24

BS 28 00-00-30 180-00-24 00-00-30 180-00-22

T@ 29 180-51-56 180-51-59 180-52-00 180-52-02

180-51-59 ✓

89-32-37

29 to 30 89-32-41 270-27-27 589.87 589.85 - 589.86

30 to 29 90-31-27 269-28-44 589.89 589.87 ✓

90-31-22

FS 31 176-27-02 356-26-54 176-27-03 356-26-56

BS 29 00-00-19 180-00-18 00-00-21 180-00-14

T@ 30 176-26-43 176-26-36 176-26-42 176-26-42

176-26-41

91-36-12

30 to 31 91-36-14 268-23-51 104.21 104.17 - 104.175

31 to 30 88-45-21 271-14-44 104.20 104.18 ✓

88-45-18

CKWA

9-8-83

7" Birch

29

29.22

5.70

5" Birch

11" ASPEN

14.39

14.39

5" ASPEN

12.69

60d spike

T58N R26W Sec 1. Subd.

Traverse Contd from Pg 17

STA 1stH&D 2ndH&R 3rdH&D 4thH&RFS 32 183-22-12¹² 183-22-10 183-22-14 183-22-09BS 30 00-00-24¹⁴ 180-00-08 00-00-16 180-00-09TQ 31 183-21-58⁵⁸ 183-22-02 183-21-58 183-22-00

183-22-00 ✓

93-22-49

7 52

Dist 31-32 93-22-55 266-32-14 192.13 191.78 ✓ 191.79

Dist 32-31 273-16-03 86-44-02 192.11 191.80 ✓
86-44-00

FS 33 179-17-09 359-17-06 179-17-91 359-17-02

BS 31 00-00-24 180-00-12 00-00-15 180-00-12

TQ 32 179-16-45 179-16-54 179-16-56 179-16-50

179-16-51

87-50-19

32+033 87-50-20 272-09-43 354.17 353.92 ✓ 353.915

33+032 92-16-09 267-43-51 354.19 353.91 ✓
92-16-09

CK WK

9-8-83

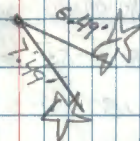

STA 31 = 60' spike

5' JACK PINE

425'

5' 80'

5' ASPEN

60' spike

T58N R26W Sec 1. Subd.

Traverse Cont'd from pg 18

STA 1st H&O 2nd HAR. 3rd H&O 4th HAR

FS 34	180-11-17	00-11-14	180-00-25	00-11-13
-------	-----------	----------	----------------------	----------

BS 32	00-00-25	180-00-20	00-00-27	180-00-25
-------	----------	-----------	----------	-----------

T@ 33	180-10-22	180-10-54	180-10-46	180-10-53
-------	-----------	-----------	----------------------	-----------

180-10-54

94-44-10

33-34	94-44-10	265-15-50	169.17	168.59
-------	----------	-----------	--------	--------

34-33	85-06-20	274-53-43	169.21	168.59
-------	----------	-----------	--------	--------

See page 38 for continuation
of traverse

CK WOT

9-8-83

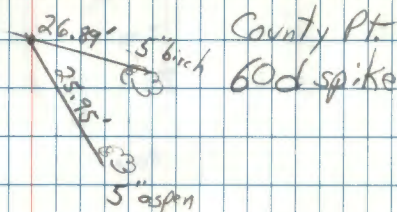

STA 34 =

Twp
Corner

Itasca co. monument
w/cap broken off

101 • 451

102 •

103 •

104 •

105 •

106 •

107 •

• 108

• 109

• 110

• 111

• 112

114 • 113

• 112

• 57A115

• 116

• 117

• 118

• 119

• 120

• 121

• 122

• 123

• 124

T58N R26W Sec. 1 subdivision

Traverse Cont'd from Pg. 1 To south

STA 1stHAD 2ndHAR 3rdHAD 4thHAR

HA

FS 101 252-03-³⁷41 72-03-²⁷24 252-03-35 72-03-25BS ~~46~~ 00-00-10 180-00-⁰²07 00-00-11 180-00-05T@ 451 252-03-²⁷24 252-03-²⁵11 252-03-24 252-03-20

252-03-24 ✓

D^s 451 101 78-15-41 281-44-18 78-15-42 242.68' 237.59 ✓D^s 101 to 451 101-53-34 258-06-20 101-53-37 242.79' 237.58

FS 102 75-27-51 255-27-47 75-27-56 255-27-56

BS @ 451 00-00-16 180-00-11 00-00-18 180-00-12

T@ 101 75-27-35 75-27-36 75-27-38 75-27-44

75-27-38

Dist 101-102 87-00-36 222-59-38 87-00-29 525.95' 525.23 ✓

Dist 102-101 93-04-00 266-56-07 93-03-57 525.99' 525.24 ✓

CK WA

9-12-83

G. Kasenka - P. Chief

hazy, cool

B. Ausk - Aid

Temp - low 60's

G. Robertson - X → M

Hg - 29.7

Wild T2 #265184

Environmental Correction - 0

Leitz Red 1A

237.59 ✓

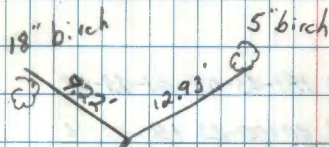

STA 101 = 60 d spike

525.24 ✓

T58N R26W Sec 1 subdivision

Traverse Cont'd from pg 21

STA 1st H&D 2nd H&R 3rd H&D 4th H&R

H 4

FS 103 153-28-49 ⁴⁵333-28-49 153-28-47 333-28-37BS 101 00-00-17 180-00-~~24~~⁰⁹ 00-00-08 180-00-03T@ 102 153-28-32 ⁻³⁶153-28-~~45~~ 153-28-39 153-28-34

153-28-35

Dist 102-103 88-36-58 271-23-12 88-36-53 475.50' 475.36

Dist 103-102 91-28-01 268-32-01 91-28-00 475.50' 475.34

FS 104 181-43-05 01-43-04 181-43-07 01-43-02

BS 102 00-00-20 180-00-17 00-00-23 180-00-12

T@ 103 181-42-45 181-42-47 181-42-44 181-42-50

181-42-47

Dist 103-104 93-31-20 266-28-44 93-31-18 515.44 514.47

Dist 104-103 86-33-00 273-26-48 86-33-06 515.~~42~~⁴² 514.49

CK WA

9-12-83

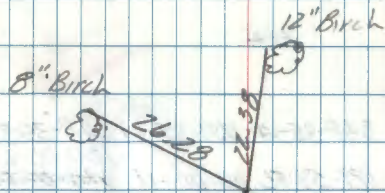

STA 102 = 60 d spike

475.35 ✓

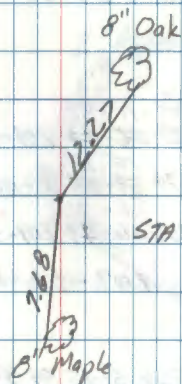

STA 103 = 60 d spike

514.48 ✓

T58N R24W Sec 1 Sub

Traverse cont'd from pg 22

STA 1st H&D 2nd H&D 3rd H&D 4th H&D

HA

FS 105 168-35-41 348-35-39 168-35-41 348-35-36

BS 103 00-00-⁰³~~11~~ 179-57-56 00-00-11 ~~348-35-36~~
180-00-01

T@ 104 168-35-39 168-35-38 168-35-30 168-35-35

168-35-35 ✓

Dist 104-105 91-17-40 268-47-22 91-17-26 635.08 634.92 ✓

Dist 105-104 88-46-06 271-13-59 88-46-03 635.05 634.90 ✓

FS 106 209-56-43 ²⁹~~29~~-11-38 ~~43~~ 209-56-42 29-56-31 ³⁴BS 104 00-00-11 ^{15 12}~~11~~ 179-57-~~51~~ 00-00-12 188-00-10T@ 105 209-56-32 ¹⁶⁻²¹~~41~~ 209-56-30 209-56-24

209-56-28 ✓

Dist 105-106 91-08-22 268-51-27 91-08-27 304.40 304.34 ✓

Dist 106-105 88-58-54 271-01-07 88-58-54 304.40 304.35 ✓

CK WA

Sept 12, 1983

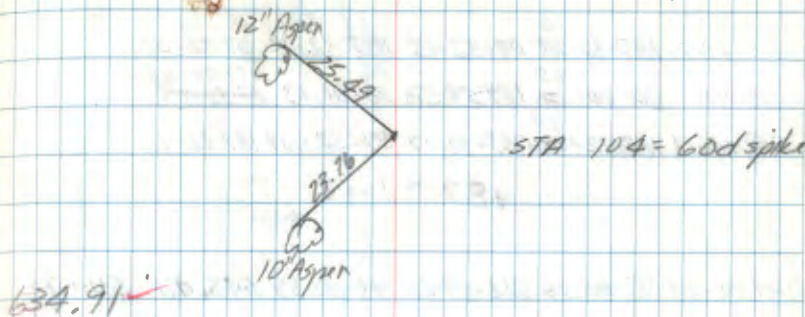

STA 104 = 60d spike

634.91 ✓

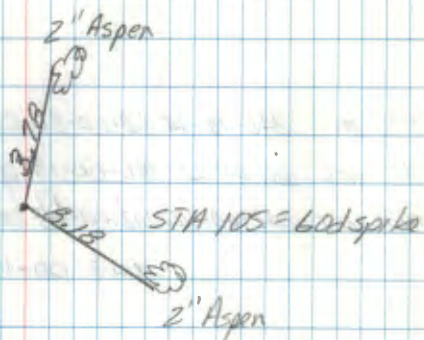

STA 105 = 60d spike

304.35 ✓

T58N R26W Sec 1 Subdivision

Traverse cont'd from pg 23

STA 1st H&D 2nd H&R 3rd H&D 4th H&R

H X

FS 107	187-32- 18 ¹⁰	07-32-15	187-32-12	07-32-09
BS 105	00-00- 18 ⁰⁵	179-59-58	00-00-03	179-59-53
PI@ 106	187-32- 00 ⁰⁷	187-32-17	187-32-09	187-32-16
	187-32-12 ✓			

Dist 106-107 93-00-36 266-59-26 93-00-35 545.48 544.73 ✓

Dist 107-106 87-03-25 272-56-36 87-03-25 545.44 544.72

FS 108	242-00-44	62-00-36	242-01-00	62-01-00
BS 106	00-00-32	186-00-19	00-00- 27 ⁵⁴	180-00-59
PI@ 107	242-00-12	242-00- 15 ¹⁷	242-00- 52 ⁰⁶	242-00-06
	242-00-10 ✓			

Dist 107-108 89-43-57 270-16-11 89-43-53 461.44 461.43 ✓

Dist 108-107 90-21-05 269-39-02 90-21-01 461.46 461.45

CKWA

Sept 12, 1983

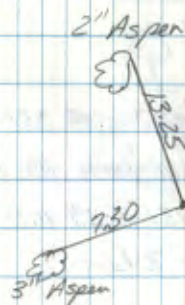

STA 106 = bad spike

544.73 ✓



STA 107 = bad spike

461.44 ✓

T58N R26W Sec 1 Subdivision

Traverse cont'd from pg 24

STA 1st H&D 2nd H&R 3rd H&D 4th H&R

H&R

FS 109 157-15-~~32~~³² 337-15-31 157-15-34 337-15-27BS 107 00-00-~~17~~¹⁶ 180-00-03 00-00-11 180-00-00T@ 108 157-15-~~25~~²⁶ 157-15-28 157-15-23 157-15-27

157-15-26 ✓

Dist 108-109 90-13-51 26446-02 90-13-55 784.30 784.29

Dist 109-108 89-43-47 270-10-54 89-43-57 784.29 784.29

FS 110 141-19-24 321-19-17 141-19-27 321-19-08

BS 108 00-00-32 180-00-18 00-00-24 186-00-09

T@ 109 141-18-52 141-18-59 141-19-03 141-18-59

141-18-58 ✓

Dist 109-110 91-19-33 268-40-20 91-19-37 570.04 569.89

Dist 110-109 88-44-12 271-15-33 88-44-20 570.06 569.92

CKWA

Sept 12, 1983



STA 108 = 60 d spike

784.29 ✓



STA 109 = 60 d spike

569.91 ✓

TSBN P26W Sec 1 Subdivision

Traverse cont'd from pg. 25

STA 1st H&D 2nd H&R 3rd H&D 4th H&R

H&R

FS 111 ~~222-28-25~~ ¹⁴ 42-28-22 ~~222-28-27~~ 42-28-13BS 109 ~~00-00-26~~ ¹⁸ 180-00-22 ~~180-00-18~~PI@ 110 ~~222-27-59~~ ²⁷⁻⁵⁶ 222-28-12 ~~222-28-15~~ 222-27-55

222-27-59 ✓

Dist 110-111 87-49-47 272-10-16 87-49-46 362.96 362.70

Dist 111-110 92-16-20 267-43-36 92-16-22 362.98 362.69

FS 112 198-52-25 18-52-12 198-52-23 18-52-17

BS 110 00-00-39 180-00-25 00-00-38 180-00-25

PI@ 111 198-51-46 198-51-47 198-51-45 198-51-52

198-51-48 ✓

Dist 111-112 89-36-18 270-23-46 89-36-16 416.42 416.41

Dist 112-111 90-29-15 269-30-40 90-29-18 416.43 416.41

CKWA

Sept 12, 1983

3' Aspen

1.28

STA 110 = 60d spike

2.70

3' Aspen

362.70 ✓

11.86

3' Aspen

STA 111 = 60d spike

11.34

2" Birch

416.41 ✓

T58N R26W Sec 1 Subdivision

Traverse cont'd from pg 26

STA 1st H&D 2nd H&R 3rd H&D 4th H&R

H4

FS 113 206-07-32 26-07-25 206-07-32 26-07-23

BS 111 00-00-28 180-00-20 00-00-24 180-00-18

TI@ 112 206-07-04 206-07-05 206-07-06 206-07-05

206-07-05 ✓

Dist 112-113 91-33-42 268-26-19 91-33-42 581.28 581.06

Dist 113-112 88-30-23 271-29-42 88-30-21 581.25' 581.05

FS 114 105-36-18 285-36-10 105-36-16 285-36-08

BS 112 00-00-23 180-00-11 00-00-24 180-00-19

TI@ 113 105-35-55 105-35-59 105-35-52 105-55-54

105-35-55 ✓

Dist 113-114 88-34-30 271-25-23 88-34-33 498.92 498.77

Dist 114-113 91-30-08 268-30-00 91-30-04 498.94 498.77

CKWA

Sept 12, 1983

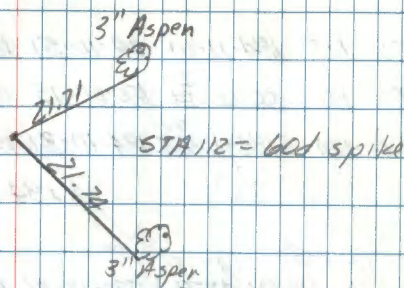

581.06 ✓

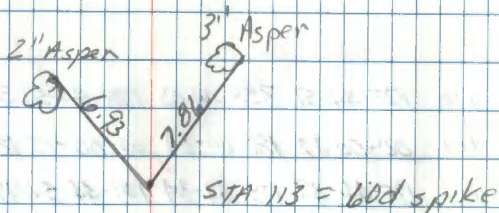

498.77 ✓

T58N R26W Sec 1 Subdivision

Traverse cont'd from pg 27

STA 1st H&D 2nd H&R 3rd H&D 4th H&R
H&D

FS 115 184-11-01 04-10-51 184-10-51 04-10-38
BS 113 00-00-~~19~~²¹ 180-00-15 00-00-24 186-00-13
TI@ 114 184-10-~~17~~⁴⁰ 184-10-36 184-10-27 184-10-25
184-10-32 ✓

114-115 47-36
Dist 115-114 ~~89-47-36~~ 270-12-43 89-47-27 2849.95 2849.93
Dist 114-115 90-14-14 269-45-39 90-14-20 2849.92 2849.90
115-114

FS 116 178-44-56 358-44-43 178-44-51 358-44-43
BS 114 00-00-17 180-00-09 00-00-15 180-00-04
TI@ 115 178-44-39 178-44-34 178-44-36 178-44-39
178-44-37 ✓

Dist 115-116 91-51-27 268-08-37 91-51-25 281.05 280.90
Dist 116-115 88-16-44 271-43-20 88-16-42 281.05 280.92

JDK G.L. 9/15/83

Sept 12, 1983

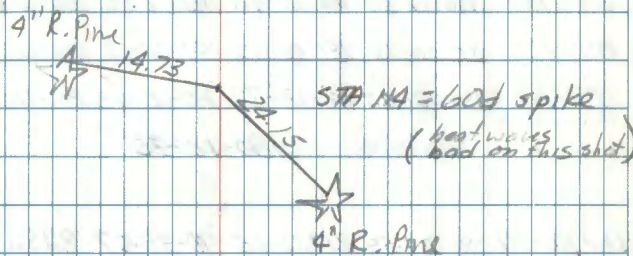

2849.91 ✓

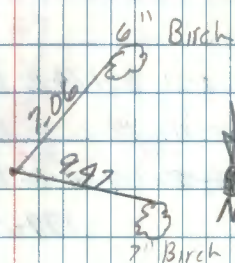

280.91 ✓

T58N R26W Sec 1 Subdivision

Traverse cont'd from pg 28

STA 1st H&D 2nd H&R 3rd H&D 4th H&R
H4

FS 117 180-12-50 00-12-94 180-12-55 00-12-40

BS 115 00-00-10 180-00-05 00-00-10 180-00-09

T@116 180-12-40 180-12-39 180-12-45 180-12-36

180-12-40

Dist 116-117 90-37-59 269-22-05 90-37-57 823.17 823.12

Dist 117-116 89-~~24-47~~²⁵⁻¹⁵ 270-34-30 89-25-22 823.20 823.16

FS 118 179-24-31 359-24-20 179-25-11 359-25-12

BS 116 00-00-~~10~~²⁵ 180-00-15 00-01-11 179-00-~~19~~¹⁹04T@117 179-24-06 179-24-25 179-24-00 179-23-~~53~~⁵⁷

179-24-02

Dist 117-118 82-15-42 277-44-16 82-15-43 171.25 169.69

Dist 118-117 97-57-15 262-02-37 97-57-19 171.34 169.69

✓ OK Pl. 9/15/83

Sept 13, 1983

ptly cldy, cool, breeze

Same crew as previous day

T-2 s/n 265184

Red 1 SN

EGF = +1

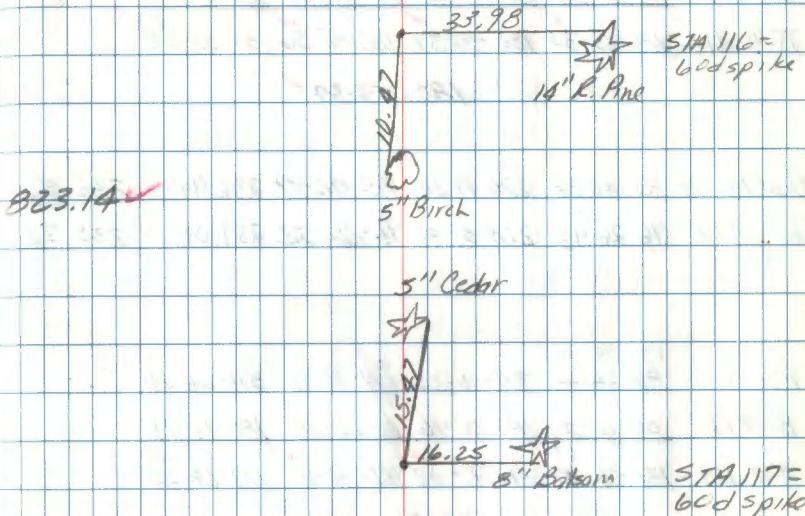

823.14 ✓

169.69 ✓

SPENT 2 1/2 HRS

T58N R26W Sec. 1 Subd. v. sion

Traverse Cont'd from pg. 29

STA 1st H&D 2nd H&R 3rd H&D 4th H&R

#4

FS 119 180-53-54 00-53-51 180-53-57 00-53-~~47~~⁴⁹

BS 117 00-00-20 180-00-15 00-00-21 180-00-21

T@ 118 180-53-34 180-53-36 180-53-36 180-53-26

180-53-34

Dist 118-119 83-42-37 276-17-20 83-42-39 236.94' 235.51

Dist 119-118 96-26-45 263-33-00 96-26-52 237.01' 235.51

FS@ 120 131-06-28
92-26-45 311-06-25 131-06-31 311-06-26

BS@ 118 00-00-24 180-00-16 00-00-29 180-00-21

T@ 119 131-06-~~21~~⁰⁴ 131-06-09 131-06-07 131-06-05

131-06-06

Dist 119-120 91-09-36 268-50-22 91-09-37 287.62' 287.56

Dist 120-119 88-55-07 271-01-52 88-58-08 287.62 287.57

✓ OK Bk 9/15/83

Sept 13, 1983

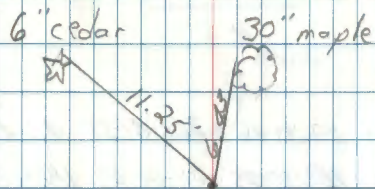

STA 118 = 60d spike

Sept 14, 1983

T-2 S/N 265189

Pthly cldy, breeze

23551 KATHA S/N 4863

PC to G. Kosenko

ELF = 0

T T B. Robertson

Aides - B. Husk

Arks - K. Whisthorn

3" Maple

3" Maple

STA 119 = 60d spike

287.57 ✓

T.58N R.26W Sec 1 Subdivision

Traverse started from pg. 30

STA 1st H&D 2nd H&D 3rd H&D 4th H&D

H &

FS 121	222-49-38	42-49-26	222-49-35	42-49-30
BS @ 119	00-00-13	180-00-03	00-00-09	180-00-04
PC @ 120	222-49-25	222-49-23	222-49-26	222-49-26
		222-49-25		

22

Dist 121-121	93-12-31	266-47-32	93-12-30	153.13'	152.89
Dist 121-120	87-02-31	272-57-52	87-02-20	153.08'	152.88

BS 120	179-47-26	359-47-21	179-47-26	359-47-19
FS 122	00-00-09	180-00-05	00-00-08	180-00-03
PC @ 121	179-47-17	179-47-16	179-47-16	179-47-16
		179-47-17		

~~87-02-31 277-01~~

Dist 121-122	99-56-00	260-04-00	99-56-00	96.55	95.10
Dist 121-121	80-27-17	279-32-46	80-27-16	96.52	95.18

✓ O.K. OK 9/15/83

Sept 14, 1983

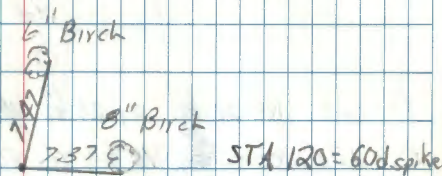

152.88 ✓

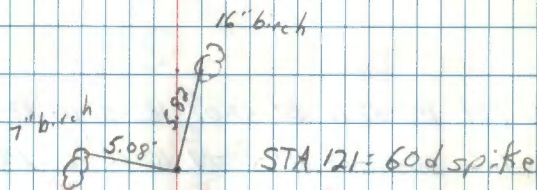

95.14 ✓

T5BN R26W Sec 1 Subdivision

Traverse cont'd from pg. 31.

STA 1st H&D 2nd H&R 3rd H&D 4th H&R

H&R

FS 123 184-28-~~20~~¹⁸ 04-28-~~18~~¹⁶ 184-28-32 04-28-21BS 121 00-00-~~18~~⁰⁸ 180-00-~~18~~ 00-00-22 180-00-04TE 122-184-~~27~~²⁸⁻¹⁰-57 184-28-05 184-28-10 184-28-17

184-28-11 ✓

Dist 122-123 90-18-11 269-41-37 90-18-17 331.53 331.53

Dist 123-122 89-48-20 270-11-24 89-48-28 331.52 331.52

FS 124 182-57-11 02-57-07 182-57-09 02-57-~~04~~⁰¹

BS 122 00-00-19 180-00-09 00-00-16 180-00-06

TE 123 182-56-52 182-56-~~58~~ 184-56-53 182-56-55

182-56-55 ✓

Dist 123-124 92-06-15 267-53-07 92-06-34 364.14 363.89

Dist 124-123 87-59-51 272-00-00 87-59-56 364.13 363.91

VOK Br. 9/15/83

Sept 14, 1983

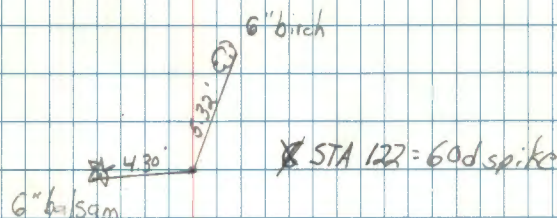

331.52 ✓

8" Maple



5" Maple

5.31

7.60

STA 123 = 60 d spike

363.90 ✓

STA 124 =



Iron pipe w/BC

BS to STA 123 from

TE 124 to NEBT 77-48-00

to SEBT 96-36-20, to Tagged tree 121-59-00, to SWBT 190-35-00

to NWBT 295-38-00

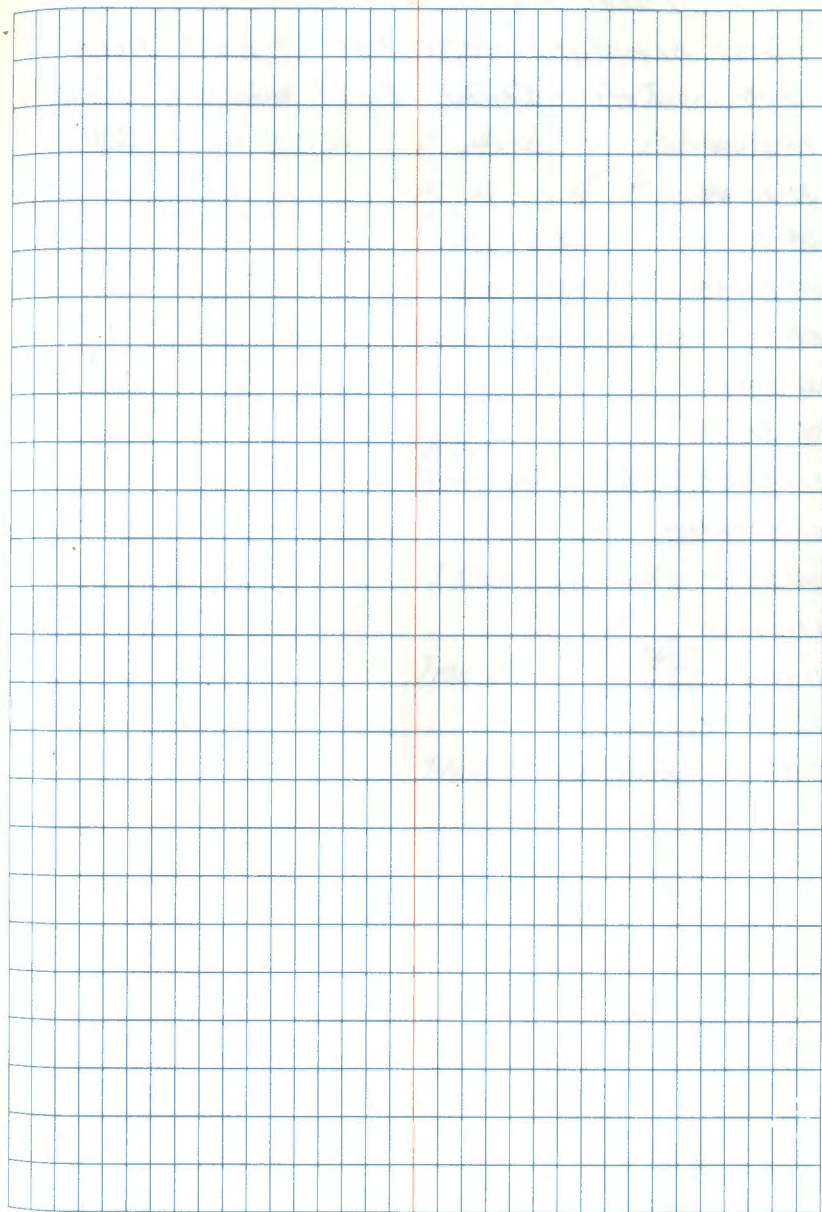
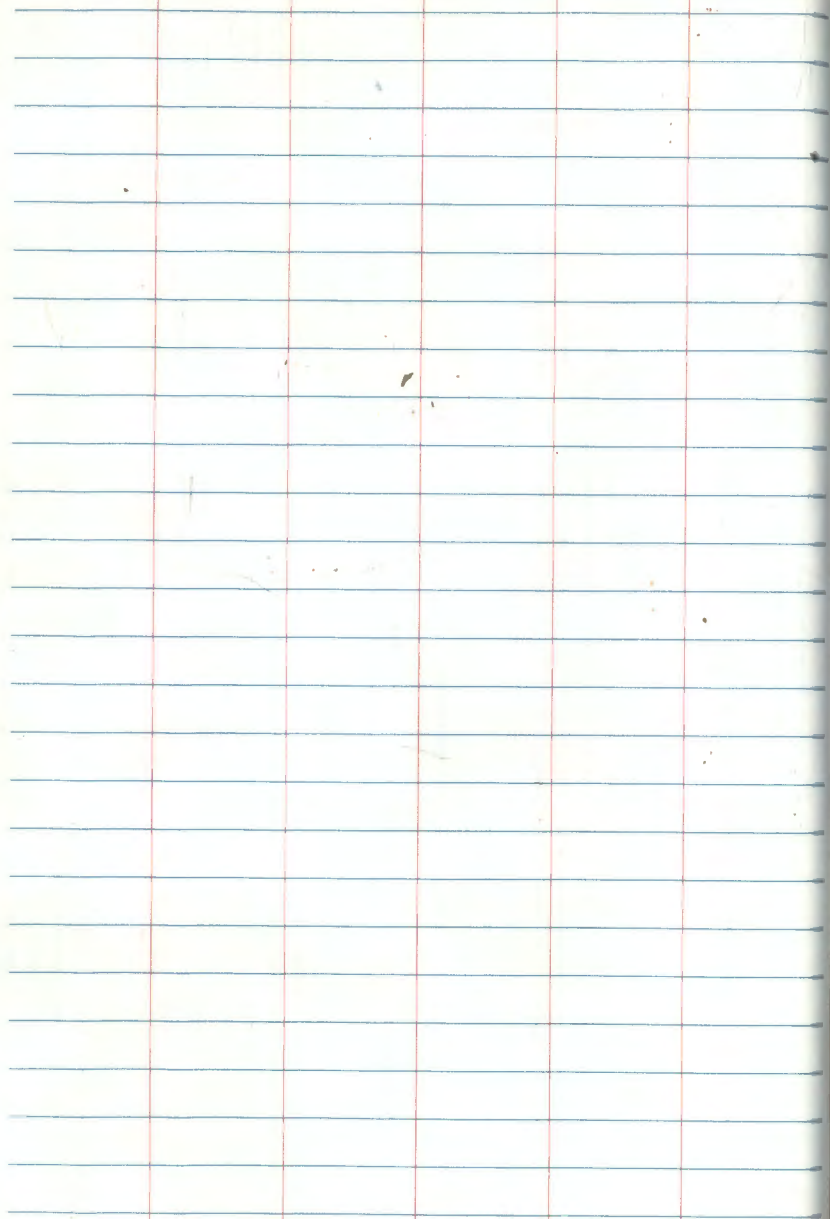

TSBN R26W Sec 1 Subdivision

Laser orientation east half of north line

Gate Left Center Right sensitivity Event #

10-20-00 3211

09-00-04

08-20-05

08-00-58

~~07-01-00~~ 07-01-00

06-00-02

06-30-04

06-45-05

06-50-07

06-55-00

07-01-00

11-00-00

12-00-00

07-30-00

Sept 13, 1983

Clear

G. Robertson - Transmitter

B. Aust - Receiver

PC # - G. Kosenko

DKM 2 - LRP

S/N 230831

Laser trans S/N 0001

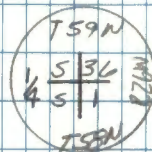
Rec'd
Trans @

Itasca Co. Mon

Tran @



Itasca Co. Mon

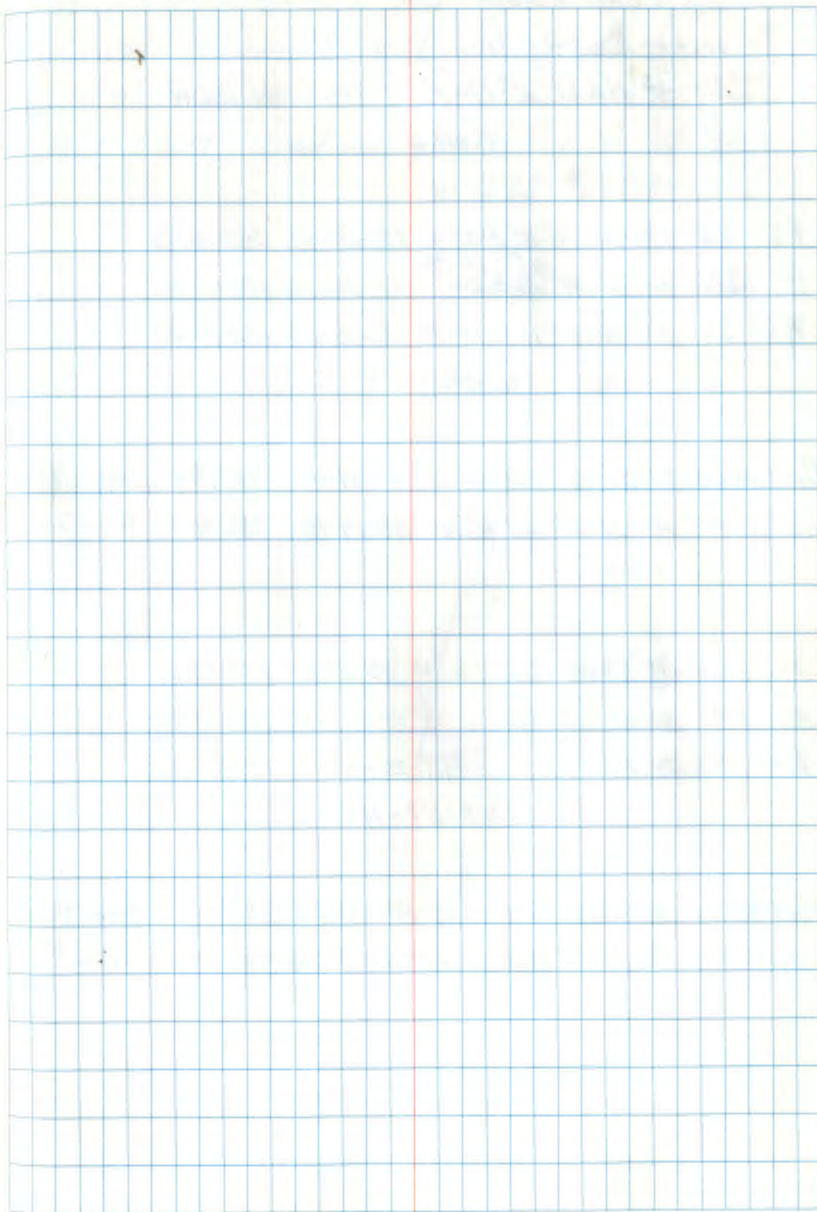

T58N R26W Sec. 1 Subdivision

Traverse Cont'd from pg 19

STA 1st H&O 2nd HAR 3rd H&O 4th HAR

HX

FS 35 172-05-54 352-05-46 172-05-53 352-05-46

BS 33 10-10-14 ~~180-00-08~~ 180-00-08 00-00-16 180-00-06

T@ 34 172-05-40 172-05-38 172-05-37 172-05-40

172-05-39

Dist 34-35 91-51-32 268-08-12 91-51-40 385.94 385.74

Dist 35-34 88-14-24 271-45-48 88-14-18 385.90 385.72

FS 36 75-57-28 255-57-20 75-57-27 255-57-14

BS 34 00-00-15 180-00-08 00-00-15 180-00-08

T@ 35 75-57-13 75-57-12 75-57-12 75-57-06

75-57-11

Dist 35-36 89-33-32 270-26-37 89-33-28 386.95 386.94

Dist 36-35 90-32-25 279-27-30 90-32-28 386.95 386.93

CKWA

9/21/83

Temp 40°

Overcast rainy,
Kind of shitty weatherG. Kosenka - P.C.

B. Ausk - Aid

G. Robertson -

hail, sleet, cold, muddy Lietz Red 1A SN 4863

Wild T2 #265184

STA 34 = twp corner

T-AREA CO. MAP

385.73

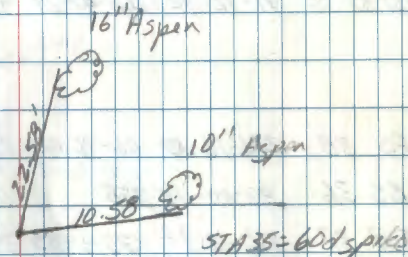

386.94

T5811R26W Sect. Sub-

Traverse cont'd from pg 38

STA 1st 14x0 2nd 4x R 3rd 4x D 4th 14x R

H4

FS 37 193-35-03 13-34-59 193-35-09 13-35-00

BS 35 00-00-20 180-00-08 00-00-22 180-00-14

T@ 36 193-34-43 193-34-51 193-34-47 193-34-46

193-34-47 ✓

Dist 36-37 89-50-00 271-09-43 88-50-08 898.18 897.99

Dist 37-36 91-12-32 268-47-21 91-12-36 898.18 897.98 ✓

FS 38 236-16-~~57~~ 56-16-48 236-17-01 56-16-~~50~~⁵¹BS 36 00-00-15 ~~18~~¹⁹⁰⁻⁰⁰⁻¹⁸ 00-00-24 00-00-17T@ 37 236-16-44 236-16-35 236-16-37 236-16-~~35~~³⁸

236-16-38 ✓

Dist 37-38 86-07-53 278-52-03 86-07-55 413.91 412.97

Dist 38-37 93-57-53 266-02-01 93-57-56 413.95 412.96

CK WA

Sept 21, 1933

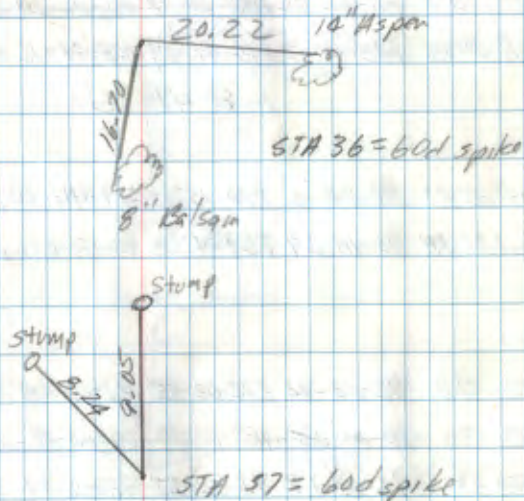

TSBN R26W Sec 1 Sub

Traverse cont'd from pg 39

STA 1st H&D 2nd H&D 3rd H&D 4th H&D

HX

FS 39 148-41-39 328-41-31 148-41-40 328-41-33

BS 37 00-00-20 180-00-17 00-00-24 180-00-18

T@ 38 148-41-19 148-41-14 148-41-16 148-41-15

148-41-16 ✓

Dist 38-39 89-44-16 270-15-37 9-44-20 874.90 874.89

Dist 39-38 90-18-29 269-41-33 90-18-28 874.92 874.91

FS 40 92-02-42 272-02-35 92-02-38 272-02-33

BS 38 00-00-25 180-00-18 00-00-19 180-01-13

T@ 39 92-02-17 92-02-27 92-02-19 92-02-20

92-02-21

Dist 39-40 91-29-05 268-30-52 91-29-07 748.85 748.60

Dist 40-39 88-54-01 271-25-57 88-54-02 748.85 748.62

CKWA

Sept 21, 1983

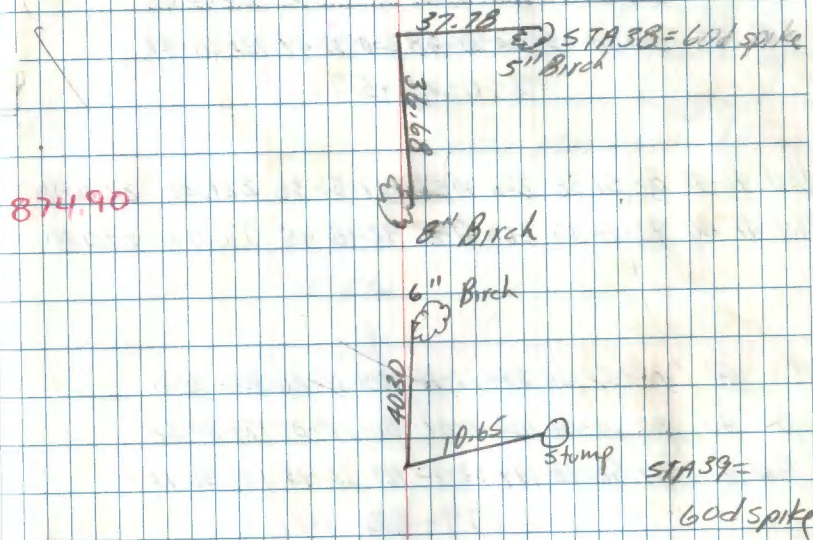

T58N R26W Sec 1 Sub

Traverse cont'd from pg 40

STA 1st H&D 2nd H&R 3rd H&D 4th H&R

H&R

FS 41 250-29-17 70-29-11 250-29-19 70-29-16

BS 39 00-00-22 180-00-28 00-00-30 180-00-27

T@ 40 250-28-55 250-28-48 250-28-49 250-28-49

250-28-50 ✓

Dist 40-41 87-51-38 272-08-23 87-51-36 221.01 220.86

Dist 41-40 92-18-50 267-41-21 92-18-45 221.02 220.84

FS 42 179-32-20 359-32-16 179-32-20 359-32-11

BS 40 00-00-04 180-00-01 70-00-07 179-59-58

T@ 41 179-32-16 179-32-15 179-32-13 179-32-13

179-32-14 ✓

Dist 41-42 92-49-00 267-11-01 92-48-59 330.70 330.30

Dist 42-41 87-17-52 272-42-01 87-17-65 330.67 330.30

Sept. 21, 1993



STA 40 =

County Monument w/ Abmicap

220.85

4" Elm



STA 41 = 60d spike

330.30

10" Aspen

TSBR226W Sec 1 Sub

Traverse cont'd from pg 41

STA 1st H&D 2nd H&R 3rd H&D 4th H&R

H&R

FS 43 151-48-17 331-48-12 151-48-19 331-48-13

BS 41 00-00-12 180-00-04 00-00-12 180-00-06

PI@ 42 151-48-05 151-48-08 151-48-07 151-48-07

151-48-07 ✓

Dist 42-43 94-22-37 265-37-29 94-22-34 167.63 167.14

Dist 43-42 85-50-46 274-09-08 85-50-49 167.57 167.13

FS 44 224-14-00 44-13-54 224-14-01 44-13-55

BS 42 00-00-19 180-00-12 00-00-25 180-00-12

PI@ 43 224-13-41 224-13-42 224-13-36 224-13-43

224-13-41 ✓

Dist 43-44 92-21-14 267-38-40 92-21-17 242.00 241.80

Dist 44-43 87-48-20 272-11-27 87-48-27 241.97 241.79

CK W/A

Sept 21, 1983

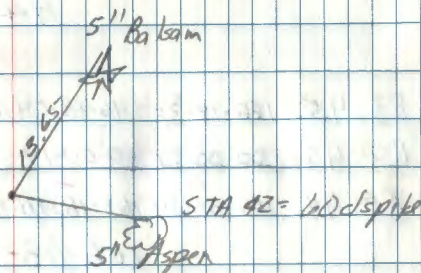

167.14

STA 43 = bad spike
 north side of driveway
 at edge of lawn
 (no ties)

241.80

T58N R26W Sec. 1 Sub

Traverse Cont'd From Pg 42

STA 1stH&D 2ndH&R 3rdH&D 4thH&R
H4

F3 45 166-18-31 346-18-24 166-18-40 346-18-32

BS 43 00-00-17 180-00-14 00-00-21 180-00-18

TA @ 44 166-18-14 166-18-10 166-18-19 166-18-14
166-18-14 ✓

44 to 45 90-58-41 269-01-09 90-58-46 510.64 510.57

45 to 44 89-05-38 270-54-18 89-05-40 510.64 510.58

F3 ⁴⁴⁰¹~~430~~ 181-23-24 01-23-44 181-23-53 01-23-51

BS 43 00-00-17 180-00-14 00-00-21 180-00-18

TA @ 44 181-23-27 181-23-30 181-23-32 181-23-33
181-23-31 ✓

44 to ^{East} MC ₍₄₄₀₁₎ 96-50-19 263-09-38 90-50-21 56.52 56.12

CK WA

Sept. 21, 1983

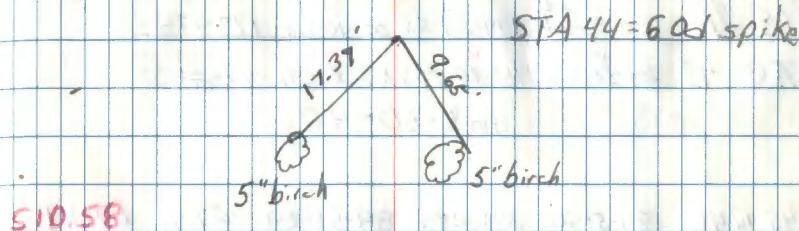

510.58

Side Shot

STA 4401 =

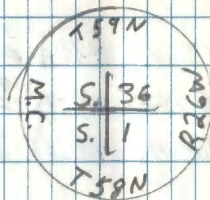

56.12

TS&N R&GW Sec 1 Sub

Traverse Cont'd from Pg 43

STA 1stH&D 2ndH&R 3rdH&D 4thH&R
H 4

FS 44 ⁴⁶	163-30-57 ⁴³	343-30-38	163-30-47	343-30-29
BS 46 ⁴⁶	00-00-04 ⁰⁴	179-59-55	00-00-06	179-59-52
TA@ 45	163-30-54 ³⁹	163-30-43	163-30-41	163- 29 ³⁰ -37
		163-30-40		

45 to 46 84-51-26 275-08-28 84-51-29 67.46 67.19

46 to 45 95-41-16 264-18-46 95-41-15 67.51 67.18

FS 47	178-08-21 ³¹	358-08-20	178-08-33	358-08-27
BS 45	00-00-27 ⁴³	180-00-32	00-00-47	180-10-42
TA@ 46	178-07-59 ⁴⁶	178-07-48	178-07-46	178-07-45
		178-07-47		

Dist 46-47 91-43-43 268-16-36 91-43-34 111.95 111.90

Dist 47-46 88-36-45 271-23-23 88-36-41 111.94 111.91

CKWA

Sept. 21, 1983

W. M.C.
 TS&N
 STA 45 =

5.36	U
5.1	Z

 TS&N.

67.19

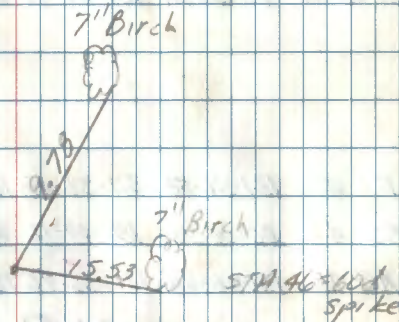

111.91

TSBN R26W Sect Sub

Traverse control from pg 44

STA 1st H&D 2nd H&D 3rd H&D 4th H&D

H4

FS 48 217-54-~~00~~⁰⁷ 37-54-02 217-54-14 37-53-58BS 46 00-00-~~15~~¹⁶ 180-00-~~05~~ 00-00-12 179-59-56

T@ 47 217-53-51 217-53-57 217-54-02 217-54-02

217-53-58 ✓

Dist 47-48 89-16-01 270-43-38 89-16-11 240.43 240.41

Dist 48-47 90-53-24 268-~~05-42~~⁰⁶⁻⁵³ 90-53-16 240.43 240.40

FS 49 131-56-58 311-56-48 131-56-59 311-56-51

BS 47 00-00-20 180-00-12 00-00-20 180-00-11

T@ 48 131-56-38 131-56-36 131-56-39 131-56-40

131-56-38 ✓

Dist 48-49 88-22-15 271-37-49 88-22-13 279-~~12~~¹² 279.01

Dist 49-48 91-43-20 268-16-27 91-43-27 279.15 279.02

CKWA

9/24/83

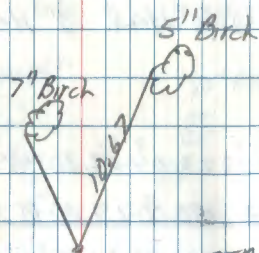

STA 47 = 60d spike

240.41

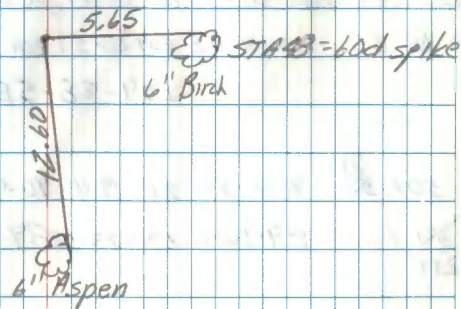

STA 48 = 60d spike

279.02

T58N R26W Sec. 1 subdivision

Traverse Cont'd from Pg 45

STA 1st H4D 2nd HAR 3rd H4D 4th HAR

FS 50 203-04-12 23-04-02 203-04-16 23-04-08

BS 48 00-00-32 180-00-29 00-00-38 180-00-34

T@ 49 203-03-40 203-03-33 203-03-38 203-03-34

203-03-36 ✓

49 to 50 88-56-11 271-03-~~48~~⁴⁵ 88-56-12 349.72 349.66

50 to 49 91-10-20 268-49-34 91-10-23 349.74 349.67

FS ~~50~~²¹¹ 209-29-22 29-29-11 209-29-19 29-29-09

BS 49 00-00-20 180-00-14 00-00-22 180-00-12

T@ 50 209-29-02 209-28-57 209-28-57 209-28-57

209-28-58 ✓

50 to ~~50~~²¹¹ 90-40-52 269-19-11 90-40-51 242.37 242.35~~50~~²¹¹ to 50 89-30-11 270-29-57 89-30-10 242.35 242.34

211

9/22/83

cloudy, windy

36°F

Hg 29.8

Same instruments

as previous

day

B. Ausk Aid P.C.

G. Robertson TMM

6" ASPEN

15" ASPEN

3330

3330

3330

3330

60d Spike

349.67

4" ASPEN

3" ASPEN

3826

3826

3826

3826

60d spike

242.35

47

T58N R26W SEC 1 Subd.

TRAVERSE CONT. From Page 46

STA 15th H&D 2nd H&R 3rd H&D 4th H&RPS ~~201~~ 153-14-49 333-14-39 153-14-47 333-14-39BS 50 00-00-~~13~~¹³ 180-00-05 00-00-13 180-00-09T@ ~~21~~²¹ 153-14-36 153-14-34 153-14-34 153-14-30

153-14-34

211 ~~201~~³¹⁻³³
~~14052~~ 85-~~16-30~~³¹⁻³³ 274-28-27 85-31-33 183.01 182.45 ✓

✓ OK GR 11/7/83

Temp. 50°F

Hg. 29.8

9-23-83

47

G. KOSENKO T

B. AUSK T

Sta. 51 = Δ NW SEC 1

Sta. 52 = FS Point on road

T58N R26W Sec 1 Subdivision

Spur Traverse to west M.C. Little Dead Horse
Cont'd frSTA 1st HAD 2nd HAR 3rd HAD 4th HAR
HADist ~~202-203~~ 87-43-48 270-16-15 2700-26 2700-23~~FS 203 175-23-07 355-22-59 175-23-02 355-22-57~~~~BS 201 00-00-48 180-00-11 00-00-16 180-00-06~~~~IT@202 40 48 46 57~~~~Dist 202-203 86-28-21 273-31-39 211-59~~~~Dist 202-201 87-43-48 270-16-15~~

FS 203 166-15-29 346-15-14 166-15-24 346-15-16

BS 201 00-00-25 180-00-15 00-00-21 180-00-17

IT@202 166-15-04 166-14-59 166-15-03 166-14-59

166-15-01 ✓

Dist 202-203 86-28-21 273-31-39 86-28-21 211-59 211-19

Dist 203-202 93-41-58 266-17-48 93-42-05 211-61 211-17

✓ OK file 11/8/83

9/22/83

B. Ausk P.C. M

G. Robertson T T M

STA 202 = West M.C.

Caribou Lake

STA 201 = East M.C.

Caribou Lake

211-179 ✓

T58N R26W Sec 1 Subdivision

Spur Traverse to West M.C. Little Dead Horse Lake

FS 204 131-00-57 311-00-53⁴ 131-00-57 311-00-51

BS 202 00-00-33 180-00-26 00-00-36 180-00-19

T@ 203 131-00-24 131-00-27 131-00-21 131-00-32

131-00-26 ✓

203 to 204 89-51-40 270-08-14 89-51-43 132.63 132.63

204 to 203 90-25-25 269-34-50 90-25-17 132.63 132.63

FS 205 253-34-42 73-34-33 253-34-41 73-34-33³

BS 203 00-00-16 180-00-01 00-00-11 180-00-03

T@ 204 253-34-26 253-34-32 253-34-30 253-34-30

253-34-30 ✓

204-205 89-33-30 270-26-31 89-33-30 650.98 650.96

205 to 204 70-30-04 269-29-55 90-30-05 651.01 650.99

-OK H. 11/8/85

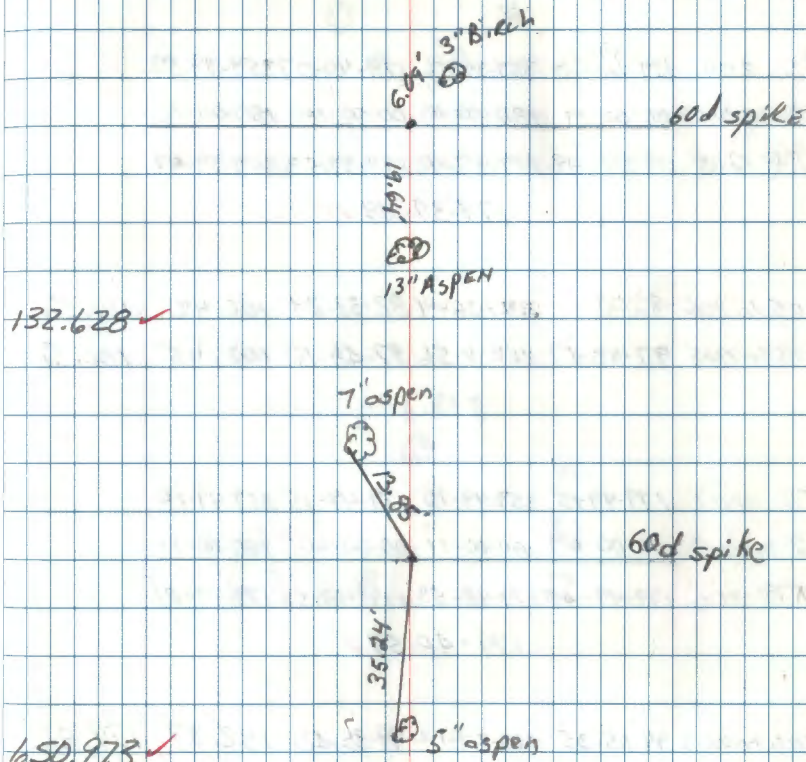

T58N R26W SEC 1 Subd.

Spur TRAVERSE to W. MC Little Dendhorse LAKE

FS 206 179-40-³⁹54 359-39-56 179-40-07 359-39-57

BS 204 00-00-19 180-00-10 00-00-14 180-00-10

A@ 205 179-39-48 179-39-46 179-39-53 359-39-47

179-39-49 ✓

205 to 206 82-33-17 277-26-19 82-33-29 102.42 101.56

206 to 205 97-48-17 262-11-56 97-48-10 102.45 101.50

FS 207 179-49-⁻¹⁴45 359-49-10 179-49-15 359-49-12BS 205 00-00-³17 180-00-11 00-00-20 180-00-11A@ 206 179-49-⁰¹28 179-48-59 179-48-55 179-49-01

179-48-59 ✓

206 to 207 99-35-35 260-24-12 99-35-42 182.37 179.82

207 to 206 80-27-33 279-32-13 80-27-40 182.37 179.85

VOK PL 11/8/33

12.17'

11.81'

60d spike

101.529 ✓

5" Birch

2.44'

8" Birch

8.08'

60d spike

179.835 ✓

T58N R26W Sec 1 Subd.

ES 208 169-59-~~10~~²⁷ 169-59-~~15~~¹⁷ 169-59-20 169-59-08PS 206 180-00-~~35~~¹⁶ 180-00-~~36~~⁰⁷ 180-00-~~37~~²² 180-00-02T@ 207 169-59-11 169-59-~~12~~ 169-58-58 169-59-01

169-59-06 ✓

207+208 90-09-35 269-50-25 90-09-35 1232.53 1232.525 ✓

✓ OK file 11/11/35

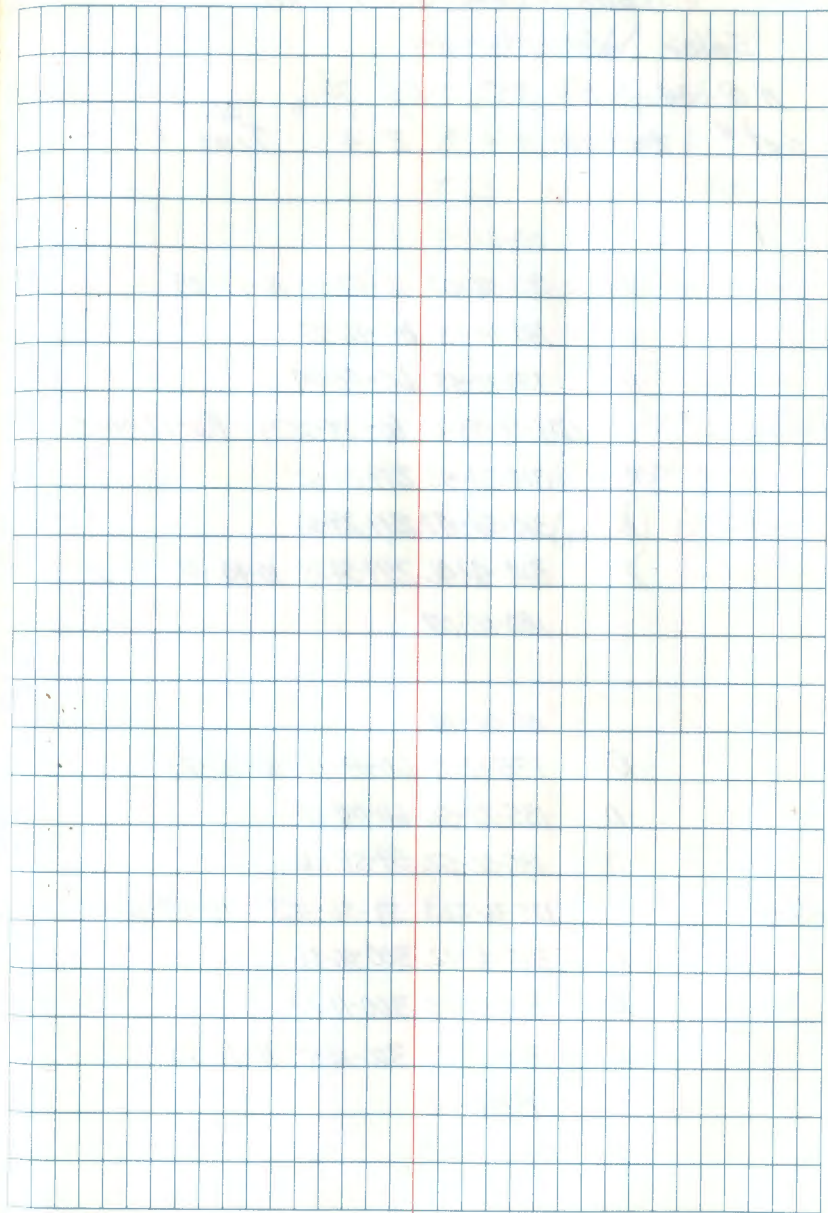

TSBN R26W Sec 1 Sub

Solar Orientation

T₀ 34, BS 35, FS 20Set # Position H \ddagger Z \ddagger Time \ddagger COST

1 00-00-13

D 133-56-07 60-51-00 10-11-09

D 134-04-13 60-46-35

134-04-04.7

D 134-12-33 60-42-09

Mean 134-18-53.2 60-38-25.7 10-12-46.5

R 314-24-53 299-24-52

R 314-33-47 299-29-50

134-33-41.7

R 314-42-46 299-34-23 10-14-24

180-00-07

2 00-00-14

D 135-12-17 60-09-16 10-16-23

D 135-21-36 60-04-20

D 135-32-52 59-58-26

Mean 135-36-22.3 59-56-32.3 10-17-56.5

R 315-42-22 300-06-36

R 315-51-23 300-11-27

R 315-58-20 300-14-45 10-19-30

180-00-12

✓ OK RR 11/7/83

Sept. 23, 1983

Clear, cold, calm

PC # G. Kosenko

T B. Avsk

T-2 SW 265184

watch is 16 sec slow

Lat. true - 47° 32' 41"

Long. true - 93° 34' 34"

Elevation (quad) 1395 ft

TSBN R26W Sec 1 sub

Solar Orientation cont'd from pg 54

Set# Post H' " Z' " ^{COST} Time AM

3

00-00-11

D 136-30-59 59-28-00 10-21-43

P 136-40-10 59-23-26

D 136-46-38 59-19-56

Mean 136-57-45.8 59-14-13.0 10-23-30.0

R ~~317-27-51~~
316 300-50-58

R 317-17-22 300-55-50

R 317-24-38 300-59-16 10-25-17

180-00-10

4

00-00-09

G.P. KOSENKO

D 138-00-36 58-42-20 10-27-41

D 138-08-20 58-38-39

D 138-15-26 58-35-13

138-22-31.8 58-31-30.3 10:29:11

R 318-27-46 301-30-59

R 318-37-44 301-36-06

R 318-46-03 301-40-05 10-30-41

180-00-03

✓ IK PR 11/7/83

Sept 23, 1983

T58N R26W Sec 1 Sub

T@ 34 BS 35 Tie to Bts

BS=0000-03

R. PINE 44-50-00

W. Birch 153-59-00

Co. B1
W. Birch 176-37-00Co. B2
J. PINE 243-31-00OR 19 W. PINE
298-05-00

R. PINE 315-10-00

Co. B1
R. PINE 320-42-00OR 19
R. PINE 335-30-00

For other corner info see

58-26 BK 2 pg 16

58-26 BK 3 pg 68

9-23-83

G. Kosenko TX

B. AUSK AD

T58N R26W Sec 1 Subdivision

Solar Orientation

TB 124 BS 123 FS X

Set #	Position	H X	Z X	H:M:S COST
1		0-00-19	X	
	D	213-59-43	55-34-02	3:04:12
	D	214-07-28	55-36-58	
	D	214-14-08	55-39-21	
Mean		214-21-54	55°42'25"	3:05:37
	R	34-27-05	304-15-43	
	P R	34-38-09	304- 38-09 ¹¹⁻⁴⁰	
	R	34-45-57	304-11-40	3:07:02
		180-00-01	304-08-27	3:05:37 Mean
2		00-00-09		
	D	215-57-08	56-18-50	3:11:20
	D	216-06-05	56-22-26	
	D	216-13-30	56-25-11	
Mean		216-19-16.0	56-27-26.8	3:12:43
	R	36-23-35	303-31-10	
	R	36-34-00	303-26-48	
	R	36-41-36	303-23-48	3:14:06
		179-59-57		

✓ OK GR 11/8/03

A G. Kosenko
M K. Whithorn

September 27, 1983

Clear, Warm, Light breeze

75°± Gusty Winds

Barometer ^{Not} Read in Hg

T2 SN 265184

Start at 3:00 PM CDT

Elevation (quad) 1400 ft

Watch is 16 sec Slow

Latitude 47°30'05"
Longitude 93°35'53"

87-89 40

34 17 35
55-42-25

Continued on page 58

T58N. R26W Sec 9

Solar Observation - Continued From.
Page 57.

Set #	Position	H \times	Z \times	H.M.S. COST
3		0.00-00		
	D	217-21-08	56-52-07	3:16:32
	D	217-31-15	56-56-29	
	D	217-38-58	56-59-42	
Mean		217-44-49.3	57-01-55.7	3:18:01
	R	37-49-52	302-56-02	
	R	37-58-42	302-52-26	
	R	38-08-28	302-48-14	3:19:30
		179-59-49		

4		00-00-06		
	D	218-53-21	57-30-49	3:22:18
	D	219-01-26	57-34-00	
	D	219-07-55	57-37-07	
Mean		219-14-28.7	57-39-50.8	3:23:38
	R	39-20-45	302-17-30	
	R	39-28-08	302-14-14	
	R	39-35-23	302-11-07	3:24:58
		179-59-56		

✓ OK bk 4/0/83

Sept 27, 1983

↑ G. Kasenko

↓ K. Whitehorn

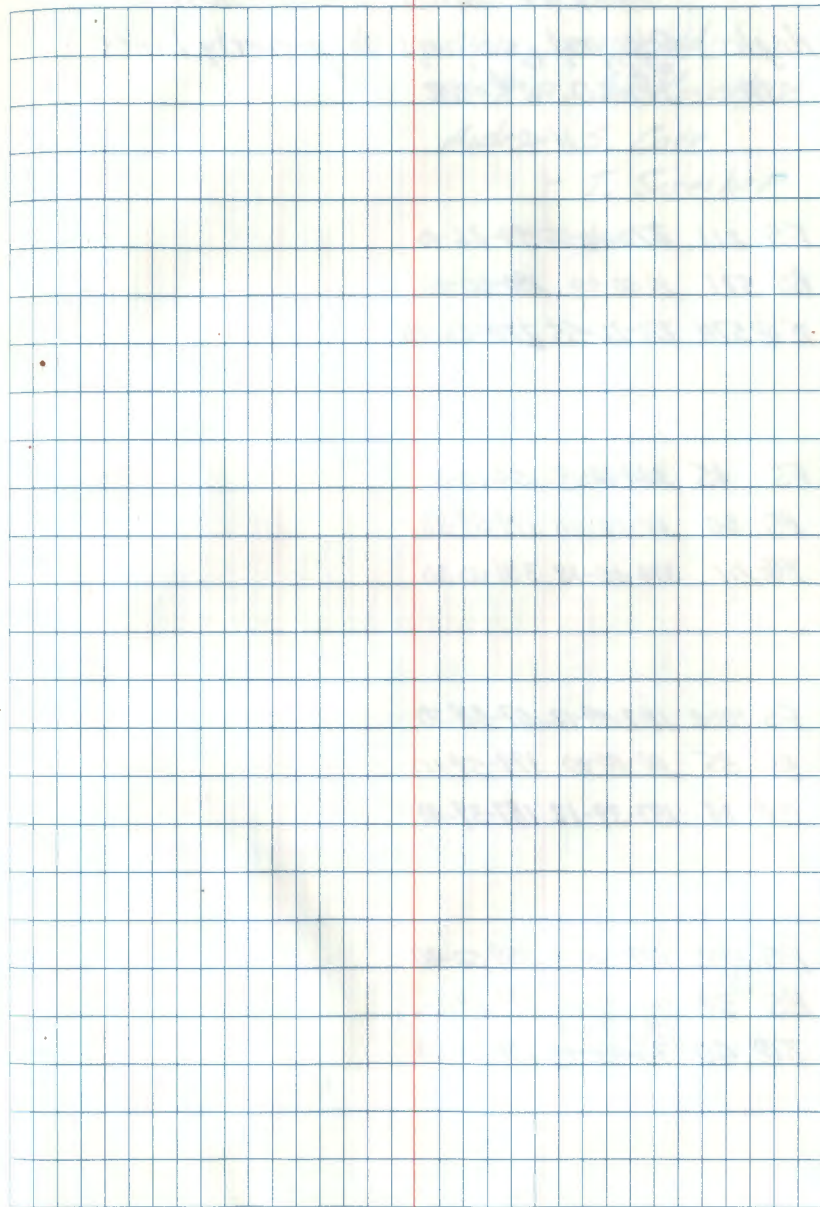

T58N R26W Sec 1 Subdivision

Angles @ property corners to property lines

STA 1st H&D 2nd H&R

H &

FS 211 270-26-55 90-26-10

BS 571 20-00-00 180-00-00

T@571 270-26-55 270-26-10

FS 45 334-10-13 154-00-00

BS 50 00-00-00 179-59-30

T@211 334-10-13 334-00-30

FS 1004 187-39-12 07-38-50

BS 35 00-00-00 179-59-10

T@34 187-39-12 187-39-40

FS 1003 179-53-13 359-52-40

BS ~~39~~ 4¹ 00-00-00 179-59-00T@40 ~~70-22-13~~ 179-53-13 179-53-40

Jan 10, 1983

Clear, very cold

PC T@ G. Kosenku

Aides - S. Carr

- T. Sereiber

T58N R26W Sec 1 Subdivision

Inverse and traverse from STA 5711 to STA 1007

FS 5712			
1007	359-17-50	179-17-00	

BS 571	00-00-00	179-59-20	
--------	----------	-----------	--

π @ 5711	359-17-50	359-17-40	
--------------	-----------	-----------	--

Dist 5711-5712	84-21-00	275-38-50	172.49
----------------	----------	-----------	--------

Dist 5712-5711	95-51-10	264-08-30	172.55
----------------	----------	-----------	--------

FS 5713	180-00- ³⁰ 25	359-59-50	180-00-35	359-59-55
---------	--------------------------	-----------	-----------	-----------

BS 5711	00-00-00	179-59-10	00-00-00	179-59-15
---------	----------	-----------	----------	-----------

π @ 5712	180-00- ³⁰ 25	180-00-40	180-00-35	180-00-40
--------------	--------------------------	-----------	-----------	-----------

Dist	88-24-40	271-38-00	339.54
------	----------	-----------	--------

Dist	91-41-10	268-18-30	339.57
------	----------	-----------	--------

Temp. 25°F, overcast, breezy Jan 23, 1983

G. Robertson π π π

T. Schreiber aid

S. Carr aid

Leitz T600 158830

Leitz Red 1A

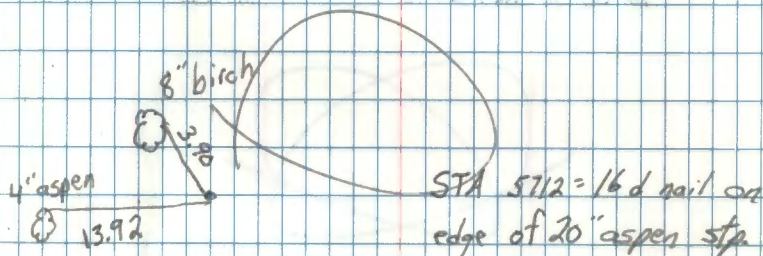

FS	180-00-40	³⁶⁰ 60-00-00	180-00-40	360-00-00
BS	00-00-00	179-59-15	00-00-00	179-59-10
TA@ 5713	180-00-40	180-00-45	180-00-40	180-00-50

Dist	92.05-40	267.54-10	251.48
Dist			

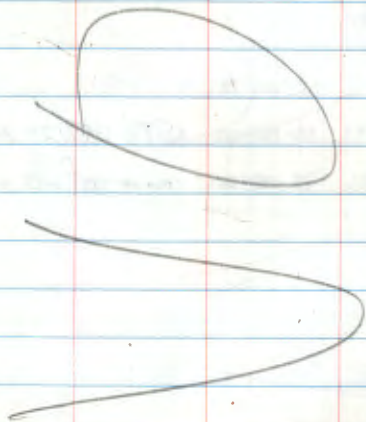

Jan 22, 1984

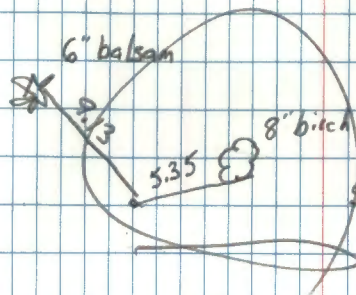

STA 5713 = 60d spike

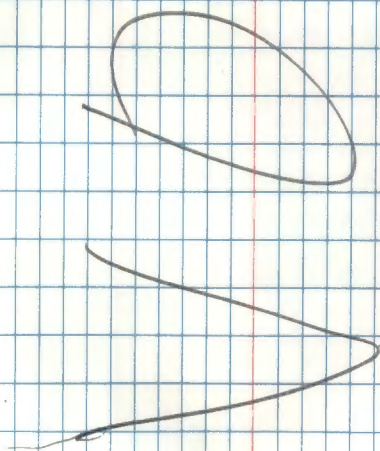

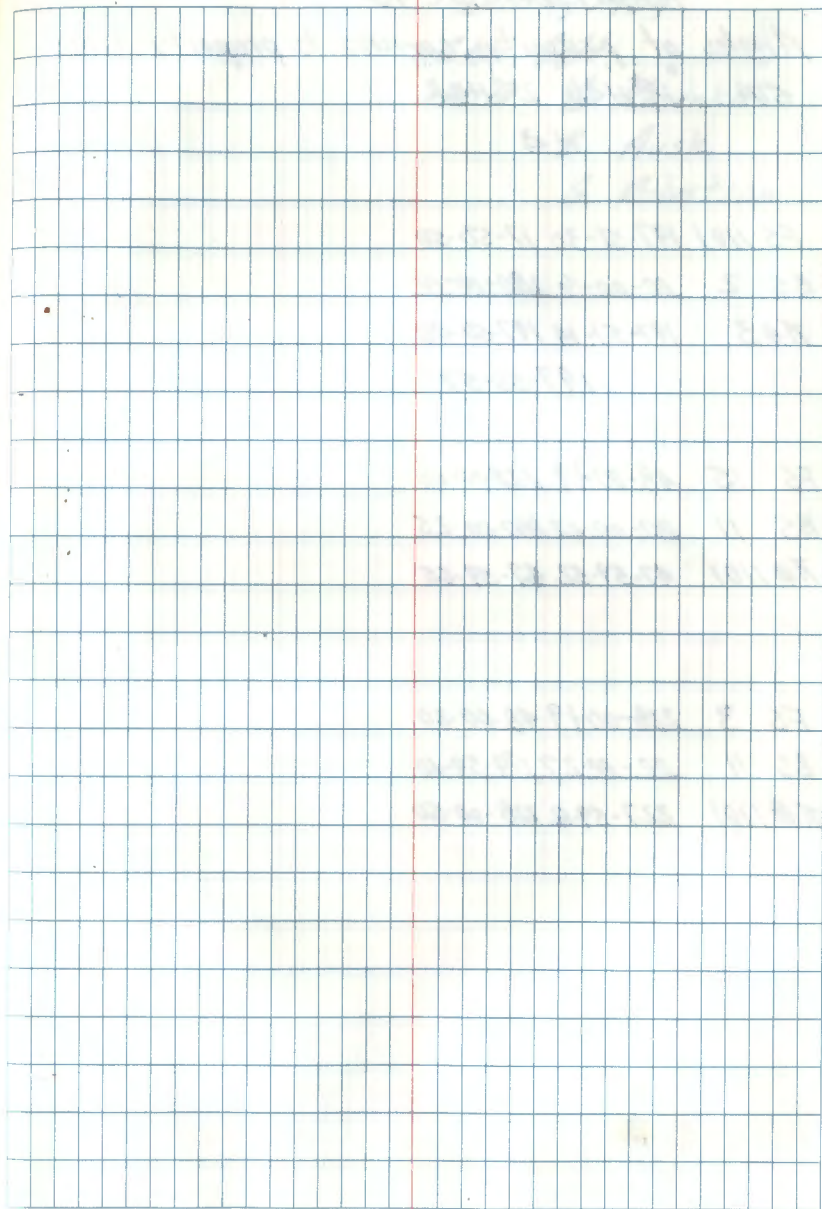

TSBN R26W Sec 16

Angles at property corners to property lines

STA 1st H&D 2nd H&R

H 4

FS 1101 197-51-30 17-50-50

BS 2 00-00-16 180-00-10

T@3 197-51-14 197-50-40

197-50-57

FS 15 48-00-19 228-00-00

BS 11 00-00-27 180-00-25

T@1101 47-59-52 47-59-35

FS 3 228-00-19 48-00-30

BS 11 00-00-27 179-59-40

T@1101 227-59-42 228-00-50

Dec 3, 1989

Clear, Cold

AC @ G. Kasenko

B. Ausk

G. Robertson

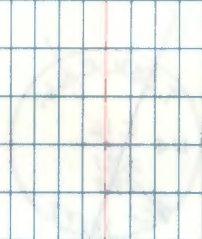

Handwritten text on the graph paper, possibly a date or a note, including the characters "1957" and "P-E 100".

TSBN R26W Sec 16

Inverse and Monumentation info

to set 5^{1/4}, 5^{1/6},STA 1st H4 D 2nd H4 R

H. Dist

H4

26845-19 94.59-31

211.13 385.87

211.25 386.84

FS 1101 116-01-17 296-01-59

BS 12 00-00-23 180-00-12

T@ 11 116-00-54 116-00-47

596.55

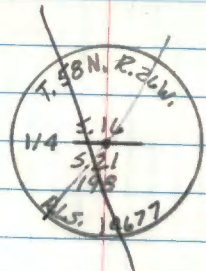

Corner set by County

Dec 3-4, 1984

Dec 5, 1984

Snow, cold, calm

T-2 S/W 265184

PC G. Kosenko

Red 1-A S/W 4863

Ardes - B. Adsk

ECF = -3

- G. Robertson

Additional Angle to tie in County corner

FS 1102 179-57-51 339-57-53 94-49-58

BS 11 00-00-20 180-00-30

T@ 1101 179-57-31 179-57-23 396.76

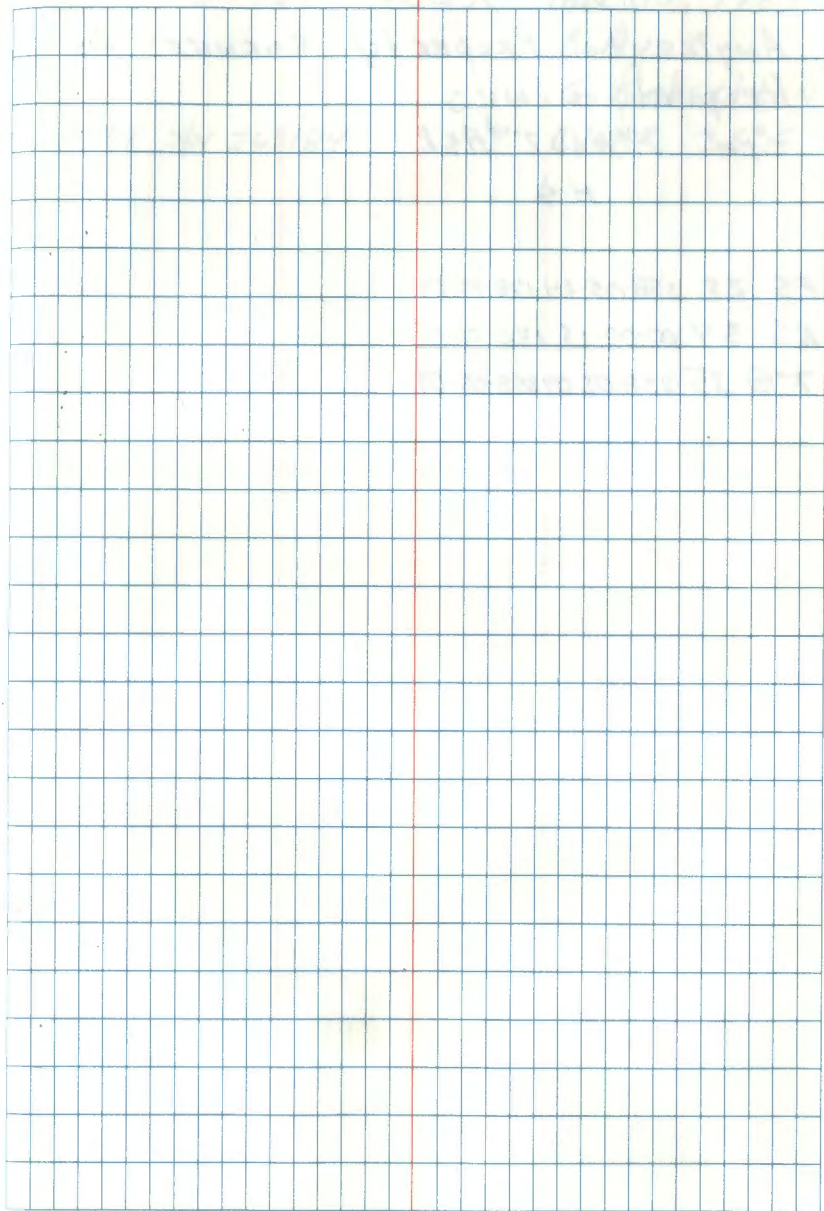

T58N R26W SEC 16

Angles to PROPERTY CORNERS to
PROPERTY LINESSTA 1st H&D 2nd H&R

H&S

FS 28 358-05-24 178-05-24

BS 34 00-00-15 180-00-15

X@ 35 358-05-09 358-05-09

DEC. 10, 1984

B. AUSK

G. ROBERTSON

CLEAR 35°F

T2 S1N 26S184

T58N R26W

Angles at Property Corners to

Property Lines

S + A 1st H&D 2nd H&R

H&R

FS 20 323-37-37 143-37-53

BS 27 00-00-17 180-00-08

T@ 28 323-37-20 323-37-45

Dec. 11, 1984

G. Rosen Ro

T@ B. Ausk

T-2 S/N 265184

G. Robertson

MEANDER CORNER BET. SEC'S, 5+32

WEST SHORE OF NORTH STAR LAKE

ORIG. GOV'T. SURVEY 1873

SET WOOD POST

BIRCH 4 N22W 15 LKS = 9.90'

CEDAR 9 S39W 40 LKS = 26.40'

CERTIFICATE FILED

MEANDER CORNER BET SEC'S. 5+32

WEST SHORE OF WILDCAT ISLAND

ORIG. GOV'T. SURVEY 1915

SET WOOD POST

CEDAR 7 NORTH 24 LKS. = 15.84

TAN. 5 S9 1/2 E 57 LKS. = 37.62'

CERTIFICATE FILED

MEANDER CORNER BET. SEC'S, 5+32
 ON EAST SHORE OF WILDCAT ISLAND
 ORIG. GOV'T. SURVEY 1915
 SET WOOD POST

WATER ELM 8 S58°15'W 44 LKS. = 29.04'

CEDAR 6 N9°45'E 22 LKS. = 14.52'

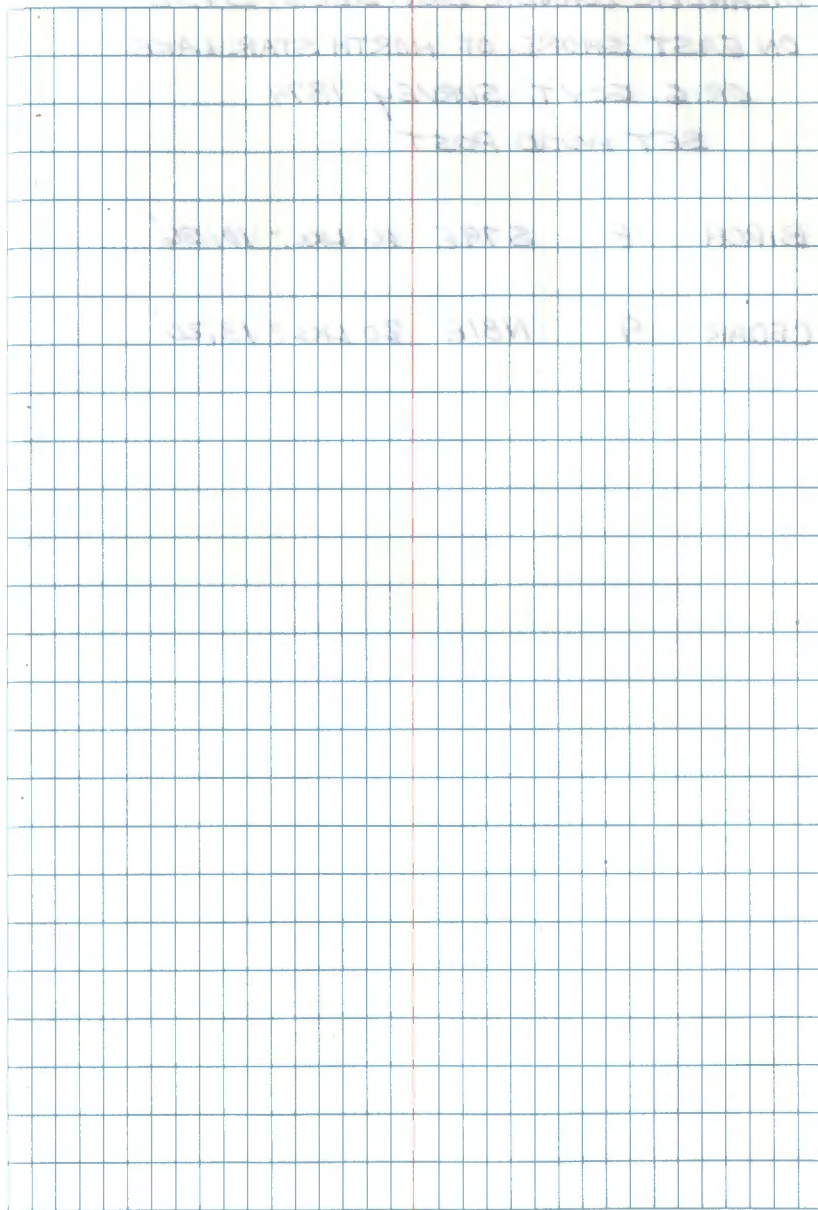

MEANDER CORNER BET. SEC'S. 5+32
 ON EAST SHORE OF NORTH STAR LAKE
 ORIG. GOV'T. SURVEY 1874
 SET WOOD POST

BIRCH 8 S 79 E 16 LKS. = 10,56'

CEDAR 9 NB 1 E 20 LKS. = 13,20'

MEANDER CORNER, BET. SEC'S. 4-33
 ON WEST SHORE OF NORTH STAR LAKE
 ORIG. GOV'T. SURVEY 1874
 ● SET WOOD POST

CEDAR 7 N75W 18 LKS = 11.88'

BIRCH 6 S32W 20 LKS = 13.20'

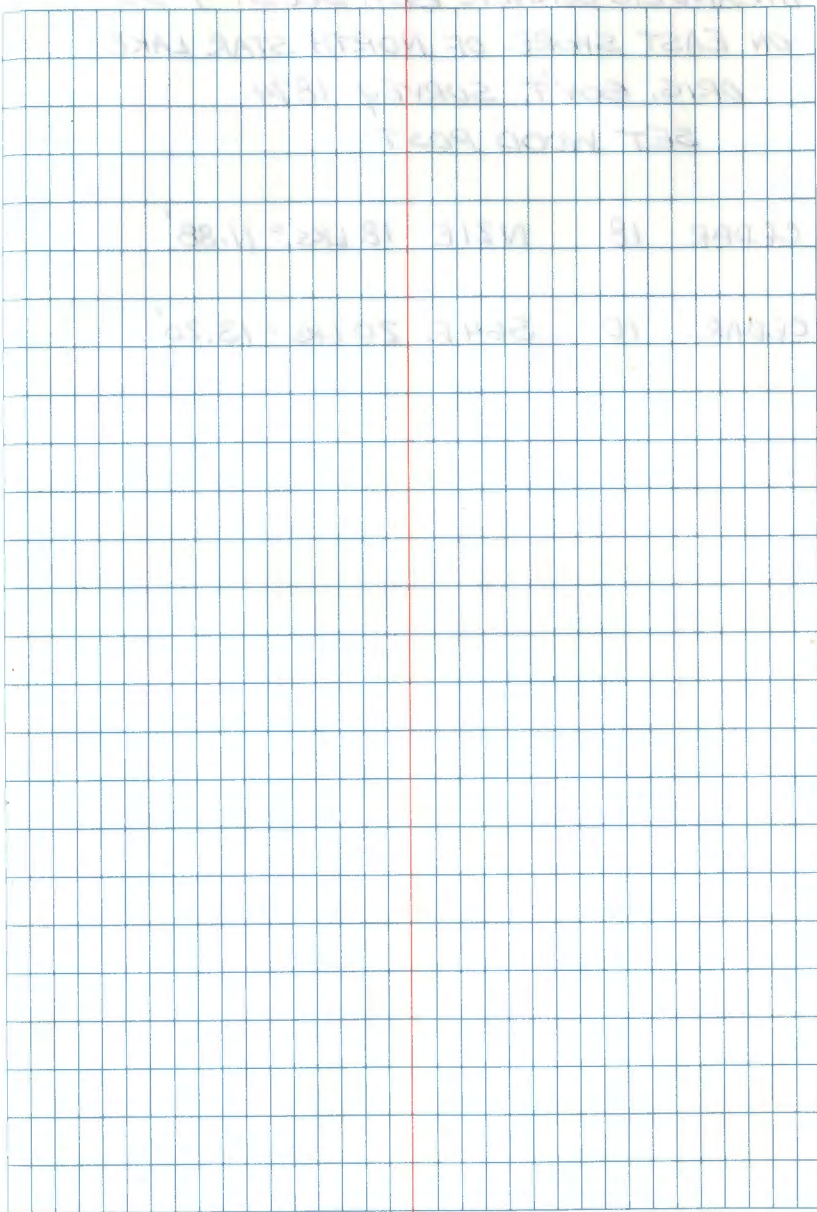

MEANDER CORNER, BET. SEC'S, 4-33
ON EAST SHORE OF NORTH STAR LAKE
ORIG. GOVT. SURVEY 1874
SET WOOD POST

CEDAR 18 NZIE 18 LKS. = 11.88'

CEDAR 10 S64E 20 LKS. = 13.20'