

Form 874-9—Revised May, 1918
U. S. Department of Agriculture
FOREST SERVICE

Chippewa NATIONAL FOREST

CORNERS OF THE PUBLIC SURVEY

T. 150 N R. 28 W 5th Mer.

1/4 Corner common to Sections
35, and 36

Corner consists of a Tam. Stake (not) in place
State condition Fair

Dimensions above ground 3" x 3" x 16" inches
Sketch grooves, letters, figures, or notches, on proper face or edge.

CARDINAL POSITION

DIAGONAL POSITION

	<u>1/4</u> <u>S</u> <u>35</u>		<u>1/4</u> <u>S</u> <u>36</u>
N	W	S	E

NW	SW	SE	NE

Mound of _____ is located _____

Pits are located _____

Sketch markings of Bearing Trees (or Rocks) in proper box and fill blanks below, giving bearings from Corner to Trees and Distances in Links.

Species _____

Diameter None

Bearing _____

Distance _____

Do you believe this to be a genuine Land Office Corner? Yes

If not, why? _____

Field Man:

Hamie

H. C. Norman
(Signature)

Sept. 27, 1935
(Date)

J. F.
(Title)

On Burned Area

Corner again.

Give any further facts which will aid in finding this

0.62 chains distant.

from which this Corner bears N 70° E

side of Tree

tree 10 inches diameter, on the NE

Metal Location Poster is on a stick

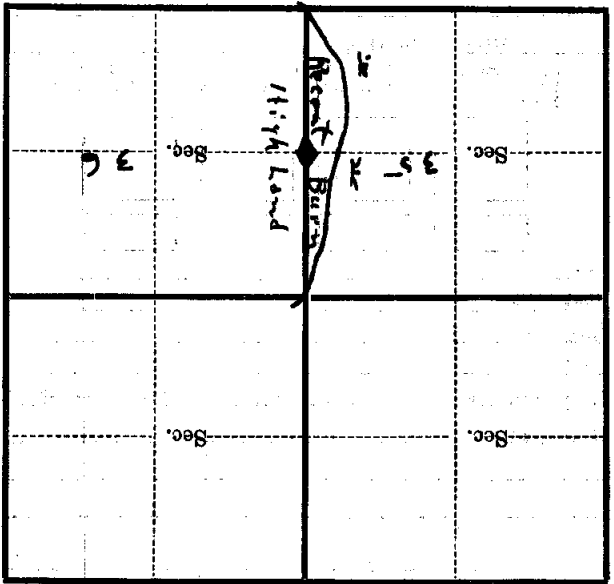

(Make sketch of topography near Corner)

T. 15° N R. 28° W S. 4th Mer.

U. S. Department of Agriculture

FOREST SERVICE

CHIPPEN NATIONAL FOREST

CORNERS OF THE PUBLIC SURVEY

T. 152N R. 28W 514 Mer.

1/4 Corner common to Sections
 _____, _____, 35, and 36

Corner consists of a TRIP STAKE (not) in place
 State condition FAIR

Dimensions above ground 3" X 3" X 16" inches
 Sketch grooves, letters, figures, or notches, on proper face or edge.

CARDINAL POSITION

DIAGONAL POSITION

	<u>1/4</u>		<u>1/4</u>
	<u>3</u>		<u>3</u>
	<u>35</u>		<u>36</u>
N	W	S	E

NW	SW	SE	NE

Mound of _____ is located _____

Pits are located _____

Sketch markings of Bearing Trees (or Rocks) in proper box and fill blanks below, giving bearings from Corner to Trees and Distances in Links.

Species _____

Diameter NONE _____

Bearing _____

Distance _____

Do you believe this to be a genuine Land Office Corner? YES

If not, why? _____

H.C. Norman

(Signature)

T.F.

Sept 27 1935
 (Date)

(Title)

X-21

S. N. BURNED AREA

Corner again.

Give any further facts which will aid in finding this

chains distant:

from which this Corner bears N 80° E

side of AREA

tree 10 inches diameter, on the N.E.

Metal Location Poster is on a BIRCH

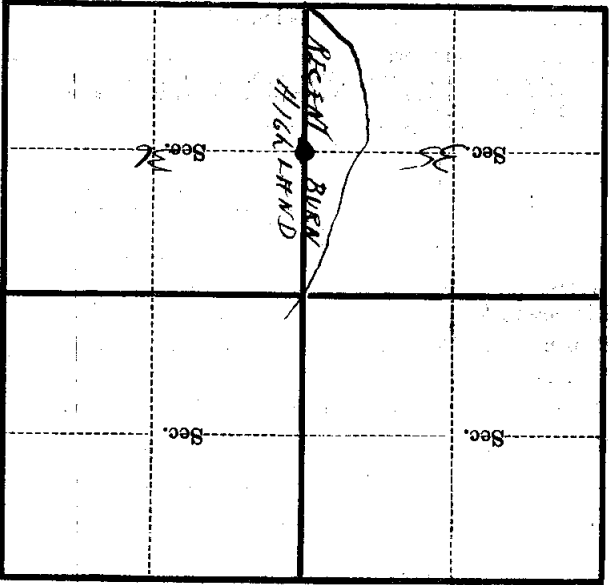

(Make sketch of topography near Corner)

T. 152N. R. 21W. S. 7K Mer.

U. S. Department of Agriculture

FOREST SERVICE

Chippewa NATIONAL FOREST

CORNERS OF THE PUBLIC SURVEY

T. 150N R. 28W 5th Mer.

1/4 Corner common to Sections
35, and 36

Corner consists of a Tim. Stake (not) in place
State condition Fix

Dimensions above ground 3" X 3" X 16" inches

Sketch grooves, letters, figures, or notches, on proper face or edge.

CARDINAL POSITION

DIAGONAL POSITION

	<u>1/4</u>		<u>1/4</u>
	<u>S</u>		<u>S</u>
	<u>35</u>		<u>36</u>
N	W	S	E

NW	SW	SE	NE

Mound of _____ is located _____

Pits are located _____

Sketch markings of Bearing Trees (or Rocks) in proper box and fill blanks below, giving bearings from Corner to Trees and Distances in Links.

Species _____

Diameter None _____

Bearing _____

Distance _____

Do you believe this to be a genuine Land Office Corner? yes

If not, why? _____

Field Man:

Hamre

(J. C. Noonan)
(Signature)

Sept. 27, 1935
(Date)

J. F.
(Title)

X-21

On burned Area.

Corner again.

Give any further facts which will aid in finding this

0.62 chains distant.

from which this Corner bears **N 80° E**

side of **LYSS**.

tree 10 inches diameter, on the **NE**

Metal Location Poster is on a **Box**

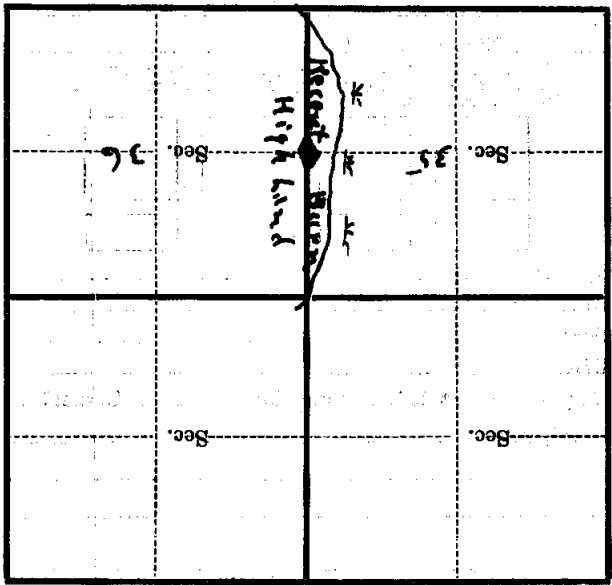

(Make sketch of topography near Corner)

T. 150 N R. 28 W 374 Mer.

U. S. Department of Agriculture

FOREST SERVICE

E.M. Surveys

Chippewa NATIONAL FOREST

CORNERS OF THE PUBLIC SURVEY

T. 150 N R. 28 W 5th Mer.

$\frac{1}{4}$ Corner common to Sections 35, and 36

Corner consists of a *Tam. Stake* (not) in place
State condition *Fair*

Dimensions above ground *3" X 3" X 16"* inches
Sketch grooves, letters, figures, or notches, on proper face or edge.

CARDINAL POSITION

DIAGONAL POSITION

	$\frac{1}{4}$ S 35		$\frac{1}{4}$ S 36
N	W	S	E

NW	SW	SE	NE

Mound of _____ is located _____

Pits are located _____

Sketch markings of Bearing Trees (or Rocks) in proper box and fill blanks below, giving bearings from Corner to Trees and Distances in Links.

Species _____
 Diameter *None* _____
 Bearing _____
 Distance _____

Do you believe this to be a genuine Land Office Corner? *yes*
If not, why? _____

Field Man

Harris

H. C. Norman
(Signature)

Sept. 27, 1935
(Date)

J. F.
(Title)

On burned Area

Corner again.

Give any further facts which will aid in finding this

0.62 chains distant.

from which this Corner bears N 80. E.

side of trees.

tree 10 inches diameter, on the NE

Metal Location Poster is on a Birch

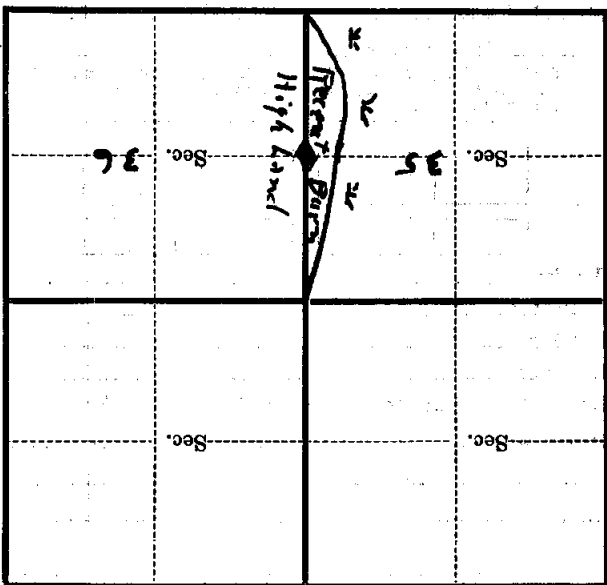

(Make sketch of topography near Corner)

T. 150 N. R. 2 E. Mer. 5th Mer.