

Form 874-9—Revised May, 1918  
U. S. Department of Agriculture  
FOREST SERVICE

✓1  
parted

NATIONAL FOREST

CORNERS OF THE PUBLIC SURVEY

T. 150 R. 29-22 S. Mer.

38-00 Corner common to Sections

20-31-26, and 25

Corner consists of a 2-BT (not) in place

State condition

Dimensions above ground inches

Sketch grooves, letters, figures, or notches, on proper face or edge.

CARDINAL POSITION

DIAGONAL POSITION

--	--	--	--

N W S E

--	--	--	--

NW SW SE NE

Mound of is located

Pits are located

Sketch markings of Bearing Trees (or Rocks) in proper box and fill blanks below, giving bearings from Corner to Trees and Distances in Links.

	150 R 29 Sec 26		150 R 29 Sec 25
	BT		BT

Species 201 W.P. Shum

Diameter 12 8

Bearing

Distance

Do you believe this to be a genuine Land Office Corner? Yes

If not, why?

W. H. Maday

(Signature)

12-24-33

(Date)

Estimate

(Title)

V-1

Corner again  
Of the farm of J. S. Johnson  
Road One Mile West  
of Mt. No. 4

Metal Location Poster is on a  
tree inches diameter, on the  
side of from which this Corner bears  
chains distant.  
Give any further facts which will aid in finding this

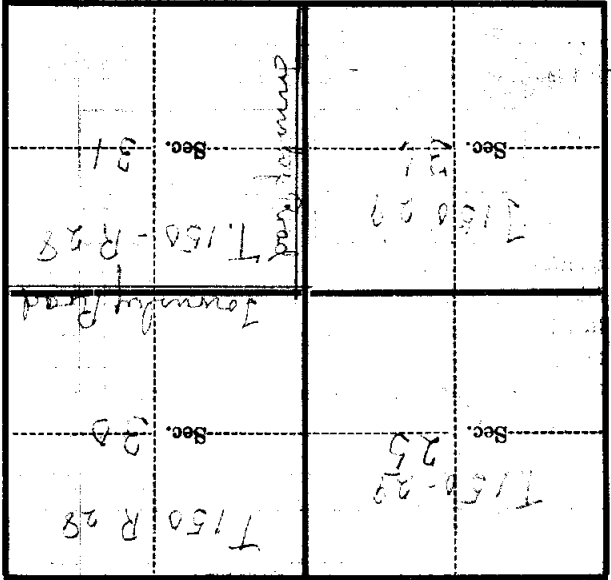

(Make sketch of topography near Corner)

T. 150 R. 28\*29 5 Mer.