

U. S. Department of Agriculture
FOREST SERVICE

515
posted

Chippewa NATIONAL FOREST

CORNERS OF THE PUBLIC SURVEY

T. 100 R. 27 Mer.

14 Corner common to Sections
10, and 15

Corner consists of a post (not) in place

State condition post on north side

Dimensions above ground _____ inches

Sketch grooves, letters, figures, or notches, on proper face or edge.

CARDINAL POSITION

DIAGONAL POSITION

--	--	--	--

N W S E

--	--	--	--

NW SW SE NE

Mound of _____ is located _____

Pits are located _____

Sketch markings of Bearing Trees (or Rocks) in proper box and fill blanks below, giving bearings from Corner to Trees and Distances in Links.

Species _____

Diameter _____

Bearing _____

Distance _____

Do you believe this to be a genuine Land Office Corner? Yes

If not, why? _____

Frederick W. ...
(Signature)

Jan 10 1934
(Date)

...
(Title) J-15

Corner again.
Then the level
is read from
level notes

Give any further facts which will aid in finding this
Corner again.
East Road chains distant.
from which this Corner bears
side of Road
7 inches diameter, on the North
Metal Location Poster is on a
Force Post

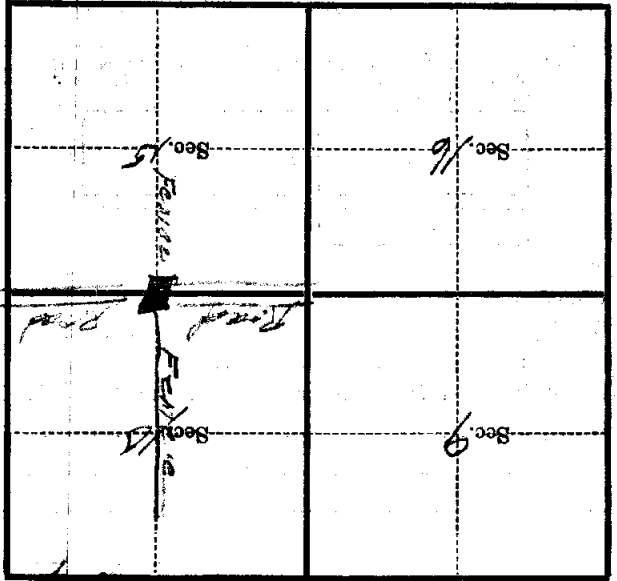

T. 150 N. R. 27 W. S. 9. Mer. T-15