

U. S. Department of Agriculture

FOREST SERVICE

P

CHIPPEWA NATIONAL FOREST V-13

CORNERS OF THE PUBLIC SURVEY

T. 150 N R. 27 W 5<sup>TH</sup> Mer. SECTION Corner common to Sections

28, 29, 33, and 34

Corner consists of a SPRUCE POST (not) in place

State condition FAIR

Dimensions above ground 36 inches

Sketch grooves, letters, figures, or notches, on proper face or edge.

CARDINAL POSITION

DIAGONAL POSITION

N	W	S	E

S 28	S 33	S 34	S 27
NW	SW	SE	NE

Mound of \_\_\_\_\_ is located \_\_\_\_\_

Pits are located \_\_\_\_\_

Sketch markings of Bearing Trees (or Rocks) in proper box and fill blanks below, giving bearings from Corner to Trees and Distances in Links.

B.T.			

Species TAM.

Diameter 6" STUMP

Bearing N 60° W

Distance 40 LINKS

Do you believe this to be a genuine Land Office Corner? yes

If not, why? \_\_\_\_\_

Harrison Adams (Signature)

7/30/34 (Date)

Acc. Asst. (Title)

V-13

Corner again.

Give any further facts which will aid in finding this

chains distant.

From which this Corner bears

S 45° E

side of

S 88

tree 6 inches diameter, on the

SOUTH EAST

Metal Location Poster is on a

SPRU

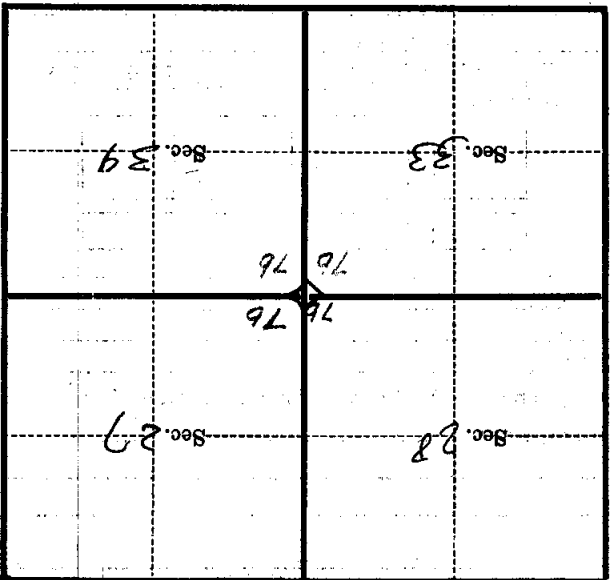

(Make sketch of topography near Corner)

V-13

Mer.

T. 100 N. R. 27 W. IA