

U. S. Department of Agriculture

FOREST SERVICE

210

Chippewa NATIONAL FOREST

CORNERS OF THE PUBLIC SURVEY

T. 149-150N R. 27W 5th P. Mer.

W 1/16 Corner common to Sections
33, and 4Corner consists of a 4" scribed stake in place
State condition Fair (weathered)

Dimensions above ground 2 feet inches

Sketch grooves, letters, figures, or notches, on proper face or edge.

CARDINAL POSITION

DIAGONAL POSITION

1/16		1/16	
S.		S.	
33		4	
N	W	S	E

NW	SW	SE	NE

Mound of _____ is located _____

Pits are located _____

Sketch markings of Bearing Trees (or Rocks) in proper box and fill blanks below, giving bearings from Corner to Trees and Distances in Links.

Illegible			

Species Aspen

Diameter 12"

Bearing S. 85° W

Distance 4 links

Do you believe this to be a genuine Land Office Corner? _____

If not, why? Appears to be original survey corner.

 H.E. ALTMAN
 (Signature)

2/12/40

(Date)

Acting Forest Ranger

(Title)

FEB 15 1940

Blazed line runs East and West in both directions from corner.

Corner again. Give any further facts which will aid in finding this

chain distant.

from which this Corner bears N 80° W.

side of tree 12" inches diameter, on the West

Metal Location Poster is on a White Barren

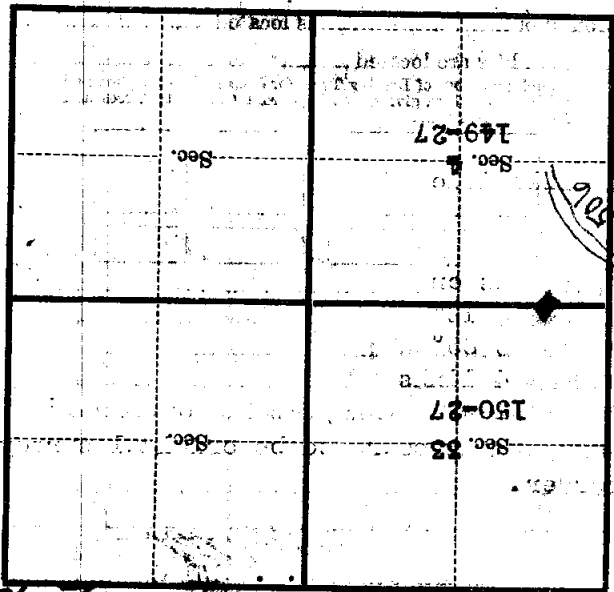

(Make sketch of topography near corner)

1749-150N R. 27W 5th E. Mer.