

A 5. ~~142~~ ~~151~~ ~~27~~
3/32-151-27
6/5-150-27

Section Corners

15/150 N 27 5

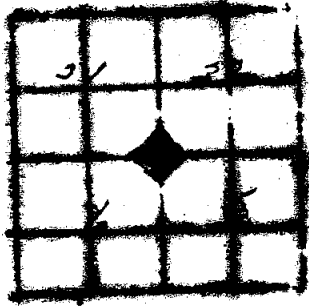

~~Post~~
~~24''~~
~~4''x4''~~
~~_____~~
~~_____~~

~~_____~~

_____	_____	_____	_____	_____
_____	_____	Birch	_____	_____
_____	_____	_____	_____	_____
_____	_____	5/16	_____	_____
_____	_____	5/16	_____	_____

~~_____~~ B.T. Birch 10'' 5 7/8
5 LINKS

1-31-34

~~_____~~
A-5

U. S. Department of Agriculture
FOREST SERVICE

F A 5
292

CHIPPEWA NATIONAL FOREST

CORNERS OF THE PUBLIC SURVEY

T. ¹⁵¹151N R. 27W 5th Mer.

SECTION _____ Corner common to Sections
5, 6, 31, and 32

Corner consists of a WOOD STAKE (set) in place

State condition FAIR

Dimensions above ground 4x4x30" inches

Sketch grooves, letters, figures, or notches, on proper face or edge.

CARDINAL POSITION

DIAGONAL POSITION

--	--	--	--

<u>S</u>	<u>31</u>	<u>S</u>	<u>5</u>
<u>150N</u>	<u>R27W</u>	<u>150N</u>	<u>R27W</u>
<u>5</u>	<u>6</u>	<u>5</u>	<u>32</u>

N W S E

NW SW SE NE

Mound of _____ is located _____

Pits are located _____

Sketch markings of Bearing Trees (or Rocks) in proper box and fill blanks below, giving bearings from Corner to Trees and Distances in Links.

<u>150N</u>			
<u>R27W</u>			
<u>BT</u>			

Species BIRCH STAKE

Diameter 1.0

Bearing S 70° E

Distance 0.5 ch

Do you believe this to be a genuine Land Office Corner? _____

If not, why? _____

H. C. Norman
(Signature)

Sept 5 1935
(Date)

G. FORSTER
(Title)

A-5

Corner again.
Give any further facts which will aid in finding this
chains distant.

05
from which this Corner bears *N. 70° W.*
side of *TRX*
tree *D.* inches diameter, on the *N.W.*
Metal Location Poster is on a *Birch*

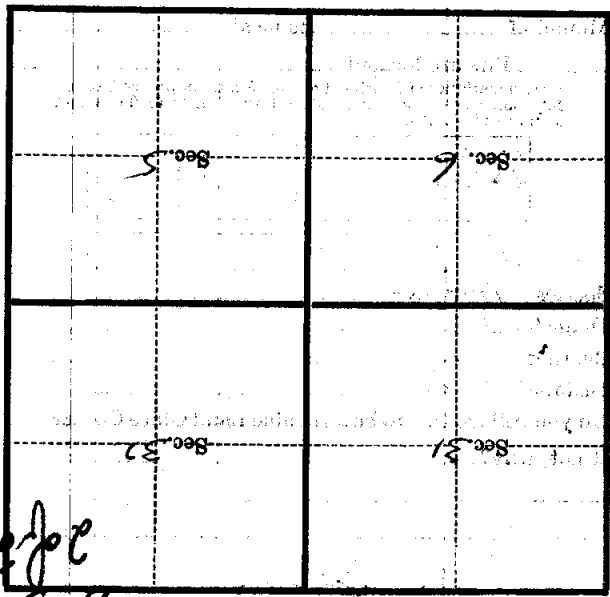

(Make sketch of topography near Corner)

Mer. *A-5* *STH* *R. 27N* *T. 52N*

2 of 2