

Form 874-0—Revised May, 1918
 U. S. Department of Agriculture
 FOREST SERVICE

N21
 P

CHIPPEWA NATIONAL FOREST

CORNERS OF THE PUBLIC SURVEY

T. 150 N. R. 26 W. 5th P. Mer.

SECTION Corner common to Sections

13, 14, 23, and 24

Corner consists of a WOODEN STAKE (1st) in place
 State condition Good

Dimensions above ground 323x36 inches

Sketch grooves, letters, figures, or notches, on proper face or edge.

CARDINAL POSITION

DIAGONAL POSITION

N	W	S	E

NW	SW	SE	NE
5	5	5	5
14	23	24	13

Mound of _____ is located _____

Pits are located _____

Sketch markings of Bearing Trees (or Rocks) in proper box and fill blanks below, giving bearings from Corner to Trees and Distances in Links.

S 24	S 23		
BT	BT		

Species THORNTON THORNTON

Diameter 7 in. 10 in.

Bearing S27NE S37NW

Distance .57 CM .65 CM

Do you believe this to be a genuine Land Office Corner? _____

If not, why? RESURVEY BY COUNTY

ENGINEER

Ralph L. Johnson
 (Signature)

JULY 17, 1935

FREMONT, CEM. CO. 7

(Date)

(Title)

T. 150 N. R. 26 W. S. 21 P. Mer.

(Make sketch of topography near Corner)

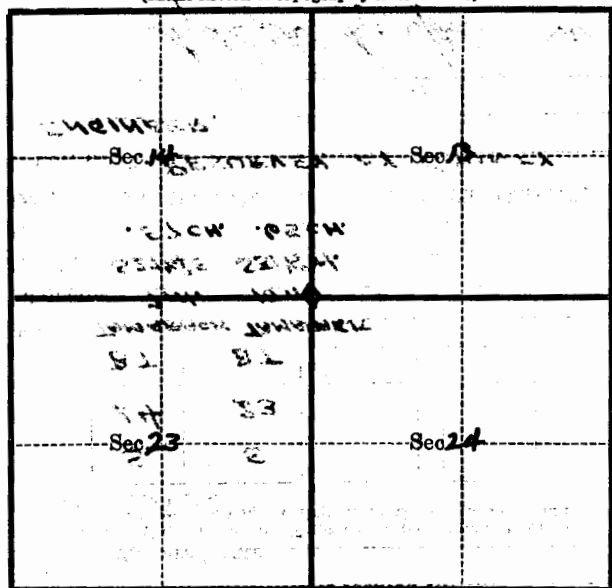

Metal Location Poster is on a TAMARACK
 tree 10 inches diameter, on the NE 1/4 12
 side of TREE
 from which this Corner bears N. 37 1/2 E
65 chains distant.

Give any further facts which will aid in finding this
 Corner again.

CORNER LOCATED IN SWAMP
R. ON PROPOSED ROAD CENTER LINE
SECTION
SW 1/4
SECTION
SW 1/4