

Form 874-0—Revised May, 1918
U. S. Department of Agriculture
FOREST SERVICE

N15

CHIPPEWA NATIONAL FOREST

CORNERS OF THE PUBLIC SURVEY

T. 150 N. R. 26 W. 5th P. Mer.

1/4 Corner common to Sections
15, and 22

Corner consists of a WOODEN STAKE (not) in place
State condition Good

Dimensions above ground 3 X 3 X 36 inches
Sketch grooves, letters, figures, or notches, on proper face or edge.

CARDINAL POSITION

DIAGONAL POSITION

<u>1/4</u>		<u>1/4</u>	
<u>5</u>		<u>5</u>	
<u>15</u>		<u>22</u>	
N	W	S	E

NW	SW	SE	NE

Mound of _____ is located _____

Pits are located _____

Sketch markings of Bearing Trees (or Rocks) in proper box and fill blanks below, giving bearings from Corner to Trees and Distances in Links.

<u>5</u>	<u>5</u>		
<u>22</u>	<u>15</u>		
<u>BT</u>	<u>BT</u>		

Species SPRUCES? ASH?

Diameter 10 IN. 8 IN.

Bearing S 34 1/2° W N 51° E

Distance 59 CMS. 1.09 CMS.

Do you believe this to be a genuine Land Office Corner? _____

If not, why? RESURVEY BY COUNTY
ENGINEER

Ralph L. Johnson
(Signature)

JUNE 17, 1935 FREEMAN, C.R.M., C.U.-7
(Date) (Title)

T. 150 N. R. 26 W. 5TH P Mer.

(Make sketch of topography near Corner)

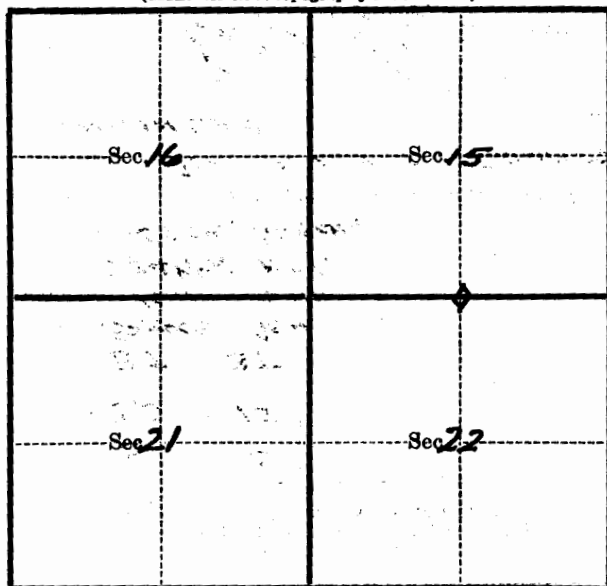

Metal Location Poster is on a SPRUCE
tree 10 inches diameter, on the NE
side of TREE
from which this Corner bears N. 34 1/4° E
.59 chains distant.

Give any further facts which will aid in finding this
Corner again.

CORNER LOCATED ON LOW
GROUND & ON PROPOSED ROAD
CENTER LINE.