

Form 874-9—Revised May, 1918
U. S. Department of Agriculture
FOREST SERVICE

P
V13

Chippewa NATIONAL FOREST

CORNERS OF THE PUBLIC SURVEY

T. 150 N. R. 26 W. 5th Mer.

Section Corner common to Sections

27, 28, 33, and 34

Corner consists of a Ash Post (~~stone~~) in place

State condition Good

Dimensions above ground 36 inches

Sketch grooves, letters, figures, or notches, on proper face or edge.

CARDINAL POSITION

DIAGONAL POSITION

--	--	--	--

N W S E

--	--	--	--

NW SW SE NE

Mound of _____ is located _____

Pits are located _____

Sketch markings of Bearing Trees (or Rocks) in proper box and fill blanks below, giving bearings from Corner to Trees and Distances in Links.

New B.T.
by County
No Scrips
MKS

Species Ash

Diameter 5"

Bearing N. 13° E

Distance ?

Do you believe this to be a genuine Land Office Corner? yes

If not, why? _____

J. A. Gjelhaug

(Signature)

Jr. Civil Engr.

(Title)

1/10/36

(Date)

T. 150N R. 26W 5th Mer.

(Make sketch of topography near Corner)

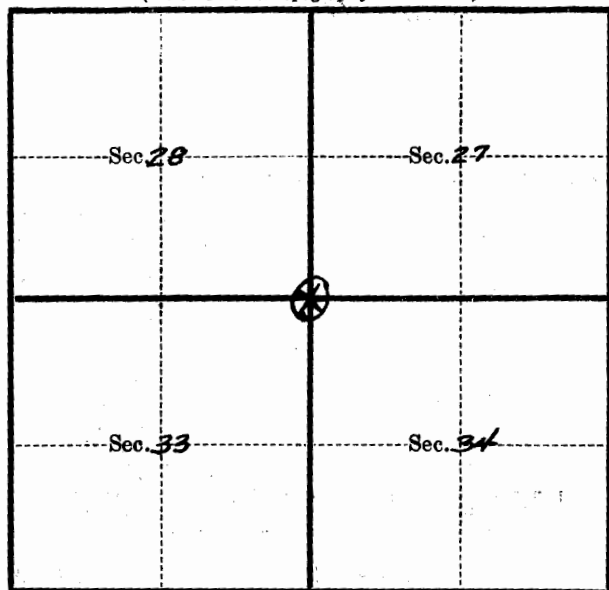

Metal Location Poster is on a Ash
tree 5 inches diameter, on the South
side of tree
from which this Corner bears S. 13° W.
0.07 chains distant.

Give any further facts which will aid in finding this
Corner again.

Old scribed post orig. B.I.s. lost.
Post is in line with old orig. line blazes E &
N & S.