

U. S. Department of Agriculture  
FOREST SERVICEChippewa NATIONAL FOREST

## CORNERS OF THE PUBLIC SURVEY

T. 150N. R. 26W. 5<sup>m</sup> Mer.Quarter Corner common to Sections, , 33, and 34Corner consists of a Tam. Post (~~set~~) in placeState condition Good (set new post)Dimensions above ground 36 inches

Sketch grooves, letters, figures, or notches, on proper face or edge.

CARDINAL POSITION

DIAGONAL POSITION

--	--	--	--

N W S E

--	--	--	--

NW SW SE NE

Mound of \_\_\_\_\_ is located \_\_\_\_\_

Pits are located \_\_\_\_\_

Sketch markings of Bearing Trees (or Rocks) in proper box and fill blanks below, giving bearings from Corner to Trees and Distances in Links.

<u>1/4</u> <u>S</u>			

Species Tam. Scacl \_\_\_\_\_Diameter 4" \_\_\_\_\_Bearing N. 65° E \_\_\_\_\_Lks. Distance 63 \_\_\_\_\_Do you believe this to be a genuine Land Office Corner? yes

If not, why? \_\_\_\_\_

\_\_\_\_\_

\_\_\_\_\_

J. A. Gjelhaug

(Signature)

1/10/36

(Date)

Jr. Civil Engr

(Title)

T. 150 N R. 26 W 5<sup>th</sup> Mer.

(Make sketch of topography near Corner)

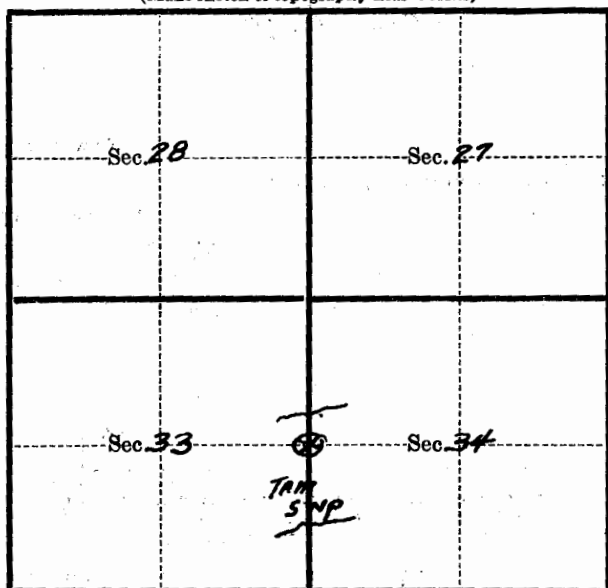

Metal Location Poster is on a *Tam dead. orig B.T.*  
tree *4*" inches diameter, on the *S.W.*  
side of *Tree*  
from which this Corner bears *S. 65° E*  
*0.63* chains distant.

Give any further facts which will aid in finding this  
Corner again.