

Form 874-9—Revised May, 1918
U. S. Department of Agriculture
FOREST SERVICE

N-21
N21

Chippewa NATIONAL FOREST

CORNERS OF THE PUBLIC SURVEY

T. 149 N. R. 31 W. 5th Mer.

Section Corner common to Sections

14 15 23 and 24

Corner consists of a (not) in place

State condition No stake found

Dimensions above ground inches

Sketch grooves, letters, figures, or notches, on proper face or edge.

CARDINAL POSITION

DIAGONAL POSITION

--	--	--	--

N W S E

--	--	--	--

NW SW SE NE

Mound of is located

Pits are located

Sketch markings of Bearing Trees (or Rocks) in proper box and fill blanks below, giving bearings from Corner to Trees and Distances in Links.

	T. 149 R. 31 S. 23		
	BT	← not sure	

Species Cedar Cedar

Diameter 11" ← 10

Bearing S. 88° E. S 88° W

Distance 32 lks. 20

Do you believe this to be a genuine Land Office Corner? Yes

If not, why?

T. Fairbanks

T. Fairbanks

(Signature)

Enrollee

(Title)

4/1/36

(Date)

N-21

(Make sketch of topography near Corner)

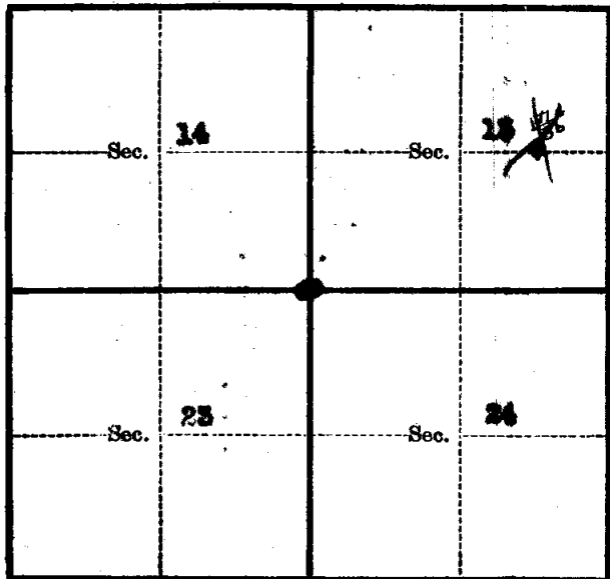

Metal Location Poster is on a Cedar Tree
 tree 5 inches diameter, on the SE
 side of Tree
 from which this Corner bears S. 70° E.
.20 chains distant.

Give any further facts which will aid in finding this
 Corner again.

Blazed line from East and North.

