

Form 874-9--Revised May, 1918
U. S. Department of Agriculture
FOREST SERVICE

25

Chippewa NATIONAL FOREST

CORNERS OF THE PUBLIC SURVEY

T. 149 N R. 29 W 5th. P. Mer.
Quarter

Corner common to Sections

-----, 19, and 20

Corner consists of a Ask post (~~rod~~) in place

State condition Good

Dimensions above ground 48 inches

Sketch grooves, letters, figures, or notches, on proper face or edge.

CARDINAL POSITION

DIAGONAL POSITION

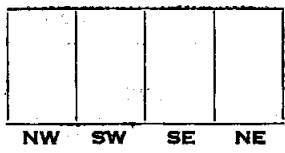
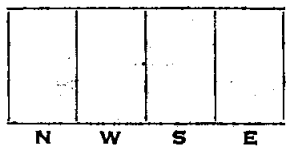

Mound of ----- is located -----

Pits are located -----

Sketch markings of Bearing Trees (or Rocks) in proper box and fill blanks below, giving bearings from Corner to Trees and Distances in Links.

New	BT 18		
	SK 9	S 20	
	BT	BT	

Species Aspen Balsam

Diameter 3" 62

Bearing N24°W N74°E

Distance 82 92

Do you believe this to be a genuine Land Office Corner? yes

If not, why? -----

John A. Gjelhaug

(Signature)

Jr. Civil Eng.

(Title)

5/16/39

(Date)

Corner again.

Give any further facts which will aid in finding this

0.11 chains distant.

From which this Corner bears S89°W

side of Tree

tree 1 1/2 inches diameter, on the West

Metal Location Poster is on a Aspen

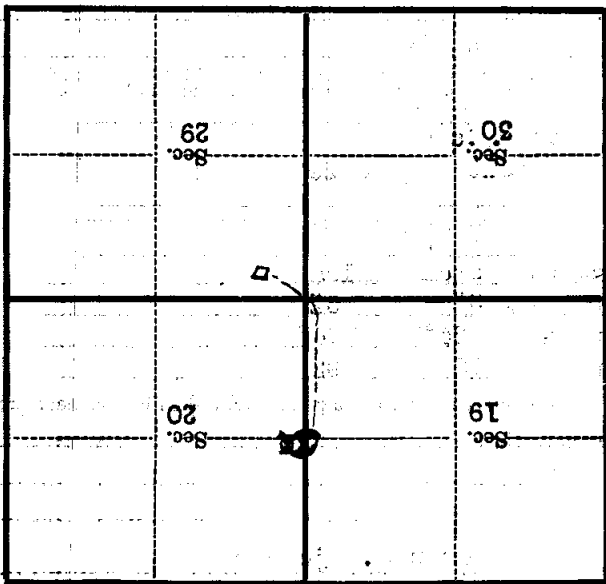

(Make sketch of topography near Corner)

T. 149 N. R. 82 29W 5th. P. Mer.

Form 874-B—Revised May, 1918
U. S. Department of Agriculture
FOREST SERVICE

25

Chippewa NATIONAL FOREST

CORNERS OF THE PUBLIC SURVEY

T. 149 N R. 29 W 5th. P. Mer.

Section _____ Corner common to Sections

19, 20, 29, and 30

Corner consists of a Cedar post (not) in place

State condition Good

Dimensions above ground 60 inches

Sketch grooves, letters, figures, or notches, on proper face or edge.

CARDINAL POSITION

DIAGONAL POSITION

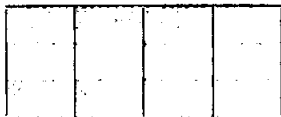

Mound of _____ is located _____

Pits are located _____

Sketch markings of Bearing Trees (or Rocks) in proper box and fill blanks below, giving bearings from Corner to Trees and Distances in Links.

Orig. BTS

down stub
burnt

BT

Species Pine Blasam Stp.

Diameter 12" 10"

Bearing N81°W S55°E

Distance 34 27

Do you believe this to be a genuine Land Office Corner? yes

If not, why? _____

John A. Gjelhaug

(Signature)

Jr. Civil Eng.

(Title)

5/16/39

(Date)

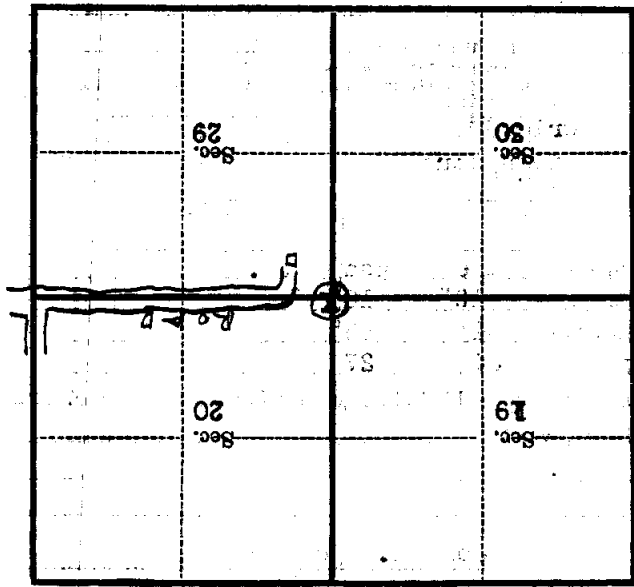

(Make sketch of topography near Corner)

T. 149 N. R. 29 W. 5th. B. Mer.

Metal Location Poster is on a Cedar post for cor. South side of Post where ~~is located~~ this Corner ~~is located~~ is located chains distant. Give any further facts which will aid in finding this Corner again. No trees near. Pasture and burned over area.