

U. S. Department of Agriculture  
FOREST SERVICE

VE21

Chippewa NATIONAL FOREST

CORNERS OF THE PUBLIC SURVEY

T. 149 N R. 28 W S. 11 Mer. Sec. \_\_\_\_\_

Corner common to Sections 1, 2, 11, and 12

Corner consists of a Tamarac Stakes (not) in place  
State condition Good

Dimensions above ground 24 inches  
Sketch grooves, letters, figures, or notches, on proper face or edge.  
CARDINAL POSITION DIAGONAL POSITION

N	W	S	E

S	T 149N R28W	S	S
2	S11	12	1
NW	SW	SE	NE

Mound of \_\_\_\_\_ is located \_\_\_\_\_

Pits are located \_\_\_\_\_

Sketch markings of Bearing Trees (or Rocks) in proper box and fill blanks below, giving bearings from Corner to Trees and Distances in Links.

R28			
S-11			
B. T.			

Species Tamarac STUMPS

Diameter 8"

Bearing S52W

Distance 18 LKS

Do you believe this to be a genuine Land Office Corner? yes

If not, why? \_\_\_\_\_

Field Man: Hamre by A.C. Norman  
(Signature)

Oct. 16, 1935  
(Date)

J.F.  
(Title)

In edge of swamp of old burning

Corner again.

Give any further facts which will aid in finding this

18 links chains distant.

from which this Corner bears N 4. E

side of trees

tree 4 inches diameter, on the N E

Metal Location Poster is on a BALSAM

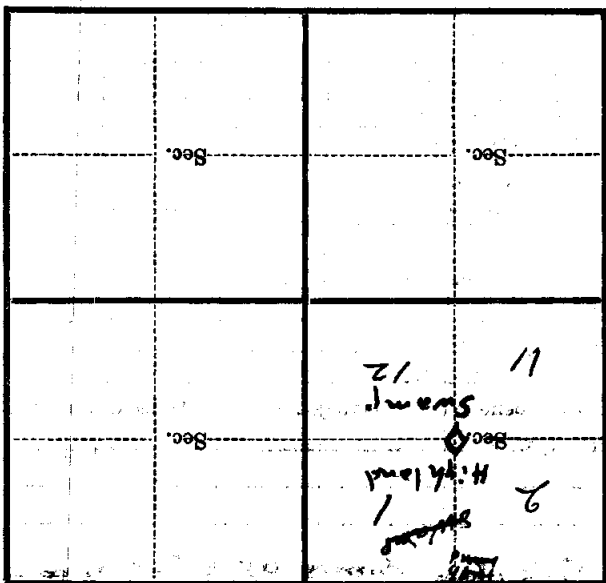

(Make sketch of topography near Corner)

T. 149 N. R. 28 W. 5 P. Mer.

Form 874-9—Revised May, 1918  
 U. S. Department of Agriculture  
 FOREST SERVICE

Chippewa NATIONAL FOREST

CORNERS OF THE PUBLIC SURVEY

T. 149N R. 28W 5P Mer.  
Sec. Corner common to Sections

1, 2, 11, and 12

Corner consists of a Tamarac stake (~~not~~) in place  
 State condition Good

Dimensions above ground 24 inches  
 Sketch grooves, letters, figures, or notches, on proper face or edge.

CARDINAL POSITION

DIAGONAL POSITION

N	W	S	E

S	T 149N	S	S
2	R 28W	12	1
	S 11		
NW	SW	SE	NE

Mound of \_\_\_\_\_ is located \_\_\_\_\_

Pits are located \_\_\_\_\_

Sketch markings of Bearing Trees (or Rocks) in proper box and fill blanks below, giving bearings from Corner to Trees and Distances in Links.

R-28			
S-11			
B-T	1		

Species Tamarac STUMP

Diameter 8"

Bearing S 53 W

Distance 18 LKS

Do you believe this to be a genuine Land Office Corner? yes

If not, why? \_\_\_\_\_

\_\_\_\_\_

\_\_\_\_\_

\_\_\_\_\_

Field Man: Harve by J. C. Norman  
 (Signature)

Oct. 16, 1935  
 (Date)

\_\_\_\_\_  
 (Title)

In edge of swamp off old burning.

Corner again.

Give any further facts which will aid in finding this

187 links ~~about~~ distant.

from which this Corner bears

N 40° E

side of

Tree.

tree 4 inches diameter, on the N E

Metal Location Poster is on a Balsam

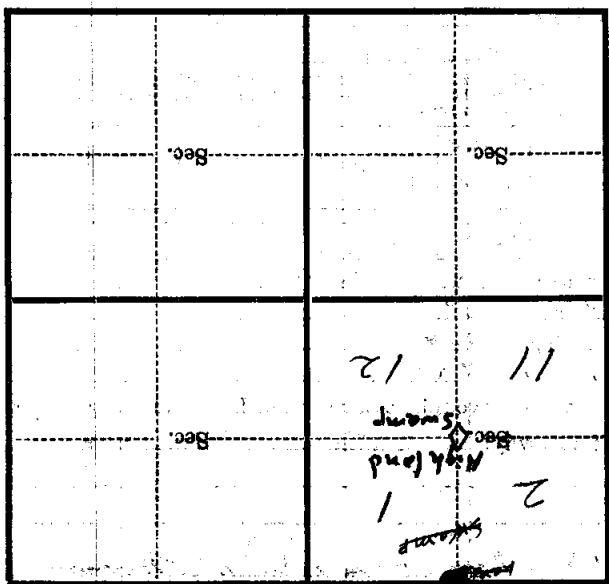

Make sketch of topography near Corner

T. 149N R. 28W S.P. Mer.