

U. S. Department of Agriculture
FOREST SERVICE

----- NATIONAL FOREST

CORNERS OF THE PUBLIC SURVEY

T. 49 N R. 28 W Mer.

----- Corner common to Sections
12, 23, 34, and 45-----

Corner consists of a AS? (not) in place
State condition AS?

Dimensions above ground 48 inches
Sketch grooves, letters, figures, or notches, on proper face or edge.

CARDINAL POSITION

DIAGONAL POSITION

--	--	--	--

N W S E

		S	X 12 3 N K 2 2 2
		4.	S 3 3

NW SW SE NE

Mound of ----- is located -----

Pits are located -----

Sketch markings of Bearing Trees (or Rocks) in proper box and fill blanks below, giving bearings from Corner to Trees and Distances in Links.

Species -----

Diameter -----

Bearing -----

Distance -----

Do you believe this to be a genuine Land Office Corner? Yes

If not, why? -----

(Signature)

(Date)

(Title)

2-9

Metal Location Poster is on a tree _____ inches diameter, on the _____ side of _____ from which this Corner bears _____ chains distant.

Give any further facts which will aid in finding this Corner again.

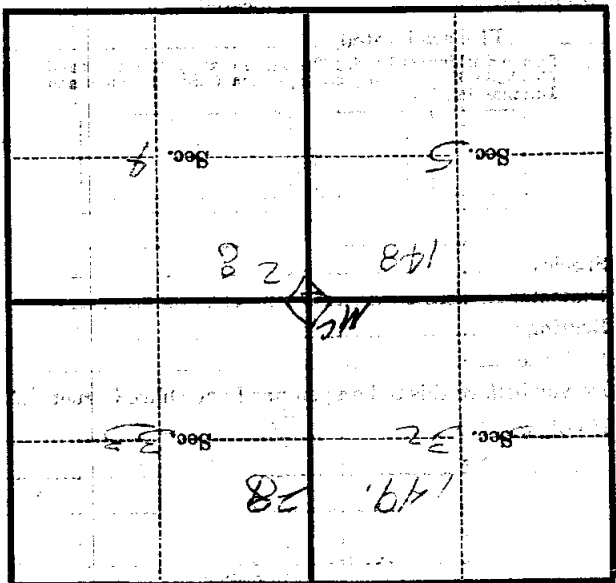

(Make sketch of topography near Corner)

Form 874-9—Revised May, 1918
 U. S. Department of Agriculture
 FOREST SERVICE

29
P

Chippewa NATIONAL FOREST

CORNERS OF THE PUBLIC SURVEY

T. 149 N. R. 28 W. 5th Mer.
 Section

Corner common to Sections
 _____, _____, 32, and 33

Corner consists of a ASPEN post (not) in place
 State condition fair

Dimensions above ground 46 inches
 Sketch grooves, letters, figures, or notches, on proper face or edge.

CARDINAL POSITION

DIAGONAL POSITION

N	W	S	E

S. 32		S 4	T149N R28W S.33
NW	SW	SE	NE

Mound of _____ is located _____

Pits are located _____

Sketch markings of Bearing Trees (or Rocks) in proper box and fill blanks below, giving bearings from Corner to Trees and Distances in Links.

None	found		

Species _____
 Diameter _____
 Bearing _____
 Distance _____

Do you believe this to be a genuine Land Office Corner? Yes
 If not, why? _____

W. E. ...
 (Signature)

7/3/35.
 (Date)

Chief of party. c. c. c.
 (Title)

2-9

Corner again.

Give any further facts which will aid in finding this

chains distant.

from which this Corner bears

side of

tree inches diameter, on the

Metal Location Poster is on a

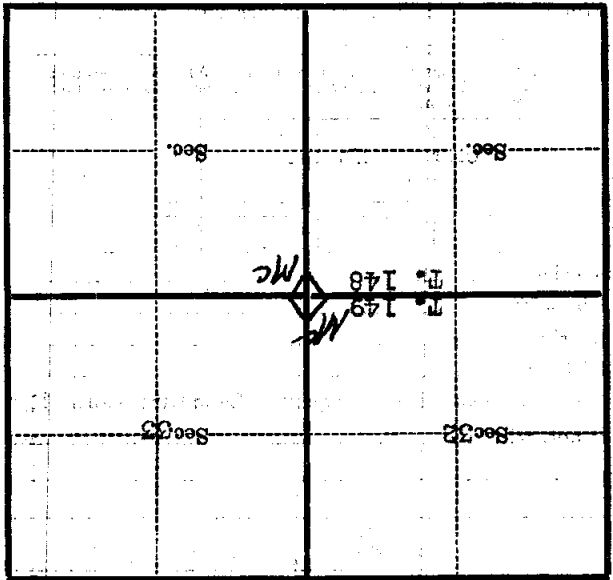

(Make sketch of topography near Corner)

T. 149 N. R. 28 W. S. 4th Mer.