

Form 874-9—Revised May, 1918  
U. S. Department of Agriculture  
FOREST SERVICE

N25

Posted

~~Chippewa Acq.~~ NATIONAL FOREST  
CORNERS OF THE PUBLIC SURVEY

T. 149 N R. 27 W 5th Mer.  
section Corner common to Sections  
13, 14, 18, and 19

Corner consists of a \_\_\_\_\_ (not) in-place  
State condition \_\_\_\_\_

Dimensions above ground \_\_\_\_\_ inches  
Sketch grooves, letters, figures, or notches, on proper face or edge.

CARDINAL POSITION

DIAGONAL POSITION

--	--	--	--

--	--	--	--

N W S E

NW SW SE NE

Mound of \_\_\_\_\_ is located \_\_\_\_\_

\_\_\_\_\_ Pits are located \_\_\_\_\_

Sketch markings of Bearing Trees (or Rocks) in proper box and  
fill blanks below, giving bearings from Corner to Trees and  
Distances in Links.

S 24	
---------	--

--	--

S 19	
---------	--

--	--

B. T.	
-------	--

--	--

B. T.	
-------	--

--	--

Species	<u>Norway pine</u>	<u>white pine</u>
Diameter	<u>15</u>	<u>18</u>
Bearing	<u>S 70 W</u>	<u>S 49 E</u>
Distance	<u>1.45 chains</u>	<u>1.19 chains</u>

Do you believe this to be a genuine Land Office Corner? Yes

If not, why? \_\_\_\_\_

*Roy Wilson*

(Signature)

1/23/35  
(Date)

chief of party cco  
(Title)

N-25

Series of horizontal dashed lines for writing.

Corner again.

Give any further facts which will aid in finding this

0.25 chains distant.

from which this Corner bears west

side of tree

tree 6 inches diameter, on the east

Metal Location Poster is on a Aspen

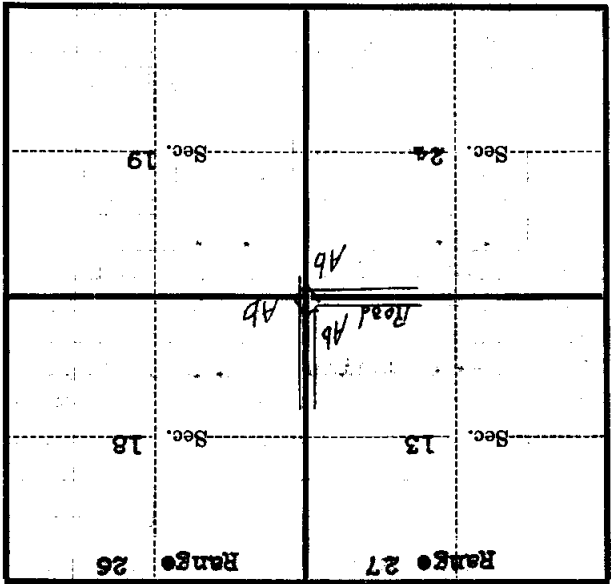

(Make sketch of topography near Corner)

**U. S. Department of Agriculture**  
**FOREST SERVICE**

..... NATIONAL FOREST

**CORNERS OF THE PUBLIC SURVEY**

T. 13 R. 24 Mer.

..... Corner common to Sections

13, 24, 13, and 14

Corner consists of a ..... (not) in place  
State condition .....

Dimensions above ground ..... inches

Sketch grooves, letters, figures, or notches, on proper face or edge.

CARDINAL POSITION

DIAGONAL POSITION

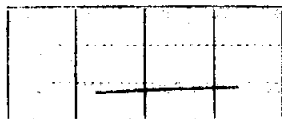

N W S E

NW SW SE NE

Mound of ..... is located .....

Pits are located .....

Sketch markings of Bearing Trees (or Rocks) in proper box and fill blanks below, giving bearings from Corner to Trees and Distances in Links.

24		19	
BT		BT	

Species Yucca, Oak White Oak

Diameter 15" 14"

Bearing S70°W S44°E

Distance 14.51 11.91

Do you believe this to be a genuine Land Office Corner? Yes

If not, why? .....

(Signature)

Chas. J. P. K.  
(Title)

1-23-35  
(Date)

Lined area for notes at the top of the page.

Corner again.

Give any further facts which will aid in finding this

25 H chains distant.

from which this Corner bears West

side of 1500

tree 6 inches diameter, on the East

Metal Location Poster is on a A.S.P.

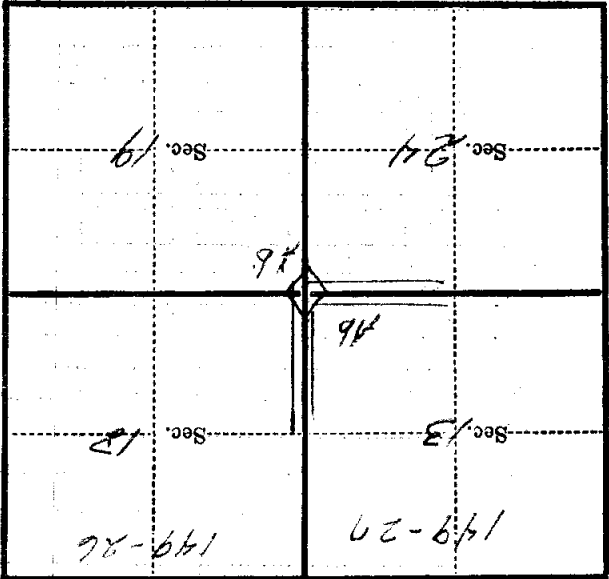

(Make sketch of topography near Corner)

U. S. Department of Agriculture  
FOREST SERVICE

Chippewa NATIONAL FOREST

CORNERS OF THE PUBLIC SURVEY

T. 149 R. 2726 S Mer.  
Sec. Corner common to Sections  
13, 18, 24, and 19

Corner consists of a \_\_\_\_\_ (not) in place  
State condition \_\_\_\_\_

Dimensions above ground \_\_\_\_\_ inches

Sketch grooves, letters, figures, or notches, on proper face or edge.

CARDINAL POSITION

DIAGONAL POSITION

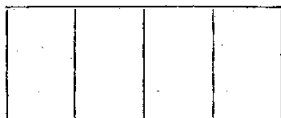

N W S E

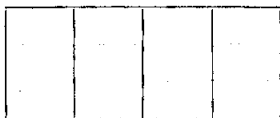

NW SW SE NE

Mound of \_\_\_\_\_ is located \_\_\_\_\_

Pits are located \_\_\_\_\_

Sketch markings of Bearing Trees (or Rocks) in proper box and fill blanks below, giving bearings from Corner to Trees and Distances in Links.

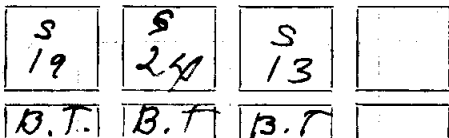

Species W. pine N. pine Aspen  
Diameter 18" 14" 16"  
Bearing S30E S70W N45W  
Distance 20 Lks. 80 Lks. 45 Lks.

Do you believe this to be a genuine Land Office Corner? Yes.

If not, why? \_\_\_\_\_

O. Sherman  
(Signature)

(Date)

(Title)

-----

-----

-----

-----

-----

-----

-----

-----

-----

-----

Corner again.

Give any further facts which will aid in finding this

chains distant.

from which this Corner bears

side of

*Tree.*

tree  $\frac{4}{4}$  inches diameter, on the *East*

Metal Location Poster is on a *Paplar*

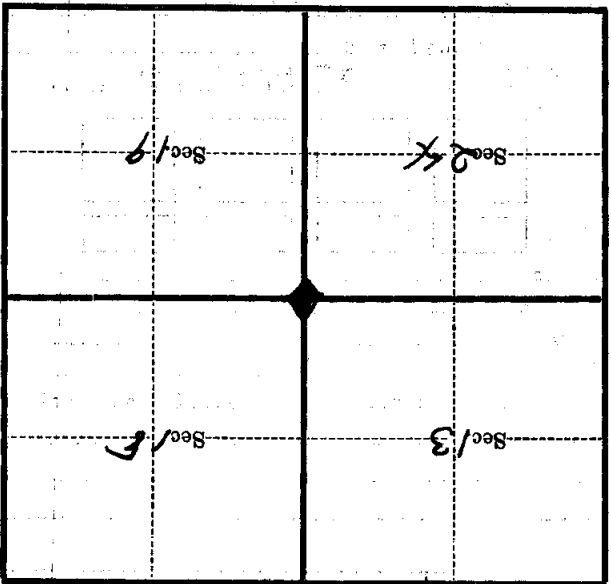

(Make sketch of topography near Corner)

T. 149 R. 27 Mer. 5